



CITY OF NEW YORK

MANHATTAN COMMUNITY BOARD FOUR

330 West 42nd Street, 26th floor New York, NY 10036
tel: 212-736-4536 fax: 212-947-9512
www.nyc.gov/mcb4

COREY JOHNSON
Chair

ROBERT J. BENFATTO, JR., ESQ.
District Manager

June 5, 2013

Dennis Rosen
Chairman
New York State Liquor Authority
80 S. Swan Street, 9th Floor
Albany, New York 12210

**Re: 210 Tenth Avenue, LLC
d/b/a The Diner
210 10th Avenue (22/23)**

Dear Chairman Rosen:

Manhattan Community Board 4 (MCB4) recommends denial of transfer restaurant license for 210 Tenth Avenue d/b/a The Diner – 210 10th Avenue (22/23) unless the following stipulation, agreed to by the applicant, is part of the method of operation for this establishment with a capacity of about 100, with 22 tables and 64 seats, one stand-up bar with 11 seats and 80 seats with 28 tables outside within building property line.

A signed copy of the questionnaire, stipulations and community agreements are enclosed.

Sincerely,

Corey Johnson
Chair

[signed 06/05/13]
Paul Seres
Co-Chair
Business License &
Permits Committee

[signed 06/05/13]
Lisa Daglian
Co-Chair
Business License &
Permits Committee

Manhattan Community Board 4

Liquor License Stipulations Application

(All Fields Must Be Completed)

APPLICANT 210 Tenth Avenue LLC		DOING BUSINESS AS (DBA) FBO.	
STREET ADDRESS 210 Tenth Avenue		CROSS STREETS 22nd & 23rd streets	
OWNER	NAME: Mark Amadei	ATTORNEY	NAME: R. Bookman
	PHONE: 917-207-0374		PHONE: 212-513-1988
	FAX: 646-861-6541		FAX: 212-385-0564
MANAGER	NAME: A. Glassberg	LANDLORD	NAME: C. Levinson
	PHONE: 917-714-6676		PHONE: 516-313-9929
	FAX: 646-861-6541		FAX: 212-619-1358
DESCRIPTION OF BUSINESS			
Establishment Type:		<input type="radio"/> Bar/Tavern <input type="radio"/> Bed & Breakfast <input type="radio"/> Eating Place Beer <input type="radio"/> Cabaret <input type="radio"/> Night Club <input type="radio"/> Hotel <input checked="" type="radio"/> Restaurant <input type="radio"/> Catering Establishment <input type="radio"/> Club (Fraternal Organization - Members Only) <input type="radio"/> Other (Explain): _____	
Method of Operation:		<input checked="" type="radio"/> Restaurant <input type="radio"/> Dance Club <input type="radio"/> Sports Bar <input type="radio"/> Adult Entertainment <input type="radio"/> Wine Bar <input type="radio"/> Pizzeria <input type="radio"/> Cafe <input type="radio"/> Other (Explain): _____	
License Type:		<input checked="" type="radio"/> On-Premise <input type="radio"/> Wine <input type="radio"/> Beer <input type="radio"/> Wine & Beer	
APPLICATION TYPE <i>(check one)</i>	<input checked="" type="radio"/> New	Has applicant owned or managed a similar business?	<input checked="" type="radio"/> YES <input type="radio"/> NO
		What is/was the name of establishment?	(1) Lion
		What is/was the address of the establishment?	62 W. 9th St ↓
		What were the dates the applicant was involved with this former premise?	
	<input type="radio"/> Transfer	What is the prior license #?	
		What is the expiration date on the prior license?	
		Are you making any alterations or operational changes?	YES NO
		<i>If alterations or operational changes are being made, please attach the plans to this form.</i>	
	<input type="radio"/> Alteration	What is the current license #?	
		What is the expiration date on the current license?	
<i>Please describe the nature of the alterations and attach the plans</i>			

Business Licenses & Permits Committee

(2) Delicatessen
@ 54 Prince St
(3) Bills food & DRINK
57 E. 54th St.

OPERATIONAL ISSUES										
HOURS		MONDAY	TUESDAY	WEDNESDAY	THURSDAY	FRIDAY	SATURDAY	SUNDAY		
	Operation	6AM-4AM	6AM-4AM	6AM-4AM	6AM-4AM	6AM-4AM	6AM-4AM	6AM-4AM	6AM-4AM	
	Music	background								
	Kitchen	6AM-4AM	6AM-4AM	6AM-4AM	6AM-4AM	6AM-4AM	6AM-4AM	6AM-4AM	6AM-4AM	
OCCUPANCY	INDOOR				BAR			OUTSIDE		
	Capacity (Certificate of Occupancy)	Maximum # of Persons You Anticipate Occupying Premises (Including Employees)	Number of Tables	Number of Seats	Number of Service Only Bars	Number of Stand-Up Bars	Number of Seats at Bars	Number of Seats	Number of Tables	
	N/A	N/100	22	64	Ø	1	11	80	28	
How many floors are there? What is the capacity for each floor? (please respond in space provided)					<input checked="" type="radio"/> 1-2	<input type="radio"/> 3-4	<input type="radio"/> 5+			
Will you be applying or intending to apply for a cabaret license? If yes, will there be dancing? (please respond in space provided)					YES	<input checked="" type="radio"/> NO	N/A			
Will applicant have bottle service?					YES	<input checked="" type="radio"/> NO	N/A			
Will you be hosting private parties and promotional events?					<input checked="" type="radio"/> YES	<input type="radio"/> NO	N/A			
Will outside promoters be used?					YES	<input checked="" type="radio"/> NO	N/A			
Will the security plan submitted be implemented?					YES	NO	<input checked="" type="radio"/> N/A			
Will State certified security personnel be used?					YES	NO	<input checked="" type="radio"/> N/A			
Will New York Nightlife Association recommendations and NYPD Best Practices be followed?					<input checked="" type="radio"/> YES	NO	N/A			
Will the applicant be using delivery bicycles? If yes, have you applied to DOT for bicycle rack? Delivery bicycles are to be clearly marked with the name of the restaurant and staff will wear attire clearly noting name. (please respond in space provided)					<input checked="" type="radio"/> YES	NO	N/A			
Will the applicant be applying for a Sidewalk Café now or in the future? (please respond in space provided)					<input checked="" type="radio"/> YES	NO	N/A			
If yes to the above, are plans attached and submitted to DCA? How many tables/seats? (please respond in space provided)					<input checked="" type="radio"/> YES	NO	N/A			
Will applicant provide contact information to neighbors and respond to complaints that arise?					<input checked="" type="radio"/> YES	NO	N/A			
Will you inform the Community Board office of your job openings and/or provide a hyperlink to your jobs webpage?					<input checked="" type="radio"/> YES	NO	N/A			
If you plan to have music, what type(s)?			<input checked="" type="radio"/> BACKGROUND	<input type="radio"/> LIVE MUSIC	<input type="radio"/> DJ					
BUILDING DESIGN										
Doors and windows will be closed when any amplified music is played and in the event of no amplified sound, will be closed by 11 PM Friday and Saturday and 10 PM on all other days.					YES	NO	<input checked="" type="radio"/> N/A			
Will applicant follow the recommendations of a certified sound engineer to mitigate potential noise disturbance to the neighboring residents and buildings, including placing speakers on the floor of the establishment?					<input checked="" type="radio"/> YES	NO	N/A			
Do you agree to comply with DOB rules concerning a storm enclosure? Storm enclosures can be used between November 15 and April 15, but they may NOT project more than 18 inches from the store front.)					<input checked="" type="radio"/> YES	NO	N/A			

OUTDOOR ITEMS				
Will applicant use the rooftop, rear yard or any outdoor space?	<input checked="" type="radio"/> YES	<input type="radio"/> NO	<input type="radio"/> N/A	Sidewalk cafe
If yes to the above, the rear yard, rooftop, and any outdoor space will be closed and vacated by 11 PM on Friday & Saturday and 10 PM on all other days.	<input type="radio"/> YES	<input checked="" type="radio"/> NO	<input type="radio"/> N/A	asking for respect/curfew hours (12 AM / 1 AM)
The service and consumption of alcohol in the rear yard, on the rooftop, or in any other outdoor space will be only via seated food service.	<input checked="" type="radio"/> YES	<input type="radio"/> NO	<input type="radio"/> N/A	
The rear yard, rooftop, and any other outdoor space will not allow standing space for patrons to drink or smoke.	<input checked="" type="radio"/> YES	<input type="radio"/> NO	<input type="radio"/> N/A	
Applicant will do everything in their power to provide an effective sound baffling or sound controlled environment through landscaping or some type of enclosure, where possible; provided they do not violate any fire or building code regulations? This includes possibly working with landlords for soundproofing tenants apartments (such as installing soundproofing windows, acoustical tiles, etc.).	<input checked="" type="radio"/> YES	<input type="radio"/> NO	<input type="radio"/> N/A	
Applicant will enforce a quiet environment in the outdoor space, so as not to disturb nearby residents (e.g. there will be no amplified music, as per the law, and windows and doors to areas that play amplified music shall be closed). The applicant will make every effort possible to limit the noise emanating from diners by posting signs outside and also on menus asking for respect of the neighbor's privacy and peace. The staff will also encourage a peaceful environment amongst the outdoor diners.	<input checked="" type="radio"/> YES	<input type="radio"/> NO	<input type="radio"/> N/A	
Applicant will have a lighting plan that will allow safe usage of the outdoor space without disrupting neighbors?	<input checked="" type="radio"/> YES	<input type="radio"/> NO	<input type="radio"/> N/A	

LOCATION & ZONING				
Primary Zoning District:	C-2	Overlay (If Applicable):	C2 w R8	
Is this a Special District? If yes, is it Clinton, West Chelsea or Hudson Yards?	<input type="radio"/> YES	<input checked="" type="radio"/> NO	<input type="radio"/> N/A	
Does the building have a Certificate of Occupancy ("C of O") or a letter of no objection?	<input checked="" type="radio"/> YES	<input type="radio"/> NO	<input type="radio"/> N/A	
Is the 500 Foot Rule or 200 Foot Rule Triggered? If yes, which? Please attach a diagram of the establishments that triggers the rule.	<input checked="" type="radio"/> YES	<input type="radio"/> NO	<input type="radio"/> N/A	500'
Is a Public Assembly permit required?	<input type="radio"/> YES	<input checked="" type="radio"/> NO	<input type="radio"/> N/A	
Are your plans filed with DOB?	<input type="radio"/> YES	<input checked="" type="radio"/> NO	<input type="radio"/> N/A	
Building Type	<input type="radio"/> Residential <input checked="" type="radio"/> Commercial <input type="radio"/> Mixed Use <input type="radio"/> Other, describe: _____			
Adjacent Buildings	<input type="radio"/> Residential <input checked="" type="radio"/> Commercial <input type="radio"/> Mixed Use <input type="radio"/> Other, describe: _____			
NOTIFICATION: What organizations / community groups have you notified regarding your application?	# 1	CONS OF Chelsea Block ASSOCIATIONS		
	# 2			
	# 3			

ADDITIONAL INFORMATION: (Applicant Use)

ADDITIONAL NOTES: (Office Use Only)

No changes to previous owner's method of operation

Manhattan Community Board 4 (MCB4) recommends:

Approval Denial unless all agreed to by applicant is part of the method of operation Denial

CB4 REPRESENTATIVES

Nelly Gonzalez
CB4 Community Associate



Lisa Daglian
CB4 BLP Committee Co-Chair

Paul Sires
CB4 BLP Committee Co-Chair

APPLICANT AGREEMENT WITH THE COMMUNITY

Pursuant to these stipulations, this applicant agrees to have these provisions incorporated in the method of operation of their liquor license. Additionally, the applicant agrees to the community agreements as the basis for the community supporting this application.

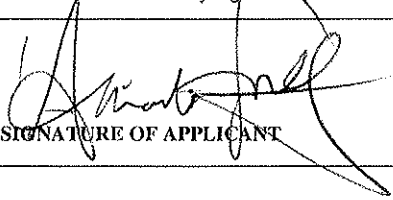
SIGN HERE →

SIGNATURE OF APPLICANT

5/14/13
DATE



CITY OF NEW YORK

MANHATTAN COMMUNITY BOARD No. 4

330 West 42nd Street, 26th floor New York, NY 10036
tel: 212-736-4536 fax: 212-947-9512
www.nyc.gov/mcb4

COREY JOHNSON
Chair

ROBERT J. BENFATTO, JR., ESQ.
District Manager

PUBLIC NOTICE

Business Licenses and Permits Committee
will discuss an application submitted by

**Entity to be formed by
Mark T. Amadei & Andrew
Glassberg
d/b/a The Diner
210 10th Avenue**

An application for an On-Premise Liquor License

DATE:	Tuesday, May 14, 2013
TIME:	6:30 PM
PLACE:	Intercontinental NY Time Square - 300 West 44 th Street

We invite you to attend this meeting and give your comments on this application.
Alternately, you may mail, fax or email us at the address listed above.
For more information, please call 212-736-4536.

DINER (210 10TH AVE)
BREAKFAST

CHEF'S SCRAMBLE

grains, greens, fresh cheese, roasted tomato & homemade hot
sauce
\$11

THE PERFECT OMELETTE

herbed omelette, lemon crème fraiche, 'smashed Yukon
potatoes
\$12

"JERSEY EGG SANDWICH"

imported Taylor ham, fried egg, melted leeks, cheddar,
English muffin
\$11

POACHED EGGS PARMESAN

Perfectly poached eggs, marinara, crostini, mozzarella,
basil
\$13

HUNGRY BEAR BREAKFAST

3 eggs anyway you want it, breakfast sausage, potato cakes,
Texas toast, popeye spinach, bottomless coffee
\$12

MIKE'S "MEXICAN" OATMEAL

Steel cut oats, cinnamon, sweet cream, dried mango, toasted
pepitas
\$8

FLUFFY BUTTERMILK PANCAKES

Maple butter, fresh ricotta, apricot puree
\$10

CRISPY BAGEL CHIPS & GRAVLAX

Hummus cream cheese, pickled red onions, caperberries
\$13

ACCESSORIES

Gooey grits \$4
Kale porridge \$5
Fruit salad \$7

Bacon, bacon, bacon \$7
BREAKFAST BEVERAGES

Cup of "joe" \$3
Cappuccino, latte, espresso, etc.... \$5
Orange Pekoe black tea \$3
Ice cold chocolate milk \$3
Arnold Palmer \$4
Mellow Mint tea \$3

Fresh OJ \$4
Kale, apple, lime juice \$6
Carrot, beet juice \$6
Dairy free smoothies \$5
Morning Honey Yogurt shake \$6

MID MORNING BACK UP PLAN
(take away)

AMANDA'S NUT-FREE GRANOLA BAR \$4
URBAN RANGER COOKIES (3) \$6
HOMEMADE CHEDDAR CHIVE BISCUIT \$3
PEANUT BUTTER BACON BARS \$5

LUNCH

SOUPS

MATZOH BALL MARROW SOUP

Double chicken broth, marrow bone, parsley, schmaltz
\$9

FRENCH ONION

Swiss cheese bread pudding croutons
\$8

SOUP OF THE DAY

\$8

SALADS

"CHOPPED" SALAD

romaine, bacon, poached turkey, eggs, green olives
\$16

"MEAN GREENS SALAD"

kale, preserved lemon, aged goat cheese, farro, roasted
garlic
\$15

"VINNIE'S SALAD"

salami, provolone, celery, oregano, peppers, arugula
\$17

"UNIQUE" BEET SALAD

raw beet, watercress, pistachio, mascarpone, sourdough
crouton
\$14

STUFFED AVOCADO

Crab salad, old bay mayo, lemon supremes, saltines
\$22

SANDWICHES

"THE BURGER"

brioche bun, special sauce, pickles & tomato
\$19

"CLOSET VEGETARIAN"

oven roasted vegetables, parsley pesto, grilled flatbread
\$17

CLASSIC GRILLED CHEESE

butter bathed with your choice of tomato, bacon or straight
up
\$13

HOT BROWN OPEN FACED TURKEY

Turkey bacon, mornay sauce, turkey gravy, herb salad
\$18

CRISPY FISH FILET "OLD SCHOOL"

Half roasted chicken, ricotta, carrots, charred lemons
\$23

STEAK AND POTATOES

Butcher's cut, marrow butter, fries, beef jus
p/a

PORK ON PORK CHOP

crispy pancetta, white beans, collards
\$22

NEW YORK BROOK TROUT ALMONDINE

brown butter, almonds, green beans
\$21

RIGATONI MARINARA

Fresh ricotta, basil, garlic, chili flake
\$18

RABBIT STEW GERMAN STYLE

spaetzle, bacon, pearl onions, rosemary
\$22

MEATBALL HERO

Tomato soaked garlic bread, the best balls, provolone
\$17

DAVID'S VEGETABLE LASAGNA

Spinach, zucchini, peppers, portobellos, extra cheese
\$17

"THE BURGER"

brioche bun, special sauce, pickles & tomato
\$19

FISH AND CHIPS

Haddock, spiced potato chips, malt vinegar aioli
\$20

VEAL PICCATA

capers, lemon, butter, rice porridge
\$28

SIDES

SALT N PEPPER FRIES \$8

CREAMY ORZO \$9

MASHED POTATOES & GRAVY &6

BROCCOLINI & LEMON GARLIC \$8

AMANDA'S COLE SLAW \$5

YELLOW & GREEN BEAN PESTO \$6

CAULIFLOWER TOMATO STEW \$6
EGGPLANT CAPONATA & CHICKPEA PANCAKE \$7
CREAMED SWISS CHARD \$8

Sweet treats

A PIECE OF THE "PIE"

Find out todays flavor and add some ice cream

p/a

SKYSCRAPER CHEESECAKE

Ooey gooey fruit topping

\$8

BANANA SPLIT

wet walnuts, chocolate sauce, strawberries, cherry on top

\$6

CHOCOLATE CHALLAH BREAD PUDDING

butterscotch chips, crème fraiche

\$6

GRANDMA'S ORANGE CHIFFON CAKE

orange curd, crystallized buttercream

\$5

STRAWBERRY MOUSSE

rhubard jam, shortbread cookie

\$7

COOKIES TO GO OR TO STAY

priced per piece

SOFT SERVE SUNDAE or CONE

Flavor of the day or a swirl of 2

\$5

HOT DONUT HOLES

Salted caramel

\$6

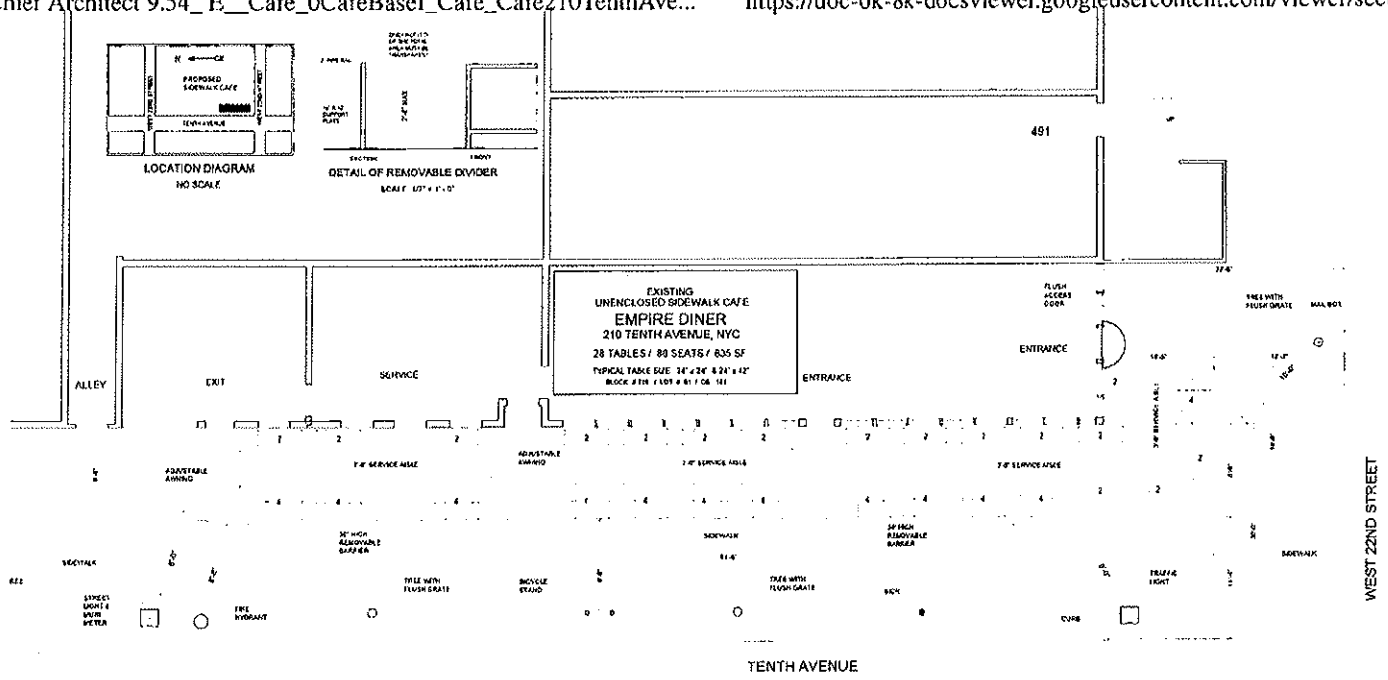

SITE PLAN

<p>JAMES GARRETSON ARCHITECT AIA</p> <p>38 BROADWAY, SUITE 1110, NEW YORK, NY 10006 212-310-3382 FAX 212-310-9432</p>	<p>EXISTING UNENCLOSED SIDEWALK CAFE 210 TENTH AVENUE, NYC</p>	<p>DATE: 04/21/13 SCALE: 1/8" = 1'-0"</p>	<p>1</p>
---	--	---	----------

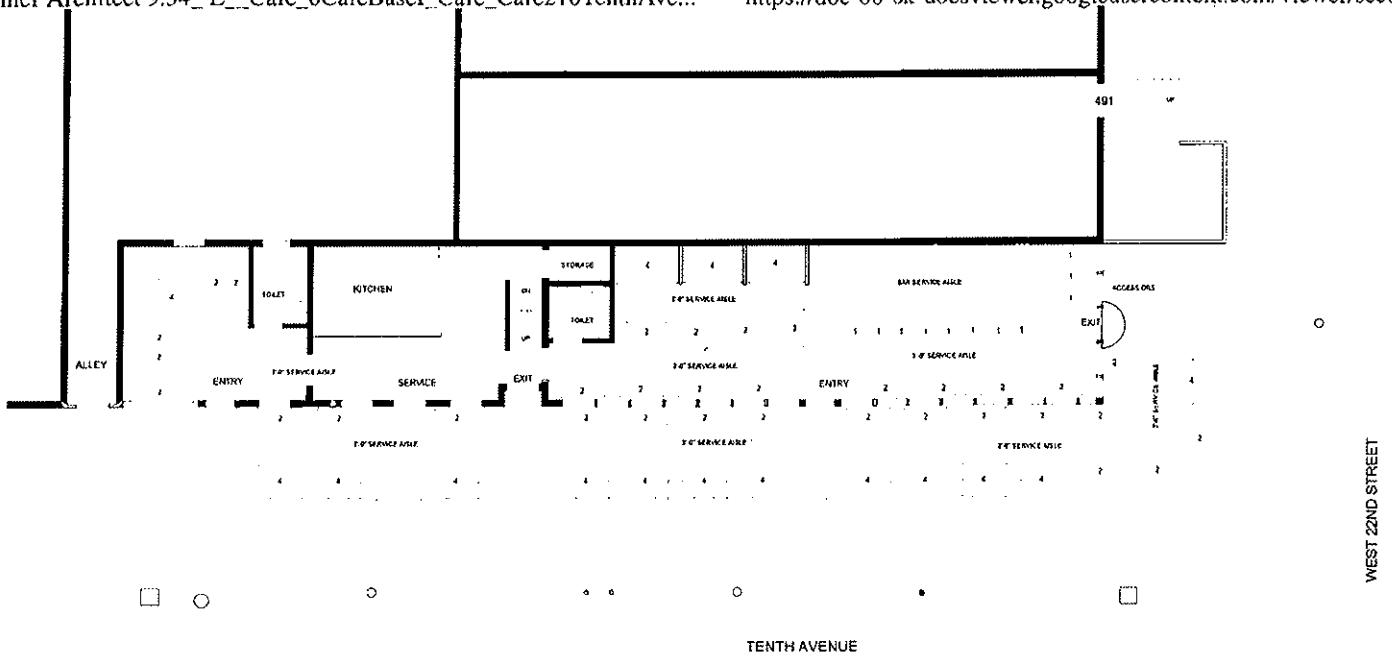

N ← PLAN

<p>JAMES GARRETSON ARCHITECT AIA</p> <p>38 UNDAWAY, SUITE 1110, NEW YORK, NY 10006 212-316-3692 FAX: 212-316-9410</p>	<p>RESTAURANT SEATING LAYOUT PLAN</p> <p>210 TENTH AVENUE, NYC</p>	<p>DATE: 04/21/13</p> <p>SCALE: 1/8"=1'-0"</p>	<p>1</p>
---	---	--	-----------------

PREMISES WITHIN 500 FEET

Legend

LEGEND

On Premises Licenses

- On Premises Liquor
- ▲ On Premises Wine and Beer
- On Premises Beer

Off Premise Licenses

- Off Premises Liquor
- ▲ Off Premises Wine
- Off Premises Beer

Wholesale Licenses

- Wholesale

Pending Licenses

- Pending

All Licenses

- On Premises Liquor
- ▲ On Premises Wine and Beer
- On Premises Beer
- Off Premises Liquor
- ▲ Off Premises Wine
- Off Premises Beer
- Wholesale
- Pending

Churches

- ⬇ Church

Schools

- School

Zones

- Zone

Community Boards

- Community Board

Police Precincts

- Police Precinct

Courts

- Court



Disclaimer: The NYS Liquor Authority is not responsible for the accuracy of maps or data obtained from third party sources.





W 22 St

MAY

EAT IT

DINED

COZ C-O-AZ-

PESETSKY and BOOKMAN
ATTORNEYS AT LAW
325 BROADWAY, SUITE 501
NEW YORK, N.Y. 10007

WARREN B. PESETSKY
ROBERT S. BOOKMAN*

(212) 513-1988
FAX: (212) 385-0564

RANDYE F. BERNFELD
Of counsel

April 2, 2013

Via Certified Mail

Community Board No. 4
330 West 42nd Street, Suite 2618
New York, NY 10036

**Re: An Entity to be formed by Mark T. Amadei &
Andrew Glassberg
d/b/a "The Diner"
210 10th Avenue
New York, NY 10011**

Dear Sir/Madam:

This letter is to serve as notification that the above referenced entity is filing for an on premise liquor license at the above referenced address.

Thank you for your attention to this matter.

Very truly yours,



Robert S. Bookman

RSB:dm

STATE OF NEW YORK
 EXECUTIVE DEPARTMENT
 DIVISION OF ALCOHOLIC BEVERAGE CONTROL
 STATE LIQUOR AUTHORITY

Standardized **NOTICE FORM** for Providing a 30-Day Advance Notice to a Local Municipality or Community Board in connection with the submission to the State Liquor Authority of a **(check one)**

New Application **Renewal Application** **Alteration Application**
 Corporate Change for an On-Premises Alcoholic Beverage License

1. Date the original copy of this Notice was mailed to the Local Municipality or Community Board: Month: 0 Day: 4 Month: 6 Day: 2 Year: 2013

THIS 30-DAY ADVANCE NOTICE IS BEING PROVIDED TO THE CLERK OF THE FOLLOWING LOCAL MUNICIPALITY OR COMMUNITY BOARD

2. Name of the Local Municipality or Community Board: Community Board No 4
ATTORNEY REPRESENTING THE APPLICANT IN CONNECTION WITH THE APPLICANT'S LICENSE APPLICATION NOTED AS ABOVE FOR THE ESTABLISHMENT IDENTIFIED IN THIS NOTICE
 3. Attorney's Full Name is: Robert Brokman
 4. Attorney's Street Address: 325 Broadway, Suite 501
 5. City, Town or Village: New York State: NY Zip Code: 10007
 6. Business Telephone Number of Attorney: 212-513-1988

**FOR NEW APPLICANTS, PROVIDE DESCRIPTION BELOW USING ALL INFORMATION KNOWN TO DATE
 FOR ALTERATION APPLICANTS, ATTACH COMPLETE DESCRIPTION AND DIAGRAM OF PROPOSED ALTERATION(S)
 FOR CURRENT LICENSEES, SET FORTH APPROVED METHOD OF OPERATION ONLY
 DO NOT USE THIS FORM TO CHANGE YOUR METHOD OF OPERATION**

7. Type(s) of alcohol sold or to be sold under the license: ("X" One) Beer Only Wine and Beer Only Liquor, Wine and Beer
 8. Extent of Food Service: ("X" One) Restaurant (Sale of food primarily; Full food menu; Kitchen run by chef) Tavern/Cocktail Lounge/Adult Venue/Bar (Alcohol sales primarily-meets legal minimum food availability requirements)
 9. Type of establishment: ("X" all that apply)
 Hotel Live Music Disc Jockey Juke Box Patron Dancing (Small scale) Karaoke Bar
 Cabaret, Night Club, (Large Scale Dance Club) Capacity for 600 or more patrons Bed & Breakfast Restaurant
 Club (e.g. Golf/Fraternal Org.) Catering Facility Stage Shows Topless Entertainment Recreational Facility (Sports Facility/Vessel)
 10. Licensed outdoor area: ("X" all that apply)
 None Rooftop Patio or Deck Freestanding Covered Structure Garden/Grounds
 Sidewalk Café Other (Specify): None
 11. Will the license holder or a manager be physically present within the establishment during all hours of operation? ("X" one) Yes No
 12. License serial number: _____ Expiration Date: _____
 13. The applicant's or license holder's full name, as it appears or will appear on the license: AN ENTITY IN WHICH MARK AMADEI + Andrew Glassberg
 14. The Trade name, if any, under which the establishment conducts or will conduct business: "The Diner" *are principals.*
 15. The establishment is located within the building which has the following street address: 210 10th Avenue
 16. City, Town, or Village: NY State: NY Zip Code: 10011
 17. The establishment is located on the following floor(s) of the building at the above address: Ground floor & basement
 18. Within the building at the above address, the establishment is located within the room(s) numbered as follows: -
 19. Business telephone number of applicant/licensee: 917-207-0374 Business fax number of applicant/licensee: _____
 20. Business e-mail address of applicant/licensee: _____
 21. Does the applicant or license holder own the building in which the establishment is located? ("X" one) Yes (If "Yes", SKIP items 22-25) No

OWNER OF THE BUILDING IN WHICH THE LICENSED ESTABLISHMENT IS LOCATED

22. Building owner's full name is: Charles Lewison
 23. Building owner's street address: 210 10th Ave
 24. City, Town, or Village: NY State: _____ Zip Code: _____
 25. Business telephone number of building owner: 516-763-1109

26. I am the applicant or hold the license or am a principal of the legal entity that holds or is applying for the license. Representations in this form are in conformity with representations made in submitted documents relied upon by the Authority when granting the license. I understand that representations made in this form will also be relied upon, and that false representations may result in disapproval of the application or revocation of the license.
 By my signature, I affirm - under **Penalty of Perjury** - that the representations made in this form are true.
 Printed Name: MARK T. AMADEI Title: m.m. Signature: X [Signature]