

Manhattan Community Board 4
(All Fields Must Be Completed)

Liquor License Stipulations Application

CORPORATION NAME R & R Westside LLC		DOING BUSINESS AS (DBA) The Brazen Tavern	
STREET ADDRESS 356 W 44TH ST		CROSS STREETS 8TH & 9TH Avenues	ZIP CODE 10036
OWNER <i>(Attach a list of all the people that will be associated/linked with the license)</i>	NAME: Damien Rafferty	ATTORNEY/ REPRESENTATIVE	NAME: Michael KELLY
	PHONE: (917) 455-0707		PHONE: (914) 632-6036
	EMAIL: RaffertyDamien@gmail.com		EMAIL: KELLYMLK136@gmail.com
MANAGER	NAME: Geraldine Ryan	LANDLORD	NAME: Lori REALTY CO
	PHONE: (646) 496-3284		PHONE: (212) 489-8183
	EMAIL: Gerbutter@yahoo.com		EMAIL:
APPLICATION TYPE (Check One)			
<input type="radio"/> New	Has applicant owned or managed a similar business?	YES	NO
	What is/was the name and address of establishment?		
	What were the dates applicant was involved with this former premise?		
<input type="radio"/> Transfer	What is the prior license # and expiration date?		
	Is applicant making any alterations or operational changes?	YES	NO
	If alterations or operational changes are being made, please describe/list all changes.		
<input checked="" type="radio"/> Alteration	What is the current license # and expiration date?	1296311 7/31/18	
Please list/describe the nature of all the changes and attach the plans:		addition of a sidewalk cafe	
METHOD OF OPERATION			
TYPE OF ALCOHOL	<input checked="" type="radio"/> Liquor/Wine/Beer <input type="radio"/> Beer <input type="radio"/> Wine & Beer		
ESTABLISHMENT TYPE	<input checked="" type="radio"/> Restaurant <input type="radio"/> Cabaret <input type="radio"/> Night Club <input type="radio"/> Hotel <input type="radio"/> Bar/Tavern <input type="radio"/> Catering Establishment <input type="radio"/> Adult Entertainment <input type="radio"/> Wine Bar <input type="radio"/> Dance Club <input type="radio"/> Sports Bar <input type="radio"/> Club (Fraternal Organization - Members Only)		
Has applicant/owner filed with the SLA? If yes, when? If no, when do you plan to file?	<input checked="" type="radio"/> YES	<input type="radio"/> NO	
Is the 500 Foot Rule applicable? If yes, please attach a diagram of the On-Premise liquor license establishments within a 500 ft. radius of your establishment and the Public Interest Statement.	YES	<input checked="" type="radio"/> NO	
Is the 200 Foot Rule applicable? If yes, please attach a diagram of the schools and houses of worship that trigger the rule.	YES	<input checked="" type="radio"/> NO	
Has applicant/owner(s) read MCB4 Policy Regarding Concentration and Location of Alcoholic-Serving Establishments?	<input checked="" type="radio"/> YES	<input type="radio"/> NO	

OPERATIONAL DETAILS (*Closing time will be when establishment is vacated of all patrons)

HOURS* (Indoor Only)		MONDAY	TUESDAY	WEDNESDAY	THURSDAY	FRIDAY	SATURDAY	SUNDAY
	Operation	11am-4am	11am-4am	11am-4am	11am-4am	11am-4am	11am-4am	11am-4am
	Kitchen	12pm-2am	12pm-2am	12pm-2am	12pm-2am	12pm-2am	12pm-2am	12pm-2am
	Music	11am-3am	11am-3am	11am-3am	11am-3am	11am-3am	11am-3am	11am-3am

If you plan to have music, what type(s)? (Circle all that apply)

BACKGROUND
 LIVE MUSIC
 DJ
 JUKE BOX
 KARAOKE

OCCUPANCY

	Capacity (Certificate of Occupancy)	Maximum # of Persons You Anticipate Occupying Premises (Including Employees)	Number of Tables	Number of Seats	Number of Service Only Bars	Number of Stand-Up Bars	Number of Seats at Stand-Up Bar
INSIDE	195	150	14-1st 12 2nd	26 48	0	2	17-1st 18 2nd
OUTSIDE (Other than sidewalk café)	N/A	N/A	N/A	N/A	N/A	N/A	N/A
SIDEWALK CAFÉ	-	10 14	5 5	16 11	-	-	-

How many floors are there? What is the capacity for each floor? 3 Fl. 7-Basement, 100 on 1st 88 on 2nd

How frequently will the owner(s) be at the establishment? Always

Will you be applying or intending to apply for a cabaret license with DCA? If yes, will there be dancing?	YES	<input checked="" type="radio"/> NO
Will applicant have bottle or table service for beverage alcohol?	YES	<input checked="" type="radio"/> NO
Will you be hosting private, promotional or corporate events?	<input checked="" type="radio"/> YES	NO OCCASIONAL Corporate events
Will outside promoters be used on a regular basis? If yes please describe.	YES	<input checked="" type="radio"/> NO
Will you have a security plan? If, yes please attach.	YES	<input checked="" type="radio"/> NO
Will security plan be implemented?	YES	<input checked="" type="radio"/> NO
Will State certified security personnel be used?	<input checked="" type="radio"/> YES	NO
Will New York Nightlife Association and NYPD Best Practices be followed?	<input checked="" type="radio"/> YES	NO
Will applicant be using delivery bicycles? If yes, how many?	YES	<input checked="" type="radio"/> NO
Will delivery bicycles be clearly marked with the name of the restaurant and will staff wear attire clearly noting name as described by NYC Law?	YES	NO N/A
Where will delivery bicycles be stored during the day when not in use?	N/A	

LOCATION & ZONING		
Is this a Special District? If yes, is it Clinton, West Chelsea or Hudson Yards?	YES	<input checked="" type="radio"/> NO
Does the building have a Certificate of Occupancy ("C of O") or a letter of no objection?	<input checked="" type="radio"/> YES	NO
Is a Public Assembly permit required?	<input checked="" type="radio"/> YES	NO
Are your plans filed with DOB?	YES	NO <i>∴ No changes</i>

Community Notification/Relations		
NOTIFICATION: List all block associations; tenant associations, co-op boards or condo boards of residential buildings; and community groups that applicant has notified regarding its application. For each please list both the organization and individual you contacted	# 1	WEST 44 TH ST BETTER BLOCK ASSOCIATION
	# 2	
	# 3	
	# 4	
	# 5	
Please provide dates when applicant met with the groups listed above.		
Who was your contact person at each group you met with?	Linda Ashley was Emailed	
When did applicant post the notice that was provided?	4/10/17	
Where did applicant post the notice that was provided?	FRONT WINDOW	
Will applicant provide owner cell phone number to neighbors and respond to complaints that arise? Please provide number in space provided.	<input checked="" type="radio"/> YES	NO (646) 644-2284
Will applicant inform the Community Board office of its job openings and/or provide a hyperlink to applicants jobs webpage?	<input checked="" type="radio"/> YES	NO

BUILDING DESIGN			
State the name and type of business previously located in the space.	applicant occupies space		
Has a liquor-licensed establishment previously occupied this space at any time? If yes, please provide the name of the business.	<input checked="" type="radio"/> YES	<input type="radio"/> NO	applicant
Do you plan any changes to the existing façade? If yes, please describe.	YES	<input checked="" type="radio"/> NO	
Will applicant have a vestibule within the establishment?	<input checked="" type="radio"/> YES	<input type="radio"/> NO	
Will applicant use a storm enclosure?	YES	<input checked="" type="radio"/> NO	
Will applicant not place any items or obstructions on the sidewalk, for example, sandwich boards, sidewalk signs, freestanding menus and plants, as per the law?	<input checked="" type="radio"/> YES	<input type="radio"/> NO	
Will applicant comply with the NYC noise code?	<input checked="" type="radio"/> YES	<input type="radio"/> NO	
Will the establishment have any of the following: (circle all that apply)	<input checked="" type="radio"/> FRENCH DOORS	<input type="radio"/> GARAGE DOORS	<input type="radio"/> WINDOWS THAT CAN BE OPENED
Will applicant close all windows, French doors, garage doors when any music or amplified sound (including televisions) is played inside the establishment?	<input checked="" type="radio"/> YES	<input type="radio"/> NO	
Will applicant close all windows, French doors, garage doors by 11 PM Friday and Saturday and 10 PM on all other days even if no music or amplified sound is played inside the establishment?	<input checked="" type="radio"/> YES	<input type="radio"/> NO	
Has applicant obtained an acoustical report from a certified sound engineer to assess potential noise disturbance to the neighboring residents and buildings?	YES	<input checked="" type="radio"/> NO	
Will applicant follow the recommendations of a certified sound engineer to mitigate potential noise disturbance to the neighboring residents and buildings, including placing speakers on the floor of the establishment?	<input checked="" type="radio"/> YES	<input type="radio"/> NO	if needed
Will the kitchen exhaust system extend to the roof?	<input checked="" type="radio"/> YES	<input type="radio"/> NO	
Will the establishment have an illuminated sign?	YES	<input checked="" type="radio"/> NO	
Will the establishment have a canopy extending over the sidewalk?	YES	<input checked="" type="radio"/> NO	
Where will the air conditioner be located? What type is it?	Roof		
When was the air conditioner installed?	unknown		

OUTDOOR ITEMS - OTHER THEN SIDEWALK CAFÉ

U1A

Has the applicant/owner(s) read MCB 4 Rear Yard Rooftop Policy?	<input checked="" type="radio"/> YES	<input type="radio"/> NO	
Will applicant use any outdoor spaces: rooftop, rear yard, patio, porch, balcony, pavilion, tents, deck or gazebo? If yes, which one(s)?	<input type="radio"/> YES	<input checked="" type="radio"/> NO	
Are the floorplans for the outdoor space(s) included?	<input type="radio"/> YES	<input type="radio"/> NO	
Will applicant close and vacate the outdoor space(s) by 11PM on Friday & Saturday and 10 PM on all other days?	<input type="radio"/> YES	<input type="radio"/> NO	
Will the service and consumption of alcohol in any outdoor space only be via seated food service?	<input type="radio"/> YES	<input type="radio"/> NO	
Will applicant not allow standing space for patrons to drink or smoke in any outdoor space(s)?	<input type="radio"/> YES	<input type="radio"/> NO	
Will there be no amplified music, as per the law?	<input type="radio"/> YES	<input type="radio"/> NO	
If amplified sound is played inside the establishment, will windows and doors be closed?	<input type="radio"/> YES	<input type="radio"/> NO	
Will applicant agree to post signs outside asking customers to respect the neighbors?	<input type="radio"/> YES	<input type="radio"/> NO	
Will applicant agree to train staff to encourage a peaceful environment?	<input type="radio"/> YES	<input type="radio"/> NO	
Will applicant provide effective sound control (landscaping enclosure, soundproofing tenants apartments)	<input type="radio"/> YES	<input type="radio"/> NO	
Will there be a lighting plan that allows safe usage of the outdoor space without disrupting neighbors?	<input type="radio"/> YES	<input type="radio"/> NO	

OUTDOOR ITEMS – SIDEWALK CAFÉ		
Has the applicant/owner(s) read MCB4 Sidewalk Café Policy?	<input checked="" type="radio"/> YES	<input type="radio"/> NO
Will applicant be applying for a sidewalk café now or in the future?	<input checked="" type="radio"/> YES	<input type="radio"/> NO
Is applicant in this application seeking to include a sidewalk café in its liquor license?	<input checked="" type="radio"/> YES	<input type="radio"/> NO
If yes, has applicant submitted an application and plans to NYC Dept. of Consumer Affairs? Please attach application and plans.	<input checked="" type="radio"/> YES	<input type="radio"/> NO
Will applicant close and vacate the sidewalk café by 11 PM on Friday & Saturday and 10 PM on all other days?	<input checked="" type="radio"/> YES	<input type="radio"/> NO
Will applicant be serving alcohol in the sidewalk café? If so, will you have waiter service?	<input checked="" type="radio"/> YES	<input type="radio"/> NO
Will the café have a 3 ft. wide serving aisle running the entire length of the sidewalk café?	<input checked="" type="radio"/> YES	<input type="radio"/> NO
Will applicant mark the perimeter of the café on the sidewalk?	<input checked="" type="radio"/> YES	<input type="radio"/> NO
Will the service and consumption of alcohol in the sidewalk café only be via seated food service?	<input checked="" type="radio"/> YES	<input type="radio"/> NO
Will the sidewalk café not provide standing space for drinking or smoking?	<input checked="" type="radio"/> YES	<input type="radio"/> NO
Will applicant use any portable natural gas heaters? If so, do you have the requisite approvals from DOB & the Fire Department?	<input type="radio"/> YES	<input checked="" type="radio"/> NO
Will applicant have a lighting plan that will allow safe usage of the outdoor space without disrupting neighbors?	<input checked="" type="radio"/> YES	<input type="radio"/> NO
Will all furniture, plants and barricades be stored inside between the evening closing hours and the morning opening hours?	<input checked="" type="radio"/> YES	<input type="radio"/> NO
Will all furniture be stored inside between December 21 st and March 21 st , and any other day when it rains or snows?	<input checked="" type="radio"/> YES	<input type="radio"/> NO
Will applicant use umbrellas?	<input type="radio"/> YES	<input checked="" type="radio"/> NO
If construction or construction protection has reduced the sidewalk width, will applicant always maintain an 8 foot clear path of sidewalk between the perimeter of the café and the closes obstruction including construction barricades?	<input checked="" type="radio"/> YES	<input type="radio"/> NO

ADDITIONAL STIPULATIONS: (Office Use Only)

- Applicant will remove one center table and push 2 east and 2 west tables together
- Cafe will be reduced to 5 tables and 11 seats
- Will submit revised plans to CB4 by 4/26/17
- Prior stips dated 7/13/14 remain in effect

To the extent any additional stipulation on pages 7 and 8 of this application conflicts with any response on pages 1 – 6 of this application, the stipulations on pages 7 and 8 control.

ADDITIONAL STIPULATIONS: (Office Use Only), *Continued*

To the extent any additional stipulation on pages 7 and 8 of this application conflicts with any response on pages 1 - 6 of this application, the stipulations on pages 7 and 8 control.

Manhattan Community Board 4 (MCB4) recommends:

Denial unless all stipulations agreed to by applicant/owner are part of the method of operation

Denial Approval

CB4 REPRESENTATIVES

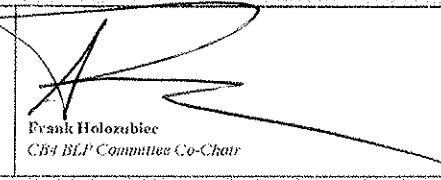
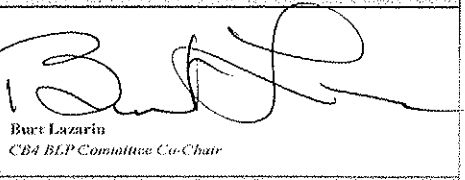
 Nelly Gonzalez CB4 Assistant District Manager	 Frank Holozubiec CB4 BLP Committee Co-Chair	 Burt Lazzarin CB4 BLP Committee Co-Chair
---	--	--

APPLICANT AGREEMENT WITH THE COMMUNITY

Applicant agrees to these stipulations as the basis for the community support of this application and acknowledges that all of these stipulations are essential prerequisites to the MCB4 recommendation regarding this application. Applicant agrees to have these stipulations incorporated in the method of operation of its liquor license. The stipulations in this application constitute the entire agreement between MCB4 and applicant and may only be altered in writing signed by MCB4 and applicant. These stipulations supersede any oral statements or representations in connection with this application.

SIGN HERE →

PRINT NAME OF APPLICANT

SIGNATURE OF APPLICANT

DATE

Damien Robert Damien Robert 4/18/17

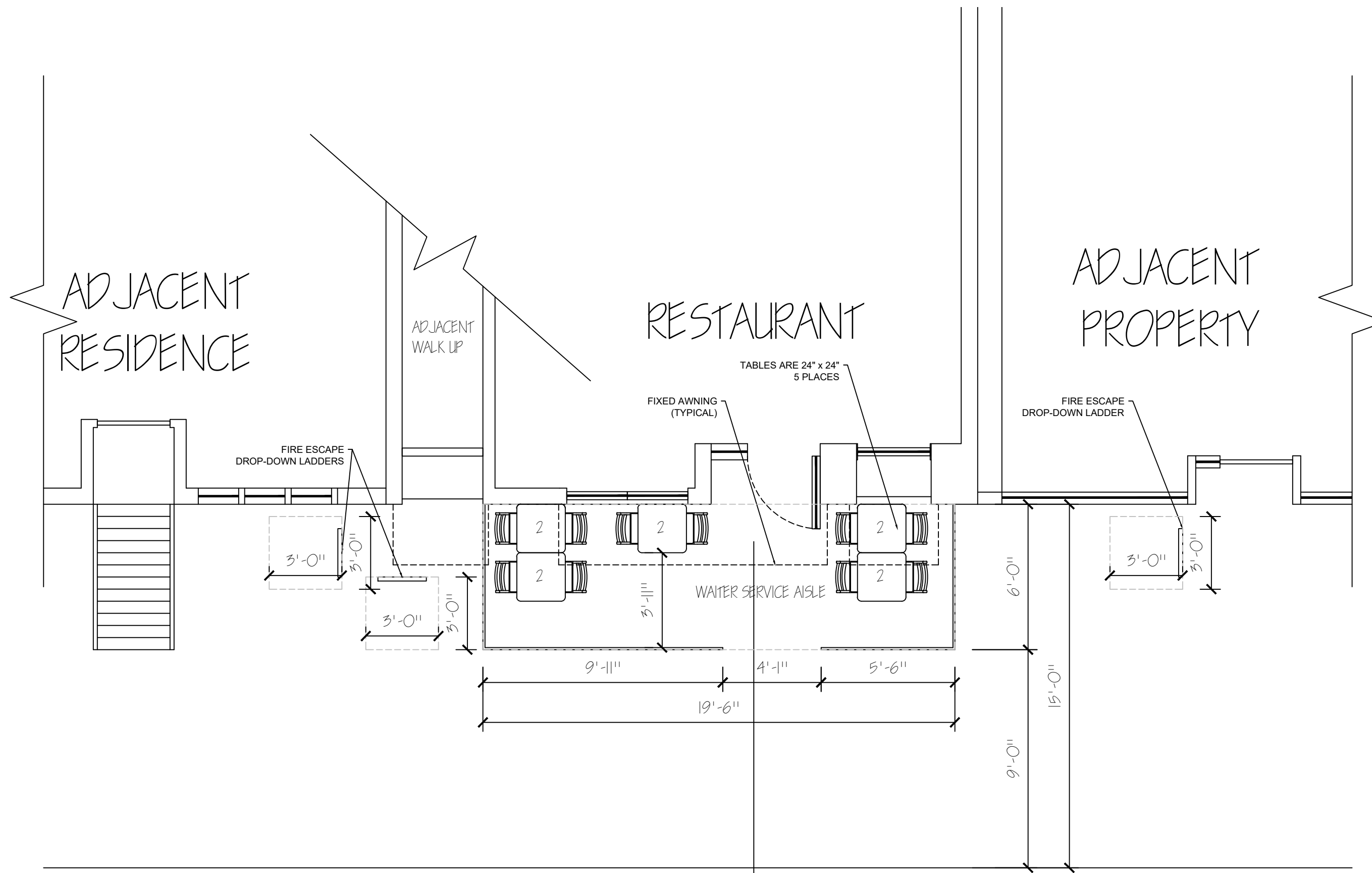

2 PLAN W 44th St
1/4"=1'

4
A1-01

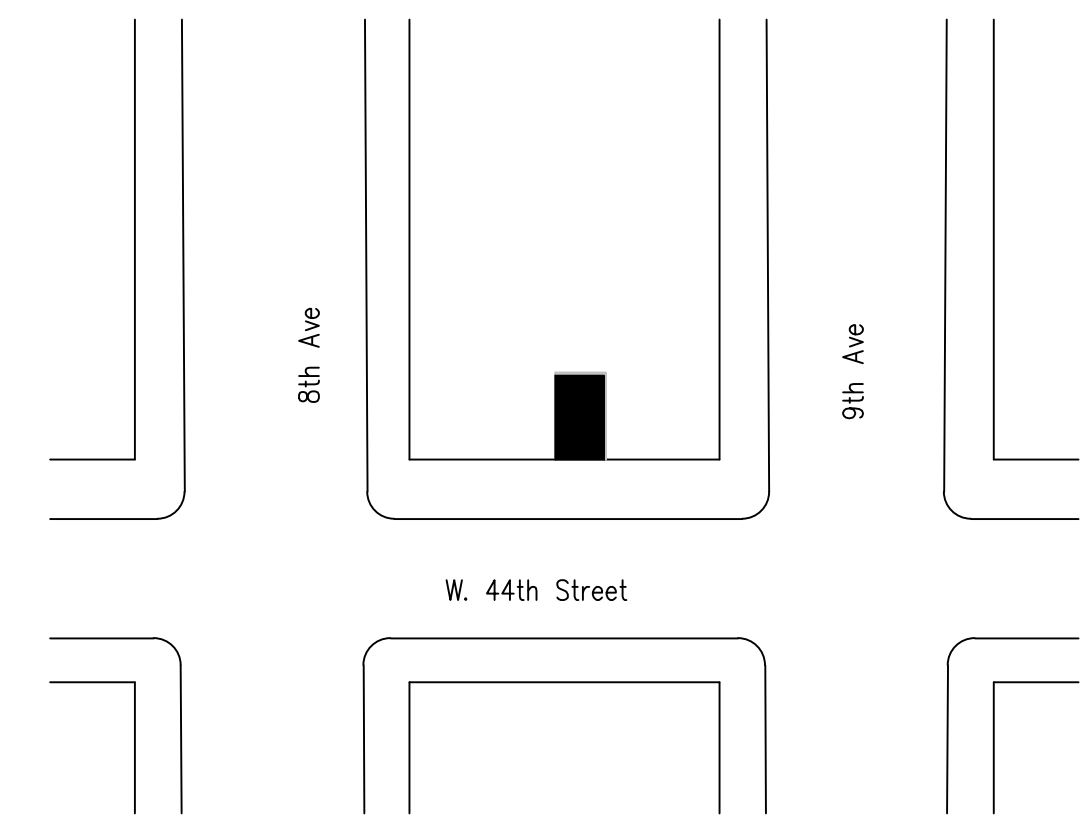

1 LOCATION PLAN
NTS

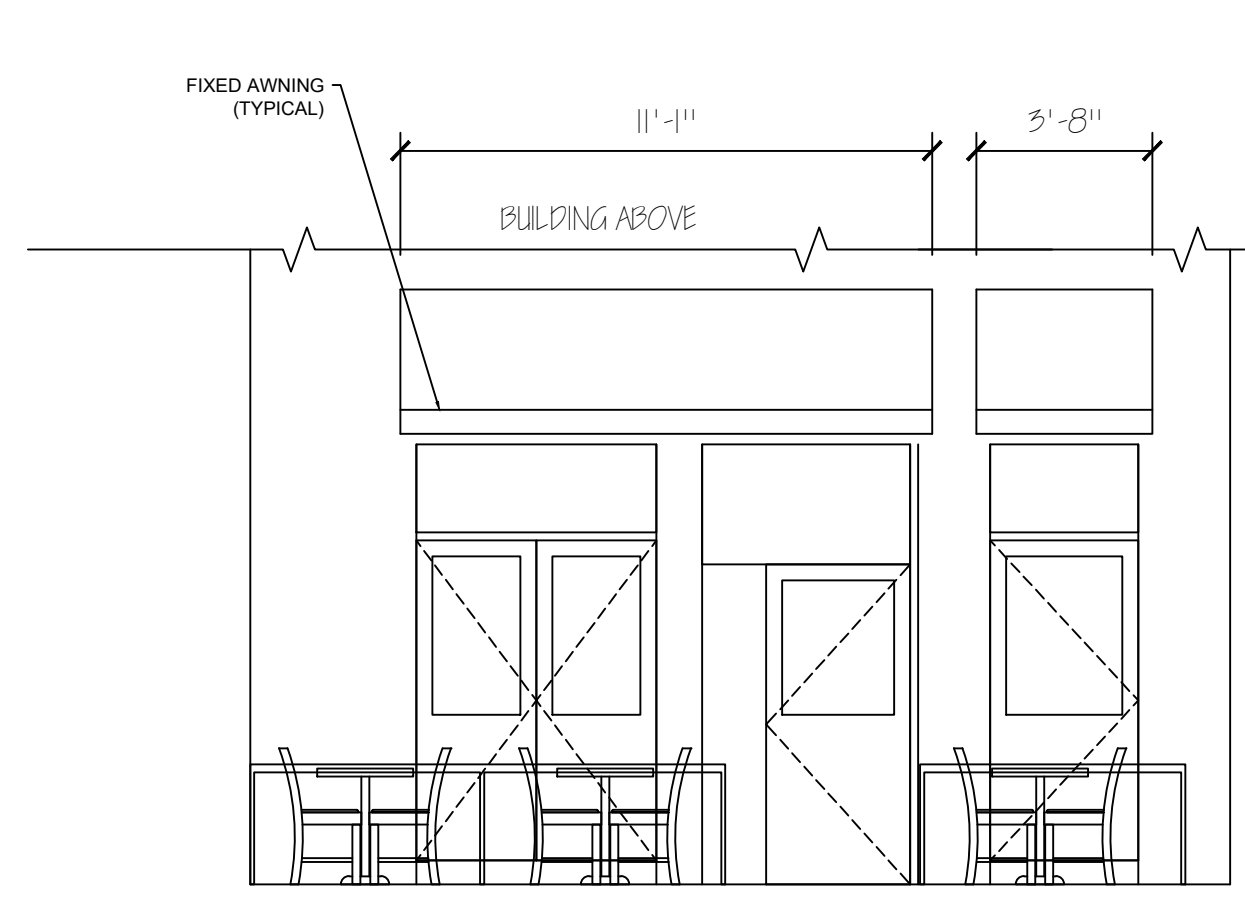

3 ELEVATION W 44th St
1/4"=1'

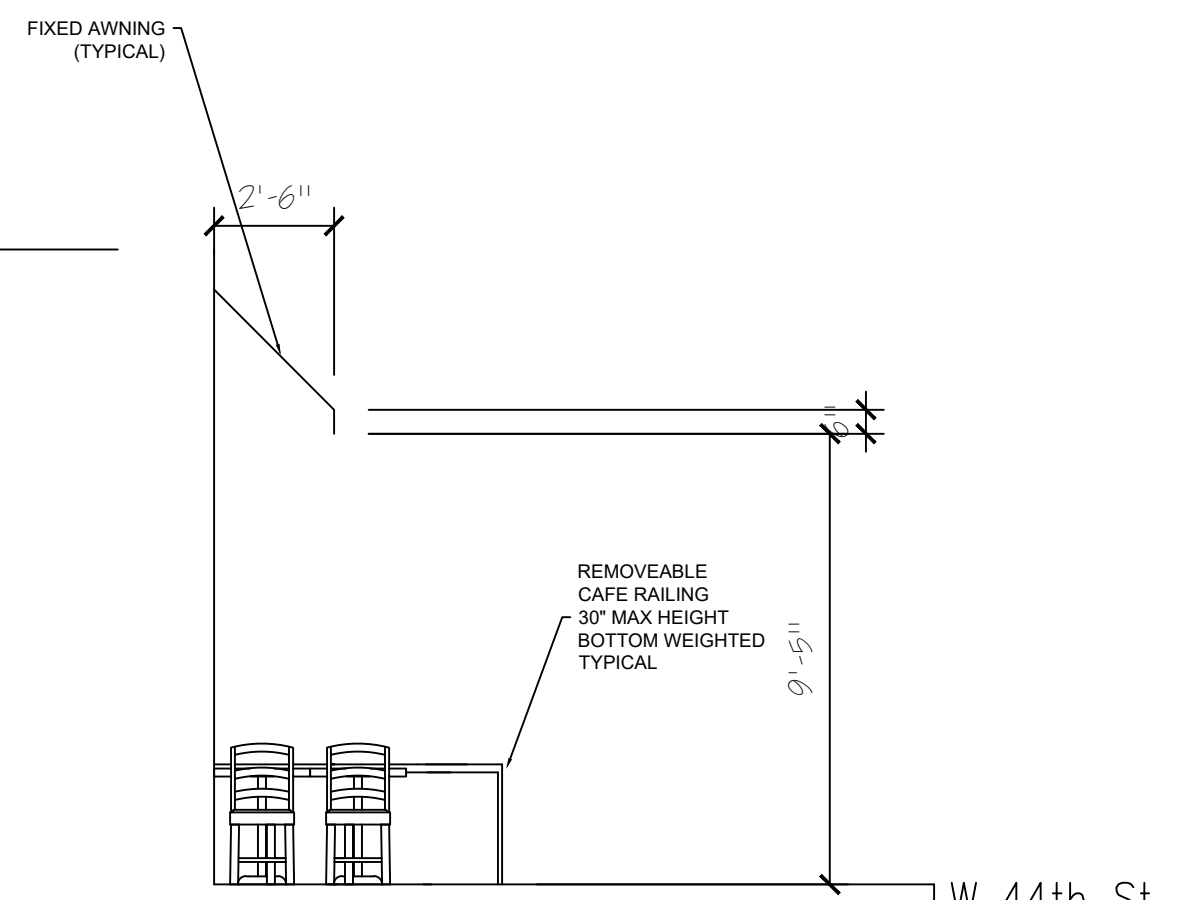

4 SECTION
1/4"=1'

DRAWING NAME
SITE AND PLAN VIEW OF UNENCLOSED SIDEWALK CAFE R & R WESTSIDE LLC 356 W. 44th Street NEW YORK, NY 10036
APPLICATION DATA
COMMUNITY BOARD # 4 BLOCK # 1034 LOT # 60 # OF TABLES: 5 # OF SEATS: 10 CAFE AREA: 117 SQ. FT.
DRAWING NUMBER
A1.1
SCALE
1/4"=1'-0"
DATE
02.23.17
RML CONSULTING 70 MT VERNON AVE APT 8D PATCHOGUE, NY 11772 631-275-5746

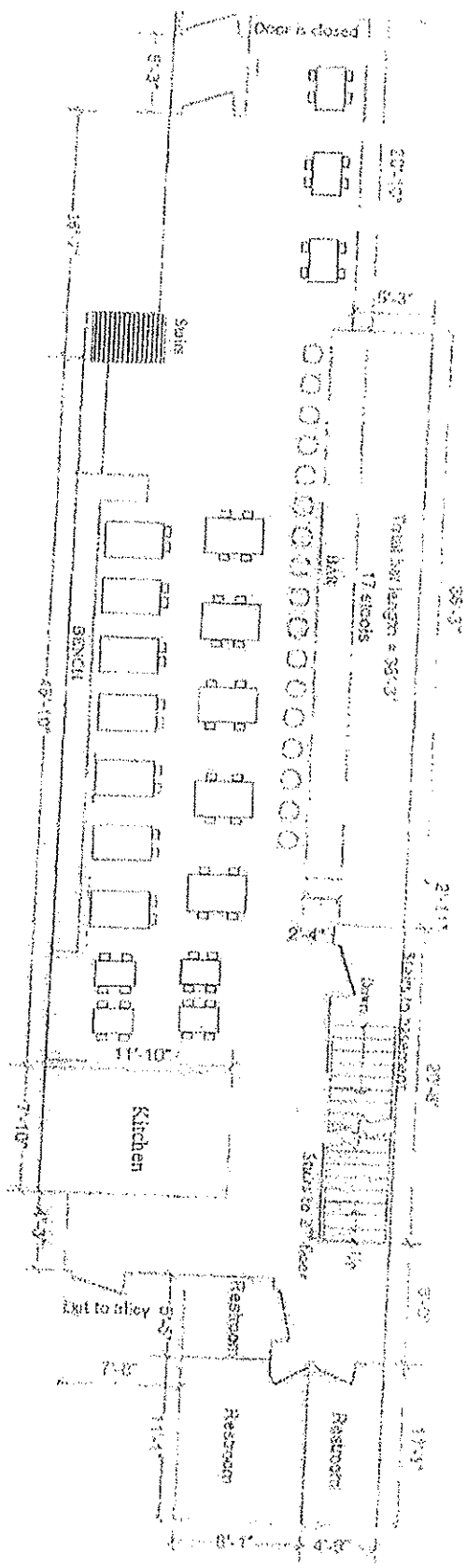

R&R Westside LLC
 356 West 44th Street
 New York, NY 10036
 First Floor

R&R Westside LLC
356 West 44th Street
New York, NY 10036
Second Floor

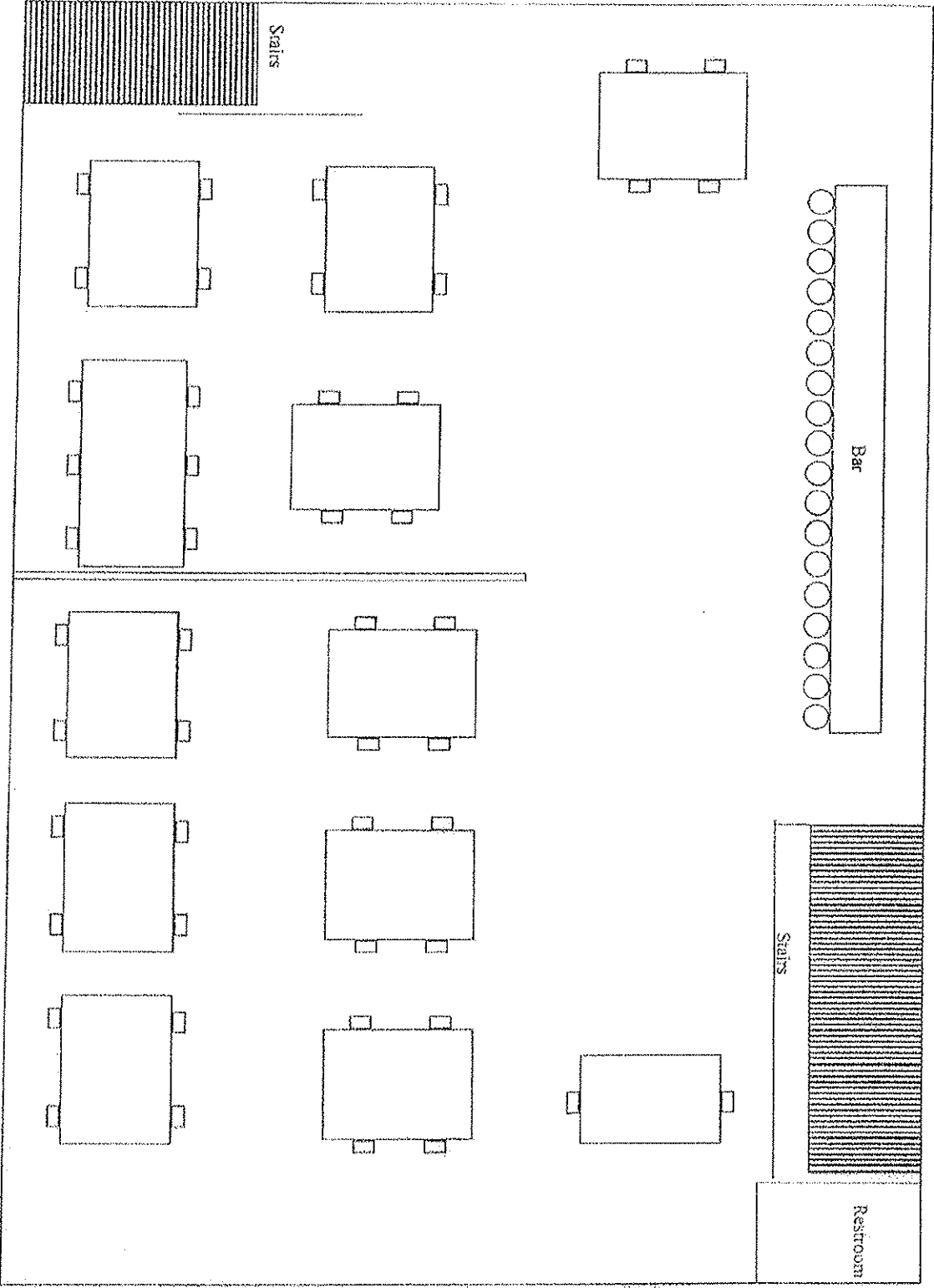

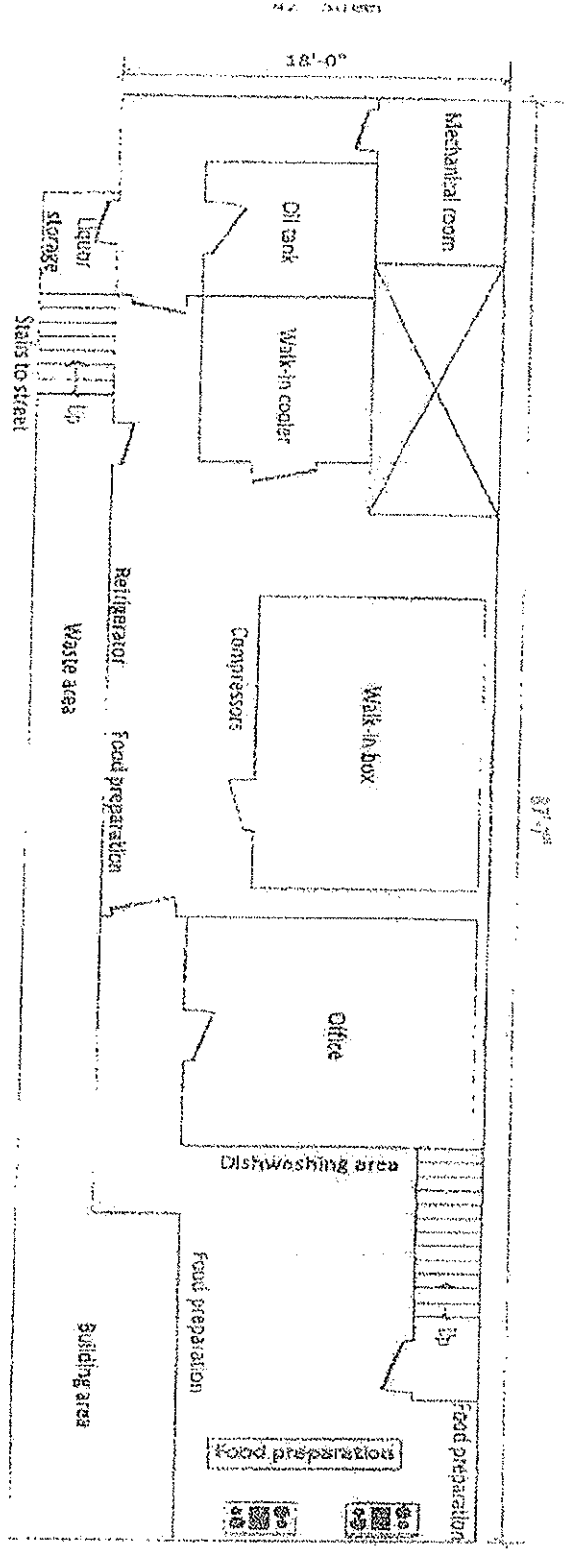

R&R Westside LLC
 356 West 44th Street
 New York, NY 10036
 Basement

Appetizers

Jumbo Shrimp Cocktail
Served with Cocktail Sauce

14

Spinach & Artichoke Dip Imperial
With Crab Meat served with Pita Toast Points

14

Wings

(your choice)

Lemon Butter & Garlic, Buffalo,
Honey Sriracha, or BBQ
*Served with Ranch or Blue Cheese,
Celery and Carron Sticks*

10

Chef Mike's Chili

*Served with Cheddar Salsa, Peas, Bread,
CROUTONS, Chipotle Sour Cream, and Fresh
Cilantro*

9

Chicken Fingers

With Choice of Sauce

(Buffalo - Honey Sriracha - BBQ)

10

Bavarian Pretzel

W/ Sea Salt and Blue Moon Beer Cheese

8

Lump Crab Cake

*2 Petit Crab Cakes served over Mixed Greens &
Topped with Imperial sauce*

11

Cheese & Fruit & Charcuterie Board

*Soppressata, Pepperoni, Abruzzese, Maytag Blue
cheese, Smoked Gouda, Fig jam, grapes, apples,
and Carl's Crackers
(Based on availability)*

14

Rock Shrimp Tempura

Served with Honey Sriracha Mayo & Ketchup

12

Sliders

Beef or Crab Cake served on teli's Brioche

Beef 10

Crab Cake 13

Parmesan and Truffle Steak Fries

*Wedge Cut Fries topped with Herbs Parmesan
and Truffle oil*

8

Braised Pork Belly

Soups and Salads

French Onion Soup Au Gratin

*Served in a Crock Bowl with
Croutons & Gruyere*

8

Cream of Mushroom & Chicken Soup

Served in a Bread Bowl

10

Poached Pear Salad

*Poached Pear, Candied Pecans, Crumbled Bleu
Cheese, Raspberry Vinaigrette*

12

Cobb Salad

*With Bacon Croutons, Hard Boiled Egg,
Avocado, Crumbled Cheese, Grilled Chicken,
Tomatoes, Romaine and Leaf Lettuce Red
Wine Vinaigrette*

14

House Salad

*Mixed Lettuce with Tomatoes, Cucumber, Red
Onion, Croutons, Shredded Carrots with
choice of Dressing*

12

Caesar Salad

*Romaine Lettuce and Croutons Dressed with
Parmesan Cheese, And Caesar Dressing
(contains anchovies)*

10

Sides

Roasted Rustic Herbed Potatoes

6

Crispy Browned Brussel Sprouts

6

Wild Rice

6

Garlic & Rosemary Mashed Potatoes

6

Sautéed Haricoyverts

6

Creamed Spinach

7

Sautéed Corn

6

Mixed Veggies

6

Potatoes Au Gratin

*Scalloped Potatoes Baked in a Creamy and
Cheesy Sauce until Golden Brown*

8

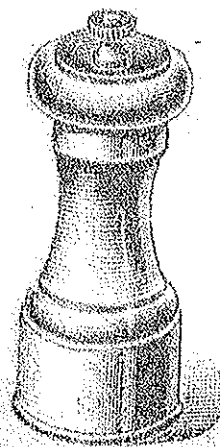
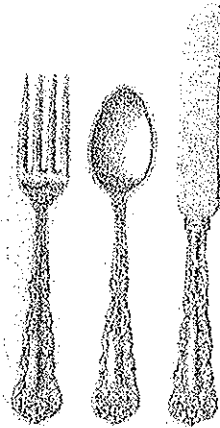

The Brazen Burger
2 Beef Patties, Sautéed Mushrooms, American Cheese,
topped with Crispy Onion, Mayo, Bacon,
on Eli's Onion Brioche
 20

Portobello Burger Ala Caprese
Roasted Red Pepper, Fresh Mozzarella, Nut Free Basil Pesto,
Balsamic reduction
 13

Tavern Burger
Herbed Mayo with Lettuce & Tomato set
(Add Cheese \$1.50)
Served on Eli's Onion Brioche
 13



Chicken Sandwich
Swiss Cheese, Avocado, and Herbed Mayo
Served on Semolina Hero Roll
 12

Classic Philly Cheese Steak
With Peppers, Onions, and American Cheese
Served on Semolina Hero Roll
 15

Turkey Club
Triplo Decker Sandwich with Homemade brined
Turkey Breast, Melted Swiss cheese, Bacon, Lettuce,
Tomato, and Mayo
Served on Texas Toast
 16

Entrees



Beef Stew topped with Puffed Pastry
Hearty Beef Stew with Chunks of Tender Beef and
Vegetables in a Rich Beef Gravy Topped with a Flaky
Pastry Crust
 18

Chicken & Dumplings
Creamy Chicken Stew with Soft Fluffy Dumplings
 17

Baked Mac & Cheese
Passilli Pasta Baked into a Cheese Sauce
 15

Pan Roasted Half Chicken
With Pan Gravy and Choice of 2 Sides
(please allow 20 mins to prepare)
 17

Center Cut Grilled Bone in Pork chop
With Apple Chutney and Choice of 2 Sides
 22

Sliced Flanger Steak with Wild Mushroom Ragu
Served over Wild Rice and choice of 1 side
 27

Bone in Rib Eye Steak
24oz Rib eye topped with Sautéed Buttered Mushrooms and
Choice of 2 sides
 36



Grilled Salmon
Topped with a Lemon, Capor, and Herb Compound Butter
Choice of 2 sides
 28

Crispy Long Island Duck Breast
Spiced Mandarin Orange Glaze
Choice of 2 Sides
 28

Pasta Primavera
Pasta Tossed with Parmesan and Vegetables
in a pink sauce
 16
 Add Chicken - 3 Add Steak - 8

Steak Pasta
Roasted Red Pepper and Garlic Cream Sauce
 24

Pancetta Brined Beef Short Ribs
Slow cooked Beef Short Ribs Fall off the Bone Tender
Choice of 2 Sides
 36

Crab Cake Imperial
Served over Mixed Corn and Brussel Sprouts
Choice of 2 Sides
 27

Keith's Fish & Chips
Fried Atlantic Cod and Wedge Cut Fries
Served with Mol. Vinegar
 14

HEATH'S KITCHEN