

**Manhattan Community Board 4**  
(All Fields Must Be Completed)

Liquor License Stipulations Application

CORPORATION NAME Amethyst Pear Squared LLC		DOING BUSINESS AS (DBA) TBD	
STREET ADDRESS 308 W 50th Street		CROSS STREETS 8th & 9th Avenue	ZIP CODE 10019
OWNER <i>(Attach a list of all the people that will be associated/listed with the license)</i>	NAME: Yanna Slavutsky	ATTORNEY/ REPRESENTATIVE	NAME: Robert S Bookman, Esq.
	PHONE: 786-618-7363		PHONE: 212-513-1988
	EMAIL: yannaslavutsky@gmail.com		EMAIL: rbookman@pandblegal.com
MANAGER	NAME: Aleksandra Putnam	LANDLORD	NAME: George Comfort & Sons
	PHONE: 917-342-0029		PHONE: 212-542-2137
	EMAIL: aleksandra@bluedognyc.com		EMAIL: ahalder@gcomfort.com
<b>APPLICATION TYPE</b> <i>(Check One)</i>			
<input type="radio"/> New	Has applicant owned or managed a similar business?	<input checked="" type="checkbox"/> YES	<input type="checkbox"/> NO
	What is/was the name and address of establishment?	Blue Dog Coffee Bar & Bakery	
	What were the dates applicant was involved with this former premise?	101 W 25th Street - Since 2011	
<input checked="" type="radio"/> Transfer	What is the prior license # and expiration date?	Serial# 1272878 Exp: 9/30/2017	
	Is applicant making any alterations or operational changes?	<input type="checkbox"/> YES	<input checked="" type="checkbox"/> NO
	<i>If alterations or operational changes are being made, please describe/list all changes.</i>		
<input type="radio"/> Alteration	What is the current license # and expiration date?		
	<i>Please list/describe the nature of all the changes and attach the plans:</i>		
<b>METHOD OF OPERATION</b>			
TYPE OF ALCOHOL	<input checked="" type="checkbox"/> Liquor/Wine/Beer <input type="checkbox"/> Beer <input type="checkbox"/> Wine & Beer		
ESTABLISHMENT TYPE	<input checked="" type="checkbox"/> Restaurant <input type="checkbox"/> Cabaret <input type="checkbox"/> Night Club <input type="checkbox"/> Hotel <input type="checkbox"/> Bar/Tavern <input type="checkbox"/> Catering Establishment		
	<input type="checkbox"/> Adult Entertainment <input type="checkbox"/> Wine Bar <input type="checkbox"/> Dance Club <input type="checkbox"/> Sports Bar <input type="checkbox"/> Club (Fraternal Organization - Members Only)		
Has applicant/owner filed with the SLA? If yes, when? If no, when do you plan to file?	YES	<input checked="" type="checkbox"/> NO	
Is the 500 Foot Rule applicable? If yes, please attach a diagram of the On-Premise liquor license establishments within a 500 ft. radius of your establishment and the Public Interest Statement.	<input checked="" type="checkbox"/> YES	<input type="checkbox"/> NO	
Is the 200 Foot Rule applicable? If yes, please attach a diagram of the schools and houses of worship that trigger the rule.	YES	<input checked="" type="checkbox"/> NO	
Has applicant/owner(s) read MCB4 Policy Regarding Concentration and Location of Alcoholic-Serving Establishments?	<input checked="" type="checkbox"/> YES	<input type="checkbox"/> NO	

**OPERATIONAL DETAILS** (\*Closing time will be when establishment is vacated of all patrons)

HOURS* <i>(Indoor Only)</i>		MONDAY	TUESDAY	WEDNESDAY	THURSDAY	FRIDAY	SATURDAY	SUNDAY
	Operation	8am- 2am	8am- 2am	8am- 2am	8am- 2am	8am- 2am	8am- 2am	8am- 2am
	Kitchen	SAA	SAA	SAA	SAA	SAA	SAA	SAA
	Music	SAA	SAA	SAA	SAA	SAA	SAA	SAA
If you plan to have music, what type(s)? (Circle all that apply)		<input checked="" type="checkbox"/> BACKGROUND		LIVE MUSIC	DJ	JUKE BOX	KARAOKE	

**OCCUPANCY**

	Capacity (Certificate of Occupancy)	Maximum # of Persons You Anticipate Occupying Premises (Including Employees)	Number of Tables	Number of Seats	Number of Service Only Bars	Number of Stand-Up Bars	Number of Seats at Stand-Up Bar
INSIDE	74	74	11	52	0	1, but no standing seats only	6
OUTSIDE <i>(Other than sidewalk café)</i>	NA	NA	0	0	0	0	0
SIDEWALK CAFÉ	NA	NA					

How many floors are there? What is the capacity for each floor?

1st Floor

How frequently will the owner(s) be at the establishment?

Daily

Will you be applying or intending to apply for a cabaret license with DCA? If yes, will there be dancing?

YES  NO

Will applicant have bottle or table service for beverage alcohol?

YES NO

Will you be hosting private; promotional or corporate events?

YES NO

Will outside promoters be used on a regular basis? If yes please describe.

YES  NO

Will you have a security plan? If, yes please attach.

YES NO NA

Will security plan be implemented?

YES NO NA

Will State certified security personnel be used?

YES NO NA

Will New York Nightlife Association and NYPD Best Practices be followed?

YES NO NA

Will applicant be using delivery bicycles? If yes, how many?

YES NO 3-4

Will delivery bicycles be clearly marked with the name of the restaurant and will staff wear attire clearly noting name as described by NYC Law?

YES NO

Where will delivery bicycles be stored during the day when not in use?

Staff takes bikes home

LOCATION & ZONING			
Is this a Special District? If yes, is it Clinton, West Chelsea or Hudson Yards?	<input checked="" type="checkbox"/> YES	<input type="checkbox"/> NO	Clinton
Does the building have a Certificate of Occupancy ("C of O") or a letter of no objection?	<input checked="" type="checkbox"/> YES	<input type="checkbox"/> NO	
Is a Public Assembly permit required?	<input type="checkbox"/> YES	<input checked="" type="checkbox"/> NO	
Are your plans filed with DOB?	<input type="checkbox"/> YES	<input checked="" type="checkbox"/> NO	

Community Notification/Relations			
<b>NOTIFICATION:</b> List all block associations; tenant associations, co-op boards or condo boards of residential buildings; and community groups that applicant has notified regarding its application. For each please list both the organization and individual you contacted	# 1	A mass email was sent to all the contacts on the list	
	# 2	provided by the community board	
	# 3		
	# 4		
	# 5		
Please provide dates when applicant met with the groups listed above.		NA	
Who was your contact person at each group you met with?		NA	
When did applicant post the notice that was provided?		June 28th	
Where did applicant post the notice that was provided?		In front of premise & 4 corners of 50th and 8th , 50th and 9th Ave	
Will applicant provide owner cell phone number to neighbors and respond to complaints that arise? Please provide number in space provided.		<input checked="" type="checkbox"/> YES	<input type="checkbox"/> NO 786-618-7363
Will applicant inform the Community Board office of its Job openings and/or provide a hyperlink to applicants jobs webpage?		<input checked="" type="checkbox"/> YES	<input type="checkbox"/> NO

<b>BUILDING DESIGN</b>			
State the name and type of business previously located in the space.	Blue Dog Kitchen - Restaurant		
Has a liquor-licensed establishment previously occupied this space at any time? If yes, please provide the name of the business.	<input checked="" type="checkbox"/> YES	<input type="checkbox"/> NO	Blue Dog Kitchen
Do you plan any changes to the existing façade? If yes, please describe.	YES	<input checked="" type="checkbox"/> NO	
Will applicant have a vestibule within the establishment?	YES	<input checked="" type="checkbox"/> NO	
Will applicant use a storm enclosure?	YES	<input checked="" type="checkbox"/> NO	
Will applicant not place any items or obstructions on the sidewalk, for example, sandwich boards, sidewalk signs, freestanding menus and plants, as per the law?	YES	<input checked="" type="checkbox"/> NO	
Will applicant comply with the NYC noise code?	<input checked="" type="checkbox"/> YES	<input type="checkbox"/> NO	
Will the establishment have any of the following: (circle all that apply)	<b>FRENCH DOORS</b>	<b>GARAGE DOORS</b>	<b>WINDOWS THAT CAN BE OPENED</b>
Will applicant close all windows, French doors, garage doors when any music or amplified sound (including televisions) is played inside the establishment?	YES	<input type="checkbox"/> NO	NA
Will applicant close all windows, French doors, garage doors by 11 PM Friday and Saturday and 10 PM on all other days even if no music or amplified sound is played inside the establishment?	YES	<input type="checkbox"/> NO	NA
Has applicant obtained an acoustical report from a certified sound engineer to assess potential noise disturbance to the neighboring residents and buildings?	YES	<input type="checkbox"/> NO	NA
Will applicant follow the recommendations of a certified sound engineer to mitigate potential noise disturbance to the neighboring residents and buildings, including placing speakers on the floor of the establishment?	YES	<input type="checkbox"/> NO	NA
Will the kitchen exhaust system extend to the roof?	YES	<input checked="" type="checkbox"/> NO	to the mezzanine
Will the establishment have an illuminated sign?	YES	<input checked="" type="checkbox"/> NO	
Will the establishment have a canopy extending over the sidewalk?	YES	<input checked="" type="checkbox"/> NO	
Where will the air conditioner be located? What type is it?	Inside the restaurant		
When was the air conditioner installed?	2014		

<b>OUTDOOR ITEMS - OTHER THEN SIDEWALK CAFÉ</b>			
Has the applicant/owner(s) read MCB 4 Rear Yard Rooftop Policy?	YES	NO	NA
Will applicant use any outdoor spaces: rooftop, rear yard, patio, porch, balcony, pavilion, tents, deck or gazebo? If yes, which one(s)?	YES	NO	NA
Are the floorplans for the outdoor space(s) included?	YES	NO	NA
Will applicant close and vacate the outdoor space(s) by 11PM on Friday & Saturday and 10 PM on all other days?	YES	NO	NA
Will the service and consumption of alcohol in any outdoor space only be via seated food service?	YES	NO	NA
Will applicant not allow standing space for patrons to drink or smoke in any outdoor space(s)?	YES	NO	NA
Will there be no amplified music, as per the law?	YES	NO	NA
If amplified sound is played inside the establishment, will windows and doors be closed?	YES	NO	NA
Will applicant agree to post signs outside asking customers to respect the neighbors'?	YES	NO	NA
Will applicant agree to train staff to encourage a peaceful environment?	YES	NO	NA
Will applicant provide effective sound control (landscaping enclosure, soundproofing tenants apartments)	YES	NO	NA
Will there be a lighting plan that allows safe usage of the outdoor space without disrupting neighbors?	YES	NO	NA

**OUTDOOR ITEMS – SIDEWALK CAFÉ**

Has the applicant/owner(s) read MCB4 Sidewalk Café Policy?	YES	NO	NA
Will applicant be applying for a sidewalk café now or in the future?	YES	NO	NA
Is applicant in this application seeking to include a sidewalk café in its liquor license?	YES	NO	NA
If yes, has applicant submitted an application and plans to NYC Dept. of Consumer Affairs? Please attach application and plans.	YES	NO	NA
Will applicant close and vacate the sidewalk café by 11 PM on Friday & Saturday and 10 PM on all other days?	YES	NO	NA
Will applicant be serving alcohol in the sidewalk café? If so, will you have waiter service?	YES	NO	NA
Will the café have a 3 ft. wide serving aisle running the entire length of the sidewalk café?	YES	NO	NA
Will applicant mark the perimeter of the café on the sidewalk?	YES	NO	NA
Will the service and consumption of alcohol in the sidewalk café only be via seated food service?	YES	NO	NA
Will the sidewalk café not provide standing space for drinking or smoking?	YES	NO	NA
Will applicant use any portable natural gas heaters? If so, do you have the requisite approvals from DOB & the Fire Department?	YES	NO	NA
Will applicant have a lighting plan that will allow safe usage of the outdoor space without disrupting neighbors?	YES	NO	NA
Will all furniture, plants and barricades be stored inside between the evening closing hours and the morning opening hours?	YES	NO	NA
Will all furniture be stored inside between December 21 <sup>st</sup> and March 21 <sup>st</sup> , and any other day when it rains or snows?	YES	NO	NA
Will applicant use umbrellas?	YES	NO	NA
If construction or construction protection has reduced the sidewalk width, will applicant always maintain an 8 foot clear path of sidewalk between the perimeter of the café and the closes obstruction including construction barricades?	YES	NO	NA

**ADDITIONAL STIPULATIONS: (Office Use Only)**

- Applicant will not place any a-frame signs on the sidewalk

***To the extent any additional stipulation on pages 7 and 8 of this application conflicts with any response on pages 1 – 6 of this application, the stipulations on pages 7 and 8 control.***





ADDITIONAL STIPULATIONS: (Office Use Only)

APPLICANTS WILL NOT PLACE  
ANY A-FRAME SIGNS  
ON SIDEWALK,

*To the extent any additional stipulation on pages 7 and 8 of this application conflicts with any response on pages 1 - 6 of this application, the stipulations on pages 7 and 8 control.*

**ADDITIONAL STIPULATIONS: (Office Use Only), *Continued***

*To the extent any additional stipulation on pages 7 and 8 of this application conflicts with any response on pages 1 – 6 of this application, the stipulations on pages 7 and 8 control.*

Manhattan Community Board 4 (MCB4) recommends:	<input checked="" type="radio"/> Denial unless all stipulations agreed to by applicant/owner are part of the method of operation <input type="radio"/> Denial <input type="radio"/> Approval
--	---

**CB4 REPRESENTATIVES**

 Nelly Gonzalez <i>CB4 Assistant District Manager</i>	 Frank Holozubiec <i>CB4 BLP Committee Co-Chair</i>	 Burt Lazarlo <i>CB4 BLP Committee Co-Chair</i>
--	---	--

**APPLICANT AGREEMENT WITH THE COMMUNITY**

Applicant agrees to these stipulations as the basis for the community support of this application and acknowledges that all of these stipulations are essential prerequisites to the MCB4 recommendation regarding this application. Applicant agrees to have these stipulations incorporated in the method of operation of its liquor license. The stipulations in this application constitute the entire agreement between MCB4 and applicant and may only be altered in writing signed by MCB4 and applicant. These stipulations supersede any oral statements or representations in connection with this application.

SIGN HERE →	YANNA SLAVUTSKY		6/28/17
	PRINT NAME OF APPLICANT	SIGNATURE OF APPLICANT	DATE

 7/11/17

## Proximity Report for Location:

June 30, 2017

308 W 50th St, New York, NY, 10019

\* This report is for informational purposes only in aid of identifying establishments potentially subject to 500 and 200 foot rules. Distances are approximated using industry standard GIS techniques and do not reflect actual distances between points of entry. The NYS Liquor Authority makes no representation as to the accuracy of the information and disclaims any liability for errors.

### Closest Liquor Stores

Name	Address	Approx. Distance
SHON 45 LIQUORS INC	840 8TH AVENUE	220 ft
REIDY WINE & LIQUOR CO INC	762 8TH AVENUE	855 ft
RAY & FRANK LIQUOR STORE INC	706 9TH AVENUE	895 ft
ROYAL WINES & LIQUORS INC	789 9TH AVE	1050 ft
921 WESTERLY LIQUOR CORP	921 8TH AVE	1240 ft
NINTH AVENUE VINTNER LTD	669 671 9TH AVENUE	1270 ft
54 WINES & SPIRITS INC	400 W 55TH ST AKA 839 9TH AVE	1540 ft

### Churches within 500 Feet

Name	Approx. Distance
------	------------------

### Schools within 500 Feet

Name	Address	Approx. Distance
PS 35	317 W 52ND ST	465 ft

### On-Premise Licenses within 750 Feet

Name	Address	Approx. Distance
23 INNOVATIONS INC	308 W 50TH ST	20 ft
DON ANTONIO RESTAURANT LLC	309 W 50TH ST	40 ft
KIOSK 50 CORP	322 W 50TH STREET	120 ft
WESTSIDE TM CORPORATION	813 8TH AVE	170 ft
SAS RESTAURANTS LLC	807 8TH AVE	215 ft
TBB TAVERN CORPORATION	302 W 51ST STREET	255 ft
NEW WORLD STAGES HOLDING CO LLC &	340 W 50TH ST	275 ft
316 WEST 49TH RESTAURANT CORP	316 W 49TH STREET	280 ft
SHIMIZU & TODO LLC	318 324 W 51ST STREET	285 ft
MIL LLC	329 W 49TH STREET	290 ft
TOUT VA BIEN RESTAURANT INC	311 W 51ST ST	290 ft
319 WEST 51ST STREET REST INC	319 WEST 51ST STREET	305 ft
CERTA GENTE LLC	325 W 51ST STREET	320 ft
WASHINGTON JEFFERSON HOTEL LLC	318 W 51ST ST	330 ft
CHIPOTLE MEXICAN GRILL OF COLORADO LLC	854 8TH AVENUE	350 ft
WOO LAE OAK 50 INC	350 WEST 50TH STREET	365 ft
IPPUDO WESTSIDE LLC	321 323 W 51ST ST	380 ft

Name	Address	Approx. Distance
SOCIAL 8TH AVE CORP	795 8TH AVE	395 ft
790 LOUNGE LLC & 488 HOSPITALITY GROUP LLC	790 8TH AVE	405 ft
PALM WEST CORPORATION	250 WEST 50TH STREET	415 ft
BARRAJA INC	250 W 50TH STREET	415 ft
FEDERICO S RESTAURANT INC	249 251 W 50TH STREET	415 ft
AURA LLC AND SCOTT STERNICK AND RICHARD WINKELMAN	350 W 49TH ST	440 ft
SPOONFED NEW YORK COUNTRY GROUP LLC	331 W 51ST ST	450 ft
ELYMAR RESTAURANT CORPORATION	365 W 50TH STREET	485 ft
PATZERIA FAMILY & FRIENDS INC	311 W 48TH STREET	490 ft
251 WEST 51 HOSPITALITY CORP	251 W 51ST ST	490 ft
MARIA S MONT BLANC RESTAURANT CORP	315 W 48TH STREET	495 ft
C A P RESTAURANT CORP	301 W 48TH STREET	495 ft
790 FRENCH LLC	790 8TH AVENUE	515 ft
JUJAMCYN THTRS LLC & SWEET HOSPITALITY GRP AS MGR	230 W 49TH ST	520 ft
49TH STREET RESTAURANT LLC	249 W 49TH STREET	520 ft
NIPPORI INC	245 W 51ST ST	525 ft
TOM & TOON INC	245 W 51ST STREET	535 ft
787 EIGHTH AVE CORP	787 8TH AVENUE	550 ft
BROADWAY BLUES 50TH ST CORP	226 W 50TH STREET	560 ft
TATSU RESTAURANT LLC	226 W 50TH ST EAST STORE	560 ft
TATSU RESTAURANT LLC	226 W 50TH ST WEST STORE	560 ft
M 49 LLC	240 242 W 49TH ST	565 ft
LATTITUDE WESTSIDE CORP	783 8TH AVE	610 ft
PRIVY LLC	346 W 52ND STREET	610 ft
OSIB 50TH STREET OPERATOR LLC	218-222 W 50TH ST	610 ft
TWO GUYS AND TOM INC	348 W 52ND ST	620 ft
E & E RESTAURANT 1 LLC	233 W 49TH ST	620 ft
PIATTI ITALIANI LLC	220 W 49TH ST	625 ft
RUSSIAN SAMOVAR INC	256 W 52ND STREET	630 ft
MONTAFON LLC	344 346 W 52ND ST	635 ft
SANDBAR CONCESSION INC	222 W 51ST STREET	635 ft
FJ 48 CORP	234 W 48TH ST	640 ft
LUSCIOUS INC	234 W 48TH ST	640 ft
SANDBAR CONCESSION INC	250 WEST 52ND STREET	650 ft
HARMONY VIEW INC	210 W 50TH STREET	660 ft
JUJAMCYN THTRS LLC & SWEET HOSPITALITY GRP AS MGR	219 W 48TH ST	670 ft
SWEET HOSPITALITY GROUP	261 65 W 47TH ST	675 ft
355 HELL S KITCHEN GROUP LLC	355 W 52ND ST BTW 8TH & 9TH AV	680 ft
REGENCY RESTAURANT LLC/LOUNGE 49 LLC	224 W 49TH STREET	685 ft
VICTORS CAFE 52ND STREET INC	236 238 W 52ND STREET	695 ft
JUJAMCYN THTRS LLC & SWEET HOSPITALITY GRP AS MGR	245 W 52ND ST	705 ft
PONGSRI THAI RESTAURANT CORP	244 W 48TH STREET	710 ft
LAURENCE T GINSBERG &	239 W 52ND STREET	725 ft

Name	Address	Approx. Distance
VYNL LLC	754 9TH AVE	730 ft
THEATRE REFRESHMENT CO OF NY INC	215 W 49TH STREET	735 ft
DUTCH FRED'S INC	307 W 47TH ST	740 ft
BROADWAY APPLE LLC	1634 BROADWAY	745 ft
API RESTAURANT INC	1633 BROADWAY	745 ft
M&C NEW YORK TIMES SQUARE LLC	226 W 52ND ST	745 ft

### Pending Licenses within 750 Feet

Name	Address	Approx. Distance
17 STONE STREET LLC	832 8TH AVE	165 ft
FEDERICOS RESTAURANT INC	00 BROADWAY PLAZA	285 ft
329 BLEECKER CORP	329 W 51ST ST	440 ft
FRATELLI ITALIANI LLC	220 W 49TH ST	595 ft
LANTERN GLOBAL LLC	246 W 48TH ST	605 ft

### Unmapped licenses within zipcode of report location

Name	Address
------	---------

**SWA**  
 THE OFFICE OF S. STEVE WYGOODA  
 ARCHITECTS AND PLANNERS  
 100 EAST MAIN STREET  
 HUNTINGTON, NY 11743  
 PARSIPpany, NY 07654

IT IS A VIOLATION OF N.Y. STATE LAWS  
 FOR ANY PERSON UNLESS DESIGNATED BY A  
 LICENSE TO SEAL OR SIGN ARCHITECTURAL  
 DRAWINGS TO SEAL OR SIGN ANY DRAWING  
 TO ALTER ANY ITEM IN ANY WAY.

ISSUE DATES:

NO.	DATE	DESCRIPTION
1	06/28/11	ISSUED TO OWNER
2	06/28/12	ISSUED TO OWNER

REVISIONS:

NO.	DATE	DESCRIPTION
1	5-24-2011	
2	5-24-2011	

PROJECT: 308 WEST 50TH STREET, NEW YORK, NY 10019  
 DRAWING TITLE: PROPOSED GROUND FLOOR PLAN  
 DATE: 07-22-10  
 PROJECT NO.:  
 DRAWING BY:  
 CHECK BY:  
 SCALE: A-100.00  
 SHEET 2 OF 3

Copyright 2010 The Office of S. Steve Wygoda. All rights reserved.

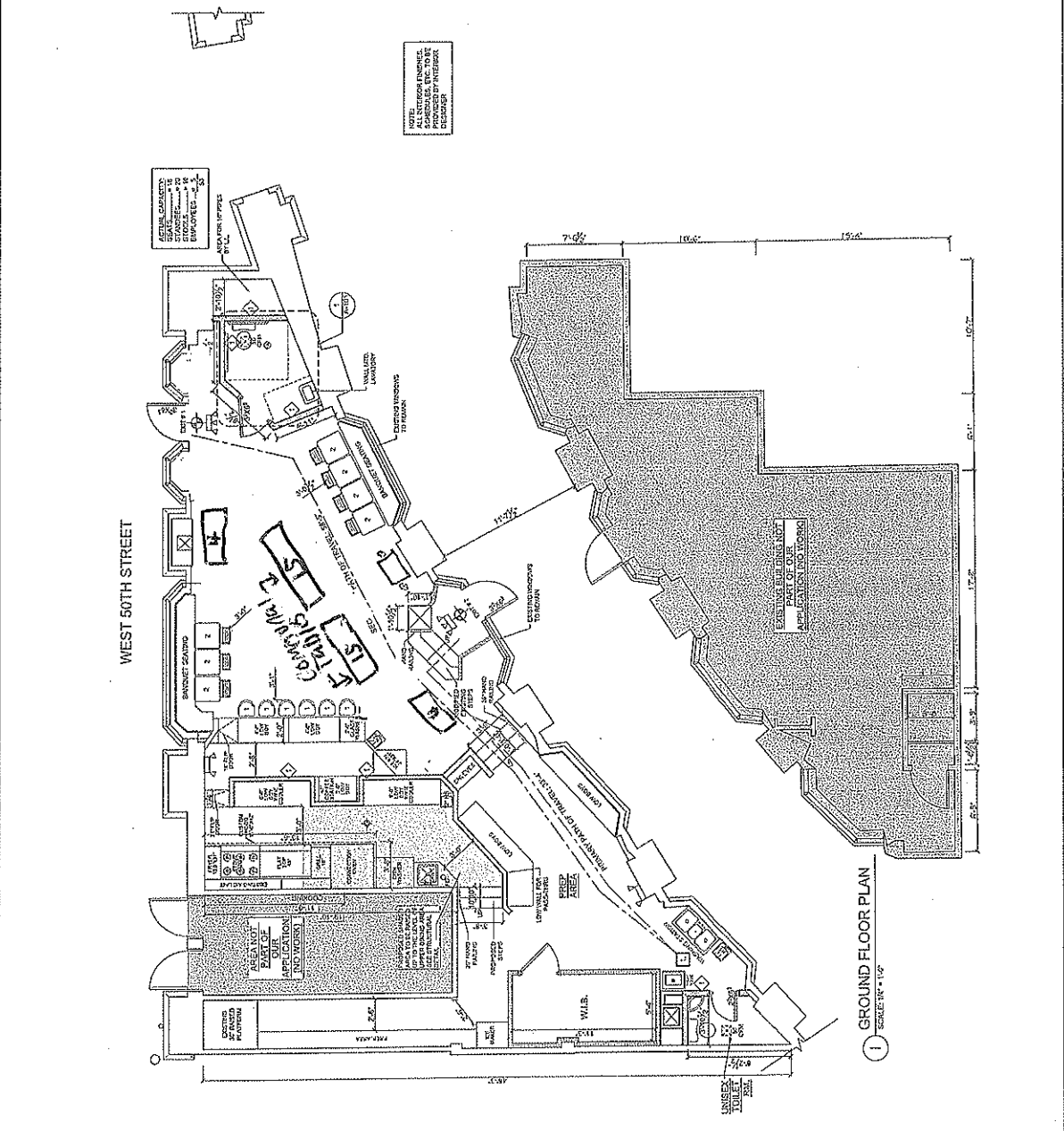

**LEGEND**

EXISTING CONSTRUCTION TO REMAIN  
 FIRE RATING AS NOTED.  
 TO BE VERIFIED IN FIELD BY CONTRACTOR.

EXISTING CONSTRUCTION TO BE REMOVED

NEW PARTITION CONSTRUCTION  
 2-1/2" x 3-1/2" METAL STUDS @ 16" O.C. WITH ONE 5/8" x 1/2" GYP BOARD OVER EACH SIDE.  
 SEE PLAN AND TYPICAL PARTITION DETAIL.

NEW PARTITION CONSTRUCTION - 4 INCHES FIRE RATED  
 2-1/2" METAL STUDS @ 16" O.C. WITH TWO LAYERS OF 5/8" x 1/2" GYP BOARD OVER EACH SIDE.  
 SEE PLAN AND TYPICAL PARTITION DETAIL.

NYC APPROVED 40 LAMP EXIT SIGN  
 BATTERY PACKS ON SEPARATE CIRCUIT

CIRCULATIONALING APPROVED AS LINE EXIT SIGN  
 (BATTERY PACKS ON SEPARATE CIRCUIT)

EMERGENCY LIGHT (ELECTRIC)  
 BATTERY PACKS ON SEPARATE CIRCUIT

SUSPENSION LIGHT (LUMEN)  
 BATTERY PACKS ON SEPARATE CIRCUIT

**IMPORTANT NOTE:**  
 CONTRACTOR SHALL VERIFY ALL FIELD CONDITIONS A DIMENSIONS AND BE RESPONSIBLE FOR FIELD FIT AND CONDITIONS OR FIELD CONDITIONS IS NOTED. CONTRACTOR SHALL VERIFY ALL FIELD CONDITIONS AND PROVIDE DIMENSIONS TO RELOCATE THE DEVICE. NO DIMENSIONS SHALL BE MADE ON BEHALF OF THE CONTRACTOR FOR ANY DIMENSIONS NOT SHOWN ON THIS PLAN.

**ELECTRICAL FIXTURE LEGEND:**

SYMBOL	FIXTURE TYPE
⊕	FIXTURE CEILING FUTURE
⊙	FIXTURE CEILING FUTURE
⊕	ATTENNA WALL DEVICE
⊕	RECESSED RECESSED CIRCULAR
⊕	4" FLUORESCENT TUBE
⊕	SWITCH

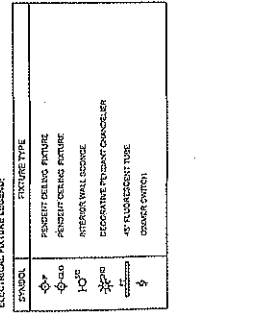

## Brunch Cocktails 12

**BLOODY MARY**  
VODKA, BLOODY MARY MIX (ADD SHRIMP SKEWER -7)

**NEW GIMLET**  
GIN, ST. GERMAIN, Muddled Mint, CUCUMBER, LIME

**CLASSY PEAR**  
FRESH PEAR JUICE, RYE, BRANDY, LIME & CLOVE

**FRAMBOISIER**  
HOT COCOA, RASPBERRY LIQUER

**GLORIOUS TINI**  
DON JULIO TEQUILA, GLORIOUS DETOX JUICE

**MIMOSA**  
PROSECCO, FRESH ORANGE JUICE

**MARIA'S COCOA**  
HOT COCOA, TIA MARIA, PEPPERMINT

**CENTRAL PARK**  
BOURBON, ALL GREENS JUICE, BASHI SYRUP

**BERRY DANGEROUS**  
Muddled STRAWBERRY, BLUEBERRY, BLACKBERRY, LEMON, STOUT, LEMONADE

**ROYAL BELLINI**  
FRESH OJ, CHAMPAGNE, PROSECCO

**QUEEN BELLINI**  
STRAWBERRY CORDIAL, PROSECCO, ELDERFLOWER

**JAVILTON SUNRISE**  
TEQUILA, PINEAPPLE JUICE, BLOOD ORANGE SYRUP

## Quesadillas

**FREE RANGE CHICKEN 16**  
ROASTED RED PEPPER, ONION, CHEDDAR, PEPPER JACK

**SHRIMP 20**  
ROASTED RED PEPPER, ONION, CHEDDAR, PEPPER JACK

**VEGETABLE 19**  
MUSHROOM, ROASTED TOMATO, BABY SPINACH, ONION, CHEDDAR, PEPPER JACK

**GRASS FED STEAK 20**  
ROASTED RED PEPPER, ONION, CHEDDAR, PEPPER JACK

## Sandwiches and Fries

**GOOEY CHEESE 12**

NEW YORK STATE CHEDDAR, GORGONZOLA, APPLES  
GRILLED ORGANIC ASPRAGUS, WHITE TRUFFLE OIL  
PEPPER JACK, CHEDDAR, SAN FRANCISCO SOUR DOUGH

**FREE RANGE CHICKEN 14**

BRIE, ARUGULA, MANGO CHUTNEY  
BACON, PEPPER JACK, SPINACH

**CUBANO 19**

HAM, ROASTED PORK, CHEESE, PICKLE, CHIPOTLE AIOLI  
TURKEY, HAVARTI, PICKLE CHIPOTLE AIOLI  
ON BAGUETTE

**TUNA, HAVARTI MELT 19**

ORGANIC VEGETABLE SANDWICH 15  
ZUCCHINI, SQUASH, GOAT CHEESE, ROASTED TOMATO, PESTO

## Tailored Omelettes

RUSTIC POTATOES, MIXED GREEN SALAD  
CHOOSE UP TO 5 ITEMS 15

ZUCCHINI, MUSHROOM, CARAMELIZED ONION, JALAPENO, KALE, TOMATO, SPINACH,  
ASPARAGUS, ROASTED RED PEPPER, BLACK BEAN PUREE  
SWISS, CHEDDAR, HAVARTI, PEPPER JACK, MOZZARELLA, GOAT CHEESE, BRIE  
SAUSAGE, BACON, HAM, TURKEY BACON, TURKEY BREAST

## Sunrise Sandwiches

RUSTIC POTATOES AND ORGANIC MIXED GREEN SALAD

EGG AND CHEESE 11

EGG WHITES AND AVOCADO 14

ADD SAUSAGE, BACON, HAM, TURKEY BACON, TURKEY &  
EZEKIEL (SROUTED WHEAT) BREAD, TOASTED BAGEL, CROISSANT 1.5

## Benedicts

2 POACHED EGGS, HOLLANDAISE, ENGLISH MUFFIN,  
WITH RUSTIC POTATOES & GREEN SALAD

CRABCAKE, 18

TRADITIONAL (CANADIAN BACON) 16

SPINACH FLORENTINE 15

GRILLED AVOCADO 17.5

## Juicy Burgers And Fries

SUB TRUFFLE, ROSEMARY, OR PARMESAN FRIES 2

**BLUE DOG BURGER 16.5**

BRISKEET - CHUCK BLEND, CRISPY BACON, PICKLE  
SUNNY SIDE UP EGG

**HOUSE MADE VEGAN BURGER 16**

SHITAKE "BACON," CRISPY ASPRAGUS

**CHEESY BURGER 19.5**

CHOOSE FROM WHITE CHEDDAR, SWISS OR PEPPER JACK

**BOOZY CHICKEN 16**

PAN FRIED CHICKEN THIGH, SRIRACHA MUSTARD  
CAVIR, BOOZY CHEESE SAUCE

**GRASS FED LAMB 16**

GRILLED ONIONS, SWISS, ROMAINE, TOMATO, PICKLE

## Specialties

**DULCE DE LECHE WAFFLES 15**

WHIPPED RICOTTA-LIME CREME, DULCE DE LECHE DRIZZLE

**CRUNCHY FRENCH TOAST 15**

PULLMAN BREAD, CARAMELIZED BANANA

**PUMPKIN STUFFED FRENCH TOAST 15**

CREAM CHEESE PUMPKIN PUREE, SWEET BRIOCHE, BLACKBERRY GLAZE

**CHOCOLATE CHIP PANCAKES 13**

DULCE DE LECHE, WHIPPED RICOTTA-LIME CREME

**HOUSE CURED SALMON PLATTER 19**

CAPERS, CUCUMBER, ORGANIC GREENS, CREAM CHEESE,  
TOASTED BAGEL

**HOMESTYLE CHICKEN, MAC,  
& GRILLED CORNBREAD 22**

**BREAKFAST BURRITO 14**

ORGANIC SCRAMBLED EGGS, MUSHROOM, ASPRAGUS, JALAPENOS,  
CHIPOTLE TOMATILLO SALSA, MONTEREY JACK CHEESE

**AVOCADO GOAT CHEESE TOAST 15.5**

SUNNY SIDE UP EGG

**HUEVOS CON CHORIZO 16**

SCRAMBLED EGGS, SPANISH PORK CHORIZO,  
RUSTIC POTATO, ORGANIC MIXED GREENS

**CROQUE MADAME 16**

HONEY CURED HAM, MELTED CHEESE, BECHAMEL, ON  
SOURDOUGH SUNNY SIDE EGG, MIXED ORGANIC GREENS

**CROQUE MONSIEUR 15**

HONEY CURED HAM, MELTED CHEESE, BECHAMEL,  
ON SOURDOUGH, HAND CUT FRIES

**HUEVOS RANCHEROS 17**

SUNNY SIDE UP EGG, BLACK BEANS, CRISPY  
TORTILLA, MONTEREY JACK CHEESE, PICKLED JALAPENO

**STEAK 'N EGGS 20**

GRILLED GRASS FED HANGER STEAK, SUNNY SIDE UP EGG  
CHIMICHURRI, RUSTIC POTATOES

**VEGETABLE TACOS 12**

BUTTERNUT SQUASH, MUSHROOM, KALE SLAW

## Salads

**CARIBBEAN COBB WITH CHICKEN 16**

MANGO, TOMATO, CUCUMBER, CARROT, AVOCADO, ROMAINE,  
BLUE CHEESE, BALSAMIC DRESSING

**GRILLED SCOTTISH SALMON 20**

ORGANIC BABY SPINACH, ASIAN PEAR, HEARTS OF PALM,  
LEMON HONEY VINAIGRETTE

**KALE 15.5**

KALE, AVOCADO, APPLE, ORANGE,  
TOASTED SUNFLOWER SEEDS, SHOKED SEA SALT, TAHINI DRESSING  
ADD SHRIMP 7

**HANGER STEAK 23**

BRUSSEL SPROUTS, ARUGULA, BLEU CHEESE, TOMATO,  
SPANISH ONION, BALSAMIC DRESSING

## Sides

**BUTTERNUT SQUASH FRIES 9**

**ARUGULA SIDE SALAD 7**  
LEMON, OLIVE OIL

**CHARRED CAULIFLOWER 9**  
CILANTRO LIME AIOLI

**RUSTIC POTATOES 6**

**PARMESAN FRIES 8**

**HAND CUT FRENCH FRIES 6**

**WHITE TRUFFLE FRIES 8**

**ROSEMARY FRIES 8**

Blue Dog



## Cold Pressed Juices

ALL GREENS 9  
PARSLEY, ROMAINE, CUCUMBER, CELERY

ALL GREENS PLUS 9.50  
KALE, SPINACH, PARSLEY, GINGER, APPLE, LEMON, CUCUMBER

ORANGE JUICE 5.50

GREENS WITH SPEED 9  
SPINACH, PARSLEY, CUCUMBER, CELERY, CAYENNE

TWISTED OLIVER 9.50  
APPLE, CUCUMBER, PINEAPPLE, KALE, LEMON, GINGER

GLORIOUS DETOX 9  
ALOE, IMMUNITY ELIXIR, PINEAPPLE, PEAR, GINGER, APPLE

KNIGHT IN ARMOR 9  
IMMUNITY ELIXIR, DOUBLE GINGER, APPLE, LEMON, CAYENNE

SPRING AWAKENING 9  
PINEAPPLE, PEAR, APPLE, MINT

KALEARITA 9  
APPLE, CUCUMBER, PINEAPPLE, KALE, LEMON, GINGER

## Natural Smoothies

BIG KAUNA 8  
PINEAPPLE, COCONUT MANGO, GUAVA,  
AGAVE, COCONUT WATER

UBER ANTIOXIDANT 8  
BLUEBERRY, RASPBERRY, STRAWBERRY,  
POMEGRANATE, ORANGE JUICE

GOJI BERRY 9.5  
GOJI, ALMOND BUTTER, COCONUT,  
STRAWBERRY, BANANA, COCONUT WATER

KING OF THE JUNGLE 9.5  
KALE, SPINACH, BANANA, ALMOND MILK

BALI 8.5  
CINNAMON, VANILLA, SHREDDED COCONUT,  
BANANA, COCONUT WATER

MARRAKESH 8.5  
STRAWBERRY, PINEAPPLE, GINGER,  
AGAVE, MINT GREEN TEA

ST. TROPEZ 8.5  
BLUEBERRY, BANANA, STRAWBERRY,  
WALNUT, VANILLA, APPLE JUICE

QUEEN OF THE JUNGLE 8.5  
KALE, SPINACH, BANANA, FRESH  
PRESSED ORANGE JUICE

CHAI'NG MAI 8.25  
PEANUT BUTTER, BANANA, CINNAMON,  
COCONUT, VANILLA, SOY MILK

STRAWBERRY FIELDS 8.75  
STRAWBERRY, PINEAPPLE, BANANA, FLAX  
OIL, AGAVE, COCONUT WATER

TAHITI 8.25  
STRAWBERRY, BANANA,  
VANILLA, COCONUT WATER

ST. BARTH 8.25  
PINEAPPLE, BLUEBERRY, BANANA,  
VANILLA, COCONUT WATER

LAGUNA BEACH 9  
BANANA, STRAWBERRY, BLUEBERRY,  
GRANOLA, VANILLA, COCONUT WATER

## Glacial Sips

BLOOD ORANGE LEMONADE 4

STRAWBERRY LEMONADE 4

RASPBERRY LEMONADE 4

HIBISCUS LEMONADE 4

ICED CHAI LATTE 5

MOROCCAN MINT ICED TEA 4

STRAWBERRY SODA 3.5

POMEGRANATE ARNOLD PALMER 4

MANGO ICED TEA 4

BLACK ICED TEA 4

## Blue Dog Java Blends

BLUE DOG BREW 6  
ESPRESSO, CHAI, MOCHA

SALTED CARAMEL LATTE 6  
BLACK SEA SALT

DIRTY HOT CHOCOLATE 6  
ESPRESSO, WHIPPED CREAM

NYC O'CHINNO 6  
ESPRESSO, PEANUT BUTTER, MOCHA

RASPBERRY WHITE CHOCOLATE 6.25  
MOCHA

PEANUT BUTTER & JELLY LATTE 6  
ESPRESSO, PEANUT BUTTER, STRAWBERRY

CREAMY HOT CHOCOLATE 5.5  
WHIPPED CREAM

## Loose Leaf Teas 3.75

ORGANIC GREEN  
ORGANIC CLOUDS AND MIST  
POMEGRANATE  
MOROCCAN MINT  
DRAGON WELL  
MATE GREEN  
GENMAICHA  
JASMINE

HERBAL  
MORITANA GOLD  
RED BERRIES  
LEMON GINGER  
PEPPERMINT  
CHAMOMILE  
PEACH PARADISE

HOUSE BLEND  
ANGEL BENEVO  
INNER GLOW  
AFRICAN SILK  
DURBAN SUNSET

EXOTIC BLACK  
EARL GREY WHITE TIP  
LEMON DROP  
BLUEBERRY FIELDS  
ENGLISH BREAKFAST  
BREAKFAST ASSAULT

## Blue Dog Basics

RICH ROASTED HOUSE 2.75  
ESPRESSO 2.25 3.25  
BLACK EYE 4.25  
RED EYE 3.75  
SPICED CHAI LATTE 5  
CAPPUCCINO 4.5

LATTE 5  
CAFE AU LAIT 4  
DIRTY CHAI 5.75  
MACCHIATO 3.25  
CARAMEL MACCHIATO 4

## Starters

- OUR FAMOUS TURKEY CHILI 9  
SEA SALT & PEPPER CALAMARI 13  
ROASTED TOMATO MARINARA/ SPICY AIOLI  
CHICKEN DUMPLINGS 12  
PONZU SAUCE  
STRING BEAN SAGE TEMPURA 11  
SPICY SOY  
TUNA TARTARE 15  
CRISPY SUSHI RICE/ SPICY AIOLI  
CLASSIC GUACAMOLE 14  
HOUSE MADE CHIPS/ MEDITERRANEAN SEA SALT  
HOT POTATO CHIPS 8  
WARM BLUE CHEESE DIP  
BUTTERNUT SQUASH FRIES 9  
SPICY TRUFFLE AIOLI
- VEGAN SOUP SPECIAL 8  
ASK YOUR FRIENDLY SERVER FOR TODAY'S SPECIAL  
TERIYAKI WINGS 11  
WARM BLUE CHEESE  
TACOS - 2 PER ORDER  
STEAK/ FISH/ VEGGIE - 12  
VERACRUZ GUACAMOLE 15  
GOAT CHEESE/ PEPITAS/ WARM CORN CHIPS  
ROCK SHRIMP TEMPURA 15  
KALE SLAW  
TRUFFLED MAC & CHEESE 11  
BURRATA TOAST 14  
TOMATO/ BASIL/ AGED BALSAMIC  
BUTTERNUT SQUASH TOAST 13  
GOAT CHEESE/ PEPITAS/ AGED BALSAMIC  
AVOCADO TOAST 12

## Entrees

- SCOTTISH SALMON 26  
CURRIED BLACK LENTILS/ BUTTERNUT SQUASH/ KALE  
RIGATONI 19  
CREAM/ FRESH TOMATO/ CREMINI MUSHROOM  
FARM PICKED VEGETABLE UDON 17  
ZUCCHINI/ BASIL/ CILANTRO/ SQUASH/ CARROT/  
GREEN BEAN/ SWEET CORN/ PEANUT SAUCE  
HANGER STEAK 28  
GREEN PEAS/ MUSHROOMS/ CHIMICHURI SAUCE  
SPICY CURRY 23  
SPICY CURRY COCONUT MILK WITH WILD RICE -  
CHICKEN OR SALMON  
JAPANESE SAUTEE PAN 18  
UDON NOODLE VEGGIES/ GINGER/ SOY/  
STEAK CHICKEN OR SHRIMP
- SPAGHETTI 18  
SUN-DRIED TOMATO/ EGGPLANT  
CRISPY FISH AND CHIPS 21  
HOMEMADE JALAPENO TARTAR  
SPRING VEGETABLE BIMIBAP 19  
SUSHI RICE/ SPINACH/ CREMINI MUSHROOM/ EDAMAME/  
HOUSE MADE PICKLED VEGETABLE/ SUNNY SIDE EGG  
TRUFFLED MAC & CHEESE 18  
CRISPY FLOUNDER SANDWICH 18  
KALE SLAW/ SPICY HARBISSA SAUCE/ FRENCH FRIES  
CBLT 16  
GRILLED CHICKEN/ BACON/ LETTUCE/ TOMATO  
HONEY WASABI SAUCE

## Burgers

- BLUE DOG 18  
BRISKET - CHICK BLEND/ APPLE WOOD BACON/ SUNNY SIDE UP EGG/  
TOMATO/ PICKLE/ LETTUCE/ FRENCH FRIES  
CHEESY BURGER 17  
CHOICE OF MELTED CHEESE/ ROMAINE/ TOMATO/ PICKLE/  
FRENCH FRIES  
GRILLED PORTABELLO 16  
AVOCADO AIOLI/ BABY SPINACH/ FRENCH FRIES/  
ORGANIC MIX GREEN SALAD  
FREE RANGE CHICKEN BURGER 17  
GROUND CHICKEN/ ROMAINE/ TOMATO/ PICKLES/  
FRENCH FRIES  
LAMB 18  
GRILLED ONIONS/ CHEDDAR/ ROMAINE/ TOMATO/ PICKLE/  
FRENCH FRIES

## Quesadillas

SERVED WITH GUACAMOLE AND SAUSA

- FARM PICKED VEGETABLE 14  
MUSHROOM/ ROASTED TOMATO/ BABY SPINACH/ ONION/ CHEDDAR/  
PEPPER JACK  
CHICKEN 16  
ROASTED RED PEPPER/ ONION/ CHEDDAR/ PEPPER JACK  
HANGER STEAK OR SHRIMP 18  
ROASTED RED PEPPER/ ONION/ CHEDDAR/ PEPPER JACK

## Salads

- ARUGULA 14  
ZUCCHINI/ ORANGE/ OLIVE OIL/ MINT  
ROASTED BEET 15  
GRAPEFRUIT/ GOAT CHEESE/ WATERCRESS  
KALE 14  
BABY KALE/ SUNFLOWER SEED TAHINI/ AVOCADO/ APPLE/ ORANGE/  
TOASTED SUNFLOWER SEEDS/ SMOKED SEA SALT  
ADD STEAK 9    ADD CHICKEN 7    ADD SHRIMP 8

## Entree Salads

- GRILLED SCOTTISH SALMON 21  
BABY SPINACH/ ASIAN PEAR/ HEARTS OF PALM/  
CARROT/ LEMON HONEY VINAIGRETTE  
HANGER STEAK 23  
BRUSSEL SPROUTS/ ARUGULA/ GOAT CHEESE/ TOMATO/ SPANISH ONION/  
BALSAMIC  
CRISPY CALAMARI 19  
ARUGULA/ GREEN BEAN/ CORN/ CREAMED HABANARO

## Sides

- ARUGULA SIDE SALAD 7  
LEMON/ OLIVE OIL  
SAUTEED KALE PORTOBELLO 9.5  
SWEET SOY  
CHARRED CAULIFLOWER 9  
CILANTRO LIME AIOLI  
FARMHOUSE BRUSSEL SPROUTS 9.5  
MEDITERRANEAN SEA SALT/ LIME  
TRUFFLED MAC & CHEESE 11  
WHITE TRUFFLE FRIES 9  
FRENCH FRIES 7  
PARMESAN FRIES 8

WE BELIEVE IN USING WHOLESOME, NATURAL, GRASS FED & FREE  
RANGE INGREDIENTS IN OUR CREATIONS

Blue Dog  
RESTAURANT

Dinner Served 4 Pm - 11 Pm  
Monday Through Saturday



