

Manhattan Community Board 4
(All Fields Must Be Completed)

Liquor License Stipulations Application

CORPORATION NAME <i>Pazzo Kollio Corp</i>		DOING BUSINESS AS (DBA) <i>Pizza Kollio</i>	
STREET ADDRESS <i>261 W 18th St</i>		CROSS STREETS <i>8th ave</i>	ZIP CODE <i>10011</i>
OWNER <small>(Attach a list of all the people that will be associated/invest with the license)</small>	NAME: <i>Miyuki Talwar</i>	ATTORNEY/ REPRESENTATIVE	NAME:
	PHONE: <i>646 262 1438</i>		PHONE:
	EMAIL: <i>pizzakolliony@gmail.com</i>		EMAIL:
MANAGER	NAME: <i>Mark Tapanaha</i>	LANDLORD	NAME: <i>Sharoon Din</i>
	PHONE: <i>646 657 8674</i>		PHONE: <i>212 989 3100</i>
	EMAIL: <i>pizzakolliony@gmail.com</i>		EMAIL: <i>sdin@wmgottlieb.com</i>
APPLICATION TYPE (Check One)			
<input checked="" type="radio"/> New	Has applicant owned or managed a similar business?	<input checked="" type="radio"/> YES	<input type="radio"/> NO
	What is/was the name and address of establishment?	<i>Pizza Kollio at the Plaza Hotel</i>	
	What were the dates applicant was involved with the former premise?	<i>November 2014</i>	
<input type="radio"/> Transfer	What is the prior license # and expiration date?		
	Is applicant making any alterations or operational changes?	<input type="radio"/> YES	<input type="radio"/> NO
	If alterations or operational changes are being made, please describe/list all changes.		
<input type="radio"/> Alteration	What is the current license # and expiration date?		
	Please describe the nature of all the changes and attach the plans.		
METHOD OF OPERATION			
TYPE OF ALCOHOL	<input type="radio"/> Liquor/Wine/Beer	<input type="radio"/> Beer	<input checked="" type="radio"/> Wine & Beer
ESTABLISHMENT TYPE	<input checked="" type="radio"/> Restaurant <input type="radio"/> Cabaret <input type="radio"/> Night Club <input type="radio"/> Hotel <input type="radio"/> Bar/Tavern <input type="radio"/> Catering Establishment		
	<input type="radio"/> Adult Entertainment <input type="radio"/> Wine Bar <input type="radio"/> Dance Club <input type="radio"/> Sports Bar <input type="radio"/> Club (Fraternal Organization - Members Only)		
Has applicant/owner filed with the SLA? If yes, when? If no, when do you plan to file?	YES	<input checked="" type="radio"/> NO	<i>after approval with CB4</i>
Is the 500 Foot Rule applicable? If yes, please attach a diagram of the On-Premise liquor license establishments within a 500 ft. radius of your establishment and the Public Interest Statement.	YES	<input checked="" type="radio"/> NO	
Is the 200 Foot Rule applicable? If yes, please attach a diagram of the schools and houses of worship that trigger the rule.	YES	<input checked="" type="radio"/> NO	
Has applicant/owner(s) read MCB4 Policy Regarding Concentration and Location of Alcoholic-Serving Establishments?	<input checked="" type="radio"/> YES	<input type="radio"/> NO	

OPERATIONAL DETAILS (*Closing time will be when establishment is vacated of all patrons)									
HOURS* (Indoor Only)		MONDAY	TUESDAY	WEDNESDAY	THURSDAY	FRIDAY	SATURDAY	SUNDAY	
	Operation	11am-11pm	11-11pm	11-11pm	11-11pm	11-11pm	11-11pm	11-11pm	11-11pm
	Kitchen	10-11:30	10-11:30	10-11:30	10-11:30	10-11:30	10-11:30	10-11:30	
	Music	11-10pm	11-10pm	11-10pm	11-10pm	11-10pm	11-10pm	11-10pm	
If you plan to have music, what type(s)? (Circle all that apply)		<input checked="" type="checkbox"/> BACKGROUND		<input type="checkbox"/> LIVE MUSIC	<input type="checkbox"/> DJ	<input type="checkbox"/> JUKE BOX	<input type="checkbox"/> KARAOKE		
OCCUPANCY									
	Capacity (Certificate of Occupancy)	Maximum # of Persons You Anticipate Occupying Premises (Including Employees)	Number of Tables	Number of Seats	Number of Service Only Bars	Number of Stand-Up Bars	Number of Seats at Stand-Up Bar		
INSIDE		24 24	8 8	17 17	n/a	n/a	n/a		
OUTSIDE (Other than sidewalk cafe)		0	0	0	n/a	n/a	n/a		
SIDEWALK CAFE									
How many floors are there? What is the capacity for each floor?					ground floor				
How frequently will the owner(s) be at the establishment?					regularly				
Will you be applying or intending to apply for a cabaret license with DCA? If yes, will there be dancing?					YES	<input checked="" type="radio"/> NO			
Will applicant have bottle or table service for beverage alcohol?					YES	<input checked="" type="radio"/> NO			
Will you be hosting private, promotional or corporate events?					<input checked="" type="radio"/> YES	<input type="radio"/> NO			
Will outside promoters be used on a regular basis? If yes please describe.					YES	<input checked="" type="radio"/> NO			
Will you have a security plan? If, yes please attach.					YES	<input checked="" type="radio"/> NO			
Will security plan be implemented?					<input checked="" type="radio"/> YES	<input type="radio"/> NO	webcam		
Will State certified security personnel be used?					YES	<input checked="" type="radio"/> NO			
Will New York Nightlife Association and NYPD Best Practices be followed?					<input checked="" type="radio"/> YES	<input type="radio"/> NO			
Will applicant be using delivery bicycles? If yes, how many?					<input checked="" type="radio"/> YES	<input type="radio"/> NO			
Will delivery bicycles be clearly marked with the name of the restaurant and will staff wear attire clearly noting name as described by NYC Law?					<input checked="" type="radio"/> YES	<input type="radio"/> NO			
Where will delivery bicycles be stored during the day when not in use?									

AAH
AAH

LOCATION & ZONING		
Is this a Special District? If yes, is it Clinton, West Chelsea or Hudson Yards?	YES	<input checked="" type="radio"/> NO
Does the building have a Certificate of Occupancy ("C of O") or a letter of no objection?	<input checked="" type="radio"/> YES	NO
Is a Public Assembly permit required?	YES	<input checked="" type="radio"/> NO
Are your plans filed with DOB?	<input checked="" type="radio"/> YES	NO

Community Notification/Relations		
NOTIFICATION: List all block associations, tenant associations, co-op boards or condo boards of residential buildings, and community groups that applicant has notified regarding its application. For each please list both the organization and individual you contacted	# 1	<i>Amorino Gelato</i>
	# 2	
	# 3	
	# 4	
	# 5	
	Please provide dates when applicant met with the groups listed above.	
Who was your contact person at each group you met with?		<i>Muzuki Talwar</i>
When did applicant post the notice that was provided?		
Where did applicant post the notice that was provided?		<i>at the window front of shop</i>
Will applicant provide owner cell phone number to neighbors and respond to complaints that arise? Please provide number in space provided.	<input checked="" type="radio"/> YES	NO <i>6462621438</i>
Will applicant inform the Community Board office of its job openings and/or provide a hyperlink to applicants jobs webpage?	<input checked="" type="radio"/> YES	NO

BUILDING DESIGN			
State the name and type of business previously located in the space.	office space / gelato		
Has a liquor-licensed establishment previously occupied this space at any time? If yes, please provide the name of the business.	YES	NO	
Do you plan any changes to the existing façade? If yes, please describe.	YES	NO	change door / install glass window
Will applicant have a vestibule within the establishment?	YES	NO	
Will applicant use a storm enclosure?	YES	NO	
Will applicant not place any items or obstructions on the sidewalk, for example, sandwich boards, sidewalk signs, freestanding menus and plants, as per the law?	YES	NO	
Will applicant comply with the NYC noise code?	YES	NO	
Will the establishment have any of the following: (circle all that apply)	FRENCH DOORS	GARAGE DOORS	WINDOWS THAT CAN BE OPENED
Will applicant close all windows, French doors, garage doors when any music or amplified sound (including televisions) is played inside the establishment?	YES	NO	
Will applicant close all windows, French doors, garage doors by 11 PM Friday and Saturday and 10 PM on all other days even if no music or amplified sound is played inside the establishment?	YES	NO	
Has applicant obtained an acoustical report from a certified sound engineer to assess potential noise disturbance to the neighboring residents and buildings?	YES	NO	
Will applicant follow the recommendations of a certified sound engineer to mitigate potential noise disturbance to the neighboring residents and buildings, including placing speakers on the floor of the establishment?	YES	NO	
Will the kitchen exhaust system extend to the roof?	YES	NO	n/a
Will the establishment have an illuminated sign?	YES	NO	
Will the establishment have a canopy extending over the sidewalk?	YES	NO	only a little
Where will the air conditioner be located? What type is it?	inside the shop / freidrich commercial		
When was the air conditioner installed?	to be installed		

OUTDOOR ITEMS - OTHER THEN SIDEWALK CAFE		
Has the applicant/owner(s) read MCB 4 Rear Yard Rooftop Policy?	<input checked="" type="radio"/> YES	<input type="radio"/> NO
Will applicant use any outdoor spaces: rooftop, rear yard, patio, porch, balcony, pavilion, tents, deck or gazebo? If yes, which one(s)?	<input checked="" type="radio"/> YES	<input type="radio"/> NO
Are the floorplans for the outdoor space(s) included?	<input checked="" type="radio"/> YES	<input type="radio"/> NO
Will applicant close and vacate the outdoor space(s) by 11PM on Friday & Saturday and 10 PM on all other days?	<input checked="" type="radio"/> YES	<input type="radio"/> NO
Will the service and consumption of alcohol in any outdoor space only be via seated food service?	<input checked="" type="radio"/> YES	<input type="radio"/> NO
Will applicant not allow standing space for patrons to drink or smoke in any outdoor space(s)?	<input checked="" type="radio"/> YES	<input type="radio"/> NO
Will there be no amplified music, as per the law?	<input checked="" type="radio"/> YES	<input type="radio"/> NO
If amplified sound is played inside the establishment, will windows and doors be closed?	<input checked="" type="radio"/> YES	<input type="radio"/> NO
Will applicant agree to post signs outside asking customers to respect the neighbors?	<input checked="" type="radio"/> YES	<input type="radio"/> NO
Will applicant agree to train staff to encourage a peaceful environment?	<input checked="" type="radio"/> YES	<input type="radio"/> NO
Will applicant provide effective sound control (landscaping enclosure, soundproofing tenants apartments)	<input checked="" type="radio"/> YES	<input type="radio"/> NO
Will there be a lighting plan that allows safe usage of the outdoor space without disrupting neighbors?	<input checked="" type="radio"/> YES	<input type="radio"/> NO

THIS APPLICATION DOES NOT EXTEND

OUTDOOR ITEMS – SIDEWALK CAFÉ	
Has the applicant/owner(s) read MCB4 Sidewalk Café Policy?	<input checked="" type="radio"/> YES <input type="radio"/> NO
Will applicant be applying for a sidewalk café now or in the future?	<input checked="" type="radio"/> YES <input type="radio"/> NO
Is applicant in this application seeking to include a sidewalk café in its liquor license?	<input checked="" type="radio"/> YES <input type="radio"/> NO
If yes, has applicant submitted an application and plans to NYC Dept. of Consumer Affairs? Please attach application and plans.	<input type="radio"/> YES <input checked="" type="radio"/> NO
Will applicant close and vacate the sidewalk café by 11 PM on Friday & Saturday and 10 PM on all other days?	<input checked="" type="radio"/> YES <input type="radio"/> NO
Will applicant be serving alcohol in the sidewalk café? If so, will you have waiter service?	<input checked="" type="radio"/> YES <input type="radio"/> NO
Will the café have a 3 ft. wide serving aisle running the entire length of the sidewalk café?	<input checked="" type="radio"/> YES <input type="radio"/> NO
Will applicant mark the perimeter of the café on the sidewalk?	<input checked="" type="radio"/> YES <input type="radio"/> NO
Will the service and consumption of alcohol in the sidewalk café only be via seated food service?	<input checked="" type="radio"/> YES <input type="radio"/> NO
Will the sidewalk café not provide standing space for drinking or smoking?	<input checked="" type="radio"/> YES <input type="radio"/> NO
Will applicant use any portable natural gas heaters? If so, do you have the requisite approvals from DOB & the Fire Department?	<input type="radio"/> YES <input checked="" type="radio"/> NO
Will applicant have a lighting plan that will allow safe usage of the outdoor space without disrupting neighbors?	<input checked="" type="radio"/> YES <input type="radio"/> NO
Will all furniture, plants and barricades be stored inside between the evening closing hours and the morning opening hours?	<input checked="" type="radio"/> YES <input type="radio"/> NO
Will all furniture be stored inside between December 21 st and March 21 st , and any other day when it rains or snows?	<input type="radio"/> YES <input checked="" type="radio"/> NO
Will applicant use umbrellas?	<input checked="" type="radio"/> YES <input type="radio"/> NO
If construction or construction protection has reduced the sidewalk width will applicant always maintain an 8 foot clear path of sidewalk between the perimeter of the café and the closest obstruction including construction barricades?	<input checked="" type="radio"/> YES <input type="radio"/> NO

YTO ANT
SIDEWALK CAFÉ

ADDITIONAL STIPULATIONS: (Office Use Only)

- This application does not extend to any sidewalk cafe

To the extent any additional stipulation on pages 7 and 8 of this application conflicts with any response on pages 1 – 6 of this application, the stipulations on pages 7 and 8 control.

ADDITIONAL STIPULATIONS: (Office Use Only), *Continued*

To the extent any additional stipulation on pages 7 and 8 of this application conflicts with any response on pages 1 – 6 of this application, the stipulations on pages 7 and 8 control.

Manhattan Community Board 4 (MCB4) recommends:	<input checked="" type="radio"/> Denial unless all stipulations agreed to by applicant/owner are part of the method of operation <input type="radio"/> Denial <input type="radio"/> Approval
------------------------------------------------	-------------------------------------------------------------------------------------------------------------------------------------------------------------------------------------------------

CB4 REPRESENTATIVES

 Nelly Gonzalez <i>CB4 Assistant District Manager</i>	 Franca Brusilovic <i>CB4 BLP Committee Co-Chair</i>	 Bert Lazzarin <i>CB4 BLP Committee Co-Chair</i>
----------------------------------------------------------------------------------------------------------------------------------------------	----------------------------------------------------------------------------------------------------------------------------------------------	------------------------------------------------------------------------------------------------------------------------------------------

APPLICANT AGREEMENT WITH THE COMMUNITY

Applicant agrees to these stipulations as the basis for the community support of this application and acknowledges that all of these stipulations are essential prerequisites to the MCB4 recommendation regarding this application. Applicant agrees to have these stipulations incorporated in the method of operation of its liquor license. The stipulations in this application constitute the entire agreement between MCB4 and applicant and may only be altered in writing signed by MCB4 and applicant. These stipulations supersede any oral statements or representations in connection with this application.

SIGN HERE →	Miyuki Talwar		6/23/2017
	PRINT NAME OF APPLICANT	SIGNATURE OF APPLICANT	DATE

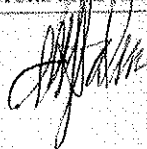
 9/11/17

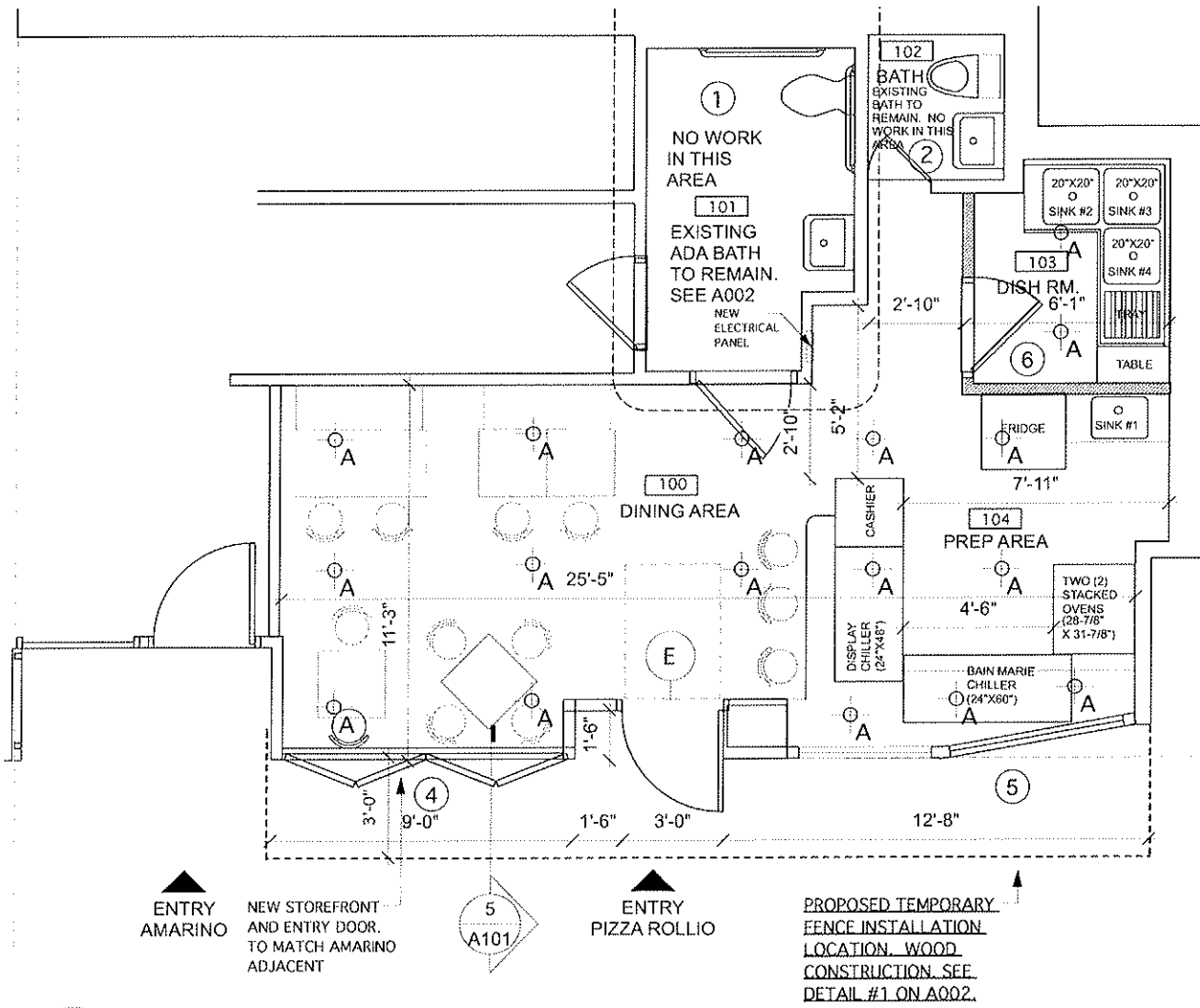

2 CONSTRUCTION PLAN
 Scale: 1/4" = 1'-0"

LIGHTING KEY:

⊕ A RECESSED ADJUSTABLE DOWNLIGHT. LOCATIONS AND QUANTITIES FOR PRICING ONLY. COORDINATE LOCATIONS

You've NEVER had pizza this thin!

DESSERT PIZZA

APPLE CINNAMON half \$7.95
apple slices, walnuts, cinnamon

BANANA NUTELLA half \$7.95
banana slices, Nutella, almonds

DRINKS

brewed coffee, cappuccino, latte,
espresso, iced coffee, milk, iced green
tea, fruit juice, San Pellegrino, canned
soda, bottled water, sparkling water,
hot tea, hot chocolate

SALAD

GARDEN SALAD \$7.50

CAESAR SALAD \$7.50

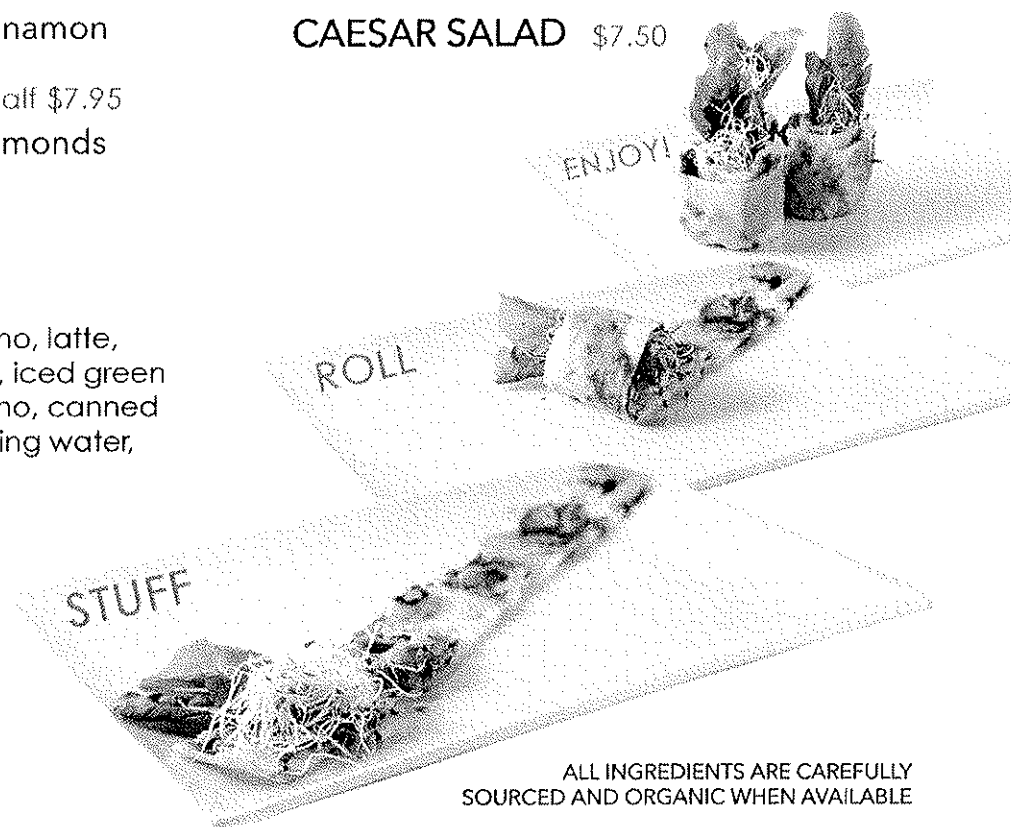

(646) 637-8674
pizarollio.com
f /pizarollio
@pizarollio

ALL INGREDIENTS ARE CAREFULLY
SOURCED AND ORGANIC WHEN AVAILABLE

ADDITIONAL STIPULATIONS: (Office Use Only), *Continued*

To the extent any additional stipulation on pages 7 and 8 of this application conflicts with any response on pages 1 – 6 of this application, the stipulations on pages 7 and 8 control.

ADDITIONAL STIPULATIONS: (Office Use Only)

THIS APPLICATION DOES
EXTEND TO ANY
S. JOURNAL CASES

To the extent any additional stipulation on pages 7 and 8 of this application conflicts with any response on pages 1 - 6 of this application, the stipulations on pages 7 and 8 control.