

Manhattan Community Board 4
(All Fields Must Be Completed)

Liquor License/Sidewalk Cafe Stipulations Application

| | | | |
|---|--|--------------------------------------|---|
| CORPORATION NAME | | DOING BUSINESS AS (DBA) | |
| An Entity to be formed by Louis Fugazy | | Flight 151 | |
| STREET ADDRESS | | CROSS STREETS | ZIP CODE |
| 151 8th Avenue | | W 17th and 18th Streets | 10011 |
| OWNER <i>(Attach a list of all the people that will be associated/listed with the license)</i> | NAME: | Louis Fugazy | NAME: Robert S Bookman - Pesetsky and Bookman |
| | PHONE: | 516-650-2961 | PHONE: 212-513-1988 |
| | EMAIL: | l.fugazy@gmail.com | EMAIL: rbookman@pandblegal.com |
| MANAGER | NAME: | Magdalena Kotzeva | NAME: Roy Savelli |
| | PHONE: | 347-833-9897 | PHONE: 212-229-1868 |
| | EMAIL: | maggie@reservoirbar.com | EMAIL: |
| ATTORNEY/ REPRESENTATIVE | | | |
| LANDLORD | | | |
| APPLICATION TYPE <i>(Check One)</i> | | | |
| <input checked="" type="checkbox"/> New | Has applicant owned or managed a similar business? | <input checked="" type="radio"/> YES | <input type="radio"/> NO |
| | What is/was the name and address of establishment? | Reservoir - 70 University Place | |
| | What were the dates applicant was involved with this former premise? | 11/2014 - Present | |
| <input type="checkbox"/> Corp Change/Class Change/Removal | What is the license # and expiration date? | | |
| | Is applicant making any alterations or operational changes? | <input type="radio"/> YES | <input type="radio"/> NO |
| | <i>If alterations or operational changes are being made, please describe/list all changes.</i> | | |
| <input type="checkbox"/> Alteration | What is the current license # and expiration date? | | |
| | <i>Please list/describe the nature of all the changes and attach the plans:</i> | | |
| METHOD OF OPERATION | | | |
| TYPE OF ALCOHOL | <input checked="" type="checkbox"/> Liquor/Wine/Beer & Cider <input type="checkbox"/> Beer & Cider <input type="checkbox"/> Wine/Beer & Cider | | |
| ESTABLISHMENT TYPE | <input checked="" type="checkbox"/> Restaurant <input type="checkbox"/> Cabaret <input type="checkbox"/> Night Club <input type="checkbox"/> Hotel <input type="checkbox"/> Bar/Tavern <input type="checkbox"/> Catering Establishment <input type="checkbox"/> Adult Entertainment <input type="checkbox"/> Wine Bar <input type="checkbox"/> Dance Club <input type="checkbox"/> Sports Bar <input type="checkbox"/> Club (Fraternal Organization – Members Only) | | |
| Has applicant/owner filed with the SLA? If yes, when? If no, when do you plan to file? | YES | <input checked="" type="radio"/> NO | |
| Is the 500 Foot Rule applicable? If yes, please attach a diagram of the On-Premise liquor license establishments within a 500 ft. radius of your establishment and the Public Interest Statement. | <input checked="" type="radio"/> YES | <input type="radio"/> NO | |
| Is the 200 Foot Rule applicable? If yes, please attach a diagram of the schools and houses of worship that trigger the rule. | YES | <input checked="" type="radio"/> NO | |
| Has applicant/owner(s) read MCB4 Policy Regarding Concentration and Location of Alcoholic-Serving Establishments? | <input checked="" type="radio"/> YES | <input type="radio"/> NO | |

| OPERATIONAL DETAILS (*Closing time will be when establishment is vacated of all patrons) | | | | | | | | | |
|--|--|--|------------------|-----------------|--------------------------------------|-------------------------------------|---------------------------------|------------|--|
| HOURS* <i>(Indoor Only)</i> | | MONDAY | TUESDAY | WEDNESDAY | THURSDAY | FRIDAY | SATURDAY | SUNDAY | |
| | Operation | 11:30a-4am | 11:30a-4a | 11:30a-4am | 11:30a-4am | 11:30a-4am | 11:30a-4am | 11:30a-4am | |
| | Kitchen | SAA | SAA | SAA | SAA | SAA | SAA | SAA | |
| | Music | SAA | SAA | SAA | SAA | SAA | SAA | SAA | |
| If you plan to have music, what type(s)? (Circle all that apply) | | BACKGROUND | | LIVE MUSIC | DJ | JUKE BOX | KARAOKE | | |
| OCCUPANCY | | | | | | | | | |
| | Capacity (Certificate of Occupancy) | Maximum # of Persons You Anticipate Occupying Premises (Including Employees) | Number of Tables | Number of Seats | Number of Service Only Bars | Number of Stand-Up Bars | Number of Seats at Stand-Up Bar | | |
| INSIDE | 74 | 74 | 15 | 60 | 0 | 1 | 8 | | |
| OUTSIDE <i>(Other than sidewalk café)</i> | 0 | 0 | 0 | 0 | 0 | 0 | 0 | | |
| SIDEWALK CAFÉ | 0 | 0 | 0 | 0 | | | | | |
| How many floors are there? What is the capacity for each floor? | | | | | 1st Floor and Basement | | | | |
| How frequently will the owner(s) be at the establishment? | | | | | Daily | | | | |
| Will you be applying or intending to apply for a cabaret license with DCA? If yes, will there be dancing? | | | | | YES | <input checked="" type="radio"/> NO | | | |
| Will applicant have bottle or table service for beverage alcohol? | | | | | YES | <input checked="" type="radio"/> NO | | | |
| Will you be hosting private; promotional or corporate events? | | | | | YES | <input checked="" type="radio"/> NO | | | |
| Will outside promoters be used on a regular basis? If yes please describe. | | | | | YES | <input checked="" type="radio"/> NO | | | |
| Will you have a security plan? If, yes please attach. | | | | | YES | <input checked="" type="radio"/> NO | | | |
| Will security plan be implemented? | | | | | YES | <input checked="" type="radio"/> NO | | | |
| Will State certified security personnel be used? | | | | | YES | <input checked="" type="radio"/> NO | | | |
| Will New York Nightlife Association and NYPD Best Practices be followed? | | | | | <input checked="" type="radio"/> YES | <input type="radio"/> NO | | | |
| Will applicant be using delivery bicycles? If yes, how many? | | | | | YES | <input checked="" type="radio"/> NO | | | |
| Will delivery bicycles be clearly marked with the name of the restaurant and will staff wear attire clearly noting name as described by NYC Law? | | | | | YES | <input type="radio"/> NO | NA | | |
| Where will delivery bicycles be stored during the day when not in use? | | | | | NA | | | | |

| LOCATION & ZONING | | |
|---|--------------------------------------|-------------------------------------|
| Is this a Special District? If yes, is it Clinton, West Chelsea or Hudson Yards? | YES | <input checked="" type="radio"/> NO |
| Does the building have a Certificate of Occupancy ("C of O") or a letter of no objection? | <input checked="" type="radio"/> YES | NO |
| Is a Public Assembly permit required? | YES | <input checked="" type="radio"/> NO |
| Are your plans filed with DOB? | <input checked="" type="radio"/> YES | NO |

| Community Notification/Relations | | |
|--|--------------------------------------|---|
| NOTIFICATION: List all block associations; tenant associations, co-op boards or condo boards of residential buildings; and community groups that applicant has notified regarding its application. For each please list both the organization and individual you contacted | # 1 | A mass email will be sent to all the block association/ |
| | # 2 | organization contacts provided by the community board. |
| | # 3 | |
| | # 4 | |
| | # 5 | |
| Please provide dates when applicant met with the groups listed above. | NA | |
| Who was your contact person at each group you met with? | NA | |
| When did applicant post the notice that was provided? | 11/03/2017 | |
| Where did applicant post the notice that was provided? | Front of Premises | |
| Will applicant provide owner cell phone number to neighbors and respond to complaints that arise? Please provide number in space provided. | <input checked="" type="radio"/> YES | <input type="radio"/> NO 516-650-2961 |
| Will applicant inform the Community Board office of its job openings and/or provide a hyperlink to applicants jobs webpage? | <input checked="" type="radio"/> YES | <input type="radio"/> NO |

| BUILDING DESIGN | | | |
|---|---|-------------------------------------|--|
| State the name and type of business previously located in the space. | Flight 151 - Restaurant | | |
| Has a liquor-licensed establishment previously occupied this space at any time? If yes, please provide the name of the business. | <input checked="" type="radio"/> YES | <input type="radio"/> NO | Flight 151 |
| Do you plan any changes to the existing façade? If yes, please describe. | YES | <input checked="" type="radio"/> NO | |
| Will applicant have a vestibule within the establishment? | YES | <input checked="" type="radio"/> NO | |
| Will applicant use a storm enclosure? | YES | <input checked="" type="radio"/> NO | |
| Will applicant not place any items or obstructions on the sidewalk, for example, sandwich boards, sidewalk signs, freestanding menus and plants, as per the law? | YES | <input checked="" type="radio"/> NO | |
| Will applicant comply with the NYC noise code? | <input checked="" type="radio"/> YES | <input type="radio"/> NO | |
| Will the establishment have any of the following: (circle all that apply) | <input checked="" type="radio"/> FRENCH DOORS | <input type="radio"/> GARAGE DOORS | <input type="radio"/> WINDOWS THAT CAN BE OPENED |
| Will applicant close all windows, French doors, garage doors when any music or amplified sound (including televisions) is played inside the establishment? | <input checked="" type="radio"/> YES | <input type="radio"/> NO | |
| Will applicant close all windows, French doors, garage doors by 11 PM Friday and Saturday and 10 PM on all other days even if no music or amplified sound is played inside the establishment? | <input checked="" type="radio"/> YES | <input type="radio"/> NO | |
| Has applicant obtained an acoustical report from a certified sound engineer to assess potential noise disturbance to the neighboring residents and buildings? | YES | <input checked="" type="radio"/> NO | |
| Will applicant follow the recommendations of a certified sound engineer to mitigate potential noise disturbance to the neighboring residents and buildings, including placing speakers on the floor of the establishment? | <input checked="" type="radio"/> YES | <input type="radio"/> NO | |
| Will the kitchen exhaust system extend to the roof? | <input checked="" type="radio"/> YES | <input type="radio"/> NO | |
| Will the establishment have an illuminated sign? | YES | <input checked="" type="radio"/> NO | |
| Will the establishment have a canopy extending over the sidewalk? | YES | <input checked="" type="radio"/> NO | |
| Where will the air conditioner be located? What type is it? | | | |
| When was the air conditioner installed? | | | |

| OUTDOOR ITEMS - OTHER THEN SIDEWALK CAFÉ | Not Applicable | | |
|--|----------------|----|--|
| Has the applicant/owner(s) read MCB 4 Rear Yard Rooftop Policy? | YES | NO | |
| Will applicant use any outdoor spaces: rooftop, rear yard, patio, porch, balcony, pavilion, tents, deck or gazebo? If yes, which one(s)? | YES | NO | |
| Are the floorplans for the outdoor space(s) included? | YES | NO | |
| Will applicant close and vacate the outdoor space(s) by 11PM on Friday & Saturday and 10 PM on all other days? | YES | NO | |
| Will the service and consumption of alcohol in any outdoor space only be via seated food service? | YES | NO | |
| Will applicant not allow standing space for patrons to drink or smoke in any outdoor space(s)? | YES | NO | |
| Will there be no amplified music, as per the law? | YES | NO | |
| If amplified sound is played inside the establishment, will windows and doors be closed? | YES | NO | |
| Will applicant agree to post signs outside asking customers to respect the neighbors'? | YES | NO | |
| Will applicant agree to train staff to encourage a peaceful environment? | YES | NO | |
| Will applicant provide effective sound control (landscaping enclosure, soundproofing tenants apartments) | YES | NO | |
| Will there be a lighting plan that allows safe usage of the outdoor space without disrupting neighbors? | YES | NO | |

| OUTDOOR ITEMS – SIDEWALK CAFÉ Not Applicable | | | |
|--|-----|----|--|
| Has the applicant/owner(s) read MCB4 Sidewalk Café Policy? | YES | NO | |
| Will applicant be applying for a sidewalk café now or in the future? | YES | NO | |
| Is applicant in this application seeking to include a sidewalk café in its liquor license? | YES | NO | |
| If yes, has applicant submitted an application and plans to NYC Dept. of Consumer Affairs? Please attach application and plans. | YES | NO | |
| Will applicant close and vacate the sidewalk café by 11 PM on Friday & Saturday and 10 PM on all other days? | YES | NO | |
| Will applicant be serving alcohol in the sidewalk café? If so, will you have waiter service? | YES | NO | |
| Will the café have a 3 ft. wide serving aisle running the entire length of the sidewalk café? | YES | NO | |
| Will applicant mark the perimeter of the café on the sidewalk? | YES | NO | |
| Will the service and consumption of alcohol in the sidewalk café only be via seated food service? | YES | NO | |
| Will the sidewalk café not provide standing space for drinking or smoking? | YES | NO | |
| Will applicant use any portable natural gas heaters? If so, do you have the requisite approvals from DOB & the Fire Department? | YES | NO | |
| Will applicant have a lighting plan that will allow safe usage of the outdoor space without disrupting neighbors? | YES | NO | |
| Will all furniture, plants and barricades be stored inside between the evening closing hours and the morning opening hours? | YES | NO | |
| Will all furniture be stored inside between December 21 st and March 21 st , and any other day when it rains or snows? | YES | NO | |
| Will applicant use umbrellas? | YES | NO | |
| If construction or construction protection has reduced the sidewalk width, will applicant always maintain an 8 foot clear path of sidewalk between the perimeter of the café and the closes obstruction including construction barricades? | YES | NO | |

ADDITIONAL STIPULATIONS: (Office Use Only)

To the extent any additional stipulation on pages 7 and 8 of this application conflicts with any response on pages 1 – 6 of this application, the stipulations on pages 7 and 8 control.

To the extent any additional stipulation on pages 7 and 8 of this application conflicts with any response on pages 1 – 6 of this application, the stipulations on pages 7 and 8 control.

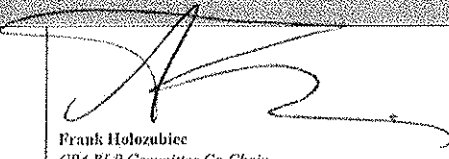
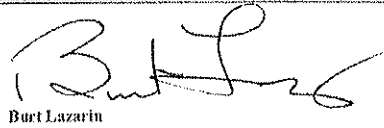
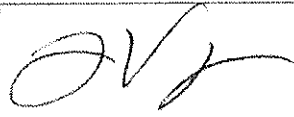
| | | | |
|---|--|---|--------------------|
| Manhattan Community Board 4 (MCB4) recommends: <i>MCB4's recommendation is based on a vote taken at its 12/6/17 full board meeting, with 45 members voting in favor of the recommendation, 0 members opposed, 0 members abstaining and 0 present but not eligible)</i> | | <input checked="" type="radio"/> Denial unless all stipulations agreed to by applicant/owner are part of the method of operation <input type="radio"/> Denial <input type="radio"/> Approval | |
| CB4 REPRESENTATIVES | | | |
|  Nelly Gonzalez <i>CB4 Assistant District Manager</i> |  Frank Holozubiec <i>CB4 BLP Committee Co-Chair</i> |  Burt Lazarin <i>CB4 BLP Committee Co-Chair</i> | |
| APPLICANT AGREEMENT WITH THE COMMUNITY | | | |
| Applicant agrees to these stipulations as the basis for the community support of this application and acknowledges that all of these stipulations are essential prerequisites to the MCB4 recommendation regarding this application. Applicant agrees to have these stipulations incorporated in the method of operation of its liquor license. The stipulations in this application constitute the entire agreement between MCB4 and applicant and may only be altered in writing signed by MCB4 and applicant. These stipulations supersede any oral statements or representations in connection with this application. | | | |
| SIGN HERE → | Louis Fugazy PRINT NAME OF APPLICANT |  SIGNATURE OF APPLICANT | 11/03/2017 DATE |

¹ Any Manhattan Community Board 4 (MCB4) recommendation on an application for a liquor license, whether for or against, should not be construed as an endorsement of, or precedent for, any group use that is not consistent with Board's preferred zoning. For example, 1). MCB4 supports R8, R8A and R9 zoning, and the underlining group uses associated with those zones, in the area bounded by Eleventh and Twelfth Avenues, and West 43rd and West 55th Streets. 2). MCB4 supports a text amendment to the Special Clinton District, Preservation Area, that limits group use for any vacant ground floor to Use Group 6.

Proximity Report for Location:

November 3, 2017

151 8th Ave, New York, NY, 10011

* This report is for informational purposes only in aid of identifying establishments potentially subject to 500 and 200 foot rules. Distances are approximated using industry standard GIS techniques and do not reflect actual distances between points of entry. The NYS Liquor Authority makes no representation as to the accuracy of the information and disclaims any liability for errors.

Closest Liquor Stores

| Name | Address | Approx. Distance |
|----------------------------|--------------------|------------------|
| HOME OF CHEERS CORP | 188 90 8TH AVE | 775 ft |
| CHELSEA WINE COUNTRY INC | 86 7TH AVENUE | 1045 ft |
| FORAGERS WINES CHELSEA LLC | 231 8TH AVE | 1050 ft |
| MAHADEV INC | 242 W 14TH ST | 1055 ft |
| CHELSEA WINERY LTD | 75 9TH AVENUE | 1070 ft |
| MIDTOWN SPIRITS INC | 177 9TH AVE UNIT C | 1160 ft |
| MFR RETAILING LLC | 249 W 13TH ST | 1200 ft |

Churches within 500 Feet

| Name | Approx. Distance |
|------|------------------|
|------|------------------|

Schools within 500 Feet

| Name | Address | Approx. Distance |
|--------------------------------|---------------|------------------|
| NYC MUSEUM SCHOOL | 333 W 17TH ST | 310 ft |
| NYC LAB SCHOOL FOR COLLABORATI | 333 W 17TH ST | 310 ft |
| IS 70 O. HENRY SCHOOL | 333 W 17TH ST | 310 ft |
| HUMANITIES PREP SCHOOL | 351 W 18TH ST | 375 ft |
| HS - HUMANITIES | 351 W 18TH ST | 375 ft |
| LIBERTY HS | 250 W 18TH ST | 395 ft |

On-Premise Licenses within 750 Feet

| Name | Address | Approx. Distance |
|--|-------------------|------------------|
| 151 ROYS REST INC | 151 8TH AVENUE | 0 ft |
| CHIPOTLE MEXICAN GRILL OF COLORADO LLC | 149 8TH AVE | 30 ft |
| SILOM THAI INC | 150 8TH AVE | 50 ft |
| MAGNUMS IN PARIS LLC | 158 8TH AVE | 90 ft |
| MEXICUE 160 8TH AVENUE LLC | 160 8TH AVE | 105 ft |
| 161 8TH AVE RESTAURANT LLC | 161 8TH AVE | 170 ft |
| RTC 18 CORP | 166 8TH AVE | 195 ft |
| TEAM MWB LLC | 167 8TH AVENUE | 230 ft |
| 169 EIGHT RESTAURANT CORP | 169 8TH AVE | 265 ft |
| EL CID RESTAURANT INC | 174 8TH AVE | 330 ft |
| HARU CHELSEA CORP | 176 8TH AVE | 335 ft |
| GUCKENHEIMER SERVICES LLC | 245 249 W 17TH ST | 340 ft |

| Name | Address | Approx. Distance |
|---|-------------------------------|------------------|
| BUCKWHEAT & ALFALFA INC | 182 8TH AVENUE | 425 ft |
| TAVERN ON 8TH AVENUE CORP & BUNS 19TH STREET CORP | 184 8TH AVE | 470 ft |
| THANA CORP | 114 8TH AVE | 475 ft |
| RESTAURANT ASSOCIATES LLC | 111 8TH AVE | 500 ft |
| RESTAURANT ASSOCIATES LLC | 111 8TH AVE | 500 ft |
| RESTAURANT ASSOCIATES LLC | 111 8TH AVE | 500 ft |
| RESTAURANT ASSOCIATES LLC | 111 8TH AVE | 500 ft |
| MEJO LLC | 259 W 19TH ST | 540 ft |
| TUTTO BENE RESTAURANT INC | 108 8TH AVENUE | 550 ft |
| 346 LOUNGE LLC & STRATEGIC DREAM ROOFTOP LLC | 355 W 16TH STREET | 580 ft |
| SAHARA DREAMS LLC, AVE REST LLC & STRATEGIC DREAM | 355 W 16TH STREET | 580 ft |
| ELECTRIC ROOM 16 LLC STRATEGIC DREAM LOUNGE LLC | 355 W 16TH ST | 595 ft |
| EISEN & SON INC | 196 8TH AVE AKA 258 W 20TH ST | 605 ft |
| CAFE RETAMAR INC | 245 W 16TH STREET | 620 ft |
| BE TEMERARIO GROUP LLC | 198 8TH AVE | 655 ft |
| DISH RESTAURANT CORP | 201 8TH AVENUE | 675 ft |
| B & R SORRENTO CORP | 202 8TH AVE | 675 ft |
| SWEET CONCESSIONS INC | 336 W 20TH ST | 690 ft |
| SHARABI INC | 258 W 15TH STREET | 690 ft |
| BD STANHOPE LLC AND E&S HOTEL OWNERS INC AS MGR | 369 W 16TH ST | 690 ft |

Pending Licenses within 750 Feet

| Name | Address | Approx. Distance |
|--------------------------------|-------------------|------------------|
| PAZZO ROLLIO CORP | 261 W 18TH ST | 200 ft |
| EIGHTH AVENUE GOURMET DELI INC | 134 8TH AVE | 235 ft |
| LAS RAMBLAS RESTAURANT LLC | 355 W 16TH STREET | 580 ft |
| EXCEL RESTAURANT GROUP CORP | 200 8TH AVE | 680 ft |
| KUNI'S CORPORATION | 96 8TH AVE | 715 ft |

Unmapped licenses within zipcode of report location

| Name | Address |
|------|---------|
|------|---------|

FLIGHT 151 & CELLAR FLOOR PLANS

$\frac{3}{16}'' = 1'0''$

Cellar

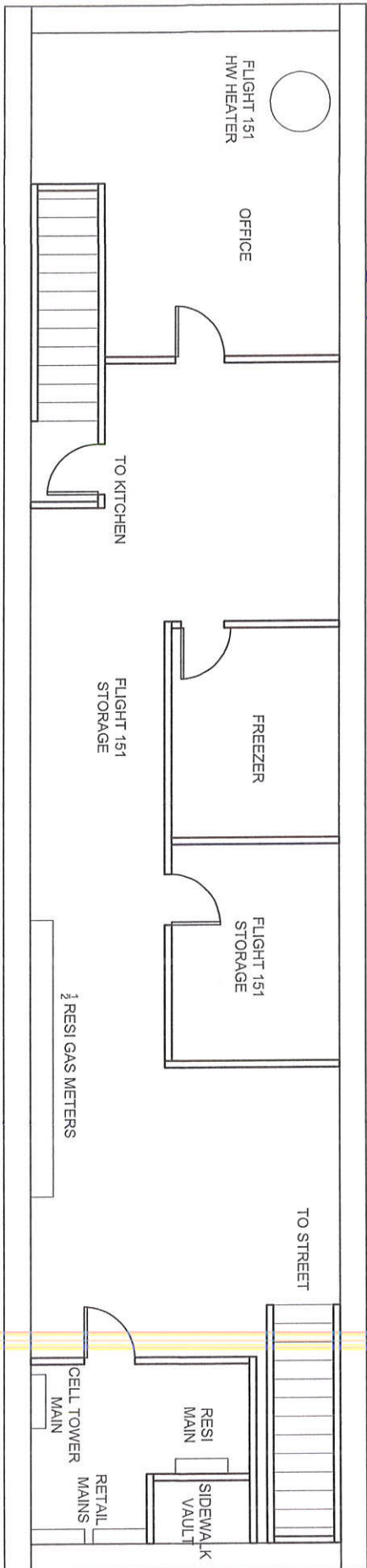

8TH AVE

1st Floor

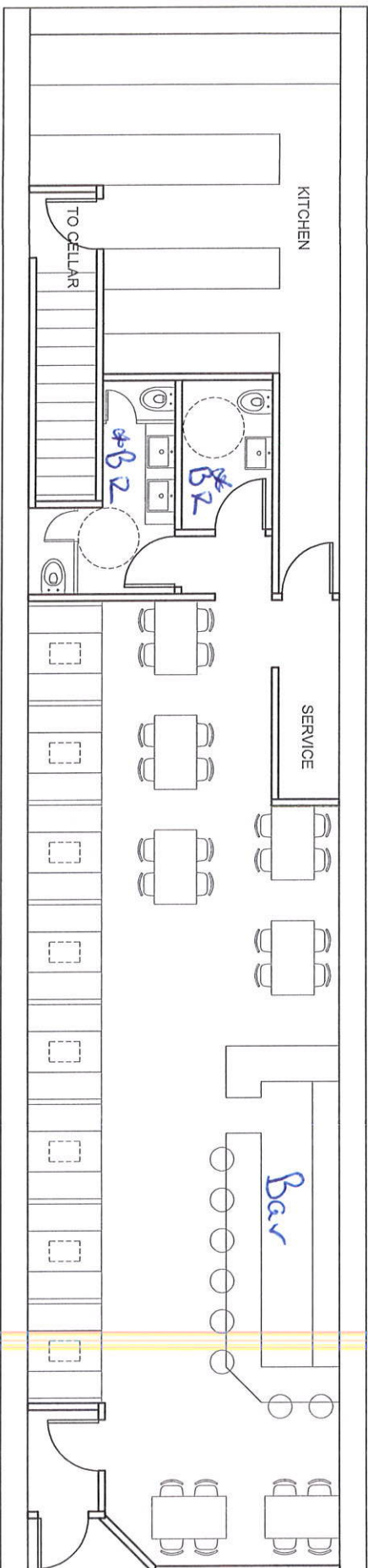

8TH AVE

** B2 = Bathroom*

Flight 151

Main Menu

APPETIZER

| | | | |
|---|---------------|---|---------------|
| Soup Du Jour | \$2.95 | California Chili | \$4.95 |
| <hr/> | | | |
| Chips & Salsa | \$2.95 | Buffalo Chicken Wings | \$6.95 |
| <hr/> | | | |
| Buffalo Chicken Fingers | \$6.95 | Chicken Fingers | \$5.95 |
| <hr/> | | | |
| Sesame Chicken Fingers | \$6.95 | Homemade Mozzarella Sticks | \$5.95 |
| <hr/> | | | |
| Nachos | \$6.95 | Assorted Appetizer Platter | \$6.95 |
| <hr/> | | | |
| Blackened Chicken Fingers | \$6.95 | Cajun Crab Cakes | \$6.95 |
| on a garlic crouton topped with salsa | | with a spicy creole sauce | |
| <hr/> | | | |
| Potato Skins | \$6.95 | Disco Fries | \$3.95 |
| with cheese & choice of chili, bacon or broccoli | | | |
| <hr/> | | | |
| | | Greenpoint Pierogies: | \$7.95 |
| | | choice of meat, cheese, mushroom, potato or comb | |
| <hr/> | | | |

SALADS

Choice Of Homemade Dressing: Bleu Cheese, Russian, Thousand Island, Honey Mustard, Spicy Ranch, Vinaigrette, Or Oil & Vinegar

| | | | |
|----------------------------|--------|-----------------------------------|--------|
| House Salad | \$3.95 | Caesar Salad | \$5.95 |
| <hr/> | | | |
| Warm Grilled Chicken Salad | \$8.95 | Warm Grilled Chicken Caesar Salad | \$8.95 |

PICK YOUR PASTA

All Pastas Served With House Salad Choose From Fettucine, Linguine Or Penne, Add Chicken To Any Pasta \$3.00

| | | | |
|---|--------|---------------------------|--------|
| Rich Alfredo Parmesan | \$8.95 | Hearty Carbonara | \$9.95 |
| <hr/> | | | |
| Creamy Vodka Sauce | \$9.95 | Traditional Marinara | \$8.95 |
| <hr/> | | | |
| Sundried Tomatoes, Mushrooms, Garlic & Olive Oil | \$8.95 | Beef Bolognese | \$9.95 |
| <hr/> | | | |
| | | Smoked Salmon Cream Sauce | \$9.95 |

SANDWICHES, WRAPS, ETC:

All Sandwiches Served With Curly Q's, Mashed Potato, Baked Potato Or Steak Fries

Burger \$6.95

(our marinated chopped beef)

Vegetarian Garden Burger \$6.95

add a topping: bacon, chili, american, swiss, cheddar, bleu or mozzarella \$1.00

Cajun Chicken Sandwich \$7.95

Tuna Club Or Melt \$6.95

Captain Roy's Sliced Steak Sandwich \$12.95

sliced ny sirloin with grilled onion on toasted garlic bread

Chicken Caesar Wrap \$8.95

Smoked Salmon Wrap \$8.95

with lettuce, cucumber, tomato and vinaigrette

Quarter Pound All Beef Hot Dog \$5.95

Turkey Burger \$6.95

Marinated Chicken Breast Sandwich \$6.95

with bacon & swiss cheese

Buffalo Chicken Sandwich \$7.95

Crab Caked Sandwich \$7.95

Grilled Vegetable Sandwich \$7.95

fresh grilled eggplant with onions, roasted red peppers & mozzarella served on french bread

Cajun Chicken Wrap \$8.95

with crispy onions & salsa

Beer Battered Fish & Chips \$9.95

ENTREES

All Entrees Served With, House Salad, Vegetable, And Your Choice Of Baked Potato, Mashed Potatoes, Steak Fries Or Curly Q's

Ny Sirloin Steak Grilled To Perfection \$14.95

Homemade Meatloaf \$9.95

Bar-b-q Half Roasted Chicken \$10.95

Bar-b-q Baby Back Ribs \$13.95

Sauteed Chicken Breast Your Way \$10.95

Broiled Half Roasted Chicken \$10.95

rich marsala sauce with mushrooms, lemon & white wine francese, creamy dijon sauce, sundried tomatoes, mushrooms & peppers in a white wine sauce

SIDES

| | | | |
|------------------------------|--------|---------------------------------|--------|
| Basket Of Curly Q's | \$2.95 | Homemade Steak Fries | \$2.25 |
| <hr/> | | | |
| Baked Potato With Sour Cream | \$2.95 | Vegetable Du Jour | \$2.95 |
| <hr/> | | | |
| Mashed Potatoes & Gravy | \$2.95 | Cheese Curly Q's Or Steak Fries | \$3.95 |
| <hr/> | | | |
| Garlic Bread | \$1.95 | Beer Battered Onion Rings | \$3.95 |
| <hr/> | | | |

DESSERTS

| | | | |
|--|--------|---|--------|
| Award Winning Brownie Sundae Walnut Brownie | \$4.95 | Homemade Apple Pie With Whipped Cream | \$2.95 |
| <hr/> | | <hr/> | |
| with vanilla ice cream, whipped cream, & your choice of chocolate or strawberry sauce | | Homemade Apple Pie A La Mode | \$3.95 |
| <hr/> | | <hr/> | |
| Homemade N.y. Style Cheese Cake | \$4.95 | Ice Cream Sundae Vanilla Ice Cream | \$3.95 |
| <hr/> | | <hr/> | |
| | | topped with chocolate or strawberry sauce | |
| | | <hr/> | |

