

# Manhattan Community Board 4

(All Fields Must Be Completed)

## Liquor License Stipulations Application

<b>CORPORATION NAME</b>		<b>DOING BUSINESS AS (DBA)</b>	
PGNV LLC		Empanada Mama	
<b>STREET ADDRESS</b>		<b>CROSS STREETS</b>	<b>ZIP CODE</b>
765 9th Avenue		Between W 51st & W 52nd	10019
<b>OWNER</b> <i>(Attach a list of all the people that will be associated/listed with the license)</i>	<b>NAME:</b>	Socrates Nanas	<b>ATTORNEY/ REPRESENTAIVE</b>
	<b>PHONE:</b>	917-686-8592	
	<b>EMAIL:</b>	pgrnv@gmail.co,	
<b>MANAGER</b>	<b>NAME:</b>	Tentomas	<b>LANDLORD</b>
	<b>PHONE:</b>	718-877-4901	
	<b>EMAIL:</b>	ntent11@yahoo.com	
		<b>NAME:</b>	Joseph Levey
		<b>PHONE:</b>	212-219-1193
		<b>EMAIL:</b>	Patty@helbraunlevey.com
		<b>NAME:</b>	765 9th Ave Corp
		<b>PHONE:</b>	
		<b>EMAIL:</b>	
<b>APPLICATION TYPE (Check One)</b>			
<input type="radio"/> <b>New</b>	Has applicant owned or managed a similar business?		<input checked="" type="radio"/> YES <input type="radio"/> NO
	What is/was the name and address of establishment?		Empanada Mama - 763 9th Ave & 95 Allen St
	What were the dates applicant was involved with this former premise?		Since ~March, 2005 & May 2014
<input checked="" type="radio"/> <b>Transfer</b>	What is the prior license # and expiration date?		1225174, exp. 10/31/2017
	Is applicant making any alterations or operational changes?		<input checked="" type="radio"/> YES <input type="radio"/> NO
	If alterations or operational changes are being made, please describe/list all changes. painting, fixing the floor in the kitchen		
<input type="radio"/> <b>Alteration</b>	What is the current license # and expiration date?		
	Please list/describe the nature of all the changes and attach the plans:		
<b>METHOD OF OPERATION</b>			
<b>TYPE OF ALCOHOL</b>	<input checked="" type="radio"/> Liquor/Wine/Beer <input type="radio"/> Beer <input type="radio"/> Wine & Beer		
<b>ESTABLISHMENT TYPE</b>	<input checked="" type="radio"/> Restaurant <input type="radio"/> Cabaret <input type="radio"/> Night Club <input type="radio"/> Hotel <input type="radio"/> Bar/Tavern <input type="radio"/> Catering Establishment <input type="radio"/> Adult Entertainment <input type="radio"/> Wine Bar <input type="radio"/> Dance Club <input type="radio"/> Sports Bar <input type="radio"/> Club (Fraternal Organization - Members Only)		
Has applicant/owner filed with the SLA? If yes, when? If no, when do you plan to file?		<b>YES</b>	<input checked="" type="radio"/> YES <input type="radio"/> NO
Is the 500 Foot Rule applicable? If yes, please attach a diagram of the On-Premise liquor license establishments within a 500 ft. radius of your establishment and the Public Interest Statement.		<input checked="" type="radio"/> YES <input type="radio"/> NO	Attached in email
Is the 200 Foot Rule applicable? If yes, please attach a diagram of the schools and houses of worship that trigger the rule.		<input type="radio"/> YES <input checked="" type="radio"/> NO	N/A
Has applicant/owner(s) read MCB4 Policy Regarding Concentration and Location of Alcoholic-Serving Establishments?		<input checked="" type="radio"/> YES <input type="radio"/> NO	

SEE ADDITIONAL STIPULATIONS  
FOR HOURLY OF ALCOHOL SERVICE

OPERATIONAL DETAILS (*Closing time will be when establishment is vacated of all patrons)									
HOURS* (Indoor Only)		MONDAY	TUESDAY	WEDNESDAY	THURSDAY	FRIDAY	SATURDAY	SUNDAY	
	Operation	RESTAURANT WILL BE OPEN 24 HOURS (WILL STOP SERVING BY 4AM)							
	Kitchen	ALL HOURS OF OPERATION ----->							
	Music	BACKGROUND ONLY, ALL HOURS OF OPERATION ----->							
If you plan to have music, what type(s)? (Circle all that apply)			<input checked="" type="checkbox"/> BACKGROUND	<input type="checkbox"/> LIVE MUSIC	<input type="checkbox"/> DJ	<input type="checkbox"/> JUKE BOX	<input type="checkbox"/> KARAOKE		
OCCUPANCY									
	Capacity (Certificate of Occupancy)	Maximum # of Persons You Anticipate Occupying Premises (Including Employees)	Number of Tables	Number of Seats	Number of Service Only Bars	Number of Stand-Up Bars	Number of Seats at Stand-Up Bar		
INSIDE	105	<105	25	50	0	1	14		
OUTSIDE (Other than sidewalk café)	N/A	N/A	N/A	N/A	N/A	N/A	N/A		
SIDEWALK CAFE	N/A	N/A	N/A	N/A	N/A				
How many floors are there? What is the capacity for each floor?					2				
How frequently will the owner(s) be at the establishment?					7 days per week				
Will you be applying or intending to apply for a cabaret license with DCA? If yes, will there be dancing?					YES	<input checked="" type="radio"/>			
Will applicant have bottle or table service for beverage alcohol?					YES	<input checked="" type="radio"/>			
Will you be hosting private; promotional or corporate events?					YES	<input checked="" type="radio"/>			
Will outside promoters be used on a regular basis? If yes please describe.					YES	<input checked="" type="radio"/>			
Will you have a security plan? if, yes please attach.					<input checked="" type="radio"/> YES	<input type="radio"/> NO			
Will security plan be implemented?					<input checked="" type="radio"/> YES	<input type="radio"/> NO			
Will State certified security personnel be used?					YES	<input checked="" type="radio"/>			
Will New York Nightlife Association and NYPD Best Practices be followed?					<input checked="" type="radio"/> YES	<input type="radio"/> NO			
Will applicant be using delivery bicycles? If yes, how many?					<input checked="" type="radio"/> YES	<input type="radio"/> NO	~3		
Will delivery bicycles be clearly marked with the name of the restaurant and will staff wear attire clearly noting name as described by NYC Law?					<input checked="" type="radio"/> YES	<input type="radio"/> NO			
Where will delivery bicycles be stored during the day when not in use?					cellar				

LOCATION & ZONING			
Is this a Special District? If yes, is it Clinton, West Chelsea or Hudson Yards?	YES	<input checked="" type="radio"/>	
Does the building have a Certificate of Occupancy ("C of O") or a letter of no objection?		<input checked="" type="radio"/>	NO
Is a Public Assembly permit required?	YES	<input checked="" type="radio"/>	
Are your plans filed with DOB?	YES	<input checked="" type="radio"/>	N/A

Community Notification/Relations			
<b>NOTIFICATION:</b> List all block associations; tenant associations, co-op boards or condo boards of residential buildings; and community groups that applicant has notified regarding its application. For each please list both the organization and individual you contacted	# 1	Applicant notified all surrounding residential tenants	
	# 2	All block associations per MCB4 were notified, please see the attached	
	# 3	list in a separate email	
	# 4		
	# 5		
Please provide dates when applicant met with the groups listed above.		Pending	
Who was your contact person at each group you met with?		Pending	
When did applicant post the notice that was provided?		June 27th	
Where did applicant post the notice that was provided?		Posted on front of establishment, and handed out to neighbors	
Will applicant provide owner cell phone number to neighbors and respond to complaints that arise? Please provide number in space provided.		<input checked="" type="radio"/>	NO 917-686-8592
Will applicant inform the Community Board office of its job openings and/or provide a hyperlink to applicants jobs webpage?		<input checked="" type="radio"/>	NO

<b>BUILDING DESIGN</b>			
State the name and type of business previously located in the space.	The Cannery - Restaurant		
Has a liquor-licensed establishment previously occupied this space at any time? If yes, please provide the name of the business.	<input checked="" type="radio"/> YES	<input type="radio"/> NO	
Do you plan any changes to the existing façade? If yes, please describe.	YES	<input checked="" type="radio"/> YES	
Will applicant have a vestibule within the establishment?	<input checked="" type="radio"/> YES	<input type="radio"/> NO	existing vestibule
Will applicant use a storm enclosure?	YES	<input checked="" type="radio"/> YES	
Will applicant not place any items or obstructions on the sidewalk, for example, sandwich boards, sidewalk signs, freestanding menus and plants, as per the law?	<input checked="" type="radio"/> YES	<input type="radio"/> NO	
Will applicant comply with the NYC noise code?	<input checked="" type="radio"/> YES	<input type="radio"/> NO	
Will the establishment have any of the following: (circle all that apply)	FRENCH DOORS	<input checked="" type="checkbox"/> GARAGE DOORS existing	WINDOWS THAT CAN BE OPENED
Will applicant close all windows, French doors, garage doors when any music or amplified sound (including televisions) is played inside the establishment?	<input checked="" type="radio"/> YES	<input type="radio"/> NO	
Will applicant close all windows, French doors, garage doors by 11 PM Friday and Saturday and 10 PM on all other days even if no music or amplified sound is played inside the establishment?	<input checked="" type="radio"/> YES	<input type="radio"/> NO	
Has applicant obtained an acoustical report from a certified sound engineer to assess potential noise disturbance to the neighboring residents and buildings?	YES	<input checked="" type="radio"/> YES	
Will applicant follow the recommendations of a certified sound engineer to mitigate potential noise disturbance to the neighboring residents and buildings, including placing speakers on the floor of the establishment?	<input checked="" type="radio"/> YES	<input type="radio"/> NO	sound proofing is already installed
Will the kitchen exhaust system extend to the roof?	<input checked="" type="radio"/> YES	<input type="radio"/> NO	
Will the establishment have an illuminated sign?	YES	<input type="radio"/> NO	unsure at this moment
Will the establishment have a canopy extending over the sidewalk?	<input checked="" type="radio"/> YES	<input type="radio"/> NO	existing
Where will the air conditioner be located? What type is it?	existing air conditioner, in same location		
When was the air conditioner installed?	by the previous owner		

<b>OUTDOOR ITEMS - OTHER THEN SIDEWALK CAFE</b>	<b>No Outdoor Space</b>		
Has the applicant/owner(s) read MCB 4 Rear Yard Rooftop Policy?	YES	<input checked="" type="radio"/>	
Will applicant use any outdoor spaces: rooftop, rear yard, patio, porch, balcony, pavilion, tents, deck or gazebo? If yes, which one(s)?	YES	<input type="radio"/>	N/A
Are the floorplans for the outdoor space(s) included?	YES	<input type="radio"/>	N/A
Will applicant close and vacate the outdoor space(s) by 11PM on Friday & Saturday and 10 PM on all other days?	YES	<input type="radio"/>	N/A
Will the service and consumption of alcohol in any outdoor space only be via seated food service?	YES	<input type="radio"/>	N/A
Will applicant not allow standing space for patrons to drink or smoke in any outdoor space(s)?	YES	<input type="radio"/>	N/A
Will there be no amplified music, as per the law?	YES	<input type="radio"/>	N/A
If amplified sound is played inside the establishment, will windows and doors be closed?	YES	<input type="radio"/>	N/A
Will applicant agree to post signs outside asking customers to respect the neighbors'?	YES	<input type="radio"/>	N/A
Will applicant agree to train staff to encourage a peaceful environment?	YES	<input type="radio"/>	N/A
Will applicant provide effective sound control (landscaping enclosure, soundproofing tenants apartments)	YES	<input type="radio"/>	N/A
Will there be a lighting plan that allows safe usage of the outdoor space without disrupting neighbors?	YES	<input type="radio"/>	N/A

<b>OUTDOOR ITEMS – SIDEWALK CAFÉ</b>			
Has the applicant/owner(s) read MCB4 Sidewalk Café Policy?	<input checked="" type="radio"/> YES	<input type="radio"/> NO	
Will applicant be applying for a sidewalk café now or in the future?	<input checked="" type="radio"/> YES	<input type="radio"/> NO	In the future
Is applicant in this application seeking to include a sidewalk café in its liquor license?	<input type="radio"/> YES	<input checked="" type="radio"/> NO	
If yes, has applicant submitted an application and plans to NYC Dept. of Consumer Affairs? Please attach application and plans.	<input type="radio"/> YES	<input checked="" type="radio"/> NO	N/A
Will applicant close and vacate the sidewalk café by 11 PM on Friday & Saturday and 10 PM on all other days?	<input checked="" type="radio"/> YES	<input type="radio"/> NO	
Will applicant be serving alcohol in the sidewalk café? If so, will you have waiter service?	<input checked="" type="radio"/> YES	<input type="radio"/> NO	
Will the café have a 3 ft. wide serving aisle running the entire length of the sidewalk café?	<input checked="" type="radio"/> YES	<input type="radio"/> NO	
Will applicant mark the perimeter of the café on the sidewalk?	<input checked="" type="radio"/> YES	<input type="radio"/> NO	
Will the service and consumption of alcohol in the sidewalk café only be via seated food service?	<input checked="" type="radio"/> YES	<input type="radio"/> NO	
Will the sidewalk café not provide standing space for drinking or smoking?	<input type="radio"/> YES	<input checked="" type="radio"/> NO	
Will applicant use any portable natural gas heaters? If so, do you have the requisite approvals from DOB & the Fire Department?	<input type="radio"/> YES	<input checked="" type="radio"/> NO	
Will applicant have a lighting plan that will allow safe usage of the outdoor space without disrupting neighbors?	<input checked="" type="radio"/> YES	<input type="radio"/> NO	
Will all furniture, plants and barricades be stored inside between the evening closing hours and the morning opening hours?	<input checked="" type="radio"/> YES	<input type="radio"/> NO	
Will all furniture be stored inside between December 21 <sup>st</sup> and March 21 <sup>st</sup> , and any other day when it rains or snows?	<input checked="" type="radio"/> YES	<input type="radio"/> NO	
Will applicant use umbrellas?	<input type="radio"/> YES	<input type="radio"/> NO	Not sure at this point
If construction or construction protection has reduced the sidewalk width, will applicant always maintain an 8 foot clear path of sidewalk between the perimeter of the café and the closes obstruction including construction barricades?	<input checked="" type="radio"/> YES	<input type="radio"/> NO	

**ADDITIONAL STIPULATIONS: (Office Use Only)**

- Will add three tables to bar area and will submit revised floor plan by 7/22
- Applicant will apply for a bike corral near NW corner of 51st and Ninth Ave, on 51st St.
- Licensed NYS Security Personnel will be on site Thursday, Friday and Saturday from 10p.m. to 6a.m. the following morning to monitor sidewalk and dispersal of patrons
- All alcohol services will cease by 2:00a.m. Sunday - Wednesday and 4:00a.m. Thursday - Saturday
- Tables: 25 with 59 seats

***To the extent any additional stipulation on pages 7 and 8 of this application conflicts with any response on pages 1 – 6 of this application, the stipulations on pages 7 and 8 control.***

**ADDITIONAL STIPULATIONS: (Office Use Only), *Continued***

*To the extent any additional stipulation on pages 7 and 8 of this application conflicts with any response on pages 1 – 6 of this application, the stipulations on pages 7 and 8 control.*



Manhattan Community Board 4 (MCB4) recommends:

Denial unless all stipulations agreed to by applicant/owner are part of the method of operation

Denial  Approval

**CB4 REPRESENTATIVES**

Nelly Gonzalez  
CB4 Assistant District Manager

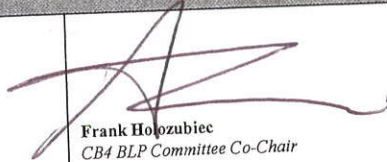
  
Frank Holozubiec  
CB4 BLP Committee Co-Chair

  
Burt Lazarin  
CB4 BLP Committee Co-Chair

**APPLICANT AGREEMENT WITH THE COMMUNITY**

Applicant agrees to these stipulations as the basis for the community support of this application and acknowledges that all of these stipulations are essential prerequisites to the MCB4 recommendation regarding this application. Applicant agrees to have these stipulations incorporated in the method of operation of its liquor license. The stipulations in this application constitute the entire agreement between MCB4 and applicant and may only be altered in writing signed by MCB4 and applicant. These stipulations supersede any oral statements or representations in connection with this application.

**SIGN HERE** →

Socrates Nanas

PRINT NAME OF APPLICANT

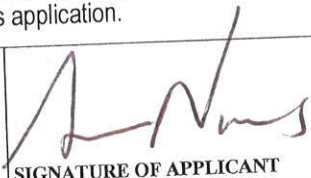

SIGNATURE OF APPLICANT

6/30/2016

DATE

drawing no.	A-001.00	date	5/21/15	proj. no.	1212-1
scale	AS NOTED	date	XXXXX	client	XXXXX
author	AS NOTED	date	XXXXX	client	XXXXX
project	ORIGINAL RAMPANADAS MAMAS	date	XXXXX	client	XXXXX
location	NEW YORK, NEW YORK	date	XXXXX	client	XXXXX
address	765 9th AVE	date	XXXXX	client	XXXXX
description	EXISTING FLOOR PLANS	date	XXXXX	client	XXXXX
architect	George Monstero Architect	date	XXXXX	client	XXXXX
contact	Point Lookout, New York 11569 917.371.2340	date	XXXXX	client	XXXXX
email	George@MonsteroArchitect.com	date	XXXXX	client	XXXXX
website	MonsteroArchitect.com	date	XXXXX	client	XXXXX

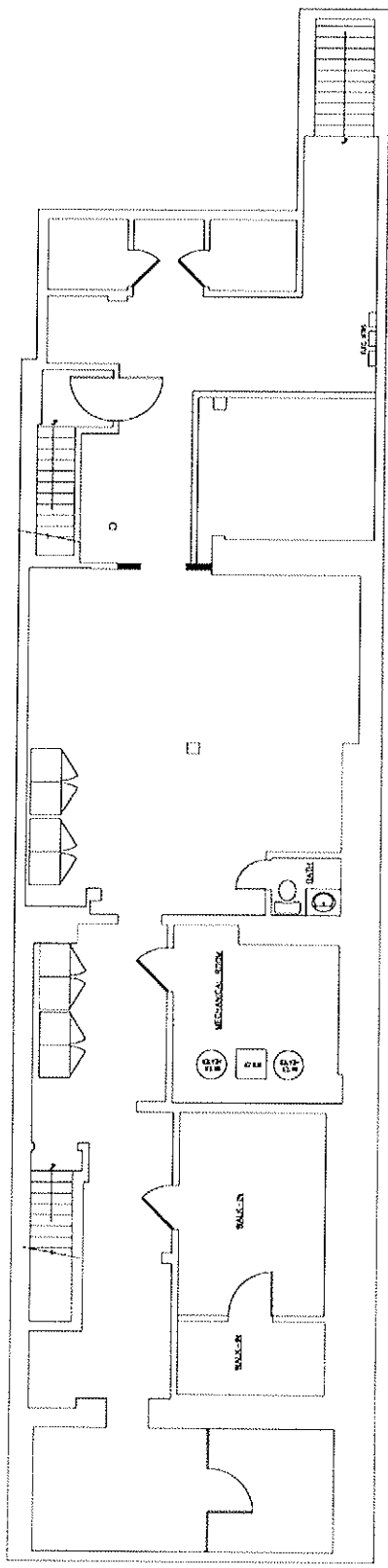

1 CELLAR FLOOR PLAN

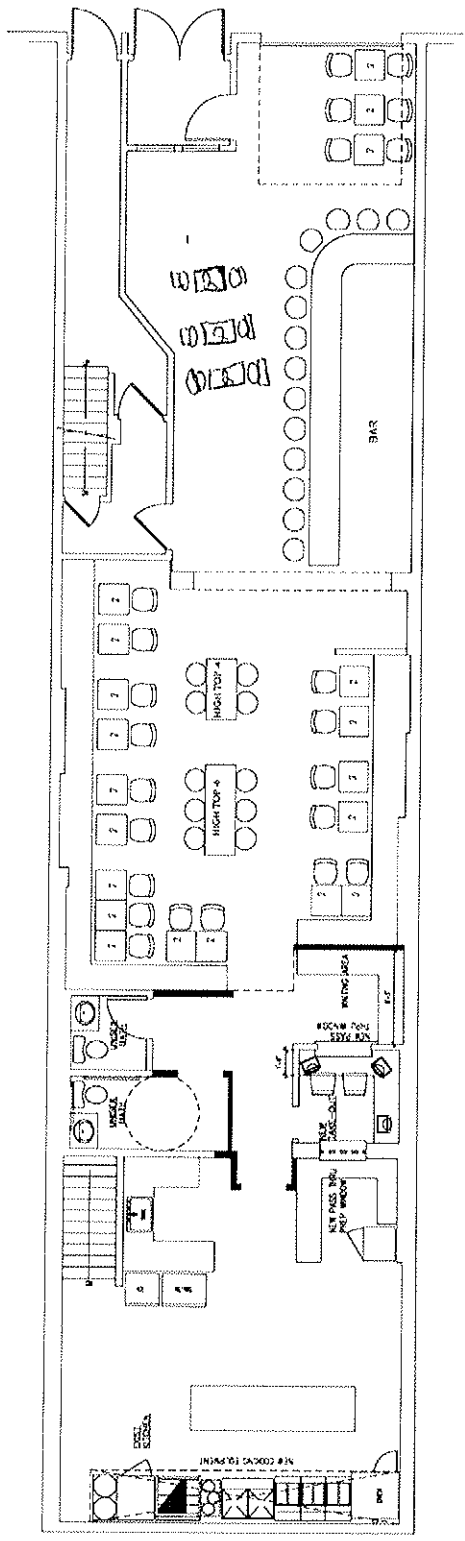

2 FIRST FLOOR PLAN

# Menu

## entrées

- **Arroz Con Camarones\$16.25**

special for wednesday and friday. colombian style shrimps mixed with sofrito sauce, seasoned yellow rice, peas, onions and carrots. served with house salad. comes with green and red salsa

- **Arroz Con Pollo\$14.95**

colombian style boneless chicken mixed with sofrito sauce, seasoned yellow rice, peas, onions and red peppers. served with maduros (fried sweet plantains) comes with green and red salsa

- **Comes With Green And Red Salsa\$11.95**

traditional homemade colombian style tamales wrapped in a banana leaf (pork or chicken). comes with green and red salsa

- **Pollo Guisado\$14.25**

latin style chicken stew cooked slowly in sofrito sauce, yellow peppers, potato and garlic. served with white or yellow rice

- **Pollo A La Plancha\$15.45**

marinated chicken breast seasoned with traditional latin herbs and spices grilled to perfection. served with white or yellow rice, black or red beans, salad and chimichurri sauce

- **Palomilla A La Plancha\$18.45**

grilled sirloin, marinated with traditional latin herbs and spices. served with white or yellow rice, black or red beans, salad and chimichurri sauce

- **Entrana A La Plancha\$18.45**

grilled skirt steak marinated with traditional herbs and spices. served with white or yellow rice, black or red beans, salad and chimichurri sauce

- **Chuleta Empanizada\$16.75**

fried breaded pork chop, cooked golden and crispy on the outside, and soft and tender on the inside. served with a side of white or yellow rice, black or red beans and salad

- **Mexi-Burger\$9.95**

8oz. burger, toasted bun, chipotle mayo, pickled jalapenos, lettuce, tomato, red onions, avocado. served with home made potato chips

- **Mexi-Burger Add-On\$1.25**

add cheddar, mozzarella or brie cheese

- **Mexi-Burger Only\$7.50**

## salads

- **Avocado Salad\$9.95**

avocado, cucumber, tomato, romaine and iceberg lettuces, cilantro and scallions, with either cumin dressing or a mustard vinaigrette

- **Endive Salad\$9.95**

romaine lettuce, red cabbage, endive, arugula with fresh lemon, olive oil, mustard, red wine vinegar, cayenne and shallots dressing

- **Greek Salad\$9.95**

romaine lettuce, tomatoes, cucumbers, kalamata olives, red onion, imported feta cheese, oregano with house vinaigrette

- **Persephone Salad\$9.95**

arugula, watercress, chicory and romaine, red onion, grapes, toasted walnuts, olive oil and red wine vinegar

# Menu

- **Ensalada Pequeña \$5.50**

small green salad

## tapas

- **Typical Colombian Breakfast \$7.75**

scrambled eggs with tomatoes and scallions, served with white rice mixed with red beans and arepa.

- **Typical Colombian Breakfast \$2.95**

add grilled colombian sausage

- **9th Ave Breakfast \$7.95**

scrambled eggs with melted cheddar cheese served with grilled hot dogs and our delicious home fries

- **Cheesesteak Fritata \$7.95**

served with yucca fries

- **Guacamole \$7.75**

with plantain chips (regular, mild, or hot)

- **Yuca Frita \$7.75**

fried cassava served with guacamole sauce

- **Tostones \$7.75**

mashed fried green plantains, served with garlic puree

- **Maduros \$6.25**

fried sweet plantains

- **Veal And Rice Balls \$7.75**

with lemon mushroom sauce and a splash of our albarino wine from galicia, spain

- **Colombian Sausage \$5.50**

with griddle cake and lemon

- **Homemade Cassava \$4.95**

mashed yuca dough stuffed with ground beef or oven roasted pork comes with green and red salsa

- **Sweet Corn Tamales \$6.45**

with mozzarella

- **Sweet Corn Tamales \$0.75**

extra mozzarella

- **Zapiekanka \$7.25**

sauteed mushrooms and onions, salt and pepper, over a baguette topped with brie cheese and parsley

## arepas \$6.25

Plain Arepa \$3.75. Traditional South American White Corn Pattie Stuffed With Your Choice Of: Each Arepa Comes With Green And Red Salsa. Make Your Own Special Arepa - Add On Or Mix And Match. Additional Toppings - Add \$1.25. Add Avocado \$3.25

- **Shredded Beef**
- **Shredded Chicken**
- **Cheese**
- **Ham**
- **Pork**
- **Ground Beef**
- **Spinach**

## specialty arepas \$7.25

- **Mozzarepa**

sweet corn griddle cake with bits of melted mozzarella cheese

# Menu

- **Cubana**

sofrito seasoned roast pork, ham, cuban style black beans and mozzarella cheese

- **Spicy Chicken**

slowly cooked chicken breast in mama's picante sauce.

- **Spicy Chicken\$0.75**

add on cheese for

- **Ham And Cheese**

a delicious ham and cheese melt

- **Cheeseburger**

ground beef cooked in traditional latin spices with cheddar cheese

- **Cheese Steak**

top round with mozzarella, red bell pepper, spanish onion and a latin twist

## wheat flour

- **Desayuno Colombiano (Breakfast Empanada Available Anytime)\$2.85**

colombian sausage, cheddar cheese, eggs and spanish onion

- **Desayuno Americano (Breakfast Empanadas Available Anytime)\$2.85**

top round steak, cheddar cheese, eggs, spanish onion and a latin twist

- **Huevos Pericos (Breakfast Empanadas Available Anytime)\$2.85**

tomatoes, eggs and scallion

- **Brasil\$2.95**

traditional brazilian style empanada with ground beef, olives, sauteed onions, and potatoes

- **Spicy Chicken\$2.95**

chunks of chicken breast slowly cooked in mama's special picante sauce

- **Reggaeton\$2.95**

caribbean style roast pork with sofrito seasoned yellow rice and gandules (peas)

- **Cheesesteak\$2.95**

skirt steak with mozzarella cheese and a latin twist

- **Mambo Italiano\$2.85**

roasted italian sweet sausage with red and green peppers, onions, mozzarella cheese and a touch of tomato sauce

- **Americano\$2.85**

juicy hot dog with cheddar cheese

- **Shredded Beef\$2.85**

with onion, slowly cooked beef marinated in traditional colombian spices

- **Beef & Broccoli Teriyaki\$2.85**

strips of beef sautéed with a teriyaki sauce and broccoli

- **Shredded Chicken\$2.85**

all-white chicken breast slowly cooked with sofrito sauce

- **Cheese\$2.85**

a simple and delicious empanada stuffed with mozzarella cheese

- **Ham And Cheese\$2.85**

# Menu

mama→s ham and cheese melt

- **Chicken & Broccoli Teriyaki**\$2.85

pieces of chicken breast sautéed with a teriyaki sauce and broccoli

- **Viagra**\$3.00

mama→s seafood stew with shrimps, scallops, and crab meat

- **Hawaiian**\$2.85

pieces of ham with sautéed pineapples and mozzarella cheese

- **Cheeseburger**\$2.85

ground beef cooked in traditional latin spices with cheddar cheese

- **Cuban**\$2.85

slowly roasted pork, ham with mozzarella cheese and a touch of sofrito sauce

- **Pernil**\$2.85

marinated pork slowly roasted to perfection

- **Tuna Jalapeño**\$2.85

albacore tuna with jalapeños

- **Tjc**\$2.85

mama→s tuna melt with cheddar cheese and jalapeños

- **Polish**\$2.85

polish sausage (kielbasa) sautéed with sauerkraut

- **Pizza**\$2.85

tomato sauce and cheese

- **Pepperoni Pizza**\$2.85

slices of pepperoni with tomato sauce and cheese

- **Spinach & Cheese**\$2.85

mozzarella with sauteed spinach

## oven baked wheat flour \$2.85

- **Beef**

ground beef sautéed with onions, latin herbs and spices

- **Shredded Chicken**

sauteed chicken with sofrito sauce and red peppers

- **Mushrooms**

sauteed portobello & white mushrooms with onions

- **Greek Spinach Pie**

classic greek style empanada with spinach and feta cheese

- **Greek Sausage Pie**

greek sausage in traditional mediterranean spices

## corn flour \$2.75

- **Ground Beef**

traditional colombian style ground beef

- **Chorizo**

ground pork sausage with classic latin herbs and spices

# Menu

- **Shredded Chicken**

traditional colombian style chicken with peas and carrots

- **Veggie**

steamed potatoes, carrots and lima beans

- **Cheese**

a colombian classic corn empanada stuffed with mozzarella

- **Broccoli And Cheese**

mozzarella cheese and sautéed broccoli

- **Rice And Beans**

white rice and red beans

- **Chili And Beef**

slowly cooked ground beef with latin style spices and chili peppers

## dessert wheat flour

**\$2.95**

- **Romeo And Juliet**

guava with mozzarella cheese

- **Belgian Milk Chocolate And Banana**

- **Figs, Caramel And Cheese**

- **Sweet Plantains And Cheese**

mashed sweet plantains with mozzarella cheese

- **Usa**

apples and cinnamon

- **Elvis**

peanut butter and bananas

- **Caramel And Cheese**

- **Belgian Milk Chocolate**

- **Add To Your Dessert Empanada**

a scoop of vanilla ice cream, whipped cream, chocolate syrup, caramel syrup.

## soups

- **Soup Of The Day\$7.00**

- **Mediterranean White Beans\$7.45**

(v,l,d).

- **Mediterranean White Beans\$3.25**

(v,l,d). add a spanish chorizo

- **Butternut Squash\$7.45**

(v,l). with a hint of ginger

- **Chicken\$7.95**

(d). colombian style chicken soup with a side of white rice.

- **Sancocho De Cola\$11.75**

(d). home made colombian style oxtail soup. prepared with yucca, green plantains, slices of corn on the cob, recaito, cilantro and onions with a side of white rice

## sides

- **Rice And Beans\$5.00**

- **Guacamole\$5.25**

- **Sour Cream\$0.50**

- **Potato Chips\$2.75**

- **Red Or Green Salsa\$10.00 - \$4.00**

# Menu

salsas will be served with empanadas, arepas, cassavas, arroz con pollo, arroz con camarones and tamales only.

- **Rice White Or Yellow\$3.25**
- **Beans Red Or Black\$3.75**
- **Plantain Chips\$2.75**
- **Garlic Puree\$0.95**
- **Chimichurri Sauce\$0.95**
- **Chipotle Mayo\$0.95**

## natural fruit shakes

Made With Either Milk Or Water Add Romaine Lettuce, Spinach, Cucumber. Great Source Of Vitamins For Kids!!

- **Guava\$4.50**
- **Guava\$0.95**

add ice cream to your natural fruit shake

- **Guava\$0.50**

additional flavor

- **Green Orange\$4.50**
- **Green Orange\$0.95**

add ice cream to your natural fruit shake

- **Green Orange\$0.50**

additional flavor

- **Blackberry\$4.50**
- **Blackberry\$0.95**

add ice cream to your natural fruit shake

- **Blackberry\$0.50**

additional flavor

- **Soursop\$4.50**

- **Soursop\$0.95**

add ice cream to your natural fruit shake

- **Soursop\$0.50**

additional flavor

- **Strawberry\$4.50**
- **Strawberry\$0.95**

add ice cream to your natural fruit shake

- **Strawberry\$0.50**

additional flavor

- **Pineapple\$4.50**
- **Pineapple\$0.95**

add ice cream to your natural fruit shake

- **Pineapple\$0.50**

additional flavor

- **Passion Fruit\$4.50**
- **Passion Fruit\$0.95**

add ice cream to your natural fruit shake

- **Passion Fruit\$0.50**

additional flavor

- **Papaya\$4.50**
- **Papaya\$0.95**

add ice cream to your natural fruit shake

- **Papaya\$0.50**

additional flavor

- **Mango\$4.50**



# Menu

- **Mango\$0.95**

add ice cream to your natural fruit shake

- **Mango\$0.50**

additional flavor

- **Banana Milkshake\$4.95**

- **Banana Milkshake\$1.25**

add ice cream to your natural fruit shake

- **Banana Milkshake\$0.95**

additional flavor

- **Banana Milkshake\$0.95**

add chocolate syrup

## desserts

- **Flan\$4.75**

traditional colombian style flan

- **Fresh Fruit Platter\$4.95**

watermelon, apples, oranges and grapes

- **Fresh Fruit Platter\$0.95**

add organic agave nectar

## cold beverages

- **Salpicon\$4.25**

home made - mixed fresh fruit cocktail made with: grapes, apples, watermelon, melon, bananas

- **Iced Tea\$2.50**

home made - with honey and lemon

- **Lemonade\$2.50**

home made

- **Mint Lemonade\$3.00**

home made

- **Watermelon Lemonade\$3.00**

home made

- **Cherry Lemonade\$3.00**

home made

- **Sodas\$2.50**

coke / diet coke / sprite / ginger ale

- **Postobon Sodas\$2.50**

colombiana / apple / sparkling

- **Juices\$2.50**

passion fruit / mango

- **Tropicana Orange Juice\$2.50**

- **Malta\$2.50**

- **Poland Spring Water\$2.00**

- **Iced Cappuccino\$3.50**

## hot beverages

- **Homemade Hot Apple Cider\$4.00**

with cloves and cinnamon stick

- **Homemade Hot Apple Cider\$0.95**

add ice cream

- **Homemade Hot Apple Cider\$0.50**

# Menu

with vanilla or hazelnut syrup

- Tea\$2.50
- Cafe Con Leche\$3.95
- Cafe Mocha\$3.95
- Espresso\$2.50 - \$4.00

- Cappuccino\$3.95
- Vanilla Cappuccino\$4.45
- Hazelnut Cappuccino\$4.45
- Colombian Hot Chocolate\$3.25

## **Security Plan**

The establishment is supervised and managed at all times by a principal, manger, or both. All staff members are TIPS- and/or ATAP-trained, and are also trained on responsibility and awareness practices. The staff will also be trained to check and verify the identification of each guest in order to promote the safety of patrons and prevent the establishment from becoming disorderly.

## **Block Association Reach Out**

- West 46th Street Block Association: Allison Tupper at [atallisontupper@verizon.net](mailto:atallisontupper@verizon.net)
- West 47th/48th Streets Block Association: Elke Fears at [aefearshk@earthlink.net](mailto:aefearshk@earthlink.net)
- West 47th/48th Streets Block Association: Larry Roberts  
at [larrymichaelroberts@gmail.com](mailto:larrymichaelroberts@gmail.com)
- West 47th/48th Streets Block Association: Kim Bagues at [jamesbagues@gmail.com](mailto:jamesbagues@gmail.com)
- West 47th/48th Streets Block Association: Chuck Vassallo at [chasmv@hotmail.com](mailto:chasmv@hotmail.com)
- West 47th/48th Streets Block Association: Steven Riedl  
at [chluderemyc@yahoo.com](mailto:chluderemyc@yahoo.com)
- West 47th/48th Streets Block Association: Nancy Roylance  
at [nancyroylance@ymail.com](mailto:nancyroylance@ymail.com)
- West 50th/51st Streets Block Association: Steve Belida at [hk5051@gmail.com](mailto:hk5051@gmail.com)
- Oasis Gardens I Association: Nancy Kyriacou at [nkyriacou@yahoo.com](mailto:nkyriacou@yahoo.com)
- Oasis Gardens II Association: Gary DiPasquale at [gdclay@att.net](mailto:gdclay@att.net)
- West 55th Street Block Association: Christine Gorman  
at [west55ba@gmail.com](mailto:west55ba@gmail.com) or [cgormanhealth@gmail.com](mailto:cgormanhealth@gmail.com)
- 300 West 55th Street Block Association: Paul Loeb at [ploeb315@aol.com](mailto:ploeb315@aol.com)
- Hudson Hotel Residents: [rrlarios@hotmail.com](mailto:rrlarios@hotmail.com)
- Housing Conservation Coordinators: Sarah Desmond at [sdesmond@hcc-nyc.org](mailto:sdesmond@hcc-nyc.org)
- Midtown North Precinct Council: J.D. Noland at [jeandaniel@aol.com](mailto:jeandaniel@aol.com)
- Midtown North/South Precinct Council: John Mudd at [john.mudd@usa.net](mailto:john.mudd@usa.net)
- Midtown North/South Precinct Council: William Otterson  
at [bill@midtownsouthcc.org](mailto:bill@midtownsouthcc.org)

PGNV LLC  
765 9th Avenue  
New York, NY 10016





**PGNV LLC**  
**765 9<sup>th</sup> Avenue**  
**New York, NY 10016**

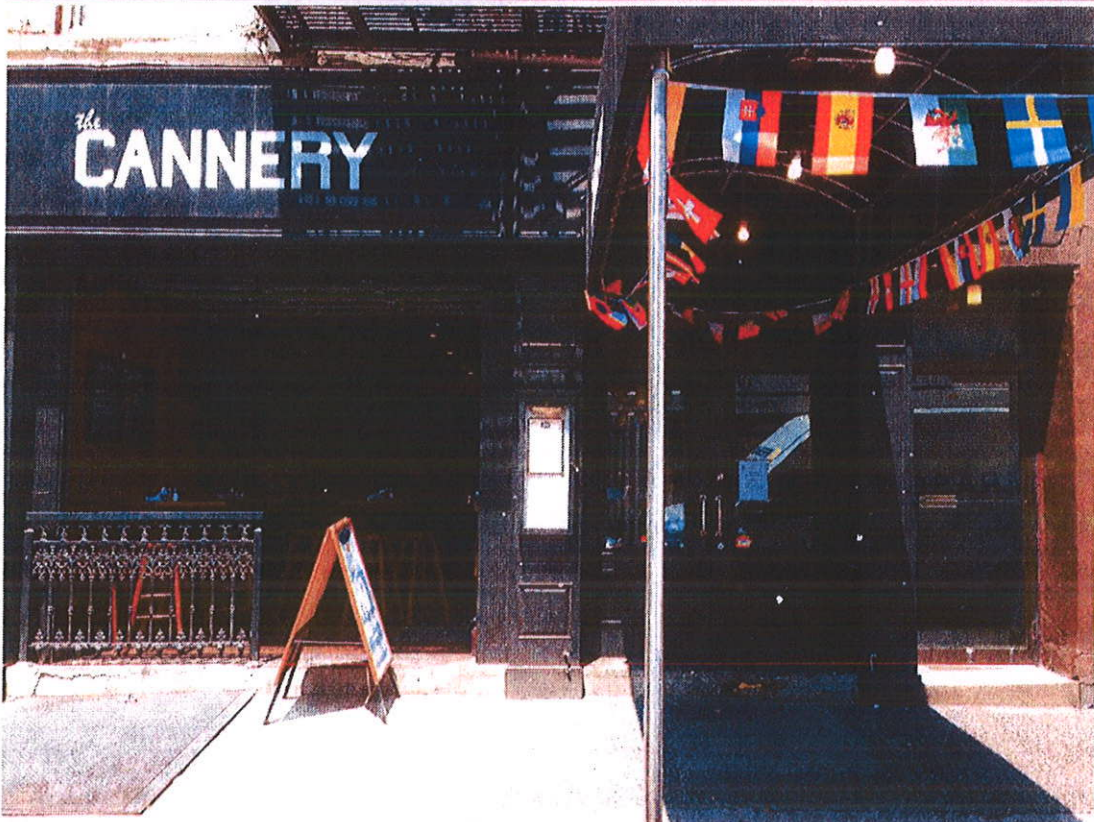



**PGNV LLC**  
**765 9th Avenue**  
**New York, NY 10016**





**PGNV LLC  
765 9th Avenue  
New York, NY 10016**

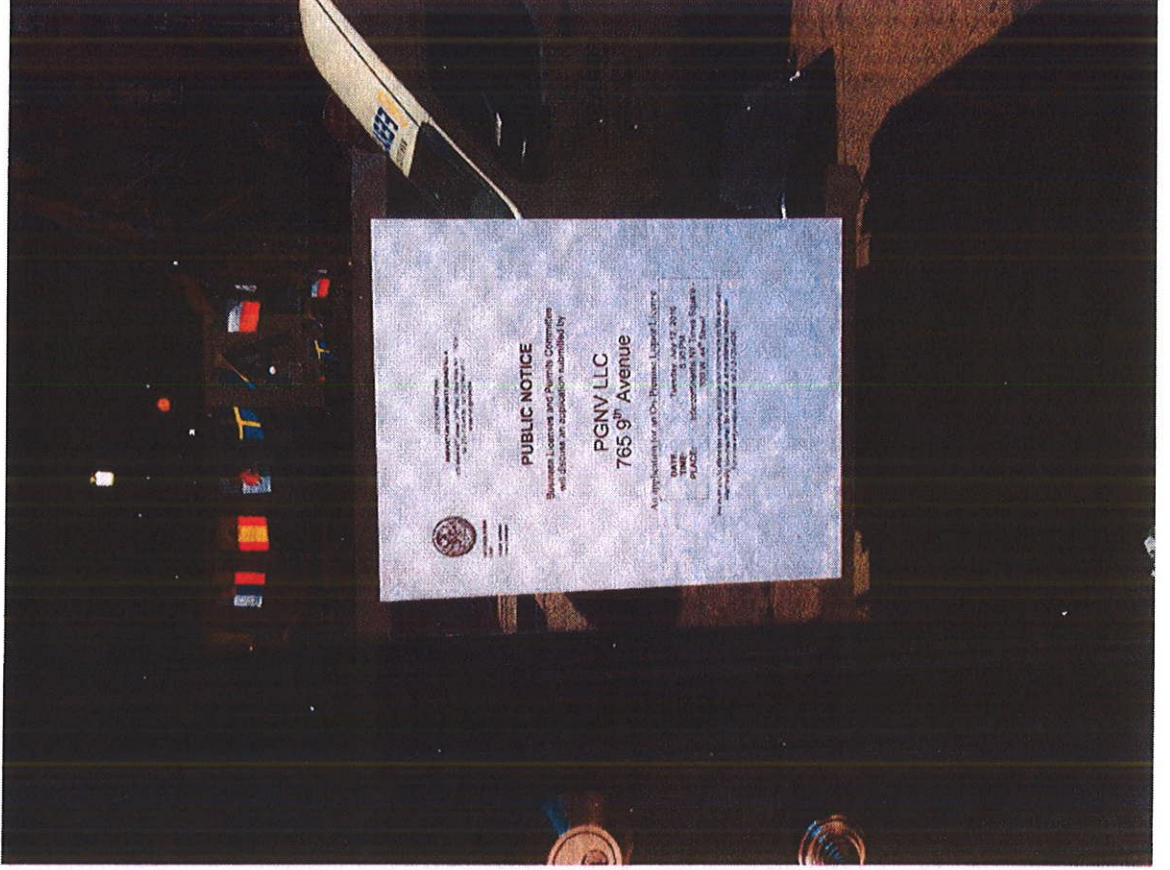
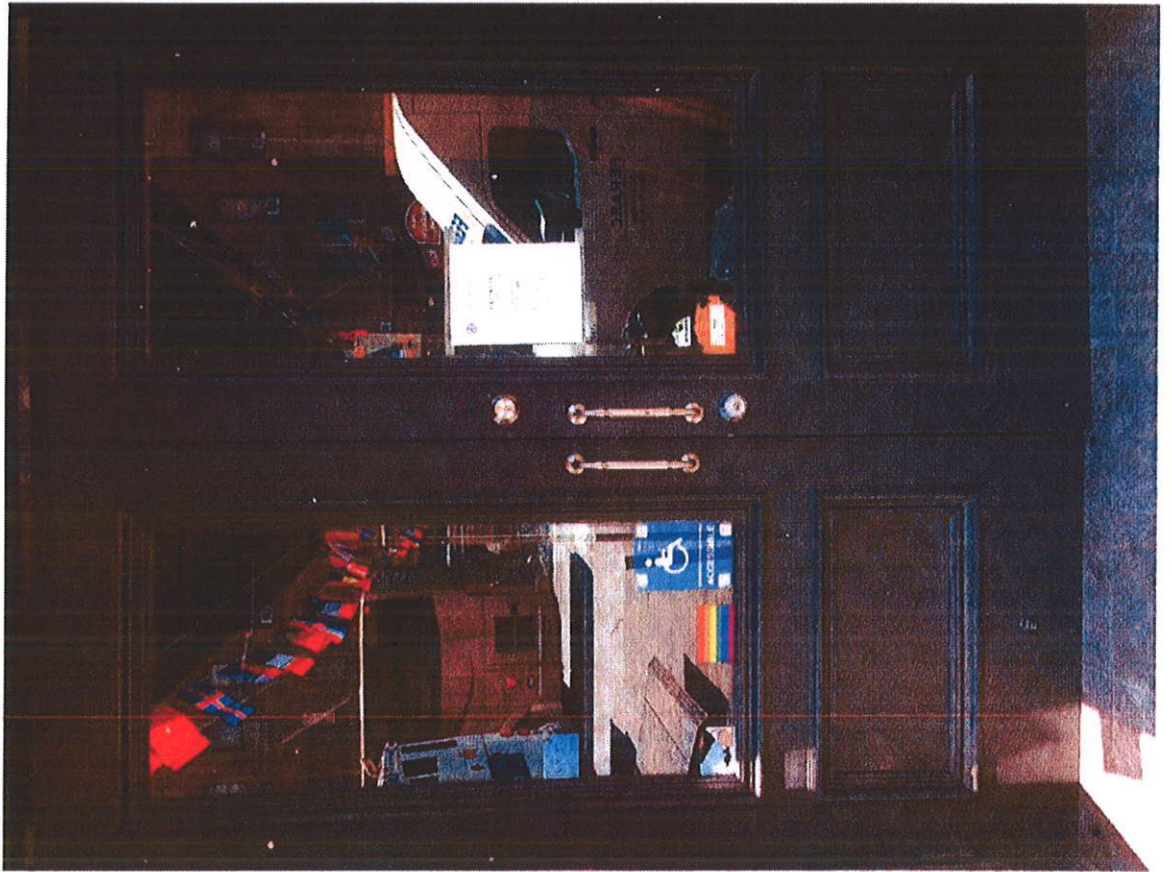



**PGNV LLC**  
**765 9<sup>th</sup> Avenue**  
**New York, NY 10016**





# 765 9th Avenue 500' Map

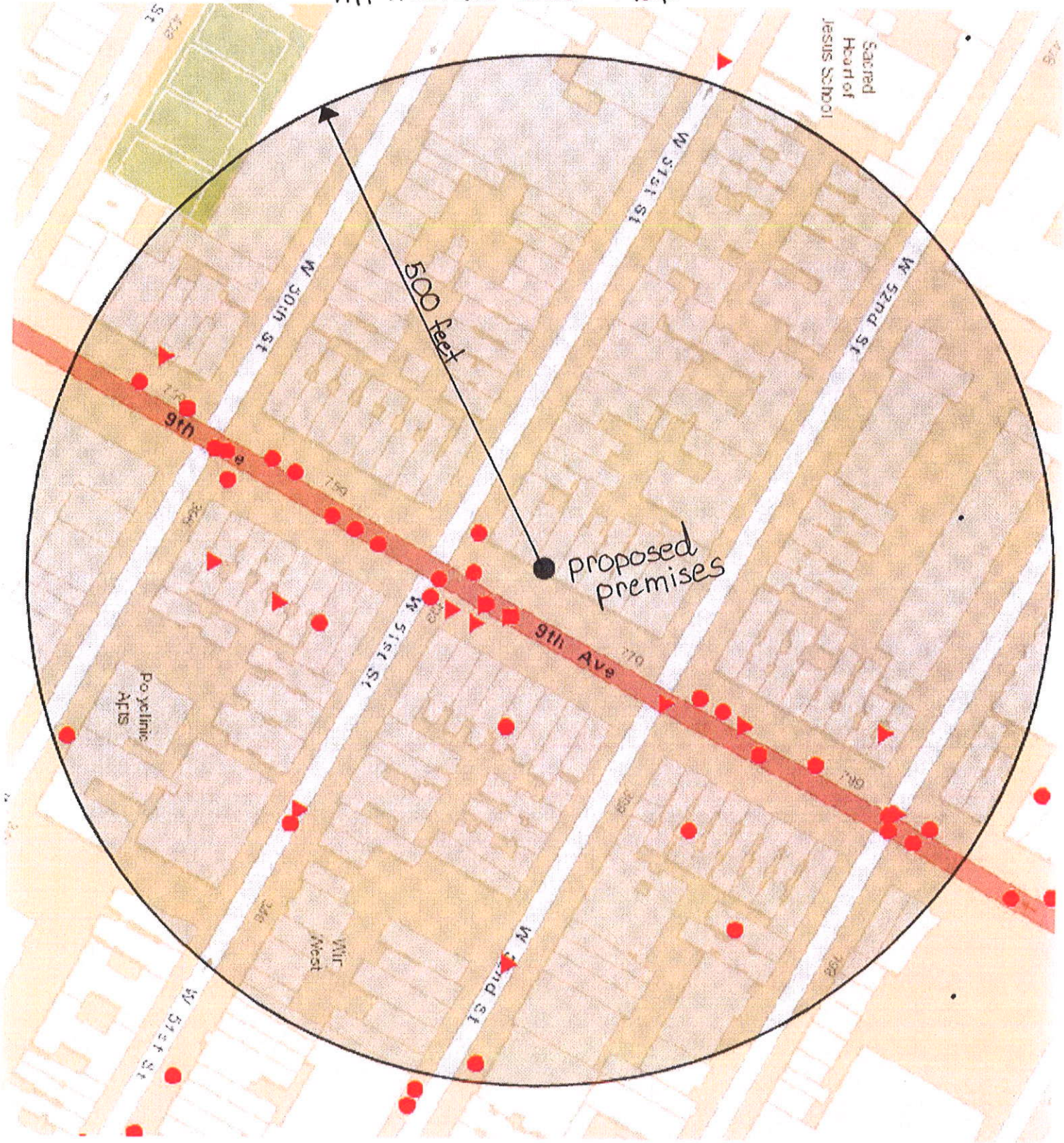



# Proximity Report for Location:

July 1, 2016

765 9 Ave, New York, NY, 10019

\* This report is for informational purposes only in aid of identifying establishments potentially subject to 500 and 200 foot rules. Distances are approximated using industry standard GIS techniques and do not reflect actual distances between points of entry. The NYS Liquor Authority makes no representation as to the accuracy of the information and disclaims any liability for errors.

## Closest Liquor Stores

Name	Address	Approx. Distance
ROYAL WINES & LIQUORS INC	789 9TH AVE	285 ft
RAY & FRANK LIQUOR STORE INC	706 9TH AVENUE	790 ft
WEST 54 LIQUORS LLC	453 W 54TH ST	825 ft
CHOSEN TRADING CORP	400 WEST 55TH ST AKA 839 9TH A	935 ft
CELLAR 53 WINE & SPIRITS INC	785 10TH AVE	980 ft
SHON 45 LIQUORS INC	840 8TH AVENUE	995 ft
ADRIATIC WINE & LIQUOR LLC	714 10TH AVENUE	1025 ft

## Churches within 500 Feet

Name	Approx. Distance
------	------------------

## Schools within 500 Feet

Name	Address	Approx. Distance
PS/IS 111 ADOLPH S. OCHS SCHOO	440 W 53RD ST	425 ft

## On-Premise Licenses within 750 Feet

Name	Address	Approx. Distance
INISTIOGE INC	768 9TH AVE	60 ft
AGEHA JAPANESE FUSION INC	767 9TH AVE	60 ft
765 NINTH AVE REST LLC	765 9TH AVE	65 ft
COVADONGA INC	763 9TH AVE	70 ft
TWO BIG BOYS INC	405 WEST 51ST STREET	75 ft
AGGIEPOLO INC	761 9TH AVE	105 ft
ARRIBA ARRIBA MEXICAN RESTAURANTS INC	762 9TH AVENUE	115 ft
MORNINGSIDE TERRACE CORP	772 9TH AVE	165 ft
HIGHLANDERS 756 INC	756 NINTH AVE	165 ft
OXIDO CORP	753 9TH AVE	190 ft
EL AZTECA MEXICAN REST INC	783 9TH AVENUE	205 ft
LARRY KEVIN K CORP	751 9TH AVE	220 ft
VYNL LLC	754 9TH AVE	230 ft
785 CAFE INC	785 9TH AVENUE	230 ft
UNCLE NICKS INC	747 9TH AVENUE	265 ft
SHERIDIN FAST FOOD INC	789 9TH AVE	290 ft
BASERA INDIAN CUISINE INC	745 9TH AVE	295 ft

Name	Address	Approx. Distance
TAKE ANY RUG IN THE HOUSE LLC	788 9TH AVE	305 ft
DREAM TEAM PARTNERS LLC	744 9TH AVENUE	330 ft
401 W 50 TAVERN INC	401 W 50TH STREET	340 ft
FLAMING SADDLES NYC 1 LLC	793 9TH AVE	340 ft
BOXERS ENTERPRISES LLC	742 9TH AVE	350 ft
MORALES CABRERA CORP	741 9TH AVE	350 ft
XAI XAI WINE BAR LLC	369 W 51ST ST	360 ft
MOLLOY S IRISH PUB LLC	737 9TH AVENUE	390 ft
IDEALIZE INC	362 W 53RD ST	410 ft
KQT LLC	401 W 53RD ST	425 ft
STOKES & MCGINLEY INC	800 9TH AVE	435 ft
733 RESTAURANT CORP	733 9TH AVENUE	445 ft
S SCOTTY ENTERPRISES INC	802 9TH AVE	465 ft
9TH AVE LIME JUNGLE INC	803 9TH AVE	470 ft
355 HELL S KITCHEN GROUP LLC	355 W 52ND ST BTW 8TH & 9TH AV	500 ft
ELYMAR RESTAURANT CORPORATION	365 W 50TH STREET	500 ft
TWO GUYS AND TOM INC	348 W 52ND ST	535 ft
BAR 9 ENTERTAINMENT CORP	807 9TH AVE	550 ft
PRIVY LLC	346 W 52ND STREET	555 ft
WESTWARD GALLERY & CAFE INC	344 346 W 52ND STREET	555 ft
MANTA LLC	809 9TH AVE	575 ft
MEDI WINEBAR LLC	811-13 9TH AVENUE	610 ft
WOO LAE OAK 50 INC	350 WEST 50TH STREET	620 ft
IPPUDO WESTSIDE LLC	321 323 W 51ST ST	625 ft
PUCCINI RESTAURANT TWO LLC	400 1/2 W 54TH ST	665 ft
TPMJV BAR & REST CORP	815 9TH AVE	680 ft
NINE AVENUE THAI INC	717 9TH AVE	685 ft
NEW WORLD STAGES HOLDING CO LLC &	340 W 50TH ST	690 ft
BRAAI LLC	329 W 51ST STREET	695 ft
CERTA GENTE LLC	325 W 51ST STREET	730 ft
SHIMIZU & TODO LLC	318 324 W 51ST STREET	735 ft
CHOW DOWN INC	824 NINTH AVENUE	750 ft

### Pending Licenses within 750 Feet

Name	Address	Approx. Distance
------	---------	------------------

### Unmapped licenses within zipcode of report location

Name	Address
------	---------

Date	Name (Please Print)	Signature	Address	Are you a resident of the building? (Kindly indicate Yes or No)
7/1/16	William F		769 - 793 ave	No
7/1/16	Jake Taylor-Vivian		405 W 51st	No
7/1/16	Ricon Whenn		405 W 51st	No
7/1/16	Victor Overada		423 W 55th	No
7/1/16	Me Ell Mae		449 W. 51	Yes No
7/1/16	Eric Lumen		321 W 44	No
7/1/16	Julian Fran		449 W 33 St.	No
7/1/16	Thom Williams		449 W 33 St.	No
7/1/16	Huanu Beans		455 W 44th Apt 2	No
7/1/16	Joe Gasser		754 9th St.	No
7/1/16	Yury Podugal		348 W 50th	No
7/1/16	S Wenz		746 9th	No
7/1/16	Folwierski		746 9th	No
7/1/16	Kim Gumbrecht		427 W 52nd	No
7/1/16	Jeha Kell		427 W 52nd	No
7/1/16	Alvora W Pompe		408 W 51st	No
7/1/16	James Santos		574 W 48th	No

PETITION

The following undersigned residents of premises and surrounding buildings support the issuance of an

on premises \_\_\_\_\_ license

(Please indicate type of license)

to the following applicant/establishment:

Address of premises: EMERSONIAN MANNA  
765 9TH AVENUE, NY, NY 10019

- This business will be a: bar  restaurant  (circle one) or describe other: \_\_\_\_\_
- With an outdoor space: backyard garden  sidewalk café  rooftop  (circle one)
- The hours of operation will be (for indoor establishment): \_\_\_\_\_
- The hours of operation for establishment's outdoor space: \_\_\_\_\_

Date	Name (Please Print)	Signature	Address	Are you a resident of the building? (Kindly indicate Yes or No)
07/01	DIVINE PAUL	<i>[Signature]</i>	497 W. 58 <sup>th</sup>	Yes
07/01	SAMUEL J. TERRELL	<i>[Signature]</i>	498 W. 51	Yes
07/01	Shekg Gya	<i>[Signature]</i>	757 9 <sup>th</sup> Ave	Yes
07/01	Danica Gredjub	<i>[Signature]</i>	408 West 51 <sup>st</sup> 204	Yes
07/01	PAUL MONT	<i>[Signature]</i>	408 W. 51 <sup>st</sup>	Yes
07/01	Humayun Kabir	<i>[Signature]</i>	406 W 51 <sup>st</sup>	No
07/01	Yelk Khan	<i>[Signature]</i>	405 W 50 <sup>th</sup> St.	No
07/01	Conrad Robinson	<i>[Signature]</i>	437 W 51 <sup>st</sup>	No
07/01	Joseph Rodriguez	<i>[Signature]</i>	308 W 49	No











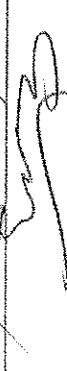





PETITION

Date	Name (Please Print)	Signature	Address	Are you a resident of the building? (Kindly Indicate Yes or No)
7/1/16	Shane Chas		410 W 57 <sup>th</sup>	NO
7/1/16	Gregory		888 W 47 <sup>th</sup> Street	no
7/1/16	David Ingram		5305 Newland Ave	Yes.
7/1/16	Seema Deyal		401 Broadway	NO
7/1/16	Dallway Logo		540 W 52 <sup>nd</sup> St	NO
7/1/16	Sasha Ryan		536 18 <sup>th</sup> W 55 <sup>th</sup> St	NO
7/1/16	Moni Berra		13-02 Redfern Ave	NO
7/1/16	Arnova Greene		105 Thayer St.	NO
7/1/16	David Perez		<del>105</del> 464 W 51 <sup>st</sup>	NO
7/1/16	Matthews Aart		340 Madison Ave	No
7/1/16	Steven Edwin Rosado		412 W 1 <sup>st</sup> St	NO
7/1/16	José David		717 7 <sup>th</sup> Ave	NO
7/1/16	Shir Wolfman		408 West 51 <sup>st</sup>	NO
7/1/16	Dennis Lavanti		502 W 43 <sup>rd</sup>	NO
7/1/16	Caroline Miller		338 W 44 <sup>th</sup> St	NO
7/1/16	Michael		457 W 44 <sup>th</sup>	
7/1/16	Kellie Johnson		55 West End Ave, 57 <sup>th</sup>	No

Date	Name (Please Print)	Signature	Address	Are you a resident of the building? (Kindly Indicate Yes or No)
7/11/16	T. MCNAMARA	<i>T. McNamara</i>	516 W 52ND ST NYC 10019	NO
7/11/16	Joselyn Pagredi	<i>Joselyn Pagredi</i>	206 WEST 80th ST. 10024 229 W 60th ST 10026	NO
7/11/16	Jose Santana	<i>Jose Santana</i>	241 E 111th ST 10029	NO
7/11/16	Rolando Martin	<i>Rolando Martin</i>	241 E 111th ST 10029	NO
7/11/16	Ben Fudge	<i>Ben Fudge</i>	241 E 111th ST 10029	NO
7/11/16	Margaret Brown	<i>Margaret Brown</i>	285 4th AVE 10019	NO
7/11/16	Andrew Mueenno	<i>Andrew Mueenno</i>	410 W 51st ST 10020	NO
7/11/16	Sarah Castro	<i>Sarah Castro</i>	345 W 50th Street	NO
7/11/16	Jason Brito	<i>Jason Brito</i>	375 W 48th Street	NO
7/11/16	Nicole Severi	<i>Nicole Severi</i>	830 50th St. Apt 4F	NO
7/11/16	Ronni Under	<i>Ronni Under</i>	530 W 47th St. Apt 3E	NO
7/11/16	GARY DWYER	<i>GARY DWYER</i>	348 W 48th ST 4W	NO
7/11/16	Ashley McGulley	<i>Ashley McGulley</i>	317 W 48th apt #4	NO
7/11/16	Temper Edwards	<i>Temper Edwards</i>	666 W 162nd St. #36	NO
7/11/16	Anthony Greene	<i>Anthony Greene</i>	<del>444 W 50th St</del> 774 9th AV. Apt 2S	NO
7/11/16	Mildred Donato	<i>Mildred Donato</i>	1 River Place	NO
7/11/16	Jel Glava	<i>Jel Glava</i>	189	NO

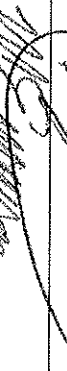

Date	Name (Please Print)	Signature	Address	Are you a resident of the building? (Kindly Indicate Yes or No)
7/1/16	Michael Curiglio		601 W. 14th St.	Yes
7/1/16	SEAN MADON		304 W 378 St	No
07/16	Yvette Gonzalez		355 W. 51 St	No
07/16	Alexander Kles		410 W 32nd St	Yes
07/16	HANE EVANSKOLSKA		410 W 57th St	No
07/16	DANA ELASKRASKA		410 W 51 St	No
07-16	Elmer Giovanni		410 W 51 St	No
07-16	AMISSIE LEONARD		446 W 51 St	No
7-16	ZACHARY DUNN		446 W 51 St	No
7-16	WILLY RICCIARDI		305 W 57th St	No
7-16	Tommy Brannan		415 W 51st Street	No
7-16	Maggie Josick		36 W. 51st St	No
7-16	Sam Poisson		45 W 57th	No
	BOB SPOFFORD		41 Sutton St B1c	No
			355 107th W	No
7-16	Kindra Julia		777-779 9th Ave	
7-16	Kevin Knapp		777-779 9th	No

Date	Name (Please Print)	Signature	Address	Are you a resident of the building? (Kindly Indicate Yes or No)
7/1	Russell Boris		414 W 50th	No
7/1	Erica Adelberg		414 E 52nd	No
7/1	ISIS Flores		410 W 51st	No
7/1	John David		410 W 51st	No
7/1	RALPH FERRELLI		410 W 51st 401	No
7/1	Joseph		809 E 4th	No
7/1	Joseph			No
7/1	HONG		573 18th	Yes
7/1	Madelyn Baker		3495 Broadway	No
7/1	JACK CRACK		120 W 89th	No
7/1	Seony Moss		513 W 54th	No
7/1	Nilton Bravo		113 W 60th Street	No
7/1	SHAUN EVERTON		4200 Broadway	No
7/1	Stolan Moya		321 W 103 St. NYC	No
7/1	MICHAEL EMERSON		345 W 55	No
7/1	John Sotomayor		1033 Broadway	No
7/1	Anthony Bernasconi		1033 Broadway	No
7/1	Mandy Oser		510 W 52nd St	No

PETITION

Date	Name (Please Print)	Signature	Address	Are you a resident of the building? (Kindly Indicate Yes or No)
7/16	Tim Bloom		692 E 14th St	No
7/16	Zach Hunt		747 10th	No
7/16	Aubrey Piv		355 W 4th St	No
7/16	Catherine M	Allyson	335 W 5th St	No
7/26	Franklin		410 W 51st	No
7/16	Edwards		711 17th Ave	No
1-7-16	P. GUTMAN		" "	No
07/16	Joseph		" "	No
07/16	Carlos Hernandez		711th 11th Ave	No
7-1	Anna Hernandez	Forman	601 W 58th St	No
7-1	TARA RAY-SCHW		769 9th Ave	No
7/1	Edward Estrella		410 W 51st	No
7/1	David Mejino		1355 8th Ave NW	No
7/1	Nico Frank Bauer	Julia Bauer	408 West 51st St	No
7/1	B. REYES		4-R 9th Ave	No
7/1	Diana Borsari		427 W 51st	No
7/1	Jane Allyn		430 W 52nd St	No
7/1	Perennial Hummished		430 W 56th St	No