

**Manhattan Community Board 4**  
(All Fields Must Be Completed)

Liquor License Stipulations Application

APPLICANT		ADDING BUSINESS AS (DBA)					
KUNG FU LITTLE STEAMED BUNS RAMEN, INC		T/B/D					
STREET ADDRESS		CROSS STREET					
300 WEST 49TH STREET., BALLROOM LEVEL		8 AVE					
OWNER	NAME	SONG, Zhe	OWNER	NAME	GRING, TING		
	PHONE	(347) 757-8208	OWNER	PHONE	(718) 321-7130		
	DOB	N/A	OWNER	PHONE	(718) 321-7135		
MANAGER	NAME	T/B/D	LANDLORD	NAME	300 WEST 49th ST. LLC		
	PHONE			PHONE	(516) 837-7000		
	TAX ID			PHONE	N/A		
DESCRIPTION OF BUSINESS							
Establishment Type:		<input type="radio"/> Bar/Tavern <input type="radio"/> Bed & Breakfast <input type="radio"/> Eating Place Beer <input type="radio"/> Cabaret <input type="radio"/> Night Club <input type="radio"/> Hotel <input checked="" type="radio"/> Restaurant <input type="radio"/> Catering Establishment <input type="radio"/> Club ( Fraternal Organization - Members Only) <input type="radio"/> Other (Explain): Bar/Arcade					
Method of Operation:		<input checked="" type="radio"/> Restaurant <input type="radio"/> Dance Club <input type="radio"/> Sports Bar <input type="radio"/> Adult Entertainment <input type="radio"/> Wine Bar <input type="radio"/> Pizzeria <input type="radio"/> Cafe <input type="radio"/> Other (Explain): Bar/Arcade					
License Type:		<input type="radio"/> On-Premise <input type="radio"/> Wine <input type="radio"/> Beer <input checked="" type="radio"/> Wine & Beer					
APPLICATION TYPE (check one)		<input checked="" type="radio"/> New		Has applicant owned or managed a similar business?		YES	NO
				What is/are the name/s of establishment/s?			
				What is/are the address/s of the establishment/s?			
				What were the dates the applicant was involved with this former premise/s?			
		<input type="radio"/> Transfer		What is the prior license #?			
				What is the expiration date on the prior license?			
				Are you making any alterations or operational changes?		YES	NO
				If alterations or operational changes are being made, please attach the plans to this form.			
		<input type="radio"/> Alteration		What is the current license #?			
				What is the expiration date on the current license?			
Please describe the nature of the alterations and attach the plans							

OPERATIONAL ISSUES										
HOURS		MONDAY	TUESDAY	WEDNESDAY	THURSDAY	FRIDAY	SATURDAY	SUNDAY		
		Operation	8AM - 1AM	8AM - 1AM	8AM - 1AM	8AM - 1AM	8AM - 1AM	8AM - 1AM	8AM - 1AM	
		Music	8AM - 1AM	8AM - 1AM	8AM - 1AM	8AM - 1AM	8AM - 1AM	8AM - 1AM	8AM - 1AM	
	Kitchen	8AM - 12:30AM	8AM - 12:30AM	8AM - 12:30AM	8AM - 12:30AM	8AM - 12:30AM	8AM - 12:30AM	8AM - 12:30AM		
OCCUPANCY	IN DOOR		BAR			OUT DOOR				
	Capacity (Certificate Occupancy)	Maximum # of Persons You Anticipate Occupying Establishment (Including Employees)	Number of Tables	Number of Seats	Number of Seating Out Door	Number of Seating Out Door	Number of Seating Out Door	Number of Seating Out Door	Number of Seating Out Door	
	No C of O	40	7	31	1	0	0	0	0	
How many floors are there? What is the capacity for each floor? (please respond in space provided)					<input checked="" type="radio"/>			1st Floor and Cellar		
Will you be applying or intending to apply for a cabaret license? if yes, will there be dancing? (please respond in space provided)					<input checked="" type="radio"/>	<input type="radio"/>	<input type="radio"/>			
Will applicant have bottle service?					<input checked="" type="radio"/>	<input type="radio"/>	<input type="radio"/>			
Will you be hosting private parties and promotional events?					<input checked="" type="radio"/>	<input type="radio"/>	<input type="radio"/>			
Will outside promoters be used?					<input checked="" type="radio"/>	<input type="radio"/>	<input type="radio"/>			
Will the security plan submitted be implemented?					<input checked="" type="radio"/>	<input type="radio"/>	<input type="radio"/>			
Will State certified security personnel be used?					<input checked="" type="radio"/>	<input type="radio"/>	<input type="radio"/>			
Will New York Nighthille Association recommendations and NYPD Best Practices be followed?					<input checked="" type="radio"/>	<input type="radio"/>	<input type="radio"/>			
Will the applicant be using delivery bicycles? If yes, have you applied to DOT for bicycle rack? Delivery bicycles are to be clearly marked with the name of the restaurant and staff will wear attire clearly noting name. (please respond in space provided)					<input checked="" type="radio"/>	<input type="radio"/>	<input type="radio"/>	T/B/D		
Will the applicant be applying for a Sidewalk Café now or in the future? (please respond in space provided)					<input checked="" type="radio"/>	<input type="radio"/>	<input type="radio"/>			
If yes to the above, are plans attached and submitted to DCA? How many tables/seats? (please respond in space provided)					<input checked="" type="radio"/>	<input type="radio"/>	<input type="radio"/>			
Will applicant provide contact information to neighbors and respond to complaints that arise?					<input checked="" type="radio"/>	<input type="radio"/>	<input type="radio"/>			
Will you inform the Community Board office of your job openings and/or provide a hyperlink to your jobs webpage?					<input checked="" type="radio"/>	<input type="radio"/>	<input type="radio"/>	T/B/D		
If you plan to have music, what type(s)?			BACKGROUND	LIVE MUSIC	DJ					
BUILDING DISTURBANCE										
Doors and windows will be closed when any amplified music is played and in the event of no amplified sound, will be closed by 11 PM Friday and Saturday and 10 PM on all other days.					<input checked="" type="radio"/>	<input type="radio"/>	<input type="radio"/>			
Will applicant follow the recommendations of a certified sound engineer to mitigate potential noise disturbance to the neighboring residents and buildings, including placing speakers on the floor of the establishment?					<input checked="" type="radio"/>	<input type="radio"/>	<input type="radio"/>			
Do you agree to comply with DOB rules concerning a storm enclosure? Storm enclosures can be used between November 16 and April 15, but they may NOT project more than 18 inches from the store front.					<input checked="" type="radio"/>	<input type="radio"/>	<input type="radio"/>			

OUTDOOR DINING			
Will applicant use the rooftop, rear yard or any outdoor space?	YES	<input checked="" type="radio"/> NO	<input type="radio"/> N/A
If yes to the above, the rear yard, rooftop, and any outdoor space will be closed and vacated by 11 PM on Friday & Saturday and 10 PM on all other days.	YES	<input type="radio"/> NO	<input checked="" type="radio"/> N/A
The service and consumption of alcohol in the rear yard, on the rooftop, or in any other outdoor space will be only via seated food service.	YES	<input type="radio"/> NO	<input checked="" type="radio"/> N/A
The rear yard, rooftop, and any other outdoor space will not allow standing space for patrons to drink or smoke.	YES	<input type="radio"/> NO	<input checked="" type="radio"/> N/A
Applicant will do everything in their power to provide an effective sound baffling or sound controlled environment through landscaping or some type of enclosure, where possible; provided they do not violate any fire or building code regulations? This includes possibly working with landlords for soundproofing tenants apartments (such as installing soundproofing windows, acoustical tiles, etc.).	<input checked="" type="radio"/> YES	<input type="radio"/> NO	<input type="radio"/> N/A
Applicant will enforce a quiet environment in the outdoor space, so as not to disturb nearby residents (e.g. there will be no amplified music, as per the law, and windows and doors to areas that play amplified music shall be closed). The applicant will make every effort possible to limit the noise emanating from diners by posting signs outside and also on menus asking for respect of the neighbor's privacy and peace. The staff will also encourage a peaceful environment amongst the outdoor diners.	<input checked="" type="radio"/> YES	<input type="radio"/> NO	<input type="radio"/> N/A
Applicant will have a lighting plan that will allow safe usage of the outdoor space without disrupting neighbors?	<input checked="" type="radio"/> YES	<input type="radio"/> NO	<input type="radio"/> N/A

LOCATION & ZONING			
Primary Zoning District:		Overlay (If Applicable):	
Is this a Special District? If yes, is it Clinton, West Chelsea or Hudson Yards?	<input checked="" type="radio"/> YES	<input type="radio"/> NO	<input type="radio"/> N/A Clinton
Does the building have a Certificate of Occupancy ("C of O") or a letter of no objection?	<input type="radio"/> YES	<input type="radio"/> NO	<input type="radio"/> N/A No objection letter being applied for
Is the 500 Foot Rule or 200 Foot Rule Triggered? If yes, which? Please attach a diagram of the establishments that triggers the rule.	YES	<input checked="" type="radio"/> NO	<input type="radio"/> N/A
Is a Public Assembly permit required?	YES	<input checked="" type="radio"/> NO	<input type="radio"/> N/A
Are your plans filed with DOB?	YES	<input checked="" type="radio"/> NO	<input type="radio"/> N/A
Building Type	<input type="radio"/> Residential <input type="radio"/> Commercial <input checked="" type="radio"/> Mixed Use <input type="radio"/> Other, describe: _____		
Adjacent Buildings	<input type="radio"/> Residential <input type="radio"/> Commercial <input checked="" type="radio"/> Mixed Use <input type="radio"/> Other, describe: _____		
NOTIFICATION: What organizations / community groups have you notified regarding your application?	# 1	Manhattan Community Board #6	
	# 2		
	# 3		

ADDITIONAL INFORMATION (Applicant Use)



ADDITIONAL NOTES (Office Use Only)

Will Install a Bike Rack when Delivery Begins

ADDITIONAL SIMULATIONS (Office Use Only)

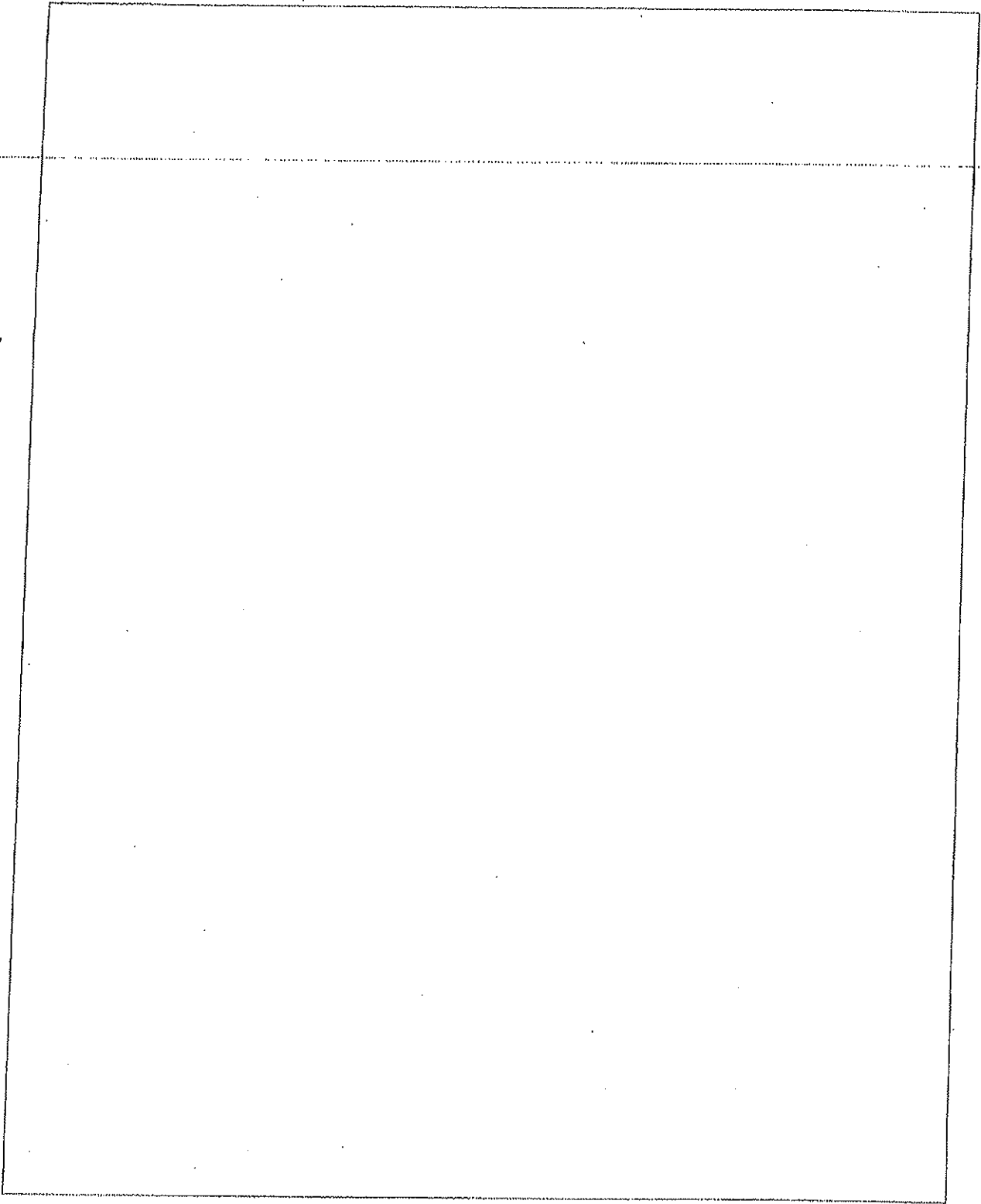
[Empty simulation area]

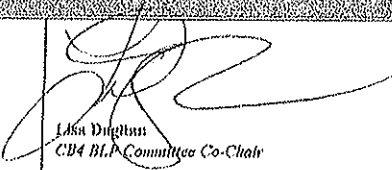
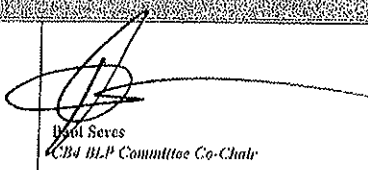

Manhattan Community Board 4 (MCB4) recommends:		<input checked="" type="radio"/> Denial unless all agreed to by applicant is part of the method of operation <input type="radio"/> Denial <input type="radio"/> Approval
CB4 REPRESENTATIVES		
Nelly Gonzalez <i>CB4 Assistant District Manager</i>	 Liza Dignani <i>CB4 BLP Committee Co-Chair</i>	 Paul Seves <i>CB4 BLP Committee Co-Chair</i>
APPLICANT AGREEMENT WITH THE COMMUNITY		
Pursuant to these stipulations, this applicant agrees to have these provisions incorporated in the method of operation of their liquor license. Additionally, the applicant agrees to the community agreements as the basis for the community supporting this application.		
SIGN HERE →	 SIGNATURE OF APPLICANT	DATE 12/02/2013

X the song

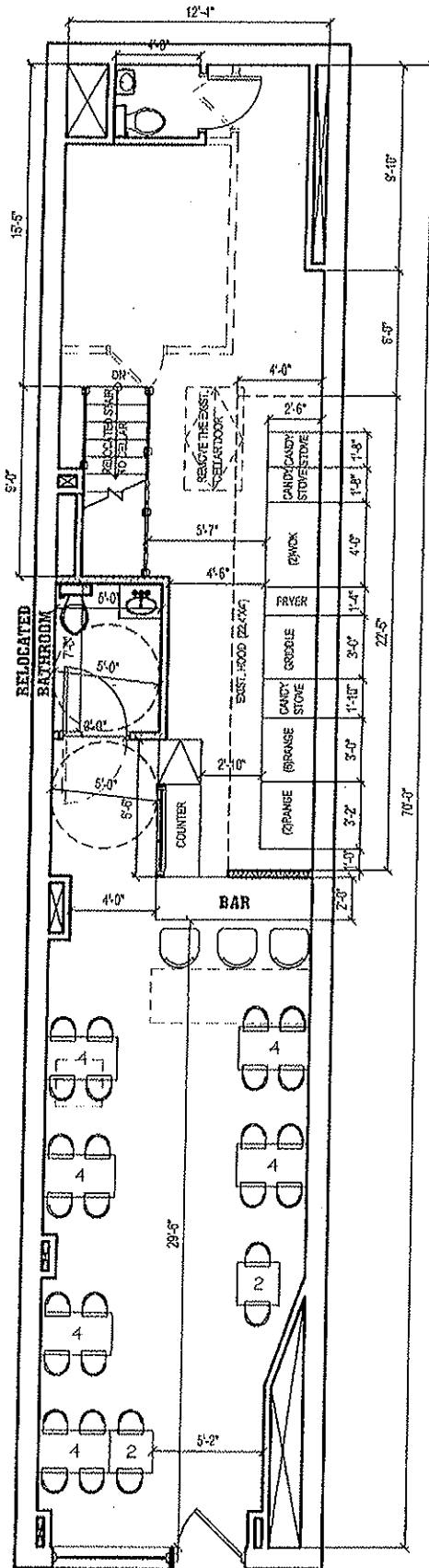



Examples of Diagrams

West 49<sup>th</sup> Street

West 49<sup>th</sup> Street

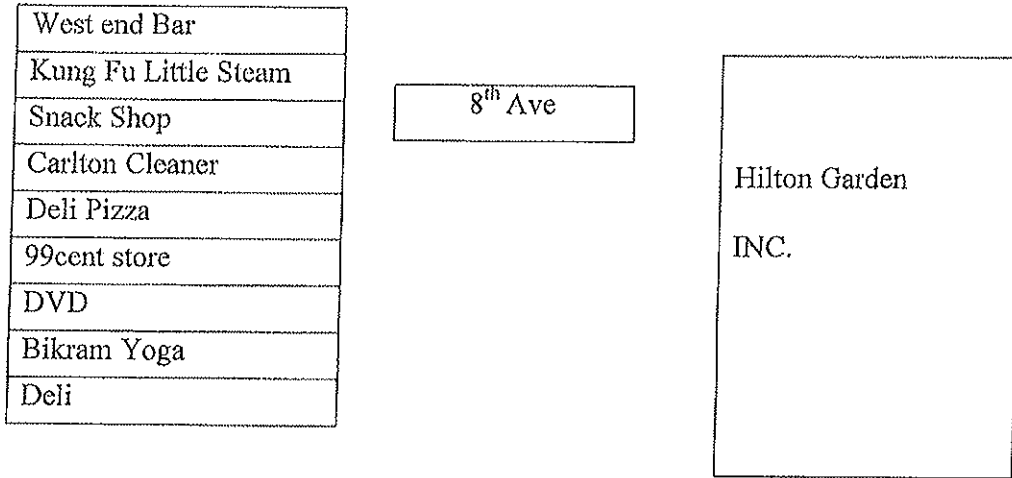

West 48<sup>th</sup> Street

West 48<sup>th</sup> Street

Front Elevation Diagram.

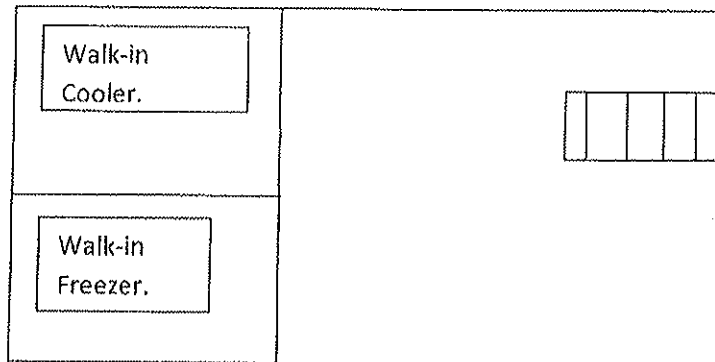
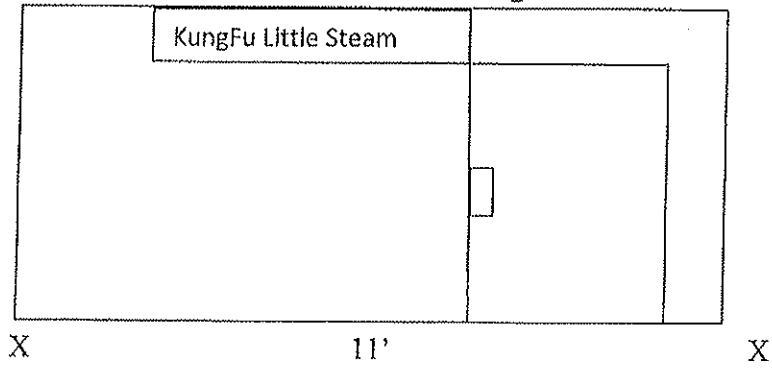



# 功夫小笼包

KUNG  FU

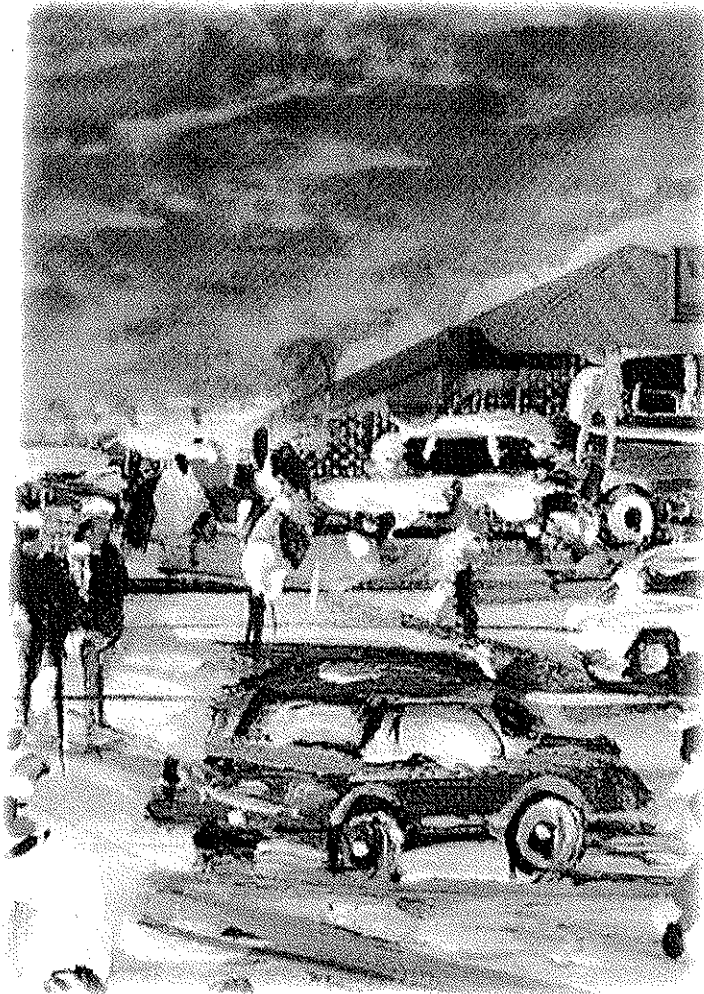

# Breakfast

## 早点

1.Sweet Soy Milk

甜豆浆..... \$ 2.00

2.Salted Soy Milk

咸豆浆..... \$ 2.50

3.Iced Soy Milk

冰豆浆..... \$ 2.25

4.Sweet Soy Bean Curd

甜豆花..... \$ 2.00

5.Salted Soy Bean Curd

咸豆花..... \$ 2.50

6.Crispy Fried Dough

油条..... \$ 2.00

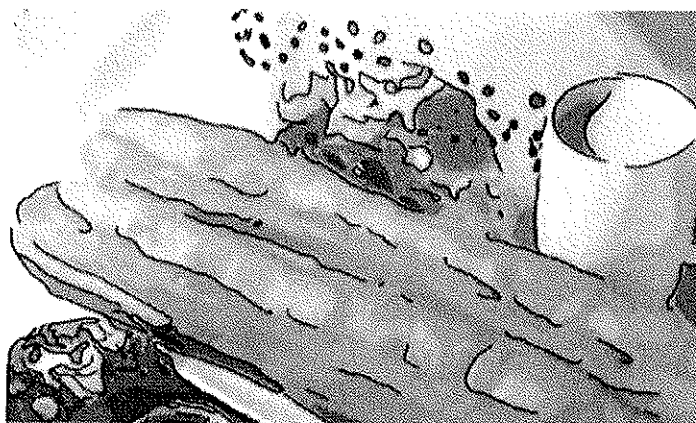

## Cold Dish/ Appetizer

### 美味凉菜

1. Marinated Gluten  
四鲜烤麸 ..... \$ 6.00
2. Shanghai Shu Ji  
上海素鸡 ..... \$ 6.00
3. Cucumber Garlic  
脆口青瓜 ..... \$ 5.50
4. Sliced Beef In Spicy Sauce  
五香牛肉 ..... \$ 7.25
5. Wined Pork Knuckles  
清醉猪蹄 ..... \$ 7.25
6. Shredded Spicy Cabbage  
辣白菜 ..... \$ 5.25
7. Potato Salad Red Oil  
红油土豆丝 ..... \$ 5.00
8. Tofu Shred  
豆干丝 ..... \$ 6.50
9. Pork With Bean Curd Sheet  
百页结烤肉 ..... \$ 7.25
10. Boiled Peanuts  
花生 ..... \$ 5.00
11. Vietnamese Summer Roll  
越南卷 ..... \$ 6.50
12. Japanese Seaweed Salad  
日本海苔 ..... \$ 6.50
13. Green Soy Bean Pod  
毛豆荚 ..... \$ 5.00



# KUNG FU DIM SUM

## 功夫点心

-  1. Scallion Pancake  
葱油饼 ----- \$ 3.50
-  2. Scallion Pancake With  
Sliced Beef  
牛肉夹饼 ----- \$ 5.50
-  3. Fried Bun With  
Chives & EGG ( 2 )  
韭菜合子 ----- \$ 3.50
-  4. Red Bean Puffs ( 4 )  
豆沙酥饼 ( 4 ) ----- \$ 4.00
-  5. Turnip Puffs ( 4 )  
萝卜丝酥饼 ----- \$ 4.00
-  6. Steamed Vegetable  
Buns ( 2 )  
香菇菜包 ----- \$ 4.75
-  7. Peking Duck Bun ( 2 )  
北京鸭包 ----- \$ 5.50
-  8. Shanghai Spring Roll ( 2 )  
上海春卷 ----- \$ 2.75

# KUNG FU DIM SUM

## 功夫点心

1.Kungfu Steamed Pork

Buns ( 6 )



功夫小笼包 ----- \$ 7.25

2.Steamed Crab Meat Pork

Buns ( 6 )



蟹粉小笼包 ----- \$ 8.95

3.Shrimp&vegetable

Steamed Pork Buns ( 6 )



虾仁丝瓜小笼包 ----- \$ 8.95

4.Steamed Vegetable

Buns ( 6 )



清素小笼包 ----- \$ 7.25

6.Shanghai Pan Fried Pork

Buns ( 6 )



上海生煎包 ----- \$ 7.25

7.Pan Fried Dumplings ( 6 )



生煎锅贴 ----- \$ 6.50

# KUNG FU DIM SUM

## 功夫點心

1. Steamed Vegetable  
Dumplings ( 6 )



素蒸餃 ----- \$ 6.50

2. Chicken Dumplings ( 6 )



雞餃 ----- \$ 6.50

3. Pork Dumplings ( 6 )



豬肉餃 ----- \$ 6.50

4. Shrimp & pork Dumpling



三鮮餃 ----- \$ 7.50

5. Pork Vegetable Wonton  
in Casserole ( 6 )



芥菜云吞 ----- \$ 7.25

6. Sweet Sticky Rice



秘制八寶飯 ----- \$ 4.50

7. Sticky Rice Ball In Chinese  
Sweet Liqueur



酒釀圓子 ----- \$ 6.50

## Ramen/Sliced Noodle 拉面/刀削面

1. "House Special Ramen ( Shrimp/虾 ,  
Egg/鸡蛋 , Beef/牛肉 , Pakchoi/青菜 )"  
本楼拉面 ----- \$ 10.50

2. Beef Ramen  ----- \$ 8.75  
牛肉拉面

3. Chicken Ramen  
鸡肉拉面 ----- \$ 8.75

4. Shrimp Tempura Ramen  
虾拉面 ----- \$ 9.25

5. Roast Duck Ramen  ----- \$ 9.25  
烤鸭拉面

6. Spicy Beef Ramen  
牛肉辣酱面 ----- \$ 8.75

7. Assorted Vegetable Ramen  
蔬菜拉面 ----- \$ 8.75

8. Cold Sesame Ramen  
凉拌面 ----- \$ 8.75



# Teriyak 烧烤

- |   |                                       |         |
|---|---------------------------------------|---------|
|    | 1.Chicken stick<br>鸡肉串-----           | \$ 2.00 |
|    | 2.Beef stick<br>牛肉串-----              | \$ 2.00 |
|    | 3.Lamb stick<br>羊肉串-----              | \$ 2.00 |
|    | 4.Chicken heart stick<br>鸡心串-----     | \$ 2.00 |
|    | 5.Fish Ball stick<br>鱼丸串-----         | \$ 3.00 |
|  | 6.Fish TOFU<br>鱼豆腐串-----              | \$ 3.00 |
|  | 7.Squid stick<br>鱿鱼串-----             | \$ 3.00 |
|  | 8.Chicken Wing stick<br>鸡翅串-----      | \$ 3.00 |
|  | 9.Chives stick<br>韭菜串-----            | \$ 2.00 |
|  | 10.Broccoli stick<br>芥兰串-----         | \$ 2.00 |
|  | 11.Mushroom stick<br>蘑菇串-----         | \$ 2.00 |
|  | 12.String Bean stick<br>四季豆串-----     | \$ 2.00 |
|  | 13.Long Hot Pepper stick<br>牛角椒串----- | \$ 2.00 |

# Fried noodle

## 炒面

### 1.Pork Fried Noodle

 猪肉炒面 -----\$ 10.95

### 2.Chicken Fried Noodle

 鸡肉炒面 -----\$ 10.95

### 3.Beef Fried Noodle

 牛肉炒面 -----\$ 10.95

### 4.Shrime Fried Noodle

 虾炒面 -----\$ 11.95

### 5.vegetable Fried Noodle

 蔬菜炒面 -----\$ 10.95

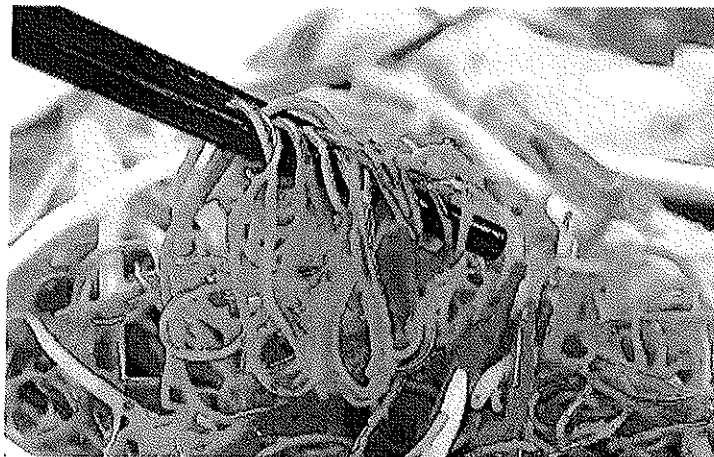

## Desserts&cold Drinks

### 饮品

1.Milk tea



奶茶 ..... \$ 2.50

2.Tapioca Black Milk Tea



珍珠奶茶 ..... \$ 3.50

3.Taro Milk Tea



芋香奶茶 ..... \$ 3.50

4.soda



汽水 ..... \$ 2.00

5.China ice tea



中国凉茶 ..... \$ 3.00

