

Manhattan Community Board 4

(All Fields Must Be Completed)

Liquor License Stipulations Application

APPLICANT		DOING BUSINESS AS (DBA)		
RTC 18 Corp.		N/A		
ADDRESS		LICENSE ADDRESS		
166 8th Avenue, New York, NY 10011		WEST 18 STREET&WEST 19		
OWNER	NAME	Chi Yan Ng	ATTORNEY NAME	
	PHONE	917-572-6112	ATTORNEY PHONE	
	FAX		ATTORNEY FAX	
MANAGER	NAME	Thomas Ng	LANDLORD NAME	
	PHONE	646-773-1055	LANDLORD PHONE	
	FAX		LANDLORD FAX	
Establishment Type: <input type="radio"/> Bar/Tavern <input type="radio"/> Bed & Breakfast <input type="radio"/> Eating Place Beer <input type="radio"/> Cabaret <input type="radio"/> Night Club <input type="radio"/> Hotel <input checked="" type="radio"/> Restaurant <input type="radio"/> Catering Establishment <input type="radio"/> Club (Fraternal Organization - Members Only) <input type="radio"/> Other (Explain): _____				
Method of Operation: <input checked="" type="radio"/> Restaurant <input type="radio"/> Dance Club <input type="radio"/> Sports Bar <input type="radio"/> Adult Entertainment <input type="radio"/> Wine Bar <input type="radio"/> Pizzeria <input type="radio"/> Cafe <input type="radio"/> Other (Explain): _____				
License Type: <input checked="" type="radio"/> On-Premise <input type="radio"/> Wine <input type="radio"/> Beer <input type="radio"/> Wine & Beer				
APPLICATION TYPE (check one)	<input type="radio"/> New	Has applicant owned or managed a similar business?	YES	NO
		What is/was the name of establishment?		
		What is/was the address of the establishment?		
		What were the dates the applicant was involved with this former premise?		
	<input checked="" type="radio"/> Transfer	What is the prior license #?	1177404	
		What is the expiration date on the prior license?	06/30/2014	
		Are you making any alterations or operational changes?	YES	NO <input checked="" type="radio"/>
		<i>If alterations or operational changes are being made, please attach the plans to this form.</i>		
	<input type="radio"/> Alteration	What is the current license #?		
		What is the expiration date on the current license?		
<i>Please describe the nature of the alterations and attach the plans</i>				

	MONDAY	TUESDAY	WEDNESDAY	THURSDAY	FRIDAY	SATURDAY	SUNDAY
11AM-10PM	11AM-10PM	11AM-10PM	11AM-10PM	11AM-10PM 12A	11AM-10PM 12A	11AM-10PM 12A	11AM-10PM
11AM-10PM	11AM-10PM	11AM-10PM	11AM-10PM	11AM-10PM 12A	11AM-10PM 12A	11AM-10PM 12A	11AM-10PM
11AM-10PM	11AM-10PM	11AM-10PM	11AM-10PM	11AM-10PM 12A	11AM-10PM 12A	11AM-10PM 12A	11AM-10PM

Number of Employees	Maximum Number of Persons Per Occupancy (Employees/Customers)	Number of Tables	Number of Seats	Number of Servers/Waiters	Number of Bartenders	Number of Cashiers	Number of Security Personnel
LNO/74	70	12	41	0	1	5	N/A

How many floors are there? What is the capacity for each floor? (please respond in space provided)	<input checked="" type="radio"/>	<input type="radio"/>	<input type="radio"/>
Will you be applying or intending to apply for a cabaret license? If yes, will there be dancing? (please respond in space provided)	YES	<input checked="" type="radio"/>	N/A
Will applicant have bottle service?	YES	<input checked="" type="radio"/>	N/A
Will you be hosting private parties and promotional events?	YES	<input checked="" type="radio"/>	N/A
Will outside promoters be used?	YES	<input checked="" type="radio"/>	N/A
Will the security plan submitted be implemented?	YES	NO	<input checked="" type="radio"/>
Will State certified security personnel be used?	YES	NO	<input checked="" type="radio"/>
Will New York Nightlife Association recommendations and NYPD Best Practices be followed?	YES	NO	<input checked="" type="radio"/>
Will the applicant be using delivery bicycles? If yes, have you applied to DOT for bicycle rack? Delivery bicycles are to be clearly marked with the name of the restaurant and staff will wear attire clearly noting name. (please respond in space provided)	YES	<input checked="" type="radio"/>	N/A
Will the applicant be applying for a Sidewalk Café now or in the future? (please respond in space provided)	YES	<input checked="" type="radio"/>	N/A
If yes to the above, are plans attached and submitted to DCA? How many tables/seats? (please respond in space provided)	YES	NO	<input checked="" type="radio"/>
Will applicant provide contact information to neighbors and respond to complaints that arise?	<input checked="" type="radio"/>	NO	N/A
Will you inform the Community Board office of your job openings and/or provide a hyperlink to your jobs webpage?	<input checked="" type="radio"/>	NO	N/A
If you plan to have music, what type(s)?	<input checked="" type="radio"/>	LIVE MUSIC	DJ

Doors and windows will be closed when any amplified music is played and in the event of no amplified sound, will be closed by 11 PM Friday and Saturday and 10 PM on all other days.	<input checked="" type="radio"/>	NO	N/A
Will applicant follow the recommendations of a certified sound engineer to mitigate potential noise disturbance to the neighboring residents and buildings, including placing speakers on the floor of the establishment?	<input checked="" type="radio"/>	NO	N/A
Do you agree to comply with DOB rules concerning a storm enclosure? Storm enclosures can be used between November 15 and April 15, but they may NOT project more than 18 inches from the store front.)	<input checked="" type="radio"/>	NO	N/A

Will applicant use the rooftop, rear yard or any outdoor space?	YES	<input checked="" type="radio"/> NO	<input type="radio"/> N/A
If yes to the above, the rear yard, rooftop, and any outdoor space will be closed and vacated by 11 PM on Friday & Saturday and 10 PM on all other days.	YES	<input type="radio"/> NO	<input checked="" type="radio"/> N/A
The service and consumption of alcohol in the rear yard, on the rooftop, or in any other outdoor space will be only via seated food service.	YES	<input type="radio"/> NO	<input checked="" type="radio"/> N/A
The rear yard, rooftop, and any other outdoor space will not allow standing space for patrons to drink or smoke.	YES	<input type="radio"/> NO	<input checked="" type="radio"/> N/A
Applicant will do everything in their power to provide an effective sound baffling or sound controlled environment through landscaping or some type of enclosure, where possible; provided they do not violate any fire or building code regulations? This includes possibly working with landlords for soundproofing tenants apartments (such as installing soundproofing windows, acoustical tiles, etc.).	YES	<input type="radio"/> NO	<input checked="" type="radio"/> N/A
Applicant will enforce a quiet environment in the outdoor space, so as not to disturb nearby residents (e.g. there will be no amplified music, as per the law, and windows and doors to areas that play amplified music shall be closed). The applicant will make every effort possible to limit the noise emanating from diners by posting signs outside and also on menus asking for respect of the neighbor's privacy and peace. The staff will also encourage a peaceful environment amongst the outdoor diners.	YES	<input type="radio"/> NO	<input checked="" type="radio"/> N/A
Applicant will have a lighting plan that will allow safe usage of the outdoor space without disrupting neighbors?	YES	<input type="radio"/> NO	<input checked="" type="radio"/> N/A

Primary Zoning District:	C2-7A R8B		Overlay (If Applicable):	
Is this a Special District? If yes, is it Clinton, West Chelsea or Hudson Yards?	YES	<input checked="" type="radio"/> NO	<input type="radio"/> N/A	
Does the building have a Certificate of Occupancy ("C of O") or a letter of no objection?	<input checked="" type="radio"/> YES	<input type="radio"/> NO	<input type="radio"/> N/A	
Is the 500 Foot Rule or 200 Foot Rule Triggered? If yes, which? Please attach a diagram of the establishments that triggers the rule.	YES	<input type="radio"/> NO	<input checked="" type="radio"/> N/A	
Is a Public Assembly permit required?	YES	<input checked="" type="radio"/> NO	<input type="radio"/> N/A	
Are your plans filed with DOB?	YES	<input checked="" type="radio"/> NO	<input type="radio"/> N/A	
Building Type	<input type="radio"/> Residential <input type="radio"/> Commercial <input checked="" type="radio"/> Mixed Use <input type="radio"/> Other, describe: _____			
Adjacent Buildings	<input checked="" type="radio"/> Residential <input type="radio"/> Commercial <input type="radio"/> Mixed Use <input type="radio"/> Other, describe: _____			
NOTIFICATION: What organizations / community groups have you notified regarding your application?	# 1			
	# 2			
	# 3			

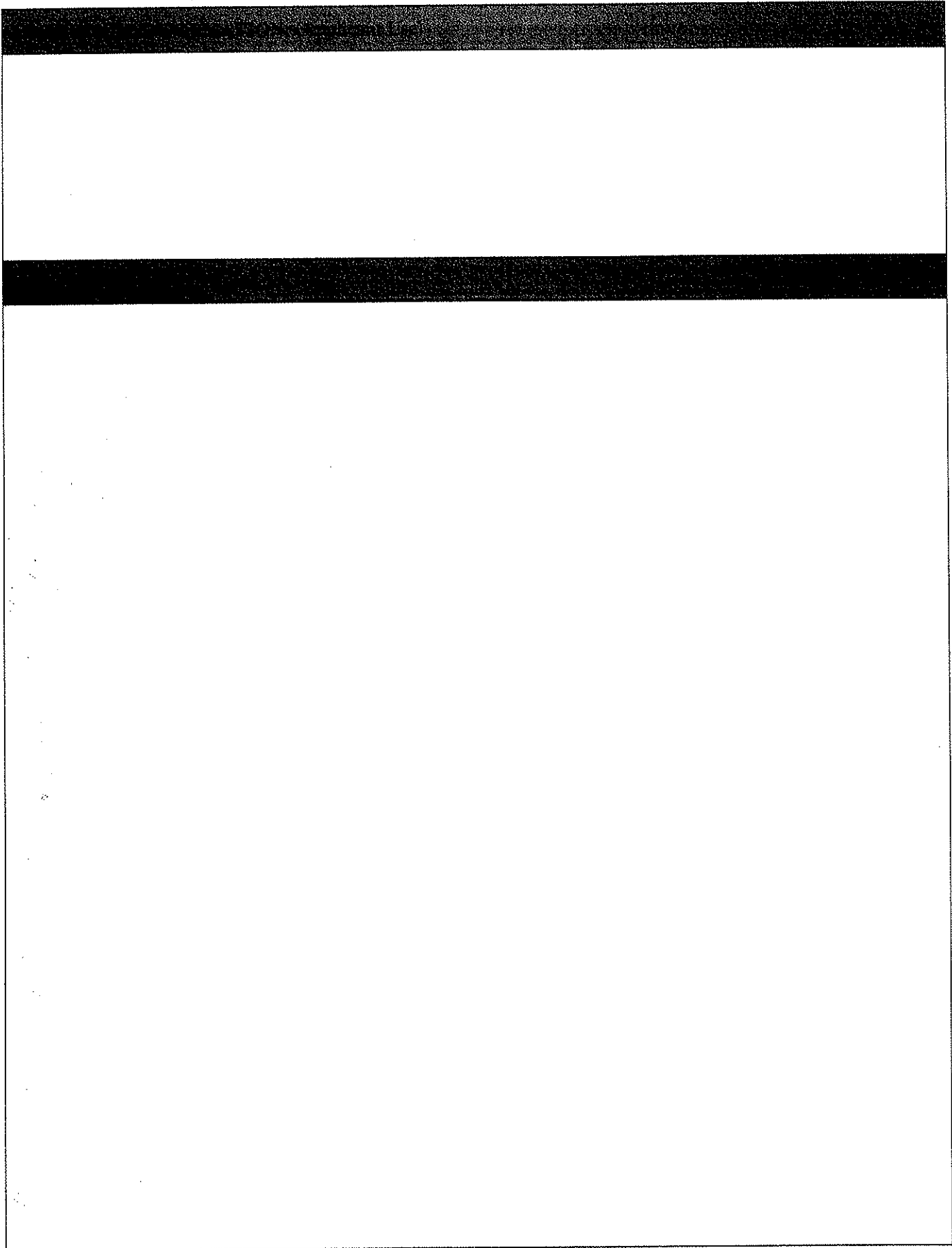

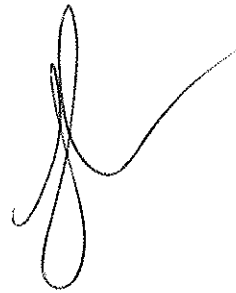

will close windows at 10PM on
Sun - Thurs & 11PM Fri - Sat.

A handwritten signature in black ink, consisting of a stylized, cursive letter 'R' followed by a horizontal line extending to the right.

Manhattan Community Board 4 (MCB4) recommends:

Approval Denial unless all agreed to by applicant is part of the method of operation Denial

Nelly Gonzalez
CB4 Community Associate

Lisa Daglian
CB4 BLP Committee Co-Chair

Paul Seres
CB4 BLP Committee Co-Chair

Pursuant to these stipulations, this applicant agrees to have these provisions incorporated in the method of operation of their liquor license. Additionally, the applicant agrees to the community agreements as the basis for the community supporting this application.

SIGNATURE OF APPLICANT

09/22/2013

DATE

OFFICE USE ONLY		
<input type="radio"/> Original	<input type="radio"/> Amended	Date

500 FOOT RULE STATEMENT

**Applicants for on premises liquor licenses must complete this section
(Not required for on premises beer or wine application)**

If the location is subject to the 500 foot rule, and no other exception applies, the license cannot be issued unless the State Liquor Authority makes an affirmative finding that it is in the public interest to issue the license.

The provisions of Section 64, 64-a, 64-c and 64-d of the ABC Law require the Authority to consult with the municipality or community board prior to granting a license for **ANY ON PREMISES LIQUOR ESTABLISHMENTS** where such premises is located within 500' of three or more similarly licensed premises. The Authority is further required to conduct a public hearing, upon notice to the applicant and the municipality or the community board.

The proposed premises: Check the appropriate box below:

- PREMISES IS NOT WITHIN A 500' RADIUS OF THREE OR MORE ESTABLISHMENTS HOLDING ON PREMISES LIQUOR LICENSES.
- PREMISES IS WITHIN A 500' RADIUS OF THREE OR MORE ESTABLISHMENTS SELLING LIQUOR FOR ON PREMISES CONSUMPTION. (IF SO, YOU MUST COMPLETE THE WRITTEN STATEMENT BELOW AND SUBMIT THE NAMES AND ADDRESSES OF THE ESTABLISHMENTS WITHIN THE 500' RADIUS, *UNLESS THE PREMISES HAS BEEN CONTINUOUSLY LICENSED ON OR PRIOR TO NOVEMBER 1, 1993.*)
- NOT APPLICABLE - PREMISES HAS BEEN CONTINUOUSLY LICENSED ON OR PRIOR TO NOVEMBER 1, 1993
- NOT APPLICABLE - POPULATION UNDER 20,000

YOU MUST PROVIDE THE NAMES OF ALL ON PREMISES LIQUOR ESTABLISHMENTS LOCATED WITHIN 500' OF THE PROPOSED PREMISES

IMPORTANT:

If premises is within a 500' radius of three or more establishments holding on premises liquor licenses and has not been continuously licensed since November 1, 1993 and the population is over 20,000 you must, **SUBMIT A WRITTEN STATEMENT EXPLAINING IN DETAIL WHY YOU BELIEVE ISSUANCE OF THE LICENSE WOULD BE IN THE PUBLIC INTEREST.**

FAILURE TO SUBMIT THIS INFORMATION MAY RESULT IN DISAPPROVAL OF THE LICENSE APPLICATION.

Most, if not all, Thai restaurant provide alcoholic beverage upon it is customary. It is part of Thailand culture and tradition to serve beer, wine and liquor with Thai food. The liquor is as essential to an authentic meal as the Thai food it is served with. Since we are an Thai restaurant we would like to provide our customers with a true experience. Although there are restaurant within a 500 feet radius which serve alcoholic drinks, these restaurants are very different in styles. There will be no dancing or improper behavior within our premise. We only wish serve liquor with our dishes to enhance the dining experience and bring a flavor of Thailand to our customers.

On-Premises Licenses within 500 Feet

Name	Address	Approx. Distance
ROOM SERVICE II INC	166 8TH AVENUE	15 ft
TEAM MWB LLC	167 8TH AVENUE	50 ft
POUNDS & OUNCES LLC	160 8TH AVE	75 ft
E Z JOINT VENTURES LLC	169 8TH AVENUE	80 ft
MAGNUMS IN PARIS LLC	158 8TH AVE	105 ft
KHANDAKAR R AMIN	155 8TH AVENUE	135 ft
EL CID RESTAURANT INC	174 8TH AVE	140 ft
151 ROYS REST INC	151 8TH AVENUE	190 ft
BANGKOK BISTRO 148 INC	150 8TH AVENUE	215 ft
CHIPOTLE MEXICAN GRILL OF	149 8TH AVE	220 ft
BUCKWHEAT & ALFALFA INC	182 8TH AVENUE	240 ft
ANEMACORE LLC	184 EIGHTH AVE	265 ft
PRINCESSA 62 CORP	311 W 17TH ST	310 ft
190 RESTAURANT CORP	190 8TH AVENUE	340 ft

PRODUCED BY AN AUTODESK EDUCATIONAL PRODUCT

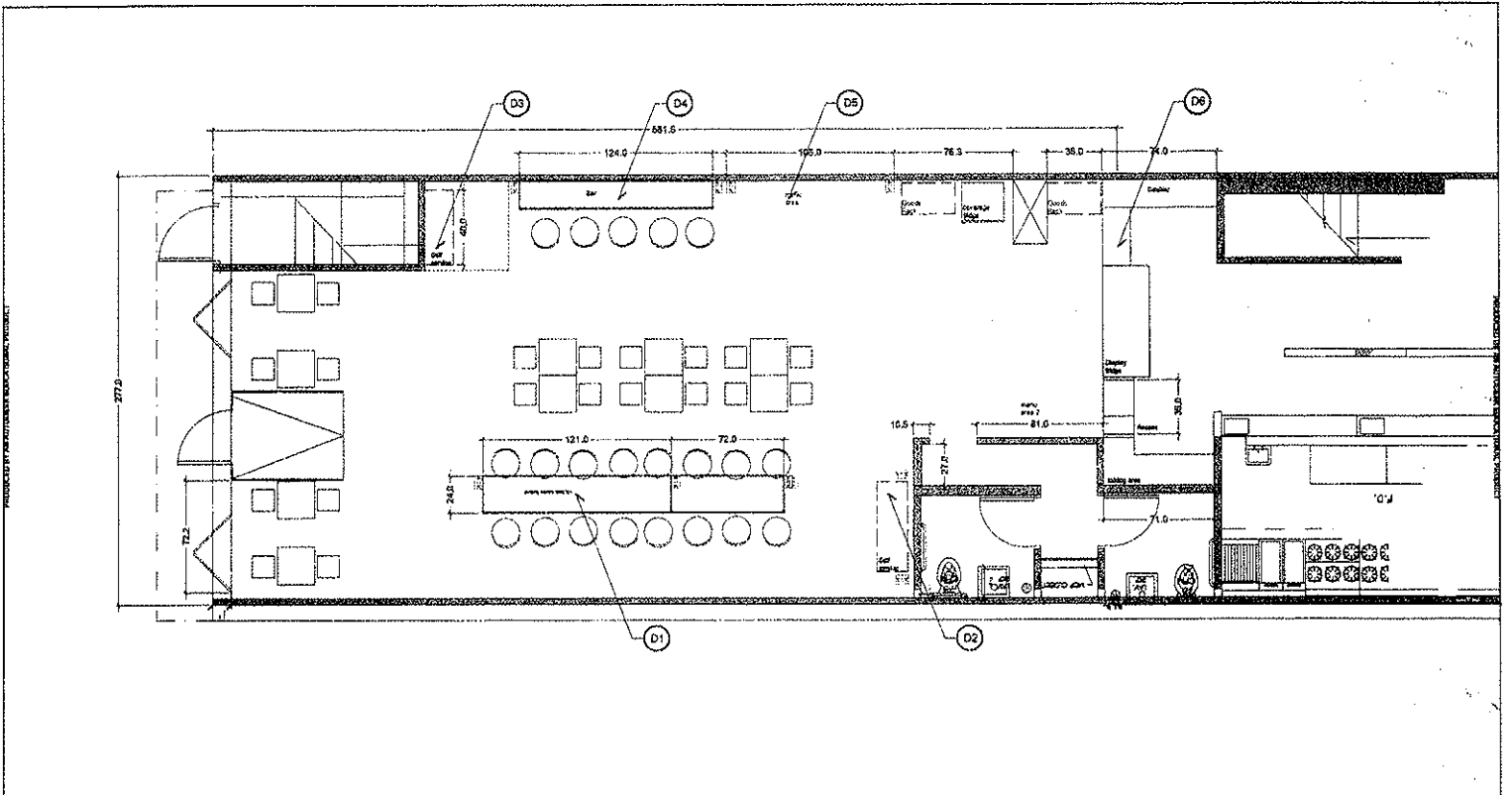

PRODUCED BY AN AUTODESK EDUCATIONAL PRODUCT

Mon-Thru 11:00 AM-11:30 PM
 Friday 11:50 AM-1:00 AM
 Saturday 12:00 PM-1:00 AM
 Sunday 12:00 PM-11:00 PM

Appetizers

Eat like a Bangkokian

Traditional Bangkokian
 Performance Cuisine

THE BLUE OX

The Blue Ox
 History
 The Blue Ox
 History
 The Blue Ox
 History

Local Dishes

LUNCH
STARTING AT \$7.50

The Blue Ox
 History
 The Blue Ox
 History
 The Blue Ox
 History
 The Blue Ox
 History

Room Service

