

# Manhattan Community Board 4

(All Fields Must Be Completed)

# Liquor License Stipulations Application

<b>APPLICANT</b> Rim Nam Corp.		<b>DOING BUSINESS AS (DBA)</b> Siri Thai		
<b>STREET ADDRESS</b> 641 10th Avenue, New York, NY 10036		<b>CROSS STREETS</b> West 45th street and West 46th Street		
<b>OWNER</b>	<b>NAME:</b> Phawadee Ektheerachaisakul	<b>Rep.</b> <del>ATTORNEY</del>	<b>NAME:</b> Anthony L. Caraballo	
	<b>PHONE:</b> (917) 371-0526		<b>PHONE:</b> (718) 875-2929	
	<b>FAX:</b>		<b>FAX:</b> (718) 875-3737	
<b>co-owner</b> <b>MANAGER</b>	<b>NAME:</b> Praphai Siriwatanakul	<b>LANDLORD</b>	<b>NAME:</b> 641 10th Avenue LLC	
	<b>PHONE:</b> (646) 244-7664		<b>PHONE:</b> (212) 757-8888	
	<b>FAX:</b>		<b>FAX:</b>	
<b>DESCRIPTION OF BUSINESS</b>				
<b>Establishment Type:</b>		<input type="radio"/> Bar/Tavern <input type="radio"/> Bed & Breakfast <input type="radio"/> Eating Place Beer <input type="radio"/> Cabaret <input type="radio"/> Night Club <input type="radio"/> Hotel <input checked="" type="radio"/> Restaurant <input type="radio"/> Catering Establishment <input type="radio"/> Club (Fraternal Organization - Members Only) <input type="radio"/> Other (Explain): _____		
<b>Method of Operation:</b>		<input checked="" type="radio"/> Restaurant <input type="radio"/> Dance Club <input type="radio"/> Sports Bar <input type="radio"/> Adult Entertainment <input type="radio"/> Wine Bar <input type="radio"/> Pizzeria <input type="radio"/> Cafe <input type="radio"/> Other (Explain): _____		
<b>License Type:</b>		<input type="radio"/> On-Premise <input type="radio"/> Wine <input type="radio"/> Beer <input checked="" type="radio"/> Wine & Beer		
<b>APPLICATION TYPE</b> (check one)	<input checked="" type="radio"/> <b>New</b>	Has applicant owned or managed a similar business?	<input checked="" type="radio"/> YES      NO	
		What is/was the name of establishment?	Real Thai	
		What is/was the address of the establishment?	1069 1st Ave. NYC	
		What were the dates the applicant was involved with this former premise?	2008-Present	
	<input type="radio"/> <b>Transfer</b>	What is the prior license #?		
		What is the expiration date on the prior license?		
		Are you making any alterations or operational changes?	<input type="radio"/> YES <input type="radio"/> NO	
	If alterations or operational changes are being made, please attach the plans to this form.			
	<input type="radio"/> <b>Alteration</b>	What is the current license #?		
		What is the expiration date on the current license?		
Please describe the nature of the alterations and attach the plans				

**OPERATIONAL ISSUES**

HOURS		MONDAY	TUESDAY	WEDNESDAY	THURSDAY	FRIDAY	SATURDAY	SUNDAY
	Operation	11am-12am	11am-12am	11am-12am	11am-12am	11am-12am	11am-12am	11am-12am
	Music	All open hours (background only)						
	Kitchen	11am-11:45pm	11am-11:45pm	11am-11:45pm	11am-11:45pm	11am-11:45pm	11am-11:45pm	11am-11:45pm

OCCUPANCY	INDOOR				BAR			OUTSIDE	
	Capacity (Certificate of Occupancy)	Maximum # of Persons You Anticipate Occupying Premises (Including Employees)	Number of Tables	Number of Seats	Number of Service Only Bars	Number of Stand-Up Bars	Number of Seats at Bars	Number of Seats	Number of Tables
	Letter of no objection under 74	49	12	24	None	None	N/A	N/A	N/A

How many floors are there? What is the capacity for each floor? (please respond in space provided)	1-2	3-4	5+	One, 49
Will you be applying or intending to apply for a cabaret license? If yes, will there be dancing? (please respond in space provided)	YES	<input checked="" type="radio"/> NO	N/A	
Will applicant have bottle service?	YES	<input checked="" type="radio"/> NO	N/A	
Will you be hosting private parties and promotional events?	YES	<input checked="" type="radio"/> NO	N/A	
Will outside promoters be used?	YES	<input checked="" type="radio"/> NO	N/A	
Will the security plan submitted be implemented?	YES	<input checked="" type="radio"/> NO	N/A	
Will State certified security personnel be used?	YES	<input checked="" type="radio"/> NO	N/A	
Will New York Nightlife Association recommendations and NYPD Best Practices be followed?	<input checked="" type="radio"/> YES	NO	N/A	
Will the applicant be using delivery bicycles? If yes, have you applied to DOT for bicycle rack? Delivery bicycles are to be clearly marked with the name of the restaurant and staff will wear attire clearly noting name. (please respond in space provided)	<input checked="" type="radio"/> YES	NO	N/A	Applicant has requested DOT bicycle rack.
Will the applicant be applying for a Sidewalk Café now or in the future? (please respond in space provided)	YES	<input checked="" type="radio"/> NO	N/A	
If yes to the above, are plans attached and submitted to DCA? How many tables/seats? (please respond in space provided)	YES	NO	<input checked="" type="radio"/> N/A	
Will applicant provide contact information to neighbors and respond to complaints that arise?	<input checked="" type="radio"/> YES	NO	N/A	
Will you inform the Community Board office of your job openings and/or provide a hyperlink to your jobs webpage?	YES	NO	<input checked="" type="radio"/> N/A	

If you plan to have music, what type(s)?	<input checked="" type="radio"/> BACKGROUND	<input type="radio"/> LIVE MUSIC	<input type="radio"/> DJ
--	---	----------------------------------	--------------------------

**BUILDING DESIGN**

Doors and windows will be closed when any amplified music is played and in the event of no amplified sound, will be closed by 11 PM Friday and Saturday and 10 PM on all other days.	<input checked="" type="radio"/> YES	NO	N/A
Will applicant follow the recommendations of a certified sound engineer to mitigate potential noise disturbance to the neighboring residents and buildings, including placing speakers on the floor of the establishment?	<input checked="" type="radio"/> YES	NO	N/A
Do you agree to comply with DOB rules concerning a storm enclosure? Storm enclosures can be used between November 15 and April 15, but they may NOT project more than 18 inches from the store front.)	<input checked="" type="radio"/> YES	NO	N/A

**OUTDOOR ITEMS**

Will applicant use the rooftop, rear yard or any outdoor space?	YES	<input checked="" type="radio"/> NO	N/A
If yes to the above, the rear yard, rooftop, and any outdoor space will be closed and vacated by 11 PM on Friday & Saturday and 10 PM on all other days.	YES	NO	<input checked="" type="radio"/> N/A
The service and consumption of alcohol in the rear yard, on the rooftop, or in any other outdoor space will be only via seated food service.	YES	NO	<input checked="" type="radio"/> N/A
The rear yard, rooftop, and any other outdoor space will not allow standing space for patrons to drink or smoke.	YES	NO	<input checked="" type="radio"/> N/A
Applicant will do everything in their power to provide an effective sound baffling or sound controlled environment through landscaping or some type of enclosure, where possible; provided they do not violate any fire or building code regulations? This includes possibly working with landlords for soundproofing tenants apartments (such as installing soundproofing windows, acoustical tiles, etc.).	YES	NO	<input checked="" type="radio"/> N/A
Applicant will enforce a quiet environment in the outdoor space, so as not to disturb nearby residents (e.g. there will be no amplified music, as per the law, and windows and doors to areas that play amplified music shall be closed). The applicant will make every effort possible to limit the noise emanating from diners by posting signs outside and also on menus asking for respect of the neighbor's privacy and peace. The staff will also encourage a peaceful environment amongst the outdoor diners.	YES	NO	<input checked="" type="radio"/> N/A
Applicant will have a lighting plan that will allow safe usage of the outdoor space without disrupting neighbors?	YES	NO	<input checked="" type="radio"/> N/A

**LOCATION & ZONING**

Primary Zoning District:	C 6-3	Overlay (If Applicable):	
Is this a Special District? If yes, is it Clinton, West Chelsea or Hudson Yards?	YES	<input checked="" type="radio"/> NO	N/A
Does the building have a Certificate of Occupancy ("C of O") or a letter of no objection?	<input checked="" type="radio"/> YES	NO	N/A
Is the 500 Foot Rule or 200 Foot Rule Triggered? If yes, which? Please attach a diagram of the establishments that triggers the rule.	YES	<input checked="" type="radio"/> NO	N/A (This is for Beer & Wine only)
Is a Public Assembly permit required?	YES	<input checked="" type="radio"/> NO	N/A
Are your plans filed with DOB?	YES	<input checked="" type="radio"/> NO	N/A
Building Type	<input type="radio"/> Residential <input type="radio"/> Commercial <input checked="" type="radio"/> Mixed Use <input type="radio"/> Other, describe: _____		
Adjacent Buildings	<input type="radio"/> Residential <input type="radio"/> Commercial <input checked="" type="radio"/> Mixed Use <input type="radio"/> Other, describe: _____		
<b>NOTIFICATION:</b> What organizations / community groups have you notified regarding your application?	# 1	Block Association West 45th Street between 9-11 Avenues	
	# 2	Block Association West 46th Street	
	# 3		

**ADDITIONAL INFORMATION: (Applicant Use)**

Please find attached the email to the West 45th Street Block Association about this application.  
Please also be advised that we attempted to contact the West 46th Block Association on 3 occasions and the emails were returned.  
Pursuant to our dialog with Erica Baptiste we are awaiting an email from a member of the Block Association in regard to this application.

**ADDITIONAL NOTES: (Office Use Only)**

Manhattan Community Board 4 (MCB4) recommends:	<input type="radio"/> Approval <input checked="" type="radio"/> Denial unless all agreed to by applicant is part of the method of operation <input type="radio"/> Denial
--	--

**CB4 REPRESENTATIVES**

 Nelly Gonzalez CB4 Community Associate	Lisa Daglian CB4 BLP Committee Co-Chair	 Paul Sires CB4 BLP Committee Co-Chair
--	--	--

**APPLICANT AGREEMENT WITH THE COMMUNITY**

Pursuant to these stipulations, this applicant agrees to have these provisions incorporated in the method of operation of their liquor license. Additionally, the applicant agrees to the community agreements as the basis for the community supporting this application.

SIGN HERE →	 SIGNATURE OF APPLICANT	8/20/13 DATE <del>July 17, 2013</del>
-------------	---	--

*X phub*

**ADDITIONAL STIPULATIONS: (Office Use Only)**

## SRI SOUP

- 15 | **TOM YUM GOONG** ~  
shrimp, spring Thai herbs, mushroom, onion, bell pepper
- 5 | **TOM KHA GAI**  
chicken, coconut milk with Thai herbs, mushroom, onion, bell pepper
- 1 | **TOM JERD TAO-HOO**  
tofu, mix veg in clear chicken broth
- 1 | **GINGER SOUP**  
chicken, ginger, mix veg in clear chicken broth

## SALAD

- 1 | **CUCUMBER SALAD**  
cucumber, mix greens, red onion served with Thai vinaigrette dressing
- 1 | **THAI SALAD**  
fresh garden vegetables, fried tofu served with peanut vinaigrette dressing

## YUM

- 1 | **SOM TUM** ~  
shredded papaya, tomato, green bean, peanut, dried shrimp, garlic, lime juice & chili
- 1 | **YUM MA-MUANG** ~  
mango, cashew nut, tomato, red onion, scallion, cilantro, lime juice & chili
- 1 | **LARB GAI** ~  
marinated chicken, red onion, scallion, roasted rice, mint, lime juice & chili
- 1 | **YUM WOON SEN** ~  
shrimp & squid with glass noodle, tomato, red onion, scallion, cilantro, lime juice & chili
- 1 | **YUM PED** ~  
crispy duck, pineapple, tomato, cashew nut, red onion, scallion, cilantro, lime juice & chili
- 1 | **YUM NUER** ~  
grilled shell steak sliced, cucumber, tomato, red onion, scallion, cilantro, mint, lime juice & chili
- 1 | **PIAR** ~  
shrimp & calamari, lemon grass, tomato, red onion, scallion, cilantro, mint, lime juice & chili paste

## SRI SNACKS

- 4 | **SPRING ROLL**  
crispy mix veg spring roll served with sweet chili sauce
- 4 | **FRIED TOFU**  
crispy tofu served with chili beanmin sauce & peanut
- 4 | **KARBE PUFF**  
marinated chicken, potato, curry in puff pastry
- 4 | **GRILLED THAI MEATBALL**  
beef Thai meatball, grilled served with chili beanmin sauce
- 5 | **FRESH ROLL**  
shrimp, mix veg, mint, rice paper wrapping, served with beanmin sauce
- 5 | **KANOM JIEB**  
steamed dumpling stuffed chicken & shrimp served with Thai soy sauce
- 5 | **STEAMED YEG DUMPLING**  
mix veg dumpling served with Thai soy sauce
- 5 | **GAI SATAY**  
grilled chicken, served with peanut sauce & cucumber vinaigrette
- 5 | **GU-CHAI**  
crispy dive pancake served with Thai soy sauce
- 5 | **KOW THANG**  
crispy rice cake, chicken & shrimp served with special Sri sauce
- 6 | **MOO YANG**  
grilled pork served with chili bean sauce
- 6 | **MUK TOD**  
crispy calamari served with sweet chili sauce
- 7 | **TIGER SHRIMP**  
crispy shrimp wrapped with bacon strip, served with sweet chili sauce

## CHEF SPECIAL

- 15 | **GAI YANG SOM TUM**  
half chicken marinated in Thai herbs with papaya salad, sticky rice
- 15 | **MASSAMAN NUER** ~  
stew beef, potato, onion, peanut

## ENTREE

- 14 | **GAI RAMA**  
grilled chicken breast with peanut sauce, curry rice
- 15 | **MANGO CURRY** ~  
chicken & shrimp, mango, curry powder in coconut milk
- 15 | **PAD PED HOI** ~  
minced with fresh basil in spices
- 16 | **CRUYING TIGER STEAK** ~  
grilled slice shell steak served with chili bean sauce
- 16 | **TALAY PAD CHA** ~  
mix seafood, okra, chili paste in stirred fry  
\*No Substitution\*
- Served with jasmine rice
- 11 | **CHICKEN PORK TOFU VEG** |  
13 | **BEEF SHRIMP SQUID** |
- PAD GRA PROW** ~  
onion, bell pepper, fresh basil
- PAD KHING**  
ginger, onion, scallion, carrot, mushroom
- PAD PRIOW WAN**  
cucumber, tomato, pineapple, bell pepper, onion, scallion
- PAD CASHW NUT**  
onion, scallion, bell pepper, carrot, celery, pineapple, cashew nut
- PAD PRIG KHING** ~  
chili paste, string bean, bell pepper
- PAD PED NOR-MAI** ~  
bamboo shoot, string bean, carrot, onion, bell pepper
- PAD GRA-TIEM PRIG THAI**  
spice garlic coriander served with steamed mix veg
- PAD TUA-LUN TOW**  
snow pea, baby corn, mushroom, onion, scallion

## LUNCH SPECIAL

- M-F Weekdays (Except Holidays)  
- 11:30AM - 3:30PM  
(Only Stir Fry & Curry dishes include jasmine rice)
- Substitute brown rice | 1.00  
Choice of free selective item:  
Spring Roll | Thai House Salad
- 7.5 | **CHICKEN PORK TOFU** | VEGETABLE |  
8.5 | **BEEF** |  
9.5 | **SHRIMP** | SQUID |

## NOODLES

- Pad Thai  
Pad Key Mao ~  
Pad See Ew  
Hai Lun

## FRIED RICE

- Kow Pad Kana  
Kow Pad Gra Prow ~  
Kow Pad Karsee

## STIR FRY

- Pad Gra Prow ~  
Pad Khing ~  
Pad Priow Wan  
Pad Cashew Nut  
Pad Prig Khing ~  
Pad Ped Nor-Mai ~  
Rama

## CURRY

- Red ~  
Green ~  
Yellow ~  
Massaman ~



**FISH**

161 FILET TILAPIA  
221 WHOLE RED SNAPPER

PLA GRATIEM  
crispy fish in spice garlic coriander

PLA RAD PRIG  
crispy fish in chili sauce

PLA MIENG  
crispy fish in Thai herb spicy lime

PLA CHU CHEE  
crispy fish in special chili paste

PLA MA-NOW  
steamed fish in lime chili juice

PLA PRAW WAN  
crispy fish in sweet & sour sauce

DUCK  
161 Half Duck

PED GRA PROW  
crispy duck, snow peas in thai basil sauce

GANG PED YANG  
crispy duck, pineapple & tomato in thai red curry

PED NOR-MAI  
crispy duck in stirred fry bamboo shoot

PED KHING  
crispy duck in stirred fry ginger

PED MAKHAM  
crispy duck in tamarind sauce

PED PANANG  
crispy duck in panang curry

**CURRY**

served with jasmine rice  
Substitute brown rice | 1.00

111 CHICKEN PORK TOFU VEG |  
131 BEEF SHRIMP |

RED CURRY  
Bamboo shoots, bell peppers, fresh basil, coconut milk

GREEN CURRY  
Bamboo shoots, egg plants, bell peppers, fresh basil, coconut milk

PANANG CURRY  
Bell peppers, lemon leaves, coconut milk

MASSAMAN CURRY  
Potatoes, onions, and peanuts, coconut milk

YELLOW CURRY  
Potatoes, carrots, onions, curry powder in coconut milk

JUNGLE CURRY  
bamboo shoot, mix veg, fresh basil

VEGETARIAN  
121 Mock Duck | ToFu | Veg |

GANK PAK  
mix veg in red curry

MA-KUER GRA PROW  
eggplant, mix veg in basil sauce

MOCK DUCK GRA PROW  
veg mock duck in basil sauce

TAO-HOO PAD PED  
tofu, mix veg in chili paste

TAO-HOO RAMA  
steamed tofu in peanut sauce

PAD RUOM PAK  
mix veg in brown sauce

**NOODLE**

101 CHICKEN PORK TOFU VEG |  
131 BEEF SHRIMP | SQUID |

PAD THAI  
rice-stick noodle, egg, brown tofu, bean sprout, scallion, ground peanut

PAD SEE EW  
flat rice noodle, egg, Asian broccoli in sweet soy sauce

PAD KEY MAO  
flat rice noodle, egg, fresh basil, onion, bell pepper

GAI HAI LUM  
flat rice noodle, egg, bean sprout in sesame oil sauce

PAD NAR  
flat rice noodle topped with Thai gravy and Asian broccoli

KOW SOY  
egg noodle, pickle mustard green, bean sprout, red onion in Chang Mai curry

NOODLE SOUP

10 | BAH MEE MOO YANG  
grilled pork, egg noodle, bean sprout in clear chicken broth

10 | TOM YUM NOODLE SOUP  
shrimp, minced pork, rice-stick noodle, bean sprout, ground peanut

11 | NUER NOODLE SOUP  
rice-stick noodle, beef, Thai meatballs, Asian broccoli, bean sprout in brown stock

**FRIED RICE**

with egg  
Substitute brown rice | 2.00

10 | KOW PAD KANA SAUSAGE  
pork sausage, Asian broccoli

10 | KOW PAD GRA PROW  
Minced chicken | pork  
fresh basil, onion, bell pepper

10 | KOW PAD KAREE GAI  
chicken, curry powder, onion  
served with cucumber, vanaigrette

13 | KOW PAD SAPPAROAD  
GAI & GOONG  
chicken & shrimp, pineapple, cashew nut

13 | KOW PAD SRIRACHA GOONG  
shrimp, sriracha sauce, kornalia, onion

13 | KOW PAD POO  
crab meat, onion

**SIDE ORDER**

1 | JASMINE rice

2 | BROWN rice

2 | STICKY rice

1 | PEANUT sauce

2 | FRIED egg

3 | STEAMED veg

3 | STEAMED chicken

**BEVERAGE**

2.5 | THAI iced tea

2.5 | THAI iced coffee

2.5 | SPARKLING water

1.5 | BOTTLED water

1.5 | SOFT drink (SODA)

2 | UNSWEETENED iced tea

3 | COCONUT | ORANGE | CRANBERRY juice

10  
Minimum delivery \$18.00

Business Hours:  
Open everyday  
11:30AM - 11PM

641 10 Avenue  
(Btwn 45<sup>th</sup>st-46<sup>th</sup>st)  
New York, NY 10036  
Tel.: 212-245-4601  
Fax: 212-245-4600



www.sirithainyc.com

~Lunch~Dinner~Pick up~Catering~



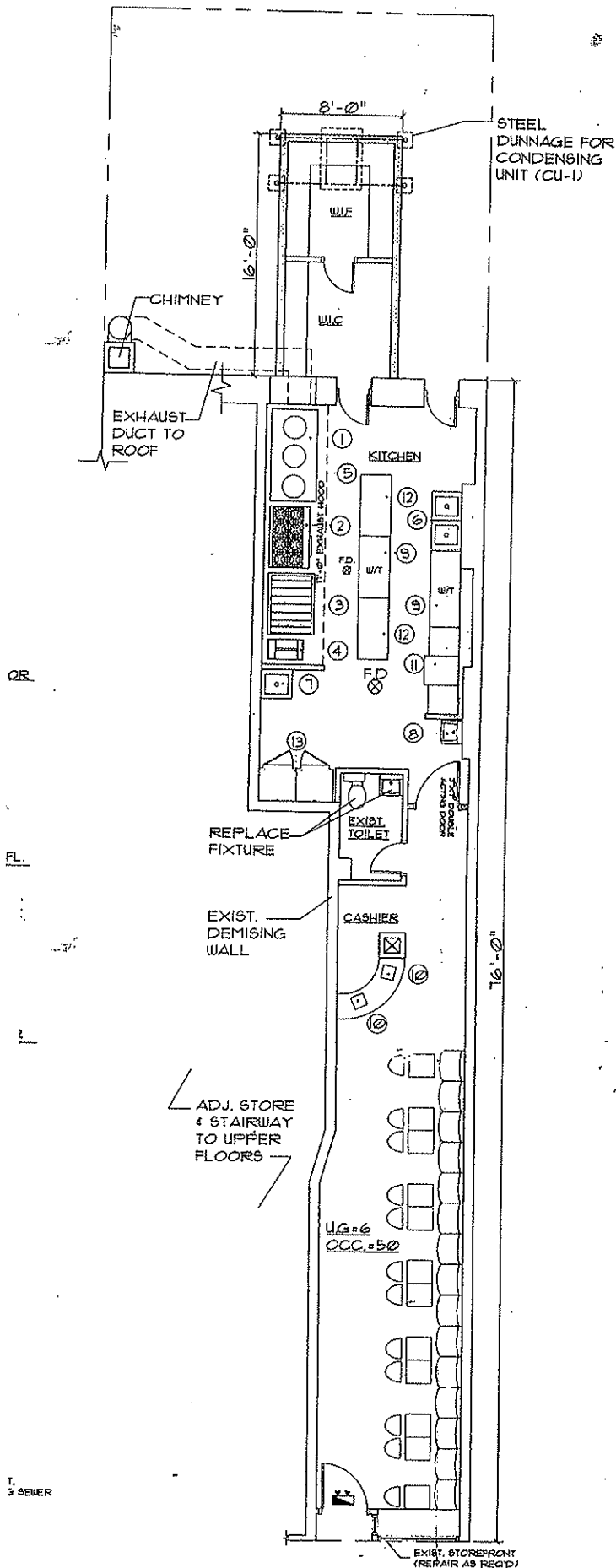

CONSTRUCTION PLAN

SCALE: 3/16" = 1'-0"

Rin Nam Corp.  
 D/B/A Siri Thai  
 641 10<sup>th</sup> Avenue  
 New York, N.Y. 10036

Restaurant-Wine License Application

We have no objection to the issuance of a restaurant-wine license (Beer and wine only) for the above-stated Thai restaurant. The hours of operation will be from 11:30 AM to 12:00 AM. There will be light background dining music only. There will be no outside seating.

NAME	ADDRESS	DATE	SIGNATURE
(Please print)			
Christine Lam	2160 10 <sup>th</sup> Ave	6/28/2013	
Melanie Hardcastle	7000 N. Adams	6/28/13	
Cristina Sadler	9 Putnam St	6/28/13	
SHERRY SMITH	788 AMSTERDAM AVE	6/28/13	
Pimwattana R.	7615 Woodside	6/28/13.	
GARY MURKA	1211 3 <sup>RD</sup> ST. <sup>GRAND</sup> TEXAS	6-28-13	
Bebe Federmann	Brooklyn, NY	6-28-13	
Lisa Galindez	30-07 94 ST NY 11369	6-28-2013	
Luis A. Serrano	30-07 94 <sup>th</sup> NY 11369	6-28-13	
Ai King Loo	342 Gold Street <sup>APT 101</sup> Brooklyn NY 11201	6-28-13	
Ashley Alicea	208 W 122 <sup>nd</sup> St. NY NY 10027	6/28/13	
Ben Spalding	82 Irving Pl. Brooklyn NY 11238	6/28/13	
Phil Ek	40-15 Hampton St 11373	6/28/13	
Munuel Valdeson	1143 Dekalb Ave, Brooklyn 11221	6/28/13	
Peter Will	545 Nell Kitchlen	6/28/13	
Siripong Panyasirika	Emhurst Queen NY	6/28/13	
Nannapat Soncharoen	4141 Woodside NY	6/29/13	
Walter Aguilar	N.E Washington DC	6/29/13	
Russell Goward	Baltimore, MD	6/29/13	
FLORIAN LAO	321 Pleasantview Ave	6/29/13	
DAONNABY LENT	1 Spear crossing.	6/29/13	
CHAYOT CHANPARAKSKUL	321 PLEASANTVIEW AVE	6-29-13	
EDDE SAEGHER	7 <sup>th</sup> AV PENN HOTEL	6-29-13	

Rin Nam Corp.  
 D/B/A Siri Thai  
 641 10<sup>th</sup> Avenue  
 New York, N.Y. 10036

Restaurant-Wine License Application

We have no objection to the issuance of a restaurant-wine license (Beer and wine only) for the above-stated Thai restaurant. The hours of operation will be from 11:30 AM to 12:00 AM. There will be light background dining music only. There will be no outside seating.

NAME	ADDRESS	DATE	SIGNATURE
(Please print)			
Raf Sherman	10 tonsburdun Ave, 2900, NY, NY	7/12/13	<i>[Signature]</i>
Michael P. Kaaber	529 W 42 St #8M NY NY 10036	7/2/13	<i>[Signature]</i>
JAMES O ANDERSON	529 W 42 ST #8M NY NY 10036	7/2/13	<i>[Signature]</i>
Frank Castellan	635 W. 42nd St	10036 7/2/13	<i>[Signature]</i>
JIM PENNY	347 W 39 <sup>TH</sup> ST	10018 7/2/13	<i>[Signature]</i>
Marilyn Crespo	1691 Eastburn Ave	7/3/13	<i>[Signature]</i>
Adam Legm	48 WALL St suite 1100	7/3/13	<i>[Signature]</i>
Sue Blackston	7 E 67 <sup>th</sup> St	7/3/13	<i>[Signature]</i>
Wing Yeap	657 107 <sup>th</sup> Ave #20	10036 7/3/13	<i>[Signature]</i>
Martina K. Kunk	455 W 43 St.	7/3/13	<i>[Signature]</i>
Sergio Peña	545 W 146 St.	7/04/13	<i>[Signature]</i>
Bery Montez	545 W 146 St.	7/04/13	<i>[Signature]</i>
SHARNA BURN	504 MAQUICK	7/5/13	<i>[Signature]</i>
Maria Osborn	504 MAURICIE	7/5/13	<i>[Signature]</i>
Mo ZIAD	1425 MOIR LAI BURLINGAME	7/5/13	<i>[Signature]</i>
Chantal Villain	530 W 40 <sup>th</sup> St	7/5/13	<i>[Signature]</i>
Lesley Johnson	646 377 Ce 781		<i>[Signature]</i>
Li Zhang	560 W. 45 St.	7/5/13	<i>[Signature]</i>
ANDREA MARTYNOWSKI	719 MONTAUK HWY, AMAGANSETT, NY 11930	7/5/13	<i>[Signature]</i>
HOFFMAN	503 97 <sup>th</sup> AVE	7/5/13	<i>[Signature]</i>
Seiwa Hepburn	1046 Amsterdam #6	7/5/13	<i>[Signature]</i>
TOM AGIN	ROYERSFORD PA 19468	7/5/13	<i>[Signature]</i>
Sebastian Szymanski	40-15 Hopton N.Y.	7/5/13	<i>[Signature]</i>

Rin Nam Corp.  
 D/B/A Siri Thai  
 641 10<sup>th</sup> Avenue  
 New York, N.Y. 10036

Restaurant-Wine License Application

We have no objection to the issuance of a restaurant-wine license (Beer and wine only) for the above-stated Thai restaurant. The hours of operation will be from 11:30 AM to 12:00 AM. There will be light background dining music only. There will be no outside seating.

NAME	ADDRESS	DATE	SIGNATURE
(Please print)			
Robert Roll	698 10 <sup>th</sup> Ave	6/30	Robert Roll
Alex SALTON	449 west 44 <sup>th</sup>	7/1	Alex Salton
Sherman Gold	500 WEA	7/1	Sherman Gold
Eric Warr	425 51 <sup>st</sup>	7/1	Eric Warr
STEVE GINSBERG	215 CRESCENT	7/1	Steve Ginsberg
Carolyn Anthony	450 W. 42 <sup>nd</sup>	7/1	Carolyn Anthony
Melnsberg	215 Crescent St.	7/1	Melnsberg
Patrick Phang	5031 15 <sup>th</sup> St Flushing	7/1	Patrick Phang
Lauren Ulrich	464 W 44 <sup>th</sup> St	7/1	Lauren Ulrich
Ann J. Zuma	446 W. 46 <sup>th</sup> St.	7/1	Ann J. Zuma
Nathaniel Billuhim	1 Water Place	7/1	Nathaniel Billuhim
Byres Beltran	978 W 96 <sup>th</sup> St	9/1	Byres Beltran
NORMAN ODER	578 West 14 <sup>th</sup> St Brooklyn	7/13	Norman Oder
MARYANNE VESTHECO	4108 43 <sup>RD</sup> ST. #6F, Sunnyside, NY	7/13	Maryanne Vestheco
Jon Cheng	650 West 4 <sup>th</sup> St #202	7/1	Jon Cheng
Aaron Solomon	447 West 43 <sup>rd</sup> St Apt 2C	7/11	Aaron Solomon
Debra Lee	Rein Station	7/1	Debra Lee
Hilari Grant	435 E 92 <sup>nd</sup> St	7/1	Hilari Grant
JOE SAWATORE	20 BOND ST. NY, NY 10012	7/1	Joe Sawatore
Lee Blumenschim	3 Spencer Court BK, NY 11205	7/1	Lee Blumenschim
Jenny BARONE	465 Willoughby Ave BK, NY 11206	7/1	Jenny Barone
Lexo Lai	Fresh Meadows, NY	7/1	Lexo Lai
Bruce Gronya	484 W. 43 <sup>rd</sup> St.	7/1	Bruce Gronya

Rin Nam Corp.  
 D/B/A Siri Thai  
 641 10<sup>th</sup> Avenue  
 New York, N.Y. 10036

Restaurant-Wine License Application

We have no objection to the issuance of a restaurant-wine license (Beer and wine only) for the above-stated Thai restaurant. The hours of operation will be from 11:30 AM to 12:00 AM. There will be light background dining music only. There will be no outside seating.

NAME ADDRESS DATE SIGNATURE  
 (Please print)

NAME	ADDRESS	DATE	SIGNATURE
Rose Hernandez	2416 WEST ST Union City NJ	7/5/13	Rose Hernandez
Joe Maxson	601 WEST 4 <sup>th</sup> ST NY NY 10036	7/5/13	Joe Maxson
Sunwoo Lee	360 Riverside Dr APPL, New York NY 10027	7/5/13	Sunwoo Lee
Adam Brown	429 East 8 <sup>th</sup> St, Apt 2D New York, NY 10014	7/5/2013	Adam Brown
Karl Bear	515 W 46 <sup>th</sup> St. Apt 5B NY, NY 10036	7/5/13	Karl Bear
Glome Parris	1517 E 33 <sup>rd</sup> St. Bklyn NY 11234	7/5/13	Glome Parris
Simone Parris	1517 East 33 <sup>rd</sup> St. Brooklyn NY 11234	7/5/13	Simone Parris
Pinela Russo	6204 81st Street Middle Village, NY 11379	7/5/13	Pinela Russo
Mack Neuber	545 W 45 <sup>th</sup> ST, NY, NY	7/8/13	Mack Neuber
David Kaplan	545 W 45 <sup>th</sup> ST NY NY	7/8/13	David Kaplan
Leo Russo	902 CR 124 <sup>th</sup> AV. Union City NJ	7/8/13	Leo Russo
D. Gabriel	545 W 45 <sup>th</sup> ST NY NY	7/8/13	D. Gabriel
Jonathan Clark	620 11 <sup>th</sup> AVENUE	7/8/13	Jonathan Clark
Janie Bullard	405 Smith St, Brooklyn NY, 11231	7/8/13	Janie Bullard
Jeff Laurie	509 W 46 <sup>th</sup> St NY NY 10036	7/8/13	Jeff Laurie
John Wicks	529 W 42 <sup>nd</sup> St, NY NY 10036	7/8/13	John Wicks
Julie Evans	529 W 42 <sup>nd</sup> St NY NY 10036	7/8/13	Julie Evans
Tom Brien	636 11 <sup>th</sup> Ave NY NY 10036	7/8/13	Tom Brien
Bar Nelson	454 W 46 <sup>th</sup> St NY NY 10036	7/8/13	Bar Nelson
Stephen Odo	390 W 18 <sup>th</sup> St NYC NY NY 10011	7/8/13	Stephen Odo
Denzel Cadet	50 Wilson Ave BK, NY 11237	7/8/13	Denzel Cadet
Ashley Williams	30 West 141 <sup>st</sup> New York, NY 10037	7/8/13	Ashley Williams



# Proof of Posting, done on Thursday July 11<sup>th</sup> 2013

