

Manhattan Community Board 4
(All Fields Must Be Completed)

Liquor License Stipulations Application

CORPORATION NAME Very Fresh Noodles, LLC		DOING BUSINESS AS (DBA) Very Fresh Noodles	
STREET ADDRESS 425 West 15th Street, Kiosk #11, New York, NY		CROSS STREETS Btwn. 9th and 10th Avenue	ZIP CODE 10011
OWNER <i>(Attach a list of all the people that will be associated/listed with the license)</i>	NAME: Peter Tondreau & Victor Huang	ATTORNEY/ REPRESENTATIVE	NAME: Alexander Victor
	PHONE: (206) 225-0663		PHONE: (212) 557-7200
	EMAIL: veryfreshnoodles@gmail.com		EMAIL: abv@dnclegal.com
MANAGER	NAME: Peter Tondreau	LANDLORD	NAME: Jamestown Premier Chelsea Market L.P.
	PHONE: (206) 225-0663		PHONE: (770) 805-1000
	EMAIL: veryfreshnoodles@gmail.com		EMAIL:
APPLICATION TYPE <i>(Check One)</i>			
<input checked="" type="radio"/> New	Has applicant owned or managed a similar business?	<input checked="" type="radio"/> YES	<input type="radio"/> NO
	What is/was the name and address of establishment?	Bar Suzette LLC/ 425 West 15th Street, Kiosk#6, NY, NY 10011 Grand Central Suzette LLC/ 230 Park Ave., Stall 14, NY, NY 10169 Mario San Incorporated/ 230 Park Ave, Stall 21, NY, NY 10169	
	What were the dates applicant was involved with this former premise?		
<input type="radio"/> Transfer	What is the prior license # and expiration date?		
	Is applicant making any alterations or operational changes?	<input type="radio"/> YES	<input type="radio"/> NO
	<i>If alterations or operational changes are being made, please describe/list all changes.</i>		
<input type="radio"/> Alteration	What is the current license # and expiration date?		
	<i>Please list/describe the nature of all the changes and attach the plans:</i>		
METHOD OF OPERATION			
TYPE OF ALCOHOL	<input type="radio"/> Liquor/Wine/Beer <input type="radio"/> Beer <input checked="" type="radio"/> Wine & Beer		
ESTABLISHMENT TYPE	<input checked="" type="radio"/> Restaurant* <input type="radio"/> Cabaret <input type="radio"/> Night Club <input type="radio"/> Hotel <input type="radio"/> Bar/Tavern <input type="radio"/> Catering Establishment <input type="radio"/> Food Counter/Eatery <input type="radio"/> Adult Entertainment <input type="radio"/> Wine Bar <input type="radio"/> Dance Club <input type="radio"/> Sports Bar <input type="radio"/> Club (Fraternal Organization – Members Only)		
Has applicant/owner filed with the SLA? If yes, when? If no, when do you plan to file?	YES	<input checked="" type="radio"/> NO	Plan to file after appearing before CB4's BLP committee
Is the 500 Foot Rule applicable? If yes, please attach a diagram of the On-Premise liquor license establishments within a 500 ft. radius of your establishment and the Public Interest Statement.	YES	<input checked="" type="radio"/> NO	
Is the 200 Foot Rule applicable? If yes, please attach a diagram of the schools and houses of worship that trigger the rule.	YES	<input checked="" type="radio"/> NO	
Has applicant/owner(s) read MCB4 Policy Regarding Concentration and Location of Alcoholic-Serving Establishments?	<input checked="" type="radio"/> YES	<input type="radio"/> NO	

OPERATIONAL DETAILS (*Closing time will be when establishment is vacated of all patrons)

		MONDAY	TUESDAY	WEDNESDAY	THURSDAY	FRIDAY	SATURDAY	SUNDAY
HOURS* <i>(Indoor Only)</i>	Operation	11am-10pm	11am-10pm	11am-10pm	11am-10pm	11am-10pm	11am-10pm	11am-10pm
	Kitchen	11am-10pm	11am-10pm	11am-10pm	11am-10pm	11am-10pm	11am-10pm	11am-10pm
	Music	11am-10pm	11am-10pm	11am-10pm	11am-10pm	11am-10pm	11am-10pm	11am-10pm
If you plan to have music, what type(s)? (Circle all that apply)		<input checked="" type="checkbox"/> BACKGROUND		<input type="checkbox"/> LIVE MUSIC	<input type="checkbox"/> DJ	<input type="checkbox"/> JUKE BOX	<input type="checkbox"/> KARAOKE	

OCCUPANCY

	Capacity (Certificate of Occupancy)	Maximum # of Persons You Anticipate Occupying Premises (Including Employees)	Number of Tables	Number of Seats	Number of Service Only Bars	Number of Stand-Up Bars	Number of Seats at Stand-Up Bar
INSIDE	1000+ (within Chelsea Market)	8	1	8	0	1* <small>*Same as table</small>	8* <small>Same as table seats</small>
OUTSIDE <i>(Other than sidewalk café.)</i>	N/A	N/A	N/A	N/A	N/A	N/A	N/A
SIDEWALK CAFE	N/A	N/A	N/A	N/A			

How many floors are there? What is the capacity for each floor?	Ground Floor	
How frequently will the owner(s) be at the establishment?	Approx. 3-5 days per week, or as necessary	
Will you be applying or intending to apply for a cabaret license with DCA? If yes, will there be dancing?	YES	<input checked="" type="radio"/> NO
Will applicant have bottle or table service for beverage alcohol?	YES	<input checked="" type="radio"/> NO <small>Other than wine/beer by the bottle and restaurant-style table service. Not nightclub-style "bottle service" or "table service."</small>
Will you be hosting private, promotional or corporate events?	YES	<input checked="" type="radio"/> NO
Will outside promoters be used on a regular basis? If yes please describe.	YES	<input checked="" type="radio"/> NO
Will you have a security plan? If, yes please attach.	YES	<input checked="" type="radio"/> NO
Will security plan be implemented?	YES	NO N/A
Will State certified security personnel be used?	YES	NO N/A
Will New York Nightlife Association and NYPD Best Practices be followed?	YES	NO N/A
Will applicant be using delivery bicycles? If yes, how many?	YES	<input checked="" type="radio"/> NO
Will delivery bicycles be clearly marked with the name of the restaurant and will staff wear attire clearly noting name as described by NYC Law?	<input checked="" type="radio"/> YES	NO If used.
Where will delivery bicycles be stored during the day when not in use?	N/A	

LOCATION & ZONING			
Is this a Special District? If yes, is it Clinton, West Chelsea or Hudson Yards?	YES	<input checked="" type="radio"/> NO	
Does the building have a Certificate of Occupancy ("C of O") or a letter of no objection?	<input checked="" type="radio"/> YES	NO	
Is a Public Assembly permit required?	YES	<input checked="" type="radio"/> NO	
Are your plans filed with DOB?	YES	NO	N/A

Community Notification/Relations			
NOTIFICATION: List all block associations; tenant associations, co-op boards or condo boards of residential buildings; and community groups that applicant has notified regarding its application. For each please list both the organization and individual you contacted	# 1	Manhattan Community Board 4	
	# 2	See list attached.	
	# 3		
	# 4		
	# 5		
	Please provide dates when applicant met with the groups listed above.		Meeting CB4 on Oct. 10, 2017
Who was your contact person at each group you met with?		N/A - See list of addresses emailed attached, together with a copy of the email notice	
When did applicant post the notice that was provided?		To be posted one week prior to meeting	
Where did applicant post the notice that was provided?		Four closest street corners	
Will applicant provide owner cell phone number to neighbors and respond to complaints that arise? Please provide number in space provided.		<input checked="" type="radio"/> YES	NO (206) 225-0663
Will applicant inform the Community Board office of its job openings and/or provide a hyperlink to applicants jobs webpage?		<input checked="" type="radio"/> YES	NO

Arteaga, Carmelo A.

From: Arteaga, Carmelo A.
Sent: Monday, October 02, 2017 10:26 AM
To: Arteaga, Carmelo A. (CAA@dhclegal.com)
Cc: Victor, Alexander B.; 'negonzalez@cb.nyc.gov'
Subject: CB4 October 10, Very Fresh Noodles (Beer/Wine Application)

Dear Sir or Madam,

I received your contact from Community Board 4 and I am writing on behalf of my client Very Fresh Noodles LLC which is opening a small (8-seat) restaurant/eatery (doing business as Very Fresh Noodles) which will serve Taiwanese noodles. The restaurant/eatery will be located within Chelsea Market at 425 West 15th Street, (between 9th and 10th Avenue).

Very Fresh Noodles intends to complement the food service with beer and wine (among other soft drinks) and, accordingly, will be applying to the New York State Liquor Authority for a Beer & Wine License. This application will be before Manhattan Community Board 4's Business Licenses & Permits Committee on October 10, 2017, which meeting begins at 6:30PM and is being held at Yotel New York, 570 Tenth Avenue (4th Floor - The Green Room).

Please feel free to contact me if you have any questions about this application or would like additional information.

Thank you,
Carmelo



Carmelo Arteaga, Paralegal
Davidoff Hutcher & Citron LLP,
605 Third Avenue, New York, NY 10158
Firm: 212.557.7200 Direct: 646.428.3202
Fax: 212.286.1884 Cell: 718.916.5753
Email: caa@dhclegal.com

Organization (Include firm for everything in Chelsea aside from his block)	First Name	Last Name	Email
100/200 West 15 Street	Bill	Borock	wborock@hotmail.com
100/200 West 15 Street	Stanley	Bulbach	letters@bulbach.com
300 West 15th Street	Robert	Boddington	rboddington@gmail.com
100 West 16th Street	Jim	Jasper	jasper@ge.cuny.edu
100 West 16th Street	Paul	Groonki	paul@groonki.com
100 West 16th Street	Eric	Bornze	eric.bornze@gmail.com
200 West 16th Street	Elizabeth	Zacharia	ezacharia@gmail.com
Fulton House Tenant Association (W 16th St. to W 19th St. from 9th/10th Avenue)	Will	Rogers	wilrogers@gmail.com
100 West 17th/18th Street	Miguel	Acevedo	acevedoandassociates@gmail.com
100 West 17th/18th Street	Craig	Slutzkin	craig.slutzkin@outlook.com; craigs1029@aol.com
300 West 18th/19th Street	Judy	Klein	jakmail@earthlink.net
300 West 18th/19th Street (President)	Cheryl	Kupper	ckupper@aol.com
300 West 18th/19th Street	Ethan	Felson	Ethan_Felson@jewishfederations.org
100 West 19th/20th/21st/22nd Street	Gloria	Lowe	larameirag@gmail.com
100 West 19th/20th/21st/22nd Street	Bliff	Borock	wborock@hotmail.com
100 West 19th/20th/21st/22nd Street	Sally	Greenspan	sallygma@gmail.com
100 West 19th/20th/21st/22nd Street	Diane	Nichols	beacon195@aol.com
100 West 19th/20th/21st/22nd Street	Gerald	Germamy	germanygerald@aol.com
100 West 19th/20th/21st/22nd Street	Melissa	Stern	m@melissa-stern.com
200 West 19th/20th/21st/22nd/23rd Street	Michael	Walsh	mwalshny@yahoo.com
200 West 19th/20th/21st/22nd/23rd Street	Ramela	Wolff	pamelaw@earthlink.net
200 West 19th/20th/21st/22nd/23rd Street	Dottie	Francoure	dfranco243@earthlink.net
200 West 19th/20th/21st/22nd/23rd Street	Pat	Cooke	frama@tpe.com
500 West 19th Street	Mele	Lister	media.lewme@gmail.com
300 West 20th Street	Neil	Selkirk	nel@neliselkirk.com
300 West 20th Street	Carol	Ot	col@nyc.rr.com
300 West 20th Street	Albert	Taylor	alberttaylor@gmail.com
300 West 20th Street	Leslie	Doyal	lesley@lyrichord.com
300 West 21st/22nd/23rd Street	Eleanor	Horowitz	eleanor@quiltedpomer.com
300 West 21st/22nd/23rd Street	Andrea	Gabriele	300wba@gmail.com
300 West 21st/22nd/23rd Street	Phyllis	Waisman	phylliswaisman@gmail.com
400 West 21st/22nd/23rd Street	Zazel	Loven	zazel@loven@yahoo.com
400 West 21st/22nd/23rd Street	Mary	Swartz	ms@nyc.rr.com
400 West 21st/22nd/23rd Street	Eileen	McElduff	emce33@aol.com
400 West 21st/22nd/23rd Street	Jean	Blair	jblair@bobchristianson.com
400 West 21st/22nd/23rd Street	Karen	Jacob	w400ha@gmail.com
100 West 26th Street	Susan	Buttenwieser	susanb101@aol.com
Chelsea-Elliott Tenant Association (W 25th/26th Street from 9th/10th Avenue)	Dan	Shulman	shulman@speakeasy.net
Chelsea-Elliott Tenant Association (W 25th/26th Street from 9th/10th Avenue)	Florence	Dent	fdentburle@gmail.com
Penn South (W 23rd to W 23th Street from 8th/9th Avenue)	Darlene	Waters	dwatersh@gmail.com
London Terrace Towers (W 23rd/24th Street from 9th/10th Avenue)	Mario	Mazzoni	education@peninsouth.coop
Hotel Americana	Carl	Reinhilb	
Highline537	Andy	Humm	andyhumm@aol.com
Donna Langman Costumes	Scott	Hupe	
	Donna	Langman	donna@donnalangman.com

BUILDING DESIGN			
State the name and type of business previously located in the space.	Urban food court, shopping mall and offices		
Has a liquor-licensed establishment previously occupied this space at any time? If yes, please provide the name of the business.	<input checked="" type="radio"/> YES	<input type="radio"/> NO	Numerous licenses in Chelsea Market
Do you plan any changes to the existing façade? If yes, please describe.	YES	<input checked="" type="radio"/> NO	
Will applicant have a vestibule within the establishment?	YES	<input checked="" type="radio"/> NO	
Will applicant use a storm enclosure?	YES	<input checked="" type="radio"/> NO	
Will applicant not place any items or obstructions on the sidewalk, for example, sandwich boards, sidewalk signs, freestanding menus and plants, as per the law?	<input checked="" type="radio"/> YES	<input type="radio"/> NO	
Will applicant comply with the NYC noise code?	<input checked="" type="radio"/> YES	<input type="radio"/> NO	
Will the establishment have any of the following: (circle all that apply)	<input type="radio"/> FRENCH DOORS	<input type="radio"/> GARAGE DOORS	<input type="radio"/> WINDOWS THAT CAN BE OPENED
Will applicant close all windows, French doors, garage doors when any music or amplified sound (including televisions) is played inside the establishment?	<input type="radio"/> YES	<input type="radio"/> NO	N/A
Will applicant close all windows, French doors, garage doors by 11 PM Friday and Saturday and 10 PM on all other days even if no music or amplified sound is played inside the establishment?	<input type="radio"/> YES	<input type="radio"/> NO	N/A
Has applicant obtained an acoustical report from a certified sound engineer to assess potential noise disturbance to the neighboring residents and buildings?	YES	<input checked="" type="radio"/> NO	
Will applicant follow the recommendations of a certified sound engineer to mitigate potential noise disturbance to the neighboring residents and buildings, including placing speakers on the floor of the establishment?	YES	<input type="radio"/> NO	N/A
Will the kitchen exhaust system extend to the roof?	<input checked="" type="radio"/> YES	<input type="radio"/> NO	
Will the establishment have an illuminated sign?	YES	<input checked="" type="radio"/> NO	
Will the establishment have a canopy extending over the sidewalk?	YES	<input checked="" type="radio"/> NO	
Where will the air conditioner be located? What type is it?	Existing		
When was the air conditioner installed?	Existing		

OUTDOOR ITEMS - OTHER THEN SIDEWALK CAFÉ	** Not Applicable **		
Has the applicant/owner(s) read MCB 4 Rear Yard Rooftop Policy?	YES	NO	
Will applicant use any outdoor spaces: rooftop, rear yard, patio, porch, balcony, pavilion, tents, deck or gazebo? If yes, which one(s)?	YES	NO	
Are the floorplans for the outdoor space(s) included?	YES	NO	
Will applicant close and vacate the outdoor space(s) by 11PM on Friday & Saturday and 10 PM on all other days?	YES	NO	
Will the service and consumption of alcohol in any outdoor space only be via seated food service?	YES	NO	
Will applicant not allow standing space for patrons to drink or smoke in any outdoor space(s)?	YES	NO	
Will there be no amplified music, as per the law?	YES	NO	
If amplified sound is played inside the establishment, will windows and doors be closed?	YES	NO	
Will applicant agree to post signs outside asking customers to respect the neighbors'?	YES	NO	
Will applicant agree to train staff to encourage a peaceful environment?	YES	NO	
Will applicant provide effective sound control (landscaping enclosure, soundproofing tenants apartments)	YES	NO	
Will there be a lighting plan that allows safe usage of the outdoor space without disrupting neighbors?	YES	NO	

OUTDOOR ITEMS – SIDEWALK CAFÉ	** Not Applicable **	
Has the applicant/owner(s) read MCB4 Sidewalk Café Policy?	YES	NO
Will applicant be applying for a sidewalk café now or in the future?	YES	NO
Is applicant in this application seeking to include a sidewalk café in its liquor license?	YES	NO
If yes, has applicant submitted an application and plans to NYC Dept. of Consumer Affairs? Please attach application and plans.	YES	NO
Will applicant close and vacate the sidewalk café by 11 PM on Friday & Saturday and 10 PM on all other days?	YES	NO
Will applicant be serving alcohol in the sidewalk café? If so, will you have waiter service?	YES	NO
Will the café have a 3 ft. wide serving aisle running the entire length of the sidewalk cafe?	YES	NO
Will applicant mark the perimeter of the café on the sidewalk?	YES	NO
Will the service and consumption of alcohol in the sidewalk café only be via seated food service?	YES	NO
Will the sidewalk café not provide standing space for drinking or smoking?	YES	NO
Will applicant use any portable natural gas heaters? If so, do you have the requisite approvals from DOB & the Fire Department?	YES	NO
Will applicant have a lighting plan that will allow safe usage of the outdoor space without disrupting neighbors?	YES	NO
Will all furniture, plants and barricades be stored inside between the evening closing hours and the morning opening hours?	YES	NO
Will all furniture be stored inside between December 21 st and March 21 st , and any other day when it rains or snows?	YES	NO
Will applicant use umbrellas?	YES	NO
If construction or construction protection has reduced the sidewalk width, will applicant always maintain an 8 foot clear path of sidewalk between the perimeter of the café and the closes obstruction including construction barricades?	YES	NO

ADDITIONAL STIPULATIONS: (Office Use Only)

To the extent any additional stipulation on pages 7 and 8 of this application conflicts with any response on pages 1 – 6 of this application, the stipulations on pages 7 and 8 control.

ADDITIONAL STIPULATIONS: (Office Use Only), *Continued*

To the extent any additional stipulation on pages 7 and 8 of this application conflicts with any response on pages 1 – 6 of this application, the stipulations on pages 7 and 8 control.

Manhattan Community Board 4 (MCB4) recommends:	<input checked="" type="radio"/> Denial unless all stipulations agreed to by applicant/owner are part of the method of operation <input type="radio"/> Denial <input type="radio"/> Approval
--	---

CB4 REPRESENTATIVES

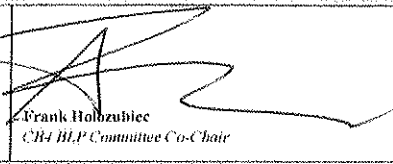
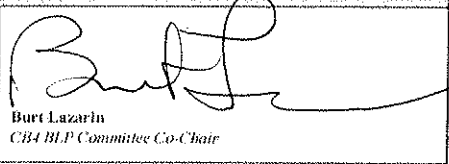
 Nelly Gonzalez <i>CB4 Assistant District Manager</i>	 Frank Holozubiec <i>CB4 BLP Committee Co-Chair</i>	 Burt Lazarin <i>CB4 BLP Committee Co-Chair</i>
--	--	--

APPLICANT AGREEMENT WITH THE COMMUNITY

Applicant agrees to these stipulations as the basis for the community support of this application and acknowledges that all of these stipulations are essential prerequisites to the MCB4 recommendation regarding this application. Applicant agrees to have these stipulations incorporated in the method of operation of its liquor license. The stipulations in this application constitute the entire agreement between MCB4 and applicant and may only be altered in writing signed by MCB4 and applicant. These stipulations supersede any oral statements or representations in connection with this application.

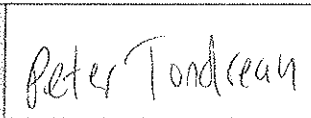
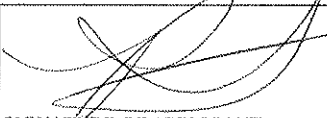
SIGN HERE →	 PRINT NAME OF APPLICANT	 SIGNATURE OF APPLICANT	10/10/17 DATE
--------------------	--	--	------------------

TAB 2

Very Fresh Noodles, LLC
425 West 15th Street, Kiosk #11
New York, New York 10011

Diagrams & Floor Plans

Chelsea Market - Ground Floor (Entire Floor):

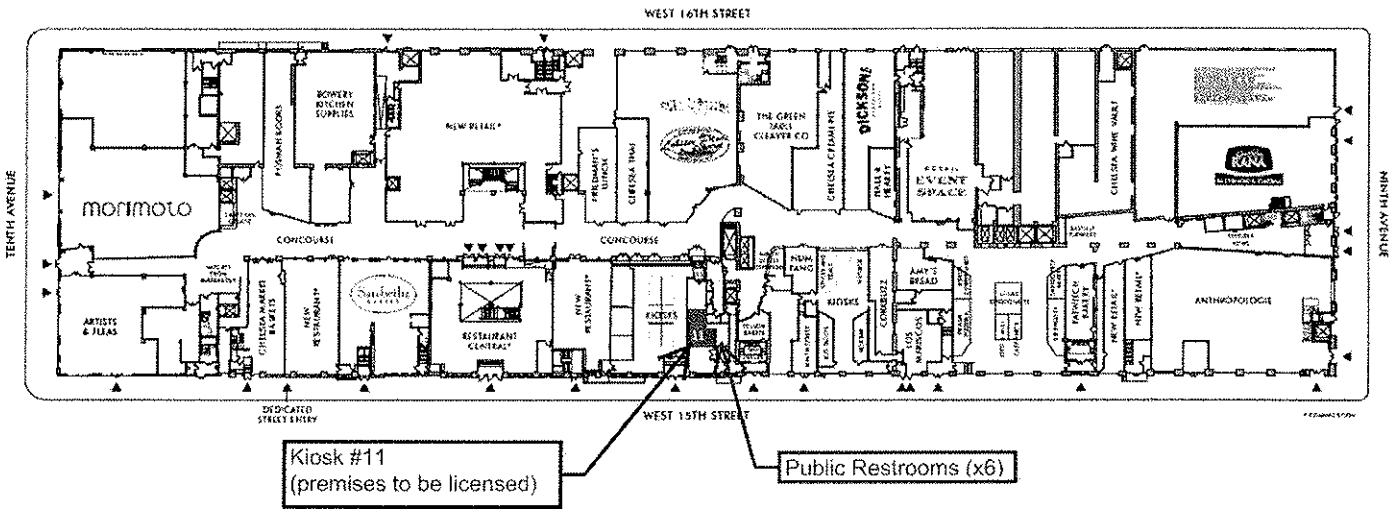

**See next page for enlarged diagram of Kiosk #11*

Very Fresh Noodles, LLC
425 West 15th Street, Kiosk #11
New York, New York 10011

Diagrams & Floor Plans

Enlarged Diagram of Kiosk #11:

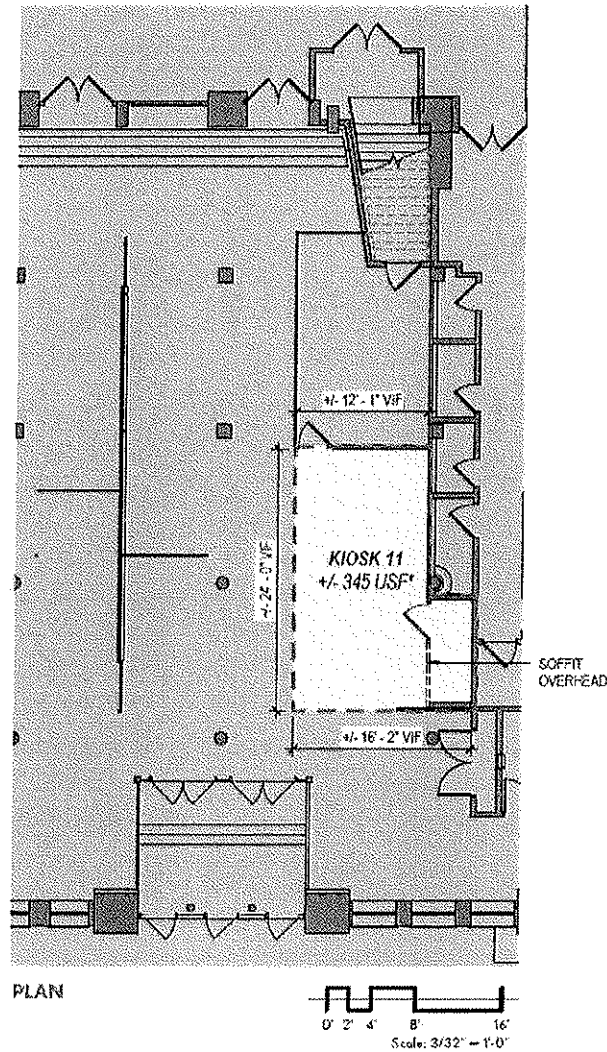

**See next page for detailed diagram of Kiosk #11 showing seating and food preparation and storage facilities.*

Very Fresh Noodles, LLC
 425 West 15th Street, Kiosk #11
 New York, New York 10011

Diagrams & Floor Plans

Detailed Diagram of Kiosk #11:

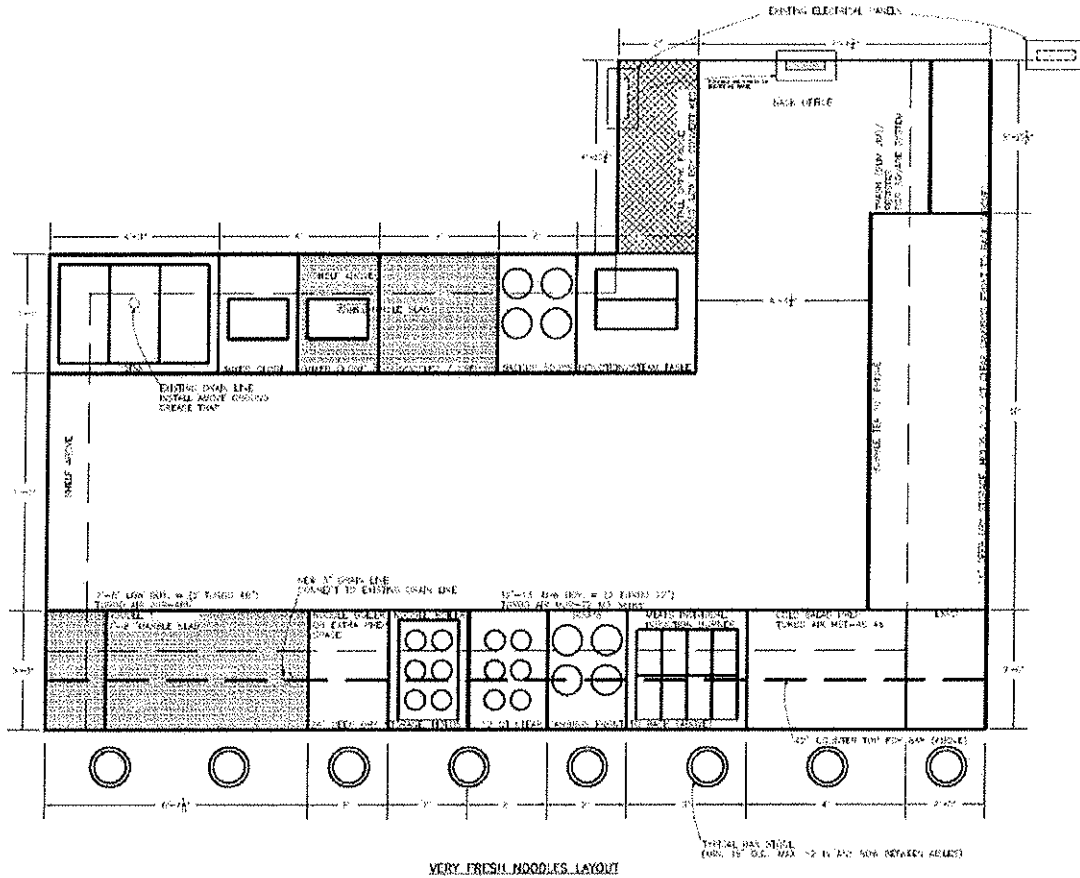

FRESH NOODLES

NOODLES

SNACKS

NOODLES

NOODLE SOUPS

THAI CHICKEN SOUP
THAI CHICKEN SOUP
THAI CHICKEN SOUP
THAI CHICKEN SOUP

VERY FRESH NOODLES

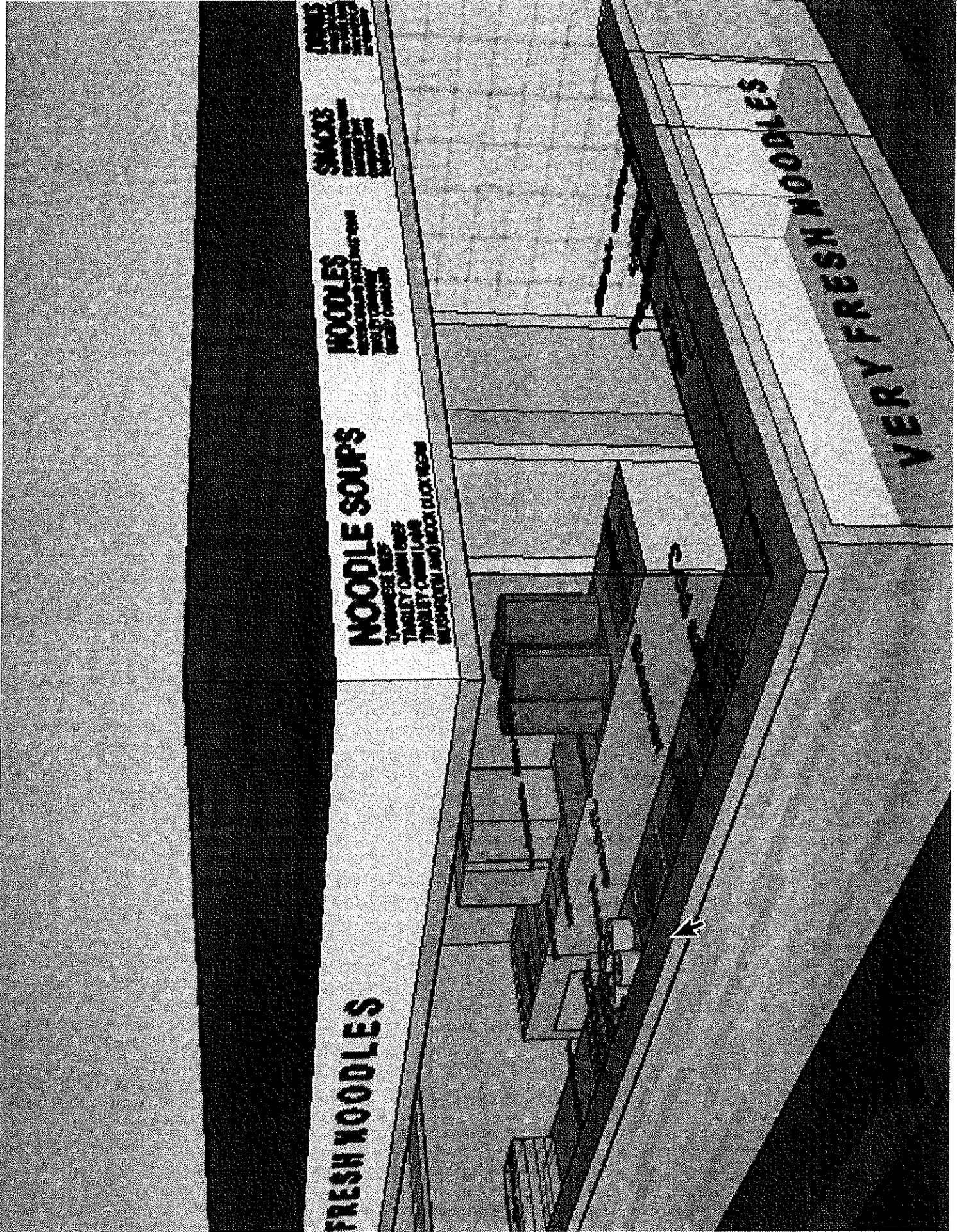

TAB 3

EXHIBIT E

新 VERY FRESH MENU

very fresh noodles

TINGLY CUMIN LAMB 小茴香羊肉麵
12.86 * (dry or in soup)
our signature "biangbiang" noodles ** (pulled, smashed, and ripped) seasoned with a heap of cumin, sichuan peppercorns, chili oil, celery, and fresh herbs; plus, your choice of beef or lamb.

TINGLY CUMIN BEEF
11.94 (dry or in soup)

VEGAN NOODLES WITH MOCK DUCK, BOK CHOY & SHIITAKE MUSHROOM
11.94 (dry or in soup)
our signature "biangbiang" noodles in a rich vegan mushroom broth seasoned with shaoxing wine 紹興酒, black vinegar, cumin, sichuan peppercorns, chili oil, celery, pickled mustard greens, and fresh herbs. *note: mock duck is a meat substitute*

LA MEI TAIWANESE BEEF NOODLE SOUP 牛肉麵
12.86
slow-braised beef shanks and handpulled noodles in beef soup, served with pickled mustard greens, scallion, cilantro, and a touch of chili oil; a Taiwanese classic
available mild or spicy

side

CLASSIC PORK & CHIVE DUMPLINGS
six piece 5.45 / twelve piece 8.25

SUANLA SICHUAN WONTONS 酸辣抄手
six piece 5.45 / twelve piece 8.25
"folded-hands" pork wontons in a hot and sour chili sauce

CLEAVER-SMASHED CUCUMBERS 拍黃瓜
4.55
chili, garlic, sesame-soy vinaigrette

bubble tea

TARO / ALMOND / BLACK TEA / OOLONG
medium 3.68 / large 4.55

beverages

**CHRYSANTHEMUM TEA / COKE / DIET COKE
SPRITE / WATER / COCONUT DRINK / ALOE
VERA / GRASS JELLY**
1.84

* ALL PRICES ARE BEFORE TAX

** PLEASE ENJOY OUR NOODLES FRESH
AS THEY'LL LOSE THEIR DELICATE
CHEWY BITE OVER TIME

條 VERY FRESH NOODLES

FOLLOW US ON INSTAGRAM @VERYFRESHNOODLES

425 W. 15 Street NYC | www.vfnoodles.com

TAB 4

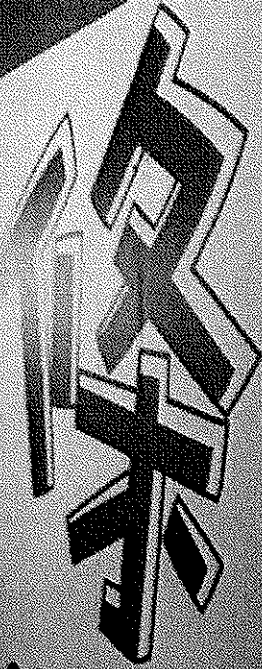

ALL DAY FRESH NOODLES COMING SOON



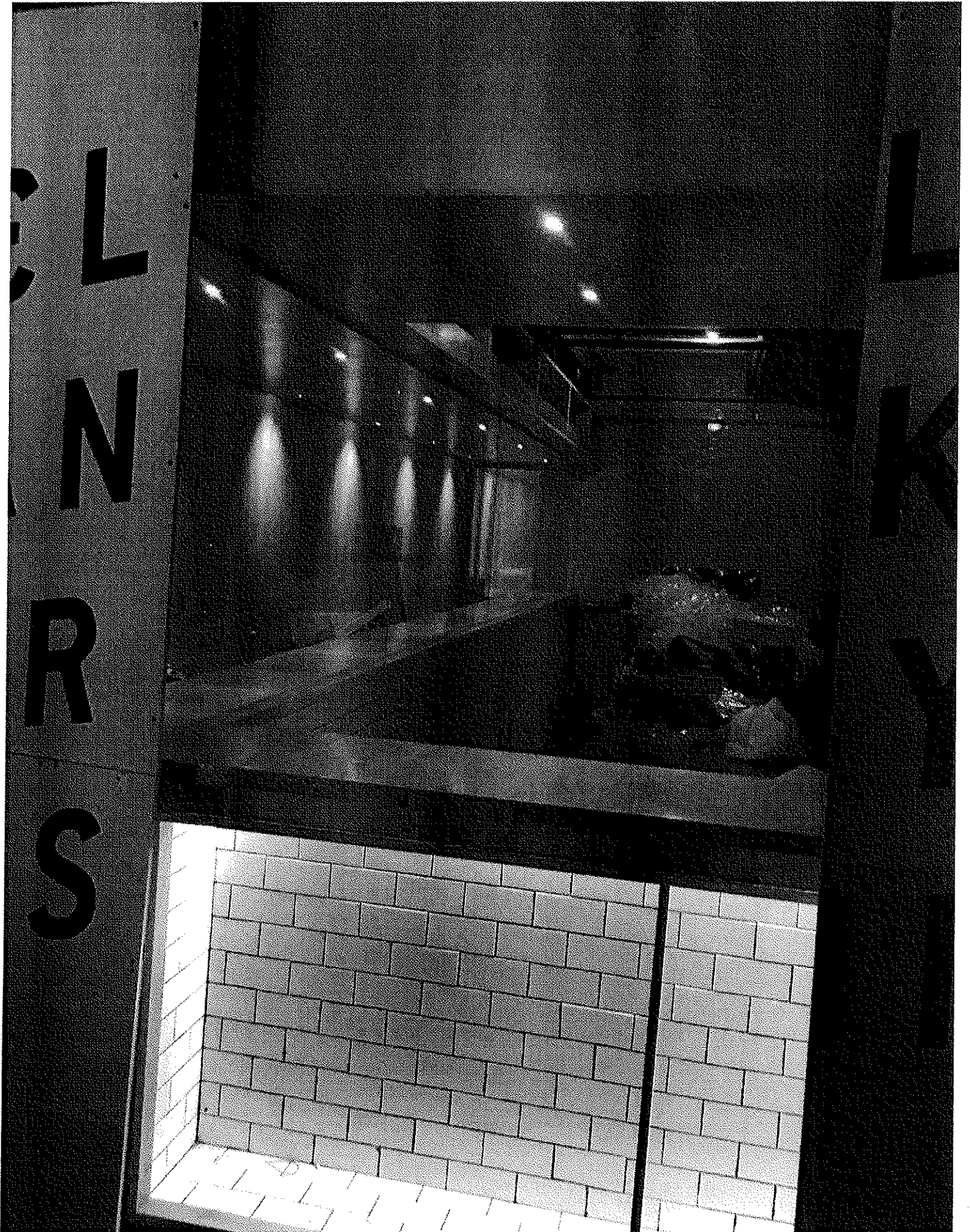



TAB 1

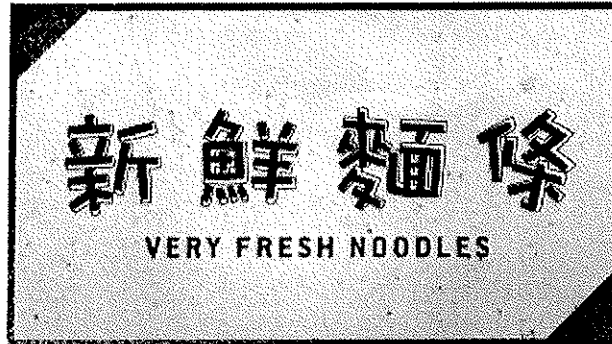

Manhattan Community Board 4
Business Licenses & Permits Committee

October 10, 2017

<u>Tab</u>	<u>Document</u>
1	Community Board Questionnaire
2	Floor Plans and Rendering of Premises
3	Menu
4	Premises Photographs



Davidoff Hutcher & Citron LLP
605 Third Avenue, 34th Floor
New York, New York 10158
Tel.: (212) 557-7200