

Manhattan Community Board 4

Liquor License/Sidewalk Cafe Stipulations Application

(All Fields Must Be Completed)

CORPORATION NAME		DOING BUSINESS AS (DBA)	
ESQUINA NYC MH28 LLC		LA ESQUINA	
STREET ADDRESS		CROSS STREETS	ZIP CODE
441 EIGHTH AVENUE & 372 NINTH AVE		WEST 31ST AND 33RD STREETS	10001
OWNER <i>(Attach a list of all the people that will be associated/listed with the license)</i>	NAME: DEREK SANDERS	ATTORNEY/ REPRESENTAIVE	NAME: HEATHER KIRK/ HELBRAUN LEVEY LLP
	PHONE: (212) 920-7434		PHONE: 212-219-1193
	EMAIL: derek@esquinanyc.com		EMAIL: HEATHER@HELBRAUNLEVEY.COM
MANAGER	NAME: DIANA BOYAZ	LANDLORD	NAME: FARLEY RETAIL MASTER TENANT SPE
	PHONE: 6464096869		PHONE: 917.860.3100
	EMAIL: DIANA@ESQUINANYC.COM		EMAIL:
APPLICATION TYPE (<input checked="" type="checkbox"/> Liquor License <input type="checkbox"/> Unenclosed Sidewalk Cafe)			
<input checked="" type="checkbox"/> New	Has applicant owned or managed a similar business?	<input checked="" type="checkbox"/> YES	<input type="checkbox"/> NO
	What is/was the name and address of establishment?	La Esquina - 200 W 55th / 1402 2nd Ave / 114 Kenmare	
	What were the dates applicant was involved with this former premise?	All active and open	
<input type="checkbox"/> Corp Change/Class Change/Removal	What is the license # and expiration date?		
	Is applicant making any alterations or operational changes?	<input type="checkbox"/> YES	<input type="checkbox"/> NO
	<i>If alterations or operational changes are being made, please describe/list all changes.</i>		
<input type="checkbox"/> Alteration	What is the current license # and expiration date?		
	<i>Please list/describe the nature of all the changes and attach the plans:</i>		
METHOD OF OPERATION			
TYPE OF ALCOHOL	<input checked="" type="checkbox"/> Liquor/Wine/Beer & Cider	<input type="checkbox"/> Beer & Cider	<input type="checkbox"/> Wine/Beer & Cider
ESTABLISHMENT TYPE	<input checked="" type="checkbox"/> Restaurant	<input type="checkbox"/> Cabaret	<input type="checkbox"/> Night Club
	<input type="checkbox"/> Adult Entertainment	<input type="checkbox"/> Wine Bar	<input type="checkbox"/> Dance Club
	<input type="checkbox"/> Hotel	<input type="checkbox"/> Bar/Tavern	<input type="checkbox"/> Catering Establishment
	<input type="checkbox"/> Sports Bar	<input type="checkbox"/> Club (Fraternal Organization – Members Only)	
Has applicant/owner filed with the SLA? If yes, when? If no, when do you plan to file?	YES	NO	NO; WILL FILE AFTER MEETING
Is the 500 Foot Rule applicable? If yes, please attach a diagram of the On-Premise Liquor license establishments within a 500 ft. radius of your establishment and the Public Interest Statement.	YES	NO	YES, SEE ATTACHED.
Is the 200 Foot Rule applicable? If yes, please attach a diagram of the schools and houses of worship that trigger the rule.	YES	NO	NO.
Has applicant/owner(s) read MCB4 Policy Regarding Concentration and Location of Alcoholic-Serving Establishments?	YES	NO	YES.

OPERATIONAL DETAILS (*Closing time will be when establishment is vacated of all patrons)

HOURS* <i>(Indoor Only)</i>		MONDAY	TUESDAY	WEDNESDAY	THURSDAY	FRIDAY	SATURDAY	SUNDAY
	Operation	11am-1am	11am-1am	11am-1am	11am-1am	11am-1am	11am-1am	11am-1am
	Kitchen	11am-12am	11am-12am	11am-12am	11am-12am	11am-12am	11am-12am	11am-12am
	Music	11am-12am	11am-12am	11am-12am	11am-12am	11am-12am	11am-12am	11am-12am

If you plan to have music, what type(s)? (Circle all that apply)

BACKGROUND
 LIVE MUSIC
 DJ
 JUKE BOX
 KARAOKE

OCCUPANCY

	Capacity (Certificate of Occupancy)	Maximum # of Persons You Anticipate Occupying Premises (Including Employees)	Number of Tables	Number of Seats	Number of Service Only Bars	Number of Stand-Up Bars	Number of Seats at Stand-Up Bar
INSIDE	900(food hall)	40	9	24	0	1	9
OUTSIDE <i>(Other than sidewalk café)</i>	N/A	N/A	N/A	N/A	N/A	N/A	N/A
SIDEWALK CAFÉ	N/A	N/A	N/A	N/A	N/A	N/A	N/A

How many floors are there? What is the capacity for each floor? **1, CONCOURSE LEVEL OF TRAIN HALL, 780 SQ FT**

How frequently will the owner(s) be at the establishment? **MANAGER ON SITE, OWNERS WILL BE THERE MULTIPLE TIMES A WEEK**

Will there be dancing? YES NO

Will applicant have bottle or table service for beverage alcohol? YES NO

Will you be hosting private; promotional or corporate events? YES NO

Will outside promoters be used on a regular basis? If yes please describe. YES NO

Will you have a security plan? If, yes please attach. YES NO **Security provided by train hall**

Will security plan be implemented? YES NO

Will State certified security personnel be used? YES NO

Will New York Nightlife Association and NYPD Best Practices be followed? YES NO

Will applicant be using delivery bicycles? If yes, how many? YES NO

Will delivery bicycles be clearly marked with the name of the restaurant and will staff wear attire clearly noting name as described by NYC Law? YES NO **n/a**

Where will delivery bicycles be stored during the day when not in use? **n/a**

LOCATION & ZONING

Is this a Special District? If yes, is it Clinton, West Chelsea or Hudson Yards?	<input type="checkbox"/> YES	<input checked="" type="checkbox"/> NO	
Does the building have a Certificate of Occupancy ("C of O") or a letter of no objection?	<input checked="" type="checkbox"/> YES	<input type="checkbox"/> NO	
Is a Public Assembly permit required?	<input checked="" type="checkbox"/> YES	<input type="checkbox"/> NO	
Are your plans filed with DOB?	<input checked="" type="checkbox"/> YES	<input type="checkbox"/> NO	

Community Notification/Relations

NOTIFICATION: List all block associations; tenant associations, co-op boards or condo boards of residential buildings; and community groups that applicant has notified regarding its application. For each please list both the organization and individual you contacted	# 1	notice posting - 1/22/24
	# 2	email to all block association groups on provided list
	# 3	
	# 4	
	# 5	
Please provide dates when applicant met with the groups listed above.		n/a
Who was your contact person at each group you met with?		see list provided by CB
When did applicant post the notice that was provided?		1/22/24
Where did applicant post the notice that was provided?		on building entrances and lamp posts around 1 block
Will applicant provide owner cell phone number to neighbors and respond to complaints that arise? Please provide number in space provided.		<input checked="" type="checkbox"/> YES <input type="checkbox"/> NO
Will applicant inform the Community Board office of its job openings and/or provide a hyperlink to applicants jobs webpage?		<input type="checkbox"/> YES <input checked="" type="checkbox"/> NO

BUILDING DESIGN			
State the name and type of business previously located in the space.	vacant space in food hall		
Has a liquor-licensed establishment previously occupied this space at any time? If yes, please provide the name of the business.	<input type="checkbox"/> YES	<input checked="" type="checkbox"/> NO	*other kiosks in food hall are licensed.
Do you plan any changes to the existing façade? If yes, please describe.	<input type="checkbox"/> YES	<input type="checkbox"/> NO	(n/a)
Has the applicant/owner(s) read MCB 4 ADA Guidelines Memo?	<input checked="" type="checkbox"/> YES	<input type="checkbox"/> NO	
Is the entrance ADA Compliant?	<input checked="" type="checkbox"/> YES	<input type="checkbox"/> NO	
Do you plan any changes to the existing façade? If yes, please describe.	<input type="checkbox"/> YES	<input type="checkbox"/> NO	(n/a)
Will applicant have a vestibule within the establishment?	<input type="checkbox"/> YES	<input type="checkbox"/> NO	(n/a)
Will applicant use a storm enclosure?	<input type="checkbox"/> YES	<input type="checkbox"/> NO	(n/a)
Will applicant agree not to place any items or obstructions on the sidewalk, for example, sandwich boards, sidewalk signs, freestanding menus and plants, as per the law?	<input type="checkbox"/> YES	<input type="checkbox"/> NO	(n/a)
Will applicant comply with the NYC noise code?	<input checked="" type="checkbox"/> YES	<input type="checkbox"/> NO	
Will the establishment have any of the following: (circle all that apply)	<input type="checkbox"/> FRENCH DOORS	<input type="checkbox"/> GARAGE DOORS	<input type="checkbox"/> WINDOWS THAT CAN BE OPENED
Will applicant close all windows, French doors, garage doors when any music or amplified sound (including televisions) is played inside the establishment?	<input type="checkbox"/> YES	<input type="checkbox"/> NO	(n/a) - located in concourse floor of train hall.
Will applicant close all windows, French doors, garage doors by 11 PM Friday and Saturday and 10 PM on all other days even if no music or amplified sound is played inside the establishment?	<input type="checkbox"/> YES	<input type="checkbox"/> NO	(n/a) - located in concourse floor of train hall.
Has applicant obtained an acoustical report from a certified sound engineer to assess potential noise disturbance to the neighboring residents and buildings?	<input type="checkbox"/> YES	<input checked="" type="checkbox"/> NO	
Will applicant follow the recommendations of a certified sound engineer to mitigate potential noise disturbance to the neighboring residents and buildings, including placing speakers on the floor of the establishment?	<input type="checkbox"/> YES	<input type="checkbox"/> NO	(n/a) - located in concourse floor of train hall.
Will the kitchen exhaust system extend to the roof?	<input type="checkbox"/> YES	<input type="checkbox"/> NO	handled by train hall; unknown
Will the establishment have an illuminated sign?	<input type="checkbox"/> YES	<input type="checkbox"/> NO	(n/a) - located in concourse floor of train hall.
Will the establishment have a canopy extending over the sidewalk?	<input type="checkbox"/> YES	<input type="checkbox"/> NO	(n/a) - located in concourse floor of train hall.
Where will the air conditioner be located? What type is it?	handled by train hall; unknown		
When was the air conditioner installed?	handled by train hall; unknown		

OUTDOOR ITEMS - OTHER THEN SIDEWALK CAFÉ

Has the applicant/owner(s) read MCB 4 Rear Yard Rooftop Policy?	<input type="checkbox"/> YES	<input checked="" type="checkbox"/> NO	(n/a) - located in concourse floor of train hall.
Will applicant use any outdoor spaces: rooftop, rear yard, patio, porch, balcony, pavilion, tents, deck or gazebo? If yes, which one(s)?	<input type="checkbox"/> YES	<input checked="" type="checkbox"/> NO	(n/a) - located in concourse floor of train hall.
Are the floorplans for the outdoor space(s) included?	<input type="checkbox"/> YES	<input type="checkbox"/> NO	N/A
Will applicant close and vacate the outdoor space(s) by 11PM on Friday & Saturday and 10 PM on all other days?	<input type="checkbox"/> YES	<input type="checkbox"/> NO	N/A
Will the service and consumption of alcohol in any outdoor space only be via seated food service?	<input type="checkbox"/> YES	<input type="checkbox"/> NO	N/A
Will applicant not allow standing space for patrons to drink or smoke in any outdoor space(s)?	<input type="checkbox"/> YES	<input type="checkbox"/> NO	N/A
Will there be no amplified music, as per the law?	<input type="checkbox"/> YES	<input type="checkbox"/> NO	N/A
If amplified sound is played inside the establishment, will windows and doors be closed?	<input type="checkbox"/> YES	<input type="checkbox"/> NO	N/A
Will applicant agree to post signs outside asking customers to respect the neighbors'?	<input type="checkbox"/> YES	<input type="checkbox"/> NO	N/A
Will applicant agree to train staff to encourage a peaceful environment?	<input checked="" type="checkbox"/> YES	<input type="checkbox"/> NO	
Will applicant provide effective sound control (landscaping enclosure, soundproofing tenants apartments)	<input type="checkbox"/> YES	<input type="checkbox"/> NO	N/A
Will there be a lighting plan that allows safe usage of the outdoor space without disrupting neighbors?	<input type="checkbox"/> YES	<input type="checkbox"/> NO	N/A

OUTDOOR ITEMS – SIDEWALK CAFÉ

Has the applicant/owner(s) read MCB4 Sidewalk Café Policy?	<input type="checkbox"/> YES	<input checked="" type="checkbox"/> NO	
Will applicant be applying for a sidewalk café now or in the future?	<input type="checkbox"/> YES	<input checked="" type="checkbox"/> NO	
Is applicant in this application seeking to include a sidewalk café in its liquor license?	<input type="checkbox"/> YES	<input checked="" type="checkbox"/> NO	
If yes, has applicant submitted an application and plans to NYC Dept. of Consumer Affairs? Please attach application and plans.	<input type="checkbox"/> YES	<input type="checkbox"/> NO	N/A
Will applicant close and vacate the sidewalk café by 11 PM on Friday & Saturday and 10 PM on all other days?	<input type="checkbox"/> YES	<input type="checkbox"/> NO	N/A
Will applicant be serving alcohol in the sidewalk café? If so, will you have waiter service?	<input type="checkbox"/> YES	<input type="checkbox"/> NO	N/A
Will the café have a 3 ft. wide serving aisle running the entire length of the sidewalk cafe?	<input type="checkbox"/> YES	<input type="checkbox"/> NO	N/A
Will applicant mark the perimeter of the café on the sidewalk?	<input type="checkbox"/> YES	<input type="checkbox"/> NO	N/A
Will the service and consumption of alcohol in the sidewalk café only be via seated food service?	<input type="checkbox"/> YES	<input type="checkbox"/> NO	N/A
Will the sidewalk café not provide standing space for drinking or smoking?	<input type="checkbox"/> YES	<input type="checkbox"/> NO	N/A
Will applicant use any portable natural gas heaters? If so, do you have the requisite approvals from DOB & the Fire Department?	<input type="checkbox"/> YES	<input type="checkbox"/> NO	N/A
Will applicant have a lighting plan that will allow safe usage of the outdoor space without disrupting neighbors?	<input type="checkbox"/> YES	<input type="checkbox"/> NO	N/A
Will all furniture, plants and barricades be stored inside between the evening closing hours and the morning opening hours?	<input type="checkbox"/> YES	<input type="checkbox"/> NO	N/A
Will all furniture be stored inside between December 21 st and March 21 st , and any other day when it rains or snows?	<input type="checkbox"/> YES	<input type="checkbox"/> NO	N/A
Will applicant use umbrellas?	<input type="checkbox"/> YES	<input type="checkbox"/> NO	N/A
If construction or construction protection has reduced the sidewalk width, will applicant always maintain an 8 foot clear path of sidewalk between the perimeter of the café and the closes obstruction including construction barricades?	<input type="checkbox"/> YES	<input type="checkbox"/> NO	N/A

ADDITIONAL STIPULATIONS: (Office Use Only)

To the extent any additional stipulation on pages 7 and 8 of this application conflicts with any response on pages 1 – 6 of this application, the stipulations on pages 7 and 8 control.

ADDITIONAL STIPULATIONS: (Office Use Only), *Continued*

To the extent any additional stipulation on pages 7 and 8 of this application conflicts with any response on pages 1 – 6 of this application, the stipulations on pages 7 and 8 control.

Manhattan Community Board 4 (MCB4) recommends:
 (MCB4's recommendation is based on a vote taken at its
 March 6, 2024 full board meeting, with 36 members voting in favor
 of the recommendation, 0 members opposed, 0 members
 abstaining and 0 present but not eligible)

Denial unless all stipulations agreed to by applicant/owner are part of the method of
 operation
 Denial Approval

CB4 REPRESENTATIVES

 Nelly Gonzalez CB4 Assistant District Manager	 Frank Holozubiec CB4 BLP Committee Co-Chair	 Yoni Bokser CB4 BLP Committee Co-Chair
---	---	--

APPLICANT AGREEMENT WITH THE COMMUNITY

Applicant agrees to these stipulations as the basis for the community support of this application and acknowledges that all of these stipulations are essential prerequisites to the MCB4 recommendation regarding this application. Applicant agrees to have these stipulations incorporated in the method of operation of its liquor license. The stipulations in this application constitute the entire agreement between MCB4 and applicant and may only be altered in writing signed by MCB4 and applicant. These stipulations supersede any oral statements or representations in connection with this application.

SIGN HERE →	DETCEK SANDERS PRINT NAME OF APPLICANT	 SIGNATURE OF APPLICANT	1.30.24 DATE
-------------	---	--	-----------------



LA ESQUINA

Cafe Food Menu

@esquinanyc 646.613.7100 esquinanyc.com

SMALL PLATES

GUACAMOLE Y CHIPS 15

Hass Avocado, Onion, Cilantro, Jalapeño and Fresh Lime Juice with La Esquina Corn Chips and Salsa Molcajete

TOSTADA CONTRAMAR 9

Corn Tostada, Chipotle Mayo, Diced Tuna and Yuzu, Crispy Leeks, Avocado

ELOTE CALLEJERO 7

Grilled Corn, Queso Cotija, Mayonnaise, Chile Piquin

QUESO FUNDIDO 13

Melted Chihuahua Cheese Served with Salsa Verde and Corn & Flour Tortillas
Add Chorizo or Roasted Oyster Mushrooms +5

SOPA DE TORTILLA 14

Smoky Tomato Soup, Shredded Chicken, Queso Fresco, Avocado, Tortilla Strips and Crispy Chicharron

TACOS

Two Tacos Per Order

11.50

POLLO ADOBADO

Adobo-grilled Chicken, Salsa Verde,
Cilantro, Onion

BISTEC CON QUESO

Sliced Steak, Crispy Queso Monterey, Tomatillo
Salsa, Cilantro, Onion

CAMARON

Grilled Shrimp, Cabbage, Salsa Verde,
Chipotle Mayo, Pickled Red Onion

COLIFLOR

Roasted Cauliflower, Guacamole, Salsa Macha, Queso
Fresco

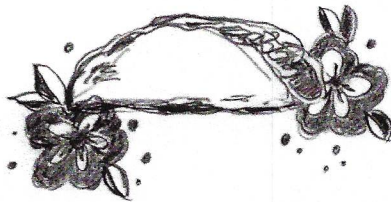

SALADS / BOWLS

16

ENSALADA DE LA CASA

Mixed Little Gems, Cotija Cheese, Fresh Nopales,
Burnt Red Onion, Avocado, Jalapeño Dressing, Smoked
Almonds

JULIA'S GRAIN BOWL

Mexican Lentil and Bean Salad, Roasted Chayote
Squash, Oyster Mushrooms, Little Gem Lettuces,
Pickled Red Onion, Avocado, Rice

Add your choice of:

Roasted Chicken +5

Grilled Shrimp +5

Sunny-Side-Up Egg +2

SIDES

EJOTES 7
Charred String Beans, Lime Garlic Dressing

PLATANOS MACHOS FRITOS 6
Fried Plantains, Salsa Verde, Queso Fresco

MOROS Y CRISTIANOS 5
White Rice, Black Beans, Queso Fresco,
Pico de Gallo

FRIJOLES 5
Black Beans

ARROZ 5
White Rice

TORTILLAS 4
Yellow Corn

AVOCADO 5

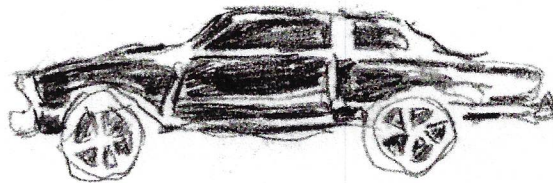

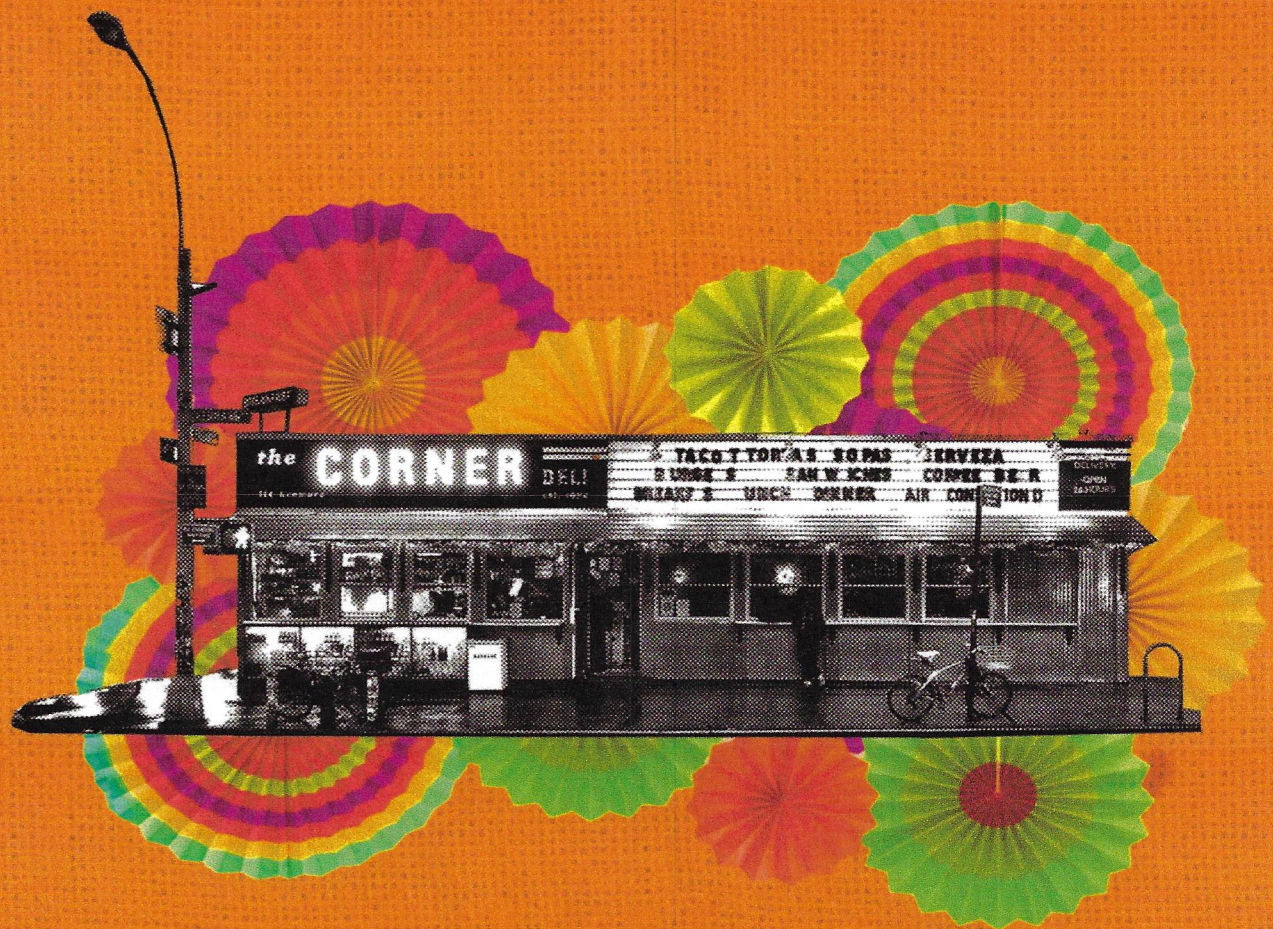

LA ESQUINA

Cafe Beverage Menu

@esquinanyc 646.613.7100 esquinanyc.com

LA ESQUINA COCKTAILS

La Esquina only uses fresh fruits and juices

SEXICO 14/42

Tequila Blanco, Lime, Lemon, Agave

EL MACIZO CON FRUTA 14/42

Tequila Reposado, Passion Fruit
or Blood Orange

SPICEY DAISY 14/42

Tequila Blanco, Lime, Lemon, Jalapeño

PEPINO DIABLO 14/42

Tequila, Cucumber, Jalapeño, Lime

MEZCALITA 14/42

Mezcal, Lime, Lemon, Agave

GIN PALOMA 15

Gin, Grapefruit, Lime, Agave



WINE

IN A CAN 12

WHITE

Ah-So, Viura & Garnacha Blanco (Navarre, Spain)

ROSÉ

Ah-So, Garnacha Rose (Navarre, Spain)

RED

Gotham Project, Cabernet Sauvignon (New York)

TEQUILA

BLANCO

Casamigos – floral, herbal, delicate 16

Gran Centenario Plata – earthy, spicy, vegetal 14

REPOSADO

Patron – citrus, pepper, honey 16

Corralejo – rich, pungent, round 14

ANEJO

Casa Noble – toasty, caramel, vanilla 17

ArtenOM "1146" – nutty, orange, cocoa 26

MEZCAL

El Peloton Joven – rich, spicy, earthy 13

Buen Bicho Espadin Joven – light, vegetal, floral 15

Illegal Reposado – smoky, full, round 18

SPIRITS

VODKA

Tito's (Texas) 14

RUM

Charanda Uruapan (Mexico) 15

GIN

Greenhook "American Dry" (New York) 14

WHISKEY

Sierra Norte Single Barrel
"Black Corn" (Mexico) 17



CERVEZAS

TECATE 6

BOHEMIA 7

NEGRA MODELO 8

MICHELADA +5

Lime, Valentina, Tajin

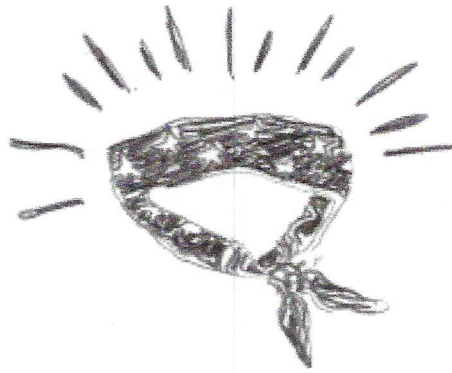

SODAS & WATER

COCA-COLA	3
DIET COKE	3
GINGER ALE	3
JARRITOS	4
Mandarin, Grapefruit, Tamarind	
Agua de Piedra Mineral Water	
Still	3 / 7
Sparkling	3.50

AGUAS FRESCAS

JAMAICA	5
Tangy Mexican Hibiscus	
HORCHATA	5
Refreshing, Mexican rice drink	

Block Plot Diagram

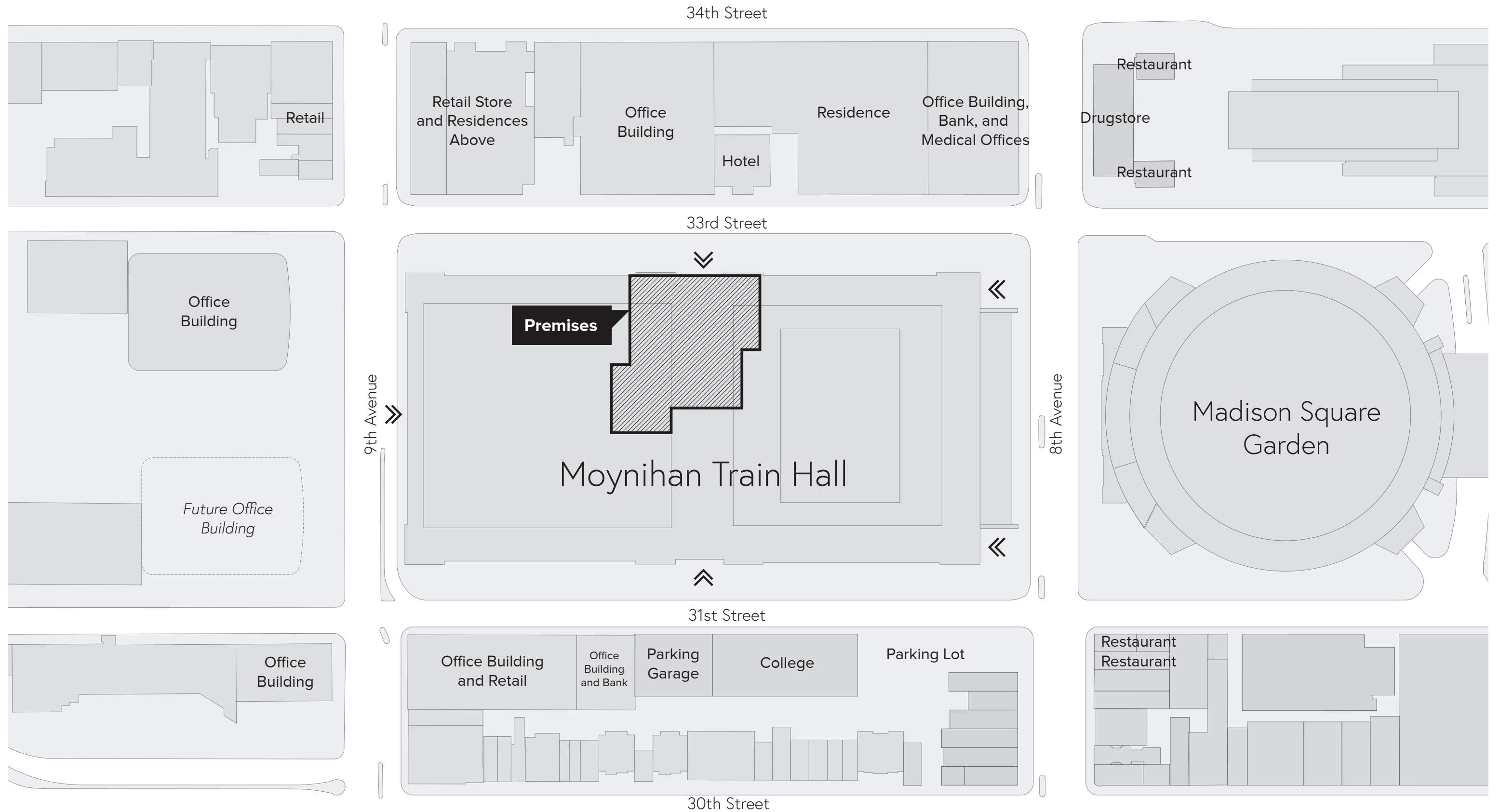

HELBRAUN | LEVEY

NEIGHBORHOOD MAP

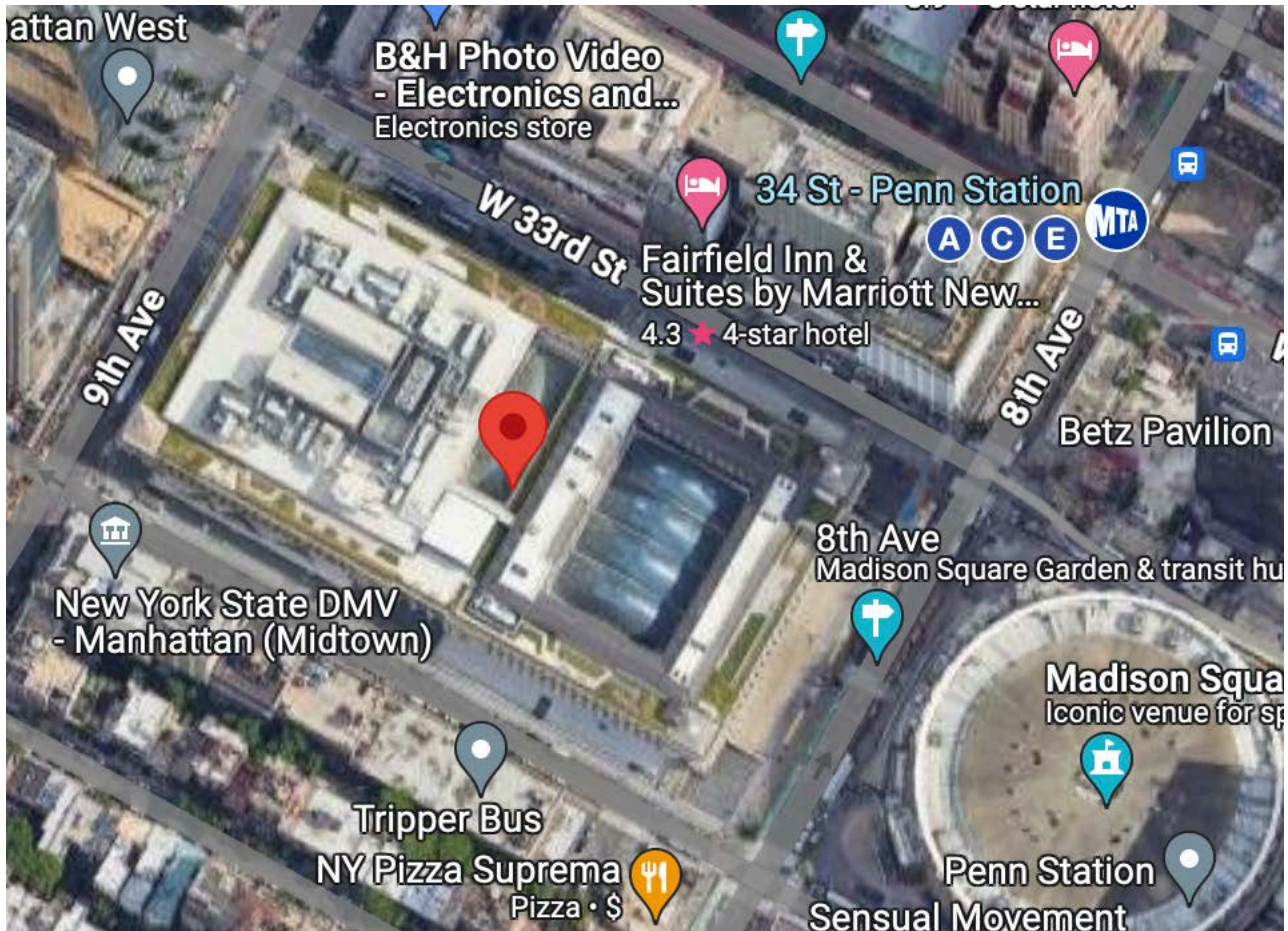

HELBRAUN | LEVEY

500 FOOT MAP

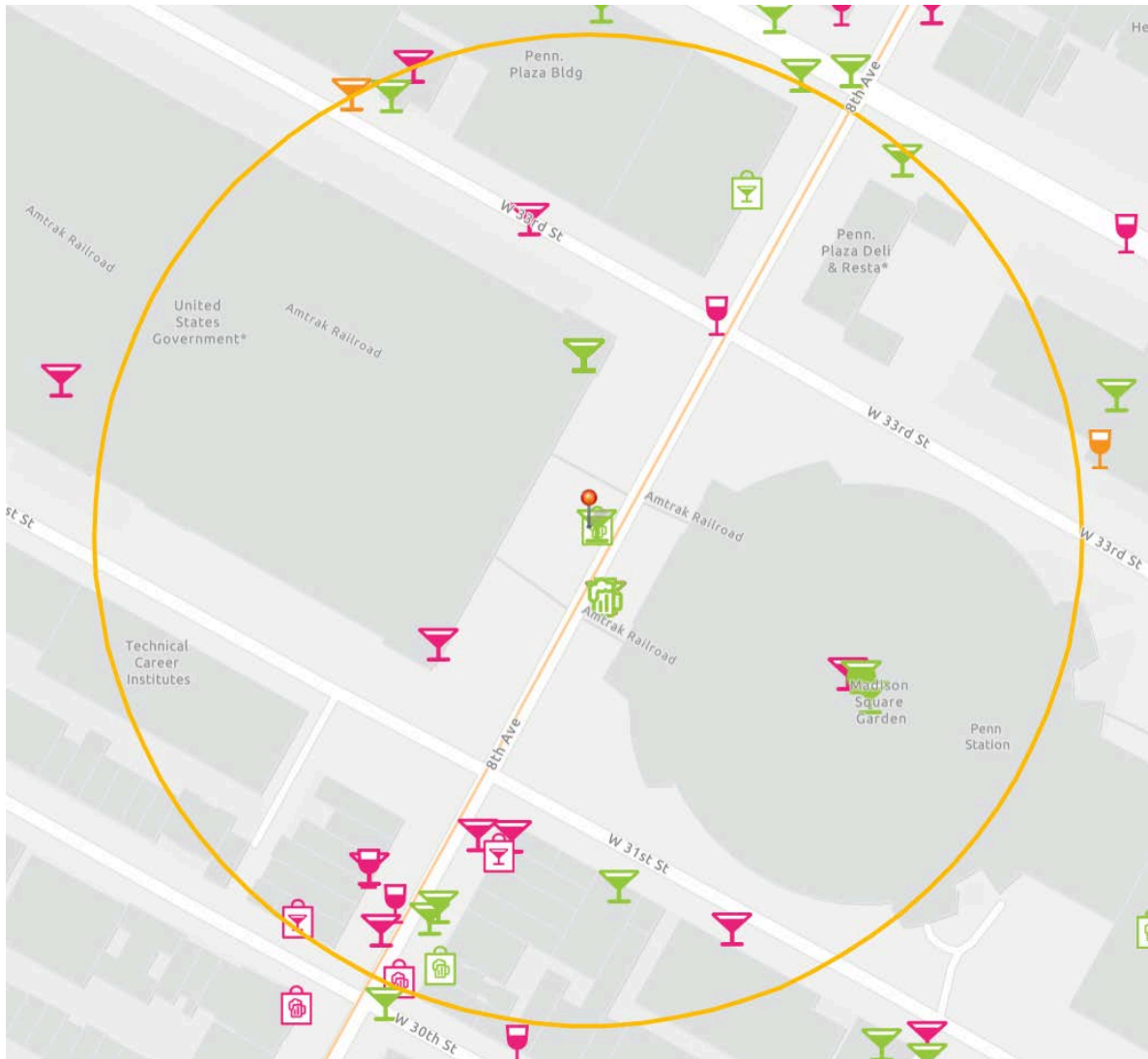

GREEN MARTINI=OP LICENSE
PINK MARTINI= INACTIVE OP LICENSE
GREEN WINE=RW/TW LICENSE
PINK WINE=INACTIVE RW/TW LICENSE

This report is for informational purposes only in aid of identifying establishments potentially subject to 500 and 200 foot rules. Distances are approximated using industry standard GIS techniques and do not reflect actual distances between points of entry. The NYS Liquor Authority makes no representation as to the accuracy of the information and disclaims any liability for errors.

Proximity Report For:	
Location	441 8th Ave, New York, New York, 10001
Geocode	Latitude: 40.75097 longitude: -73.99447
Report Generated On	1/18/2024

8 Closest Liquor Stores		
Name	Address	Distance
BARRIL WINES & LIQUORS INC License ID: 0100-22-117862 Legacy Serial No.: 1315255	5 7 CARYL AVE YONKERS, New York 10705	379 ft
NRS WINE AND LIQUOR INC License ID: 0100-21-115199 Legacy Serial No.: 1336044	391 8TH AVE NEW YORK, NY 10001	670 ft
RAJ WINE LLC License ID: 0100-22-117690 Legacy Serial No.: 1314271	PENN STATION 7TH AVE CORRIDOR-SPACE 23B NEW YORK, New York 10001	708 ft
342 350 LIQUOR CORP License ID: 0100-21-114109 Legacy Serial No.: 1286875	342 7TH AVE STE 3 NEW YORK, New York 10001	1,115 ft
BARRELMORE WINE & SPIRITS INC License ID: 0100-22-116157 Legacy Serial No.: 1295123	488 7TH AVE NEW YORK, New York 10018	1,435 ft
AMSTERWINE.COM INC License ID: 0100-23-126194 Legacy Serial No.: 1356273	475 9TH AVE SPACE A NEW YORK, New York 10018	1,578 ft
HUDSON YARDS WINES & SPIRITS INC License ID: 0100-23-125394 Legacy Serial No.: 1320790	486 9TH AVE NEW YORK, New York 10018	1,608 ft
MEENA SAMANI CORPORATION License ID: 0100-22-116891 Legacy Serial No.: 1273576	460 W 34TH ST STORE# 1 NEW YORK, New York 10001	1,609 ft

Schools within 500 feet		
Name	Address	Distance
No Schools within 500 feet		

Churches within 500 feet	
Name	Distance
No Churches within 500 feet	

Pending On Premises Liquor Licenses within 750 feet		
Name	Address	Distance
PENN DISTRICT BP LLC & PASTA PENN LLC Application ID: NA-0340-23-104016	349 W 33RD ST NEW YORK, New York 10001.0	501 ft

Active On Premises Liquor Licenses within 750 feet		
Name	Address	Distance
ARAMARK SERVICES INC License ID: 0340-21-118638 Legacy Serial No.: 1336869	421 8TH AVE AKA 372 NINTH AVE NEW YORK, New York 10001	10 ft
GENTS ENTERPRISES INC License ID: 0340-23-127606 Legacy Serial No.: 1023985	PENN STATION-MAIN CONCOURSE NEW YORK, New York 10001	70 ft
AMTRAK N R P CORP License ID: 0358-23-227433 Legacy Serial No.: 2001351	PENN STATION UNDER OPTION B NEW YORK, New York 10001	176 ft
AMTRAK N R P CORP License ID: 0358-23-227597 Legacy Serial No.: 2001397	PENN STATION UNDER OPTION B NEW YORK, New York 10001	176 ft
AMTRAK N R P CORP License ID: 0358-23-227420 Legacy Serial No.: 2001342	PENN STATION UNDER OPTION B NEW YORK, New York 10001	176 ft
AMTRAK N R P CORP License ID: 0358-23-227471 Legacy Serial No.: 2001383	PENN STATION UNDER OPTION B NEW YORK, New York 10001	176 ft
AMTRAK N R P CORP License ID: 0358-23-227427 Legacy Serial No.: 2001375	PENN STATION UNDER OPTION B NEW YORK, New York 10001	176 ft
AMTRAK N R P CORP License ID: 0358-23-227565 Legacy Serial No.: 2001345	PENN STATION UNDER OPTION B NEW YORK, New York 10001	176 ft
AMTRAK N R P CORP License ID: 0358-23-227629 Legacy Serial No.: 2001369	PENN STATION UNDER OPTION B NEW YORK, New York 10001	176 ft
AMTRAK N R P CORP License ID: 0358-23-227437 Legacy Serial No.: 2001367	PENN STATION UNDER OPTION B NEW YORK, New York 10001	176 ft
AMTRAK N R P CORP License ID: 0358-23-235445 Legacy Serial No.: 2001405	PENN STATION UNDER OPTION B NEW YORK, New York 10001	176 ft
AMTRAK N R P CORP License ID: 0358-23-227699 Legacy Serial No.: 2001389	PENN STATION UNDER OPTION B NEW YORK, New York 10001	176 ft
AMTRAK N R P CORP License ID: 0358-23-227648	PENN STATION UNDER OPTION B	176 ft

Active On Premises Liquor Licenses within 750 feet		
Name	Address	Distance
Legacy Serial No.: 2001396	NEW YORK, New York 10001	
AMTRAK N R P CORP License ID: 0358-23-227702 Legacy Serial No.: 2001392	PENN STATION UNDER OPTION B NEW YORK, New York 10001	176 ft
AMTRAK N R P CORP License ID: 0358-23-227424 Legacy Serial No.: 2001359	PENN STATION UNDER OPTION B NEW YORK, New York 10001	176 ft
AMTRAK N R P CORP License ID: 0358-23-227631 Legacy Serial No.: 2001378	PENN STATION UNDER OPTION B NEW YORK, New York 10001	176 ft
AMTRAK N R P CORP License ID: 0358-23-227428 Legacy Serial No.: 2001376	PENN STATION UNDER OPTION B NEW YORK, New York 10001	176 ft
AMTRAK N R P CORP License ID: 0358-23-227572 Legacy Serial No.: 2001372	PENN STATION UNDER OPTION B NEW YORK, New York 10001	176 ft
AMTRAK N R P CORP License ID: 0358-23-227595 Legacy Serial No.: 2001388	PENN STATION UNDER OPTION B NEW YORK, New York 10001	176 ft
AMTRAK N R P CORP License ID: 0358-23-227646 Legacy Serial No.: 2001387	PENN STATION UNDER OPTION B NEW YORK, New York 10001	176 ft
AMTRAK N R P CORP License ID: 0358-23-227435 Legacy Serial No.: 2001365	PENN STATION UNDER OPTION B NEW YORK, New York 10001	176 ft
AMTRAK N R P CORP License ID: 0358-23-227430 Legacy Serial No.: 2001348	PENN STATION UNDER OPTION B NEW YORK, New York 10001	176 ft
AMTRAK N R P CORP License ID: 0358-23-227436 Legacy Serial No.: 2001366	PENN STATION UNDER OPTION B NEW YORK, New York 10001	176 ft
AMTRAK N R P CORP License ID: 0358-23-235751 Legacy Serial No.: 2001408	PENN STATION UNDER OPTION B NEW YORK, New York 10001	176 ft
AMTRAK N R P CORP License ID: 0358-23-227645 Legacy Serial No.: 2001385	PENN STATION UNDER OPTION B NEW YORK, New York 10001	176 ft
AMTRAK N R P CORP License ID: 0358-23-227596 Legacy Serial No.: 2001395	PENN STATION UNDER OPTION B NEW YORK, New York 10001	176 ft
AMTRAK N R P CORP License ID: 0358-23-227598 Legacy Serial No.: 2001402	PENN STATION UNDER OPTION B NEW YORK, New York 10001	176 ft
AMTRAK N R P CORP License ID: 0358-23-227621 Legacy Serial No.: 2001335	PENN STATION UNDER OPTION B NEW YORK, New York 10001	176 ft
AMTRAK N R P CORP License ID: 0358-23-235796 Legacy Serial No.: 2001404	PENN STATION UNDER OPTION B NEW YORK, New York 10001	176 ft
AMTRAK N R P CORP License ID: 0358-23-227438 Legacy Serial No.: 2001368	PENN STATION UNDER OPTION B NEW YORK, New York 10001	176 ft

Active On Premises Liquor Licenses within 750 feet		
Name	Address	Distance
AMTRAK N R P CORP License ID: 0358-23-227623 Legacy Serial No.: 2001344	PENN STATION UNDER OPTION B NEW YORK, New York 10001	176 ft
AMTRAK N R P CORP License ID: 0358-23-227560 Legacy Serial No.: 2001338	PENN STATION UNDER OPTION B NEW YORK, New York 10001	176 ft
AMTRAK N R P CORP License ID: 0358-23-227564 Legacy Serial No.: 2001343	PENN STATION UNDER OPTION B NEW YORK, New York 10001	176 ft
AMTRAK N R P CORP License ID: 0358-23-227423 Legacy Serial No.: 2001358	PENN STATION UNDER OPTION B NEW YORK, New York 10001	176 ft
AMTRAK N R P CORP License ID: 0358-23-235749 Legacy Serial No.: 2001406	PENN STATION UNDER OPTION B NEW YORK, New York 10001	176 ft
AMTRAK N R P CORP License ID: 0358-23-227421 Legacy Serial No.: 2001356	PENN STATION UNDER OPTION B NEW YORK, New York 10001	176 ft
AMTRAK N R P CORP License ID: 0358-23-227649 Legacy Serial No.: 2001403	PENN STATION UNDER OPTION B NEW YORK, New York 10001	176 ft
AMTRAK N R P CORP License ID: 0358-23-227628 Legacy Serial No.: 2001362	PENN STATION UNDER OPTION B NEW YORK, New York 10001	176 ft
AMTRAK N R P CORP License ID: 0358-23-227425 Legacy Serial No.: 2001373	PENN STATION UNDER OPTION B NEW YORK, New York 10001	176 ft
AMTRAK N R P CORP License ID: 0358-23-227473 Legacy Serial No.: 2001399	PENN STATION UNDER OPTION B NEW YORK, New York 10001	176 ft
AMTRAK N R P CORP License ID: 0358-23-227701 Legacy Serial No.: 2001391	PENN STATION UNDER OPTION B NEW YORK, New York 10001	176 ft
AMTRAK N R P CORP License ID: 0358-23-227627 Legacy Serial No.: 2001360	PENN STATION UNDER OPTION B NEW YORK, New York 10001	176 ft
AMTRAK N R P CORP License ID: 0358-23-227571 Legacy Serial No.: 2001370	PENN STATION UNDER OPTION B NEW YORK, New York 10001	176 ft
AMTRAK N R P CORP License ID: 0358-23-227474 Legacy Serial No.: 2001400	PENN STATION UNDER OPTION B NEW YORK, New York 10001	176 ft
AMTRAK N R P CORP License ID: 0358-23-227700 Legacy Serial No.: 2001390	PENN STATION UNDER OPTION B NEW YORK, New York 10001	176 ft
RAILROAD PASSENGER SERVICES CORP License ID: 0358-23-127084 Legacy Serial No.: 1138563	PENN STATION NEW YORK, New York 10001	176 ft
AMTRAK N R P CORP License ID: 0358-23-227625 Legacy Serial No.: 2001353	PENN STATION UNDER OPTION B NEW YORK, New York 10001	176 ft

Active On Premises Liquor Licenses within 750 feet		
Name	Address	Distance
AMTRAK N R P CORP License ID: 0358-23-227566 Legacy Serial No.: 2001374	PENN STATION UNDER OPTION B NEW YORK, New York 10001	176 ft
AMTRAK N R P CORP License ID: 0358-23-227422 Legacy Serial No.: 2001357	PENN STATION UNDER OPTION B NEW YORK, New York 10001	176 ft
AMTRAK N R P CORP License ID: 0358-23-227426 Legacy Serial No.: 2001374	PENN STATION UNDER OPTION B NEW YORK, New York 10001	176 ft
AMTRAK N R P CORP License ID: 0358-23-227630 Legacy Serial No.: 2001371	PENN STATION UNDER OPTION B NEW YORK, New York 10001	314 ft
AMTRAK N R P CORP License ID: 0358-23-227472 Legacy Serial No.: 2001384	PENN STATION UNDER OPTION B NEW YORK, New York 10001	314 ft
MSG ARENA LLC License ID: 0340-22-111364 Legacy Serial No.: 1288582	4 PENNSYLVANIA PLAZA NEW YORK, New York 10121	332 ft
TNN OPERATING LLC License ID: 0340-22-104269 Legacy Serial No.: 1294294	254 W 31ST ST NEW YORK, New York 10001	361 ft
AMA RESTAURANTS LLC License ID: 0340-22-106062 Legacy Serial No.: 1153660	410 8TH AVENUE 31ST & 32ND STREETS NEW YORK, New York 10001	410 ft
NAVIC INVEST GROUP LLC License ID: 0340-23-137165 Legacy Serial No.: 1265672	408 8TH AVE NEW YORK, New York 10001	425 ft
NY 33RD LEASEHOLD LLC,FIVE POINTS OPRTG TENANT LLC License ID: 0343-21-102308 Legacy Serial No.: 1334766	325 W 33RD ST NEW YORK, New York 10001	481 ft
PANMELLITO INC License ID: 0340-23-131149 Legacy Serial No.: 1325354	PENN STATION MAIN CONCOURSE, SPACE# 68B NEW YORK, New York 10001	490 ft
CHIPOTLE MEXICAN GRILL OF COLORADO LLC License ID: 0340-21-116089 Legacy Serial No.: 1145224	304 W 34TH ST NEW YORK, New York 10001	506 ft
402 8TH AVENUE REST INC License ID: 0340-23-131503 Legacy Serial No.: 1024099	402 8TH AVENUE NEW YORK, New York 10001	520 ft
AMERICAN MULTI-CINEMA INC License ID: 0340-23-131188 Legacy Serial No.: 1322890	312 W 34TH ST NEW YORK, New York 10001	529 ft
NEW YORKER HOTEL MANAGEMENT COMPANY INC & License ID: 0343-22-131290 Legacy Serial No.: 1023277	481 8TH AVENUE STE 633 NEW YORK, New York 10001	534 ft
MANHATTAN CENTER STUDIOS INC License ID: 0340-22-105261 Legacy Serial No.: 1103659	311 W 34TH STREET NEW YORK, New York 10001	552 ft
LOCAL WEST LLC License ID: 0340-23-131570 Legacy Serial No.: 1157796	ONE PENN PLAZA WEST STORE ROOF NEW YORK, New York 10119	552 ft

Active On Premises Liquor Licenses within 750 feet		
Name	Address	Distance
AMTRAK N R P CORP License ID: 0358-23-227434 Legacy Serial No.: 2001364	PENN STATION UNDER OPTION B NEW YORK, New York 10001	598 ft
TRACKS 31 LLC License ID: 0340-23-137191 Legacy Serial No.: 1320711	220 W 31ST ST NEW YORK, New York 10001	636 ft
34TH STREET DINER INC License ID: 0340-23-135308 Legacy Serial No.: 1283055	481 8TH AVE STORE 1 NEW YORK, New York 10001	677 ft
34TH STREET DINER INC License ID: 0340-23-131485 Legacy Serial No.: 1024091	481 8TH AVE STORE 2 NEW YORK, New York 10001	677 ft
WALTERS BAR INC License ID: 0340-22-107039 Legacy Serial No.: 1024070	389 8TH AVE NEW YORK, New York 10001	702 ft
WHISKEYBARRELBAR LLC License ID: 0340-23-131757 Legacy Serial No.: 1270766	247 W 30TH ST NEW YORK, New York 10001	728 ft

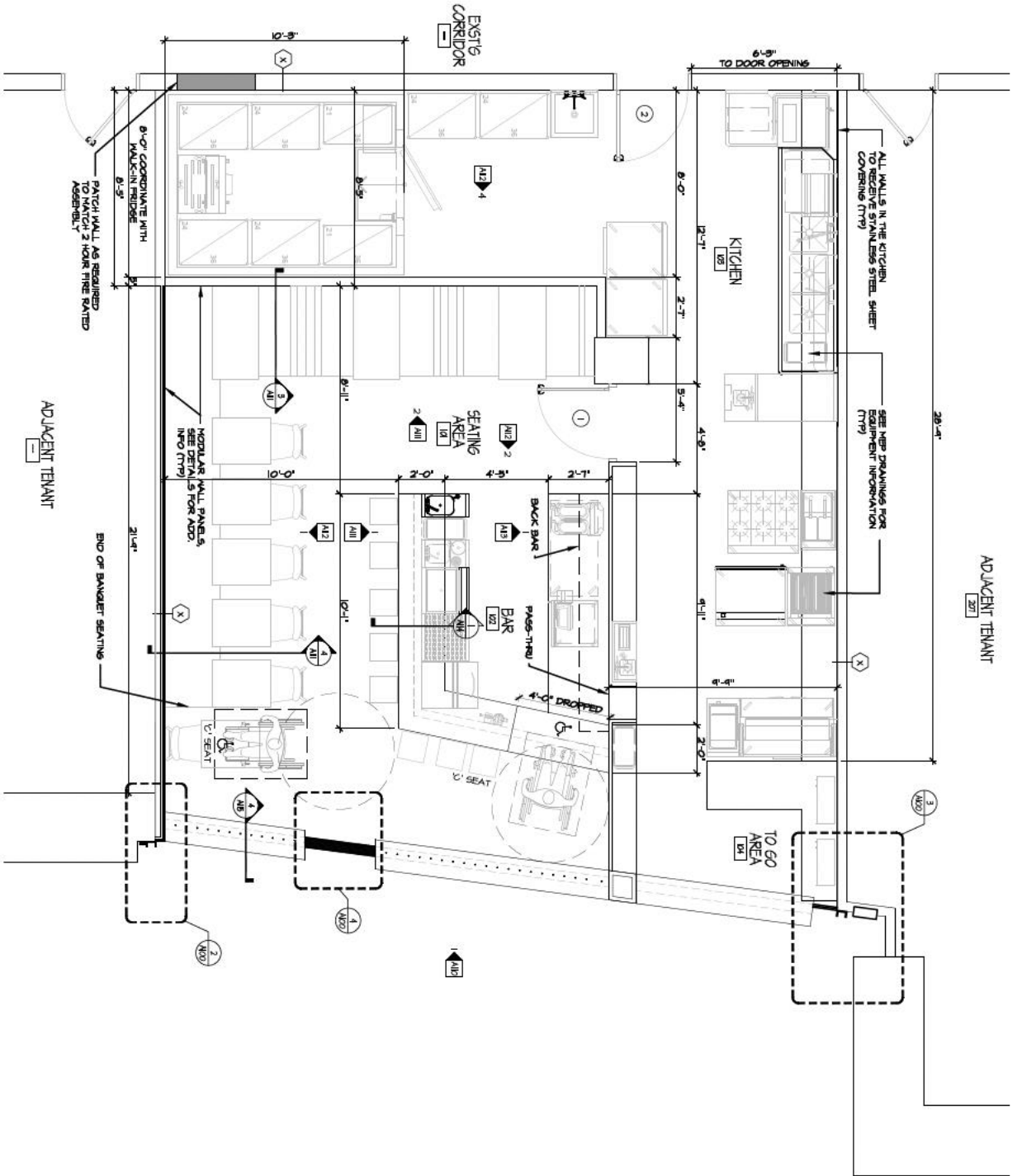

1 PARTIAL FIRST FLOOR PLAN
 3/8" = 1'-0"

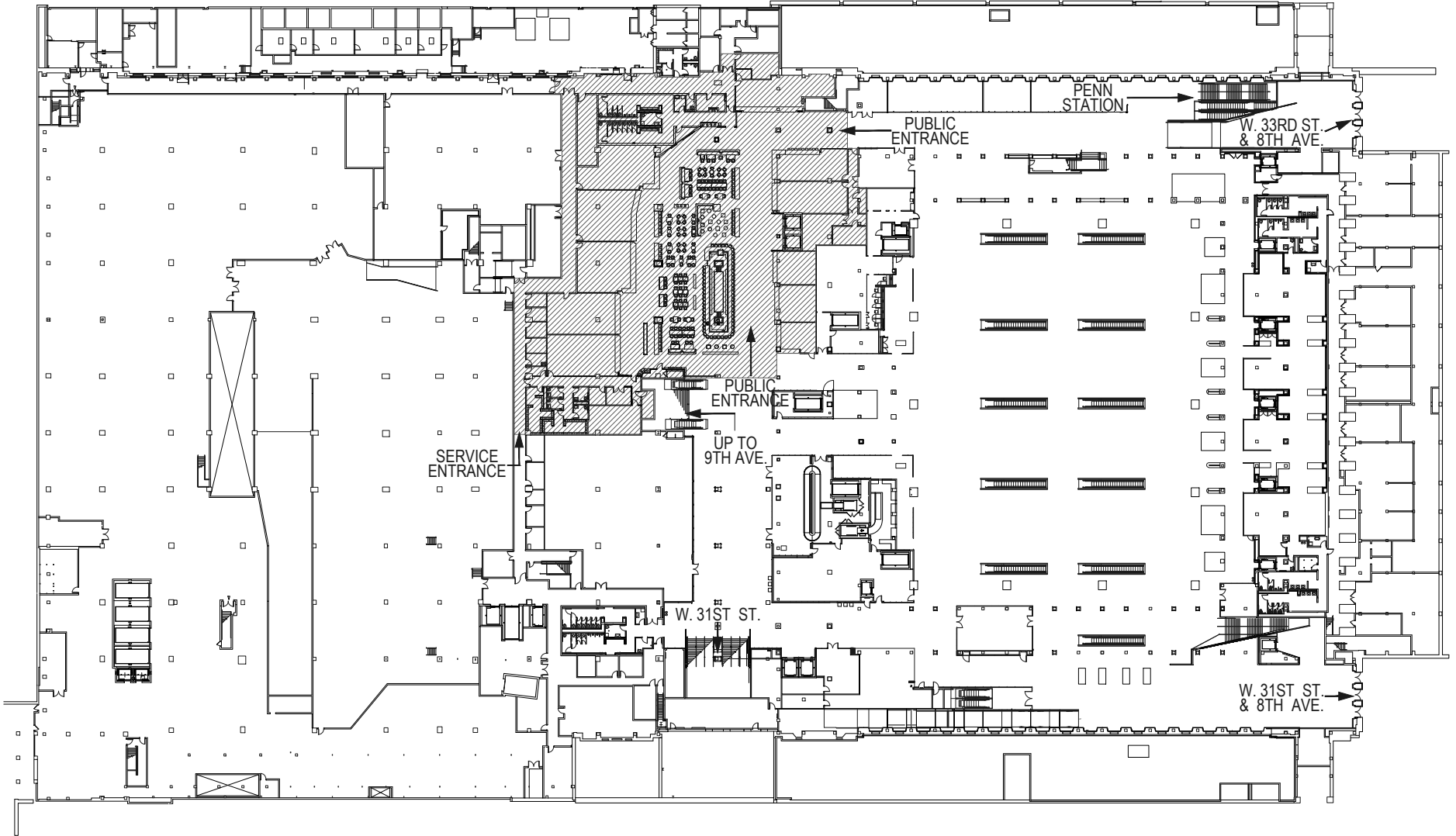

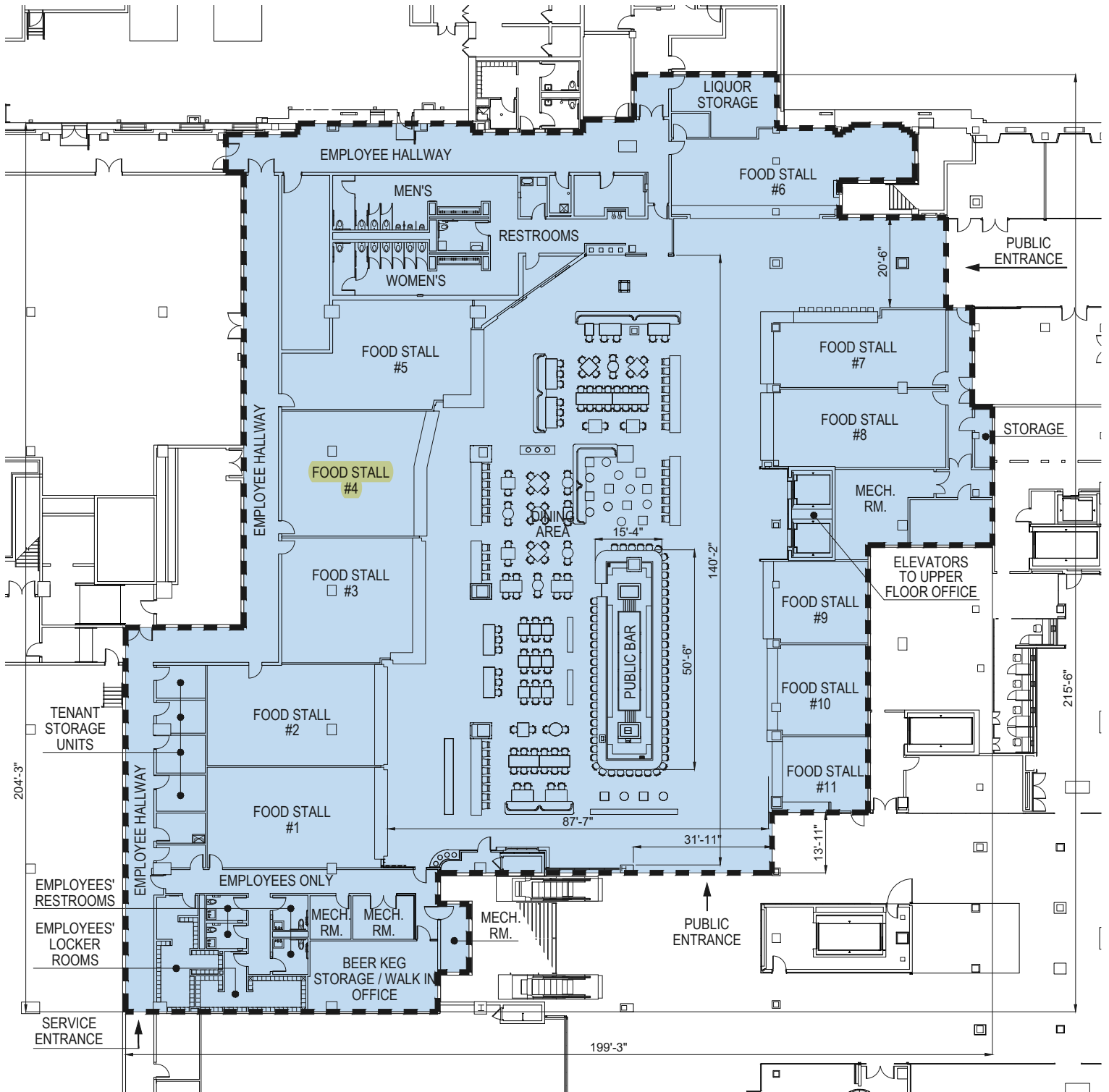

MOYNIHAN TRAIN HALL CONCOURSE LEVEL

MANHATTAN WEST & HUDSON YARDS

9TH AVENUE

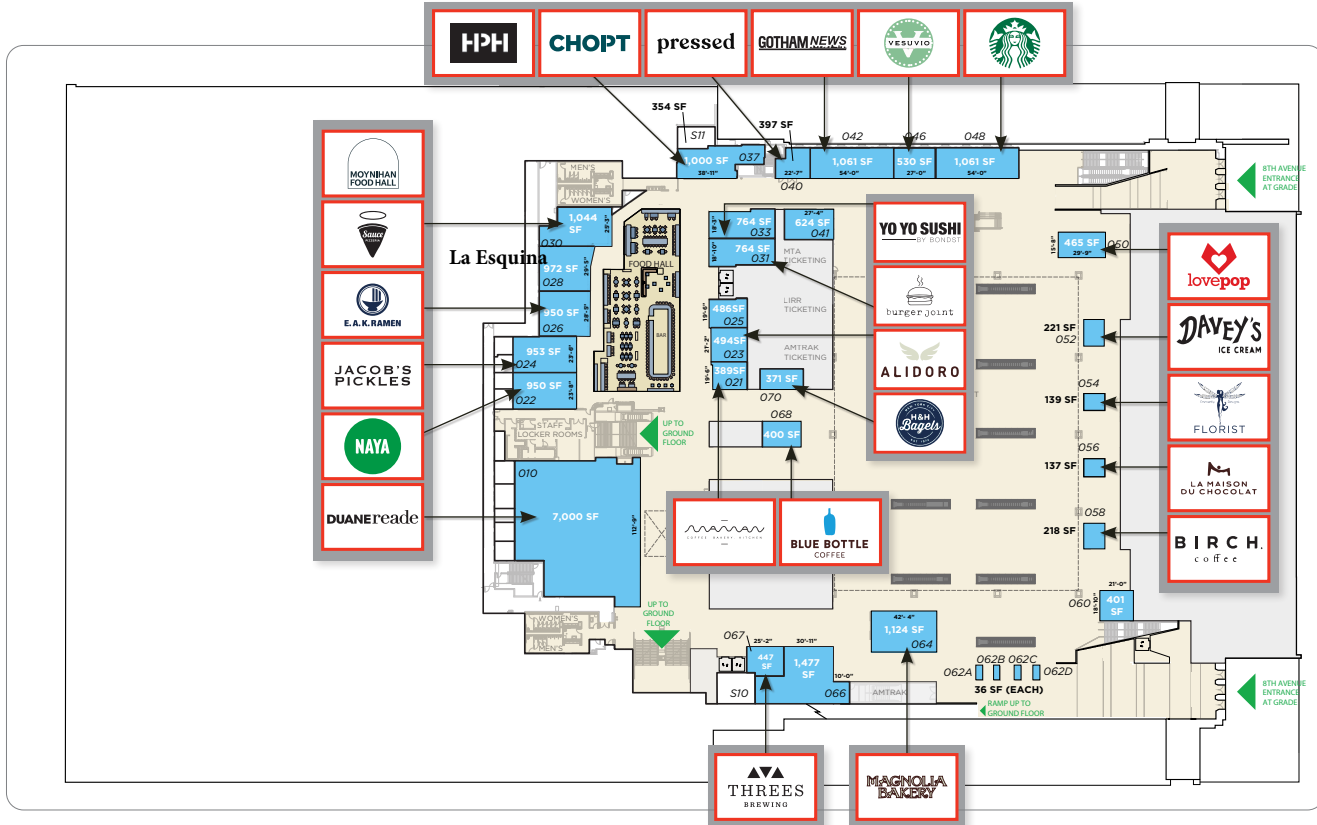

8TH AVENUE

MADISON SQUARE GARDEN
PENN STATION





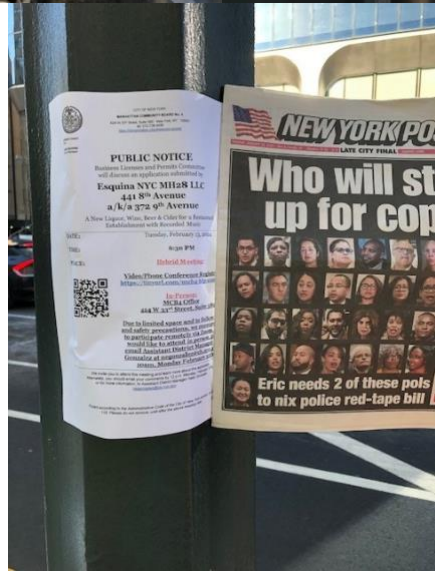
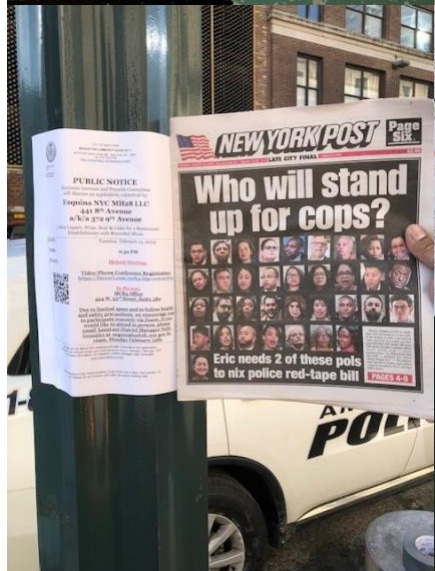
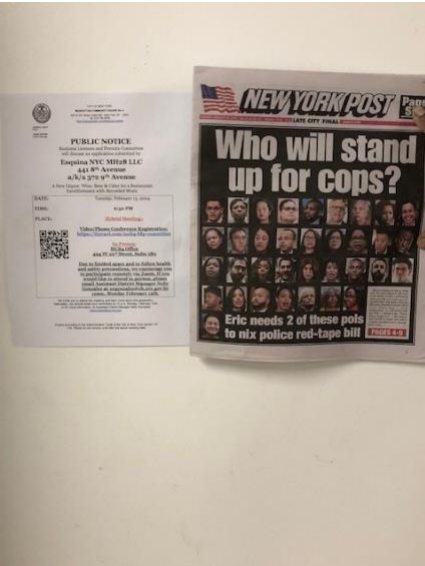
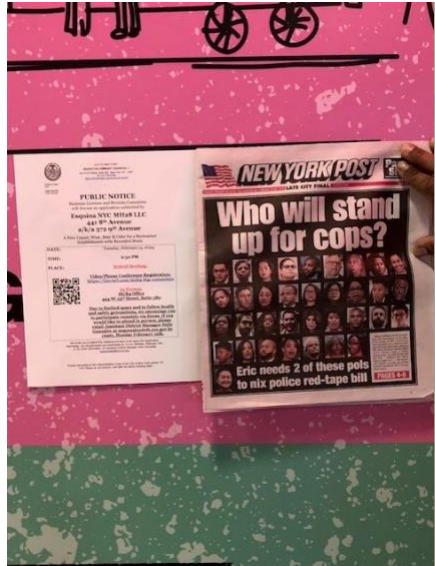



Who will stand up for cops?



Eric needs 2 of these pols to nix police red-tape bill

Mayor Adams needs to yank two city lawmakers to his side if he wants to kill a potential veto override of a controversial cop bill that will make officers file more detailed reports after every street stop — even minor ones. To effectively kill the bill — dubbed the “How Many Stops Act” — the mayor also needs to make sure other council members don’t change their votes.

PAGES 4-9

West 30's Block Associations/Tenant Associations/Community Groups

Block/Tenant Association & Community Groups	First name	Last name	E-MAIL	PHONE
HKNA (incl. Dog Run)	Kathleen	Treat	kathleentreat123@gmail.com	
West 36th Street	Frank	Strock	mcgee79@aol.com	
CHDC (incl. Bob's & bird parks)	Joe	Restuccia	info@clintonhousing.org; jrestuccia2@clintonhousing.org	
CHDC (incl. Bob's & bird parks)	Ryan	Marcano	rmarcano@clintonhousing.org	
Hudson Yards Hell's Kitchen Alliance	Bob	Benfatto	rjbenfatto@hyhkalliance.org	
Hudson Yards Hell's Kitchen Alliance	Patty	Gouris	pgouris@hyhkalliance.org	
Hotel Americano			(212) 216-0000	
Highline537	Scott	Hupe	212-838-3700	
Donna Langman Costumes	Donna	Langman	donna@donnalangman.com	
CHEKPEDS	Christine	Berthet	excom@chekpeds.com	
Hell's Kitchen Block Association (W 33rd/34th/35th Streets (8th to 12th Avenues)	Julia	Campanelli	HellsKBA@gmail.com	Last Wednesday of the month, except August or November
W36th Block Association (8/9)	Brian	Weber	brianscottweber@gmail.com	
W36th Block Association (8/9)	Cressida	Connelly	cressidac@gmail.com	

When sending an email please bcc everyone on the list

LA ESQUINA

Derek Sanders <derek@esquinanyc.com>

La Esquina at Moynihan Hall

1 message

Derek Sanders <derek@esquinanyc.com>

Mon, Jan 29, 2024 at 7:47 PM

To: Derek Sanders <derek@esquinanyc.com>

Cc: Derek Sanders <derek@esquinanyc.com>

Bcc: kathleentreat123@gmail.com, info@clintonhousing.org, mcgee79@aol.com, jrestuccia2@clintonhousing.org, rmarcano@clintonhousing.org, rjbenfatto@hyhkalliance.org, pgouris@hyhkalliance.org, donna@donnalangman.com, excom@chekpeds.com, HellsKBA@gmail.com, brianscottweber@gmail.com, cressidac@gmail.com, negonzalez@cb.nyc.gov

Hi,

My name is Derek Sanders. I am the owner of La Esquina restaurants. We serve traditional family style Mexican food and drinks. Our flagship location opened in Soho in 2005. In 2017 we opened (2) small cafes on west 55th street and east 73rd street. Currently we are building a new cafe in the food court of Moynihan Train Hall on the lower level of the station. We will be located in a 780sf space between Sauce Pizza and E.A. Ramen in the food court.

Like our other La Esquina cafes we will be serving a full menu at Moynihan Hall including small plates (guacamole, tuna tostada, grilled corn, queso fundido, tortilla soup), tacos (chicken, sliced steak, grilled shrimp, roasted cauliflower) house salad and a mexican grain bowl (lentil and bean salad, squash, mushrooms, lettuce, avocado and rice) along with your choice of a protein. Our beverages will include beer, wine, our signature margarita, along with other traditional cocktails.

I'm looking forward to being part of the community and serving you authentic Mexican food and drinks.

kind regards,
Derek

--
Derek Sanders

E: derek@esquinanyc.com

C: (212) 920-7434

[La Esquina](#)