

Manhattan Community Board 4

(All Fields Must Be Completed)

Liquor License/Sidewalk Cafe Stipulations Application

CORPORATION NAME Aramark Services Inc.		DOING BUSINESS AS (DBA) N/A	
STREET ADDRESS 509 West 34th Street		CROSS STREETS Hudson Boulevard and Tenth Avenue in Hudson Yards	ZIP CODE 10001
OWNER <i>(Attach a list of all the people that will be associated/listed with the license)</i>	NAME: N/A	ATTORNEY/ REPRESENTATIVE	NAME: Maston J. Sansom
	PHONE:		PHONE: 518-407-5800
	EMAIL:		EMAIL: Maston.Sansom@srclawoffices.com
MANAGER	NAME: Aramark Services, Inc.	LANDLORD	NAME: 509 W 34 LLC
	PHONE: 412-456-2044		PHONE: (212)588-8662
	EMAIL: chris@flaherty-ohara.com		EMAIL: fcaplan@tishmanspeyer.com
APPLICATION TYPE (<input checked="" type="checkbox"/> <i>Liquor License</i> _____ <i>Unenclosed Sidewalk Cafe</i>)			
<input checked="" type="checkbox"/> New	Has applicant owned or managed a similar business?	<input checked="" type="checkbox"/> YES	<input type="checkbox"/> NO
	What is/was the name and address of establishment?	See attached	
	What were the dates applicant was involved with this former premise?	Currently active licenses	
<input type="checkbox"/> Corp Change/Class Change/Removal	What is the license # and expiration date?		
	Is applicant making any alterations or operational changes?	<input type="checkbox"/> YES	<input type="checkbox"/> NO
	If alterations or operational changes are being made, please describe/list all changes.		
<input type="checkbox"/> Alteration	What is the current license # and expiration date?		
	Please list/describe the nature of all the changes and attach the plans:		
METHOD OF OPERATION			
TYPE OF ALCOHOL	<input checked="" type="checkbox"/> Liquor/Wine/Beer & Cider <input type="checkbox"/> Beer & Cider <input type="checkbox"/> Wine/Beer & Cider		
ESTABLISHMENT TYPE	<input type="checkbox"/> Restaurant <input type="checkbox"/> Cabaret <input type="checkbox"/> Night Club <input type="checkbox"/> Hotel <input type="checkbox"/> Bar/Tavern <input checked="" type="checkbox"/> Catering Establishment <input type="checkbox"/> Adult Entertainment <input type="checkbox"/> Wine Bar <input type="checkbox"/> Dance Club <input type="checkbox"/> Sports Bar <input type="checkbox"/> Club (Fraternal Organization – Members Only)		
Has applicant/owner filed with the SLA? If yes, when? If no, when do you plan to file?	<input type="checkbox"/> YES	<input checked="" type="checkbox"/> NO	Upon approval of the Community Board.
Is the 500 Foot Rule applicable? If yes, please attach a diagram of the On-Premise liquor license establishments within a 500 ft. radius of your establishment and the Public Interest Statement.	<input checked="" type="checkbox"/> YES	<input type="checkbox"/> NO	Please see attached.
Is the 200 Foot Rule applicable? If yes, please attach a diagram of the schools and houses of worship that trigger the rule.	<input type="checkbox"/> YES	<input checked="" type="checkbox"/> NO	
Has applicant/owner(s) read MCB4 Policy Regarding Concentration and Location of Alcoholic-Serving Establishments?	<input checked="" type="checkbox"/> YES	<input type="checkbox"/> NO	

OPERATIONAL DETAILS (*Closing time will be when establishment is vacated of all patrons)

		MONDAY	TUESDAY	WEDNESDAY	THURSDAY	FRIDAY	SATURDAY	SUNDAY
HOURS* <i>(Indoor Only)</i>	Operation	6am - 8pm	6am - 8pm	6am - 8pm	6am - 8pm	6am - 8pm	N/A	N/A
	Kitchen	All hours that alcohol is served.						
	Music	Music is only played during evening events and is only low-level background music.						
If you plan to have music, what type(s)? (Circle all that apply)			<input checked="" type="checkbox"/> BACKGROUND	<input type="checkbox"/> LIVE MUSIC	<input type="checkbox"/> DJ	<input type="checkbox"/> JUKE BOX	<input checked="" type="checkbox"/> KARAOKE	

OCCUPANCY

	Capacity (Certificate of Occupancy)	Maximum # of Persons Occupying Premises (Including Employees)	Number of Tables	Number of Seats	Number of Service Only Bars	Number of Stand-Up Bars	Number of Seats at Stand-Up Bar
INSIDE	172	172	27	172	1	2	0
OUTSIDE <i>(Other than sidewalk café)</i>	N/A	N/A	N/A	N/A	N/A	N/A	N/A
DCA APPROVED UNENCLOSED SIDEWALK CAFÉ	N/A	N/A	N/A	N/A			

How many floors are there? What is the capacity for each floor?

4 floors (25th, 26th, 27th, and 28th floors)

How frequently will the owner(s) be at the establishment?

Aramark is a publicly traded company, as such their shareholders will not be present. A manager will always be present.

Will there be dancing?

YES NO

Will applicant have bottle or table service for beverage alcohol?

YES NO

Will applicant be hosting private; promotional or corporate events?

YES NO

Will outside promoters be used on a regular basis? If yes please describe.

YES NO

Will applicant have a security plan? If, yes please attach.

YES NO

Will security plan be implemented?

YES NO An alcohol security plan will be implemented.

Will State certified security personnel be used?

YES NO

Will New York Nightlife Association and NYPD Best Practices be followed?

YES NO

Does applicant agree to notify MCB4 prior to making changes to its method of operation?

YES NO

Will applicant be using delivery bicycles? If yes, how many?

YES NO

Will delivery bicycles be clearly marked with the name of the restaurant and will staff wear attire clearly noting name as described by NYC Law?

YES NO N/A

Where will delivery bicycles be stored during the day when not in use?

N/A

LOCATION & ZONING			
Is this a Special District? If yes, is it Clinton, West Chelsea or Hudson Yards?	YES <input checked="" type="checkbox"/>	NO	Location is within the Hudson Yards Hell's Kitchen Alliance
Does the building have a Certificate of Occupancy ("C of O") or a letter of no objection?	YES <input checked="" type="checkbox"/>	NO	
Is a Public Assembly permit required?	YES <input checked="" type="checkbox"/>	NO	
Are your plans filed with DOB?	YES <input checked="" type="checkbox"/>	NO	

Community Notification/Relations		
NOTIFICATION: List all block associations; tenant associations, co-op boards or condo boards of residential buildings; and community groups that applicant has notified regarding its application. For each please list both the organization and individual you contacted	# 1	All parties on the community board contact list were notified.
	# 2	
	# 3	
	# 4	
	# 5	
Please provide dates when applicant met with the groups listed above.	*Contact list was emailed on 2/6/2024	
Who was your contact person at each group you met with?	*Contacts provided by board	
When did applicant post the notice that was provided?	2/6/2024	
Where did applicant post the notice that was provided?	Exterior of premise and surrounding lightposts	
Will applicant provide owner cell phone number to neighbors and respond to complaints that arise? Please provide number in space provided.	YES	<input checked="" type="checkbox"/> NO We will provide, name and phone number of on-site manager.
Will applicant inform the Community Board office of its job openings and/or provide a hyperlink to applicants jobs webpage?	YES	NO All aramark positions are publicly posted at Aramark.com

BUILDING DESIGN												
State the name and type of business previously located in the space.	Currently operating as a hotel											
Has a liquor-licensed establishment previously occupied this space at any time? If yes, please provide the name of the business.	YES	<input checked="" type="checkbox"/> NO										
Do you plan any changes to the existing façade? If yes, please describe.	YES	<input checked="" type="checkbox"/> NO										
Has the applicant/owner(s) read MCB 4 ADA Guidelines Memo?	<input checked="" type="checkbox"/> YES	NO										
Is the entrance ADA Compliant?	<input checked="" type="checkbox"/> YES	NO										
Do you plan any changes to the existing façade? If yes, please describe.	YES	<input checked="" type="checkbox"/> NO										
Will applicant have a vestibule within the establishment?	<input checked="" type="checkbox"/> YES	NO	Lobby									
Will applicant use a storm enclosure?	YES	<input checked="" type="checkbox"/> NO	Premise is located on the 25th, 26th, 27th, and 28th floors									
Does applicant agree to keep the sidewalk clear of all items or obstructions, such as sandwich boards, sidewalk signs, freestanding menus and plants, as per the law?	YES	<input checked="" type="checkbox"/> NO	Premise is located on the 25th, 26th, 27th, and 28th floors									
Will applicant comply with the NYC noise code?	<input checked="" type="checkbox"/> YES	NO										
Will the establishment have any of the following: (circle all that apply) <input checked="" type="checkbox"/> N/A	<table border="1"> <thead> <tr> <th>FRENCH DOORS</th> <th>GARAGE DOORS</th> <th>WINDOWS THAT CAN BE OPENED</th> </tr> </thead> <tbody> <tr> <td>YES</td> <td>NO</td> <td>N/A</td> </tr> <tr> <td>YES</td> <td>NO</td> <td>N/A</td> </tr> </tbody> </table>			FRENCH DOORS	GARAGE DOORS	WINDOWS THAT CAN BE OPENED	YES	NO	N/A	YES	NO	N/A
FRENCH DOORS	GARAGE DOORS	WINDOWS THAT CAN BE OPENED										
YES	NO	N/A										
YES	NO	N/A										
Will applicant close all windows, French doors, garage doors when any music or amplified sound (including televisions) is played inside the establishment?	YES	NO	N/A									
Will applicant close all windows, French doors, garage doors by 11 PM Friday and Saturday and 10 PM on all other days even if no music or amplified sound is played inside the establishment?	YES	NO	N/A									
Has applicant obtained an acoustical report from a certified sound engineer to assess potential noise disturbance to the neighboring residents and buildings?	YES	<input checked="" type="checkbox"/> NO										
Will applicant follow the recommendations of a certified sound engineer to mitigate potential noise disturbance to the neighboring residents and buildings, including placing speakers on the floor of the establishment?	YES	<input checked="" type="checkbox"/> NO	No. This is for a Catering license, for private events. It will not open to the public.									
Will the kitchen exhaust system extend to the roof?	YES	<input checked="" type="checkbox"/> NO	ventless kitchen									
Will the establishment have an illuminated sign?	YES	<input checked="" type="checkbox"/> NO										
Will the establishment have a canopy extending over the sidewalk?	YES	<input checked="" type="checkbox"/> NO										
Where will the air conditioner be located? What type is it?	Conditioned air is supplied by the building's Landlord											
When was the air conditioner installed?	Conditioned air is supplied by the building's Landlord											

OUTDOOR ITEMS - OTHER THAN SIDEWALK CAFÉ			
Has the applicant/owner(s) read MCB 4 Rear Yard Rooftop Policy?	YES	NO	N/A
Will applicant use any outdoor spaces: rooftop, rear yard, patio, porch, balcony, pavilion, tents, deck, gazebo or open dining in the parking lane? If yes, which one(s)?	YES	NO	N/A
Are the floorplans for the outdoor space(s) included?	YES	NO	N/A
Will applicant close and vacate the outdoor space(s) by 11PM on Friday & Saturday and 10 PM on all other days?	YES	NO	N/A
Will the service and consumption of alcohol in any outdoor space only be via seated food service?	YES	NO	N/A
Will applicant not allow standing space for patrons to drink or smoke in any outdoor space(s) or on the sidewalk?	YES	NO	N/A
Will there be no amplified music, as per the law?	YES	NO	N/A
If amplified sound is played inside the establishment, will windows and doors be closed?	YES	NO	N/A
Will applicant agree to post signs outside asking customers to respect the neighbors'?	YES	NO	N/A
Will applicant agree to train staff to encourage a peaceful environment?	YES	NO	N/A
Will applicant provide effective sound control (landscaping enclosure, soundproofing tenants apartments)	YES	NO	N/A
Will there be a lighting plan that allows safe usage of the outdoor space without disrupting neighbors?	YES	NO	N/A
If open dining in the parking lane, will applicant agree to leave the sidewalk free of any furniture?	YES	NO	N/A
If open dining, will you comply with all NYC DOT guidelines?	YES	NO	N/A
If open dining, will the installation be year-round?	YES	NO	N/A

DCA APPROVED UNENCLOSED SIDEWALK CAFÉ	N/A		
Has the applicant/owner(s) read MCB4 Sidewalk Café Policy?	YES	NO	N/A
Will applicant be applying for a sidewalk café now or in the future?	YES	NO	N/A
Is applicant in this application seeking to include a sidewalk café in its liquor license?	YES	NO	N/A
If yes, has applicant submitted an application and plans to NYC Dept. of Consumer Affairs? Please attach application and plans.	YES	NO	N/A
Will applicant close and vacate the sidewalk café by 11 PM on Friday & Saturday and 10 PM on all other days?	YES	NO	N/A
Will applicant be serving alcohol in the sidewalk café? If so, will you have waiter service?	YES	NO	N/A
Will the café have a 3 ft. wide serving aisle running the entire length of the sidewalk café?	YES	NO	N/A
Will applicant mark the perimeter of the café on the sidewalk?	YES	NO	N/A
Will the service and consumption of alcohol in the sidewalk café only be via seated food service?	YES	NO	N/A
Will the sidewalk café not provide standing space for drinking or smoking?	YES	NO	N/A
Will applicant use any portable natural gas heaters? If so, do you have the requisite approvals from DOB & the Fire Department?	YES	NO	N/A
Will applicant have a lighting plan that will allow safe usage of the outdoor space without disrupting neighbors?	YES	NO	N/A
Will all furniture, plants and barricades be stored inside between the evening closing hours and the morning opening hours?	YES	NO	N/A
Will all furniture be stored inside between December 21 st and March 21 st , and any other day when it rains or snows?	YES	NO	N/A
Will applicant use umbrellas?	YES	NO	N/A
If construction or construction protection has reduced the sidewalk width, will applicant always maintain an 8 foot clear path of sidewalk between the perimeter of the café and the closest obstruction including construction barricades?	YES	NO	N/A
If open dining is in the parking lane, will applicant agree to remove its sidewalk café?	YES	NO	N/A

ADDITIONAL STIPULATIONS: (Office Use Only)



To the extent any additional stipulation on pages 7 and 8 of this application conflicts with any response on pages 1 – 6 of this application, the stipulations on pages 7 and 8 control.

ADDITIONAL STIPULATIONS: (Office Use Only), *Continued*

To the extent any additional stipulation on pages 7 and 8 of this application conflicts with any response on pages 1 – 6 of this application, the stipulations on pages 7 and 8 control.

<p>Manhattan Community Board 4 (MCB4) recommends: <i>(MCB4's recommendation is based on a vote taken at its March 6, 2024 full board meeting, with 36 members voting in favor of the recommendation, 0 members opposed, 0 members abstaining and 0 present but not eligible)</i></p>	<p><input checked="" type="checkbox"/> Denial unless all stipulations agreed to by applicant/owner are part of the method of operation</p> <p><input type="checkbox"/> Denial <input type="checkbox"/> Approval</p>
---	---

CB4 REPRESENTATIVES

 <p>Nelly Gonzalez CB4 Assistant District Manager</p>	 <p>Frank Holozubiec CB4 BLP Committee Co-Chair</p>	 <p>Burt Lazario CB4 BLP Committee Co-Chair</p>
--	--	--

APPLICANT AGREEMENT WITH THE COMMUNITY

Applicant agrees to these stipulations as the basis for the community support of this application and acknowledges that all of these stipulations are essential prerequisites to the MCB4 recommendation regarding this application. Applicant agrees to have these stipulations incorporated in the method of operation of its liquor license. The stipulations in this application constitute the entire agreement between MCB4 and applicant and may only be altered in writing signed by MCB4 and applicant. These stipulations supersede any oral statements or representations in connection with this application.

<p>SIGN HERE →</p>	<p>James Tarangelo</p> <p>PRINT NAME OF APPLICANT</p>	 <p>SIGNATURE OF APPLICANT</p>	<p>4/11/24</p> <p>DATE</p>
---------------------------	--	--	-----------------------------------

ACTIVE LICENSES HELD BY ARAMARK SERVICES INC.

PremiseName	PremiseAddress1	PremiseAddress2	PremiseCity	PremiseState	PremiseZIP	CountyName
ARAMARK SERVICES INC	299 PARK AVE	27TH-29TH FLOORS	NEW YORK	New York	10171	New York
ARAMARK SERVICES INC	277 PARK AVE	17TH AND 18TH FL	NEW YORK	New York	10017	New York
ARAMARK SERVICES INC	383 MADISON AVE		NEW YORK	New York	10017	
ARAMARK SERVICES INC	388 GREENWICH ST	39TH FL	NEW YORK	New York	10013	New York
ARAMARK SERVICES INC	401 9TH AVE		NEW YORK	New York	10001	New York
ARAMARK SERVICES INC	51 MADISON AVE		NEW YORK	New York	10010	New York
ARAMARK SERVICES INC	1307 WALT WHITMAN RD		MELVILLE	New York	11747	Suffolk
ARAMARK SERVICES INC	645 5TH AVE		NEW YORK	New York	10022	New York
ARAMARK SERVICES INC	1301 6TH AVE	9TH FL	NEW YORK	New York	10019	New York
ARAMARK SERVICES INC	51 MADISON AVE	34TH FL	NEW YORK	New York	10010	New York
ARAMARK SERVICES INC	300 MADISON AVE		NEW YORK	New York	10017	New York
ARAMARK SERVICES INC	9 Park Pl		Corning	New York	14830	Steuben
ARAMARK SERVICES INC	55 E 52ND ST	FL 43 & 44	NEW YORK	New York	10022	New York
ARAMARK SERVICES INC	4 METROTECH CENTER	5TH FL	BROOKLYN	New York	11245	Kings
ARAMARK SERVICES INC	421 8TH AVE	AKA 372 NINTH AVE	NEW YORK	New York	10001	New York
ARAMARK SERVICES INC	1 RIVERFRONT PLAZA		CORNING	NY	14831	
ARAMARK SERVICES INC & CORNING MUSEUM OF GLASS INC	1 MUSEUM WAY		CORNING	NY	14830	Steuben
ARAMARK SERVICES INC & CORNING MUSEUM OF GLASS INC	1 MUSEUM WAY		CORNING	NY	14830	Steuben
ARAMARK SERVICES INC & CORNING MUSEUM OF GLASS INC	1 MUSEUM WAY		CORNING	NY	14830	Steuben
ARAMARK SERVICES INC & CORNING MUSEUM OF GLASS INC	1 MUSEUM WAY		CORNING	NY	14830	Steuben
ARAMARK SERVICES INC & CORNING MUSEUM OF GLASS INC	1 MUSEUM WAY		CORNING	New York	14830	
ARAMARK SERVICES INC	1 MUSEUM WAY		CORNING	NY	14830	
ARAMARK SERVICES INC & CORNING MUSEUM OF GLASS INC	1 MUSEUM WAY		CORNING	NY	14831	
ARAMARK SERVICES INC & CORNING MUSEUM OF GLASS INC	1 MUSEUM WAY		CORNING	NY	14830	Steuben
ARAMARK SERVICES INC & CORNING MUSEUM OF GLASS INC	1 MUSEUM WAY		CORNING	NY	14830	Steuben
ARAMARK SERVICES INC & CORNING MUSEUM OF GLASS INC	1 MUSEUM WAY		CORNING	NY	14830	Steuben
ARAMARK SERVICES INC & CORNING MUSEUM OF GLASS INC	1 MUSEUM WAY		CORNING	NY	14830	Steuben
ARAMARK SERVICES INC & CORNING MUSEUM OF GLASS INC	1 MUSEUM WAY		CORNING	NY	14830	Steuben
ARAMARK SERVICES INC & CORNING MUSEUM OF GLASS INC	1 MUSEUM WAY		CORNING	NY	14830	Steuben
ARAMARK SERVICES INC & CORNING MUSEUM OF GLASS INC	1 RIVERFRONT PLAZA		CORNING	NY	14830	Steuben
ARAMARK SERVICES INC & CORNING MUSEUM OF GLASS INC	1 MUSEUM WAY		CORNING	NY	14831	
ARAMARK SERVICES INC & CORNING MUSEUM OF GLASS INC	1 MUSEUM WAY		CORNING	NY	14830	Steuben
ARAMARK SERVICES INC & CORNING MUSEUM OF GLASS INC	1 MUSEUM WAY		CORNING	NY	14830	Steuben
ARAMARK SERVICES INC & CORNING MUSEUM OF GLASS INC	1 MUSEUM WAY		CORNING	NY	14830	Steuben
ARAMARK SERVICES INC	1 MUSEUM WAY		CORNING	NY	14831	
ARAMARK SERVICES INC & CORNING MUSEUM OF GLASS INC	1 MUSEUM WAY		CORNING	NY	14830	Steuben
ARAMARK SERVICES INC & CORNING MUSEUM OF GLASS INC	1 MUSEUM WAY		CORNING	NY	14830	Steuben
ARAMARK SERVICES INC & CORNING MUSEUM OF GLASS INC	1 MUSEUM WAY		CORNING	NY	14830	Steuben
ARAMARK SERVICES INC	1 RIVERFRONT PLAZA		CORNING	NY	14831	
ARAMARK SERVICES INC & CORNING MUSEUM OF GLASS INC	1 MUSEUM WAY		CORNING	NY	14830	Steuben
ARAMARK SERVICES INC & CORNING MUSEUM OF GLASS INC	1 MUSEUM WAY		CORNING	NY	14830	Steuben
ARAMARK SERVICES INC & CORNING MUSEUM OF GLASS INC	1 MUSEUM WAY		CORNING	NY	14830	Steuben
ARAMARK SERVICES INC	1 RIVERFRONT PLAZA		CORNING	NY	14831	
ARAMARK SERVICES INC & CORNING MUSEUM OF GLASS INC	1 MUSEUM WAY		CORNING	NY	14830	Steuben
ARAMARK SERVICES INC & CORNING MUSEUM OF GLASS INC	1 MUSEUM WAY		CORNING	NY	14830	Steuben
ARAMARK SERVICES INC & CORNING MUSEUM OF GLASS INC	1 MUSEUM WAY		CORNING	NY	14830	Steuben
ARAMARK SERVICES INC	1 RIVERFRONT PLAZA		CORNING	NY	14831	
ARAMARK SERVICES INC & CORNING MUSEUM OF GLASS INC	1 MUSEUM WAY		CORNING	NY	14830	Steuben
ARAMARK SERVICES INC	1 RIVERFRONT PLAZA		CORNING	NY	14831	
ARAMARK SERVICES INC & CORNING MUSEUM OF GLASS INC	1 MUSEUM WAY		CORNING	NY	14830	Steuben
ARAMARK SERVICES INC & CORNING MUSEUM OF GLASS INC	1 MUSEUM WAY		CORNING	NY	14830	Steuben

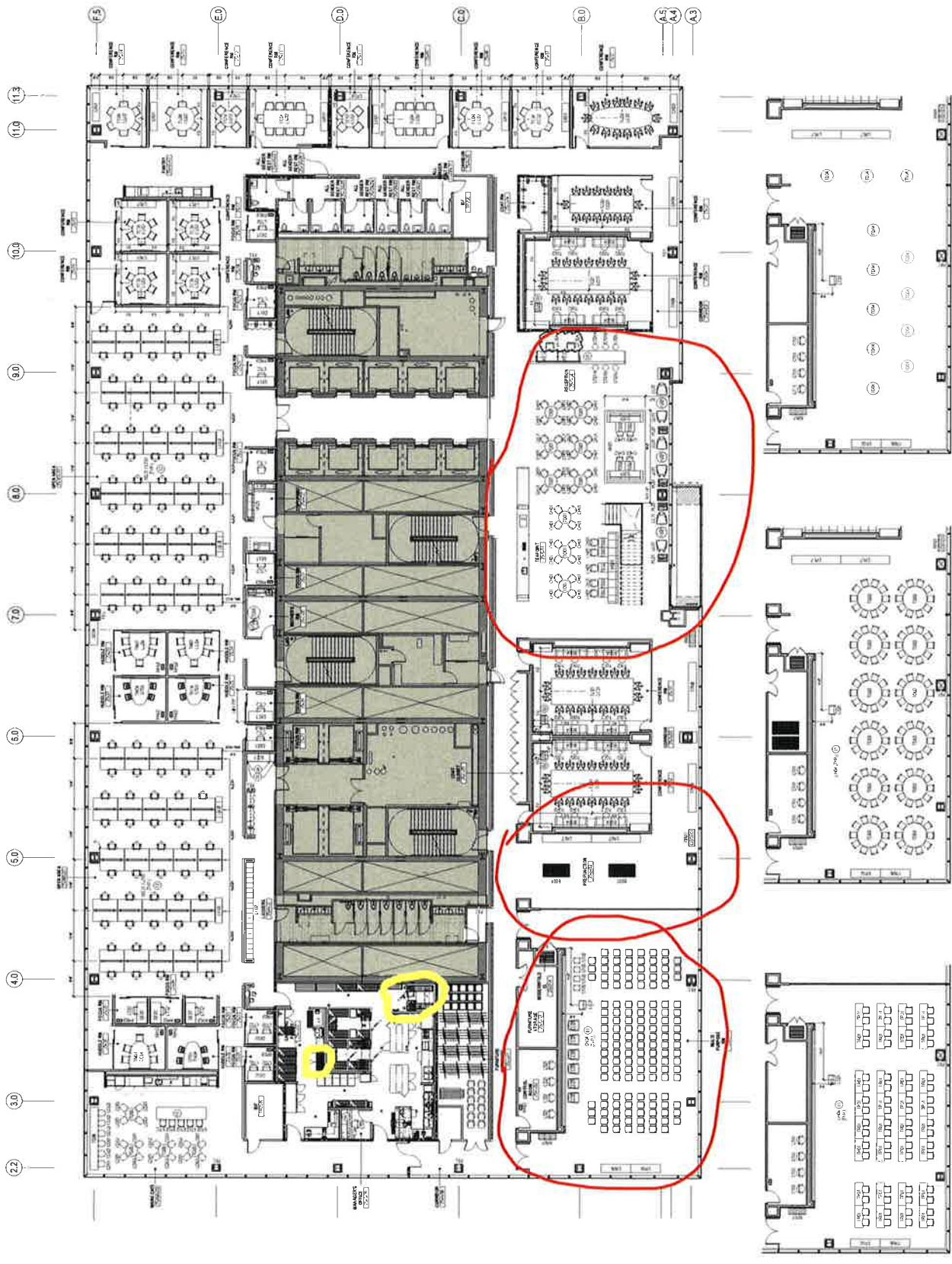

02 ENLARGED PLAN - COCKTAIL LAYOUT
 SCALE: 1/8" = 1'-0"

03 ENLARGED PLAN - DINING LAYOUT
 SCALE: 1/8" = 1'-0"

04 ENLARGED PLAN - TRAINING LAYOUT
 SCALE: 1/8" = 1'-0"

SHEET NOTES

- 1. FINISHES: SEE FINISH SCHEDULE
- 2. WALLS: 1/2" GYPSUM BOARD ON STUDS
- 3. FLOORS: 1/2" GYPSUM BOARD ON CONCRETE
- 4. CEILING: 2' X 4' SUSPENDED GRID WITH 2' X 2' ACoustIC PANELS
- 5. LIGHTING: 2' X 4' RECESSED CAN LIGHTS
- 6. DOORS: 1-1/2" SOLID CORE DOORS WITH 1-1/2" MIN. RISE
- 7. WINDOWS: 1/2" ALUMINUM WINDOW FRAMES WITH 1/2" MIN. RISE
- 8. STAIRS: 1/2" GYPSUM BOARD ON STUDS
- 9. ELEVATORS: 1/2" GYPSUM BOARD ON STUDS
- 10. MECHANICAL/ELECTRICAL/PLUMBING: SEE MECHANICAL/ELECTRICAL/PLUMBING SCHEDULE

GENERAL NOTES

- 1. FURNITURE: SEE FURNITURE SCHEDULE
- 2. WALLS: 1/2" GYPSUM BOARD ON STUDS
- 3. FLOORS: 1/2" GYPSUM BOARD ON CONCRETE
- 4. CEILING: 2' X 4' SUSPENDED GRID WITH 2' X 2' ACoustIC PANELS
- 5. LIGHTING: 2' X 4' RECESSED CAN LIGHTS
- 6. DOORS: 1-1/2" SOLID CORE DOORS WITH 1-1/2" MIN. RISE
- 7. WINDOWS: 1/2" ALUMINUM WINDOW FRAMES WITH 1/2" MIN. RISE
- 8. STAIRS: 1/2" GYPSUM BOARD ON STUDS
- 9. ELEVATORS: 1/2" GYPSUM BOARD ON STUDS
- 10. MECHANICAL/ELECTRICAL/PLUMBING: SEE MECHANICAL/ELECTRICAL/PLUMBING SCHEDULE

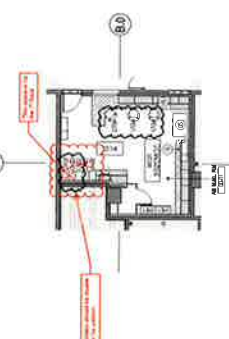
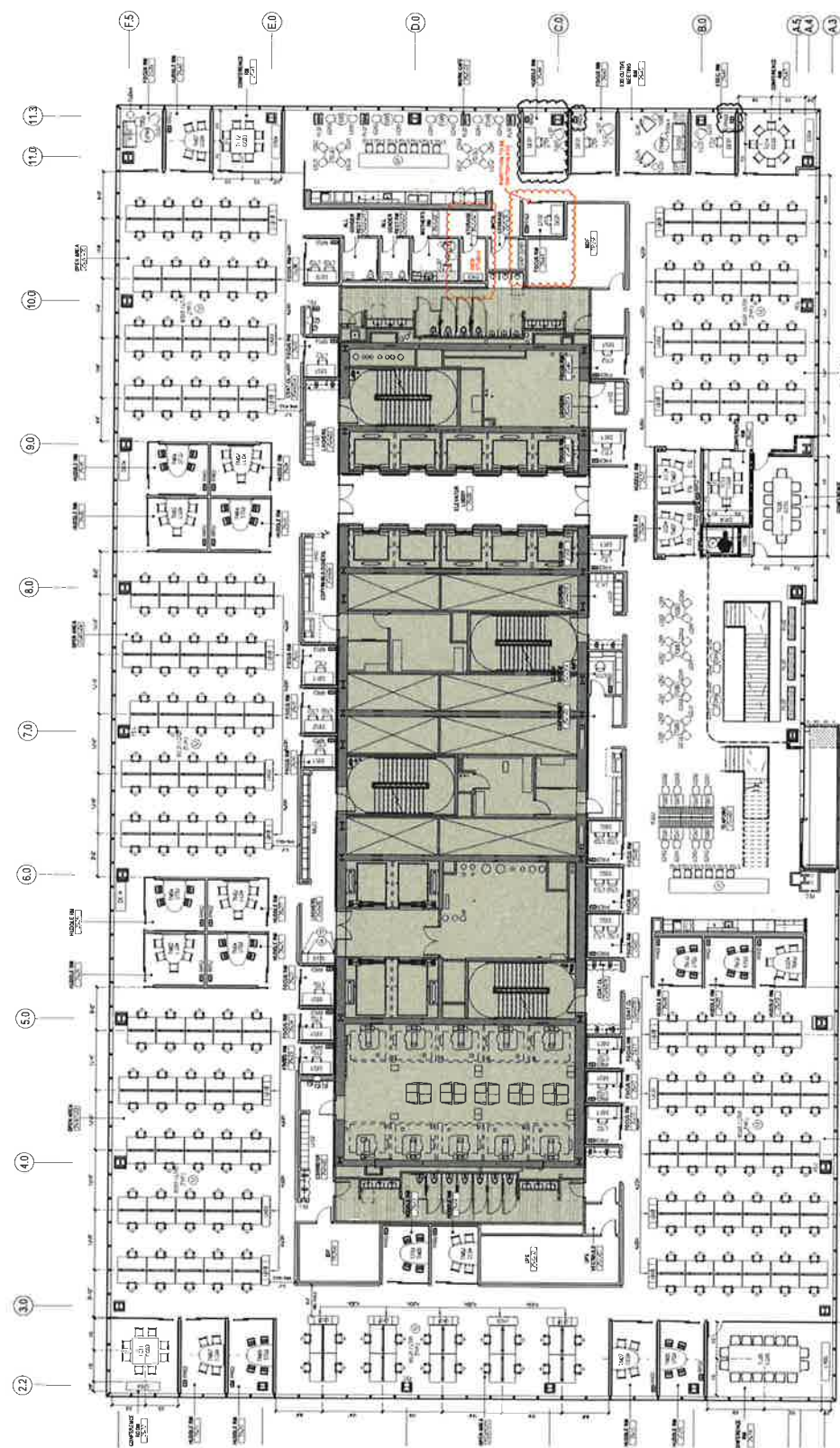

2 FURNITURE PLAN - CELLAR MAIL RM

- SHEET NOTES**
- 1. ALL FURNITURE PLACEMENTS ARE SUBJECT TO CHANGE WITHOUT NOTICE.
 - 2. ALL FURNITURE PLACEMENTS ARE SUBJECT TO CHANGE WITHOUT NOTICE.
 - 3. ALL FURNITURE PLACEMENTS ARE SUBJECT TO CHANGE WITHOUT NOTICE.
 - 4. ALL FURNITURE PLACEMENTS ARE SUBJECT TO CHANGE WITHOUT NOTICE.
 - 5. ALL FURNITURE PLACEMENTS ARE SUBJECT TO CHANGE WITHOUT NOTICE.
 - 6. ALL FURNITURE PLACEMENTS ARE SUBJECT TO CHANGE WITHOUT NOTICE.
 - 7. ALL FURNITURE PLACEMENTS ARE SUBJECT TO CHANGE WITHOUT NOTICE.
 - 8. ALL FURNITURE PLACEMENTS ARE SUBJECT TO CHANGE WITHOUT NOTICE.
 - 9. ALL FURNITURE PLACEMENTS ARE SUBJECT TO CHANGE WITHOUT NOTICE.
 - 10. ALL FURNITURE PLACEMENTS ARE SUBJECT TO CHANGE WITHOUT NOTICE.

- GENERAL NOTES**
- 1. ALL FURNITURE PLACEMENTS ARE SUBJECT TO CHANGE WITHOUT NOTICE.
 - 2. ALL FURNITURE PLACEMENTS ARE SUBJECT TO CHANGE WITHOUT NOTICE.
 - 3. ALL FURNITURE PLACEMENTS ARE SUBJECT TO CHANGE WITHOUT NOTICE.
 - 4. ALL FURNITURE PLACEMENTS ARE SUBJECT TO CHANGE WITHOUT NOTICE.
 - 5. ALL FURNITURE PLACEMENTS ARE SUBJECT TO CHANGE WITHOUT NOTICE.
 - 6. ALL FURNITURE PLACEMENTS ARE SUBJECT TO CHANGE WITHOUT NOTICE.
 - 7. ALL FURNITURE PLACEMENTS ARE SUBJECT TO CHANGE WITHOUT NOTICE.
 - 8. ALL FURNITURE PLACEMENTS ARE SUBJECT TO CHANGE WITHOUT NOTICE.
 - 9. ALL FURNITURE PLACEMENTS ARE SUBJECT TO CHANGE WITHOUT NOTICE.
 - 10. ALL FURNITURE PLACEMENTS ARE SUBJECT TO CHANGE WITHOUT NOTICE.

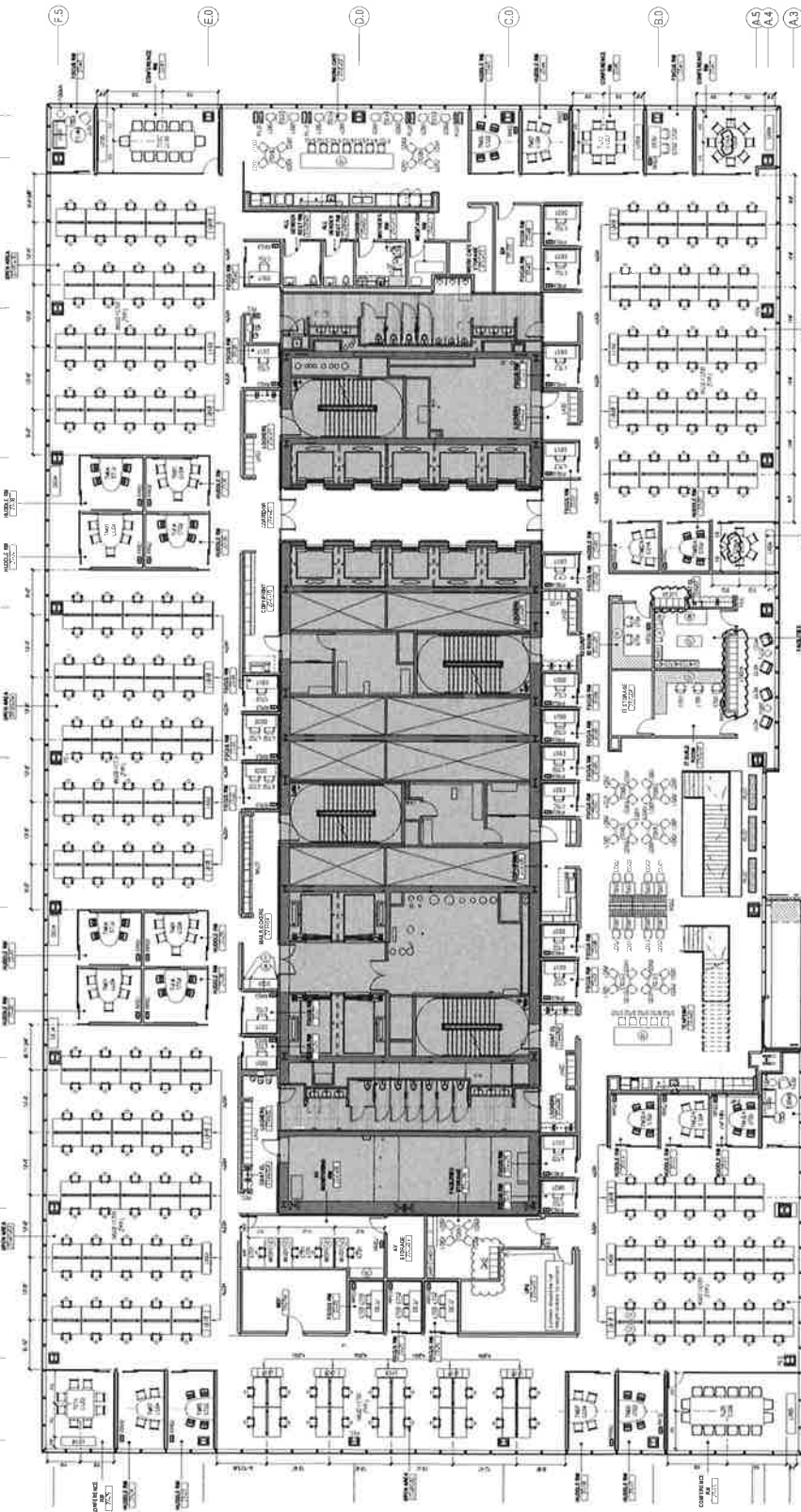

GENERAL NOTES

- 1. SEE GENERAL NOTES TO THE CONTRACT.
- 2. ALL DIMENSIONS ARE TO FACE UNLESS NOTED OTHERWISE.
- 3. FINISHES TO BE AS SHOWN ON THE FINISH SCHEDULE.
- 4. VERIFY ALL CONDITIONS AND CONDITIONS WITH THE ARCHITECT.

SHEET NOTES

- 1. SEE GENERAL NOTES TO THE CONTRACT.
- 2. ALL DIMENSIONS ARE TO FACE UNLESS NOTED OTHERWISE.
- 3. FINISHES TO BE AS SHOWN ON THE FINISH SCHEDULE.
- 4. VERIFY ALL CONDITIONS AND CONDITIONS WITH THE ARCHITECT.

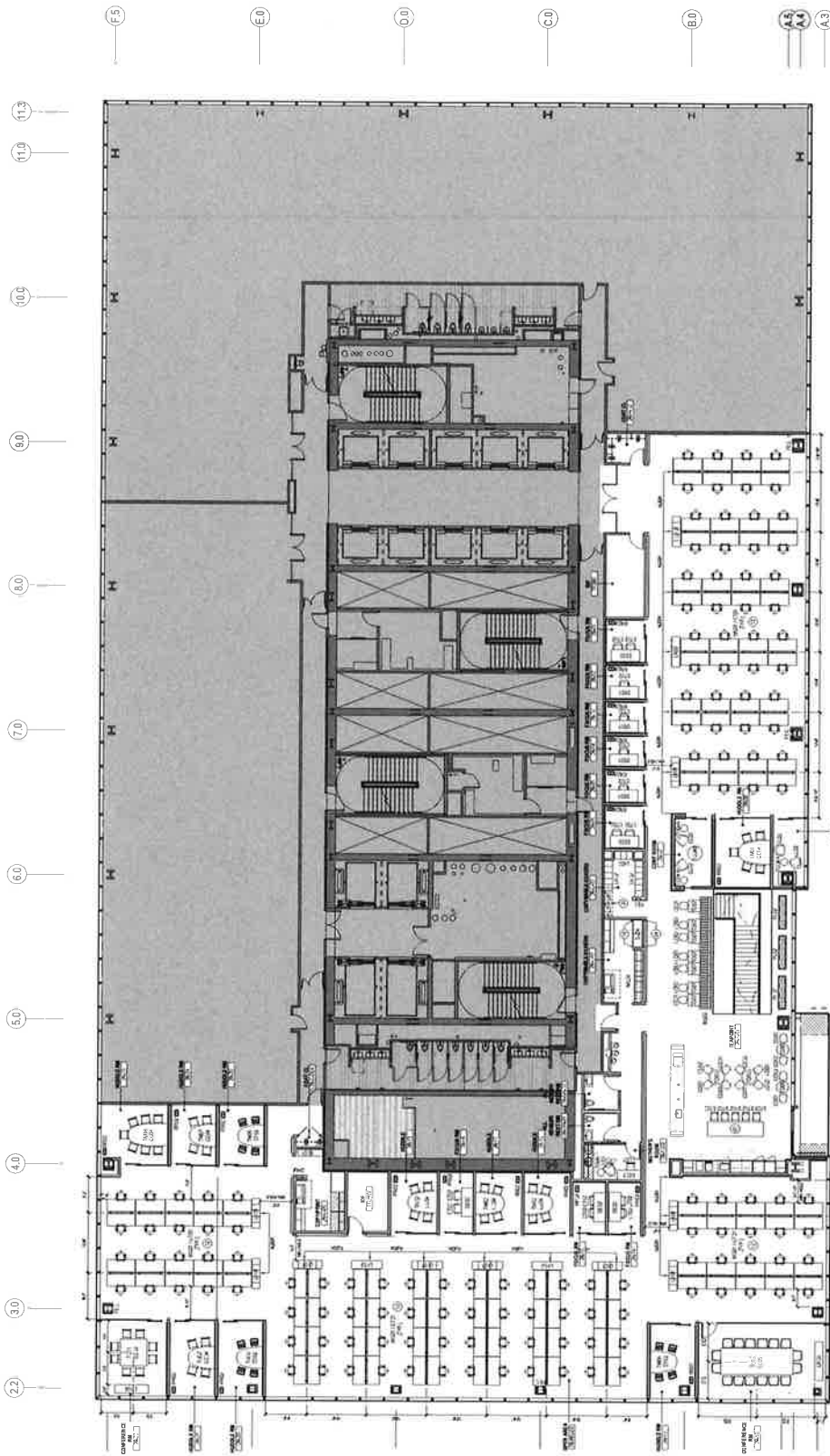
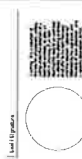

- SHEET NOTES**
- 1. SEE GENERAL NOTES TO THIS SET.
 - 2. ALL DIMENSIONS UNLESS OTHERWISE NOTED.
 - 3. ALL WORK SHALL BE IN ACCORDANCE WITH THE LATEST EDITIONS OF THE NATIONAL BUILDING CODE.
 - 4. ALL WORK SHALL BE IN ACCORDANCE WITH THE LATEST EDITIONS OF THE NATIONAL ELECTRICAL CODE.
 - 5. ALL WORK SHALL BE IN ACCORDANCE WITH THE LATEST EDITIONS OF THE NATIONAL PLUMBING CODE.
 - 6. ALL WORK SHALL BE IN ACCORDANCE WITH THE LATEST EDITIONS OF THE NATIONAL MECHANICAL CODE.

- GENERAL NOTES**
- 1. ALL WORK SHALL BE IN ACCORDANCE WITH THE LATEST EDITIONS OF THE NATIONAL BUILDING CODE.
 - 2. ALL WORK SHALL BE IN ACCORDANCE WITH THE LATEST EDITIONS OF THE NATIONAL ELECTRICAL CODE.
 - 3. ALL WORK SHALL BE IN ACCORDANCE WITH THE LATEST EDITIONS OF THE NATIONAL PLUMBING CODE.
 - 4. ALL WORK SHALL BE IN ACCORDANCE WITH THE LATEST EDITIONS OF THE NATIONAL MECHANICAL CODE.

ALLIANCEBERNSTEIN
CATERING MENU





BREAKFAST BUFFETS

Includes Orange Juice, Water, Coffee & Tea.



Light Start

- Avocado Toast | 160 Cal
- Seasonal Sliced Fruit | 140 Cal
- Kashi Cereal | 140 Cal
- Greek Yogurt With Honey | 140 Cal
- Overnight Chia Oats | 150 Cal
- \$16.99 per guest

Santorini Sunrise

- Chicken Sausage Strata | 100-160 Cal
- Pita Bread | 140 Cal
- Olive Tapenade | 130 Cal
- Hummus | 30 Cal
- Marinated Fresh Tomatoes | 140 Cal
- Whipped Feta | 160 Cal
- Red Pepper Jam | 30 Cal
- \$18.99 per guest

Titan Continental

- Assorted Bagels
- Assorted Mini Croissants
- Assorted Mini Breakfast Pastries
- Seasonal Fruit Salad
- Assorted Cream Cheese
- House Whipped Butter
- Assorted Jams
- \$18.99 per guest

5th & Fiesta Breakfast Taco Bar

- Scrambled Eggs w/ Green Salsa
- Chorizo w/ Peppers & Onions
- Tater Tots
- Pico de Gallo
- Shredded Cheese
- Sour Cream
- Fruit Salad with Lime & Tajin
- \$17.99 per guest

The Noshville Bagel Buffet

- Assorted Bagels, Red Onion, Tomatoes, Capers & Lemons Wedge
- Schmears: Choose 2 (orders of 6 or more guests will receive all)
- Plain Cream Cheese
- Smoked Salmon Cream Cheese
- Vegetable Cream Cheese
- Herb Cream Cheese
- House Whipped Butter
- \$16.99 per guest (add Fresh Lox \$4.99)

The Smashville

- Shrimp & Grits
- Tasso Ham
- Red Eye Gravy
- Scrambled Eggs
- Smashed Hashbrowns
- Assorted Seasonal Berries
- Buttery Biscuits
- Assorted Jams & Butter
- \$18.99 per guest

Chef Eddie's Tuscan Delight

- Vegetable Frittata
- Roasted Tomatoes & Onions
- Chicken Sausage
- Roasted Potatoes
- Strawberries with Balsamic Glaze
- Assorted Artisan Breads
- House Whipped Butter
- \$18.99 per guest



PLEASE BE ADVISED THAT FOOD PREPARED HERE MAY CONTAIN THESE INGREDIENTS: MILK, EGGS, WHEAT, SOYBEAN, PEANUTS, TREE NUTS, FISH AND SHELLFISH



A LA CARTE BREAKFAST



Yogurt Parfaits

Spiced Banana Yogurt Parfait | 460cal

Apple Pie Yogurt Parfait | 440cal

Blueberry & Orange Yogurt Parfait | 430cal

Strawberry-Mango Yogurt Parfait | 400cal

\$4.99 per guest

Overnight Oats

Pear & Pecan Overnight Chia Oats | 390cal

Blueberry Overnight Chia Oats | 370cal

\$4.99 per guest

Add-Ons

Scrambled Eggs | 150cal
\$2.99 per guest

Egg Whites | 150cal
\$2.99 per guest

Chicken Sausage | 150cal
\$3.99 per guest

Avocado Toast With Everything Bagel Seasoning | 150cal
\$3.99 per guest

Old Fashioned Oatmeal | 150cal
\$2.99 per guest

Roasted Rosemary Potatoes | 130cal 
\$2.99 per guest

Seasonal Roasted Vegetables | 160cal 
\$2.99 per guest

Breakfast Sandwiches & Wraps

Croissant, Egg, Ham & Cheddar

Flour Tortilla , Egg, Sausage, Tater Tots, Salsa & Monterey Jack Cheese

Biscuit, Egg, Bacon & American Cheese

Multigrain Bread, Egg White, Spinach, Tomato & Bacon

\$5.99 per guest (minimum 6 guests)

Hearty Sides

Applewood Smoked Bacon
\$2.99 per guest

Sausage
\$2.99 per guest

Buttery Waffle, Crispy Chicken, Berries & Hot Honey
\$8.99 per guest

 PLEASE BE ADVISED THAT FOOD PREPARED HERE MAY CONTAIN THESE INGREDIENTS: MILK, EGGS, WHEAT, SOYBEAN, PEANUTS, TREE NUTS, FISH AND SHELLFISH

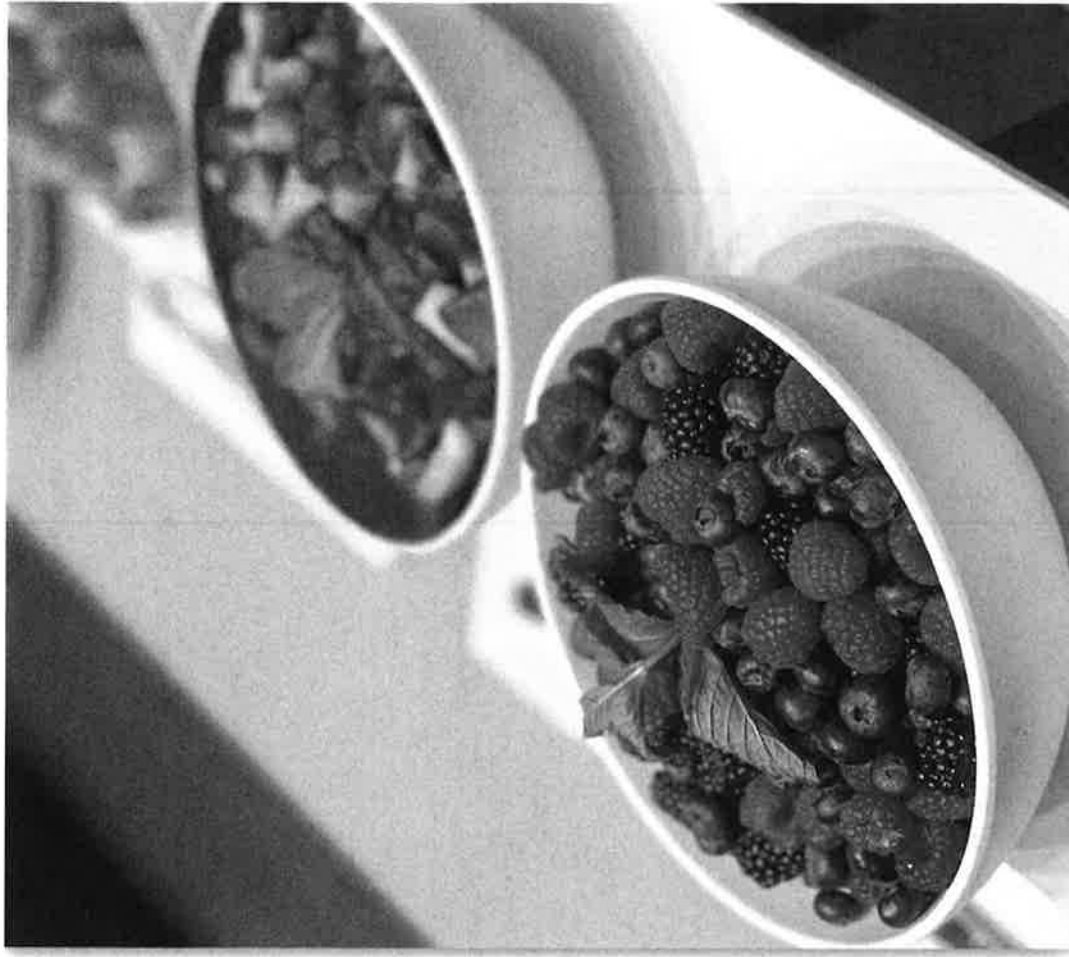



SNACK BREAKS & SWEET TREATS

All Snack Breaks Includes Still & Sparkling Water

AM BREAKS



Seasonal Sliced Fruit & Berries 170Call
\$4.99 per guest

Individual Assorted Chobani Greek Yogurt 1110-220Call
\$2.99 per guest

Seasonal Whole Fruit 150-110Call
\$1.99 per guest

PM BREAKS

Natchez Trace Nachos
Salsa, Guacamole & Tortilla Chips 1400Call
\$7.99 per guest

It's Greek to Me
Hummus, Whipped Feta Cheese & Baked Pita Chips 1570Call
\$6.99 per guest

The Johnny Cashew
Assorted Mixed Nuts & Dried Fruit 1350Call
\$4.99 per guest

Roasted Vegetable Crudité
Hummus 190Call
Ranch Dressing 1120Call
Green Goddess 1120Call
\$8.99 per guest

SWEET TREATS

Fresh Assorted Cookies:
Chocolate Chip, Oatmeal Raisin, Sugar & Macadamia White
Chocolate
\$2.99 per guest

D'Andrews Mini Blueberry Cornmeal Muffins
With House-Whipped Honey Butter
\$2.49 per guest

D'Andrews Donuts With Vanilla Pastry Cream
\$2.99 per guest

D'Andrews Pecan Cinnamon "Bunz"
\$2.99 per guest

D'Andrews Assorted Danishes, Croissant, Pan au Chocolat
\$7.99 per guest



PLEASE BE ADVISED THAT FOOD PREPARED HERE MAY CONTAIN THESE INGREDIENTS:
MILK, EGGS, WHEAT, SOYBEAN, PEANUTS, TREE NUTS, FISH AND SHELLFISH



HAPPY HOUR BREAKS

"Tennessee Three" Salumeria
Chef's Choice of Three Cured Meats &
Three Artisanal Cheeses & Mixed
Olives
Served With Assorted Toast Points
\$11.99 per guest

I Believe it's Pronounced "Bru-sket-ty"
Ricotta Impastata & Prosciutto
Honey Infused Mascarpone, Fig Compote &
Basil Oil
Roasted Mushrooms, Pecorino & Truffle Oil
\$9.99 per guest

"Fear The Schmeer"
Mascarpone, Maldon Salt & E.V.O.O.
Honeycomb
Roasted Marcona Almonds
Toasted Pita Bread
\$9.99 per guest

"The Germantown"
German Style Sausages
W/ Roasted & Pickled Onions
Stone Ground Mustard
House-baked Pretzel
\$9.99 per guest

Grand "Ole Opry" Flat Bread
Pepperoni, Sausage, Ham & Bacon
BBQ Chicken, Gouda, Mango & Cilantro
Margherita Basil & Tomato
\$9.99 per guest

Ask for our Chef Special



 PLEASE BE ADVISED THAT FOOD PREPARED HERE MAY CONTAIN THESE INGREDIENTS:
MILK, EGGS, WHEAT, SOYBEAN, PEANUTS, TREE NUTS, FISH AND SHELLFISH



BEVERAGES

All Packages Includes Still & Sparkling Water

COFFEE SERVICE

Coffee
Decaf
Tea
\$3.49 per guest

TEA & LEMONADE

Unsweetened Iced Tea
Sweet Tea
Freshly Squeezed Lemonade
Raspberry Lemonade
Strawberry Lemonade
\$2.99 per guest

JUICE

Orange
Grapefruit
Apple
Cranberry
\$1.99 per guest

SPECIAL REQUESTS

Almond, Soy & Oat Milk are available at no additional cost

Assorted Sodas are available for External Client Events for **\$1.99 per guest**

INFUSED WATER

Blueberry-Lemon Infused Water
Orange-Basil Infused Water
Cucumber-Mint Infused Water
Citrus Infused Water
\$2.99 per guest





SANDWICH PROGRAM

Available as Buffet or Box Lunch

All Packages Includes Choice of 3 sandwiches and Still & Sparkling Water

Sandwiches Made With Boar's Head Deli Selections & Frothy Monkey Bread. Includes Dill Pickle, Bag Of Chips, Cookie Or Whole Fruit.

The Gobbler

Boar's Head Pastrami Seasoned Turkey Breast, Creamy Havarti Cheese, Ripe Avocado, Fresh Tomatoes, Lettuce, Honey Mustard Spread, Freshly Baked Frothy Monkey Multi-Grain Bread

Jack Hamiels

Boar's Head Bourbon Ham, Lacey Swiss Cheese, Bacon, Fresh Tomatoes, Lettuce, Peppercorn Aioli, Freshly Baked Frothy Monkey Brioche Bread

SoBro-ast Beef

Seasoned Top Round Boar's Head Roast Beef, Spicy 3 Pepper Jack Cheese, Fresh Arugula, Fresh Tomatoes, Pub Style Horseradish Spread, Frothy Monkey Sliced Brioche Bread

Miley Cy-Irish

Boar's Head Corned Beef, Creamy Old-Fashioned Coleslaw, Swiss Cheese, Tangy Thousand Island Dressing on Freshly Baked Frothy Monkey Rye Bread

Nashville Not-So-Hot Chicken

Rotisserie Seasoned Chicken Breast, Manchego Cheese, Dill Pickles, Fresh Tomatoes, Lettuce, Chipotle Gourmaise, Fire Roasted Peppers, Crusty Frothy Monkey Brioche Bun

Ask About Chef's Choice

\$19.99 per guest

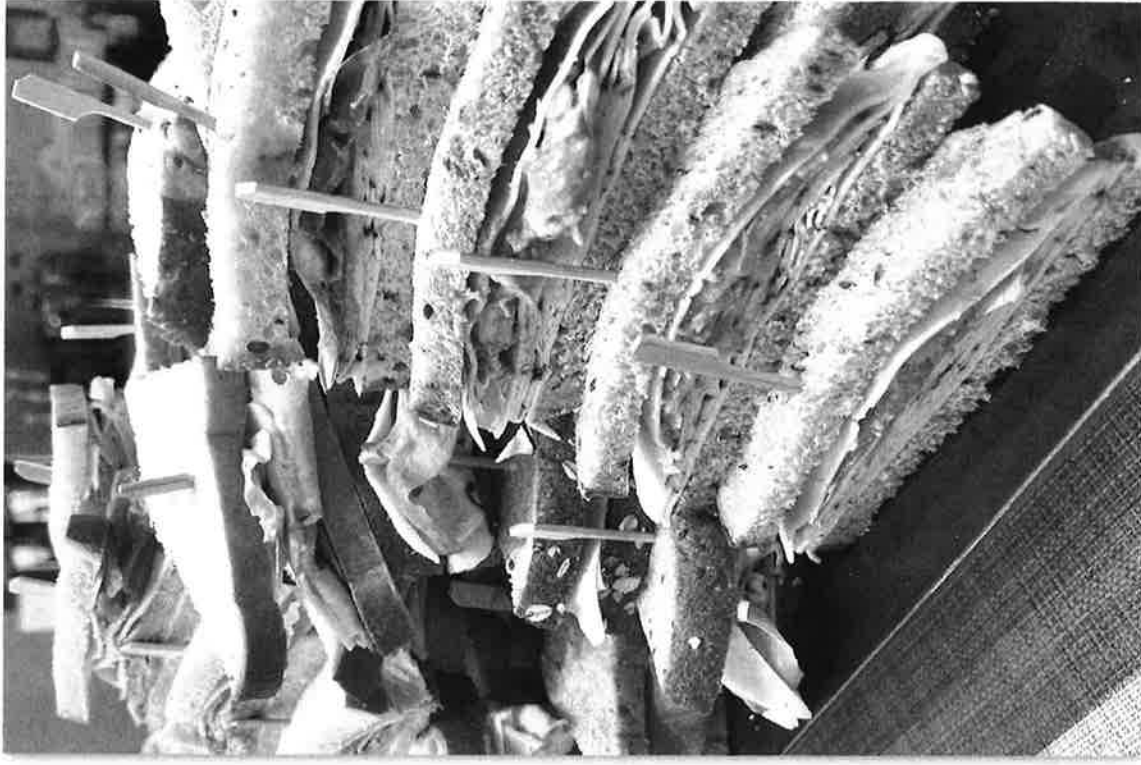

⚠ PLEASE BE ADVISED THAT FOOD PREPARED HERE MAY CONTAIN THESE INGREDIENTS: MILK, EGGS, WHEAT, SOYBEAN, PEANUTS, TREE NUTS, FISH AND SHELLFISH



WRAP SELECTION

Available For Individual Serving Or Platter

All Packages Include a Choice of 3 Wraps and Still & Sparkling Water

Wraps are Made With Boar's Head Deli Selections. Includes Dill Pickle, Bag Of Chips, Cookie Or Whole Fruit.

Buffalo Bluegrass Wrap

Boar's Head Blazing Buffalo Chicken Breast, Bacon, Crumbled Blue Cheese, Shredded Carrot & Celery

Shirley Caesar Wrap

Herbed Chicken Breast, Parmesan Cheese, Romaine Lettuce, House Made Creamy Caesar Dressing

Volunteer Veggie Wrap

Cabbage, Cucumbers, Mojo Roasted Veggies, Black Bean Hummus, Cojita Cheese & Mix of Lettuces

Muffaletta Wrap

Boar's Head Capicola, Ham, Genova Salami, Fresh Arugula, Provolone Cheese, Fresh Tomatoes, Muffaletta Spread

Tennessee Turkey Wrap

Boar's Head PitCraft Smoked Turkey, Monterey Jack Cheese, Roasted Corn, Chipotle Mayo & Mix of Lettuces

Ask About Chef's Choice

\$17.99 per guest



 PLEASE BE ADVISED THAT FOOD PREPARED HERE MAY CONTAIN THESE INGREDIENTS: MILK, EGGS, WHEAT, SOYBEAN, PEANUTS, TREE NUTS, FISH AND SHELLFISH



HEALTHY BOWLS

Available as Buffet or Individual Serving

All Packages Includes Still & Sparkling Water

Broadway Strip

Seared NY Strip Steak W/ Barolo Reduction, Polenta Cake, Broccolini, Carrots, Cipollini & Mushroom Fricassee.
\$21.99 per guest

The Gatlin-Bird

Oven Roasted Bone-in Chicken Breast W/ Black Mission Fig Sauce, Wild Rice, Brussels Sprouts, Crispy Pancetta & Carrots.
\$20.99 per guest

Smokey Mountain Poke

Wild Caught Ahi Tuna, Marinated Sushi Rice, Edamame Beans, Avocado, Cucumber, Pickled Daikon, Carrots, Furikake Seasoning & Tobiko.
\$21.99 per guest

Tofu Or Not Tofu - That Is The Question

Poke Style Bowl W/ Choice of Grilled Tofu Or Teriyaki Chicken, Marinated Sushi Rice, Edamame Beans, Avocado, Cucumber, Pickled Daikon, Mango & Furikake Seasoning.

\$19.99 Tofu per guest

\$20.99 Chicken per guest



! PLEASE BE ADVISED THAT FOOD PREPARED HERE MAY CONTAIN THESE INGREDIENTS:
MILK, EGGS, WHEAT, SOYBEAN, PEANUTS, TREE NUTS, FISH AND SHELLFISH



SALAD SELECTIONS

Salad Selection Available For Individual Serving Or Platter, Served With Focaccia Bread
All Packages Includes a Choice of 3 Salads and Still & Sparkling Water

The Sans Is Very Cobb

Turkey Breast, Bacon, Avocado, Local Pimento Cheese, Tomato, Hard-Cooked Egg, Mixed Greens, Guilt-Free Olive Oil-Herb Dressing.

Franklin Kale Caesar

Herbed Chicken Breast, Garlic Croutons, Parmesan Cheese, Kale, Quinoa, House Made Creamy Caesar Dressing.

Belle Meade

Mozzarella Cheese, Heirloom Tomato, Basil Pesto, Toasted Pine Nuts & Arugula.

12 South-West

Shredded Romaine, Avocado, Jicama, Black Beans, Corn, Tomato, Chipotle Chicken, Poblano Peppers, Spicy Ranch, Shredded Monterrey Jack & Roasted Pumpkin Seed.

The Gulch Salad

Garden-Fresh Carrots, Avocado, Cucumber, Cabbage, Tomato, Bell Peppers, Spring Mix Lettuce, White Balsamic Dressing.

Ask About Chef's Choice

\$12.99 per guest



 PLEASE BE ADVISED THAT FOOD PREPARED HERE MAY CONTAIN THESE INGREDIENTS:
MILK, EGGS, WHEAT, SOYBEAN, PEANUTS, TREE NUTS, FISH AND SHELLFISH



Questions on your next catering, reception or custom event?

Please Contact:

dining.NASH@alliancebernstein.com

Or

Executive Chef Eddie Baida M: 615-749-7170

eddie.baida@alliancebernstein.com

Chef De Cuisine Ryan Holmes

ryan.holmes@alliancebernstein.com

General Manager George Hovey M: 248-893-9471

george.hovey@alliancebernstein.com

Legend



Vegetarian



Gluten Free



PLEASE BE ADVISED THAT FOOD PREPARED HERE MAY CONTAIN THESE INGREDIENTS: MILK, EGGS, WHEAT, SOYBEAN, PEANUTS, TREE NUTS, FISH AND SHELLFISH

ASK ABOUT OUR LOCAL PARTNERSHIPS



BAGELS
HAND-ROLLED
NEW YORK BAGELS

CALIFARMIA
co - Farm. Fresh. California. Catering - TN





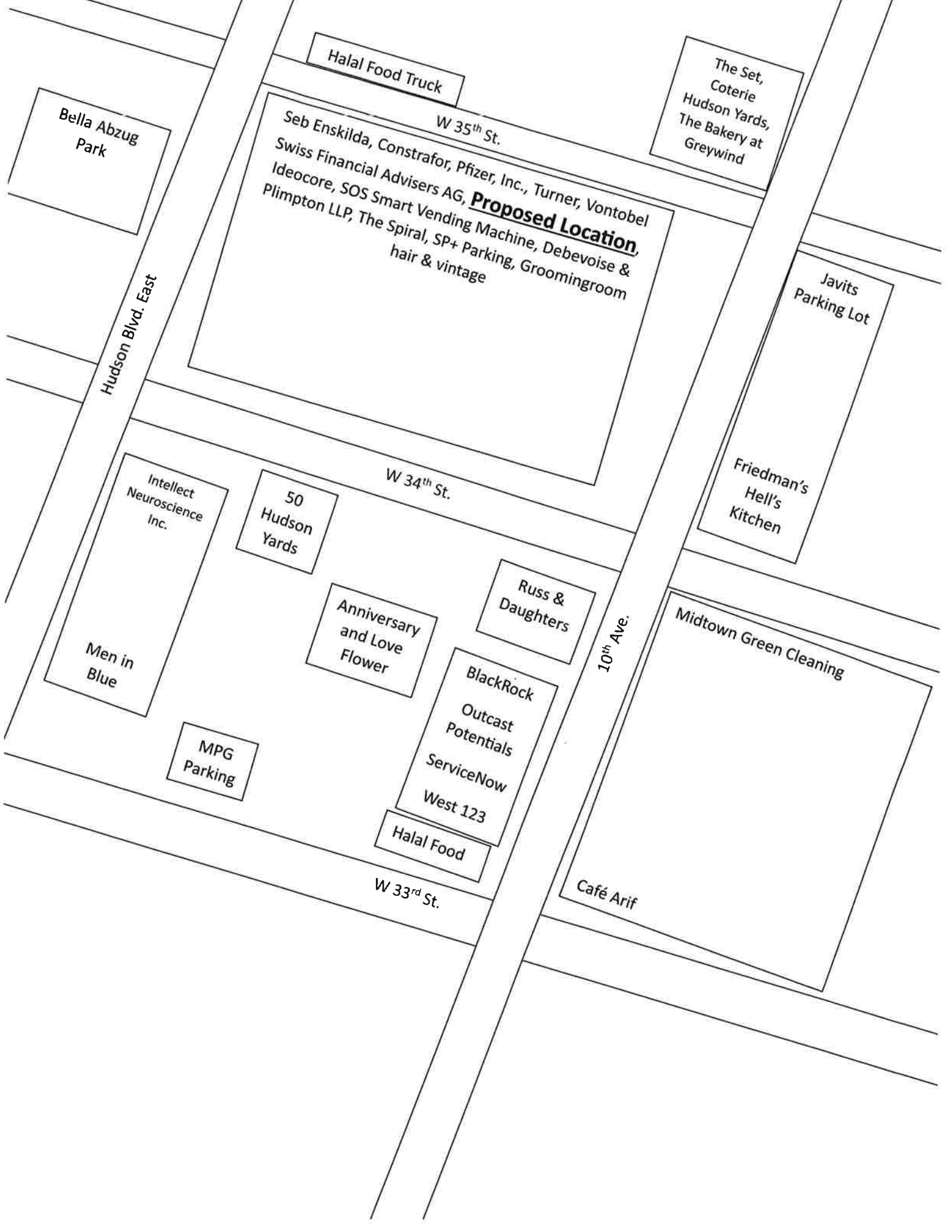

Halal Food Truck

The Set,
Coterie
Hudson Yards,
The Bakery at
Greywind

Bella Abzug
Park

W 35th St.

Seb Enskilda, Constrafor, Pfizer, Inc., Turner, Vontobel
Swiss Financial Advisers AG, **Proposed Location**,
Ideocore, SOS Smart Vending Machine, Debevoise &
Plimpton LLP, The Spiral, SP+ Parking, Groomingroom
hair & vintage

Javits
Parking Lot

Hudson Blvd. East

Friedman's
Hell's
Kitchen

W 34th St.

Intellect
Neuroscience
Inc.

50
Hudson
Yards

Russ &
Daughters

Men in
Blue

Anniversary
and Love
Flower

10th Ave.

Midtown Green Cleaning

MPG
Parking

BlackRock
Outcast
Potentials
ServiceNow
West 123

Halal Food

W 33rd St.

Café Arif

500 Foot Statement

Aramark Services Inc.
509 W. 34th Street
New York, NY 10001

Aramark Services Inc. is seeking a Catering License at 509 W. 43th Street, New York, NY 10001. The premises would be located on floors 25 through 28. The establishment would be closed to the public, and as such, is not expected to increase vehicle or pedestrian traffic. Featuring recorded background music and karaoke, only, as well as no outdoor area, adverse impact on noise in the area is not expected. The applicant principals are experienced and responsible operators, holding numerous licenses throughout the City and State. For these reasons, we believe that issuance of this license would serve public convenience and advantage.

Aramark 509 West 43th St., NY, NY 10001

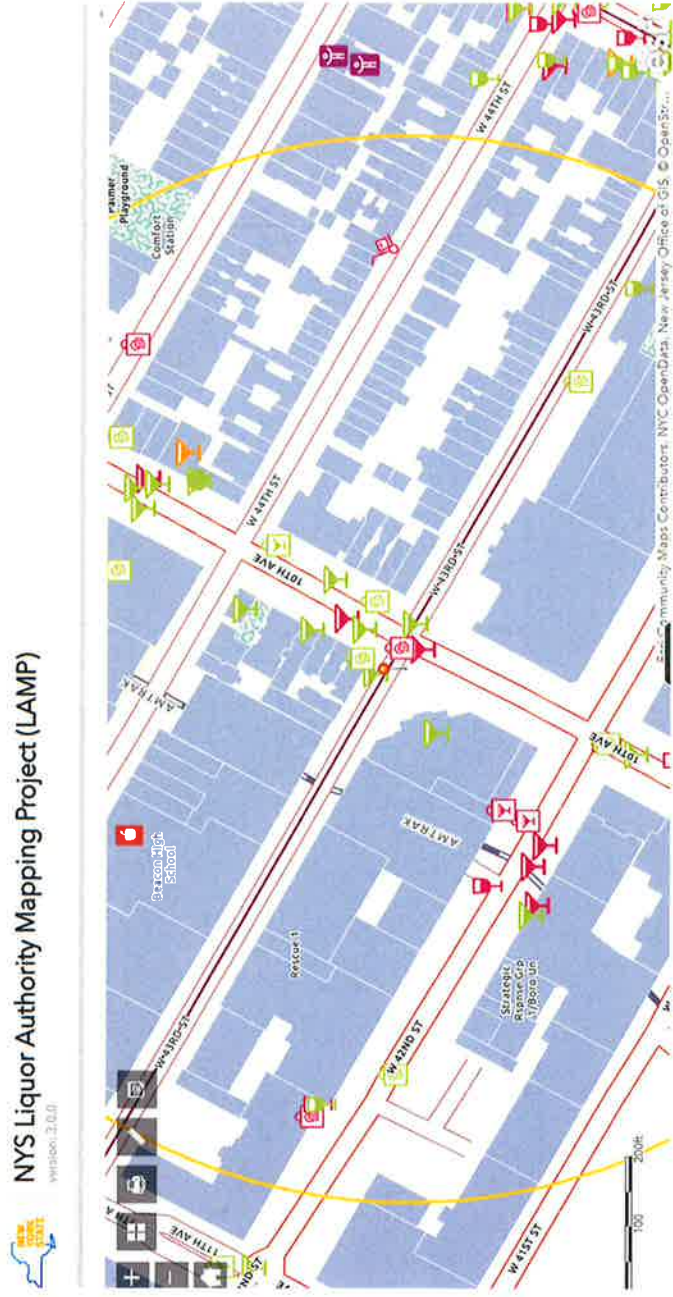

Erin Bruce

From: Erin Bruce
Sent: Tuesday, February 6, 2024 9:28 AM
To: kathleentreat123@gmail.com; mcgee79@aol.com; info@clintonhousing.org; jrestuccia2@clintonhousing.org; rmarcano@clintonhousing.org; rjbenfatto@hyhkalliance.org; pgouris@hyhkalliance.org; donna@donnalangman.com; excom@chekpeds.com; HellsKBA@gmail.com; brianscottweber@gmail.com; cressidac@gmail.com
Cc: Maston Sansom; Theresa Russo; Ashley Worobey
Subject: New Catering License to be located at 509 W 34th St.
Attachments: Public Notice to be posted.pdf; New AB Menu 2023 SUMMER FALL FINAL Review PDF.pdf

Good morning,

I am emailing you on behalf of our client, Aramark Services Inc. ("The Applicant"). The applicant is proposing to obtain a Catering License from the New York State Liquor Authority to serve Liquor, Beer, and Wine at their premise located 509 W. 34th Street. We intend to license floors 25 through 28. The maximum occupancy is 172. The proposed hours of operation will be Monday through Friday 6 am – 8 9m with alcohol service only during hours permitted by the county regulations. The applicant will be serving the attached draft menu. The Applicant feels the ability to serve beer, wine, and spirits will help to enhance their menu and customer experience. The only music played will be background music and music will not be heard outside of the premise. The applicant does not plan to have outdoor space.

Aramark is a national food service/management company with years of experience at location across New York City, New York State, and the entire United States. The Applicant has a detailed internal alcohol policy to ensure a safe environment is maintained during all hours of operations and all local and state laws are followed.

The Applicant will be appearing before Manhattan Community Board 4 on February 13th, at 6:30 pm. This meeting will be held virtually. For specific instructions on how to join the meeting please visit <https://www1.nyc.gov/html/mancb4/html/home/home.shtml> I have also included a copy of the notice that has been posted outside of the proposed premise.

Please feel free to either contact myself or Maston Sansom, the attorney appearing at the meeting, directly if you have any questions or require additional information.

Thank you,
Erin

Erin M. Bruce | New York State Alcohol Licensing Manager
(Formerly Erin M. O'Brien)



121 State Street, 4th Floor Albany, NY 12207
tel: 518.407.5800 | fax: 518.419.6389
www.srclawoffices.com

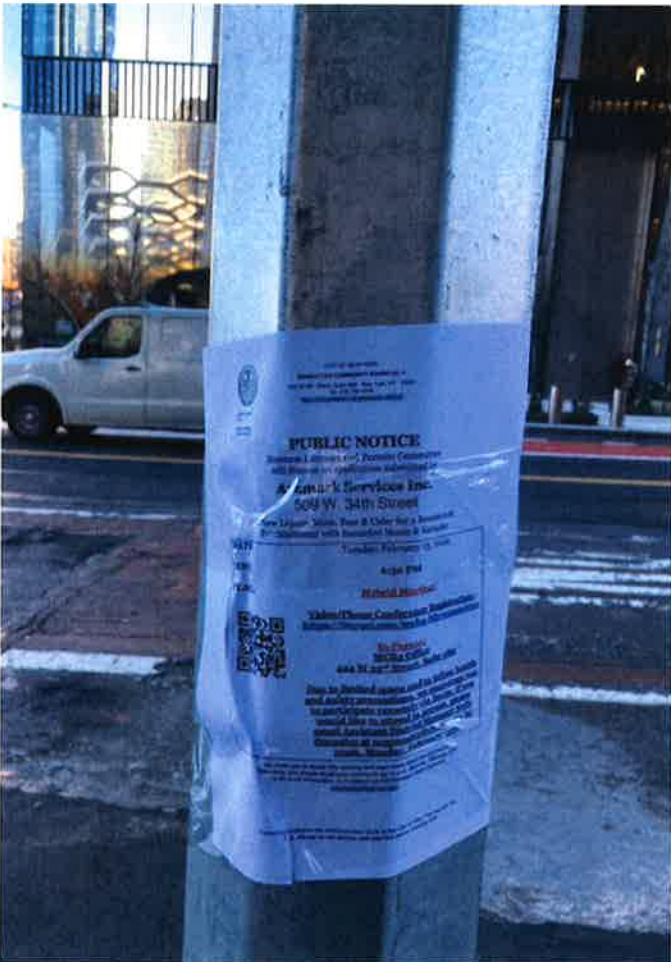
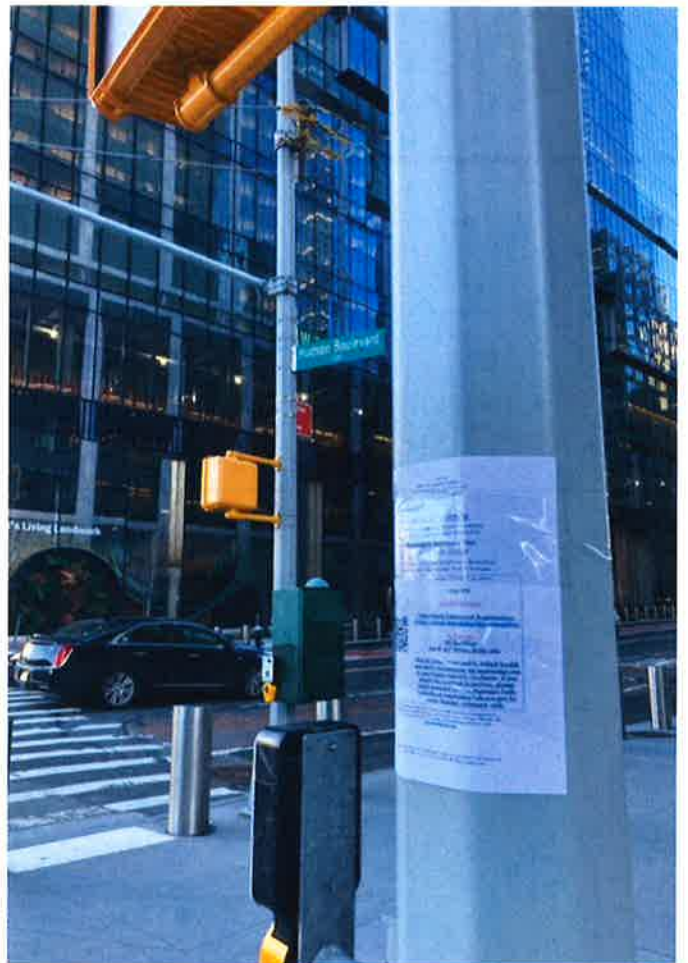
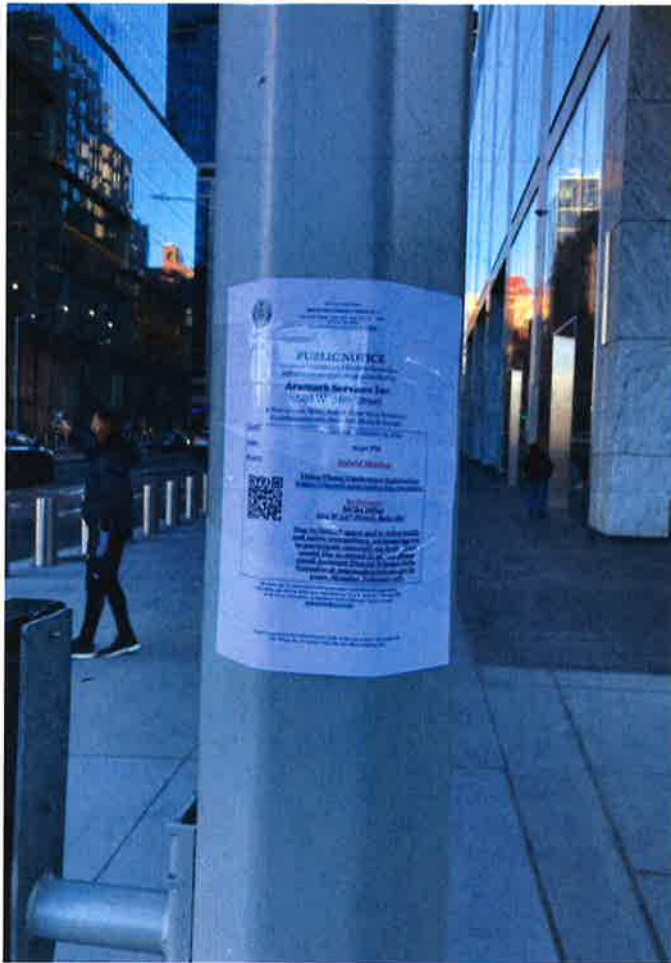

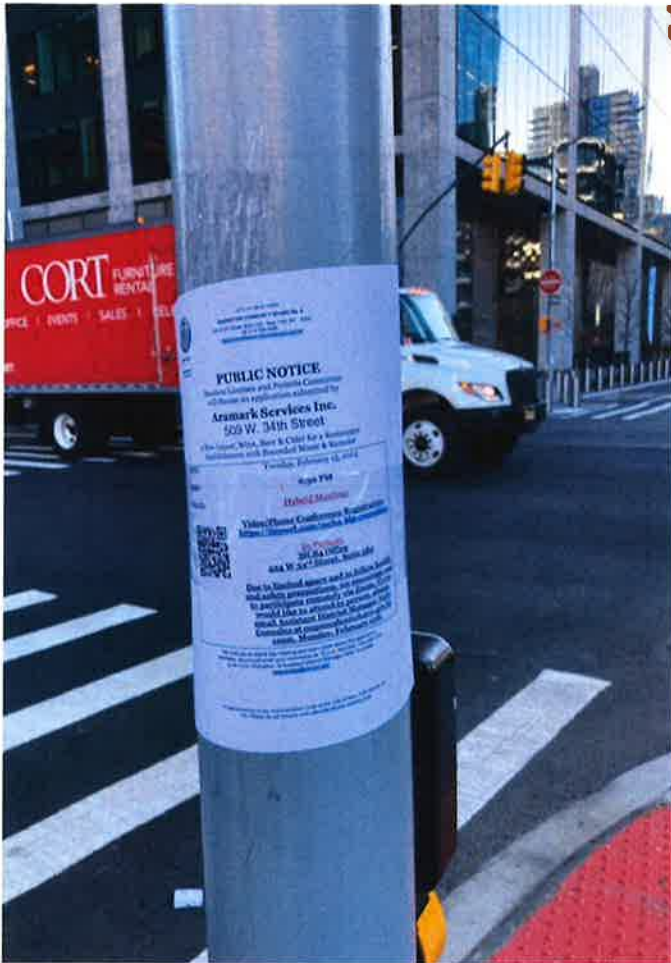



CITY OF NEW YORK
MANHATTAN COMMUNITY BOARD No. 4
424 W 33rd Street, Suite 202 New York, NY 10018
Tel: 212 738 4100
manhattancommunityboard04.nyc.gov

PUBLIC NOTICE
Business Licenses and Permits Committee
will discuss an application submitted by
Aramark Services Inc.
509 W. 34th Street
A New Liquor, Wine, Beer & Cider for a Restaurant
Establishment with Recorded Music & Karaoke

DATE: Tuesday, February 13, 2024
TIME: 6:30 PM
PLACE: Hybrid Meeting

Video/Phone Conference Registration:
<https://tinyurl.com/mcb4-blp-committee>

In-Person
MCHA Office
424 W 33rd Street, Suite 202

Due to limited space and to follow health and safety precautions, we encourage you to participate remotely via Zoom. If you would like to attend in person, please email Assistant District Manager Nelly Gonzalez at nelgonzalez@cb.nyc.gov by 10am, Monday, February 12th.

We invite you to attend the meeting and learn more about the application. Attendance is voluntary unless otherwise indicated by 12 o'clock, Monday, February 12th. For more information, see Assistant Chief of Management Nelly Gonzalez at nelgonzalez@cb.nyc.gov.

Posted According to the Administrative Code of the City of New York section 24-118. Please do not remove until after the above meeting date.



Certificate of Occupancy

CO Number: 1090122-0000012

This certifies that the premises described herein conforms substantially to the approved plans and specifications and to the requirements of all applicable laws, rules and regulations for the uses and occupancies specified. No change of use or occupancy shall be made unless a new Certificate of Occupancy is issued. *This document or a copy shall be available for inspection at the building at all reasonable times.*

A.	Borough: MANHATTAN Address: 509 WEST 34TH STREET Building Identification Number(BIN): 1090122	Block Number: 706 Lot Number(s): 17 Additional Lot Number(s): Application Type: NB - NEW BUILDING	Full Building Certificate Type: Temporary Date Issued: 01/22/2024
	This building is subject to this Building Code: 2014		
This Certificate of Occupancy is associated with job# 122885422-01			
B.	Construction Classification: I-A: 3 HOUR PROTECTED - NON-COMBUST Building Occupancy Group classification: B - BUSINESS Multiple Dwelling Law Classification: Not Available		
	No. of stories: 66	Height in feet: 1041	No. of dwelling units: Not Available
C.	Fire Protection Equipment: Fire Alarm System, Sprinkler System, Standpipe System		
D.	Parking Spaces and Loading Berths: Open Parking Spaces: 0 Enclosed Parking Spaces: 24 Total Loading Berths: Not available		
	This Certificate is issued with the following legal limitations: Restrictive Declaration: 2017000211993 Zoning Exhibit: 201700357449, 2018000055478 BSA Calendar Number(s): None CPC Calendar Number(s): None		
	Borough Comments:		

Borough Commissioner

Commissioner



Permissible Use and Occupancy

FLOOR	Occ Group	Max. Persons Permitted	Live Loads (lbs per sq ft)	Zoning Use Group	Dwelling or Rooming Units	Job Reference	Certificate of Occupancy Type	CO Expiration Date
Sub-Cellar - 1	H-2	14	OG	6		122885422	Temporary	04/28/2024
Description of Use:	Building contains materials that present a deflagration hazard or an accelerated burning hazard. DETENTION TANK AND STORAGE					Exceptions:		
Cellar	F-2	55	OG	6		122885422	Temporary	04/28/2024
Description of Use:	Mechanical and/or electrical equipment rooms MECHANICAL ROOMS, ENGINEERING TOOLS SHOP, SWITCHGEAR ROOM, EMR					Exceptions:		
Cellar	S-1	17	OG	6		122885422	Temporary	04/28/2024
Description of Use:	Storage of Flammable or Combustible Materials TENANT STORAGE,CHEMICAL STORAGE					Exceptions:		
Cellar	F-2	28	100	6		122885422	Temporary	04/28/2024
Description of Use:	Mechanical and/or electrical equipment rooms FIRE PUMP ROOM, WATER SERVICE ROOM, GAS SERVICE ROOM, MECHANICAL PLATFORM (CELLAR MEZZANINE)					Exceptions:		
Cellar	H-3	5	OG	6		122885422	Temporary	04/28/2024
Description of Use:	Building contains materials that readily support combustion or present a physical hazard. FUEL OIL ROOM					Exceptions:		
Cellar	S-2	124	OG	6		122885422	Temporary	04/28/2024
Description of Use:	Storage of non combustibile Materials STORAGELOADING,STORAGE, BIKE STORAGE FOR 298 BIKES					Exceptions:		



Permissible Use and Occupancy

FLOOR	Occ Group	Max. Persons Permitted	Live Loads (lbs per sq ft)	Zoning Use Group	Dwelling or Rooming Units	Job Reference	Certificate of Occupancy Type	CO Expiration Date
Cellar	F-1	7	OG	6		122885422	Temporary	04/28/2024
Description of Use: Moderate-Hazard: Manufacturing TRASH ROOM AND TOOL SHOP						Exceptions:		
Cellar	B	95	OG	6		122885422	Temporary	04/28/2024
Description of Use: Business and Service OFFICES, DOCKMASTER & SECURITY OFFICE, ACCESSORY LOCKER ROOMS FOR STAFF						Exceptions:		
Cellar	S-2	N/A	OG	6		122885422	Temporary	04/28/2024
Description of Use: Parking Garage PARKING STACKERS FOR 24 CARS ACCESSORY TO BUSINESS USE						Exceptions:		
Floor 1	B	493	100	6		122885422	Temporary	04/28/2024
Description of Use: Business and Service LOBBY HUDSON BLVD, TENANT LOBBY 34TH STREET, 2 TENANT LOBBY W.35TH STREET, TENANT LOBBY 10TH AVE, SERVICE ELEVATOR LOBBY, OFFICE						Exceptions:		
Floor 1	I-4	61	100	4		122885422	Temporary	04/28/2024
Description of Use: Day Nursery DAYCARE ACCESSORY TO TENANTS (24 CHILDREN UNDER 2, 13 CHILDREN OVER 2)						Exceptions:		
Floor 1	S-2	6	100	6		122885422	Temporary	04/28/2024
Description of Use: Storage of non combustible Materials MESSENGER CENTER AND SCREENING						Exceptions:		



Permissible Use and Occupancy

FLOOR	Occ Group	Max. Persons Permitted	Live Loads (lbs per sq ft)	Zoning Use Group	Dwelling or Rooming Units	Job Reference	Certificate of Occupancy Type	CO Expiration Date
Floor 1	F-2	11	100	6		122885422	Temporary	04/28/2024
Description of Use: Mechanical and/or electrical equipment rooms MECHANICAL ROOMS, ELECTRICAL ROOM, SECURITY,MECHANICAL ROOM FOR DAYCARE							Exceptions:	
Mezzanine - 1	E	26	75	4		122885422	Temporary	04/28/2024
Description of Use: Day Care DAYCARE ACCESSORY TO TENANTS (26 CHILDREN OVER 2).							Exceptions:	
Mezzanine - 1	A-2	150	75	6		122885422	Temporary	04/28/2024
Description of Use: Eating and Drinking CAFE ACCESSORY TO TENANT							Exceptions:	
Mezzanine - 1	B	45	75	6		122885422	Temporary	04/28/2024
Description of Use: Business and Service TENANT LOBBY, OFFICES, DAYCARE OFFICES							Exceptions:	
Mezzanine - 1	F-2	12	75	6		122885422	Temporary	04/28/2024
Description of Use: Mechanical and/or electrical equipment rooms MECHANICAL ROOMS							Exceptions:	
Floor 2	B	0	100	6		122885422	Core & Shell	04/28/2024
Description of Use: Business and Service OFFICES, WOMEN'S WASHROOM, MEN'S WASH ROOM, JANITOR CLOSET, ELEVATOR LOBBY							Exceptions: Zero Occupancy Allowed.	



Permissible Use and Occupancy

FLOOR	Occ Group	Max. Persons Permitted	Live Loads (lbs per sq ft)	Zoning Use Group	Dwelling or Rooming Units	Job Reference	Certificate of Occupancy Type	CO Expiration Date	
Floor 2	F-2	0	100	6		122885422	Core & Shell	04/28/2024	
Description of Use:		Mechanical and/or electrical equipment rooms MECHANICAL ROOMS, SERVICE ELEVATOR LOBBY, FIRE ALARM CLOSET, ELECTRICAL ROOM, JANITOR CLOSET.				Exceptions: Zero Occupancy Allowed.			
Floor 3	F-2	23	100	6		122885422	Temporary	04/28/2024	
Description of Use:		Mechanical and/or electrical equipment rooms MECHANICAL ROOMS, SERVICE ELEVATOR LOBBY, FIRE ALARM CLOSET, ELECTRICAL ROOM, JANITOR CLOSET.				Exceptions:			
Floor 3	B	557	100	6		122885422	Temporary	04/28/2024	
Description of Use:		Business and Service OFFICES, WOMEN'S WASHROOM, MEN'S WASH ROOM, JANITOR CLOSET, ELEVATOR LOBBY				Exceptions:			
Floor 4	F-2	20	100	6		122885422	Temporary	04/28/2024	
Description of Use:		Mechanical and/or electrical equipment rooms MECHANICAL ROOMS, SERVICE ELEVATOR LOBBY, FIRE ALARM CLOSET, ELECTRICAL ROOM, JANITOR CLOSET.				Exceptions:			
Floor 4	B	570	100	6		122885422	Temporary	04/28/2024	
Description of Use:		Business and Service OFFICES, WOMEN'S WASHROOM, MEN'S WASH ROOM, JANITOR CLOSET, ELEVATOR LOBBY				Exceptions:			
Floor 5	F-2	23	100	6		122885422	Temporary	04/28/2024	
Description of Use:		Mechanical and/or electrical equipment rooms MECHANICAL ROOMS, SERVICE ELEVATOR LOBBY, FIRE ALARM CLOSET, ELECTRICAL ROOM, JANITOR CLOSET.				Exceptions:			



Permissible Use and Occupancy

FLOOR	Occ Group	Max. Persons Permitted	Live Loads (lbs per sq ft)	Zoning Use Group	Dwelling or Rooming Units	Job Reference	Certificate of Occupancy Type	CO Expiration Date
Floor 5	B	357	100	6		122885422	Temporary	04/28/2024
Description of Use:		Business and Service OFFICES, ACCESSORY COFFEE BAR, WOMEN'S WASHROOM, MEN'S WASH ROOM, JANITOR CLOSET, ELEVATOR LOBBY				Exceptions:		
Floor 5	A-2	241	100	6		122885422	Temporary	04/28/2024
Description of Use:		Banquet TOWNHALL				Exceptions:		
Floor 6	F-2	192	100	6		122885422	Temporary	04/28/2024
Description of Use:		Mechanical and/or electrical equipment rooms MECHANICAL ROOM, SERVICE ELEVATOR LOBBY, ELECTRICAL ROOM, FIRE ALARM CLOSET, EMR & CON ROOM.				Exceptions:		
Floor 7	B	24	100	6		122885422	Temporary	04/28/2024
Description of Use:		Business and Service OFFICE AND TENANT STORAGE				Exceptions:		
Floor 7	F-2	30	100	6		122885422	Temporary	04/28/2024
Description of Use:		Low-Hazard: Processing KITCHENS FOR CAFETERIA				Exceptions:		
Floor 7	A-2	250	100	6		122885422	Temporary	04/28/2024
Description of Use:		Cafeteria CAFETERIA				Exceptions:		



Permissible Use and Occupancy

FLOOR	Occ Group	Max. Persons Permitted	Live Loads (lbs per sq ft)	Zoning Use Group	Dwelling or Rooming Units	Job Reference	Certificate of Occupancy Type	CO Expiration Date
Floor 7	A-2	50	100	6		122885422	Temporary	04/28/2024
Description of Use: Cafeteria SERVERY						Exceptions:		
Floor 7	A-3	70	100	6		122885422	Temporary	04/28/2024
Description of Use: Health Club/ Gym/ Fitness Center FITNESS CENTER ACCESSORY TO OFFICE USE						Exceptions: Not including Terrace Accessory to Office Use		
Floor 7	A-3	424	100	6		122885422	Temporary	04/28/2024
Description of Use: Recreation LECTURE HALL ACCESSORY TO OFFICE (ACCESSORY BALCONIES ON 8TH FLOOR)						Exceptions:		
Floor 8	A-2	96	100	6		122885422	Temporary	04/28/2024
Description of Use: Banquet GRANDSTAND-BLEACHER SEATING						Exceptions:		
Floor 8	A-3	76	100	6		122885422	Temporary	04/28/2024
Description of Use: Recreation BALCONIES ACCESSORY TO LECTURE HALL ON THE 7TH FLOOR						Exceptions:		
Floor 8	A-2	96	100	6		122885422	Temporary	04/28/2024
Description of Use: Eating and Drinking CAFE (48) AND LOUNGE (48)ACCESSORY TO OFFICE USE						Exceptions:		



Permissible Use and Occupancy

FLOOR	Occ Group	Max. Persons Permitted	Live Loads (lbs per sq ft)	Zoning Use Group	Dwelling or Rooming Units	Job Reference	Certificate of Occupancy Type	CO Expiration Date	
Floor 8	A-2	80	100	6		122885422	Temporary	04/28/2024	
Description of Use:	Banquet EXHIBIT SPACE					Exceptions:			
Floor 8	A-3	45	100	6		122885422	Temporary	04/28/2024	
Description of Use:	Health Club/ Gym/ Fitness Center FITNESS CENTER ACCESSORY TO OFFICES					Exceptions:			
Floor 8	A-3	104	100	6		122885422	Temporary	04/28/2024	
Description of Use:	Recreation MULTIPURPOSE ROOMS (CONFERENCE ROOMS 1 (20 PEOPLE), CONFERENCE ROOM 2 (36 PEOPLE) TRAINING ROOM (48 PEOPLE)					Exceptions:			
Floor 8	A-2	150	100	6		122885422	Temporary	04/28/2024	
Description of Use:	Banquet MULTIPURPOSE ROOM-COLLABORATION SPACE					Exceptions:			
Floor 8	B	120	100	6		122885422	Temporary	04/28/2024	
Description of Use:	Business and Service OFFICES, ACCESSORY CAFE (NO COOKING), AND ACCESSORY STORAGE					Exceptions:			
Floor 8	A-3	160	100	6		122885422	Temporary	04/28/2024	
Description of Use:	Recreation MEETING HALL					Exceptions:			



Permissible Use and Occupancy

FLOOR	Occ Group	Max. Persons Permitted	Live Loads (lbs per sq ft)	Zoning Use Group	Dwelling or Rooming Units	Job Reference	Certificate of Occupancy Type	CO Expiration Date
Floor 9	B	350	100	6		122885422	Temporary	04/28/2024
Description of Use: Business and Service OFFICES, WOMEN'S WASHROOM, MEN'S WASHROOM, JANITOR CLOSET, ELEVATOR LOBBY, CAFE, AND TERRACE ACCESSORY TO OFFICE USE Exceptions:								
Floor 9	F-2	30	100	6		122885422	Temporary	04/28/2024
Description of Use: Mechanical and/or electrical equipment rooms MECHAICAL ROOMS, SERVICE ELEVATOR LOBBY, FIRE ALARM CLOSET, ELECTRICAL ROOM, EXECUTIVE KITCHEN FOR DINING Exceptions:								
Floor 10	B	451	100	6		122885422	Temporary	04/28/2024
Description of Use: Business and Service OFFICES, WOMEN'S WASHROOM, MEN'S WASHROOM, JANITOR CLOSET, ELEVATOR LOBBY, CAFE, AND TERRACE ACCESSORY TO OFFICE USE Exceptions:								
Floor 10	F-2	25	100	6		122885422	Temporary	04/28/2024
Description of Use: Mechanical and/or electrical equipment rooms MECHAICAL ROOMS, SERVICE ELEVATOR LOBBY, FIRE ALARM CLOSET, ELECTRICAL ROOM, Exceptions:								
Floor 11	F-2	25	100	6		122885422	Temporary	04/28/2024
Description of Use: Mechanical and/or electrical equipment rooms MECHAICAL ROOMS, SERVICE ELEVATOR LOBBY, FIRE ALARM CLOSET, ELECTRICAL ROOM, Exceptions:								
Floor 11	B	443	100	6		122885422	Temporary	04/28/2024
Description of Use: Business and Service OFFICES, WOMEN'S WASHROOM, MEN'S WASHROOM, JANITOR CLOSET, ELEVATOR LOBBY, CAFE, AND TERRACE ACCESSORY TO OFFICE USE Exceptions:								



Permissible Use and Occupancy

FLOOR	Occ Group	Max. Persons Permitted	Live Loads (lbs per sq ft)	Zoning Use Group	Dwelling or Rooming Units	Job Reference	Certificate of Occupancy Type	CO Expiration Date
Floor 12	F-2	25	100	6		122885422	Temporary	04/28/2024
Description of Use:		Mechanical and/or electrical equipment rooms MECHAICAL ROOMS,SERVICE ELEVATOR LOBBY, FIRE ALARM CLOSET,ELECTRICAL ROOM,				Exceptions:		
Floor 12	B	449	100	6		122885422	Temporary	04/28/2024
Description of Use:		Business and Service OFFICES, WOMEN'S WASHROOM,MEN'S WASHROOM, JANITOR CLOSET,ELEVATOR LOBBY, CAFE, AND TERRACE ACCESSORY TO OFFICE USE				Exceptions:		
Floor 13	B	442	100	6		122885422	Temporary	04/28/2024
Description of Use:		Business and Service OFFICES, WOMEN'S WASHROOM,MEN'S WASHROOM, JANITOR CLOSET,ELEVATOR LOBBY, CAFE, AND TERRACE ACCESSORY TO OFFICE USE				Exceptions:		
Floor 13	F-2	25	100	6		122885422	Temporary	04/28/2024
Description of Use:		Mechanical and/or electrical equipment rooms MECHAICAL ROOMS,SERVICE ELEVATOR LOBBY, FIRE ALARM CLOSET,ELECTRICAL ROOM,				Exceptions:		
Floor 14	F-2	25	100	6		122885422	Temporary	04/28/2024
Description of Use:		Mechanical and/or electrical equipment rooms MECHAICAL ROOMS,SERVICE ELEVATOR LOBBY, FIRE ALARM CLOSET,ELECTRICAL ROOM, KITCHEN ACCESSORY TO CAFE				Exceptions:		
Floor 14	B	354	100	6		122885422	Temporary	04/28/2024
Description of Use:		Business and Service OFFICES, WOMEN'S WASHROOM,MEN'S WASHROOM, JANITOR CLOSET, ELEVATOR LOBBY, AND TERRACE ACCESSORY TO OFFICE USE				Exceptions:		



Permissible Use and Occupancy

FLOOR	Occ Group	Max. Persons Permitted	Live Loads (lbs per sq ft)	Zoning Use Group	Dwelling or Rooming Units	Job Reference	Certificate of Occupancy Type	CO Expiration Date	
Floor 14	A-2	100	100	6		122885422	Temporary	04/28/2024	
Description of Use:		Eating and Drinking CAFE				Exceptions:			
Floor 15	B	508	100	6		122885422	Temporary	04/28/2024	
Description of Use:		Business and Service OFFICES, WOMEN'S WASHROOM, MEN'S WASHROOM, JANITOR CLOSET, ELEVATOR LOBBY, CAFE, AND TERRACE ACCESSORY TO OFFICE USE				Exceptions:			
Floor 15	F-2	23	100	6		122885422	Temporary	04/28/2024	
Description of Use:		Mechanical and/or electrical equipment rooms MECHAICAL ROOMS, SERVICE ELEVATOR LOBBY, FIRE ALARM CLOSET, ELECTRICAL ROOM,				Exceptions:			
Floor 16	B	507	100	6		122885422	Temporary	04/28/2024	
Description of Use:		Business and Service OFFICES, WOMEN'S WASHROOM, MEN'S WASHROOM, JANITOR CLOSET, ELEVATOR LOBBY, CAFE, AND TERRACE ACCESSORY TO OFFICE USE				Exceptions:			
Floor 16	F-2	23	100	6		122885422	Temporary	04/28/2024	
Description of Use:		Mechanical and/or electrical equipment rooms MECHAICAL ROOMS, SERVICE ELEVATOR LOBBY, FIRE ALARM CLOSET, ELECTRICAL ROOM,				Exceptions:			
Floor 17	B	505	100	6		122885422	Temporary	04/28/2024	
Description of Use:		Business and Service OFFICES, WOMEN'S WASHROOM, MEN'S WASHROOM, JANITOR CLOSET, ELEVATOR LOBBY, CAFE, AND TERRACE ACCESSORY TO OFFICE USE				Exceptions:			



Permissible Use and Occupancy

FLOOR	Occ Group	Max. Persons Permitted	Live Loads (lbs per sq ft)	Zoning Use Group	Dwelling or Rooming Units	Job Reference	Certificate of Occupancy Type	CO Expiration Date
Floor 17	F-2	23	100	6		122885422	Temporary	04/28/2024
Description of Use:		Mechanical and/or electrical equipment rooms MECHAICAL ROOMS,SERVICE ELEVATOR LOBBY, FIRE ALARM CLOSET,ELECTRICAL ROOM,				Exceptions:		
Floor 18	F-2	0	100	6		122885422	Core & Shell	04/28/2024
Description of Use:		Mechanical and/or electrical equipment rooms MECHAICAL ROOMS,SERVICE ELEVATOR LOBBY, FIRE ALARM CLOSET,ELECTRICAL ROOM,				Exceptions: Zero Occupancy Allowed.		
Floor 18	B	0	100	6		122885422	Core & Shell	04/28/2024
Description of Use:		Business and Service OFFICES, WOMEN'S WASHROOM,MEN'S WASHROOM, JANITOR CLOSET,ELEVATOR LOBBY, CAFE, AND TERRACE ACCESSORY TO OFFICE USE				Exceptions: Zero Occupancy Allowed.		
Floor 19	B	0	100	6		122885422	Core & Shell	04/28/2024
Description of Use:		Business and Service OFFICES,WOMEN'S WASHROOM,MEN'S WASHROOM, JANITOR CLOSET, ELEVATOR LOBBY, TERRACE ACCESSORY TO OFFICE USE				Exceptions: Zero Occupancy Allowed.		
Floor 19	F-2	0	100	6		122885422	Core & Shell	04/28/2024
Description of Use:		Mechanical and/or electrical equipment rooms MECHAICAL ROOMS,SERVICE ELEVATOR LOBBY, FIRE ALARM CLOSET,ELECTRICAL ROOM,				Exceptions: Zero Occupancy Allowed.		
Floor 20	F-2	0	100	6		122885422	Core & Shell	04/28/2024
Description of Use:		Mechanical and/or electrical equipment rooms MECHAICAL ROOMS,SERVICE ELEVATOR LOBBY, FIRE ALARM CLOSET,ELECTRICAL ROOM,				Exceptions: Zero Occupancy Allowed.		



Permissible Use and Occupancy

FLOOR	Occ Group	Max. Persons Permitted	Live Loads (lbs per sq ft)	Zoning Use Group	Dwelling or Rooming Units	Job Reference	Certificate of Occupancy Type	CO Expiration Date
Floor 20	B	0	100	6		122885422	Core & Shell	04/28/2024
Description of Use: Business and Service OFFICES, WOMEN'S WASHROOM, MEN'S WASHROOM, JANITOR CLOSET, ELEVATOR LOBBY, TERRACE ACCESSORY TO OFFICE USE						Exceptions: Zero Occupancy Allowed.		
Floor 21	B	409	100	6		122885422	Temporary	04/28/2024
Description of Use: Business and Service OFFICES, WOMEN'S WASHROOM, MEN'S WASHROOM, JANITOR CLOSET, ELEVATOR LOBBY, TERRACE ACCESSORY TO OFFICE USE						Exceptions:		
Floor 21	F-2	21	100	6		122885422	Temporary	04/28/2024
Description of Use: Mechanical and/or electrical equipment rooms MECHAICAL ROOMS, SERVICE ELEVATOR LOBBY, FIRE ALARM CLOSET, ELECTRICAL ROOM,						Exceptions:		
Floor 22	F-2	21	100	6		122885422	Temporary	04/28/2024
Description of Use: Mechanical and/or electrical equipment rooms MECHAICAL ROOMS, SERVICE ELEVATOR LOBBY, FIRE ALARM CLOSET, ELECTRICAL ROOM,						Exceptions:		
Floor 22	B	418	100	6		122885422	Temporary	04/28/2024
Description of Use: Business and Service OFFICES, WOMEN'S WASHROOM, MEN'S WASHROOM, JANITOR CLOSET, ELEVATOR LOBBY, TERRACE ACCESSORY TO OFFICE USE						Exceptions:		
Floor 23	F-2	22	100	6		122885422	Temporary	04/28/2024
Description of Use: Mechanical and/or electrical equipment rooms MECHAICAL ROOMS, SERVICE ELEVATOR LOBBY, FIRE ALARM CLOSET, ELECTRICAL ROOM,						Exceptions:		



Permissible Use and Occupancy

FLOOR	Occ Group	Max. Persons Permitted	Live Loads (lbs per sq ft)	Zoning Use Group	Dwelling or Rooming Units	Job Reference	Certificate of Occupancy Type	CO Expiration Date
Floor 23	B	758	100	6		122885422	Temporary	04/28/2024
Description of Use: Business and Service OFFICES,WOMEN'S WASHROOM, MEN'S WASHROOM, JANITOR CLOSET,ELEVATOR LOBBY,TERRACE ACCESSORY TO OFFICE USE Exceptions:								
Floor 24	F-2	18	100	6		122885422	Temporary	04/28/2024
Description of Use: Mechanical and/or electrical equipment rooms MECHAICAL ROOMS,SERVICE ELEVATOR LOBBY, FIRE ALARM CLOSET,ELECTRICAL ROOM, Exceptions:								
Floor 24	B	762	100	6		122885422	Temporary	04/28/2024
Description of Use: Business and Service OFFICES,WOMEN'S WASHROOM,MEN'S WASHROOM, JANITOR CLOSET, ELEVATOR LOBBY, TERRACE ACCESSORY TO OFFICE USE Exceptions:								
Floor 25	B	0	100	6		122885422	Core & Shell	04/28/2024
Description of Use: Business and Service OFFICES,WOMEN'S WASHROOM,MEN'S WASHROOM, JANITOR CLOSET, ELEVATOR LOBBY, TERRACE ACCESSORY TO OFFICE USE Exceptions: Zero Occupancy Allowed.								
Floor 25	F-2	0	100	6		122885422	Core & Shell	04/28/2024
Description of Use: Mechanical and/or electrical equipment rooms MECHAICAL ROOMS,SERVICE ELEVATOR LOBBY, FIRE ALARM CLOSET,ELECTRICAL ROOM, Exceptions: Zero Occupancy Allowed.								
Floor 26	B	0	100	6		122885422	Core & Shell	04/28/2024
Description of Use: Business and Service OFFICES,WOMEN'S WASHROOM,MEN'S WASHROOM, JANITOR CLOSET, ELEVATOR LOBBY, TERRACE ACCESSORY TO OFFICE USE Exceptions: Zero Occupancy Allowed.								



Permissible Use and Occupancy

FLOOR	Occ Group	Max. Persons Permitted	Live Loads (lbs per sq ft)	Zoning Use Group	Dwelling or Rooming Units	Job Reference	Certificate of Occupancy Type	CO Expiration Date	
Floor 26	F-2	0	100	6		122885422	Core & Shell	04/28/2024	
Description of Use:		Mechanical and/or electrical equipment rooms MECHAICAL ROOMS,SERVICE ELEVATOR LOBBY, FIRE ALARM CLOSET,ELECTRICAL ROOM,				Exceptions: Zero Occupancy Allowed.			
Floor 27	F-2	0	100	6		122885422	Core & Shell	04/28/2024	
Description of Use:		Mechanical and/or electrical equipment rooms MECHAICAL ROOMS,SERVICE ELEVATOR LOBBY, FIRE ALARM CLOSET,ELECTRICAL ROOM,				Exceptions: Zero Occupancy Allowed.			
Floor 27	B	0	100	6		122885422	Core & Shell	04/28/2024	
Description of Use:		Business and Service OFFICES,WOMEN'S WASHROOM,MEN'S WASHROOM, JANITOR CLOSET, ELEVATOR LOBBY, TERRACE ACCESSORY TO OFFICE USE				Exceptions: Zero Occupancy Allowed.			
Floor 28	B	276	100	6		122885422	Temporary	04/28/2024	
Description of Use:		Business and Service OFFICES,WOMEN'S WASHROOM,MEN'S WASHROOM, JANITOR CLOSET, ELEVATOR LOBBY, TERRACE ACCESSORY TO OFFICE USE				Exceptions:			
Floor 28	F-2	20	100	6		122885422	Temporary	04/28/2024	
Description of Use:		Mechanical and/or electrical equipment rooms MECHAICAL ROOMS,SERVICE ELEVATOR LOBBY, FIRE ALARM CLOSET,ELECTRICAL ROOM,				Exceptions:			
Floor 29	B	265	100	6		122885422	Temporary	04/28/2024	
Description of Use:		Business and Service OFFICES, WOMEN'S WASHROOM, MEN'S WASHROOM, JANITOR CL, ELEVATOR LOBBY, TERRACE ACCESS.TO OFFICE USE				Exceptions:			



Permissible Use and Occupancy

FLOOR	Occ Group	Max. Persons Permitted	Live Loads (lbs per sq ft)	Zoning Use Group	Dwelling or Rooming Units	Job Reference	Certificate of Occupancy Type	CO Expiration Date	
Floor 29	A-2	336	100	6		122885422	Temporary	04/28/2024	
Description of Use:		Banquet EVENTS SPACE (TOWNHALL), CONFERENCE ROOM, COFFEE BAR				Exceptions:			
Floor 29	F-2	20	100	6		122885422	Temporary	04/28/2024	
Description of Use:		Mechanical and/or electrical equipment rooms MECHANICAL ROOMS, SERVICE ELEVATOR LOBBY, FIRE ALARM CLOSET, ELECTRICAL ROOM,				Exceptions:			
Floor 30	B	238	100	6		122885422	Temporary	04/28/2024	
Description of Use:		Business and Service OFFICES, WOMEN'S WASHROOM, MEN'S WASHROOM, JANITOR CLOSET, ELEVATOR LOBBY, TERRACE ACCESSORY TO OFFICE USE				Exceptions:			
Floor 30	F-2	18	100	6		122885422	Temporary	04/28/2024	
Description of Use:		Mechanical and/or electrical equipment rooms MECHANICAL ROOMS, SERVICE ELEVATOR LOBBY, FIRE ALARM CLOSET, ELECTRICAL ROOM,				Exceptions:			
Floor 31	F-2	0	100	6		122885422	Core & Shell	04/28/2024	
Description of Use:		Mechanical and/or electrical equipment rooms MECHANICAL ROOMS, SERVICE ELEVATOR LOBBY, FIRE ALARM CLOSET, ELECTRICAL ROOM,				Exceptions: Zero Occupancy Allowed.			
Floor 31	B	0	100	6		122885422	Core & Shell	04/28/2024	
Description of Use:		Business and Service OFFICES, WOMEN'S WASHROOM, MEN'S WASHROOM, JANITOR CLOSET, ELEVATOR LOBBY, TERRACE ACCESSORY TO OFFICE USE				Exceptions: Zero Occupancy Allowed.			



Permissible Use and Occupancy

FLOOR	Occ Group	Max. Persons Permitted	Live Loads (lbs per sq ft)	Zoning Use Group	Dwelling or Rooming Units	Job Reference	Certificate of Occupancy Type	CO Expiration Date
Floor 32	B	0	100	6		122885422	Core & Shell	04/28/2024
Description of Use: Business and Service OFFICES,WOMEN'S WASHROOM,MEN'S WASHROOM, JANITOR CLOSET, ELEVATOR LOBBY, TERRACE ACCESSORY TO OFFICE USE						Exceptions: Zero Occupancy Allowed.		
Floor 32	F-2	0	100	6		122885422	Core & Shell	04/28/2024
Description of Use: Mechanical and/or electrical equipment rooms MECHAICAL ROOMS,SERVICE ELEVATOR LOBBY, FIRE ALARM CLOSET,ELECTRICAL ROOM,						Exceptions: Zero Occupancy Allowed.		
Floor 33	F-2	0	100	6		122885422	Core & Shell	04/28/2024
Description of Use: Mechanical and/or electrical equipment rooms MECHAICAL ROOMS,SERVICE ELEVATOR LOBBY, FIRE ALARM CLOSET,ELECTRICAL ROOM,						Exceptions: Zero Occupancy Allowed.		
Floor 33	B	0	100	6		122885422	Core & Shell	04/28/2024
Description of Use: Business and Service OFFICES,WOMEN'S WASHROOM,MEN'S WASHROOM, JANITOR CLOSET, ELEVATOR LOBBY, TERRACE ACCESSORY TO OFFICE USE						Exceptions: Zero Occupancy Allowed.		
Floor 34	F-2	17	100	6		122885422	Temporary	04/28/2024
Description of Use: Mechanical and/or electrical equipment rooms MECHAICAL ROOMS,SERVICE ELEVATOR LOBBY, FIRE ALARM CLOSET,ELECTRICAL ROOM,						Exceptions:		
Floor 34	B	333	100	6		122885422	Temporary	04/28/2024
Description of Use: Business and Service OFFICES,WOMEN'S WASHROOM,MEN'S WASHROOM, JANITOR CLOSET, ELEVATOR LOBBY, TERRACE ACCESSORY TO OFFICE USE						Exceptions:		



Permissible Use and Occupancy

FLOOR	Occ Group	Max. Persons Permitted	Live Loads (lbs per sq ft)	Zoning Use Group	Dwelling or Rooming Units	Job Reference	Certificate of Occupancy Type	CO Expiration Date
Floor 35	F-2	17	100	6		122885422	Temporary	04/28/2024
Description of Use: Mechanical and/or electrical equipment rooms MECHAICAL ROOMS,SERVICE ELEVATOR LOBBY, FIRE ALARM CLOSET,ELECTRICAL ROOM,						Exceptions:		
Floor 35	B	332	100	6		122885422	Temporary	04/28/2024
Description of Use: Business and Service OFFICES,WOMEN'S WASHROOM,MEN'S WASHROOM, JANITOR CLOSET, ELEVATOR LOBBY, TERRACE ACCESSORY TO OFFICE USE						Exceptions:		
Floor 36	F-2	13	100	6		122885422	Temporary	04/28/2024
Description of Use: Mechanical and/or electrical equipment rooms MECHAICAL ROOMS,SERVICE ELEVATOR LOBBY, FIRE ALARM CLOSET,ELECTRICAL ROOM,						Exceptions:		
Floor 36	B	340	100	6		122885422	Temporary	04/28/2024
Description of Use: Business and Service OFFICES,WOMEN'S WASHROOM,MEN'S WASHROOM, JANITOR CLOSET, ELEVATOR LOBBY, TERRACE ACCESSORY TO OFFICE USE						Exceptions:		
Floor 37	F-2	118	150	6		122885422	Temporary	04/28/2024
Description of Use: Mechanical and/or electrical equipment rooms GENERATOR ROOM, EPS ROOM, MECHANICAL ROOM, ELECTICAL ROOMS, SERVICE ELEVATOR LOBBY						Exceptions:		
Floor 38	F-2	7	150	6		122885422	Temporary	04/28/2024
Description of Use: Mechanical and/or electrical equipment rooms EMR & CONTROL ROOM						Exceptions:		



Permissible Use and Occupancy

FLOOR	Occ Group	Max. Persons Permitted	Live Loads (lbs per sq ft)	Zoning Use Group	Dwelling or Rooming Units	Job Reference	Certificate of Occupancy Type	CO Expiration Date
Floor 39	F-2	50	150	6		122885422	Temporary	04/28/2024
Description of Use:	Mechanical and/or electrical equipment rooms MECHANICAL ROOMS, ATS ROOM, SWITCHGEAR ROOM, SERVICE ELEVATOR LOBBY					Exceptions:		
Floor 40	B	370	100	6		122885422	Temporary	04/28/2024
Description of Use:	Business and Service OFFICES, WOMEN'S WASHROOM, MEN'S WASHROOM, JANITOR CLOSET, ELEVATOR LOBBY, TERRACE ACCESSORY TO OFFICE USE, ELEVATOR LOBBY					Exceptions:		
Floor 40	F-2	12	100	6		122885422	Temporary	04/28/2024
Description of Use:	Mechanical and/or electrical equipment rooms MECHANICAL ROOMS, SERVICE ELEVATOR LOBBY, FIRE ALARM CLOSET, ELECTRICAL ROOM					Exceptions:		
Floor 41	B	348	100	6		122885422	Temporary	04/28/2024
Description of Use:	Business and Service OFFICES, WOMEN'S WASHROOM, MEN'S WASHROOM, JANITOR CLOSET, ELEVATOR LOBBY, TERRACE ACCESSORY TO OFFICE USE, ELEVATOR LOBBY					Exceptions:		
Floor 41	F-2	12	100	6		122885422	Temporary	04/28/2024
Description of Use:	Mechanical and/or electrical equipment rooms MECHANICAL ROOMS, SERVICE ELEVATOR LOBBY, FIRE ALARM CLOSET, ELECTRICAL ROOM					Exceptions:		
Floor 42	B	364	100	6		122885422	Temporary	04/28/2024
Description of Use:	Business and Service OFFICES, WOMEN'S WASHROOM, MEN'S WASHROOM, JANITOR CLOSET, ELEVATOR LOBBY, TERRACE ACCESSORY TO OFFICE USE, ELEVATOR LOBBY, CONFERENCE ROOMS					Exceptions:		



Permissible Use and Occupancy

FLOOR	Occ Group	Max. Persons Permitted	Live Loads (lbs per sq ft)	Zoning Use Group	Dwelling or Rooming Units	Job Reference	Certificate of Occupancy Type	CO Expiration Date	
Floor 42	F-2	12	100	6		122885422	Temporary	04/28/2024	
Description of Use:		Mechanical and/or electrical equipment rooms MECHANICAL ROOMS, SERVICE ELEVATOR LOBBY, FIRE ALARM CLOSET, ELECTRICAL ROOM				Exceptions:			
Floor 43	F-2	12	100	6		122885422	Temporary	04/28/2024	
Description of Use:		Mechanical and/or electrical equipment rooms MECHANICAL ROOMS, SERVICE ELEVATOR LOBBY, FIRE ALARM CLOSET, ELECTRICAL ROOM				Exceptions:			
Floor 43	B	344	100	6		122885422	Temporary	04/28/2024	
Description of Use:		Business and Service OFFICES, WOMEN'S WASHROOM, MEN'S WASHROOM, JANITOR CLOSET, ELEVATOR LOBBY, TERRACE ACCESSORY TO OFFICE USE, ELEVATOR LOBBY, CONFERENCE ROOMS				Exceptions:			
Floor 44	F-2	12	100	6		122885422	Temporary	04/28/2024	
Description of Use:		Mechanical and/or electrical equipment rooms MECHANICAL ROOMS, SERVICE ELEVATOR LOBBY, FIRE ALARM CLOSET, ELECTRICAL ROOM				Exceptions:			
Floor 44	B	355	100	6		122885422	Temporary	04/28/2024	
Description of Use:		Business and Service OFFICES, WOMEN'S WASHROOM, MEN'S WASHROOM, JANITOR CLOSET, ELEVATOR LOBBY, TERRACE ACCESSORY TO OFFICE USE, ELEVATOR LOBBY, CONFERENCE ROOMS				Exceptions:			
Floor 45	B	323	100	6		122885422	Temporary	04/28/2024	
Description of Use:		Business and Service OFFICES, WOMEN'S WASHROOM, MEN'S WASHROOM, JANITOR CLOSET, ELEVATOR LOBBY, TERRACE ACCESSORY TO OFFICE USE, ELEVATOR LOBBY, CONFERENCE ROOMS				Exceptions:			



Permissible Use and Occupancy

FLOOR	Occ Group	Max. Persons Permitted	Live Loads (lbs per sq ft)	Zoning Use Group	Dwelling or Rooming Units	Job Reference	Certificate of Occupancy Type	CO Expiration Date	
Floor 45	F-2	12	100	6		122885422	Temporary	04/28/2024	
Description of Use:		Mechanical and/or electrical equipment rooms MECHANICAL ROOMS, SERVICE ELEVATOR LOBBY, FIRE ALARM CLOSET, ELECTRICAL ROOM				Exceptions:			
Floor 46	B	326	100	6		122885422	Temporary	04/28/2024	
Description of Use:		Business and Service OFFICES, WOMEN'S WASHROOM, MEN'S WASHROOM, JANITOR CLOSET, ELEVATOR LOBBY, TERRACE ACCESSORY TO OFFICE USE, ELEVATOR LOBBY, CONFERENCE ROOMS				Exceptions:			
Floor 46	F-2	20	100	6		122885422	Temporary	04/28/2024	
Description of Use:		Mechanical and/or electrical equipment rooms MECHANICAL ROOMS, SERVICE ELEVATOR LOBBY, FIRE ALARM CLOSET, ELECTRICAL ROOM				Exceptions:			
Floor 47	F-2	12	100	6		122885422	Temporary	04/28/2024	
Description of Use:		Mechanical and/or electrical equipment rooms MECHANICAL ROOMS, SERVICE ELEVATOR LOBBY, FIRE ALARM CLOSET, ELECTRICAL ROOM				Exceptions:			
Floor 47	B	330	100	6		122885422	Temporary	04/28/2024	
Description of Use:		Business and Service OFFICES, WOMEN'S WASHROOM, MEN'S WASHROOM, JANITOR CLOSET, ELEVATOR LOBBY, TERRACE ACCESSORY TO OFFICE USE, ELEVATOR LOBBY, CONFERENCE ROOMS				Exceptions:			
Floor 48	B	322	100	6		122885422	Temporary	04/28/2024	
Description of Use:		Business and Service OFFICES, WOMEN'S WASHROOM, MEN'S WASHROOM, JANITOR CLOSET, ELEVATOR LOBBY, TERRACE ACCESSORY TO OFFICE USE, ELEVATOR LOBBY, CONFERENCE ROOMS				Exceptions:			



Permissible Use and Occupancy

FLOOR	Occ Group	Max. Persons Permitted	Live Loads (lbs per sq ft)	Zoning Use Group	Dwelling or Rooming Units	Job Reference	Certificate of Occupancy Type	CO Expiration Date
Floor 48	F-2	15	100	6		122885422	Temporary	04/28/2024
Description of Use:	Mechanical and/or electrical equipment rooms MECHANICAL ROOMS, SERVICE ELEVATOR LOBBY, FIRE ALARM CLOSET, ELECTRICAL ROOM					Exceptions:		
Floor 49	B	302	100	6		122885422	Temporary	04/28/2024
Description of Use:	Business and Service OFFICES, WOMEN'S WASHROOM, MEN'S WASHROOM, JANITOR CLOSET, ELEVATOR LOBBY, TERRACE ACCESSORY TO OFFICE USE, ELEVATOR LOBBY, CONFERENCE ROOMS					Exceptions:		
Floor 49	F-2	15	100	6		122885422	Temporary	04/28/2024
Description of Use:	Mechanical and/or electrical equipment rooms MECHANICAL ROOMS, SERVICE ELEVATOR LOBBY, FIRE ALARM CLOSET, ELECTRICAL ROOM					Exceptions:		
Floor 50	B	346	100	6		122885422	Temporary	04/28/2024
Description of Use:	Business and Service OFFICES, WOMEN'S WASHROOM, MEN'S WASHROOM, JANITOR CLOSET, ELEVATOR LOBBY, TERRACE ACCESSORY TO OFFICE USE, ELEVATOR LOBBY, CONFERENCE ROOMS					Exceptions:		
Floor 50	F-2	13	100	6		122885422	Temporary	04/28/2024
Description of Use:	Mechanical and/or electrical equipment rooms MECHANICAL ROOMS, SERVICE ELEVATOR LOBBY, FIRE ALARM CLOSET, ELECTRICAL ROOM					Exceptions:		
Floor 51	F-2	20	100	6		122885422	Temporary	04/28/2024
Description of Use:	Mechanical and/or electrical equipment rooms MECHANICAL ROOMS, SERVICE ELEVATOR LOBBY, FIRE ALARM CLOSET, ELECTRICAL ROOM, KITCHEN ACCESSORY TO CAFETERIA OFFICE SPACE					Exceptions:		



Permissible Use and Occupancy

FLOOR	Occ Group	Max. Persons Permitted	Live Loads (lbs per sq ft)	Zoning Use Group	Dwelling or Rooming Units	Job Reference	Certificate of Occupancy Type	CO Expiration Date
Floor 51	B	400	100	6		122885422	Temporary	04/28/2024
Description of Use:	Business and Service OFFICES, WOMEN'S WASHROOM, MEN'S WASHROOM, JANITOR CLOSET, ELEVATOR LOBBY, TERRACE ACCESSORY TO OFFICE USE, ELEVATOR LOBBY, CONFERENCE ROOMS					Exceptions:		
Floor 51	A-2	380	100	6		122885422	Temporary	04/28/2024
Description of Use:	Cafeteria CAFETERIA AND KITCHEN ACCESSORY TO OFFICE SPACE					Exceptions:		
Floor 52	A-3	238	100	6		122885422	Temporary	04/28/2024
Description of Use:	Community/Exhibition/Lecture Hall CONFERENCE ROOM SOUTH					Exceptions:		
Floor 52	A-3	137	100	6		122885422	Temporary	04/28/2024
Description of Use:	Community/Exhibition/Lecture Hall CONFERENCE ROOM NORTH					Exceptions:		
Floor 52	B	306	100	6		122885422	Temporary	04/28/2024
Description of Use:	Business and Service OFFICES, TERRACE ACCESSORY TO OFFICE, MECHANICAL ROOM, SERVICE ELEVATOR LOBBY, FIRE ALARM CLOSET, ELECTRICAL ROOM, WOMEN'S WASHROOM, MEN'S WASHROOM, JANITOR CLOSET, CONFERENCE ROOMS					Exceptions:		
Floor 52	F-2	12	100	6		122885422	Temporary	04/28/2024
Description of Use:	Mechanical and/or electrical equipment rooms MECHANICAL ROOMS, SERVICE ELEVATOR LOBBY, FIRE ALARM CLOSET, ELECTRICAL ROOM					Exceptions:		



Permissible Use and Occupancy

FLOOR	Occ Group	Max. Persons Permitted	Live Loads (lbs per sq ft)	Zoning Use Group	Dwelling or Rooming Units	Job Reference	Certificate of Occupancy Type	CO Expiration Date
Floor 53	B	309	100	6		122885422	Temporary	04/28/2024
Description of Use:		Business and Service OFFICES, WOMEN'S WASHROOM, MEN'S WASHROOM, JANITOR CLOSET, ELEVATOR LOBBY, TERRACE ACCESSORY TO OFFICE USE, ELEVATOR LOBBY				Exceptions:		
Floor 53	F-2	13	100	6		122885422	Temporary	04/28/2024
Description of Use:		Mechanical and/or electrical equipment rooms MECHANICAL ROOMS, SERVICE ELEVATOR LOBBY, FIRE ALARM CLOSET, ELECTRICAL ROOM				Exceptions:		
Floor 54	F-2	0	100	6		122885422	Core & Shell	04/28/2024
Description of Use:		Mechanical and/or electrical equipment rooms MECHANICAL ROOMS, SERVICE ELEVATOR LOBBY, FIRE ALARM CLOSET, ELECTRICAL ROOM				Exceptions: Zero Occupancy Allowed.		
Floor 54	B	0	100	6		122885422	Core & Shell	04/28/2024
Description of Use:		Business and Service OFFICES, WOMEN'S WASHROOM, MEN'S WASHROOM, JANITOR CLOSET, ELEVATOR LOBBY, TERRACE ACCESSORY TO OFFICE USE, ELEVATOR LOBBY				Exceptions: Zero Occupancy Allowed.		
Floor 55	B	0	100	6		122885422	Core & Shell	04/28/2024
Description of Use:		Business and Service OFFICES, WOMEN'S WASHROOM, MEN'S WASHROOM, JANITOR CLOSET, ELEVATOR LOBBY, TERRACE ACCESSORY TO OFFICE USE, ELEVATOR LOBBY				Exceptions: Zero Occupancy Allowed.		
Floor 55	F-2	0	100	6		122885422	Core & Shell	04/28/2024
Description of Use:		Mechanical and/or electrical equipment rooms MECHANICAL ROOMS, SERVICE ELEVATOR LOBBY, FIRE ALARM CLOSET, ELECTRICAL ROOM				Exceptions: Zero Occupancy Allowed.		



Permissible Use and Occupancy

FLOOR	Occ Group	Max. Persons Permitted	Live Loads (lbs per sq ft)	Zoning Use Group	Dwelling or Rooming Units	Job Reference	Certificate of Occupancy Type	CO Expiration Date
Floor 56	B	0	100	6		122885422	Core & Shell	04/28/2024
Description of Use:		Business and Service OFFICES,WOMEN'S WASHROOM, MEN'S WASHROOM, JANITOR CLOSET,ELEVATOR LOBBY, TERRACE ACCESSORY TO OFFICE USE, ELEVATOR LOBBY				Exceptions: Zero Occupancy Allowed.		
Floor 56	F-2	0	100	6		122885422	Core & Shell	04/28/2024
Description of Use:		Mechanical and/or electrical equipment rooms MECHANICAL ROOMS, SERVICE ELEVATOR LOBBY, FIRE ALARM CLOSET, ELECTRICAL ROOM				Exceptions: Zero Occupancy Allowed.		
Floor 57	F-2	0	100	6		122885422	Core & Shell	04/28/2024
Description of Use:		Mechanical and/or electrical equipment rooms MECHANICAL ROOMS, SERVICE ELEVATOR LOBBY, FIRE ALARM CLOSET, ELECTRICAL ROOM				Exceptions: Zero Occupancy Allowed.		
Floor 57	B	0	100	6		122885422	Core & Shell	04/28/2024
Description of Use:		Business and Service OFFICES,WOMEN'S WASHROOM, MEN'S WASHROOM, JANITOR CLOSET,ELEVATOR LOBBY, TERRACE ACCESSORY TO OFFICE USE, ELEVATOR LOBBY				Exceptions: Zero Occupancy Allowed.		
Floor 58	B	0	100	6		122885422	Core & Shell	04/28/2024
Description of Use:		Business and Service OFFICES,WOMEN'S WASHROOM, MEN'S WASHROOM, JANITOR CLOSET,ELEVATOR LOBBY, TERRACE ACCESSORY TO OFFICE USE, ELEVATOR LOBBY				Exceptions: Zero Occupancy Allowed.		
Floor 58	F-2	0	100	6		122885422	Core & Shell	04/28/2024
Description of Use:		Mechanical and/or electrical equipment rooms MECHANICAL ROOMS, SERVICE ELEVATOR LOBBY, FIRE ALARM CLOSET, ELECTRICAL ROOM				Exceptions: Zero Occupancy Allowed.		



Permissible Use and Occupancy

FLOOR	Occ Group	Max. Persons Permitted	Live Loads (lbs per sq ft)	Zoning Use Group	Dwelling or Rooming Units	Job Reference	Certificate of Occupancy Type	CO Expiration Date
Floor 59	B	0	100	6		122885422	Core & Shell	04/28/2024
Description of Use:		Business and Service OFFICES, WOMEN'S WASHROOM, MEN'S WASHROOM, JANITOR CLOSET, ELEVATOR LOBBY, TERRACE ACCESSORY TO OFFICE USE, ELEVATOR LOBBY				Exceptions: Zero Occupancy Allowed.		
Floor 59	F-2	0	100	6		122885422	Core & Shell	04/28/2024
Description of Use:		Mechanical and/or electrical equipment rooms MECHANICAL ROOMS, SERVICE ELEVATOR LOBBY, FIRE ALARM CLOSET, ELECTRICAL ROOM				Exceptions: Zero Occupancy Allowed.		
Floor 60	F-2	0	100	6		122885422	Core & Shell	04/28/2024
Description of Use:		Mechanical and/or electrical equipment rooms MECHANICAL ROOMS, SERVICE ELEVATOR LOBBY, FIRE ALARM CLOSET, ELECTRICAL ROOM				Exceptions: Zero Occupancy Allowed.		
Floor 60	B	0	100	6		122885422	Core & Shell	04/28/2024
Description of Use:		Business and Service OFFICES, WOMEN'S WASHROOM, MEN'S WASHROOM, JANITOR CLOSET, ELEVATOR LOBBY, TERRACE ACCESSORY TO OFFICE USE, ELEVATOR LOBBY				Exceptions: Zero Occupancy Allowed.		
Floor 61	B	0	100	6		122885422	Core & Shell	04/28/2024
Description of Use:		Business and Service OFFICES, WOMEN'S WASHROOM, MEN'S WASHROOM, JANITOR CLOSET, ELEVATOR LOBBY, TERRACE ACCESSORY TO OFFICE USE, ELEVATOR LOBBY				Exceptions: Zero Occupancy Allowed.		
Floor 61	F-2	0	100	6		122885422	Core & Shell	04/28/2024
Description of Use:		Mechanical and/or electrical equipment rooms MECHANICAL ROOMS, SERVICE ELEVATOR LOBBY, FIRE ALARM CLOSET, ELECTRICAL ROOM				Exceptions: Zero Occupancy Allowed.		



Permissible Use and Occupancy

FLOOR	Occ Group	Max. Persons Permitted	Live Loads (lbs per sq ft)	Zoning Use Group	Dwelling or Rooming Units	Job Reference	Certificate of Occupancy Type	CO Expiration Date	
Floor 62	B	0	100	6		122885422	Core & Shell	04/28/2024	
Description of Use:		Business and Service OFFICES, WOMEN'S WASHROOM, MEN'S WASHROOM, JANITOR CLOSET, ELEVATOR LOBBY, TERRACE ACCESSORY TO OFFICE USE, ELEVATOR LOBBY				Exceptions: Zero Occupancy Allowed.			
Floor 62	F-2	0	100	6		122885422	Core & Shell	04/28/2024	
Description of Use:		Mechanical and/or electrical equipment rooms MECHANICAL ROOMS, SERVICE ELEVATOR LOBBY, FIRE ALARM CLOSET, ELECTRICAL ROOM				Exceptions: Zero Occupancy Allowed.			
Floor 63	B	0	100	6		122885422	Core & Shell	04/28/2024	
Description of Use:		Business and Service OFFICES, WOMEN'S WASHROOM, MEN'S WASHROOM, JANITOR CLOSET, ELEVATOR LOBBY, TERRACE ACCESSORY TO OFFICE USE, ELEVATOR LOBBY				Exceptions: Zero Occupancy Allowed.			
Floor 63	F-2	0	100	6		122885422	Core & Shell	04/28/2024	
Description of Use:		Mechanical and/or electrical equipment rooms MECHANICAL ROOMS, SERVICE ELEVATOR LOBBY, FIRE ALARM CLOSET, ELECTRICAL ROOM				Exceptions: Zero Occupancy Allowed.			
Floor 64	B	0	100	6		122885422	Core & Shell	04/28/2024	
Description of Use:		Business and Service OFFICES, WOMEN'S WASHROOM, MEN'S WASHROOM, JANITOR CLOSET, ELEVATOR LOBBY, TERRACE ACCESSORY TO OFFICE USE, ELEVATOR LOBBY				Exceptions: Zero Occupancy Allowed.			
Floor 64	F-2	0	100	6		122885422	Core & Shell	04/28/2024	
Description of Use:		Mechanical and/or electrical equipment rooms MECHANICAL ROOMS, SERVICE ELEVATOR LOBBY, FIRE ALARM CLOSET, ELECTRICAL ROOM				Exceptions: Zero Occupancy Allowed.			



Permissible Use and Occupancy

FLOOR	Occ Group	Max. Persons Permitted	Live Loads (lbs per sq ft)	Zoning Use Group	Dwelling or Rooming Units	Job Reference	Certificate of Occupancy Type	CO Expiration Date	
Floor 65	B	286	100	6		122885422	Temporary	04/28/2024	
Description of Use:		Business and Service OFFICES,WOMEN'S WASHROOM, MEN'S WASHROOM, JANITOR CLOSET,ELEVATOR LOBBY, TERRACE ACCESSORY TO OFFICE USE, ELEVATOR LOBBY				Exceptions:			
Floor 65	F-2	8	100	6		122885422	Temporary	04/28/2024	
Description of Use:		Mechanical and/or electrical equipment rooms MECHANICAL ROOMS, SERVICE ELEVATOR LOBBY, FIRE ALARM CLOSET, ELECTRICAL ROOM				Exceptions:			
Floor 66	B	53	150	6		122885422	Temporary	04/28/2024	
Description of Use:		Business and Service OFFICES,CONFERENCE ROOMS, WOMEN'S WASHROOM,MEN'S WASHROOM,JANITOR CLOSET, ELEVATOR LOBBY, TERRACE ACCESSORY TO OFFICE USE,ELEVATOR LOBBY				Exceptions:			
Floor 66	F-2	12	150	6		122885422	Temporary	04/28/2024	
Description of Use:		Mechanical and/or electrical equipment rooms BOILER ROOM, MECHANICAL ROOMS, ELECTRICAL ROOM,EMR & CONTROL ROOM, FIRE ALARM CLOSET, FIRE TANK & PUMP ROOM, SERVICE ELEVATOR LOBBY				Exceptions:			
Floor 66	A-2	355	150	6		122885422	Temporary	04/28/2024	
Description of Use:		Banquet ACCESSORY LOUNGES AND RECEPTION FOR BUILDING TENANTS WITH WARMING PANTRY. AND EATING AND DRINKING ESTABLISHMENT				Exceptions: No cooking, warming only			
Roof	F-2	18	150	6		122885422	Temporary	04/28/2024	
Description of Use:		Mechanical and/or electrical equipment rooms MECHANICAL PENTHOUSE, EMR & CONTROL ROOM.				Exceptions:			

CofO Comments: THESE PREMISE HAVE BEEN DECLARED TO BE ONE ZONING LOT CONSISTING OF TAX LOTS 20,17,29,35,36 UNDER BLOCK 706 UNDER CRFN#S2017000211993 2018000055478.

Borough Commissioner

Commissioner