

# Manhattan Community Board 4

(All Fields Must Be Completed)

Liquor License/Sidewalk Cafe Stipulations Application

CORPORATION NAME		DOING BUSINESS AS (DBA)	
STREET ADDRESS 472 9th Ave		CROSS STREETS Bwn 36+37th St	ZIP CODE 10018
OWNER <small>(Attach a list of all the people that will be associated/listed with the license)</small>	NAME: Margaret Reilly	ATTORNEY/ REPRESENTATIVE	NAME: Terrence Flynn Jr
	PHONE: 646 515 4921		PHONE: 718 945 1000
	EMAIL: maggiereillysmc@gmail.com		EMAIL: tcflynnjr@gmail.com
MANAGER	NAME: Same	LANDLORD	NAME: Thomas Makkos
	PHONE:		PHONE: 212 736 8700
	EMAIL:		EMAIL: makkosthomas@gmail.com
APPLICATION TYPE ( <u>    </u> Liquor License <u>    </u> Unenclosed Sidewalk Cafe )			
<input checked="" type="radio"/> New	Has applicant owned or managed a similar business?	<input checked="" type="radio"/> YES	<input type="radio"/> NO
	What is/was the name and address of establishment?	Maggie Reillys, 340 9th Ave NY 10001	
	What were the dates applicant was involved with this former premise?	Dec 10, 2012 - Present	
<input type="radio"/> Corp Change/Class Change/Removal	What is the license # and expiration date?		
	Is applicant making any alterations or operational changes?	<input type="radio"/> YES	<input type="radio"/> NO
	If alterations or operational changes are being made, please describe/list all changes.		
<input type="radio"/> Alteration	What is the current license # and expiration date?		
	Please list/describe the nature of all the changes and attach the plans:		
METHOD OF OPERATION			
TYPE OF ALCOHOL	<input checked="" type="radio"/> Liquor/Wine/Beer & Cider <input type="radio"/> Beer & Cider <input type="radio"/> Wine/Beer & Cider		
ESTABLISHMENT TYPE	<input checked="" type="radio"/> Restaurant <input type="radio"/> Cabaret <input type="radio"/> Night Club <input type="radio"/> Hotel <input type="radio"/> Bar/Tavern <input type="radio"/> Catering Establishment <input type="radio"/> Adult Entertainment <input type="radio"/> Wine Bar <input type="radio"/> Dance Club <input type="radio"/> Sports Bar <input type="radio"/> Club (Fraternal Organization - Members Only)		
Has applicant/owner filed with the SLA? If yes, when? If no, when do you plan to file?	<input type="radio"/> YES	<input checked="" type="radio"/> NO	Immediately
Is the 500 Foot Rule applicable? If yes, please attach a diagram of the On-Premise liquor license establishments within a 500 ft. radius of your establishment and the Public Interest Statement.	<input checked="" type="radio"/> YES	<input type="radio"/> NO	Longro Bros.
Is the 200 Foot Rule applicable? If yes, please attach a diagram of the schools and houses of worship that trigger the rule.	<input type="radio"/> YES	<input checked="" type="radio"/> NO	
Has applicant/owner(s) read MCB4 Policy Regarding Concentration and Location of Alcoholic-Serving Establishments?	<input checked="" type="radio"/> YES	<input type="radio"/> NO	

OPERATIONAL DETAILS (*Closing time will be when establishment is vacated of all patrons)									
HOURS* <i>(Indoor Only)</i>		MONDAY	TUESDAY	WEDNESDAY	THURSDAY	FRIDAY	SATURDAY	SUNDAY	
	Operation	11am-2am	11am-2am	11am-2am	11am-2am	11am-3am	11am-3am	11am-2am	
	Kitchen	11am-2am	11am-2am	11am-2am	11am-2am	11am-3am	11am-3am	11am-2am	
	Music	11am-2am	11am-2am	11am-2am	11am-2am	11am-3am	11am-3am	11am-2am	
If you plan to have music, what type(s)? (Circle all that apply)		<input checked="" type="checkbox"/> BACKGROUND		<input type="checkbox"/> LIVE MUSIC	<input type="checkbox"/> DJ	<input type="checkbox"/> JUKE BOX	<input type="checkbox"/> KARAOKE		
OCCUPANCY									
	Capacity (Certificate of Occupancy)	Maximum # of Persons Occupying Premises (Including Employees)	Number of Tables	Number of Seats	Number of Service Only Bars	Number of Stand-Up Bars	Number of Seats at Stand-Up Bar		
INSIDE	74	74	16	48	0	1	22		
OUTSIDE <i>(Other than sidewalk café)</i>	N/A								
DCA APPROVED UNENCLOSED SIDEWALK CAFÉ	N/A								
How many floors are there? What is the capacity for each floor?					1 Floor - 74 Capacity				
How frequently will the owner(s) be at the establishment?					Daily				
Will there be dancing?					YES	<input checked="" type="checkbox"/> NO			
Will applicant have bottle or table service for beverage alcohol?					YES	<input checked="" type="checkbox"/> NO			
Will applicant be hosting private; promotional or corporate events?					YES	<input checked="" type="checkbox"/> NO			
Will outside promoters be used on a regular basis? If yes please describe.					YES	<input checked="" type="checkbox"/> NO			
Will applicant have a security plan? If, yes please attach.					YES	<input checked="" type="checkbox"/> NO			
Will security plan be implemented?					YES	NO	N/A		
Will State certified security personnel be used?					YES	NO	N/A		
Will New York Nightlife Association and NYPD Best Practices be followed?					<input checked="" type="checkbox"/> YES	NO			
Does applicant agree to notify MCB4 prior to making changes to its method of operation?					<input checked="" type="checkbox"/> YES	NO			
Will applicant be using delivery bicycles? If yes, how many?					YES	<input checked="" type="checkbox"/> NO			
Will delivery bicycles be clearly marked with the name of the restaurant and will staff wear attire clearly noting name as described by NYC Law?					YES	NO	N/A		
Where will delivery bicycles be stored during the day when not in use?					N/A				

**MULTIPLE SPACES/FLOORS CAPACITY BREAKDOWN**

Space /Floor	Description/Use of Space	Capacity	Hours	# of Tables	# of Seats	# of Service Only Bars	# of Stand-Up Bars/Seats at Bar	Music

LOCATION & ZONING		
Is this a Special District? If yes, is it Clinton, West Chelsea or Hudson Yards?	YES	<del>NO</del>
Does the building have a Certificate of Occupancy ("C of O") or a letter of no objection?	<del>YES</del>	NO
Is a Public Assembly permit required?	YES	<del>NO</del>
Are your plans filed with DOB?	YES	<del>NO</del>

**Community Notification/Relations**

<b>NOTIFICATION:</b> List all block associations; tenant associations, co-op boards or condo boards of residential buildings; and community groups that applicant has notified regarding its application. For each please list both the organization and individual you contacted	# 1	HKNA - Kathleen Treat
	# 2	West 36 <sup>th</sup> St - Frank Strack
	# 3	CHDC (incl. Bob's & Bird Parks) - Joe Restuccia
	# 4	Hudson Yards Hells Kitchen Alliance - Bob Benfatto
	# 5	CHEKPEDS - Christine Berthel
Please provide dates when applicant met with the groups listed above.		March 22, 2024 - Sent emails
Who was your contact person at each group you met with?		Kathleen Treat, Joe Restuccia, Julia Campanelli, Frank Strack, Brian Weber, Nelly Gonzalez
When did applicant post the notice that was provided?		
Where did applicant post the notice that was provided?		Lamp Posts, door of Space 472 9 <sup>th</sup> Ave
Will applicant provide owner cell phone number to neighbors and respond to complaints that arise? Please provide number in space provided.		YES <input checked="" type="checkbox"/> NO <input type="checkbox"/>
Will applicant inform the Community Board office of its job openings and/or provide a hyperlink to applicants jobs webpage?		YES <input checked="" type="checkbox"/> NO <input type="checkbox"/>

BUILDING DESIGN			
State the name and type of business previously located in the space.	Thai Select - Thai Restaurant		
Has a liquor-licensed establishment previously occupied this space at any time? If yes, please provide the name of the business.	<input checked="" type="checkbox"/> YES	<input type="checkbox"/> NO	
Do you plan any changes to the existing façade? If yes, please describe.	<input checked="" type="checkbox"/> YES	<input type="checkbox"/> NO	Cosmetic
Has the applicant/owner(s) read MCB 4 ADA Guidelines Memo?	<input checked="" type="checkbox"/> YES	<input type="checkbox"/> NO	
Is the entrance ADA Compliant?	<input checked="" type="checkbox"/> YES	<input type="checkbox"/> NO	
Do you plan any changes to the existing façade? If yes, please describe.	<input checked="" type="checkbox"/> YES	<input type="checkbox"/> NO	Cosmetic. Wood front change up
Will applicant have a vestibule within the establishment?	<input type="checkbox"/> YES	<input checked="" type="checkbox"/> NO	
Will applicant use a storm enclosure?	<input type="checkbox"/> YES	<input checked="" type="checkbox"/> NO	
Does applicant agree to keep the sidewalk clear of all items or obstructions, such as sandwich boards, sidewalk signs, freestanding menus and plants, as per the law?	<input checked="" type="checkbox"/> YES	<input type="checkbox"/> NO	
Will applicant comply with the NYC noise code?	<input checked="" type="checkbox"/> YES	<input type="checkbox"/> NO	
Will the establishment have any of the following: (circle all that apply)	<input type="checkbox"/> FRENCH DOORS	<input type="checkbox"/> GARAGE DOORS	<input checked="" type="checkbox"/> WINDOWS THAT CAN BE OPENED
Will applicant close all windows, French doors, garage doors when any music or amplified sound (including televisions) is played inside the establishment?	<input checked="" type="checkbox"/> YES	<input type="checkbox"/> NO	
Will applicant close all windows, French doors, garage doors by 11 PM Friday and Saturday and 10 PM on all other days even if no music or amplified sound is played inside the establishment?	<input checked="" type="checkbox"/> YES	<input type="checkbox"/> NO	
Has applicant obtained an acoustical report from a certified sound engineer to assess potential noise disturbance to the neighboring residents and buildings?	<input type="checkbox"/> YES	<input checked="" type="checkbox"/> NO	
Will applicant follow the recommendations of a certified sound engineer to mitigate potential noise disturbance to the neighboring residents and buildings, including placing speakers on the floor of the establishment?	<input checked="" type="checkbox"/> YES	<input type="checkbox"/> NO	
Will the kitchen exhaust system extend to the roof?	<input checked="" type="checkbox"/> YES	<input type="checkbox"/> NO	
Will the establishment have an illuminated sign?	<input checked="" type="checkbox"/> YES	<input type="checkbox"/> NO	
Will the establishment have a canopy extending over the sidewalk?	<input checked="" type="checkbox"/> YES	<input type="checkbox"/> NO	
Where will the air conditioner be located? What type is it?	Roof Set Back - YORK 7 1/2 TONS x2		
When was the air conditioner installed?	2014		

OUTDOOR ITEMS - OTHER THAN SIDEWALK CAFÉ			
Has the applicant/owner(s) read MCB 4 Rear Yard Rooftop Policy?	YES	NO	N/A
Will applicant use any outdoor spaces: rooftop, rear yard, patio, porch, balcony, pavilion, tents, deck, gazebo or open dining in the parking lane? If yes, which one(s)?	YES	NO	N/A
Are the floorplans for the outdoor space(s) included?	YES	NO	N/A
Will applicant close and vacate the outdoor space(s) by 11PM on Friday & Saturday and 10 PM on all other days?	YES	NO	N/A
Will the service and consumption of alcohol in any outdoor space only be via seated food service?	YES	NO	N/A
Will applicant not allow standing space for patrons to drink or smoke in any outdoor space(s) or on the sidewalk?	YES	NO	N/A
Will there be no amplified music, as per the law?	YES	NO	N/A
If amplified sound is played inside the establishment, will windows and doors be closed?	<input checked="" type="checkbox"/> YES	NO	
Will applicant agree to post signs outside asking customers to respect the neighbors'?	<input checked="" type="checkbox"/> YES	NO	
Will applicant agree to train staff to encourage a peaceful environment?	<input checked="" type="checkbox"/> YES	NO	
Will applicant provide effective sound control (landscaping enclosure, soundproofing tenants apartments)	<input checked="" type="checkbox"/> YES	NO	
Will there be a lighting plan that allows safe usage of the outdoor space without disrupting neighbors?	<input checked="" type="checkbox"/> YES	NO	
If open dining in the parking lane, will applicant agree to leave the sidewalk free of any furniture?	<input checked="" type="checkbox"/> YES	NO	
If open dining, will you comply with all NYC DOT guidelines?	<input checked="" type="checkbox"/> YES	NO	
If open dining, will the installation be year-round?	YES	NO	As Per City / DOT Rules

**DCA APPROVED UNENCLOSED SIDEWALK CAFÉ**

Has the applicant/owner(s) read MCB4 Sidewalk Café Policy?	<input checked="" type="checkbox"/> YES	<input type="checkbox"/> NO	
Will applicant be applying for a sidewalk café now or in the future?	<input checked="" type="checkbox"/> YES	<input type="checkbox"/> NO	
Is applicant in this application seeking to include a sidewalk café in its liquor license?	<input type="checkbox"/> YES	<input checked="" type="checkbox"/> NO	
If yes, has applicant submitted an application and plans to NYC Dept. of Consumer Affairs? Please attach application and plans.	<input type="checkbox"/> YES	<input type="checkbox"/> NO	N/A
Will applicant close and vacate the sidewalk café by 11 PM on Friday & Saturday and 10 PM on all other days?	<input type="checkbox"/> YES	<input type="checkbox"/> NO	N/A
Will applicant be serving alcohol in the sidewalk café? If so, will you have waiter service?	<input type="checkbox"/> YES	<input type="checkbox"/> NO	N/A
Will the café have a 3 ft. wide serving aisle running the entire length of the sidewalk café?	<input type="checkbox"/> YES	<input type="checkbox"/> NO	N/A
Will applicant mark the perimeter of the café on the sidewalk?	<input type="checkbox"/> YES	<input type="checkbox"/> NO	N/A
Will the service and consumption of alcohol in the sidewalk café only be via seated food service?	<input type="checkbox"/> YES	<input type="checkbox"/> NO	N/A
Will the sidewalk café not provide standing space for drinking or smoking?	<input type="checkbox"/> YES	<input type="checkbox"/> NO	N/A
Will applicant use any portable natural gas heaters? If so, do you have the requisite approvals from DOB & the Fire Department?	<input type="checkbox"/> YES	<input type="checkbox"/> NO	N/A
Will applicant have a lighting plan that will allow safe usage of the outdoor space without disrupting neighbors?	<input type="checkbox"/> YES	<input type="checkbox"/> NO	N/A
Will all furniture, plants and barricades be stored inside between the evening closing hours and the morning opening hours?	<input type="checkbox"/> YES	<input type="checkbox"/> NO	N/A
Will all furniture be stored inside between December 21 <sup>st</sup> and March 21 <sup>st</sup> , and any other day when it rains or snows?	<input type="checkbox"/> YES	<input type="checkbox"/> NO	N/A
Will applicant use umbrellas?	<input type="checkbox"/> YES	<input type="checkbox"/> NO	N/A
If construction or construction protection has reduced the sidewalk width, will applicant always maintain an 8 foot clear path of sidewalk between the perimeter of the café and the closest obstruction including construction barricades?	<input type="checkbox"/> YES	<input type="checkbox"/> NO	N/A
If open dining is in the parking lane, will applicant agree to remove its sidewalk café?	<input type="checkbox"/> YES	<input type="checkbox"/> NO	N/A

**ADDITIONAL STIPULATIONS: (Office Use Only)**

- Applicant will obtain an acoustical report from an NYC-approved acoustical engineer and submit the report to MCB4 office by 4/24/24.
- Applicant agrees to implement all recommendations of report

***To the extent any additional stipulation on pages 7 and 8 of this application conflicts with any response on pages 1 – 6 of this application, the stipulations on pages 7 and 8 control.***



**ADDITIONAL STIPULATIONS: (Office Use Only), *Continued***

***To the extent any additional stipulation on pages 7 and 8 of this application conflicts with any response on pages 1 – 6 of this application, the stipulations on pages 7 and 8 control.***

Manhattan Community Board 4 (MCB4) recommends:  
 (MCB4's recommendation is based on a vote taken at its  
May 1, 2024 full board meeting, with 39 members voting in favor  
 of the recommendation, 0 members opposed, 0 members  
 abstaining and 0 present but not eligible)

Denial unless all stipulations agreed to by applicant/owner are part of the method of operation  
 Denial  Approval

**CB4 REPRESENTATIVES**



Nelly Gonzalez  
 CB4 Assistant District Manager



Frank Holozubiec  
 CB4 BLP Committee Co-Chair



Burt Lazarin  
 CB4 BLP Committee Co-Chair

**APPLICANT AGREEMENT WITH THE COMMUNITY**

Applicant agrees to these stipulations as the basis for the community support of this application and acknowledges that all of these stipulations are essential prerequisites to the MCB4 recommendation regarding this application. Applicant agrees to have these stipulations incorporated in the method of operation of its liquor license. The stipulations in this application constitute the entire agreement between MCB4 and applicant and may only be altered in writing signed by MCB4 and applicant. These stipulations supersede any oral statements or representations in connection with this application.

SIGN HERE →



PRINT NAME OF APPLICANT



SIGNATURE OF APPLICANT

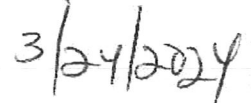

DATE

# Flynn & Flynn, P.L.L.C.

ATTORNEYS AT LAW

TERRENCE R. FLYNN, JR.

MARY P. FLYNN

444 Beach 129th Street  
Belle Harbor, New York 11694  
TEL: 718-945-1000  
FAX: 718-318-6162

March 12, 2024

CERTIFIED MAIL  
NO. 9589 0710 5270 0717 4469 38  
RETURN RECEIPT REQUESTED

Mr Jesse Bodine, District Manager  
Manhattan Community Board 4  
424 West 33<sup>rd</sup> Street, Suite #580  
New York, NY 10001

Manhattan Community Board

RECEIVED

Date: 3/14/24

Time: 2pm

By: *Neilly Conroy*

Re: Margaret Reilly or Entity to be formed-On-Premise Liquor License and  
Temporary Permit Application

Dear Mr. Bodine:

Please be advised that I am the attorney for Margaret Reilly or Entity to be formed that is applying for an On-Premise Liquor License and Temporary Permit for the premises located at 472 9<sup>th</sup> Avenue, New York, NY 10018. This notification is given pursuant to Section 64, Subdivision 2A of the Alcoholic Beverage Control Law.

If you have any questions, please do not hesitate to call my office. Thank you for your cooperation in this matter.

Sincerely yours,

*Terrence R. Flynn Jr.*

Terrence R. Flynn, Jr.

TRFJ/vc

### Standardized NOTICE FORM for Providing 30-Day Advance Notice to a Local Municipality or Community Board

1. Date Notice Sent:

March 12, 2024

1a. Delivered by:

Certified Mail / Return Receipt

2. Select the type of Application that will be filed with the Authority for an On-Premises Alcoholic Beverage License:

For premises outside the City of New York:

New Application  Removal  Class Change

For premises in the City of New York:

New Application  New Application and Temporary Retail Permit  Renewal  Alteration  Removal

Class Change  Method of Operation  Corporate Change

For **New** and Temporary Retail Permit applicants, answer each question below using all information known to date

For **Renewal** applicants, answer all questions

For **Alteration** applicants, attach a complete written description and diagrams depicting the proposed alteration(s)

For **Corporate Change** applicants, attach a list of the current and proposed corporate principals

For **Removal** applicants, attach a statement of your current and proposed addresses with the reason(s) for the relocation

For **Class Change** applicants, attach a statement detailing your current license type and your proposed license type

For **Method of Operation Change** applicants, although not required, if you choose to submit, attach an explanation detailing those changes

**Please include all documents as noted above. Failure to do so may result in disapproval of the application.**

**This 30-Day Advance Notice is Being Provided to the Clerk of the Following Local Municipality or Community Board:**

3. Name of Municipality or Community Board:

Community Bd #4

**Applicant/Licensee Information:**

4. Licensee Serial Number (if applicable):

\_\_\_\_\_

Expiration Date (if applicable):

\_\_\_\_\_

5. Applicant or Licensee Name:

Margaret Reilly or Entity to be formed

6. Trade Name (if any):

\_\_\_\_\_

7. Street Address of Establishment:

472 9th Avenue

8. City, Town or Village:

Manhattan

, NY Zip Code:

10018

9. Business Telephone Number of applicant/ Licensee:

646 476 3209

10. Business E-mail of Applicant/Licensee:

Maggiereillysnyc@gmail.com

11. Type(s) of alcohol sold or to be sold:

Beer & cider

Wine, Beer & Cider

Liquor, Wine, Beer & Cider

12. Extent of Food Service:

Full Food menu; full kitchen run by a chef/cook  Menu meets legal minimum food requirements; food prep area required

13. Type of Establishment:

IRISH PUB & RESTAURANT

Seasonal Establishment

Juke Box

Disc Jockey

Recorded Music

Karaoke

14. Method of Operation:  
(check all that apply)

Live Music (give details i.e., rock bands, acoustic, jazz, etc.): \_\_\_\_\_

Patron Dancing

Employee Dancing

Exotic Dancing

Topless Entertainment

Video/Arcade Games

Third Party Promoters

Security Personnel

Other (specify): \_\_\_\_\_

\_\_\_\_\_

15. Licensed Outdoor Area:

None

Patio or Deck

Rooftop

Garden/Grounds

Freestanding Covered Structure

(check all that apply)

Sidewalk Cafe

Other (specify): \_\_\_\_\_

Original

Amended

Date \_\_\_\_\_

16. List the floor(s) of the building that the establishment is located on:

Ground Floor

17. List the room number(s) the establishment is located in within the building, if appropriate:

18. Is the premises located within 500 feet of three or more on-premises liquor establishments?

Yes  No

19. Will the license holder or a manager be physically present within the establishment during all hours of operation?

Yes  No

20. If this is a transfer application (an existing licensed business is being purchased) provide the name and serial number of the licensee:

Name

Serial Number

21. Does the applicant or licensee own the building in which the establishment is located?

Yes (if YES, SKIP 23-26)  No

**Owner of the Building in Which the Licensed Establishment is Located**

22. Building Owner's Full Name:

Thomas Makkos

23. Building Owner's Street Address:

349 West 37th Street

24. City, Town or Village:

Manhattan

State:

N.Y

Zip Code:

10018

25. Business Telephone Number of Building Owner:

212-736-8700

**Representative or Attorney Representing the Applicant in Connection with the Application for a License to Traffic in Alcohol at the Establishment Identified in this Notice**

26. Representative/Attorney's Full Name:

TERRENCE R. FLYNN JR.

27. Representative/Attorney's Street Address:

1-88 Beach 102nd St.

28. City, Town or Village:

Far Rockaway

State:

N.Y

Zip Code:

11694

29. Business Telephone Number of Representative/Attorney:

718-945-1000

30. Business E-mail Address of Representative/Attorney:

trflynnjr@gmail.com

I am the applicant or licensee holder or a principal of the legal entity that holds or is applying for the license. Representations in this form are in conformity with representations made in submitted documents relied upon by the Authority when granting the license. I understand that representations made in this form will also be relied upon, and that false representations may result in disapproval of the application or revocation of the license.

By my signature, I affirm - under **Penalty of Perjury** - that the representations made in this form are true.

31. Printed Principal Name:

MARGARET REILLY

Title:

Owner

Principal Signature:

*Margaret Reilly*

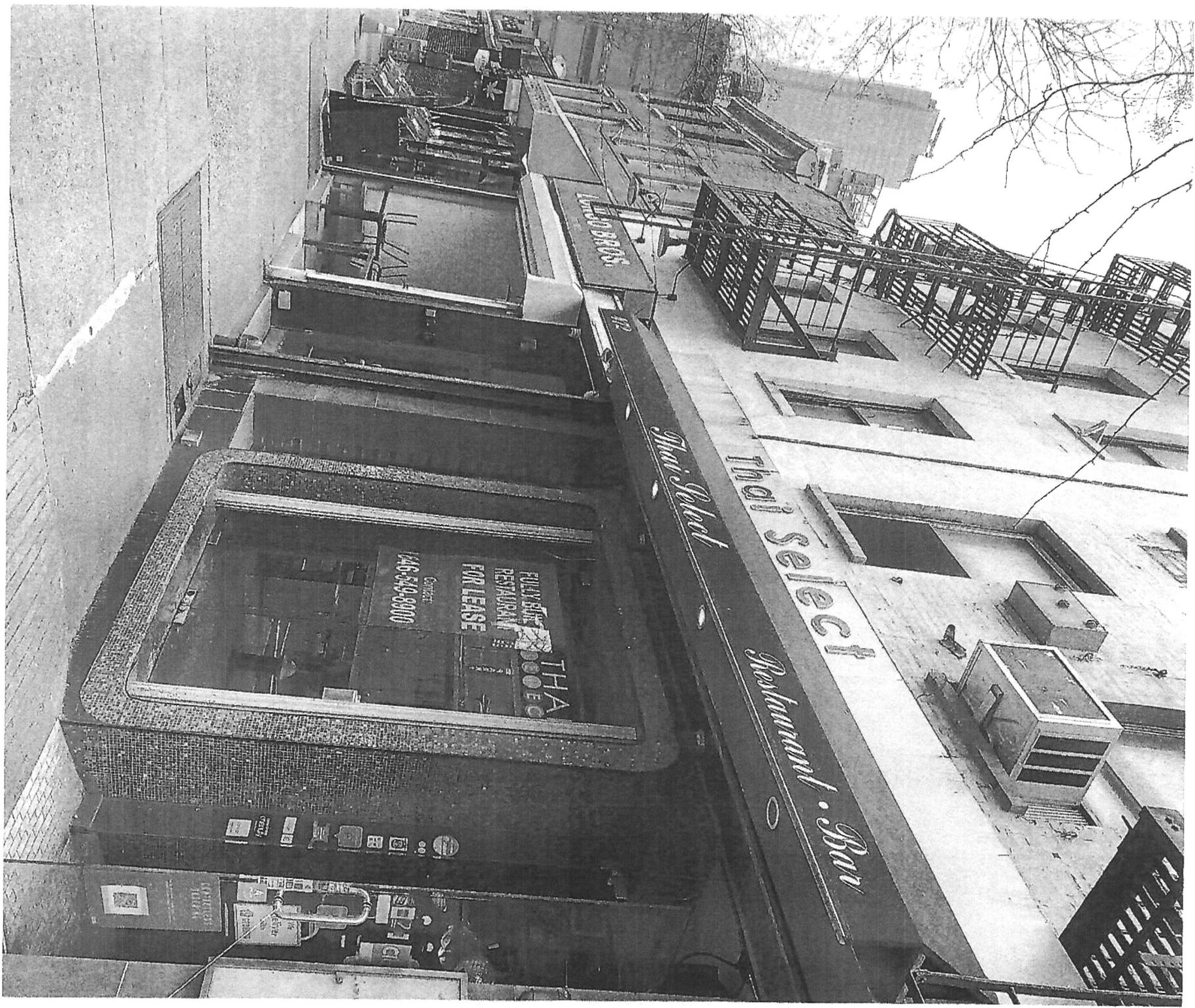

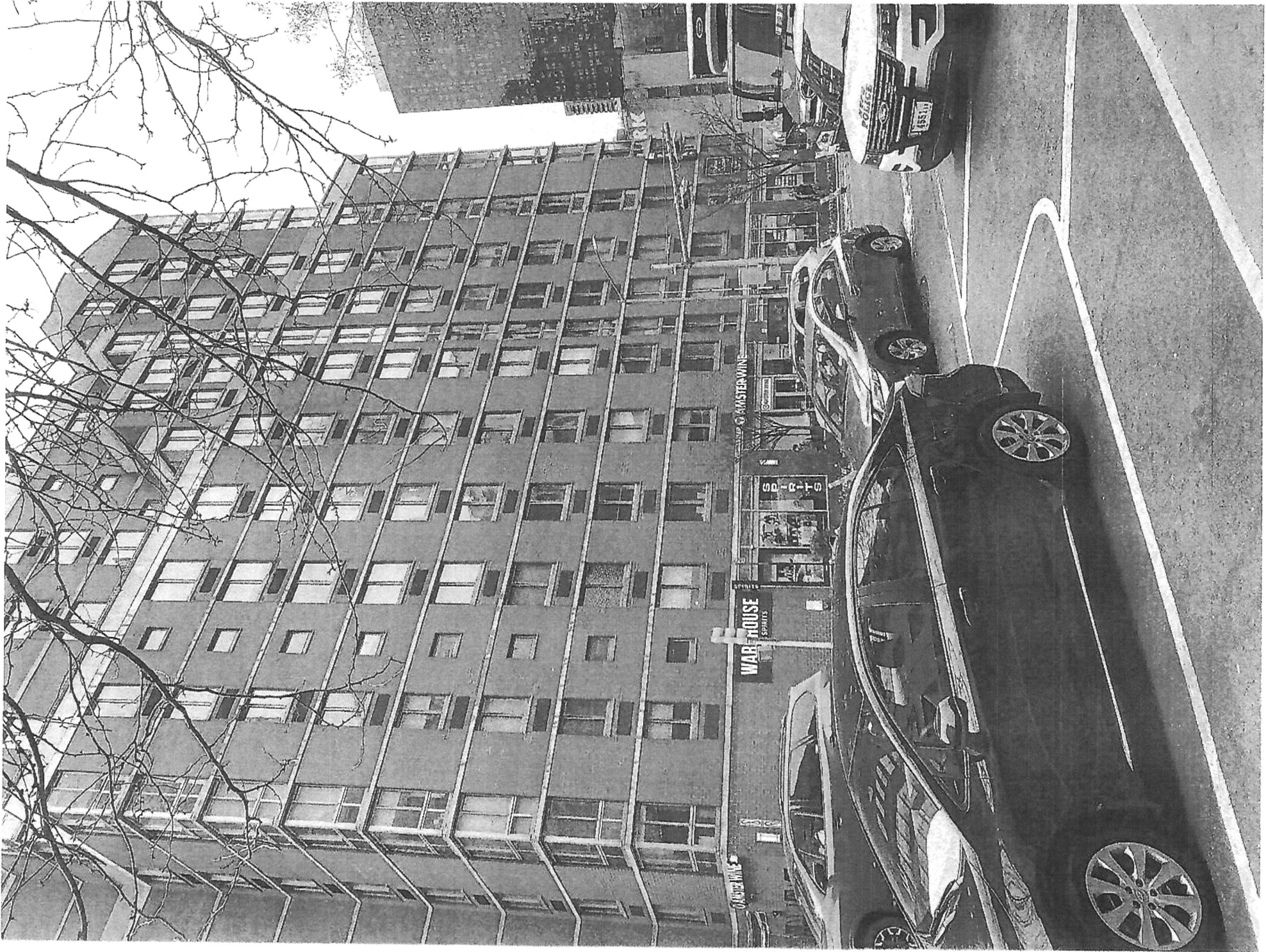

9:18



 Longo Bros · 2 years ago



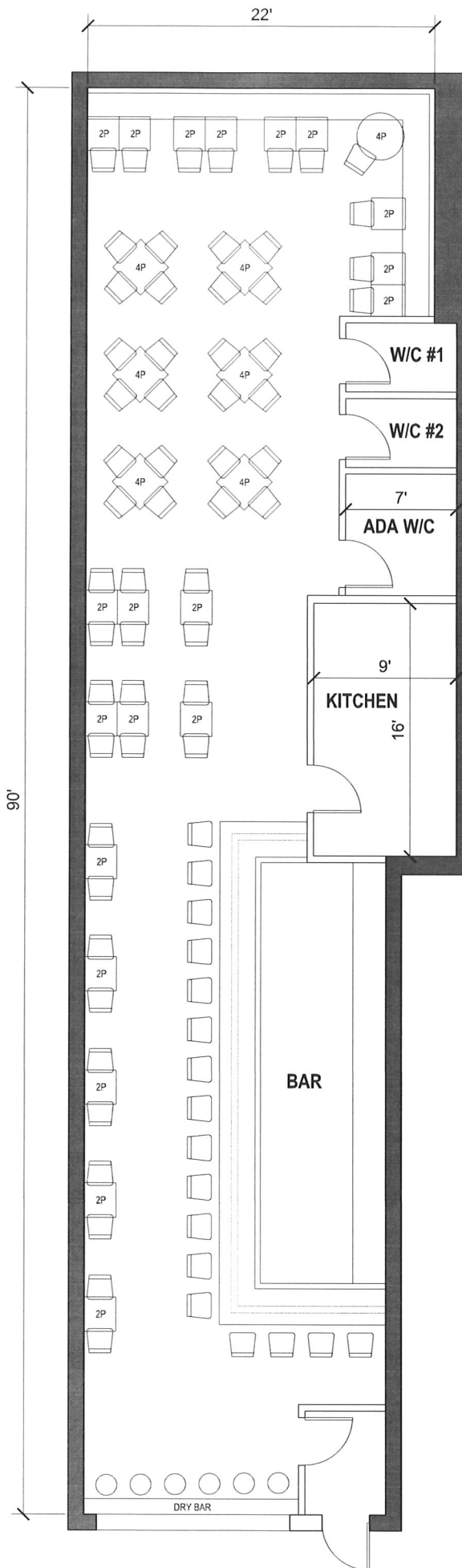

## **Moe & Sal Menu**

Soup du Jour 10  
French Onion Soup 11

### **Appetizers**

Buffalo Wings 18  
Wings tossed in choice of sauce (BBQ, Teriyaki, Hot, Medium, Mild) celery, carrots, blue cheese dressing  
Mozzarella Sticks 16  
Served w/homemade marinara sauce  
Moe & Sals Sample Platter 40  
Wings, mozzarella sticks, Crudite w/ranch & blue cheese, onion rings, tater tots, chicken fingers  
Fried Calamari 18  
Krispy floured squid w/marinara side  
Potato Skins 17  
Stuffed potato skins w/bacon & cheese. Sour cream side  
Quessadilla w/cheese 14  
Add chicken 18 Add veggies 19 Add steak 20 Add Fries 4

### **Salad**

Mediterranean Salad 15  
Mixed greens w/black olives, feta cheese, tomato 'n' olive oil  
Artichoke salad 16  
Mixed greens, artichoke, tomato, cucumber, onion, chopped red apple, grapes  
Meza Luna salad 15  
Mixed greens, dried cranberries, chopped walnuts, blue cheese crumble, tomato  
Add Protien : Chicken 6, steak 9  
Caesar Salad 14  
Chopped romaine lettuce, garlic herb croutons, anchovies, shaved parmesan cheese  
House Salad 10  
w/mixed greens, cherry tomatoes, fried leeks, cucumber, raspberry vinaigrette

### **Mains**

Fish & Chips w/tartar sauce 24  
Shepherds Pie 24  
Chicken Pot Pie 24  
Guinness Beef Stew 26  
Grilled Salmon w/Dijon mustard sauce 28  
Grilled 12 oz New York Strip Steak 38  
Penne a la Vodka w/fresh vegetables 24

**Burgers & Sandwiches served w/Fries or Salad or cup of soup du jour**

Moe & Sals House Burger 19

Hamburger 18

Grilled Cajun Chicken on Baguette 18

Buffalo Chicken Wrap w/lettuce & tomato 18

Grilled Beyond Burger 18

Veggie Burger 18

Grilled Ham & Brie on Baguette 18

Kids Corner 16 (Ages 12 & under)

Includes one small juice & ice cream

Mac 'n' cheese,

Hamburger w/fries

Grilled cheese w/Fries

Mozzarella sticks

Chicken Tenders w/fries

THAI SELECT

Y BUILT  
AURANT  
LEASE  
ntact,  
19 8000

**PUBLIC NOTICE**  
If you are planning to be  
in the area of  
1st St. Avenue  
on 1/15/2020  
1:00 PM - 5:00 PM  
Call 616.221.0778  
See the Special Order and the Public Notice  
for more information. For more information,  
please contact the Michigan State Police  
at 616.221.0778 or visit the Michigan State  
Police website at [www.michigan.gov/dhs](http://www.michigan.gov/dhs).

**BUSINESS HOURS**

Monday	
Tuesday	
Wednesday	
Thursday	
Friday	
Saturday	
Sunday	

Chipotle





April 24, 2024

Ms. Margaret Reilly  
472 Ninth Avenue  
New York, NY 10018

Re: New Bar/Restaurant

Dear Ms. Reilly,

Pursuant to your request, I inspected the above premises on April 22, 2024.

## SUMMARY

**You are opening a bar/restaurant at the above premises. The design of the space and the levels of the sound system will keep sound levels within Noise Code limits. I have provided soundproofing recommendations to prevent transmission of excessive noise to the neighbors.**

## DBA VS ONE-THIRD OCTAVE BAND MUSIC LEVELS

One way that sound levels are often measured uses the "A scale", the A-weighted decibel scale. This dBA scale (see Noise Code Section §24-231 a1) is the most common type of sound measurement, which represents a summation of middle (midrange) and high frequencies (treble), but largely ignores low-frequency "bass" sounds. Measuring the dBA levels requires only a simple sound level meter. DBA is what the City DEP inspectors usually use, and they normally consider anything above 42 dBA to be unreasonable.

C-weighted decibels or dBC (see Noise Code Section §24-231 a3) are also a measurement of all frequencies, but this method includes the important low-frequency "bass" sounds. However, dBC readings pick up so many frequencies at the same time that they usually do not distinguish between normal background noise and music beats.

One-third-octave band sound level readings (see Noise Code Section §24-231 a2) were also taken, which are measured in decibels, or dB. Sounds with frequencies below 250 Hertz are called bass or low frequencies, which sound like thumping or vibration. This range of low frequencies is addressed in the Noise Code regulations and is the sound most likely to cause neighbor complaints. Bass and drums usually cause sounds in these frequency ranges. These sounds require a complex spectrum analyzer to measure them.

## THE NOISE CODE - MUSIC

*§24-231 Commercial music.*

*(a) No person shall make or cause or permit to be made or caused any music originating from or in connection with the operation of any commercial establishment or enterprise when the level of sound attributable to such music, as measured inside any receiving property dwelling unit:*

- (1) is in excess of 42 dB(A) as measured with a sound level meter; or
- (2) is in excess of 45 dB in anyone-third octave band having a center frequency between 63 hertz and 500 hertz (ANSI bands numbers 18 through 27, Inclusive), in accordance with American National Standards Institute standard S1.6-1984; or
- (3) causes a 6 dBC or more increase in the total sound level above the ambient sound level as measured in decibels in the "C" weighting network provided that the ambient sound level is in excess of 62 dBC.

**TEST**

A loud music selection was played in the empty restaurant using a test sound system. The level was 101 dBC, measured in the center of the main room. Sound was then measured in the center of the second-floor apartment, which is directly above the restaurant. The desired maximum level for the restaurant was determined to be approximately 92 dBC.

See the graph below. The sound leakage to the second floor was as high as 64 decibels, which is 19 decibels above the Noise Code 45 decibel limit. Since the maximum desired sound level in the future would be 92 dBC, which is 9 decibels below the test level, the actual maximum sound heard upstairs would be 10 decibels too high. With the sound mitigation measures outlined below, the final sound level will be below the Code limit

**Measured Sound Levels**

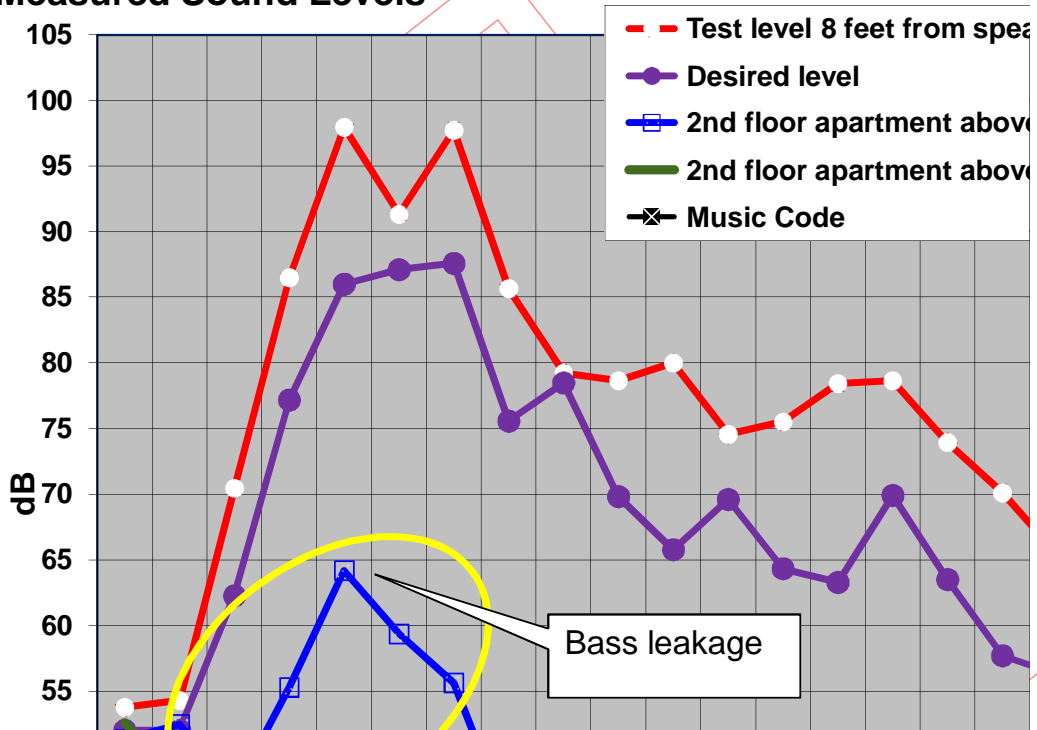



## Measured Sound Levels

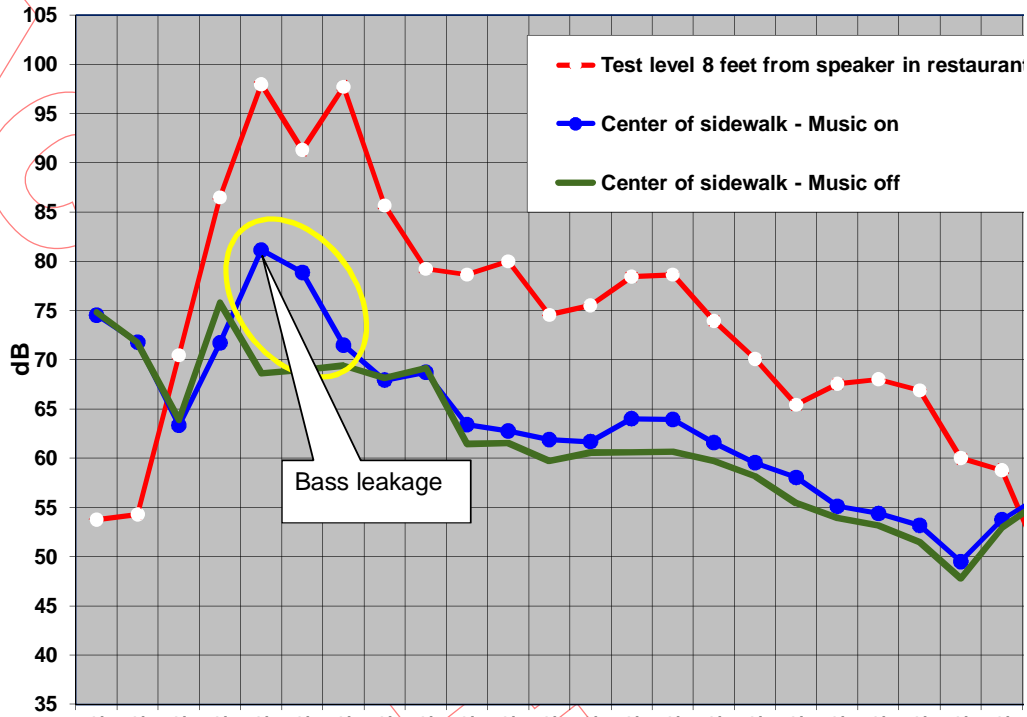

In order to provide an even greater safety margin, the sound system recommendations will include limiting the bass sound level, since that is the most critical part of the sound in this location.

## INSPECTION

There are recessed speakers in the air conditioning/sprinkler soffits. There are also 4 Bose soffit-mounted speakers without any type of shock mounting.

There is an existing Sony receiver powering the sound system.

There has been no history of noise complaints, according to the super and landlord. The upstairs second-floor neighbors were looking forward to the opening.

## RECOMMENDATIONS

### CEILING

1. The existing small speakers should be removed. Seal the holes in the bottom of the soffit with 5/8" sheetrock.

### SOUND SYSTEM

2. The music level must be controlled effectively in the space. Therefore, an important step is to properly design the sound system.
  - a. Distributed speakers are recommended to provide an even sound level

throughout the space without hot spots. The existing small speakers should not be reused.

- b. The sound system should have at least 16 speakers distributed around the restaurant, rather than a few large (and therefore louder) speakers.
  - c. The woofers must not exceed 6" in diameter.
  - d. Small speakers such as Behringer Model 1C-BK, JBL Control 1 or Yamaha NS-AW150 should be used as a distributed system. Data attached.
  - e. Do not use subwoofers.
  - f. The system should be set up in stereo. Stereo sounds louder to the customers without actually increasing the sound that travels upstairs. Alternate the speakers left/right.
  - g. Do not install speakers in any of the back-of-house areas, including the kitchen.
  - h. Hang the speakers from the north brick wall on brackets.
  - i. In the back area, again hang the speakers from the brick walls. Use 4 speakers in this area, which is not underneath the apartment. There is no need to "shock-mount" the speakers.
  - j. Any good commercial stereo power amp of 100 watts per channel or higher, preferably without volume controls, can easily handle all the speakers. A zone control box can be used. Data attached.
  - k. Use #18 gauge zip cord for the low-volume speakers. Do not buy Monster cable.
2. The sound system will incorporate an equalizer. The equalizer will then feed into a limiter. Both functions can be accomplished with a DBX DriveRack PA2 or similar processor, which is a deterrent to volume-abusing employees. Data attached. Installed in the system right before the amplifier and locked with a password, it will prevent the sound system from exceeding a pre-determined sound level, set by the sound installer. If the sound system is turned up too high, the limiter will activate and guarantee that the actual sound never exceeds the desired maximum.
- a. The amplifier has to be set to maximum level during this process so it cannot be turned up further at a later time.
  - b. Using the crossover section, attenuate (lower) all frequencies 125 Hertz and below by setting a high-pass filter on both stereo channels to a cutoff frequency of 125 Hertz and a slope of 12 dB/octave.
  - c. Set the compressor Ratio control to infinity, Over-Easy to off, and the Threshold control so as to normally limit only 3 decibels while playing the loudest possible music. If the music tries to get louder for any reason, the sound will stay at the same volume.
  - d. Using the compressor Output level control, set the sound level to 92 dBC, measured in the center of the restaurant. The sound installer can do this with a simple Radio Shack sound level meter. Set the meter to read "C", and "Slow". This will be a good starting point from which to operate the sound system.
  - e. This unit could be set in conjunction with tests made of noise levels in the apartment.
  - f. To ensure the accuracy of the meter, it can be calibrated at my office.

## DOORS

3. The doors should not be propped open since a small amount of sound will exit onto the sidewalk, which could lead to Noise Code Section 24-244 violations. See below.
  - a. Noise Code Section § 24-244 states,  
*Sound reproduction devices.*
    - (a) *Except as otherwise provided in Section 10-108 of the code, no person shall operate or use or cause to be operated or used any sound reproduction device in such a manner as to create unreasonable noise.*
    - (b) *No person shall operate or use or cause to be operated or used any sound reproduction device, for commercial or business advertising purposes or for the purpose of attracting attention to any performance, show, sale or display of merchandise, in connection with any commercial or business enterprise (including those engaged in the sale of radios, television sets, compact discs or tapes),*
      - (i) *outside or in front of any building, place or premises or in or through any aperture of such building, place or premises, abutting on or adjacent to a public street, park or place...*
  - b. This section is used by inspectors incorrectly. It is intended to prohibit music used for "commercial or business advertising purposes", not for accidental street leakage through the front door. Even though the application of the law is wrong, DEP inspectors often issue these violations without a meter if they hear noise on the sidewalk.

If I can be of further assistance, please call.

It is strongly recommended that all complicated construction projects get regular inspection visits at critical times, to make sure the system performs properly. This is an optional service which I can provide. All Acoustilog, Inc.-designed information supplied is for the original client and may not be copied in any way for different projects by any architect, consultant, engineer or other party. Copyright Acoustilog, Inc. © 2024. All rights reserved. No reproduction of any type permitted without written permission of Acoustilog, Inc.

Yours Truly,

Alan Fierstein



President

[acoustilog1@verizon.net](mailto:acoustilog1@verizon.net)

*All readings re: .0002 microbar and to Code.  
Readings taken with Bruel & Kjaer  
2250/2260/2270 Analyzer, Bruel & Kjaer 4134,  
4135, 4145, 4155, 4165, 4189 or 4190  
Microphone, Acoustilog 232A Reverberation  
Timer. Calibrated to Bruel & Kjaer 4220 Sound  
Source or Quest CA-15.*

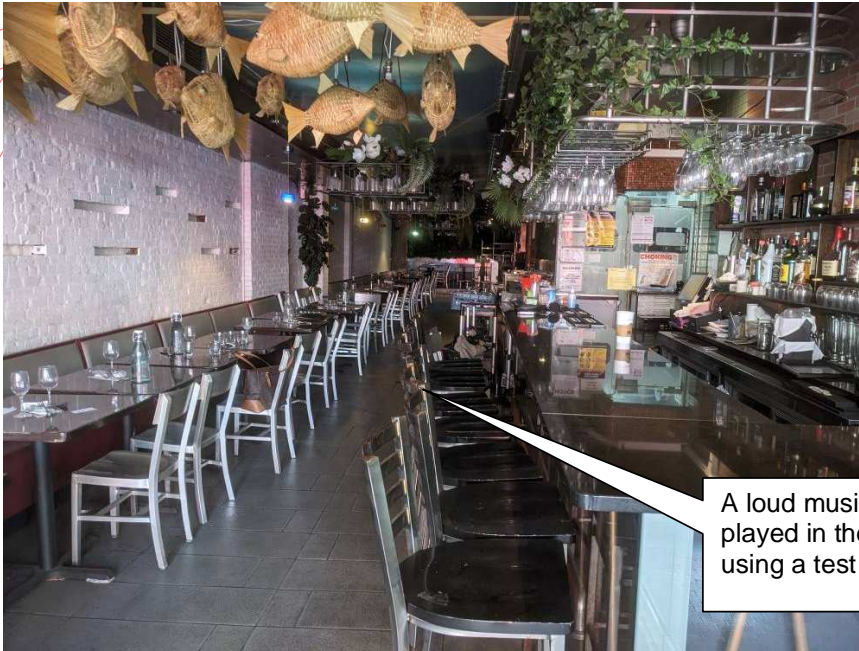

A loud music selection was played in the empty restaurant using a test sound system.



The existing small speakers should be removed.

Seal the holes in the bottom of the soffit where the flush-mounted speakers are being removed. These holes can be patched with 5/8" sheetrock.





Hang the speakers from the north brick wall on brackets.

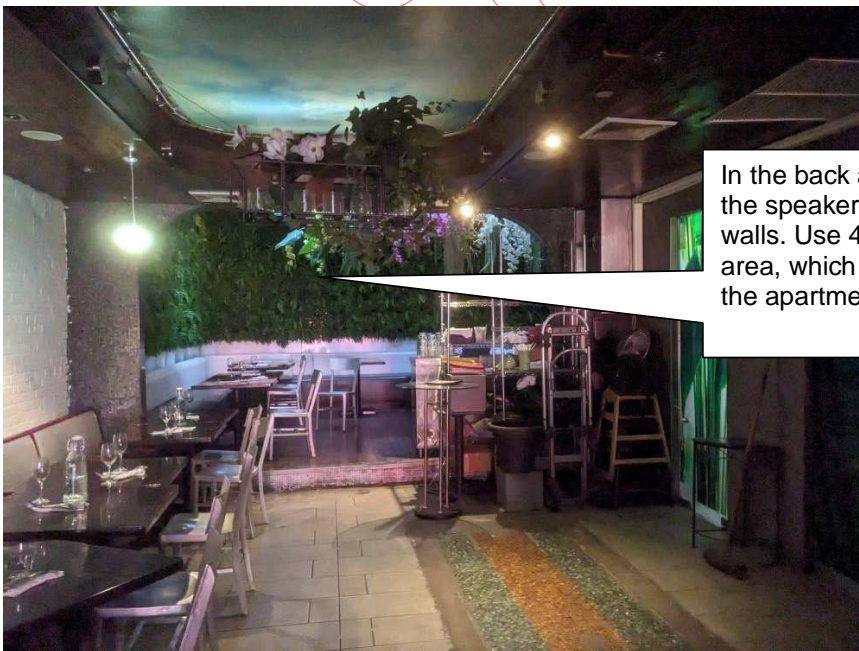

In the back area, again hang the speakers from the brick walls. Use 4 speakers in this area, which is not underneath the apartment.





# Control<sup>®</sup> 1 Pro

Two-Way Professional Compact Loudspeaker System

## Professional Series

### Key Features:

- ▶ 150 Watts Continuous Power Handling
- ▶ Professional Drivers and Crossover Network
- ▶ Included Mounting Bracket
- ▶ Transparent and Faithful Sonic Performance
- ▶ Magnetically Shielded Transducers
- ▶ SonicGuard™ Overload Protection
- ▶ Available in Black or White Finishes

### Applications:

Representing the next-generation in professional high-performance, compact loudspeaker systems, the Control<sup>®</sup> 1 Pro builds on its proud heritage while incorporating the latest innovations in JBL Professional loudspeaker systems design. Featuring proven JBL transducer technologies, the Control 1 Pro is perfect for a wide variety of critical near-field audio applications.

With independent, monitor-grade high and low frequency drivers, the Control 1 Pro's professional crossover network provides steep slopes for exceptional sonic performance and incorporates full-range SonicGuard™ overload protection into the design ensuring network and transducer protection from excessive power surges from the amplifier.

The Control 1 Pro's rugged and durable molded enclosure houses magnetically shielded transducers making it ideal for use with video and computer monitors or other magnetically sensitive equipment. Moreover, the Control 1 Pro's compact design makes it ideal for audio-visual applications, computer workstations, recording and broadcast studios, mobile audio-video control rooms and foreground and background music.

The Control 1 Pro can easily be mounted against a wall or other flat surface with the enclosed brackets or simply used as a bookshelf speaker.



### Specifications:

#### System:

Frequency Range (-10 dB):	80 Hz - 20 kHz
Frequency Response (+/- 3 dB):	100 Hz - 18 kHz
Power Capacity <sup>1</sup> :	150 W
Sensitivity <sup>2</sup> :	87 dB SPL, 1 W 1 m (3.3 ft)
Maximum SPL <sup>3</sup> :	108 dB continuous, 114 dB peak
Directivity Factor (Q) <sup>2</sup> :	6.0
Directivity Index (DI):	7.8 dB
Nominal Impedance:	4 ohms
Crossover Frequency:	4.2 kHz
Overload Protection:	Full-range SonicGuard™ power limiting to protect network and transducers

#### Transducers:

LF Driver:	135 mm (5.25 in) low frequency loudspeaker
HF Driver:	19 mm (.75 in) polycarbonate dome tweeter
Input Connectors:	Spring-loaded terminals

#### Enclosure:

Enclosure Material:	Polypropylene Structural Foam
Finish:	Black (C1Pro) or White (C1Pro-WH)
Dimensions:	235 mm x 159 mm x 143 mm (9.3 in x 6.3 in x 5.6 in)
Net Weight (each):	1.8 kg (4 lb)
Shipping Weight (pair):	4.6 kg (10 lb)
Included Accessories:	Mounting Bracket Assembly

<sup>1</sup>IEC Standard, full bandwidth pink noise with 6 dB crest factor; 2 hour duration.

<sup>2</sup>Average 1 kHz to 10 kHz

<sup>3</sup>Calculated based on power rating and sensitivity, exclusive of power compression.

JBL continually engages in research related to product improvement. Some materials, production methods and design refinements are introduced into existing products without notice as a routine expression of that philosophy. For this reason, any current JBL product may differ in some respect from its published description, but will always equal or exceed the original design specifications unless otherwise stated.

# ▶ Control 1 Pro Two-Way Professional Compact Loudspeaker

## Beamwidth:

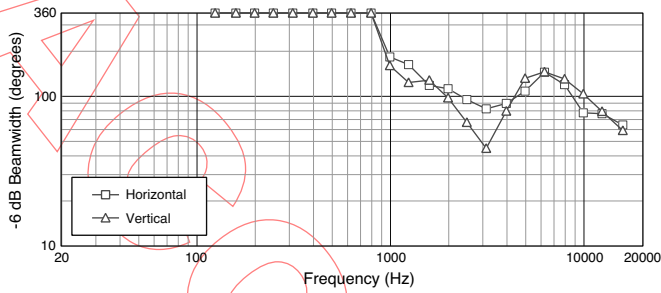

## Directivity Index:

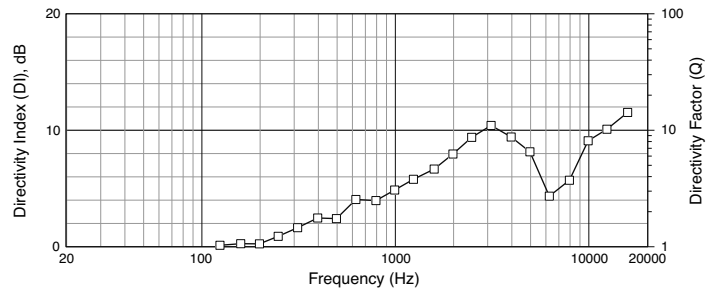

## Frequency Response:

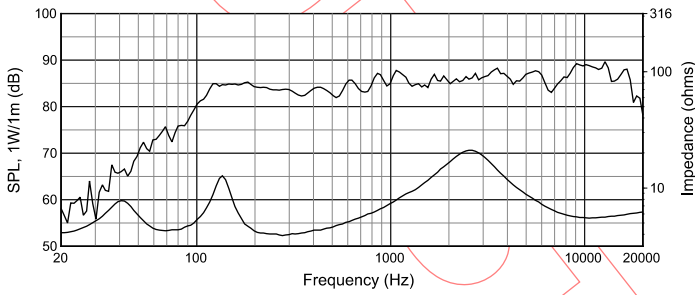

## Horizontal Off-Axis Frequency Response:

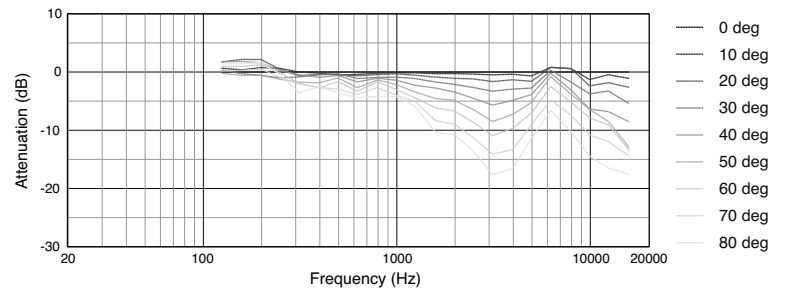

## Dimensions:

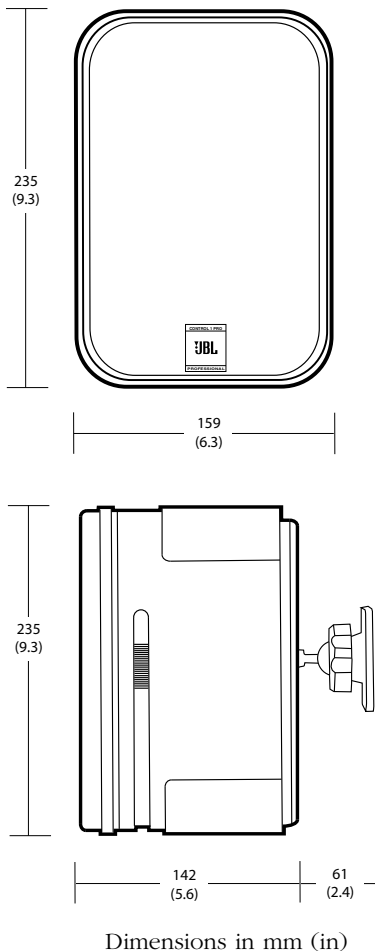

## Mounting Bracket:

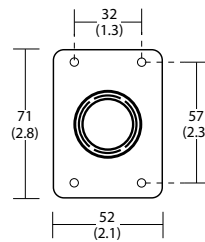
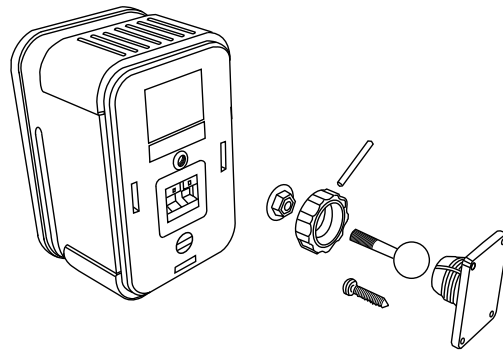

JBL Professional  
8500 Balboa Boulevard, P.O. Box 2200  
Northridge, California 91329 U.S.A.

© Copyright 2014 JBL Professional  
www.jblpro.com

SS C1P  
CRP  
03/14

# Behringer Monitor Speakers 1C-BK - Black

5.5" 100W Passive 2-way Monitor Speakers for Fixed Installation (pair) - Black



## High-precision components deliver incredible sound quality

1C-BK passive monitor speakers derive their massive sound from powerful 5.5" cellulose cone woofers and high-resolution 0.5" tweeters. Built with high-precision components, these speakers exhibit absolute phase linearity, delivering exceptionally clear sound reproduction and excellent frequency response from 60Hz all the way up to 23kHz. On top of that, you won't have to worry about blowing the 1C-BKs' tweeters, thanks to the auto-overload protection that's built into these speakers' low-distortion, phase-optimized crossovers. In other words, these little guys sound great!

## Behringer 1C-BK Passive Monitor Speakers Features:

- Ultra-linear design delivers exceptionally clear sound reproduction and excellent frequency response
- High power handling capabilities provide full-range output with extremely low distortion
- Phase-optimized and high-precision crossovers for absolute phase linearity
- Auto-overload protection prevents tweeter damage and resets automatically
- Solid protective grilles and exceptionally rugged construction for long life and durability
- Brackets for wall/ceiling mounting are included

For stunningly accurate sound and stylish, neo-classic design, look to Behringer 1C-BK passive monitor speakers!

## Tech Specs

<b>Powered</b>	No
<b>LF Driver Size</b>	5.5"
<b>HF Driver Size</b>	0.5"
<b>Power Rating (Program)</b>	25W
<b>Peak Power Capacity</b>	100W
<b>Impedance</b>	4 ohms
<b>Frequency Range</b>	60Hz-23kHz (-10dB)
<b>Crossover Frequency</b>	5000Hz
<b>Maximum Peak SPL</b>	112dB @ 1m





# NS-AW150 Outdoor 2-way Speakers

★★★★☆ 4.4 21 Reviews | [Read Reviews](#)



\$129.95 PR.

FREE Shipping - [Learn More](#)

NS-AW150 Black – Available



Select a color/finish above.

NS-AW150 Black



[<](#) **Overview** [Specs](#) [Downloads](#)

## Product Information

### NS-AW150 Outdoor 2-way Speakers

All-weather speaker system with wide frequency response.

- 5" High Compliance Polypropylene Mica Filled Woofer
- 1/2" PEI Dome Tweeter
- Wide Frequency Response (55 Hz-40 kHz)
- 120 W Maximum Input
- Wall Mounting Bracket Included
- Vertical or Horizontal Placement
- 5-way Binding Post Speaker



# Speaker Selector with Volume Controls for Six Pairs of Speakers

SSVC-6



DESCRIPTION

FEATURES

SPECS

RESOURCES

WARRANTY

## Niles Audio SSVC-6 | FG01044 Features at a Glance

- Power handling: 100 watts per channel RMS; 200 watts peak
- Selectable impedance magnification for 1, 2, 3/4, 5/6 pairs of speakers
- Individual room on/off selector switches
- 12-step controls; 54dB maximum attenuation
- Separate left and right ground paths for compatibility with all amplifiers
- Removable screwless connectors accommodate up to 12-gauge wire
- Rugged all metal chassis construction
- Non skid feet won't scratch furniture and ensure unit stability during operation
- 72 adhesive-backed room identification labels

© 2023 NILES AUDIO



Larger Images

**ALL YOU NEED TO GET THE MOST FROM YOUR PA. NOW WITH COMPLETE CONTROL FROM YOUR MOBILE DEVICE.**

The DriveRack® PA2 provides all the processing you need between your mixer and amplifiers to optimize and protect your loudspeakers. With the latest advancements in dbx's proprietary AutoEQ™ and AFS™ algorithms, a new input delay module for delaying the FOH system to the backline, Ethernet control via an Android®, iOS®, Mac®, or Windows® device, and updated Wizards, the DriveRack PA2 continues the DriveRack legacy of great-sounding, powerful, and affordable loudspeaker management processors, for a whole new generation.



control app for all 4 major OSes

**AUTOEQ™**

New, improved AutoEQ algorithm ensures an extremely accurate, fast, and non-intrusive automatic EQ experience.

With the RTA Mic "listening" to your room, the new, updated DriveRack PA2 AutoEQ algorithm sets speaker levels and room EQ automatically in a matter of seconds. This means room adjustments can now be made very quickly, without subjecting the audience to annoying, lengthy broadcasts of pink noise.

**ENHANCED AFS™ FEEDBACK ELIMINATION**

Enhanced AFS™ algorithm for faster, more precise feedback elimination, without adversely affecting your system's tone.

Nothing turns audiences away like annoying and potentially painful audio feedback. Fortunately, dbx engineers have revisited their already-stellar Advanced Feedback Suppression algorithm and made it work even better. The DriveRack PA2 listens for and anticipates feedback and adjusts speaker output automatically before it even has a chance, while never altering your sound.

**UPDATED WIZARD SETUP FUNCTIONS**

Updated Wizards make initial set up easy, while ensuring speaker tunings and other settings are up-to-date.

Wizard functions on the DriveRack PA2 guide you through easy, step-by-step processes to help you get the most from your loudspeaker system. Helps you easily configure level balancing, AutoEQ, Advanced Feedback Suppression, and provides access to built-in and constantly updating speaker tunings from most major speaker manufacturers.

**AVAILABLE INPUT PROCESSING**

- > dbx Compression
- > AFS™ (Advanced Feedback Suppression)
- > Graphic EQ
- > 8-Band Parametric EQ (adjusted when using the AutoEQ)
- > Subharmonic Synthesis

**AVAILABLE OUTPUT PROCESSING**

- > Crossover (supports full range, 2-way, and 3-way systems)
- > 8-Band Parametric EQs (used for speaker tunings)
- > dbx Limiting
- > Driver Alignment Delays

# DriveRack PA2

Complete Loudspeaker Management System

MSRP ~~\$624.94~~  
**\$399.95**  
 SAVE \$224.99!

Buy It Now

**OVERVIEW**

- VIDEOS
- FEATURES
- MANUALS/DOCUMENTATION
- DOWNLOADS
- SPECIFICATIONS
- NEWS
- SUPPORT/FAQS

f Like 555 t Tweet



## Features

- > All New Setup Wizard
- > Streamlined AutoEQ™
- > All New AFS™ (Advanced Feedback Suppression)
- > Mobile Control (Android®, iOS®, Mac®, Windows®)
- > dbx Compression
- > Graphic EQ
- > 8-Band Parametric EQ (adjusted when using the AutoEQ) Input
- > Subharmonic Synthesis
- > Crossover (supports full range, 2-way, and 3-way systems)
- > 8-Band Parametric EQs (used for speaker tunings) Output
- > dbx Limiting
- > Driver Alignment Delays



PHONE, MIXER  
OR OTHER  
SOUND SOURCE

EQUALIZER

LIMITER  
(STEREO)

AMPLIFIERS/AMPLIFIED  
SPEAKERS  
Volume controls on  
maximum.

NOTE - LIMITER AND EQUALIZER  
FUNCTIONS CAN BE COMBINED IN  
ONE PROCESSOR

NOT TO SCALE. All Acoustilog,  
Inc.-designed information supplied  
is for the original client and may  
not be copied in any way for  
different projects by any architect,  
consultant, engineer or other party.  
Copyright Acoustilog, Inc. © 2022.  
All rights reserved. No reproduction  
of any type permitted without  
written permission of Acoustilog,  
Inc.

INC.

Acoustilog

The screenshot shows the RadioShack website interface. At the top, there's a navigation bar with the RadioShack logo, customer service contact info (24/7 Customer Service, 800-843-7422), a store selector, and language options (Español). There are also links for Store Finder, My Account, and a shopping cart showing 0 items for \$0.00. Below the navigation bar, there are category tabs: Deals, Services, and Weekly Ad. A search bar is present. The main navigation menu includes: CELL PHONES & ACCESSORIES, ELECTRONICS & ACCESSORIES, HOBBY & DO-IT-YOURSELF, BATTERIES & POWER, and SHOP ALL PRODUCTS. A promotional banner for R-CASH offers a \$10 reward for spending \$30. The product page for the Digital Sound Level Meter (Model: Digital 2055) is displayed, featuring a product image, price (\$49.99), a 4-star rating, and an 'ADD TO CART' button. Shipping and service options like 'Free Shipping' and 'Free Ship to Store' are listed. Social media sharing options and a 'FIND IT NEARBY' button are also visible.

## Product Summary

### **Fine-tune your audio.**

Fine-tune your PA or stereo systems audio response to match the acoustic environment with this Digital Sound Level Meter. It comes with a carrying case for travel and features an easy-to-read display.

- Carrying case protects the meter when traveling
- Easy-to-read display, sound range 30-130db, digit LCD display
- You can fine-tune your PA or stereo systems audio response to match the acoustic environment

**Pricing and availability:** Please note that all prices are subject to change without prior notice. Prices advertised on this site are for online orders only. Prices on some items may differ from those advertised in RadioShack stores. All merchandise may not be available at all stores, and all stores may not participate in all sales promotions. We recommend you contact the store to confirm product availability and price.

### **Shipping**

**Usually ships in 1 - 2 business days**

**In store:** [Check availability](#)

By phone: 1-800-843-7422

### **Manufacturer Warranty**

- Parts: 12 month
- Labor: 12 month