

Manhattan Community Board 4

Liquor License/Sidewalk Cafe Stipulations Application

(All Fields Must Be Completed)

CORPORATION NAME		DOING BUSINESS AS (DBA)	
Mogao Management Inc.		The Corner	
STREET ADDRESS		CROSS STREETS	ZIP CODE
698 9th Avenue		West 47th & 48th Street	10036
OWNER <i>(Attach a list of all the people that will be associated/listed with the license)</i>	NAME:	Hao Dong Zhang	NAME: James Wang
	PHONE:	(740)319-2198	PHONE: (212)219-3070
	EMAIL:	lidufan@gmail.com	EMAIL: j.y.wang.ny@gmail.com
MANAGER	NAME:	Du Fan Li	NAME: 698 HK LLC
	PHONE:	(740)319-2198	PHONE:
	EMAIL:	lidufan@gmail.com	EMAIL:
APPLICATION TYPE (<input checked="" type="checkbox"/> <i>Liquor License</i> _____ <i>Unenclosed Sidewalk Cafe</i>)			
<input checked="" type="radio"/> New	Has applicant owned or managed a similar business?		<input checked="" type="radio"/> YES <input type="radio"/> NO
	What is/was the name and address of establishment?		Astraea Management Inc.
	What were the dates applicant was involved with this former premise?		36 E. 8th Street, New York, NY 10003
<input type="radio"/> Corp Change/Class Change/Removal	What is the license # and expiration date?		
	Is applicant making any alterations or operational changes?		<input type="radio"/> YES <input type="radio"/> NO
	If alterations or operational changes are being made, please describe/list all changes.		
<input type="radio"/> Alteration	What is the current license # and expiration date?		
	Please list/describe the nature of all the changes and attach the plans:		
METHOD OF OPERATION			
TYPE OF ALCOHOL	<input checked="" type="radio"/> Liquor/Wine/Beer & Cider <input type="radio"/> Beer & Cider <input type="radio"/> Wine/Beer & Cider		
ESTABLISHMENT TYPE	<input checked="" type="radio"/> Restaurant <input type="radio"/> Cabaret <input type="radio"/> Night Club <input type="radio"/> Hotel <input type="radio"/> Bar/Tavern <input type="radio"/> Catering Establishment <input type="radio"/> Adult Entertainment <input type="radio"/> Wine Bar <input type="radio"/> Dance Club <input type="radio"/> Sports Bar <input type="radio"/> Club (Fraternal Organization – Members Only)		
Has applicant/owner filed with the SLA? If yes, when? If no, when do you plan to file?		<input type="radio"/> YES <input checked="" type="radio"/> NO	after community board meeting
Is the 500 Foot Rule applicable? If yes, please attach a diagram of the On-Premise liquor license establishments within a 500 ft. radius of your establishment and the Public Interest Statement.		<input checked="" type="radio"/> YES <input type="radio"/> NO	
Is the 200 Foot Rule applicable? If yes, please attach a diagram of the schools and houses of worship that trigger the rule.		<input type="radio"/> YES <input checked="" type="radio"/> NO	
Has applicant/owner(s) read MCB4 Policy Regarding Concentration and Location of Alcoholic-Serving Establishments?		<input checked="" type="radio"/> YES <input type="radio"/> NO	

OPERATIONAL DETAILS (*Closing time will be when establishment is vacated of all patrons)

HOURS* <i>(Indoor Only)</i>		MONDAY	TUESDAY	WEDNESDAY	THURSDAY	FRIDAY	SATURDAY	SUNDAY
	Operation	11A-12A	11A-12A	11A-12A	11A-12A	11A-12A	11A-12A	11A-12A
	Kitchen	11A-12A	11A-12A	11A-12A	11A-12A	11A-12A	11A-12A	11A-12A
	Music	11A-10P	11A-10P	11A-10P	11A-10P	11A-10P	11A-10P	11A-10P
If you plan to have music, what type(s)? (Circle all that apply)			<input checked="" type="checkbox"/> BACKGROUND	<input type="checkbox"/> LIVE MUSIC	<input type="checkbox"/> DJ	<input type="checkbox"/> JUKE BOX	<input type="checkbox"/> KARAOKE	

OCCUPANCY

	Capacity (Certificate of Occupancy)	Maximum # of Persons Occupying Premises (Including Employees)	Number of Tables	Number of Seats	Number of Service Only Bars	Number of Stand-Up Bars	Number of Seats at Stand-Up Bar
INSIDE	74	70	15	60	1	0	0
OUTSIDE <i>(Other than sidewalk café)</i>	N/A						
DCA APPROVED UNENCLOSED SIDEWALK CAFÉ	N/A						

How many floors are there? What is the capacity for each floor?	1 floor, 74	
How frequently will the owner(s) be at the establishment?	full time	
Will there be dancing?	YES	<input checked="" type="radio"/> NO
Will applicant have bottle or table service for beverage alcohol?	<input checked="" type="radio"/> YES	NO
Will applicant be hosting private; promotional or corporate events?	YES	<input checked="" type="radio"/> NO
Will outside promoters be used on a regular basis? If yes please describe.	YES	<input checked="" type="radio"/> NO
Will applicant have a security plan? If, yes please attach.	<input checked="" type="radio"/> YES	NO security camera
Will security plan be implemented?	<input checked="" type="radio"/> YES	NO
Will State certified security personnel be used?	YES	<input checked="" type="radio"/> NO
Will New York Nightlife Association and NYPD Best Practices be followed?	<input checked="" type="radio"/> YES	NO
Does applicant agree to notify MCB4 prior to making changes to its method of operation?	<input checked="" type="radio"/> YES	NO
Will applicant be using delivery bicycles? If yes, how many?	YES	<input checked="" type="radio"/> NO Third party delivery
Will delivery bicycles be clearly marked with the name of the restaurant and will staff wear attire clearly noting name as described by NYC Law?	YES	<input checked="" type="radio"/> NO Third party name
Where will delivery bicycles be stored during the day when not in use?	Third party	

MULTIPLE SPACES/FLOORS CAPACITY BREAKDOWN

Space/Floor	Description/Use of Space	Capacity	Hours	# of Tables	# of Seats	# of Service Only Bars	# of Stand-Up Bars/Seats at Bar	Music

LOCATION & ZONING

Is this a Special District? If yes, is it Clinton, West Chelsea or Hudson Yards?	<input checked="" type="radio"/> YES	<input type="radio"/> NO	Clinton
Does the building have a Certificate of Occupancy ("C of O") or a letter of no objection?	<input checked="" type="radio"/> YES	<input type="radio"/> NO	
Is a Public Assembly permit required?	<input type="radio"/> YES	<input checked="" type="radio"/> NO	
Are your plans filed with DOB?	<input type="radio"/> YES	<input checked="" type="radio"/> NO	

Community Notification/Relations

NOTIFICATION: List all block associations; tenant associations, co-op boards or condo boards of residential buildings; and community groups that applicant has notified regarding its application. For each please list both the organization and individual you contacted	# 1	sent email by the listing provide from MCB4		
	# 2			
	# 3			
	# 4			
	# 5			
Please provide dates when applicant met with the groups listed above.		wait the answer from them		
Who was your contact person at each group you met with?				
When did applicant post the notice that was provided?				
Where did applicant post the notice that was provided?				
Will applicant provide owner cell phone number to neighbors and respond to complaints that arise? Please provide number in space provided.		<input checked="" type="radio"/> YES	<input type="radio"/> NO	(740)319-2198
Will applicant inform the Community Board office of its job openings and/or provide a hyperlink to applicants jobs webpage?		<input checked="" type="radio"/> YES	<input type="radio"/> NO	

BUILDING DESIGN			
State the name and type of business previously located in the space.	Qi Restaurant & Bar		
Has a liquor-licensed establishment previously occupied this space at any time? If yes, please provide the name of the business.	<input checked="" type="radio"/> YES	<input type="radio"/> NO	Qi Restaurant & Bar
Do you plan any changes to the existing façade? If yes, please describe.	YES	<input type="radio"/> NO	
Has the applicant/owner(s) read MCB 4 ADA Guidelines Memo?	<input checked="" type="radio"/> YES	<input type="radio"/> NO	
Is the entrance ADA Compliant?	<input checked="" type="radio"/> YES	<input type="radio"/> NO	
Do you plan any changes to the existing façade? If yes, please describe.	YES	<input type="radio"/> NO	
Will applicant have a vestibule within the establishment?	<input checked="" type="radio"/> YES	<input type="radio"/> NO	
Will applicant use a storm enclosure?	<input checked="" type="radio"/> YES	<input checked="" type="radio"/> NO	
Does applicant agree to keep the sidewalk clear of all items or obstructions, such as sandwich boards, sidewalk signs, freestanding menus and plants, as per the law?	<input checked="" type="radio"/> YES	<input type="radio"/> NO	
Will applicant comply with the NYC noise code?	<input checked="" type="radio"/> YES	<input type="radio"/> NO	
Will the establishment have any of the following: (circle all that apply)	FRENCH DOORS	GARAGE DOORS	WINDOWS THAT CAN BE OPENED
Will applicant close all windows, French doors, garage doors when any music or amplified sound (including televisions) is played inside the establishment?	<input checked="" type="radio"/> YES	<input type="radio"/> NO	
Will applicant close all windows, French doors, garage doors by 11 PM Friday and Saturday and 10 PM on all other days even if no music or amplified sound is played inside the establishment?	<input checked="" type="radio"/> YES	<input type="radio"/> NO	
Has applicant obtained an acoustical report from a certified sound engineer to assess potential noise disturbance to the neighboring residents and buildings?	<input checked="" type="radio"/> YES	<input type="radio"/> NO	
Will applicant follow the recommendations of a certified sound engineer to mitigate potential noise disturbance to the neighboring residents and buildings, including placing speakers on the floor of the establishment?	<input checked="" type="radio"/> YES	<input type="radio"/> NO	
Will the kitchen exhaust system extend to the roof?	<input checked="" type="radio"/> YES	<input type="radio"/> NO	
Will the establishment have an illuminated sign?	<input checked="" type="radio"/> YES	<input type="radio"/> NO	
Will the establishment have a canopy extending over the sidewalk?	YES	<input type="radio"/> NO	
Where will the air conditioner be located? What type is it?	Roof		
When was the air conditioner installed?	not sure		

OUTDOOR ITEMS - OTHER THAN SIDEWALK CAFÉ

Has the applicant/owner(s) read MCB 4 Rear Yard Rooftop Policy?	<input checked="" type="radio"/> YES	<input type="radio"/> NO	
Will applicant use any outdoor spaces: rooftop, rear yard, patio, porch, balcony, pavilion, tents, deck, gazebo or open dining in the parking lane? If yes, which one(s)?	<input type="radio"/> YES	<input checked="" type="radio"/> NO	
Are the floorplans for the outdoor space(s) included?	<input type="radio"/> YES	<input type="radio"/> NO	N/A
Will applicant close and vacate the outdoor space(s) by 11PM on Friday & Saturday and 10 PM on all other days?	<input checked="" type="radio"/> YES	<input type="radio"/> NO	
Will the service and consumption of alcohol in any outdoor space only be via seated food service?	<input type="radio"/> YES	<input checked="" type="radio"/> NO	
Will applicant not allow standing space for patrons to drink or smoke in any outdoor space(s) or on the sidewalk?	<input type="radio"/> YES	<input checked="" type="radio"/> NO	
Will there be no amplified music, as per the law?	<input checked="" type="radio"/> YES	<input type="radio"/> NO	
If amplified sound is played inside the establishment, will windows and doors be closed?	<input checked="" type="radio"/> YES	<input type="radio"/> NO	
Will applicant agree to post signs outside asking customers to respect the neighbors'?	<input checked="" type="radio"/> YES	<input type="radio"/> NO	
Will applicant agree to train staff to encourage a peaceful environment?	<input checked="" type="radio"/> YES	<input type="radio"/> NO	
Will applicant provide effective sound control (landscaping enclosure, soundproofing tenants apartments)	<input checked="" type="radio"/> YES	<input type="radio"/> NO	
Will there be a lighting plan that allows safe usage of the outdoor space without disrupting neighbors?	<input checked="" type="radio"/> YES	<input type="radio"/> NO	
If open dining in the parking lane, will applicant agree to leave the sidewalk free of any furniture?	<input checked="" type="radio"/> YES	<input type="radio"/> NO	
If open dining, will you comply with all NYC DOT guidelines?	<input checked="" type="radio"/> YES	<input type="radio"/> NO	
If open dining, will the installation be year-round?	<input type="radio"/> YES	<input type="radio"/> NO	

DCA APPROVED UNENCLOSED SIDEWALK CAFÉ			
Has the applicant/owner(s) read MCB4 Sidewalk Café Policy?	YES	NO	
Will applicant be applying for a sidewalk café now or in the future?	YES	NO	
Is applicant in this application seeking to include a sidewalk café in its liquor license?	YES	NO	
If yes, has applicant submitted an application and plans to NYC Dept. of Consumer Affairs? Please attach application and plans.	YES	NO	
Will applicant close and vacate the sidewalk café by 11 PM on Friday & Saturday and 10 PM on all other days?	YES	NO	
Will applicant be serving alcohol in the sidewalk café? If so, will you have waiter service?	YES	NO	
Will the café have a 3 ft. wide serving aisle running the entire length of the sidewalk cafe?	YES	NO	
Will applicant mark the perimeter of the café on the sidewalk?	YES	NO	
Will the service and consumption of alcohol in the sidewalk café only be via seated food service?	YES	NO	
Will the sidewalk café not provide standing space for drinking or smoking?	YES	NO	
Will applicant use any portable natural gas heaters? If so, do you have the requisite approvals from DOB & the Fire Department?	YES	NO	
Will applicant have a lighting plan that will allow safe usage of the outdoor space without disrupting neighbors?	YES	NO	
Will all furniture, plants and barricades be stored inside between the evening closing hours and the morning opening hours?	YES	NO	
Will all furniture be stored inside between December 21 st and March 21 st , and any other day when it rains or snows?	YES	NO	
Will applicant use umbrellas?	YES	NO	
If construction or construction protection has reduced the sidewalk width, will applicant always maintain an 8 foot clear path of sidewalk between the perimeter of the café and the closest obstruction including construction barricades?	YES	NO	
If open dining is in the parking lane, will applicant agree to remove its sidewalk café?	YES	NO	

ADDITIONAL STIPULATIONS: (Office Use Only)

To the extent any additional stipulation on pages 7 and 8 of this application conflicts with any response on pages 1 – 6 of this application, the stipulations on pages 7 and 8 control.

To the extent any additional stipulation on pages 7 and 8 of this application conflicts with any response on pages 1 – 6 of this application, the stipulations on pages 7 and 8 control.

Manhattan Community Board 4 (MCB4) recommends:
 (MCB4's recommendation is based on a vote taken at its
 April 4, 2023 full board meeting, with 36 members voting in favor
 of the recommendation, 0 members opposed, 0 members
 abstaining and 0 present but not eligible)

Denial unless all stipulations agreed to by applicant/owner are part of the method of operation
 Denial Approval

CB4 REPRESENTATIVES

 Nelly Gonzalez CB4 Assistant District Manager	 Frank Holozubiec CB4 BLP Committee Co-Chair	 Burt Lizarin CB4 BLP Committee Co-Chair
--	--	--

APPLICANT AGREEMENT WITH THE COMMUNITY

Applicant agrees to these stipulations as the basis for the community support of this application and acknowledges that all of these stipulations are essential prerequisites to the MCB4 recommendation regarding this application. Applicant agrees to have these stipulations incorporated in the method of operation of its liquor license. The stipulations in this application constitute the entire agreement between MCB4 and applicant and may only be altered in writing signed by MCB4 and applicant. These stipulations supersede any oral statements or representations in connection with this application.

<p>SIGN HERE →</p>	<p>Hao Dong Zhang</p> <p>PRINT NAME OF APPLICANT</p>	 <p>SIGNATURE OF APPLICANT</p>	<p>03/07/2023</p> <p>DATE</p>
---------------------------	---	--	--------------------------------------

3 EXISTING HOST TABLE TO BE REMOVE

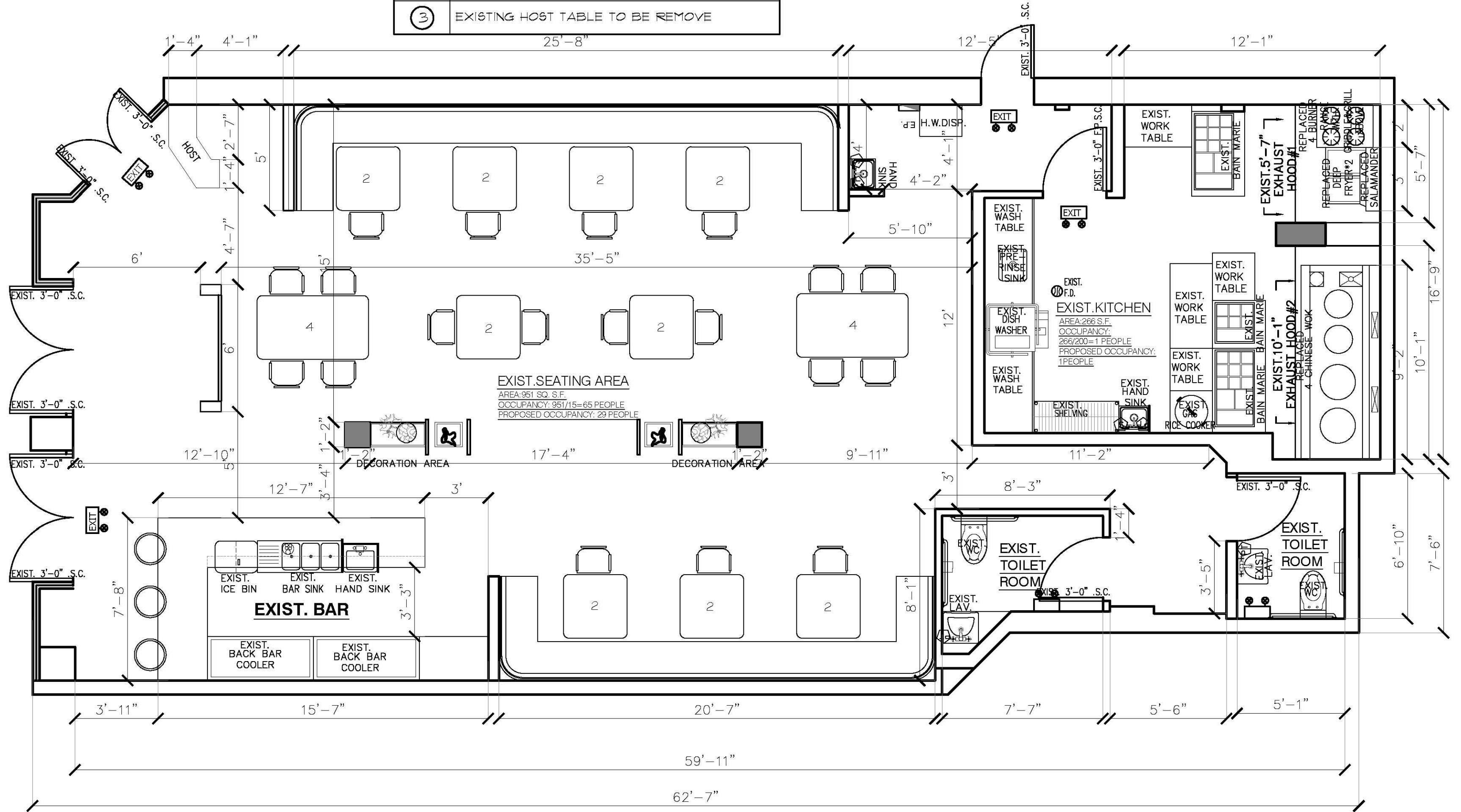

PROPOSED 1ST FLOOR PLAN

SCALE: 1/4" = 1'-0"



KATHY HOCHUL
Governor

LILY M. FAN
Commissioner

VINCENT G. BRADLEY
Chairman

GREELEY FORD
Commissioner

PUBLIC INTEREST QUESTIONNAIRE
(FOR APPLICATIONS SUBJECT TO THE 500 FOOT LAW)
(revised 12/31/21)

Applicant's Name: Mogao Management Inc.

Applicant's DBA/trade name:

Applicant's Serial Number:

Address of Applicant's Premises

Street Number & Name: 698 9th Avenue

City: New York
Zip Code: 10036

PLEASE READ THE FOLLOWING CAREFULLY BEFORE COMPLETING THE QUESTIONNAIRE.

- This questionnaire must be submitted. Do not use any version other than the 12/31/21 revised form. No other document that an applicant submits will be accepted as a substitute. If needed, the applicant can attach supplemental pages to the questionnaire. Additional pages should be signed and dated by the person submitting the questionnaire.
- The information provided in this questionnaire must be consistent with the information provided in the application. If upon review the Authority determines that the applicant submitted conflicting or contrary information, the application will be subject to disapproval or, if the license has already been issued, the licensee will be subject to disciplinary action.
- The information provided in this questionnaire, as well as the information provided in the application, must also be consistent with the information provided in the notice that must be sent to the municipality 30 days before the application is filed. If the information sent to the municipality differs in any way from what was provided by the applicant, the applicant must identify those differences when completing this questionnaire.
- The Administrative Law Judge assigned to the application will not have a copy of the application as part of the record. The Administrative Law Judge will only have the material received by the deadline for submissions. Applicants should, therefore, answer the questionnaire as completely and thoroughly as possible.

Questions

General location of proposed licensed premises

1. In what city, town or village is the proposed licensed premises located? (For the City of New York, please identify the Community Board)

City/ Town/ Village/ Community Board: Manhattan Community Board 4

County: New York

2. How many establishments with On-Premises Liquor licenses are located within a 500- foot radius of the proposed licensed premises?

24

3. Of those establishments, how many can best be described as:

Restaurant? 15

Tavern/bar? 9

Hotel? _____

Catering hall? -

Nightclub? -

Adult entertainment venue? _____

Other? _____

4. The area surrounding the proposed licensed premises is best described as (check only one):

Residential? _____

Commercial? _____

Mixed residential/commercial X

Description of proposed licensed premises and method of operation

5. What type of business (restaurant, tavern/bar, nightclub, catering hall, etc.) will the applicant be operating?

Restaurant

6. In what type of building (single occupant, multi-unit, mixed-use, etc.) will the proposed licensed premises be located and how many floors does the building have?

Multi-unit

Public Interest Questionnaire

Serial #: _____

Page 3 of 7

7. Are there residents living above, below, or adjacent to the proposed licensed premises? If so, have they been contacted by the applicant, and is the applicant aware of whether they support or oppose this application?

Yes

8. How many floors will the proposed licensed premises occupy?

1

9. What is the maximum occupancy of the proposed licensed premises (interior space only)?

74

10. How large (in square feet) is the proposed licensed premises (interior space only)?

1500 sf

11. How many tables (for patrons) will be in the proposed licensed premises (interior space only)?

11

12. How many seats (total) will be at the tables (interior space only)?

36

13. How many customer bars will be in the proposed licensed premises (interior space only)?

1

14. How many seats will be at the customer bars (interior space only)?

3

15. Will the proposed licensed premises have a full restaurant menu or a limited tavern menu?

Full restaurant menu

16. Will the applicant have security and, if so, how many security personnel will be used?

No

Public Interest Questionnaire

Serial #: _____

Page 4 of 7

17. Will the applicant have recorded (background, no DJs or Juke Box) music?

Yes

18. Will the applicant have live music?

No

19. Will the applicant have DJs?

No

20. Will the applicant have a Juke Box?

No

21. Will the applicant have karaoke?

No

22. If the applicant will have music, how will it control the noise volume?

Door and windows kept closed all time and lower speaker volume.

23. Will the applicant allow patron dancing?

No

24. Will the applicant have employee/staff dancing and, if there is dancing will it include topless or exotic dancing (such as pole or lap dancing)?

No

25. Will the applicant use the services of a promoter?

No

26. Will the applicant rent out part, or all, of the premises for private events (Not applicable to catering establishments)? If so, how many times a year will the premises be rented out?

No

Public Interest Questionnaire

Serial #: _____

Page 5 of 7

27. Does the applicant have an agreement in place with its municipality regarding the operation of the proposed licensed premises? If so, a copy of the agreement must be provided with this questionnaire.

Yes

28. If there is no agreement in place, has the applicant met with the municipality and is the applicant aware of the municipality's position regarding this application?

Support

29. What are the applicant's hours of operation?

11AM-12AM, seven days a week

30. Will the applicant be using any outside areas (including but not limited to sidewalk cafes, patios, decks, yards, etc.)? If so, please describe, including where the area is and the square footage, number of tables/ seats/ customer bars, hours of operation for outside service, etc.

No

31. Does the applicant intend to operate with any doors or windows kept open? If so, please describe and indicate the hours that the doors or windows will be kept open.

No

32. Is the applicant currently operating under a temporary retail permit?

Yes, only serve beer & wine with TP base on a restaurant wine application-1355142

33. Other than the liquor license, are there any required government approvals, permits, etc., that have not yet been obtained by the applicant to operate the proposed licensed premises?

No

34. Was the proposed licensed premises licensed in the past? If so, please identify the prior licensee and disclose any adverse disciplinary history, if known.

No

35. Is the proposed licensed premises currently licensed? If so, please identify the current licensee and disclose any adverse disciplinary history, if known.

No

Public Interest Questionnaire

Serial #: _____

Page 6 of 7

36. If the proposed licensed premises was, or is currently licensed, briefly describe the prior licensee's method of operation, if known.

Restaurant

37. If the proposed licensed premises has an adverse, disciplinary history, what actions will the applicant take to prevent future violations?

No adverse, disciplinary history.

38. Is the applicant currently operating at the proposed licensed premises without alcoholic beverage sales?

No, Operating with temporyt permit 1355142 (beer & wine)

39. Does the applicant have parking available for its patrons? Please describe the type of parking, if any.

Street parking

Information concerning the applicant

40. Has the applicant, or any of its principals, or proposed managers, ever held, or currently hold, a license to sell alcoholic beverages? If so, please identify those licenses.

No

41. Has the applicant, or any of its principals, or proposed managers, ever had a license cancelled or revoked by the Authority?

No

42. Does the applicant, or any of its principals, or proposed managers, have any other adverse disciplinary history with the Authority?

No

43. Does the applicant, or any of its principals, or proposed managers, have any other experience operating, supervising or working at a business licensed to sell alcoholic beverages? If so, please explain.

Yes, S/N 1342174, Astraea Management Inc.

Additional information regarding Public Interest

44. Please explain the impact that the proposed licensed premises will have on vehicle and pedestrian traffic in the area.

We will not be negatively veicular or pedestrian traffic in the area.
We also do not expect to impact pedestrian traffic. We do not foresee drawing huge crowd that would overwhelm the area. There is no outdoor seating.
In event the premise gets on vehicle or pedestrian traffic in the area, one employee will help crowd control/management.

45. Please explain the impact that the proposed licensed premises will have on the noise level in the area.

We will not negatively the noise level in the area. The premise is a restaurant and background music will only be played with the doors and windows kept closed.

46. Are there any other reasons to support a finding that issuing this license is in the public interest? Please be as specific as possible.

The principal holds Restaurant Wine licenses more than 1 year. Although there are 24 establishemnts within a 500 feet radius that serve alcoholic drinks, those restaurants are very different in style.

The applicant acknowledges that the Authority will rely on the representations made in this questionnaire. By signing and submitting this questionnaire, the applicant acknowledges that any false statement or misrepresentation herein will constitute cause for the disapproval of the application or disciplinary action against the applicant's license if the application is approved, including the possibility of revocation or cancellation of the license.

Please print the name of the applicant/ applicant's principal signing this questionnaire:

Signature of applicant/ applicant's principal

03/07/2023
Date

James Wang

Please print the name of applicant's attorney/representative, if any

Signature of applicant's attorney/representative

03/07/2023
Date

THE CHINESE FOOD CORNER



the lioner



the lioner

終之
戀

010 21000

010 21000



THE

CHINESE
FOOD



CORNER

THE CHINESE FOOD CORNER

Menu



The Corner Chinese restaurant may be located on a busy street, but it is far from your typical “corner” restaurant. The moment you step through the door, you are transported to a world of authentic Chinese cuisine and culture.

What sets us apart is our dedication to using only the freshest ingredients and traditional cooking methods. From the succulent Peking imperial to the our decadent west lake beef soup, every dish is made with care and attention to detail. Our chefs are skilled in the art of Chinese cuisine and create dishes that are both delicious and visually stunning.

We take pride in our extensive menu, which offers a wide variety of dishes from different regions of China. Whether you are in the mood for something a bit savory or spicy, we have something for everyone.

At The Corner, we also believe in providing an immersive dining experience.

So next time you're in the mood for Chinese food, skip the average “corner” restaurant and come experience The Corner. You won't be disappointed.





Soups and Starters

 Hot and Sour Soup 酸辣汤	4
Wonton Soup 上海馄饨	5
West Lake Beef Soup 西湖牛肉羹	13
Filet Mignon Egg Roll (1) 牛里脊肉春卷	6
Peking Duck Egg Rolls (2) 烤鸭春卷	14
Shanghai Shrimp Rolls (2) 上海虾卷	6
Vegetable Spring Rolls(2) 素春卷	5
  Peppercorn Calamari 椒盐鲜鱿	12
Pan fried Vegetable or Pork Dumplings (5) 白菜猪肉/素菜饺	12
Chicken Soong in Lettuce Wraps (4) 鸡松	16
 Spicy Rock Shrimp w. Scallion Pancakes 辣味虾葱油饼	19
 Sichuan Hot & Spicy Dumpling (4) 红油抄手	8
Skewered Chicken and Steak (3) 鸡肉牛肉串	12
  Crispy Peppercorn Chicken Wings (6) 椒盐鸡翅	15
 Spicy Crispy Shredded Beef 辣脆牛肉丝	16

Please be aware that not all ingredients are listed. Please inform us of any food allergies or dietary restrictions and our chefs will be happy to accommodate you. Consuming raw or undercooked meats, poultry, seafood, shellfish or eggs may increase your risk of foodborne illness. Prices are subject to change without notice. 20% gratuity will be added to party of 6 or more.

Seafood

Walnut Shrimp 核桃大虾 \$28

Crispy giant prawns quick-fried in our Grand Marnier sauce. Served with honey glazed walnuts.

Jumbo Shrimp with Lobster Sauce 虾龙糊 \$28

Jumbo prawns stir fried and served with a chicken and eggs broth-based sauce.

Seared Ahi Tuna over Mesclun Salad 吞拿鱼沙拉 \$24

Seared Tuna Tataki with peppercorn crust, wasabi sesame crème on a bed of mustard & soy Mesclun salad.

Jumbo Shrimp with Homemade Sesame Sauce 芝麻虾 \$28

Giant prawns battered and glazed with our homemade sesame sauce.

Sichuan Boiled Fish 水煮鱼片 \$26

Tilapia fillet and vegetables seasoned with our homemade spicy Szechuan sauce.

Peking Imperial 双喜 MP

Live Maine lobster accompanied by filet mignon. The ultimate surf and turf entrée.

Cumin Fish Fillet 孜然鱼片 \$24

Tender fish fillet quick fried, then topped with cumin and garlic.

Live Lobster 龙虾 MP

W/Scallion & ginger or Peppercorn sauce.
1½ Lbs. or 3¼ Lbs.

Wok Sauteed Medallions of Sole 脆炸鱼船 \$32

Sole Medallions sautéed in a light Rice Wine Sauce, with ginger, garlic, and Shao Xing wine, Presented in an edible "Sole Boat".



Meat

Crisped Steak with a Tangy Tangerine Peel Sauce 陈皮牛柳 \$26

Tender steak coated in a tangerine garlic-ginger sauce.

🌶️ Chung King Beef 重庆牛柳 \$24

Wok seared chunks of filet mignon and mushrooms on a bed of fresh spinach.

Beef with Broccoli 芥兰牛肉片 \$18

Flank steak stir-fried with broccoli and seasoned with our famous brown sauce.

🌶️ Sizzling Black Pepper Filet Mignon 铁板黑椒牛柳 \$26

Filet mignon with stir-fried onions and mushrooms.

The Corner's Three Delights 铁板三鲜(鸡牛虾) \$28

One of our most popular entrees! Sautéed chicken, beef, and shrimp with fresh seasonal vegetables in a hearty garlic sauce served on a sizzling skillet.

Crispy Sweet and Sour Pork 锅包肉 \$24

Battered Pork is fried to a golden crisp and smothered in a sweet and sour sauce.

Desert Lamb Chops 沙漠羊排 \$36

Grass-fed lamb chops lightly fried until crispy, then stir fried with chopped peppers in a cumin sauce.

Ishiyaki Stone Filet Mignon 桂花石烹牛柳 \$38

Melt-in-your-mouth filet mignon cooked table-side on a heated Ishiyaki grilling stone and served with Asian vegetables on the side. This dish is as decadent as it sounds!

🌶️ Boiled Beef 水煮牛肉片 \$24

Tender flank steak and vegetables seasoned with our homemade spicy Szechuan sauce.

Please be aware that not all ingredients are listed. Please inform us of any food allergies or dietary restrictions and our chefs will be happy to accommodate you. Consuming raw or undercooked meats, poultry, seafood, shellfish or eggs may increase your risk of foodborne illness. Prices are subject to change without notice. 20% gratuity will be added to party of 6 or more.

Poultry

🌶️ Chicken Imperial 左宗鸡球 \$18

The secret recipe stolen by General Tso.

🌿 Sesame Chicken 芝麻鸡球 \$18

Chicken breast is flash-fried and glazed with a sweet and tangy sauce.

Chicken with Broccoli 芥兰鸡片 \$18

Touted as “The best Chicken with Broccoli ever” by critics and guests alike.

🌶️ 🌿 Crispy Peppercorn Chicken 椒盐鸡沙拉 \$19

Crispy peppercorn chicken tenders over a bed of organic salad greens.

Kung Pao Cashew Chicken 宫保腰果鸡 \$19

Stir-fried tender chunks of chicken & crunchy cashews in a spicy sauce.

🌿 Sweet and Sour Pineapple Chicken 菠萝鸡块 \$22

Our hand sourced Chicken is Sautéed with the sweetest Hawaiian Gold pineapples.

Crispy Duck with Chow fun in Hoisin Sauce 脆皮鸭河粉 \$26

Lightly crispy Long Island duck served over fresh chow fun sautéed in our homemade hoisin sauce.

🌶️ Crispy Chicken W. Magic Chili 脆椒鸡丁 \$22

Sichuan chili chicken pieces fried with edible magic chili.



Vegetables

GF Sautéed Baby Bok Choy 上海苗 \$14

Sautéed Assorted Vegetables 罗汉斋 \$15

Dry Sautéed String Beans 干煸四季豆 \$14

Sizzling Tofu 铁板豆腐 \$16

Basil, mushrooms, and various vegetables.

🌶️ Baby Eggplant with our Homemade Garlic Sauce 鱼香茄子 \$15

🌶️ Vegetarian Imperial 素左鸡 \$19

Homemade veggie patties stir-fried in a tangy sweet sauce.

🌶️ Ma-Po Tofu 麻婆豆腐 \$15

A traditional dish bursting with Sichuan spices • Add ground chicken or pork \$3.00

Fried Rice and Pastas

Corner Fried Rice 本楼炒饭 \$16

Fried rice with a combination of shrimp, pork, chicken, and fresh vegetables.

Fried Rice with Beef, Pork, Chicken, Shrimp or Vegetables 炒饭 \$13

Lo Mein with Beef, Pork, Chicken, Shrimp or Vegetables 捞面 \$13

Angel Hair Rice Pasta with Beef, Pork, Chicken, Shrimp or Vegetables 米粉 \$14

With or without curry

Pineapple Fried Rice 菠萝炒饭 \$16

Chow-Fun Noodles 河粉 \$16

Sautéed with chicken, beef, or shrimp.

Please be aware that not all ingredients are listed. Please inform us of any food allergies or dietary restrictions and our chefs will be happy to accommodate you. Consuming raw or undercooked meats, poultry, seafood, shellfish or eggs may increase your risk of foodborne illness. Prices are subject to change without notice. 20% gratuity will be added to party of 6 or more.

Lunch Entrees

Monday - Friday 12:00 - 2:30PM, excluding Holidays

All lunch entrees are served with white or brown rice, and your choice of Soup.

\$12

🌶️ Chicken Imperial 左宗鸡球

Chicken and Broccoli 芥蓝鸡片

GF Sesame Chicken 芝麻鸡球

GF Pineapple Chicken 菠萝鸡块

\$14

🌶️ Crispy Tangerine Steak 陈皮牛柳

Pepper Steak 青椒牛肉丝

Beef and Broccoli 芥蓝牛肉片

Shredded Pork in Szechuan Sauce 鱼香肉丝

\$16

Shrimp with Lobster Sauce 虾龙糊

GF Sesame Shrimp 芝麻大虾

🌶️ Crispy Shrimp with Tangerine Peel 陈皮大虾

Velvet Shrimp 芙蓉虾



Menu

Soups and Starters

Hot and Sour Soup 酸辣汤	4
Wonton Soup 上海馄饨	5
West Lake Beef Soup 西湖牛肉羹	13
Filet Mignon Egg Roll (1) 牛里脊肉春卷	6
Peking Duck Egg Rolls (2) 烤鸭春卷	14
Shanghai Shrimp Rolls (2) 上海虾卷	6
Vegetable Spring Rolls(2) 素春卷	5
Peppercorn Calamari 椒盐鲜鱿	12
Pan fried Vegetable or Pork Dumplings (5) 白菜猪肉/素菜饺	12
Chicken Soong in Lettuce Wraps (4) 鸡松	16
Spicy Rock Shrimp w. Scallion Pancakes 辣味虾葱油饼	19
Sichuan Hot & Spicy Dumpling (4) 红油抄手	8
Skewered Chicken and Steak (3) 鸡肉牛肉串	12
Crispy Peppercorn Chicken Wings (6) 椒盐鸡翅	15
Spicy Crispy Shredded Beef 辣脆牛肉丝	16

Please be aware that not all ingredients are listed. Please inform us of any food allergies or dietary restrictions and our chefs will be happy to accommodate you.

Seafood

Walnut Shrimp 核桃大虾 \$28	Crispy giant prawns quick-fried in our Grand Marnier sauce. Served with honey glazed walnuts.
Jumbo Shrimp with Lobster Sauce 虾龙糊 \$28	Jumbo prawns stir fried and served with a chicken and eggs broth-based sauce.
Seared Ahi Tuna over Mesclun Salad 吞拿鱼沙拉 \$24	Seared Tuna Tataki with peppercorn crust, wasabi sesame crème on a bed of mustard & soy Mesclun salad.
Jumbo Shrimp with Homemade Sesame Sauce 芝麻大虾 \$28	Giant prawns battered and glazed with our homemade sesame sauce.
Sichuan Boiled Fish 水煮鱼片 \$26	Tilapia fillet and vegetables seasoned with our homemade spicy Szechuan sauce.
Peking Imperial 双喜 MP	Live Maine lobster accompanied by filet mignon. The ultimate surf and turf entrée.
Cumin Fish Fillet 孜然鱼片 \$24	Tender fish fillet quick fried, then topped with cumin and garlic.
Live Lobster 龙虾 MP	W/Scallion & ginger or Peppercorn sauce. 1½ Lbs. or ¾ Lbs.
Wok Sautéed Medallions of Sole 脆炸鱼船 \$32	Sole Medallions sautéed in a light Rice Wine Sauce, with ginger, garlic, and Shao Xing wine, Presented in an edible "Sole Boat".

Consuming raw or undercooked meats, poultry, seafood, shellfish, or eggs may increase your risk of foodborne illness.

Meat

Crisped Steak with a Tangy Tangerine Peel Sauce 陈皮牛柳 \$26	Tender steak coated in a tangerine garlic-ginger sauce.
Chung King Beef 重庆牛柳 \$24	Wok seared chunks of filet mignon and mushrooms on a bed of fresh spinach.
Beef with Broccoli 芥兰牛肉片 \$18	Flank steak stir-fried with broccoli and seasoned with our famous brown sauce.
Sizzling Black Pepper Filet Mignon 铁板黑椒牛柳 \$26	Filet mignon with stir-fried onions and mushrooms.
The Corner's Three Delights 铁板三鲜(鸡牛虾) \$28	One of our most popular entrees! Sauteed chicken, beef, and shrimp with fresh seasonal vegetables in a hearty garlic sauce served on a sizzling skillet.
Crispy Sweet and Sour Pork 锅包肉 \$24	Battered Pork is fried to a golden crisp and smothered in a sweet and sour sauce.
Desert Lamb Chops 沙漠羊排 \$36	Grass-fed lamb chops lightly fried until crispy, then stir fried with chopped peppers in a cumin sauce.
Ishiyaki Stone Filet Mignon 桂花石烹牛柳 \$38	Melt-in-your-mouth filet mignon cooked table-side on a heated Ishiyaki grilling stone and served with Asian vegetables on the side. This dish is as decadent as it sounds!
Boiled Beef 水煮牛肉片 \$24	Tender flank steak and vegetables seasoned with our homemade spicy Szechuan sauce.



Poultry

Chicken Imperial 左宗鸡球 \$18

The secret recipe stolen by General Tso.

Sesame Chicken 芝麻鸡球 \$18

Chicken breast is flash-fried and glazed with a sweet and tangy sauce.

Chicken with Broccoli 芥兰鸡片 \$18

Touted as “The best Chicken with Broccoli ever” by critics and guests alike.

Crispy Peppercorn Chicken 椒盐鸡沙拉 \$19

Crispy peppercorn chicken tenders over a bed of organic salad greens.

Kung Pao Cashew Chicken 宫保腰果鸡 \$19

Stir-fried tender chunks of chicken & crunchy cashews in a spicy sauce.

Sweet and Sour Pineapple Chicken 菠萝鸡 \$22

Our hand sourced Chicken is Sautéed with the sweetest Hawaiian Gold pineapples.

Crispy Duck with Chow fun in Hoisin Sauce 脆皮鸭河粉 \$26

Lightly crispy Long Island duck served over fresh chow fun sautéed in our homemade hoisin sauce.

Crispy Chicken W. Magic Chili 脆椒鸡丁 \$22

Sichuan chili chicken pieces fried with edible magic chili.

Vegetables

Sautéed Baby Bok Choy 上海苗 \$14

Sautéed Assorted Vegetables 罗汉斋 \$15

Dry Sautéed String Beans 干煸四季豆 \$14

Sizzling Tofu 铁板豆腐 \$16

Basil, mushrooms, and various vegetables.

Baby Eggplant with our Homemade Garlic Sauce 鱼香茄子 \$15

Vegetarian Imperial 素左鸡 \$19

Homemade veggie patties stir-fried in a tangy sweet sauce.

Ma-Po Tofu 麻婆豆腐 \$15

A traditional dish bursting with Sichuan spices • Add ground chicken or pork \$3.00

Fried Rice and Pastas

Corner Fried Rice 本楼炒饭 \$16

Fried rice with a combination of shrimp, pork, chicken, and fresh vegetables.

Fried Rice with Beef, Pork, Chicken, Shrimp or Vegetables 炒饭 \$13

Lo Mein with Beef, Pork, Chicken, Shrimp or Vegetables 捞面 \$13

Angel Hair Rice Pasta with Beef, Pork, Chicken, Shrimp or Vegetables 米粉 \$14

With or without curry

Pineapple Fried Rice 菠萝炒饭 \$16

Chow-Fun Noodles 河粉 \$16

Sautéed with chicken, beef, or shrimp.

Lunch Entrees

Monday – Friday 12:00 – 2:30PM, excluding Holidays

All lunch entrees are served with white or brown rice,
and your choice of Soup.

\$12

Chicken Imperial 左宗鸡球

Chicken and Broccoli 芥蓝鸡片

Sesame Chicken 芝麻鸡球

Pineapple Chicken 菠萝鸡块

\$14

Crispy Tangerine Steak 陈皮牛柳

Pepper Steak 青椒牛肉丝

Beef and Broccoli 芥蓝牛肉片

Shredded Pork in Szechuan Sauce 鱼香肉丝

\$16

Shrimp with Lobster Sauce 虾龙糊

Sesame Shrimp 芝麻大虾

Crispy Shrimp with Tangerine Peel 陈皮大虾

Velvet Shrimp 芙蓉虾

Prices are subject to change without notice. 20% gratuity will
be added to a party of 6 or more.

Coke/ Diet Coke/ Ginger Ale/ Sprite/ Soda 可乐/健怡可乐/姜汁汽水/雪碧/苏打水 \$3

Iced Herbal Tea 王老吉 \$3

Orange Soda 北冰洋 \$3 **Spring Water** 矿泉水 \$3

The Corner Chinese restaurant may be located on a busy street, but it is far from your typical “corner” restaurant. The moment you step through the door, you are transported to a world of authentic Chinese cuisine and culture.

What sets us apart is our dedication to using only the freshest ingredients and traditional cooking methods. From the succulent Peking Imperial to our decadent West Lake beef soup, every dish is made with care and attention to detail. Our chefs are skilled in the art of Chinese cuisine and create dishes that are both delicious and visually stunning. We take pride in our extensive menu, which offers a wide variety of dishes from different regions of China. Whether you are in the mood for something a bit savory or spicy, we have something for everyone.

At The Corner, we also believe in providing an immersive dining experience. So next time you're in the mood for Chinese food, skip the average “corner” restaurant and come experience The Corner. You won't be disappointed.

698 9th Ave
New York, NY 10036
(212) 970 - 0698



W 47th St

W 49th St

W 48th St

W 47th St

W 48th St

W 46th St

Ramon Aponte Park

W 47th St

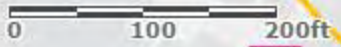

Active On Premises Liquor Licenses within 500 Feet

Name	Address	Distance
CLL CAPITAL INC Ser #: 1316908	689 9TH AVE NEW YORK, NY 10036	105 ft
683 NINTH AVENUE INC Ser #: 1111088	683 NINTH AVE AKA 401 W 47TH NEW YORK, NY 10036	133 ft
GAF WEST LTD Ser #: 1114375	401 W 48TH STREET NEW YORK, NY 10036	179 ft
GO BNB REST LLC Ser #: 1297091	675B 9TH AVE NEW YORK, NY 10036	210 ft
HKQ INC Ser #: 1326730	675A 9TH AVE NEW YORK, NY 10036	210 ft
MARI HOSPITALITY NYC INC Ser #: 1337568	679 9TH AVE NEW YORK, NY 10036	214 ft
701 RESTAURANT LLC Ser #: 1278118	701 9TH AVE NEW YORK, NY 10019	229 ft
REVIVAL SURVIVAL LLC Ser #: 1339740	714 9TH AVE NEW YORK, NY 10019	333 ft
BOYYTHAI CORP Ser #: 1315787	662 9TH AVE NEW YORK, NY 10036	342 ft
RHUNGRUENG INC Ser #: 1309255	717 9TH AVE NEW YORK, NY 10019	349 ft
CANTINA 46TH CORP Ser #: 1334700	373 W 46TH ST NEW YORK, NY 10036	351 ft
371 W 46TH ST OWNERS LLC Ser #: 1332557	371 W 46TH ST NEW YORK, NY 10036	356 ft
365 SEKI INC Ser #: 1284690	365 367 W 46TH ST NEW YORK, NY 10036	367 ft
S&F SZECHUAN INC Ser #: 1319343	353 WEST 46TH ST NEW YORK, NY 10036	410 ft
G CUBED CORP Ser #: 1181500	369 W 46TH ST 46TH ST BTWN 8TH&9TH AVENUES NEW YORK, NY 10036	431 ft
656 9TH AVENUE LLC Ser #: 1339807	656 9TH AVE NEW YORK, NY 10036	438 ft
659 REST INC Ser #: 1028039	659 9TH AVE NEW YORK, NY 10036	439 ft
JOIN US HK LLC Ser #: 1302077	364 W 46TH ST NEW YORK, NY 10036	441 ft
GIFT NEW YORK NO 2 LLC Ser #: 1322727	360 W 46TH ST NEW YORK, NY 10036	452 ft
KINSALE ROAD INC Ser #: 1114815	370 WEST 46TH STREET 8 & 9 AVENUE NEW YORK, NY 10036	456 ft
BARE CITY THREE LLC Ser #: 1270774	366 W 46TH ST NEW YORK, NY 10036	457 ft
363 WEST 46TH STREET TAVERN INC Ser #: 1148229	363 W 46TH ST 8TH AVENUE & 9TH AVENUE NEW YORK, NY 10036	462 ft
ERMINIA RESTAURANT CORPORATION Ser #: 1027795	361 W 46TH STREET NEW YORK, NY 10036	473 ft
350 W 46 CAFE LLC Ser #: 1314607	350 W 46TH ST 9TH & 8TH AVENUES NEW YORK, NY 10036	498 ft