

Manhattan Community Board 4

Liquor License/Sidewalk Cafe Stipulations Application

(All Fields Must Be Completed)

CORPORATION NAME		DOING BUSINESS AS (DBA)			
STREET ADDRESS		CROSS STREETS		ZIP CODE	
OWNER <small>(Attach a list of all the people that will be associated/listed with the license)</small>	NAME:	ATTORNEY/ REPRESENTAIVE	NAME:		
	PHONE:		PHONE:		
	EMAIL:		EMAIL:		
MANAGER	NAME:	LANDLORD	NAME:		
	PHONE:		PHONE:		
	EMAIL:		EMAIL:		
APPLICATION TYPE (<input type="checkbox"/> <i>Liquor License</i> <input type="checkbox"/> <i>Unenclosed Sidewalk Cafe</i>)					
<input type="radio"/> New	Has applicant owned or managed a similar business?		YES	NO	
	What is/was the name and address of establishment?				
	What were the dates applicant was involved with this former premise?				
<input type="radio"/> Corp Change/Class Change/Removal	What is the license # and expiration date?				
	Is applicant making any alterations or operational changes?		YES	NO	
	<i>If alterations or operational changes are being made, please describe/list all changes.</i>				
<input type="radio"/> Alteration	What is the current license # and expiration date?				
	<i>Please list/describe the nature of all the changes and attach the plans:</i>				
METHOD OF OPERATION					
TYPE OF ALCOHOL	<input type="radio"/> Liquor/Wine/Beer & Cider		<input type="radio"/> Beer & Cider		<input type="radio"/> Wine/Beer & Cider
ESTABLISHMENT TYPE	<input type="radio"/> Restaurant <input type="radio"/> Cabaret <input type="radio"/> Night Club <input type="radio"/> Hotel <input type="radio"/> Bar/Tavern <input type="radio"/> Catering Establishment *FOOD STALL IN MARKET <input type="radio"/> Adult Entertainment <input type="radio"/> Wine Bar <input type="radio"/> Dance Club <input type="radio"/> Sports Bar <input type="radio"/> Club (Fraternal Organization – Members Only)				
Has applicant/owner filed with the SLA? If yes, when? If no, when do you plan to file?			YES	NO	
Is the 500 Foot Rule applicable? If yes, please attach a diagram of the On-Premise liquor license establishments within a 500 ft. radius of your establishment and the Public Interest Statement.			YES	NO	
Is the 200 Foot Rule applicable? If yes, please attach a diagram of the schools and houses of worship that trigger the rule.			YES	NO	
Has applicant/owner(s) read MCB4 Policy Regarding Concentration and Location of Alcoholic-Serving Establishments?			YES	NO	

OPERATIONAL DETAILS (*Closing time will be when establishment is vacated of all patrons)

HOURS* <i>(Indoor Only)</i>		MONDAY	TUESDAY	WEDNESDAY	THURSDAY	FRIDAY	SATURDAY	SUNDAY
	Operation							
	Kitchen							
	Music	MUSIC WILL BE PLAYED IN COMMON FOOD HALL						

If you plan to have music, what type(s)? (Circle all that apply)	BACKGROUND	LIVE MUSIC	DJ	JUKE BOX	KARAOKE
---	-------------------	-------------------	-----------	-----------------	----------------

OCCUPANCY

	Capacity (Certificate of Occupancy)	Maximum # of Persons You Anticipate Occupying Premises (Including Employees)	Number of Tables	Number of Seats	Number of Service Only Bars	Number of Stand-Up Bars	Number of Seats at Stand-Up Bar
INSIDE							
OUTSIDE <i>(Other than sidewalk café)</i>							
SIDEWALK CAFÉ							

How many floors are there? What is the capacity for each floor?

How frequently will the owner(s) be at the establishment?

Will there be dancing?	YES	NO
------------------------	------------	-----------

Will applicant have bottle or table service for beverage alcohol?	YES	NO
---	------------	-----------

Will you be hosting private; promotional or corporate events?	YES	NO
---	------------	-----------

Will outside promoters be used on a regular basis? If yes please describe.	YES	NO
--	------------	-----------

Will you have a security plan? If, yes please attach.	YES	NO
---	------------	-----------

Will security plan be implemented?	YES	NO
------------------------------------	------------	-----------

Will State certified security personnel be used?	YES	NO
--	------------	-----------

Will New York Nightlife Association and NYPD Best Practices be followed?	YES	NO
--	------------	-----------

Will applicant be using delivery bicycles? If yes, how many?	YES	NO
--	------------	-----------

Will delivery bicycles be clearly marked with the name of the restaurant and will staff wear attire clearly noting name as described by NYC Law?	YES	NO
--	------------	-----------

Where will delivery bicycles be stored during the day when not in use?

LOCATION & ZONING

Is this a Special District? If yes, is it Clinton, West Chelsea or Hudson Yards?	YES	NO	
Does the building have a Certificate of Occupancy ("C of O") or a letter of no objection?	YES	NO	
Is a Public Assembly permit required?	YES	NO	
Are your plans filed with DOB?	YES	NO	

Community Notification/Relations

NOTIFICATION: List all block associations; tenant associations, co-op boards or condo boards of residential buildings; and community groups that applicant has notified regarding its application. For each please list both the organization and individual you contacted	# 1	
	# 2	
	# 3	
	# 4	
	# 5	
Please provide dates when applicant met with the groups listed above.		
Who was your contact person at each group you met with?		
When did applicant post the notice that was provided?		
Where did applicant post the notice that was provided?		
Will applicant provide owner cell phone number to neighbors and respond to complaints that arise? Please provide number in space provided.	YES	NO
Will applicant inform the Community Board office of its job openings and/or provide a hyperlink to applicants jobs webpage?	YES	NO

BUILDING DESIGN			
State the name and type of business previously located in the space.			
Has a liquor-licensed establishment previously occupied this space at any time? If yes, please provide the name of the business.	YES	NO	
Do you plan any changes to the existing façade? If yes, please describe.	YES	NO	
Has the applicant/owner(s) read MCB 4 ADA Guidelines Memo?	YES	NO	
Is the entrance ADA Compliant?	YES	NO	
Do you plan any changes to the existing façade? If yes, please describe.	YES	NO	
Will applicant have a vestibule within the establishment?	YES	NO	
Will applicant use a storm enclosure?	YES	NO	
Will applicant agree not to place any items or obstructions on the sidewalk, for example, sandwich boards, sidewalk signs, freestanding menus and plants, as per the law?	YES	NO	
Will applicant comply with the NYC noise code?	YES	NO	
Will the establishment have any of the following: (circle all that apply)	FRENCH DOORS		GARAGE DOORS
	WINDOWS THAT CAN BE OPENED		
Will applicant close all windows, French doors, garage doors when any music or amplified sound (including televisions) is played inside the establishment?	YES	NO	
Will applicant close all windows, French doors, garage doors by 11 PM Friday and Saturday and 10 PM on all other days even if no music or amplified sound is played inside the establishment?	YES	NO	
Has applicant obtained an acoustical report from a certified sound engineer to assess potential noise disturbance to the neighboring residents and buildings?	YES	NO	
Will applicant follow the recommendations of a certified sound engineer to mitigate potential noise disturbance to the neighboring residents and buildings, including placing speakers on the floor of the establishment?	YES	NO	
Will the kitchen exhaust system extend to the roof?	YES	NO	
Will the establishment have an illuminated sign?	YES	NO	
Will the establishment have a canopy extending over the sidewalk?	YES	NO	
Where will the air conditioner be located? What type is it?			
When was the air conditioner installed?			

OUTDOOR ITEMS - OTHER THEN SIDEWALK CAFÉ

Has the applicant/owner(s) read MCB 4 Rear Yard Rooftop Policy?	YES	NO	
Will applicant use any outdoor spaces: rooftop, rear yard, patio, porch, balcony, pavilion, tents, deck or gazebo? If yes, which one(s)?	YES	NO	
Are the floorplans for the outdoor space(s) included?	YES	NO	
Will applicant close and vacate the outdoor space(s) by 11PM on Friday & Saturday and 10 PM on all other days?	YES	NO	
Will the service and consumption of alcohol in any outdoor space only be via seated food service?	YES	NO	
Will applicant not allow standing space for patrons to drink or smoke in any outdoor space(s)?	YES	NO	
Will there be no amplified music, as per the law?	YES	NO	
If amplified sound is played inside the establishment, will windows and doors be closed?	YES	NO	
Will applicant agree to post signs outside asking customers to respect the neighbors'?	YES	NO	
Will applicant agree to train staff to encourage a peaceful environment?	YES	NO	
Will applicant provide effective sound control (landscaping enclosure, soundproofing tenants apartments)	YES	NO	
Will there be a lighting plan that allows safe usage of the outdoor space without disrupting neighbors?	YES	NO	

OUTDOOR ITEMS – SIDEWALK CAFÉ

Has the applicant/owner(s) read MCB4 Sidewalk Café Policy?	YES	NO	
Will applicant be applying for a sidewalk café now or in the future?	YES	NO	
Is applicant in this application seeking to include a sidewalk café in its liquor license?	YES	NO	
If yes, has applicant submitted an application and plans to NYC Dept. of Consumer Affairs? Please attach application and plans.	YES	NO	
Will applicant close and vacate the sidewalk café by 11 PM on Friday & Saturday and 10 PM on all other days?	YES	NO	
Will applicant be serving alcohol in the sidewalk café? If so, will you have waiter service?	YES	NO	
Will the café have a 3 ft. wide serving aisle running the entire length of the sidewalk cafe?	YES	NO	
Will applicant mark the perimeter of the café on the sidewalk?	YES	NO	
Will the service and consumption of alcohol in the sidewalk café only be via seated food service?	YES	NO	
Will the sidewalk café not provide standing space for drinking or smoking?	YES	NO	
Will applicant use any portable natural gas heaters? If so, do you have the requisite approvals from DOB & the Fire Department?	YES	NO	
Will applicant have a lighting plan that will allow safe usage of the outdoor space without disrupting neighbors?	YES	NO	
Will all furniture, plants and barricades be stored inside between the evening closing hours and the morning opening hours?	YES	NO	
Will all furniture be stored inside between December 21 st and March 21 st , and any other day when it rains or snows?	YES	NO	
Will applicant use umbrellas?	YES	NO	
If construction or construction protection has reduced the sidewalk width, will applicant always maintain an 8 foot clear path of sidewalk between the perimeter of the café and the closes obstruction including construction barricades?	YES	NO	

ADDITIONAL STIPULATIONS: (Office Use Only)

To the extent any additional stipulation on pages 7 and 8 of this application conflicts with any response on pages 1 – 6 of this application, the stipulations on pages 7 and 8 control.



ADDITIONAL STIPULATIONS: (Office Use Only), *Continued*

To the extent any additional stipulation on pages 7 and 8 of this application conflicts with any response on pages 1 – 6 of this application, the stipulations on pages 7 and 8 control.

Manhattan Community Board 4 (MCB4) recommends:
 (MCB4's recommendation is based on a vote taken at its
 November 2, 2022 full board meeting, with 43 members voting in favor
 of the recommendation, 0 members opposed, 0 members
 abstaining and 0 present but not eligible)

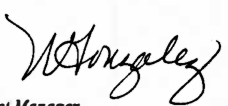

Denial unless all stipulations agreed to by applicant/owner are part of the method of
 operation
 Denial Approval

CB4 REPRESENTATIVES

 Nelly Gonzalez CB4 Assistant District Manager	 Frank Holozabiec CB4 BLP Committee Co-Chair	 Burt Lazarin CB4 BLP Committee Co-Chair
--	--	--

APPLICANT AGREEMENT WITH THE COMMUNITY

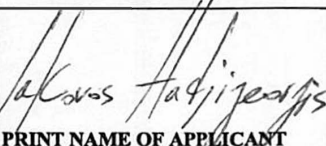
Applicant agrees to these stipulations as the basis for the community support of this application and acknowledges that all of these stipulations are essential prerequisites to the MCB4 recommendation regarding this application. Applicant agrees to have these stipulations incorporated in the method of operation of its liquor license. The stipulations in this application constitute the entire agreement between MCB4 and applicant and may only be altered in writing signed by MCB4 and applicant. These stipulations supersede any oral statements or representations in connection with this application.

<p>SIGN HERE →</p>	 PRINT NAME OF APPLICANT	 SIGNATURE OF APPLICANT	10-11-22 DATE
---------------------------	--	--	------------------

JOSIPH SUERO
 Notary Public, State of New York
 No. 01SU6202184
 Qualified in Bronx County
 Commission Expires March 9, 2025



BREAKFAST

SANDWICHES

'TIL
11:30AM

ON A DONUT OR BISCUIT

EGG & CHEESE 7

BACON EGG & CHEESE 8

SAUSAGE EGG & CHEESE 8

BAG OF FOUR BISCUITS 8
W/ MAPLE BUTTER



ADD COFFEE +2

MAC & CHEESE

THE CLASSIC 14

BUFFALO CHICKEN 15

FRIED CHICKEN CAESAR SALAD

MAKE IT NASHVILLE HOT +2

15

FRIED PICKLES

9

FRIED CHICKEN

BISCUIT SANDWICHES

15

HONEY CHICKEN & PICKLES

NASHVILLE HOT CHICKEN

BBQ PEPPERJACK CHICKEN

SAUSAGE GRAVY SMOTHERED CHICKEN



ADD MAC & CHEESE +7

BEER & SOFT SERVE

BISCUIT BEER

TALL BOY 7 FOUR PACK 19

VEGAN

PICKLE ICE CREAM 5

POPCORN ICE CREAM 5

GIVE THE GIFT OF PICKLES!
GIFT BASKETS AVAILABLE



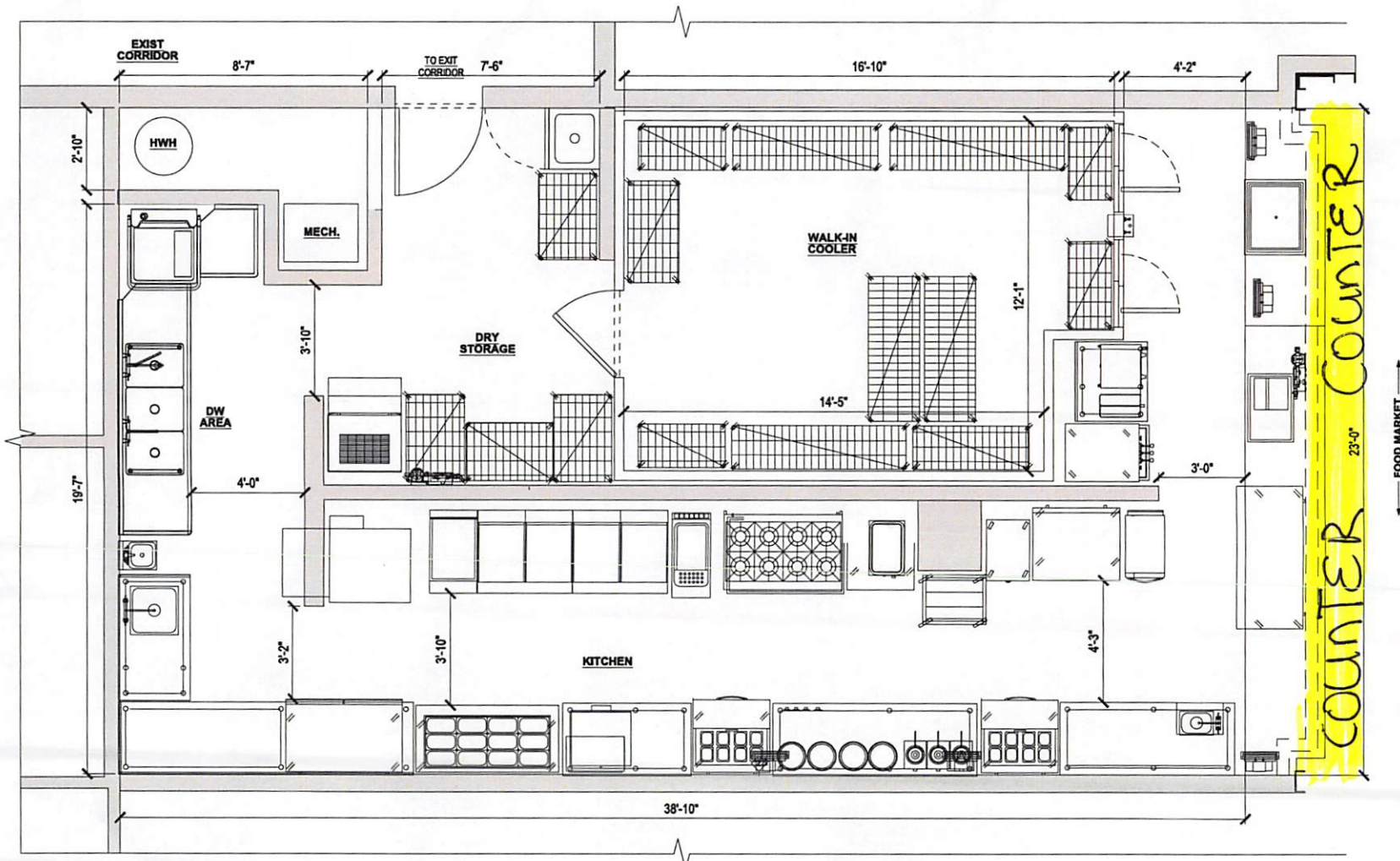

JACOB'S PICKLE
 MOYNIHAN STATION
 441 8TH AVENUE
 NEW YORK, NY 10001

ARCHITECT: TITLE

adg ADG Architecture & Design P.C.
 13 West 38th Street, 7th Floor
 New York, New York, 10018
 (P) 212.777.8890
 (F) 212.979.0818

All rights reserved.
 All drawings, specifications and copies thereof furnished are
 and shall remain the property of ADG Architecture & Design
 P.C. and are not to be used on this or any other project
 without written consent from ADG Architecture & Design P.C.

JACOB'S PICKLE
 MOYNIHAN STATION

DATE: 09.13.2022

PROJECT NO: 5186

DRAWING BY: BJ

CHK BY: CC/MN

ISSUE	DESCRIPTION	DATE
1	DOB SUBMISSION	09.13.22

PROFESSIONAL STAMP/ SIGNATURE

DWG NO



A-01

Ground Level (page 2)

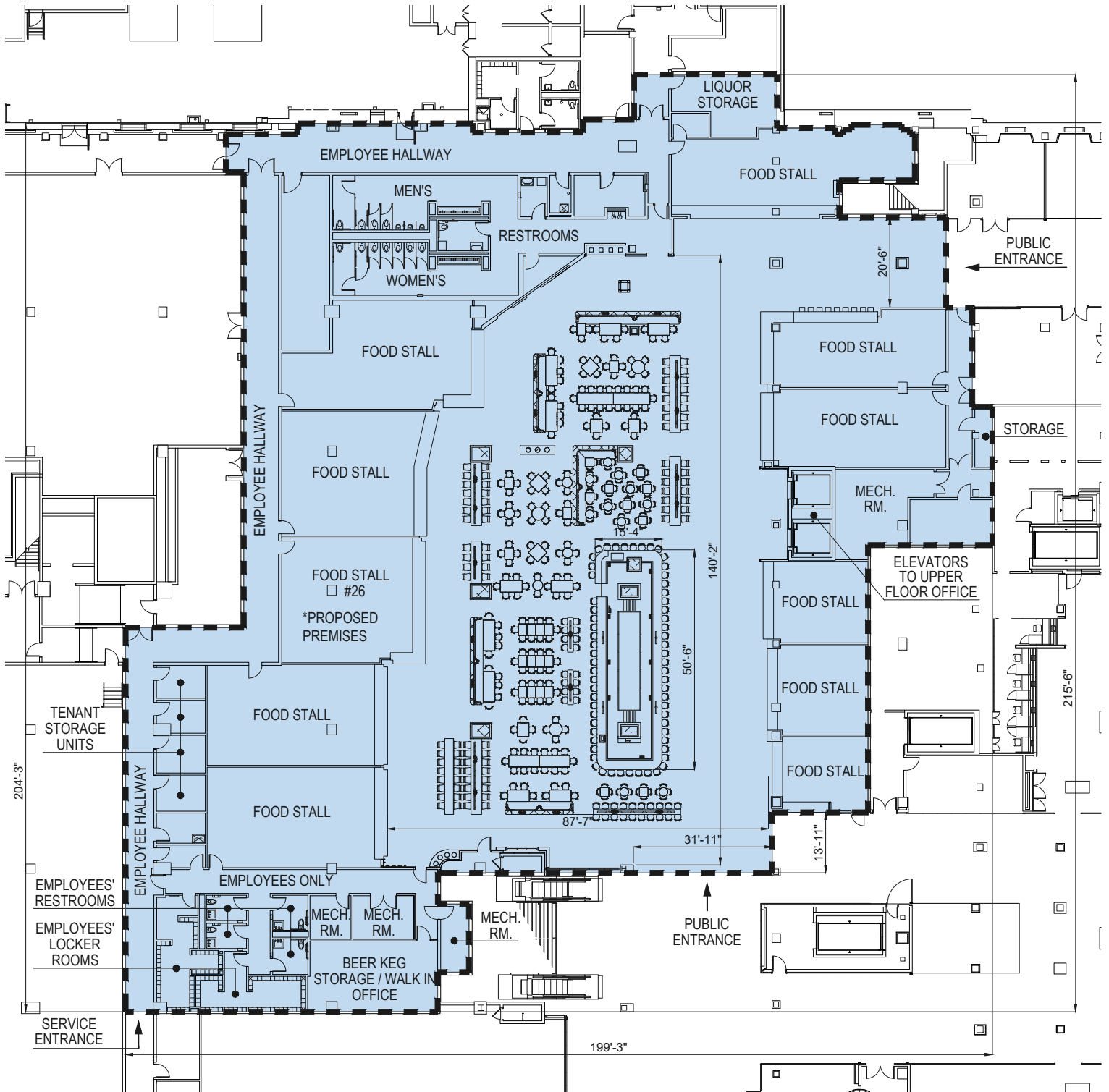

GROUND FLOOR:	
PATRON BARS:	1
LENGTH OF BAR:	127'-8"
TABLES:	79
SEATS AT TABLES:	419
SEATS AT BAR:	58
OVERALL DIMENSIONS:	30,570 S.F.

NEIGHBORHOOD INFORMATION:

Block Plot Diagram

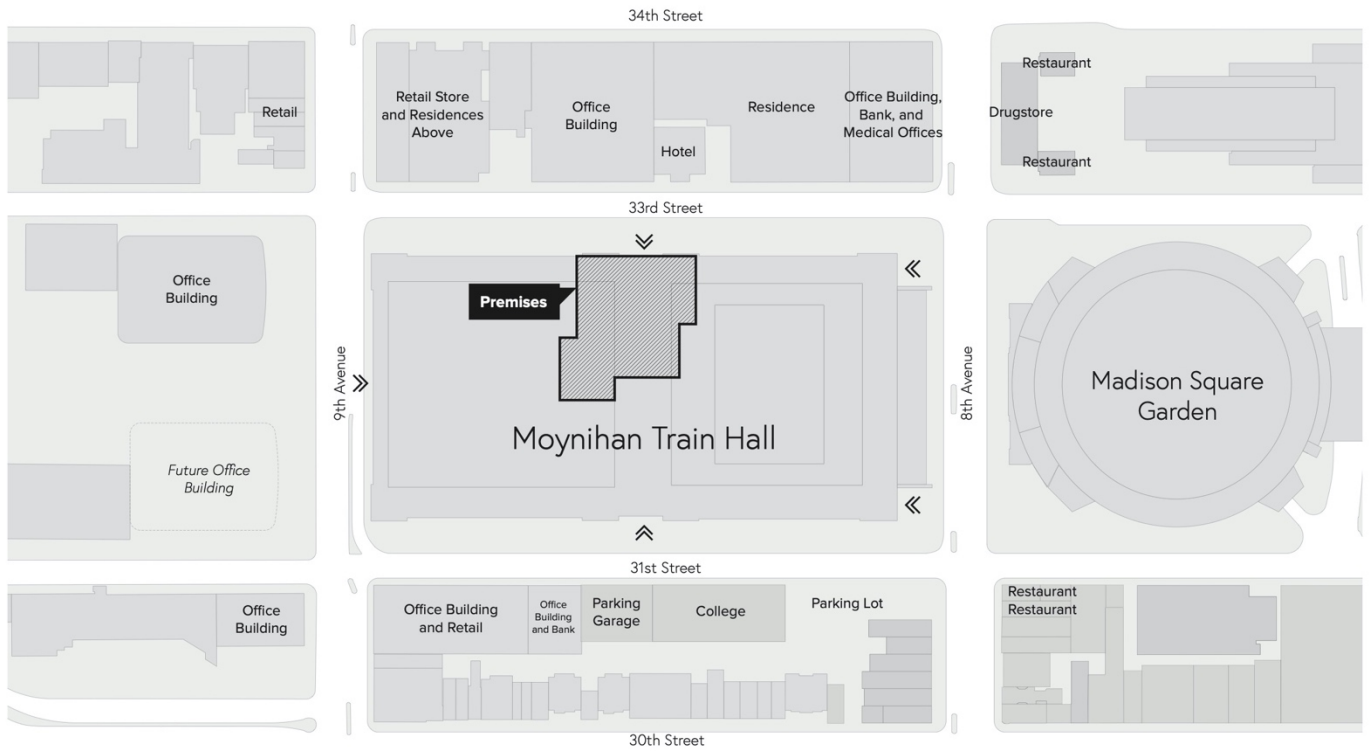

Moynihan Train Hall
May 2021

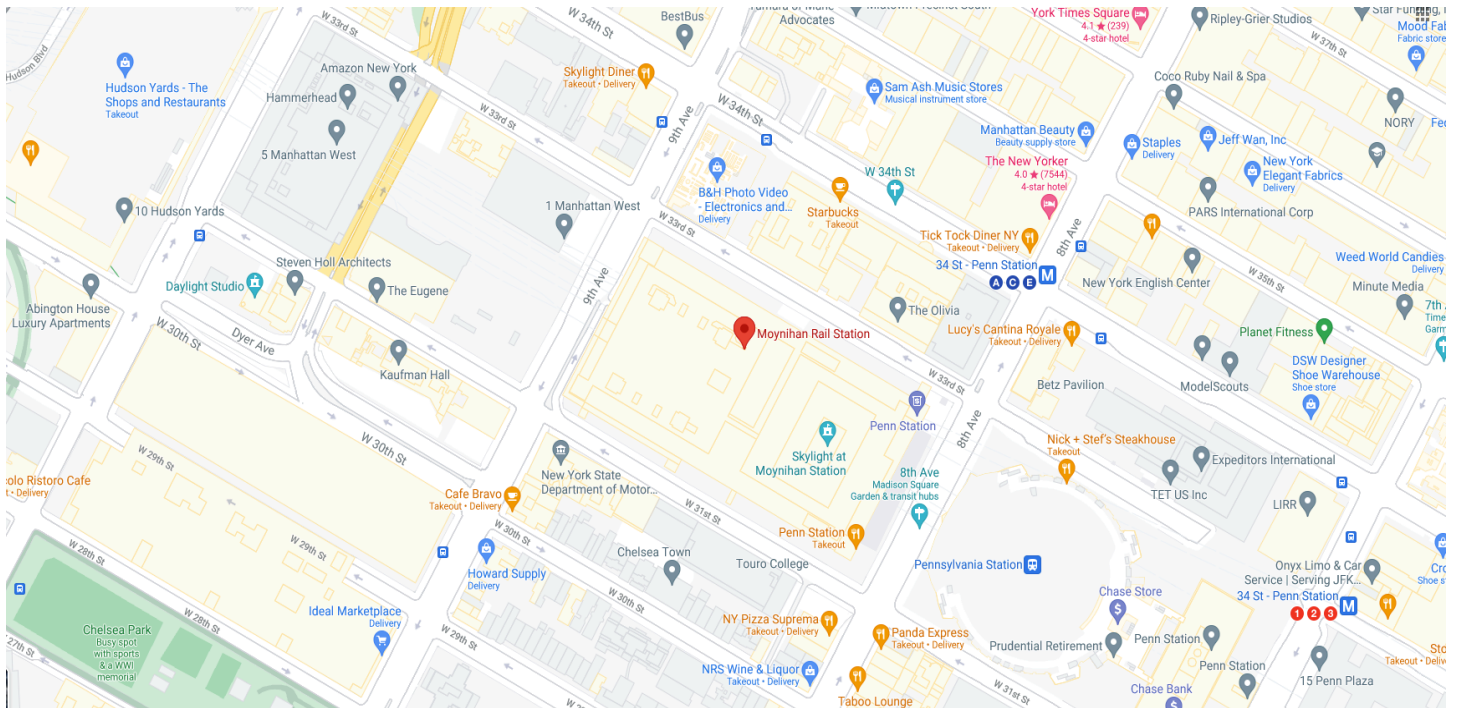

NEIGHBORHOOD MAP



500 FOOT MAP

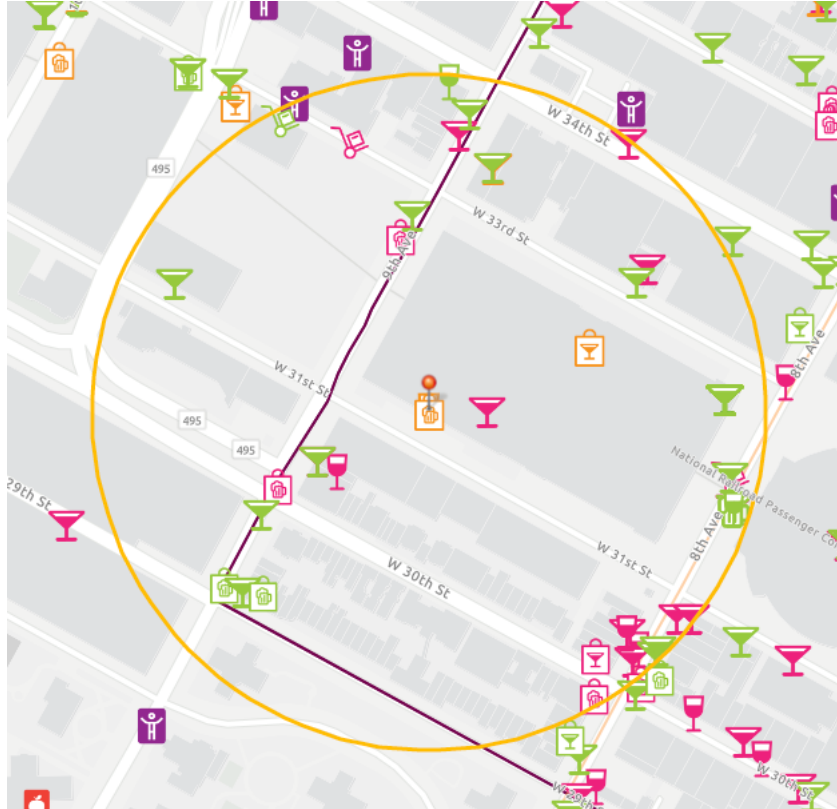

GREEN MARTINI= OP LICENSE

PINK MARTINI= INACTIVE OP LICENSE

GREEN WINE= TW/ RW LICENSE

PINK WINE= INACTIVE TW/ RW LICENSE

This report is for informational purposes only in aid of identifying establishments potentially subject to 500 and 200 foot rules. Distances are approximated using industry standard GIS techniques and do not reflect actual distances between points of entry. The NYS Liquor Authority makes no representation as to the accuracy of the information and disclaims any liability for errors.

Proximity Report For:	
Location	383 W 31st St, New York, New York, 10001
Geocode	Latitude: 40.75138 Longitude: -73.99686
Report Generated On	9/21/2022

8 Closest Liquor Stores		
Name	Address	Distance
NRS WINE AND LIQUOR INC Ser #: 1336044	391 8TH AVE NEW YORK, NY 10001	787 ft
BARRIL WINES & LIQUORS INC Ser #: 1315255	5 7 CARYL AVE YONKERS, NY 10705	846 ft
MEENA SAMANI CORPORATION Ser #: 1273576	460 W 34TH ST STORE# 1 NEW YORK, NY 10001	1,124 ft
ANA WINE AND LIQUORS LLC Ser #: 1336884	20 HUDSON YARDS, UNIT RU101 A/KA 500 W 33RD ST NEW YORK, NY 10001	1,185 ft
RAJ WINE LLC Ser #: 1314271	PENN STATION 7TH AVE CORRIDOR-SPACE 23B NEW YORK, NY 10001	1,376 ft
PENN WINE & SPIRITS INC Ser #: 1170139	PENNSYLVANIA STATION 3 PENN PLAZA LEVEL A CONCOURSE NEW YORK, NY 10001	1,447 ft
AMSTERWINE.COM INC Ser #: 1313979	475 9TH AVE NEW YORK, NY 10018	1,457 ft
36TH STREET WINE & LIQUOR INC Ser #: 1023632	270 W 36TH STREET NEW YORK, NY 10018	1,547 ft

Schools within 500 feet		
Name	Address	Distance
No Schools within 500 feet		

Churches within 500 feet	
Name	Distance
No Churches within 500 feet	

Pending On Premises Liquor Licenses within 750 feet

Name	Address	Distance
MOYNIHAN OVERLOOK BAR LLC & PDP HOSPITALITY LLC Ser #: 1338758	383 W 33RD ST # 188-189 NEW YORK, NY 10001	559 ft

Active On Premises Liquor Licenses within 750 feet

Name	Address	Distance
MATES GLOBAL LTD Ser #: 1323955	360 9TH AVE NEW YORK, NY 10001	271 ft
ARAMARK SERVICES INC Ser #: 1337824	401 9TH AVE NEW YORK, NY 10001	437 ft
BARRAGH CORP Ser #: 1268099	340 9TH AVE NEW YORK, NY 10001	438 ft
NY 33RD LEASEHOLD LLC,FIVE POINTS OPRTG TENANT LLC Ser #: 1334766	325 W 33RD ST NEW YORK, NY 10001	545 ft
MOYNIHAN FOOD HALL BAR LLC & PDP HOSPITALITY LLC Ser #: 1337991	383 W 33RD ST #20 NEW YORK, NY 10001	559 ft
BILLY MARKS WEST INC Ser #: 1105367	332 NINTH AVENUE NEW YORK, NY 10001	576 ft
435 WEST 31ST STREET A LLC Ser #: 1329408	435 W 31ST ST 1ST FL NEW YORK, NY 10001	635 ft
435 WEST 31ST STREET B LLC Ser #: 1329468	435 W 31ST ST 2ND & 3RD FLOORS NEW YORK, NY 10001	635 ft
AMTRAK N R P CORP Ser #: 2001362	PENN STATION UNDER OPTION B NEW YORK, NY 10001	659 ft
AMTRAK N R P CORP Ser #: 2001356	PENN STATION UNDER OPTION B NEW YORK, NY 10001	659 ft
AMTRAK N R P CORP Ser #: 2001403	PENN STATION UNDER OPTION B NEW YORK, NY 10001	659 ft
AMTRAK N R P CORP Ser #: 2001373	PENN STATION UNDER OPTION B NEW YORK, NY 10001	659 ft
AMTRAK N R P CORP Ser #: 2001342	PENN STATION UNDER OPTION B NEW YORK, NY 10001	659 ft
AMTRAK N R P CORP Ser #: 2001359	PENN STATION UNDER OPTION B NEW YORK, NY 10001	659 ft
AMTRAK N R P CORP Ser #: 2001353	PENN STATION UNDER OPTION B NEW YORK, NY 10001	659 ft
AMTRAK N R P CORP Ser #: 2001400	PENN STATION UNDER OPTION B NEW YORK, NY 10001	659 ft

Active On Premises Liquor Licenses within 750 feet		
Name	Address	Distance
AMTRAK N R P CORP Ser #: 2001406	PENN STATION UNDER OPTION B NEW YORK, NY 10001	659 ft
AMTRAK N R P CORP Ser #: 2001370	PENN STATION UNDER OPTION B NEW YORK, NY 10001	659 ft
AMTRAK N R P CORP Ser #: 2001396	PENN STATION UNDER OPTION B NEW YORK, NY 10001	659 ft
AMTRAK N R P CORP Ser #: 2001390	PENN STATION UNDER OPTION B NEW YORK, NY 10001	659 ft
AMTRAK N R P CORP Ser #: 2001376	PENN STATION UNDER OPTION B NEW YORK, NY 10001	659 ft
AMTRAK N R P CORP Ser #: 2001385	PENN STATION UNDER OPTION B NEW YORK, NY 10001	659 ft
AMTRAK N R P CORP Ser #: 2001348	PENN STATION UNDER OPTION B NEW YORK, NY 10001	659 ft
AMTRAK N R P CORP Ser #: 2001397	PENN STATION UNDER OPTION B NEW YORK, NY 10001	659 ft
AMTRAK N R P CORP Ser #: 2001391	PENN STATION UNDER OPTION B NEW YORK, NY 10001	659 ft
RAILROAD PASSENGER SERVICES CORP Ser #: 1138563	PENN STATION NEW YORK, NY 10001	659 ft
AMTRAK N R P CORP Ser #: 2001365	PENN STATION UNDER OPTION B NEW YORK, NY 10001	659 ft
AMTRAK N R P CORP Ser #: 2001351	PENN STATION UNDER OPTION B NEW YORK, NY 10001	659 ft
AMTRAK N R P CORP Ser #: 2001357	PENN STATION UNDER OPTION B NEW YORK, NY 10001	659 ft
AMTRAK N R P CORP Ser #: 2001368	PENN STATION UNDER OPTION B NEW YORK, NY 10001	659 ft
AMTRAK N R P CORP Ser #: 2001345	PENN STATION UNDER OPTION B NEW YORK, NY 10001	659 ft
AMTRAK N R P CORP Ser #: 2001388	PENN STATION UNDER OPTION B NEW YORK, NY 10001	659 ft
AMTRAK N R P CORP Ser #: 2001374	PENN STATION UNDER OPTION B NEW YORK, NY 10001	659 ft

Active On Premises Liquor Licenses within 750 feet		
Name	Address	Distance
AMTRAK N R P CORP Ser #: 2001383	PENN STATION UNDER OPTION B NEW YORK, NY 10001	659 ft
AMTRAK N R P CORP Ser #: 2001360	PENN STATION UNDER OPTION B NEW YORK, NY 10001	659 ft
AMTRAK N R P CORP Ser #: 2001369	PENN STATION UNDER OPTION B NEW YORK, NY 10001	659 ft
AMTRAK N R P CORP Ser #: 2001389	PENN STATION UNDER OPTION B NEW YORK, NY 10001	659 ft
AMTRAK N R P CORP Ser #: 2001404	PENN STATION UNDER OPTION B NEW YORK, NY 10001	659 ft
AMTRAK N R P CORP Ser #: 2001372	PENN STATION UNDER OPTION B NEW YORK, NY 10001	659 ft
AMTRAK N R P CORP Ser #: 2001392	PENN STATION UNDER OPTION B NEW YORK, NY 10001	659 ft
AMTRAK N R P CORP Ser #: 2001343	PENN STATION UNDER OPTION B NEW YORK, NY 10001	659 ft
AMTRAK N R P CORP Ser #: 2001366	PENN STATION UNDER OPTION B NEW YORK, NY 10001	659 ft
AMTRAK N R P CORP Ser #: 2001358	PENN STATION UNDER OPTION B NEW YORK, NY 10001	659 ft
AMTRAK N R P CORP Ser #: 2001335	PENN STATION UNDER OPTION B NEW YORK, NY 10001	659 ft
AMTRAK N R P CORP Ser #: 2001387	PENN STATION UNDER OPTION B NEW YORK, NY 10001	659 ft
AMTRAK N R P CORP Ser #: 2001399	PENN STATION UNDER OPTION B NEW YORK, NY 10001	659 ft
AMTRAK N R P CORP Ser #: 2001405	PENN STATION UNDER OPTION B NEW YORK, NY 10001	659 ft
AMTRAK N R P CORP Ser #: 2001395	PENN STATION UNDER OPTION B NEW YORK, NY 10001	659 ft
AMTRAK N R P CORP Ser #: 2001344	PENN STATION UNDER OPTION B NEW YORK, NY 10001	659 ft
AMTRAK N R P CORP Ser #: 2001367	PENN STATION UNDER OPTION B NEW YORK, NY 10001	659 ft

Active On Premises Liquor Licenses within 750 feet		
Name	Address	Distance
AMTRAK N R P CORP Ser #: 2001375	PENN STATION UNDER OPTION B NEW YORK, NY 10001	659 ft
AMTRAK N R P CORP Ser #: 2001408	PENN STATION UNDER OPTION B NEW YORK, NY 10001	659 ft
AMTRAK N R P CORP Ser #: 2001338	PENN STATION UNDER OPTION B NEW YORK, NY 10001	659 ft
AMTRAK N R P CORP Ser #: 2001402	PENN STATION UNDER OPTION B NEW YORK, NY 10001	659 ft
AMTRAK N R P CORP Ser #: 2001347	PENN STATION UNDER OPTION B NEW YORK, NY 10001	659 ft
AMTRAK N R P CORP Ser #: 2001378	PENN STATION UNDER OPTION B NEW YORK, NY 10001	659 ft
TWINS PUB INC Ser #: 1034146	421 9TH AVENUE NEW YORK, NY 10001	665 ft
ARAMARK SERVICES INC Ser #: 1336869	421 8TH AVE AKA 372 NINTH AVE NEW YORK, NY 10001	687 ft
GENTS ENTERPRISES INC Ser #: 1023985	PENN STATION-MAIN CONCOURSE NEW YORK, NY 10001	714 ft
AMA RESTAURANTS LLC Ser #: 1153660	410 8TH AVENUE 31ST & 32ND STREETS NEW YORK, NY 10001	737 ft
NAVIC INVEST GROUP LLC Ser #: 1265672	408 8TH AVE NEW YORK, NY 10001	740 ft



JACOB'S PICKLES

Southern Comfort Food

FRIED CHICKEN BISCUIT SANDWICHES

BREAKFAST SANDWICHES ON A DONUT OR BISCUIT EGG & CHEESE 7 BACON EGG & CHEESE 8 SAUSAGE EGG & CHEESE 8 BAG OF FOUR BISCUITS 8 ADD COFFEE \$2	MAC & CHEESE THE CLASSIC 12 BUFFALO CHICKEN 15 FRIED CHICKEN CAESAR SALAD MAKE IT NASHVILLE HOT \$2 15 FRIED PICKLES 9	BEER BISCUITS OR PICKLES JACOB'S PICKLES NASHVILLE BEER HALL	FRIED CHICKEN BISCUIT SANDWICHES 15 HONEY CHICKEN & PICKLES NASHVILLE HOT CHICKEN BIG PEPPERJACK CHICKEN SAUSAGE GRAVY BROTHERED CHICKEN ADD MAC & CHEESE \$7	BEER & SOFT SERVE BISCUIT BEER TALL 80¢ FOUR PACK 10 PICKLE ICE CREAM 5 PICKLE ICE CREAM 5 GIVE THE GIFT OF PICKLES! GIFT BASKETS AVAILABLE
--	---	--	--	---

PICKLES

PICKLES













CITY OF NEW YORK
 MANHATTAN COMMUNITY BOARD No. 4
 424 W 33rd Street, Suite 580 New York, NY 10001
 tel: 212-738-4536
<https://cbmanhattan.cityofnewyork.us/cb4/>

JEFFREY LEFRANCIOS
 Chair
 JESSE BOONE
 District Manager

PUBLIC NOTICE
 Business Licenses and Permits Committee
 will discuss an application submitted by
Quick Pickle Penn LLC
383 W 31st Street, Space 24

A New Wine, Beer & Cider Application for
 Restaurant Establishment with Recorded Music

DATE: Tuesday, October 11, 2022
TIME: 6:30 PM
PLACE: Video/Phone Conference Registration:
https://zoom.us/webinar/register/WN_66-6SX3vS_6HVC2bBstV3A

We invite you to attend this meeting and learn more about this application.
 Alternately, you may email your comments by 12 p.m. Monday, October 10, 2022
 or for more information, please email Assistant District Manager Nelly Gonzalez
negonzalez@cb.nyc.gov.

Posted according to the Administrative Code of the City of New York
 119. Please do not remove

#: 21-57
 7/13/2021 4:17:46PM
 N THE PROPERTY OR
PERMIT
 e 024)
 Moynihan Station Train Hall (Farley
 MIT APPLICATION
 FERRE PREVENTION
 THAT APPLY.
 IT THE WORK TO
 IFORM CODE OR
 DION THERE OF
 OC Project: No
 Special Notes:
 P. extended due to work in progress.
 T
 N.
 strator
 22:24PM

"All the News
 That's Fit to Print"

The New York Times

VOL. CLXXII ... No. 59,560 © 2022 The New York Times Company NEW YORK, WEDNESDAY, SEPTEMBER 28, 2022

**Right Ties Up
 Voting Process**

Late Edition
 Today, periodic sunshine, largely
 dry, high 70. Tonight, partly cloudy,
 cool, low 54. Tomorrow, partly
 sunny, a bit cooler than average,
 high 67. Weather map, Page B12.

West 30's Block Associations/Tenant Associations/Community Groups

Block/Tenant Association & Community Groups	First name	Last name	E-MAIL	PHONE
HKNA (incl. Dog Run)	Kathleen	Treat	kathleentreat123@gmail.com	
West 36th Street	Frank	Strock	mcgee79@aol.com	
CHDC (incl. Bob's & bird parks)	Joe	Restuccia	info@clintonhousing.org; jrestuccia2@clintonhousing.org	
CHDC (incl. Bob's & bird parks)	Ryan	Marcano	rmarcano@clintonhousing.org	
Hudson Yards Hell's Kitchen Alliance	Bob	Benfatto	rjbenfatto@hyhkalliance.org	
Hudson Yards Hell's Kitchen Alliance	Patty	Gouris	pgouris@hyhkalliance.org	
Hotel Americano			(212) 216-0000	
Highline537	Scott	Hupe	212-838-3700	
Donna Langman Costumes	Donna	Langman	donna@donnalangman.com	
CHEKPEDS	Christine	Berthet	cberthet@me.com	
Hell's Kitchen Block Association (W 33rd/34th/35th Streets (8th to 12th Avenues)	Julia	Campanelli	HellsKBA@gmail.com	Last Wednesday of the month, except August or November
W36th Block Association (8/9)	Brian	Weber	brianscottweber@gmail.com	
W36th Block Association (8/9)	Cressida	Connelly	cressidac@gmail.com	

When sending an email please bcc everyone on the list