

# Manhattan Community Board 4

(All Fields Must Be Completed)

Liquor License/Sidewalk Cafe Stipulations Application

CORPORATION NAME <b>SUSHI LLC</b>		DOING BUSINESS AS (DBA) <b>MIZUKI NYC</b>	
STREET ADDRESS <b>555 6th AVE</b>		CROSS STREETS <b>W 15th ST. - W 16th ST.</b>	ZIP CODE <b>10011</b>
OWNER <small>(Attach a list of all the people that will be associated/listed with the license)</small>	NAME: <b>LEANDRO ONSARI</b>	ATTORNEY/ REPRESENTATIVE	NAME: <b>MICHAEL KELLY</b>
	PHONE: <b>917 996-1313</b>		PHONE: <b>914 632-6036</b>
	EMAIL: <b>LEAONSARI@GMAIL.COM</b>		EMAIL: <b>KELLYMLK136@GMAIL.COM</b>
MANAGER	NAME: <b>HASSAN HALANI</b>	LANDLORD	NAME: <b>SP 555 SIXTH LLC</b>
	PHONE: <b>732-895-0512</b>		PHONE: <b>917 757-8246</b> <b>BURT SALOMON</b>
	EMAIL: <b>HHALANI@AOL.COM</b>		EMAIL:
APPLICATION TYPE ( <input checked="" type="checkbox"/> <i>Liquor License</i> <input type="checkbox"/> <i>Unenclosed Sidewalk Cafe</i> )			
<input checked="" type="checkbox"/> <b>New</b>	Has applicant owned or managed a similar business?		<input checked="" type="radio"/> YES <input type="radio"/> NO
	What is/was the name and address of establishment?		<b>555 6th AVE SUSHI NYC</b>
	What were the dates applicant was involved with this former premise?		<b>2021 - Present</b>
<input type="checkbox"/> <b>Corp</b> <b>Change/Class</b> <b>Change/Removal</b>	What is the license # and expiration date?		
	Is applicant making any alterations or operational changes?		<input type="radio"/> YES <input type="radio"/> NO
	<i>If alterations or operational changes are being made, please describe/list all changes.</i>		
<input type="checkbox"/> <b>Alteration</b>	What is the current license # and expiration date?		
	<i>Please list/describe the nature of all the changes and attach the plans:</i>		
<b>METHOD OF OPERATION</b>			
TYPE OF ALCOHOL	<input type="radio"/> Liquor/Wine/Beer & Cider <input type="radio"/> Beer & Cider <input checked="" type="radio"/> Wine/Beer & Cider		
ESTABLISHMENT TYPE	<input checked="" type="radio"/> Restaurant <input type="radio"/> Cabaret <input type="radio"/> Night Club <input type="radio"/> Hotel <input type="radio"/> Bar/Tavern <input type="radio"/> Catering Establishment <input type="radio"/> Adult Entertainment <input type="radio"/> Wine Bar <input type="radio"/> Dance Club <input type="radio"/> Sports Bar <input type="radio"/> Club (Fraternal Organization - Members Only)		
Has applicant/owner filed with the SLA? If yes, when? If no, when do you plan to file?	YES	<input checked="" type="radio"/> NO	<b>AFTER MEETING WITH CB 4</b>
Is the 500 Foot Rule applicable? If yes, please attach a diagram of the On-Premise liquor license establishments within a 500 ft. radius of your establishment and the Public Interest Statement.		<input checked="" type="radio"/> NO	
Is the 200 Foot Rule applicable? If yes, please attach a diagram of the schools and houses of worship that trigger the rule.	YES	<input checked="" type="radio"/> NO	
Has applicant/owner(s) read MCB4 Policy Regarding Concentration and Location of Alcoholic-Serving Establishments?	<input checked="" type="radio"/> YES	<input type="radio"/> NO	

**OPERATIONAL DETAILS** (\*Closing time will be when establishment is vacated of all patrons)

HOURS* (Indoor Only)		MONDAY	TUESDAY	WEDNESDAY	THURSDAY	FRIDAY	SATURDAY	SUNDAY
	Operation	12 <sup>PM</sup> - 1 <sup>AM</sup>	12 <sup>PM</sup> - 1 <sup>AM</sup>	12 <sup>PM</sup> - 1 <sup>AM</sup>	12 <sup>PM</sup> - 1 <sup>AM</sup>	12 <sup>PM</sup> - 1 <sup>AM</sup>	12 <sup>PM</sup> - 1 <sup>AM</sup>	12 <sup>PM</sup> - 1 <sup>AM</sup>
	Kitchen	12 <sup>PM</sup> - 12 <sup>AM</sup>	12 <sup>PM</sup> - 12 <sup>AM</sup>	12 <sup>PM</sup> - 12 <sup>AM</sup>	12 <sup>PM</sup> - 12 <sup>AM</sup>	12 <sup>PM</sup> - 12 <sup>AM</sup>	12 <sup>PM</sup> - 12 <sup>AM</sup>	12 <sup>PM</sup> - 12 <sup>AM</sup>
	Music	12 <sup>PM</sup> - 1 <sup>AM</sup>	12 <sup>PM</sup> - 1 <sup>AM</sup>	12 <sup>PM</sup> - 1 <sup>AM</sup>	12 <sup>PM</sup> - 1 <sup>AM</sup>	12 <sup>PM</sup> - 1 <sup>AM</sup>	12 <sup>PM</sup> - 1 <sup>AM</sup>	12 <sup>PM</sup> - 1 <sup>AM</sup>

If you plan to have music, what type(s)? (Circle all that apply)

<input checked="" type="checkbox"/> BACKGROUND	<input type="checkbox"/> LIVE MUSIC	<input type="checkbox"/> DJ	<input type="checkbox"/> JUKE BOX	<input type="checkbox"/> KARAOKE
--	-------------------------------------	-----------------------------	-----------------------------------	----------------------------------

**OCCUPANCY**

	Capacity (Certificate of Occupancy)	Maximum # of Persons Occupying Premises (Including Employees)	Number of Tables	Number of Seats	Number of Service Only Bars	Number of Stand-Up Bars	Number of Seats at Stand-Up Bar
INSIDE	74	74	20	40	1	0	0
OUTSIDE (Other than sidewalk café)	OPEN REST. STREET SEATING IN ROADWAY ONLY	24	12	24	—	—	—
DCA APPROVED UNENCLOSED SIDEWALK CAFÉ	N/A	N/A	N/A	N/A	N/A		

How many floors are there? What is the capacity for each floor? 1ST FLR - 74

How frequently will the owner(s) be at the establishment? ALL HOURS OF OPERATION

Will there be dancing? YES  NO

Will applicant have bottle or table service for beverage alcohol? YES  NO

Will applicant be hosting private; promotional or corporate events? YES  NO

Will outside promoters be used on a regular basis? If yes please describe. YES  NO

Will applicant have a security plan? If, yes please attach. YES  NO

Will security plan be implemented? YES  NO

Will State certified security personnel be used? YES  NO

Will New York Nightlife Association and NYPD Best Practices be followed? YES  NO

Does applicant agree to notify MCB4 prior to making changes to its method of operation? YES  NO

Will applicant be using delivery bicycles? If yes, how many? YES  NO  3rd Party

Will delivery bicycles be clearly marked with the name of the restaurant and will staff wear attire clearly noting name as described by NYC Law? YES  NO  N/A

Where will delivery bicycles be stored during the day when not in use? N/A



LOCATION & ZONING		
Is this a Special District? If yes, is it Clinton, West Chelsea or Hudson Yards?	YES	<input checked="" type="radio"/> NO
Does the building have a Certificate of Occupancy ("C of O") or a letter of no objection?	<input checked="" type="radio"/> YES	NO
Is a Public Assembly permit required?	YES	<input checked="" type="radio"/> NO
Are your plans filed with DOB?	<input checked="" type="radio"/> YES	NO

Community Notification/Relations		
<b>NOTIFICATION:</b> List all block associations; tenant associations, co-op boards or condo boards of residential buildings; and community groups that applicant has notified regarding its application. For each please list both the organization and individual you contacted	# 1	
	# 2	
	# 3	
	# 4	
	# 5	
Please provide dates when applicant met with the groups listed above.		
Who was your contact person at each group you met with?		
* When did applicant post the notice that was provided?	8/18/22	
* Where did applicant post the notice that was provided?	FRONT WINDOW + 2 ON THE BLOCK (SEE PHOTOS)	
Will applicant provide owner cell phone number to neighbors and respond to complaints that arise? Please provide number in space provided.	<input checked="" type="radio"/> YES	NO
Will applicant inform the Community Board office of its job openings and/or provide a hyperlink to applicants jobs webpage?	<input checked="" type="radio"/> YES	NO

**BUILDING DESIGN**

State the name and type of business previously located in the space.	RESTAURANT		
Has a liquor-licensed establishment previously occupied this space at any time? If yes, please provide the name of the business.	<input checked="" type="radio"/> YES	<input type="radio"/> NO	FIKA 555 6th Avenue LLC (FIKA)
Do you plan any changes to the existing façade? If yes, please describe.	YES	<input checked="" type="radio"/> NO	EXISTING RESTAURANT
Has the applicant/owner(s) read MCB 4 ADA Guidelines Memo?	<input checked="" type="radio"/> YES	<input type="radio"/> NO	
Is the entrance ADA Compliant?	<input checked="" type="radio"/> YES	<input type="radio"/> NO	
Do you plan any changes to the existing façade? If yes, please describe.	YES	<input checked="" type="radio"/> NO	
Will applicant have a vestibule within the establishment?	YES	<input checked="" type="radio"/> NO	
Will applicant use a storm enclosure?	YES	<input checked="" type="radio"/> NO	
Does applicant agree to keep the sidewalk clear of all items or obstructions, such as sandwich boards, sidewalk signs, freestanding menus and plants, as per the law?	<input checked="" type="radio"/> YES	<input type="radio"/> NO	
Will applicant comply with the NYC noise code?	<input checked="" type="radio"/> YES	<input type="radio"/> NO	
Will the establishment have any of the following: (circle all that apply)	FRENCH DOORS <input checked="" type="radio"/> No	GARAGE DOORS <input checked="" type="radio"/> No	WINDOWS THAT CAN BE OPENED <input checked="" type="radio"/> No
Will applicant close all windows, French doors, garage doors when any music or amplified sound (including televisions) is played inside the establishment?	<input checked="" type="radio"/> YES	<input type="radio"/> NO	
Will applicant close all windows, French doors, garage doors by 11 PM Friday and Saturday and 10 PM on all other days even if no music or amplified sound is played inside the establishment?	<input checked="" type="radio"/> YES	<input type="radio"/> NO	
Has applicant obtained an acoustical report from a certified sound engineer to assess potential noise disturbance to the neighboring residents and buildings?	YES	<input checked="" type="radio"/> NO	
Will applicant follow the recommendations of a certified sound engineer to mitigate potential noise disturbance to the neighboring residents and buildings, including placing speakers on the floor of the establishment?	<input checked="" type="radio"/> YES	<input type="radio"/> NO	IF NEEDED
Will the kitchen exhaust system extend to the roof?	YES	<input checked="" type="radio"/> NO	N/A
Will the establishment have an illuminated sign?	YES	<input checked="" type="radio"/> NO	
Will the establishment have a canopy extending over the sidewalk?	YES	<input checked="" type="radio"/> NO	
Where will the air conditioner be located? What type is it?	EXISTING		
When was the air conditioner installed?	MAY YEARS AGO		

OUTDOOR ITEMS - OTHER THAN SIDEWALK CAFÉ			
Has the applicant/owner(s) read MCB 4 Rear Yard Rooftop Policy?	<input checked="" type="radio"/> YES	<input type="radio"/> NO	
Will applicant use any outdoor spaces: rooftop, rear yard, patio, porch, balcony, pavilion, tents, deck, gazebo or open dining in the parking lane? If yes, which one(s)?	<input checked="" type="radio"/> YES	<input type="radio"/> NO	OPEN RESTAURANT SEATING
Are the floorplans for the outdoor space(s) included?	<input checked="" type="radio"/> YES	<input type="radio"/> NO	PHOTOS
Will applicant close and vacate the outdoor space(s) by 11PM on Friday & Saturday and 10 PM on all other days?	<input checked="" type="radio"/> YES	<input type="radio"/> NO	All outdoor space closed & vacated by 10 p.m. nightly
Will the service and consumption of alcohol in any outdoor space only be via seated food service?	<input checked="" type="radio"/> YES	<input type="radio"/> NO	
Will applicant not allow standing space for patrons to drink or smoke in any outdoor space(s) or on the sidewalk?	<input checked="" type="radio"/> YES	<input type="radio"/> NO	
Will there be no amplified music, as per the law?	<input checked="" type="radio"/> YES	<input type="radio"/> NO	
If amplified sound is played inside the establishment, will windows and doors be closed?	<input checked="" type="radio"/> YES	<input type="radio"/> NO	
Will applicant agree to post signs outside asking customers to respect the neighbors?	<input checked="" type="radio"/> YES	<input type="radio"/> NO	
Will applicant agree to train staff to encourage a peaceful environment?	<input checked="" type="radio"/> YES	<input type="radio"/> NO	
Will applicant provide effective sound control (landscaping enclosure, soundproofing tenants apartments)	<input type="radio"/> YES	<input type="radio"/> NO	IF NEEDED
Will there be a lighting plan that allows safe usage of the outdoor space without disrupting neighbors?	<input checked="" type="radio"/> YES	<input type="radio"/> NO	
If open dining in the parking lane, will applicant agree to leave the sidewalk free of any furniture?	<input checked="" type="radio"/> YES	<input type="radio"/> NO	
If open dining, will you comply with all NYC DOT guidelines?	<input checked="" type="radio"/> YES	<input type="radio"/> NO	
If open dining, will the installation be year-round?	<input checked="" type="radio"/> YES	<input type="radio"/> NO	



**DCA APPROVED UNENCLOSED SIDEWALK CAFÉ**

Has the applicant/owner(s) read MCB4 Sidewalk Café Policy?	<input checked="" type="radio"/> YES	<input type="radio"/> NO	
Will applicant be applying for a sidewalk café now or in the future?	<input checked="" type="radio"/> YES	<input type="radio"/> NO	IN THE FUTURE
Is applicant in this application seeking to include a sidewalk café in its liquor license?	<input type="radio"/> YES	<input checked="" type="radio"/> NO	
If yes, has applicant submitted an application and plans to NYC Dept. of Consumer Affairs? Please attach application and plans.	<input type="radio"/> YES	<input type="radio"/> NO	N/A
Will applicant close and vacate the sidewalk café by 11 PM on Friday & Saturday and 10 PM on all other days?	<input type="radio"/> YES	<input type="radio"/> NO	N/A
Will applicant be serving alcohol in the sidewalk café? If so, will you have waiter service?	<input type="radio"/> YES	<input type="radio"/> NO	N/A
Will the café have a 3 ft. wide serving aisle running the entire length of the sidewalk café?	<input type="radio"/> YES	<input type="radio"/> NO	N/A
Will applicant mark the perimeter of the café on the sidewalk?	<input type="radio"/> YES	<input type="radio"/> NO	N/A
Will the service and consumption of alcohol in the sidewalk café only be via seated food service?	<input type="radio"/> YES	<input type="radio"/> NO	N/A
Will the sidewalk café not provide standing space for drinking or smoking?	<input type="radio"/> YES	<input type="radio"/> NO	N/A
Will applicant use any portable natural gas heaters? If so, do you have the requisite approvals from DOB & the Fire Department?	<input type="radio"/> YES	<input type="radio"/> NO	N/A
Will applicant have a lighting plan that will allow safe usage of the outdoor space without disrupting neighbors?	<input type="radio"/> YES	<input type="radio"/> NO	N/A
Will all furniture, plants and barricades be stored inside between the evening closing hours and the morning opening hours?	<input type="radio"/> YES	<input type="radio"/> NO	N/A
Will all furniture be stored inside between December 21 <sup>st</sup> and March 21 <sup>st</sup> , and any other day when it rains or snows?	<input type="radio"/> YES	<input type="radio"/> NO	N/A
Will applicant use umbrellas?	<input type="radio"/> YES	<input type="radio"/> NO	N/A
If construction or construction protection has reduced the sidewalk width, will applicant always maintain an 8 foot clear path of sidewalk between the perimeter of the café and the closest obstruction including construction barricades?	<input type="radio"/> YES	<input type="radio"/> NO	N/A
If open dining is in the parking lane, will applicant agree to remove its sidewalk café?	<input type="radio"/> YES	<input type="radio"/> NO	N/A

**ADDITIONAL STIPULATIONS: (Office Use Only)**

- All Open Restaurants outdoor seating will be in roadway only and not the sidewalk. All outdoor seating will be closed and vacated of patrons no later than 10 p.m. nightly

***To the extent any additional stipulation on pages 7 and 8 of this application conflicts with any response on pages 1 – 6 of this application, the stipulations on pages 7 and 8 control.***

**ADDITIONAL STIPULATIONS: (Office Use Only), *Continued***

***To the extent any additional stipulation on pages 7 and 8 of this application conflicts with any response on pages 1 – 6 of this application, the stipulations on pages 7 and 8 control.***



Manhattan Community Board 4 (MCB4) recommends:  
 (MCB4's recommendation is based on a vote taken at its  
 October 6, 2022 full board meeting, with 37 members voting in favor  
 of the recommendation, 0 members opposed, 0 members  
 abstaining and 0 present but not eligible)

Denial unless all stipulations agreed to by applicant/owner are part of the method of operation  
 Denial  Approval

**CB4 REPRESENTATIVES**

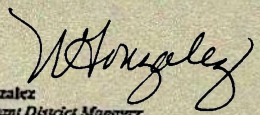
  
 Nelly Gonzalez  
 CB4 Assistant District Manager

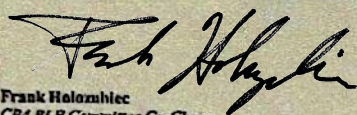
  
 Frank Holomahlec  
 CB4 BLP Committee Co-Chair

  
 Burt Lazarin  
 CB4 BLP Committee Co-Chair

**APPLICANT AGREEMENT WITH THE COMMUNITY**

Applicant agrees to these stipulations as the basis for the community support of this application and acknowledges that all of these stipulations are essential prerequisites to the MCB4 recommendation regarding this application. Applicant agrees to have these stipulations incorporated in the method of operation of its liquor license. The stipulations in this application constitute the entire agreement between MCB4 and applicant and may only be altered in writing signed by MCB4 and applicant. These stipulations supersede any oral statements or representations in connection with this application.

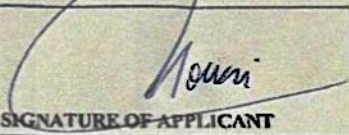
SIGN HERE →	LEANDRO ONSARI PRINT NAME OF APPLICANT	 SIGNATURE OF APPLICANT	08-10-2022 DATE
-------------	---	---	--------------------



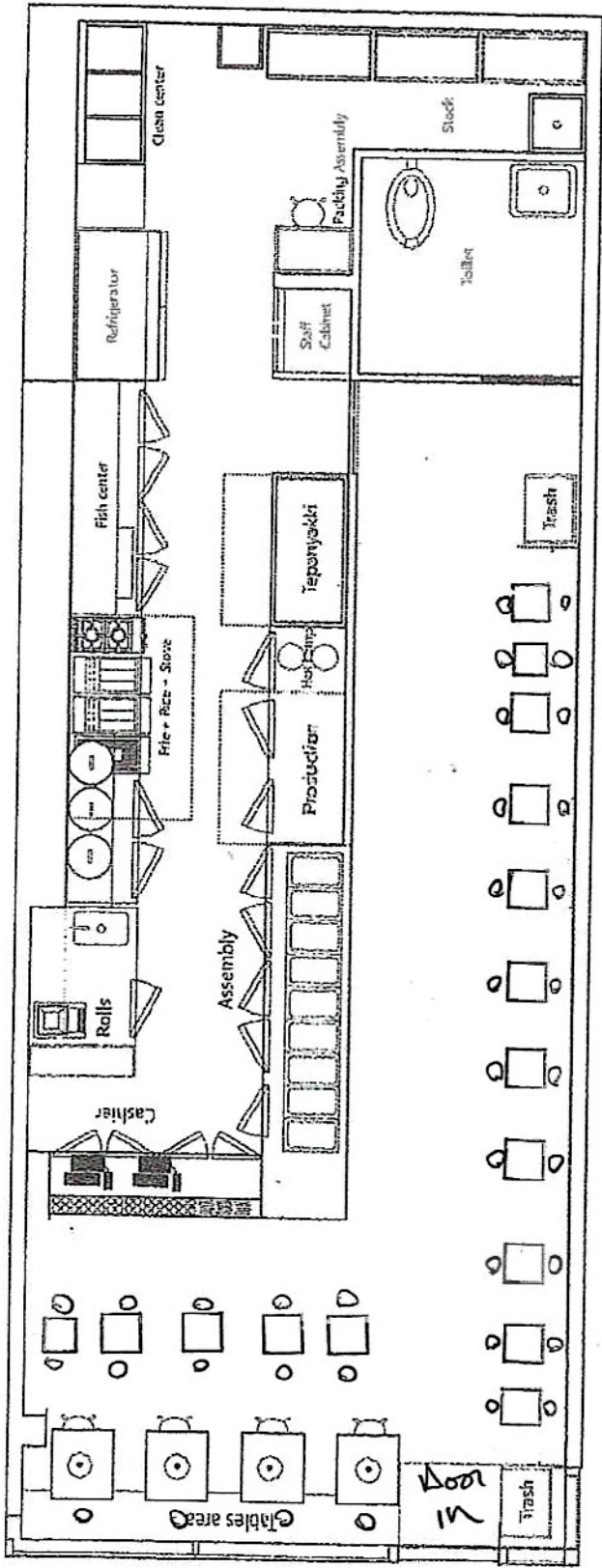

Inside  
 20 Tables  
 40 SEATS

OUTDOOR STREET SEATING

12 Tables  
 24 SEATS

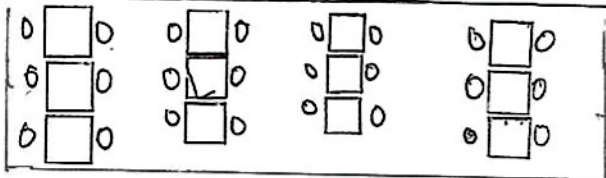

Street Seating

# 1 SUSHI

## SUSHI ROLLS

CHOOSE YOUR ROLLS \$2 *per piece*

### CALIFORNIA

SALMON AVOCADO

### SPICY TUNA

CRUNCHY SPICY SALMON

### CLASSIC ROLLS

CALIFORNIA

12

SALMON AVOCADO

12

CRAB

10

SHRIMP

12

CUCUMBER

10

SPICY TUNA

12

PHILADELPHIA

12

SPICY SALMON

12

### HAND ROLL

CALIFORNIA

5

YELLOW TAIL SCALLION

6

SPICY CRAB

6

SHRIMP CUCUMBER

5

TUNA AVOCADO

6

WHITE TUNA AVOCADO

6

SALMON AVOCADO

6

SALMON SKIN

5

SPICY TUNA

5

## SPECIALITY ROLLS

8 pieces

### SCALLOP FIRE

Torched scallop, truffle butter, lime

18

### CEVICHE ROLL

Avocado, shrimp furai, white fish, ceviche sauce, furikake

18

### DRAGON ROLL

Crab, cucumber, eel, avocado, eel sauce on top

14

### VEGGIE ROLL

Smoked mushrooms, crispy sweet potato, scallion, yuzu soy, eel sauce

14

### GEISHA ROLL

Tamago skin, salmon, cream cheese, teriyaki, sauce on top

16

### LIME SALMON

Crispy shrimp, cream cheese, salmon slices and lime

16

### SPICY TAO

Salmon, avocado, cream cheese, siracha sauce

16

### CRUNCHY SHRIMP ROLL

Shrimp cucumber, crab, tempura crumbs

14



# 1 SUSHI

## STARTERS

<b>GYOZA</b> (x6) Pork or veggie	6	<b>SALMON CARPACCIO</b> Soy ginger, passion fruit reduction, tempura flakes	16
<b>SPICY TUNA</b> Japanese style, soy ginger sauce	18	<b>CRISPY ROCK SHRIMP</b> Honey glaze, scallion, chipotle mayo	18
<b>CRISPY RICE</b> (x6) Tuna tartar, jalapeño, scallion, eel sauce	14	<b>GRILL OCTOPUS</b> Siracha spice marinade, scallion, yuzu, lemon	20
<b>SHRIMP TEMPURA</b> Ponzu, ginger, scallion	16	<b>WAKAME</b> Japanese seaweed salad	8
<b>VEGGIE TEMPURA</b> Ponzu, ginger, scallion	14		

### SUSHI

*2 nigiri pieces per order*

<b>ALBACORE</b> Ponzu and chives	6
<b>BAY SCALLOPS</b> Yuzu ponzu	7
<b>JAPANESE YELLOWTAIL</b> Lemon	7
<b>TUNA</b>	6
<b>SALMON</b> Toasted sesame	6

### SASHIMI

*2 pieces per order*

<b>TUNA</b>	6
<b>SALMON</b>	6
<b>JAPANESE YELLOWTAIL</b>	7
<b>BAY SCALLOPS</b>	7
<b>SHRIMP</b>	6

## MAINS

<b>TUNA TATAKI</b> Seared tuna, ginger soy sauce, scallion	18	<b>YELLOW FIN TUNA</b> Ponzu, jalapeño, Rocoto yuzu sauce	20
<b>CHICKEN TERIYAKI</b> Served with mushroom, Zucchini, onions, carrots, sesame seeds and white rice	16	<b>JAPANESE FRIED RICE (yakimeshi)</b> +3 Beef or shrimp Choice of chicken, beef or shrimp, onions, carrots, peas, scallion, egg, garlic butter, soy sauce	14
<b>BEEF TERIYAKI</b> Served with mushroom, Zucchini, onions, carrots, sesame seeds and white rice	18	<b>NIKKEI</b> Tuna, soy ginger dressing, sesame oil, scallion	20

*Certificate of Occupancy*

**CO Number: 120635465T024**

This certifies that the premises described herein conforms substantially to the approved plans and specifications and to the requirements of all applicable laws, rules and regulations for the uses and occupancies specified. No change of use or occupancy shall be made unless a new Certificate of Occupancy is issued. *This document or a copy shall be available for inspection at the building at all reasonable times.*

<b>A.</b>	<b>Borough:</b> Manhattan	<b>Block Number:</b> 00791	<b>Certificate Type:</b> Temporary
	<b>Address:</b> 555 6TH AVE	<b>Lot Number(s):</b> 36	<b>Effective Date:</b> 02/05/2021
	<b>Building Identification Number (BIN):</b> 1014560	<b>Building Type:</b> Altered	<b>Expiration Date:</b> 05/06/2021
<b>This building is subject to this Building Code: 2008 Code</b>			
<i>For zoning lot metes &amp; bounds, please see BISWeb.</i>			
<b>B.</b>	<b>Construction classification:</b> 2-B	(1968 Code designation)	
	<b>Building Occupancy Group classification:</b> R-2	(2014/2008 Code)	
	<b>Multiple Dwelling Law Classification:</b> HAEA		
	<b>No. of stories:</b> 6	<b>Height in feet:</b> 62	<b>No. of dwelling units:</b> 163
<b>C.</b>	<b>Fire Protection Equipment:</b> Fire alarm system, Sprinkler system		
<b>D.</b>	<b>Type and number of open spaces:</b> None associated with this filing.		
<b>E.</b>	<b>This Certificate is issued with the following legal limitations:</b> None		
<b>Outstanding requirements for obtaining Final Certificate of Occupancy:</b>			
There are 23 outstanding requirements. Please refer to BISWeb for further detail.			
<b>Borough Comments:</b> None			



Borough Commissioner

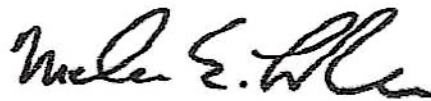

Commissioner



*Certificate of Occupancy*

CO Number: 120635465T024

**Permissible Use and Occupancy**

All Building Code occupancy group designations below are 2008 designations.

Floor From To	Maximum persons permitted	Live load lbs per sq. ft.	Building Code occupancy group	Dwelling or Rooming Units	Zoning use group	Description of use
CEL	88	OG	A-3			PHYSICAL CULTURE ESTABLISHMENT
CEL	66	150	R-2		0	LOUNGE (ACCESSORY TO RESIDENTIAL OCCUPANCY)
CEL	66	150	R-2		0	MULTI-PURPOSE ROOM, PATIO, OFFICE, STORAGE ROOMS (ACCESSORY TO RESIDENTIAL)
CEL	110	100	M		6	RETAIL STORE IN CONJUNCTION WITH FIRST FLOOR
SUB	15	OG	S-2		2	STORAGE, ACCESSORY AND ATTENDANT GARAGES FOR NINETY (90) CARS, BIKE PARKING
SUB		OG	F-2		2	METER ROOM, BOILER ROOM, REFUSE ROOM, COMPACTOR ROOM, STORAGE, LOCKER ROOM, SUPERINTENDENT'S, WORKSHOP, PUMP ROOM
001	370	100	M		6	RETAIL STORES (IN CONJUNCTION WITH CELLAR)
001	98	100	A-3			PHYSICAL CULTURE ESTABLISHMENT
001		40	R-2	13	2	THIRTEEN (13) APARTMENTS AND LOBBY
002 006		40	R-2	30	2	THIRTY (30) CLASS 'A' APARTMENTS ON EACH FLOOR
ROF		100	R-2		2	MECHANICAL/BULKHEAD

THAT THE TERM OF THE PCE GRANT WILL EXPIRE ON MAY 20, 2024; THAT THERE WILL BE NO CHANGE IN OWNERSHIP OR OPERATING CONTROL OF THE PCE WITHOUT PRIOR APPLICATION TO AND APPROVAL FROM THE BOARD; THAT THE HOURS OF OPERATION FOR THE PCE WILL BE LIMITED TO MONDAY THROUGH FRIDAY, FROM 5:00A.M. TO 11:00 P.M. AND SATURDAY AND SUNDAY, FROM 8:00A.M. TO 11:00P.M.; THAT LOCAL LAW 58/87 COMPLIANCE WILL BE AS REVIEWED AND APPROVED BY DOB; THAT FIRE SAFETY MEASURES WILL BE INSTALLED AND/OR MAINTAINED AS SHOWN ON THE BOARD-APPROVED PLANS; THAT THE ABOVE CONDITIONS WILL APPEAR ON THE CERTIFICATE OF OCCUPANCY;

END OF SECTION



Borough Commissioner

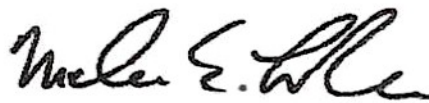

Commissioner

END OF DOCUMENT



This report is for informational purposes only in aid of identifying establishments potentially subject to 500 and 200 foot rules. Distances are approximated using industry standard GIS techniques and do not reflect actual distances between points of entry. The NYS Liquor Authority makes no representation as to the accuracy of the information and disclaims any liability for errors.

Proximity Report For:	
Location	<b>555 6th Ave, New York, New York, 10011</b>
Geocode	<b>Latitude: 40.73837 longitude: -73.99619</b>
Report Generated On	<b>2/10/2022</b>

8 Closest Liquor Stores		
Name	Address	Distance
WINE GALLERY INC,THE Ser #: 1023576	576 6TH AVENUE NEW YORK, NY 10011	204 ft
MAYURA INC Ser #: 1267883	52 W 14TH ST NEW YORK, NY 10011	657 ft
CHELSEA WINE COUNTRY INC Ser #: 1196366	86 7TH AVENUE 15TH ST. & 16TH STS. NEW YORK, NY 10011	898 ft
LE GARREC NYC LLC Ser #: 1303313	111 W 20TH ST NEW YORK, NY 10011	1,145 ft
MAHADEV INC Ser #: 1265163	242 W 14TH ST NEW YORK, NY 10011	1,327 ft
BOTTLEROCKET WINE & SPIRIT LLC Ser #: 1165680	5 W 19TH STREET 5TH & 6TH AVENUES NEW YORK, NY 10011	1,341 ft
VILLAGE WINE CELLAR INC Ser #: 1288335	448 AVENUE OF THE AMERICAS NEW YORK, NY 10011	1,375 ft
FARMERS FIZZ LLC Ser #: 1266747	35 1/2 GREENWICH AVE NEW YORK, NY 10014	1,607 ft

Schools within 500 feet		
Name	Address	Distance
SIXTH AVENUE ELEMENTARY SCHOOL	64 W 17TH ST NEW YORK, NY 10011	361 ft
WINSTON PREPARATORY SCHOOL	126 W 17TH ST NEW YORK, NY 10011	433 ft

Schools within 500 feet		
Name	Address	Distance
XAVIER HIGH SCHOOL	30 W 16TH ST NEW YORK, NY 10011	473 ft

Churches within 500 feet	
Name	Distance
French Evangelical Church	374 ft
Ephesians Mennonite Church	397 ft
Iglesiacristiana Pentecostal Monte Sion	461 ft
St Francis Xavier Church	492 ft

Pending On Premises Liquor Licenses within 750 feet		
Name	Address	Distance
GV WINGS LLC Ser #: 1336295	103 W 14TH ST NEW YORK, NY 10011	374 ft
TWO GUYS AND A FISH TANK LLC Ser #: 1340676	105 W 13TH ST NEW YORK, NY 10011	662 ft
BONITO RESTAURANT LLC Ser #: 1339670	31 W 17TH ST NEW YORK, NY 10011	670 ft
SWEET 101 LLC Ser #: 1340322	29 W 17TH ST NEW YORK, NY 10011	687 ft

Active On Premises Liquor Licenses within 750 feet		
Name	Address	Distance
SMJ PARTNERS LLC Ser #: 1318056	545 6TH AVE NEW YORK, NY 10011	207 ft
DA UMBERTO RESTAURANT INC Ser #: 1024870	107 W 17TH STREET NEW YORK, NY 10011	410 ft
17 PRIME INC Ser #: 1322465	111 W 17TH ST NEW YORK, NY 10011	461 ft
FTG COMPANY USA INC Ser #: 1286191	37 W 17TH ST NEW YORK, NY 10011	633 ft
UNDER CHELSEA LLC Ser #: 1209785	48 W 17TH STREET NEW YORK, NY 10011	666 ft
PORTAL HOSPITALITY LLC Ser #: 1319298	126 W 18TH ST NEW YORK, NY 10011	689 ft

Active On Premises Liquor Licenses within 750 feet

Name	Address	Distance
N & J SALAM CORP Ser #: 1024932	104 W 13TH STREET NEW YORK, NY 10011	718 ft
CHIPOTLE MEXICAN GRILL OF COLORADO LLC Ser #: 1272679	504 6TH AVE NEW YORK, NY 10011	725 ft
PIPPO PLUTO PAPERINO INC Ser #: 1105164	126 W 13TH ST NEW YORK, NY 10011	731 ft
ZESTFUL MANAGEMENT CORP Ser #: 1024991	502 AVE OF THE AMERICAS NEW YORK, NY 10011	744 ft





SUSHI



SUSHI



SPOTTERS THROUGHOUT BUILDING

SMALL BUSINESS  
SUPPORT & GROWTH  
COUNCIL OF THE TRIANGLE



OPEN







JEFFREY LEFRANCIOS  
Chair

JESSE BODINE  
District Manager

CITY OF NEW YORK  
MANHATTAN COMMUNITY BOARD No. 4  
424 W 33rd Street, Suite 550, New York, NY 10001  
tel. 212-735-4500  
<https://c4m.manhattan.cityofnewyork.us/>

## PUBLIC NOTICE

Business Licenses and Permits Committee  
will discuss an application submitted by

**Sushi1 LLC**  
**555 6th Avenue**

A New Wine, Beer & Cider Application for a  
Restaurant Establishment with Recorded Music, Live  
Music (Jazz)

**DATE:** Tuesday, September 13, 2022  
**TIME:** 6:30 PM  
**PLACE:** Video/Phone Conference Registration:  
[https://zoom.us/webinar/register/WN\\_666SX3vS6HVC4hBstV4d](https://zoom.us/webinar/register/WN_666SX3vS6HVC4hBstV4d)

We invite you to attend this meeting and learn more about this application.  
Alternately, you may email your comments by 12 p.m. Monday, September 12,  
2022 or for more information, please email Assistant District Manager Kelly  
Gonzalez: [kgonzalez@cp.ny.gov](mailto:kgonzalez@cp.ny.gov)

Posted according to the Administrative Code of the City of New York section 24-  
119. Please do not remove until after the above meeting date.





JEFFREY LEFRANCOIS  
Clerk

JESSE BICONE  
District Manager

CITY OF NEW YORK

MANHATTAN COMMUNITY BOARD No. 4

424 W 33<sup>rd</sup> Street, Suite 580 New York, NY 10001  
tel: 212-736-4536

<https://www.manhattan.cibofnyc.gov/cb4/>

## PUBLIC NOTICE

Business Licenses and Permits Committee  
will discuss an application submitted by

**Sushi1 LLC**

**555 6<sup>th</sup> Avenue**

A New Wine, Beer & Cider Application for a  
Restaurant Establishment with Recorded Music, Live  
Music (Jazz)

DATE:

Tuesday, September 13, 2022

TIME:

6:30 PM

PLACE:

Video/Phone Conference Registration:  
[https://zoom.us/webinar/register/WN\\_66-6SX3vS\\_6HVC2bBstV3A](https://zoom.us/webinar/register/WN_66-6SX3vS_6HVC2bBstV3A)

We invite you to attend this meeting and learn more about this application.  
Alternatively, you may email your comments by 12 p.m. Monday, September 12,  
2022 or for more information, please email Assistant District Manager Nelly  
Gonzalez [negonzalez@cb.nyc.gov](mailto:negonzalez@cb.nyc.gov).

Posted according to the Administrative Code of the City of New York section 10-119. Please do not remove until after the above meeting date.



103254

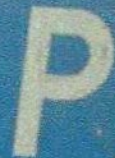

103254

PARENYC



Address \_\_\_\_\_  
Borough \_\_\_\_\_ Zip Code \_\_\_\_\_

For additional information  
or a copy of an inspection  
report, call 311 or visit  
[nyc.gov/health](http://nyc.gov/health)



JEFFREY LEFRANCIOS  
Chair

JESSE BODINE  
District Manager

CITY OF NEW YORK  
MANHATTAN COMMUNITY BOARD No. 4  
424 W 33<sup>rd</sup> Street, Suite 580 New York, NY 10001  
tel: 212-736-4536  
<https://cbmanhattan.cityofnewyork.us/cb4/>

## PUBLIC NOTICE

Business Licenses and Permits Committee  
will discuss an application submitted by

**Sushi1 LLC**  
**555 6<sup>th</sup> Avenue**

A New Wine, Beer & Cider Application for a  
Restaurant Establishment with Recorded Music, Live  
Music (Jazz)

<b>DATE:</b>	Tuesday, September 13, 2022
<b>TIME:</b>	<b>6:30 PM</b>
<b>PLACE:</b>	<b>Video/Phone Conference Registration:</b> <a href="https://zoom.us/webinar/register/WN_66-6SX3vS_6HVC2bBstV3A">https://zoom.us/webinar/register/WN_66-6SX3vS_6HVC2bBstV3A</a>

We invite you to attend this meeting and learn more about this application.  
Alternately, you may email your comments by 12 p.m. Monday, September 12,  
2022 or for more information, please email Assistant District Manager Nelly  
Gonzalez [negonzalez@cb.nyc.gov](mailto:negonzalez@cb.nyc.gov).

*Posted according to the Administrative Code of the City of New York section 10-119. Please do not remove until after the above meeting date.*