

GIFT NEW YORK NO. 3 LLC
383 WEST 31ST STREET
NEW YORK, NY 10001

MANHATTAN COMMUNITY BOARD 4

Manhattan Community Board 4

Liquor License/Sidewalk Cafe Stipulations Application

(All Fields Must Be Completed)

CORPORATION NAME				DOING BUSINESS AS (DBA)			
Gift New York No. 3 LLC				E.A.K. Ramen			
STREET ADDRESS				CROSS STREETS		ZIP CODE	
383 West 31st Street				8th Avenue & 9th Avenue		10001	
OWNER <small>(Attach a list of all the people that will be associated/listed with the license)</small>	NAME:	Sho Tagawa	Tatsuya Sasajima	ATTORNEY/ REPRESENTAIVE	NAME:	Heather Kirk.	
	PHONE:	042-860-7182	090-2436-9744		PHONE:	(212) 219-1193	
	EMAIL:	tagawa.sho@gift-group.co.jp	sasajima.t@gift-group.co.jp		EMAIL:	heather@helbraunlevey.com	
MANAGER	NAME:	Taiyoshi Saito		LANDLORD	NAME:	James A. Farley Condominium / Moynihan Train Hall	
	PHONE:	718-925-1753			PHONE:	332-236-5092	
	EMAIL:	saito.taiyoshi@gift-group.co.jp			EMAIL:		
APPLICATION TYPE (<input checked="" type="checkbox"/> <i>Liquor License</i> _____ <i>Unenclosed Sidewalk Cafe</i>)							
<input checked="" type="radio"/> New	Has applicant owned or managed a similar business?			<input checked="" type="checkbox"/> YES	<input type="checkbox"/> NO		
	What is/was the name and address of establishment?			Gift New York LLC, 469 6th Avenue, NY, NY 10011 Gift New York No. 2 LLC, 360 W 46th Street, New York, NY 10036			
	What were the dates applicant was involved with this former premise?			09/01/2016, 10/25/2019			
<input type="radio"/> Corp Change/Class Change/Removal	What is the license # and expiration date?						
	Is applicant making any alterations or operational changes?			<input checked="" type="checkbox"/> YES	<input type="checkbox"/> NO		
	<i>If alterations or operational changes are being made, please describe/list all changes.</i>						
<input type="radio"/> Alteration	What is the current license # and expiration date?						
	<i>Please list/describe the nature of all the changes and attach the plans:</i>						
METHOD OF OPERATION							
TYPE OF ALCOHOL	<input type="radio"/> Liquor/Wine/Beer & Cider		<input checked="" type="radio"/> Beer & Cider		<input type="radio"/> Wine/Beer & Cider		
ESTABLISHMENT TYPE	<input checked="" type="radio"/> Restaurant <input type="radio"/> Cabaret <input type="radio"/> Night Club <input type="radio"/> Hotel <input type="radio"/> Bar/Tavern <input type="radio"/> Catering Establishment <input type="radio"/> Adult Entertainment <input type="radio"/> Wine Bar <input type="radio"/> Dance Club <input type="radio"/> Sports Bar <input type="radio"/> Club (Fraternal Organization – Members Only)						
Has applicant/owner filed with the SLA? If yes, when? If no, when do you plan to file?				<input type="checkbox"/> YES	<input checked="" type="checkbox"/> NO	After CB Meeting.	
Is the 500 Foot Rule applicable? If yes, please attach a diagram of the On-Premise liquor license establishments within a 500 ft. radius of your establishment and the Public Interest Statement.				<input checked="" type="checkbox"/> YES	<input type="checkbox"/> NO	Please see the attached	
Is the 200 Foot Rule applicable? If yes, please attach a diagram of the schools and houses of worship that trigger the rule.				<input type="checkbox"/> YES	<input checked="" type="checkbox"/> NO		
Has applicant/owner(s) read MCB4 Policy Regarding Concentration and Location of Alcoholic-Serving Establishments?				<input checked="" type="checkbox"/> YES	<input type="checkbox"/> NO		

OPERATIONAL DETAILS (*Closing time will be when establishment is vacated of all patrons)

HOURS* <i>(Indoor Only)</i>		MONDAY	TUESDAY	WEDNESDAY	THURSDAY	FRIDAY	SATURDAY	SUNDAY
	Operation	10:00 am-12:00 am	10:00 am-12:00 am	10:00 am-12:00 am	10:00 am-12:00 am	10:00 am-12:00 am	10:00 am-12:00 am	10:00 am-12:00 am
	Kitchen	10:00 am-12:00 am	10:00 am-12:00 am	10:00 am-12:00 am	10:00 am-12:00 am	10:00 am-12:00 am	10:00 am-12:00 am	10:00 am-12:00 am
	Music	Music will be played in common food hall						
If you plan to have music, what type(s)? (Circle all that apply)			<input checked="" type="checkbox"/> BACKGROUND	<input type="checkbox"/> LIVE MUSIC	<input type="checkbox"/> DJ	<input type="checkbox"/> JUKE BOX	<input type="checkbox"/> KARAOKE	

OCCUPANCY

	Capacity (Certificate of Occupancy)	Maximum # of Persons Occupying Premises (Including Employees)	Number of Tables	Number of Seats	Number of Service Only Bars	Number of Stand-Up Bars	Number of Seats at Stand-Up Bar
INSIDE	Appx. 400	Appx. 400	41	171	0	1	
OUTSIDE <i>(Other than sidewalk café)</i>							
DCA APPROVED UNENCLOSED SIDEWALK CAFÉ							

How many floors are there? What is the capacity for each floor?	Ground Floor	
How frequently will the owner(s) be at the establishment?	All open hours	
Will there be dancing?	YES	<input type="checkbox"/> NO
Will applicant have bottle or table service for beverage alcohol?	YES	<input type="checkbox"/> NO
Will applicant be hosting private; promotional or corporate events?	YES	<input type="checkbox"/> NO
Will outside promoters be used on a regular basis? If yes please describe.	YES	<input type="checkbox"/> NO
Will applicant have a security plan? If, yes please attach.	YES	<input type="checkbox"/> NO
Will security plan be implemented?	YES	<input type="checkbox"/> NO
Will State certified security personnel be used?	YES	<input type="checkbox"/> NO
Will New York Nightlife Association and NYPD Best Practices be followed?	<input checked="" type="checkbox"/> YES	NO
Does applicant agree to notify MCB4 prior to making changes to its method of operation?	<input checked="" type="checkbox"/> YES	NO
Will applicant be using delivery bicycles? If yes, how many?	<input type="checkbox"/>	NO
Will delivery bicycles be clearly marked with the name of the restaurant and will staff wear attire clearly noting name as described by NYC Law?	<input checked="" type="checkbox"/> YES	NO
Where will delivery bicycles be stored during the day when not in use?	Using third party apps	

LOCATION & ZONING

Is this a Special District? If yes, is it Clinton, West Chelsea or Hudson Yards?	YES	<input checked="" type="checkbox"/> NO	
Does the building have a Certificate of Occupancy ("C of O") or a letter of no objection?	YES	NO	Pending
Is a Public Assembly permit required?	<input checked="" type="checkbox"/> YES	NO	
Are your plans filed with DOB?	<input checked="" type="checkbox"/> YES	NO	

Community Notification/Relations

NOTIFICATION: List all block associations; tenant associations, co-op boards or condo boards of residential buildings; and community groups that applicant has notified regarding its application. For each please list both the organization and individual you contacted	# 1	Please see Email sent to community board association groups.	
	# 2		
	# 3		
	# 4		
	# 5		
Please provide dates when applicant met with the groups listed above.		N/A	
Who was your contact person at each group you met with?		N/A	
When did applicant post the notice that was provided?		8/29/22	
Where did applicant post the notice that was provided?		Pending	
Will applicant provide owner cell phone number to neighbors and respond to complaints that arise? Please provide number in space provided.		<input checked="" type="checkbox"/> YES	NO
Will applicant inform the Community Board office of its job openings and/or provide a hyperlink to applicants jobs webpage?		<input checked="" type="checkbox"/> YES	NO

BUILDING DESIGN			
State the name and type of business previously located in the space.	Vacant Retail Space		
Has a liquor-licensed establishment previously occupied this space at any time? If yes, please provide the name of the business.	YES	<input type="checkbox"/> NO	
Do you plan any changes to the existing façade? If yes, please describe.	YES	<input type="checkbox"/> NO	
Has the applicant/owner(s) read MCB 4 ADA Guidelines Memo?	<input checked="" type="checkbox"/> YES	NO	
Is the entrance ADA Compliant?	<input checked="" type="checkbox"/> YES	NO	
Do you plan any changes to the existing façade? If yes, please describe.	YES	<input type="checkbox"/> NO	
Will applicant have a vestibule within the establishment?	YES	<input type="checkbox"/> NO	
Will applicant use a storm enclosure?	YES	<input type="checkbox"/> NO	
Does applicant agree to keep the sidewalk clear of all items or obstructions, such as sandwich boards, sidewalk signs, freestanding menus and plants, as per the law?	<input checked="" type="checkbox"/> YES	NO	N/A- No Sidewalk
Will applicant comply with the NYC noise code?	<input checked="" type="checkbox"/> YES	NO	
Will the establishment have any of the following: (circle all that apply)	FRENCH DOORS		GARAGE DOORS
	WINDOWS THAT CAN BE OPENED		
Will applicant close all windows, French doors, garage doors when any music or amplified sound (including televisions) is played inside the establishment?	YES	NO	N/A- Food Hall
Will applicant close all windows, French doors, garage doors by 11 PM Friday and Saturday and 10 PM on all other days even if no music or amplified sound is played inside the establishment?	YES	NO	N/A- Food Hall
Has applicant obtained an acoustical report from a certified sound engineer to assess potential noise disturbance to the neighboring residents and buildings?	YES	<input type="checkbox"/> NO	
Will applicant follow the recommendations of a certified sound engineer to mitigate potential noise disturbance to the neighboring residents and buildings, including placing speakers on the floor of the establishment?	YES	NO	N/A- Food Hall
Will the kitchen exhaust system extend to the roof?	<input checked="" type="checkbox"/> YES	NO	
Will the establishment have an illuminated sign?	<input checked="" type="checkbox"/> YES	NO	
Will the establishment have a canopy extending over the sidewalk?	YES	<input type="checkbox"/> NO	
Where will the air conditioner be located? What type is it?	Food Hall		
When was the air conditioner installed?	N/A		

OUTDOOR ITEMS - OTHER THAN SIDEWALK CAFÉ**N/A**

Has the applicant/owner(s) read MCB 4 Rear Yard Rooftop Policy?	YES	NO	
Will applicant use any outdoor spaces: rooftop, rear yard, patio, porch, balcony, pavilion, tents, deck, gazebo or open dining in the parking lane? If yes, which one(s)?	YES	NO	
Are the floorplans for the outdoor space(s) included?	YES	NO	
Will applicant close and vacate the outdoor space(s) by 11PM on Friday & Saturday and 10 PM on all other days?	YES	NO	
Will the service and consumption of alcohol in any outdoor space only be via seated food service?	YES	NO	
Will applicant not allow standing space for patrons to drink or smoke in any outdoor space(s) or on the sidewalk?	YES	NO	
Will there be no amplified music, as per the law?	YES	NO	
If amplified sound is played inside the establishment, will windows and doors be closed?	YES	NO	
Will applicant agree to post signs outside asking customers to respect the neighbors'?	YES	NO	
Will applicant agree to train staff to encourage a peaceful environment?	YES	NO	
Will applicant provide effective sound control (landscaping enclosure, soundproofing tenants apartments)	YES	NO	
Will there be a lighting plan that allows safe usage of the outdoor space without disrupting neighbors?	YES	NO	
If open dining in the parking lane, will applicant agree to leave the sidewalk free of any furniture?	YES	NO	
If open dining, will you comply with all NYC DOT guidelines?	YES	NO	
If open dining, will the installation be year-round?	YES	NO	

DCA APPROVED UNENCLOSED SIDEWALK CAFÉ**N/A**

Has the applicant/owner(s) read MCB4 Sidewalk Café Policy?	YES	NO	
Will applicant be applying for a sidewalk café now or in the future?	YES	NO	
Is applicant in this application seeking to include a sidewalk café in its liquor license?	YES	NO	
If yes, has applicant submitted an application and plans to NYC Dept. of Consumer Affairs? Please attach application and plans.	YES	NO	
Will applicant close and vacate the sidewalk café by 11 PM on Friday & Saturday and 10 PM on all other days?	YES	NO	
Will applicant be serving alcohol in the sidewalk café? If so, will you have waiter service?	YES	NO	
Will the café have a 3 ft. wide serving aisle running the entire length of the sidewalk cafe?	YES	NO	
Will applicant mark the perimeter of the café on the sidewalk?	YES	NO	
Will the service and consumption of alcohol in the sidewalk café only be via seated food service?	YES	NO	
Will the sidewalk café not provide standing space for drinking or smoking?	YES	NO	
Will applicant use any portable natural gas heaters? If so, do you have the requisite approvals from DOB & the Fire Department?	YES	NO	
Will applicant have a lighting plan that will allow safe usage of the outdoor space without disrupting neighbors?	YES	NO	
Will all furniture, plants and barricades be stored inside between the evening closing hours and the morning opening hours?	YES	NO	
Will all furniture be stored inside between December 21 st and March 21 st , and any other day when it rains or snows?	YES	NO	
Will applicant use umbrellas?	YES	NO	
If construction or construction protection has reduced the sidewalk width, will applicant always maintain an 8 foot clear path of sidewalk between the perimeter of the café and the closest obstruction including construction barricades?	YES	NO	
If open dining is in the parking lane, will applicant agree to remove its sidewalk café?	YES	NO	

ADDITIONAL STIPULATIONS: (Office Use Only)

To the extent any additional stipulation on pages 7 and 8 of this application conflicts with any response on pages 1 – 6 of this application, the stipulations on pages 7 and 8 control.

ADDITIONAL STIPULATIONS: (Office Use Only), *Continued*

To the extent any additional stipulation on pages 7 and 8 of this application conflicts with any response on pages 1 – 6 of this application, the stipulations on pages 7 and 8 control.

Manhattan Community Board 4 (MCB4) recommends:
 (MCB4's recommendation is based on a vote taken at its
 October 6, 2022 full board meeting, with 37 members voting in favor
 of the recommendation, 0 members opposed, 0 members
 abstaining and 0 present but not eligible)

Denial unless all stipulations agreed to by applicant/owner are part of the method of operation
 Denial Approval

CB4 REPRESENTATIVES

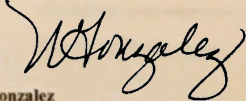
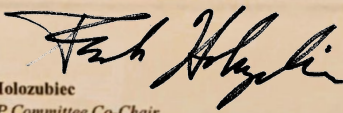
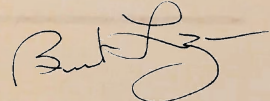
 Nelly Gonzalez CB4 Assistant District Manager	 Frank Holozubiec CB4 BLP Committee Co-Chair	 Burt Lazarin CB4 BLP Committee Co-Chair
---	---	---

APPLICANT AGREEMENT WITH THE COMMUNITY

Applicant agrees to these stipulations as the basis for the community support of this application and acknowledges that all of these stipulations are essential prerequisites to the MCB4 recommendation regarding this application. Applicant agrees to have these stipulations incorporated in the method of operation of its liquor license. The stipulations in this application constitute the entire agreement between MCB4 and applicant and may only be altered in writing signed by MCB4 and applicant. These stipulations supersede any oral statements or representations in connection with this application.

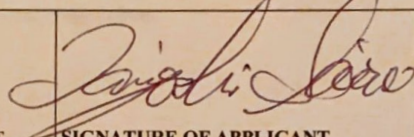
SIGN HERE →	Taiyoshi Saito PRINT NAME OF APPLICANT	 SIGNATURE OF APPLICANT	06/01/2021 DATE
-------------	---	--	------------------------

Tel: (212) 242-1400
 Fax: (212) 242-1400
<http://www.mcb4.com>
<http://www.mcb4.com>

This message is a PRIVATE communication. The message and its attachments are intended only for the individual or organization named by a line item and may be confidential or privileged by attorney-client privilege or other special provisions. If you are not the intended recipient, you are hereby notified that any disclosure, copying, distribution or use of the information contained in or attached to this message is strictly prohibited. Please notify the sender of the delivery error by return e-mail message and then delete it from your system. Thank you.

家系

E.A.K.

since 2008

SMALL BITES ござら料理

COLD れい菜 6,50
Umami Pickled Vegetables (V)
 White radish, celery, cauliflower, carrots, cucumber pickled with Japanese vinegar and white wine vinegar mixed with Umami kombu dashi and a hint of chili pepper.

Spicy Menma with Cilantro (V) (Chicken +2) 5,50
 Bamboo shoots marinated, cilantro and Mini tomatoes, homemade spicy garlic sauce.

Homemade Cucumber Kimchi 5,50
 Our homemade spicy leek mixed with kimchi and marinated cucumber.

Green Salad (V) (Chicken, Salmon, Avocado +2) 5,50
 Mixed leaf, broccoli, snap peas, with homemade vegan onion dressing.

HOT おん菜 5,50
 Soybeans that are boiled and lightly salted.

Garlic Edamame (VO) 6,50
 Soybeans that are boiled and lightly salted, then grilled with garlic aioli sauce and anchovy paste.

Eggplant Stir-fried (V) 6,50
 Fried Eggplants, Japanese style sweet savory, Mirin, Shoyu, garlic aioli, topped with fried garlic flake.

Shishito Peppers Stir-fried (V) 6,50
 Fried Shishito Peppers, Japanese style sweet savory, Mirin, Shoyu, garlic aioli, topped with fried garlic flake.

Brussel Sprouts Stir-fried (V) 6,50
 Fried Brussel Sprouts, Japanese style sweet savory, Mirin, Shoyu, garlic aioli, topped with fried garlic flake.

Assorted Mushrooms (V) 6,50
 Marinated maitake, shimeji and mushroom, topped with snap pea and mini tomatoes.

French fries (V) 5,50
 French fries with nori flakes served with ketchup.

Gyoza ぎょうざ

Homemade Ginger Pork 8,50
 Homemade grilled dumplings filled with seasoned pork, chives and ginger with original gyoza sauce

Karaage からあげ

2 choices of sauces: - Ponzu - Sweet chili - tartar
 Spicy garlic - Curry Mayo - Honey mustard

Chicken (we use juicy thigh) 7,80
 Lightly salted crispy fried chicken, with shishito peppers and lemon.

Tofu (V) 7,80
 Tofu treated with our special garlic sauce, and then deep fried to create an unimaginable texture with shishito pepper and lemon.

Hot Appetizers おいしいいろいろ

Pork Belly (Butakaku) 10,50
 Braised pork belly simmered in a soy based sauce

Shrimp Garlic with Broccoli 10,50
 Shrimp stir fried with broccoli and our garlic aioli seasoning with butter shoyu.

Takoyaki 6,80
 Savory round octopus pancake, with a sweet takoyaki sauce, spicy mayo sauce, and nori flakes.

Sizzler Teppan Grill 鉄板グリル

Tofu Agedashi (V) 10,50
 Silky tofu lightly battered and fried, edamame, served with assorted mushrooms and umami dashi sauce.

Yakiniku Beef 10,50
 Grilled beef with onions marinated in our original BBQ sauce, boiled bean sprouts and cabbage, red ginger and sesame seeds.

Buns Original E.A.K ハンズ

Pork Belly 5,50
Tofu 5,50
 Tender pork belly, (Butakaku)
 lettuce, boiled egg,
 mustard mayo sauce.

Shrimp 5,50
 Deep fried shrimp,
 lettuce with sweet chili sauce,
 homemade tartar sauce.

Fried Rice いためし

E.A.K. 8,80
 Pork fried rice with green onions and egg shot served table, side in a piping hot iron skillet.

Spicy 9,80
 Pork fried rice with green onions and egg shot served table, side in a piping hot iron skillet, above fried rice with a spicy bomb on top.

Mushroom (V) 9,80
 Assorted mushrooms sauted in garlic aioli sauce, with sweet corn, edamame topped with shoyu tare.

Rice Bowls どんぶりごはん

Poke (Tuna or Salmon) 13,80
 Avocado, crunchy garlic chips, edamame, sliced shishito peppers, sliced onions, topped with nori and golden sesame seeds in our specialty BBQ poke sauce on a bed of rice.

Salmon Ikura Avocado 15,80
 Slices of salmon, salmon roe, and avocado, served with nori and sesame seeds on a bed of rice.

Salmon Avocado 12,80
 Slices of salmon and avocado, served with nori and sesame seeds on a bed of rice.

Avocado (V) 9,80
 Slices of avocado, lettuce and mini tomatoes, lime, with homemade vegan onion dressing, on a bed of rice.

Pork Belly Chashu 10,80
 Braised pork belly simmered in a soy based sauce, lettuce, soft-boiled egg, ginger, sesame seed on a bed of rice.

Yakiniku Beef 10,80
 Grilled beef with onions marinated in our original BBQ sauce lettuce, soft-boiled egg, ginger, sesame seed on a bed of rice.

Extra Topping for Rice Bowl

Salmon 3,00
Ikura 3,00
Avocado 2,00
Chicken Breast 2,00
White Rice 2,00
 Steamed Japanese Rice.

• (V) - Vegan • (VO) - Vegan option

RAMEN らーめん

TONKOTSU 豚系とんこつ
The E.A.K Shoyu オリジナルしょうゆ 12,80
 Our signature Yokohama style pork and chicken broth, shoyu tare and thick noodles, topped with spinach, chashu, and nori.

Zebra Shio 黒がしニクニクバターしお 13,80
 Our signature Yokohama style pork and chicken broth, shio tare and thick noodles, topped with spinach, chashu, butter, garlic oil and nori.

Oh So Hot! Miso うまからみそ 14,80
 Our signature Yokohama style pork and chicken broth, miso tare fried garlic and thick noodles, spinach, chashu, bean sprouts, cabbage, spicy ground chicken and nori.

Choose a spiciness level! - Mild - Spicy - Hot

CHICKEN 中華そば
Tokyo Chicken (Chuka soba) 12,80
 Chicken and umami vege broth, thin wavy noodles, chicken breast, menma, naruto, diced onions and green onions.

VEGAN やさいきのこ
Umami Mushroom Shoyu きのこしょうゆ 14,80
 Umami dashi broth (konbu and shiitake), spinach noodles, shoyu tare, shiitake, maitake, shimeji and mushroom, topped with baby corn and snap pea.

Green House Shoyu やさいしょうゆ 14,80
 6 kinds vegetable broth, and kombu umami dashi shoyu tare sansho and thin noodles, mixed leaf, lotus root, baby corn, mini tomatoes, snap pea, sesame seeds oil.

Go Green Miso やさいみそ 14,80
 6 kinds vegetable broth, and soy milk, vegan miso tare, fried garlic and thin noodles, mixed leaf, lotus root, baby corn, mini tomatoes, snap pea,

Choose a spiciness level! - Mild - Spicy - Hot

COLD RAMEN 冷たいらーめん
Maze Soba Taiwan Style まぜそば 13,80
 Coming Soon

Ramen Salad (V) ざらだらーめん 14,80
 Mixed leaf on a bed of spinach noodles, topped with avocado, tofu, edamame and red ginger, mixed homemade umami onion dressing, with a hint of spice.

- 18% gratuity will be added to parties of 6 or more. - Consuming raw or undercooked meats, poultry, seafood, shellfish, or eggs may increase your risk of foodborne illness, especially if you have a medical condition. - Food Allergy Notice: please be advised that food prepared here may contain these ingredients : milk, eggs, wheat, soybean, fish and shell fish. Please ask your server if you have any concerns or if you think their hot.

DRINKS

DRAFT BEER

Sapporo glass 6, ⁰⁰	Pichers 16, ⁰⁰
Pale Lager Japan	
Orion glass 7, ⁰⁰	Pichers 17, ⁰⁰
Rice Lager, Okinawa Japan	
Wolf Pup glass 8, ⁰⁰	Pichers 18, ⁰⁰
IPA Los Angeles, CA	
Matcha Beer glass 7, ⁰⁰	
Green tea and beer	

BOTTLED BEER

Kawaba Sunrise Ale 7, ⁸⁰	
Amber ale, Gumma Japan	
330ml, 5.2% Alc	
Kawaba Snow Weizen 7, ⁸⁰	
Wheat, Gumma Japan	
330ml, 5.2% Alc	
Kirin Light 6, ⁰⁰	
Premium Light Beer, Japan	
355ml, 3.2% Alc, 95Calories	

WINE

White glass 8, ⁰⁰	bottle 30, ⁰⁰
Nisia (100% Verdejo) from Rueda, Spain	
Red glass 9, ⁰⁰	bottle 34, ⁰⁰
Odfjell (90% Cabernet, 10% Syrah) from Chile	

SOUR CIDERS

Black Dog 8, ⁰⁰	Guava 8, ⁰⁰
Charcoal, blood orange,	
Lavender, Los Angeles, CA	
355ml, 6.9% Alc	
Zero sugar probiotic	
Zero sugar probiotic	

DESSERTS

Mochi Ice Cream (contains Coconutmilk Vegan) 2, ⁰⁰	
- Green tea - Mango - Strawberry - Yuzu - Chocolate	
Matcha Cheesecake 4, ⁵⁰	

SO HAPPY HOUR

WEEKDAYS MON to FRIDAY
5PM - 7PM
ALL FOODS, ALL DRINKS

- Orders are accepted by 7PM - No happy hour for to-go orders
- Please do not take any happy hour foods and drinks outside

COCKTAIL SOJU

Lemon Sour 8, ⁸⁰	Calpico Sour 8, ⁸⁰
Lemon, soda, soju	
with sugar syrup	
Oolong Tea Hai 7, ⁸⁰	Green Tea Hai 7, ⁸⁰
Iced oolong tea and soju	
Iced green tea, soju	
Lychee Sour 8, ⁸⁰	Soju Mojito 9, ⁸⁰
Lychee, soda, soju	
and lime	
Mint, lime, soda and soju	
with sugar syrup	

SAKE

Hot Sake 8, ⁵⁰	Plum Sake Wine 8, ⁵⁰
Hakutsuru, Junmai	
On the rocks or club soda	
Dassai 50 Premium 18, ⁰⁰	Makiri Premium 17, ⁰⁰
300ml Yamaguchi Japan.	
Junmai dai ginjo extra dry	
Junmai ginjo extra dry	
Kurosawa Nigori 13, ⁰⁰	Organic Sake 12, ⁰⁰
300ml Nagano Japan.	
Un-filtered, semi-dry	
Kikusui Can 8, ⁰⁰	Mio Sparkling 8, ⁰⁰
200ml can, Niigata Japan.	
300ml, Japan.	
Honjozo Nama genshu	

NON ALCOHOL DRINKS

Iced Green Tea 3, ⁰⁰	Iced Oolong Tea 3, ⁰⁰	Ramune 3, ⁰⁰
Calpico Soda 3, ⁰⁰	Mexican Coke 3, ⁰⁰	Ginger Ale 2, ⁵⁰
San Pellegrino 3, ⁰⁰	Becks 5, ⁰⁰	Homemade Refreshing Flavored Soda 5, ⁰⁰
Choice of: - Lychee - Cherry Blossom - Green Apple		
- White Peach - Grapefruit		

- 18% gratuity will be added to parties of 6 or more. - Consuming raw or undercooked meats, poultry, seafood, shellfish, or eggs may increase your risk of foodborne illness, especially if you have a medical condition.
- Food Allergy Notice: please be advised that food prepared here may contain these ingredients: milk, eggs, wheat, soybean, fish and shellfish. Please ask your server if you have any concerns or if you think their hot.

Ground Level (page 2)

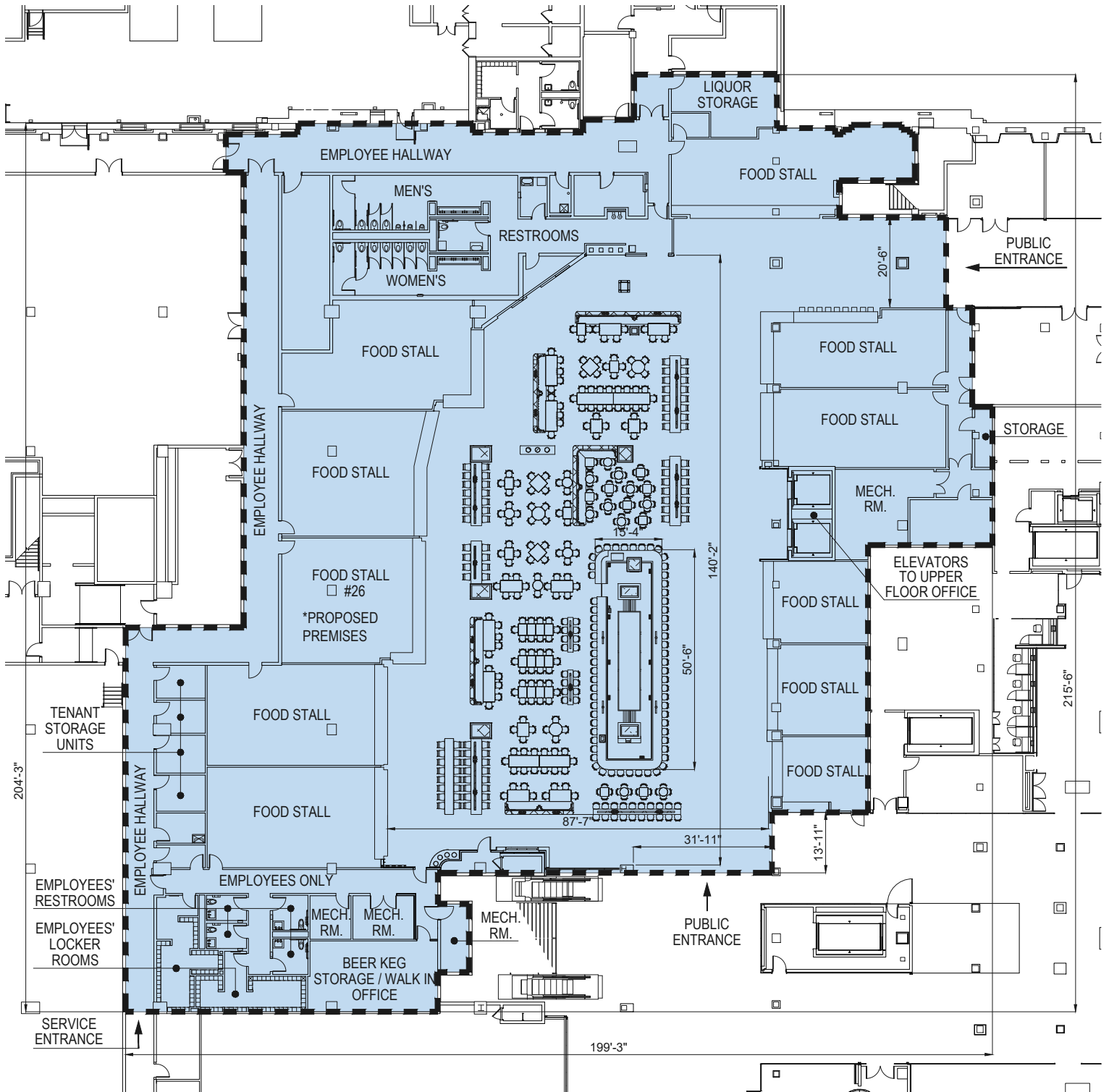

GROUND FLOOR:	
PATRON BARS:	1
LENGTH OF BAR:	127'-8"
TABLES:	79
SEATS AT TABLES:	419
SEATS AT BAR:	58
OVERALL DIMENSIONS:	30,570 S.F.

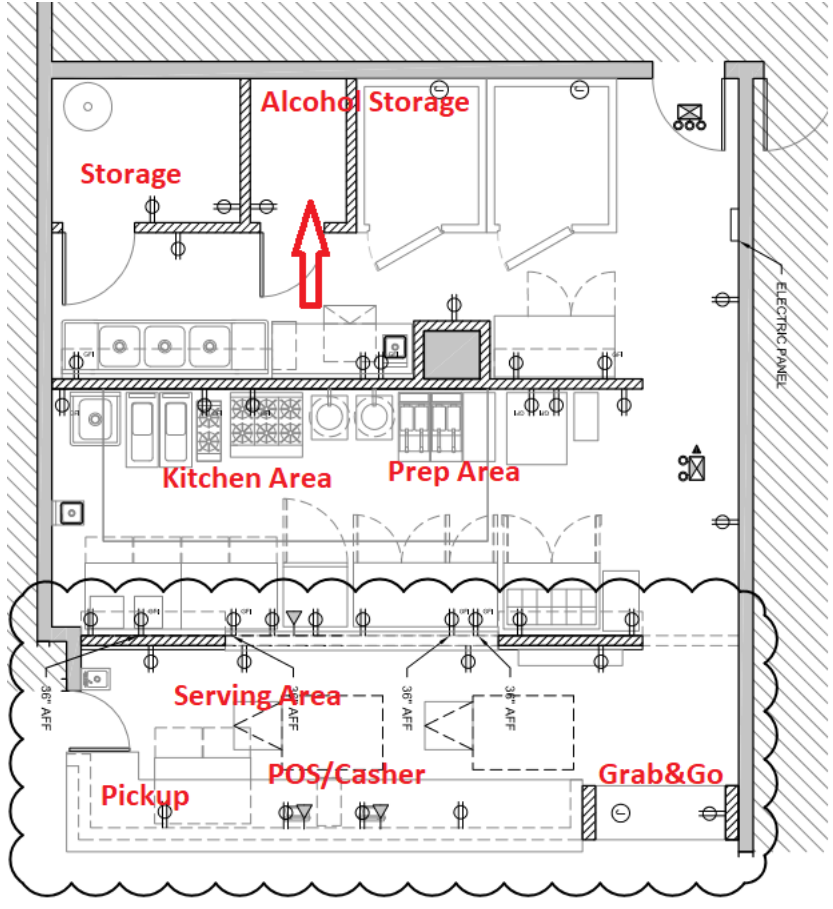

HELBRAUN | LEVEY

NEIGHBORHOOD MAP

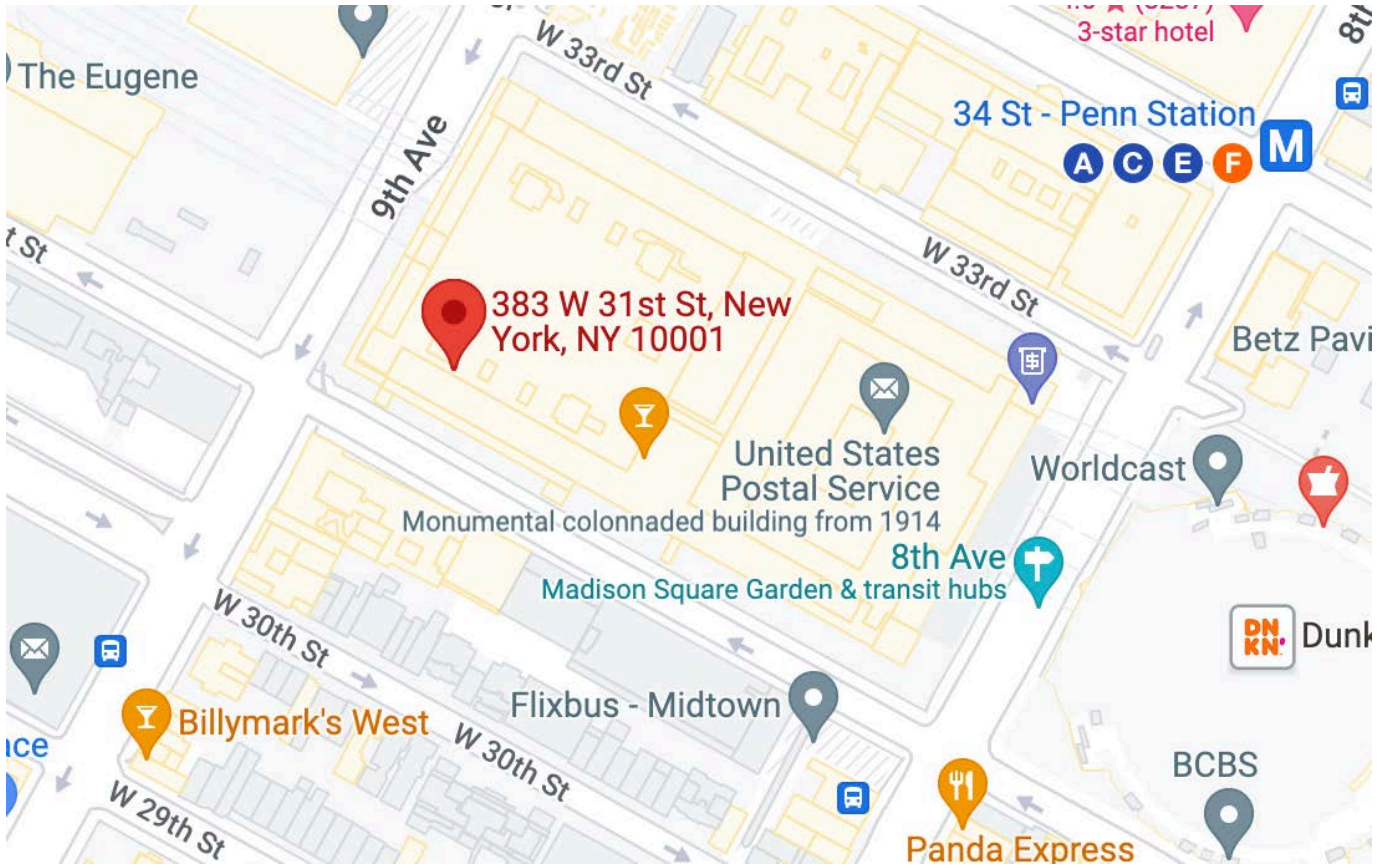

HELBRAUN | LEVEY

500 FOOT MAP

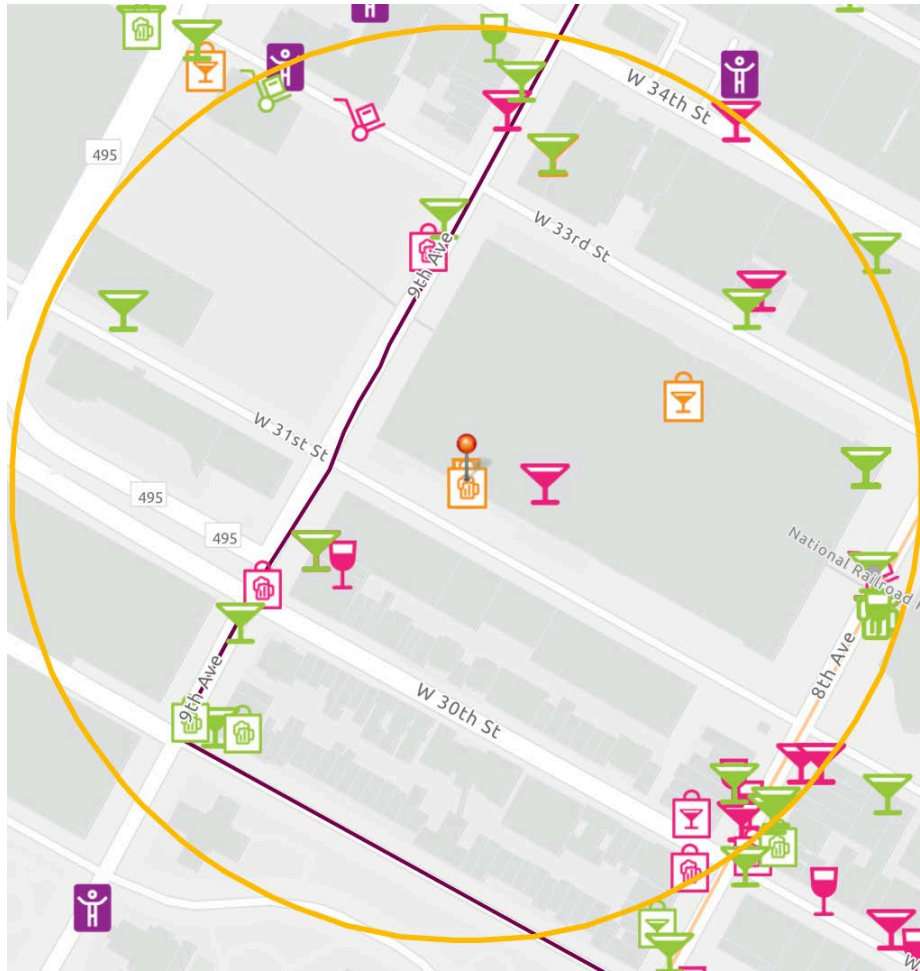

GREEN MARTINI=OP LICENSE
PINK MARTINI=INACTIVE OP LICENSE
GREEN WINE= RW/TW LICENSE
PINK WINE=INACTIVE RW/TW LICENSE

This report is for informational purposes only in aid of identifying establishments potentially subject to 500 and 200 foot rules. Distances are approximated using industry standard GIS techniques and do not reflect actual distances between points of entry. The NYS Liquor Authority makes no representation as to the accuracy of the information and disclaims any liability for errors.

Proximity Report For:	
Location	383 W 31st St, New York, New York, 10001
Geocode	Latitude: 40.75138 longitude: -73.99686
Report Generated On	7/12/2022

8 Closest Liquor Stores		
Name	Address	Distance
NRS WINE AND LIQUOR INC Ser #: 1336044	391 8TH AVE NEW YORK, NY 10001	787 ft
BARRIL WINES & LIQUORS INC Ser #: 1315255	5 7 CARYL AVE YONKERS, NY 10705	846 ft
MEENA SAMANI CORPORATION Ser #: 1273576	460 W 34TH ST STORE# 1 NEW YORK, NY 10001	1,124 ft
ANA WINE AND LIQUORS LLC Ser #: 1336884	20 HUDSON YARDS, UNIT RU101 A/KA 500 W 33RD ST NEW YORK, NY 10001	1,185 ft
RAJ WINE LLC Ser #: 1314271	PENN STATION 7TH AVE CORRIDOR-SPACE 23B NEW YORK, NY 10001	1,376 ft
PENN WINE & SPIRITS INC Ser #: 1170139	PENNSYLVANIA STATION 3 PENN PLAZA LEVEL A CONCOURSE NEW YORK, NY 10001	1,447 ft
AMSTERWINE.COM INC Ser #: 1313979	475 9TH AVE NEW YORK, NY 10018	1,457 ft
36TH STREET WINE & LIQUOR INC Ser #: 1023632	270 W 36TH STREET NEW YORK, NY 10018	1,547 ft

Schools within 500 feet		
Name	Address	Distance
No Schools within 500 feet		

Churches within 500 feet	
Name	Distance
No Churches within 500 feet	

Pending On Premises Liquor Licenses within 750 feet

Name	Address	Distance
MOYNIHAN OVERLOOK BAR LLC & PDP HOSPITALITY LLC Ser #: 1338758	383 W 33RD ST # 188-189 NEW YORK, NY 10001	559 ft

Active On Premises Liquor Licenses within 750 feet

Name	Address	Distance
MATES GLOBAL LTD Ser #: 1323955	360 9TH AVE NEW YORK, NY 10001	271 ft
ARAMARK SERVICES INC Ser #: 1337824	401 9TH AVE NEW YORK, NY 10001	437 ft
BARRAGH CORP Ser #: 1268099	340 9TH AVE NEW YORK, NY 10001	438 ft
NY 33RD LEASEHOLD LLC,FIVE POINTS OPRTG TENANT LLC Ser #: 1334766	325 W 33RD ST NEW YORK, NY 10001	545 ft
MOYNIHAN FOOD HALL BAR LLC & PDP HOSPITALITY LLC Ser #: 1337991	383 W 33RD ST #20 NEW YORK, NY 10001	559 ft
BILLY MARKS WEST INC Ser #: 1105367	332 NINTH AVENUE NEW YORK, NY 10001	576 ft
435 WEST 31ST STREET B LLC Ser #: 1329468	435 W 31ST ST 2ND & 3RD FLOORS NEW YORK, NY 10001	635 ft
435 WEST 31ST STREET A LLC Ser #: 1329408	435 W 31ST ST 1ST FL NEW YORK, NY 10001	635 ft
AMTRAK N R P CORP Ser #: 2001378	PENN STATION UNDER OPTION B NEW YORK, NY 10001	659 ft
AMTRAK N R P CORP Ser #: 2001402	PENN STATION UNDER OPTION B NEW YORK, NY 10001	659 ft
AMTRAK N R P CORP Ser #: 2001395	PENN STATION UNDER OPTION B NEW YORK, NY 10001	659 ft
AMTRAK N R P CORP Ser #: 2001389	PENN STATION UNDER OPTION B NEW YORK, NY 10001	659 ft
AMTRAK N R P CORP Ser #: 2001375	PENN STATION UNDER OPTION B NEW YORK, NY 10001	659 ft
AMTRAK N R P CORP Ser #: 2001369	PENN STATION UNDER OPTION B NEW YORK, NY 10001	659 ft
AMTRAK N R P CORP Ser #: 2001358	PENN STATION UNDER OPTION B NEW YORK, NY 10001	659 ft
AMTRAK N R P CORP Ser #: 2001399	PENN STATION UNDER OPTION B NEW YORK, NY 10001	659 ft

Active On Premises Liquor Licenses within 750 feet		
Name	Address	Distance
AMTRAK N R P CORP Ser #: 2001392	PENN STATION UNDER OPTION B NEW YORK, NY 10001	659 ft
AMTRAK N R P CORP Ser #: 2001405	PENN STATION UNDER OPTION B NEW YORK, NY 10001	659 ft
AMTRAK N R P CORP Ser #: 2001372	PENN STATION UNDER OPTION B NEW YORK, NY 10001	659 ft
AMTRAK N R P CORP Ser #: 2001376	PENN STATION UNDER OPTION B NEW YORK, NY 10001	659 ft
AMTRAK N R P CORP Ser #: 2001353	PENN STATION UNDER OPTION B NEW YORK, NY 10001	659 ft
AMTRAK N R P CORP Ser #: 2001347	PENN STATION UNDER OPTION B NEW YORK, NY 10001	659 ft
AMTRAK N R P CORP Ser #: 2001367	PENN STATION UNDER OPTION B NEW YORK, NY 10001	659 ft
AMTRAK N R P CORP Ser #: 2001373	PENN STATION UNDER OPTION B NEW YORK, NY 10001	659 ft
AMTRAK N R P CORP Ser #: 2001396	PENN STATION UNDER OPTION B NEW YORK, NY 10001	659 ft
AMTRAK N R P CORP Ser #: 2001387	PENN STATION UNDER OPTION B NEW YORK, NY 10001	659 ft
AMTRAK N R P CORP Ser #: 2001342	PENN STATION UNDER OPTION B NEW YORK, NY 10001	659 ft
AMTRAK N R P CORP Ser #: 2001344	PENN STATION UNDER OPTION B NEW YORK, NY 10001	659 ft
AMTRAK N R P CORP Ser #: 2001390	PENN STATION UNDER OPTION B NEW YORK, NY 10001	659 ft
AMTRAK N R P CORP Ser #: 2001370	PENN STATION UNDER OPTION B NEW YORK, NY 10001	659 ft
AMTRAK N R P CORP Ser #: 2001359	PENN STATION UNDER OPTION B NEW YORK, NY 10001	659 ft
AMTRAK N R P CORP Ser #: 2001400	PENN STATION UNDER OPTION B NEW YORK, NY 10001	659 ft
AMTRAK N R P CORP Ser #: 2001388	PENN STATION UNDER OPTION B NEW YORK, NY 10001	659 ft

Active On Premises Liquor Licenses within 750 feet		
Name	Address	Distance
AMTRAK N R P CORP Ser #: 2001345	PENN STATION UNDER OPTION B NEW YORK, NY 10001	659 ft
AMTRAK N R P CORP Ser #: 2001391	PENN STATION UNDER OPTION B NEW YORK, NY 10001	659 ft
AMTRAK N R P CORP Ser #: 2001365	PENN STATION UNDER OPTION B NEW YORK, NY 10001	659 ft
AMTRAK N R P CORP Ser #: 2001403	PENN STATION UNDER OPTION B NEW YORK, NY 10001	659 ft
AMTRAK N R P CORP Ser #: 2001356	PENN STATION UNDER OPTION B NEW YORK, NY 10001	659 ft
AMTRAK N R P CORP Ser #: 2001385	PENN STATION UNDER OPTION B NEW YORK, NY 10001	659 ft
AMTRAK N R P CORP Ser #: 2001348	PENN STATION UNDER OPTION B NEW YORK, NY 10001	659 ft
AMTRAK N R P CORP Ser #: 2001362	PENN STATION UNDER OPTION B NEW YORK, NY 10001	659 ft
AMTRAK N R P CORP Ser #: 2001368	PENN STATION UNDER OPTION B NEW YORK, NY 10001	659 ft
AMTRAK N R P CORP Ser #: 2001404	PENN STATION UNDER OPTION B NEW YORK, NY 10001	659 ft
RAILROAD PASSENGER SERVICES CORP Ser #: 1138563	PENN STATION NEW YORK, NY 10001	659 ft
AMTRAK N R P CORP Ser #: 2001408	PENN STATION UNDER OPTION B NEW YORK, NY 10001	659 ft
AMTRAK N R P CORP Ser #: 2001335	PENN STATION UNDER OPTION B NEW YORK, NY 10001	659 ft
AMTRAK N R P CORP Ser #: 2001357	PENN STATION UNDER OPTION B NEW YORK, NY 10001	659 ft
AMTRAK N R P CORP Ser #: 2001397	PENN STATION UNDER OPTION B NEW YORK, NY 10001	659 ft
AMTRAK N R P CORP Ser #: 2001351	PENN STATION UNDER OPTION B NEW YORK, NY 10001	659 ft
AMTRAK N R P CORP Ser #: 2001406	PENN STATION UNDER OPTION B NEW YORK, NY 10001	659 ft

Active On Premises Liquor Licenses within 750 feet		
Name	Address	Distance
AMTRAK N R P CORP Ser #: 2001383	PENN STATION UNDER OPTION B NEW YORK, NY 10001	659 ft
AMTRAK N R P CORP Ser #: 2001338	PENN STATION UNDER OPTION B NEW YORK, NY 10001	659 ft
AMTRAK N R P CORP Ser #: 2001343	PENN STATION UNDER OPTION B NEW YORK, NY 10001	659 ft
AMTRAK N R P CORP Ser #: 2001360	PENN STATION UNDER OPTION B NEW YORK, NY 10001	659 ft
AMTRAK N R P CORP Ser #: 2001374	PENN STATION UNDER OPTION B NEW YORK, NY 10001	659 ft
AMTRAK N R P CORP Ser #: 2001366	PENN STATION UNDER OPTION B NEW YORK, NY 10001	659 ft
8 CHELSEA CORP Ser #: 1295428	409 8TH AVE NORTH STORE NEW YORK, NY 10001	661 ft
TWINS PUB INC Ser #: 1034146	421 9TH AVENUE NEW YORK, NY 10001	665 ft
ARAMARK SERVICES INC Ser #: 1336869	421 8TH AVE AKA 372 NINTH AVE NEW YORK, NY 10001	687 ft
GENTS ENTERPRISES INC Ser #: 1023985	PENN STATION-MAIN CONCOURSE NEW YORK, NY 10001	714 ft
AMA RESTAURANTS LLC Ser #: 1153660	410 8TH AVENUE 31ST & 32ND STREETS NEW YORK, NY 10001	737 ft
NAVIC INVEST GROUP LLC Ser #: 1265672	408 8TH AVE NEW YORK, NY 10001	740 ft

HELBRAUN | LEVEY



HELBRAUN || LEVEY





JEFFREY LEFRANCIOS
Chair

JESSE BODINE
District Manager

CITY OF NEW YORK
MANHATTAN COMMUNITY BOARD No. 4
424 W 33rd Street, Suite 580 New York, NY 10001
tel: 212-736-4536
<https://cbmanhattan.cityofnewyork.us/cb4/>

PUBLIC NOTICE

Business Licenses and Permits Committee
will discuss an application submitted by

Gift New York No.3 (at Moynihan Food Hall) 383 W 31st Street, Stall# 26

A New Wine, Beer & Cider Application for a Fall
Hall/Vendor Kiosk Establishment with Recorded
Music

DATE:	Tuesday, September 13, 2022
TIME:	6:30 PM
PLACE:	<u>Video/Phone Conference Registration:</u> <u>https://zoom.us/webinar/register/WN_66-6SX3vS_6HVC2bBstV3A</u>

We invite you to attend this meeting and learn more about this application.
Alternately, you may email your comments by 12 p.m. Monday, September 12,
2022 or for more information, please email Assistant District Manager Nelly
Gonzalez negonzalez@cb.nyc.gov.

Posted according to the Administrative Code of the City of New York section 10-119. Please do not remove until after the above meeting date.



JEFFREY LEFRANCIOS
Chair

JESE SCOWE
District Manager

CITY OF NEW YORK
MANHATTAN COMMUNITY BOARD No. 4
424 W 33rd Street, Suite 580 New York, NY 10001
tel. 212-736-4538
<https://cbmanhattan.cityofnewyork.us/cb4/>

PUBLIC NOTICE

Business Licenses and Permits Committee
will discuss an application submitted by

**Gift New York No.3
(at Moynihan Food Hall)
383 W 31st Street, Stall# 26**

A New Wine, Beer & Cider Application for a Fall
Hall/Vendor Kiosk Establishment with Recorded
Music

DATE: Tuesday, September 13, 2022
TIME: 6:30 PM
PLACE: Video/Phone Conference Registration:
https://zoom.us/webinar/register/WN_66-6SX3vS_6HVC2bBstV3A

We invite you to attend this meeting and learn more about this application.
Alternately, you may email your comments by 12 p.m. Monday, September 12,
2022 or for more information, please email Assistant District Manager Nelly
Gonzalez nelgonzalez@cb.nyc.gov

Posted according to the Administrative Code of the City of New York section 10-
119. Please do not remove until after the above meeting date.

