

Manhattan Community Board 4

(All Fields Must Be Completed)

Liquor License/Sidewalk Cafe Stipulations Application

CORPORATION NAME		DOING BUSINESS AS (DBA)	
Baby Luc's 2 LLC		Baby Luc's	
STREET ADDRESS		CROSS STREETS	ZIP CODE
20 Hudson Yards New York, NY		33rd Street & 10th Ave.	10001
OWNER <small>(Attach a list of all the people that will be associated/listed with the license)</small>	NAME:	Marc Iacono	ATTORNEY/ REPRESENTATIVE
	PHONE:	718-216-1233	
	EMAIL:	mark@lucali.com	
	NAME:	Max Bookman, Esq./ Pesetsky & Bookman PC	
	PHONE:	212-513-1988	
	EMAIL:	max@pb.law: yakeima@pb.law	
MANAGER	NAME:	Krystal Fierman	LANDLORD
	PHONE:	917-214-3602	
	EMAIL:	krystal@lucali.com	
	NAME:	The Related Companies	
	PHONE:	212-320-9660	
	EMAIL:	nbeesemer@related.com	
APPLICATION TYPE (<input checked="" type="checkbox"/> <i>Liquor License</i> <input type="checkbox"/> <i>Unenclosed Sidewalk Cafe</i>)			
<input checked="" type="radio"/> New	Has applicant owned or managed a similar business?	<input checked="" type="checkbox"/> YES	<input type="checkbox"/> NO
	What is/was the name and address of establishment?	Baby Luc's/ 387 Court St, Brooklyn, NY 11231	
	What were the dates applicant was involved with this former premise?	July 2021-present	
<input type="radio"/> Corp Change/Class Change/Removal	What is the license # and expiration date?		
	Is applicant making any alterations or operational changes?	<input type="checkbox"/> YES	<input type="checkbox"/> NO
	<i>If alterations or operational changes are being made, please describe/list all changes.</i>		
<input type="radio"/> Alteration	What is the current license # and expiration date?		
	<i>Please list/describe the nature of all the changes and attach the plans:</i>		
METHOD OF OPERATION			
TYPE OF ALCOHOL	<input checked="" type="checkbox"/> Liquor/Wine/Beer & Cider <input type="checkbox"/> Beer & Cider <input type="checkbox"/> Wine/Beer & Cider		
ESTABLISHMENT TYPE	<input type="checkbox"/> Restaurant <input type="checkbox"/> Cabaret <input type="checkbox"/> Night Club <input type="checkbox"/> Hotel <input checked="" type="checkbox"/> Bar/Tavern <input type="checkbox"/> Catering Establishment <input type="checkbox"/> Adult Entertainment <input type="checkbox"/> Wine Bar <input type="checkbox"/> Dance Club <input type="checkbox"/> Sports Bar <input type="checkbox"/> Club (Fraternal Organization – Members Only)		
Has applicant/owner filed with the SLA? If yes, when? If no, when do you plan to file?	YES	<input checked="" type="checkbox"/>	
Is the 500 Foot Rule applicable? If yes, please attach a diagram of the On-Premise liquor license establishments within a 500 ft. radius of your establishment and the Public Interest Statement.	<input checked="" type="checkbox"/>	NO	
Is the 200 Foot Rule applicable? If yes, please attach a diagram of the schools and houses of worship that trigger the rule.	YES	<input checked="" type="checkbox"/>	
Has applicant/owner(s) read MCB4 Policy Regarding Concentration and Location of Alcoholic-Serving Establishments?	<input checked="" type="checkbox"/>	NO	

OPERATIONAL DETAILS (*Closing time will be when establishment is vacated of all patrons)

		MONDAY	TUESDAY	WEDNESDAY	THURSDAY	FRIDAY	SATURDAY	SUNDAY
HOURS* <i>(Indoor Only)</i>	Operation	11am-9pm	11am-9pm	11am-9pm	11am-9pm	11am-9pm	11am-9pm	11am-9pm
	Kitchen	11am-9pm	11am-9pm	11am-9pm	11am-9pm	11am-9pm	11am-9pm	11am-9pm
	Music	11am-9pm	11am-9pm	11am-9pm	11am-9pm	11am-9pm	11am-9pm	11am-9pm
If you plan to have music, what type(s)? (Circle all that apply)		BACKGROUND		LIVE MUSIC	DJ	JUKE BOX	KARAOKE	

OCCUPANCY

	Capacity (Certificate of Occupancy)	Maximum # of Persons Occupying Premises (Including Employees)	Number of Tables	Number of Seats	Number of Service Only Bars	Number of Stand-Up Bars	Number of Seats at Stand-Up Bar
INSIDE	74	14	1	10	0	1	0
OUTSIDE <i>(Other than sidewalk café)</i>	n/a	n/a	n/a	n/a	n/a	n/a	n/a
DCA APPROVED UNENCLOSED SIDEWALK CAFÉ	n/a	n/a	n/a	n/a	n/a		

How many floors are there? What is the capacity for each floor?

1

How frequently will the owner(s) be at the establishment?

During hours of operation

Will there be dancing?

YES NO

Will applicant have bottle or table service for beverage alcohol?

YES NO

Will applicant be hosting private; promotional or corporate events?

YES NO

Will outside promoters be used on a regular basis? If yes please describe.

YES NO

Will applicant have a security plan? If, yes please attach.

YES NO

Will security plan be implemented?

YES NO

Will State certified security personnel be used?

YES NO

Will New York Nightlife Association and NYPD Best Practices be followed?

YES NO

Does applicant agree to notify MCB4 prior to making changes to its method of operation?

YES NO

Will applicant be using delivery bicycles? If yes, how many?

YES NO

Will delivery bicycles be clearly marked with the name of the restaurant and will staff wear attire clearly noting name as described by NYC Law?

YES NO

Where will delivery bicycles be stored during the day when not in use?

n/a

MULTIPLE SPACES/FLOORS CAPACITY BREAKDOWN

Space/Floor	Description/Use of Space	Capacity	Hours	# of Tables	# of Seats	# of Service Only Bars	# of Stand-Up Bars/Seats at Bar	Music

LOCATION & ZONING			
Is this a Special District? If yes, is it Clinton, West Chelsea or Hudson Yards?	<input checked="" type="checkbox"/> YES	<input type="checkbox"/> NO	Hudson Yards
Does the building have a Certificate of Occupancy ("C of O") or a letter of no objection?	<input checked="" type="checkbox"/> YES	<input type="checkbox"/> NO	
Is a Public Assembly permit required?	<input type="checkbox"/> YES	<input checked="" type="checkbox"/> NO	
Are your plans filed with DOB?	<input checked="" type="checkbox"/> YES	<input type="checkbox"/> NO	

Community Notification/Relations			
NOTIFICATION: List all block associations; tenant associations, co-op boards or condo boards of residential buildings; and community groups that applicant has notified regarding its application. For each please list both the organization and individual you contacted	# 1	HKNA (incl. Dog Run) - K. Treat	
	# 2	CHDC (incl. Bob's & bird parks) - J. Restuccia)	
	# 3	HY Hell's Kitchen Alliance - B. Benfatto	
	# 4	Chekpedes - C. Berthet	
	# 5	Hell's Kitchen Block Assn - J. Campanelli	
Please provide dates when applicant met with the groups listed above.		emailed and notified about the upcoming July Community Board meeting	
Who was your contact person at each group you met with?			
When did applicant post the notice that was provided?			
Where did applicant post the notice that was provided?		Notices were posted around the Hudson Yards	
Will applicant provide owner cell phone number to neighbors and respond to complaints that arise? Please provide number in space provided.		<input checked="" type="checkbox"/> YES	<input type="checkbox"/> NO
Will applicant inform the Community Board office of its job openings and/or provide a hyperlink to applicants jobs webpage?		<input checked="" type="checkbox"/> YES	<input type="checkbox"/> NO

BUILDING DESIGN

State the name and type of business previously located in the space.	Jack's Coffee Shop		
Has a liquor-licensed establishment previously occupied this space at any time? If yes, please provide the name of the business.	YES	<input checked="" type="checkbox"/> NO	
Do you plan any changes to the existing façade? If yes, please describe.	YES	<input checked="" type="checkbox"/> NO	
Has the applicant/owner(s) read MCB 4 ADA Guidelines Memo?	<input checked="" type="checkbox"/> YES	NO	
Is the entrance ADA Compliant?	<input checked="" type="checkbox"/> YES	NO	
Do you plan any changes to the existing façade? If yes, please describe.	YES	<input checked="" type="checkbox"/> NO	
Will applicant have a vestibule within the establishment?	YES	<input checked="" type="checkbox"/> NO	
Will applicant use a storm enclosure?	YES	<input checked="" type="checkbox"/> NO	
Does applicant agree to keep the sidewalk clear of all items or obstructions, such as sandwich boards, sidewalk signs, freestanding menus and plants, as per the law?	YES	NO	n/a
Will applicant comply with the NYC noise code?	<input checked="" type="checkbox"/> YES	NO	
Will the establishment have any of the following: (circle all that apply) n/a	FRENCH DOORS	GARAGE DOORS	WINDOWS THAT CAN BE OPENED
Will applicant close all windows, French doors, garage doors when any music or amplified sound (including televisions) is played inside the establishment?	YES	NO	n/a
Will applicant close all windows, French doors, garage doors by 11 PM Friday and Saturday and 10 PM on all other days even if no music or amplified sound is played inside the establishment?	YES	NO	n/a
Has applicant obtained an acoustical report from a certified sound engineer to assess potential noise disturbance to the neighboring residents and buildings?	YES	NO	n/a
Will applicant follow the recommendations of a certified sound engineer to mitigate potential noise disturbance to the neighboring residents and buildings, including placing speakers on the floor of the establishment?	YES	NO	n/a
Will the kitchen exhaust system extend to the roof?	YES	NO	n/a
Will the establishment have an illuminated sign?	YES	NO	n/a
Will the establishment have a canopy extending over the sidewalk?	YES	NO	n/a
Where will the air conditioner be located? What type is it?	Central air in the entire building		
When was the air conditioner installed?			

OUTDOOR ITEMS - OTHER THAN SIDEWALK CAFÉ

Has the applicant/owner(s) read MCB 4 Rear Yard Rooftop Policy?	YES	NO	n/a
Will applicant use any outdoor spaces: rooftop, rear yard, patio, porch, balcony, pavilion, tents, deck, gazebo or open dining in the parking lane? If yes, which one(s)?	YES	NO	n/a
Are the floorplans for the outdoor space(s) included?	YES	NO	n/a
Will applicant close and vacate the outdoor space(s) by 11PM on Friday & Saturday and 10 PM on all other days?	YES	NO	n/a
Will the service and consumption of alcohol in any outdoor space only be via seated food service?	YES	NO	n/a
Will applicant not allow standing space for patrons to drink or smoke in any outdoor space(s) or on the sidewalk?	YES	NO	n/a
Will there be no amplified music, as per the law?	YES	NO	n/a
If amplified sound is played inside the establishment, will windows and doors be closed?	YES	NO	n/a
Will applicant agree to post signs outside asking customers to respect the neighbors'?	YES	NO	n/a
Will applicant agree to train staff to encourage a peaceful environment?	<input checked="" type="checkbox"/> YES	NO	
Will applicant provide effective sound control (landscaping enclosure, soundproofing tenants apartments)	YES	NO	n/a
Will there be a lighting plan that allows safe usage of the outdoor space without disrupting neighbors?	YES	NO	n/a
If open dining in the parking lane, will applicant agree to leave the sidewalk free of any furniture?	YES	NO	n/a
If open dining, will you comply with all NYC DOT guidelines?	YES	NO	n/a
If open dining, will the installation be year-round?	YES	NO	n/a

DCA APPROVED UNENCLOSED SIDEWALK CAFÉ			
Has the applicant/owner(s) read MCB4 Sidewalk Café Policy?	YES	NO	n/a
Will applicant be applying for a sidewalk café now or in the future?	YES	NO	n/a
Is applicant in this application seeking to include a sidewalk café in its liquor license?	YES	NO	n/a
If yes, has applicant submitted an application and plans to NYC Dept. of Consumer Affairs? Please attach application and plans.	YES	NO	n/a
Will applicant close and vacate the sidewalk café by 11 PM on Friday & Saturday and 10 PM on all other days?	YES	NO	n/a
Will applicant be serving alcohol in the sidewalk café? If so, will you have waiter service?	YES	NO	n/a
Will the café have a 3 ft. wide serving aisle running the entire length of the sidewalk cafe?	YES	NO	n/a
Will applicant mark the perimeter of the café on the sidewalk?	YES	NO	n/a
Will the service and consumption of alcohol in the sidewalk café only be via seated food service?	YES	NO	n/a
Will the sidewalk café not provide standing space for drinking or smoking?	YES	NO	n/a
Will applicant use any portable natural gas heaters? If so, do you have the requisite approvals from DOB & the Fire Department?	YES	NO	n/a
Will applicant have a lighting plan that will allow safe usage of the outdoor space without disrupting neighbors?	YES	NO	n/a
Will all furniture, plants and barricades be stored inside between the evening closing hours and the morning opening hours?	YES	NO	n/a
Will all furniture be stored inside between December 21 st and March 21 st , and any other day when it rains or snows?	YES	NO	n/a
Will applicant use umbrellas?	YES	NO	n/a
If construction or construction protection has reduced the sidewalk width, will applicant always maintain an 8 foot clear path of sidewalk between the perimeter of the café and the closest obstruction including construction barricades?	YES	NO	n/a
If open dining is in the parking lane, will applicant agree to remove its sidewalk café?	YES	NO	n/a

ADDITIONAL STIPULATIONS: (Office Use Only)

To the extent any additional stipulation on pages 7 and 8 of this application conflicts with any response on pages 1 – 6 of this application, the stipulations on pages 7 and 8 control.



ADDITIONAL STIPULATIONS: (Office Use Only), *Continued*

To the extent any additional stipulation on pages 7 and 8 of this application conflicts with any response on pages 1 – 6 of this application, the stipulations on pages 7 and 8 control.

Manhattan Community Board 4 (MCB4) recommends:
 (MCB4's recommendation is based on a vote taken at its
 July 27, 2022 full board meeting, with 39 members voting in favor
 of the recommendation, 0 members opposed, 0 members
 abstaining and 0 present but not eligible)

Denial unless all stipulations agreed to by applicant/owner are part of the method of
 operation
 Denial Approval

CB4 REPRESENTATIVES

 Nelly Gonzalez <i>CB4 Assistant District Manager</i>	 Frank Holozubiec <i>CB4 BLP Committee Co-Chair</i>	 Burt Lazarin <i>CB4 BLP Committee Co-Chair</i>
--	--	--

APPLICANT AGREEMENT WITH THE COMMUNITY

Applicant agrees to these stipulations as the basis for the community support of this application and acknowledges that all of these stipulations are essential prerequisites to the MCB4 recommendation regarding this application. Applicant agrees to have these stipulations incorporated in the method of operation of its liquor license. The stipulations in this application constitute the entire agreement between MCB4 and applicant and may only be altered in writing signed by MCB4 and applicant. These stipulations supersede any oral statements or representations in connection with this application.

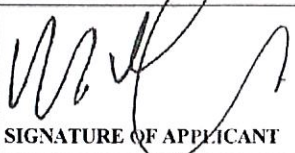
<p>SIGN HERE →</p>	<p>Mark Iacono</p> <p>PRINT NAME OF APPLICANT</p>	 SIGNATURE OF APPLICANT	<p>6/27/22</p> <p>DATE</p>
---------------------------	--	--	-----------------------------------

BABY LUC'S
500 WEST 33RD STREET
20 HUDSON YARDS, 4TH FLOOR (#435)
NEW YORK, NY 10001

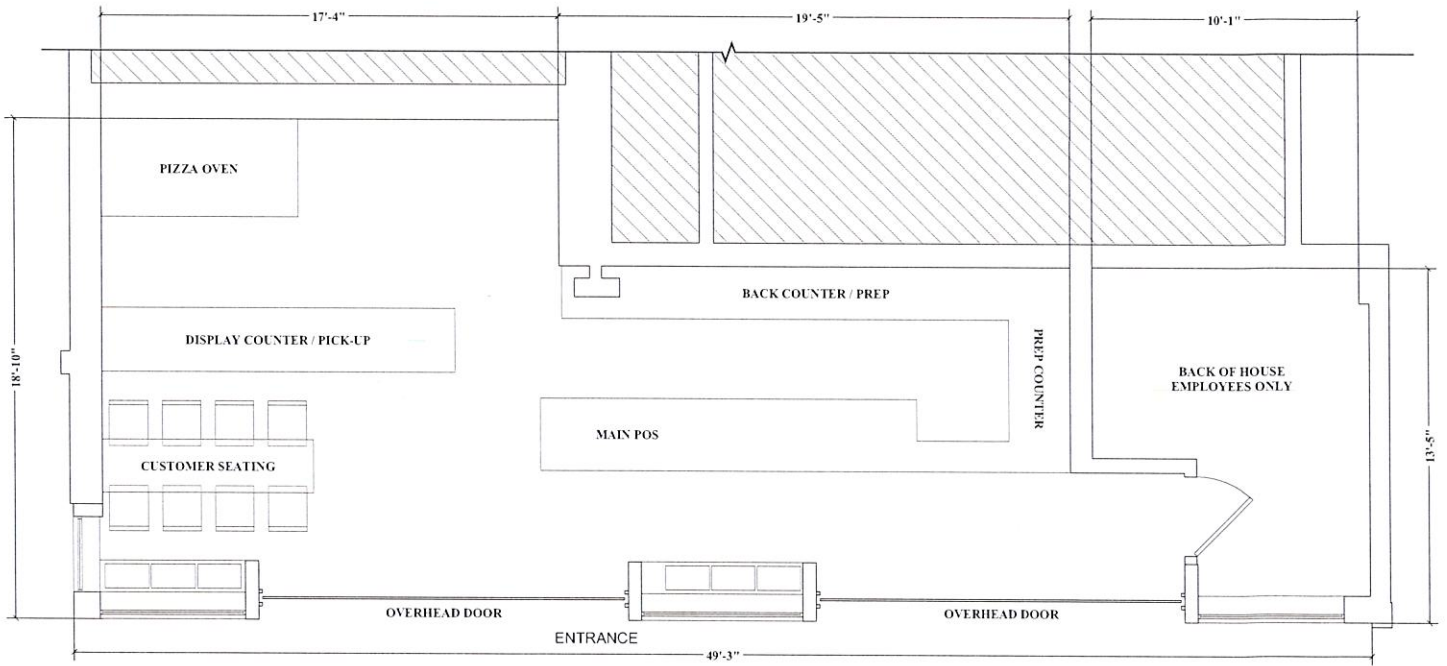

PIZZA

. REGULAR/MARG

Slice \$4

Pie \$30

. RICOTTA & BROCCOLI RABE

Pie \$34

. SAUSAGE & PEPPERS

Pie \$34

. PEPPERONI

Slice \$4.50

Pie \$34



JEFFREY LEFRANCIOS
Chair

JESSE BODINE
District Manager

CITY OF NEW YORK
MANHATTAN COMMUNITY BOARD No. 4
424 W 33rd Street, Suite 580 New York, NY 10001
tel: 212-736-4536
<https://cbmanhattan.cityofnewyork.us/cb4/>

PUBLIC NOTICE

Business Licenses and Permits Committee
will discuss an application submitted by

Baby Luc's 2 LLC **20 Hudson Yards, Unit** **RU404**

A New Liquor, Wine, Beer & Cider Application for a
Pizzeria Establishment with Recorded Music

DATE:	Tuesday, July 12, 2022
TIME:	6:30 PM
PLACE:	<u>Video/Phone Conference Registration:</u> <u>https://zoom.us/webinar/register/WN_66-6SX3vS_6HVC2bBstV3A</u>

We invite you to attend this meeting and learn more about this application.
Alternately, you may email your comments by 12 p.m. Monday, July 11, 2022 or
for more information, please email Assistant District Manager Nelly Gonzalez
negonzalez@cb.nyc.gov.

Posted according to the Administrative Code of the City of New York section 10-119. Please do not remove until after the above meeting date.



JEFFREY LEFRANCIOS
Chair

JESSE BODINE
District Manager

CITY OF NEW YORK
MANHATTAN COMMUNITY BOARD No. 4
424 W 33rd Street, Suite 580 New York, NY 10001
tel: 212-736-4536
<https://cbmanhattan.cityofnewyork.us/cb4/>

PUBLIC NOTICE

Business Licenses and Permits Committee
will discuss an application submitted by

Baby Luc's 2 LLC **20 Hudson Yards, Unit** **RU404**

A New Liquor, Wine, Beer & Cider Application for a
Pizzeria Establishment with Recorded Music

DATE:	Tuesday, July 12, 2022
TIME:	6:30 PM
PLACE:	Video/Phone Conference Registration: https://zoom.us/webinar/register/WN_66-6SX3vS_6HVC2hBstV3A

We invite you to attend this meeting and learn more about this application.
Alternately, you may email your comments by 12 p.m. Monday, July 11, 2022 or
for more information, please email Assistant District Manager Nelly Gonzalez
nelgonzalez@cb.nyc.gov.

Posted according to the Administrative Code of the City of New York section 10-119. Please do not remove until after the above meeting date.









New Restaurant Opening in Hudson Yards

Jillian Rothenberg <jillian@princestreethg.com>
To: yakeima@pb.law

Wed, Jun 22, 2022 at 4:00 PM

Hi Hudson Yards Community,

We are opening another location of Baby Lucs in Hudson Yards Mall and we are asking for the community's support as we go through our liquor application.

It will be a pizzeria/ slice shop serving beer and negronis everyday from 12pm-9pm and will have background music only.

Please be sure to respond with any feedback or any comments and thank you for your time.

Warm Regards,



Jillian Rothenberg
Prince Street Hospitality
917-331-4589
jillian@princestreethg.com



Certificate of Occupancy

CO Number:1088961-0000001

This certifies that the premises described herein conforms substantially to the approved plans and specifications and to the requirements of all applicable laws, rules and regulations for the uses and occupancies specified.No change of use or occupancy shall be made unless a new Certificate of Occupancy is issued.*This document or a copy shall be available for inspection at the building at all reasonable times.*

A.	Borough: MANHATTAN	Block Number: 702	Full Building Certificate Type: Temporary Date Issued: 06/15/2021
	Address: 500 WEST 33RD STREET	Lot Number(s): 110	
	Building Identification Number(BIN): 1088961	Additional Lot Number(s):	
		Application Type: NB - NEW BUILDING	
This building is subject to this Building Code: 2008			
This Certificate of Occupancy is associated with job# 121186251-01			
B.	Construction Classification: I-A: 3 HOUR PROTECTED - NON-COMBUST		
	Building Occupancy Group classification: B - BUSINESS		
	Multiple Dwelling Law Classification: Not Available		
	No.of stories: 68	Height in feet: 1269	No.of dwelling units: Not Available
C	Fire Protection Equipment: Fire Alarm System, Fire Suppression System, Sprinkler System, Standpipe System		
D	Parking Spaces and Loading Berths:		
	Open Parking Spaces: Not Available.		
	Enclosed Parking Spaces: Not Available.		
	Total Loading Berths: Not available		
E.	This Certificate is issued with the following legal limitations:		
	Restrictive Declaration: None Zoning Exhibit: None		
	BSA Calendar Number(s): N150132ZCM CPC Calendar Number(s): N150069ZCM, N150070ZCM, N150071ZCM, N150072ZCM, N150073ZCM		
Borough Comments:			

Borough Commissioner

Commissioner



Permissible Use and Occupancy

FLOOR	Occ Group	Live Loads (lbs per sq ft)	Zoning Use Group	Dwelling or Rooming Units	Job Reference	Certificate of Occupancy Type	Exceptions	CO Expiration Date
Cellar	F-2	100	6		121186251-01	Temporary		08/17/202
Description of Use :Mechanical and/or electrical equipment rooms : FUEL OIL TANK AND PUMP ROOMS, MECHANICAL ROOMS, FOAM SUPPRESSION TANKS (TOWER - C-1 FL), DRY FLOODPROOFED. (Additional use B & H-3 Use)						Maximum Person Permitted:65		
Cellar	U	N/A	N/A		121331763-01	Temporary		08/17/202
Description of Use :Accessory Structure : MTA/LIRR FACILITIES TRACK LEVEL - DOB JURISDICTION. (530 W. 33RD STREET - NB-121331763)						Maximum Person Permitted:N/A		
Cellar	F-2	OG	6		121186251-01	Temporary		08/17/202
Description of Use :Mechanical and/or electrical equipment rooms : MECHANICAL ROOMS, GAS, SEWER, WATER P.O.E. (PODIUM; C-1) DRY FLOODPROOFED						Maximum Person Permitted:16		
Ground Floor	S-1	100	6		121186251-01	Temporary		08/17/202
Description of Use :Storage of Flammable or Combustible Materials : (16) LOADING DOCKS (RETAIL)						Maximum Person Permitted:132		
Ground Floor	F-2	100	6		121186251-01	Temporary		08/17/202
Description of Use :Mechanical and/or electrical equipment rooms : MECHANICAL ROOMS, COGEN PUMP ROOM, GAS METER ROOMS, FIRE PUMP ROOM, GREASE TRAP/INTERCEPTOR (FLOOR IS DESIGN ABOVE FLOOD ELEVATION)(RETAIL)						Maximum Person Permitted:15		
Ground Floor	B	100	6		121186251-01	Temporary		08/17/202
Description of Use :Offices : LOBBY, MESSENGER CENTER (TOWER) (FLOOR IS DESIGN ABOVE FLOOD ELEVATION)						Maximum Person Permitted:69		
Ground Floor	F-2	100	6		121186251-01	Temporary		08/17/202
Description of Use :Mechanical and/or electrical equipment rooms : (14)LOADING DOCKS, BICYCLE PARKING 380 BICYCLES(FLOOR IS DESIGN ABOVE FLOOD ELEVATION) (TOWER) LEVEL 00 (Additional Use S-1)						Maximum Person Permitted:73		
Floor Number(s) - 1	U	N/A	N/A		121331763-01	Temporary		08/17/202
Description of Use :Accessory Structure : OPEN TO BELOW - MTA/LIRR FACILITIES TRACK LEVEL -NO DOB JURISDICTION ABOVE FLOOD ELEVATION. (530 W. 33RD STREET - NB-121331763)						Maximum Person Permitted:N/A		
Floor Number(s) - 1	B	100	6		121186251-01	Temporary		08/17/202
Description of Use :Offices : OFFICE LOBBY (TOWER)(DRY FLOOD PROOF ELEVATED ABOVE FLOOD ELEVATION)						Maximum Person Permitted:201		
Floor Number(s) - 1	M	100	6		121186251-01	Temporary		08/17/202

Description of Use :Retail Sales : RETAIL STORES, RU101-RU103,103A,RU104-RU106, RU108,RU109,RU110A,110B,110C, RU111A,RU112 ,RU114,RU115A,115B,RU116-RU119,RU120A,B,RU121,RU123,RU-124, RU-125,RU127,RU128A,B,RU129,RU130,RU131A,131B,RU132,RU133, COMMON CONCOURSE						Maximum Person Permitted:3678
Floor Number(s) - 2	F-2	100	6	121186251-01	Temporary	08/17/202
Description of Use :Mechanical and/or electrical equipment rooms : MECHANICAL ROOMS, STORAGE (Additional use S-1)						Maximum Person Permitted:16
Floor Number(s) - 2	A-3	100	6	121186251-01	Temporary	08/17/202
Description of Use :Community/Exhibition/Lecture Hall : EXHIBITION (RU 212)						Maximum Person Permitted:252
Floor Number(s) - 3	F-2	100	6	121186251-01	Temporary	08/17/202
Description of Use :Mechanical and/or electrical equipment rooms : DATA CENTER FACILITY - RU334						Maximum Person Permitted:13
Floor Number(s) - 3	F-2	100	6	121186251-01	Temporary	08/17/202
Description of Use :Mechanical and/or electrical equipment rooms : MECHANICAL ROOMS (TOWER)						Maximum Person Permitted:20
Floor Number(s) - 3	B	100	6	121186251-01	Temporary	08/17/202
Description of Use :Offices : OFFICES (TOWER), OFFICE RU 313B						Maximum Person Permitted:47
Floor Number(s) - 4	A-2	100	6	121186251-01	Temporary	08/17/202
Description of Use :Eating and Drinking : EATING & DRINKING ESTABLISHMENT (RU 401B)						Maximum Person Permitted:171
Floor Number(s) - 4	A-3	100	6	121186251-01	Temporary	08/17/202
Description of Use :Community/Exhibition/Lecture Hall : OB DECK - (TOWER)						Maximum Person Permitted:710
Floor Number(s) - 4	A-2	100	6	121186251-01	Temporary	08/17/202
Description of Use :Eating and Drinking : EATING AND DRINKING ESTABLISHMENT(RU401A)						Maximum Person Permitted:366
Floor Number(s) - 4	A-2	100	6	121186251-01	Temporary	08/17/202
Description of Use :Eating and Drinking : EATING AND DRINKING ESTABLISHMENT(RU415)						Maximum Person Permitted:475
Floor Number(s) - 4	B	100	6	121186251-01	Temporary	08/17/202
Description of Use :Offices : OFFICES, MECHANICAL ROOMS, STORAGE ROOMS (RU415) (Additional Use F-2, S-1)						Maximum Person Permitted:19
Floor Number(s) - 5	A-2	100	6	121186251-01	Temporary	08/17/202

Description of Use :Eating and Drinking : EATING AND DRINKING ESTABLISHMENT(LOWER LEVEL PA- RU 508 IN CONJUNCTIONWITH UPPER LEVEL PA RU 605)							Maximum Person Permitted:93
Floor Number(s) - 5	A-2	100	6	121186251-01	Temporary	08/17/202	
Description of Use :Eating and Drinking : OB DECK BAR (TOWER)							Maximum Person Permitted:103
Floor Number(s) - 5	F-2	100	6	121186251-01	Temporary	08/17/202	
Description of Use :Mechanical and/or electrical equipment rooms : MECHANICAL ROOMS (RU507, RU508)							Maximum Person Permitted:14
Floor Number(s) - 5	A-2	100	6	121186251-01	Temporary	08/17/202	
Description of Use :Eating and Drinking : EATING & DRINKING ESTABLISHMENT (RU507)							Maximum Person Permitted:204
Floor Number(s) - 5	B	100	6	121186251-01	Temporary	08/17/202	
Description of Use :Offices : OFFICES, OFFICES OB DECK TOWER (TOWER)							Maximum Person Permitted:88
Floor Number(s) - 5	A-3	100	6	121186251-01	Temporary	08/17/202	
Description of Use :Community/Exhibition/Lecture Hall : OB DECK (TOWER)							Maximum Person Permitted:373
Floor Number(s) - 5	A-2	100	6	121186251-01	Temporary	08/17/202	
Description of Use :Eating and Drinking : EATING AND DRINKING ESTABLISHMENT(LOWER LEVEL PA - RU 505 IN CONJUNCTIONWITH UPPER LEVEL PA RU 602)							Maximum Person Permitted:60
Floor Number(s) - 5	F-2	100	6	121186251-01	Temporary	08/17/202	
Description of Use :Mechanical and/or electrical equipment rooms : MECHANICAL ROOMS, STORAGE ROOMS, BOH STORAGE, OFFICE (OB DECK) (ADDITIONAL USE B) (TOWER)							Maximum Person Permitted:66
Floor Number(s) - 5	B	100	6	121186251-01	Temporary	08/17/202	
Description of Use :Offices : OFFICE, STORAGE ROOM (RU505, RU501) (ADDITIONAL USE S-2, F-2)							Maximum Person Permitted:24
Floor Number(s) - 5	A-2	100	6	121186251-01	Temporary	08/17/202	
Description of Use :Eating and Drinking : EATING AND DRINKING ESTABLISHMENT (RU501)							Maximum Person Permitted:150
Floor Number(s) - 5	S-1	100	6,10	121186251-01	Temporary	08/17/202	
Description of Use :Clothing, woolen wearing apparel : MECHANICAL ROOMS, STORAGE ROOMS(DEPARTMENT STORE RU504)							Maximum Person Permitted:21
Floor Number(s) - 6	F-2	100	6	121186251-01	Temporary	08/17/202	

Description of Use :Mechanical and/or electrical equipment rooms : MECHANICAL ROOMS (RU 602)						Maximum Person Permitted:35
Floor Number(s) - 6	M	100	6,10	121186251-01	Temporary	08/17/202
Description of Use :Retail Sales : EATING AND DRINKING ESTABLISHMENT(RU601)						Maximum Person Permitted:68
Floor Number(s) - 6	A-2	100	6	121186251-01	Temporary	08/17/202
Description of Use :Eating and Drinking : EATING AND DRINKING ESTABLISHMENTINDOOR FOOD SERVICE (410)PERSON,OUTDOOR TERRACE FOOD SERVICE(78) PERSON, (UPPER LEVEL RU605 & RU604IN CONJUNCTION WITH LOWER LEVEL PARU508)						Maximum Person Permitted:488
Floor Number(s) - 6	B	100	6	121186251-01	Temporary	08/17/202
Description of Use :Offices : OFFICE, MECHANICAL ROOMS, STORAGE ROOMS (ADDITIONAL USE F-2, S-2) (RU605)						Maximum Person Permitted:34
Floor Number(s) - 6	F-2	100	6	121186251-01	Temporary	08/17/202
Description of Use :Mechanical and/or electrical equipment rooms : MECHANICAL ROOMS(ADDITIONAL USE S-1) (TOWER)						Maximum Person Permitted:130
Floor Number(s) - 6	A-2	100	6	121186251-01	Temporary	08/17/202
Description of Use :Eating and Drinking : EATING AND DRINKING ESTABLISHMENT.INDOOR FOOD SERVICE (246) PERSON,OUTDOOR TERRACE FOOD SERVICE (24)PERSON, (UPPER LEVEL RU602, RU603A,RU603B, IN CONJUNCTION WITH LOWERLEVEL PA RU505)						Maximum Person Permitted:270
Floor Number(s) - 6	F-2	100	6,10	121186251-01	Temporary	08/17/202
Description of Use :Mechanical and/or electrical equipment rooms : MECHANICAL ROOMS, STORAGE ROOMS,KITCHEN (DEPARTMENT STORE RU601)						Maximum Person Permitted:42
Floor Number(s) - 7	A-2	100	6,10	121186251-01	Temporary	08/17/202
Description of Use :Eating and Drinking : EATING AND DRINKING ESTABLISHMENT (RU701)						Maximum Person Permitted:231
Floor Number(s) - 8	F-2	100	6	121186251-01	Temporary	08/17/202
Description of Use :Mechanical and/or electrical equipment rooms : MECHANICAL, STORAGE (TOWER DISPLAY 10) (Additional use S-1)						Maximum Person Permitted:168
Floor Number(s) - 8	F-2	100	6	121186251-01	Temporary	08/17/202
Description of Use :Mechanical and/or electrical equipment rooms : MECHANICAL (RETAIL PODIUM - DISPLAY 10 FL)						Maximum Person Permitted:245
Floor Number(s) - 9	F-2	100	6	121186251-01	Temporary	08/17/202
Description of Use :Mechanical and/or electrical equipment rooms : MECHANICAL TRANSFORMER VAULTS NETWORK PROTECTOR (DISPLAY 11 FL) (TOWER)						Maximum Person Permitted:83
Floor Number(s) - 9	F-2	100	6	121186251-01	Temporary	08/17/202

Description of Use :Mechanical and/or electrical equipment rooms : MECHANICAL (RETAIL)						Maximum Person Permitted:87
Floor Number(s) - 10	F-2	100	6	121186251-01	Temporary	08/17/202
Description of Use :Mechanical and/or electrical equipment rooms : MECHANICAL SETBACK ROOF (RETAIL PODIUM- 14FL)						Maximum Person Permitted:103
Floor Number(s) - 10	B	100	6	121186251-01	Temporary	08/17/202
Description of Use :Offices : OFFICES (TOWER DISPLAY - 14TH FL)						Maximum Person Permitted:614
Floor Number(s) - 11	B	100	6	121186251-01	Temporary	08/17/202
Description of Use :Offices : OFFICES (TOWER - 15TH FL) (Additional Use F-2, S-1)						Maximum Person Permitted:613
Floor Number(s) - 11	F-2	100	6	121186251-01	Temporary	08/17/202
Description of Use :Mechanical and/or electrical equipment rooms : MECHANICAL,(RETAIL PODIUM - 15FL)						Maximum Person Permitted:35
Floor Number(s) - 12	B	100	6	121186251-01	Temporary	08/17/202
Description of Use :Offices : OFFICES (TOWER DISPLAY 16 FL) (Additional Use F-2)						Maximum Person Permitted:610
Floor Number(s) - 13	B	100	6	121186251-01	Temporary	08/17/202
Description of Use :Offices : OFFICES (TOWER - DISPLAY 17TH FL) (Additional Use F-2)						Maximum Person Permitted:607
Floor Number(s) - 14	B	100	6	121186251-01	Temporary	08/17/202
Description of Use :Offices : OFFICES (TOWER DISPLAY 18TH FL) (Additional Use F-2)						Maximum Person Permitted:604
Floor Number(s) - 15	B	100	6	121186251-01	Temporary	08/17/202
Description of Use :Offices : OFFICES (TOWER DISPLAY - 19FL) (Additional Use F-2)						Maximum Person Permitted:600
Floor Number(s) - 16	B	100	6	121186251-01	Temporary	08/17/202
Description of Use :Offices : OFFICES (TOWER DISPLAY 20FL) (Additional Use F-2)						Maximum Person Permitted:492
Floor Number(s) - 17	B	100	6	121186251-01	Temporary	08/17/202
Description of Use :Offices : OFFICES (TOWER DISPLAY - 21 FL) (Additional Use F-2, S-1)						Maximum Person Permitted:594
Floor Number(s) - 18	B	100	6	121186251-01	Temporary	08/17/202
Description of Use :Offices : OFFICES (TOWER DISPLAY -22FL) (Additional Use F-2, S-1)						Maximum Person Permitted:590

Floor Number(s) - 19	B	100	6	121186251-01	Temporary	08/17/202
Description of Use :Offices : SMALL SCREENING ROOM, OFFICES (TOWER DISPLAY 23 FL) (Additional Use F-2, S-1)						Maximum Person Permitted:582
Floor Number(s) - 19	F-2	100	6	121186251-01	Temporary	08/17/202
Description of Use :Mechanical and/or electrical equipment rooms : MECHANICAL EQUIPMENT ROOMS - TECHROOMS ELVE.PITS (TOWER DISPLAY 23 FL						Maximum Person Permitted:4
Floor Number(s) - 19	A-1	100	6	121186251-01	Temporary	08/17/202
Description of Use :Studio - Television/Radio : LOWER PORTION OF LARGE SCREENINGROOM (TOWER DISPLAY 23 FL)						Maximum Person Permitted:126
Floor Number(s) - 19	A-1	100	6	121186251-01	Temporary	08/17/202
Description of Use :Studio - Television/Radio : LOWER PORTION OF MEDIUM SCREENINGROOM (TOWER DISPLAY 23 FL)						Maximum Person Permitted:60
Floor Number(s) - 20	A-2	100	6	121186251-01	Temporary	08/17/202
Description of Use :Banquet : BANQUET/MEETING ROOM (TOWER DISPLAY 24 FL) WEST COMPARTMENT) (ADDITIONAL A-3 USE)						Maximum Person Permitted:173
Floor Number(s) - 20	A-3	100	6	121186251-01	Temporary	08/17/202
Description of Use :Community/Exhibition/Lecture Hall : CONFERENCE #8 (EAST COMPARTMENT) (Additional use A-2)						Maximum Person Permitted:89
Floor Number(s) - 20	A-1	100	6	121186251-01	Temporary	08/17/202
Description of Use :Studio - Television/Radio : UPPER PORTION MEDIUM SCREENING ROOM(TOWER DISPLAY 24 FL)(WESTCOMPARTMENT)						Maximum Person Permitted:90
Floor Number(s) - 20	A-2	100	6	121186251-01	Temporary	08/17/202
Description of Use :Eating and Drinking : RECEPTION/LOUNGE (TOWER DISPLAY 24 FL)(EAST COMPARTMENT) (Additional Use A-3)						Maximum Person Permitted:160
Floor Number(s) - 20	A-3	100	6	121186251-01	Temporary	08/17/202
Description of Use :Community/Exhibition/Lecture Hall : CONFERENCE ROOM #5 (EASTCOMPARTMENT)(TOWER DISPLAY 24 FL) (Additional use A-2)						Maximum Person Permitted:93
Floor Number(s) - 20	B	100	6	121186251-01	Temporary	08/17/202
Description of Use :Offices : OFFICES, CONFERENCE ROOMS,MECHANICAL ROOMS, STORAGE ROOMS.(67 Person-EASTCOMPARTMENT)OFFICES ,MECHANICAL ROOMS, KITCHEN.(TOWER DISPLAY 24 FL) (167 Person-WESTCOMPARTMENT) (Additional Use F-2,S-2)						Maximum Person Permitted:234
Floor Number(s) - 20	A-3	100	6	121186251-01	Temporary	08/17/202
Description of Use :Community/Exhibition/Lecture Hall : CONFERENCE ROOM #3, (WESTCOMPARTMENT) (TOWER DISPLAY 24 FL) (Additional use A-2)						Maximum Person Permitted:100

Floor Number(s) - 20	A-1	100	6	121186251-01	Temporary	08/17/202
Description of Use :Studio - Television/Radio : UPPER PORTION LARGE SCREENING ROOM(TOWER DISPLAY 24 FL) (EASTCOMPARTMENT)					Maximum Person Permitted:190	
Floor Number(s) - 20	A-3	100	6	121186251-01	Temporary	08/17/202
Description of Use :Community/Exhibition/Lecture Hall : CONFERENCE #7 (EAST COMPARTMENT)(TOWER DISPLAY 24 FL) (Additional use A-2)					Maximum Person Permitted:97	
Floor Number(s) - 21	F-2	100	6	121186251-01	Temporary	08/17/202
Description of Use :Mechanical and/or electrical equipment rooms : MECHANICAL ROOMS (TOWER - 25 FL)					Maximum Person Permitted:191	
Floor Number(s) - 22	F-2	100	6	121186251-01	Temporary	08/17/202
Description of Use :Mechanical and/or electrical equipment rooms : KITCHEN, DISHWASHING, MECHANICALROOMS (TOWER DISPLAY 35 FL EAST)					Maximum Person Permitted:26	
Floor Number(s) - 22	A-2	100	6	121186251-01	Temporary	08/17/202
Description of Use :Cafeteria : CAFE/DINING AREA (TOWER DISPLAY - 35 FL EAST)					Maximum Person Permitted:567	
Floor Number(s) - 22	M	100	6	121186251-01	Temporary	08/17/202
Description of Use :Retail Sales : SERVERY (TOWER DISPLAY 35 FL EAST)					Maximum Person Permitted:82	
Floor Number(s) - 22	A-2	100	6	121186251-01	Temporary	08/17/202
Description of Use :Eating and Drinking : EATING AND DRINKING (TOWER DISPLAY 35FL WEST)					Maximum Person Permitted:150	
Floor Number(s) - 23	B	100	6	121186251-01	Temporary	08/17/202
Description of Use :Offices : MECHANICAL ROOMS, LOCKER ROOMS,STORAGE ROOM (EAST) WELLNESS ROOM, ELECTRICAL ROOMS,STORAGE ROOMS (WEST) (TOWER DISPLAY 36) (Additional Use F-2, S-2)					Maximum Person Permitted:167	
Floor Number(s) - 23	A-3	100	6	121186251-01	Temporary	08/17/202
Description of Use :Health Club/ Gym/ Fitness Center : FITNESS CENTER (TOWER DISPLAY 36 FL EAST)					Maximum Person Permitted:218	
Floor Number(s) - 24	B	100	6	121186251-01	Temporary	08/17/202
Description of Use :Offices : OFFICES (TOWER DISPLAY - 37 FL) (Additional Use F-2)					Maximum Person Permitted:435	
Floor Number(s) - 25	B	100	6	121186251-01	Temporary	08/17/202
Description of Use :Offices : OFFICES (TOWER DISPLAY - 38 FL) (Additional Use F-2)					Maximum Person Permitted:431	
Floor Number(s) - 26	B	100	6	121186251-01	Temporary	08/17/202

Description of Use :Offices : OFFICES (TOWER DISPLAY - 39 FL) (Additional Use F-2)					Maximum Person Permitted:428
Floor Number(s) - 27	B	100	6	121186251-01	Temporary 08/17/202
Description of Use :Offices : OFFICES (TOWER DISPLAY - 40 FL) (Additional Use F-2)					Maximum Person Permitted:425
Floor Number(s) - 28	B	100	6	121186251-01	Temporary 08/17/202
Description of Use :Offices : OFFICES (TOWER DISPLAY - 41FL) (Additional Use F-2,S-1)					Maximum Person Permitted:422
Floor Number(s) - 29	B	100	6	121186251-01	Temporary 08/17/202
Description of Use :Offices : OFFICES (TOWER DISPLAY - 42 FL) (Additional use F-2)					Maximum Person Permitted:419
Floor Number(s) - 30	B	100	6	121186251-01	Temporary 08/17/202
Description of Use :Offices : OFFICES (TOWER DISPLAY - 43 FL) (Additional use F-2)					Maximum Person Permitted:416
Floor Number(s) - 31	B	100	6	121186251-01	Temporary 08/17/202
Description of Use :Offices : OFFICES (TOWER DISPLAY - 44 FL) (Additional use F-2)					Maximum Person Permitted:412
Floor Number(s) - 32	B	100	6	121186251-01	Temporary 08/17/202
Description of Use :Offices : OFFICES (TOWER DISPLAY - 45 FL) (Additional use F-2)					Maximum Person Permitted:409
Floor Number(s) - 33	B	100	6	121186251-01	Temporary 08/17/202
Description of Use :Offices : OFFICES (TOWER DISPLAY - 46 FL) (Additional use F-2)					Maximum Person Permitted:406
Floor Number(s) - 34	B	100	6	121186251-01	Temporary 08/17/202
Description of Use :Offices : OFFICES (TOWER DISPLAY - 47 FL) (Additional use F-2)					Maximum Person Permitted:403
Floor Number(s) - 35	B	100	6	121186251-01	Temporary 06/10/202
Description of Use :Offices : OFFICES (TOWER DISPLAY - 48 FL) (Additional use F-2)					Maximum Person Permitted:399
Floor Number(s) - 36	B	100	6	121186251-01	Temporary 08/17/202
Description of Use :Offices : OFFICES (TOWER DISPLAY - 49 FL) (Additional use F-2)					Maximum Person Permitted:397
Floor Number(s) - 37	B	100	6	121186251-01	Temporary 08/17/202
Description of Use :Offices : OFFICES (TOWER DISPLAY - 50) (Additional use F-2)					Maximum Person Permitted:312
Floor Number(s) - 37	A-3	100	6	121186251-01	Temporary 08/17/202

Description of Use :Community/Exhibition/Lecture Hall : CONFERENCE ROOM (TOWER DISPLAY - 50 FL)						Maximum Person Permitted:90
Floor Number(s) - 38	B	100	6	121186251-01	Temporary	08/17/202
Description of Use :Offices : OFFICES (TOWER DISPLAY - 51 FL) (Additional use F-2)						Maximum Person Permitted:390
Floor Number(s) - 39	F-2	100	6	121186251-01	Temporary	08/17/202
Description of Use :Mechanical and/or electrical equipment rooms : MECHANICAL ROOMS, TRANSFORMER, ELEVATOR MACHINE ROOM (TOWER DISPLAY -52 FL)						Maximum Person Permitted:136
Floor Number(s) - 40	B	100	6	121186251-01	Temporary	08/17/202
Description of Use :Offices : OFFICES (TOWER DISPLAY - 60 FL) (Additional use F-2)						Maximum Person Permitted:380
Floor Number(s) - 41	B	100	6	121186251-01	Temporary	08/17/202
Description of Use :Offices : OFFICES (TOWER DISPLAY - 61 FL) (Additional use F-2)						Maximum Person Permitted:377
Floor Number(s) - 42	B	100	6	121186251-01	Temporary	08/17/202
Description of Use :Offices : OFFICES (TOWER DISPLAY - 62 FL) (Additional use F-2)						Maximum Person Permitted:374
Floor Number(s) - 43	A-3	100	6	121186251-01	Temporary	08/17/202
Description of Use :Community/Exhibition/Lecture Hall : MEETING & LOUNGE (NON ASSEMBLY SPACE) (TENANT) (TOWER DISPLAY 63FL)						Maximum Person Permitted:279
Floor Number(s) - 43	B	100	6	121186251-01	Temporary	08/17/202
Description of Use :Offices : OFFICES & FACILITIES (TENANT) (TOWER DISPLAY - 63 FL)						Maximum Person Permitted:63
Floor Number(s) - 43	E	100	6	121186251-01	Temporary	08/17/202
Description of Use :Libraries accessory to Group E (as defined in the 2014 code) occupancies. : LIBRARY (TENANT) (TOWER DISPLAY-63FL)						Maximum Person Permitted:12
Floor Number(s) - 43	A-3	100	6	121186251-01	Temporary	08/17/202
Description of Use :Community/Exhibition/Lecture Hall : MEETING ROOM (TENANT) (TOWER DISPLAY - 63 FL)						Maximum Person Permitted:129
Floor Number(s) - 43	F-2	100	6	121186251-01	Temporary	08/17/202
Description of Use :Mechanical and/or electrical equipment rooms : MECHANICAL (TENANT)(TOWER DISPLAY 63FL)						Maximum Person Permitted:5
Floor Number(s) - 43	S-2	100	6	121186251-01	Temporary	08/17/202
Description of Use :Storage of non combustibile materials : STORAGE & ELECTRICA						Maximum Person Permitted:10

CLOSETS (TENANT)(TOWER DISPLAY -63FL)

Floor Number(s) - 44	B	100	6	121186251-01	Temporary	08/17/202
Description of Use :Offices : OFFICES (TOWER DISPLAY - 64 FL) (Additional use F-2)					Maximum Person Permitted:368	
Floor Number(s) - 45	B	100	6	121186251-01	Temporary	08/17/202
Description of Use :Offices : OFFICES (TOWER DISPLAY - 65 FL), (ADDITIONAL USE F-2)					Maximum Person Permitted:365	
Floor Number(s) - 46	B	100	6	121186251-01	Temporary	08/17/202
Description of Use :Offices : OFFICES (TOWER DISPLAY - 66 FL) (ADDITIONAL USE F-2)					Maximum Person Permitted:362	
Floor Number(s) - 47	B	100	6	121186251-01	Temporary	08/17/202
Description of Use :Offices : OFFICES (TOWER DISPLAY - 67 FL) (ADDITIONAL USE F-2)					Maximum Person Permitted:359	
Floor Number(s) - 48	F-2	100	6	121186251-01	Temporary	08/17/202
Description of Use :Mechanical and/or electrical equipment rooms : MECHANICAL ROOMS (TOWER DISPLAY-68 FL)					Maximum Person Permitted:0	
Floor Number(s) - 48	A-2	100	6	121186251-01	Temporary	08/17/202
Description of Use :Cafeteria : KITCHEN (TOWER DISPLAY - 68 FL)					Maximum Person Permitted:43	
Floor Number(s) - 48	A-2	100	6	121186251-01	Temporary	08/17/202
Description of Use :Cafeteria : CAFETERIA & QUEUING (TOWER DISPLAY - 68 FL)					Maximum Person Permitted:480	
Floor Number(s) - 49	A-3	100	6	121186251-01	Temporary	08/17/202
Description of Use :Community/Exhibition/Lecture Hall : MEETING ROOM (TOWER DISPLAY-69 FL)					Maximum Person Permitted:150	
Floor Number(s) - 49	A-3	100	6	121186251-01	Temporary	08/17/202
Description of Use :Community/Exhibition/Lecture Hall : MEETING ROOM (TOWER DISPLAY-69 FL)					Maximum Person Permitted:100	
Floor Number(s) - 49	B	100	6	121186251-01	Temporary	08/17/202
Description of Use :Offices : OFFICES (TOWER DISPLAY - 69 FL) (ADDITIONAL USE F-2, S-1)					Maximum Person Permitted:190	
Floor Number(s) - 50	B	100	6	121186251-01	Temporary	08/17/202
Description of Use :Offices : OFFICES (TOWER DISPLAY 70 FL) (ADDITIONAL USE F-2, S-1)					Maximum Person Permitted:349	
Floor Number(s) - 51	B	100	6	121186251-01	Temporary	08/17/202

Description of Use :Offices : OFFICES (TOWER DISPLAY 71 FL) (ADDITIONAL USE F-2, S-1)							Maximum Person Permitted:346
Floor Number(s) - 52	B	100	6	121186251-01	Temporary	08/17/202	
Description of Use :Offices : OFFICES (TOWER DISPLAY - 72 FL) (ADDITIONAL USE F-2)							Maximum Person Permitted:346
Floor Number(s) - 53	B	100	6	121186251-01	Temporary	08/17/202	
Description of Use :Offices : OFFICES (TOWER DISPLAY - 73 FL)(ADDITIONAL USE F-2)							Maximum Person Permitted:340
Floor Number(s) - 54	B	100	6	121186251-01	Temporary	08/17/202	
Description of Use :Offices : OFFICES (TOWER DISPLAY - 74 FL)(ADDITIONAL USE F-2)							Maximum Person Permitted:380
Floor Number(s) - 55	B	100	6	121186251-01	Temporary	08/17/202	
Description of Use :Offices : OFFICES (TOWER DISPLAY - 75 FL)(ADDITIONAL USE F-2)							Maximum Person Permitted:380
Floor Number(s) - 56	B	100	6	121186251-01	Temporary	08/17/202	
Description of Use :Offices : OFFICES (TOWER DISPLAY - 76 FL) (ADDITIONAL USE F-2)							Maximum Person Permitted:380
Floor Number(s) - 57	B	100	6	121186251-01	Temporary	08/17/202	
Description of Use :Offices : OFFICES (TOWER DISPLAY - 77 FL) (ADDITIONALY USE F-2)							Maximum Person Permitted:380
Floor Number(s) - 58	A-2	100	6	121186251-01	Temporary	08/17/202	
Description of Use :Cafeteria : FULL FLOOR PLACE OF ASSEMBLY (A-2 CAFE/DINING AREA, A-3 MEETING ROOMS, COMMERCIAL KITCHEN ACCESSORY TO PLACE OF ASSEMBLY) (TOWER DISPLAY 78 FL) (ADDITIONAL USE F-2)							Maximum Person Permitted:446
Floor Number(s) - 60	F-2	100	6	121186251-01	Temporary	08/17/202	
Description of Use :Mechanical and/or electrical equipment rooms : MECHANICAL ROOMS, STORMWATER TANK, ELEVATOR OVERRUN, FP TANK, ELEV. MACHINE ROOM (TOWER DISPLAY M79 FL)							Maximum Person Permitted:112
Floor Number(s) - 61	F-2	100	6	121186251-01	Temporary	08/17/202	
Description of Use :Mechanical and/or electrical equipment rooms : MECHANICAL ROOMS, PUMP ROOMS, FIRE PUMP ROOM, SETBACK ROOF, WINDOW WASHING EQUIPMENT, SATELLITE DISHES (TOWER DISPLAY 80 FL)							Maximum Person Permitted:50
Floor Number(s) - 61	A-2	100	6	121186251-01	Temporary	08/17/202	
Description of Use :Cafeteria : CAFE/DINING AREA, ROOF TERRACE ACCESSORY TO INTERIOR CAFE/DINING (TOWER DISPLAY 80 FL) (A-2 & A-3 USE)							Maximum Person Permitted:300
Floor Number(s) - 62	B	100	6	121186251-01	Core & Shell	08/17/202	

Description of Use :Offices : OFFICES (TOWER DISPLAY - 81 FL) (ADDITIONAL USE F-2)						Maximum Person Permitted:0
Floor Number(s) - 63	B	100	6	121186251-01	Temporary	08/17/202
Description of Use :Offices : OFFICE (TOWER DISPLAY - 82 FL) (ADDITIONAL USE F-2)						Maximum Person Permitted:198
Floor Number(s) - 64	B	100	6	121186251-01	Temporary	08/17/202
Description of Use :Offices : OFFICES (TOWER DISPLAY - 83 FL) (ADDITIONAL USE F-2)						Maximum Person Permitted:195
Floor Number(s) - 65	F-2	100	6	121186251-01	Temporary	08/17/202
Description of Use :Mechanical and/or electrical equipment rooms : MECHANICAL (TOWER DISPLAY - 97 FL)						Maximum Person Permitted:67
Floor Number(s) - 66	F-2	100	6	121186251-01	Temporary	08/17/202
Description of Use :Mechanical and/or electrical equipment rooms : MECHANICAL ROOM, FIRST RESPONDER, FIRE PUMP, SATELLITE (TOWER DISPLAY - 98 FL)						Maximum Person Permitted:62
Mezzanine - 66	F-2	100	6	121186251-01	Temporary	08/17/202
Description of Use :Mechanical and/or electrical equipment rooms : MECHANICAL -MZ 66 -(TOWER - 99FL)						Maximum Person Permitted:42
Floor Number(s) - 67	A-2	100	6	121186251-01	Temporary	08/17/202
Description of Use :Eating and Drinking : EATING & DRINKING(A-2),EXHIBITION GALLERY(A-3)(COMPARTMENT 67B)(TOWER DISPLAY 100-FL)(OB DECK)						Maximum Person Permitted:366
Floor Number(s) - 67	A-2	100	6	121186251-01	Temporary	08/17/202
Description of Use :Eating and Drinking : EATING & DRINKING(A-2),EXHIBITION GALLERY(A-3)(COMPARTMENT 67A)(TOWER DISPLAY 100-FL)(OB-DECK)						Maximum Person Permitted:284
Floor Number(s) - 67	F-2	100	6	121186251-01	Temporary	08/17/202
Description of Use :Mechanical and/or electrical equipment rooms : BOH OFFICE/STORAGE(F-2)(COMPARTMENT 67B)(TOWER DISPLAY 100-FL)(OB DECK)						Maximum Person Permitted:6
Floor Number(s) - 67	A-2	100	6	121186251-01	Temporary	08/17/202
Description of Use :Eating and Drinking : LOCKER ROOM(ACCESSORY TO A-3 & A-2)(COMPARTMENT 67B)(TOWER DISPLAY 100 FL) (OB DECK)						Maximum Person Permitted:23
Floor Number(s) - 68	F-2	100	6	121186251-01	Temporary	08/17/202
Description of Use :Mechanical and/or electrical equipment rooms : ACCESSORY KITCHEN(COMPARTMENT 68B)(TOWER DISPLAY-101 FL)(OB DECK)						Maximum Person Permitted:9
Floor Number(s) - 68	A-3	100	6	121186251-01	Temporary	08/17/202
Description of Use :Community/Exhibition/Lecture Hall : EXHIBITION GALLERY(A-						Maximum Person Permitted:74

3)(COMPARTMENT 68A)(TOWER DISPLAY 101 FL)OB DECK

Floor Number(s) - 68 A-2 100 6 121186251-01 Temporary 08/17/202

Description of Use :Eating and Drinking : EATING & DRINKING (COMPARTMENT 68B)(TOWER DISPLAY-101 FL)(OB DECK) Maximum Person Permitted:318

Floor Number(s) - 68 A-2 100 6 121186251-01 Temporary 08/17/202

Description of Use :Eating and Drinking : MULTIFUNCTION(COMPARTMENT 68A)(TOWER DISPLAY-101 FL)(OB DECK) (A-2, A-3 USE) Maximum Person Permitted:338

Penthouse - 1 F-2 100 6 121186251-01 Temporary 08/17/202

Description of Use :Mechanical and/or electrical equipment rooms : ELEVATOR MACHINE ROOM,ELEVATOR RUN,MECHANICAL ACCESS. (PENTHOUSE) Maximum Person Permitted:7

Roof A-5 100 6 121186251-01 Temporary 08/17/202

Description of Use :Other : AERIAL ADVENTURE COURSE (TOWER DISPLAY-102-LEVEL 1,2,3) (NOT A PLACE OF ASSEMBLY) Maximum Person Permitted:66

Roof F-2 100 6 121186251-01 Temporary 08/17/202

Description of Use :Mechanical and/or electrical equipment rooms : COOLING TOWER,ELEVATOR LOBBY,TOWER CT,BMU,ELEVATOR OVERRUN(TOWER DISPLAY -102-LEVEL 1,2,3,) Maximum Person Permitted:8

CofO Comments: NB - 121331763 (530 WEST 33RD STREET) PLATFORM This New Building Application 121331763 is for the construction of a platform over the existing MTA/LIRR Eastern Rail Yards. DOB has no Jurisdiction over this Facility. All Egress for the Rail Yards is provided separately and independently from this Platform. All future construction above or incorporated within this platform will be filed under a separate applications with the Department of Buildings for their review as applicable to the specific work proposed. Revisions to this filing will be made based on these future reviews. All proposed spaces below the base flood elevation will be dry flood proofed. The foundation and structural work in this application located below the floor elevation has been designed to withstand hydrostatic and hydrodynamic forces for dry floodproofed structures ASCE 24. NB 121186251 (500 West 33rd Street) These premises have been declared to be one zoning lot as per section 12-10 of the zoning resolution consisting of tax lots 4, 10, 125, 150 in block 702 recorded at city register under CRFN 2015000064092 & 2015000064093. This structure is located in Zone X per the DOB 2013 Firm Maps. All Construction below the Design flood elevation has been dry proofed.

Borough Commissioner



Commissioner

