

Manhattan Community Board 4

(All Fields Must Be Completed)

| | | | | | | | |
|---|---|--------------------------------|--|---|--|-------------------------------|--|
| CORPORATION NAME | | DOING BUSINESS AS (DBA) | | | | | |
| Mad for Chicken Chelsea LLC | | Mad for Chicken | | | | | |
| STREET ADDRESS | | CROSS STREETS | | ZIP CODE | | | |
| 153 8th Avenue | | W. 17th & 18th Street | | 10011 | | | |
| OWNER <small>(Attach a list of all the people that will be associated/listed with the license)</small> | NAME: | Clinton Oh | | ATTORNEY/ REPRESENTATIVE | NAME: | James Wang | |
| | PHONE: | (917)903-4043 | | | PHONE: | (212)2193070 | |
| | EMAIL: | ceo@clintonoh.com | | | EMAIL: | j.y.wang.ny@gmail.com | |
| MANAGER | NAME: | same above | | LANDLORD | NAME: | 151 Eightstone LP; c/o KSR | |
| | PHONE: | | | | PHONE: | (212)417-9217 | |
| | EMAIL: | | | | EMAIL: | kschwimmer@tarterkrinsky.com | |
| APPLICATION TYPE (<input checked="" type="checkbox"/> <i>Liquor License</i> _____ <i>Unenclosed Sidewalk Cafe</i>) | | | | | | | |
| <input checked="" type="checkbox"/> New | Has applicant owned or managed a similar business? | | | <input checked="" type="radio"/> YES | <input type="radio"/> NO | Mad for Chicken | |
| | What is/was the name and address of establishment? | | | (Bayside, Sunnyside, Brooklyn) | | | |
| | What were the dates applicant was involved with this former premise? | | | two years | | | |
| <input type="radio"/> Corp Change/Class Change/Removal | What is the license # and expiration date? | | | | | | |
| | Is applicant making any alterations or operational changes? | | | <input type="radio"/> YES | <input type="radio"/> NO | | |
| | If alterations or operational changes are being made, please describe/list all changes. | | | | | | |
| <input type="radio"/> Alteration | What is the current license # and expiration date? | | | | | | |
| | Please list/describe the nature of all the changes and attach the plans: | | | | | | |
| METHOD OF OPERATION | | | | | | | |
| TYPE OF ALCOHOL | <input checked="" type="radio"/> Liquor/Wine/Beer & Cider <input type="radio"/> Beer & Cider <input type="radio"/> Wine/Beer & Cider | | | | | | |
| ESTABLISHMENT TYPE | <input checked="" type="radio"/> Restaurant <input type="radio"/> Cabaret <input type="radio"/> Night Club <input type="radio"/> Hotel <input type="radio"/> Bar/Tavern <input type="radio"/> Catering Establishment <input type="radio"/> Adult Entertainment <input type="radio"/> Wine Bar <input type="radio"/> Dance Club <input type="radio"/> Sports Bar <input type="radio"/> Club (Fraternal Organization – Members Only) | | | | | | |
| Has applicant/owner filed with the SLA? If yes, when? If no, when do you plan to file? | | | | <input type="radio"/> YES | <input checked="" type="radio"/> NO | after community board meeting | |
| Is the 500 Foot Rule applicable? If yes, please attach a diagram of the On-Premise liquor license establishments within a 500 ft. radius of your establishment and the Public Interest Statement. | | | | <input checked="" type="radio"/> YES | <input type="radio"/> NO | | |
| Is the 200 Foot Rule applicable? If yes, please attach a diagram of the schools and houses of worship that trigger the rule. | | | | <input type="radio"/> YES | <input checked="" type="radio"/> NO | | |
| Has applicant/owner(s) read MCB4 Policy Regarding Concentration and Location of Alcoholic-Serving Establishments? | | | | <input checked="" type="radio"/> YES | <input type="radio"/> NO | | |

OPERATIONAL DETAILS (*Closing time will be when establishment is vacated of all patrons)

| HOURS* <i>(Indoor Only)</i> | | MONDAY | TUESDAY | WEDNESDAY | THURSDAY | FRIDAY | SATURDAY | SUNDAY |
|---|------------------|---------|-------------------|------------|----------|----------|----------|---------|
| | Operation | 11A-12A | 11A-12A | 11A-12A | 11A-12A | 11A-12A | 11A-12A | 11A-12A |
| | Kitchen | 11A-12A | 11A-12A | 11A-12A | 11A-12A | 11A-12A | 11A-12A | 11A-12A |
| | Music | 11A-10P | 11A-10P | 11A-10P | 11A-10P | 11A-10P | 11A-10P | 11A-10P |
| If you plan to have music, what type(s)? (Circle all that apply) | | | BACKGROUND | LIVE MUSIC | DJ | JUKE BOX | KARAOKE | |

OCCUPANCY

| | Capacity (Certificate of Occupancy) | Maximum # of Persons Occupying Premises (Including Employees) | Number of Tables | Number of Seats | Number of Service Only Bars | Number of Stand-Up Bars | Number of Seats at Stand-Up Bar |
|---|--|---|------------------|-----------------|-----------------------------|-------------------------|---------------------------------|
| INSIDE | 74 | 52 | 19 | 42 | 0 | 1 | 4 |
| OUTSIDE <i>(Other than sidewalk café)</i> | | | | | | | |
| DCA APPROVED UNENCLOSED SIDEWALK CAFÉ | | | | | | | |

| | | | |
|--|--|-------------------------------------|-----|
| How many floors are there? What is the capacity for each floor? | 2 floor, 1st floor 46, basement for storage only | | |
| How frequently will the owner(s) be at the establishment? | Owner or manager will at the premise all time | | |
| Will there be dancing? | YES | <input checked="" type="radio"/> NO | |
| Will applicant have bottle or table service for beverage alcohol? | YES | <input checked="" type="radio"/> NO | |
| Will applicant be hosting private; promotional or corporate events? | YES | <input checked="" type="radio"/> NO | |
| Will outside promoters be used on a regular basis? If yes please describe. | YES | <input checked="" type="radio"/> NO | |
| Will applicant have a security plan? If, yes please attach. | YES | <input checked="" type="radio"/> NO | |
| Will security plan be implemented? | YES | NO | N/A |
| Will State certified security personnel be used? | YES | NO | N/A |
| Will New York Nightlife Association and NYPD Best Practices be followed? | <input checked="" type="radio"/> YES | NO | |
| Does applicant agree to notify MCB4 prior to making changes to its method of operation? | <input checked="" type="radio"/> YES | NO | |
| Will applicant be using delivery bicycles? If yes, how many? | YES | <input checked="" type="radio"/> NO | |
| Will delivery bicycles be clearly marked with the name of the restaurant and will staff wear attire clearly noting name as described by NYC Law? | YES | NO | N/A |
| Where will delivery bicycles be stored during the day when not in use? | N/A | | |

LOCATION & ZONING

| | | | |
|---|-----|----|----------|
| Is this a Special District? If yes, is it Clinton, West Chelsea or Hudson Yards? | YES | NO | not sure |
| Does the building have a Certificate of Occupancy ("C of O") or a letter of no objection? | YES | NO | |
| Is a Public Assembly permit required? | YES | NO | |
| Are your plans filed with DOB? | YES | NO | |

Community Notification/Relations

| | | |
|--|----------------|---|
| NOTIFICATION: List all block associations; tenant associations, co-op boards or condo boards of residential buildings; and community groups that applicant has notified regarding its application. For each please list both the organization and individual you contacted | # 1 | 100 West 17th/18th Street Block Association/Antonella |
| | # 2 | 100 West 17th/18th Street Block Association/Donna |
| | # 3 | 100 West 17th/18th Street Block Association/Michael |
| | # 4 | 100 West 17th/18th Street Block Association/Judy |
| | # 5 | |
| Please provide dates when applicant met with the groups listed above. | by email | |
| Who was your contact person at each group you met with? | refer above | |
| When did applicant post the notice that was provided? | 09/07/2021 | |
| Where did applicant post the notice that was provided? | front of store | |
| Will applicant provide owner cell phone number to neighbors and respond to complaints that arise? Please provide number in space provided. | YES | NO |
| Will applicant inform the Community Board office of its job openings and/or provide a hyperlink to applicants jobs webpage? | YES | NO |

| BUILDING DESIGN | | | |
|---|--------------------------------------|-------------------------------------|--|
| State the name and type of business previously located in the space. | BAREBURGER CHELSEA | | |
| Has a liquor-licensed establishment previously occupied this space at any time? If yes, please provide the name of the business. | <input checked="" type="radio"/> YES | <input type="radio"/> NO | NGM MANAGEMENT GROUP LLC |
| Do you plan any changes to the existing façade? If yes, please describe. | <input type="radio"/> YES | <input checked="" type="radio"/> NO | |
| Has the applicant/owner(s) read MCB 4 ADA Guidelines Memo? | <input checked="" type="radio"/> YES | <input type="radio"/> NO | |
| Is the entrance ADA Compliant? | <input checked="" type="radio"/> YES | <input type="radio"/> NO | |
| Do you plan any changes to the existing façade? If yes, please describe. | <input type="radio"/> YES | <input checked="" type="radio"/> NO | |
| Will applicant have a vestibule within the establishment? | <input checked="" type="radio"/> YES | <input type="radio"/> NO | |
| Will applicant use a storm enclosure? | <input type="radio"/> YES | <input checked="" type="radio"/> NO | |
| Does applicant agree to keep the sidewalk clear of all items or obstructions, such as sandwich boards, sidewalk signs, freestanding menus and plants, as per the law? | <input checked="" type="radio"/> YES | <input type="radio"/> NO | |
| Will applicant comply with the NYC noise code? | <input checked="" type="radio"/> YES | <input type="radio"/> NO | |
| Will the establishment have any of the following: (circle all that apply) | <input type="radio"/> FRENCH DOORS | <input type="radio"/> GARAGE DOORS | <input type="radio"/> WINDOWS THAT CAN BE OPENED |
| Will applicant close all windows, French doors, garage doors when any music or amplified sound (including televisions) is played inside the establishment? | <input checked="" type="radio"/> YES | <input type="radio"/> NO | |
| Will applicant close all windows, French doors, garage doors by 11 PM Friday and Saturday and 10 PM on all other days even if no music or amplified sound is played inside the establishment? | <input checked="" type="radio"/> YES | <input type="radio"/> NO | |
| Has applicant obtained an acoustical report from a certified sound engineer to assess potential noise disturbance to the neighboring residents and buildings? | <input checked="" type="radio"/> YES | <input type="radio"/> NO | |
| Will applicant follow the recommendations of a certified sound engineer to mitigate potential noise disturbance to the neighboring residents and buildings, including placing speakers on the floor of the establishment? | <input checked="" type="radio"/> YES | <input type="radio"/> NO | |
| Will the kitchen exhaust system extend to the roof? | <input checked="" type="radio"/> YES | <input type="radio"/> NO | |
| Will the establishment have an illuminated sign? | <input checked="" type="radio"/> YES | <input type="radio"/> NO | |
| Will the establishment have a canopy extending over the sidewalk? | <input type="radio"/> YES | <input checked="" type="radio"/> NO | |
| Where will the air conditioner be located? What type is it? | Roof, central air condition | | |
| When was the air conditioner installed? | 2008 | | |

OUTDOOR ITEMS - OTHER THAN SIDEWALK CAFÉ

| | | | |
|---|--------------------------------------|-------------------------------------|------------------------------|
| Has the applicant/owner(s) read MCB 4 Rear Yard Rooftop Policy? | <input checked="" type="radio"/> YES | <input type="radio"/> NO | |
| Will applicant use any outdoor spaces: rooftop, rear yard, patio, porch, balcony, pavilion, tents, deck, gazebo or open dining in the parking lane? If yes, which one(s)? | <input type="radio"/> YES | <input checked="" type="radio"/> NO | |
| Are the floorplans for the outdoor space(s) included? | <input type="radio"/> YES | <input type="radio"/> NO | we do not have sidewalk cafe |
| Will applicant close and vacate the outdoor space(s) by 11PM on Friday & Saturday and 10 PM on all other days? | <input type="radio"/> YES | <input type="radio"/> NO | N/A |
| Will the service and consumption of alcohol in any outdoor space only be via seated food service? | <input type="radio"/> YES | <input type="radio"/> NO | N/A |
| Will applicant not allow standing space for patrons to drink or smoke in any outdoor space(s) or on the sidewalk? | <input checked="" type="radio"/> YES | <input type="radio"/> NO | |
| Will there be no amplified music, as per the law? | <input checked="" type="radio"/> YES | <input type="radio"/> NO | |
| If amplified sound is played inside the establishment, will windows and doors be closed? | <input checked="" type="radio"/> YES | <input type="radio"/> NO | |
| Will applicant agree to post signs outside asking customers to respect the neighbors'? | <input checked="" type="radio"/> YES | <input type="radio"/> NO | |
| Will applicant agree to train staff to encourage a peaceful environment? | <input checked="" type="radio"/> YES | <input type="radio"/> NO | |
| Will applicant provide effective sound control (landscaping enclosure, soundproofing tenants apartments) | <input checked="" type="radio"/> YES | <input type="radio"/> NO | |
| Will there be a lighting plan that allows safe usage of the outdoor space without disrupting neighbors? | <input checked="" type="radio"/> YES | <input type="radio"/> NO | |
| If open dining in the parking lane, will applicant agree to leave the sidewalk free of any furniture? | <input checked="" type="radio"/> YES | <input type="radio"/> NO | |
| If open dining, will you comply with all NYC DOT guidelines? | <input checked="" type="radio"/> YES | <input type="radio"/> NO | |
| If open dining, will the installation be year-round? | <input checked="" type="radio"/> YES | <input type="radio"/> NO | |

| DCA APPROVED UNENCLOSED SIDEWALK CAFÉ | | | |
|---|-----|----|-------------------------------|
| Has the applicant/owner(s) read MCB4 Sidewalk Café Policy? | YES | NO | we do not apply sidewalk cafe |
| Will applicant be applying for a sidewalk café now or in the future? | YES | NO | |
| Is applicant in this application seeking to include a sidewalk café in its liquor license? | YES | NO | |
| If yes, has applicant submitted an application and plans to NYC Dept. of Consumer Affairs? Please attach application and plans. | YES | NO | |
| Will applicant close and vacate the sidewalk café by 11 PM on Friday & Saturday and 10 PM on all other days? | YES | NO | |
| Will applicant be serving alcohol in the sidewalk café? If so, will you have waiter service? | YES | NO | |
| Will the café have a 3 ft. wide serving aisle running the entire length of the sidewalk cafe? | YES | NO | |
| Will applicant mark the perimeter of the café on the sidewalk? | YES | NO | |
| Will the service and consumption of alcohol in the sidewalk café only be via seated food service? | YES | NO | |
| Will the sidewalk café not provide standing space for drinking or smoking? | YES | NO | |
| Will applicant use any portable natural gas heaters? If so, do you have the requisite approvals from DOB & the Fire Department? | YES | NO | |
| Will applicant have a lighting plan that will allow safe usage of the outdoor space without disrupting neighbors? | YES | NO | |
| Will all furniture, plants and barricades be stored inside between the evening closing hours and the morning opening hours? | YES | NO | |
| Will all furniture be stored inside between December 21 st and March 21 st , and any other day when it rains or snows? | YES | NO | |
| Will applicant use umbrellas? | YES | NO | |
| If construction or construction protection has reduced the sidewalk width, will applicant always maintain an 8 foot clear path of sidewalk between the perimeter of the café and the closest obstruction including construction barricades? | YES | NO | |
| If open dining is in the parking lane, will applicant agree to remove its sidewalk café? | YES | NO | |

ADDITIONAL STIPULATIONS: (Office Use Only)

To the extent any additional stipulation on pages 7 and 8 of this application conflicts with any response on pages 1 – 6 of this application, the stipulations on pages 7 and 8 control.

ADDITIONAL STIPULATIONS: (Office Use Only), *Continued*

To the extent any additional stipulation on pages 7 and 8 of this application conflicts with any response on pages 1 – 6 of this application, the stipulations on pages 7 and 8 control.

Manhattan Community Board 4 (MCB4) recommends:
 (MCB4's recommendation is based on a vote taken at its
 October 6, 2021 full board meeting, with 43 members voting in favor
 of the recommendation, 0 members opposed, 0 members
 abstaining and 0 present but not eligible)

Denial unless all stipulations agreed to by applicant/owner are part of the method of
 operation
 Denial Approval

CB4 REPRESENTATIVES

| | | |
|---|---|---|
|  Nelly Gonzalez <i>CB4 Assistant District Manager</i> |  Frank Holozubiec <i>CB4 BLP Committee Co-Chair</i> |  Burt Lazarin <i>CB4 BLP Committee Co-Chair</i> |
|---|---|---|

APPLICANT AGREEMENT WITH THE COMMUNITY

Applicant agrees to these stipulations as the basis for the community support of this application and acknowledges that all of these stipulations are essential prerequisites to the MCB4 recommendation regarding this application. Applicant agrees to have these stipulations incorporated in the method of operation of its liquor license. The stipulations in this application constitute the entire agreement between MCB4 and applicant and may only be altered in writing signed by MCB4 and applicant. These stipulations supersede any oral statements or representations in connection with this application.

| | | | |
|---------------------------|---|--|--------------------------------------|
| <p>SIGN HERE →</p> | <p>Clinton Oh</p> <p>PRINT NAME OF APPLICANT</p> |  <p>SIGNATURE OF APPLICANT</p> | <p>08/21/2021</p> <p>DATE</p> |
|---------------------------|---|--|--------------------------------------|

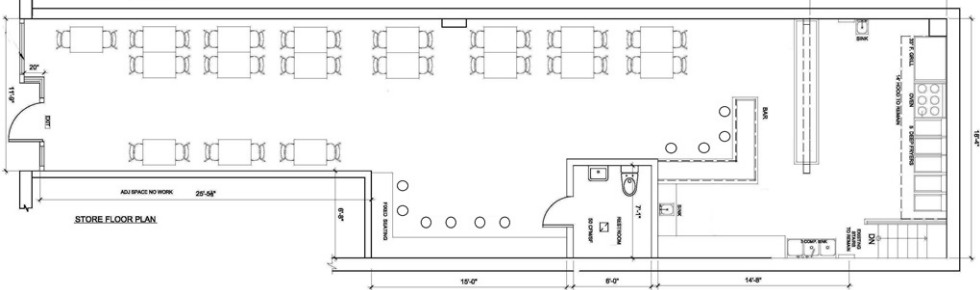

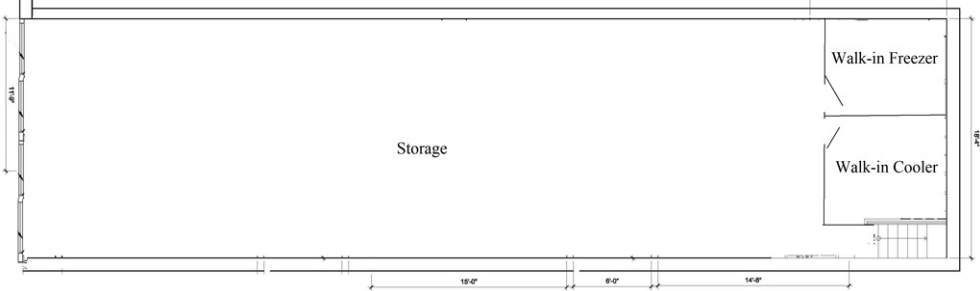

SANDWICH



BULGOGI CHEESE SANDWICH \$14

Korean-style marinated beef, onions, peppers, white American cheese, long soft roll with fries

CAJUN CHICKEN AVOCADO SANDWICH \$14

Cajun marinated grilled chicken, melted mozzarella cheese, tomato, honey mustard vinaigrette, toasted long soft roll with fries

SPECIAL

BUDAE JUNGOL \$30

Hot and spicy soup with sausage, ham, kimchi, tofu and ramen.

(Add Noodle \$2 / Cheese \$2 / Sausage & Ham \$4)

MADLY RICE



KIMCHI FRIED RICE \$14

Pan-fried white rice with kimchi, ham, vegetables and sunny side egg (Add Mozzarella cheese \$2)

BULGOGI OVER RICE \$15

Steamed white rice topped with thinly sliced marinated beef rib-eye and vegetables (Add Egg \$1)

BURRITO BOWL \$15

Select a Protein: Chicken or Bulgogi

With your choice of protein, rice, beef chili, corn, pico, jalapeno, guacamole and spicy cream on top.



SALAD

Add Grilled Chicken \$3 / Fresh Avocado \$4

AVOCADO SALAD \$13

Mixed greens, fresh-cut avocados, grape tomatoes with olive oil and a sesame dressing



CRABMEAT SALAD \$12

Mixed greens, spicy mayo crabmeat, grape tomatoes with olive oil and a homemade mustard dressing



SIDE

Kimchi \$2 / Corn salad \$2 / Pico \$2 / Radish \$2 / Celery & Carrot \$3

Dipping \$1 - Honey mustard / Spicy mayo / Blue cheese / Ranch

***Please inform us if a person in your party has food allergy.
Our dishes may contain wheat, egg, dairy, soy or fish allergens.

Share your experience with us
[@Mad_for_chicken](#)





Our Signature Fried Chicken is organic, breaded, double fried with vegetable oil and individually brushed with love. 30 minutes cooking time but trust us its worth the wait!

CHICKEN

★ CHOOSE YOUR SAUCE ★

Soy Garlic / Spicy Soy Garlic / Half & Half



MFC SIGNATURE CHICKEN

WINGS

Small: 10 pcs \$13.95
Medium: 20 pcs \$25.75
Large: 30 pcs \$36.45

COMBO

Small (3 Drumsticks & 5 Wings) \$13.95
Medium (5 Drumsticks & 10 wings) \$25.75
Large (8 Drumsticks & 15 wings) \$36.45

BONELESS BREASTS

Medium: 10 pcs \$13.95
Large: 20 pcs \$25.75

BUFFALO WINGS (Bone-In or Boneless)

Choose Your Sauce
(Hickory BBQ / Hot & Spicy / Jalapeno BBQ / Sweet & Spicy)

Small: 10 pcs \$13.95
Medium: 20 pcs \$25.75
Large: 30 pcs \$36.45

DRUMSTICKS

Small: 5 pcs \$13.95
Medium: 10 pcs \$25.75
Large: 15 pcs \$36.45



SCALLION CHICKEN

Deep-fried boneless breast with scallion, red onion with sweet mustard sauce

Medium: 8 pcs \$15
Large: 12 pcs \$22

STARTERS



KIMCHI FRIES \$12

Topped with onion, kimchi, scallion, and spicy mayo drizzled on top

PARMESAN FRIES \$8

Topped with Parmesan Cheese, garlic and chopped parsley. Served with spicy mayo and ketchup

SWEET POTATO FRIES \$9

Deep fried Sweet Potato fries served with habanero honey and ketchup

TRUFFLE FRIES \$10

Topped with truffle oil, garlic, chopped parsley and served with spicy mayo and ketchup



MAC & MELTED CHEESE \$12

Cooked macaroni with Jack & Cheddar cheese, Mozzarella cheese and cream

KIMCHI QUESADILLA \$15

Select a protein: Chicken or Bulgogi
Monterey jack and cheddar cheese and kimchi, onion, corn, pico, and spicy cream on top.



FRIED DUMPLING \$9

Choose Your Sauce (Mild / Hot / Half & Half)
Deep fried dumplings filled with beef, pork and vegetables

TOPPOKI \$18

Braised rice cake, fish cake, scallion, onion, cabbage with our special spicy sauce
(Add Cheese \$2 / Noodle \$2 / Sausage \$2 / Dumpling (4pcs) \$4)

MAD NACHOS \$18

Tortilla chips, monterey jack and cheddar cheese, beef chili, corn, pico, jalapeno, spicy crema on top. (Add Guacamole \$2)

BAREBURGER
ORGANIC



212.414.bare

153

bareburger.com

RETAIL
SPACE
212.498.3700

RETAIL
SPACE
212.498.3700



THE
IMPOSSIBLE
BURGER.
TRY IT NOW!



Active On Premises Liquor Licenses within 500 feet

| Name | Address | Distance |
|--|--|-----------------|
| 8BELLES LLC Ser #: 1332890 | 151 8TH AVE NEW YORK, NY 10011 | 44 ft |
| CHIPOTLE MEXICAN GRILL OF COLORADO LLC Ser #: 1221368 | 149 8TH AVE NEW YORK, NY 10011 | 87 ft |
| SILOM THAI INC Ser #: 1291524 | 150 8TH AVE NEW YORK, NY 10011 | 123 ft |
| 161 8TH AVE RESTAURANT LLC Ser #: 1299917 | 161 8TH AVE NEW YORK, NY 10011 | 156 ft |
| MEXICUE 160 8TH AVENUE LLC Ser #: 1298926 | 160 8TH AVE NEW YORK, NY 10011 | 161 ft |
| TEAM MWB LLC Ser #: 1161532 | 167 8TH AVENUE NEW YORK, NY 10001 | 226 ft |
| 169 EIGHTH RESTAURANT CORP Ser #: 1279926 | 169 8TH AVE NEW YORK, NY 10011 | 238 ft |
| 174 EIGHTH REST CORP Ser #: 1310305 | 174 8TH AVE NEW YORK, NY 10011 | 327 ft |
| MVLH HOSPITALITY GROUP LLC Ser #: 1318652 | 176 8TH AVE NEW YORK, NY 10011 | 346 ft |
| ELGIN THEATRE FOUNDATION INC Ser #: 1024878 | 175 8TH AVE NEW YORK, NY 10011 | 353 ft |
| GAUTENG LLC Ser #: 1309686 | 116 8TH AVE A/K/A 260 W 16TH ST NEW YORK, NY 10011 | 447 ft |
| NEW HK 2 LLC Ser #: 1319713 | 182 8TH AVE NEW YORK, NY 10011 | 449 ft |
| CKBA LLC Ser #: 1326556 | 263 W 19TH ST NEW YORK, NY 10011 | 457 ft |
| EIGHTH AVENUE KITCHEN LLC Ser #: 1323689 | 184 8TH AVE NEW YORK, NY 10011 | 472 ft |

500 Foot Rule Public Interest Statement

Re: Mad for Chicken Chelsea LLC
DBA: Mad for Chicken
153 8th Avenue
New York, NY 10011

This will apply for a liquor license.

- 1) This is a full service restaurant, not a bar.
- 2) This is Franchise Store
- 3) There are 1000 square feet at first floor, 800 SF at basement (for storage only).
- 4) The premises hold a restaurant wine license for 10 years and have no liquor violations.
- 5) The principal holds liquor licenses more than 2 years and have no liquor violations.
- 6) We do have all necessary licenses and permits from the state and the NYC.
- 7) We only have background music. It will be no increase in noise levels.
- 8) Most, if not all, a restaurant provide alcoholic beverages upon, it is customary. It is part of eating culture and tradition to serve beer, wine, and liquor with a food. The liquor is as essential to an authentic meal. Since we are a franchise restaurant we would like to provide our customers with true experience. Although there are restaurants within a 500 feet radius that serve alcoholic drinks, these restaurants are very different in styles. There will be no dancing or improper behavior within our premises. We only wish to serve liquor with our dishes to enhance the dining experience.