

Manhattan Community Board 4

Liquor License/Sidewalk Cafe Stipulations Application

(All Fields Must Be Completed)

CORPORATION NAME		DOING BUSINESS AS (DBA)					
Ari Sushi Inc.		Ari Sushi Inc.					
STREET ADDRESS		CROSS STREETS		ZIP CODE			
402 West 44th Street, New York, NY		9th & 10th Avenue		10036			
OWNER <small>(Attach a list of all the people that will be associated/listed with the license)</small>	NAME:	Tongqing Zheng		ATTORNEY/ REPRESENTAIVE	NAME:	James Wang	
	PHONE:	(917)9121289			PHONE:	(212)2193070	
	EMAIL:	jjbbqzheng@gmail.com			EMAIL:	j.y.wang.ny@gmail.com	
MANAGER	NAME:	same as above		LANDLORD	NAME:	Ninth Avenue Realty LLC	
	PHONE:				PHONE:	(917)299-7095	
	EMAIL:				EMAIL:		
APPLICATION TYPE (<input checked="" type="checkbox"/> <i>Liquor License</i> <input type="checkbox"/> <i>Unenclosed Sidewalk Cafe</i>)							
<input checked="" type="checkbox"/> New	Has applicant owned or managed a similar business?			YES	NO	Yes	
	What is/was the name and address of establishment?			Umi Sushi Inc, 118 E 31st St., NY 10016			
	What were the dates applicant was involved with this former premise?			09/27/2005			
<input type="checkbox"/> Corp Change/Class Change/Removal	What is the license # and expiration date?						
	Is applicant making any alterations or operational changes?			YES	NO		
	If alterations or operational changes are being made, please describe/list all changes.						
<input type="checkbox"/> Alteration	What is the current license # and expiration date?						
	Please list/describe the nature of all the changes and attach the plans:						
METHOD OF OPERATION							
TYPE OF ALCOHOL	<input type="checkbox"/> Liquor/Wine/Beer & Cider		<input type="checkbox"/> Beer & Cider		<input checked="" type="checkbox"/> Wine/Beer & Cider		
ESTABLISHMENT TYPE	<input checked="" type="checkbox"/> Restaurant <input type="checkbox"/> Cabaret <input type="checkbox"/> Night Club <input type="checkbox"/> Hotel <input type="checkbox"/> Bar/Tavern <input type="checkbox"/> Catering Establishment <input type="checkbox"/> Adult Entertainment <input type="checkbox"/> Wine Bar <input type="checkbox"/> Dance Club <input type="checkbox"/> Sports Bar <input type="checkbox"/> Club (Fraternal Organization – Members Only)						
Has applicant/owner filed with the SLA? If yes, when? If no, when do you plan to file?				YES	NO	No	
Is the 500 Foot Rule applicable? If yes, please attach a diagram of the On-Premise liquor license establishments within a 500 ft. radius of your establishment and the Public Interest Statement.				YES	NO	Not applicable	
Is the 200 Foot Rule applicable? If yes, please attach a diagram of the schools and houses of worship that trigger the rule.				YES	NO	Not applicable	
Has applicant/owner(s) read MCB4 Policy Regarding Concentration and Location of Alcoholic-Serving Establishments?				YES	NO	Yes	

OPERATIONAL DETAILS (*Closing time will be when establishment is vacated of all patrons)

HOURS* <i>(Indoor Only)</i>		MONDAY	TUESDAY	WEDNESDAY	THURSDAY	FRIDAY	SATURDAY	SUNDAY
	Operation	11A-12A	11A-12A	11A-12A	11A-12A	11A-12A	11A-12A	11A-12A
	Kitchen	11A-12A	11A-12A	11A-12A	11A-12A	11A-12A	11A-12A	11A-12A
	Music	11A-10P	11A-10P	11A-10P	11A-10P	11A-10P	11A-10P	11A-10P
If you plan to have music, what type(s)? (Circle all that apply)		BACKGROUND		LIVE MUSIC	DJ	JUKE BOX	KARAOKE	

OCCUPANCY

	Capacity (Certificate of Occupancy)	Maximum # of Persons Occupying Premises (Including Employees)	Number of Tables	Number of Seats	Number of Service Only Bars	Number of Stand-Up Bars	Number of Seats at Stand-Up Bar
INSIDE	48	35	11	22	0	1	4
OUTSIDE <i>(Other than sidewalk café)</i>	N/A						
DCA APPROVED UNENCLOSED SIDEWALK CAFÉ	N/A						

How many floors are there? What is the capacity for each floor?	One Floor, 48	
How frequently will the owner(s) be at the establishment?	Full Time	
Will there be dancing?	YES	NO
Will applicant have bottle or table service for beverage alcohol?	YES	NO
Will applicant be hosting private; promotional or corporate events?	YES	NO
Will outside promoters be used on a regular basis? If yes please describe.	YES	NO
Will applicant have a security plan? If, yes please attach.	YES	NO
Will security plan be implemented?	YES	NO
Will State certified security personnel be used?	YES	NO
Will New York Nightlife Association and NYPD Best Practices be followed?	YES	NO
Does applicant agree to notify MCB4 prior to making changes to its method of operation?	YES	NO
Will applicant be using delivery bicycles? If yes, how many?	YES	NO
Will delivery bicycles be clearly marked with the name of the restaurant and will staff wear attire clearly noting name as described by NYC Law?	YES	NO
Where will delivery bicycles be stored during the day when not in use?	Front of store	

LOCATION & ZONING			
Is this a Special District? If yes, is it Clinton, West Chelsea or Hudson Yards?	YES	NO	No
Does the building have a Certificate of Occupancy ("C of O") or a letter of no objection?	YES	NO	Yes
Is a Public Assembly permit required?	YES	NO	N/A
Are your plans filed with DOB?	YES	NO	Yes

Community Notification/Relations				
NOTIFICATION: List all block associations; tenant associations, co-op boards or condo boards of residential buildings; and community groups that applicant has notified regarding its application. For each please list both the organization and individual you contacted	# 1	West 44th Street Better Block Association		
	# 2	West 44th Street (b. 9th/10th)		
	# 3			
	# 4			
	# 5			
Please provide dates when applicant met with the groups listed above.		send email on 7/29/2021		
Who was your contact person at each group you met with?		by email		
When did applicant post the notice that was provided?		yes		
Where did applicant post the notice that was provided?		Front of the restaurant		
Will applicant provide owner cell phone number to neighbors and respond to complaints that arise? Please provide number in space provided.		YES	NO	Yes
Will applicant inform the Community Board office of its job openings and/or provide a hyperlink to applicants jobs webpage?		YES	NO	Yes

BUILDING DESIGN			
State the name and type of business previously located in the space.	Boon European Bistro		
Has a liquor-licensed establishment previously occupied this space at any time? If yes, please provide the name of the business.	<input checked="" type="radio"/> YES	<input type="radio"/> NO	Gallo Nero w. 44th Inc; 1196151 Bkuk 6 Corp.; 1293813
Do you plan any changes to the existing façade? If yes, please describe.	<input checked="" type="radio"/> YES	<input type="radio"/> NO	Change the sign
Has the applicant/owner(s) read MCB 4 ADA Guidelines Memo?	<input checked="" type="radio"/> YES	<input type="radio"/> NO	
Is the entrance ADA Compliant?	<input checked="" type="radio"/> YES	<input type="radio"/> NO	
Do you plan any changes to the existing façade? If yes, please describe.	<input type="radio"/> YES	<input checked="" type="radio"/> NO	
Will applicant have a vestibule within the establishment?	<input type="radio"/> YES	<input checked="" type="radio"/> NO	
Will applicant use a storm enclosure?	<input type="radio"/> YES	<input checked="" type="radio"/> NO	
Does applicant agree to keep the sidewalk clear of all items or obstructions, such as sandwich boards, sidewalk signs, freestanding menus and plants, as per the law?	<input checked="" type="radio"/> YES	<input type="radio"/> NO	
Will applicant comply with the NYC noise code?	<input checked="" type="radio"/> YES	<input type="radio"/> NO	
Will the establishment have any of the following: (circle all that apply)	FRENCH DOORS	GARAGE DOORS	WINDOWS THAT CAN BE OPENED
Will applicant close all windows, French doors, garage doors when any music or amplified sound (including televisions) is played inside the establishment?	<input checked="" type="radio"/> YES	<input type="radio"/> NO	
Will applicant close all windows, French doors, garage doors by 11 PM Friday and Saturday and 10 PM on all other days even if no music or amplified sound is played inside the establishment?	<input checked="" type="radio"/> YES	<input type="radio"/> NO	
Has applicant obtained an acoustical report from a certified sound engineer to assess potential noise disturbance to the neighboring residents and buildings?	<input type="radio"/> YES	<input checked="" type="radio"/> NO	
Will applicant follow the recommendations of a certified sound engineer to mitigate potential noise disturbance to the neighboring residents and buildings, including placing speakers on the floor of the establishment?	<input checked="" type="radio"/> YES	<input type="radio"/> NO	
Will the kitchen exhaust system extend to the roof?	<input checked="" type="radio"/> YES	<input type="radio"/> NO	
Will the establishment have an illuminated sign?	<input type="radio"/> YES	<input checked="" type="radio"/> NO	
Will the establishment have a canopy extending over the sidewalk?	<input type="radio"/> YES	<input checked="" type="radio"/> NO	
Where will the air conditioner be located? What type is it?	My store roof, central air condition		
When was the air conditioner installed?	2021		

OUTDOOR ITEMS - OTHER THAN SIDEWALK CAFÉ

Has the applicant/owner(s) read MCB 4 Rear Yard Rooftop Policy?	<input checked="" type="radio"/> YES	<input type="radio"/> NO	
Will applicant use any outdoor spaces: rooftop, rear yard, patio, porch, balcony, pavilion, tents, deck, gazebo or open dining in the parking lane? If yes, which one(s)?	<input type="radio"/> YES	<input checked="" type="radio"/> NO	
Are the floorplans for the outdoor space(s) included?	<input type="radio"/> YES	<input type="radio"/> NO	N/A
Will applicant close and vacate the outdoor space(s) by 11PM on Friday & Saturday and 10 PM on all other days?	<input type="radio"/> YES	<input type="radio"/> NO	N/A
Will the service and consumption of alcohol in any outdoor space only be via seated food service?	<input type="radio"/> YES	<input type="radio"/> NO	N/A
Will applicant not allow standing space for patrons to drink or smoke in any outdoor space(s) or on the sidewalk?	<input type="radio"/> YES	<input type="radio"/> NO	N/A
Will there be no amplified music, as per the law?	<input type="radio"/> YES	<input type="radio"/> NO	
If amplified sound is played inside the establishment, will windows and doors be closed?	<input checked="" type="radio"/> YES	<input type="radio"/> NO	
Will applicant agree to post signs outside asking customers to respect the neighbors'?	<input checked="" type="radio"/> YES	<input type="radio"/> NO	
Will applicant agree to train staff to encourage a peaceful environment?	<input checked="" type="radio"/> YES	<input type="radio"/> NO	
Will applicant provide effective sound control (landscaping enclosure, soundproofing tenants apartments)	<input checked="" type="radio"/> YES	<input type="radio"/> NO	
Will there be a lighting plan that allows safe usage of the outdoor space without disrupting neighbors?	<input checked="" type="radio"/> YES	<input type="radio"/> NO	
If open dining in the parking lane, will applicant agree to leave the sidewalk free of any furniture?	<input type="radio"/> YES	<input type="radio"/> NO	N/A
If open dining, will you comply with all NYC DOT guidelines?	<input checked="" type="radio"/> YES	<input type="radio"/> NO	
If open dining, will the installation be year-round?	<input checked="" type="radio"/> YES	<input type="radio"/> NO	

DCA APPROVED UNENCLOSED SIDEWALK CAFÉ

Has the applicant/owner(s) read MCB4 Sidewalk Café Policy?	YES	NO	
Will applicant be applying for a sidewalk café now or in the future?	YES	NO	
Is applicant in this application seeking to include a sidewalk café in its liquor license?	YES	NO	N/A
If yes, has applicant submitted an application and plans to NYC Dept. of Consumer Affairs? Please attach application and plans.	YES	NO	N/A
Will applicant close and vacate the sidewalk café by 11 PM on Friday & Saturday and 10 PM on all other days?	YES	NO	N/A
Will applicant be serving alcohol in the sidewalk café? If so, will you have waiter service?	YES	NO	N/A
Will the café have a 3 ft. wide serving aisle running the entire length of the sidewalk cafe?	YES	NO	N/A
Will applicant mark the perimeter of the café on the sidewalk?	YES	NO	N/A
Will the service and consumption of alcohol in the sidewalk café only be via seated food service?	YES	NO	N/A
Will the sidewalk café not provide standing space for drinking or smoking?	YES	NO	N/A
Will applicant use any portable natural gas heaters? If so, do you have the requisite approvals from DOB & the Fire Department?	YES	NO	N/A
Will applicant have a lighting plan that will allow safe usage of the outdoor space without disrupting neighbors?	YES	NO	N/A
Will all furniture, plants and barricades be stored inside between the evening closing hours and the morning opening hours?	YES	NO	N/A
Will all furniture be stored inside between December 21 st and March 21 st , and any other day when it rains or snows?	YES	NO	N/A
Will applicant use umbrellas?	YES	NO	N/A
If construction or construction protection has reduced the sidewalk width, will applicant always maintain an 8 foot clear path of sidewalk between the perimeter of the café and the closest obstruction including construction barricades?	YES	NO	N/A
If open dining is in the parking lane, will applicant agree to remove its sidewalk café?	YES	NO	N/A

ADDITIONAL STIPULATIONS: (Office Use Only)

To the extent any additional stipulation on pages 7 and 8 of this application conflicts with any response on pages 1 – 6 of this application, the stipulations on pages 7 and 8 control.

ADDITIONAL STIPULATIONS: (Office Use Only), *Continued*



To the extent any additional stipulation on pages 7 and 8 of this application conflicts with any response on pages 1 – 6 of this application, the stipulations on pages 7 and 8 control.

Manhattan Community Board 4 (MCB4) recommends:
 (MCB4's recommendation is based on a vote taken at its
 October 6, 2021 full board meeting, with 43 members voting in favor
 of the recommendation, 0 members opposed, 0 members
 abstaining and 0 present but not eligible)

Denial unless all stipulations agreed to by applicant/owner are part of the method of
 operation

Denial Approval

CB4 REPRESENTATIVES

 Nelly Gonzalez CB4 Assistant District Manager	 Frank Holozubiec CB4 BLP Committee Co-Chair	 Burt Lazarin CB4 BLP Committee Co-Chair
--	--	--

APPLICANT AGREEMENT WITH THE COMMUNITY

Applicant agrees to these stipulations as the basis for the community support of this application and acknowledges that all of these stipulations are essential prerequisites to the MCB4 recommendation regarding this application. Applicant agrees to have these stipulations incorporated in the method of operation of its liquor license. The stipulations in this application constitute the entire agreement between MCB4 and applicant and may only be altered in writing signed by MCB4 and applicant. These stipulations supersede any oral statements or representations in connection with this application.

<p>SIGN HERE →</p>	<p>Tongqing Zheng</p> <p>PRINT NAME OF APPLICANT</p>	 <p>SIGNATURE OF APPLICANT</p>	<p>07/29/2021</p> <p>DATE</p>
---------------------------	---	--	--------------------------------------

FIRST FLOOR PLAN

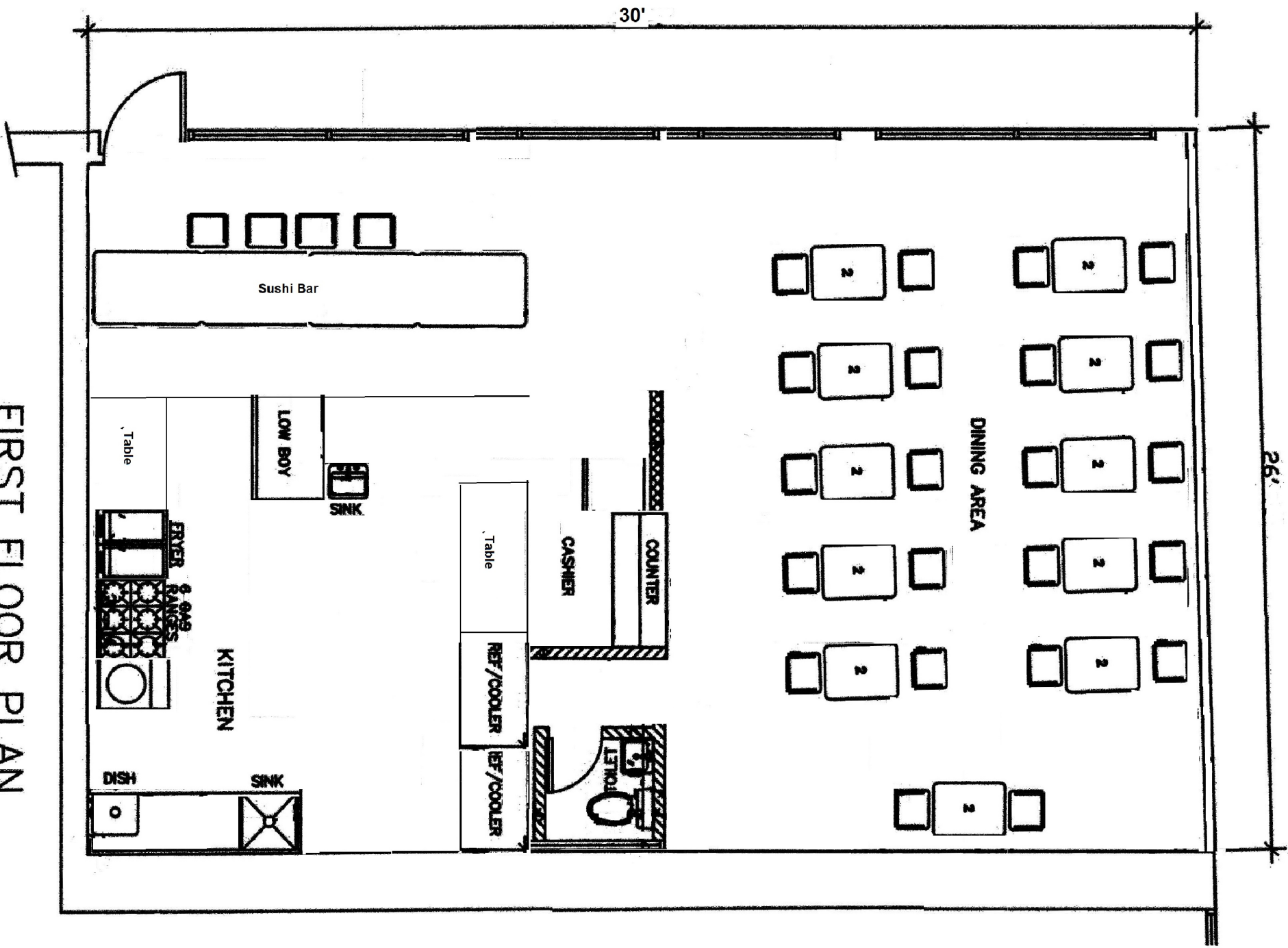

30'

26'

Sushi Bar

LOW BOY

SINK

Table

FRYER & RANGES

KITCHEN

DIS

SINK

COUNTER

CASHIER

Table

REF / COOLER

REF / COOLER

TOILET

DINING AREA

2

2

2

2

2

2

2

2

2

2

2

KITCHEN ENTREES

All Served with White Rice or Brown Rice & Miso Soup or Green Salad

TERIYAKI

Dressed with Teriyaki Sauce Served with Seasonal Vegetable

Tofu Teriyaki	13.00	Shrimp Teriyaki	18.00
Chicken Teriyaki	15.00	Wild Scottish Salmon Teriyaki	18.00
Beef Teriyaki	18.00		

TEMPURA

Lightly Fried Served with Dipping Sauce

Shrimp Tempura Only	17.00	Vegetable Tempura	13.00
Chicken & Vegetable Tempura	17.00	Shrimp & Vegetable Tempura	17.00

KATSU or DON BURI

Chicken Katsu	15.00	Pork or Chicken Katsu Don	15.00
Deep fried strips breaded chicken served with tonkatsu sauce		Deep fried strips breaded pork or chicken cutlets with egg & onion over rice	
Tonkatsu	15.00	Oyakodon	15.00
Deep fried strips breaded pork loin served with tonkatsu sauce		Chicken cutlet with egg & onion over rice	

NEGIMAKI

Beef Negimaki	17.00
Thinly sliced beef wrapped with scallions broiled with teriyaki sauce	
Chicken Negimaki	16.00
Thinly sliced chicken wrapped with scallions broiled with teriyaki sauce	

DINNER BENTO BOX SPECIAL

Choice of Any One Item with Shrimp, One California Roll, Green Salad, White Rice & Miso Soup

ONLY \$19.99

Chicken Teriyaki	Tonkatsu
Tofu Teriyaki	Chicken Katsu
Beef Teriyaki	Shrimp Tempura
Shrimp Teriyaki	Vegetable Tempura
Wild Scottish Salmon Teriyaki	Sashimi
Beef Negimaki	Sushi
Chicken Negimaki	

NOODLE

Yaki Soba or Yaki Udon Stir Fried Noodle with Vegetable

Served with Miso Soup

Chicken	12.00	Seafood	16.00
Beef	13.00	Vegetable	11.00
Shrimp	13.00		

UDON or SOBA SOUP

Served with Chicken broth with Seasonal Greens, Served with Green Sauce

Vegetable	11.00	Seafood	16.00
Chicken	12.00	Tempura	15.00
Beef	13.00	With 2 pcs shrimp & vegetable	
Shrimp	13.00	Nabeyaki Udon	15.00
		With soft-boiled egg, chicken vegetable & 2 pcs shrimp tempura	

RAMEN

Miso Ramen	13.00
Deep pork scallion boiled egg/kaniago & menma in chicken broth	
Tonkatsu Ramen	13.00
Deep pork scallion boiled egg spinach/menma/sweet brini	
Yasai Ramen	12.00
Cabbage cauliflower boiled egg spinach bean sprout kikurage in vegetable broth	
Chicken Katsu Ramen	13.00
Deep fried strips breaded chicken scallion boiled egg menma in chicken broth	
Spicy Seafood Ramen	15.00
Shrimp scallion squid fishcake/dan spinach menma boiled egg in chicken broth	

DESSERTS

Tempura Ice Cream	5.00
Vanilla, green tea or red bean	
Ice Cream	4.00
Vanilla, green tea or red bean	
Mochi Ice Cream	4.00
Green tea, red bean or vanilla	
Tempura Banana	5.00
Served with cream	
Fresh Tropical Fruits	8.00

SOFT DRINK

Soda	2.00
Coke, Cola, Sprite, Diet Sprite, Diet Pepsi, Odo Soda	
Snapple	2.50
Lemon, Peach, Blueberry, Diet Peach	
Spring Water	2.50

LUNCH SPECIAL

Served 11:00am - 2:00pm (Monday - Friday)

KITCHEN LUNCH BOX SPECIAL

All Served with Salad, Miso Soup, White Rice & California Roll

Vegetable Tempura	11.00	Tofu Teriyaki	11.00
Pork / Chicken Katsu	11.00	Shrimp & Vegetable Tempura	12.00
Salmon Teriyaki	12.00	Shrimp Teriyaki	12.00
Chicken Teriyaki	12.00	Yaki Udon or Soba	12.00
Beef Teriyaki	12.00	3-in-1 noodles with shrimp, beef, chicken	
Beef Negimaki	12.00	Chicken Negimaki	12.00

SUSHI BAR LUNCH SPECIAL

All Served with Miso Soup & Salad

Sushi	17.00	Tuna Sushi	17.00
5 pcs assorted sushi & California roll		4 pcs tuna & tuna cucumber	
Chirashi	19.00	Salmon Sushi	17.00
Assort of raw fish over sushi rice		4 pcs salmon & salmon avocado roll	
Sushi & Sashimi		Yellowtail Sushi	17.00
Combo	22.00	4 pcs yellowtail & yellowtail scallion roll	
Sushi & sashimi & California roll		Eel Sushi	17.00
Sashimi	18.00	4 pcs eel & red avocado roll	
Assorted sashimi		Unagi Don	15.00

MAKI LUNCH SPECIAL

All Served with Miso Soup & Salad

Choose: Any 2 Rolls For \$11.00 * Any 3 Rolls For \$14.00

California	Yellowtail & Cucumber
Spicy Tuna	Yellowtail & Avocado
Tuna	Salmon Skin
Tuna & Cucumber	Salmon
Alaska	Salmon & Avocado
Philadelphia	Salmon & Cucumber
Shrimp & Avocado	White Tuna & Avocado
Shrimp & Cucumber	White Tuna & Cucumber
Shrimp & Asparagus	Shrimp Tempura
Spicy Crab Meat Cucumber	Peanut & Avocado
Eel & Cucumber or Avocado	Avocado
Spicy Yellowtail	Cucumber & Avocado
Spicy Salmon	Snow Crab Avocado
Yellowtail & Scallion	Spicy Crawfish Avocado



402 West 44th Street
New York, NY 10036

Tel **646-669-9999**
646-669-9996

Monday-Friday 11:00am - 10:00pm
Saturday & Sunday 12:00noon - 10:00pm



www.AriSushiNY.com



Ari Sushi Inc.

402 W 44 St.

