

Manhattan Community Board 4

Liquor License/Sidewalk Cafe Stipulations Application

(All Fields Must Be Completed)

CORPORATION NAME		DOING BUSINESS AS (DBA)	
NPD WEST 51, Inc		B SIDE	
STREET ADDRESS		CROSS STREETS	ZIP CODE
370 WEST 51st STREET			10019
OWNER <small>(Attach a list of all the people that will be associated listed with the license)</small>	NAME:	ATTORNEY/ REPRESENTATIVE	NAME:
	PHONE:		PHONE:
	EMAIL:		EMAIL:
	JOHN DEMPSEY		
	917.577.1827		
	john@chowdowninc.com		
MANAGER	NAME:	LANDLORD	NAME:
	PHONE:		PHONE:
	EMAIL:		EMAIL:
	KURT REED		FIRST PIONEER PROPERTIES
	302.233.2100		718.482.0700
	rkurtreed@gmail.com		suraj@firstpioneerproperties.com
APPLICATION TYPE (<input checked="" type="checkbox"/> Liquor License <input type="checkbox"/> Unenclosed Sidewalk Cafe)			
<input type="radio"/> New	Has applicant owned or managed a similar business?		YES NO
	What is/was the name and address of establishment?		
	What were the dates applicant was involved with this former premise?		
<input checked="" type="radio"/> Corp Change/Class Change/Removal	What is the license # and expiration date?		# 1275830 x 7.31.22
	Is applicant making any alterations or operational changes?		YES <input checked="" type="checkbox"/> NO
	If alterations or operational changes are being made, please describe/list all changes.		APPLYING FULL ON PREMISE LICENSE
<input type="radio"/> Alteration	What is the current license # and expiration date?		
	Please list/describe the nature of all the changes and attach the plans:		
METHOD OF OPERATION			
TYPE OF ALCOHOL	<input checked="" type="checkbox"/> Liquor/Wine/Beer & Cider <input type="checkbox"/> Beer & Cider <input type="checkbox"/> Wine/Beer & Cider		
ESTABLISHMENT TYPE	<input checked="" type="checkbox"/> Restaurant <input type="checkbox"/> Cabaret <input type="checkbox"/> Night Club <input type="checkbox"/> Hotel <input type="checkbox"/> Bar/Tavern <input type="checkbox"/> Catering Establishment <input type="checkbox"/> Adult Entertainment <input type="checkbox"/> Wine Bar <input type="checkbox"/> Dance Club <input type="checkbox"/> Sports Bar <input type="checkbox"/> Club (Fraternal Organization – Members Only)		
Has applicant/owner filed with the SLA? If yes, when? If no, when do you plan to file?		YES	<input checked="" type="checkbox"/> NO
Is the 500 Foot Rule applicable? If yes, please attach a diagram of the On-Premise liquor license establishments within a 500 ft. radius of your establishment and the Public Interest Statement.		<input checked="" type="checkbox"/> YES	NO
Is the 200 Foot Rule applicable? If yes, please attach a diagram of the schools and houses of worship that trigger the rule.		YES	<input checked="" type="checkbox"/> NO
Has applicant/owner(s) read MCB4 Policy Regarding Concentration and Location of Alcoholic-Serving Establishments?		<input checked="" type="checkbox"/> YES	NO

OPERATIONAL DETAILS (*Closing time will be when establishment is vacated of all patrons)

		MONDAY	TUESDAY	WEDNESDAY	THURSDAY	FRIDAY	SATURDAY	SUNDAY
HOURS* (Indoor Only)	Operation	NOON - MIDNIGHT →						
	Kitchen	NOON - MIDNIGHT →						
	Music	SPOTIFY INDOOR →						
If you plan to have music, what type(s)? (Circle all that apply)			BACKGROUND	LIVE MUSIC	DJ	JUKE BOX	KARAOKE	

OCCUPANCY

	Capacity (Certificate of Occupancy)	Maximum # of Persons Occupying Premises (Including Employees)	Number of Tables	Number of Seats	Number of Service Only Bars	Number of Stand-Up Bars	Number of Seats at Stand-Up Bar	WINDOW SEATING
INSIDE	N/A	44	8	16	0	1	9	13
OUTSIDE (Other than sidewalk cafe)	OPEN RESTAURANT							
DCA APPROVED UNENCLOSED SIDEWALK CAFE	N/A							

How many floors are there? What is the capacity for each floor?

RETAIL SPACE PLUS BASEMENT

How frequently will the owner(s) be at the establishment?

EVERY DAY

Will there be dancing?

YES

Will applicant have bottle or table service for beverage alcohol?

YES

Will applicant be hosting private; promotional or corporate events?

YES

Will outside promoters be used on a regular basis? If yes please describe.

YES

Will applicant have a security plan? If, yes please attach.

YES

Will security plan be implemented?

YES

Will State certified security personnel be used?

YES

Will New York Nightlife Association and NYPD Best Practices be followed?

YES NO

Does applicant agree to notify MCB4 prior to making changes to its method of operation?

YES NO

Will applicant be using delivery bicycles? If yes, how many?

YES

Will delivery bicycles be clearly marked with the name of the restaurant and will staff wear attire clearly noting name as described by NYC Law?

YES NO

N/A

Where will delivery bicycles be stored during the day when not in use?

N/A

LOCATION & ZONING			
Is this a Special District? If yes, is it Clinton, West Chelsea or Hudson Yards?	YES	<input checked="" type="checkbox"/>	
Does the building have a Certificate of Occupancy ("C of O") or a letter of no objection?	YES	<input checked="" type="checkbox"/>	LETTER OF NO OBJECTION
Is a Public Assembly permit required?	YES	<input checked="" type="checkbox"/>	N/A
Are your plans filed with DOB?	YES	<input type="checkbox"/>	N/A

Community Notification/Relations

NOTIFICATION: List all block associations; tenant associations, co-op boards or condo boards of residential buildings; and community groups that applicant has notified regarding its application. For each please list both the organization and individual you contacted	# 1	49/54 BLOCK ASSOCIATION ZOOM MEETING
	# 2	5.26.21 @ 6:30 P.M. (STEVE DELIDA)
	# 3	EMAILED THE LIST OF COMMUNITY GROUPS/MEMBERS
	# 4	THAT CBA REQUIRED ON FRIDAY
	# 5	MAY 28, 2021

Please provide dates when applicant met with the groups listed above.				
Who was your contact person at each group you met with?				
When did applicant post the notice that was provided?	5.28.21			
Where did applicant post the notice that was provided?	FRONT WINDOW			
Will applicant provide owner cell phone number to neighbors and respond to complaints that arise? Please provide number in space provided.	<table border="1"> <tr> <td><input checked="" type="checkbox"/></td> <td>NO</td> <td>917.577.1827</td> </tr> </table>	<input checked="" type="checkbox"/>	NO	917.577.1827
<input checked="" type="checkbox"/>	NO	917.577.1827		
Will applicant inform the Community Board office of its job openings and/or provide a hyperlink to applicants jobs webpage?	<table border="1"> <tr> <td><input checked="" type="checkbox"/></td> <td>NO</td> <td></td> </tr> </table>	<input checked="" type="checkbox"/>	NO	
<input checked="" type="checkbox"/>	NO			

BUILDING DESIGN			
State the name and type of business previously located in the space.	CONTINUING PIZZA BAR		
Has a liquor-licensed establishment previously occupied this space at any time? If yes, please provide the name of the business.	YES	NO	CURRENTLY BEER, WINE, CIDER
Do you plan any changes to the existing façade? If yes, please describe.	YES	<input checked="" type="checkbox"/>	
Has the applicant/owner(s) read MCB 4 ADA Guidelines Memo?	<input checked="" type="checkbox"/>	NO	
Is the entrance ADA Compliant?	<input checked="" type="checkbox"/>	NO	
Do you plan any changes to the existing façade? If yes, please describe.	YES	<input checked="" type="checkbox"/>	
Will applicant have a vestibule within the establishment?	YES	<input checked="" type="checkbox"/>	
Will applicant use a storm enclosure?	<input checked="" type="checkbox"/>	<input checked="" type="checkbox"/>	
Does applicant agree to keep the sidewalk clear of all items or obstructions, such as sandwich boards, sidewalk signs, freestanding menus and plants, as per the law?	<input checked="" type="checkbox"/>	NO	
Will applicant comply with the NYC noise code?	<input checked="" type="checkbox"/>	NO	
Will the establishment have any of the following: (circle all that apply)	FRENCH DOORS	GARAGE DOORS	WINDOWS THAT CAN BE OPENED
Will applicant close all windows, French doors, garage doors when any music or amplified sound (including televisions) is played inside the establishment?	<input checked="" type="checkbox"/>	NO	
Will applicant close all windows, French doors, garage doors by 11 PM Friday and Saturday and 10 PM on all other days even if no music or amplified sound is played inside the establishment?	<input checked="" type="checkbox"/>	NO	
Has applicant obtained an acoustical report from a certified sound engineer to assess potential noise disturbance to the neighboring residents and buildings?	YES	NO	BEEN OPERATING FOR PAST 8 YEARS
Will applicant follow the recommendations of a certified sound engineer to mitigate potential noise disturbance to the neighboring residents and buildings, including placing speakers on the floor of the establishment?	YES	NO	
Will the kitchen exhaust system extend to the roof?	<input checked="" type="checkbox"/>	NO	
Will the establishment have an illuminated sign?	YES	<input checked="" type="checkbox"/>	
Will the establishment have a canopy extending over the sidewalk?	YES	<input checked="" type="checkbox"/>	
Where will the air conditioner be located? What type is it?	ON ROOF		
When was the air conditioner installed?	8 YEARS AGO		

****OPEN RESTAURANT ONLY****

OUTDOOR ITEMS - OTHER THAN SIDEWALK CAFE		
Has the applicant/owner(s) read MCB 4 Rear Yard Rooftop Policy?	<input checked="" type="checkbox"/> YES	<input type="checkbox"/> NO
Will applicant use any outdoor spaces: rooftop, rear yard, patio, porch, balcony, pavilion, tents, deck, gazebo or open dining in the parking lane? If yes, which one(s)?	<input type="checkbox"/> YES	<input type="checkbox"/> NO
Are the floorplans for the outdoor space(s) included?	<input type="checkbox"/> YES	<input checked="" type="checkbox"/> NO
Will applicant close and vacate the outdoor space(s) by 11PM on Friday & Saturday and 10 PM on all other days?	<input checked="" type="checkbox"/> YES	<input type="checkbox"/> NO
Will the service and consumption of alcohol in any outdoor space only be via seated food service?	<input checked="" type="checkbox"/> YES	<input type="checkbox"/> NO
Will applicant not allow standing space for patrons to drink or smoke in any outdoor space(s) or on the sidewalk?	<input checked="" type="checkbox"/> YES	<input type="checkbox"/> NO
Will there be no amplified music, as per the law?	<input checked="" type="checkbox"/> YES	<input type="checkbox"/> NO
If amplified sound is played inside the establishment, will windows and doors be closed?	<input checked="" type="checkbox"/> YES	<input type="checkbox"/> NO
Will applicant agree to post signs outside asking customers to respect the neighbors'?	<input checked="" type="checkbox"/> YES	<input type="checkbox"/> NO
Will applicant agree to train staff to encourage a peaceful environment?	<input checked="" type="checkbox"/> YES	<input type="checkbox"/> NO
Will applicant provide effective sound control (landscaping enclosure, soundproofing tenants apartments)	<input checked="" type="checkbox"/> YES	<input type="checkbox"/> NO
Will there be a lighting plan that allows safe usage of the outdoor space without disrupting neighbors?	<input checked="" type="checkbox"/> YES	<input type="checkbox"/> NO
If open dining in the parking lane, will applicant agree to leave the sidewalk free of any furniture?	<input checked="" type="checkbox"/> YES	<input type="checkbox"/> NO
If open dining, will you comply with all NYC DOT guidelines?	<input checked="" type="checkbox"/> YES	<input type="checkbox"/> NO
If open dining, will the installation be year-round?	<input checked="" type="checkbox"/> YES	<input type="checkbox"/> NO

OPEN RESTAURANTS - USING
A WOODEN STRUCTURE IN STREET

DCA APPROVED UNENCLOSED SIDEWALK CAFÉ

Has the applicant/owner(s) read MCB4 Sidewalk Café Policy?	YES	NO	
Will applicant be applying for a sidewalk café now or in the future?	YES	NO	OPEN RESTAURANTS
Is applicant in this application seeking to include a sidewalk café in its liquor license?	YES	NO	
If yes, has applicant submitted an application and plans to NYC Dept. of Consumer Affairs? Please attach application and plans.	YES	NO	
Will applicant close and vacate the sidewalk café by 11 PM on Friday & Saturday and 10 PM on all other days?	YES	NO	
Will applicant be serving alcohol in the sidewalk café? If so, will you have waiter service?	YES	NO	
Will the café have a 3 ft. wide serving aisle running the entire length of the sidewalk cafe?	YES	NO	
Will applicant mark the perimeter of the café on the sidewalk?	YES	NO	
Will the service and consumption of alcohol in the sidewalk café only be via seated food service?	YES	NO	
Will the sidewalk café not provide standing space for drinking or smoking?	YES	NO	
Will applicant use any portable natural gas heaters? If so, do you have the requisite approvals from DOB & the Fire Department?	YES	NO	
Will applicant have a lighting plan that will allow safe usage of the outdoor space without disrupting neighbors?	YES	NO	
Will all furniture, plants and barricades be stored inside between the evening closing hours and the morning opening hours?	YES	NO	
Will all furniture be stored inside between December 21 st and March 21 st , and any other day when it rains or snows?	YES	NO	
Will applicant use umbrellas?	YES	NO	
If construction or construction protection has reduced the sidewalk width, will applicant always maintain an 8 foot clear path of sidewalk between the perimeter of the café and the closest obstruction including construction barricades?	YES	NO	
If open dining is in the parking lane, will applicant agree to remove its sidewalk café?	YES	NO	OPEN RESTAURANTS

****OPEN RESTAURANT ONLY****

ADDITIONAL STIPULATIONS: (Office Use Only)

- This application does not extend to any permanent outdoor space or sidewalk cafe

To the extent any additional stipulation on pages 7 and 8 of this application conflicts with any response on pages 1 – 6 of this application, the stipulations on pages 7 and 8 control.

To the extent any additional stipulation on pages 7 and 8 of this application conflicts with any response on pages 1 – 6 of this application, the stipulations on pages 7 and 8 control.

Manhattan Community Board 4 (MCB4) recommends:
(MCB4's recommendation is based on a vote taken at its
July 28, 2021 full board meeting, with 35 members voting in favor
of the recommendation, 0 members opposed, 0 members
abstaining and 0 present but not eligible)

Denial unless all stipulations agreed to by applicant/owner are part of the method of operation

Denial Approval

CB4 REPRESENTATIVES

Nelly Gonzalez
CB4 Assistant District Manager

Frank Holozubiec
CB4 BLP Committee Co-Chair

Burt Lazarin
CB4 BLP Committee Co-Chair

APPLICANT AGREEMENT WITH THE COMMUNITY

Applicant agrees to these stipulations as the basis for the community support of this application and acknowledges that all of these stipulations are essential prerequisites to the MCB4 recommendation regarding this application. Applicant agrees to have these stipulations incorporated in the method of operation of its liquor license. The stipulations in this application constitute the entire agreement between MCB4 and applicant and may only be altered in writing signed by MCB4 and applicant. These stipulations supersede any oral statements or representations in connection with this application.

SIGN HERE



JOHN DEMPSEY
PRINT NAME OF APPLICANT

SIGNATURE OF APPLICANT

5.30.21
DATE

51st Street

1 2 3

WINDOW SEATING

10 11 12 13 14

WINDOW SEATING

15 16 17 18 19

WINDOW SEATING

BAR SEATING

20 21 22

2 top
23

2 top
24

MIS EN PLACE

MIS EN PLACE

COUNTER

31

32

33

34

35

36

SEATING

BAR

6 - 2 TOP'S

[]

40

[]

41

[]

42

[]

43

[]

44

[]

45

OVEN
PIZZA

B SIDE PIZZA BAR

Greens and things

Smoked Prosciutto & Parmesan Cubes

almonds, olive oil 10

Burrata

melons, tomato, chiles, olive oil, pesto, basil 15
add prosciutto 4

Roasted Broccolini

fresh garlic, pickled chili vinaigrette, brown butter, parmesan 12

Roasted Cauliflower

capers, raisins, pine nuts, lemon 13

Bacon & Beef Meatballs

tomato conserva, balsamic, parmesan 13

Black Kale

pickled dried apricots, red onion, pecorino, almonds, mint 10

Roasted Peaches

baby arugula, charred scallion vinaigrette, formaggio di fossa 12

Roasted Brussel Sprouts

honey, lemon, egg, pancetta, parmesan, chiles 12

Zucchini "Noodles" Salad

pistachio vinaigrette, mint, parmesan, chiles 12

Roasted Corn on the Cob

pickled jalapeño aioli, smoked paprika, ricotta 9

Roasted Avocado

preserved lemon dressing, anchovy extract, arugula, red onion, chiles, celery leaf salad 10

* **Add Chicken** to any of the above 5

Pizza

Oscar the Grouch

spinach, black kale, garlic, mozzarella fonduta 15

El Puerco Loco

tomato, mozzarella, pancetta, taleggio, parmesan, pork sausage, chiles 16

Marge

tomato, mozzarella, basil, oregano, sea salt 14 add prosciutto or sopressata 4

Black & White

garlic & cauliflower puree, black truffle, shallots, parsley, truffle oil
sherry vinaigrette, parmesan, robiola 18

Don Ho

tomato, roasted pineapple, prosciutto, burrata, pickled Fresno chiles 17

Cali Wowie

heirloom tomato, whipped ricotta, pesto 18

Carbonara

fontina, mozzarella, pancetta, panna, parmesan, black pepper, egg 17

Meat Packing

tomato, sopressata, pancetta, taleggio, speck, bacon, sausage, mozzarella, vincotto 19

Killer Bee

tomato, mozzarella, sopressata, garlic puree, chili oil, honey 16

You Got a Lot a' Balls

tomato, meatballs, mozzarella, taleggio, oregano, peppers 17

Spicoli

tomato, mozzarella, roasted mushrooms, caramelized onions, parmesan 16

D.F.

garlic, tomato, chorizo sausage, fontina, oregano, chiles, fennel 17

Dessert

Budino Italian chocolate pudding, cracked sea salt, olive oil, whipped cream 7

Buttermilk Panna Cotta grilled strawberries, vincotto 7

Classic Tiramisu 7

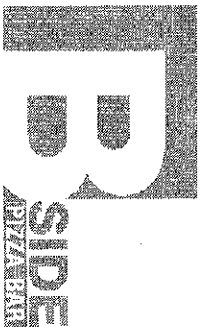

370B West 51st Street

New York, NY 10019

(646) 679-7225

www.BSidePizzeria-NYC.com



bsidepizzabar



B Side Pizza Bar

Concoctions \$8

- Shut Out the Light** cardamaro, dolin dry, dolin rouge, lemon bitters, citrus twist
The Sweetest Thing cocchi americano rosa, rose syrup, lemon juice, hibiscus tea
Starla byrrh, ginger beer
Ruby Tuesday cappelletti, dolin rouge, sparkling white wine
Silver Springs cocchi americano, elder flower syrup, sparkling white wine
Yellow Ledbetter byrrh, lemonade, IPA

American Craft Beer on Tap \$7

- Other Half** american ipa 7.1% Brooklyn, NY
Ommegang Write wheat ale 5.2% Cooperstown, NY
Dowreast farmhouse cider 5.1% Waterville ME
War Flag pilsner 5.0% Brooklyn, NY
Broken Bow auger lager 5.0% Tuckahoe, NY
Evil Twin molotov lite 2x ipa 8.0% Brooklyn, NY
B Side Rotating Tap ask your server for details

Beer

Bottles & Cans

- Radiant Pig** junior ipa 5% New York, NY 7
Peroni pale lager 5.1% Rome, Italy 7
Montauk summer ale 5.6% Montauk, NY 7

Non

- Fever Tree** Ginger Brew 3.5
Coke, Diet Coke, Ginger Ale, Sprite, Club Soda, Root Beer 3
Unsweetened Iced Tea 3
Lemonade 3
Arnold Palmer 3.5

Alcohol

Wine

Reds

- Rosso Toscano** Circa, 2013 (Tuscany) 9 / 32
Cotes du Rhone AOC CDR, 2012 (Rhône Valley) 12 / 44
Montepulciano Quattro Mani, 2014 (Abruzzo) 11 / 40
Barbera Quattro Mani, 2012 (Piemont, Italy) 12 / 44
Malbec Jelu Estate, 2012 (San Juan, Argentina) 11 / 40
Super Tuscan la Maia Lina, 2013 (Tuscany) 11 / 40
Cabernet Sauvignon Broadside, 2013 (Paso Robles) 13 / 48

Rosé

- Rosé Syrah** Francois Lupton, 2015 (Pays d'Oc, France) 12 / 44
Rosé Minhoto Caves Campelo, 2014 (Portugal) 10 / 36

Whites

- Viognier** Puntapays, 2015 (Mendoza, Argentina) 10 / 36
Pinot Blanc Albert Seltz, 2014 (Alsace, France) 12 / 44
Gruner Veltliner Leth, 2014 (Austria) 12 / 44
Vinho Verde Vaca das Cordas, 2014 (Portugal) 10 / 36
Sauvignon Blanc Domaine Pauli Buisse, 2015 (Loire Valley) 11 / 40

Sparkling

- Prosecco** Primaterra, NV (Sicilia) 9 / 32
Lambrusco Cantina di Sorbara, 2012 (Capri) 10 / 36
Rosé Brut Carbone Malvolti, 2013 (Veneto) 13 / 48

Red On Tap

- Rioja** Ermita San Felices, 2009 (Spain) 10
Sangiovese Montalvini, 2011 (Italy) 11
French Merlot Blend Chateau de Bonhoste, 2013 (Bordeaux) 10
Pinot Noir Barrique, 2013 (Sonoma, CA) 12

White On Tap

- Pinot Grigio** Montalvini, 2013 (Veneto) 10
Rosé Pinot Noir Acrobot, 2015 (Oregon) 11
Riesling Neiss, 2014 (Germany) 10
Chardonnay L'Oliveto, 2013 (Sonoma, CA) 11



370b West 51st Street New York, NY 10019 (646) 679-7225

www.BSidePizzeria-NYC.com



bsidepizzabar



BSide Pizza Bar

NRD WEST 51 Ave
d/b/a B SIDE
370 WEST 51st STREET
New York, New York 10019

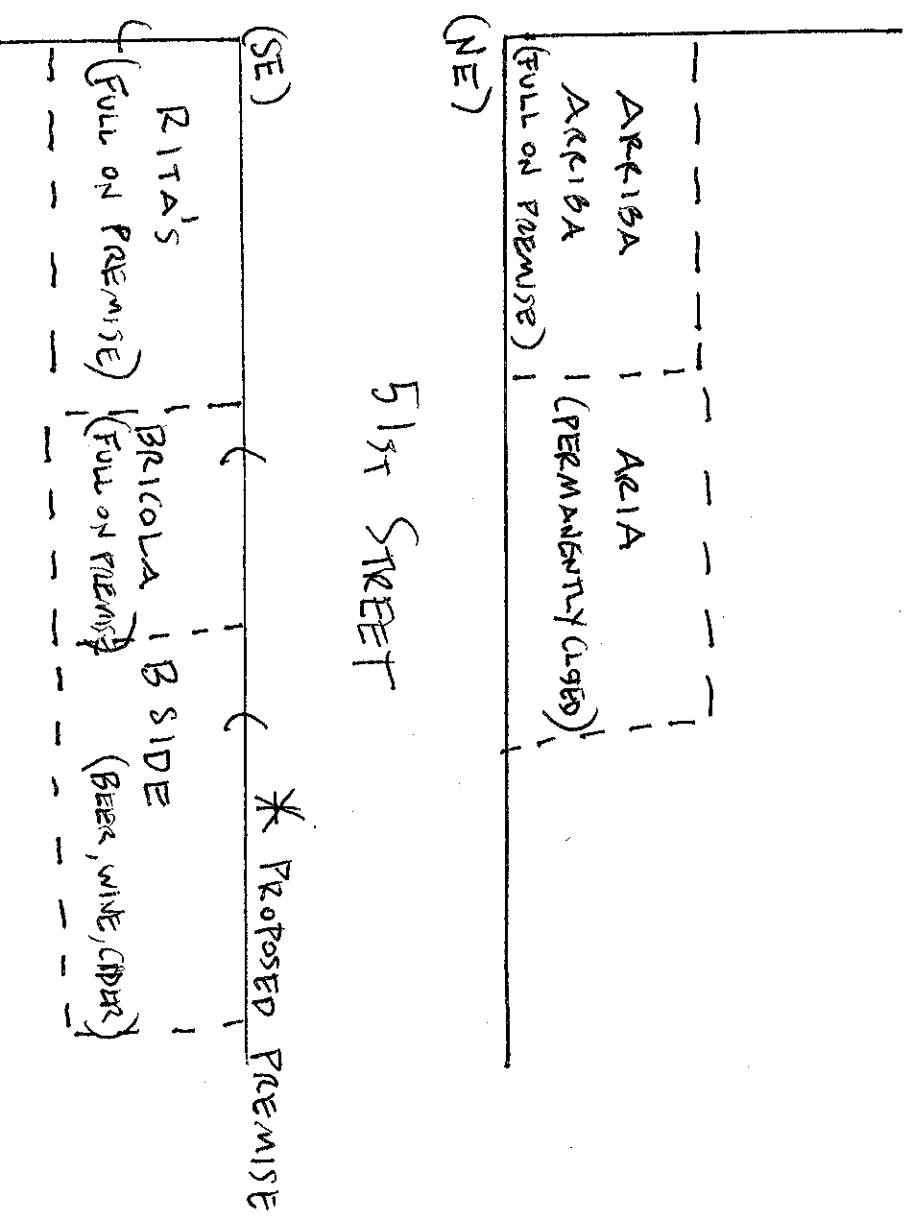
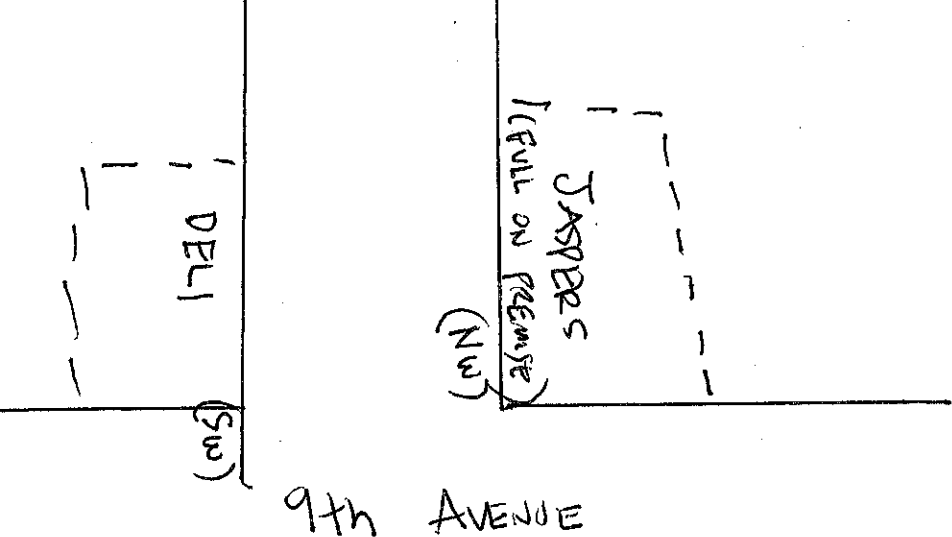



NOTICE

NOTICE

118

NOTICE

30 INCH

NOTICE

NOTICE

