

Manhattan Community Board 4

Liquor License/Sidewalk Cafe Stipulations Application

(All Fields Must Be Completed)

CORPORATION NAME		DOING BUSINESS AS (DBA)					
BL 55 Hudson Yards NY LLC		Bluestone Lane					
STREET ADDRESS		CROSS STREETS		ZIP CODE			
55 Hudson Yards		Hudson Yards		10001			
OWNER <small>(Attach a list of all the people that will be associated/listed with the license)</small>	NAME:	Bluestone Lane Holdings LLC Nicholas Stone, CEO		ATTORNEY/ REPRESENTATIVE	NAME:	Hari Nathan Kalyan, Esq., General Counsel	
	PHONE:				PHONE:	917-653-0633	
	EMAIL:	legal@bluestonelane.com			EMAIL:	hari@bluestonelane.com	
MANAGER	NAME:	Tom Selementi, SVP Retail		LANDLORD	NAME:	ERY RETAIL PODIUM LLC	
	PHONE:				PHONE:		
	EMAIL:	tom.selementi@bluestonelane.com			EMAIL:		
APPLICATION TYPE (<input checked="" type="checkbox"/> <i>Liquor License</i> <input type="checkbox"/> <i>Unenclosed Sidewalk Cafe</i>)							
<input checked="" type="radio"/> New	Has applicant owned or managed a similar business?			YES	NO		
	What is/was the name and address of establishment?			60+ locations across the country			
	What were the dates applicant was involved with this former premise?			March 2014			
<input type="radio"/> Corp Change/Class Change/Removal	What is the license # and expiration date?						
	Is applicant making any alterations or operational changes?			YES	NO		
	<i>If alterations or operational changes are being made, please describe/list all changes.</i>						
<input type="radio"/> Alteration	What is the current license # and expiration date?						
	<i>Please list/describe the nature of all the changes and attach the plans:</i>						
METHOD OF OPERATION							
TYPE OF ALCOHOL	<input checked="" type="radio"/> Liquor/Wine/Beer & Cider		<input type="radio"/> Beer & Cider		<input type="radio"/> Wine/Beer & Cider		
ESTABLISHMENT TYPE	<input checked="" type="radio"/> Restaurant <input type="radio"/> Cabaret <input type="radio"/> Night Club <input type="radio"/> Hotel <input type="radio"/> Bar/Tavern <input type="radio"/> Catering Establishment <input type="radio"/> Adult Entertainment <input type="radio"/> Wine Bar <input type="radio"/> Dance Club <input type="radio"/> Sports Bar <input type="radio"/> Club (Fraternal Organization – Members Only)						
Has applicant/owner filed with the SLA? If yes, when? If no, when do you plan to file?				YES	NO <input checked="" type="checkbox"/>	Following CB4 hearing	
Is the 500 Foot Rule applicable? If yes, please attach a diagram of the On-Premise liquor license establishments within a 500 ft. radius of your establishment and the Public Interest Statement.				YES	NO <input checked="" type="checkbox"/>		
Is the 200 Foot Rule applicable? If yes, please attach a diagram of the schools and houses of worship that trigger the rule.				YES	NO <input checked="" type="checkbox"/>		
Has applicant/owner(s) read MCB4 Policy Regarding Concentration and Location of Alcoholic-Serving Establishments?				YES <input checked="" type="checkbox"/>	NO		

OPERATIONAL DETAILS (*Closing time will be when establishment is vacated of all patrons)

HOURS* <i>(Indoor Only)</i>		MONDAY	TUESDAY	WEDNESDAY	THURSDAY	FRIDAY	SATURDAY	SUNDAY
	Operation	8am-11pm	8am-11pm	8am-11pm	8am-11pm	8am-11pm	8am-11pm	8am-11pm
	Kitchen	8am-11pm	8am-11pm	8am-11pm	8am-11pm	8am-11pm	8am-11pm	8am-11pm
	Music	8am-11pm	8am-11pm	8am-11pm	8am-11pm	8am-11pm	8am-11pm	8am-11pm

If you plan to have music, what type(s)? (Circle all that apply)	<input checked="" type="checkbox"/> BACKGROUND	<input type="checkbox"/> LIVE MUSIC	<input type="checkbox"/> DJ	<input type="checkbox"/> JUKE BOX	<input type="checkbox"/> KARAOKE
---	--	-------------------------------------	-----------------------------	-----------------------------------	----------------------------------

OCCUPANCY

	Capacity (Certificate of Occupancy)	Maximum # of Persons You Anticipate Occupying Premises (Including Employees)	Number of Tables	Number of Seats	Number of Service Only Bars	Number of Stand-Up Bars	Number of Seats at Stand-Up Bar
INSIDE	74	58	17	54	0	0	0
OUTSIDE <i>(Other than sidewalk café)</i>			8	32	0	0	0
SIDEWALK CAFÉ	N/A	N/A	N/A	N/A	N/A		

How many floors are there? What is the capacity for each floor?	1 (74 max)
---	------------

How frequently will the owner(s) be at the establishment?	Manager on site at all times
---	------------------------------

Will there be dancing?	YES	NO <input checked="" type="checkbox"/>
------------------------	-----	--

Will applicant have bottle or table service for beverage alcohol?	YES	NO <input checked="" type="checkbox"/>
---	-----	--

Will you be hosting private; promotional or corporate events?	YES	NO <input checked="" type="checkbox"/>
---	-----	--

Will outside promoters be used on a regular basis? If yes please describe.	YES	NO <input checked="" type="checkbox"/>
--	-----	--

Will you have a security plan? If, yes please attach.	YES	NO <input checked="" type="checkbox"/>
---	-----	--

Will security plan be implemented?	YES	NO <input checked="" type="checkbox"/>
------------------------------------	-----	--

Will State certified security personnel be used?	YES	NO <input checked="" type="checkbox"/>
--	-----	--

Will New York Nightlife Association and NYPD Best Practices be followed?	YES <input checked="" type="checkbox"/>	NO
--	---	----

Will applicant be using delivery bicycles? If yes, how many?	YES	NO <input checked="" type="checkbox"/>
--	-----	--

Will delivery bicycles be clearly marked with the name of the restaurant and will staff wear attire clearly noting name as described by NYC Law?	YES	NO <input type="checkbox"/>
--	-----	-----------------------------

Where will delivery bicycles be stored during the day when not in use?	N/A
--	-----

LOCATION & ZONING

Is this a Special District? If yes, is it Clinton, West Chelsea or Hudson Yards?	YES <input checked="" type="checkbox"/>	NO	Hudson Yards
Does the building have a Certificate of Occupancy ("C of O") or a letter of no objection?	YES <input checked="" type="checkbox"/>	NO	
Is a Public Assembly permit required?	YES	NO <input checked="" type="checkbox"/>	
Are your plans filed with DOB?	YES	NO <input checked="" type="checkbox"/>	

Community Notification/Relations

NOTIFICATION: List all block associations; tenant associations, co-op boards or condo boards of residential buildings; and community groups that applicant has notified regarding its application. For each please list both the organization and individual you contacted	# 1	See attached Rider
	# 2	
	# 3	
	# 4	
	# 5	
Please provide dates when applicant met with the groups listed above.		email sent 4/22/21
Who was your contact person at each group you met with?		See attached Rider
When did applicant post the notice that was provided?		Yes
Where did applicant post the notice that was provided?		At the proposed premises
Will applicant provide owner cell phone number to neighbors and respond to complaints that arise? Please provide number in space provided.		YES <input checked="" type="checkbox"/> NO
Will applicant inform the Community Board office of its job openings and/or provide a hyperlink to applicants jobs webpage?		YES <input checked="" type="checkbox"/> NO

BUILDING DESIGN			
State the name and type of business previously located in the space.	Mayson Kaiser - cafe and bakery		
Has a liquor-licensed establishment previously occupied this space at any time? If yes, please provide the name of the business.	YES	NO X	
Do you plan any changes to the existing façade? If yes, please describe.	YES	NO X	
Will applicant have a vestibule within the establishment?	YES	X NO	
Will applicant use a storm enclosure?	XYES	NO	
Will applicant not place any items or obstructions on the sidewalk, for example, sandwich boards, sidewalk signs, freestanding menus and plants, as per the law?	YES X	NO	
Will applicant comply with the NYC noise code?	XYES	NO	
Will the establishment have any of the following: (circle all that apply)	FRENCH DOORS		GARAGE DOORS WINDOWS THAT CAN BE OPENED
Will applicant close all windows, French doors, garage doors when any music or amplified sound (including televisions) is played inside the establishment?	YES	NO X	
Will applicant close all windows, French doors, garage doors by 11 PM Friday and Saturday and 10 PM on all other days even if no music or amplified sound is played inside the establishment?	YES X	NO	
Has applicant obtained an acoustical report from a certified sound engineer to assess potential noise disturbance to the neighboring residents and buildings?	YES	X NO	
Will applicant follow the recommendations of a certified sound engineer to mitigate potential noise disturbance to the neighboring residents and buildings, including placing speakers on the floor of the establishment?	X YES	NO	
Will the kitchen exhaust system extend to the roof?	XYES	NO	
Will the establishment have an illuminated sign?	YES	X NO	
Will the establishment have a canopy extending over the sidewalk?	YES	X NO	
Where will the air conditioner be located? What type is it?	Central AC		
When was the air conditioner installed?	N/A		

OUTDOOR ITEMS - OTHER THEN SIDEWALK CAFÉ N/A

Has the applicant/owner(s) read MCB 4 Rear Yard Rooftop Policy?	YES X	NO	
Will applicant use any outdoor spaces: rooftop, rear yard, patio, porch, balcony, pavilion, tents, deck or gazebo? If yes, which one(s)?	YES X	NO	Patio in front of premises
Are the floorplans for the outdoor space(s) included?	YES X	NO	
Will applicant close and vacate the outdoor space(s) by 11PM on Friday & Saturday and 10 PM on all other days?	YES X	NO	
Will the service and consumption of alcohol in any outdoor space only be via seated food service?	YES X	NO	
Will applicant not allow standing space for patrons to drink or smoke in any outdoor space(s)?	YES X	NO	
Will there be no amplified music, as per the law?	YES X	NO	
If amplified sound is played inside the establishment, will windows and doors be closed?	YES X	NO	
Will applicant agree to post signs outside asking customers to respect the neighbors'?	YES X	NO	
Will applicant agree to train staff to encourage a peaceful environment?	YES X	NO	
Will applicant provide effective sound control (landscaping enclosure, soundproofing tenants apartments)	YES X	NO	
Will there be a lighting plan that allows safe usage of the outdoor space without disrupting neighbors?	YES X	NO	

OUTDOOR ITEMS – SIDEWALK CAFÉ N/A

Has the applicant/owner(s) read MCB4 Sidewalk Café Policy?	YES	NO	
Will applicant be applying for a sidewalk café now or in the future?	YES	NO	
Is applicant in this application seeking to include a sidewalk café in its liquor license?	YES	NO	
If yes, has applicant submitted an application and plans to NYC Dept. of Consumer Affairs? Please attach application and plans.	YES	NO	
Will applicant close and vacate the sidewalk café by 11 PM on Friday & Saturday and 10 PM on all other days?	YES	NO	
Will applicant be serving alcohol in the sidewalk café? If so, will you have waiter service?	YES	NO	
Will the café have a 3 ft. wide serving aisle running the entire length of the sidewalk cafe?	YES	NO	
Will applicant mark the perimeter of the café on the sidewalk?	YES	NO	
Will the service and consumption of alcohol in the sidewalk café only be via seated food service?	YES	NO	
Will the sidewalk café not provide standing space for drinking or smoking?	YES	NO	
Will applicant use any portable natural gas heaters? If so, do you have the requisite approvals from DOB & the Fire Department?	YES	NO	
Will applicant have a lighting plan that will allow safe usage of the outdoor space without disrupting neighbors?	YES	NO	
Will all furniture, plants and barricades be stored inside between the evening closing hours and the morning opening hours?	YES	NO	
Will all furniture be stored inside between December 21 st and March 21 st , and any other day when it rains or snows?	YES	NO	
Will applicant use umbrellas?	YES	NO	
If construction or construction protection has reduced the sidewalk width, will applicant always maintain an 8 foot clear path of sidewalk between the perimeter of the café and the closes obstruction including construction barricades?	YES	NO	

ADDITIONAL STIPULATIONS: (Office Use Only)

To the extent any additional stipulation on pages 7 and 8 of this application conflicts with any response on pages 1 – 6 of this application, the stipulations on pages 7 and 8 control.

ADDITIONAL STIPULATIONS: (Office Use Only), *Continued*

To the extent any additional stipulation on pages 7 and 8 of this application conflicts with any response on pages 1 – 6 of this application, the stipulations on pages 7 and 8 control.

Manhattan Community Board 4 (MCB4) recommends:
 (MCB4's recommendation is based on a vote taken at its
July 28, 2021 full board meeting, with 35 members voting in favor
 of the recommendation, 0 members opposed, 0 members
 abstaining and 0 present but not eligible)

Denial unless all stipulations agreed to by applicant/owner are part of the method of operation

Denial Approval

CB4 REPRESENTATIVES

 Nelly Gonzalez <i>CB4 Assistant District Manager</i>	 Frank Holozubiec <i>CB4 BLP Committee Co-Chair</i>	 Burt Lazarin <i>CB4 BLP Committee Co-Chair</i>
--	--	--

APPLICANT AGREEMENT WITH THE COMMUNITY

Applicant agrees to these stipulations as the basis for the community support of this application and acknowledges that all of these stipulations are essential prerequisites to the MCB4 recommendation regarding this application. Applicant agrees to have these stipulations incorporated in the method of operation of its liquor license. The stipulations in this application constitute the entire agreement between MCB4 and applicant and may only be altered in writing signed by MCB4 and applicant. These stipulations supersede any oral statements or representations in connection with this application.

<p>SIGN HERE →</p>	<p>Hari Nathan Kalyan, Esq. General Counsel</p> <p>PRINT NAME OF APPLICANT</p>	 <p>SIGNATURE OF APPLICANT</p>	<p>5/24/21</p> <p>DATE</p>
---------------------------	--	--	-----------------------------------



OFFICE OF THE
MAYOR
100 WALL STREET, SUITE 1000
NEW YORK, NY 10038
www.nyc.gov

OFFICE OF THE
MAYOR
100 WALL STREET, SUITE 1000
NEW YORK, NY 10038
www.nyc.gov

PUBLIC NOTICE

Business Licenses and Permits Committee
will discuss an application submitted by

BL 55 Hudson Yards NY LLC
dba
Bluestone Lane
55 Hudson Yards

A New Liquor, Wine, Beer & Cider application for a
Bar/Tavern Establishment with Recorded Music

DATE: Wednesday, June 8, 2011
TIME: 6:30 PM
PLACE: Video/Phone Conference Registration
https://www.nyc.gov/permits/registration/BL55_06
555.295.8055/CallMeNY

All attendees to attend this meeting and learn more about this application
Application, also may attend your community's Public Hearing, January 6, 2011 at
for more information, please email Assistant Control Manager Kelly Ferrante
kerry.ferrante@nyc.gov

Please appearing in the Administrative Code of the City of New York section 24
1.10. Please do not arrive until after the above meeting date

55

HUDSON YARDS

*Home to
Industry Leaders*

RELATED OXFORD MITCHELL FLUOR DANIEL

NOTIFICATION PARTIES

<u>First name</u>	<u>Last name</u>	<u>ORGANIZATION</u>	<u>E-MAIL</u>
Kathleen	Treat	HKNA (incl. Dog Run)	kathleentreat123@gmail.com
Frank	Strock	West 36th Street	mcgee79@aol.com
Brian	Weber	West 36th Street Block Association	brianscottweber@gmail.com
Joe	Restuccia	CHDC (incl. Bob's & bird parks)	info@clintonhousing.org; jrestuccia2@clintonhousing.org
Ryan	Marcano	CHDC (incl. Bob's & bird parks)	rmarcano@clintonhousing.org
Bob	Benfatto	Hudson Yards Hell's Kitchen Alliance	rjbenfatto@hyhkalliance.org
Patty	Gouris	Hudson Yards Hell's Kitchen Alliance	pgouris@hyhkalliance.org
		Hotel Americano	(212) 216-0000
Scott	Hupe	Highline537	212-838-3700
Donna	Langman	Donna Langman Costumes	donna@donnalangman.com
Bill	Borock	Council Chelsea Block Association	wborock@hotmail.com
Christine	Berthet	CHEKPEDS	cberthet@me.com
Julia	Campanelli	Hell's Kitchen Block Association (W 33rd/34th/35th Streets (8th to 12th Avenues)	juliacampanelli@gmail.com

Certificate of Occupancy

CO Number: 121184841T023

This certifies that the premises described herein conforms substantially to the approved plans and specifications and to the requirements of all applicable laws, rules and regulations for the uses and occupancies specified. No change of use or occupancy shall be made unless a new Certificate of Occupancy is issued. *This document or a copy shall be available for inspection at the building at all reasonable times.*

A.	Borough: Manhattan Address: 550 WEST 34TH STREET Building Identification Number (BIN): 1089412	Block Number: 00705 Lot Number(s): 1 Building Type: New	Certificate Type: Temporary Effective Date: 08/12/2020 Expiration Date: 11/10/2020
This building is subject to this Building Code: 2008 Code			
<i>For zoning lot metes & bounds, please see BISWeb.</i>			
B.	Construction classification: 1-A (2014/2008 Code) Building Occupancy Group classification: B (2014/2008 Code) Multiple Dwelling Law Classification: None		
	No. of stories: 51	Height in feet: 768	No. of dwelling units: 0
C.	Fire Protection Equipment: Standpipe system, Fire alarm system, Sprinkler system		
D.	Type and number of open spaces: None associated with this filing.		
E.	This Certificate is issued with the following legal limitations: None		
Outstanding requirements for obtaining Final Certificate of Occupancy:			
There are 24 outstanding requirements. Please refer to BISWeb for further detail.			
Borough Comments: None			



Borough Commissioner



Commissioner

Certificate of Occupancy

CO Number: 121184841T023

Permissible Use and Occupancy						
All Building Code occupancy group designations below are 2008 designations.						
Floor From To	Maximum persons permitted	Live load lbs per sq. ft.	Building Code occupancy group	Dwelling or Rooming Units	Zoning use group	Description of use
CEL	48	150	S-2		6	MECHANICAL (TENANT C1 LEVEL) (CORE AND SHELL ONLY)
SUB	48	150	S-2		6	MECHANICAL (TENANT C2 LEVEL) (CORE AND SHELL ONLY)
MZ1	6	100	M		6	RETAIL (CORE AND SHELL ONLY)
M51	12	150	B		6	MECHANICAL (CORE AND SHELL ONLY)
001		150	M		6	FOUR (4) ACCESSORY OFF STREET LOADING BERTHS (CORE AND SHELL ONLY)
001	305	100	M		6	RETAIL, LOBBY
001	200	100	B		6	OFFICES (CORE AND SHELL ONLY)
002	223	100	B		6	OFFICES, ACCESSORY MECHANICAL ROOMS
003	263	100	B		6	OFFICES, ACCESSORY MECHANICAL ROOMS, ACCESSORY TERRACE
004	263	100	B		6	OFFICES, ACCESSORY MECHANICAL ROOMS
005	263	100	B		6	OFFICES, ACCESSORY MECHANICAL ROOMS ON EACH FLOOR
006	351	100	B F-2		6	OFFICES, ACCESSORY MECHANICAL ROOMS
007	351	100	B F-2		6	OFFICES, ACCESSORY MECHANICAL ROOMS, ACCESSORY TERRACE



Borough Commissioner



Commissioner

Certificate of Occupancy

CO Number: 121184841T023

Permissible Use and Occupancy						
All Building Code occupancy group designations below are 2008 designations.						
Floor From To	Maximum persons permitted	Live load lbs per sq. ft.	Building Code occupancy group	Dwelling or Rooming Units	Zoning use group	Description of use
008	351	100	B F-2		6	OFFICES, ACCESSORY MECHANICAL ROOMS
009	117	150	B		6	MECHANICAL (CORE AND SHELL ONLY)
010	609	150	B A-2 A-3		6	OFFICES, CAFETERIA, MEETING HALL, EATING & DRINKING ESTABLISHMENT, ACCESSORY TERRACE, ACCESSORY MECHANICAL ROOMS
011	231	50	B		6	OFFICES, ACCESSORY MECHANICAL ROOMS
012	231	50	B		6	OFFICES, ACCESSORY MECHANICAL ROOMS
013		231	B F-2		6	OFFICES, ACCESSORY MECHANICAL ROOMS
014	017 231	50	B		6	OFFICES, ACCESSORY MECHANICAL ROOMS ON EACH FLOOR
018	231	50	B A-2 A-3		6	OFFICES, PLACE OF ASSEMBLY(CAFE/MEETING HALL/LECTURE)
019	021 231	50	B		6	OFFICES, ACCESSORY MECHANICAL ROOMS ON EACH FLOOR
022	231	50	B		6	OFFICES, ACCESSORY MECHANICAL ROOMS (CORE AND SHELL ONLY)
023	231	50	B F-2		6	OFFICES, ACCESSORY TERRACE,ACCESSORY MECHANICAL ROOMS
024	231	50	B		6	OFFICES, ACCESSORY MECHANICAL ROOMS
025	031 231	50	B		6	OFFICES, ACCESSORY MECHANICAL ROOMS ON EACH FLOOR



Borough Commissioner



Commissioner

Certificate of Occupancy

CO Number: 121184841T023

Permissible Use and Occupancy						
All Building Code occupancy group designations below are 2008 designations.						
Floor From To	Maximum persons permitted	Live load lbs per sq. ft.	Building Code occupancy group	Dwelling or Rooming Units	Zoning use group	Description of use
032 034	231	50	B		6	OFFICES, ACCESSORY MECHANICAL ROOMS ON EACH FLOOR
035	42	100	B F-2		6	OFFICES, ACCESSORY MECHANICAL ROOMS
035	250	100	A-2		6	CAFETERIA, ACCESSORY TERRACE
036	252	100	A-3 F-2		6	CONFERENCE ROOMS, MULTI-PURPOSE ROOMS
036	40	100	B F-2		6	OFFICES, ACCESSORY MECHANICAL ROOMS
037 038	231	50	B		6	OFFICES, ACCESSORY MECHANICAL ROOMS ON EACH FLOOR
039	145	50	B F-2		6	OFFICES
039	103	50	A-2 A-3		6	PLACE OF ASSEMBLY (EATING AND DRINKING ESTABLISHMENT/MEETING HALL)
040		50	B		6	ACCESSORY MECHANICAL ROOMS (CORE AND SHELL ONLY)
040	231	50	B F-2		6	OFFICES
041	231	50	B F-2		6	OFFICES, ACCESSORY MECHANICAL ROOMS
042	231	50	B F-2		6	OFFICES, ACCESSORY MECHANICAL ROOMS
043	287	100	B A-2 A-3		6	OFFICES, PLACE OF ASSEMBLY (CAFE/LECTURE HALL/EATING AND DRINKING ESTABLISHMENT), ACCESSORY MECHANICAL ROOMS



Borough Commissioner



Commissioner

Certificate of Occupancy

CO Number: 121184841T023

Permissible Use and Occupancy						
All Building Code occupancy group designations below are 2008 designations.						
Floor From To	Maximum persons permitted	Live load lbs per sq. ft.	Building Code occupancy group	Dwelling or Rooming Units	Zoning use group	Description of use
044	266	100	B F-2		6	OFFICES, ACCESSORY MECHANICAL ROOMS
045	231	50	B F-2		6	OFFICES, ACCESSORY MECHANICAL ROOMS
046	231	50	B		6	OFFICES, ACCESSORY MECHANICAL ROOMS
047	231	50	B		6	OFFICES, ACCESSORY MECHANICAL ROOM
048	231	50	B		6	OFFICES, ACCESSORY MECHANICAL ROOMS
049 050	231	50	B		6	OFFICES, ACCESSORY MECHANICAL ROOMS ON EACH FLOOR
051	77	50	B		6	MECHANICAL (CORE AND SHELL ONLY)
ROF	3	150	B		6	MECHANICAL (CORE AND SHELL ONLY)
NOTE: ZONING EXHIBITS I & III RECORDED UNDER CRFN#S 2014000290111, 2014000 290112						
END OF SECTION						



Borough Commissioner



Commissioner

END OF DOCUMENT

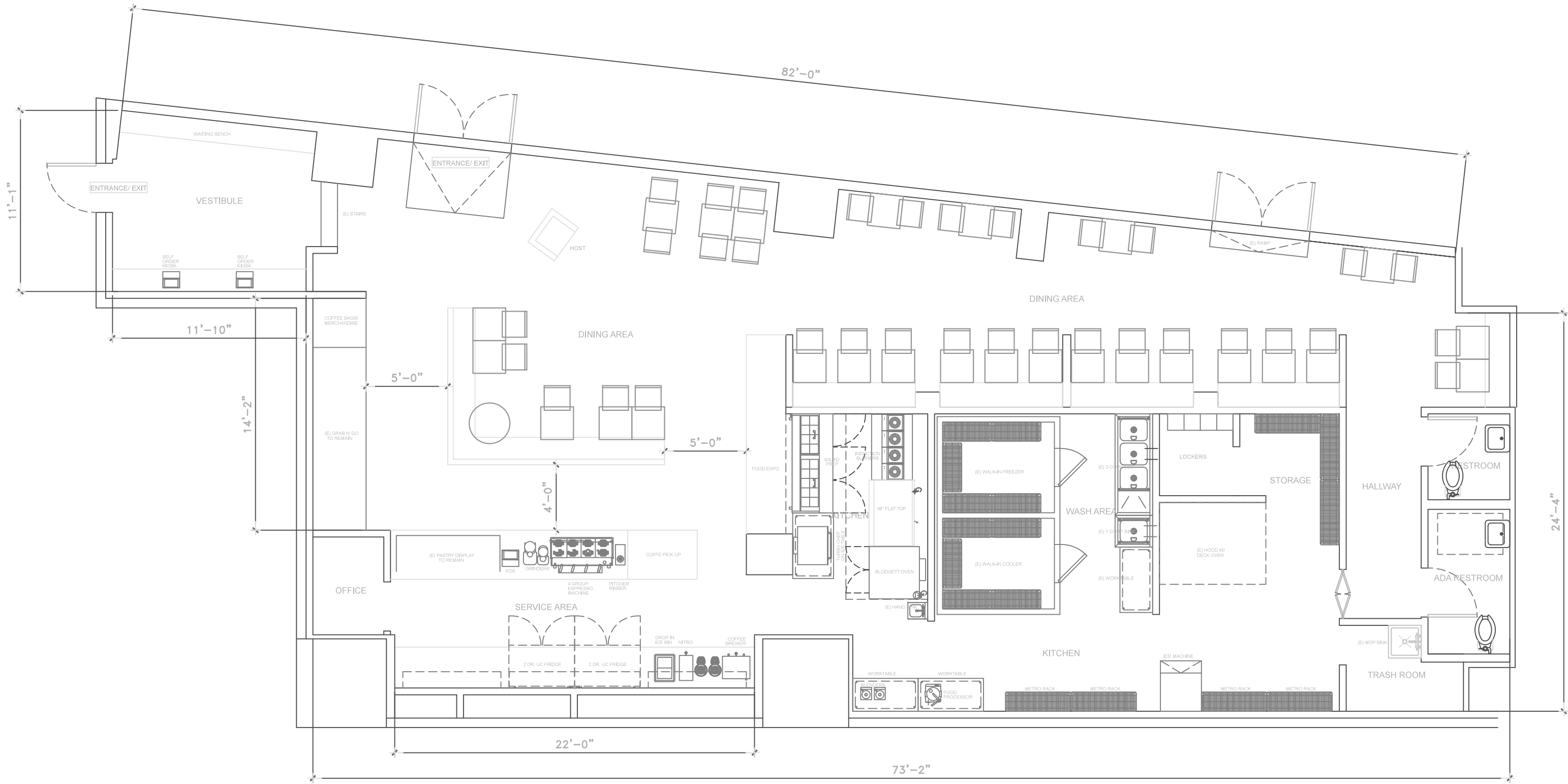

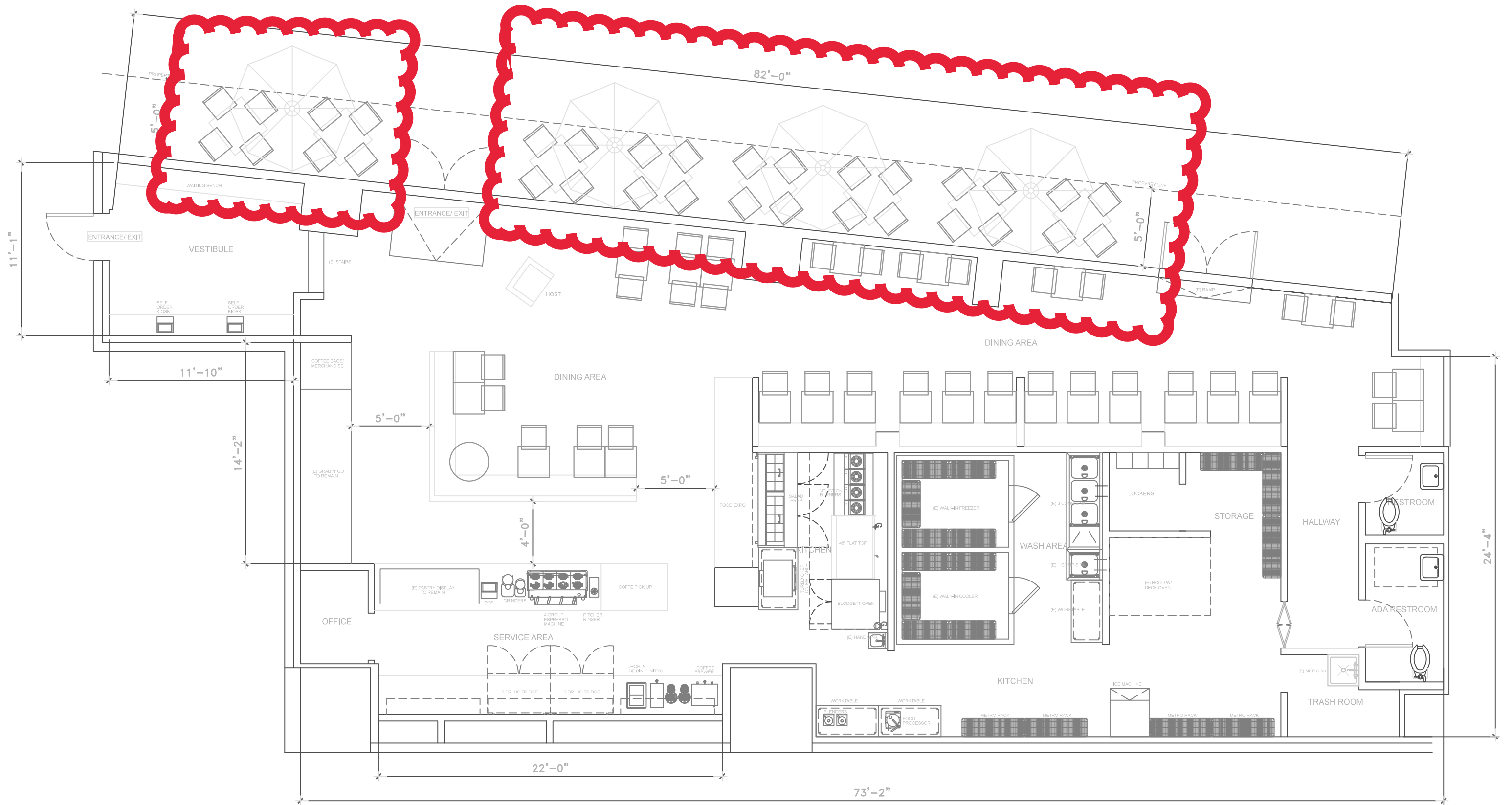



TISON KAYSER
PARIS

TISSERIE

KAYSER

DO YOU
KNOW
THE
CAFFE
L'ESPRIT

Black t-shirt with white text





































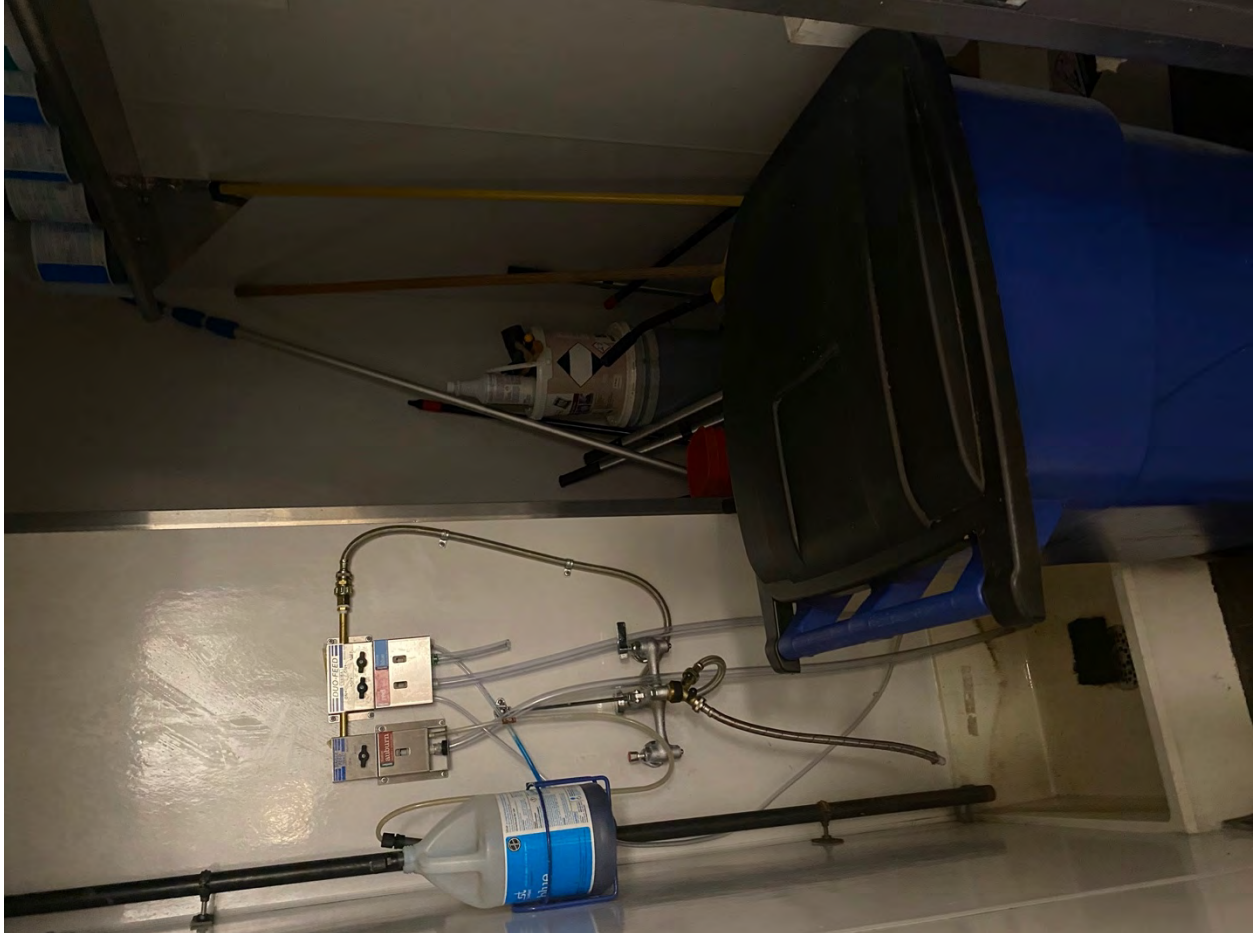

























New Year, New ME(NU)



(<https://bluestonelane.com/author/tahlia/>) Author: Tahlia | January 6, 2021

Category: The News (<https://bluestonelane.com/category/blog/>)

Like 0

Share

Tweet

A healthy, hearty winter menu has arrived!

We're taking your new year aspirations to your plate and adding 6+ perfectly crafted dishes for winter. Our seasonal menu invites the cozy and hearty with nutrient-rich roasted vegetables, warm grain bowls and new sandwiches.



Here's a closer look...



Cauli-Rice with an Avocado Rose Salad; *Housemade cauliflower rice topped with an avocado rose, poached egg on a bed of baby kale, red cabbage, crunchy seeds with zesty lemon tahini vinaigrette.*



Apple Crumble Porridge; *Creamy vegan oat porridge with slow-stewed apples, cranberries, freeze dried raspberries topped with chef's secret caramel crumble.*



Warm Chicken and Grains Bowl; *Warm farro and lentils with lemon and garlic grilled chicken, brussel sprouts, heirloom carrots, cow's milk feta, drizzled EVOO & microgreens.*



Best Mates Bowl; Harvest roasted brussels sprouts, field mushrooms, mixed through with farro, soft scrambled eggs, pickled onion, feta and finished with baby kale.



Classic Chicken & Bacon Club Sandwich; *Oven roasted chicken and bacon on sourdough with avocado, tomato and chimichurri mayo, served with crispy potato wedges.*



Green Baked Eggs; *Shakshuka-style baked eggs with spinach, sheep's milk feta, field mushrooms, tomatoes & chimichurri served w/ toast.*

We've also updated our classics to make them even more brunch worthy.

So grab a mate, and let's get brunching!



The Menu

The café menu includes Bluestone Lane favorites, such as Avocado Smash and the Good Grains Granola, complimented by Australian café staples, such as the Breakfast Burrito, as well as a range of progressive, seasonal dishes inspired by culinary themes found in Australia.

2021 WINTER CAFE MENU

BREKKIE ALL DAY

Enjoy a health-focused and progressive all-day brunch menu, featuring the Bluestone Lane signature dishes you love.

AVOCADO SMASH (D)

271 cals

Our classic avo smash with feta, heirloom tomatoes & soft herbs on toasted multigrain. Make it vegan by removing feta.

Allergens: D = Contains Dairy

**BEST MATES BOWL (D)**

Harvest roasted brussels sprouts & field mushrooms, served with soft scrambled eggs, baby kale, farro, pickled onion, feta, and toasted seeds.

Allergens: D = Contains Dairy

**SOFT CHILI SCRAMBLE W/ AVOCADO (D)**

Folded eggs with burnt butter, shallot & feta on toast with chili oil, avocado & sesame seeds.

Allergens: D = Contains Dairy

**BL BURRITO (D)**

476 cal

Scrambled eggs, bacon, guajillo sauce, avocado, feta & potato wedges, served with a side of crispy potato wedges.

Allergens: D = Contains Dairy

**B.L.A.T.E.**

493 cal

Crispy bacon, arugula, avocado, tomato, fried egg & garlic aioli on a brioche roll, served with potato wedges.

**ATHLETES BURRITO (D)**

Egg whites, sauteed spinach, roasted tomatoes, avocado, lentils & Peruvian aji sauce, served with dressed salad.

Allergens: D = Contains Dairy



**GREEN BAKED EGGS (D)**

Shakshuka-style baked eggs with spinach, feta, field mushrooms, tomatoes & chimichurri, served with multigrain toast.

Allergens: D = Contains Dairy

**BREAKFAST BOWL (D)**

428 cal

Tossed baby kale, heirloom tomatoes, feta, avocado, farro & a poached egg.

Allergens: D = Contains Dairy

**BL BIG BREKKIE**

442 cal

Avocado smash on toasted multigrain with two poached eggs, bacon, roasted tomatoes, baked mushrooms and baby kale.

**BL VEGETARIAN BIG BREKKIE (D)**

459 cal

Avocado smash on toasted multigrain with two poached eggs, halloumi, baked mushrooms, roasted tomatoes and baby kale.

Allergens: D = Contains Dairy

**APPLE CRUMBLE PORRIDGE (GF, D, N)**

Creamy oat & chia porridge with stewed apples, cranberries, and dried raspberries, served with chef's secret caramel crumble.

Allergens: GF = Gluten Free, D = Contains Dairy, N = Contains Tree Nuts

**BREKKIE BOARD (D, N)**

332 cal

Best of both worlds; half serving of our signature Avo Smash and Collective Granola.

Allergens: D = Contains Dairy, N = Contains Tree Nuts

**BANANA BREAD (GF, D, N)**

331 cal

HUSK Bakeshop gluten-free banana bread with whipped ricotta, fresh strawberries, roasted pecans & local honey.

Allergens: GF = Gluten Free, D = Contains Dairy, N = Contains Tree Nuts

**COLLECTIVE GRANOLA (GF, D, N)**

476 cal

HUSK bakeshop GF & vegan granola served w/ fat-free greek yogurt, lemon curd & fresh berries.

Allergens: GF = Gluten Free, D = Contains Dairy, N = Contains Tree Nuts

LUNCH

Our autumn lunch menu features seasonally inspired wraps, bowls, and burgers for a balanced meal any time of day.

**WARM CHICKEN AND GRAINS BOWL (D)**

Warm mixed grains bowl with lemon and garlic grilled chicken, seasonal roasted vegetables, cow's milk feta, drizzled EVOO & microgreens

Allergens: D = Contains Dairy

**CAULI-RICE W/ AVOCADO ROSE SALAD (GF)**

Housemade cauliflower rice topped with an avocado rose, poached egg on a bed of baby kale, red cabbage, crunchy seeds with zesty lemon tahini vinaigrette

Allergens: GF = Gluten Free

**CLASSIC CHICKEN & BACON CLUB SANDWICH**

Oven roasted chicken and bacon on sourdough with avocado, tomato and chimichurri mayo, served with crispy potato wedges

SPICED CHICKEN WRAP (D)



Grilled tandoori spiced chicken breast, baby kale, feta, avo smash, heirloom tomato and cumin yogurt
Allergens: D = Contains Dairy



RAINBOW BOWL (D)

Roasted heirloom carrots, spinach, farro, fresh edamame, diced beet, sliced red cabbage, feta, poached egg and avo topped with chimichurri yogurt dressing. Make it vegan by removing feta and dressing or enjoy with the chef's recommended protein of smoked salmon.
Allergens: D = Contains Dairy



RAINBOW WRAP (V)

Farro, roasted cherry tomatoes, avo smash, baby kale, red cabbage, roasted heirloom carrots and chimichurri served with mixed greens
V = Vegan



GREENS AND GRAINS BOWL (N)

Lentil and farro grains, charred broccoli, baby kale, red cabbage and edamame with tangy sesame ginger dressing topped with parsley, mint, dill
Allergens: N = Contains Tree Nuts



IMPOSSIBLE BAYSIDE BURGER

The Impossible Burger, cheddar cheese, caramelized onions, fig jam, aioli, arugula, and tomato on a brioche bun. Served with potato wedges on the side.



LUNCH BOARD (D)

Half portions of our classic Avocado Smash & Greens and Grains Bowl.
Allergens: D = Contains Dairy, N = Contains Tree Nuts

SIDES

Fresh sides & small plates designed to perfectly complement our BL classics.



TOAST BAR

160 cals

Thick cut multigrain toast served with vegemite & butter, jam & butter or almond butter.

Vegemite & Butter
Jam & Butter
Almond Butter (N)



SIDE BACON

A helping of four crispy rashers of bacon



SIDE WEDGES (D)

Crispy potatoes wedges with sour cream and sweet chili sauce

Allergens: D = Contains Dairy



SIDE ROASTED CARROTS (D, N)

Honey roasted heirloom carrots, feta cheese, toasted pecans, olive oil, maldon salt, black pepper, micro herbs

Allergens: D = Contains Dairy, N = Contains Tree Nuts



SIDE CHARRED BROCCOLI (D)

Char roasted Florets with parmesan cheese, drizzled with olive oil, sea salt, cracked pepper and a lemon wedge.

COFFEE - HOT

Bringing Melbourne's renowned coffee culture where premium coffee is a way of life

**PEPPERMINT MOCHA**

120 cal

Peppermint tea extract, double shot of espresso, and deliciously rich cocoa, spun in a pitcher with steamed, silky textured milk & dusted with chocolate shavings.

Small (8oz)
Large (12oz)

**PEPPERMINT HOT CHOCOLATE**

135 cal

Peppermint tea extract, deliciously rich cocoa, and steamed, silky textured milk. Served with chocolate shavings.

Small (8oz)
Large (12oz)

**LATTE**

120 cal

The global café favorite. Double espresso with steamed, silky textured milk and one inch of velvety micro-foam.

Small (8oz)
Large (12oz)

**FLAT WHITE**

100 - 110 cal

An Australian classic. Double espresso with steamed silky textured milk and a thin layer of micro-foam.

Small (8oz)
Large (12oz)

**CAPPUCCINO**

100 - 110 cal

Double espresso with steamed milk and slightly more microfoam than a latte with cocoa dusting on top.

Small (8oz)
Large (12oz)

**LONG BLACK**

0 cal

Single Origin espresso gently resting on a small amount of hot water for dilution, similar to an Americano.

Small (8oz)
Large (12oz)

**HOT BREW**

0 cal

Our signature flagstaff roast has tasting notes of toasted almonds, vanilla & chocolate with a caramel sweetness and juicy finish.

Small (12oz)
Large (16oz)

**MAGIC**

90 cal

A stronger, less diluted spin on a flat white – two shots of espresso in a 4.5oz cup with steamed milk and velvety microfoam, similar to a European Cortado.

Regular (5oz)

**ESPRESSO**

0 cal

Our new Single-Origin espresso from the Tarqui region of Huila, Colombia. Carefully roasted to highlight unique tasting notes of orange, vanilla, and brown sugar.

Single
Double

**MACCHIATO**

50 cal

Our signature maverick espresso with a stain of steamed milk and microfoam.

Single
Double

**PICCOLO**

75 cal

A single shot of espresso with 3 oz of steamed, silky textured milk, served in a small glass.

Regular

**CHAI LATTE**

145 cal

Chai extract with your choice of milk.

Small (8oz)
Large (12oz)

**MOCHA**

120 cal

Double shot of espresso and cocoa spun in a pitcher with steamed, silky textured milk, dusted with chocolate shavings.

Small (8oz)
Large (12oz)

**HOT CHOCOLATE**

135 cal

Deliciously rich cocoa spun in a pitcher with steamed, silky textured milk. Served with chocolate shavings.

Small (8oz)
Large (12oz)

**HOT MILO**

190 cal

An Aussie Favorite. Malted chocolate with your choice of steamed milk.

Small (8oz)
Large (12oz)

**BAMBICCINO**

BL for the little ones. Steamed and frothed milk with a dusting of cocoa.

COFFEE - COLD

Bringing Melbourne's renowned coffee culture where premium coffee is a way of life

**COLD BREW**

0 cal

Our signature flagstaff coffee immersed in water for 12 hours to extract and form a rich concentrate.

Small (16oz)
Large (20oz)

ICED LATTE

120 cal



Double shot of our signature maverick espresso blend with your choice of milk, poured over ice.

Small (16oz)

Large (20oz)



ICED LONG BLACK

Rotating Single-Origin espresso poured over ice and water.

Small (16oz)

Large (20oz)



ICED MAGIC

120 cal

A stronger, less diluted spin on an iced latte – two espresso shots with ice and milk.

Regular



ICED MOCHA

Double shot of espresso and cocoa spun in a pitcher with your choice of milk, poured over ice.

Small (16oz)

Large (20oz)



ICED CHAI LATTE

120 cal

Chai extract with your choice of milk, poured over ice.

Small (16oz)

Large (20oz)



ICED MILO

385 cal

Malted chocolate with vanilla ice cream and your choice of milk.

Small (16oz)

Large (20oz)

**AFFOGATO**

170 cal

Vanilla ice-cream served with a double shot of our signature maverick espresso.

Regular

**AUSSIE ICED LATTE**

260 cal

A double shot of espresso with vanilla ice cream and your choice of milk.

Small (16oz)

Large (20oz)

**AUSSIE ICED CHOCOLATE**

275 cal

Creamy vanilla ice cream with cocoa and your choice of milk.

Small (16oz)

Large (20oz)

**COLD BREW FLOAT**

170 cal

Our signature flagstaff coffee immersed in water for 12 hours to extract and form a rich concentrate, served with vanilla ice cream.

Small

Large

PASTRIES

Fresh pastries and select gluten free baked goods

**PLAIN CROISSANT**

300 cal

Freshly baked plain croissants. Light and airy layers of flaky buttery pastry.

4 PACK PLAIN CROISSANTS



4 freshly baked plain croissants. Light and airy layers of flaky buttery pastry.



CHOCOLATE CROISSANT

340 cal

Freshly baked chocolate croissants. Light and airy layers of flaky buttery pastry with dark chocolate.



ALMOND CROISSANT

430 cal

Freshly baked almond croissants. Light and airy layers of flaky buttery pastry with toasted slivered almonds.



BANANA BREAD (GF) (V)

230 cal

Snack time. It's the perfect portion for a brunch snack or afternoon delight. This gluten free mouthful, is unlike any other of its kind. Light, packed with visible chunks of freshly peeled banana, and as fluffy as they come. Being that it is also dairy free, its added health benefits from the coconut oil, makes it all that more enjoyable.



CINNAMON SUGAR DONUT (GF)

170 cal

Our seasonal GF donut is perfectly spiced with cinnamon and sugar. A delightful treat to pair with your favorite coffee.



GF CHOCOLATE CHIP COOKIE

350 cal

This thin American style cookie is the best of both worlds. Crispy edged with a lightly chewy center. Perfectly indulgent and decadent, lightly salted and full of the finest Belgium milk chocolate! Only the purest ingredients.

COFFEE BOXES

Catering for a larger group or the family? Picnic like a pro with our coffee boxes.



HOT BREW COFFEE BOX (96OZ)

Enjoy our premium hot coffee in a large 96oz coffee box. If you would like milk or additional condiments please ask our team when you pick up.



COLD BREW COFFEE BOX (96OZ)

Enjoy our premium cold brew coffee in a large 96oz coffee box. If you would like milk or additional condiments please ask our team when you pick up.

WINE, BEER & COCKTAILS

The law requires that all purchases of products containing alcohol can only be by an adult over the age of 21. ID must be presented upon collection.



FLEURS DE PRAIRIE ROSÉ

Provence, France- Crafted in the traditional Provencal style with a pale salmon color, delicate flavors of strawberry, rose petals, and herbs, with bright, refreshing acidity.

By the Glass
Bottle



OYSTER BAY MARLBOROUGH ROSÉ

Oyster Bay's cool climate Marlborough Rosé exudes summer cherry and fragrant blossom notes with a burst of red berries and a lively citrus zest.

By the Glass
Bottle

NICOLAS FEUILLATTE CHAMPAGNE

Réserve Exclusive Brut is an iconic Champagne that perfectly encapsulates Nicolas Feuillatte house style. Representing the entire Champagne appellation, every inch of the region comes together to reveal a glorious showcase: light, fresh and vibrant Champagne, effusing



intense, expressive fruit, while extensive cellar-ageing brings appealing maturity to perfect style and consistency.

Bottle (375ml)



DROUHIN VAUDON CHABLIS

This wine's greentinged acidity makes it cool and mouthwatering, you might find chamomile and scents of white roses as the wine lasts, pure, spicy and clean.

By the Glass

Bottle



VILLA MARIA SAUVIGNON BLANC

Sourced from vineyards across the Marlborough region of New Zealand, this vibrant Sauvignon Blanc is alive with a myriad of flavours dominated by gooseberry, passionfruit, fresh citrus and herbaceous aromas.

By the Glass

Bottle



J.LOHR CHARDONNAY

Arroyo Seco, Central Coast, CA- The fresh aromas of lime zest, nectarine, peach and apple combined with the perfumed vanilla and toasted oak bouquet leading to flavors of peach, nectarine and citrus on the palate with subtle butter and vanilla toastiness.

By the Glass

Bottle



MERCER FAMILY VINEYARDS CHARDONNAY

This elegant Chardonnay from the Columbia Valley in Washington opens with aromas of fresh green and golden apples, pears, vanilla and lemon. The body is full and lush with a clean, smooth finish.

By the Glass

Bottle



COPPOLA PINOT NOIR

California- This wine has exceptionally dark color, which is not typical of the varietal. It exhibits explosive aromatics and impressive concentration, due in large part to the well-draining soils of our Monterey vineyards. Tannins are supple and the finish on this wine is lengthy.

By the Glass

Bottle



BAROSSA VALLEY ESTATE SHIRAZ

Alluring exotic spice Shiraz with vibrant flavors of red plum and fresh blackberry. Direct from South Australia's renowned wine country of the Barossa Valley.

By the Glass
Bottle



ALL-WISE MEAD

All-Wise's flagship product is a dry honey wine made from raw and unfiltered New York honey aged with oak.

Light bodied and dry with a crisp, clean finish
ABV 11.00%

By the Glass
Bottle



BUSHWICK PILSNER

Braven Brewing Co. Based on the pilsners brewed in Bushwick for over 100 years, Bushwick Pilsner is the return of the style that made the neighborhood famous.



COOPERS PALE ALE

An Aussie brewing classic. With its fruity and floral characters, balanced with a crisp bitterness, Coopers Pale Ale has a compelling flavour which is perfect for every occasion. Naturally fermented in the "Burton-upon-Trent" style, a secondary fermentation creates the trademark sediment that gives 'Pale' its fine cloudy appearance.



COOPERS SPARKLING ALE

Australian made and owned. Coopers Sparkling Ale is brewed and fermented using a unique method of top fermentation and natural bottle conditioning. Coopers are famous for this process which leaves a natural residue of yeast during maturation and gives a cloudy appearance with an enhanced flavour. No additives, no preservatives.



SCHOFFERHOFER GRAPEFRUIT RADLER

A Radler beer brewed with a Hefeweizen and sparkling grapefruit mix. Subtle grapefruit and wheat character on the nose. Sweet grapefruit flavor blends with a sharp wheat character

THE OLD FASHIONED

Staying true to the original recipe, we keep our Old Fashioned strong and simple using a generous pour of Knob Creek® Bourbon Whiskey, bitters, cane sugar, orange, cherry, and lemon zest. 35% ABV.

**FINNISH TRADITIONAL LONG DRINK**

A refreshing gin based cocktail with natural grapefruit and juniper berry. Ready to drink & served in a glass with ice and orange slices. 5.5% ABV.

**JALAPEÑO PINEAPPLE MARGARITA**

The perfect drink for those who share our love of all things hot. The Jalapeño Pineapple Margarita uses a flavor combination of pineapple and triple sec married with plata tequila and the heat from the jalapeño. 20% ABV.

**BLOODY MARY**

We are now offering cocktails for curbside pickup in to-go cups. Try our take on a classic Bloody Mary made with Vodka and Tomato Juice.

**SPIKED COLD BREW**

Our to-go take on a classic coffee martini. Made with Coffee Liqueur, Vodka, a dash of sweet syrup & our signature Cold Brew Coffee.

ORGANIC TEAS & WELLNESS

Premium organic teas sourced from Sri Lanka's Southern Province

ICED MELBOURNE BREAKFAST TEA



Our cold brewed Melbourne Brekky is a smooth, strong blend of organic Ceylon tea. This robust brew provides a refreshing boost for any time of day.

Small (16oz)
Large (20oz)



ICED SPRING TRELIS TEA

Green roibos, raspberry, lemon peel and hibiscus. This non-caffeinated cold brewed tea is tart and refreshing with natural sweetness. Plus, it's full of antioxidants to help toxin release and promote healthy skin.

Small (16oz)
Large (20oz)



MATCHA LATTE

60 cal

Ceremonial grade matcha green tea powder that naturally detoxifies the body, is rich in antioxidants, and provides a valuable source of fiber and vitamins made with steamed almond milk.

Small (8oz)
Large (12oz)



ICED MATCHA LATTE

60 cal

Ceremonial grade matcha green tea powder that naturally detoxifies the body, is rich in antioxidants, and provides a valuable source of fiber and vitamins with almond milk.

Small (16oz)
Large (20oz)



GOLDEN LATTE

70 cal

Turmeric powder, cinnamon, ginger and black pepper, good for detoxifying the body and reducing inflammation made with steamed almond milk.

Small
Large



ICED GOLDEN LATTE

70 cal

Turmeric powder, cinnamon, ginger and black pepper, good for detoxifying the body and reducing inflammation made with almond milk.

Small (16oz)
Large (20oz)

**BEET LATTE**

60 cal

Dehydrated beet powder that is rich in antioxidants, and good for digestion. This drink is married with a dusting of cocoa and steamed almond milk.

Small

Large

**ICED BEET LATTE**

60 cal

Dehydrated beet powder that is rich in antioxidants, and good for digestion. This drink is married with a dusting of cocoa and almond milk.

Small

Large

**MELBOURNE BREAKFAST**

This smooth, strong blend of organic Ceylon tea can be enjoyed with or without milk and, despite the name, at any time of day.

Small

Large

**EARL GREY**

Twice-refined organic Spanish bergamot oil is blended with organic Ceylon tea and cornflowers to create a clean, refreshing and aromatic blend traditionally appreciated in the afternoon.

Small

Large

**LEMONGRASS & GINGER**

A much-loved favorite, this premium blend of organic ginger and lemongrass tea has made its way here from Sri Lanka. The sweet lemongrass balances out the gingery spice, creating a vibrant and energizing brew.

Small

Large

**SENCHA GREEN**

The long, slender leaves of this green tea produce sweet, mellow liquor that contains EGCG, a catechin said to lower the risk of cancer, chronic fatigue and neurological diseases.

Small

Large



PEPPERMINT

A classic herb widely appreciated as a digestive and a revitalizing tonic, organic Egyptian peppermint is picked at the peak cropping season, resulting in a bright, fresh aroma and clean, lasting finish.

Small
Large



CHAMOMILE

Harvested in the warmth of Egypt's summer, the sweet, aromatic flowers of chamomile calm nerves, soothe stomachs and leave you feeling peaceful and relaxed.

Small
Large

JUICES & BEVERAGES

Freshly cold pressed juices made with the finest ingredients



ORANGE JUICE

60 cal

Freshly cold pressed juices made with the finest oranges



FUJI APPLE JUICE

80 cal

Freshly cold pressed juices made with the finest Fuji apples



PORTSEA JUICE

70 cal

Freshly cold pressed juices made with the finest cucumber, apple, kale, lemon, ginger root and spinach

TORQUAY JUICE

110 cal

Freshly cold pressed pineapple, carrot, orange, ginger root, and turmeric.

**FITZROY JUICE**

100 cal

Freshly cold pressed juices made with the finest pineapple, grapefruit, lemon and ginger root

**BL BOTTLED WATER**

0 cal

Our 100% pure spring water in 24oz bottle. Enjoy Mates!

**NATURAL + PURE SPARKLING WATER**

0 cal

Made with all natural ingredients, our pure sparkling water has no artificial flavors, colors or sweeteners. It has a crisp, refreshing taste you've been longing for. Enjoy Mates!

**LEMON + LIME SPARKLING WATER**

0 cal

Made with all natural ingredients, our Lemon + Lime flavored sparkling water has no artificial flavors, colors or sweeteners. It has a crisp, refreshing taste you've been longing for. Enjoy Mates!

**GRAPEFRUIT SPARKLING WATER**

0 cal

Made with all natural ingredients, our Grapefruit flavored sparkling water has no artificial flavors, colors or sweeteners. It has a crisp, refreshing taste you've been longing for. Enjoy Mates!





PASSIONFRUIT SPARKLING WATER

0 cal

Made with all natural ingredients, our Passionfruit flavored sparkling water has no artificial flavors, colors or sweeteners. It has a crisp, refreshing taste you've been longing for. Enjoy Mates!

AT HOME COFFEE & PACKS

Direct from our roastery and Gluten free bakery in Brooklyn, NY, enjoy our signature fresh coffee blends and HUSK baked goods.



HOLIDAY SPICE (FILTER BLEND) 12OZ BAG

Medium Grind. Notes of pumpkin, cinnamon, nutmeg & clove. Our new Holiday Spice blend features your favorite drip & filter blend, carefully roasted with comforting autumnal flavors.



FLAGSTAFF (FILTER BLEND) 12OZ BAG

Our balanced and approachable drip blend. Using hot brewing methods you will find notes of fresh oak, vanilla, caramel, dark chocolate and molasses.

Flagstaff is also the secret behind our famous Cold Brew. When steeped for 12 hours in room temperature water, this blend produces a caramel sweetness, soft citric acidity and tones of milk chocolate with a juicy finish.

Fine (Espresso/Stovetop)
Medium (Filter machines)
Coarse (French Press/Submersion)



MAVERICK (ESPRESSO BLEND) 12OZ BAG

Bluestone Lane signature espresso blend. This is what we use in all our shops. Designed to perfectly complement milk with rich notes of cocoa, clove and honeycomb – expect a cup that is well-structured and has a creamy, full-bodied mouthfeel.

Fine (Espresso/Stovetop)
Medium (Filter machines)
Coarse (French Press/Submersion)

SINGLE ORIGIN COLOMBIA EL PARAISO 12OZ BAG

Sourced from the Tarqui region of Huila, Colombia, our El Paraiso Single-Origin has a big citrus acidity with juicy orange notes balanced out by a sugary sweet finish.



We've carefully roasted this coffee to highlight these characteristics to make an enjoyably balanced & unique espresso.

Fine (Espresso/Stovetop)
Medium (Filter machines)
Coarse (French Press/Submersion)



DECAF COLOMBIAN WHOLE BEAN 12OZ BAG

Our blend of Colombian coffee is from the Antioquia region and is decaffeinated using the Swiss Water Process method.

Swiss Water removes 99% of the coffee's caffeine without using harmful chemical solvents. The end result is a delicious full bodied coffee you can enjoy around the clock. Our Colombian Decaf has notes of Maple, Cocoa and Brown Sugar.

Fine (Espresso/Stovetop)
Medium (Filter machines)
Coarse (French Press/Submersion)



HUSK ORIGINAL GRANOLA 12OZ

The combination of overnight, perfectly marinated oats, seed, nuts and coconut, that is then slow roasted to perfection, makes for a happy morning. This balanced, crunchy and slightly sweet mix makes us proud! Using only the finest ingredients we are able to provide perfection. Simple is best, let all the goodness shine through.

(GF/DF)



HUSK PALEO MUESLI 12OZ

Talk about the healthiest alternative to add crunch and texture to your daily routine plus a little piece of mind too. Being that it's basically everything free, you get all the joy, without compromising the glory. No Gluten, No Dairy, No Added Sugar, No Grains and Vegan. A precisely curated blend of all the best Non-GMO Nuts and Seeds and a little dried fruit to add to that natural goodness that we love so much at HUSK. This muesli mix double's up and takes its place. A trail mix and a road trip amigo!

(GF/DF)



CALIFIA OAT MILK 1QT

1QT Califia Barista Edition Oat Milk. Vegan, Gluten-Free, Kosher, & Dairy-Free and made with whole rolled, gluten free oats grown in North America. This oat milk steams beautifully, perfectly pairs with coffee, and tastes dang-good by itself with no gums or stabilizers.

CALIFIA ALMOND MILK 1QT

1QT Califia Barista Edition Almond Milk. Vegan, Gluten-Free, Kosher, & Dairy-Free with full-bodied goodness, this milk functions as both a

"steamer" and creamer for your daily fix of BL coffee or HUSK granola.



HUSK GLUTEN FREE MULTIGRAIN LOAF

A Gluten Free loaf unlike any other, with the perfect texture, crumb, and thickness. HUSK Multigrain is free from gluten, dairy, and refined sugars. You will not be disappointed as our bread toasts perfectly without falling apart.

Contains: Brown Rice Flour, Teff Flour, Tapioca Starch, Corn Starch, Potato Starch, Xanthan Gum, Salt, Yeast, Egg, Apple Cider Vinegar, Coconut Syrup, Blend olive oil, Millet, Sunflower seed, Quinoa, Flaxseed.



BLUESTONE LANE TOTE BAG

The perfect partner for groceries, books, and gym gear. Our canvas tote features a unique BL design with logo and print. 100% cotton and ready for a day on the run.

YETI x Bluestone Lane Wild Barista LIMITED EDITION Collection →
(<https://bluestonelane.com/yeti-x-bluestone-lane-wild-barista-limited-edition-collection/>)

Recent Posts

(/yeti-x-bluestone-lane-wild-barista-limited-edition-collection/)

YETI x Bluestone Lane Wild Barista LIMITED EDITION

(/movember-coffee-conversation-starters/)

Movember Conversation Starters (/movember-coffee-

(/movember-coffee-conversation-challenge/)

Join the BL Movember Coffee Conversation Challenge!