

Manhattan Community Board 4

(All Fields Must Be Completed)

Liquor License/Sidewalk Cafe Stipulations Application

CORPORATION NAME		DOING BUSINESS AS (DBA)	
Pelicana HK Inc			
STREET ADDRESS		CROSS STREETS	ZIP CODE
641 10th Ave		W 45th St, W 46th St	10036
OWNER <small>(Attach a list of all the people that will be associated listed with the license)</small>	NAME:	Lim, Hun Sup	NAME: Yu, Jae
	PHONE:	646-884-0166	PHONE: 718-445-5050
	EMAIL:	hoonsup84@gmail.com	EMAIL: nylicense@gmail.com
MANAGER	NAME:		NAME: 641 10th Avenue LLC
	PHONE:		PHONE: 212-757-8888
	EMAIL:		EMAIL:
ATTORNEY/ REPRESENTAIVE			
LANDLORD			
APPLICATION TYPE (<input checked="" type="checkbox"/> Liquor License <input type="checkbox"/> Unenclosed Sidewalk Cafe)			
<input checked="" type="radio"/> New	Has applicant owned or managed a similar business?		YES <input type="checkbox"/> NO <input checked="" type="checkbox"/>
	What is/was the name and address of establishment?		
	What were the dates applicant was involved with this former premise?		
<input type="radio"/> Corp Change/Class Change/Removal	What is the license # and expiration date?		
	Is applicant making any alterations or operational changes?		YES <input type="checkbox"/> NO <input type="checkbox"/>
	<i>If alterations or operational changes are being made, please describe/list all changes.</i>		
<input type="radio"/> Alteration	What is the current license # and expiration date?		
	<i>Please list/describe the nature of all the changes and attach the plans:</i>		
METHOD OF OPERATION			
TYPE OF ALCOHOL	<input checked="" type="radio"/> Liquor/Wine/Beer & Cider <input type="radio"/> Beer & Cider <input type="radio"/> Wine/Beer & Cider		
ESTABLISHMENT TYPE	<input checked="" type="radio"/> Restaurant <input type="radio"/> Cabaret <input type="radio"/> Night Club <input type="radio"/> Hotel <input type="radio"/> Bar/Tavern <input type="radio"/> Catering Establishment <input type="radio"/> Adult Entertainment <input type="radio"/> Wine Bar <input type="radio"/> Dance Club <input type="radio"/> Sports Bar <input type="radio"/> Club (Fraternal Organization – Members Only)		
Has applicant/owner filed with the SLA? If yes, when? If no, when do you plan to file?		<input checked="" type="radio"/> YES <input type="radio"/> NO	10/26/2020
Is the 500 Foot Rule applicable? If yes, please attach a diagram of the On-Premise liquor license establishments within a 500 ft. radius of your establishment and the Public Interest Statement.		<input checked="" type="radio"/> YES <input type="radio"/> NO	
Is the 200 Foot Rule applicable? If yes, please attach a diagram of the schools and houses of worship that trigger the rule.		<input type="radio"/> YES <input checked="" type="radio"/> NO	
Has applicant/owner(s) read MCB4 Policy Regarding Concentration and Location of Alcoholic-Serving Establishments?		<input checked="" type="radio"/> YES <input type="radio"/> NO	

OPERATIONAL DETAILS (*Closing time will be when establishment is vacated of all patrons)

HOURS* <i>(Indoor Only)</i>		MONDAY	TUESDAY	WEDNESDAY	THURSDAY	FRIDAY	SATURDAY	SUNDAY
	Operation	12:00pm - 2:00am	12:00pm - 2:00am	12:00pm - 2:00am	12:00pm - 2:00am	12:00pm - 2:00am	12:00pm - 2:00am	12:00pm - 2:00am
	Kitchen	12:00pm - 1:30am	12:00pm - 1:30am	12:00pm - 1:30am	12:00pm - 1:30am	12:00pm - 1:30am	12:00pm - 1:30am	12:00pm - 1:30am
	Music	12:00pm - 1:30am	12:00pm - 1:30am	12:00pm - 1:30am	12:00pm - 1:30am	12:00pm - 1:30am	12:00pm - 1:30am	12:00pm - 1:30am
If you plan to have music, what type(s)? (Circle all that apply)			<input checked="" type="checkbox"/> BACKGROUND	<input type="checkbox"/> LIVE MUSIC	<input type="checkbox"/> DJ	<input type="checkbox"/> JUKE BOX	<input type="checkbox"/> KARAOKE	

OCCUPANCY

	Capacity (Certificate of Occupancy)	Maximum # of Persons Occupying Premises (Including Employees)	Number of Tables	Number of Seats	Number of Service Only Bars	Number of Stand-Up Bars	Number of Seats at Stand-Up Bar
INSIDE	75	26	8	20	0	1	0
OUTSIDE <i>(Other than sidewalk café)</i>							
DCA APPROVED UNENCLOSED SIDEWALK CAFÉ							

How many floors are there? What is the capacity for each floor? 6 floors including basement

How frequently will the owner(s) be at the establishment? 12:00pm - 12:00am Monday-Saturday

Will there be dancing? YES NO

Will applicant have bottle or table service for beverage alcohol? YES NO

Will applicant be hosting private; promotional or corporate events? YES NO

Will outside promoters be used on a regular basis? If yes please describe. YES NO

Will applicant have a security plan? If, yes please attach. YES NO

Will security plan be implemented? YES NO

Will State certified security personnel be used? YES NO

Will New York Nightlife Association and NYPD Best Practices be followed? YES NO

Does applicant agree to notify MCB4 prior to making changes to its method of operation? YES NO

Will applicant be using delivery bicycles? If yes, how many? YES NO

Will delivery bicycles be clearly marked with the name of the restaurant and will staff wear attire clearly noting name as described by NYC Law? YES NO N/A

Where will delivery bicycles be stored during the day when not in use? N/A

LOCATION & ZONING			
Is this a Special District? If yes, is it Clinton, West Chelsea or Hudson Yards?	YES	<input checked="" type="radio"/> NO	
Does the building have a Certificate of Occupancy ("C of O") or a letter of no objection?	<input checked="" type="radio"/> YES	NO	
Is a Public Assembly permit required?	YES	<input checked="" type="radio"/> NO	
Are your plans filed with DOB?	<input checked="" type="radio"/> YES	NO	

Community Notification/Relations			
NOTIFICATION: List all block associations; tenant associations, co-op boards or condo boards of residential buildings; and community groups that applicant has notified regarding its application. For each please list both the organization and individual you contacted	# 1	HKNA (incl. Dog Run)	
	# 2	West 45th Street BA (B. 9th/12th)	
	# 3	West 46th Street Block Association (8th Ave to 12th Ave)	
	# 4	Hell's Kitchen Block Association (W 33rd/34th/35th Streets)	
	# 5		
Please provide dates when applicant met with the groups listed above.		Emailed notification on Jan 18, 2021	
Who was your contact person at each group you met with?		Jae Yu	
When did applicant post the notice that was provided?		Jan 18th 2021	
Where did applicant post the notice that was provided?		Door window of Store	
Will applicant provide owner cell phone number to neighbors and respond to complaints that arise? Please provide number in space provided.		<input checked="" type="radio"/> YES	NO 646-884-0166
Will applicant inform the Community Board office of its job openings and/or provide a hyperlink to applicants jobs webpage?		YES	<input checked="" type="radio"/> NO

BUILDING DESIGN

State the name and type of business previously located in the space.	Hell's Chicken NYC Corp, Restaurant		
Has a liquor-licensed establishment previously occupied this space at any time? If yes, please provide the name of the business.	<input checked="" type="radio"/> YES	<input type="radio"/> NO	Hell's Chicken NYC Corp
Do you plan any changes to the existing façade? If yes, please describe.	<input checked="" type="radio"/> YES	<input type="radio"/> NO	Change signage to Pelicana Chicken
Has the applicant/owner(s) read MCB 4 ADA Guidelines Memo?	<input checked="" type="radio"/> YES	<input type="radio"/> NO	
Is the entrance ADA Compliant?	<input checked="" type="radio"/> YES	<input type="radio"/> NO	
Do you plan any changes to the existing façade? If yes, please describe.	<input checked="" type="radio"/> YES	<input type="radio"/> NO	Change signage to Pelicana Chicken
Will applicant have a vestibule within the establishment?	YES	<input checked="" type="radio"/> NO	
Will applicant use a storm enclosure?	YES	<input checked="" type="radio"/> NO	
Does applicant agree to keep the sidewalk clear of all items or obstructions, such as sandwich boards, sidewalk signs, freestanding menus and plants, as per the law?	<input checked="" type="radio"/> YES	<input type="radio"/> NO	
Will applicant comply with the NYC noise code?	<input checked="" type="radio"/> YES	<input type="radio"/> NO	
Will the establishment have any of the following: (circle all that apply)	FRENCH DOORS	GARAGE DOORS	WINDOWS THAT CAN BE OPENED
Will applicant close all windows, French doors, garage doors when any music or amplified sound (including televisions) is played inside the establishment?	<input checked="" type="radio"/> YES	<input type="radio"/> NO	
Will applicant close all windows, French doors, garage doors by 11 PM Friday and Saturday and 10 PM on all other days even if no music or amplified sound is played inside the establishment?	<input checked="" type="radio"/> YES	<input type="radio"/> NO	
Has applicant obtained an acoustical report from a certified sound engineer to assess potential noise disturbance to the neighboring residents and buildings?	YES	<input checked="" type="radio"/> NO	
Will applicant follow the recommendations of a certified sound engineer to mitigate potential noise disturbance to the neighboring residents and buildings, including placing speakers on the floor of the establishment?	<input checked="" type="radio"/> YES	<input type="radio"/> NO	
Will the kitchen exhaust system extend to the roof?	YES	<input checked="" type="radio"/> NO	
Will the establishment have an illuminated sign?	YES	<input checked="" type="radio"/> NO	
Will the establishment have a canopy extending over the sidewalk?	YES	<input checked="" type="radio"/> NO	
Where will the air conditioner be located? What type is it?	Central air conditioner installed on the ceiling		
When was the air conditioner installed?	Already exist when take over the restaurant		

OUTDOOR ITEMS - OTHER THAN SIDEWALK CAFÉ

Has the applicant/owner(s) read MCB 4 Rear Yard Rooftop Policy?	<input checked="" type="radio"/> YES	<input type="radio"/> NO	
Will applicant use any outdoor spaces: rooftop, rear yard, patio, porch, balcony, pavilion, tents, deck, gazebo or open dining in the parking lane? If yes, which one(s)?	<input type="radio"/> YES	<input checked="" type="radio"/> NO	
Are the floorplans for the outdoor space(s) included?	<input type="radio"/> YES	<input type="radio"/> NO	N/A
Will applicant close and vacate the outdoor space(s) by 11PM on Friday & Saturday and 10 PM on all other days?	<input type="radio"/> YES	<input type="radio"/> NO	N/A
Will the service and consumption of alcohol in any outdoor space only be via seated food service?	<input type="radio"/> YES	<input type="radio"/> NO	N/A
Will applicant not allow standing space for patrons to drink or smoke in any outdoor space(s) or on the sidewalk?	<input checked="" type="radio"/> YES	<input type="radio"/> NO	
Will there be no amplified music, as per the law?	<input checked="" type="radio"/> YES	<input type="radio"/> NO	
If amplified sound is played inside the establishment, will windows and doors be closed?	<input type="radio"/> YES	<input type="radio"/> NO	N/A. Soft background music only.
Will applicant agree to post signs outside asking customers to respect the neighbors'?	<input checked="" type="radio"/> YES	<input type="radio"/> NO	
Will applicant agree to train staff to encourage a peaceful environment?	<input checked="" type="radio"/> YES	<input type="radio"/> NO	
Will applicant provide effective sound control (landscaping enclosure, soundproofing tenants apartments)	<input checked="" type="radio"/> YES	<input type="radio"/> NO	
Will there be a lighting plan that allows safe usage of the outdoor space without disrupting neighbors?	<input type="radio"/> YES	<input type="radio"/> NO	N/A
If open dining in the parking lane, will applicant agree to leave the sidewalk free of any furniture?	<input type="radio"/> YES	<input type="radio"/> NO	N/A
If open dining, will you comply with all NYC DOT guidelines?	<input type="radio"/> YES	<input type="radio"/> NO	N/A
If open dining, will the installation be year-round?	<input type="radio"/> YES	<input type="radio"/> NO	N/A

DCA APPROVED UNENCLOSED SIDEWALK CAFÉ

Has the applicant/owner(s) read MCB4 Sidewalk Café Policy?	<input checked="" type="radio"/> YES	<input type="radio"/> NO	
Will applicant be applying for a sidewalk café now or in the future?	<input type="radio"/> YES	<input checked="" type="radio"/> NO	
Is applicant in this application seeking to include a sidewalk café in its liquor license?	<input type="radio"/> YES	<input checked="" type="radio"/> NO	
If yes, has applicant submitted an application and plans to NYC Dept. of Consumer Affairs? Please attach application and plans.	<input type="radio"/> YES	<input type="radio"/> NO	N/A
Will applicant close and vacate the sidewalk café by 11 PM on Friday & Saturday and 10 PM on all other days?	<input type="radio"/> YES	<input type="radio"/> NO	N/A
Will applicant be serving alcohol in the sidewalk café? If so, will you have waiter service?	<input type="radio"/> YES	<input type="radio"/> NO	N/A
Will the café have a 3 ft. wide serving aisle running the entire length of the sidewalk café?	<input type="radio"/> YES	<input type="radio"/> NO	N/A
Will applicant mark the perimeter of the café on the sidewalk?	<input type="radio"/> YES	<input type="radio"/> NO	N/A
Will the service and consumption of alcohol in the sidewalk café only be via seated food service?	<input type="radio"/> YES	<input type="radio"/> NO	N/A
Will the sidewalk café not provide standing space for drinking or smoking?	<input type="radio"/> YES	<input type="radio"/> NO	N/A
Will applicant use any portable natural gas heaters? If so, do you have the requisite approvals from DOB & the Fire Department?	<input type="radio"/> YES	<input type="radio"/> NO	N/A
Will applicant have a lighting plan that will allow safe usage of the outdoor space without disrupting neighbors?	<input type="radio"/> YES	<input type="radio"/> NO	N/A
Will all furniture, plants and barricades be stored inside between the evening closing hours and the morning opening hours?	<input type="radio"/> YES	<input type="radio"/> NO	N/A
Will all furniture be stored inside between December 21 st and March 21 st , and any other day when it rains or snows?	<input type="radio"/> YES	<input type="radio"/> NO	N/A
Will applicant use umbrellas?	<input type="radio"/> YES	<input type="radio"/> NO	N/A
If construction or construction protection has reduced the sidewalk width, will applicant always maintain an 8 foot clear path of sidewalk between the perimeter of the café and the closest obstruction including construction barricades?	<input type="radio"/> YES	<input type="radio"/> NO	N/A
If open dining is in the parking lane, will applicant agree to remove its sidewalk café?	<input type="radio"/> YES	<input type="radio"/> NO	N/A

ADDITIONAL STIPULATIONS: (Office Use Only)

To the extent any additional stipulation on pages 7 and 8 of this application conflicts with any response on pages 1 – 6 of this application, the stipulations on pages 7 and 8 control.

To the extent any additional stipulation on pages 7 and 8 of this application conflicts with any response on pages 1 – 6 of this application, the stipulations on pages 7 and 8 control.

Manhattan Community Board 4 (MCB4) recommends:
 (MCB4's recommendation is based on a vote taken at its
 March 3, 2021 full board meeting, with 41 members voting in favor
 of the recommendation, 0 members opposed, 0 members
 abstaining and 0 present but not eligible)

Denial unless all stipulations agreed to by applicant/owner are part of the method of
 operation
 Denial Approval

CB4 REPRESENTATIVES

 Nelly Gonzalez <i>CB4 Assistant District Manager</i>	 Frank Holozubiec <i>CB4 BLP Committee Co-Chair</i>	 Burt Lazarin <i>CB4 BLP Committee Co-Chair</i>
--	--	--

APPLICANT AGREEMENT WITH THE COMMUNITY

Applicant agrees to these stipulations as the basis for the community support of this application and acknowledges that all of these stipulations are essential prerequisites to the MCB4 recommendation regarding this application. Applicant agrees to have these stipulations incorporated in the method of operation of its liquor license. The stipulations in this application constitute the entire agreement between MCB4 and applicant and may only be altered in writing signed by MCB4 and applicant. These stipulations supersede any oral statements or representations in connection with this application.

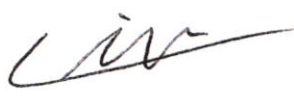
<p>SIGN HERE →</p>	<p>Lim, Hun Sup</p> <p>PRINT NAME OF APPLICANT</p>	 <p>SIGNATURE OF APPLICANT</p>	<p>11/21/2021</p> <p>DATE</p>
---------------------------	--	---	-------------------------------

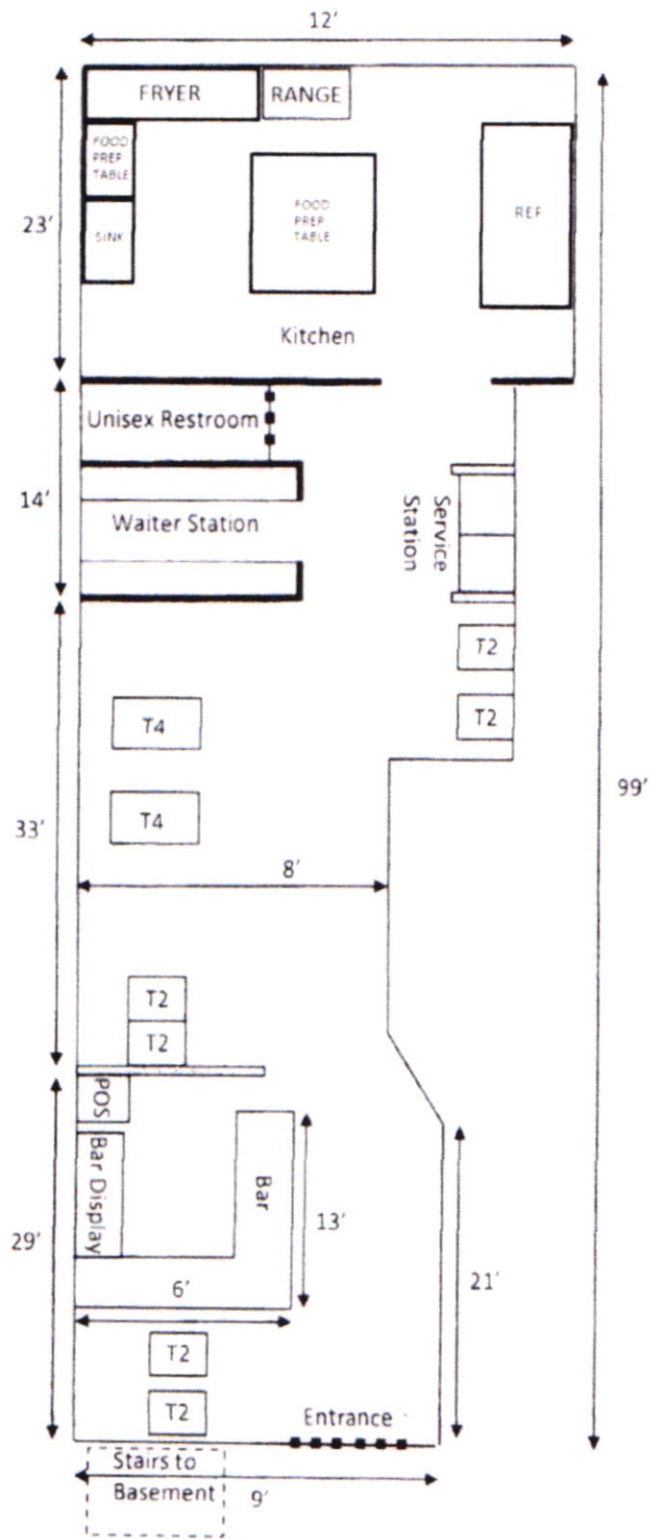

FIRST FLOOR DIAGRAM

PELICANA HK INC
 641 10TH AVE SOUTH STORE
 NEW YORK, NY 10036



gotham 13 Best Fried Chicken Sandwiches In NYC

Grilled Chicken Sandwich (Chicken Breast)

- 1. Original Grilled Chicken Sandwich \$7.99
- 2. Pelicana Signature Grilled Chicken Sandwich \$7.99
- 3. Teriyaki Grilled Chicken Sandwich \$8.99

Fried Chicken Sandwich (Chicken Thigh)

- 1. Original Fried Chicken Sandwich \$8.99
Served with lettuce and spicy ranch sauce
- 2. Pelicana Signature Fried Chicken Sandwich \$9.99
Served with lettuce and choice of any pelicana sauce

- Add Cheese \$1.00
- Add French Fries \$4.99
- Add Truffle Fries \$5.99
- Add Cajun Fries \$5.99
- Add Onion Rings \$4.99
- Add Sweet Potato Fries \$5.99
- Add White Snowing Fries \$6.99
- Add Yellow Snowing Fries \$6.99

Tteok Bok Ki

- 1. Yup Gi Tteok Bok Ki \$14.99
Served with rice cake, fishcake, sausage, cabbage, scallion, and mozzarella cheese in Yupdduk special spicy sauce
- 2. Jja Jang Tteok Bok Ki \$14.99
Served with rice cake, fishcake, sausage, cabbage, scallion in special black bean sauce

- Extra cheese \$2 / cabbage \$2 / sausage \$2 / fishcakes \$2
- Add Seafood \$4.99
- Add Beef Brisket \$5.99
- Add Assorted Fishcakes \$3.99
- Add Ramen Noodle \$2.99
- Add Glass Noodle \$2.99

We deliver fresh, new oil to our customers every day

Pelicana Special For 1

(Lunch Only) 1-4pm

Boneless Chicken +

- 1. Rice + Salad \$11.99
- 2. French Fries + Salad \$12.99
- 3. Onion Rings + Salad \$13.99
- 4. Sweet Potato Fries + Salad \$13.99
- 5. Truffle Fries + Salad \$14.99
- 6. Yellow Snowing Fries + Salad \$14.99
- 7. White Snowing Fries + Salad \$14.99
- 8. Cajun Fries + Salad \$13.99



WHAT'S "CHIMAC"?



Chimac (Korean: 치맥) is a compound word formed from Chicken and Mackju, the Korean word for "beer". It refers to a combination of chicken as anju (bar food) and beer served around evening in many South Korean restaurants.



- Flushing NY
- Palisades Park NJ
- E. 8th St. NY
- Sunnyside NY
- Bayside NY
- Astoria NY
- Brooklyn NY
- W 45th St. NY
- W 32nd St. NY
- Annandale, VA
- Philadelphia PA
- Dumont NJ
- Bronx NY Coming Soon

www.PelicanaUSA.com

We ONLY use PREMIUM chicken

UBER EATS GRUBHUB CAVIAR
DOORDASH POSTMATES

"FRESHLY FRIED FOR EVERY ORDER!"
IT'S WORTH THE WAIT!

We don't add MSG



Pelicana
Premium Chicken

DON'T BE A CHICKEN & CALL!
TEL: 917.388.2675

641 10th Ave
New York NY 10036

"KOREA'S BEST FRIED CHICKEN SINCE 1982."

SHARE YOUR EXPERIENCE WITH US!
@PELICANACHICKENNYC



Proximity Report for Location:

February 14, 2020

641 10 Ave, New York, NY, 10036

* This report is for informational purposes only in aid of identifying establishments potentially subject to 500 and 200 foot rules. Distances are approximated using industry standard GIS techniques and do not reflect actual distances between points of entry. The NYS Liquor Authority makes no representation as to the accuracy of the information and disclaims any liability for errors.

Closest Liquor Stores

Name	Address	Approx. Distance
GRACE WINE & SPIRITS INC	610 10TH AVENUE	405 ft
VERITAS STUDIOS INC	527 W 45TH ST	410 ft
WEST 42 WINE & SPIRITS INC	507 W 42ND ST	845 ft
NINTH AVENUE VINTNER LTD	669 671 9TH AVENUE	940 ft
ADRIATIC WINE & LIQUOR LLC	714 10TH AVENUE	960 ft
GRAND CRU WINE & SPIRITS INC	560 11TH AVE	1025 ft
706 9TH AVE LIQUORS INC	706 9TH AVE	1270 ft

Churches within 500 Feet

Name	Approx. Distance
------	------------------

Schools within 500 Feet

Name	Address	Approx. Distance
PS/IS 51 ELIAS HOWE SCHOOL	520 W 45TH ST	395 ft

On-Premise Licenses within 750 Feet

Name	Address	Approx. Distance
HELLS CHICKEN NYC CORP	641 10TH AVE	0 ft
KIABACCA REST CORP	639 10TH AVE	50 ft
HELL'S CHICKEN LLC	641 10TH AVE	60 ft
SHEBA ETHIOPIAN RESTAURANT INC	650 10TH AVENUE	90 ft
SD HOSPITALITY CORP	637 10TH AVENUE	95 ft
WMW REST II LLC	644 10TH AVE	115 ft
WMW RESTAURANT GROUP LLC	628 10TH AVE	215 ft
10TH AVENUE GROUP INC	626 10TH AVE	245 ft
HELL'S KITCHEN CREAM & SUGAR INC	626A 10TH AVENUE, STORE C	250 ft
PRIVE GROUP CONSULTING LLC, THE	626 10TH AVE STORE C	280 ft
PRIVE HOSPITALITY GROUP LLC	626 10TH AVE	280 ft
667 TENTH AVENUE CORP	667 10TH AVE	315 ft
KIWIS HISTORICAL BUILDING LTD	626B 10TH AVENUE	335 ft
TULCINGO RESTAURANT INC	665 10TH AVE	360 ft
TOR RESTAURANT LLC	607 10TH AVE	400 ft
ANEJO LLC	668 10TH AVE	430 ft
PIO PIO OCHO INC	604 10TH AVE	495 ft

nylicense@gmail.com

From: nylicense@gmail.com
Sent: Monday, January 18, 2021 12:00 PM
To: rjbenfatto@hyhkalliance.org; pgouris@hyhkalliance.org; kathleentreat123@gmail.com; mcgee79@aol.com; 'Christine Berthet'; info@clintonhousing.org; jrestuccia2@clintonhousing.org; rmarcano@clintonhousing.org; eduardozeiger@compuserve.com; mpta@mptenants.com; ashleyll@aol.com; twocatsltd@worldnet.att.net; Rudi_Papiri@timemagazine.com; 'Tango Tanner'; west45ba@gmail.com; 'Chana'; 'West 45 St Block Association 1 (8/9)'; stephenfanto@gmail.com; info@west46streetblockassociation.org; andrewbegg@yahoo.com; AllisonTupper@verizon.net; hudson62747@hotmail.com; aefearshk@earthlink.net; 'Larry Roberts'; jamesbogues@gmail.com; mariagnys@aol.com; ecelnik@actorsfund.org; rpimentel@commonground.org; dsage@commonground.org; nkyriacou@yahoo.com; gdclay@att.net; john.mudd@usa.net; info@hcc-nyc.org; ploeb315@aol.com; 'West 55th Street Block Association'; 'West 50th/51st Street Block Association'; tenants350west51st@gmail.com; rrlarios@hotmail.com; acernitz@gmail.com; awm3333@me.com; jessbondy@aol.com; john.waldman@redcross.org; juliacampanelli@gmail.com
Cc: 'Gonzalez, Nelly'
Subject: On-premises liquor license application: Pelicana HK Inc. - 641 10th Avenue

Dear Sir/Madam,

This office represents the above subject applicant with their On-premises license application for the above subject premises. As required by the Manhattan Community Board No.4, I, on their behalf, am notifying you of their intent to file said restaurant wine license application with the New York State Liquor Authority. The community board was already notified on Jan 14, 2021.

I'd like to request all follow up communication to our office as follows:

Jae Yu
38-25 150th Street
Flushing, NY 11354
Telephone (718) 445-5050
Fax (718) 445-4195
E mail: nylicense@gmail.com

Please feel free to contact our office should you have any questions.

Sincerely,

Jae Yu

New York Business Consulting, Co.

Tel: (718) 445 - 3560; Fax: (718) 445 - 4195

38-25 150th Street Flushing, NY 11354

OPEN



**NO FACE MASK
NO SERVICE**

**RESTROOMS
RESERVED FOR
CUSTOMERS ONLY**



LOWELL A. KERN
Chair

JESSE BLOOM
District Manager

CITY OF NEW YORK
MANHATTAN COMMUNITY BOARD, No. 4
P.O. Box 2622 New York, NY 10108
Tel. 212-736-1536
<https://cbmanhattan4.nyc.gov/network.html>

PUBLIC NOTICE

Business Licenses and Permits Committee
will discuss an application submitted by

Pelicana HK Inc.
641 10th Avenue

A New Liquor, Wine, Beer & Cider License for a
Restaurant Establishment with Recorded Music

DATE: Tuesday, February 9, 2021
TIME: 6:30 PM
PLACE: **Video/Phone Conference Registration:**
https://zoom.us/webinar/register/WN_66-6SX3vS_6HVC2bBstV3A

We invite you to attend this meeting and learn more about this application.
Alternately, you may email your comments by 2 p.m. Friday, February 5th, 2021
or for more information, please email Assistant District Manager Nelly Gonzalez
nelgonzalez@cb.nyc.gov.

Posted according to the Administrative Code of the City of New York section 10-119. Please do not remove until after the above meeting date.