

Manhattan Community Board 4

(All Fields Must Be Completed)

Liquor License/Sidewalk Cafe Stipulations Application

CORPORATION NAME		DOING BUSINESS AS (DBA)	
KISSAKI HY, LLC		KISSAKI	
STREET ADDRESS		CROSS STREETS	ZIP CODE
20 HUDSON YARDS - RU 220		10TH AVENUE 2ND WEST 30TH STREET	10001
OWNER <small>(Attach a list of all the people that will be associated/listed with the license)</small>	NAME: Igor Kanfer	ATTORNEY/ REPRESENTAIVE	NAME: Thomas McCallen
	PHONE: 347-782-6833		PHONE: 212.732.3640
	EMAIL: garry@explorekissaki.com		EMAIL: sla@carrerasmccallen.com
MANAGER	NAME: Dan MacPherson	LANDLORD	NAME: Related COMPANIES
	PHONE: 201-638-6695		PHONE: (212) 320-9660
	EMAIL: dan@explorekissaki.com		EMAIL: Nbeesemer@related.com
APPLICATION TYPE (<input checked="" type="checkbox"/> Liquor License <input type="checkbox"/> Unenclosed Sidewalk Cafe)			
<input checked="" type="radio"/> New	Has applicant owned or managed a similar business?	<input checked="" type="checkbox"/> YES	<input type="checkbox"/> NO
	What is/was the name and address of establishment?	Kissaki UWS 286 Columbus Ave, NYC Kissaki Omakase 319 Bowery, NYC KISSAKI LLC 670 MONTAUK HWY, WATER MILL, NY	
	What were the dates applicant was involved with this former premise?	Still active	
<input type="radio"/> Corp Change/Class Change/Removal	What is the license # and expiration date?		
	Is applicant making any alterations or operational changes?	<input type="checkbox"/> YES	<input type="checkbox"/> NO
	If alterations or operational changes are being made, please describe/list all changes.		
<input type="radio"/> Alteration	What is the current license # and expiration date?		
	Please list/describe the nature of all the changes and attach the plans:		
METHOD OF OPERATION			
TYPE OF ALCOHOL	<input checked="" type="radio"/> Liquor/Wine/Beer & Cider <input type="radio"/> Beer & Cider <input type="radio"/> Wine/Beer & Cider		
ESTABLISHMENT TYPE	<input checked="" type="radio"/> Restaurant <input type="radio"/> Cabaret <input type="radio"/> Night Club <input type="radio"/> Hotel <input type="radio"/> Bar/Tavern <input type="radio"/> Catering Establishment <input type="radio"/> Adult Entertainment <input type="radio"/> Wine Bar <input type="radio"/> Dance Club <input type="radio"/> Sports Bar <input type="radio"/> Club (Fraternal Organization – Members Only)		
Has applicant/owner filed with the SLA? If yes, when? If no, when do you plan to file?	<input checked="" type="checkbox"/> YES	<input type="checkbox"/> NO	APPLICATION PROCESS COMMENCED WITH 30-DAY LOCAL MUNICIPALITY NOTICE 12/20
Is the 500 Foot Rule applicable? If yes, please attach a diagram of the On-Premise liquor license establishments within a 500 ft. radius of your establishment and the Public Interest Statement.	<input checked="" type="checkbox"/> YES	<input type="checkbox"/> NO	
Is the 200 Foot Rule applicable? If yes, please attach a diagram of the schools and houses of worship that trigger the rule.	<input type="checkbox"/> YES	<input checked="" type="checkbox"/> NO	
Has applicant/owner(s) read MCB4 Policy Regarding Concentration and Location of Alcoholic-Serving Establishments?	<input checked="" type="checkbox"/> YES	<input type="checkbox"/> NO	

OPERATIONAL DETAILS (*Closing time will be when establishment is vacated of all patrons)

HOURS* <i>(Indoor Only)</i>		MONDAY	TUESDAY	WEDNESDAY	THURSDAY	FRIDAY	SATURDAY	SUNDAY
	Operation	11AM-12AM	11AM-12AM	11AM-12AM	11AM-12AM	11AM-12AM	11AM-12AM	11AM-12AM
	Kitchen	11AM-12AM	11AM-12AM	11AM-12AM	11AM-12AM	11AM-12AM	11AM-12AM	11AM-12AM
	Music	11AM-12AM	11AM-12AM	11AM-12AM	11AM-12AM	11AM-12AM	11AM-12AM	11AM-12AM

If you plan to have music, what type(s)?
(Circle all that apply)

<input checked="" type="checkbox"/> BACKGROUND	<input type="checkbox"/> LIVE MUSIC	<input type="checkbox"/> DJ	<input type="checkbox"/> JUKE BOX	<input type="checkbox"/> KARAOKE
--	-------------------------------------	-----------------------------	-----------------------------------	----------------------------------

OCCUPANCY

	Capacity (Certificate of Occupancy)	Maximum # of Persons Occupying Premises (Including Employees)	Number of Tables	Number of Seats	Number of Service Only Bars	Number of Stand-Up Bars	Number of Seats at Stand-Up Bar
INSIDE	70	60	10	50	0	POINT OF SALE	TBD
OUTSIDE <i>(Other than sidewalk café)</i>	0	0	0	0	0	0	0
DCA APPROVED UNENCLOSED SIDEWALK CAFÉ	NOT	/	APPLICABLE				

How many floors are there? What is the capacity for each floor?	1FL 70	
How frequently will the owner(s) be at the establishment?	4-5 Days a week	
Will there be dancing?	YES <input type="checkbox"/>	NO <input checked="" type="checkbox"/>
Will applicant have bottle or table service for beverage alcohol?	YES <input checked="" type="checkbox"/>	NO <input type="checkbox"/>
Will applicant be hosting private; promotional or corporate events?	YES <input type="checkbox"/>	NO <input checked="" type="checkbox"/>
Will outside promoters be used on a regular basis? If yes please describe.	YES <input type="checkbox"/>	NO <input checked="" type="checkbox"/>
Will applicant have a security plan? If, yes please attach.	YES <input checked="" type="checkbox"/>	NO <input type="checkbox"/> ATTACHED
Will security plan be implemented?	YES <input type="checkbox"/>	NO <input type="checkbox"/> NOT APPLICABLE
Will State certified security personnel be used?	YES <input type="checkbox"/>	NO <input type="checkbox"/> NOT APPLICABLE
Will New York Nightlife Association and NYPD Best Practices be followed?	YES <input type="checkbox"/>	NO <input type="checkbox"/> NOT APPLICABLE
Does applicant agree to notify MCB4 prior to making changes to its method of operation?	YES <input checked="" type="checkbox"/>	NO <input type="checkbox"/>
Will applicant be using delivery bicycles? If yes, how many?	YES <input type="checkbox"/>	NO <input checked="" type="checkbox"/>
Will delivery bicycles be clearly marked with the name of the restaurant and will staff wear attire clearly noting name as described by NYC Law?	YES <input type="checkbox"/>	NO <input type="checkbox"/> NOT APPLICABLE
Where will delivery bicycles be stored during the day when not in use?	N/A	

LOCATION & ZONING			
Is this a Special District? If yes, is it Clinton, West Chelsea or Hudson Yards?	<input checked="" type="checkbox"/> YES	<input type="checkbox"/> NO	Hudson Yards
Does the building have a Certificate of Occupancy ("C of O") or a letter of no objection?	<input type="checkbox"/> YES	<input type="checkbox"/> NO	TEMPORARY ONLY
Is a Public Assembly permit required?	<input type="checkbox"/> YES	<input checked="" type="checkbox"/> NO	
Are your plans filed with DOB?	<input checked="" type="checkbox"/> YES	<input type="checkbox"/> NO	

Community Notification/Relations			
NOTIFICATION: List all block associations; tenant associations, co-op boards or condo boards of residential buildings; and community groups that applicant has notified regarding its application. For each please list both the organization and individual you contacted	# 1	SEE ATTACHED	
	# 2		
	# 3		
	# 4		
	# 5		
Please provide dates when applicant met with the groups listed above.	NOT APPLICABLE		
Who was your contact person at each group you met with?	NOT APPLICABLE		
When did applicant post the notice that was provided?	JANUARY 4, 2021		
Where did applicant post the notice that was provided?	YES		
Will applicant provide owner cell phone number to neighbors and respond to complaints that arise? Please provide number in space provided.	<input checked="" type="checkbox"/> YES	<input type="checkbox"/> NO	IGOR KANFER 347 782-6833
Will applicant inform the Community Board office of its job openings and/or provide a hyperlink to applicants jobs webpage?	<input type="checkbox"/> YES	<input type="checkbox"/> NO	TO BE DETERMINED

BUILDING DESIGN			
State the name and type of business previously located in the space.	"The Drug Store" Restaurant & Juices		
Has a liquor-licensed establishment previously occupied this space at any time? If yes, please provide the name of the business.	YES	<input checked="" type="checkbox"/> NO	
Do you plan any changes to the existing façade? If yes, please describe.	YES	<input checked="" type="checkbox"/> NO	
Has the applicant/owner(s) read MCB 4 ADA Guidelines Memo?	<input checked="" type="checkbox"/> YES	NO	
Is the entrance ADA Compliant?	<input checked="" type="checkbox"/> YES	NO	
Do you plan any changes to the existing façade? If yes, please describe.	YES	<input checked="" type="checkbox"/> NO	
Will applicant have a vestibule within the establishment?	YES	<input checked="" type="checkbox"/> NO	
Will applicant use a storm enclosure?	YES	<input checked="" type="checkbox"/> NO	
Does applicant agree to keep the sidewalk clear of all items or obstructions, such as sandwich boards, sidewalk signs, freestanding menus and plants, as per the law?	<input checked="" type="checkbox"/> YES	NO	
Will applicant comply with the NYC noise code?	<input checked="" type="checkbox"/> YES	NO	
Will the establishment have any of the following: (circle all that apply)	FRENCH DOORS	GARAGE DOORS	WINDOWS THAT CAN BE OPENED
Will applicant close all windows, French doors, garage doors when any music or amplified sound (including televisions) is played inside the establishment?	<input checked="" type="checkbox"/> YES	NO	
Will applicant close all windows, French doors, garage doors by 11 PM Friday and Saturday and 10 PM on all other days even if no music or amplified sound is played inside the establishment?	<input checked="" type="checkbox"/> YES	NO	
Has applicant obtained an acoustical report from a certified sound engineer to assess potential noise disturbance to the neighboring residents and buildings?	YES	NO	Not APPLICABLE
Will applicant follow the recommendations of a certified sound engineer to mitigate potential noise disturbance to the neighboring residents and buildings, including placing speakers on the floor of the establishment?	YES	NO	NOT APPLICABLE
Will the kitchen exhaust system extend to the roof?	YES	<input checked="" type="checkbox"/> NO	No Exhaust. Sushi Concept
Will the establishment have an illuminated sign?	YES	<input checked="" type="checkbox"/> NO	
Will the establishment have a canopy extending over the sidewalk?	YES	<input checked="" type="checkbox"/> NO	
Where will the air conditioner be located? What type is it?	Mechanical Room		
When was the air conditioner installed?	During 20 Hudson Yards Build Out		

OUTDOOR ITEMS - OTHER THAN SIDEWALK CAFÉ

Has the applicant/owner(s) read MCB 4 Rear Yard Rooftop Policy?	YES	NO	NOT APPLICABLE
Will applicant use any outdoor spaces: rooftop, rear yard, patio, porch, balcony, pavilion, tents, deck, gazebo or open dining in the parking lane? If yes, which one(s)?	YES	NO	NOT APPLICABLE
Are the floorplans for the outdoor space(s) included?	YES	NO	NOT APPLICABLE
Will applicant close and vacate the outdoor space(s) by 11PM on Friday & Saturday and 10 PM on all other days?	YES	NO	NOT APPLICABLE
Will the service and consumption of alcohol in any outdoor space only be via seated food service?	YES	NO	NOT APPLICABLE
Will applicant not allow standing space for patrons to drink or smoke in any outdoor space(s) or on the sidewalk?	YES	NO	NOT APPLICABLE
Will there be no amplified music, as per the law?	YES	NO	NOT APPLICABLE
If amplified sound is played inside the establishment, will windows and doors be closed?	YES	NO	NOT APPLICABLE
Will applicant agree to post signs outside asking customers to respect the neighbors'?	YES	NO	NOT APPLICABLE
Will applicant agree to train staff to encourage a peaceful environment?	YES	NO	NOT APPLICABLE
Will applicant provide effective sound control (landscaping enclosure, soundproofing tenants apartments)	YES	NO	NOT APPLICABLE
Will there be a lighting plan that allows safe usage of the outdoor space without disrupting neighbors?	YES	NO	NOT APPLICABLE
If open dining in the parking lane, will applicant agree to leave the sidewalk free of any furniture?	YES	NO	NOT APPLICABLE
If open dining, will you comply with all NYC DOT guidelines?	YES	NO	NOT APPLICABLE
If open dining, will the installation be year-round?	YES	NO	NOT APPLICABLE

DCA APPROVED UNENCLOSED SIDEWALK CAFÉ

Has the applicant/owner(s) read MCB4 Sidewalk Café Policy?	<input checked="" type="checkbox"/> YES	<input type="checkbox"/> NO	
Will applicant be applying for a sidewalk café now or in the future?	YES	NO	NOT APPLICABLE
Is applicant in this application seeking to include a sidewalk café in its liquor license?	YES	NO	NOT APPLICABLE
If yes, has applicant submitted an application and plans to NYC Dept. of Consumer Affairs? Please attach application and plans.	YES	NO	NOT APPLICABLE
Will applicant close and vacate the sidewalk café by 11 PM on Friday & Saturday and 10 PM on all other days?	YES	NO	NOT APPLICABLE
Will applicant be serving alcohol in the sidewalk café? If so, will you have waiter service?	YES	NO	NOT APPLICABLE
Will the café have a 3 ft. wide serving aisle running the entire length of the sidewalk café?	YES	NO	NOT APPLICABLE
Will applicant mark the perimeter of the café on the sidewalk?	YES	NO	NOT APPLICABLE
Will the service and consumption of alcohol in the sidewalk café only be via seated food service?	YES	NO	NOT APPLICABLE
Will the sidewalk café not provide standing space for drinking or smoking?	YES	NO	NOT APPLICABLE
Will applicant use any portable natural gas heaters? If so, do you have the requisite approvals from DOB & the Fire Department?	YES	NO	NOT APPLICABLE
Will applicant have a lighting plan that will allow safe usage of the outdoor space without disrupting neighbors?	YES	NO	NOT APPLICABLE
Will all furniture, plants and barricades be stored inside between the evening closing hours and the morning opening hours?	YES	NO	NOT APPLICABLE
Will all furniture be stored inside between December 21 st and March 21 st , and any other day when it rains or snows?	YES	NO	NOT APPLICABLE
Will applicant use umbrellas?	YES	NO	NOT APPLICABLE
If construction or construction protection has reduced the sidewalk width, will applicant always maintain an 8 foot clear path of sidewalk between the perimeter of the café and the closest obstruction including construction barricades?	YES	NO	NOT APPLICABLE
If open dining is in the parking lane, will applicant agree to remove its sidewalk café?	YES	NO	NOT APPLICABLE

ADDITIONAL STIPULATIONS: (Office Use Only)

BLANK

To the extent any additional stipulation on pages 7 and 8 of this application conflicts with any response on pages 1 – 6 of this application, the stipulations on pages 7 and 8 control.



BLANK

To the extent any additional stipulation on pages 7 and 8 of this application conflicts with any response on pages 1 – 6 of this application, the stipulations on pages 7 and 8 control.

Manhattan Community Board 4 (MCB4) recommends:
 (MCB4's recommendation is based on a vote taken at its
 February 3, 2021 full board meeting, with 41 members voting in favor
 of the recommendation, 0 members opposed, 0 members
 abstaining and 0 present but not eligible)

Denial unless all stipulations agreed to by applicant/owner are part of the method of
 operation
 Denial Approval

CB4 REPRESENTATIVES

 Nelly Gonzalez CB4 Assistant District Manager	 Frank Holozubiec CB4 BLP Committee Co-Chair	 Burt Lazarin CB4 BLP Committee Co-Chair
---	---	---

APPLICANT AGREEMENT WITH THE COMMUNITY

Applicant agrees to these stipulations as the basis for the community support of this application and acknowledges that all of these stipulations are essential prerequisites to the MCB4 recommendation regarding this application. Applicant agrees to have these stipulations incorporated in the method of operation of its liquor license. The stipulations in this application constitute the entire agreement between MCB4 and applicant and may only be altered in writing signed by MCB4 and applicant. These stipulations supersede any oral statements or representations in connection with this application.

<p>SIGN HERE →</p>	<p>Igor Kanfer</p> <p>PRINT NAME OF APPLICANT</p>	 <p>SIGNATURE OF APPLICANT</p>	<p>1/3/2021</p> <p>DATE</p>
---------------------------	---	---	-----------------------------

Kissaki HY LLC
20 Hudson Yards
New York, NY 10001

Manhattan Community Board 4
500' Foot Public Interest Statement

The Applicant's principals have significant experience in the food industry with active alcoholic beverage licenses obtained from the NY State Liquor Authority.

The Applicant will operate a sushi style restaurant in the new Hudson Yards. Applicant's business model is founded on "freshness" and "premium quality" having seafood imported directly from Japan markets with no middleman so that savings may be passed-on to its patrons. This model is unlike any other local sushi restaurant making it unique in the food industry.

The Applicant's Co-Principals will manage the establishment, hire competent and local employees whenever practical to ensure that excellent customer service and food quality is maintained during all hours of operation. Applicant's establishment will feature recorded music, without dancing, third-party promoters or security personnel.

The Applicant's location is convenient to local pedestrian traffic, has access to parking for motor vehicles with two (2) commercial parking lots situated a within several blocks of the proposed premises and is convenient to mass transportation with New York's Penn Station a short distance away providing access to the area from NYC Transit Subway Service, Metropolitan Transportation Railways and New Jersey Transit systems so that it's operation will not increase traffic in the neighborhood.

As a consequence of the above, the Applicant's *Method of Operation* promotes convenience, advantage and the public's interest will be served in that local and other patrons or tourists will be able to enjoy alcoholic beverages and mixed cocktails in a comfortable setting serving popular sushi cuisine.

The names of all on-premises liquor establishments within 500' Feet of the proposed premises, as determined by the NYSLA Lamp database are attached hereto.

Kissaki HY LLC
20 Hudson Yards
New York, NY 10001

Manhattan Community Board 4
Security Plan

Applicant's management will instruct and train its employees to perform the following:

- a) check identification of all patrons to ensure that persons served are legal age;
- b) observe the establishment for impaired or unruly persons*; and
- c) secure the confinement of alcoholic beverages to the licensed premises.

*The premises Manager will be notified in the unlikely event that a patron is deemed impaired or unruly.

If such conduct continues local law enforcement will be contacted.

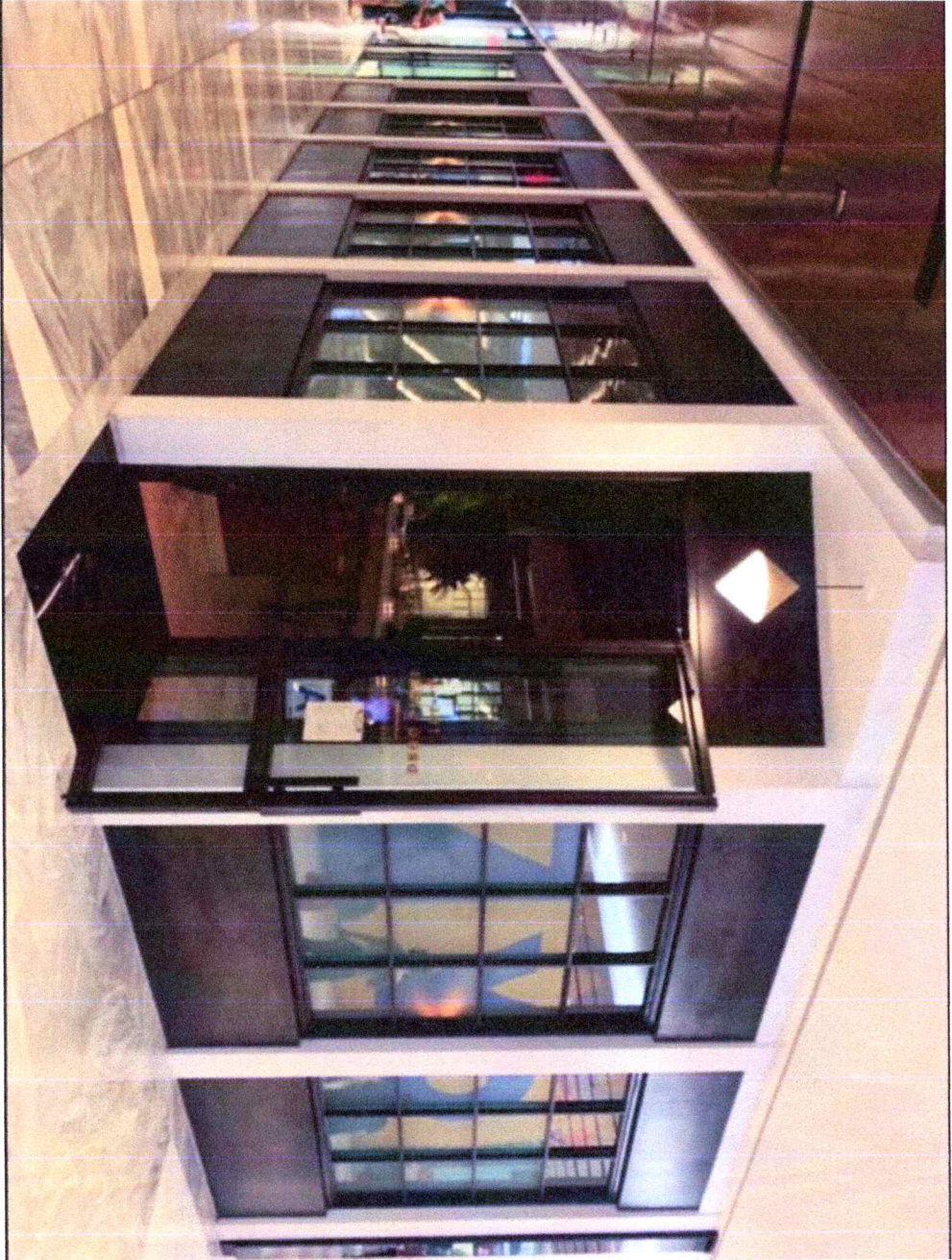

KISSAKI HY LLC
- EXTERIOR -
(ENTRANCE)



KISSAKI HY LLC
— Interior —
(DINING & BAR)

KISSKI HY LLC
 500' FOOT DISTANCE
 (PROXIMITY REPORT - SEE ATTACHED)

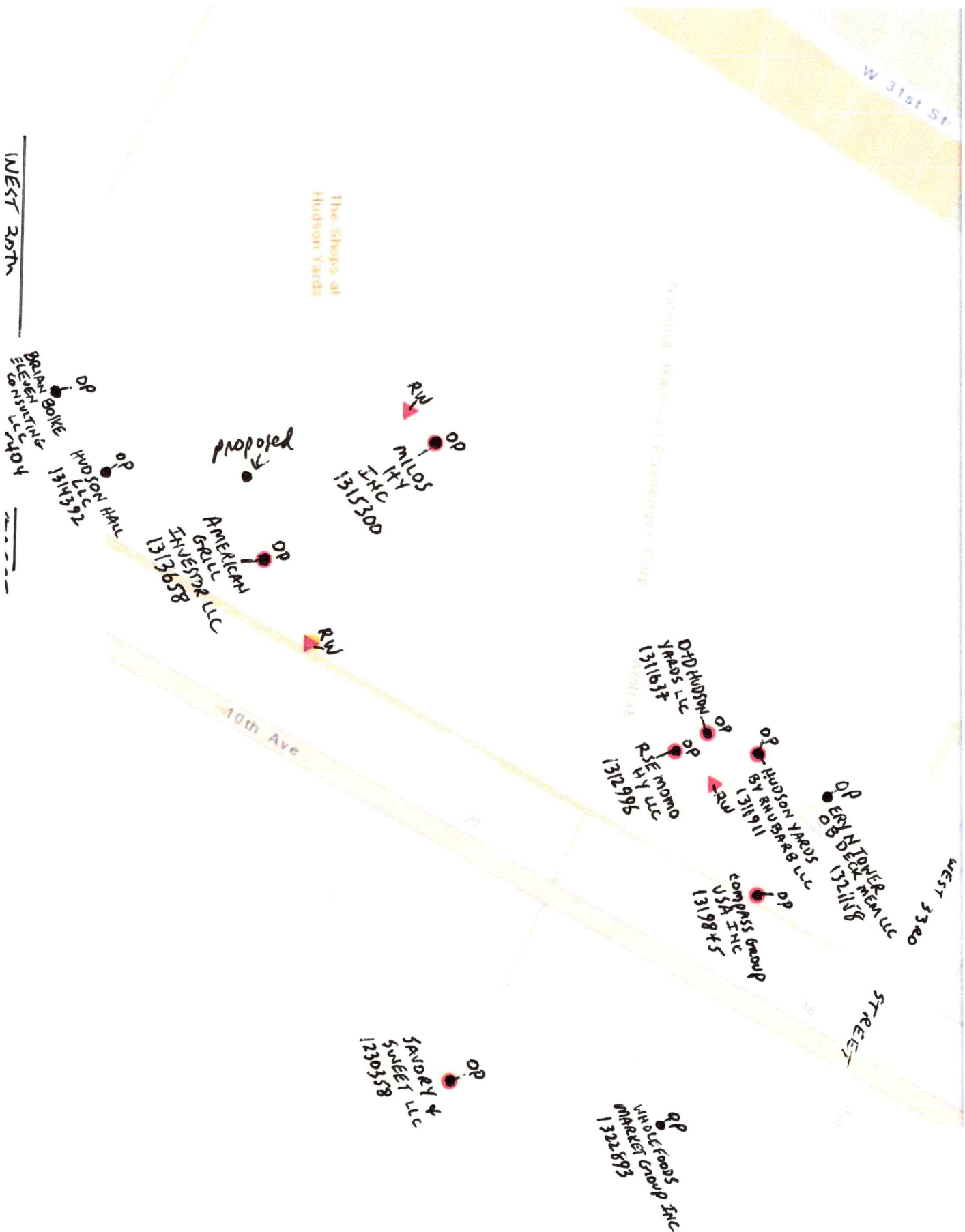

Proximity Report for Location:

January 4, 2021

20 Hudson Yards, New York, NY, 10001

* This report is for informational purposes only in aid of identifying establishments potentially subject to 500 and 200 foot rules. Distances are approximated using industry standard GIS techniques and do not reflect actual distances between points of entry. The NYS Liquor Authority makes no representation as to the accuracy of the information and disclaims any liability for errors.

Closest Liquor Stores

Name	Address	Approx. Distance
ALJ WINE AND LIQUOR INC	198 N WELLWOOD AVE	690 ft
ERIN DONAHUE	111 115 W HOFFMAN AVENUE	915 ft
BROTHERS WINE & SPIRITS INC	186 188 MONTAUK HWY	4590 ft
88 FORTUNE LIQUOR INC	498 MONTAUK HWY	4950 ft
J & M WINES AND LIQUORS INC	84A E SUNRISE HWY	4950 ft
WINE OBSESSION INC	469 PARK AVE	0 ft
CA & MJ CONCEPTS INC	648 N WELLWOOD AVE	0 ft
ALJ WINE AND LIQUOR INC	198 N WELLWOOD AVE	660 ft
ERIN DONAHUE	111 115 W HOFFMAN AVENUE	860 ft
BROTHERS WINE & SPIRITS INC	186 188 MONTAUK HWY	4650 ft
J & M WINES AND LIQUORS INC	84A E SUNRISE HWY	4900 ft
88 FORTUNE LIQUOR INC	498 MONTAUK HWY	4950 ft
WINE OBSESSION INC	469 PARK AVE	0 ft
CA & MJ CONCEPTS INC	648 N WELLWOOD AVE	0 ft
DAWN LIQUORS INC	933 2ND AVE	55 ft
764 3RD AVE LIQUORS INC	805 3RD AVE	590 ft
U N LIQUORS INC	885 FIRST AVENUE	810 ft
939 FIRST AVE LIQUORS INC	945 1ST AVE	1005 ft
855 WINE AND LIQUOR INC	855 2ND AVE	1010 ft
YOU AND ME WINES & LIQUORS INC	1020 2ND AVENUE	1105 ft
500 LEXINGTON AVE WINE & LIQUOR INC	500 LEXINGTON AVE	1320 ft
CITARELLA HUDSON WINES & SPIRITS LLC	20 HUDSON YARDS	375 ft
MEENA SAMANI CORPORATION	460 W 34TH ST	585 ft
ADB&SAB LLC	554 W 30TH ST	725 ft
MWC RETAIL LLC	606 W 28TH ST SUITE A	1400 ft
ODYSSEY WINE & SPIRITS INC	490 10TH AVE	1570 ft
AMSTERWINE.COM INC	475 9TH AVE	1620 ft
KSS WINE LLC	509 W 38TH ST	1730 ft

Churches within 500 Feet

Name	Approx. Distance
------	------------------

Schools within 500 Feet

Name	Address	Approx. Distance
------	---------	------------------

On-Premise Licenses within 750 Feet

Name	Address	Approx. Distance
AMERICAN GRILL INVESTOR LLC	20 HUDSON YARDS	50 ft
MILOS HY INC	20 HUDSON YARDS	125 ft
RSE MOMO HY LLC	500 W 33RD ST	200 ft
D & D HUDSON YARDS LLC	500 W 33RD ST	215 ft
HUDSON YARDS BY RHUBARB LLC	500 W 33RD ST	245 ft
SAVORY & SWEET LLC	404 10TH AVE AKA 450 W 33RD ST	245 ft
COMPASS GROUP USA INC	30 HUDSON YARDS	270 ft
ERY N TOWER OB DECK MEM LLC OB DECK TEN LLC & SKY	30 HUDSON YARD	270 ft
HUDSON HALL LLC & MERCADO INVESTOR LLC AS MANAGER	10 HUDSON YARDS	290 ft
BRIAN BOLKE ELEVEN CONSULTING LLC	20 HUDSON YARDS	345 ft
WHOLE FOODS MARKET GROUP INC & JAJAJA HUDSON YARDS	450 W 33RD ST	465 ft
EQUINOX HUDSON YARDS F&B LLC & BC HUDSON YARDS LLC	560 W 33RD ST	590 ft
WS NEW YORK TAVERN LLC & RH WINE MANAGEMENT LLC	560 W 33RD ST	590 ft
WHITMANS WESTSIDE LLC	500 W 30TH ST	605 ft
ROCKY'S BAR & RESTAURANT INC	460 W 34TH ST	605 ft
SHED NYC INC & 545 WEST 30TH STREET F&B MGMT LLC	545 W 30TH ST	680 ft
34 ENDEAVOR HOSPITALITY LLC	461 W 34TH ST	705 ft
HIGHLINE GROUP NYC LLC	525 W 29TH ST	735 ft

Pending Licenses within 750 Feet

Name	Address	Approx. Distance
MIZNON AT HUDSON YARDS LLC	20 HUDSON YARDS	0 ft
RESTAURANT ASSOIATES LLC	30 HUDSON YARDS 24TH FL	270 ft
AMERICAN GRILL INVESTOR LLC	20 HUDSON YARDS	275 ft
BREAKAWAY CYCLING LLC	10 HUDSON YARDS	290 ft
CITIZENS MANHATTAN WEST LLC	450 W 33RD ST	465 ft
435 WEST 31ST STREET B LLC	435 W 31ST ST	560 ft
435 WEST 31ST STREET A LLC	435 W 31ST ST	560 ft

Unmapped licenses within zipcode of report location

Name	Address
VIRGIN HOTELS NEW YORK LLC & LG BROADWAY MGMT INC	1205 1227 BROADWAY
PRIMO COFFEE INC	PENN STATION
PANMELLITO INC	PENN STATION
DENTELLE LLC	121 123 W 26TH ST

KISSAKI HY LLC
LEVEL 2 - Floor PLAN

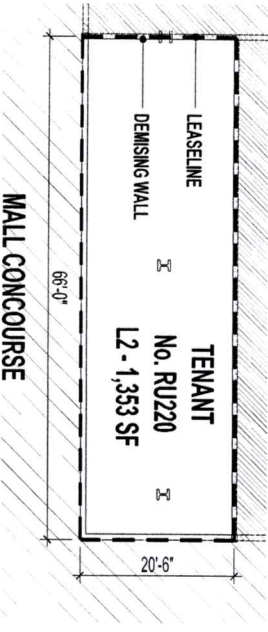

LEVEL 2 FLOOR PLAN

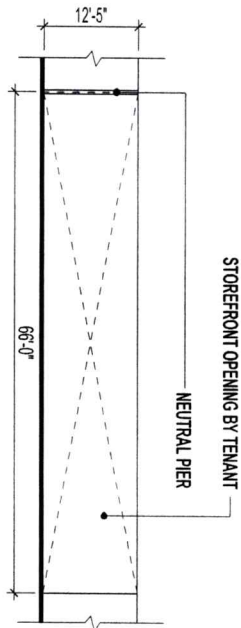

LEVEL 2 ELEVATION

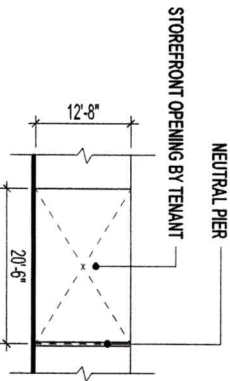

LEVEL 2 ELEVATION

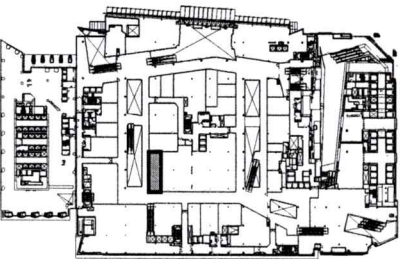

LEVEL 2 KEY PLAN N.T.S.

SPACE LAYOUT DIAGRAM

DATE: APRIL 02 2018
SPACE #: RU220
TENANT:
LEASE AREA: 1,353 SF

RELATED OXFORD

Rothschild DOWNES
RETAIL TENANT COORDINATION

S.I.D. GENERAL NOTES:

1. NEITHER THE LANDLORD NOR ITS AGENT'S SHALL BE RESPONSIBLE FOR ANY INFORMATION CONTAINED, AND ANY REPRESENTATION FOR ANY INFORMATION CONTAINED, IN THIS EXHIBIT. THE EXHIBIT IS FOR GENERAL INFORMATION AND APPROXIMATION ONLY.
2. TENANT'S REPRESENTATIVE, ARCHITECT, CONTRACTOR AND/OR ENGINEER SHALL VERIFY ALL CONDITIONS AND DIMENSIONS IN THE FIELD.
3. NO REPRESENTATION IS MADE WITH REGARD TO EXISTING CODE COMPLIANCE.
4. IT IS THE SOLE RESPONSIBILITY OF THE TENANT TO FIELD VERIFY ALL CONDITIONS, DIMENSIONS, DOORS, STOREFRONTS, DEMISING WALLS, FIRE RATED ASSEMBLIES AND OTHER BUILDING COMPONENTS.
5. LOCATION OF ALL BUILDING COMPONENTS IS DIAGRAMMATIC, FIELD VERIFY.
6. THIS EXHIBIT IS DIAGRAMMATIC. IT IS INTENDED ONLY FOR THE PURPOSE OF INDICATING THE LOCATION OF THE DEMISED PREMISES WITHIN THE PROJECT. IT DOES NOT INTEND TO SHOW THE EXACT OR APPROXIMATE LOCATION OF THE EXHIBIT. THE EXHIBIT IS FOR ARCHITECTURAL, STRUCTURAL, MECHANICAL, OR OTHER ELECTRICAL OR PLUMBING BUILDING ELEMENTS. FIELD VERIFY ALL CONDITIONS AND DIMENSIONS.
7. THE WIDTH OF A TENANT SPACE IS DERIVED FROM THE CENTERLINE OF SHARED DEMISING WALLS TO CENTERLINE OF SHARED DEMISING WALL, ROOMS, STAIRS, SHAFTS, OR EXTERIOR WALL.
8. THE DEPTH OF A TENANT SPACE IS DERIVED FROM THE LEASE LINE TO CENTERLINE OF SHARED DEMISING WALLS, OUTSIDE FACE OF COMMON BUILDING CORRIDORS, MECHANICAL ROOMS, STAIRS, SHAFTS, OR EXTERIOR WALL.
9. SOME EXISTING BUILDING ELEMENTS ARE NOT SHOWN.
10. KEY PLAN AND LOCATION PLANS ARE SCHEMATIC.
11. ALL DIMENSIONS AND CONDITIONS ARE APPROXIMATE AND SUBJECT TO FIELD VERIFICATION.

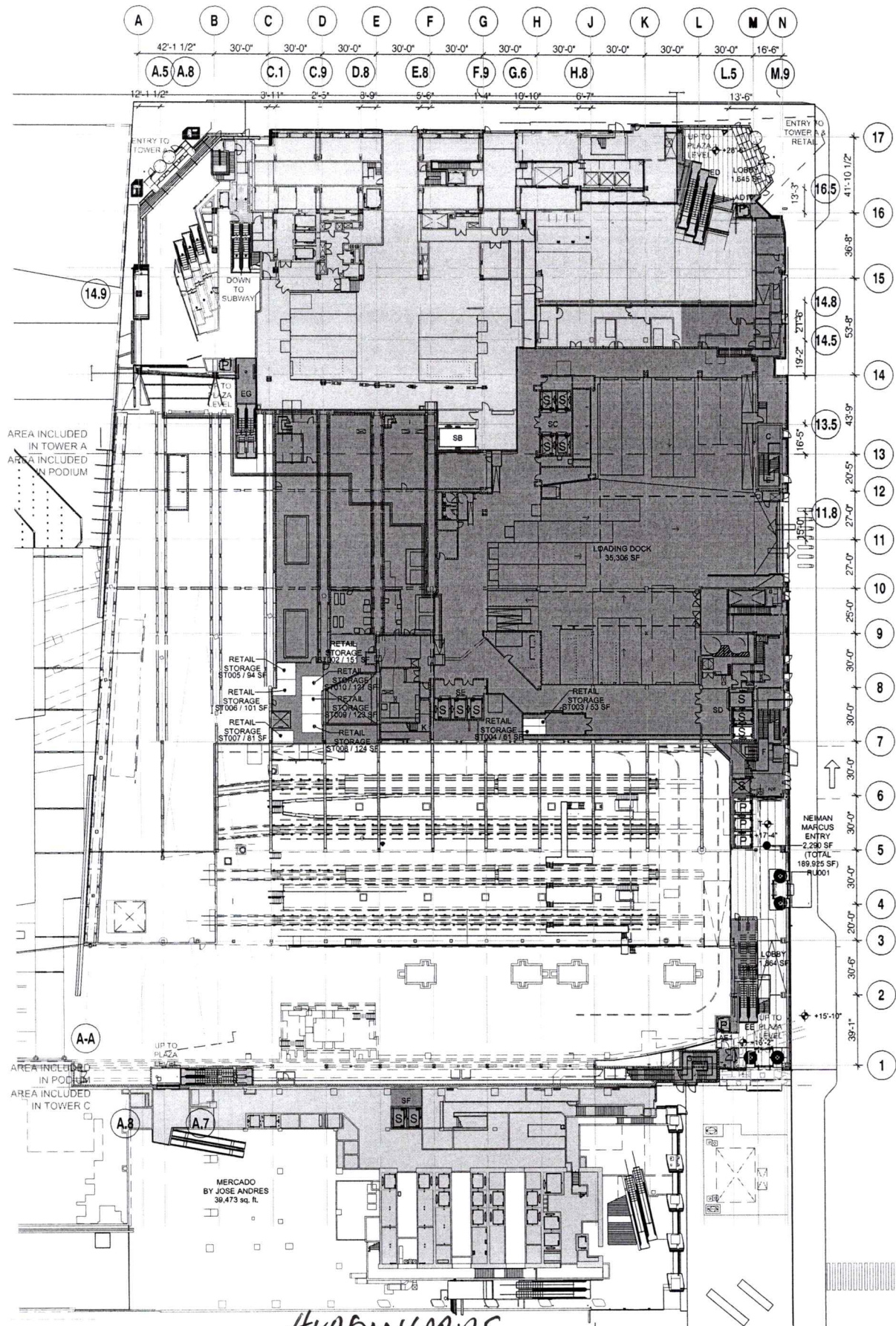

*Hudson Yards
Complex Diagrams*

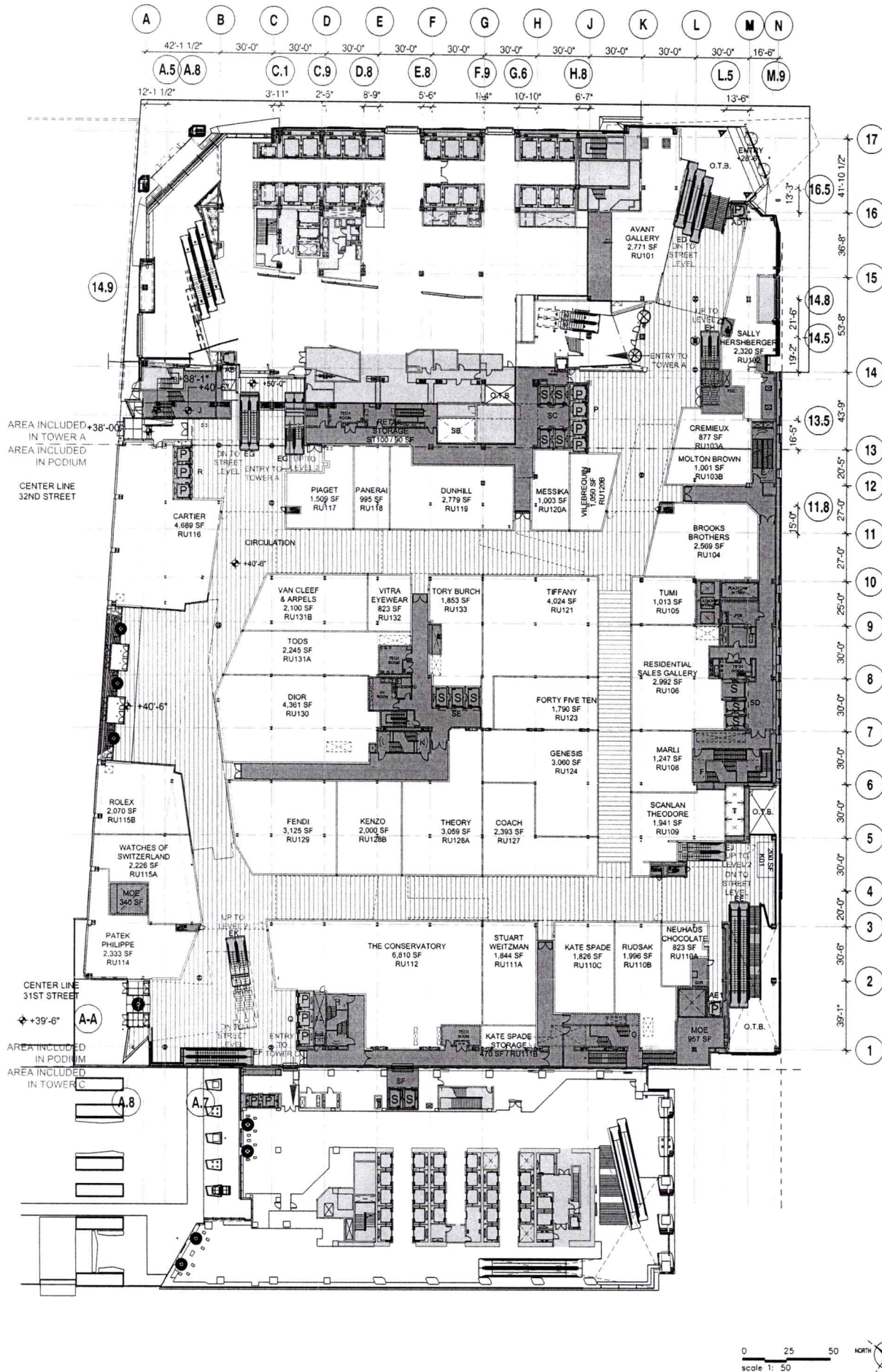

HUDSON YARDS
NEW YORK

PLAZA LEVEL LEASING PLAN
AUGUST 12, 2020
VERSION 129

RELATED

OXFORD



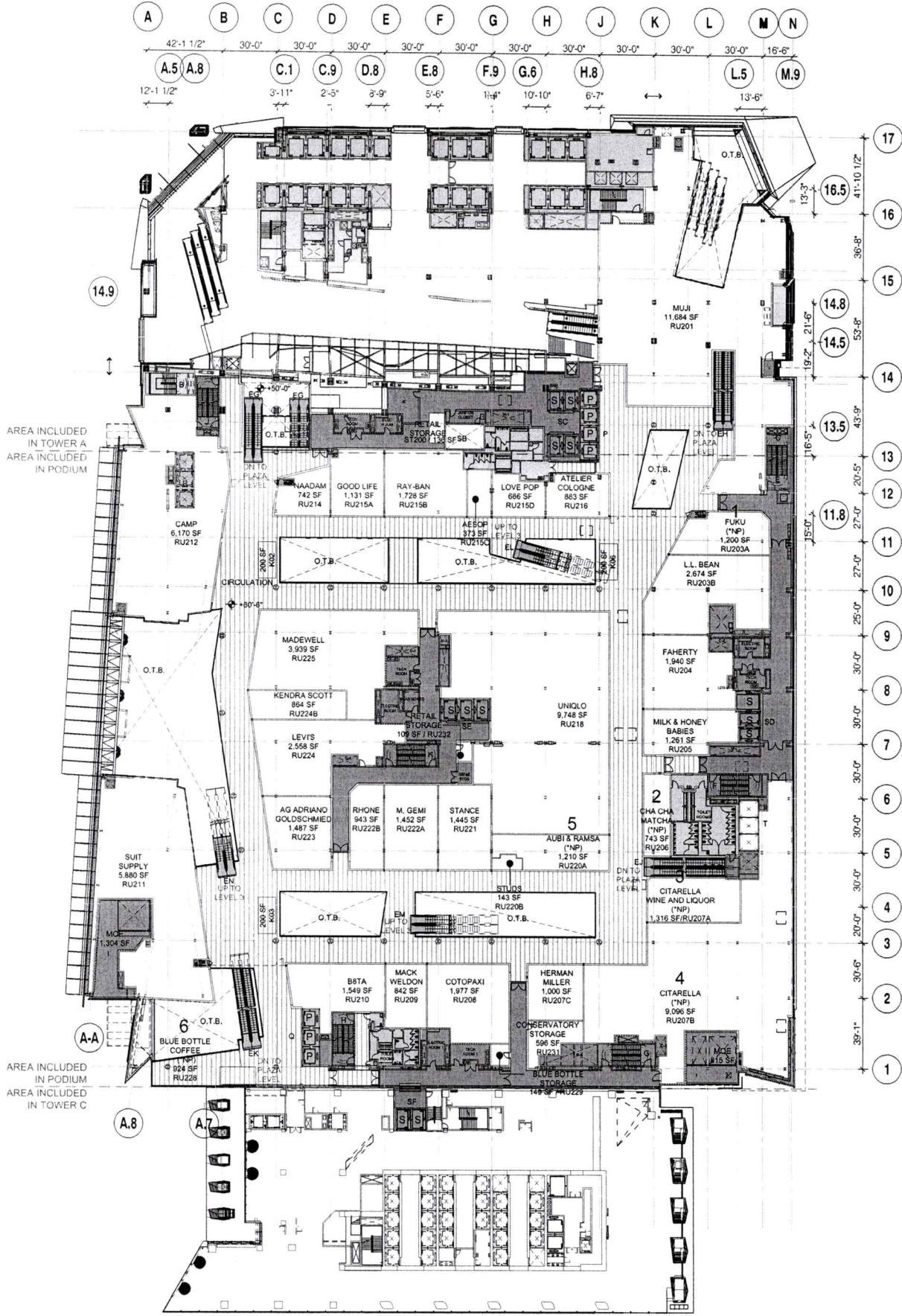

AREA INCLUDED
IN TOWER A
AREA INCLUDED
IN PODIUM

AREA INCLUDED
IN PODIUM
AREA INCLUDED
IN TOWER C



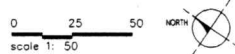

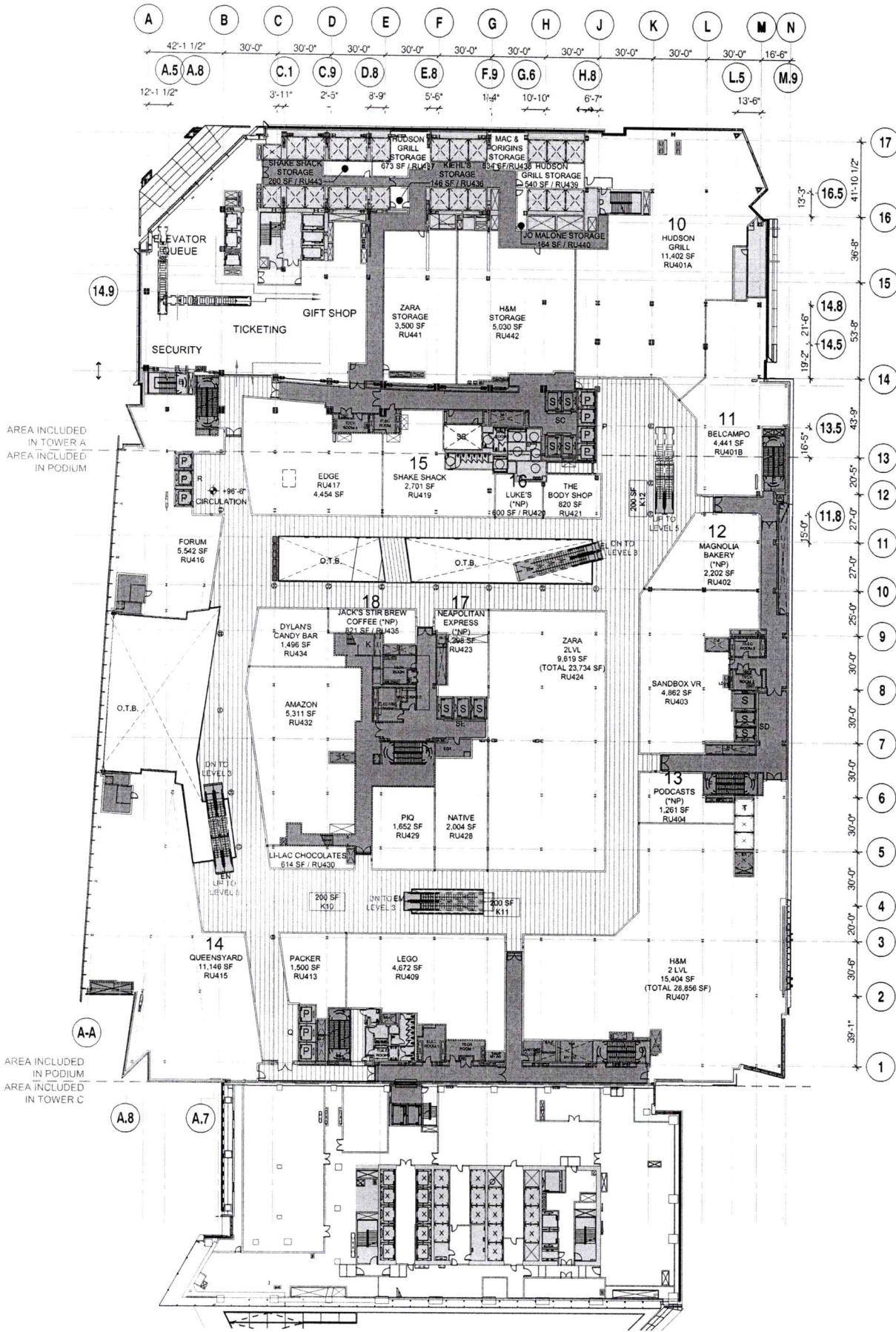

AREA INCLUDED
IN TOWER A
AREA INCLUDED
IN PODIUM

AREA INCLUDED
IN PODIUM
AREA INCLUDED
IN TOWER C

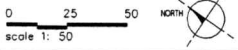

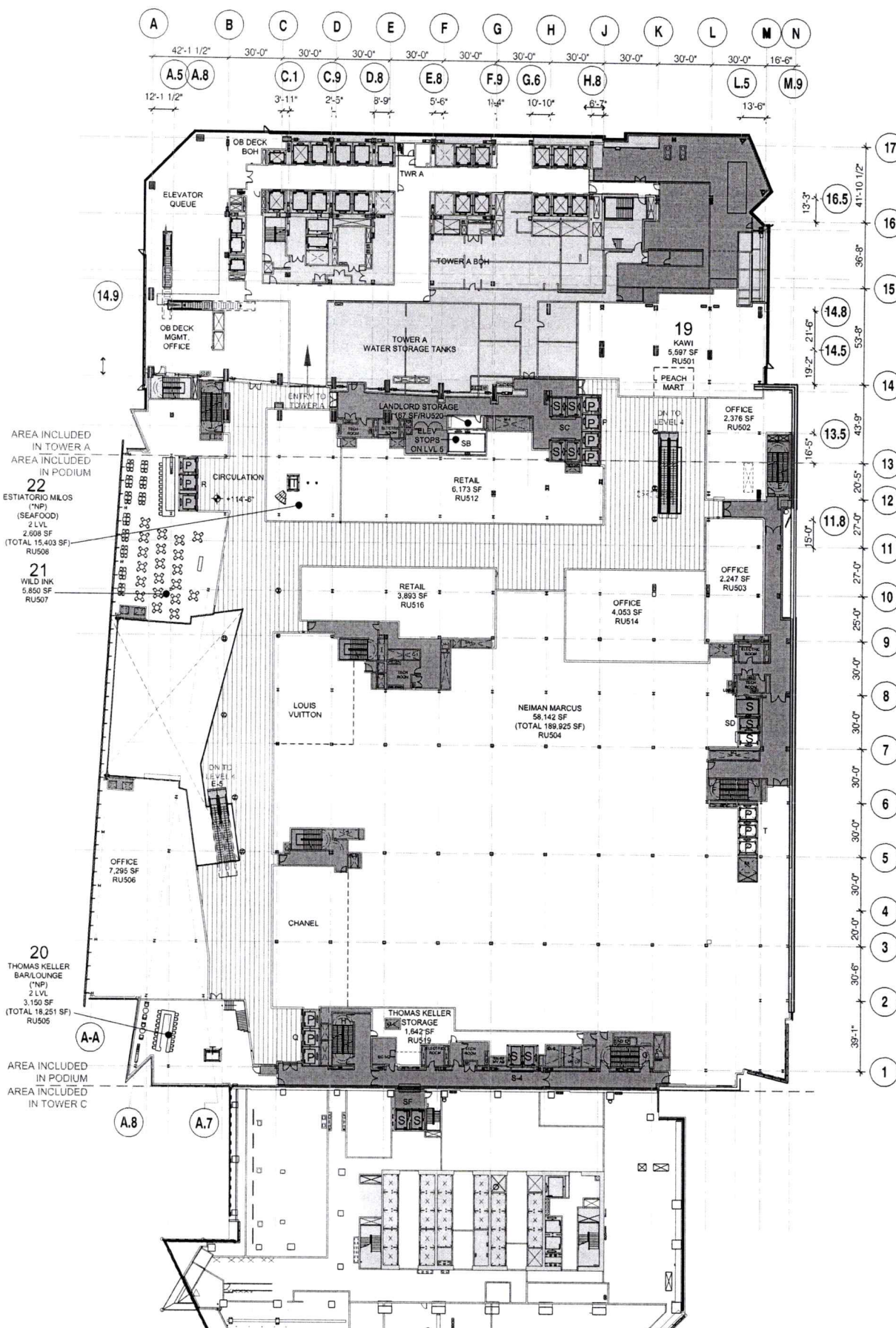

AREA INCLUDED IN TOWER A
AREA INCLUDED IN PODIUM

20 THOMAS KELLER BAR/LOUNGE (*NP) 2 LVL 3,150 SF (TOTAL 18,251 SF) RU505

AREA INCLUDED IN PODIUM
AREA INCLUDED IN TOWER C

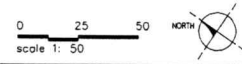

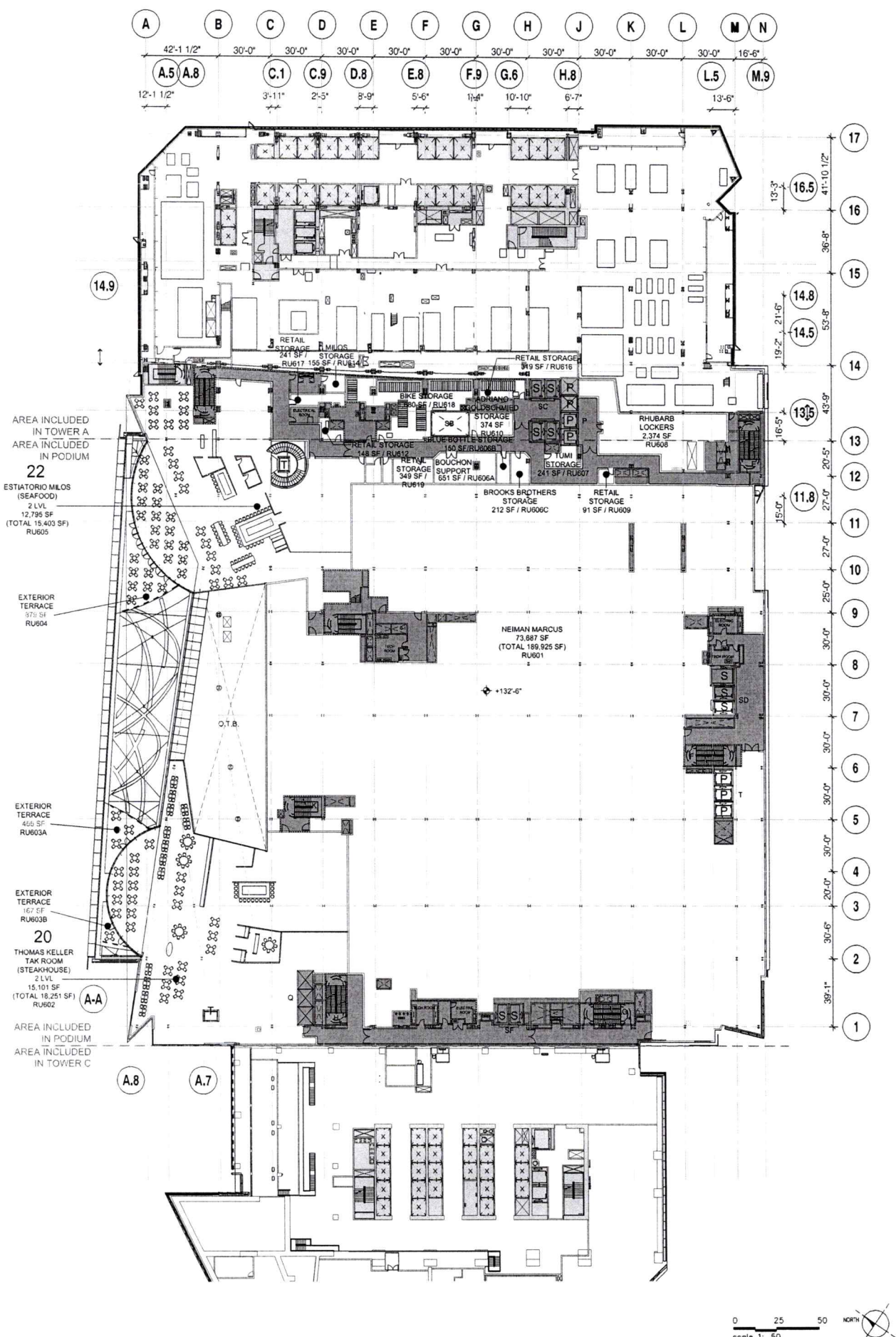

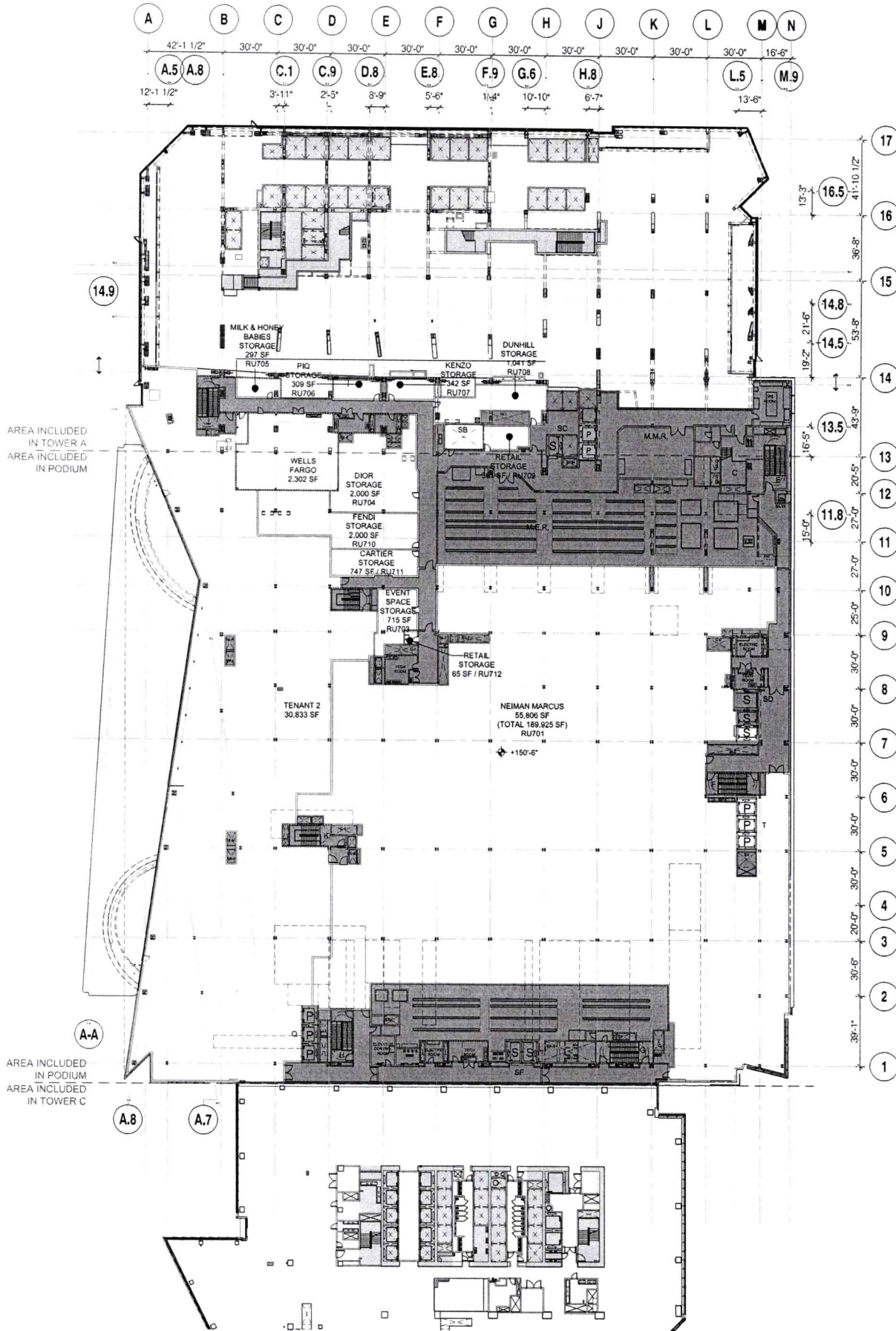

AREA INCLUDED IN TOWER A
AREA INCLUDED IN PODIUM

AREA INCLUDED IN PODIUM
AREA INCLUDED IN TOWER C

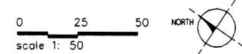

Классна АУ АС
Рубе номер 1087777
(01/04/2021)

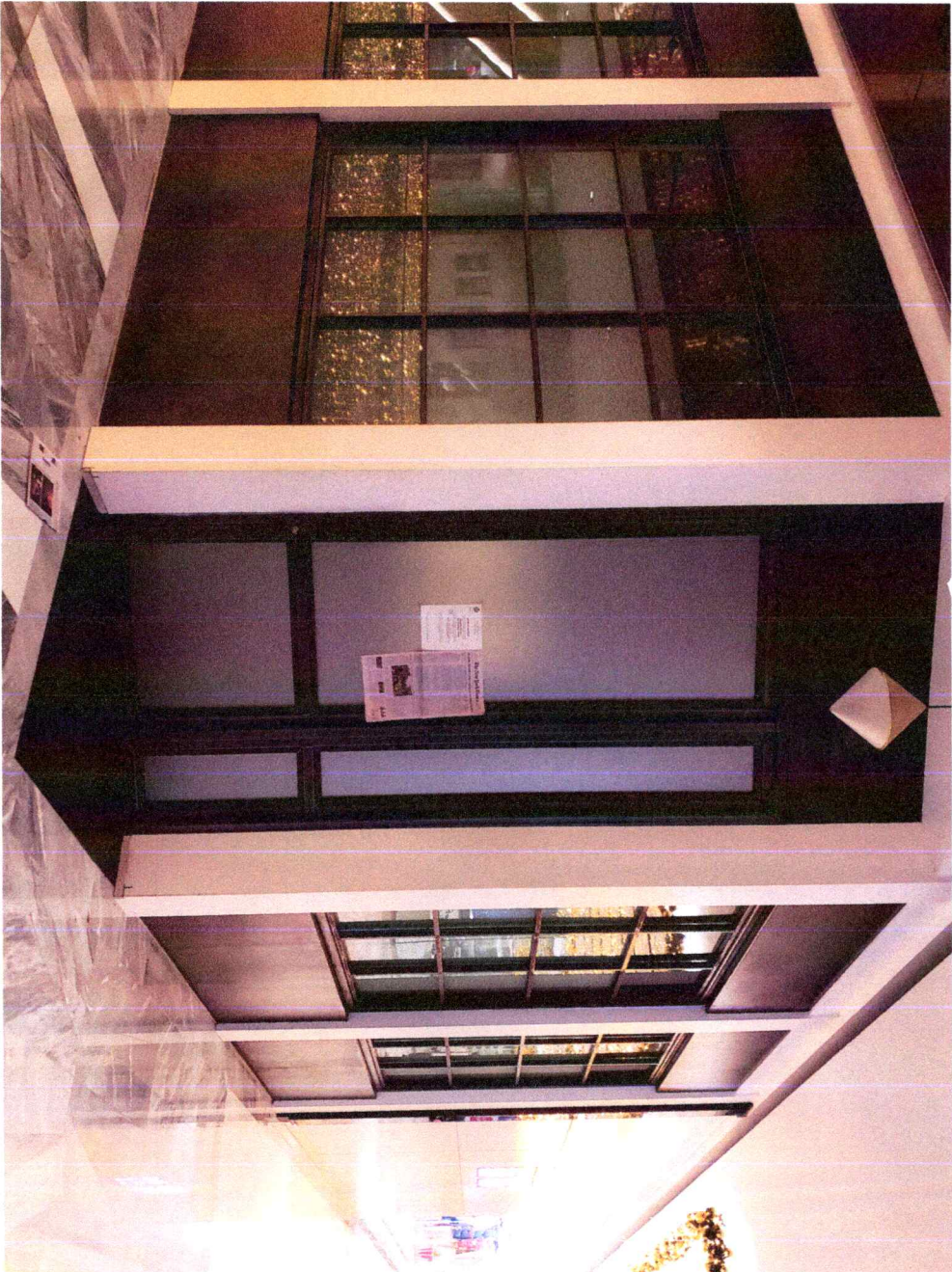

01/04/2021



LOWELL D. KERN
Chair
JESSE BODINE
District Manager

CITY OF NEW YORK
MANHATTAN COMMUNITY BOARD No. 4
P.O. Box 2622, New York, NY 10108
Tel: 212-736-4536
<https://cbmanhattan.cduofnewyork.us/cb4/>

PUBLIC NOTICE

Business Licenses and Permits Committee
will discuss an application submitted by

**Kissaki HY LLC.
20 Hudson Yards**

A New Liquor, Wine, Beer & Cider application for a
Restaurant Establishment with Recorded Music

DATE: Tuesday, January 12, 2021
TIME: 6:30 PM
PLACE: [Video/Phone Conference Registration:
https://zoom.us/join/66-6SX3vS6HVC2bBstV3A](https://zoom.us/join/66-6SX3vS6HVC2bBstV3A)

We invite you to attend this meeting and learn more about this application. Alternately, you may email your comments by 2 p.m. Friday, January 8, 2021 or for more information, please email Assistant District Manager Naily Gonzalez: negonzalez@cb.nyc.gov

Posted according to the Administrative Code of the City of New York section 10-119. Please do not remove until after the above meeting date.

"All the News
That's Fit to Print"

The New York

VOL. CLXX — No. 58,928 NEW YORK, MONDAY, JANUARY 4, 2021

ON TAPE, TRUMP PUSHES GEOR

Senate Runoffs Reflect Changes In Old Red State

From Audio Recording of President Trump's Phone Conversation With Georgia Secretary of State, Brad Raffensperger

WASHINGTON — We have won this election in Georgia based on all of this. And there's nothing wrong with saying that, you know, um, that you've recalcu-

lated. Well Mr. President, the challenge you have is the data you have is wrong.

You know what they did and you're not it. That's a criminal — that's a criminal offense you can't let that happen. That's a big risk to you and to Ryan, your lawyer. And that's a big risk look. All I want to do is this. I just want to find votes, which is one more than we have been won the state.

I watched you this morning and you so well, there was no criminality. But I mean stuff is very dangerous stuff. When you talk criminality, I think it's very dangerous for that.

Mr. President, you have people submit information and we have our that submit information. And then it before the court and the court then?

Why do you want that through? I mean, sure, we can play this game with but why do you say that?

Delay 2nd Doses? Give 2 Half-Doses? Vaccine Lag Fu

BY RAYMOND J. BELL
The Centers for Disease Control and Prevention on Monday said that people who have received one dose of the Pfizer-BioNTech COVID-19 vaccine should get a second dose as soon as possible, but that a second dose is not necessary if a person has not received a second dose by the end of the year.

WASHINGTON — The Centers for Disease Control and Prevention on Monday said that people who have received one dose of the Pfizer-BioNTech COVID-19 vaccine should get a second dose as soon as possible, but that a second dose is not necessary if a person has not received a second dose by the end of the year.

WASHINGTON — The Centers for Disease Control and Prevention on Monday said that people who have received one dose of the Pfizer-BioNTech COVID-19 vaccine should get a second dose as soon as possible, but that a second dose is not necessary if a person has not received a second dose by the end of the year.

WASHINGTON — The Centers for Disease Control and Prevention on Monday said that people who have received one dose of the Pfizer-BioNTech COVID-19 vaccine should get a second dose as soon as possible, but that a second dose is not necessary if a person has not received a second dose by the end of the year.

WASHINGTON — The Centers for Disease Control and Prevention on Monday said that people who have received one dose of the Pfizer-BioNTech COVID-19 vaccine should get a second dose as soon as possible, but that a second dose is not necessary if a person has not received a second dose by the end of the year.

WASHINGTON — The Centers for Disease Control and Prevention on Monday said that people who have received one dose of the Pfizer-BioNTech COVID-19 vaccine should get a second dose as soon as possible, but that a second dose is not necessary if a person has not received a second dose by the end of the year.

WASHINGTON — The Centers for Disease Control and Prevention on Monday said that people who have received one dose of the Pfizer-BioNTech COVID-19 vaccine should get a second dose as soon as possible, but that a second dose is not necessary if a person has not received a second dose by the end of the year.

WASHINGTON — The Centers for Disease Control and Prevention on Monday said that people who have received one dose of the Pfizer-BioNTech COVID-19 vaccine should get a second dose as soon as possible, but that a second dose is not necessary if a person has not received a second dose by the end of the year.

WASHINGTON — The Centers for Disease Control and Prevention on Monday said that people who have received one dose of the Pfizer-BioNTech COVID-19 vaccine should get a second dose as soon as possible, but that a second dose is not necessary if a person has not received a second dose by the end of the year.

WASHINGTON — The Centers for Disease Control and Prevention on Monday said that people who have received one dose of the Pfizer-BioNTech COVID-19 vaccine should get a second dose as soon as possible, but that a second dose is not necessary if a person has not received a second dose by the end of the year.

WASHINGTON — The Centers for Disease Control and Prevention on Monday said that people who have received one dose of the Pfizer-BioNTech COVID-19 vaccine should get a second dose as soon as possible, but that a second dose is not necessary if a person has not received a second dose by the end of the year.

WASHINGTON — The Centers for Disease Control and Prevention on Monday said that people who have received one dose of the Pfizer-BioNTech COVID-19 vaccine should get a second dose as soon as possible, but that a second dose is not necessary if a person has not received a second dose by the end of the year.

KISSAKI HY LLC
PUBLIC NOTICE NOTICE
(01/04/2021)

"All the News
That's Fit to Print"

The New York

VOL. CLXX . . . No. 58,928

© 2021 The New York Times Company

NEW YORK, MONDAY, JANUARY 4, 2021

ON TAPE, TRUMP PUSHES GEOR

Senate Runoffs
Reflect Changes
In Old Red State

From Audio Recording of President Trump's Phone Conversation
With Georgia's Secretary of State, Brad Raffensperger

PRESIDENT TRUMP We have won this election in Georgia
based on all of this. And there's nothing wrong w

KISSAN HY GC
PUNEK NANE RASNAK
101/04/2021



Thomas McCallen <sla@carrerasmccallen.com>

Re: Kissaki HY LLC - 20 Hudson Yards, New York, NY 10001 - Outreach for Proposed New SLA License - Confirmation

1 message

Thomas McCallen <sla@carrerasmccallen.com>
To: CB - Nelly Gonzalez <NeGonzalez@cb.nyc.gov>

Mon, Jan 4, 2021 at 5:14 PM

Manhattan Community Board 4
Nelly Gonzalez, Assistant District Manager

Good afternoon.

Attached please find copies of emails with a corresponding notice form and menu to "outreach" entities identified in your application submission packet.

A further submission will be made tomorrow concerning other requested items.

Thank you for your attention to this matter.

--

COVID-19 Remote Operations Information:

Carreras & McCallen PLLC
Telephone: 212.732.3640
eMail: sla@carrerasmccallen.com

 **KissakiHY.MCB4.Outreach.pdf**
5107K

Standardized NOTICE FORM for Providing 30-Day Advance Notice to a Local Municipality or Community Board

1. Date Notice was Sent: December 11, 2020

1a. Delivered by: email pursuant to current Covid-19 notice guidelines

2. Select the type of Application that will be filed with the Authority for an On-Premises Alcoholic Beverage License:

New Application Renewal Alteration Corporate Change Removal Class Change Method of Operation Change

For New applicants, answer each question below using all information known to date
For Renewal applicants, answer all questions
For Alteration applicants, attach a complete written description and diagrams depicting the proposed alteration(s)
For Corporate Change applicants, attach a list of the current and proposed corporate principals
For Removal applicants, attach a statement of your current and proposed addresses with the reason(s) for the relocation
For Class Change applicants, attach a statement detailing your current license type and your proposed license type
For Method of Operation Change applicants, although not required, if you choose to submit, attach an explanation detailing those changes

Please include all documents as noted above. Failure to do so may result in disapproval of the application.

This 30-Day Advance Notice is Being Provided to the Clerk of the Following Local Municipality or Community Board:

3. Name of Municipality or Community Board: Manhattan Community Board 4

Applicant/Licensee Information:

4. Licensee Serial Number (if applicable): TBD Expiration Date (if applicable): TBD

5. Applicant or Licensee Name: Kissaki HY LLC

6. Trade Name (if any): TBD

7. Street Address of Establishment: 20 Hudson Yards

8. City, Town or Village: New York, NY Zip Code: 10001

9. Business Telephone Number of Applicant/Licensee: Pending

10. Business E-mail of Applicant/Licensee: Pending

11. Type(s) of alcohol sold or to be sold: Beer & Cider Wine, Beer & Cider Liquor, Wine, Beer & Cider

12. Extent of Food Service:

Full food menu; full kitchen run by a chef or cook Menu meets legal minimum food availability requirements; food prep area at minimum

13. Type of Establishment: Restaurant (full kitchen and full menu required)

14. Method of Operation: (check all that apply)
Seasonal Establishment Juke Box Disc Jockey Recorded Music Karaoke
Live Music (give details i.e., rock bands, acoustic, jazz, etc.):
Patron Dancing Employee Dancing Exotic Dancing Topless Entertainment
Video/Arcade Games Third Party Promoters Security Personnel
Other (specify):

15. Licensed Outdoor Area: (check all that apply)
None Patio or Deck Rooftop Garden/Grounds Freestanding Covered Structure
Sidewalk Cafe Other (specify):

16. List the floor(s) of the building that the establishment is located on: **Second Floor**
17. List the room number(s) the establishment is located in within the building, if appropriate: **N/A**
18. Is the premises located within 500 feet of three or more on-premises liquor establishments? Yes No
19. Will the license holder or a manager be physically present within the establishment during all hours of operation? Yes No
20. If this is a transfer application (an existing licensed business is being purchased) provide the name and serial number of the licensee: **N/A**

Name

Serial Number

21. Does the applicant or licensee own the building in which the establishment is located? Yes (if YES, SKIP 23-26) No

Owner of the Building in Which the Licensed Establishment is Located

22. Building Owner's Full Name: **Related Companies**
23. Building Owner's Street Address: **60 Columbus Circle**
24. City, Town or Village: **New York** State: **NY** Zip Code: **10023**
25. Business Telephone Number of Building Owner: **212 421-5333**

Representative or Attorney Representing the Applicant in Connection with the Application for a License to Traffic in Alcohol at the Establishment Identified in this Notice

26. Representative/Attorney's Full Name: **Thomas J McCallen, Esq - Carreras & McCallen PLLC**
27. Representative/Attorney's Street Address: **11 Park Place, Suite 1210**
28. City, Town or Village: **New York** State: **NY** Zip Code: **10007**
29. Business Telephone Number of Representative/Attorney: **212 732-3640**
30. Business E-mail Address of Representative/Attorney: **sla@carrerasmccallen.com**

I am the applicant or licensee holder or a principal of the legal entity that holds or is applying for the license. Representations in this form are in conformity with representations made in submitted documents relied upon by the Authority when granting the license. I understand that representations made in this form will also be relied upon, and that false representations may result in disapproval of the application or revocation of the license.

By my signature, I affirm - under **Penalty of Perjury** - that the representations made in this form are true.

31. Printed Principal Name: **Igor Kanfer** Title: **LLC Managing Member**

Principal Signature: _____



KISSAKI HALL

Lunch Premium Omakase

8 Pieces Nigiri _____ \$64

Chef's hand roll, miso soup, edamame & dessert

Lunch Extended Omakase Extended

12 Pieces Nigiri _____ \$108

Chef's hand roll, miso soup, edamame & dessert

Our Menu

We serve lunches and dinners, letting you enjoy the best Japanese cuisine during your lunch-break or have an immersing culinary experience in the night hours.

Omakase

16 Course Omakase _____ \$160

3 appetizers, 12 course Nigiri & dessert

13 Course Omakase _____ \$130

3 appetizers, 9 course Nigiri & dessert

Flights

6 Piece Nigiri Flight _____ \$55

Chef's selection of 6 pieces of Nigiri

6 Piece Sashimi Flight _____ \$75

Chef's selection of 6 piece Sashimi (6 fish, two pieces each)

Nigiri

Kissaki Classics Inspired by Chef Mark
Served with chef's choice of toppings

Akama Nigiri _____ \$10

Lean bluefin tuna

Chutoro Nigiri _____ \$16

Medium fatty bluefin tuna

Otoro Nigiri _____ \$18

Extra fatty bluefin tuna belly

Sake Nigiri _____ \$8

Forre island salmon

Hamachi Nigiri _____ \$10

Yellowtail

Madai Nigiri _____ \$10

Japanese sea bream

Botan Ebi Nigiri _____ \$12

Spot prawn

Hotate Nigiri _____ \$12

Live local scallops

Uni Nigiri _____ \$16

Sea urchin

Ikura Nigiri _____ \$10

Marinated Salmon roe

Kasutera Tamago _____ \$5

Sweet egg omelette

Futomaki

Fat Rolled Sushi
cut traditionally into 5 pieces

The Classic _____ \$16

Dashi-maki tamago, kamayo, shitake, gomae, cucumber & avocado

*Add shrimp Tempura \$6

The Sandy _____ \$26

Otoro tartare, uni, ikura, kamayo, avocado, cucumber & rokkyo

Ebi-Hamachi _____ \$17

Yellowtail tartare, shrimp tempura, cucumber, avocado, cilantro & jalapeno

Sake-Cu _____ \$16

Salmon tartare, goma-de, cucumber, tolu & avocado

Maguro Mamma _____ \$17

Spicy tuna, sweet potato tempura, cucumber & avocado

Donburi

Sushi Rice Bowls

Kaisen-don _____ \$75

Seasonal sashimi over rice

Uni Sundae _____ \$65

Toro tartare, Uni & Black Kaluga Caviar over rice

Sake Zuke-don _____ \$45

Zuke Sake Sashimi, kura & shaved winter truffle over rice

Maki

Traditional 6 Piece Roll	
Tekka Maki	\$10
Lean bluefin tuna roll	
Spicy Tuna Maki	\$12
Lean tuna toriade, sesame seeds, rokkyo & chives	
Negitoro Maki	\$18
Fatty bluefin tuna toriade, sesame seeds, rokkyo & chives	
Spicy Negihama Maki	\$10
Yellowtail toriade, sesame seeds & chill oil	
Sake Maki	\$9
Salmon toriade, plum soy, sesame seed, rokkyo & chives	
Ume Shiso-Cu Maki	\$6
Plum paste, Japanese mint leaf (shiso) & cucumber	
Kampyo Maki	\$6
Japanese braised gourd	
Zuke Shiitake Maki	\$6
Soy braised shitake mushroom	
Asparagus Tempura Maki	\$6
Avocado Maki	\$8

Sides

Edamame	\$7
Miso Soup	\$8
Spicy Mayo	\$3
Sushi Rice	\$9
<small>We use a sourced, aged red vinegar specifically for Kissaki</small>	
Nori	\$4.50
<small>3 half sheets of Yekisushi/Nori</small>	

Beverages

Saratoga Still Water	\$8
Saratoga Sparkling Water	\$8
Coke	\$5
Diet Coke	\$5
Sprite	\$5
Canada Dry Ginger Ale	\$5

Desserts

Chiffon cakes by Taste Creme	
Matcha Red Bean	\$18
<small>Delicate chiffon cake with layers of sweetened red bean & matcha whipped cream</small>	
Blueberry Earl Grey	\$18
<small>Delicate chiffon cake with layers of earl grey infused whipped cream balanced with sweet blueberries</small>	
Dulce De Leche	\$18
<small>Our signature vanilla chiffon cake layered with dulce de leche whipped cream & topped with Biscoff cookie crumbles</small>	
Mango Coconut Sago	\$18
<small>Delicate chiffon cake with layers of tropical mango and coconut whipped cream textured with sago pearls & fresh mangoes</small>	



**Please inform us if you or anyone in your party has any dietary restrictions, allergies, or is pregnant. Our menus contain food allergens found in raw fish, shellfish, wheat, soy, dairy, peanuts, tree nuts, and eggs. Consuming raw, undercooked seafood, shellfish, or eggs may increase your risk of foodborne illness. Price does not include sales tax.

For Private Event & Catering inquiries,
please email us at
info@explorekissaki.com

explorekissaki.com
[@explorekissaki](https://www.instagram.com/explorekissaki)

K I S S A K I

Bubbles

glass/ bottle

PROSECCO

di Valdobbiadene
Maschio de Cavaleiri **\$16 \$60**

CHAMPAGNE

Taittinger à Peims Brut 375ml **\$70**

Taittinger Brut Prestige Posé 375ml **\$75**

Veuve Cliquot Brut Reserve **\$30 \$115**

Louis Roederer Cristal 2004 **\$600**

White Wine

glass/ bottle

Domaine Vincent Damp **\$15 \$55**

Petit Chablis 2019

Jacques Dumont **\$20 \$75**

Sancerre 2019

Kerner "Praelpositus" 2018 **\$100**

Abbazia di Novacella, Trentino - Alto Adige, Italy

Chablis La Forêt Premier Cru 2018 **\$120**

Chardonnay, Domaine Pinson Frères, Burgundy

Pouilly-Fuisse 2017 **\$140**

Chardonnay, Daniel & Julien Barraud, Mâconnais

Ashes & Diamonds Blanc 2016 **\$140**

Sauvignon Blanc-Semillon, Napa Valley

Red Wine

glass/ bottle

Marques de Riscal **\$17 \$65**

Rioja Reserva 2014

Domaine Saint Gayan **\$20 \$75**

Gigondas 2015

Domaine Besson Givry Rouge
le Haut Colombier **\$25 \$100**

Bourgogne 2018

Brunello di Montalcino 2015 **\$180**

Sangiovese, Argiano, Toscana

Hess Collection Cabernet Sauvignon 2016 **\$200**

Cabernet Sauvignon, Mount Veeder, Napa

Barolo D'agromis 2015 **\$250**

Nebbiolo, Gaja, Piemonte

Côte-Rôtie Seigneur de Maugiron 2017 **\$320**

Syrah, Delas, Côtes du Rhône

Pomerol 2015 **\$480**

Chateau Certan de May, Bordeaux

Beer

Asahi Super Dry **\$9**

Orion **\$9**

Hitachino White Ale **\$15**

Sapporo Reserve 22 oz **\$15**

Fchigo Rice Lager 16.9 oz **\$15**

B
E
V
E
R
A
G
E



MENU

KISSAKI

—
explorekissaki.com

Cocktails

\$18

Kissaki Kick

Suntory Toki, Junmai Sake, Lemon, Orgeat

Señor Sandía

Don Julio Tequila Blanco, Sparkling Sake, Watermelon, Agave, Basil, Lemon

Green Lantern

Suntory Toki, Lime, Shishito Pepper Syrup, Shiso, Club Soda

Lucky Fizu

Ketel One, Sparkling Sake, Pineapple, Lemon, Mint

Tokyo Daikiri

Banks 5 Rum, Apricot, Marigold Syrup, Lime

Ringo Sour

4 Roses Bourbon, Apple Butter, Amaro Nonino, Sage, Lemon, Egg White

Banané Manhattan

Rittenhouse Rye, Pedro Ximenez, Vermouth, Walnut Bitters, Crème de Banané

Rozumari

Ford's Gin, Rosemary, Lemon, Grapefruit, Club Soda

Winter on Fire (served hot)

Black Dirt Apple Jack, Cointreau, Plum wine, Cinnamon, Apple Cider

Tokushima Toddy (served hot)

Maker's Mark, Passionfruit, Yuzu, Sake, Apple Caramel, Ginger Beer

Sake

JUNMAI

glass/ bottle

Akitabare Koshiki Junzukurui
"Northern Skies" Akita

\$18 \$95

Tedorigawa Yamahai
"Silver Mountain" Ishikawa

\$18 \$95

Gokyo Nama Genshu
Yamaguchi

\$20 \$108

JUNMAI GINJO

glass/ bottle

Heaven Miyagi

\$20 \$108

Masumi Arabashiri Nama Nagano

\$20 \$108

Kokuryu "Black Dragon" Fukui

\$20 \$108

Narutotai Genshu
"Red Snapper" Tokushima

\$135

Tsukinokatsura Yanagi
"Willow Tree" Kyoto

\$135

DAIGINJO

glass/ bottle

Tedorigawa Iki Na Onna
"Lady Luck" Ishikawa

\$22 \$135

Seitoku "Prince of Peace" Gunma

\$165

Dewazakura Yukimanman
"Snow Country" Yamagata

\$285

Kachou Gesseki

"Morning Flower, Evening Moon" Akita

\$425

Nanbu Bijin 10 Year Koshu Iwate

\$985

JUNMAI DAIGINJO

glass/ bottle

Dassai 39

"The Otter Festival" Yamaguchi

\$18 \$95

Hakkaisan Clear Sparkling
"Awa" Niigata

\$22 \$135

Koshi No Kanbai Muku

"The Pure Realm" Niigata

\$22 \$135

Wakatake Onikoroshi

"Demon Slayer" Shizuoka

\$145

Yaegaki "Mu" Black Label Hyogo

\$145

Harushika "Spring Deer" Nara

\$165

Heaven Yamaguchi

\$195

Kimurashiki Kiseki "Miracle" Okyama

\$195

Maboroshi "Mystery" Hyogo

\$385

Chosetsu "The Sound of Snow" Akita

\$780

NIGORI GINJO

glass/ bottle

Kamoizumi "Summer Snow"
500ml Hiroshima

\$18 \$95

Dewazakura "Sarasara" Yamagata

\$18 \$95

DESSERT SAKE

Mito No Kairakuen 5 Year Aged
Plum Wine Ibaraki

2oz \$15

Hanahato Kijoshu Junmai
8 Year Aged Hiroshima

2oz \$15





Dan MacPherson <dan@explorekissaki.com>

Kissaki- Omakase Sushi @ 20 Hudson Yards

2 messages

Dan MacPherson <dan@explorekissaki.com>
To: wborock@hotmail.com

Mon, Jan 4, 2021 at 1:22 PM

Mr. Borock- Pleased to meet you by e-mail.

I am with Kissaki restaurant group based in NYC.

We have applied for a liquor license at 20 Hudson yards and wanted to let you know how excited we are to join the community.

We have restaurants in UWS and Bowery as well as a vendor stall at Jacx in Long Island City.

We strive to provide the community with freshly caught sushi grade fish served by a diverse and knowledgeable staff with a well curated cocktail and sake list that complement our menu but is not the real show... The sushi is!

Please reach out with any questions and look forward to meeting you at the restaurant!

Dan MacPherson
VP of Kissaki
dan@explorekissaki.com

Dan MacPherson <dan@explorekissaki.com>
To: wborock@hotmail.com

Mon, Jan 4, 2021 at 1:25 PM

Now with attachments :)
[Quoted text hidden]

3 attachments

 **Kissaki-Menu.pdf**
800K

 **Kissaki_B-Menu_BOW_v3_110420.pdf**
733K

 **20 Hudson Yards - Kissaki HY LLC - Notice.pdf**
73K

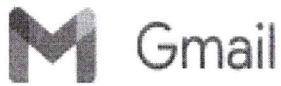

Dan MacPherson <dan@explorekissaki.com>

Kissaki- Omakase Sushi @ 20 Hudson Yards

2 messages

Dan MacPherson <dan@explorekissaki.com>
To: brianscottweber@gmail.com

Mon, Jan 4, 2021 at 1:23 PM

Brian- Pleased to meet you by e-mail.

I am with Kissaki restaurant group based in NYC.

We have applied for a liquor license at 20 Hudson yards and wanted to let you know how excited we are to join the community.

We have restaurants in UWS and Bowery as well as a vendor stall at Jacx in Long Island City.

We strive to provide the community with freshly caught sushi grade fish served by a diverse and knowledgeable staff with a well curated cocktail and sake list that complement our menu but is not the real show... The sushi is!

Please reach out with any questions and look forward to meeting you at the restaurant!

Dan MacPherson
VP of Kissaki
dan@explorekissaki.com

Dan MacPherson <dan@explorekissaki.com>
To: brianscottweber@gmail.com

Mon, Jan 4, 2021 at 1:26 PM

Now with attachments!

[Quoted text hidden]

3 attachments **Kissaki_B-Menu_BOW_v3_110420.pdf**
733K **Kissaki-Menu.pdf**
800K **20 Hudson Yards - Kissaki HY LLC - Notice.pdf**
73K



Dan MacPherson <dan@explorekissaki.com>

Kissaki- Omakase Sushi @ 20 Hudson Yards

1 message

Dan MacPherson <dan@explorekissaki.com>

Mon, Jan 4, 2021 at 1:20 PM

To: juliacampanelli@gmail.com

Julia- Pleased to meet you by e-mail.

I am with Kissaki restaurant group based in NYC.

We have applied for a liquor license at 20 Hudson yards and wanted to let you know how excited we are to join the community.

We have restaurants in UWS and Bowery as well as a vendor stall at Jacx in Long Island City.

We strive to provide the community with freshly caught sushi grade fish served by a diverse and knowledgeable staff with a well curated cocktail and sake list that complement our menu but is not the real show... The sushi is!

Reach out with any questions and look forward to meeting you at the restaurant!

Dan MacPherson
VP of Kissaki
dan@explorekissaki.com

3 attachments

 **20 Hudson Yards - Kissaki HY LLC - Notice.pdf**
73K

 **Kissaki_B-Menu_BOW_v3_110420.pdf**
733K

 **Kissaki-Menu.pdf**
800K



Dan MacPherson <dan@explorekissaki.com>

Kissaki- Omakase Sushi @ 20 Hudson Yards

1 message

Dan MacPherson <dan@explorekissaki.com>

Mon, Jan 4, 2021 at 1:18 PM

To: kathleentreat123@gmail.com

Kathleen- Pleased to meet you by e-mail.

I am with Kissaki restaurant group based in NYC.

We have applied for a liquor license at 20 Hudson yards and wanted to let you know how excited we are to join the community.

We have restaurants in UWS and Bowery as well as a vendor stall at Jacx in Long Island City.

We strive to provide the community with freshly caught sushi grade fish served by a diverse and knowledgeable staff with a well curated cocktail and sake list that complement our menu but is not the real show... The sushi is!

Also, seeing you are part of the dog run. I am a dog owner myself. In addition to our menus, I included a pic of him. His name is Chef.

Reach out with any questions and look forward to meeting you at the restaurant!

Dan MacPherson
VP of Kissaki
dan@explorekissaki.com

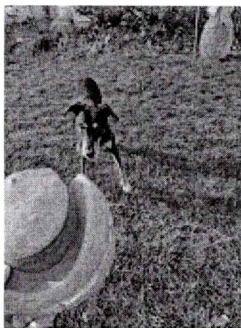
4 attachments

Chef.jpg
7628K

 **20 Hudson Yards - Kissaki HY LLC - Notice.pdf**
73K

 **Kissaki_B-Menu_BOW_v3_110420.pdf**
733K

 **Kissaki-Menu.pdf**
800K



Thomas McCallen <sla@carrerasmccallen.com>

Re: Kissaki HY LLC - 20 Hudson Yards, New York, NY 10001 - Outreach for Proposed New SLA License

1 message

Thomas McCallen <sla@carrerasmccallen.com>

Mon, Jan 4, 2021 at 4:42 PM

To: mcgee79@aol.com

West 36th Street
Frank Strock

Please accept this eMail as outreach pursuant to Manhattan Community Board # 4 (MCB4) guidelines.

Attached please find a Standardized Notice Form for proposed restaurant premises and Menu that has and/or will be submitted to MCB4.

Please contact this firm if you have any questions regarding the foregoing.

--

COVID-19 Remote Operations Information:

Carreras & McCallen PLLC
Telephone: 212.732.3640
eMail: sla@carrerasmccallen.com

 **KissakiHY.MCB4Notice.Menu.pdf**
2291K



Thomas McCallen <sla@carrerasmccallen.com>

Re: Kissaki HY LLC - 20 Hudson Yards, New York, NY 10001 - Outreach for Proposed New SLA License

1 message

Thomas McCallen <sla@carrerasmccallen.com>

Mon, Jan 4, 2021 at 4:49 PM

To: info@clintonhouseing.org

Cc: jrestuccia2@clintonhousing.org, rmarcano@clintonhousing.org

CHDC (incl.Bob's & bird parks)

Joe Restuccia

Ryan Marcano

Please accept this eMail as outreach pursuant to Manhattan Community Board # 4 (MCB4) guidelines.

Attached please find a Standardized Notice Form for proposed restaurant premises and Menu that has and/or will be submitted to MCB4.

Please contact this firm if you have any questions regarding the foregoing.

--

COVID-19 Remote Operations Information:

Carreras & McCallen PLLC

Telephone: 212.732.3640

eMail: sla@carrerasmccallen.com

**KissakiHY.MCB4Notice.Menu.pdf**

2291K



Thomas McCallen <sla@carrerasmccallen.com>

Fwd: Kissaki HY LLC - 20 Hudson Yards, New York, NY 10001 - Outreach for Proposed New SLA License

1 message

Thomas McCallen <sla@carrerasmccallen.com>
To: info@clintonhousing.org

Mon, Jan 4, 2021 at 4:51 PM

Corrected email address

----- Forwarded message -----

From: **Thomas McCallen** <sla@carrerasmccallen.com>

Date: Mon, Jan 4, 2021 at 4:49 PM

Subject: Re: Kissaki HY LLC - 20 Hudson Yards, New York, NY 10001 - Outreach for Proposed New SLA License

To: <info@clintonhousing.org>

Cc: <jrestuccia2@clintonhousing.org>, <rmarcano@clintonhousing.org>

CHDC (incl. Bob's & bird parks)

Joe Restuccia

Ryan Marcano

Please accept this eMail as outreach pursuant to Manhattan Community Board # 4 (MCB4) guidelines.

Attached please find a Standardized Notice Form for proposed restaurant premises and Menu that has and/or will be submitted to MCB4.

Please contact this firm if you have any questions regarding the foregoing.

--

COVID-19 Remote Operations Information:

Carreras & McCallen PLLC

Telephone: 212.732.3640

eMail: sla@carrerasmccallen.com

--

COVID-19 Remote Operations Information:

Carreras & McCallen PLLC

Telephone: 212.732.3640

eMail: sla@carrerasmccallen.com

Temporary address to mail all checks and any documentation
that can **NOT** be scanned as an eMail attachment:

Thomas J McCallen, Esq

31 Morewood Oaks

Port Washington, NY 11050

**KissakiHY.MCB4Notice.Menu.pdf**

2291K



Thomas McCallen <sla@carrerasmccallen.com>

Re: Kissaki HY LLC - 20 Hudson Yards, New York, NY 10001 - Outreach for Proposed New SLA License

1 message

Thomas McCallen <sla@carrerasmccallen.com>
To: rjbenfatto@hyhkalliance.org, pgouris@hyhkalliance.org

Mon, Jan 4, 2021 at 4:54 PM

Hudson Yards Hell's Kitchen Alliance
Bob Benfatto
Patty Gouris

Please accept this eMail as outreach pursuant to Manhattan Community Board # 4 (MCB4) guidelines.

Attached please find a Standardized Notice Form for proposed restaurant premises and Menu that has and/or will be submitted to MCB4.

Please contact this firm if you have any questions regarding the foregoing.

--

COVID-19 Remote Operations Information:

Carreras & McCallen PLLC
Telephone: 212.732.3640
eMail: sla@carrerasmccallen.com

 **KissakiHY.MCB4Notice.Menu.pdf**
2291K



Thomas McCallen <sla@carrerasmccallen.com>

Re: Kissaki HY LLC - 20 Hudson Yards, New York, NY 10001 - Outreach for Proposed New SLA License

1 message

Thomas McCallen <sla@carrerasmccallen.com>

Mon, Jan 4, 2021 at 4:55 PM

To: donna@donnalangman.com

Donna Langman Costumes
Donna Langman

Please accept this eMail as outreach pursuant to Manhattan Community Board # 4 (MCB4) guidelines.

Attached please find a Standardized Notice Form for proposed restaurant premises and Menu that has and/or will be submitted to MCB4.

Please contact this firm if you have any questions regarding the foregoing.

--

COVID-19 Remote Operations Information:

Carreras & McCallen PLLC

Telephone: 212.732.3640

eMail: sla@carrerasmccallen.com

 **KissakiHY.MCB4Notice.Menu.pdf**
2291K



Thomas McCallen <sla@carrerasmccallen.com>

Re: Kissaki HY LLC - 20 Hudson Yards, New York, NY 10001 - Outreach for Proposed New SLA License

1 message

Thomas McCallen <sla@carrerasmccallen.com>

Mon, Jan 4, 2021 at 4:57 PM

To: cberthet@me.com

CHEKPEDS

Christine Berthet

Please accept this eMail as outreach pursuant to Manhattan Community Board # 4 (MCB4) guidelines.

Attached please find a Standardized Notice Form for proposed restaurant premises and Menu that has and/or will be submitted to MCB4.

Please contact this firm if you have any questions regarding the foregoing.

--

COVID-19 Remote Operations Information:

Carreras & McCallen PLLC

Telephone: 212.732.3640

eMail: sla@carrerasmccallen.com

 **KissakiHY.MCB4Notice.Menu.pdf**
2291K