

Manhattan Community Board 4

(All Fields Must Be Completed)

CORPORATION NAME		DOING BUSINESS AS (DBA)	
Rise Bar NYC LLC		Rise Bar & Lounge	
STREET ADDRESS		CROSS STREETS	ZIP CODE
859 Ninth Avenue		West 55th and West 56th Streets	10019
OWNER <i>(Attach a list of all the people that will be associated/listed with the license)</i>	NAME:	ATTORNEY/ REPRESENTATIVE	NAME: Donald M. Bernstein, Esq Bernstein Redo PC
	PHONE:		PHONE: 212 651 3100
	EMAIL:		EMAIL: donald@brpclaw.com
MANAGER	NAME:	LANDLORD	NAME: Trevi Retail c/o John McCarthy
	PHONE:		PHONE: 646 937 5094
	EMAIL:		EMAIL: sdluzyn@hubbnyc.com
APPLICATION TYPE (<input type="checkbox"/> Liquor License <input checked="" type="checkbox"/> Unenclosed Sidewalk Cafe) DOT Open Restaurants			
<input type="radio"/> New	Has applicant owned or managed a similar business?	<input type="checkbox"/> YES	<input type="checkbox"/> NO
	What is/was the name and address of establishment?		
	What were the dates applicant was involved with this former premise?		
<input type="radio"/> Corp Change/Class Change/Removal	What is the license # and expiration date?	#1278667 / 10/31/2021	
	Is applicant making any alterations or operational changes?	<input checked="" type="radio"/> YES	<input type="radio"/> NO
	If alterations or operational changes are being made, please describe/list all changes.	See attached list	
<input checked="" type="radio"/> Alteration	What is the current license # and expiration date?	#1278667 / 10/31/2021	
	Please list/describe the nature of all the changes and attach the plans:	See attached list	
METHOD OF OPERATION			
TYPE OF ALCOHOL	<input checked="" type="radio"/> Liquor/Wine/Beer & Cider <input type="radio"/> Beer & Cider <input type="radio"/> Wine/Beer & Cider		
ESTABLISHMENT TYPE	<input checked="" type="radio"/> Restaurant <input type="radio"/> Cabaret <input type="radio"/> Night Club <input type="radio"/> Hotel <input checked="" type="radio"/> Bar/Tavern <input type="radio"/> Catering Establishment <input type="radio"/> Adult Entertainment <input type="radio"/> Wine Bar <input type="radio"/> Dance Club <input type="radio"/> Sports Bar <input type="radio"/> Club (Fraternal Organization – Members Only)		
Has applicant/owner filed with the SLA? If yes, when? If no, when do you plan to file?	<input type="checkbox"/> YES	<input checked="" type="radio"/> NO	February 2021 - after CB Meeting
Is the 500 Foot Rule applicable? If yes, please attach a diagram of the On-Premise liquor license establishments within a 500 ft. radius of your establishment and the Public Interest Statement.	<input type="checkbox"/> YES	<input type="checkbox"/> NO	N/A
Is the 200 Foot Rule applicable? If yes, please attach a diagram of the schools and houses of worship that trigger the rule.	<input type="checkbox"/> YES	<input type="checkbox"/> NO	N/A
Has applicant/owner(s) read MCB4 Policy Regarding Concentration and Location of Alcoholic-Serving Establishments?	<input checked="" type="radio"/> YES	<input type="checkbox"/> NO	

OPERATIONAL DETAILS (*Closing time will be when establishment is vacated of all patrons)

HOURS* <i>(Indoor Only)</i>		MONDAY	TUESDAY	WEDNESDAY	THURSDAY	FRIDAY	SATURDAY	SUNDAY
	Operation	1130AM-2AM	1130AM-2AM	1130AM-2AM	1130AM- 3AM ^{2AM}	1130AM-4AM	1130AM-4AM	1130AM-2AM*
	Kitchen	1130AM-2AM	1130AM-2AM	1130AM-2AM	1130AM-3AM	1130AM-4AM	1130AM-4AM	1130AM-2AM*
	Live Music	1130AM-1AM	1130AM-1AM	1130AM-1AM	1130AM-1AM	1130AM-1AM	1130AM-1AM	1130AM-1AM

If you plan to have music, what type(s)?
(Circle all that apply)

BACKGROUND
 LIVE MUSIC
 DJ
 JUKE BOX
 KARAOKE

***4AM when Sundays and Mondays are holidays** ^{Federal} **OCCUPANCY** **New Year's Eve allowed a 4AM close**

	Capacity (Certificate of Occupancy)	Maximum # of Persons Occupying Premises (Including Employees)	Number of Tables	Number of Seats	Number of Service Only Bars	Number of Stand-Up Bars	Number of Seats at Stand-Up Bar
INSIDE	199**	141	23	96	None	Two	30
OUTSIDE <i>(Other than sidewalk café)</i>	N/A						

DCA *** APPROVED UNENCLOSED SIDEWALK CAFÉ			Ninth Ave 13 West 56th 17	Ninth Ave 48 West 56th 56	***Sidewalk/Roadway seating approved as per DOT Open Restaurants - see enclosed		
--	--	--	------------------------------------	------------------------------------	---	--	--

How many floors are there? What is the capacity for each floor? **Ground floor= 199 / Cellar not for patron use**

How frequently will the owner(s) be at the establishment? **Regularly**

Will there be dancing? YES NO

Will applicant have bottle or table service for beverage alcohol? YES NO

Will applicant be hosting private; promotional or corporate events? YES NO **Private parties on occasion**

Will outside promoters be used on a regular basis? If yes please describe. YES NO

Will applicant have a security plan? If, yes please attach. YES NO **See attached**

Will security plan be implemented? YES NO

Will State certified security personnel be used? YES NO

Will New York Nightlife Association and NYPD Best Practices be followed? YES NO

Does applicant agree to notify MCB4 prior to making changes to its method of operation? YES NO

Will applicant be using delivery bicycles? If yes, how many? YES NO

Will delivery bicycles be clearly marked with the name of the restaurant and will staff wear attire clearly noting name as described by NYC Law? YES NO **N/A**

Where will delivery bicycles be stored during the day when not in use? **N/A**

****The Temporary Certificate of Occupancy will be amended to combine the two ground floor spaces and for new occupancy of 199**

LOCATION & ZONING			
Is this a Special District? If yes, is it Clinton, West Chelsea or Hudson Yards?	<input checked="" type="radio"/> YES	NO	Clinton
Does the building have a Certificate of Occupancy ("C of O") or a letter of no objection?	<input checked="" type="radio"/> YES	NO	Yes - see enclosed
Is a Public Assembly permit required?	<input checked="" type="radio"/> YES	NO	
Are your plans filed with DOB?	YES	<input checked="" type="radio"/> NO	

Community Notification/Relations			
NOTIFICATION: List all block associations; tenant associations, co-op boards or condo boards of residential buildings; and community groups that applicant has notified regarding its application. For each please list both the organization and individual you contacted	# 1	Email sent to groups on enclosed list on December 31, 2020	
	# 2	West 55th Block Association	
	# 3	Parc Vendome/ 340 West 57th Street	
	# 4	HK 49-53 Block Alliance	
	# 5		
Please provide dates when applicant met with the groups listed above.		*	
Who was your contact person at each group you met with?		**	
When did applicant post the notice that was provided?		January 16, 2021	
Where did applicant post the notice that was provided?		Premises and residential addresses - see enclosed list	
Will applicant provide owner cell phone number to neighbors and respond to complaints that arise? Please provide number in space provided.		<input checked="" type="radio"/> YES	NO 917 405 7905
Will applicant inform the Community Board office of its job openings and/or provide a hyperlink to applicants jobs webpage?		<input checked="" type="radio"/> YES	NO

***December 16th, 23rd & 30th of 2020 and January 6, 2021 for West 55th BA
 January 7, 2021 with CB#4
 January 11, 2021 for Parc Vendome and West 55th BA
 January 27, 2021 with HK 49-53 Block Alliance**

****Christine Gorman - West 55th BA
 Frank Holozubiec and Burt Lazarin - Co-Chairs of CB#4
 Steve Belida - HK 49-53 Block Alliance**

BUILDING DESIGN			
State the name and type of business previously located in the space.	Rise Bar has been operating at the space since November 2015		
Has a liquor-licensed establishment previously occupied this space at any time? If yes, please provide the name of the business.	<input checked="" type="radio"/> YES	<input type="radio"/> NO	Midtown Ninth Ave. Deli/Groc Inc. Grocery Store Beer License
Do you plan any changes to the existing façade? If yes, please describe.	<input checked="" type="radio"/> YES	<input type="radio"/> NO	New signage for the West 56th side
Has the applicant/owner(s) read MCB 4 ADA Guidelines Memo?	<input checked="" type="radio"/> YES	<input type="radio"/> NO	
Is the entrance ADA Compliant?	<input checked="" type="radio"/> YES	<input type="radio"/> NO	
Do you plan any changes to the existing façade? If yes, please describe.	<input checked="" type="radio"/> YES	<input type="radio"/> NO	New signage for the West 56th side
Will applicant have a vestibule within the establishment?	<input checked="" type="radio"/> YES	<input type="radio"/> NO	
Will applicant use a storm enclosure?	<input checked="" type="radio"/> YES	<input checked="" type="radio"/> NO	
Does applicant agree to keep the sidewalk clear of all items or obstructions, such as sandwich boards, sidewalk signs, freestanding menus and plants, as per the law?	<input checked="" type="radio"/> YES	<input type="radio"/> NO	
Will applicant comply with the NYC noise code?	<input checked="" type="radio"/> YES	<input type="radio"/> NO	
Will the establishment have any of the following: (circle all that apply)	<input type="radio"/> FRENCH DOORS	<input checked="" type="radio"/> GARAGE DOORS	<input type="radio"/> WINDOWS THAT CAN BE OPENED
Will applicant close all windows, French doors, garage doors when any music or amplified sound (including televisions) is played inside the establishment?	<input checked="" type="radio"/> YES	<input type="radio"/> NO	Garage doors on Ninth Avenue
Will applicant close all windows, French doors, garage doors by 11 PM Friday and Saturday and 10 PM on all other days even if no music or amplified sound is played inside the establishment?	<input checked="" type="radio"/> YES	<input type="radio"/> NO	
Has applicant obtained an acoustical report from a certified sound engineer to assess potential noise disturbance to the neighboring residents and buildings?	<input checked="" type="radio"/> YES	<input type="radio"/> NO	See enclosed sound report
Will applicant follow the recommendations of a certified sound engineer to mitigate potential noise disturbance to the neighboring residents and buildings, including placing speakers on the floor of the establishment?	<input checked="" type="radio"/> YES	<input type="radio"/> NO	
Will the kitchen exhaust system extend to the roof?	<input checked="" type="radio"/> YES	<input type="radio"/> NO	
Will the establishment have an illuminated sign?	<input type="radio"/> YES	<input checked="" type="radio"/> NO	
Will the establishment have a canopy extending over the sidewalk?	<input type="radio"/> YES	<input checked="" type="radio"/> NO	
Where will the air conditioner be located? What type is it?	Roof		
When was the air conditioner installed?	October 2015		

OUTDOOR ITEMS - OTHER THAN SIDEWALK CAFÉ			
Has the applicant/owner(s) read MCB 4 Rear Yard Rooftop Policy?	YES	NO	
Will applicant use any outdoor spaces: rooftop, rear yard, patio, porch, balcony, pavilion, tents, deck, gazebo or open dining in the parking lane? If yes, which one(s)?	YES	NO	
Are the floorplans for the outdoor space(s) included?	YES	NO	
Will applicant close and vacate the outdoor space(s) by 11PM on Friday & Saturday and 10 PM on all other days?	YES	NO	
Will the service and consumption of alcohol in any outdoor space only be via seated food service?	YES	NO	
Will applicant not allow standing space for patrons to drink or smoke in any outdoor space(s) or on the sidewalk?	YES	NO	
Will there be no amplified music, as per the law?	YES	NO	
If amplified sound is played inside the establishment, will windows and doors be closed?	YES	NO	
Will applicant agree to post signs outside asking customers to respect the neighbors'?	YES	NO	
Will applicant agree to train staff to encourage a peaceful environment?	YES	NO	
Will applicant provide effective sound control (landscaping enclosure, soundproofing tenants apartments)	YES	NO	
Will there be a lighting plan that allows safe usage of the outdoor space without disrupting neighbors?	YES	NO	
If open dining in the parking lane, will applicant agree to leave the sidewalk free of any furniture?	YES	NO	
If open dining, will you comply with all NYC DOT guidelines?	YES	NO	
If open dining, will the installation be year-round?	YES	NO	

DCA APPROVED UNENCLOSED SIDEWALK CAFÉ / DOT Open Restaurants			
Has the applicant/owner(s) read MCB4 Sidewalk Café Policy?	<input checked="" type="radio"/> YES	NO	
Will applicant be applying for a sidewalk café now or in the future?	<input checked="" type="radio"/> YES	NO	Sidewalk Cafe exists on Ninth Avenue and on West 56th Street
Is applicant in this application seeking to include a sidewalk café in its liquor license?	<input checked="" type="radio"/> YES	NO	
If yes, has applicant submitted an application and plans to NYC Dept. of Consumer Affairs? Please attach application and plans.	YES	NO	N/A
Will applicant close and vacate the sidewalk café by 11 PM on Friday & Saturday and 10 PM on all other days?	<input checked="" type="radio"/> YES	NO	
Will applicant be serving alcohol in the sidewalk café? If so, will you have waiter service?	<input checked="" type="radio"/> YES	NO	
Will the café have a 3 ft. wide serving aisle running the entire length of the sidewalk cafe?	<input checked="" type="radio"/> YES	NO	
Will applicant mark the perimeter of the café on the sidewalk?	<input checked="" type="radio"/> YES	NO	
Will the service and consumption of alcohol in the sidewalk café only be via seated food service?	<input checked="" type="radio"/> YES	NO	
Will the sidewalk café not provide standing space for drinking or smoking?	<input checked="" type="radio"/> YES	NO	
Will applicant use any portable natural gas heaters? If so, do you have the requisite approvals from DOB & the Fire Department?	YES	<input checked="" type="radio"/> NO	
Will applicant have a lighting plan that will allow safe usage of the outdoor space without disrupting neighbors?	<input checked="" type="radio"/> YES	NO	
Will all furniture, plants and barricades be stored inside between the evening closing hours and the morning opening hours?	<input checked="" type="radio"/> YES	NO	
Will all furniture be stored inside between December 21 st and March 21 st , and any other day when it rains or snows?	<input checked="" type="radio"/> YES	NO	
Will applicant use umbrellas?	<input checked="" type="radio"/> YES	NO	Only when very sunny or raining
If construction or construction protection has reduced the sidewalk width, will applicant always maintain an 8 foot clear path of sidewalk between the perimeter of the café and the closest obstruction including construction barricades?	<input checked="" type="radio"/> YES	NO	
If open dining is in the parking lane, will applicant agree to remove its sidewalk café?	<input checked="" type="radio"/> YES	NO	N/A on Ninth Avenue After 7PM street parking will remove furniture on West 56th Side but not barricades

ADDITIONAL STIPULATIONS: (Office Use Only)

- All live performances (including , without limitation, karaoke, live singing, and lip-syncing) will cease no later than 1am nightly
- Applicant will not seek a Certificate of Occupancy for more than 199 people
- This application does not extend to any DCA-approved sidewalk cafe
- Applicant will have a licensed acoustician investigate any noise issues in apartments in applicant's building and will implement all recommendations of acoustician
- If there are problems with sound leakage through windows and french doors, applicant will take steps to mitigate that leakage

To the extent any additional stipulation on pages 7 and 8 of this application conflicts with any response on pages 1 – 6 of this application, the stipulations on pages 7 and 8 control.

ADDITIONAL STIPULATIONS: (Office Use Only), *Continued*

To the extent any additional stipulation on pages 7 and 8 of this application conflicts with any response on pages 1 – 6 of this application, the stipulations on pages 7 and 8 control.

Manhattan Community Board 4 (MCB4) recommends:
(MCB4's recommendation is based on a vote taken at its
March 3, 2021 full board meeting, with 41 members voting in favor
of the recommendation, 0 members opposed, 0 members
abstaining and 0 present but not eligible)

Denial unless all stipulations agreed to by applicant/owner are part of the method of operation
 Denial Approval

CB4 REPRESENTATIVES

<p>Nelly Gonzalez CB4 Assistant District Manager</p> 	<p>Frank Holozubiec CB4 BLP Committee Co-Chair</p> 	<p>Burt Lazarin CB4 BLP Committee Co-Chair</p> 
--	--	--

APPLICANT AGREEMENT WITH THE COMMUNITY

Applicant agrees to these stipulations as the basis for the community support of this application and acknowledges that all of these stipulations are essential prerequisites to the MCB4 recommendation regarding this application. Applicant agrees to have these stipulations incorporated in the method of operation of its liquor license. The stipulations in this application constitute the entire agreement between MCB4 and applicant and may only be altered in writing signed by MCB4 and applicant. These stipulations supersede any oral statements or representations in connection with this application.

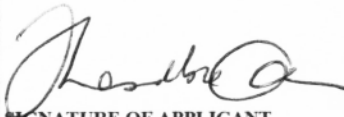
<p>SIGN HERE →</p>	<p>Theodore Arenas PRINT NAME OF APPLICANT</p>	 SIGNATURE OF APPLICANT	<p>January 1, 2021 DATE</p>
---------------------------	---	--	--

Rise Bar NYC LLC dba Rise Bar and Lounge / List of Changes

Alterations

- Adding the former Haru Restaurant to the licensed premises including cellar and full kitchen and combining spaces
- For the current licensed space: The existing number of tables will be decreased from 11 to 9 tables. The existing number of seats will be increased from 28 to 37 seats. The existing number of bar stools will be decreased from 18 to 15 bar stools. The total number of seats is 52
- For the proposed new space: A 20-foot customer bar will be installed with 15 bar stools. The proposed number of tables is 14 and the proposed number of seats is 59. The total number of seats is 74
- The total proposed number of tables is 23 with 96 seats and 30 bar stools for a grand total of 126 seats
- Open Restaurants applications were submitted to the Department of Transportation for sidewalk /roadway seating on Ninth Avenue and West 56th Street and were approved for a total of 30 tables and 104 seats

Change in Method of Operation

- Since there is a full kitchen in the new space the menu will be expanded and the establishment will also be operated as a restaurant as well as a bar and lounge
- The proposed closing hours of operation are to be extended from 11:30AM to 2:00AM Thursday to 11:30AM to 3:00AM Thursday; and 11:30 to 2:00AM Sunday to 11:30AM to 4:00AM when Sunday and the following Monday are holidays including Gay Pride and other holidays
- We are not seeking changes to the current hours of 11:30AM to 2:00AM Monday to Wednesday and 11:30AM to 4:00AM Friday to Saturday. Sundays will close at 2:00AM when Sundays and the following Mondays are not holidays

License History for Theodore Arenas, John Blair, Moises Lachman and Luiz R. Sutter

Active Licenses for Theodore Arenas, John Blair, Moises Lachman and Luiz R. Sutter

Rise Bar NYC LLC
dba Rise Bar & Lounge LLC
859 Ninth Avenue
New York, New York 10019
Serial No. 1278667
November 2015 to Present

Previous License History for Theodore Arenas

Lux Bar & Lounge LLC
dba Bar Tini
642 Tenth Avenue
New York, New York 10036
Serial No. 1224178
September 2009 to 2011

Previous License History for John Blair

De Of New York LLC
dba XL Dance Bar
357 West 16th Street
New York, New York 10011
Serial No. 1105057
April 2000 to 2006

XL Dance Bar LLC
512 West 42nd Street
New York, New York 10036
Serial No. 1248373
January 2012 to 2016

42nd Street Hotel LLC
dba The Out NYC / Kitchin
508 510 West 42nd Street
New York, New York 10036
Serial No. 1257280
March 2012 to 2016

From: Jules Vigh

Sent: Thursday, December 31, 2020 4:07 PM

To: Jules Vigh <Jules@brpclaw.com>

Cc: 'Ted Arenas' <theodorearenas@gmail.com>; 'Gonzalez, Nelly (CB)' <negonzalez@cb.nyc.gov>; Donald Bernstein <Donald@brpclaw.com>

Bcc: 'rjbenfatto@hyhkalliance.org'; 'pgouris@hyhkalliance.org'; 'kathleentreat123@gmail.com'; 'mcgee79@aol.com'; 'brianscottweber@gmail.com'; 'cberthet@me.com'; 'info@clintonhousing.org'; 'jrestuccia2@clintonhousing.org'; 'rmarcano@clintonhousing.org'; 'eduardozeiger@compuserve.com'; 'mpta@mptenants.com'; 'ashleyll@aol.com'; 'twocatsltd@worldnet.att.net'; 'Rudi_Papiri@timemagazine.com'; 'tangotanner@gmail.com'; 'west45ba@gmail.com'; 'chanawid@gmail.com'; 'block45@hellskitchen.net'; 'stephenfanto@gmail.com'; 'AllisonTupper@verizon.net'; 'hudson62747@hotmail.com'; 'aefearshk@earthlink.net'; 'larrymichaelroberts@gmail.com'; 'jamesbogues@gmail.com'; 'mariagnys@aol.com'; 'ecelnik@actorsfund.org'; 'rpimentel@commonground.org'; 'dsage@commonground.org'; 'nkyriacou@yahoo.com'; 'Ave.gdclay@att.net'; 'john.mudd@usa.net'; 'info@hcc-nyc.org'; 'ploeb315@aol.com'; 'west55ba@gmail.com'; 'hk5051@gmail.com'; 'tenants350west51st@gmail.com'; 'rrlarios@hotmail.com'; 'acernitz@gmail.com'; 'awm3333@me.com'; 'jessbondy@aol.com'; 'john.waldman@redcross.org'; 'juliacampanelli@gmail.com'

Subject: Rise Bar NYC LLC / 859 Ninth Avenue

Good afternoon:

We wanted to contact your organizations to let you know that Rise Bar NYC LLC dba Rise Bar & Lounge will be applying for an alteration and change in method of operation for the premises located at 859 Ninth Avenue between West 55th Street and West 56th Street. Rise Bar & Lounge has been operating at the premises with a full liquor license since November 2015.

The applications are scheduled to be heard at the Community Board on January 12, 2021.

The proposed hours of operation are to be extended earlier to 11:30am 7 days a week to serve Brunch on weekends and lunch on weekdays. The only additional closing hours being asked for is 1 extra closing hour on Thursdays to change from 2:00am to 3:00am, and Sundays closing time will remain 2:00am but we are seeking a closing of 4:00am on Sundays ONLY when the following Mondays are holidays and Gay Pride weekend.

We are adding the former Haru Restaurant space to the licensed premises located on West 56th Street. A full kitchen is included with the proposed new space and the existing food menu will be expanded and the establishment will also operate as a restaurant serving Mexican- American food.

The current number of seats will increase from 46 to 116. An additional 21' customer bar will be included in the new space. The Haru Restaurant cellar space will be added to the current licensed cellar space.

If you would like more information on the applications or if you should have any questions please contact the owner at theodorearenas@gmail.com and please contact counsel's office – donald@brpclaw.com and jules@brpclaw.com

Thank you.

Kind regards for the New Year,

Jules

Jules Vigh, Paralegal | BERNSTEIN REDO, P.C.

1177 Avenue of the Americas, 5th floor

New York, NY 10036

Tel. 212.651.3100 \ Cell Phone 646 358 0653

Bounded Back Emails

mx.google.com rejected your message to the following email addresses:

Rudi_Papiri@timemagazine.com (Rudi_Papiri@timemagazine.com)

The email address you entered couldn't be found. Please check the recipient's email address and try to resend the message. If the problem continues, please contact your helpdesk.

alph765.prodigy.net rejected your message to the following email addresses:

Ave.gdclay@att.net (Ave.gdclay@att.net)

There's a problem with the recipient's mailbox. Please try resending this message. If the problem continues, please contact your helpdesk.

alph765.prodigy.net gave this error:

<Ave.gdclay@att.net>... Addressee unknown, relay=[64.78.33.122]

us-smtp-1.mimecast.com rejected your message to the following email addresses:

ecelnik@actorsfund.org (ecelnik@actorsfund.org)

A problem occurred while delivering this message to this email address. Try sending this message again. If the problem continues, please contact your helpdesk.

us-smtp-1.mimecast.com gave this error:

Invalid Recipient - <https://community.mimecast.com/docs/DOC-1369#550>
[nMOKp8SoOVe3FV56IM30NA.us319]

First name	Last name	ORGANIZATION	E-MAIL	Meeting
Bob	Benfatto	Hudson Yards Hell's Kitchen Alliance	ribenfatto@hvhkalliance.org	
Patty	Gouris	Hudson Yards Hell's Kitchen Alliance	pgouris@hvhkalliance.org	
Kathleen	Treat	HKNA (incl. Dog Run)	kathleentreat123@gmail.com	
Frank	Strock	West 36th Street	mcgee79@aol.com	
Brian	Weber	West 36th Street Block Association	brianscotweber@gmail.com	
Christine	Berthet	Checkpeeps	cbertthet@me.com	
Joe	Restuccia	CHDC (incl. Bob's & bird parks)	info@clintonhousing.org ; iresituccia2@clintonhousing.org	
Ryan	Marcano	CHDC (incl. Bob's & bird parks)	marcano@clintonhousing.org	
Eduardo	Zeiger	West 43rd Street (b. 9th/10th)	eduardozeiger@compuserve.com	
Linda	Ashley	Manhattan Plaza T.A. (400 W. 43rd St.)	mplata@mp tenants.com	Fourth Tuesday of the Month
Renee & Gordon	Stanley	West 44 Street Better Block Association	ashleyv@aol.com	
Rudy	Papiri	West 44th Street (b. 9th/10th)	twocatsid@worldnet.att.net	
Tim	Tanner	West 44th Street (b. 9th/10th)	Rudi_Papiri@timemagazine.com	
David C.	Stuart	West 45th Street BA	tangotanner@gmail.com ; west45ba@gmail.com	
Chana	Widawski	West 45th Street (b. 9th/10th)	west45ba@gmail.com	
John	Fisher	W 45th Street (8/9) Block Association	chanawid@gmail.com	
Steve	Fanto	West 46th Street Block Association (8th Ave to 12th Ave)	block45@hellskitchen.net	First Tuesday of month
Allison	Tupper	West 46th Street Block Association (8th Ave to 12th Ave)	stephenfanto@gmail.com	First Tuesday of month
Brandon	Hudson	West 46th Street Block Association (8th Ave to 12th Ave)	AllisonTupper@verizon.net	First Tuesday of month
Elke	Fears	West 47th/48th Streets Block Association	hudson62747@hotmail.com	
Larry	Roberts	West 47th/48th Streets Block Association	aefearshk@earthlink.net	
Jim	Bogues	West 47th/48th Streets Block Association	larrymichaelroberts@gmail.com	
Maria	Guzman	Harborview Terrace T.A. (525 W. 55th St.)	jamesboques@gmail.com	
Ellen	Celnik	The Aurora	mariaqny@aol.com	
Richard	Pimentel	The Aurora	ecelnik@actorsfund.org	
Derrick	Sage	The Aurora	rpimentel@commonground.org	
Nancy	Kyriacou	Oasis Gardens I 10th Ave., b. 51/52	dsage@commonground.org	
Gary	Dipasquale	Oasis Gardens II 52nd St/10th Ave.	nkyriacou@yahoo.com	
Larry	Roberts	Midtown North Pct. Council	gdclay@att.net	Third Tuesday of the month
John	Mudd	Midtown North/South Pct. Council	larrymichaelroberts@gmail.com	
Paul	Loeb	Housing Conservation Coordinators [10th Ave., b. 52/53]	johnmudd@usa.net	
Christine	Gorman	300 W 55th St	info@hcc-nyc.org	
Steve	Belida	West 55th Block Association	ploeb315@aol.com	the second Monday of the month.
Raul	Larios	HK49-53 Block Alliance	west55ba@gmail.com	
Amanda	Cernitz	350 W 51st Street Tenant Association	hk5051@gmail.com	
Anita	McDonagh	Hudson Hotel Residents	tenants350west51st@gmail.com	
Jesse	Bondy	Westmore 333 W 57	rrarios@hotmail.com	
John	Waldman	Parc Vendome 340 W 57th Street	acernitz@gmail.com	
Julia	Campanelli	Colonnade 347 W 57th Street	awm3333@me.com	
		American Red Cross Greater New York Region	jessbondy@aol.com	
		Hell's Kitchen Block Association (W 33rd/34th/35th Streets) (8	john.waldman@redcross.org	
			juliacampanelli@gmail.com	

NOTICE TO RESIDENTS

We wanted to contact our neighbors to let you know that Rise Bar NYC LLC dba Rise Bar & Lounge will be applying for an alteration and change in method of operation for the premises located at 859 Ninth Avenue between West 55th Street and West 56th Street. Rise Bar & Lounge has been operating at the premises with a full liquor license since November 2015.

The applications are scheduled to be heard at the Community Board on January 12, 2021.

The proposed hours of operation are to be extended earlier to 11:30am 7 days a week to serve Brunch on weekends and lunch on weekdays. The only additional closing hours being asked for is 1 extra closing hour on Thursdays to change from 2:00am to 3:00am, and Sundays closing time will remain 2:00am but we are seeking a closing of 4:00am on Sundays ONLY when the following Mondays are holidays and Gay Pride weekend.

We are adding the former Haru Restaurant space to the licensed premises located on West 56th Street. A full kitchen is included with the proposed new space and the existing food menu will be expanded and the establishment will also operate as a restaurant serving Mexican-American food.

The current number of seats will increase from 46 to 116. An additional 21' customer bar will be included in the new space. The Haru Restaurant cellar space will be added to the current licensed cellar space.

If you would like more information on the applications or if you should have any questions please contact the owner at theodorearenas@gmail.com and please contact counsel's office – donald@brpclaw.com and jules@brpclaw.com

PLEASE SEND EMAILS OF SUPPORT TO BOTH:

NEGONALEZ@CB.CYC.GOV

THEODOREARENAS@GMAIL.COM

And(or) SIGN OUR ONLINE PETITION:

<https://thespot.wufoo.com/forms/rise-bar-expansion/>

List of Residential Addresses Where Notices to Residents and CB Meeting Notices Were Left on December 31, 2020

56th street between 9th and 10th Avenue

400 56th street
401 56th street
404 56th street
406 56th street
408 56th street
410 56th street
412 56th street
413 56th street
414 56th street
416 56th street
417 56th street
418 56th street
419 56th street
420 56th street
421 56th street
422 56th street
424 56th street
426 56th street
428 56th street
430 56th street
432 56th street
443 56th street
445 56th street
447 56th street
449 56th street
453 56th street
455 56th street

56th street between 8th and 9th Avenue

302 56th street
304 56th street
310 56th street
314 56th street
320 56th street
322 56th street
342 56th street

344 56th street
346 56th street
348 56th street
350 56th street
352 56th street
354 56th street
358 56th street
350 56th street
352 56th street
354 56th street
356 56th street

Park Vendome both 57th street and 56th Street

333 west 56th street
353 west 56th street
340 west 57th street
350 west 57th street

9th ave between 55th -57th Street

853 9th ave
855 9th ave
856 9th ave
857 9th ave
858 9th ave
860 9th ave

From: Ted Arenas <theodorearenas@gmail.com>
Sent: Wednesday, December 30, 2020 3:50 PM
To: Jules Vigh <Jules@brpclaw.com>
Subject: Fwd: Open Restaurant Form Confirmation

----- Forwarded message -----

From: **NYCDOT NOTICE** <nycdotnotice@dot.nyc.gov>
Date: Fri, Jun 19, 2020 at 12:44 PM
Subject: Open Restaurant Form Confirmation
To: theodorearenas@gmail.com <theodorearenas@gmail.com>

Congratulations! As part of the City's Open Restaurants program, Rise Bar NYC LLC , is authorized to add outdoor seating to the City's sidewalk and/or roadway in front of its restaurant in accordance with all applicable terms and conditions and health guidance.

Business name: Rise Bar NYC LLC
Business phone: 9174057905
Establishment Address: 859 9th AVENUE, Manhattan, NY

Approved for:

Sidewalk Seating: yes
Roadway Seating: yes
Alcohol Service: yes

For questions about the program, requirements and resources please visit the [NYCDOT Open Restaurant Program Website](#)

Thank you,

NYC Department of Transportation

This is the 56th street approval email

----- Forwarded message -----

From: **NYC DOT NOTICE** <nyc_dotnotice@dot.nyc.gov>

Date: Wed, Dec 30, 2020 at 3:48 PM

Subject: Open Restaurant Form Confirmation

To: theodorearenas@gmail.com <theodorearenas@gmail.com>

Congratulations! As part of the City's Open Restaurants program, RISE BAR NYC LLC , is authorized to add outdoor seating to the City's sidewalk and/or roadway in front of its restaurant in accordance with all applicable terms and conditions and health guidance.

Business name: RISE BAR NYC LLC

Business phone: 9174057905

Establishment Address: 859 9 AVENUE, Manhattan, NY

Approved for:

Sidewalk Seating- yes

Roadway Seating- yes

Alcohol Service- yes

Open Street : Restaurant- no

You will receive additional emails with materials needed for safe and successful participation in the Open Restaurants program.

For questions about the program, requirements and resources please visit the [NYCDOT Open Restaurant Program Website](#)

Thank you,

NYC Department of Transportation

Rise Bar NYC LLC dba Rise Bar and Lounge / 859 Ninth Avenue, New York, New York 10019 / Serial No. 1278667
Current Approved Diagram - Ground Floor

Tables= 11 and Seats= 28 and 18 Bar Stools for a Total of 46 Seats

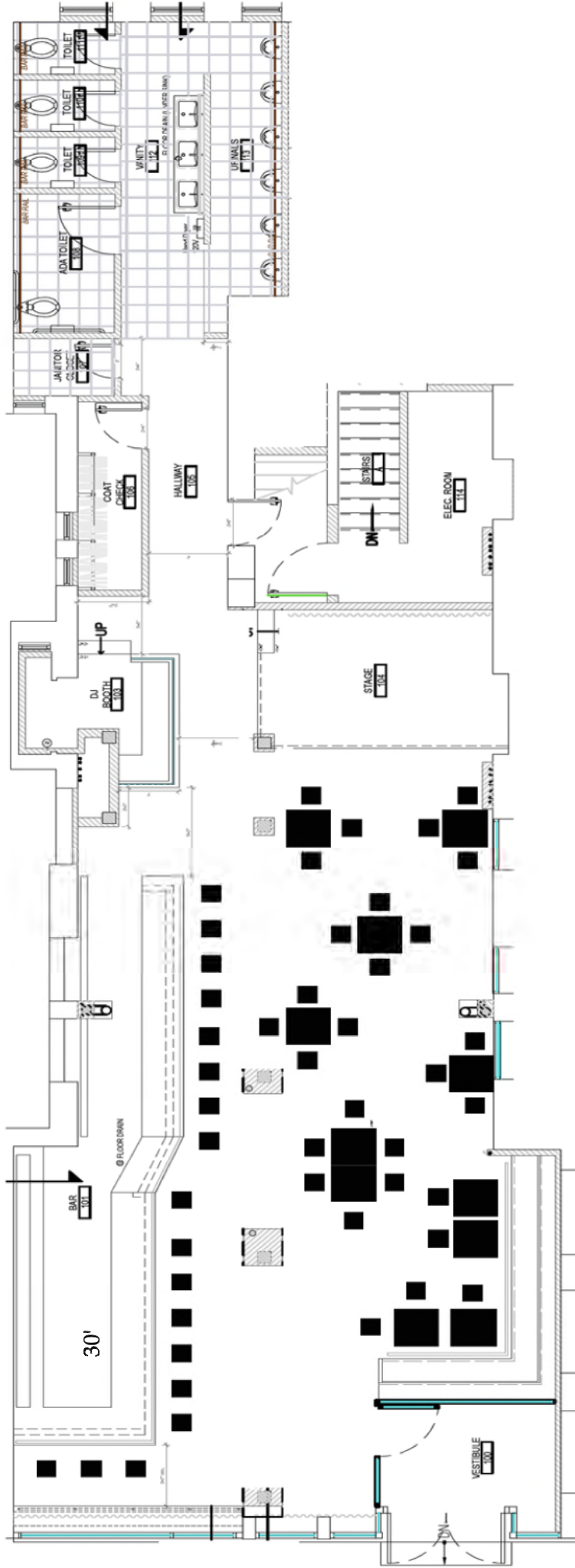

BASEMENT

Rise Bar NYC LLC dba Rise Bar and Lounge / 859 Ninth Avenue, New York, New York 10019 / Serial No. 1278667
Current Approved Diagram - Cellar

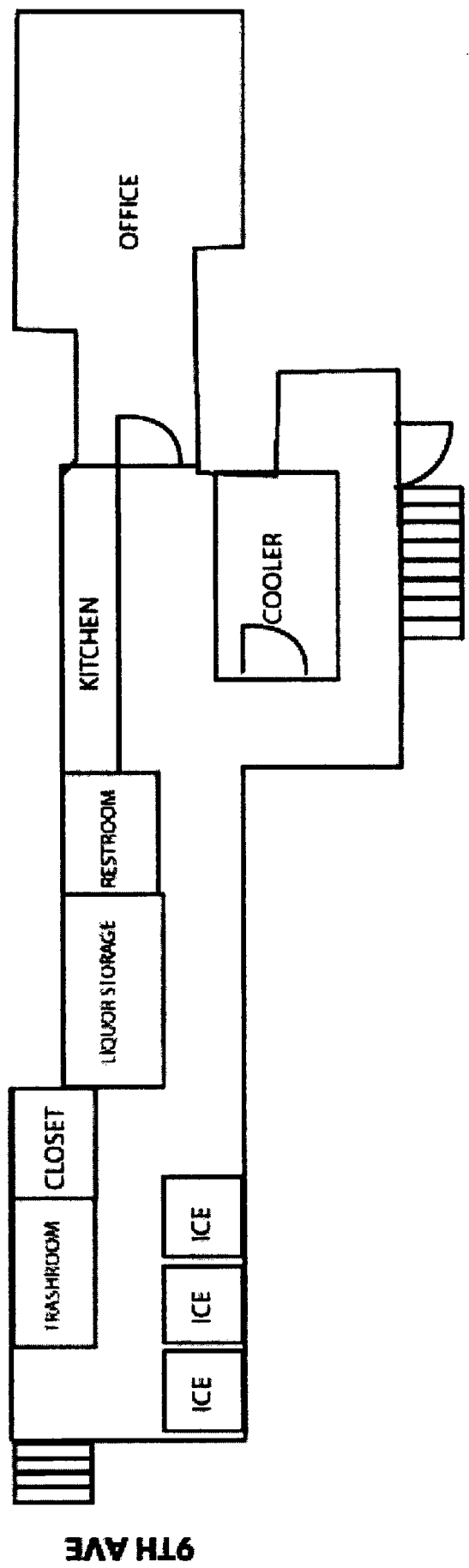

Rise Bar NYC LLC dba Rise Bar and Lounge / 859 Ninth Avenue, New York, New York 10019 / Serial No. 1278667
Updated Current Diagram - Cellar - to show egresses

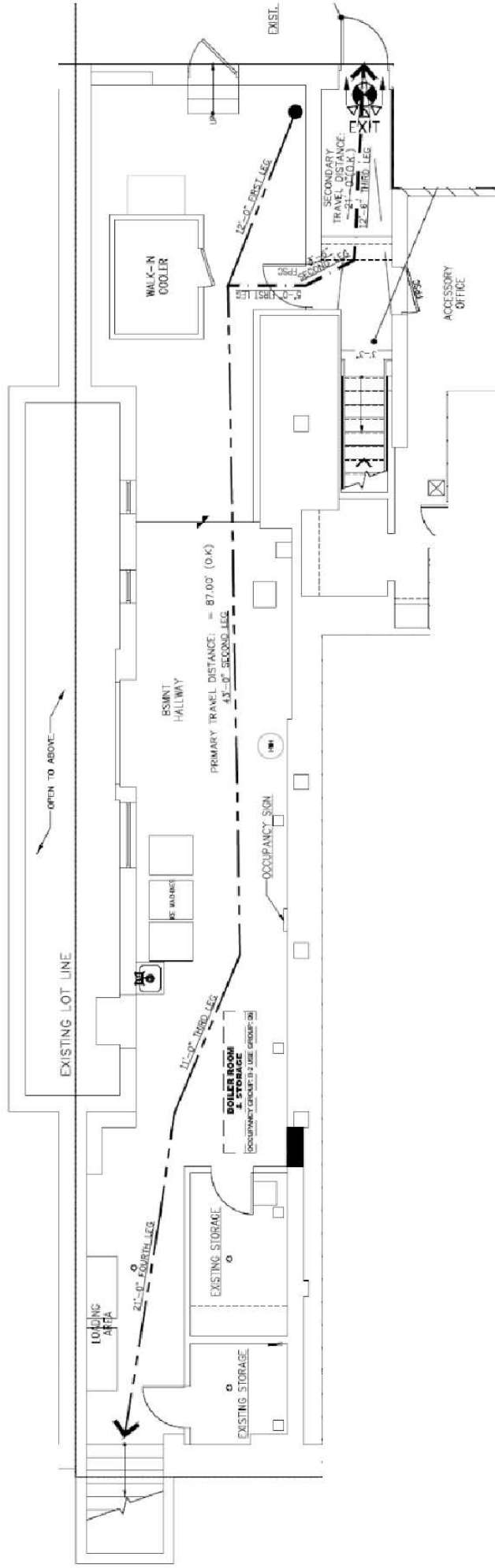

Rise Bar NYC LLC dba Rise Bar and Lounge / 859 Ninth Avenue, New York, New York 10019 / Serial No. 1278667
 Proposed Diagram - Ground Floor. Totals for both Spaces: Tables= 23 and Seats= 96 with 30 Bar Stools. Grand Total= 126 Seats

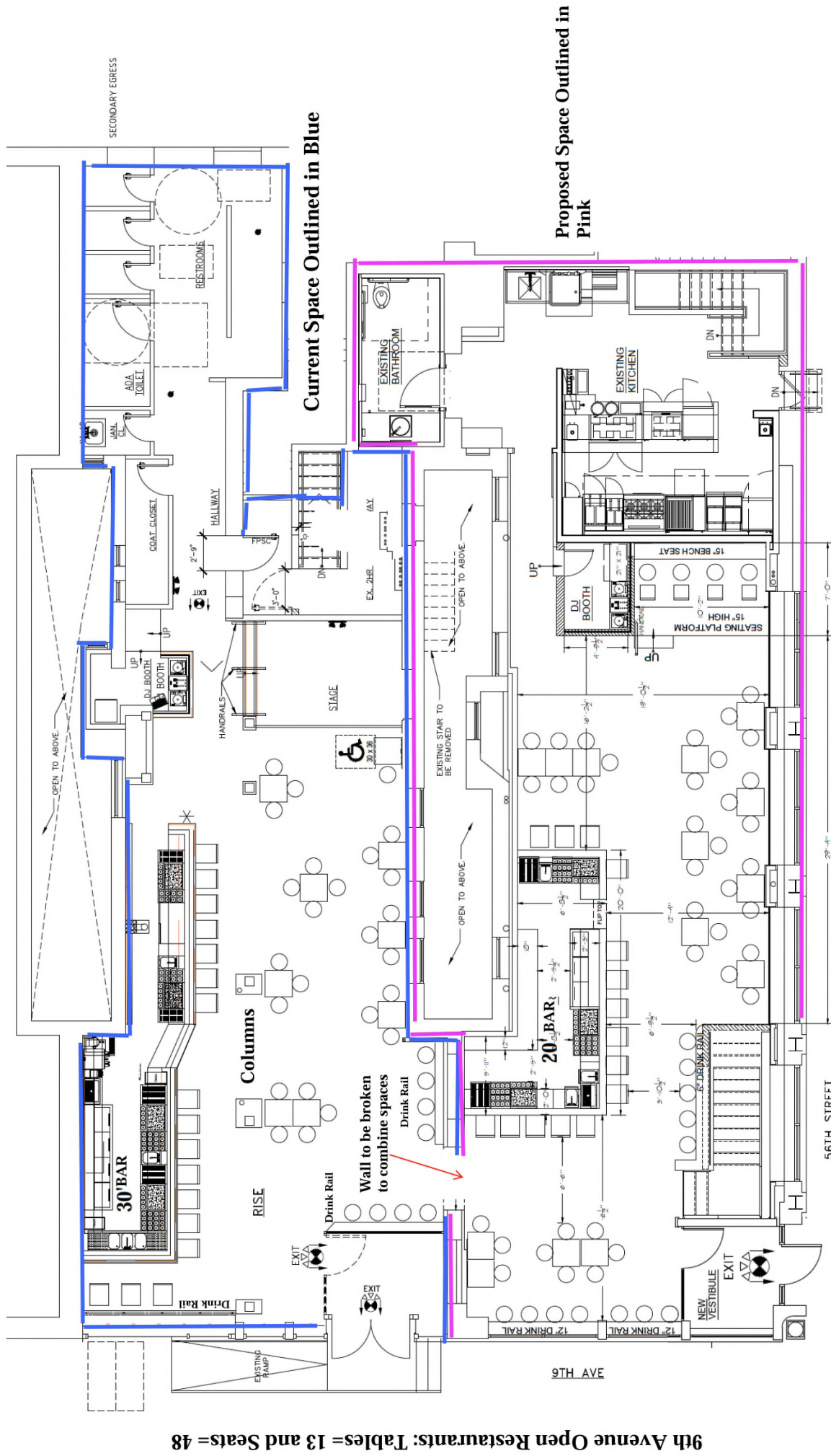

9th Avenue Open Restaurants: Tables= 13 and Seats= 48

West 56th Street Open Restaurants: Tables= 19 and Seats= 76
 See enclosed blow up diagrams

1 RISE FLOOR PLAN -1/4/21
 A100 SCALE: 1/4"=1'-0"

Rise Bar NYC LLC dba Rise Bar and Lounge / 859 Ninth Avenue, New York, New York 10019 / Serial No. 1278667
 Proposed Diagram - Cellar Floor. Current space shaded in blue and new space shaded in pink and white
 Cellar is not for patron use

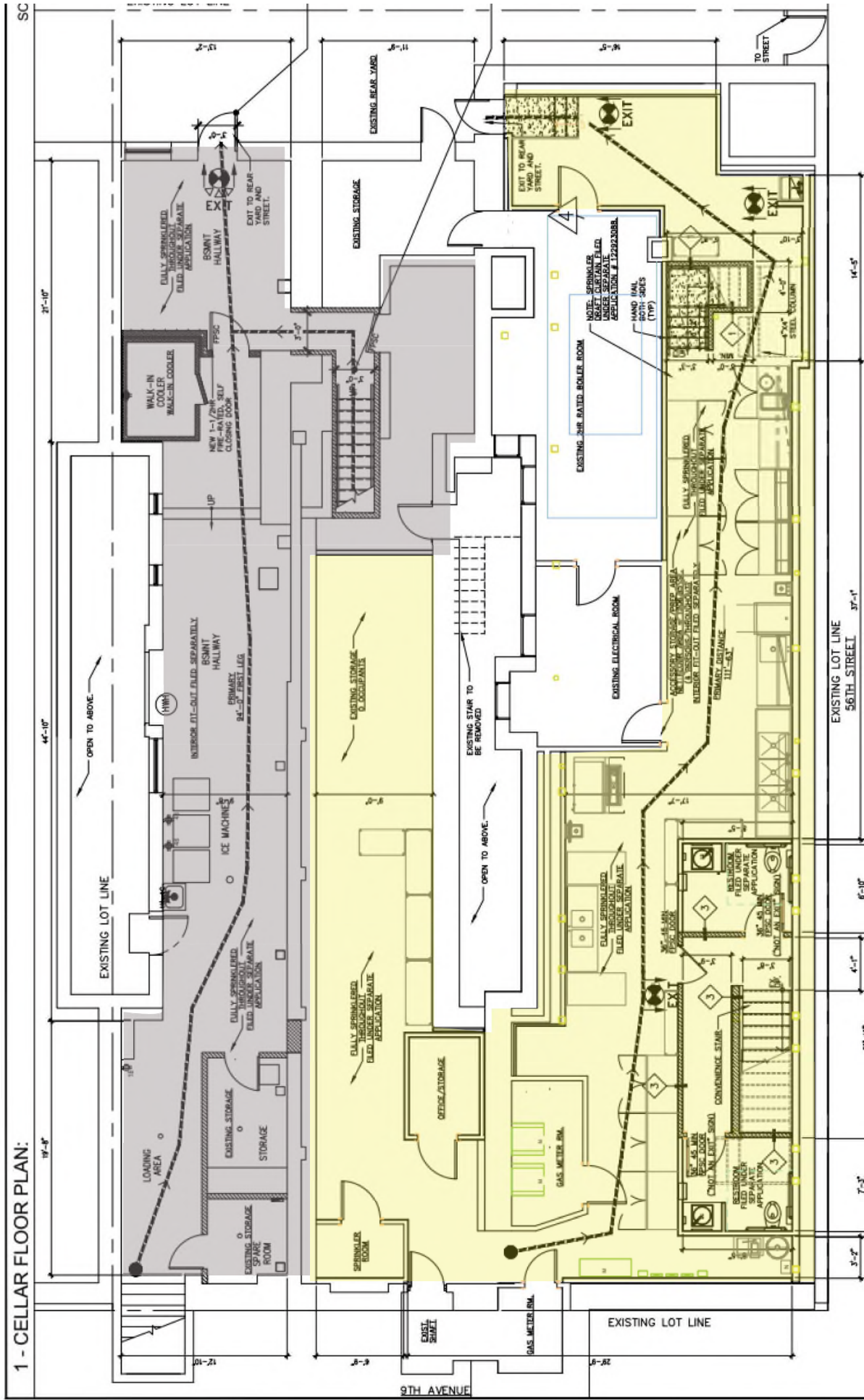

RISE CURRENT BASEMENT

RISE ADDITIONAL BASEMENT (HARU)

1
A100

RISE OUTDOOR PLAN- 9TH AVE -2/8/21
SCALE: 1/4"=1'-0"

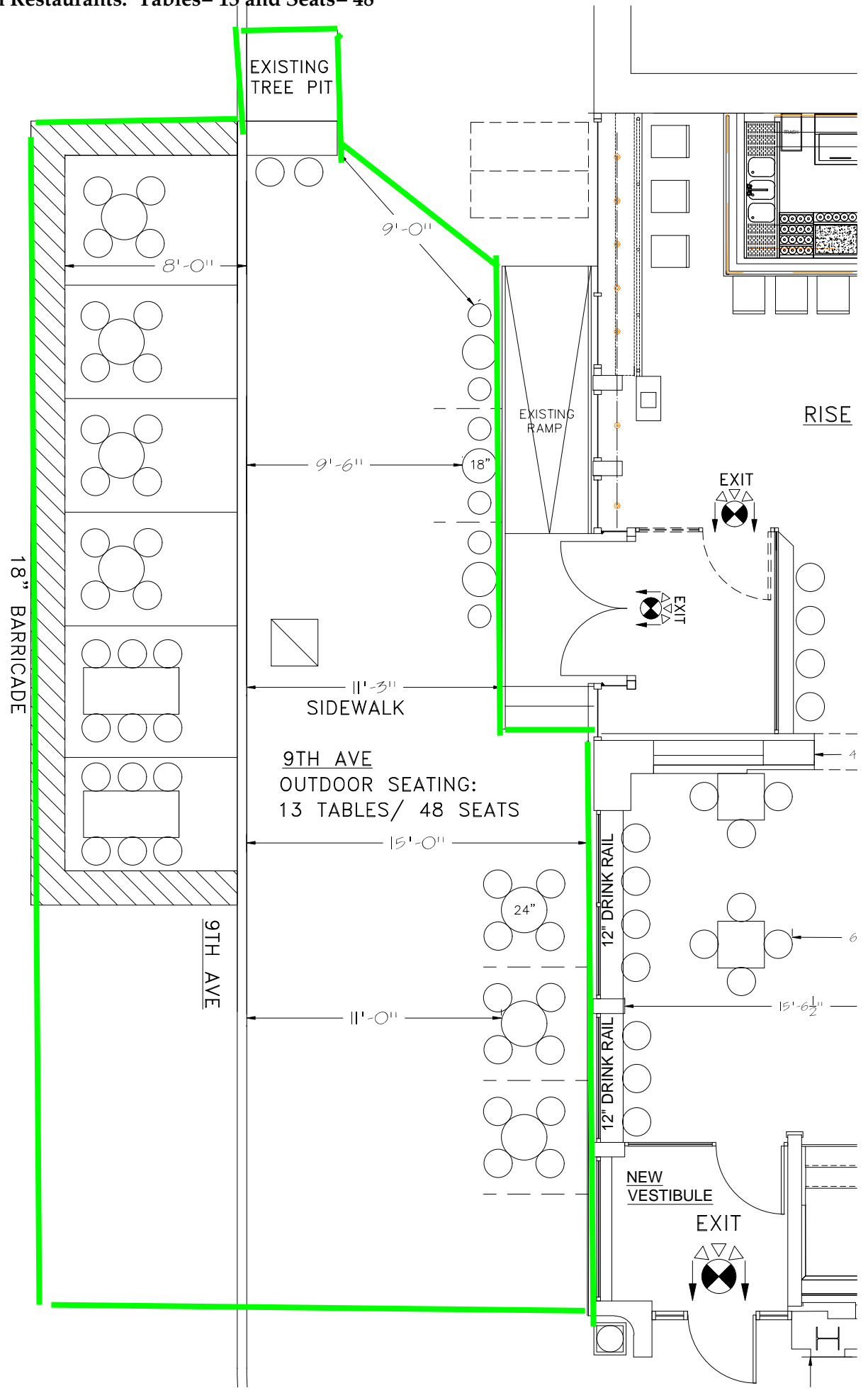

**Rise Bar NYC LLC dba Rise Bar and Lounge / 859 Ninth Avenue, New York, New York 10019 / Serial No. 1278667
 West 56th Street Open Restaurants: Tables= 17 and Seats= 56
 Outlined in green**

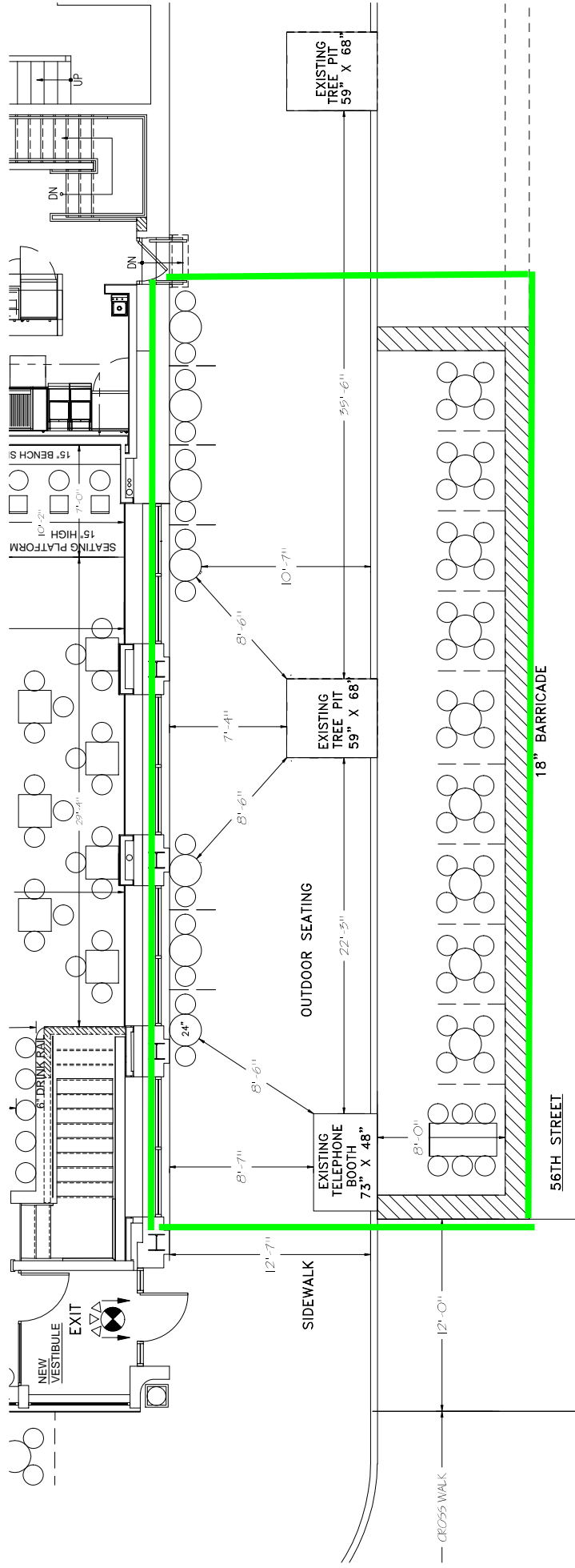

1 RISE OUTDOOR 56TH STREET -2/8/21
 A100 SCALE: 1/4"=1'-0"

Rise Bar NYC LLC
dba Rise Bar and Lounge
859 Ninth Avenue
New York, New York 10019



Rise Bar NYC LLC
dba Rise Bar and Lounge
859 Ninth Avenue
New York, New York 10019



Rise Bar NYC LLC
dba Rise Bar and Lounge
859 Ninth Avenue
New York, New York 10019



Rise Bar NYC LLC
dba Rise Bar and Lounge
859 Ninth Avenue
New York, New York 10019



Rise Bar NYC LLC
dba Rise Bar and Lounge
859 Ninth Avenue
New York, New York 10019



Rise Bar NYC LLC
dba Rise Bar and Lounge
859 Ninth Avenue
New York, New York 10019



Rise Bar NYC LLC
dba Rise Bar and Lounge
859 Ninth Avenue
New York, New York 10019



Rise Bar NYC LLC
dba Rise Bar and Lounge
859 Ninth Avenue
New York, New York 10019



Rise Bar NYC LLC
dba Rise Bar and Lounge
859 Ninth Avenue
New York, New York 10019



Rise Bar NYC LLC
dba Rise Bar and Lounge
859 Ninth Avenue
New York, New York 10019



BAR MENU

EVERYDAY FROM 11:30AM-10PM

BITES

- **LOADED TOTS**

Tater tots with melted cheddar cheese and bacon bits 12

- **NACHOS**

Tortilla chips topped w/ sour cream, guacamole, pico de gallo, black beans, pickled jalapeños, 3 Mexican cheeses 12 add Veggies +\$4. add Chicken +\$5 add Steak +\$6

BURGERS

SERVED WITH PICKLE AND FRIES

- **CHOICE OF:**

goat, cheddar, blue, pepper jack, smoked bacon, fried egg, avocado, sautéed onions, (+ 2 each)

- **THE CLASSIC RISE BURGER 18**

special blend ground beef, beefsteak tomato, butter lettuce, sesame seed bun.

- **MINI SLIDERS 22**

Three Small sliders made with a special blend ground beef, beefsteak tomato, butter lettuce, sesame seed bun.

- **GRILLED TURKEY BURGER 18**

avocado, pickled radish, horseradish mustard, brioche bun

- **VEGGIE BURGER 16**

root slaw, roasted garlic chickpea purée, brioche bun

TACOS

- **GROUND BEEF TACO 7**

Ground beef taco

- **GRILLED CHICKEN 7**

Tomatillo salsa verde, sour cream, crushed tortilla.

- **MUSHROOM AND GOAT CHEESE 7**

Roasted mushrooms, goat cheese, crispy shallots, cilantro.

- **VEGGIE TACO 7**
Oyster mushroom, fingerling potato, poblano, tomato, spring onion, house made creme, Bibb lettuce, rabano, queso fresco, cilantro.
- **CARNITAS TACO 7**
Slow roasted Berkshire pork butt, pickled red onion, roasted chili de arbol, crispy rice, cilantro.
- **SHRIMP TACO 7**
Roasted shrimp with red onions, garlic, black beans, finished with wild marjoram and chili oil drizzle.
- **CARNE ASADA TACO 7**
Sliced Yucatan Hanger Steak, mushroom, house made crema, crispy shallots, cilantro

QUESADILLAS

- **CHEESE QUESADILLA 12**
Jack cheddar cheese quesadilla.
- **CHICKEN QUESADILLA 15**
Chicken and jack cheddar quesadilla.
- **LOADED QUESADILLA 16**
Chicken, jack cheddar, , jalepenos, and red pepper flakes quesadilla.

PIZZAS

- **THE PLAIN JANE 12**
Mozzarella and red sauce
- **THE PAPA PEPPERONI 14**
Mozzarella, pepperoni and red sauce.
- **WILD MUSHROOM 15**
Wild mushrooms, ricotta and mozzarella.
- **MEAT LOVERS 16**
Prosciutto, pepperoni, mozzarella and red sauce.
- **MEXICAN PIZZA 16**
Chicken, jack cheddar, jalepenos, salsa red sauce and red pepper flakes.

BRUNCH

served 11:30am - 4pm on weekends

- **BUILD YOUR OWN OMELETTE 15**
served with home fries and toast. choice of two: goat, cheddar, blue cheese, pepper jack, tomato, avocado, pesto, spinach, wild mushrooms, peppers caramelized onions. Each additional, add +2
- **EGGS BENEDICT 16**
poached eggs, lemon hollandaise, speck, english muffin, breakfast potatoes. Add smoked salmon + 6
- **BEC SANDWICH 15**
soft scrambled eggs, bacon, aged cheddar, avocado, tomato, habanero sauce, brioche bun
- **GRILLED SKIRT STEAK + EGGS** 24**
two eggs any style, home fries egg whites available +2
- **AVOCADO TOAST 10**
Whole wheat Toast, cilantro, Add poached egg +3. Add smoked salmon +6

BREAKFAST SIDES

served until 4pm

- **TWO EGGS ANY STYLE 5**
- **BACON 7**
- **TURKEY BACON 7**
- **COUNTRY HAM STEAK 7**
- **SEASONAL FRUIT BOWL 9**
- **HOME FRIES 5**

RISE SECURITY PLAN

Security Plan Operating 7 days a week. 1 security guard 8pm till closing Sunday – Thursday. Friday – Saturday 6 security guards. 1 security guard from 5-10pm, 5 security guards from 9-Closing.

Sunday: 1 Security Guard 8-CL

Monday: 1 Security Guard 8-CL

Tuesday: 1 Security Guard 8-CL

Wednesday: 1 Security Guard 8-CL

Thursday: 1 Security Guard 8-CL

Friday: 1 Security Guard 5-10PM, 5 security guards 9-CL

Saturday: 1 Security Guard 5-10PM, 5 security guards 9-CL

Installation of Security Cameras will be installed on premises with remote viewing

- 1) ID's will be checked at the door and by bartenders in servers to make sure we are not serving any minors

- 2) All staff member will be well educated and trained making sure not to serve someone that is visibly intoxicated or from entering the premises:
 - >Speech Slurred, Confused, Abusive, profane, antagonistic or incoherent
 - >Appearance in disarray
 - >Balance unsteady, body swaying, using bar or wall to maintain balance
 - >Bloodshot eyes
 - >Fumbling or dropping of glassware, ID, Cash, or personal items
 - >Unusual symptoms: Vomiting, hiccupping, losing focus, sleeping or fainting

- 3) Anti-theft measures will be taken by providing coat check for customers, Signs coming in will tell patrons to keep an eye on your personal belongings. We will also have security on the way in to tell customers to put wallets, phones and cash in their front pockets and again remind them that coat-check is available.

- 4) Sidewalk safety and management will be implemented on the street to keep customers and crowd control respectful to the community. We will continue to use our designated smoking area away from the building where it has not been a hinderance to tenants living above. At Closing the security is to ensure orderliness when patrons are exiting the building. Security should be posted at the front door to keep patrons moving out of the area and to keep the street and sidewalk clear. This also pertains to customers smoking outside, making sure they are doing it in a designated area that is not a hinderance for tenants in the area. Security will remind customers when leaving the building to keep

noise levels down and to not disturb the neighbors. Security should remain at their outside post until the area around the establishment is clear of patrons.

- 5) Handling of any Physical Disturbance or Fights: Security and management will assess the situation and try to separate the two fighting parties and speak with them in order for them to cool down. We will then ask one person to leave and the other one shortly after so they don't continue fighting into the street. If a person starts to become a chronic problem we will ban them from entering the establishment.

Certificate of Occupancy

CO Number: 122451729T008

This certifies that the premises described herein conforms substantially to the approved plans and specifications and to the requirements of all applicable laws, rules and regulations for the uses and occupancies specified. No change of use or occupancy shall be made unless a new Certificate of Occupancy is issued. *This document or a copy shall be available for inspection at the building at all reasonable times.*

A.	Borough: Manhattan Address: 859 9 AVENUE Building Identification Number (BIN): 1026849	Block Number: 01065 Lot Number(s): 36 Building Type: Altered	Certificate Type: Temporary Effective Date: 12/11/2020 Expiration Date: 03/11/2021
This building is subject to this Building Code: Prior to 1968 Code			
<i>For zoning lot metes & bounds, please see BISWeb.</i>			
B.	Construction classification: 3 (Prior to 1968 Code designation) Building Occupancy Group classification: R-2 (2014/2008 Code) Multiple Dwelling Law Classification: HAEA		
	No. of stories: 6	Height in feet: 72	No. of dwelling units: 40
C.	Fire Protection Equipment: None associated with this filing.		
D.	Type and number of open spaces: None associated with this filing.		
E.	This Certificate is issued with the following legal limitations: None		
Outstanding requirements for obtaining Final Certificate of Occupancy:			
There are 21 outstanding requirements. Please refer to BISWeb for further detail.			
Borough Comments: None			



Borough Commissioner



Commissioner

Certificate of Occupancy

CO Number: 122451729T008

Permissible Use and Occupancy						
All Building Code occupancy group designations below are 2008 designations.						
Floor From To	Maximum persons permitted	Live load lbs per sq. ft.	Building Code occupancy group	Dwelling or Rooming Units	Zoning use group	Description of use
CEL		OG	A-2		6A	STORAGE, ACCESSORY OFFICE
CEL	4	OG	A-2		6A	PREP ROOM, BOILER, STORAGE, ACCESSORY OFFICE
001	59	100	A-2		6A	EATING&DRINKING ESTABLISHMENT
001	170	100	A-2		6A	EATING & DRINKING ESTABLISHMENT (EATING OR DRINKING ESTABLISHMENTS, INCLUDING THOSE WITH MUSICAL ENTERTAINMENT BUT NOT DANCING WITH A CAPACITY OF 200 PERSONS OR LESS PRC-B NOT A CABARET. NO OUTDOOR SEATING ARRANGMENT
002 006		40	R-2	8	2	EIGHT (8) APARTMENTS PER FLOOR (OLD LAW TENEMENT)
OLD LAW TENEMENT, CELLAR AND CONVEINENCE STAIR SPRINKLERED.						
END OF SECTION						



Borough Commissioner



Commissioner

END OF DOCUMENT

January 1, 2021

Mr. Theodore Arenas
Rise
859 Ninth Avenue
New York, NY 10019

Re: 603 Tenth Avenue, New York, NY 10019

Dear Mr. Arenas,

I conducted acoustic tests on December 30, 2020 to determine if the vacant store next to Rise should be soundproofed if you expand into that space. Recommendations are provided.

DBA VS ONE-THIRD OCTAVE BAND MUSIC LEVELS

One way that the sound levels were measured was using the A-weighting decibel scale. The dB (A) decibel scale (see Noise Code Section §24-231 a1) is the most common type of sound measurement, which represents an overall measurement of all frequencies, but with a strong tendency to ignore the low-frequency "bass" sounds. The A-weighted decibels require only a simple sound level meter to measure them. DBA is what the City DEP inspectors usually use and they normally consider anything above 42 dBA to be unreasonable.

C-weighted decibels or dBC (see Noise Code Section §24-231 a3) are also an overall measurement of all frequencies, but this measurement includes the important low-frequency "bass" sounds. However, dBC readings pick up so many frequencies at the same time that they usually do not distinguish between normal background noise and music beats.

One-third-octave band sound level readings (see Noise Code Section §24-231 a2) were also taken, which are measured in decibels, or dB. Sounds with frequencies below 250 Hertz are called bass or low frequencies, which sound like thumping or vibration. This range of low frequencies is addressed in the Noise Code regulations and is the sound most likely to cause neighbor complaints. Bass and drums usually cause sounds in these frequency ranges. These sounds require a complex spectrum analyzer to measure them.

The loudest sounds produced by music are in the low frequencies. The loudest sounds produced by voices are in the middle frequencies, so they can be described using dBA levels.

THE NOISE CODE - MUSIC

§24-231 Commercial music.

(a) No person shall make or cause or permit to be made or caused any music originating from or in connection with the operation of any commercial establishment or enterprise when the level of sound attributable to such music, as measured inside any receiving property dwelling unit:

(1) is in excess of 42 dB(A) as measured with a sound level meter; or

(2) is in excess of 45 dB in any one-third octave band having a center frequency between 63 hertz and 500 hertz (ANSI bands numbers 18 through 27, Inclusive), in accordance with American National Standards Institute standard S1.6-1984; or

(3) causes a 6 dBC or more increase in the total sound level above the ambient sound level as measured in decibels in the "C" weighting network provided that the ambient sound level is in excess of 62 dBC.

THE NOISE CODE - UNREASONABLE NOISE

§24-203 General definitions. When used in the New York city noise control code the following terms shall have the following meanings:

(62) Unreasonable noise means any excessive or unusually loud sound that disturbs the peace, comfort or repose of a reasonable person of normal sensitivities, injures or endangers the health or safety of a reasonable person of normal sensitivities or which causes injury to plant or animal life, or damage to property or business.

§24-218 General prohibitions.

(a) No person shall make, continue or cause or permit to be made or continued any unreasonable noise.

This section would apply to very loud voice noise from the customers. Note that Section §24-218 prohibits "unreasonable noise", not *all* noise.

TEST

The vacant store had been "soundproofed" with acoustic tiles under a multilayer sheetrock ceiling. Details of the construction of the sheetrock are not known. However, this is in the same building as Rise so similar construction is likely. The building was gut-renovated a few years ago.

A test loudspeaker was used to simulate loud music and voice sound in the rear area of the future bar/restaurant. The sound level in the center of the space was 99 dBC and 89 dBA. By comparison, your desired level, as measured in the center of the final, finished space would be 94 dBC / 90 dBA. This is 5 dBC below the test level.

Sound levels of transmitted noise were checked on the floor above in 3 different apartments, 1A, 1B and 1D.

RESULTS AND ANALYSIS

Music was heard in all of the apartments but it was loudest in Apartments 1A and 1B.

The leakage in Apartments 1A, 1B and 1D is shown in the graphs below. I have circled the problem frequencies in red.

For example, in the first graph showing the sound levels in Apartment 1A, the loudest frequency was 66 decibels at 100 Hertz. This was not due to outside sources such as traffic or other apartments, but from the music itself.

This level is 21 decibels over the Noise Code 45-decibel limit. The other bass frequencies are also too loud by varying amounts.

Measured Sound Levels

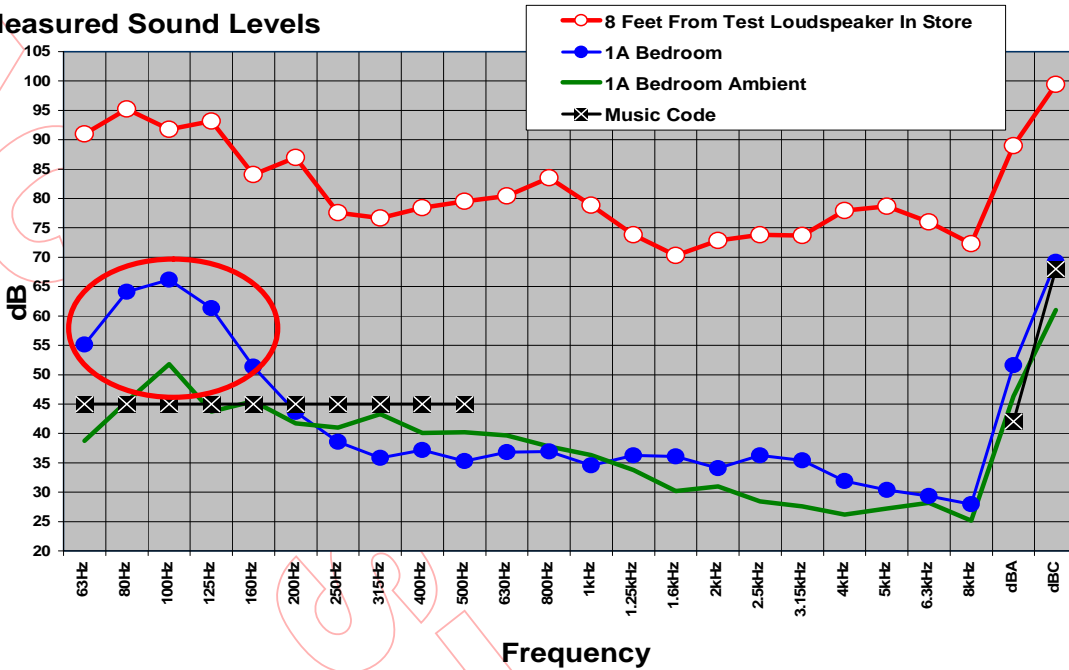

In Apartment 1B, the level was 20 decibels over the Noise Code 45-decibel limit. See the graph below.

Measured Sound Levels

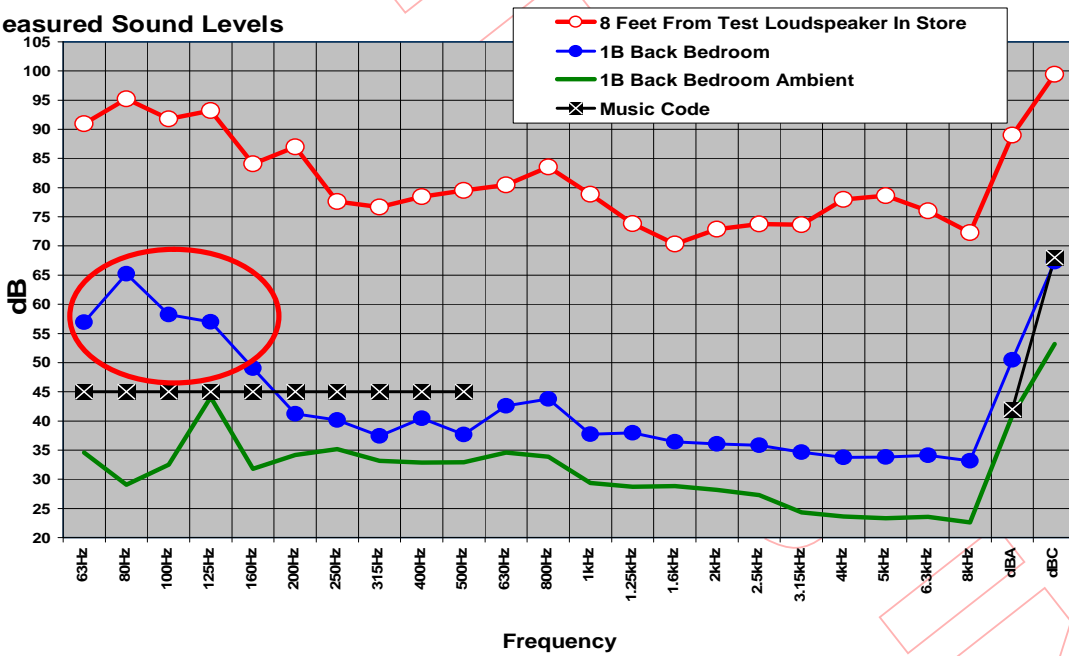

In Apartment 1D, the level was 9 decibels over the Noise Code 45-decibel limit. See the graph below.

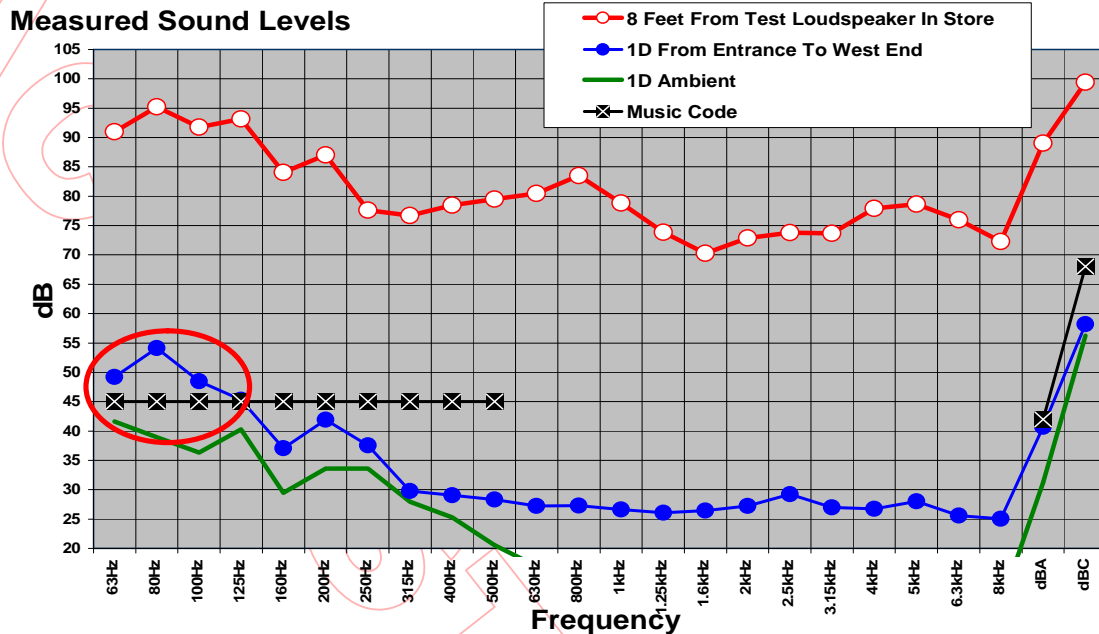

Therefore, the sound level upstairs needs to be reduced, either by lowering the sound system playback levels or by adding soundproofing that is effective in the low-frequency range. This soundproofing would be even more effective for voice frequencies.

Sound leakage in the apartments was primarily coming through the floor; a very minor portion of the noise was entering through the windows, pipes and holes around the pipes.

INSPECTION

The acoustical dropped ceiling in the front end of the restaurant was inspected. Above the lay-in tiles (which provide almost no low-frequency blocking) there are multiple layers of sheetrock in the ceiling but the only spring hangers seen are supporting HVAC equipment. Therefore, it is likely that the sheetrock is rigidly tied to the wood floor joists above. This type of construction is not sufficiently soundproof for your operation and should be improved. The steps below are designed to reduce the sound transmission to prevent excessive noise and include recommendations for the future sound system.

RECOMMENDATIONS

DROPPED CEILING

1. Open a section of the existing ceiling to expose the joists. The space above the existing sheetrock should be completely filled with high-density insulation. This can be done either by blowing fiberglass insulation into the space or by removing the sheetrock and installing batt insulation.
 - a. Thermafiber SAFB, 2.5 pound density, is the best insulation to use here, lightly compressed to fill the cavity. Data attached.
 - b. Use enough batts to completely fill the void between the joists. Do not stuff in the insulation tightly.
 - c. Any existing fiberglass insulation can be left in place as the new insulation is installed.
2. Below the joists (and the existing sheetrock, if left in place) install a dropped ceiling. Install the ceiling soundproofing as shown in the enclosed diagram.
 - a. The new ceiling must be made of 3 layers of 5/8" sheetrock. It must be supported resiliently from the joists using resilient spring/rubber mounts, black iron bars, and metal furring channels. The bottoms of the springs must not touch the top of the black iron. Leave at least 1/2" gap, which will widen when weight of the sheetrock compresses the springs. The Chicago bar connects to the black iron. The springs must be selected for 1" static deflection under the weight of the sheetrock.
 - b. If the existing sheetrock is removed, use Kinetics type ICW spring/rubber mounts, which mount on the side of the joists. Otherwise use Kinetics type SRH hangers, which hang below the joists.
 - c. Kinetics products are available from Vibration Products, 201 569 7400. The Kinetics website is www.kineticsnoise.com, where there are links to their products and ratings. Data attached.
 - d. The hangers will be located on 4-foot centers. At the perimeter and in the corners, a different color-coded spring hanger will be used because there is less weight at these locations. If your contractor faxes a layout of the space, the Vibration Products people will determine the proper type and mix for the order.
 - e. The entire new ceiling must hang below the bottom of the ceiling joists in order to provide a large insulation-filled air space (approximately 12") beneath the bottom of the joists. If the existing sheetrock is left in place, then an additional 12" space between the old and new sheetrock must be provided.
3. The air space above the new sheetrock ceiling must be filled completely with insulation.
4. There must be no openings in the sheetrock dropped ceiling through which sound can pass such as for recessed lights.
5. Do not tape the seams between adjoining layers of sheetrock; only the final layer needs taping. In addition, each layer of sheetrock should be staggered in both directions, so that the seams do not line up with those of the previous layer. This will further reduce sound traveling through the seams.

6. The dropped ceiling must not tie in to any existing walls rigidly. In the area where music will be played, the ceiling will extend to the outside walls, past the top of any interior walls.
 - a. Leave a ¼" gap all around and line it with black ¼" neoprene sponge, available from Canal Rubber Supply, 329 Canal St, phone number (212) 226-7339. Ask for Marty, and say you want the Black SCE42 Closed Cell Neoprene Sponge.
 - b. The metal and the sheetrock of the dropped ceiling will essentially be "floating" near the outside building walls.
 - c. Caulk the bottom of the gap with silicone caulk.
7. With this approach, low-frequency sounds will be reduced by at least 10 decibels, which is a 50% subjective reduction.

INTERIOR WALLS

8. All existing interior walls can extend to the underside of the new dropped ceiling, after it has been completed and the ceiling springs are fully deflected.
9. The walls can not extend up to the existing sheetrock or joists.

PIPES

10. Any pipes or rods which penetrate the new ceiling construction should not rigidly touch it. See the attached pipe-penetration detail.
 - a. Any pipe risers that penetrate the ceiling going to the upper floors must be boxed in with 2 layers of 5/8" sheetrock.
 - b. The pipe should not rigidly touch the sheetrock or framing.
 - c. Pack Thermafiber insulation loosely into the space created by the riser box.

HVAC

11. The air conditioning ducts should be installed below the dropped ceiling to prevent duct penetrations that would allow excessive sound to go upstairs.
12. Treat the duct straps with the same pipe-penetration detail shown.

LIGHTING

13. Track or other surface-mount lighting is recommended rather than recessed lights. This is to prevent sound from exiting through the sheetrock holes.

DOORS

- a. If there will be doors leading to the lobby or other sections of the building, contact me for details.

SOUND SYSTEM

14. Small speakers such as QSC AC-S6T, JBL Control 28-1 or Yamaha VS6 should be used as a distributed system. Data attached.

restaurant, absorbing materials should be added after the shell is built. Several options are described below.

17. The ceiling should get a 1" thick coating of sound-absorbing material with an NRC rating of .7 or greater, over at least 80% of the area. There are several suitable product types which I have attached data for:
- a. SonaKrete: For the ceiling, I recommend SonaKrete, manufactured by International Cellulose Corporation, at 800-444-1252. This material uses no asbestos, fiberglass or rockwool. It is troweled-on to the desired thickness. I would recommend a coating of .75" thickness for this project, directly over the existing ceiling. This product has a rough finish and is available in many colors. I have also provided specs on another product, SonaSpray.
 - b. BASWAphon is a seamless fiber-backed panel that has a troweled-on finish. Contact BASWA acoustic at 440-951-6022 or online at baswaphon.com.
 - c. I have enclosed information regarding *Star Silent* which can be used on sheetrock. Contact Howard Podelski at Pyrok, (914) 777-7070.
 - d. Acoustical absorbing panels: If the following 2" thick Owens Corning 703 panels are covered with a visual barrier such as fabric, screen or slats, they will not be seen and therefore their appearance is not an issue. In some restaurants, clouds or hanging fabric hide the absorbing material from view. Data from Stretch Ceiling Systems is attached.
 - e. Owens Corning SelectSound Black Acoustic Board, not flexible.
 - f. A SelectSound equivalent is SilentCeiling Black, 2" thick 3 lb. density from Sound Acoustic Solutions, 877 399 9697.
 - g. Kinetics Hardside panels. Many different colors of covering fabric are available. They also come with beveled or rounded edges.
 - h. The American Tin Ceilings micro-perforated tin is also an excellent choice, with an NRC of .85.
18. For the walls, treat at least 25% of the area from 42" above the floor up to the ceiling. This is typically done using products like the 1" thick Kinetics Hardside panels. They are available with wall clips.

If I can be of further assistance, please call.

It is strongly recommended that all complicated construction projects get regular inspection visits at critical times, to make sure the system performs properly. This is an optional service which I can provide. All Acoustilog, Inc.-designed information supplied is for the original client and may not be copied in any way for different projects by any architect, consultant, engineer or other party. Copyright Acoustilog, Inc. © 2021. All rights reserved. No reproduction of any type permitted without written permission of Acoustilog, Inc.

Yours Truly,

Alan Fierstein



President
acoustilog1@verizon.net

All readings re: .0002 microbar. Readings taken with Bruel & Kjaer 2250/2260/2270 Analyzer, Bruel & Kjaer 4134, 4135, 4145, 4155, 4165, 4189 or 4190 Microphone, Acoustilog 232A Reverberation Timer. Calibrated to Bruel & Kjaer 4220 Sound Source or Quest CA-15A.



A test loudspeaker produced loud simulated music and voice sound in the rear area of the future bar/restaurant.



Front end of the restaurant

CONFIDENTIAL



The acoustical dropped ceiling of the restaurant was inspected.



There are multiple layers of sheetrock in the ceiling but the only spring hangers seen are supporting HVAC equipment.



Apartment 1B back bedroom

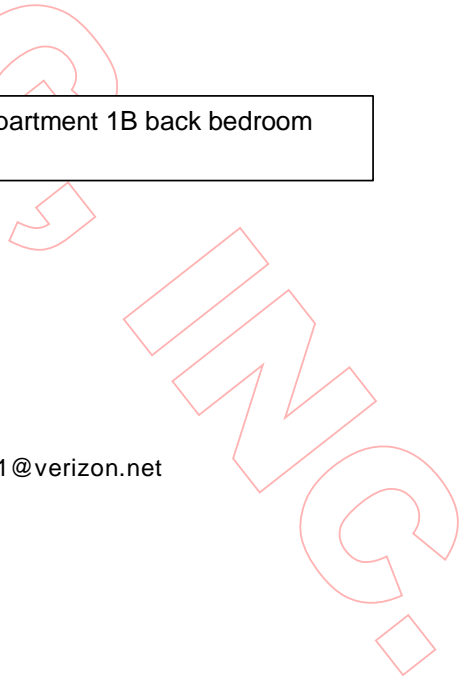

ACOUSTILOG.COM

Sound Control Insulation

Thermafiber® SAFB™

(Sound Attenuation Fire Blankets)

- + Exceptional sound and noise absorption
- + Excellent Thermal Performance (R-value of 3.7 per inch!)
- + Adds STC value to wall and floor-ceiling assemblies
- + Provides life saving fire protection in rated assemblies
- + Fire resistant to temperatures above 2,000°F (1,093°C)
- + Conserves energy, reduces Greenhouse gas and carbon emissions
- + Mold Resistant



Thermafiber SAFBs, FireSpan™, and Safing insulation contributed to the energy conservation, fire protection, and life safety of the #7 World Trade Center building in New York City. Thermafiber insulation also contributed to the building's LEED® Gold Rating.



LEED® Green Building Credits

Energy & Atmosphere	Materials & Resources	Indoor Environmental Quality	Innovation in Design
1	2.1, 2.2 3.1, 3.2 4.1, 4.2 5.1, 5.2	3.1, 3.2 9	1

Up to **90%** Recycled Content

Contributes to 33 LEED credits across 4 categories.

Thermafiber®
THE NAME IN MINERAL WOOL™



Thermafiber SAFBs are installed into an interior steel stud wall cavity.

Thermafiber® SAFB™ (Sound Attenuation Fire Blankets)

Description:

THERMAFIBER Sound Attenuation Fire Blankets (SAFB) are mineral wool batts designed to stop sound, conserve energy, and provide life saving fire protection. These products are noncombustible, moisture-resistant, noncorrosive, nondeteriorating, mildew-proof and vermin-proof. Thermafiber SAFBs provide acoustical control, thermal insulation, and fire protection in many different UL fire rated wall and floor-ceiling assemblies. SAFBs resist temperatures over 2000°F as compared to fiberglass insulation that melts around 1000°F. SAFBs add STCs to wall and floor-ceiling assemblies. See Thermafiber's SAFB Brochure (TF885) for more detail on STC and fire ratings for multiple wall and floor-ceiling assemblies.

Product Options:

- Standard SAFB
 - Creased SAFB – Made 1" wider than standard stud spacing to bow in the stud cavity for increased sound absorption.
 - Recycled Content Options¹:
 - Special "Green" Fiber 90%
 - EPA Choice Fiber (US Government Buildings)..... 75%
 - Standard Fiber 70%
- ¹Recycled content options other than standard must be specified at time of order.

Installation:

- Interior Stud Cavity – Friction fit SAFBs securely between studs. Butt ends of blankets closely together and fill all voids.
- Creased SAFB – Bow the blankets slightly to fit into stud cavity. Slit the blankets vertically 1" deep with a utility knife.
- Floor-Ceiling – Friction fit SAFBs securely between floor joists.
- Ceiling Overlayment – Lay SAFBs over ceiling panels extending 48" beyond all partitions. Tightly fit around all hangers, obstructions, and penetrations.

Standard Sizes:

	Thickness*	Widths**	Lengths**
SAFB 2.5 pcf	1-1/2" - 6"	16", 17", 24", 25"	48"
SAFB 4.0 pcf	1"	16", 17", 24", 25"	48"
Tolerances	+1/4" - 1/8"	±1/8"	±1/2"

*Thicknesses are available in 1/2" increments. **Custom sizes are available upon request.

Technical Data:

Product Designation	Nominal Density	Tested to ASTM C 518		Tested to ASTM E 84	
		"k" @ 75° [24°C] BTU.in/hr.sq. ft. °F	"R" value per inch of thickness***	Flame Spread	Smoke Developed
SAFB	2.5 pcf	0.27	3.7	0	0
SAFB	4.0 pcf	0.24	4.2	0	0

***R = thickness divided by 'k'

Acoustical Performance:

Thickness	Coefficients at Frequencies Per ASTM 423							NRC
	125 Hz	250 Hz	500 Hz	1000 Hz	2000 Hz	4000 Hz		
SAFB 2.5 pcf	0.34	0.61	1.07	1.09	1.07	1.10	0.95	
Density	0.51	0.99	1.18	1.03	0.99	0.96	1.05	
4"	0.83	1.19	1.27	1.12	1.12	1.13	1.20	
6"	1.37	1.32	1.23	1.16	1.12	1.12	1.20	

Standards Compliance:

- SAFB Insulation meets the following:
- NFPA 101** Class A rated interior finish
 - ASTM C 665** Type I, per Federal Specification HH-I-521F
 - ASTM E 136** Rated Non-combustible per NFPA Standard 220
 - ASTM C 1104** Absorbs less than 1% by volume

SAFB products are approved by: New York City Board of Standards & Appeals – (under BSA 35-66-SM, 173-77-M, 249-74-SM, 34-66-SM, & accepted by MEA 207-82-M, Vol. 2)

Thermafiber Insolutions™:

Thermafiber offers industry leading technical and engineering assistance to architects, specifiers, and contractors. These services include CAD drawings, engineering judgments, LEED Credit Information, and product recommendations. Contact our technical services department at 1-888-834-2371, or email technicalservices@thermafiber.com.

For Further Information:

For additional information about these or other Thermafiber products contact us at 1-888-834-2371 or visit our website www.thermafiber.com.

Notice:

THERMAFIBER, Inc. shall not be liable for incidental and consequential damages, directly or indirectly sustained, nor for any loss caused by application of these goods not in accordance with current printed instructions or for other than the intended use. THERMAFIBER liability is expressly limited to replacement of defective goods. Any claim shall be deemed waived unless made in writing within thirty (30) days from date it was or reasonably should have been discovered.

Submittal Approvals:

Job Name	
Contractor	Date





All Acoustilog, Inc. -designed information supplied is for the original client and may not be copied in any way for different projects by any architect, consultant, engineer, or other party.
©Acoustilog Inc. 2012

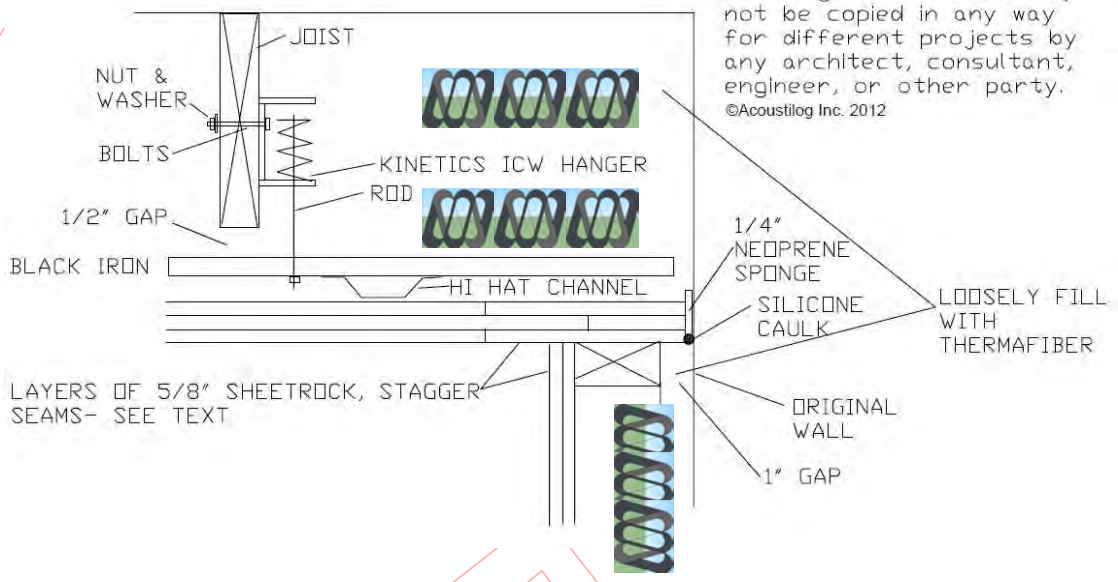

PHOTOGRAPHY



Your source for Noise, Acoustic,
Vibration and Seismic control systems
1-877-457-2695

Login: [Web Programs](#) • [Silencers Online](#)

Search:

Home	Products	Our Company	Locate a Rep	Acoustical Consultants	Contact
Submittal Drawings	Installation Guides	Specifications	Literature	AutoCAD	Seismic Design Manual STC/IIC Test Data

[Home](#) > [Architectural Noise Separation](#) > [Ceiling Isolation Systems](#) > Model ICW

Kinetics™

Wood-Frame Ceiling Hanger

Model ICW



Application

Secured to wood-frame construction (e.g., joists, trusses), Model ICW incorporates a one-inch (1") rated deflection spring in series with a neoprene cup to resiliently support one or more layers of gypsum board. The unique design of the Model ICW bracket allows the isolator to be installed on the joists to optimize ceiling height. A channel clip/leveling rod assembly is designed to carry a single piece of 1-1/2" x 1/2" 16-gage steel carrying channel. Drywall furring channel is attached to the carrying channel. The system provides the installer with a means for leveling the isolated ceiling framing. Gypsum

board attaches quickly and easily thanks to a preload spacer that holds the isolator rigid until the weight of the gypsum board compresses the spring. Incorporate Model ICW into any isolated ceiling design where one-inch (1") rated spring deflection and minimal reduction in ceiling height are needed for superior performance coupled with low-profile design.

Benefits

- Maximum natural frequency of 4.4 Hz under lightest typical load conditions.
- STC 76, IIC 62 with Model ICW attached to 2" x 10" joists and suspending two (2) layers of gypsum board with 3-1/2" fiberglass batt in airspace.
- Multiple features incorporated into the design ensure inexpensive installation.
- Spring/neoprene cup combination improves performance against low-frequency noise.
- Actual installed load can vary between 75% and 150% of rated load without significant impact to ceiling performance.

Model ICW Detail Drawing

Model ICW Ceiling Hanger

[STC/IIC Sound Test Data](#)

[UL Fire Ratings](#)

[UL Design L581](#)

[Data Sheet](#)

[Specification](#)

[Submittal Drawing](#)

[Selection Guidelines](#)

[Installation Guidelines](#)

[Complete Package](#)

PDF Drawings

[Typical Installation Drawing](#)

[Typical Attachment to Engineered Wood I-Joist](#)

[Typical Attachment to Open Web Wood Truss](#)

AutoCAD Drawings

[Typical Installation Drawing](#)

Related Products

[Ceiling Perimeter Tape - Model CPT](#)

[Perimeter Board - Model SRP](#)

Additional Information

Need a quote? Click [here](#) to access local contact information.

Tell a Friend

[Click here to E-Mail this page link to a friend](#)

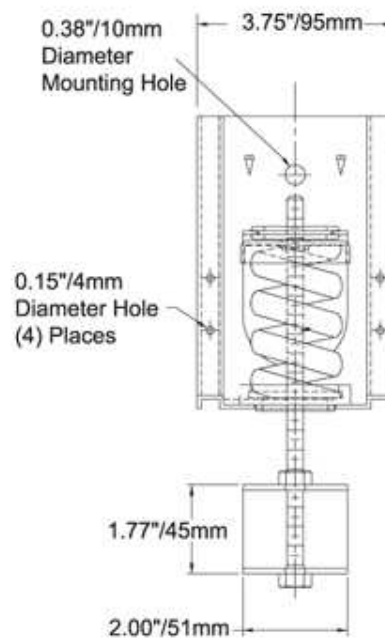
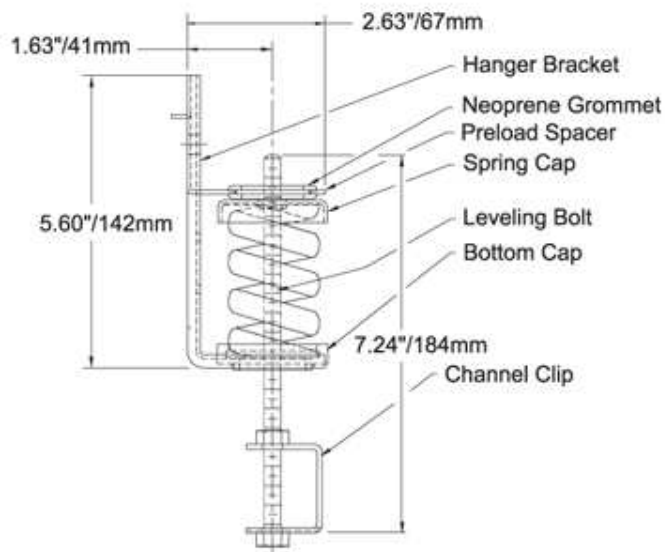

Need a quote? Click [here](#) to access local contact information.

© Kinetics Noise Control, Inc. • P.O. Box 655, Dublin, OH 43017 • Toll Free: 1-877-457-2695 • Fax: 614-889-0540

[Home](#) | [Contact](#) | [Privacy Statement](#) | [Top of Page](#)

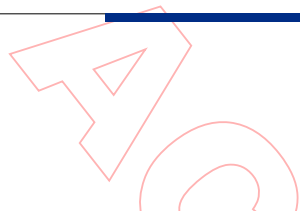

Features

- Epoxy Powder Coated Bracket and Spring Coil
- Self-Centering Cap Patent No. 5,653,426

Application

Kinetics Model SRH hangers are used to isolate suspended sources of both noise and vibration. Suspended mechanical equipment such as in-line fans, cabinet fans, and piping and ductwork in close proximity to mechanical equipment are typical uses of Model SRH hangers featuring the patented **No-Short** self-centering cap.

Kinetics' minimum recommendation for the placement of spring hangers is that they be installed on all piping in the equipment room and on the first 50' (15 m) for piping that extends outside of the equipment room. For typical installations, the three spring hangers closest to the equipment should have equal deflection to the equipment isolators. The remaining spring hangers should have a minimum deflection of 1" (25 mm). In noise sensitive areas, the pipe hangers selected should have the same deflection as that specified for the equipment isolation and all piping in the building should be isolated.

High sound transmission loss ceiling systems can be isolated by the use of Model SRH hangers in the ceiling suspension system.

Standard Model SRH hangers are shipped fully assembled and ready for installation in threaded metal rod suspension systems.

Model SRH hangers are available in a wide range of load and static deflection selections and can be provided with labor-saving accessories for adaption to wire or strap suspension systems, and may be preloaded or provided with positioning plates for ease in erecting piping at a fixed elevation.

Self-Centering No-Short Cap



How the self-centering no-short cap works:

Indexed steps in spring cap correspond to standard washer diameters for the appropriate rod diameter. The washer and rod stay centered in the cap.

Patent No. 5,653,426

KINETICS

1" and 2" Deflection Isolation Hangers

Model SRH



Description

Kinetics Model SRH vibration isolation hangers consist of free-standing, large diameter, laterally stable steel springs in series with an elastomer-in-shear insert, assembled into a stamped or welded hanger bracket. To assure stability, the spring element has a minimum lateral spring stiffness of 1.0 times the rated vertical stiffness. Hangers with properly deflected coils will allow a support rod misalignment through a 30° arc without short circuiting. Isolation brackets will carry a 500% overload without failure. Hangers are available in deflections from 1.20" to 2.40" (30 to 61 mm), and in capacities from 35 to 3500 lbs. (16 to 1588 kg). Model SRH hangers are superior to hangers which incorporate only springs, which can transmit noise through the all metal construction, and hangers which incorporate only pads, which can transmit low frequency vibration. Kinetics Model SRH hangers are recommended for the isolation of vibration produced by suspended mechanical equipment, low-speed suspended fans, transformers, ductwork, piping, etc.

Isolator Type	Spring Color	Rated Capacity		Rated Deflection		Spring O.D.		L		H		W		A		Dmax	
		Lbs	kg	In.	mm	In.	mm	In.	mm	In.	mm	In.	mm	In.	mm	In.	mm
SRH-1-35	Blue	35	16	1.61	41	1.75	45	1.72	44	7.38	187	3.69	94	2.25	57	0.63	16
SRH-1-70	Green	70	32	1.55	39	1.75	45	1.72	44	7.38	187	3.69	94	2.25	57	0.63	16
SRH-1-125	Gray	125	57	1.56	40	1.75	45	1.72	44	7.38	187	3.69	94	2.25	57	0.63	16
SRH-1-245	Brown	245	111	1.52	39	1.75	45	1.72	44	7.38	187	3.69	94	2.25	57	0.63	16
SRH-1-370	Orange	370	168	1.29	33	1.75	45	1.72	44	7.38	187	3.69	94	2.25	57	0.63	16
SRH-1-500	Beige	500	227	1.45	37	1.75	45	1.89	48	7.38	187	3.69	94	2.25	57	0.63	16
SRH-1-600	Chrome	600	273	1.35	34	1.75	45	1.89	48	7.38	187	3.69	94	2.25	57	0.63	16
SRH-1-700	Beige/Wh	700	318	1.40	36	1.75	45	1.89	48	7.38	187	3.69	94	2.25	57	0.63	16
SRH-1-805	Chr/Wh	805	365	1.25	32	1.75	45	1.89	48	7.38	187	3.69	94	2.25	57	0.63	16
SRH-1-250	Blue	250	113	2.12	54	3.00	76	2.00	51	8.59	218	5.58	142	3.63	92	0.88	22
SRH-1-450	Green	450	204	1.94	49	3.00	76	2.00	51	8.59	218	5.58	142	3.63	92	0.88	22
SRH-1-625	Black	625	283	1.80	46	3.00	76	2.00	51	8.59	218	5.58	142	3.63	92	0.88	22
SRH-1-800	Gray	800	363	1.55	39	3.00	76	2.00	51	8.59	218	5.58	142	3.63	92	0.88	22
SRH-1-1000	Red	1000	454	1.45	37	3.00	76	2.00	51	8.59	218	5.58	142	3.63	92	0.88	22
SRH-1-1250	Brown	1250	567	1.38	35	3.00	76	2.00	51	8.59	218	5.58	142	3.63	92	0.88	22
SRH-1-1700	Orange	1700	771	1.35	34	3.00	76	2.00	51	8.59	218	5.58	142	3.63	92	0.88	22
SRH-1-2200	Org/Gray	2200	998	1.52	39	3.00	76	1.85	47	9.50	241	5.00	127	4.75	121	0.88	22
SRH-1-2465	Blue	2465	1118	1.58	40	3.00	76	1.85	47	9.50	241	5.00	127	4.75	121	0.88	22
SRH-1-2865	Blu/Gray	2865	1300	1.69	43	3.00	76	1.85	47	9.50	241	5.00	127	4.75	121	0.88	22
SRH-1-3500	Blu/Brn	3500	1588	1.82	46	3.00	76	1.85	47	9.50	241	5.00	127	4.75	121	0.88	22
SRH-2-35	Blue	35	16	2.09	53	1.75	45	1.72	44	7.38	187	3.69	94	2.25	57	0.50	13
SRH-2-70	Green	70	32	2.19	56	1.75	45	1.72	44	7.38	187	3.69	94	2.25	57	0.50	13
SRH-2-120	Gray	120	54	2.32	59	1.75	45	1.72	44	7.38	187	3.69	94	2.25	57	0.50	13
SRH-2-220	Brown	220	100	2.29	58	1.75	45	1.72	44	7.38	187	3.69	94	2.25	57	0.50	13
SRH-2-260	Blue	260	118	2.21	56	3.00	76	1.75	44	8.59	218	5.58	142	3.63	92	0.88	22
SRH-2-465	Green	465	211	2.01	51	3.00	76	1.75	44	8.59	218	5.58	142	3.63	92	0.88	22
SRH-2-720	Black	720	327	2.07	53	3.00	76	1.75	44	8.59	218	5.58	142	3.63	92	0.88	22
SRH-2-850	White	850	386	1.97	50	3.00	76	1.75	44	8.59	218	5.58	142	3.63	92	0.88	22
SRH-2-1025	Beige	1025	465	1.99	51	3.00	76	1.75	44	8.59	218	5.58	142	3.63	92	0.88	22
SRH-2-1200	Chrome	1200	544	2.00	51	3.00	76	1.75	44	8.59	218	5.58	142	3.63	92	0.88	22
SRH-2-2000	Orange	2000	907	2.08	53	5.00	127	1.75	44	12.00	305	6.00	152	6.00	152	1.00	25
SRH-2-2500	Blue	2500	1134	2.10	53	5.00	127	1.75	44	12.00	305	6.00	152	6.00	152	1.00	25
SRH-2-2750	Blu/Blu	2750	1247	2.12	54	5.00	127	1.75	44	12.00	305	6.00	152	6.00	152	1.00	25
SRH-2-3025	Blu/Grn	3025	1372	2.14	54	5.00	127	1.75	44	12.00	305	6.00	152	6.00	152	1.00	25
SRH-2-3250	Blu/Blk	3250	1474	2.14	54	5.00	127	1.75	44	12.00	305	6.00	152	6.00	152	1.00	25

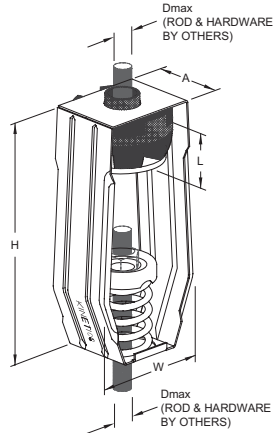

Specifications

Vibration isolators for suspended equipment with minimum static deflection requirement exceeding 0.4" (10 mm), and where both high and low frequency vibrations are to be isolated, shall be hangers consisting of a laterally stable spring in series with an elastomer-in-shear insert complete with load transfer plates and assembled in a stamped or welded steel bracket.

The bracket shall be finished with an epoxy-based powder coating. The manufacturer shall provide independent laboratory testing showing that the bracket with this finish has endured a minimum of 1,000 hours of exposure to salt spray fog testing per ASTM B117 without signs of corrosion.

The elastomer insert shall be molded from oil-resistant compounds and shall be color coded to indicate load capacity and selected to operate within its published load range.

The spring element shall have a minimum lateral stiffness of 1.0 times the rated vertical stiffness.

Springs shall be color coded or otherwise identified to indicate load capacity.

The hanger bracket shall be designed to carry a 500% overload without failure and to allow a support rod misalignment through a 30° arc without metal-to-metal contact or other short circuit.

The hanger bracket shall incorporate spring caps with indexed steps which correspond to the washer diameter of the appropriately sized hanger rod to keep the rod centered in the spring cap and reduce rod misalignment.

Isolation hangers shall be selected by the manufacturer for each specific application to comply with deflection requirements as shown on the *Vibration Isolation Schedule* or as indicated on the project documents.

The combination isolation hanger assembly with neoprene insert shall be Model SRH, as manufactured by Kinetics Noise Control, Inc.



United States
 6300 Irelan Place
 P.O. Box 655
 Dublin, Ohio 43017
 Phone: 614-889-0480
 Fax: 614-889-0540

Canada
 3570 Nashua Dr.
 Mississauga, Ontario
 L4V 1L2
 Phone: 905-670-4922
 Fax: 905-670-1698

www.kineticsnoise.com
sales@kineticsnoise.com

Kinetics Noise Control, Inc. is continually upgrading the quality of our products. We reserve the right to make changes to this and all products without notice.

SRH 1" DEFLECTION ISOLATION HANGERS IP UNITS (INCHES AND POUNDS)

TYPE	L	H	W	A	Dmax
1-35/370	1.72	7.38	3.69	2.25	0.63
1-500/805	1.89	7.38	3.69	2.25	0.63

STANDARD RATINGS		SPRING COIL				INSERT COLOR		
		SIZE	LOAD DEF.	OUTER COLOR	FREE INNER		HT.	O.D.
SRH	1-35	35	1.61	BLUE		3.19	1.75	BLACK
SRH	1-70	70	1.55	GREEN		3.19	1.75	BLACK
SRH	1-125	125	1.56	GRAY		3.19	1.75	BLACK
SRH	1-245	245	1.52	BROWN		3.19	1.75	GREEN
SRH	1-370	370	1.29	ORANGE		3.19	1.75	WHITE
SRH	1-500	500	1.45	BEIGE		3.19	1.75	WHITE
SRH	1-600	600	1.35	CHROME		3.19	1.75	PURPLE
SRH	1-700	700	1.40	BEIGE	WHITE	3.19	1.75	PURPLE
SRH	1-805	805	1.25	CHROME	WHITE	3.19	1.75	YELLOW

*

*

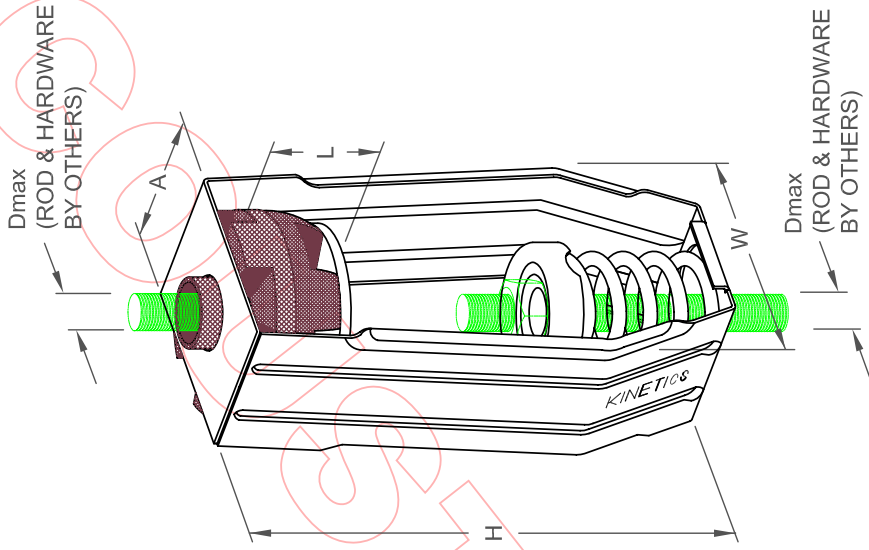

SPECIFICATIONS:

- SPRING ELEMENTS AND BRACKETS ARE POWDER-COATED
- LOAD PLATES ARE BRIGHT ZINC PLATED
- ISOLATION HANGERS HAVE A TYPICAL OVERLOAD OF 50%
- ISOLATION HANGERS HAVE A MINIMUM K_x/K_y RATIO OF 1.0
- SPRING ELEMENTS ARE SAFE AT SOLID LOADING
- HANGER BRACKETS WILL CARRY (5) TIMES OVERLOAD WITHOUT FAILURE
- HANGER BRACKETS WILL ALLOW .30" ROD MISALIGNMENT WITHOUT SHORT CIRCUITING, EXCEPT AS NOTED (*)
- ISOLATION HANGERS MARKED (*) HAVE A NEOPRENE BOTTOM SPRING CAP WITH GROMMET
- "NO SHORT" STEP CAP



Member
VISCOM
Vibration Isolation and Seismic Control Manufacturers Association

KINETICS NOISE CONTROL, INC
6300 IRELAN PL.
DUBLIN, OH 43017 USA
Ph: 614 889-0480, Fax: 614 889-0540
www.kineticsnoise.com

Model: **SRH**
1-35/805

By: **JMJ**
Date: **02/25/03**
Revised: /

Drawing No:
S-03.37-11

ACOUSTIFILL

All Acoustilog, Inc. -designed information supplied is for the original client and may not be copied in any way for different projects by any architect, consultant, engineer, or other party.

©Acoustilog Inc. 2012

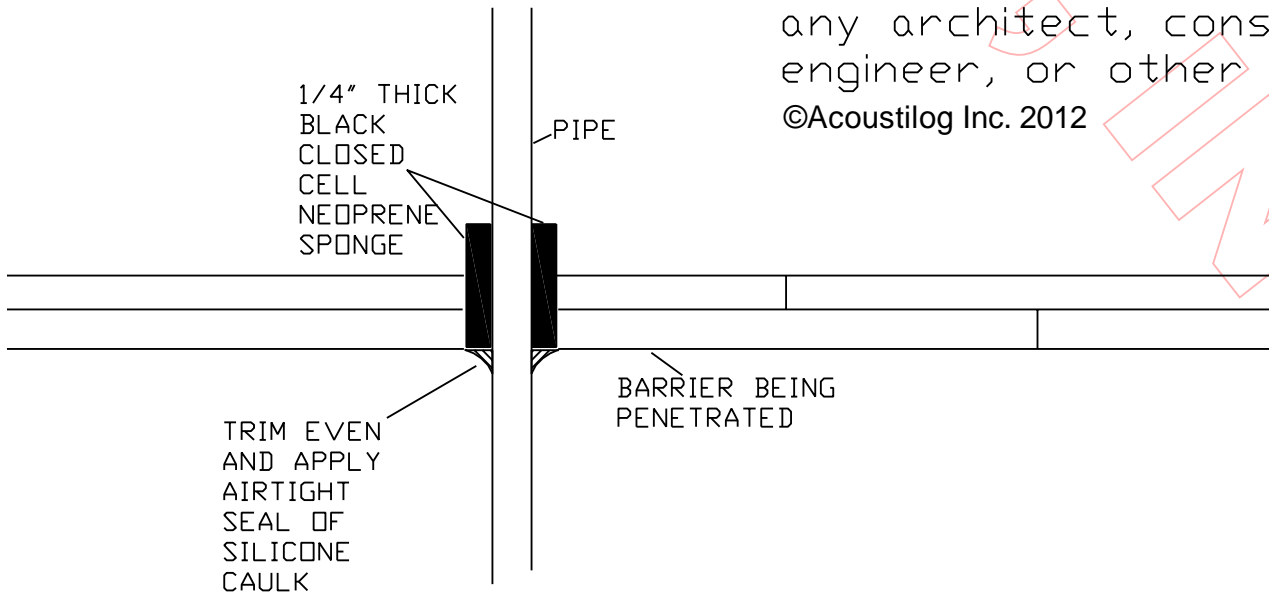

QSC

AcousticCoverage™ Series

AC-S6T

Small format, surface mount
loudspeaker

Features

- High quality transducers provide exceptional clarity through the critical voice range.
- Improved musicality often not seen in typical BGM class products.
- Ported baffle for increased low frequency extension down to 70 Hz.
- Low saturation 70/100V transformers with 8 ohm bypass.
- 4-pole Euroblock connector eases system wiring.
- Advanced voicing via QSC Intrinsic Correction™, applied using Q-SYS™ Platform or CXD Series amplifier platforms.
- Available in black (RAL 9011) or white (RAL 9010)
- Complete EASE, CAD & BIM information available online



Wide Area Paging · Background Music · Distance Conferencing Reinforcement · Healthcare Facilities · Concourses · Transportation Terminals · Ancillary Support in Larger Systems

The QSC AcousticCoverage™ Series AC-S6T is a surface mounted 6.5" two-way loudspeaker with 70/100V transformer, suitable for a wide variety of audio/video conferencing reinforcement, voice paging and background music applications.

AcousticCoverage™ Series is designed to offer integrators a cost effective solution for applications where voice reinforced coverage is of primary concern, while providing improved musicality often not seen in typical BGM class products.

A high quality 165 mm [6.5 in] polypropylene cone transducer with butyl rubber surround and a 25 mm [1 in] aluminium dome tweeter offers pristine clarity through the critical vocal range for increased speech intelligibility. With 130 degrees of conical coverage, the AC-S6T reduces the number of loudspeakers required for even coverage in close proximity.

The UV treated high impact ABS enclosure and ported baffle assembly has been optimally tuned for added musicality, creating low frequency extension down to 60 Hz. To maintain this frequency response, the AC-S6T utilizes a 30-watt low-saturation and low-loss 70/100V transformer with varying selectable taps, including an 8Ω bypass.

To further enhance performance and speed of install with optimum result, advanced voicing via QSC Intrinsic Correction™ techniques are obtainable using Q-SYS™ Platform and in CXD Series amplifiers for a complete QSC systems solution.

Installers will appreciate the 4-pole Euroblock connector for loop thru wiring, located on the rear of the enclosure. Eliminating the termination hassles of star topology wiring designs, the generous Euroblock of the AC-S6T can accept four 18AWG pairs.

The AC-S6T features brass inserts to accept the included yoke mount and is secured using the supplied thumb bolts. The grille is adorned with a spring loaded and rotatable logo for installation convenience in either horizontal or vertical deployments.

The AC-S6T is available in white (RAL 9010) or black (RAL 9011) to match complimenting QSC product families. The AC-S6T may also be painted to match any décor.

To assist in successful systems integration, complete EASE, CAD, and BIM files are available for download online.

AC-S6T Details

Beamwidth:

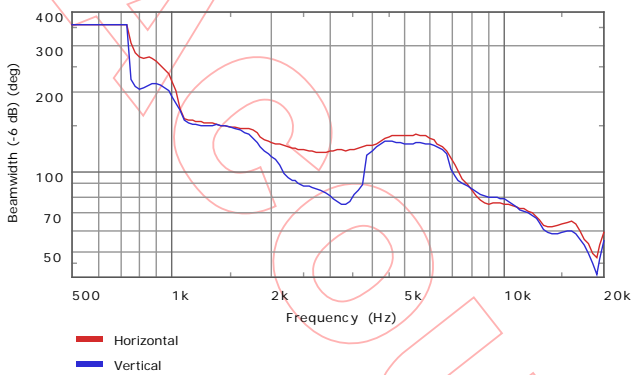

Impedance / Frequency Response:

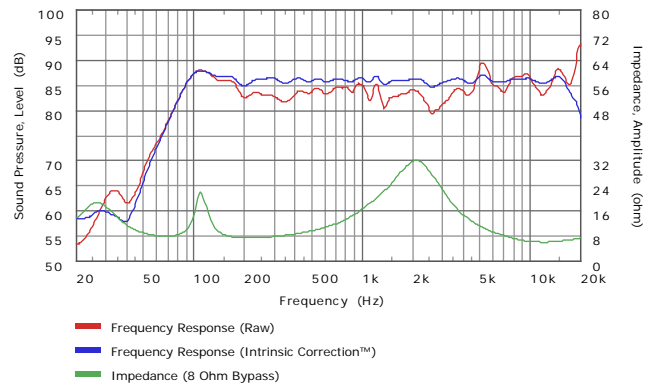

Dimensions:

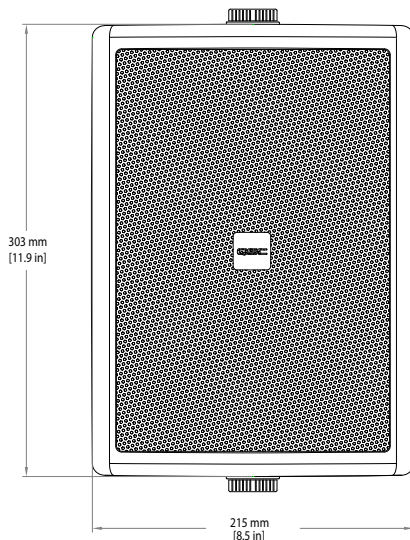
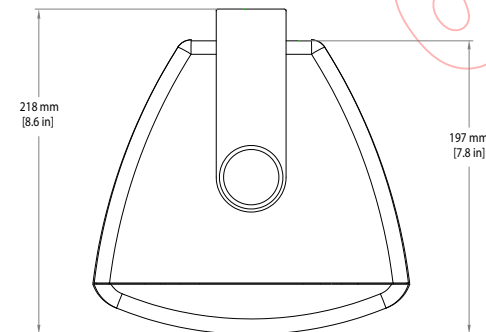

Specifications:

System Details	AC-S6T
Effective frequency range ¹	60 Hz – 20 kHz
Rated noise power / voltage ²	30 watts / 15.5 volts (rms)
Broad-band sensitivity ³	86 dB SPL
Coverage angle (-6 dB)	130° conical (500 Hz - 5 kHz)
Directivity factor (Q)	6
Directivity Index	8 dB
Maximum continuous SPL ⁴	101 dB
Maximum peak SPL ⁴	107 dB
Rated impedance	8 ohms
Recommended amplifier	60 watts
Transformer taps	70 V: 30, 15, 7.5, 3.7, 1.9 watts 100V: 30, 15, 7.5, 3.8 watts 8 ohm bypass
LF transducer	165 mm [6.5 in] Polypropylene woofer 25 mm [1 in] voice-coil
HF transducer	25 mm [1 in] Aluminium dome tweeter 25 mm [1 in] voice-coil
Input connector type	Euroblock connector with parallel output
Enclosure material	UV treated, high impact ABS polymer
Grille material	Powder coated steel
Yoke material	Powder coated steel, brass inserts
Enclosure Details	
Ingress protection	IP-44
Operating environment	Designed for indoor use
Operating Temperature Range	-20 to 50° C [-4 to 122° F]
Net weight	3.8 kg [8.3 lb]
Product dimensions	303 x 215 x 197 mm [11.9 x 8.5 x 7.8 in]
Shipping weight	8.4 kg [18.6 lb] (pair, packed)
Shipping dimensions	359 x 267 x 470 mm [14.1 x 10.5 x 18.5 in] (pair packed)
Included accessories	Yoke mount system, euroblock connector

¹ Free-field, -10 dB from on-axis sensitivity

² IEC60268-1 noise signal for 2 hours

³ On-Axis, free-field sensitivity, 2.83V, 1 m

⁴ Calculated from rated noise voltage and sensitivity

As part of QSC's ongoing commitment to product development, specifications are subject to change without notice.

QSC

1675 MacArthur Boulevard • Costa Mesa, CA 92626 • Ph: 800/854-4079 or 714/957-7100 • Fax: 714/754-6174

© 2016 QSC, LLC all rights reserved. QSC and the QSC logo are registered trademarks of QSC, LLC in the U.S. Patent and Trademark office and other countries. AcousticCoverage, Intrinsic Correction and Q-SYS are trademarks of QSC. All other trademarks are the property of their respective owners. Patents may apply or be pending.





CONTROL 28-1

High Output Indoor/Outdoor Background/Foreground Speaker

Professional Series

Features:

- ▶ Components:
 - 8" woofer with woven fiberglass cone
 - 1" PEI diaphragm tweeter with fluid cooling
- ▶ Contemporary, high-design appearance
- ▶ Built-in InvisiBall® mounting hardware*, plus available U-bracket
- ▶ Weather resistant enclosure and transducers
- ▶ Wide 100° x 100° coverage
- ▶ 120 Watt power handling (240 Watt program) in direct 8Ω setting, plus built-in 60 Watt 70V/100V multi-tap transformer.
- ▶ High fidelity sound character with broad frequency response of 45 Hz – 20 kHz.



Applications:

The Control® 28-1 is a two-way 8" speaker with rich sonic character, wide coverage, consistent coverage, versatile mounting, and a contemporary high-design look that fits into a wide range of decors. This makes Control 28-1 an excellent choice for a wide variety of applications, including retail stores, restaurants, health clubs, theme parks, educational facilities, hospitality, music cafes, leisure venues, and anywhere where a top quality high-output indoor/outdoor foreground/background music (and/or paging) speaker is required.

The unique InvisiBall mounting hardware is included in with each system, making short work of permanent installation. The InvisiBall mounting method provides a high degree of both vertical and horizontal rotation, and because InvisiBall adjustments are made through a hidden access behind the logo badge, the grille never needs to be removed and there exists a high degree of theft deterrence as well. Integrated M6 mounting points for an optional U-bracket adds to the installation versatility.

The LF driver's woven fiberglass cone provides durability and weather capable performance. The light weight high temperature fiberglass voice coil former and high temperature voice coil wire ensures stable performance under long-term high-power working conditions while also providing high sensitivity and high power capability. The pure butyl rubber surround delivers clean sound and ruggedness, while terminating its circumference in JBL's WeatherEdge™, a seamless, rubberized extension of the woofer surround that provides added protection to critical transducer elements. Cone geometry is optimized for smooth frequency response and good off-axis performance, while an FEA-optimized motor construction and linear suspension spider helps to lower harmonic distortion.

The HF driver's low viscosity ferro-magnetic fluid increases voice coil cooling for higher long-term power handling. The PEI diaphragm delivers a smooth high frequency sound quality. A light weight Kapton™ voice coil former increases durability while providing better high frequency response extension. All these factors also contribute toward making the driver especially rugged for outdoor and other stressful applications.

In addition to the driver designs contributing toward a high degree of weather resistance, the cabinet provides excellent endurance against sun, salt and moisture. Grilles are heavily zinc-plated and finished in a tough, high-grade powder coating for rust resistance, and optional MTC-28WMG-1 WeatherMax™ grilles are available for especially difficult environments and to break up driving rain. Connection is made via weather-capable screw-down terminals, and the optional MTC-PC2 and MTC-PC3 panel covers are available to protect the terminal compartment, providing a water-tight sealed gland-nut entrance (when used with round-jacketed cable within the specified diameter range).

The frequency response is extremely smooth, resulting in a very natural sound character, and the response extends down to 45 Hz, providing strong bass capability. The system is capable of handling 120 Watts continuous pink noise (240 Watts program) at its 8 ohm setting and is also equipped with a built-in 60 Watt 70V/100V multi-tap transformer for operation on distributed speaker lines. The combination of high sensitivity and power handling provides high Max SPL of 112 dB.

The Control 28-1 readily accepts a variety of paints and finishes to match any décor. Available in black or white (-WH).

CONTROL 281 High Output Indoor/Outdoor Background/Foreground Speaker

Specifications:

Frequency Range (-10 dB):	45 Hz to 20 kHz
Frequency Response (+/-3 dB):	62Hz - 16 kHz
Power Rating ² :	240 W Continuous Program (2 hrs) 120 W (480W peak), Continuous Pink Noise (2 hrs) 90 W (360W peak) Continuous Pink Noise (100 hrs)
Maximum Input Voltage:	27.5 V RMS (2 hrs), 55.0 V peak
Maximum SPL ³ :	112 dB ave. Continuous Pink Noise (118 dB peak)
Sensitivity ⁴ :	91 dB, 1W/1m (ave. 100 Hz – 10 kHz)
Coverage Angle ⁵ :	100° x 100°
Directivity Factor (Q):	7.3 (averaged 1kHz – 16kHz)
Directivity Index (DI):	8.3dB (averaged 1kHz – 16kHz)
Nominal Impedance:	8 ohms (THRU setting)
Crossover Type:	2nd order low-pass, 1st order high-pass, plus conjugate shaping
Circuitry:	
Transformer Taps:	70V: 60W, 30W, 15W, 7.5W 100V: 60W, 30W, 15W Insertion Loss: <0.94 dB at any tap setting Thru Setting: 8Ω nominal
Recommended Protective High-Pass ⁶ :	45 Hz high-pass (24 dB/oct) for 8Ω operation plus 15W and 7.5W taps; 55 Hz for 30W tap; 65 Hz for 60W tap.
Transducers:	
Low Frequency Driver:	200 mm (8 in), woven-fiberglass cone with pure butyl rubber surround with Weather-Edge frame protection, high-temp fiberglass voice coil former, high-temp voice coil wire, optimized cone geometry, linear suspension spider, and FEA optimized motor structure.
High Frequency Driver:	25 mm (1 in) PEI diaphragm, low-viscosity ferro-magnetic fluid, and lightweight Kapton™ voice coil former.
Physical:	
Enclosure Material:	High Impact Polystyrene (HIPS) with 10% glass fill, painted with highly-UV resistant paint on white (-WH) version for maximum UV fade resistance.
Grille:	Highly zinc-plated, finished in durable TGIC polyester powdercoating. MTC-28WMG-1 (&-WH) available with WeatherMax™ multi-layer foam and tight-weave mesh vapor barrier backing.
Installation:	InvisiBall wall-mounting system included. Two 6 mm attachment points (on top and bottom) for optional MTC-28WMG-1 (&-WH) U-bracket. Secondary safety attachment loop point on back panel.
Environmental:	IP-44 per IEC529 (IP-55 when installed with the optional MTC-28WMG-1 WeatherMax™ grille and either MTC-PC2 or MTC-PC3 panel cover.) Exceeds MilSpec 810 for humidity, salt-spray, temperature & UV. Passes MilStd-202F for salt spray and ASTM G85 for acid-air plus salt spray. Optional MTC-28WMG-1 WeatherMax™ grille for breaking up driving rain and for especially difficult environments.
Termination:	Screw-down terminal strip, zinc-plated copper based, nickel-plated metal screws and washers. Accepts up to 9 mm outside 4 mm inside open lugs (#6, #8, or #10 lug), plus bare wire (up to 12 AWG / 2.5 mm ²). Optional MTC-PC2 and MTC-PC3 protective panel covers available to provide sealed entrance for additional weather protection.
Agency Rating:	ROHS-compliant; Transformer UL Recognized per UL1876
Colors:	Black (RAL9004) or white (-WH, RAL9016)
Dimensions (H x W x D) ⁷ :	386 x 282 x 219 mm (15.2 x 11.1 x 8.6 in); 277 mm (10.9 in) deep total when mounted on InvisiBall wall-mount bracket.
Net Weight:	6.8 kg (15.0 lbs)
Shipping Weight:	15.4 kg (34 lbs) pair-packed (for 2 speakers)
Included Accessories:	InvisiBall™ wall-mounting system), 6 mm x 180 mm hex key
Optional Accessories:	MTC-28UB-1 – Yolk-type U-bracket (&-WH) MTC-28WMG-1 – WeatherMax grille with backing (&-WH) MTC-28/25CM – Ceiling-Mount InvisiBall adapter (&-WH)

¹ In half-space (on-wall, 2π).

² At 8Ω setting. Continuous Pink Noise rating is IEC-shaped pink noise with a 6 dB crest factor. Continuous Program Power is defined as 3 dB above the Continuous Pink Noise Rating and is a conservative expression of the system's ability to handle normal speech and music program material.

³ Calculated from sensitivity and power handling, exclusive of power compression, at THRU setting.

⁴ Half-space (on-wall) averaged 100 Hz – 10 kHz, 2.83V.

⁵ Coverage angle (-6 dB) average between 600 Hz and 12 kHz.

⁶ For protection against driving below resonant frequency and to keep transformer out of saturation.

⁷ In vertical orientation

Frequency Response

On-Axis in half-space (2π , solid line) and full-space (4π , dotted line) at thru (8Ω) setting Input Impedance

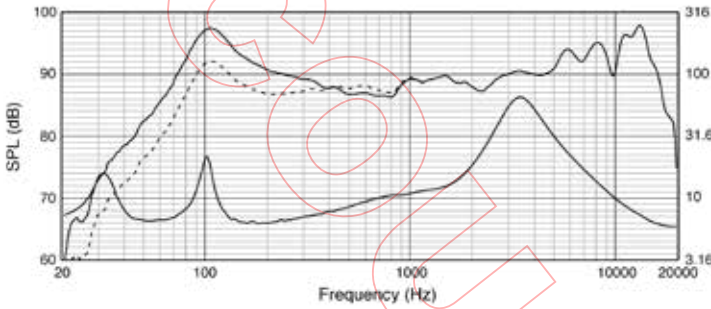

Beamwidth

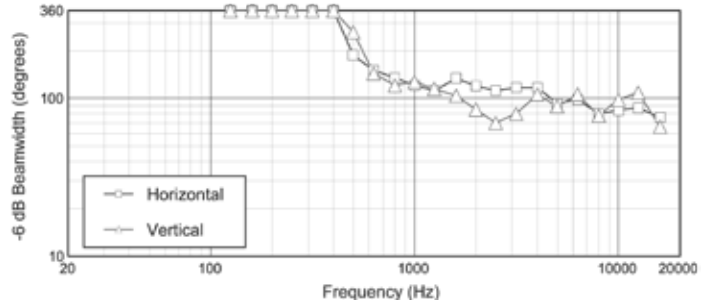

Dimensions:

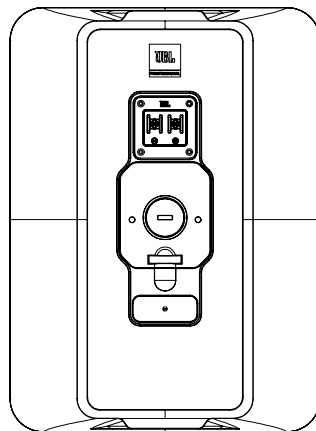
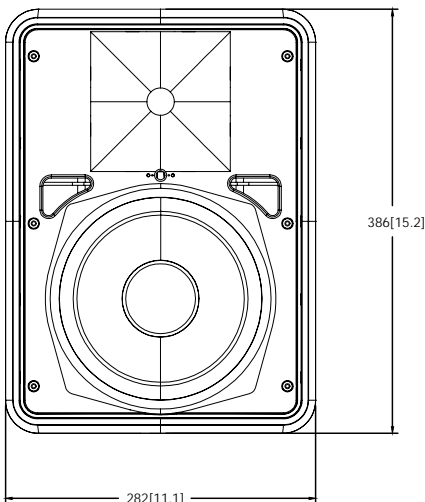
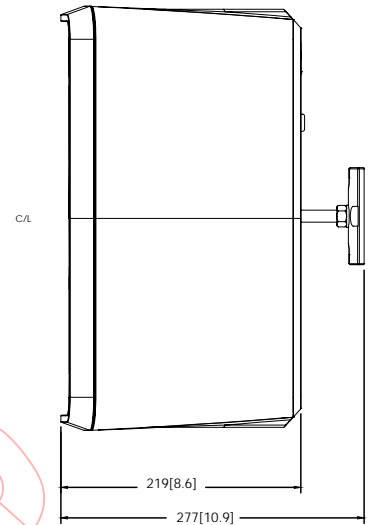
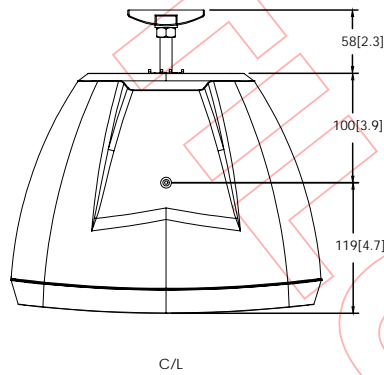
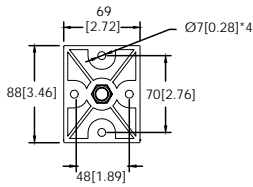

JBL Professional
8500 Balboa Boulevard, P.O. Box 2200
Northridge, California 91329 U.S.A.

© Copyright 2015 JBL Professional
www.jblpro.com

Surface Mount Speaker
VS Series
 VS6 / VS6W / VS4 / VS4W



Home > Products > Professional Audio > Speakers > VS Series

VS Series

Overview Features **Specs** Downloads Software

	VS6	VS4
General specifications		
Frequency range (-10dB)	80Hz - 20kHz	100Hz - 20kHz
Nominal coverage	H	90
	V	90
Components	LF	6.5"(160mm) cone driver
	HF	1"(25mm) balanced dome tweeter
Crossover	15kHz	15kHz
Power rating	NOISE	25W
	PGM	50W
	PEAK	100W
Nominal impedance	8Ω	8Ω
Transformer taps	100V	25W, 12.5W, 6.3W
	70V	25W, 12.5W, 6.3W, 3.1W
SPL	Sensitivity (1W, 1m on axis)	90dB SPL
	Peak (Calculated)	110dB SPL (100W)
		106dB SPL (60W)

I/O connectors	2 pairs of barrier strip (parallel-wired * Screw size: M3, Terminal Space: 6mm)	2 pairs of barrier strip (parallel-wired *Screw size: M3, Terminal Space: 6mm)
Shape	Rectangular	Rectangular
Cabinet material	HIPS, 94-HB	HIPS, 94-HB
Finish	VS6: Black, VS6W: White	VS4: Black, VS4W: White
Flying and mounting hardware	U-bracket (4 x Φ5.5mm and 2 x Φ11mm holes)	U-bracket (4 x Φ5.5mm and 2 x Φ11mm holes)
Waterproof	IEC60529 IPX3 splash proof rating	IEC60529 IPX3 splash proof rating
Dimensions	W	190 mm (7 1/2")
	H	308 mm (12 1/8")
	D	219 mm (8 5/8")
Net weight	2.8kg (6.2lbs)	1.9kg (4.2lbs)
Accessories	U-bracket, Owner's Manual, Retaining knob, Terminal cover, Terminal cover screw, SPECIFICATIONS	U-bracket, Owner's Manual, Retaining knob, Terminal cover, Terminal cover screw, SPECIFICATIONS
Others	Packaged in pair	-



All Acoustilog, Inc. -designed information supplied is for the original client and may not be copied in any way for different projects by any architect, consultant, engineer, or other party.

©Acoustilog Inc. 2013

ACOUSTILOG SERIES-PARALLEL HOOKUP

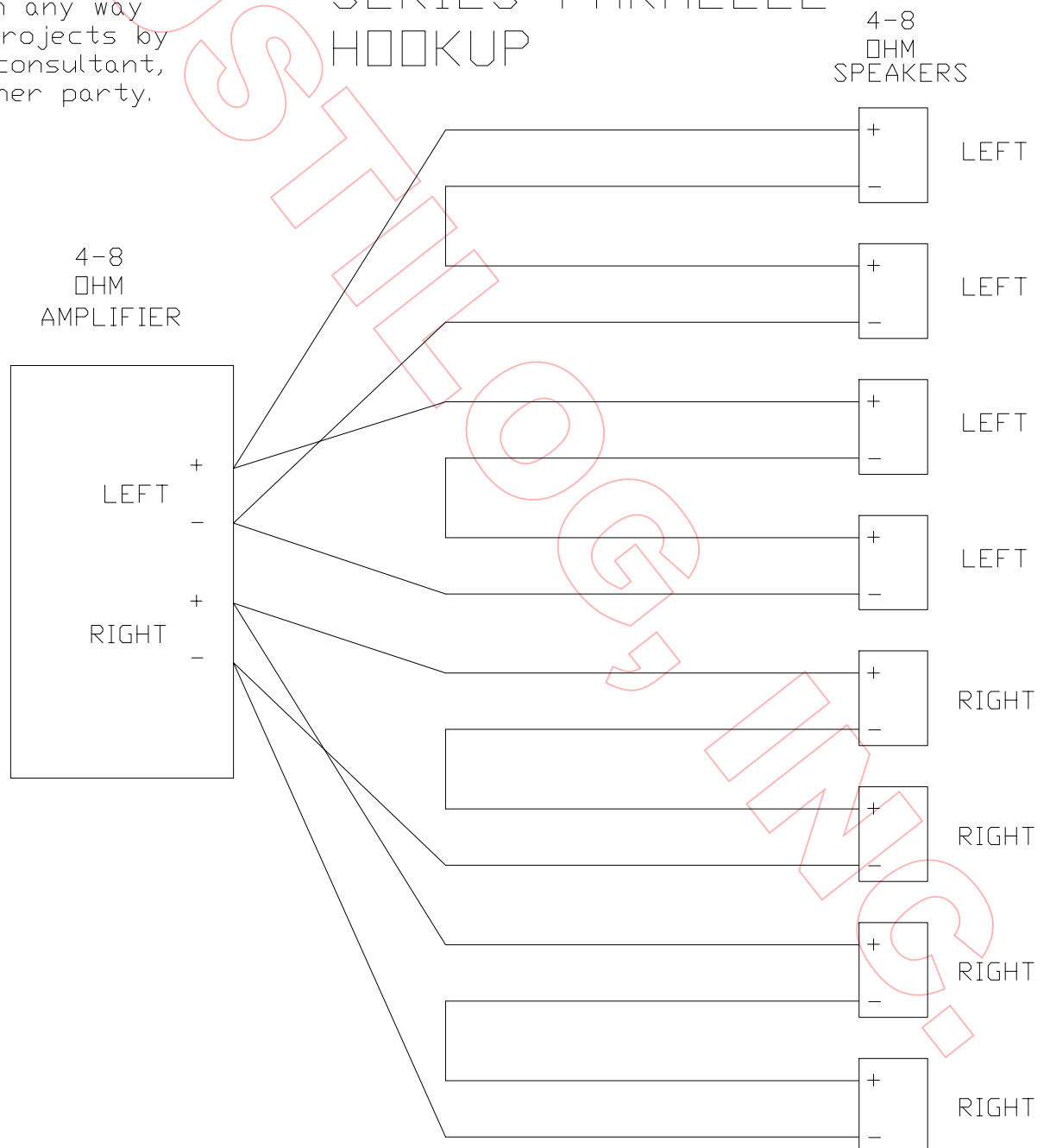



Larger Images

ALL YOU NEED TO GET THE MOST FROM YOUR PA. NOW WITH COMPLETE CONTROL FROM YOUR MOBILE DEVICE.

The DriveRack® PA2 provides all the processing you need between your mixer and amplifiers to optimize and protect your loudspeakers. With the latest advancements in dbx's proprietary AutoEQ™ and AFS™ algorithms, a new input delay module for delaying the FOH system to the backline, Ethernet control via an Android®, iOS®, Mac®, or Windows® device, and updated Wizards, the DriveRack PA2 continues the DriveRack legacy of great-sounding, powerful, and affordable loudspeaker management processors, for a whole new generation.



control app for all 4 major OSes

AUTOEQ™

New, improved AutoEQ algorithm ensures an extremely accurate, fast, and non-intrusive automatic EQ experience.

With the RTA Mic "listening" to your room, the new, updated DriveRack PA2 AutoEQ algorithm sets speaker levels and room EQ automatically in a matter of seconds. This means room adjustments can now be made very quickly, without subjecting the audience to annoying, lengthy broadcasts of pink noise.

ENHANCED AFS™ FEEDBACK ELIMINATION

Enhanced AFS™ algorithm for faster, more precise feedback elimination, without adversely affecting your system's tone.

Nothing turns audiences away like annoying and potentially painful audio feedback. Fortunately, dbx engineers have revisited their already-stellar Advanced Feedback Suppression algorithm and made it work even better. The DriveRack PA2 listens for and anticipates feedback and adjusts speaker output automatically before it even has a chance, while never altering your sound.

UPDATED WIZARD SETUP FUNCTIONS

Updated Wizards make initial set up easy, while ensuring speaker tunings and other settings are up-to-date.

Wizard functions on the DriveRack PA2 guide you through easy, step-by-step processes to help you get the most from your loudspeaker system. Helps you easily configure level balancing, AutoEQ, Advanced Feedback Suppression, and provides access to built-in and constantly updating speaker tunings from most major speaker manufacturers.

AVAILABLE INPUT PROCESSING

- › dbx Compression
- › AFS™ (Advanced Feedback Suppression)
- › Graphic EQ
- › 8-Band Parametric EQ (adjusted when using the AutoEQ)
- › Subharmonic Synthesis

AVAILABLE OUTPUT PROCESSING

- › Crossover (supports full range, 2-way, and 3-way systems)
- › 8-Band Parametric EQs (used for speaker tunings)
- › dbx Limiting
- › Driver Alignment Delays

DriveRack PA2

Complete Loudspeaker Management System

MSRP ~~\$624.94~~
\$399.95
 SAVE \$224.99!

Buy It Now

OVERVIEW

- VIDEOS
- FEATURES
- MANUALS/DOCUMENTATION
- DOWNLOADS
- SPECIFICATIONS
- NEWS
- SUPPORT/FAQS

f Like 555 t Tweet



Features

- › All New Setup Wizard
- › Streamlined AutoEQ™
- › All New AFS™ (Advanced Feedback Suppression)
- › Mobile Control (Android®, iOS®, Mac®, Windows®)
- › dbx Compression
- › Graphic EQ
- › 8-Band Parametric EQ (adjusted when using the AutoEQ) Input
- › Subharmonic Synthesis
- › Crossover (supports full range, 2-way, and 3-way systems)
- › 8-Band Parametric EQs (used for speaker tunings) Output
- › dbx Limiting
- › Driver Alignment Delays



The screenshot shows the RadioShack website interface. At the top, there's a navigation bar with the RadioShack logo, customer service contact info, store location, language options, and account/shopping cart links. Below this is a category menu with options like 'Deals', 'Services', and 'Weekly Ad'. A search bar is also present. The main content area features a promotional banner for 'R CASH' and a breadcrumb trail: 'Music & Audio > Accessories > Sound meters > Digital Sound Level Meter'. The product 'Digital Sound Level Meter' is displayed with its image, model number (Digital 2055), and price (\$49.99). It includes a star rating, an 'ADD TO CART' button, and 'In Stock Online' status. Below the product image are links for 'accessories manual' and 'FIND IT NEARBY'. A 'Need more help?' section offers links to read the manual, view technical specifications, and see product features.

Product Summary

Fine-tune your audio.

Fine-tune your PA or stereo systems audio response to match the acoustic environment with this Digital Sound Level Meter. It comes with a carrying case for travel and features an easy-to-read display.

- Carrying case protects the meter when traveling
- Easy-to-read display, sound range 30-130db, digit LCD display
- You can fine-tune your PA or stereo systems audio response to match the acoustic environment

Pricing and availability: Please note that all prices are subject to change without prior notice. Prices advertised on this site are for online orders only. Prices on some items may differ from those advertised in RadioShack stores. All merchandise may not be available at all stores, and all stores may not participate in all sales promotions. We recommend you contact the store to confirm product availability and price.

Shipping

Usually ships in 1 - 2 business days

In store: [Check availability](#)

By phone: 1-800-843-7422

Manufacturer Warranty

- Parts: 12 month
- Labor: 12 month



"Quiet Elegance!"



PO Box 450006 • Houston, TX 77245-0006
877/790-9367 • 713/433-2029 fax • icc@sonakrete.com

- Home
- About SonaKrete™
- Technical Library
- Installation
- Project List
- LEED™
- Contact Us
- Industry Links

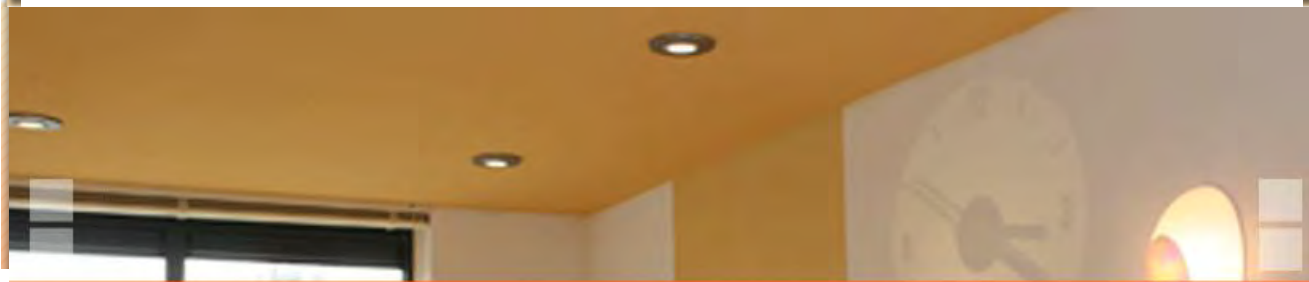

BEAUTIFULLY QUIET

Who we are?

International Cellulose Corporation is the world's leading developer and manufacturer of acoustical finishes.

Our commitment to quality is reflected in our ISO 9001: 2000 certification, and the follow up inspection programs of Underwriter's Laboratories (UL) and Factory Mutual Research Corp (FM). ICC's innovative product developments have resulted in several US and International patents.

The sales team at ICC is experienced in providing effective design solutions for your acoustical requirements. ICC acoustical products are extremely versatile and have been installed throughout the construction industry for over 35 years on both new and renovation projects.

SonaKrete™

SonaKrete™ is a newly introduced acoustical finish system that has been designed for a wide range of projects. SonaKrete™ offers architects and acoustical consultants the opportunity to specify with confidence, an attractive acoustical finish with superior sound absorption qualities, durability and adaptability to many architectural designs.

The hand "troweled" finish ensures an attractive surface that you can afford to show off.

For a [Specification Guide](#), please [click here](#).

Acoustical Performance

SonaKrete™ can be specified at different thicknesses to achieve varied acoustical performances. With only a 1/ 2" application of SonaKrete™, an unmatched NRC value of 0.65 can be achieved. Below are acoustical test results for SonaKrete™ applied to a Solid Backing:

Thickness	125Hz	250Hz	500Hz	1000Hz	2000Hz	4000Hz	NRC
.25in	.01	.07	.39	.69	.83	.87	.50
.375in	.06	.11	.46	.77	.84	.89	.55
.5in	.01	.16	.49	.89	1.03	.97	.65
.75in	.25	.48	.81	.85	.85	.94	.75

Note: NRC Values per ASTM C-423 conducted by Acoustic Systems a NVLAP certified testing laboratory.

For more information on [Acoustical Performance Data](#), please [click here](#), or request the full Acoustical Test Reports via [email](#).



PMA - Hague, Amsterdam

Substrate Compatibility

SonaKrete™ easily conforms to a wide variety of substrates, including complex and irregular* surfaces, without compromising architectural design configurations. Engineered for application to virtually any common substrate, SonaKrete™ forms a strong durable resilient bond.

***Note:** Not suitable for ribbed or conugated decks.

Features & Benefits

- Superior Sound Absorption
- Standard & Custom Colors
- Cost Competitive
- Permanent Application
- Class 1 Fire Rated
- Faster Application
- Resilient
- Environmentally Safe
- Low Maintenance



SonaKrete™ Brochure

For more information on **Product Limitations** and **Special Precautions**, please [click here](#).

Durability & Maintenance

The adhesive used to apply **SonaKrete™** creates a surface that is remarkably durable and low maintenance. **SonaKrete™** resists impact and abrasion without the cracking or spalling typical to many cementitious or plaster-based materials.

Furthermore, **SonaKrete™** provides for an easier and faster application without compromising its aesthetically pleasing finish, durability or exceptional acoustical performance. Thus, it can install at a more competitive installed cost over traditional decorative plaster finishes.

Bond Strength	> 1000 psf	ASTM E-736
Compression Strength	> 4000 psf	ASTM E-761

For information on **Product Warranty**, please [click here](#).

Fire Performance Ratings

SonaKrete™ has a **Class 1, Class A** flame spread rating per ASTM E-84.

Flame Spread	20
Smoke Developed	20

For further information on **Compliance Standards**, please [click here](#).

Colors Available

SonaKrete™ is available in standard colors and can be specially matched to any custom color to meet design requirements.

To download **SonaKrete™ Brochure**, please [click here](#).



PMIA - Hague, Amsterdam

Search:

 -- Select your language --



- BASWA Acoustic Systems
- Products
- Processing/Handling
- Documentation
- Objects
- Bidding Text



Contacts



[Here](#) you will find your **contacts**: regional, national or international.

Products



BASWAphon - Acoustic system

The BASWAacoustic AG has developed a solution concerning the growing problem of noise sensibility. With the BASWAphon product range had we achieved, to set up the reverberation time on several exploitation method.

[more information](#)



BASWAphon - Base

This module has a smooth, white, seamless, finely structured and mechanically-speaking relatively durable surface with an interesting price-performance ratio.

[more information](#)



BASWAphon - Fine

This one-layer procedure stands out for its smooth, fine surface. This system is ideal for suspended systems and/or in case of a need for short installation times.

[more information](#)



BASWAphon - Classic

This tried and tested system can be put to use universally and combines all the advantages of the BASWAphon acoustic system. The system provides the highest degree of freedom, enabling the creation of the very finest surface structure.

[more information](#)



BASWAphon - Cool

This product class combines sound absorption with the water-bearing capillary tube system and creates a room temperature in tune with our clients' specific needs.

[more information](#)

[↑ top of page](#)

 [Printer-Friendly Version](#)  [Send This Page](#)  [Add to Favorites](#)



- BASWA Acoustic Systems
- Products
- Processing/Handling
- Documentation
- Objects
- Bidding Text



Contacts



Here you will find your contacts: regional, national or international.

BASWAphon - Classic

General

This tried and tested system can be put to use universally and combines all the advantages of the BASWAphon acoustic system. The system provides the highest degree of freedom, enabling the creation of the very finest surface structure.

Special features

- finest surface structure
- intense coloration
- curved surfaces

System set-up

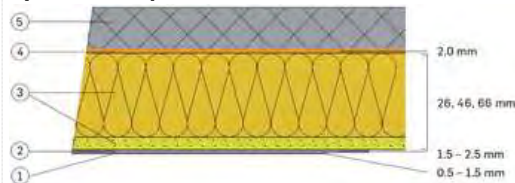

1. BASWAphon Top covering layer
2. BASWAphon 407 foundation layer
3. BASWAphon supporting panel
4. Adhesive
5. Background

[↑ top of page](#)

[Printer-Friendly Version](#) [Send This Page](#) [★ Add to Favorites](#)

The Product



- THE PRODUCT**
- PROJECTS
- DETAILS
- INSTALLATION
- DATA
- NEWS
- CONTACT US

The StarSilent System

The StarSilent system utilizes a sound board, which is made up of 96% post consumer recycled crushed glass bottles. The boards are attached to rigid metal framing with drywall screws. The edges of the boards are glued together using a special adhesive, which is also spread over the screw heads. After light sanding, the boards are first coated with a base coat plaster that requires a minimum of 36 hours to dry. The finish coat plaster is then applied to achieve a smooth seamless sound absorbing plaster wall or ceiling.

Advantages:

- No gypsum board substrate is required.
- Holes can be cut directly in the StarSilent board with standard tools (rotozip). Other products require ceiling penetrations to be boxed out with additional layers of drywall. There is potential for a telegraphing line between the drywall and these other product acoustical pads. Also the areas around these ceiling penetrations (lights, diffusers, sprinklers) are no longer sound absorbing.
- It can be used on contact walls. We recommend that stud spacing on walls below 6 foot height be eight inches on center. Other seamless systems are also subject to damage and costly repairs on low ceilings in public areas.
- The StarSilent plasters are spread over the rigid StarSilent board. The levelness of the finish is superior to other systems, which the plasters are toweled over resilient fiberglass panels.
- It can be painted without loss of its sound absorbing quality. The paint must be spray applied in two light/fog coats from a distance of 24 inches. Painting must be done with a light/fog coats as excessive painting can highlight micro textures in plaster finish. We are presently working on integral coloring the StarSilent plaster.
- It has extremely low VOC content (almost zero) and the highest percentage of recycled content of any smooth seamless acoustic plaster system.
- It can be integrated with a radiant heating and cooling system.
- It is the most installer friendly of any smooth seamless acoustic plaster system.
- Pyrok Inc. is present onsite to assist it's installers with their installations. Pyrok Inc. offers a 5 year warranty.



[Download Brochure](#)

1. Galvanised steel concealed suspended ceiling grid
2. StarSilent Panel
3. Connection of the acoustic Panel
4. Acoustically transparent decorative top coat



Details



- THE PRODUCT
- PROJECTS
- DETAILS**
- INSTALLATION
- DATA
- NEWS
- CONTACT US

Ceiling to wall

- Open perimeter
- Open perimeter with concealed ventilated trim
- Open perimeter with crown moulding
- Enclosed expansion joint
- Open expansion joint
- Floating perimeter detail
- Floating perimeter detail with light box
- Soffit/fascia detail
- Soffit/fascia - folding technique
- Wall internal / external corner
- Wall internal / external corner adjustable bracket
- Wall lining internal / external corner u-hanger
- Connection to wall lining
- Connecting wall lining to floor
- Recessed light fitting
- Moveable partition wall
- Air diffuser
- Revise grid layout to accommodate light fitting
- Barrel vault > 10ft radius
- Ceiling underneath suspended ceiling

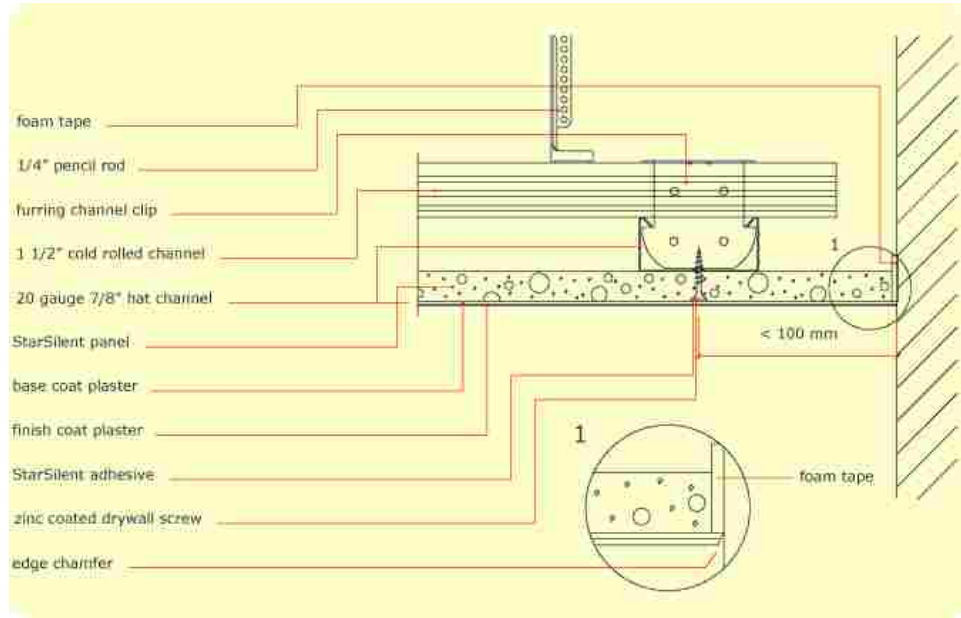

Ceiling to wall (1:2)

Illustration of a StarSilent Acoustic Ceiling system. Adjoining elements as sketch only.

 [Download detail PDF](#)

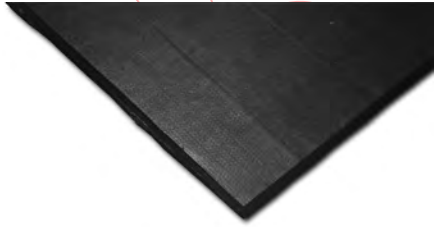

Superior Acoustical Performance

SelectSound Black acoustic board provides excellent acoustical performance for multiplex theaters, sound studios and performing arts centers. Depending on specified thickness, *SelectSound* Black acoustic board absorbs up to 100% of the sound striking its surface.

SelectSound Black acoustic board helps provide the highest quality audio reproduction by reducing sound reverberation within spaces. Sound transfer from space to space is also noticeably reduced.

Physical Property Data

Property	Test Method	Value
Compressive strength (minimum) at 10% deformation	ASTM C 165	25 lb/ft ² (1197 Pa)
at 25% deformation		90 lb/ft ² (4309 Pa)
Water vapor sorption	ASTM C 1104	<3% by weight at 120°F (49°C), 95% R.H.
Fungi resistance	ASTM C 1338	Meets requirement
Nominal density	ASTM C 303	3.0 pcf (48 kg/m ³)
Corrosiveness	ASTM C 665 Corrosiveness Test	Will not cause corrosion greater than that caused by sterile cotton on aluminum or steel*
Surface burning characteristics	ASTM E 84 CAN/ULC-S102**	Flame spread 25**
		Smoke developed 50

* When wet, coated surfaces in contact with galvanized steel may cause discoloration of the sheet metal.

** The surface burning characteristics of these products have been determined in accordance with UL 723 and CAN/ULC-S102-M. These standards should be used to measure and describe the properties of materials, products or assemblies in response to heat and flame under controlled laboratory conditions and should not be used to describe or appraise the fire hazard or fire risk of materials, products or assemblies under actual fire conditions. However, results of this test may be used as elements of a fire risk assessment which takes into account all of the factors which are pertinent to an assessment of the fire hazard of a particular end use. Values are reported to the nearest 5 rating.

Durable Material Composition

SelectSound Black acoustic board is dimensionally stable and will not shrink or warp. The board's resilient composition resists job-site damage. When necessary, the durable black mat facing may be cleaned by vacuuming. *SelectSound* Black acoustic board, composed of inorganic glass fibers, will not rot or mildew and is noncorrosive to steel, copper and aluminum.

Fast, High Quality Installation

Lightweight and resilient, *SelectSound* Black acoustic board is easy to handle, fabricate and install. Both stick pins and adhesives can be used to secure boards to drywall, concrete block or precast concrete.

Size Availability

SelectSound Black acoustic board is available in 48" x 96" size. *SelectSound* Black acoustic board can also be supplied precut in sizes up to 48" x 96" to fit specific dimensional requirements. Precut boards improve labor productivity by speeding installation.

Black Core with Dark Black Finish Surface

SelectSound Black acoustic board has an all-black core with a deep black mat finish with very low light reflectivity. The black surface is ideal for eliminating screen light reflections and preventing insulation from showing through most surface treatments.

Design Considerations

Acoustical performance of interior surfaces can generally be improved by increasing acoustical material thickness. *SelectSound* Black acoustic board can be specified for use in conjunction with other Owens Corning acoustical materials to provide additional performance.

Owens Corning also manufactures *SelectSound* Black theater blanket. This roll product is ideal for use behind fabric on theater walls, in sound studios and performing arts centers.

Applicable Standards

The noise reduction coefficients of *SelectSound* Black acoustic board were derived from tests conducted in accordance with ASTM C 423 on a Type A mounting.

Installation Procedure

SelectSound Black acoustic board can be installed on drywall, concrete block or precast concrete using impaling pins or appropriate adhesives.

When installing insulation with adhesive, follow adhesive manufacturer's recommendations for surface preparation and pattern.

When using impaling pins, follow the pin manufacturer's recommendations for surface preparation, location and amount of pins. Pin length should be selected to ensure tight fit. Where subject to physical contact, protect pin tips.

Keep product dry during shipping, storage and installation.

SelectSound™ Black Acoustic Board

Acoustical Performance

Product Type & Thickness	Density		Mounting	Octave Band Center Frequencies, Hz							Thermal Resistance* R-Value (hr•ft ² •°F)/Btu
	pcf	(kg/m ³)		125	250	500	1000	2000	4000	NRC	
1" Mat faced	3.0	(48)	A	.06	.25	.62	.91	.99	.98	.70	4.3
2" Mat faced	3.0	(48)	A	.18	.71	1.12	1.12	1.03	1.02	1.00	8.6

Derived from test conducted in accordance with ASTM C 423, Type A mounting (material placed against a solid backing such as a block wall).

Conceptual Details

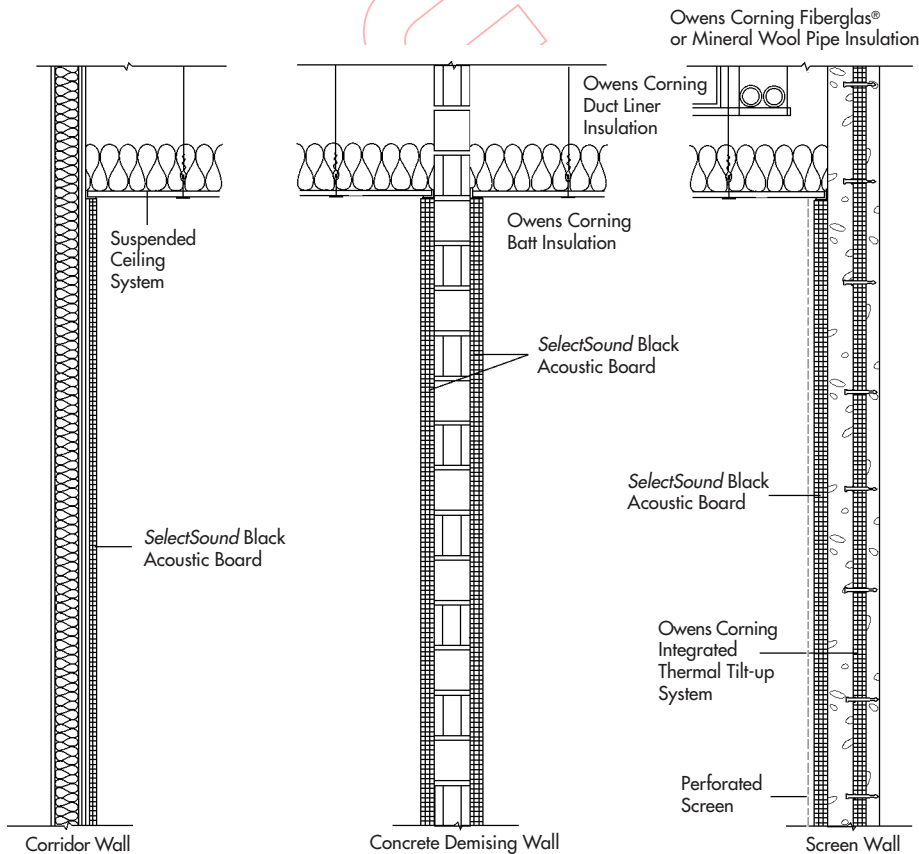

For CSI type sample specification, please contact your local Owens Corning representative.



OWENS CORNING WORLD HEADQUARTERS

ONE OWENS CORNING PARKWAY
TOLEDO, OHIO, USA 43659

1-800-GET-PINK

www.owenscorning.com

SelectSound™ is a trademark of Owens Corning.

Pub. No. 5-BL-44290-A Printed in U.S.A., December 2001 Copyright © 2001 Owens Corning

Owens Corning reserves the right to change this product as needed.



2 x 2 Black Acoustic Ceiling Tile

Home > Products > Acoustic Ceiling Tiles > 2 x 2 Black Acoustic Ceiling Tile

2 x 2 Black Acoustic Ceiling Tiles are sold under our SilentCeiling™ brand. Drop in to an existing grid ceiling these panels offers excellent sound absorption properties at an affordable price. Finished with a crisp, matte black fabric and as available in a 2' x 2' square format. Enjoy FREE SHIPPING from us on these panels.

INQUIRY FORM

In both residential and commercial applications, these tiles creates a "disappearing" acoustical tile ceiling that has a sharp and attractive look. Achieve NRC values of .75 by easily installing these lightweight grid ceiling tiles.

- Packages of 1" Boards will cover 80 sq. ft.
- Packages of 2" Boards will cover 40 sq. ft.
- Available in 2'x2'
- High NRC up to 1.00
- Lightweight and easy to cut with a utility knife
- 3# Density
- Spec-equivalent for Owens-Corning Select Sound Black Acoustic Board
- Class A fire rated

Effective Sound Absorption: SilentCeiling™ Black Acoustic Ceiling Tiles eliminate unwanted ceiling boundary reflections and control excessive room reverberation. SilentCeiling™ Black Acoustical Ceiling Tiles eliminate slap-echo between parallel floor and ceiling surfaces. Additionally, these tiles visually and audibly "disappear" by improving signal-to-noise ratio for listening, recording, and conversation.

Easy Installation: Available as a 2'x2' grid ceiling tile. SilentCeiling™ Black Acoustical Ceiling Tiles are designed to be installed in a standard drop ceiling grid. Sound Acoustic Solutions offers all of the [supplies](#) you will need to install a sound absorbing tile ceiling.

Applications: Residential and commercial - any space where reverberation or reflected noise is an issue.

- Home theatres*, media rooms
- Recording and broadcast studios
- Clubs, restaurants, entertainment facilities
- Theatres and performing arts spaces

*Learn more about home theatre application options using Acoustical Ceiling Tiles in our [Acoustical Blog](#).

Please note: SilentCeiling™ Acoustical Ceiling Tiles are not meant to uphold ceiling products such as recessed lighting. Make sure to install recessed lighting using the grid of the ceiling to support the weight of the lights, not the tiles themselves.*

Need a large amount of SilentCeiling™ Acoustical Ceiling Tiles? Call us at 877-399-9697 for a custom wholesale quote!

Product Info

Acoustic Performance

Thickness	pcf	Octave Band Center Frequencies, Hz							
		125	250	500	1000	2000	4000	NRC	R-Value
1"	3	0.06	0.25	0.62	0.91	0.99	0.98	0.7	4.3
2"	3	0.18	0.71	1.12	1.12	1.03	1.02	1	8.6
1"	6	0.3	0.34	0.68	0.87	0.97	1.06	0.7	4.3
2"	6	0.39	0.63	1.06	1.13	1.09	1.1	1	8.6

Documentation

 [Data Sheet](#)

[Buy Now](#)

2 x 2 Black Acoustic Ceiling Tile

Item # SCB.2203

1", 3#, 2' x 2' (20/Pkg) - FREE SHIPPING

Item # SCB.2203.2

2", 3#, 2' x 2' (10/Pkg) - FREE SHIPPING

Qty

Price

\$154.00

[Add To Cart](#)

\$154.00

[Add To Cart](#)

You may also like



[SilentWrap™ PSA](#)

Customer Service



[Contact Us](#)

Join our Mailing List

[Sign Up](#)





Your source for Noise, Acoustic,
Vibration and Seismic control systems
1-877-457-2695

Login: [Web Programs](#) • [Silencers Onlin](#)

Search:

Home	Products	Our Company	Locate a Rep	Acoustical Consultants	Contact
Submittal Drawings	Installation Guides	Specifications	Literature	AutoCAD	Seismic Design Manual STC/IIC Test Data

[Home](#) > [Interior Room Acoustics](#) > [HardSide Acoustical Wall Panels](#)

Kinetics™

HardSide Acoustical Wall Panels

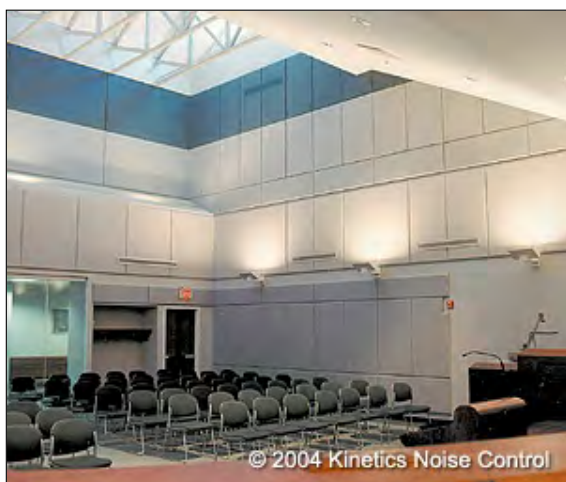

A combination of great appearance, superior acoustical performance, and design flexibility makes HardSide Acoustical Wall Panels the perfect solution for many interior reverberant noise problems.

The traditional acoustical wall panel, HardSide offers design versatility. A variety of shaped edges and panel thicknesses allow you to design for the desired appearance and acoustics. The perfect solution for many reverberant noise problems this panel offers superior performance in both wall and ceiling applications.

The core of this panel is a 5-7 PCF fiberglass board. The edges are chemically hardened for durability. Fabric facing, from the [FR 701 collection from Guilford of Maine](#) or factory-approved, customer-selected fabric, is stretched over the panel, wrapped and bonded around the edges for a crisp, finished look. Vinyl finishes are also available.

Design for panel sizes up to a maximum 4 ft. x 10 ft. or custom shaped panels with angled or contoured perimeter cuts.

Photo Gallery

Select the image to open a larger view in a new window.



Description

A versatile fiberglass acoustical wall panel wrapped in a wide selection of fabrics or vinyls. Available with hardened shaped edges. Engineered sound control with thicknesses from 1 to 4 inches and sizes up to 4 ft. x 10 ft.

HardSide Acoustical Wall Panels

[Specification](#)

[Data Sheet](#)

Fabric Selection

[Guilford of Maine FR701, Style 2100](#)

Installation Guidelines

[Adhesive Only](#)

[HS Clips with Adhesive](#)

[T Clips with Adhesive](#)

[DS-90 Clip](#)

[Edgemount Clip](#)

[Z-Clip](#)

[Z-Clips with Velcro](#)

[Z-Clips with Brackets](#)

[Velcro & Grip-Lock](#)

[Ceiling Panel Installation](#)

[Ceiling Panels with Butted Seams \(First Panel\)](#)

[Ceiling Panels with Butted Seams \(Middle Panel\)](#)

[Ceiling Panels with Butted Seams \(Last Panel\)](#)

[Field-Cut & Rewrap](#)

[Inside Corner Field-Cut & Rewrap](#)

[Electrial Outlet Extension Installation](#)

[Round Hole Field Cut](#)

Pricing and Quotations

[Your local Kinetics Interiors representative will assist you with pricing and quotations](#)

[Tell a Friend](#)

Composition

- 5-7 PCF density fiberglass core
- Chemically hardened edges
- Fabric faced with factory in-stock fabric by [Guilford of Maine](#), or factory-approved customer-selected material

[Click here to E-Mail this page link to a friend](#)

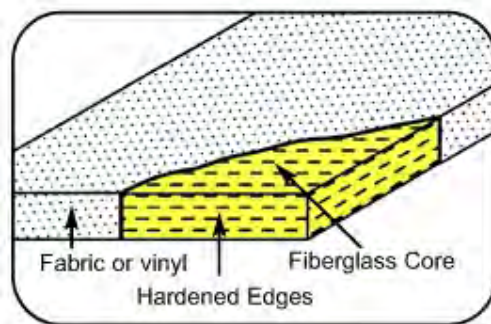

Acoustical Performance

Sound Absorption per ASTM C-423. Type A Mounting

Frequency, Hz	125	250	500	1000	2000	4000	NRC
1" Thick Panel	0.05	0.32	0.82	1.04	1.02	1.01	0.80
2" Thick Panel	0.29	0.82	1.10	1.04	1.01	1.02	1.00
4" Thick Panel	0.61	1.05	1.11	1.11	1.08	1.04	1.10

Fire Class Rating

Class A per ASTM E84

Applications

- Interior surfaces where superior acoustical performance is required
- Conference Rooms
- Schools/Classrooms
- Auditoriums
- Media Rooms
- Multi-Purpose Rooms
- Churches
- Office Spaces
- Reception Areas
- Home Theatres
- Pro Theatres

Edge Options

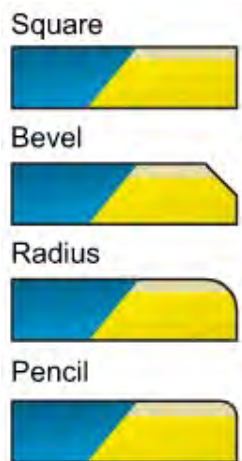

Mounting

- HardSide Impaling Clips with Adhesive
- EdgeMount Clips
- Z-Clips - movable
- Velcro - movable

See [HardSide Cloud Panels](#) for ceiling suspension.