

**Manhattan Community Board 4**  
(All Fields Must Be Completed)

Liquor License/Sidewalk Cafe Stipulations Application

CORPORATION NAME		DOING BUSINESS AS (DBA)	
Tartinery Columbus LLC		Tartinery	
STREET ADDRESS		CROSS STREETS	ZIP CODE
The shops at Columbus Circle 10 Columbus Circle		Bln 58th ; 60th	10019
OWNER <small>(Attach a list of all the people that will be associated/listed with the license)</small>	NAME:	Nicolas Dutko	NAME: Frank Palillo
	PHONE:	(646) 675-6190	PHONE: (212) 227-1640
	EMAIL:	nicolas@tartinery.com	EMAIL: fupalillo@gmail.com
MANAGER	NAME:	TBD	NAME: Time Warner Center Condominium
	PHONE:	additional owner: Cherif Souki	PHONE: (212) 823-6101
	EMAIL:		EMAIL:
ATTORNEY/ REPRESENTATIVE		LANDLORD	
APPLICATION TYPE ( <input checked="" type="checkbox"/> Liquor License <input type="checkbox"/> Unenclosed Sidewalk Cafe )			
<input checked="" type="checkbox"/> New	Has applicant owned or managed a similar business?		<input checked="" type="radio"/> YES <input type="radio"/> NO
	What is/was the name and address of establishment?		see attached
	What were the dates applicant was involved with this former premise?		
<input type="checkbox"/> Corp Change/Class Change/Removal	What is the license # and expiration date?		
	Is applicant making any alterations or operational changes?		<input type="radio"/> YES <input type="radio"/> NO
	If alterations or operational changes are being made, please describe/list all changes.		
<input type="checkbox"/> Alteration	What is the current license # and expiration date?		
	Please list/describe the nature of all the changes and attach the plans:		
<b>METHOD OF OPERATION</b>			
TYPE OF ALCOHOL	<input checked="" type="checkbox"/> Liquor/Wine/Beer & Cider <input type="checkbox"/> Beer & Cider <input type="checkbox"/> Wine/Beer & Cider		
ESTABLISHMENT TYPE	<input checked="" type="checkbox"/> Restaurant <input type="checkbox"/> Cabaret <input type="checkbox"/> Night Club <input type="checkbox"/> Hotel <input type="checkbox"/> Bar/Tavern <input type="checkbox"/> Catering Establishment <input type="checkbox"/> Adult Entertainment <input type="checkbox"/> Wine Bar <input type="checkbox"/> Dance Club <input type="checkbox"/> Sports Bar <input type="checkbox"/> Club (Fraternal Organization - Members Only)		
Has applicant/owner filed with the SLA? If yes, when? If no, when do you plan to file?	YES	<input checked="" type="radio"/> NO	
Is the 500 Foot Rule applicable? If yes, please attach a diagram of the On-Premise liquor license establishments within a 500 ft. radius of your establishment and the Public Interest Statement.	<input checked="" type="radio"/> YES	NO	
Is the 200 Foot Rule applicable? If yes, please attach a diagram of the schools and houses of worship that trigger the rule.	YES	<input checked="" type="radio"/> NO	
Has applicant/owner(s) read MCB4 Policy Regarding Concentration and Location of Alcoholic-Serving Establishments?	<input checked="" type="radio"/> YES	NO	

Rider to Page 1  
Application Type

Tartinery GCT LLC  
Grand Central Station  
Space K-9 NYC, NY  
10/18 - Present

Tartinery Liberty LLC  
225 Liberty Street  
Store 245A  
NYC, NY 10281  
04/14 - Present

Tartinery Liberty LLC  
250 Vesey Street  
NYC, NY 10281  
9/16 - Present

Tartinery Plaza LLC  
1 West 58th Street GC16  
New York, NY 10019  
2012 - Present

Tartinery 90 Park LLC  
90 Park Avenue  
New York, NY 10016  
4/18 - Present

Spread NYC, LLC  
209 Mulberry Street  
NYC, NY 10012  
2008 - 2018

SOSEB LLC  
110 Thompson Street  
New York, NY  
2012 - Present



LOCATION & ZONING			
Is this a Special District? If yes, is it Clinton, West Chelsea or Hudson Yards?	<input type="checkbox"/> YES	<input type="checkbox"/> NO	MID
Does the building have a Certificate of Occupancy ("C of O") or a letter of no objection?	<input checked="" type="checkbox"/> YES	<input type="checkbox"/> NO	
Is a Public Assembly permit required?	<input checked="" type="checkbox"/> YES	<input type="checkbox"/> NO	
Are your plans filed with DOB?	<input type="checkbox"/> YES	<input type="checkbox"/> NO	NO NEED. WE ARE NOT DOING ANY CHANGES TO THE EXISTING SPACE

Community Notification/Relations		
<b>NOTIFICATION:</b> List all block associations; tenant associations, co-op boards or condo boards of residential buildings; and community groups that applicant has notified regarding its application. For each please list both the organization and individual you contacted	# 1	As contained in Nelly's email
	# 2	
	# 3	
	# 4	
	# 5	
	Please provide dates when applicant met with the groups listed above.	
Who was your contact person at each group you met with?		
When did applicant post the notice that was provided?		AUGUST 20, 2020
Where did applicant post the notice that was provided?		STOREFRONT
Will applicant provide owner cell phone number to neighbors and respond to complaints that arise? Please provide number in space provided.		<input checked="" type="checkbox"/> YES <input type="checkbox"/> NO
Will applicant inform the Community Board office of its job openings and/or provide a hyperlink to applicants jobs webpage?		<input checked="" type="checkbox"/> YES <input type="checkbox"/> NO

BUILDING DESIGN				
State the name and type of business previously located in the space.				
Has a liquor-licensed establishment previously occupied this space at any time? If yes, please provide the name of the business.	<input checked="" type="radio"/> YES	<input type="radio"/> NO	BOUCHON BAKERY	
Do you plan any changes to the existing façade? If yes, please describe.	<input type="radio"/> YES	<input checked="" type="radio"/> NO		
Has the applicant/owner(s) read MCB 4 ADA Guidelines Memo?	<input checked="" type="radio"/> YES	<input type="radio"/> NO		
Is the entrance ADA Compliant?	<input checked="" type="radio"/> YES	<input type="radio"/> NO		
Do you plan any changes to the existing façade? If yes, please describe.	<input type="radio"/> YES	<input checked="" type="radio"/> NO		
Will applicant have a vestibule within the establishment?	<input type="radio"/> YES	<input checked="" type="radio"/> NO		
Will applicant use a storm enclosure?	<input type="radio"/> YES	<input checked="" type="radio"/> NO		
Will applicant agree not to place any items or obstructions on the sidewalk, for example, sandwich boards, sidewalk signs, freestanding menus and plants, as per the law?	<input checked="" type="radio"/> YES	<input type="radio"/> NO		
Will applicant comply with the NYC noise code?	<input checked="" type="radio"/> YES	<input type="radio"/> NO		
Will the establishment have any of the following: (circle all that apply)	<input checked="" type="radio"/> NO	<input type="radio"/> FRENCH DOORS	<input type="radio"/> GARAGE DOORS	<input type="radio"/> WINDOWS THAT CAN BE OPENED
Will applicant close all windows, French doors, garage doors when any music or amplified sound (including televisions) is played inside the establishment?	<input type="radio"/> YES	<input type="radio"/> NO	N/A	
Will applicant close all windows, French doors, garage doors by 11 PM Friday and Saturday and 10 PM on all other days even if no music or amplified sound is played inside the establishment?	<input type="radio"/> YES	<input type="radio"/> NO	N/A	
Has applicant obtained an acoustical report from a certified sound engineer to assess potential noise disturbance to the neighboring residents and buildings?	<input type="radio"/> YES	<input checked="" type="radio"/> NO		
Will applicant follow the recommendations of a certified sound engineer to mitigate potential noise disturbance to the neighboring residents and buildings, including placing speakers on the floor of the establishment?	<input type="radio"/> YES	<input type="radio"/> NO	N/A	
Will the kitchen exhaust system extend to the roof?	<input type="radio"/> YES	<input checked="" type="radio"/> NO	NO EXHAUST SYSTEM	
Will the establishment have an illuminated sign?	<input checked="" type="radio"/> YES	<input type="radio"/> NO		
Will the establishment have a canopy extending over the sidewalk?	<input type="radio"/> YES	<input type="radio"/> NO	N/A	
Where will the air conditioner be located? What type is it?	CEILING, CONNECTED TO BUILDING CONDENSING WATER SYSTEM			
When was the air conditioner installed?	2008			

**OUTDOOR ITEMS - OTHER THAN SIDEWALK CAFE**

	YES	NO	
Has the applicant/owner(s) read MCB 4 Rear Yard Rooftop Policy?	YES	NO	N/A
Will applicant use any outdoor spaces: rooftop, rear yard, patio, porch, balcony, pavilion, tents, deck or gazebo? If yes, which one(s)?	YES	NO	
Are the floorplans for the outdoor space(s) included?	YES	NO	
Will applicant close and vacate the outdoor space(s) by 11PM on Friday & Saturday and 10 PM on all other days?	YES	NO	
Will the service and consumption of alcohol in any outdoor space only be via seated food service?	YES	NO	
Will applicant not allow standing space for patrons to drink or smoke in any outdoor space(s)?	YES	NO	
Will there be no amplified music, as per the law?	YES	NO	
If amplified sound is played inside the establishment, will windows and doors be closed?	YES	NO	
Will applicant agree to post signs outside asking customers to respect the neighbors'?	YES	NO	
Will applicant agree to train staff to encourage a peaceful environment?	YES	NO	
Will applicant provide effective sound control (landscaping enclosure, soundproofing tenants apartments)	YES	NO	
Will there be a lighting plan that allows safe usage of the outdoor space without disrupting neighbors?	YES	NO	

**OUTDOOR ITEMS - SIDEWALK CAFÉ**

Has the applicant/owner(s) read MCB4 Sidewalk Café Policy?	YES	NO	
Will applicant be applying for a sidewalk café now or in the future?	YES	NO	
Is applicant in this application seeking to include a sidewalk café in its liquor license?	YES	NO	
If yes, has applicant submitted an application and plans to NYC Dept. of Consumer Affairs? Please attach application and plans.	YES	NO	
Will applicant close and vacate the sidewalk café by 11 PM on Friday & Saturday and 10 PM on all other days?	YES	NO	
Will applicant be serving alcohol in the sidewalk café? If so, will you have waiter service?	YES	NO	
Will the café have a 3 ft. wide serving aisle running the entire length of the sidewalk café?	YES	NO	
Will applicant mark the perimeter of the café on the sidewalk?	YES	NO	
Will the service and consumption of alcohol in the sidewalk café only be via seated food service?	YES	NO	
Will the sidewalk café not provide standing space for drinking or smoking?	YES	NO	
Will applicant use any portable natural gas heaters? If so, do you have the requisite approvals from DOB & the Fire Department?	YES	NO	
Will applicant have a lighting plan that will allow safe usage of the outdoor space without disrupting neighbors?	YES	NO	
Will all furniture, plants and barricades be stored inside between the evening closing hours and the morning opening hours?	YES	NO	
Will all furniture be stored inside between December 21 <sup>st</sup> and March 21 <sup>st</sup> , and any other day when it rains or snows?	YES	NO	
Will applicant use umbrellas?	YES	NO	
If construction or construction protection has reduced the sidewalk width, will applicant always maintain an 8 foot clear path of sidewalk between the perimeter of the café and the closes obstruction including construction barricades?	YES	NO	

**ADDITIONAL STIPULATIONS: (Office Use Only)**



**ADDITIONAL STIPULATIONS: (Office Use Only), *Continued***

Manhattan Community Board 4 (MCB4) recommends:  
(MCB4's recommendation is based on a vote taken at its  
October 7, 2020 full board meeting, with 42 members voting in favor  
of the recommendation, 0 members opposed, 0 members  
abstaining and 0 present but not eligible)

Denial unless all stipulations agreed to by applicant/owner are part of the method of operation  
 Denial  Approval

**CB4 REPRESENTATIVES**

  
Nelly Gonzalez  
CB4 Assistant District Manager

  
Frank Holczabiec  
CB4 BLP Committee Co-Chair

  
Burt Lazarin  
CB4 BLP Committee Co-Chair

**APPLICANT AGREEMENT WITH THE COMMUNITY**

Applicant agrees to these stipulations as the basis for the community support of this application and acknowledges that all of these stipulations are essential prerequisites to the MCB4 recommendation regarding this application. Applicant agrees to have these stipulations incorporated in the method of operation of its liquor license. The stipulations in this application constitute the entire agreement between MCB4 and applicant and may only be altered in writing signed by MCB4 and applicant. These stipulations supersede any oral statements or representations in connection with this application.

**SIGN HERE** →

Nicoles  
Dutko  
PRINT NAME OF APPLICANT

  
SIGNATURE OF APPLICANT

9/8/2020  
~~9/20/20~~  
DATE



## JUICES & SMOOTHIES / 8

**DELICIOUS TRIO**  
apple, pineapple & orange

**CITRUS SQUEEZE**  
orange, grapefruit & lemon

**SWEET GINGER**  
apple, pear & ginger

**GREEN BOOST**  
apple, cucumber, celery & kale

**BEET ME UP**  
beet, apple, carrot, lemon & ginger

**MATCHALICIOUS**  
banana, blueberry, matcha & milk

**WILD SPIRIT**  
banana, apple, strawberry & milk

**CREATE YOUR OWN / pick 4 max**  
apple, pear, orange, grapefruit, lemon, pineapple, banana, strawberry, raspberry, blueberry, carrot, celery, cucumber, beet, kale, ginger, oat, milk, vegan milk (+0.5), turmeric (+1) & matcha (+1)

## WATERS & SODAS

EVIAN / BADOIT / 3/7

COKE / DIET COKE / 2.5

MEXICAN COKE / 3

ARANCIAITA / LIMONATA / 3

## COFFEES

COFFEE / 2.5 / 3

AMERICANO / 3.75

ESPRESSO / 3.5

MACCHIATO / 3.75

CAPPUCINO / 4.5

LATTE HOT / ICED / 4.75

COLD BREW / 4.5 / 5.5

HOT CHOCOLATE / 4.75

/ *vegan milk* +0.5

## WELLNESS DRINKS

CHAI LATTE HOT / ICED / 4.75

GOLDEN LATTE HOT / ICED / 4.75

MATCHA LATTE HOT / ICED / 5

## TEAS BY PALAIS DES THÉS / 3.5



# tartinery

## BREAKFAST 7am - 11am

- CROISSANT / 4**  
**CROISSANT AUX AMANDES / 4.75**  
*almond croissant*
- PAIN AU CHOCOLAT / 4.5**  
*chocolate croissant*
- HAM & CHEESE CROISSANT / 5.95**
- HAM & CHEESE FICELLE / 6.5**
- BRIE & FIG FICELLE / 6.5**
- PROSCIUTTO FICELLE / 6.5**
- SMASHED AVOCADO TOAST / 9**  
*radish, red pepper flakes & cilantro*  
*/ add soft-boiled egg +2.5*
- EGG & SMOKED SALMON TOAST / 12**  
*crème fraîche & dill*
- EGG & CHEESE BRIOCHE / 5**  
*add bacon +2.5 / avocado +3.5*
- GRANOLA PARFAIT / 8**  
*greek yogurt, berries & honey*
- CHIA BOWL / 8**  
*banana, berries, coconut, flaxseeds & agave*

## SMALL PLATES

- BURRATA / 18**  
*prosciutto, heirloom tomatoes, basil*
- RAVIOLES DU ROYANS / 15.5**  
*baked cheese raviolis*
- LENTIL SALAD / 8.5**  
*tomato, avocado & ricotta salata*
- CHEESE BOARD / 20**  
*/ add charcuterie +9*

## TOASTS SEVEN GRAIN

- SMASHED AVOCADO / 9**  
*radish, red pepper flakes & cilantro*  
*/ add soft-boiled egg +2.5*
- HAM & SWISS / 8.5**  
*frisée, apple, honey & dijon*
- TURMERIC CHICKEN / 8.5**  
*radish, celery & seeds*
- TUNA SALAD / 8.5**  
*celery, baby spinach, sprouts & harissa mayo*

## SALADS & BOWLS

- CHOPPED KALE CEASAR / 12**  
*chickpeas, radish & pecorino*
- GOAT CHEESE SALAD / 14.5**  
*frisée, spinach, bacon crumble, pine nuts & toast*
- QUINOA BOWL / 14**  
*carrot, avocado, spinach, edamame, almond, cilantro & mint*
- WILD RICE BOWL / 13.5**  
*kale, edamame, pickled red onion, spinach, pepitos & pesto*

## ADD

- SMOKED SALMON +5.5**
- CHICKEN +4**
- SOFT-BOILED EGG +2.5**
- AVOCADO +3.5**
- FETA +3**
- TOFU +3**

## TARTINES

- LABNEH / 12.5**  
*add side green salad +2.5*
- CREAMY BURRATA / 16**  
*baby heirloom tomato & basil*
- HUMMUS & AVOCADO / 13.5**  
*hard-boiled egg & sprouts*
- RICOTTA & PROSCIUTTO / 14.5**  
*honey glazed grapes & walnuts*
- ROAST BEEF / 15**  
*pecorino, arugula & truffle mayo*
- CHICKEN SALAD / 14**  
*shaved celery & toasted pistachio*

- CLUB / 15.5**  
*turkey, brie, bacon, tomato, spinach & mayo*
- CROQUE MONSIEUR / 14**  
*ham, gruyère & bechamel*  
*/ make it a madame with a sunny side up egg +2.5*
- SMOKED SALMON / 18.5**  
*crème fraîche, capers & radish*  
*/ add soft-boiled egg +2.5*

## SOUPS

- BUTTERNUT SQUASH / 7.5**
- GAZPACHO / 8**
- VEGAN / 7.5**

## SWEETS / 8

- CHEESE CAKE**  
*raspberry coulis*
- CHIA BOWL**  
*banana, berries, coconut, flaxseeds & agave*

## LUNCH COMBO

11AM TO 3PM / 12.5  
 SOUP + TOAST

- NUTELLA TARTINE**  
*caramelized banana*
- STRAWBERRY TARTINE**  
*whipped cream & dulce de leche*

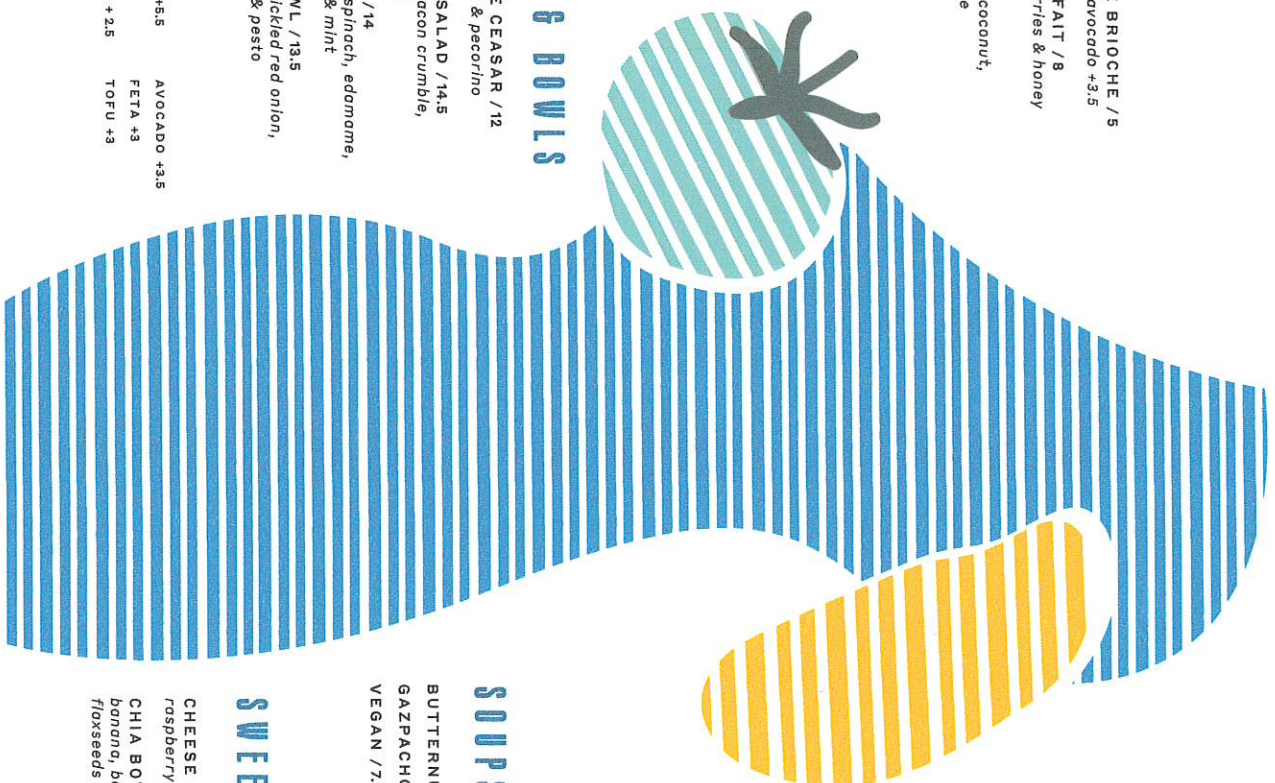

# THE RESTAURANT AND BAR COLLECTION



**PUBLIC NOTICE**

Business Licenses and Permits Committee  
will discuss an application submitted by  
**Tartinery Columbus LLC**  
to Columbus Circle,  
**The Shops at Columbus Circle**

A Site Update, Sign, Beer & Cider application for a  
Temporary Establishment with Alcohol Sale

**DATE:** Tuesday, September 8, 2020  
**TIME:** 10:00 AM - 12:00 PM  
**PLACE:** 1500 Columbus Circle, Room 1000  
1500 Columbus Circle, Room 1000  
COLUMBUS, OHIO 43260

For more information, please contact the City of Columbus, Department of Public Safety, Business Licenses and Permits Committee, 1500 Columbus Circle, Room 1000, Columbus, Ohio 43260. Phone: (614) 622-3333. Email: [blpc@cityofcolumbus.org](mailto:blpc@cityofcolumbus.org)



First floor distance  
 $97' + 64' = 161'$

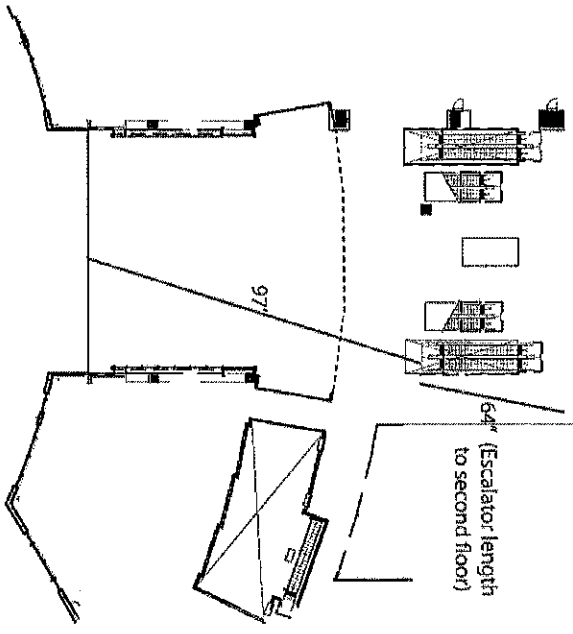

Second floor distance  
 $16' + 30' + 23' + 38' = 107'$

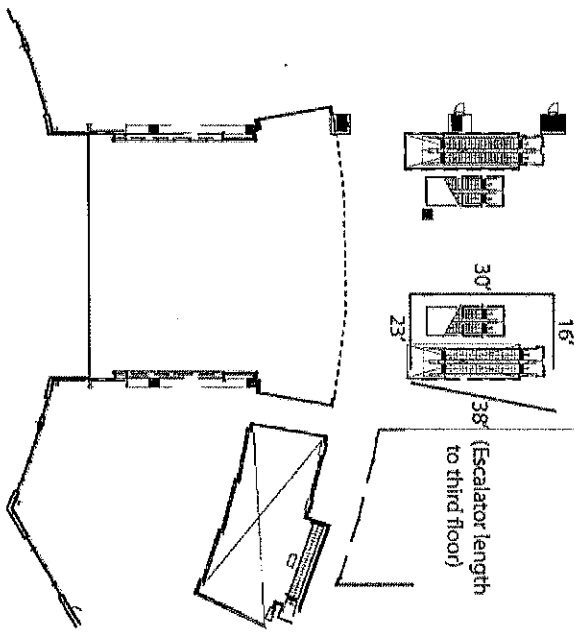

Third floor distance  
 $56' + 11' = 67'$

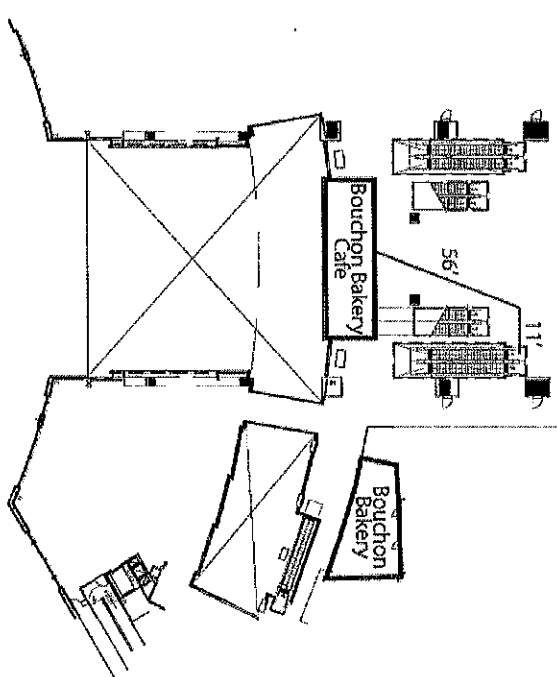

Total interior distance  
 $161' + 107' + 67' = 335'$

AREA SURVEY 1  
(Interior walking distance)  
10 Columbus Circle  
New York, NY  
August 29, 2020  
NOT TO SCALE

**Landess-Simon, Inc.**

Legal & Commercial Photography

45 Lawlins Park  
Wyckoff, NJ 07481  
Phone: (201) 848-5652  
E-mail: landess@att.net  
landessphotographers.com

Res 10 Columbus Circle

---

1. Jazz @ Lincoln Center Inc. - 10 Columbus Circle 5<sup>th</sup> & 6<sup>th</sup> Floors - (218')
2. Masa - 10 Columbus Circle 4<sup>th</sup> Floor - (135')
3. Momofuku - 10 Columbus Circle 3<sup>rd</sup> Floor - (150')
4. Bluebird Cafe - 10 Columbus Circle 3<sup>rd</sup> Floor - (212')
5. Center Bar - 10 Columbus Circle 4<sup>th</sup> Floor - (60')
6. Whole Foods Cafe - 10 Columbus Circle Cellar 1 - (120')
7. Porter House - 10 Columbus Circle 4<sup>th</sup> Floor - (113')
8. Landmarc - 10 Columbus Circle 3<sup>rd</sup> Floor - (159')
9. Ascent Lounge - 10 Columbus Circle 4<sup>th</sup> Floor - (102')
10. Per Se - 10 Columbus Circle 4<sup>th</sup> Floor - (191')
11. Barmasa - 10 Columbus Circle 4<sup>th</sup> Floor - (181')

Schools & Churches

No schools and churches within 500' area.



---

## Tartinery Columbus LLC - The Shops at Columbus Circle

---

Nicolas Dutko <nicolas@tartinery.com>

Sat, Aug 29, 2020 at 5:10 PM

Cc: "Gonzalez, Nelly (CB)" <negonzalez@cb.nyc.gov>

Bcc: rjbenfatto@hyhkalliance.org, pgouris@hyhkalliance.org, kathleentreat123@gmail.com, mcgee79@aol.com, cberthet@me.com, jrestuccia2@clintonhousing.org, info@clintonhousing.org, rmarcano@clintonhousing.org, eduardozeiger@compuserve.com, mpta@mptenants.com, ashleyll@aol.com, twocatsltd@worldnet.att.net, Rudi\_Papiri@timemagazine.com, tangotanner@gmail.com, west45ba@gmail.com, chanawid@gmail.com, block45@hellskitchen.net, stephenfanto@gmail.com, AllisonTupper@verizon.net, hudson62747@hotmail.com, info@west46streetblockassociation.org, andrewbegg@yahoo.com, aefearshk@earthlink.net, larrymichaelroberts@gmail.com, jamesbogues@gmail.com, mariagnys@aol.com, ecelnik@actorsfund.org, rpimentel@commonground.org, dsage@commonground.org, nkyriacou@yahoo.com, gdclay@att.net, john.mudd@usa.net, info@hcc-nyc.org, ploeb315@aol.com, west55ba@gmail.com, hk5051@gmail.com, tenants350west51st@gmail.com, rrlarios@hotmail.com, acernitz@gmail.com, awm3333@me.com, jessbondy@aol.com, john.waldman@redcross.org, juliacampanelli@gmail.com

Good afternoon,

I am the founder of a small restaurant group located in New York City called Tartinery ([www.tartinery.com](http://www.tartinery.com)). Our first restaurant opened in Nolita 10 years ago. We now have four locations across the city: The Plaza Food Hall, Hudson Eats, Midtown and Grand Central.

Tartinery is a casual French inspired café-bar serving tartines, salads, baked goods, coffee, fresh juices, beer, wine and liquor.

We are excited to be opening later this year our fifth location at The Shops at Columbus Circle in the former Bouchon Bakery space located on the 3rd floor. We will be operating a takeaway counter and a café with 50 seats (2,358 sf total) and our hours of operation will be 7am to 9pm from Monday to Friday and 8am to 9pm Saturday and Sunday. We are applying for a liquor license and will be presenting our application in front of the Community Board #4 on Tuesday September 8, 2020 at 6:30pm.

Please let me know if you have any questions or concerns.

I look forward to welcoming you at our future location very soon.

Sincerely,

Nicolas

--  

NICOLAS DUTKO | FOUNDER |

e. [nicolas@tartinery.com](mailto:nicolas@tartinery.com)

---

IG: [@tartinery](https://www.instagram.com/tartinery) WS: [www.tartinery.com](http://www.tartinery.com)