

Manhattan Community Board 4

(All Fields Must Be Completed)

Liquor License/Sidewalk Cafe Stipulations Application

CORPORATION NAME 528, CORP.		DOING BUSINESS AS (DBA) UNIDENTIFIED FLYING CHICKEN (UFC)		
STREET ADDRESS 528 9 AVENUE		CROSS STREETS W.39 & W.40 STREET		ZIP CODE 10018
OWNER <small>(Attach a list of all the people that will be associated/listed with the license)</small>	NAME: JUNG HWA BAE	ATTORNEY/ REPRESENTAIVE	NAME: SHYCIOR HUNG FONG	
	PHONE: 646-422-7451		PHONE: 917-535-5051	
	EMAIL: young@ufchicken.com		EMAIL: restaurant.total@gmail.com	
MANAGER	NAME: YOUNG JIN	LANDLORD	NAME: ALAN WASSERMAN	
	PHONE: 347-582-1520		PHONE: 917-637-6200	
	EMAIL: young@ufchicken.com		EMAIL: N/A	
APPLICATION TYPE (<input checked="" type="checkbox"/> <i>Liquor License</i> <input type="checkbox"/> <i>Unenclosed Sidewalk Cafe</i>)				
<input checked="" type="checkbox"/> New	Has applicant owned or managed a similar business?		<input checked="" type="checkbox"/> YES	<input type="checkbox"/> NO
	What is/was the name and address of establishment?		UFC	
	What were the dates applicant was involved with this former premise?		SINCE 2007	
<input type="checkbox"/> Corp Change/Class Change/Removal	What is the license # and expiration date?			
	Is applicant making any alterations or operational changes?		<input type="checkbox"/> YES	<input type="checkbox"/> NO
	<i>If alterations or operational changes are being made, please describe/list all changes.</i>			
<input type="checkbox"/> Alteration	What is the current license # and expiration date?			
	<i>Please list/describe the nature of all the changes and attach the plans:</i>			
METHOD OF OPERATION				
TYPE OF ALCOHOL	<input type="checkbox"/> Liquor/Wine/Beer & Cider <input type="checkbox"/> Beer & Cider <input checked="" type="checkbox"/> Wine/Beer & Cider			
ESTABLISHMENT TYPE	<input checked="" type="checkbox"/> Restaurant <input type="checkbox"/> Cabaret <input type="checkbox"/> Night Club <input type="checkbox"/> Hotel <input type="checkbox"/> Bar/Tavern <input type="checkbox"/> Catering Establishment <input type="checkbox"/> Adult Entertainment <input type="checkbox"/> Wine Bar <input type="checkbox"/> Dance Club <input type="checkbox"/> Sports Bar <input type="checkbox"/> Club (Fraternal Organization – Members Only)			
Has applicant/owner filed with the SLA? If yes, when? If no, when do you plan to file?	YES	<input checked="" type="checkbox"/>	After we obtain approval with the CB meeting	
Is the 500 Foot Rule applicable? If yes, please attach a diagram of the On-Premise liquor license establishments within a 500 ft. radius of your establishment and the Public Interest Statement.	YES	<input checked="" type="checkbox"/>		
Is the 200 Foot Rule applicable? If yes, please attach a diagram of the schools and houses of worship that trigger the rule.	YES	<input checked="" type="checkbox"/>		
Has applicant/owner(s) read MCB4 Policy Regarding Concentration and Location of Alcoholic-Serving Establishments?	<input checked="" type="checkbox"/>	NO		

OPERATIONAL DETAILS (*Closing time will be when establishment is vacated of all patrons)

HOURS* <i>(Indoor Only)</i>		MONDAY	TUESDAY	WEDNESDAY	THURSDAY	FRIDAY	SATURDAY	SUNDAY
	Operation	11am-11pm	11am -11pm	11am-11pm	11am-11pm	11am-11pm	11am-11pm	11am-11pm
	Kitchen	SAME	SAME	SAME	SAME	SAME	SAME	SAME
	Music	SAME	SAME	SAME	SAME	SAME	SAME	SAME

If you plan to have music, what type(s)? (Circle all that apply)

<input checked="" type="checkbox"/> BACKGROUND	<input type="checkbox"/> LIVE MUSIC	<input type="checkbox"/> DJ	<input type="checkbox"/> JUKE BOX	<input type="checkbox"/> KARAOKE
--	-------------------------------------	-----------------------------	-----------------------------------	----------------------------------

OCCUPANCY

	Capacity (Certificate of Occupancy)	Maximum # of Persons You Anticipate Occupying Premises (Including Employees)	Number of Tables	Number of Seats	Number of Service Only Bars	Number of Stand-Up Bars	Number of Seats at Stand-Up Bar
INSIDE	LESS THAN 74PPL	36	16	31	0	0	0
OUTSIDE <i>(Other than sidewalk café)</i>	N/A						
SIDEWALK CAFÉ	N/A						

How many floors are there? What is the capacity for each floor?

2 FLOORS
GROUND FL (33) AND BASEMENT (3PPL)

How frequently will the owner(s) be at the establishment?

EVERY DAY DURING THE DAYTIME

Will there be dancing?

YES NO

Will applicant have bottle or table service for beverage alcohol?

YES NO

Will you be hosting private; promotional or corporate events?

YES NO

Will outside promoters be used on a regular basis? If yes please describe.

YES NO

Will you have a security plan? If, yes please attach.

YES NO

Will security plan be implemented?

YES NO Manager will be on premise

Will State certified security personnel be used?

YES NO

Will New York Nightlife Association and NYPD Best Practices be followed?

YES NO

Will applicant be using delivery bicycles? If yes, how many?

YES NO 2 BYCICLES

Will delivery bicycles be clearly marked with the name of the restaurant and will staff wear attire clearly noting name as described by NYC Law?

YES NO

Where will delivery bicycles be stored during the day when not in use?

BASEMENT REAR SIDE AS PER FLOOR PLAN

LOCATION & ZONING

Is this a Special District? If yes, is it Clinton, West Chelsea or Hudson Yards?	YES	<input checked="" type="checkbox"/>	
Does the building have a Certificate of Occupancy ("C of O") or a letter of no objection?	<input checked="" type="checkbox"/>	NO	
Is a Public Assembly permit required?	YES	<input checked="" type="checkbox"/>	
Are your plans filed with DOB?	YES	<input checked="" type="checkbox"/>	There were no changes in occupancy for many years. No new plans filed with DOB

Community Notification/Relations

NOTIFICATION: List all block associations; tenant associations, co-op boards or condo boards of residential buildings; and community groups that applicant has notified regarding its application. For each please list both the organization and individual you contacted	# 1	NONE		
	# 2			
	# 3			
	# 4			
	# 5			
Please provide dates when applicant met with the groups listed above.	N/A			
Who was your contact person at each group you met with?	N/A			
When did applicant post the notice that was provided?	JULY 03, 2018			
Where did applicant post the notice that was provided?	ON THE WINDOW ENTRANCE DOOR			
Will applicant provide owner cell phone number to neighbors and respond to complaints that arise? Please provide number in space provided.	<input checked="" type="checkbox"/>	NO	347-420-1123	
Will applicant inform the Community Board office of its job openings and/or provide a hyperlink to applicants jobs webpage?	<input checked="" type="checkbox"/>	NO		

BUILDING DESIGN			
State the name and type of business previously located in the space.	ATOMIC WINGS - FAST FOOD RESTAURANT		
Has a liquor-licensed establishment previously occupied this space at any time? If yes, please provide the name of the business.	<input checked="" type="checkbox"/> YES	<input type="checkbox"/> NO	ATOMIC WINGS (KNS WING TIME INC)
Do you plan any changes to the existing façade? If yes, please describe.	YES	<input checked="" type="checkbox"/> NO	
Will applicant have a vestibule within the establishment?	YES	<input checked="" type="checkbox"/> NO	
Will applicant use a storm enclosure?	YES	<input checked="" type="checkbox"/> NO	
Will applicant not place any items or obstructions on the sidewalk, for example, sandwich boards, sidewalk signs, freestanding menus and plants, as per the law?	YES	<input checked="" type="checkbox"/> NO	
Will applicant comply with the NYC noise code?	<input checked="" type="checkbox"/> YES	<input type="checkbox"/> NO	
Will the establishment have any of the following: (circle all that apply) N/A	<input checked="" type="checkbox"/> FRENCH DOORS	<input type="checkbox"/> GARAGE DOORS	<input type="checkbox"/> WINDOWS THAT CAN BE OPENED
Will applicant close all windows, French doors, garage doors when any music or amplified sound (including televisions) is played inside the establishment?	<input checked="" type="checkbox"/> YES	<input type="checkbox"/> NO	
Will applicant close all windows, French doors, garage doors by 11 PM Friday and Saturday and 10 PM on all other days even if no music or amplified sound is played inside the establishment?	<input checked="" type="checkbox"/> YES	<input type="checkbox"/> NO	
Has applicant obtained an acoustical report from a certified sound engineer to assess potential noise disturbance to the neighboring residents and buildings?	YES	<input checked="" type="checkbox"/> NO	
Will applicant follow the recommendations of a certified sound engineer to mitigate potential noise disturbance to the neighboring residents and buildings, including placing speakers on the floor of the establishment?	<input checked="" type="checkbox"/> YES	<input type="checkbox"/> NO	
Will the kitchen exhaust system extend to the roof?	<input checked="" type="checkbox"/> YES	<input type="checkbox"/> NO	
Will the establishment have an illuminated sign?	YES	<input checked="" type="checkbox"/> NO	
Will the establishment have a canopy extending over the sidewalk?	YES	<input checked="" type="checkbox"/> NO	
Where will the air conditioner be located? What type is it?	FRIEDRICH CHILL WINDOW AC LOCATED ON THE DINING ROOM		
When was the air conditioner installed?	PREVIOUSLY INSTALLED BY PREVIOUS OWNER		

OUTDOOR ITEMS - OTHER THEN SIDEWALK CAFÉ

Has the applicant/owner(s) read MCB 4 Rear Yard Rooftop Policy?	<input checked="" type="checkbox"/> YES	<input type="checkbox"/> NO	
Will applicant use any outdoor spaces: rooftop, rear yard, patio, porch, balcony, pavilion, tents, deck or gazebo? If yes, which one(s)?	<input type="checkbox"/> YES	<input checked="" type="checkbox"/> NO	
Are the floorplans for the outdoor space(s) included?	<input type="checkbox"/> YES	<input checked="" type="checkbox"/> NO	
Will applicant close and vacate the outdoor space(s) by 11PM on Friday & Saturday and 10 PM on all other days?	<input type="checkbox"/> YES	<input type="checkbox"/> NO	N/A
Will the service and consumption of alcohol in any outdoor space only be via seated food service?	<input type="checkbox"/> YES	<input type="checkbox"/> NO	N/A
Will applicant not allow standing space for patrons to drink or smoke in any outdoor space(s)?	<input type="checkbox"/> YES	<input type="checkbox"/> NO	N/A
Will there be no amplified music, as per the law?	<input type="checkbox"/> YES	<input checked="" type="checkbox"/> NO	
If amplified sound is played inside the establishment, will windows and doors be closed?	<input type="checkbox"/> YES	<input type="checkbox"/> NO	N/A
Will applicant agree to post signs outside asking customers to respect the neighbors'?	<input checked="" type="checkbox"/> YES	<input type="checkbox"/> NO	
Will applicant agree to train staff to encourage a peaceful environment?	<input checked="" type="checkbox"/> YES	<input type="checkbox"/> NO	
Will applicant provide effective sound control (landscaping enclosure, soundproofing tenants apartments)	<input checked="" type="checkbox"/> YES	<input type="checkbox"/> NO	
Will there be a lighting plan that allows safe usage of the outdoor space without disrupting neighbors?	<input type="checkbox"/> YES	<input type="checkbox"/> NO	N/A

OUTDOOR ITEMS – SIDEWALK CAFÉ			
Has the applicant/owner(s) read MCB4 Sidewalk Café Policy?	YES	NO	N/A
Will applicant be applying for a sidewalk café now or in the future?	YES	NO	N/A
Is applicant in this application seeking to include a sidewalk café in its liquor license?	YES	NO	N/A
If yes, has applicant submitted an application and plans to NYC Dept. of Consumer Affairs? Please attach application and plans.	YES	NO	N/A
Will applicant close and vacate the sidewalk café by 11 PM on Friday & Saturday and 10 PM on all other days?	YES	NO	N/A
Will applicant be serving alcohol in the sidewalk café? If so, will you have waiter service?	YES	NO	N/A
Will the café have a 3 ft. wide serving aisle running the entire length of the sidewalk cafe?	YES	NO	N/A
Will applicant mark the perimeter of the café on the sidewalk?	YES	NO	N/A
Will the service and consumption of alcohol in the sidewalk café only be via seated food service?	YES	NO	N/A
Will the sidewalk café not provide standing space for drinking or smoking?	YES	NO	N/A
Will applicant use any portable natural gas heaters? If so, do you have the requisite approvals from DOB & the Fire Department?	YES	NO	N/A
Will applicant have a lighting plan that will allow safe usage of the outdoor space without disrupting neighbors?	YES	NO	N/A
Will all furniture, plants and barricades be stored inside between the evening closing hours and the morning opening hours?	YES	NO	N/A
Will all furniture be stored inside between December 21 st and March 21 st , and any other day when it rains or snows?	YES	NO	N/A
Will applicant use umbrellas?	YES	NO	N/A
If construction or construction protection has reduced the sidewalk width, will applicant always maintain an 8 foot clear path of sidewalk between the perimeter of the café and the closes obstruction including construction barricades?	YES	NO	N/A

ADDITIONAL STIPULATIONS: (Office Use Only)

To the extent any additional stipulation on pages 7 and 8 of this application conflicts with any response on pages 1 – 6 of this application, the stipulations on pages 7 and 8 control.

To the extent any additional stipulation on pages 7 and 8 of this application conflicts with any response on pages 1 – 6 of this application, the stipulations on pages 7 and 8 control.

Manhattan Community Board 4 (MCB4) recommends:
 (MCB4's recommendation is based on a vote taken at its
7 / 25 / 18 full board meeting, with 29 members voting in favor
 of the recommendation, 0 members opposed, 0 members
 abstaining and 0 present but not eligible)

Denial unless all stipulations agreed to by applicant/owner are part of the method of operation

Denial Approval

CB4 REPRESENTATIVES



 Nelly Gonzalez
 CB4 Assistant District Manager

 Frank Holozubiec
 CB4 BLP Committee Co-Chair

 Yoni Bokser
 CB4 BLP Committee Co-Chair

APPLICANT AGREEMENT WITH THE COMMUNITY

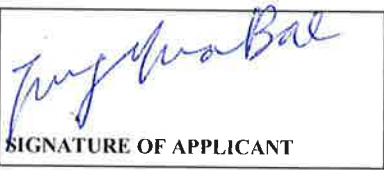
Applicant agrees to these stipulations as the basis for the community support of this application and acknowledges that all of these stipulations are essential prerequisites to the MCB4 recommendation regarding this application. Applicant agrees to have these stipulations incorporated in the method of operation of its liquor license. The stipulations in this application constitute the entire agreement between MCB4 and applicant and may only be altered in writing signed by MCB4 and applicant. These stipulations supersede any oral statements or representations in connection with this application.

<p>SIGN HERE →</p>	<p>JUNG HWA BAE PRINT NAME OF APPLICANT</p>	<p> SIGNATURE OF APPLICANT</p>	<p>07/10/2018 DATE</p>
---------------------------	--	---	-------------------------------------

Jen Salad \$6.95

red green, carrot, red onion, tomato, cucumber with UFC dressing

Spicy Shrimp Salad \$11.95

red greens, carrot, red onion, tomato, cucumber with our honey dressing

Caesar Salad \$7.95

romaine, Parmesan cheese & croutons with Caesar dressing

Top it off with Grilled or Crispy Chicken \$3.95

BURGERS & SANDWICHES

all served with Tom cat Bakery Brioche buns.

Classic Burger \$7.95

lettuce, tomato, onion, pickle, UFC aioli

Onion \$0.75

Cheese \$0.75

Cheddar Burger \$11.95

cheddar, cheddar & american cheese, bacon, lettuce, tomato, onion, chipotle aioli

Spicy Chicken Burger \$7.95

chicken, tomato, onion, pickle, UFC aioli

Spicy Bulgogi Burger \$11.95

marinated beef rib eye, caramelized onion, lettuce, pickle, onion

Spicy Shi Burger \$9.95

lettuce, tomato, onion, fried kinchi, UFC aioli

Spicy Chicken Parm Panini \$7.95

chicken, marinara sauce, lettuce, tomato, onion on a panini

Smokey Burger \$8.95

6oz, onion rings, caramelized onion, mushroom & ranch, smoked BBQ sauce

Waffle Burger \$11.95

6oz, lettuce, tomato, onion, pancake syrup

Grilled Chicken Burger \$7.95

lettuce, tomato, onion, pickle, UFC aioli

Spicy Pork Bulgogi \$11.95

marinated spicy pork, caramelized onion, green onion with lettuce & white rice

Chicken Ranch B.L.T. Panini \$7.95

bacon, lettuce, tomato, onion, ranch sauce on a panini bread

Crispy

Grilled

Make it a Deluxe!

Page

Page

Delicious Chicken Combo \$9.95

Delicious chicken, choice of rice or fries & one side

or

or

Spicy Pork Bulgogi \$11.95

Marinated spicy pork, caramelized onion, green onion with rice & white rice.

Spicy Bulgogi & Japchae Combo \$15.95

Spicy Bulgogi & Japchae over rice

Beef Bulgogi \$12.95

Marinated rib eye, caramelized onion, green onion with lettuce served with steamed rice.

Japchae Noodle Bowl \$10.95

Stir fried vegetables with sweet potato noodles flavored with sesame oil & soy sauce over rice

Hamburg Steak \$12.95

Burger patty, caramelized mushroom & onion, gravy sauce with salad & choice of rice or fries

Rice

Fries

Delicious Fried Rice \$10.95

Fried kimchi, rice, scallion, fried egg

Crispy Chicken Katsu \$11.95

FRIED CHICKEN

We are proud to serve Tecumseh Farms's Smart Chicken wings, the only in the country both certified organic & certified humane by humane animal care. Choose Flavors - Hot / Soy Garlic / BBQ Mustard / Sweet & Spicy or Plain

Small - 6 pcs \$6.95

Medium - 10 pcs \$10.95

Large - 20 pcs \$19.95

X-Large - 30 Wings \$28.95

Drumsticks

Small - 2 pcs \$5.95

Medium - 5 pcs \$10.95

Large - 10 pcs \$19.95

X-Large - 15 pcs \$28.95

Wings & Drums Combo

Small - 4 wings & 1 Drum \$7.95

Medium - 6 wings & 3 Drums \$11.95

Large - 10 wings & 5 Drums \$20.95

X-Large - 16 Wings & 8 Drums \$29.95

Half Chicken \$11.95

1.5 lb Cut in small pieces

Whole Chicken \$19.95

ONELESS CHICKEN SPECIALTIES

Garlic Parmesan \$12.95

Garlic Parm sprinkled & melted mozzarella cheese.

Raffalo (Boneless) \$11.95

Raffalo wing sauce with celery & blue cheese.

Boneless Chicken & Waffle \$12.95

Choose your favorite sauce or dipping aioli & pancake syrup.

Smoked BBQ Ranch \$11.95

Boneless Chicken & Fries \$9.95

Choose your favorite sauce or dipping aioli

SIDES

French Fries \$3.95

Sweet Potato Fries \$4.95

Macaroni Salad \$2.50

Cheese \$2

Onion Rings \$5.95

Coleslaw \$2.50

Korean Radish \$2.50

Aioli & Dipping Sauce \$0.75

Mango Aioli

Chipotle Aioli

Sriracha Aioli

Ketchup

Honey Mustard

Ranch

Blue Cheese

Smoked BBQ Sauce

BRUNCH SPECIAL

10 am - 3:30 pm Monday - Friday

Delishious Chicken Combo \$7.95

Delishious chicken + choice of rice or fries & optional One side (not counted)

Delicious Pork Bulgogi \$8.95

Marinated spicy pork, caramelized onion, green onion with white rice & white rice.

Delicious Bulgogi & Japchae Combo \$12.95

Delicious Bulgogi & Japchae over rice

Beef Bulgogi \$9.95

Marinated beef rib eye, caramelized onion, green onion with lettuce and steamed rice.

Japchae Bab \$8.95

Stir fried vegetables with sweet potato noodles flavored with sesame oil & soy sauce over rice

AVERAGE

Limited refill except canned soda

Unflavored SODA \$2.50

Choice • Diet Coke • Sprite • Ginger Ale • Orange Soda

JUICE \$3.75

Apple • Cranberry • Orange Juice • Pineapple

Unflavored TEA \$3.25

Choice • Lemon Sweet • Unsweetened • Half & Half • Diet Raspberry Pom • Raspberry • Peach Passion • Toshiimi Green

HOT TEA POT \$4.75

Green Tea • Green Tea Decaf • Chai Spice • Jasmine Blossom • Mango Passionfruit • Peppermint

Unflavored FEE \$3

Bottled Water \$2

Unflavored COFFEE \$3.75

STARTERS

cheese Fries \$6.95
 crispy Fries covered in melted cheddar cheese & bacon bits.

Spicy Pork Bulgogi Fries \$9.95
 fries covered in marinated pork loin & melted cheese.

Queso & Cheese \$4.95
 covered in melted cheddar cheese and jalapenos

Beef Bulgogi Slider \$12.95
 marinated beef rib eye, caramelized onion, lettuce, pickle,
 shallion

Grilled Corn on the Cob \$4.95
 Qajita cheese, mayo, cayenne pepper.

Beef Bulgogi Empanada (2) \$7.95
 marinated rib eye beef, sweet potato noodles, vegetables,
 mozzarella cheese.

Japchae Vegi Empanada \$5.95
 sweet potato noodles, onion, mushroom, carrot, paprika &
 abbage

Korean Vegetable Pancake \$10.95
 shallion, onion, carrot, zucchini served with house dipping
 sauce

Poutine Fries \$8.95
 Fries & cheese curds topped with brown gravy

Coconut Fried Shrimp (8) \$9.95
 choice of one aioli or dipping sauce

Mozzarella Sticks (8) \$6.95
 with marinara sauce

Pork Bulgogi Sliders \$11.95
 marinated pork loin, caramelized onion, green onion, pickled
 radish.

Japchae Noodle \$9.95
 stir fried vegetables with sweet potato noodles flavored with
 sesame oil & soy sauce topped with egg & sesame seeds.

Spicy Pork Bulgogi Empanada (2) \$6.95
 marinated pork loin, sweet potato noodles, vegetables,
 mozzarella cheese.

Korean Seafood Pancake \$13.95
 pan fried seafood & vegetables served with house dipping
 sauce

Kimchi pancake \$10.95
 kimchi Korean pancake served with house dipping sauce

STARTERS

Cheese Fries \$6.95

Crispy Fries covered in melted cheddar cheese & bacon bits.

Spicy Pork Bulgogi Fries \$9.95

Fries covered in marinated pork loin & melted cheese.

Queso & Cheese \$4.95

Covered in melted cheddar cheese and jalapenos

Beef Bulgogi Slider \$12.95

Marinated beef rib eye, caramelized onion, lettuce, pickle, shallion

Grilled Corn on the Cob \$4.95

Quesito cheese, mayo, cayenne pepper.

Beef Bulgogi Empanada (2) \$7.95

Marinated rib eye beef, sweet potato noodles, vegetables, mozzarella cheese.

Japchae Vegi Empanada \$5.95

Sweet potato noodles, onion, mushroom, carrot, paprika & cabbage

Korean Vegetable Pancake \$10.95

Shallion, onion, carrot, zucchini served with house dipping sauce

Poutine Fries \$8.95

Fries & cheese curds topped with brown gravy

Coconut Fried Shrimp (8) \$9.95

Choice of one aioli or dipping sauce

Mozzarella Sticks (8) \$6.95

With marinara sauce

Pork Bulgogi Sliders \$11.95

Marinated pork loin, caramelized onion, green onion, pickled radish.

Japchae Noodle \$9.95

Stir fried vegetables with sweet potato noodles flavored with sesame oil & soy sauce topped with egg & sesame seeds.

Spicy Pork Bulgogi Empanada (2) \$6.95

Marinated pork loin, sweet potato noodles, vegetables, mozzarella cheese.

Korean Seafood Pancake \$13.95

Pan fried seafood & vegetables served with house dipping sauce

Kimchi pancake \$10.95

Kimchi Korean pancake served with house dipping sauce

Proximity Report for Location:

July 5, 2018

528 9 Ave, New York, NY, 10018

* This report is for informational purposes only in aid of identifying establishments potentially subject to 500 and 200 foot rules. Distances are approximated using industry standard GIS techniques and do not reflect actual distances between points of entry. The NYS Liquor Authority makes no representation as to the accuracy of the information and disclaims any liability for errors.

Closest Liquor Stores

Name	Address	Approx. Distance
39TH STREET WINE INC	354 W 39TH ST	375 ft
SHILORI INC	486 9TH AVENUE	545 ft
589 NINTH AVENUE CORP	589 9TH AVENUE	725 ft
474 9TH AVE INC	474 9TH AVENUE	755 ft
GM & M RETAIL LIQUOR INC	302 W 40TH STREET	825 ft
CAMBRIDGE WINES & LIQUORS INC	594 8TH AVENUE	885 ft
460 WINE MARKET INC	460 W 42ND ST	965 ft

Churches within 500 Feet

Name	Approx. Distance
------	------------------

Schools within 500 Feet

Name	Address	Approx. Distance
------	---------	------------------

On-Premise Licenses within 750 Feet

Name	Address	Approx. Distance
542 TACO LLC	524 9TH AVE	40 ft
HOLLAND COCKTAIL LOUNGE INC	532 9TH AVENUE	75 ft
523 9TH AVENUE INC	523 9TH AVE	85 ft
STHK LLC	522 9TH AVE	95 ft
Blue Ruin Inc	538 9TH AVENUE	175 ft
511 9TH COMERCIAL LLC	511 9TH AVE	220 ft
MANGITALIA LLC	506 9TH AVE	240 ft
IL PUNTO RISTORANTE LLC	507 509 9TH AVE	240 ft
WALKINSTOWN INC	508 9TH AVE	280 ft
MIX 2 CORP	506 9TH AVE	305 ft
MORELAND INC	356 W 40TH STREET	380 ft
PROJECT X VENTURES LTD	339 W 38TH ST	390 ft
TAMBURI TRATTORIA LTD	352 W 39TH STREET	390 ft
NYHK WEST 40TH LLC / 346 WEST 40TH RESTAURANT LLC	346 354 W 40TH ST	395 ft
PORKYS SALVATION CORP	496 9TH AVE	425 ft
BACI DA ROMA LLC	331 W 38TH STREET	435 ft
MANGANARO'S HERO BOY LLC	492 9TH AVE	475 ft

Name	Address	Approx. Distance
342 PROPERTY LLC & AHM NEW YORK ASSOCIATES INC	342 W 40TH ST	490 ft
PANEVINONY INC	334 340 W 40TH ST RESTAURANT B	505 ft
334 340 HOTEL MANAGEMENT LLC	334 340 W 40TH STREET	505 ft
SKY BAR TIMES SQUARE INC & PM HOSPITALITY	330 W 40TH ST 33RD FLOOR	590 ft
TIMES SQUARE HOSPITALITY II LLC	330 W 40TH STREET	590 ft
SHORTYS RESTAURANTS LLC	576 9TH AVE	625 ft
TIMES SQUARE HOSPITALITY I LLC	326 W 40TH ST	625 ft
574 9TH AVE REST CORP	574 9TH AVE	635 ft
POD TS F&B LLC AND MAJOR MANAGEMENT TCZ LLC	400 W 42ND ST	680 ft
TNN ENTERPRISES LLC	315 WEST 39TH ST	710 ft
42ND STREET DEVELOPMENT CORP	410 WEST 42ND STREET	720 ft
CHEZ JOSEPHINE LTD	414 W 42ND STREET	735 ft
407 WEST 42ND STREET CORP	407 W 42ND STREET	750 ft
SNRP WEST 37 LLC & BALLINTEER CORP	326 330 W 37TH ST	750 ft

Pending Licenses within 750 Feet

Name	Address	Approx. Distance
506 9TH AVENUE RESTAURANT GROUP CORP	506 9TH AVE	240 ft
355 W 41ST TAVERN INC	355 WEST 41ST STREET	465 ft
PARM 42 WEST LLC	400 W 42ND ST	680 ft

Unmapped licenses within zipcode of report location

Name	Address

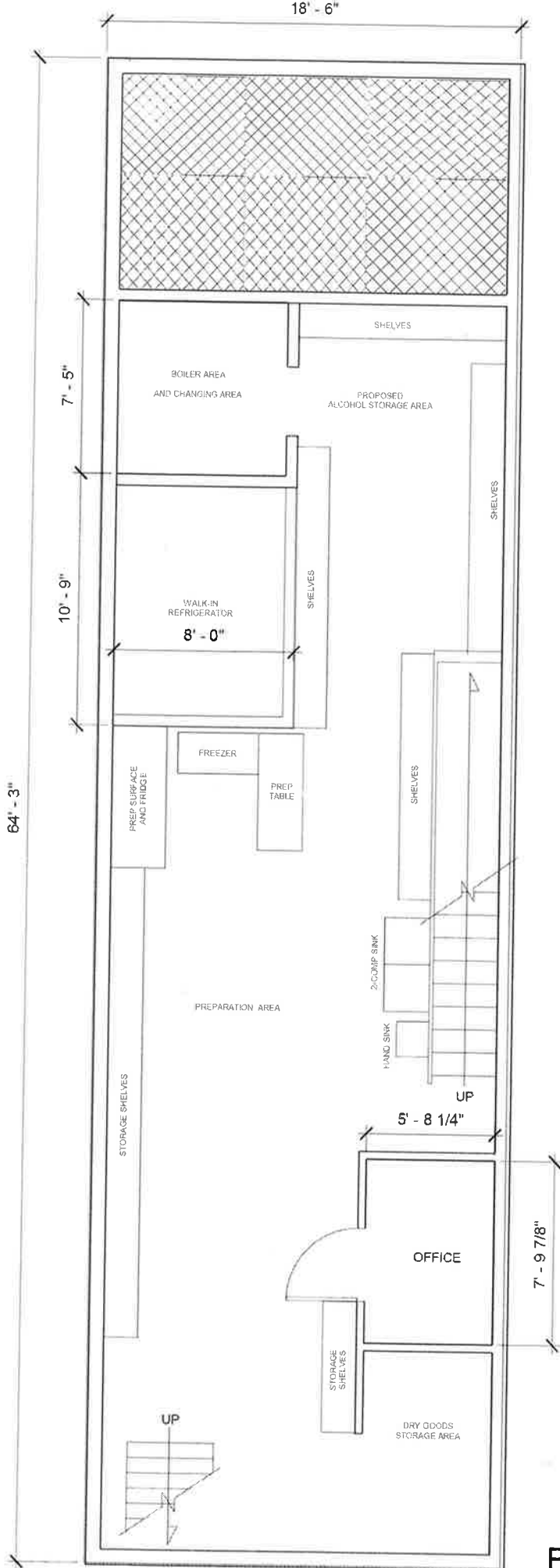

528, CORP.
 UNIDENTIFIED FLYING CHICKENS (UFC)
 528 9TH AVENUE
 MANHATTAN NY 10018

BASEMENT PLAN

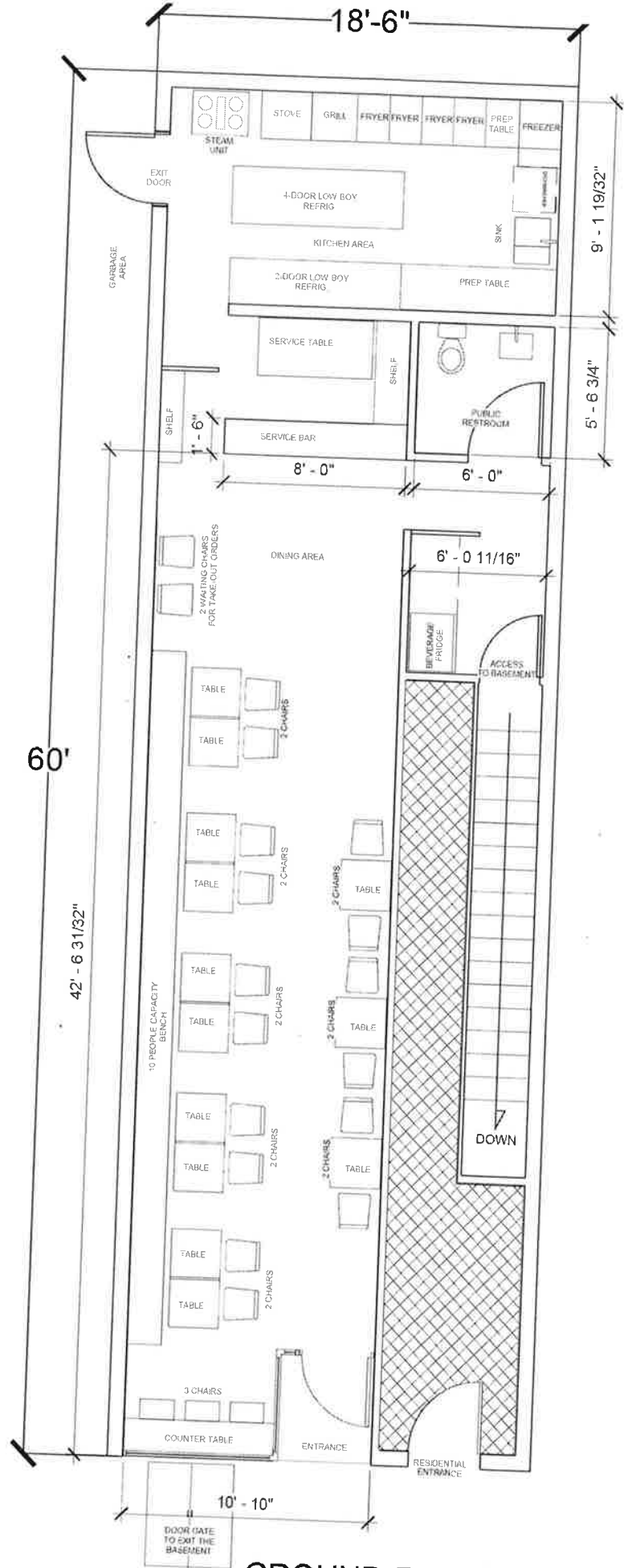

528, CORP.
 UNIDENTIFIED FLYING CHICKENS (UFC)
 528 9TH AVENUE
 MANHATTAN NY 10018

GROUND FLOOR PLAN

UFCO



528

A

A

UFCO
528



Standardized NOTICE FORM for Providing 30-Day Advance Notice to a Local Municipality or Community Board

1. Date Notice was Sent: JUNE 29, 2018

1a. Delivered by: Certified Mail Return Receipt Requested

2. Select the type of Application that will be filed with the Authority for an On-Premises Alcoholic Beverage License:
 New Application Renewal Alteration Corporate Change Removal Class Change Method of Operation Change

For **New** applicants, answer each question below using all information known to date
For **Renewal** applicants, answer all questions
For **Alteration** applicants, attach a complete written description and diagrams depicting the proposed alteration(s)
For **Corporate Change** applicants, attach a list of the current and proposed corporate principals
For **Removal** applicants, attach a statement of your current and proposed addresses with the reason(s) for the relocation
For **Class Change** applicants, attach a statement detailing your current license type and your proposed license type
For **Method of Operation Change** applicants, although not required, if you choose to submit, attach an explanation detailing those changes

This 30-Day Advance Notice is Being Provided to the Clerk of the Following Local Municipality or Community Board:

3. Name of Municipality or Community Board: Manhattan Community Board #4

Applicant/Licensee Information:

4. Licensee Serial Number (if applicable): _____ Expiration Date (if applicable): _____

5. Applicant or Licensee Name: 528, CORP.

6. Trade Name (if any): Unidentified Flying Chickens (UFC)

7. Street Address of Establishment: 528 9th Avenue

8. City, Town or Village: Manhattan, NY Zip Code: 10018

9. Business Telephone Number of Applicant/Licensee: (646) 422-7451

10. Business E-mail of Applicant/Licensee: young@ufchicken.com

11. Type(s) of alcohol sold or to be sold:
 Beer & Cider Wine, Beer & Cider Liquor, Wine, Beer & Cider

12. Extent of Food Service:
 Full food menu; full kitchen run by a chef or cook Menu meets legal minimum food availability requirements; food prep area at minimum

13. Type of Establishment: Restaurant (full kitchen and full menu required)

14. Method of Operation: (check all that apply)
 Seasonal Establishment Juke Box Disc Jockey Recorded Music Karaoke
 Live Music (give details i.e., rock bands, acoustic, jazz, etc.): _____
 Patron Dancing Employee Dancing Exotic Dancing Topless Entertainment
 Video/Arcade Games Third Party Promoters Security Personnel
 Other (specify): _____

15. Licensed Outdoor Area: (check all that apply)
 None Patio or Deck Rooftop Garden/Grounds Freestanding Covered Structure
 Sidewalk Cafe Other (specify): _____

OFFICE USE ONLY		
<input type="radio"/> Original	<input type="radio"/> Amended	Date _____

16. List the floor(s) of the building that the establishment is located on: **Ground Floor**

17. List the room number(s) the establishment is located in within the building, if appropriate: _____

18. Is the premises located within 500 feet of three or more on-premises liquor establishments? Yes No

19. Will the license holder or a manager be physically present within the establishment during all hours of operation? Yes No

20. If this is a transfer application (an existing licensed business is being purchased) provide the name and serial number of the licensee:

KNS WING TIME INC	1296434
Name	Serial Number

21. Does the applicant or licensee own the building in which the establishment is located? Yes (if YES, SKIP 23-26) No

Owner of the Building in Which the Licensed Establishment is Located

22. Building Owner's Full Name: **ALAN WASSERMAN**

23. Building Owner's Street Address: **145 Huguenot Street, Suite#503**

24. City, Town or Village: **New Rochelle** State: **NY** Zip Code: **10801**

25. Business Telephone Number of Building Owner: **(917) 637-6200**

Representative or Attorney Representing the Applicant in Connection with the Application for a License to Traffic in Alcohol at the Establishment Identified in this Notice

26. Representative/Attorney's Full Name: **SHYCIOR HUNG FONG**

27. Representative/Attorney's Street Address: **1115 BROADWAY, SUITE#1040**

28. City, Town or Village: **MANHATTAN** State: **NY** Zip Code: **10010**

29. Business Telephone Number of Representative/Attorney: **(917) 535-5051**

30. Business E-mail Address of Representative/Attorney: **restaurant.total@gmail.com**

I am the applicant or licensee holder or a principal of the legal entity that holds or is applying for the license. Representations in this form are in conformity with representations made in submitted documents relied upon by the Authority when granting the license. I understand that representations made in this form will also be relied upon, and that false representations may result in disapproval of the application or revocation of the license.

By my signature, I affirm - under **Penalty of Perjury** - that the representations made in this form are true.

31. Printed Principal Name: **JUNG HWA BAE** Title: **OWNER**

Principal Signature: 