

Manhattan Community Board 4

(All Fields Must Be Completed)

Liquor License/Sidewalk Cafe Stipulations Application

CORPORATION NAME Grand Sichuan 8 Inc.		DOING BUSINESS AS (DBA)	
STREET ADDRESS 172 8th Ave		CROSS STREETS W. 18th Street & W. 19th Street	ZIP CODE 10011
OWNER <small>(Attach a list of all the people that will be associated listed with the license)</small>	NAME: Fang Lin	ATTORNEY/ REPRESENTAIVE	NAME: James Wang
	PHONE: 212-243-1688		PHONE: 212-219-3070
	EMAIL: asian8833@gmail.com		EMAIL: j.y.wang.ny@gmail.com
MANAGER	NAME:	LANDLORD	NAME: Franklin Holding Co.
	PHONE:		PHONE: (212) 243-2370
	EMAIL:		EMAIL:
APPLICATION TYPE (Check One)			
<input checked="" type="radio"/> New	Has applicant owned or managed a similar business?	YES	<input checked="" type="radio"/> NO Transfer
	What is/was the name and address of establishment?		
	What were the dates applicant was involved with this former premise?		
<input type="radio"/> Corp Change/Class Change/Removal	What is the license # and expiration date?		
	Is applicant making any alterations or operational changes?	YES	NO
	<i>If alterations or operational changes are being made, please describelist all changes.</i>		
<input type="radio"/> Alteration	What is the current license # and expiration date?		
	<i>Please list/describe the nature of all the changes and attach the plans:</i>		
METHOD OF OPERATION			
TYPE OF ALCOHOL	<input type="radio"/> Liquor/Wine/Beer & Cider <input type="radio"/> Beer & Cider <input checked="" type="radio"/> Wine/Beer & Cider		
ESTABLISHMENT TYPE	<input checked="" type="radio"/> Restaurant <input type="radio"/> Cabaret <input type="radio"/> Night Club <input type="radio"/> Hotel <input type="radio"/> Bar/Tavern <input type="radio"/> Catering Establishment <input type="radio"/> Adult Entertainment <input type="radio"/> Wine Bar <input type="radio"/> Dance Club <input type="radio"/> Sports Bar <input type="radio"/> Club (Fraternal Organization – Members Only)		
Has applicant/owner filed with the SLA? If yes, when? If no, when do you plan to file?	YES	<input checked="" type="radio"/> NO	
Is the 500 Foot Rule applicable? If yes, please attach a diagram of the On-Premise liquor license establishments within a 500 ft. radius of your establishment and the Public Interest Statement.	YES	<input checked="" type="radio"/> NO	
Is the 200 Foot Rule applicable? If yes, please attach a diagram of the schools and houses of worship that trigger the rule.	YES	<input checked="" type="radio"/> NO	
Has applicant/owner(s) read MCB4 Policy Regarding Concentration and Location of Alcoholic-Serving Establishments?	<input checked="" type="radio"/> YES	NO	

OPERATIONAL DETAILS (*Closing time will be when establishment is vacated of all patrons)									
HOURS* <i>(Indoor Only)</i>		MONDAY	TUESDAY	WEDNESDAY	THURSDAY	FRIDAY	SATURDAY	SUNDAY	
	Operation	11am-11pm	11am-11pm	11am-11pm	11am-11pm	11am-12am	11am-12am	11am-11pm	
	Kitchen	11am-11pm	11am-11pm	11am-11pm	11am-11pm	11am-12am	11am-12am	11am-11pm	
	Music	11am-11pm	11am-11pm	11am-11pm	11am-11pm	11am-12am	11am-12am	11am-11pm	
If you plan to have music, what type(s)? (Circle all that apply)			<input checked="" type="checkbox"/> BACKGROUND	<input type="checkbox"/> LIVE MUSIC	<input type="checkbox"/> DJ	<input type="checkbox"/> JUKE BOX	<input type="checkbox"/> KARAOKE		
OCCUPANCY									
	Capacity (Certificate of Occupancy)	Maximum # of Persons You Anticipate Occupying Premises (Including Employees)	Number of Tables	Number of Seats	Number of Service Only Bars	Number of Stand-Up Bars	Number of Seats at Stand-Up Bar		
INSIDE	74	74	23	54	none	none	none		
OUTSIDE <i>(Other than sidewalk café)</i>	N/A								
SIDEWALK CAFÉ	N/A								
How many floors are there? What is the capacity for each floor?					1 floor, 54				
How frequently will the owner(s) be at the establishment?					7 days each week				
Will you be applying or intending to apply for a cabaret license with DCA? If yes, will there be dancing?					YES	<input checked="" type="radio"/> NO			
Will applicant have bottle or table service for beverage alcohol?					YES	<input checked="" type="radio"/> NO			
Will you be hosting private; promotional or corporate events?					YES	<input checked="" type="radio"/> NO			
Will outside promoters be used on a regular basis? If yes please describe.					YES	<input checked="" type="radio"/> NO			
Will you have a security plan? If, yes please attach.					YES	<input checked="" type="radio"/> NO			
Will security plan be implemented?					YES	<input checked="" type="radio"/> NO			
Will State certified security personnel be used?					YES	<input checked="" type="radio"/> NO			
Will New York Nightlife Association and NYPD Best Practices be followed?					YES	<input checked="" type="radio"/> NO			
Will applicant be using delivery bicycles? If yes, how many?					<input checked="" type="radio"/> YES	<input type="radio"/> NO	2		
Will delivery bicycles be clearly marked with the name of the restaurant and will staff wear attire clearly noting name as described by NYC Law?					<input checked="" type="radio"/> YES	<input type="radio"/> NO			
Where will delivery bicycles be stored during the day when not in use?					On sidewalk in front of the restaurant				

LOCATION & ZONING			
Is this a Special District? If yes, is it Clinton, West Chelsea or Hudson Yards?	YES	<input checked="" type="radio"/> NO	
Does the building have a Certificate of Occupancy ("C of O") or a letter of no objection?	<input checked="" type="radio"/> YES	NO	
Is a Public Assembly permit required?	YES	<input checked="" type="radio"/> NO	
Are your plans filed with DOB?	<input checked="" type="radio"/> YES	NO	

Community Notification/Relations			
NOTIFICATION: List all block associations; tenant associations, co-op boards or condo boards of residential buildings; and community groups that applicant has notified regarding its application. For each please list both the organization and individual you contacted	# 1		
	# 2		
	# 3		
	# 4		
	# 5		
Please provide dates when applicant met with the groups listed above.			
Who was your contact person at each group you met with?			
When did applicant post the notice that was provided?			
Where did applicant post the notice that was provided?		The front door of the premises	
Will applicant provide owner cell phone number to neighbors and respond to complaints that arise? Please provide number in space provided.		<input checked="" type="radio"/> YES	NO 917-855-7086
Will applicant inform the Community Board office of its job openings and/or provide a hyperlink to applicants jobs webpage?		<input checked="" type="radio"/> YES	NO

BUILDING DESIGN			
State the name and type of business previously located in the space.	America Hoist Inc/Grand Sichuan Eastern Restaurant		
Has a liquor-licensed establishment previously occupied this space at any time? If yes, please provide the name of the business.	<input checked="" type="radio"/> YES	<input type="radio"/> NO	America Hoist Inc/ DBA Grand Sichuan Eastern
Do you plan any changes to the existing façade? If yes, please describe.	YES	<input type="radio"/> NO	
Will applicant have a vestibule within the establishment?	YES	<input type="radio"/> NO	
Will applicant use a storm enclosure?	YES	<input type="radio"/> NO	
Will applicant not place any items or obstructions on the sidewalk, for example, sandwich boards, sidewalk signs, freestanding menus and plants, as per the law?	<input checked="" type="radio"/> YES	NO	
Will applicant comply with the NYC noise code?	<input checked="" type="radio"/> YES	<input type="radio"/> NO	
Will the establishment have any of the following: (circle all that apply)	FRENCH DOORS	GARAGE DOORS	WINDOWS THAT CAN BE OPENED
Will applicant close all windows, French doors, garage doors when any music or amplified sound (including televisions) is played inside the establishment?	<input checked="" type="radio"/> YES	<input type="radio"/> NO	
Will applicant close all windows, French doors, garage doors by 11 PM Friday and Saturday and 10 PM on all other days even if no music or amplified sound is played inside the establishment?	<input checked="" type="radio"/> YES	<input type="radio"/> NO	
Has applicant obtained an acoustical report from a certified sound engineer to assess potential noise disturbance to the neighboring residents and buildings?	<input checked="" type="radio"/> YES	<input type="radio"/> NO	
Will applicant follow the recommendations of a certified sound engineer to mitigate potential noise disturbance to the neighboring residents and buildings, including placing speakers on the floor of the establishment?	<input checked="" type="radio"/> YES	<input type="radio"/> NO	
Will the kitchen exhaust system extend to the roof?	YES	<input type="radio"/> NO	
Will the establishment have an illuminated sign?	<input checked="" type="radio"/> YES	<input type="radio"/> NO	
Will the establishment have a canopy extending over the sidewalk?	YES	<input type="radio"/> NO	
Where will the air conditioner be located? What type is it?	A/C		
When was the air conditioner installed?	Unknown		

Two
Two

OUTDOOR ITEMS - OTHER THEN SIDEWALK CAFÉ		
Has the applicant/owner(s) read MCB 4 Rear Yard Rooftop Policy?	<input checked="" type="radio"/> YES	<input type="radio"/> NO
Will applicant use any outdoor spaces: rooftop, rear yard, patio, porch, balcony, pavilion, tents, deck or gazebo? If yes, which one(s)?	<input type="radio"/> YES	<input checked="" type="radio"/> NO
Are the floorplans for the outdoor space(s) included?	<input type="radio"/> YES	<input type="radio"/> NO
Will applicant close and vacate the outdoor space(s) by 11PM on Friday & Saturday and 10 PM on all other days?	<input type="radio"/> YES	<input type="radio"/> NO
Will the service and consumption of alcohol in any outdoor space only be via seated food service?	<input type="radio"/> YES	<input type="radio"/> NO
Will applicant not allow standing space for patrons to drink or smoke in any outdoor space(s)?	<input type="radio"/> YES	<input type="radio"/> NO
Will there be no amplified music, as per the law?	<input type="radio"/> YES	<input type="radio"/> NO
If amplified sound is played inside the establishment, will windows and doors be closed?	<input type="radio"/> YES	<input type="radio"/> NO
Will applicant agree to post signs outside asking customers to respect the neighbors'?	<input type="radio"/> YES	<input type="radio"/> NO
Will applicant agree to train staff to encourage a peaceful environment?	<input type="radio"/> YES	<input type="radio"/> NO
Will applicant provide effective sound control (landscaping enclosure, soundproofing tenants apartments)	<input type="radio"/> YES	<input type="radio"/> NO
Will there be a lighting plan that allows safe usage of the outdoor space without disrupting neighbors?	<input type="radio"/> YES	<input type="radio"/> NO

OUTDOOR ITEMS – SIDEWALK CAFÉ			
Has the applicant/owner(s) read MCB4 Sidewalk Café Policy?	<input checked="" type="radio"/> YES	<input type="radio"/> NO	
Will applicant be applying for a sidewalk café now or in the future?	<input type="radio"/> YES	<input checked="" type="radio"/> NO	
Is applicant in this application seeking to include a sidewalk café in its liquor license?	<input type="radio"/> YES	<input checked="" type="radio"/> NO	
If yes, has applicant submitted an application and plans to NYC Dept. of Consumer Affairs? Please attach application and plans.	<input type="radio"/> YES	<input type="radio"/> NO	
Will applicant close and vacate the sidewalk café by 11 PM on Friday & Saturday and 10 PM on all other days?	<input type="radio"/> YES	<input type="radio"/> NO	
Will applicant be serving alcohol in the sidewalk café? If so, will you have waiter service?	<input type="radio"/> YES	<input type="radio"/> NO	
Will the café have a 3 ft. wide serving aisle running the entire length of the sidewalk café?	<input type="radio"/> YES	<input type="radio"/> NO	
Will applicant mark the perimeter of the café on the sidewalk?	<input type="radio"/> YES	<input type="radio"/> NO	
Will the service and consumption of alcohol in the sidewalk café only be via seated food service?	<input type="radio"/> YES	<input type="radio"/> NO	
Will the sidewalk café not provide standing space for drinking or smoking?	<input type="radio"/> YES	<input type="radio"/> NO	
Will applicant use any portable natural gas heaters? If so, do you have the requisite approvals from DOB & the Fire Department?	<input type="radio"/> YES	<input type="radio"/> NO	
Will applicant have a lighting plan that will allow safe usage of the outdoor space without disrupting neighbors?	<input type="radio"/> YES	<input type="radio"/> NO	
Will all furniture, plants and barricades be stored inside between the evening closing hours and the morning opening hours?	<input type="radio"/> YES	<input type="radio"/> NO	
Will all furniture be stored inside between December 21 st and March 21 st , and any other day when it rains or snows?	<input type="radio"/> YES	<input type="radio"/> NO	
Will applicant use umbrellas?	<input type="radio"/> YES	<input type="radio"/> NO	N/A
If construction or construction protection has reduced the sidewalk width, will applicant always maintain an 8 foot clear path of sidewalk between the perimeter of the café and the closes obstruction including construction barricades?	<input type="radio"/> YES	<input type="radio"/> NO	N/A

ADDITIONAL STIPULATIONS: (Office Use Only)



To the extent any additional stipulation on pages 7 and 8 of this application conflicts with any response on pages 1 – 6 of this application, the stipulations on pages 7 and 8 control.

ADDITIONAL STIPULATIONS: (Office Use Only), *Continued*

To the extent any additional stipulation on pages 7 and 8 of this application conflicts with any response on pages 1 – 6 of this application, the stipulations on pages 7 and 8 control.

<p>Manhattan Community Board 4 (MCB4) recommends: (MCB4's recommendation is based on a vote taken at its December 5, 2018 full board meeting, with <u>34</u> members voting in favor of the recommendation, <u>0</u> members opposed, <u>0</u> members abstaining and <u>0</u> present but not eligible)</p>	<p><input checked="" type="radio"/> Denial unless all stipulations agreed to by applicant/owner are part of the method of operation</p> <p><input type="radio"/> Denial <input type="radio"/> Approval</p>
---	---

CB4 REPRESENTATIVES

 Nely Gonzalez CB4 Assistant District Manager	 Frank Holozubiec CB4 BLP Committee Co-Chair	 Yoni Bokser CB4 BLP Committee Co-Chair
--	---	---

APPLICANT AGREEMENT WITH THE COMMUNITY

Applicant agrees to these stipulations as the basis for the community support of this application and acknowledges that all of these stipulations are essential prerequisites to the MCB4 recommendation regarding this application. Applicant agrees to have these stipulations incorporated in the method of operation of its liquor license. The stipulations in this application constitute the entire agreement between MCB4 and applicant and may only be altered in writing signed by MCB4 and applicant. These stipulations supersede any oral statements or representations in connection with this application.

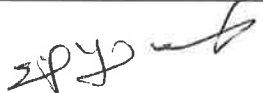
<p>SIGN HERE →</p>	<p>JAMES WELLS</p>		<p>11/13/18</p>
---------------------------	--------------------	--	-----------------

PRINT NAME OF APPLICANT

SIGNATURE OF APPLICANT

DATE

representative

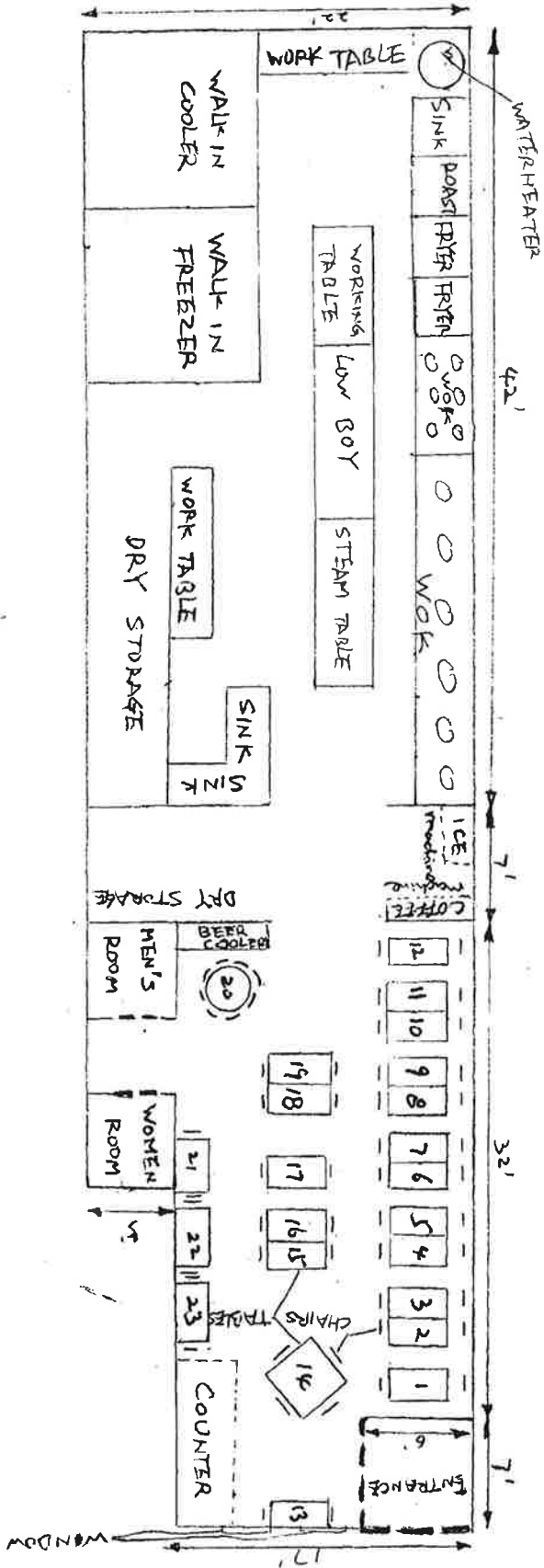



EXECUTIVE OFFICES
280 BROADWAY, NEW YORK, N.Y. 10007

Patricia J. Lancaster, AIA, Commissioner
(212) 566-5000, TTY (212) 566-4769
Website: NYC.gov/buildings

1230797-8

BOROUGH OFFICES

MANHATTAN
280 BROADWAY, 3rd FL.
NEW YORK, NY 10007

BRONX
1932 ARTHUR AVENUE
BRONX, NY 10457-6306

BROOKLYN
MUNICIPAL BUILDING
BROOKLYN, NY 11201-3715

QUEENS
126-06 QUEENS BLVD.
KEW GARDENS, NY 11411

STATEN ISLAND
BOROUGH HALL
ST. GEORGE, NY 10301-1903

May 13, 2003

New York State Liquor Authority
Division of Alcoholic Beverage Control
License Processing Unit- 3rd Floor
11 Park Place
New York, New York 10007

RE: LETTER OF NO OBJECTION
172 8th AVENUE
Block #: 768; Lot #: 82
Manhattan

Ladies and Gentlemen:

✓ The Department has No Objection to an Eating and Drinking Establishment, Use Group 6, for less than Seventy- Five (75) persons on the First (1st) floor of the above referenced premises.

However, any new Kitchen Equipment and Fire Protection System must be filed with this Department.

This is based upon departmental records; Block #: 768; Lot #: 82, Alteration # 100051701 and 102469320 and I Card.

Sincerely,

Dileep Khedekar, P.E.
Deputy Borough Superintendent
Manhattan

DK/lc:

Cc: Laura V. Osorio, R.A., Borough Commissioner-Ma
Ginio Topino, Plan Examination
LNO File
Premises File

"Ensuring a Safe Foundation"