

Manhattan Community Board 4

(All Fields Must Be Completed)

Liquor License/Sidewalk Cafe Stipulations Application

CORPORATION NAME		DOING BUSINESS AS (DBA)	
The Neiman Marcus Group LLC		Neiman Marcus	
STREET ADDRESS		CROSS STREETS	ZIP CODE
20 Hudson Yards a/k/a 500 West 33rd Street		33rd Street and 10th Avenue	10001
OWNER <small>(Attach a list of all the people that will be associated/listed with the license)</small>	NAME: Michael Sullivan, Geoffroy Van Raemdonick, Tracy Preston	ATTORNEY/ REPRESENTATIVE	NAME: Donald M. Bernstein c/o Bernstein Redo, P.C.
	PHONE: (646) 562-3500		PHONE: (212) 651-3100
	EMAIL: Michael_Sullivan@neimanmarcus.com		EMAIL: Donald@brpclaw.com
MANAGER	NAME: Mary McGreevy & David Brinkerhoff	LANDLORD	NAME: Related Companies
	PHONE: (646) 562-5300 (646)562-3500		PHONE: (212) 801-1000
	EMAIL: Mary_McGreevy@neimanmarcus.com David_Brinkerhoff@neimanmarcus.com		EMAIL: N/A
APPLICATION TYPE (<input checked="" type="checkbox"/> <i>Liquor License</i> <input type="checkbox"/> <i>Unenclosed Sidewalk Cafe</i>)			
<input type="radio"/> New	Has applicant owned or managed a similar business?	<input type="checkbox"/> YES	<input type="checkbox"/> NO
	What is/was the name and address of establishment?		
	What were the dates applicant was involved with this former premise?		
<input type="radio"/> Corp Change/Class Change/Removal	What is the license # and expiration date?		
	Is applicant making any alterations or operational changes?	<input type="checkbox"/> YES	<input type="checkbox"/> NO
	<i>If alterations or operational changes are being made, please describe/list all changes.</i>		
<input checked="" type="radio"/> Alteration	What is the current license # and expiration date?	1314221; Exp. 1/31/2021	
	<i>Please list/describe the nature of all the changes and attach the plans:</i> Alteration to add an additional stand-up bar on the fifth floor, plans attached		
METHOD OF OPERATION			
TYPE OF ALCOHOL	<input checked="" type="radio"/> Liquor/Wine/Beer & Cider <input type="radio"/> Beer & Cider <input type="radio"/> Wine/Beer & Cider		
ESTABLISHMENT TYPE	<input checked="" type="radio"/> *Luxury Retail Department Store <input type="radio"/> Restaurant <input type="radio"/> Cabaret <input type="radio"/> Night Club <input type="radio"/> Hotel <input type="radio"/> Bar/Tavern <input type="radio"/> Catering Establishment <input type="radio"/> Adult Entertainment <input type="radio"/> Wine Bar <input type="radio"/> Dance Club <input type="radio"/> Sports Bar <input type="radio"/> Club (Fraternal Organization -- Members Only)		
Has applicant/owner filed with the SLA? If yes, when? If no, when do you plan to file?	<input type="checkbox"/> YES	<input checked="" type="radio"/> NO	
Is the 500 Foot Rule applicable? If yes, please attach a diagram of the On-Premise liquor license establishments within a 500 ft. radius of your establishment and the Public Interest Statement.	<input type="checkbox"/> YES	<input checked="" type="radio"/> NO	N/A alteration application
Is the 200 Foot Rule applicable? If yes, please attach a diagram of the schools and houses of worship that trigger the rule.	<input type="checkbox"/> YES	<input checked="" type="radio"/> NO	N/A alteration application
Has applicant/owner(s) read MCB4 Policy Regarding Concentration and Location of Alcoholic-Serving Establishments?	<input checked="" type="radio"/> YES	<input type="checkbox"/> NO	

LOCATION & ZONING			
Is this a Special District? If yes, is it Clinton, West Chelsea or Hudson Yards?	<input checked="" type="radio"/> YES	NO	Hudson Yards
Does the building have a Certificate of Occupancy ("C of O") or a letter of no objection?	<input checked="" type="radio"/> YES	NO	Yes, Certificate of Occupancy
Is a Public Assembly permit required?	YES	<input checked="" type="radio"/> NO	Issued PA permit for 7th floor only
Are your plans filed with DOB?	YES	<input checked="" type="radio"/> NO	N/A

Community Notification/Relations			
NOTIFICATION: List all block associations; tenant associations, co-op boards or condo boards of residential buildings; and community groups that applicant has notified regarding its application. For each please list both the organization and individual you contacted	# 1	See attached	
	# 2		
	# 3		
	# 4		
	# 5		
Please provide dates when applicant met with the groups listed above.	N/A		
Who was your contact person at each group you met with?	See attached		
When did applicant post the notice that was provided?	10/25/2019		
Where did applicant post the notice that was provided?	Main exterior entrance - 375 10th Avenue		
Will applicant provide owner cell phone number to neighbors and respond to complaints that arise? Please provide number in space provided.	<input checked="" type="radio"/> YES	NO	
Will applicant inform the Community Board office of its job openings and/or provide a hyperlink to applicants jobs webpage?	<input checked="" type="radio"/> YES	NO	

BUILDING DESIGN

State the name and type of business previously located in the space.	Currently - The Neiman Marcus Group LLC					
Has a liquor-licensed establishment previously occupied this space at any time? If yes, please provide the name of the business.	YES	<input checked="" type="radio"/> NO				
Do you plan any changes to the existing façade? If yes, please describe.	YES	<input checked="" type="radio"/> NO				
Has the applicant/owner(s) read MCB 4 ADA Guidelines Memo?	<input checked="" type="radio"/> YES	NO				
Is the entrance ADA Compliant?	<input checked="" type="radio"/> YES	NO				
Do you plan any changes to the existing façade? If yes, please describe.	YES	<input checked="" type="radio"/> NO				
Will applicant have a vestibule within the establishment?	YES	<input checked="" type="radio"/> NO				
Will applicant use a storm enclosure?	YES	<input checked="" type="radio"/> NO				
Will applicant agree not to place any items or obstructions on the sidewalk, for example, sandwich boards, sidewalk signs, freestanding menus and plants, as per the law?	YES	NO	N/A no outdoor space			
Will applicant comply with the NYC noise code?	<input checked="" type="radio"/> YES	NO				
Will the establishment have any of the following: (circle all that apply)	<table border="1" style="width: 100%; text-align: center;"> <tr> <td>FRENCH DOORS</td> <td>GARAGE DOORS</td> <td>WINDOWS THAT CAN BE OPENED</td> </tr> </table>			FRENCH DOORS	GARAGE DOORS	WINDOWS THAT CAN BE OPENED
FRENCH DOORS	GARAGE DOORS	WINDOWS THAT CAN BE OPENED				
Will applicant close all windows, French doors, garage doors when any music or amplified sound (including televisions) is played inside the establishment?	YES	NO	N/A			
Will applicant close all windows, French doors, garage doors by 11 PM Friday and Saturday and 10 PM on all other days even if no music or amplified sound is played inside the establishment?	YES	NO	N/A			
Has applicant obtained an acoustical report from a certified sound engineer to assess potential noise disturbance to the neighboring residents and buildings?	YES	<input checked="" type="radio"/> NO				
Will applicant follow the recommendations of a certified sound engineer to mitigate potential noise disturbance to the neighboring residents and buildings, including placing speakers on the floor of the establishment?	YES	NO	N/A			
Will the kitchen exhaust system extend to the roof?	<input checked="" type="radio"/> YES	NO				
Will the establishment have an illuminated sign?	YES	<input checked="" type="radio"/> NO				
Will the establishment have a canopy extending over the sidewalk?	YES	<input checked="" type="radio"/> NO				
Where will the air conditioner be located? What type is it?	HVAC System located in mechanical rooms. AHU's installed inside mechanical rooms on each floor.					
When was the air conditioner installed?	2018					

OUTDOOR ITEMS - OTHER THEN SIDEWALK CAFÉ

Has the applicant/owner(s) read MCB 4 Rear Yard Rooftop Policy?	YES	NO	
Will applicant use any outdoor spaces: rooftop, rear yard, patio, porch, balcony, pavilion, tents, deck or gazebo? If yes, which one(s)?	YES	NO	
Are the floorplans for the outdoor space(s) included?	YES	NO	
Will applicant close and vacate the outdoor space(s) by 11PM on Friday & Saturday and 10 PM on all other days?	YES	NO	
Will the service and consumption of alcohol in any outdoor space only be via seated food service?	YES	NO	
Will applicant not allow standing space for patrons to drink or smoke in any outdoor space(s)?	YES	NO	
Will there be no amplified music, as per the law?	YES	NO	
If amplified sound is played inside the establishment, will windows and doors be closed?	YES	NO	
Will applicant agree to post signs outside asking customers to respect the neighbors'?	YES	NO	
Will applicant agree to train staff to encourage a peaceful environment?	YES	NO	
Will applicant provide effective sound control (landscaping enclosure, soundproofing tenants apartments)	YES	NO	
Will there be a lighting plan that allows safe usage of the outdoor space without disrupting neighbors?	YES	NO	

OUTDOOR ITEMS – SIDEWALK CAFÉ

Has the applicant/owner(s) read MCB4 Sidewalk Café Policy?	YES	NO	
Will applicant be applying for a sidewalk café now or in the future?	YES	NO	
Is applicant in this application seeking to include a sidewalk café in its liquor license?	YES	NO	
If yes, has applicant submitted an application and plans to NYC Dept. of Consumer Affairs? Please attach application and plans.	YES	NO	
Will applicant close and vacate the sidewalk café by 11 PM on Friday & Saturday and 10 PM on all other days?	YES	NO	
Will applicant be serving alcohol in the sidewalk café? If so, will you have waiter service?	YES	NO	
Will the café have a 3 ft. wide serving aisle running the entire length of the sidewalk café?	YES	NO	
Will applicant mark the perimeter of the café on the sidewalk?	YES	NO	
Will the service and consumption of alcohol in the sidewalk café only be via seated food service?	YES	NO	
Will the sidewalk café not provide standing space for drinking or smoking?	YES	NO	
Will applicant use any portable natural gas heaters? If so, do you have the requisite approvals from DOB & the Fire Department?	YES	NO	
Will applicant have a lighting plan that will allow safe usage of the outdoor space without disrupting neighbors?	YES	NO	
Will all furniture, plants and barricades be stored inside between the evening closing hours and the morning opening hours?	YES	NO	
Will all furniture be stored inside between December 21 st and March 21 st , and any other day when it rains or snows?	YES	NO	
Will applicant use umbrellas?	YES	NO	
If construction or construction protection has reduced the sidewalk width, will applicant always maintain an 8 foot clear path of sidewalk between the perimeter of the café and the closes obstruction including construction barricades?	YES	NO	

ADDITIONAL STIPULATIONS: (Office Use Only)



To the extent any additional stipulation on pages 7 and 8 of this application conflicts with any response on pages 1 – 6 of this application, the stipulations on pages 7 and 8 control.

ADDITIONAL STIPULATIONS: (Office Use Only), *Continued*

To the extent any additional stipulation on pages 7 and 8 of this application conflicts with any response on pages 1 – 6 of this application, the stipulations on pages 7 and 8 control.

<p>Manhattan Community Board 4 (MCB4) recommends: (MCB4's recommendation is based on a vote taken at its December 4, 2019 full board meeting, with <u>40</u> members voting in favor of the recommendation, <u>0</u> members opposed, <u>0</u> members abstaining and <u>0</u> present but not eligible)</p>	<p><input checked="" type="radio"/> Denial unless all stipulations agreed to by applicant/owner are part of the method of operation <input type="radio"/> Denial <input type="radio"/> Approval</p>
--	--

CB4 REPRESENTATIVES

 Nelly Gonzalez CB4 Assistant District Manager	 Frank Holozubiec CB4 BLP Committee Co-Chair	 Xini Bolser CB4 BLP Committee Co-Chair
---	---	--

APPLICANT AGREEMENT WITH THE COMMUNITY

Applicant agrees to these stipulations as the basis for the community support of this application and acknowledges that all of these stipulations are essential prerequisites to the MCB4 recommendation regarding this application. Applicant agrees to have these stipulations incorporated in the method of operation of its liquor license. The stipulations in this application constitute the entire agreement between MCB4 and applicant and may only be altered in writing signed by MCB4 and applicant. These stipulations supersede any oral statements or representations in connection with this application.

<p>SIGN HERE →</p>	<p>Donald Bernstein</p> <p>PRINT NAME OF APPLICANT</p>	 <p>SIGNATURE OF APPLICANT</p>	<p>11/16/19</p> <p>DATE</p>
---------------------------	--	---	-----------------------------

DAVID BRINKERHOFF
 MGR OF OPERATIONS  11/12/19

NM

Hudson Yards Vending Machine Standard Operating Procedures

- No sales to underage customers – all servers/sellers of alcohol in the vending machine adjacent area will be trained/certified in TIPS program to recognize and assess the age of someone attempting to purchase or consume an alcohol beverage. Assessment to include:
 - Ask the guest if they are of legal drinking age with request of proof for anyone under the age of 40.
 - Assess the legal age by verifying by NY legally recognized forms of identification.
 - An ID book will be at each of the 4 registers verified to sell a “token” to the guest.
- No over-serving intoxicated customers - all servers/sellers of alcohol in the vending machine adjacent area will be trained/certified in TIPS program to recognize the signs of intoxication of someone attempting to purchase or consume an alcohol beverage. Assessment to include:
 - Visibly observing the guest and/or via verbal engagement with the guest looking for all clues the guest is intoxicated, ie movement, slurring of speech, impaired movement or decision making, smell of alcohol on breath, etc.
 - Asking of other associates of any behavior that indicates visible intoxication.
- Only the 4 registers in the vending machine adjacent area will be responsible for selling and dispensing of tokens.
- Instructions where to purchase the token and the procedure will be posted at the vending machine.
- The associates of the vending machine adjacent area will observe the sale and dispensement from the vending machine by operating in the following manner:
 - Only guests who have been directly sold a token will be allowed to operate the vending machine.
 - No minors shall be allowed to operate the machine.
 - No one who is visibly intoxicated shall be allowed to operate the machine.
 - An associate will be on hand to assist the guest in opening the bottle and immediately upon dispensement of the bottle will insert a serving device to ease service to the guest.
 - All bottles will be immediately opened for consumption on premises only.
 - Neiman Marcus Associates who are scheduled same day will not be sold a token.
- Neiman Marcus Hudson Yards will only sell up to 2 tokens/bottles total to any one guest and immediately open to ensure consumption is on premise only and to a person of age and who is not intoxicated.

Neiman Marcus Security overview

The Loss Prevention staff for the Hudson Yards store consists of 7 associates and is led by the Operations Manager of the store. The store is equipped with a full complement of IP cameras and the command center is on the sixth floor. Loss Prevention are the only key-carrying members of the store, so they are first in and last out. Loss Prevention is a member of the crisis team, which provides training and response to abusive/threatening customers, active shooter, bomb threats, domestic abuse threats, civil disturbances, emergency evacuations, medical emergencies, theft/robbery and workplace violence.

NOTICE TO OUR NEIGHBORS

Neiman Marcus

Neiman Marcus, a privately-owned luxury retail department store, is in the process of altering its existing flagship store at 20 Hudson Yards a/k/a 500 West 33rd Street between 33rd Street and 10th Avenue. The proposed alteration is to add an additional stand-up bar, specifically on the fifth floor of the licensed space. Neiman Marcus is currently licensed on the fifth, sixth and seventh floors which includes food and beverage areas that patrons can enjoy while shopping.

Neiman Marcus was founded back in 1907 and currently operates 45 full-line luxury stores under the Neiman Marcus and Bergdorf Goodman banners, as well as Neiman Marcus Last Call stores and outlets, MyTheresa and their e-commerce websites.

Of its stores, there are approximately 30 stores with over 40 restaurants and bars within both Neiman Marcus and Bergdorf Goodman. To learn more about Neiman Marcus and its affiliated brands, please visit www.Neimanmarcus.com and to learn more about its restaurants, please visit <https://www.neimanmarcus.com/restaurants/locations>.

Neiman Marcus will be applying to the New York State Liquor Authority for approval of the alteration and will meet with Manhattan Community Board 4's Business, Licenses and Permit Committee on November 12, 2019 to discuss the application.

We look forward to meeting with Manhattan Community Board 4 in November. If you have any questions please contact Donald@brpclaw.com.

First name	Last name	ORGANIZATION	E-MAIL
Kathleen	Treat	HKNA (incl. Dog Run)	kathleentreat123@gmail.com
Frank	Strock	West 36th Street	mcgee79@aol.com
Joe	Restuccia	CHDC (incl. Bob's & bird parks)	info@clintonhousing.org; jrestuccia2@clintonhousing.org
Ryan	Marcano	CHDC (incl. Bob's & bird parks)	rmarcano@clintonhousing.org
Bob	Benfatto	Hudson Yards Hell's Kitchen Alliance	rjbenfatto@hyhkalliance.org
Patty	Gouris	Hudson Yards Hell's Kitchen Alliance	pgouris@hyhkalliance.org
		Hotel Americano	
Scott	Hupe	Highline537	
Donna	Langman	Donna Langman Costumes	donna@donnalangman.com
Bill	Borock	Council Chelsea Block Association	wborock@hotmail.com
Christine	Berthet	CHEKPEDS	cberthet@me.com

The Neiman Marcus Group LLC
20 Hudson Yards, NY, NY 10001

Current Licensed Space: 5th floor
6 tables, 24 seats
1 stand-up bar

— Licensed Space

6 tables, 24 seats
1 stand-up bar

Liquor Storage

Stand-up bar

Restrooms

MERCHANDISING PLAN LEGEND

— WALL
— FLOOR
— CEILING
— LIGHTING
— SIGNAGE
— FURNITURE
— FIXTURES
— EQUIPMENT
— PLANTING
— OTHER

MERCHANDISING PLAN NOTES

- ALL MERCHANDISING PLAN ELEMENTS SHALL BE INSTALLED IN ACCORDANCE WITH THE LATEST REVISIONS OF THE 2012 INTERNATIONAL MECHANICAL, ELECTRICAL AND PLUMBING (M.E.P.) CODES.
- ALL MERCHANDISING PLAN ELEMENTS SHALL BE INSTALLED IN ACCORDANCE WITH THE LATEST REVISIONS OF THE 2012 INTERNATIONAL FIRE AND SAFETY CODE.
- ALL MERCHANDISING PLAN ELEMENTS SHALL BE INSTALLED IN ACCORDANCE WITH THE LATEST REVISIONS OF THE 2012 INTERNATIONAL BUILDING CODE.
- ALL MERCHANDISING PLAN ELEMENTS SHALL BE INSTALLED IN ACCORDANCE WITH THE LATEST REVISIONS OF THE 2012 INTERNATIONAL ENERGY CONSERVATION CODE.
- ALL MERCHANDISING PLAN ELEMENTS SHALL BE INSTALLED IN ACCORDANCE WITH THE LATEST REVISIONS OF THE 2012 INTERNATIONAL PLUMBING AND MECHANICAL CODE.
- ALL MERCHANDISING PLAN ELEMENTS SHALL BE INSTALLED IN ACCORDANCE WITH THE LATEST REVISIONS OF THE 2012 INTERNATIONAL ELECTRICAL CODE.
- ALL MERCHANDISING PLAN ELEMENTS SHALL BE INSTALLED IN ACCORDANCE WITH THE LATEST REVISIONS OF THE 2012 INTERNATIONAL FIRE AND SAFETY CODE.
- ALL MERCHANDISING PLAN ELEMENTS SHALL BE INSTALLED IN ACCORDANCE WITH THE LATEST REVISIONS OF THE 2012 INTERNATIONAL BUILDING CODE.
- ALL MERCHANDISING PLAN ELEMENTS SHALL BE INSTALLED IN ACCORDANCE WITH THE LATEST REVISIONS OF THE 2012 INTERNATIONAL ENERGY CONSERVATION CODE.
- ALL MERCHANDISING PLAN ELEMENTS SHALL BE INSTALLED IN ACCORDANCE WITH THE LATEST REVISIONS OF THE 2012 INTERNATIONAL PLUMBING AND MECHANICAL CODE.
- ALL MERCHANDISING PLAN ELEMENTS SHALL BE INSTALLED IN ACCORDANCE WITH THE LATEST REVISIONS OF THE 2012 INTERNATIONAL ELECTRICAL CODE.
- ALL MERCHANDISING PLAN ELEMENTS SHALL BE INSTALLED IN ACCORDANCE WITH THE LATEST REVISIONS OF THE 2012 INTERNATIONAL FIRE AND SAFETY CODE.
- ALL MERCHANDISING PLAN ELEMENTS SHALL BE INSTALLED IN ACCORDANCE WITH THE LATEST REVISIONS OF THE 2012 INTERNATIONAL BUILDING CODE.
- ALL MERCHANDISING PLAN ELEMENTS SHALL BE INSTALLED IN ACCORDANCE WITH THE LATEST REVISIONS OF THE 2012 INTERNATIONAL ENERGY CONSERVATION CODE.
- ALL MERCHANDISING PLAN ELEMENTS SHALL BE INSTALLED IN ACCORDANCE WITH THE LATEST REVISIONS OF THE 2012 INTERNATIONAL PLUMBING AND MECHANICAL CODE.
- ALL MERCHANDISING PLAN ELEMENTS SHALL BE INSTALLED IN ACCORDANCE WITH THE LATEST REVISIONS OF THE 2012 INTERNATIONAL ELECTRICAL CODE.

REVISIONS

NO.	DATE	DESCRIPTION
1	10/1/12	ISSUED FOR PERMIT
2	10/1/12	ISSUED FOR PERMIT
3	10/1/12	ISSUED FOR PERMIT
4	10/1/12	ISSUED FOR PERMIT
5	10/1/12	ISSUED FOR PERMIT
6	10/1/12	ISSUED FOR PERMIT
7	10/1/12	ISSUED FOR PERMIT
8	10/1/12	ISSUED FOR PERMIT
9	10/1/12	ISSUED FOR PERMIT
10	10/1/12	ISSUED FOR PERMIT

PROJECT INFORMATION

PROJECT NAME: HUDSON YARDS
PROJECT ADDRESS: 20 HUDSON YARDS
PROJECT CITY: NEW YORK, NY
PROJECT STATE: NY
PROJECT ZIP: 10001
PROJECT PHONE: (212) 512-1234
PROJECT FAX: (212) 512-1234
PROJECT EMAIL: PROJECT@NEIMANMARCUS.COM
PROJECT WEBSITE: WWW.NEIMANMARCUS.COM
PROJECT CONTACT: PROJECT MANAGER
PROJECT CONTACT PHONE: (212) 512-1234
PROJECT CONTACT FAX: (212) 512-1234
PROJECT CONTACT EMAIL: PROJECT@NEIMANMARCUS.COM

JANSUNUDI DC/LIN

10/1/12

Neiman Marcus

10/1/12
HUDSON YARDS
800 WEST 33RD ST
NEW YORK, NY

MERCHANDISING PLAN

10/1/12

10/1/12

The Neiman Marcus Group LLC
20 Hudson Yards, NY, NY 10001

Proposed Alteration: 5th floor
6 tables, 24 seats
2 stand-up bars

6 tables, 24 seats
1 stand-up bar

Liquor Storage

Stand-up bar

Restrooms

Proposed
Alteration:
1 stand-up bar

Licensed Space

JANSONGOLDSTEIN

MERCHANDISE DIMENSIONS

MERCHANDISE TABLES

MERCHANDISE STANDTOPS

TABLE HEIGHT

TABLE #	TABLE TYPE	TABLE DIMENSIONS (LxW)	TABLE HEIGHT	SEATING
1	Rectangular	120x60	30"	24
2	Rectangular	120x60	30"	24
3	Rectangular	120x60	30"	24
4	Rectangular	120x60	30"	24
5	Rectangular	120x60	30"	24
6	Rectangular	120x60	30"	24

TABLE SEATING

TABLE #	TABLE TYPE	TABLE DIMENSIONS (LxW)	TABLE HEIGHT	SEATING
1	Rectangular	120x60	30"	24
2	Rectangular	120x60	30"	24
3	Rectangular	120x60	30"	24
4	Rectangular	120x60	30"	24
5	Rectangular	120x60	30"	24
6	Rectangular	120x60	30"	24

MERCHANDISE SEATING

SEATING #	SEATING TYPE	SEATING DIMENSIONS (LxW)	SEATING HEIGHT	SEATING
1	Bar Stool	16x16	30"	24
2	Bar Stool	16x16	30"	24
3	Bar Stool	16x16	30"	24
4	Bar Stool	16x16	30"	24
5	Bar Stool	16x16	30"	24
6	Bar Stool	16x16	30"	24

TABLE HEIGHT

TABLE #	TABLE TYPE	TABLE DIMENSIONS (LxW)	TABLE HEIGHT	SEATING
1	Rectangular	120x60	30"	24
2	Rectangular	120x60	30"	24
3	Rectangular	120x60	30"	24
4	Rectangular	120x60	30"	24
5	Rectangular	120x60	30"	24
6	Rectangular	120x60	30"	24

MERCHANDISE PLAN

511-112
HUDSON YARDS
600 WEST 33rd ST
NEW YORK, NY



The Neiman Marcus Group LLC
 20 Hudson Yards, New York, NY 10001

Current Licensed Space: 6th floor (No change)
 17 tables, 48 seats
 1 Stand-up bar, 13 bar stools

Licensed Space

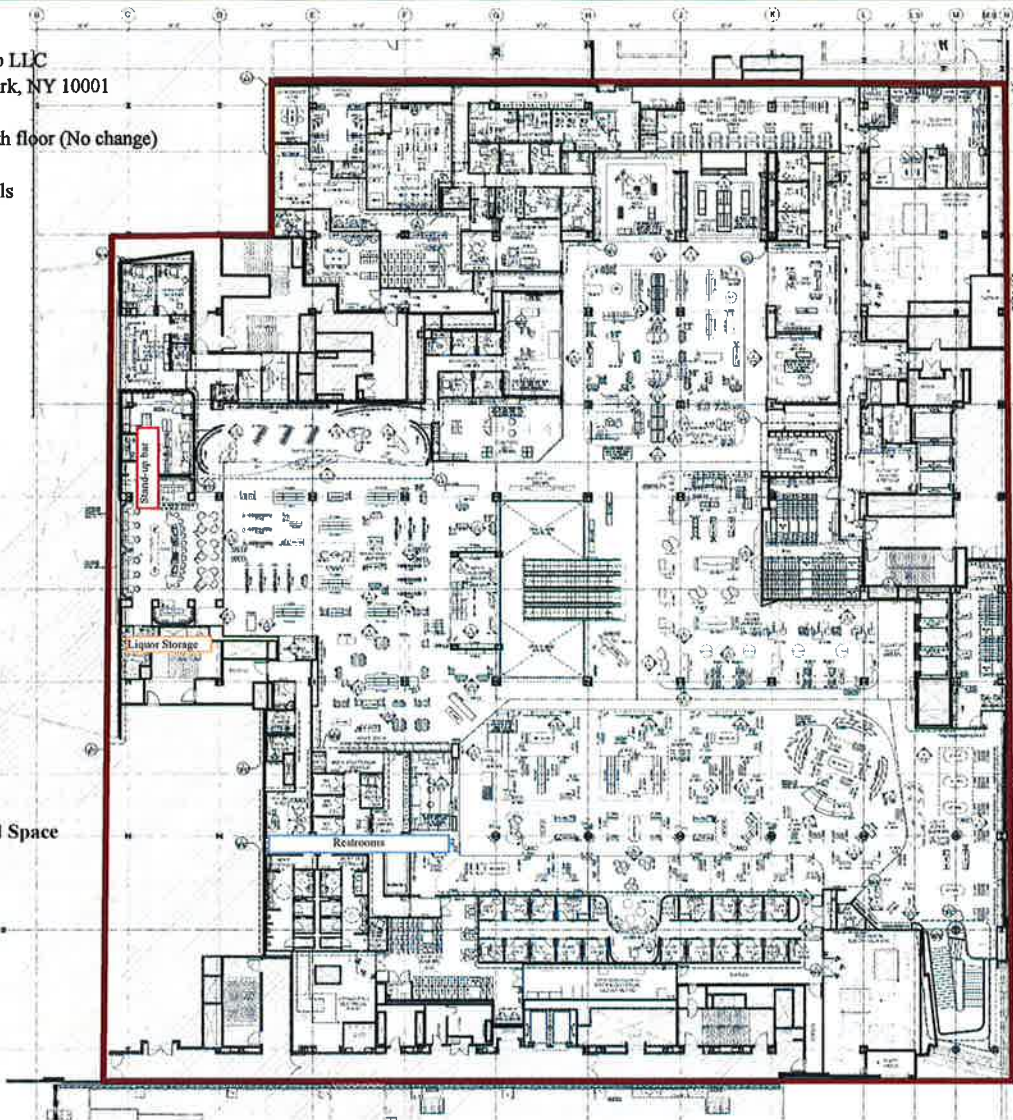

MECHANICAL PLAN LEGEND

MECHANICAL PLAN SYMBOLS

MECHANICAL PLAN NOTATION

MECHANICAL PLAN NOTES

MECHANICAL PLAN DIMENSIONS

MECHANICAL PLAN SCHEDULE

MECHANICAL PLAN SPECIFICATIONS

MECHANICAL PLAN MATERIALS

MECHANICAL PLAN FINISHES

MECHANICAL PLAN EQUIPMENT

MECHANICAL PLAN UTILITIES

MECHANICAL PLAN LEGEND

MECHANICAL PLAN SYMBOLS

MECHANICAL PLAN NOTATION

MECHANICAL PLAN NOTES

MECHANICAL PLAN DIMENSIONS

MECHANICAL PLAN SCHEDULE

MECHANICAL PLAN SPECIFICATIONS

MECHANICAL PLAN MATERIALS

MECHANICAL PLAN FINISHES

MECHANICAL PLAN EQUIPMENT

MECHANICAL PLAN UTILITIES

JANSONGLOEFLER

ARCHITECTS

100 W. 40th St., 10th Floor
 New York, NY 10018
 Tel: 212.261.1000
 Fax: 212.261.1001
 www.janongloefer.com

Neiman Marcus

PROJECT NO. 10001
 20 HUDSON YARDS
 500 WEST 33rd ST
 NEW YORK, NY

MERCHANDISING PLAN

DATE: 01/11/12

SCALE: AS SHOWN

PROJECT NO. 10001

20 HUDSON YARDS
 500 WEST 33rd ST
 NEW YORK, NY

The Neiman Marcus Group LLC
20 Hudson Yards, New York, NY 10001

Current Licensed Space: 7th floor (No change)
47 tables, 170 seats
1 Stand-up bar, 13 bar stools

— Licensed Space

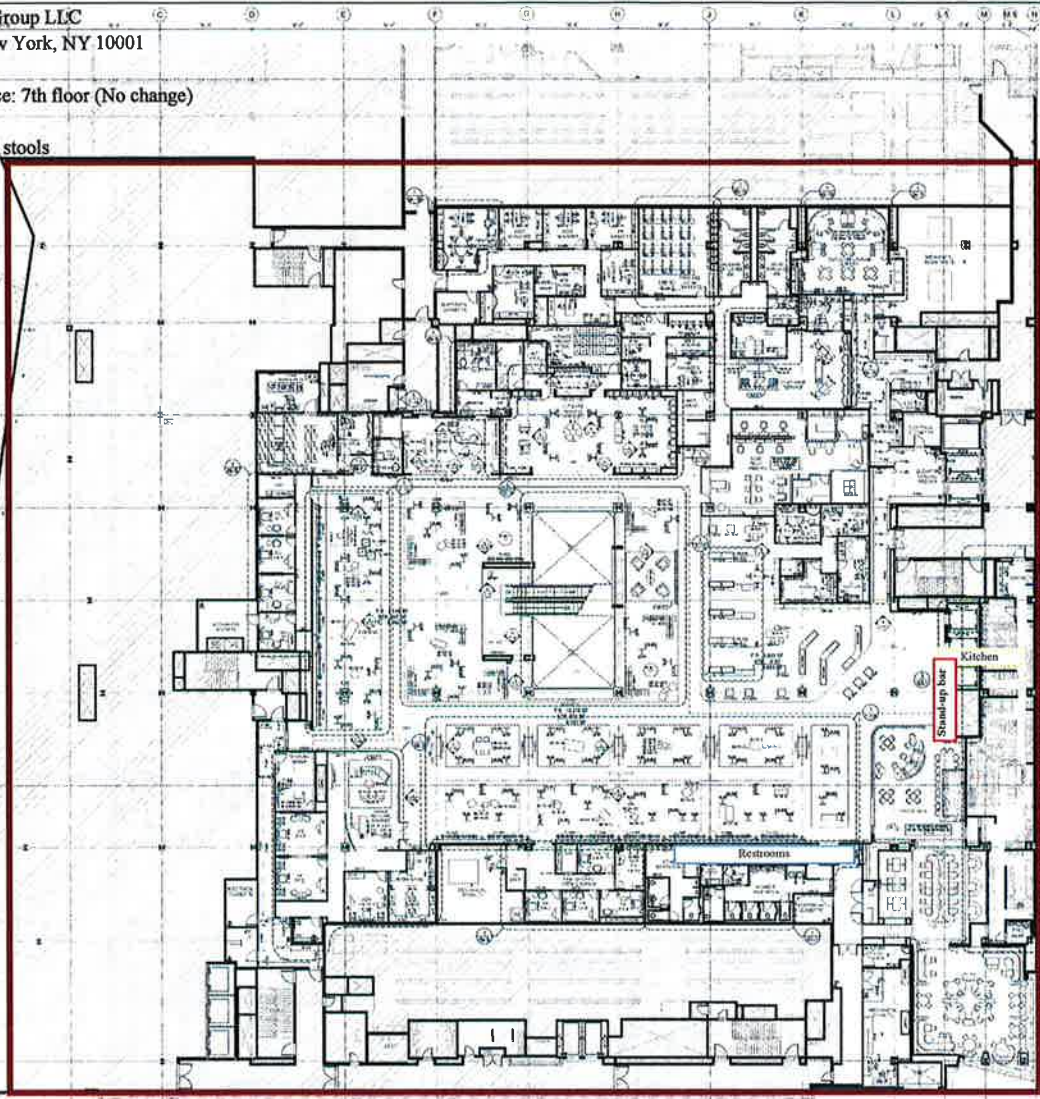

MERCHANDISING PLAN LEGEND

---	RECEIVING AREA
---	STORAGE
---	STAIRS
---	ELEVATOR
---	RESTROOMS
---	KITCHEN
---	BAR
---	TABLES
---	SEATING
---	PLANTING
---	ARTWORK
---	FIXTURES
---	...

MERCHANDISING PLAN NOTES

1. ALL MERCHANDISING PLAN ELEMENTS SHALL BE IN ACCORDANCE WITH THE LATEST EDITIONS OF THE INTERNATIONAL SYMBOLS FOR ARCHITECTURE (ISA) AND THE INTERNATIONAL SYMBOLS FOR MERCHANDISING (ISM).
2. ALL MERCHANDISING PLAN ELEMENTS SHALL BE IN ACCORDANCE WITH THE LATEST EDITIONS OF THE INTERNATIONAL SYMBOLS FOR ARCHITECTURE (ISA) AND THE INTERNATIONAL SYMBOLS FOR MERCHANDISING (ISM).
3. ALL MERCHANDISING PLAN ELEMENTS SHALL BE IN ACCORDANCE WITH THE LATEST EDITIONS OF THE INTERNATIONAL SYMBOLS FOR ARCHITECTURE (ISA) AND THE INTERNATIONAL SYMBOLS FOR MERCHANDISING (ISM).
4. ALL MERCHANDISING PLAN ELEMENTS SHALL BE IN ACCORDANCE WITH THE LATEST EDITIONS OF THE INTERNATIONAL SYMBOLS FOR ARCHITECTURE (ISA) AND THE INTERNATIONAL SYMBOLS FOR MERCHANDISING (ISM).
5. ALL MERCHANDISING PLAN ELEMENTS SHALL BE IN ACCORDANCE WITH THE LATEST EDITIONS OF THE INTERNATIONAL SYMBOLS FOR ARCHITECTURE (ISA) AND THE INTERNATIONAL SYMBOLS FOR MERCHANDISING (ISM).

GENERAL NOTES

1. ALL WORK SHALL BE IN ACCORDANCE WITH THE LATEST EDITIONS OF THE INTERNATIONAL SYMBOLS FOR ARCHITECTURE (ISA) AND THE INTERNATIONAL SYMBOLS FOR MERCHANDISING (ISM).
2. ALL WORK SHALL BE IN ACCORDANCE WITH THE LATEST EDITIONS OF THE INTERNATIONAL SYMBOLS FOR ARCHITECTURE (ISA) AND THE INTERNATIONAL SYMBOLS FOR MERCHANDISING (ISM).
3. ALL WORK SHALL BE IN ACCORDANCE WITH THE LATEST EDITIONS OF THE INTERNATIONAL SYMBOLS FOR ARCHITECTURE (ISA) AND THE INTERNATIONAL SYMBOLS FOR MERCHANDISING (ISM).
4. ALL WORK SHALL BE IN ACCORDANCE WITH THE LATEST EDITIONS OF THE INTERNATIONAL SYMBOLS FOR ARCHITECTURE (ISA) AND THE INTERNATIONAL SYMBOLS FOR MERCHANDISING (ISM).
5. ALL WORK SHALL BE IN ACCORDANCE WITH THE LATEST EDITIONS OF THE INTERNATIONAL SYMBOLS FOR ARCHITECTURE (ISA) AND THE INTERNATIONAL SYMBOLS FOR MERCHANDISING (ISM).

MERCHANDISING PLAN SCHEDULE

NO.	DESCRIPTION	QTY	UNIT	DATE
1	RECEIVING AREA	1	SQ. FT.	10/1/20
2	STORAGE	1	SQ. FT.	10/1/20
3	STAIRS	1	SQ. FT.	10/1/20
4	ELEVATOR	1	SQ. FT.	10/1/20
5	RESTROOMS	1	SQ. FT.	10/1/20
6	KITCHEN	1	SQ. FT.	10/1/20
7	BAR	1	SQ. FT.	10/1/20
8	TABLES	47	SQ. FT.	10/1/20
9	SEATING	170	SQ. FT.	10/1/20
10	PLANTING	13	SQ. FT.	10/1/20
11	ARTWORK	1	SQ. FT.	10/1/20
12	FIXTURES	1	SQ. FT.	10/1/20

JANSON/OLODFERN
ARCHITECTS

NO. 107 3
DATE 10/1/20
PROJECT 20 HUDSON YARDS
JOB APPLICATION
PROJECT MANAGER
ARCHITECT
DATE 10/1/20

NO. 107 3
DATE 10/1/20
PROJECT 20 HUDSON YARDS
JOB APPLICATION
PROJECT MANAGER
ARCHITECT
DATE 10/1/20

Neiman Marcus
20 HUDSON YARDS
500 WEST 33RD ST
NEW YORK, NY
MERCHANDISING PLAN



The Neiman Marcus Group LLC (Serial # 1314221)
20 Hudson Yards, New York, New York 10001
Fifth Floor- Proposed Alteration
Photographs



The Neiman Marcus Group LLC (Serial # 1314221)
20 Hudson Yards, New York, New York 10001
Fifth Floor- Proposed Alteration
Photographs

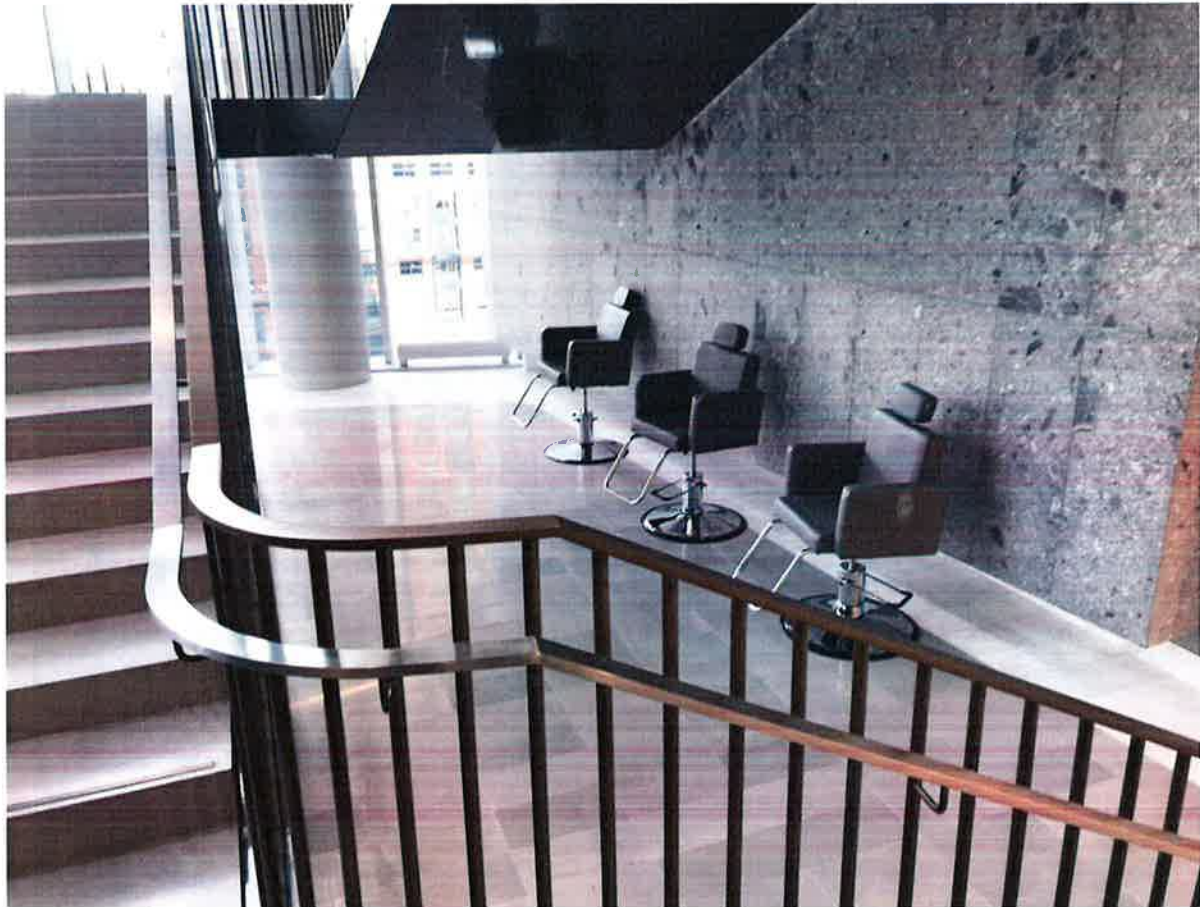

The Neiman Marcus Group LLC (Serial # 1314221)
20 Hudson Yards, New York, New York 10001

Exterior of Building



The Neiman Marcus Group LLC (Serial # 1314221)
20 Hudson Yards, New York, New York 10001



5th Floor Customer Area

The Neiman Marcus Group LLC (Serial # 1314221)
20 Hudson Yards, New York, New York 10001



6th Floor Bar and Retail Area



The Neiman Marcus Group LLC (Serial # 1314221)
20 Hudson Yards, New York, New York 10001



7th Floor Restaurant and Retail



soup

soup of the day 7.50

tortilla soup 7.50
chicken, queso, crisp tortillas

soup & half 11.50
cup of today's soup, choice of half tuna
or chicken salad sandwich

sandwiches

served with fruit

chicken salad sandwich 10.00
wheat, lettuce, tomato

tuna salad sandwich 10.00
wheat, lettuce, tomato

chicken apple club 10.00
sliced chicken, bacon, apples, lettuce,
tomato, dijonaise, wheat bread

chipotle wrap 11.00
roasted turkey, tomato, cheddar, lettuce,
chipotle mayo

turkey & gruyère 11.00
roasted turkey, gruyère, tomato,
pesto, ciabatta

salads

 bistro salad 14.00
roasted turkey, spinach, granny smith apples,
sun-dried fruits, spiced pecans,
blue cheese, light balsamic

 spring vegetable salad 14.00
mixed greens, ribbons of squash, zucchini,
julienne carrots, shaved fennel,
toasted almonds, red quinoa,
green goddess dressing

 classic cobb 14.00
mixed greens, romaine hearts, petite tomatoes,
chicken, bacon bits, boiled eggs, chives,
blue cheese, blue cheese dressing

mandarin orange soufflé 13.25
nm chicken salad, seasonal fruit, petite muffin

extras

chips 1.25

scoop 7.00

chicken or tuna salad

bakery

biscotti 2.00

bars 4.00

brownie 4.00

cake slice 7.00

cookies 4.00

chocolate chip, peanut butter, sugar

packs

protein pack 9.00

peanut butter, 2 different cheeses, apple
slices, grapes, and crackers

kids pack 6.00

pb&j, 2 different cube cheeses, apple slices



GLUTEN-FREE

www.NeimanMarcus.com/restaurants
Willow Bend



STARTERS

Petrossian Royal Ossetra Caviar * 150
30 grams classic garnish, brioche toast points

Tomato Basil Soup 8.5/12
with pesto

Housemade Guacamole 12
chips, salsa

Jumbo Shrimp Cocktail 21
fennel slaw, classic cocktail sauce

Turkey Chili 12.5
black beans, onion, sour cream, cheddar

SALADS

Lobster Salad 38
maple smoked bacon, haricot verts, feta cheese, scallions,
tomatoes, hard-boiled egg, and avocado

Blackened Shrimp Salad 28
romaine, tomatoes, marinated artichokes, cucumber,
roasted bell peppers, olives, feta cheese, chickpeas,
honey mustard vinaigrette

Baja Chicken Salad 22
grilled chicken, avocado, tomatoes, roasted corn, cucumbers,
napa cabbage, tortilla strips, tequila-lime dressing

Waldorf Salad & Curry Chicken 22
mixed greens, honey dijon dressing, walnuts, apples, grapes,
scoop nm curry chicken salad

Hoisin Glazed Salmon Salad 30
cabbage, shredded carrots, taro chips, scallion, crispy wontons,
mandarin oranges, sesame sticks, edamame, passion fruit dressing

St. Croix 20
scoop of tuna salad, shredded lettuce, fresh fruit

*These items are cooked to order. Consuming raw or undercooked meats, poultry,
seafood, shellfish, or eggs may increase your risk of food-borne illnesses.

STARTERS / SALADS



BAR4

Lobster Club 30

smoked bacon, avocado, hard-boiled egg,
tomato, toasted country white

Spicy Tuna Tartare Wrap * 22

avocado, daikon sprouts, green onions,
orange chile dressing, tobiko caviar

Blackened Campbell River Salmon Tacos 22

ricotta salata, smoked paprika aioli,
salsa verde, napa cabbage

Shanghai 20

tuna salad, sprouts, marbled rye toast,
mango chutney, fruit

Sandwich Mixer 20

your choice half sandwich tuna salad, chicken salad, egg salad,
cup of soup or small green salad & fruit, chips

Turkey Burger 21

toasted english muffin, pepper jack cheese,
shredded iceberg lettuce, pickles, buttermilk-herb aioli,
served with choice of mixed greens or house chips

**Petrossian Royal Ossetra Caviar and
Egg Salad Sandwich * 45**

toasted brioche, traditional garnish

SANDWICHES

FIRST COURSE

- TODAY'S SOUP** seasonally inspired 13
- LOBSTER BISQUE** maine lobster, chives 15
- BG DEVILED EGGS** baby arugula, crispy pancetta 14
- LOBSTER MAC & CHEESE** maine lobster, garganelli, gouda, béchamel 24
- BEET SALAD** mâche, goat cheese, toasted pistachio, horseradish vinaigrette 18
- SEARED DIVER SCALLOPS** artichoke ricotta ravioli, truffle beurre blanc, shaved truffles 23/35 *
- AHI TUNA TARTARE** avocado, english cucumber, tobiko, wasabi crème, taro crisps 23 *
- MEDITERRANEAN PLATE** hummus, tzatziki, whipped feta & red pepper dip, warm pita 22

SALADS

- ASIAN CHICKEN SALAD** napa and red cabbage, romaine, carrot, snow peas, peanuts, crispy wontons, sesame seeds, sweet chili vinaigrette 28
- JUMBO LUMP CRAB CAKE** jicama slaw, gem lettuce, chipotle aioli 39
- BABY KALE SALAD** baby carrots, walnuts, radish, quinoa, candied ginger, honey yogurt, za'atar vinaigrette 25
- GOTHAM SALAD** diced chicken breast, ham, gruyère, tomato, bacon, beets, hard-boiled egg, crisp lettuce, thousand island or dijon vinaigrette dressing 28
- LOBSTER SALAD** avocado, cucumber, cilantro, mango, mixed greens, blood orange segments, creamy herb dressing 41
- | | cal | fat | sat fat | chol | sodium | carbs | protein |
|---|-----|------|---------|--------|--------|-------|---------|
|  | 350 | 21 g | 7 g | 195 mg | 730 mg | 18 g | 25 g |
- DUCK CONFIT SALAD** sliced breast, wild mushrooms, frisée, endive, trevisano, dried berries, polenta croutons, poached berry vinaigrette 36 *

BENEFIT

Cuisine for a healthier lifestyle

* these items are cooked to order. consuming raw or undercooked meats, poultry, seafood, shellfish, or eggs may increase your risk of food-borne illnesses.

18% SERVICE CHARGE FOR PARTIES OF FIVE OR MORE

ENTREES

CHILEAN SEA BASS	haricots verts, fingerling potatoes, saffron crab sauce 40 *
LOBSTER NAPOLEON	lobster, fresh pasta layers, wild mushrooms, truffle butter 41
SKUNA BAY SALMON	spaghetti squash, walnuts, roasted brussels sprouts, warm tomato vinaigrette 36 *
HOUSE MADE RICOTTA GNOCCHI	wild mushrooms, porcini-truffle cream, parmesan-reggiano 29
ROASTED PENNSYLVANIA DUTCH CHICKEN	organic breast, parsnips, spinach, cipollini onions, white wine-rosemary natural sauce 35
FILET OF BEEF	roasted carrots, broccolini, yukon gold mashed potatoes, sauce au poivre 45 *
ROASTED CAULIFLOWER	peperonata, spinach, caramelized pears, golden raisins, cornichon-caper-mustard aioli 26
CROQUE MONSIEUR	black forest ham, gruyère, béchamel, seasonal greens 24
CROQUE MADAME	black forest ham, gruyère, béchamel with sunny-side-up egg, seasonal greens 26 *
TRUFFLE CHICKEN SALAD SANDWICH	sliced tomato, butter lettuce, pecorino cheese, brioche bun, kettle chips 30

SIDES 12

spinach, oyster mushrooms, toasted garlic
brussels sprouts, pancetta, parmesan reggiano
spaghetti squash, walnuts
roasted fingerling potatoes with cipollini onions, herb pesto
market vegetable

AFTERNOON TEA pastries, tea sandwiches, dammann teas
served daily 3:00pm – 5:00pm

BENEFIT

Cuisine for a healthier lifestyle

BEFORE PLACING YOUR ORDER, PLEASE INFORM YOUR SERVER IF A PERSON IN YOUR PARTY HAS A FOOD ALLERGY

BG IS AVAILABLE FOR PRIVATE EVENTS, PLEASE INQUIRE

DESSERTS 13

THE BG	flourless hazelnut cake, white and dark chocolate mousse, raspberries, caramel
FLOURLESS CHOCOLATE CAKE	brandied cherries, white chocolate sauce
MAPLE CHEESECAKE	bourbon caramel sauce
STICKY TOFFEE PUDDING	brandy crème anglaise
PUMPKIN CRÈME BRÛLÉE	cinnamon sugar cookies
LEMON MERINGUE TART	raspberry coulis
PROFITEROLES	chocolate sauce
TRIO OF SORBET	mango, raspberry, lemon
GELATO	vanilla, chocolate, mint chip, pumpkin, rum raisin
HOUSEMADE COOKIE PLATE	daily selection of cookies
HOUSEMADE CHOCOLATE TRUFFLES	amaretto & gran marnier
SAXELBY CHEESE PLATE	four varieties, walnut bread, fig jam 22
MOCHA MARTINI	chocolate vodka, espresso, bailey's, cocoa 16

Proximity Report for Location:

October 23, 2019

Latitude: -74.0009190691565, Longitude: 40.7533529901025

* This report is for informational purposes only in aid of identifying establishments potentially subject to 500 and 200 foot rules. Distances are approximated using industry standard GIS techniques and do not reflect actual distances between points of entry. The NYS Liquor Authority makes no representation as to the accuracy of the information and disclaims any liability for errors.

Closest Liquor Stores

Name	Address	Approx. Distance
CITARELLA HUDSON WINES & SPIRITS LLC	20 HUDSON YARDS	365 ft
ADB&SAB LLC	554 W 30TH ST	615 ft
MEENA SAMANI CORPORATION	460 W 34TH ST	655 ft
MWC RETAIL LLC	606 W 28TH ST SUITE A	1220 ft
ODYSSEY WINE & SPIRITS INC	490 10TH AVE	1595 ft
AMSTERWINE.COM INC	475 9TH AVE	1710 ft
KSS WINE LLC	509 W 38TH ST	1720 ft

Churches within 500 Feet

Name	Approx. Distance
------	------------------

Schools within 500 Feet

Name	Address	Approx. Distance
------	---------	------------------

On-Premise Licenses within 750 Feet

Name	Address	Approx. Distance
NEIMAN MARCUS GROUP LLC, THE	20 HUDSON YARDS	5 ft
BELCAMPO MEAT COMPANY EAST LLC	20 HUDSON YARDS	15 ft
MILOS HY INC	20 HUDSON YARDS	30 ft
AMERICAN GRILL INVESTOR LLC	20 HUDSON YARDS	135 ft
RSE MOMO HY LLC	500 W 33RD ST	225 ft
D & D HUDSON YARDS LLC	500 W 33RD ST	230 ft
HUDSON YARDS BY RHUBARB LLC	500 W 33RD ST	255 ft
HUDSON HALL LLC & MERCADO INVESTOR LLC AS MANAGER	10 HUDSON YARDS	300 ft
HUDSON YARDS GRILL LLC AND TKHY LLC	20 HUDSON YARDS	305 ft
BRIAN BOLKE ELEVEN CONSULTING LLC	20 HUDSON YARDS	350 ft
SAVORY & SWEET LLC	404 10TH AVE AKA 450 W 33RD ST	365 ft
WATCHES 60 GREENE INC	20 HUDSON YARDS	370 ft
EQUINOX HUDSON YARDS F&B LLC & BC HUDSON YARDS LLC	560 W 33RD ST	475 ft
SHED NYC INC & 545 WEST 30TH STREET F&B MGMT LLC	545 W 30TH ST	550 ft
TRENTA LLC	536 W 30TH ST	610 ft

Name	Address	Approx. Distance
WHITMANS WESTSIDE LLC	500 W 30TH ST	620 ft
ERY NORTH TOWER RHC TENANT LLC, EQX HOTEL MGMT LLC	35 HUDSON YARDS	670 ft
HIGHLINE GROUP NYC LLC	525 W 29TH ST	675 ft
ROCKY'S BAR & RESTAURANT INC	460 W 34TH ST	675 ft

Pending Licenses within 750 Feet

Name	Address	Approx. Distance
AMERICAN GRILL INVESTOR LLC	20 HUDSON YARDS	295 ft
COMPASS GROUP USA INC	30 HUDSON YARDS	315 ft
ERY N TOWER OB DECK MEM LLC OB DECK TEN LLC & SKY	30 HUDSON YARD	315 ft
RESTAURANT ASSOIATES LLC	30 HUDSON YARDS 24TH FL	315 ft
WS NEW YORK TAVERN LLC & RH WINE MANAGEMENT LLC	560 W 33RD ST	475 ft
WSNYC INC	560 W 33RD ST	475 ft

Unmapped licenses within zipcode of report location

Name	Address
RAJ WINE LLC	PENN STATION
TVA BAKERY LLC	138 140 W 32RD ST
VIRGIN HOTELS NEW YORK LLC & LG BROADWAY MGMT INC	1205 1227 BROADWAY

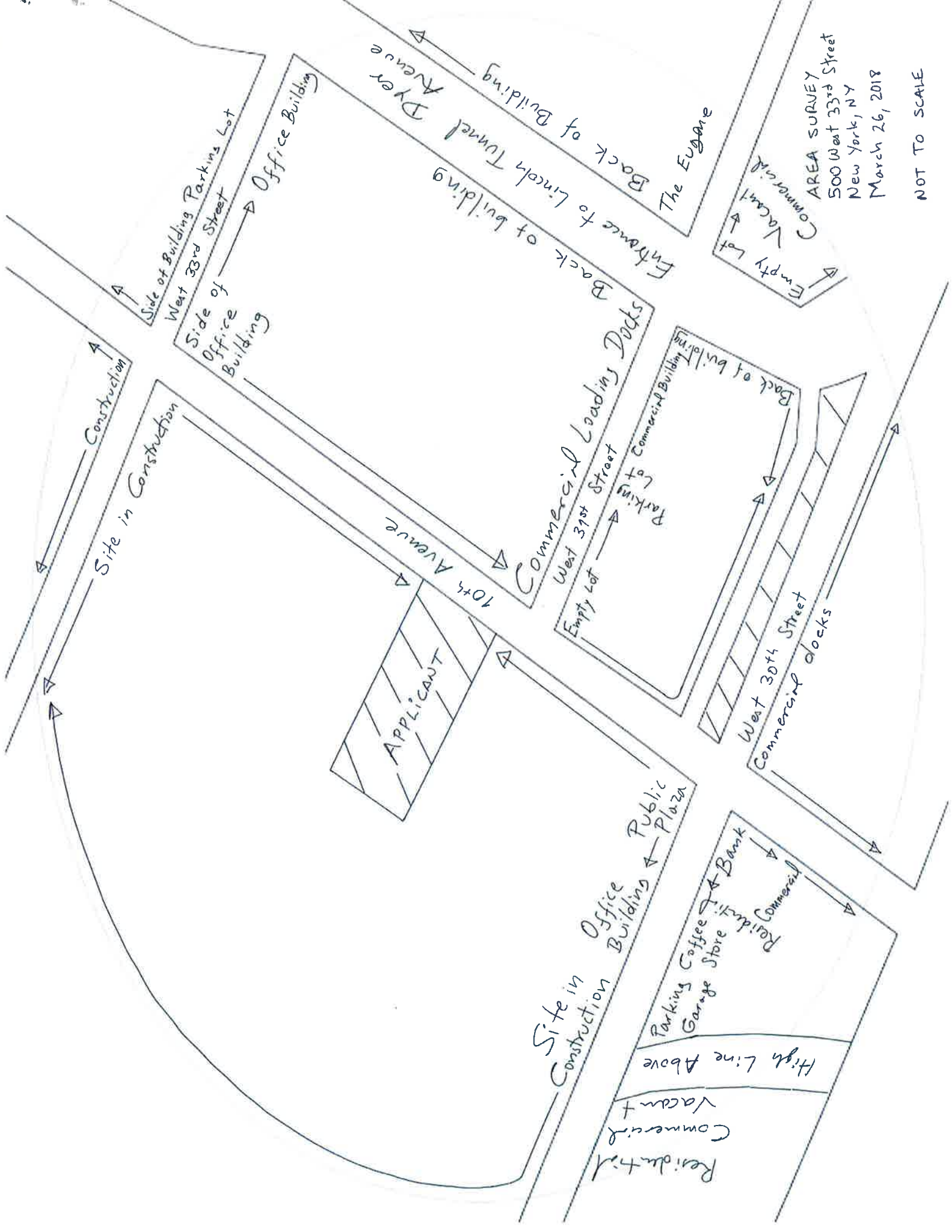

AREA SURVEY
 500 West 33rd Street
 New York, NY
 March 26, 2018
 NOT TO SCALE

Side of Building Parkins Lot
 West 33rd Street
 Office Building

Side of Office Building
 Office Building

APPLICANT

10th Avenue

Site in Construction
 Office Building
 Public Plaza

Residential
 Vacant
 Commercial
 High Line Above
 Garage Store
 Bank
 Residential
 Commercial

Commercial Loading Docks
 West 39th Street
 Empty Lot
 Back of building
 Parking Lot + Commercial Building

West 30th Street
 Commercial docks

Empty Lot
 Commercial
 Vacant
 Empty Lot

Back of building
 Entrance to Lincoln Tunnel
 Dyer Avenue
 Back of Building
 The Eugene

Re: 500 West 33rd Street

No OP licenses within 500' area.

School & Churches

No schools and churches within 500' area.

Site in Construction

Block Plot
500 West 33rd Street
New York, NY
March 26, 2018

NOT TO SCALE

APPLICANT

Office Building ← Public Plaza

10th Avenue

West 33rd Street

Side of Office Building →

Commercial Loading docks

West 39th Street

Empty Lot →

West 30th Street

