

# Manhattan Community Board 4

(All Fields Must Be Completed)

## Liquor License/Sidewalk Cafe Stipulations Application

CORPORATION NAME <b>JOIN US HK LLC</b>		DOING BUSINESS AS (DBA) <b>HOLD FAST</b>	
STREET ADDRESS <b>364 W 46<sup>th</sup> ST</b>		CROSS STREETS <b>8<sup>th</sup> &amp; 9<sup>th</sup> AVENUES</b>	ZIP CODE <b>10036</b>
OWNER <small>(Attach a list of all the people that will be associated/listed with the license)</small>	NAME: <b>RICHARD CLARK</b>	ATTORNEY/ REPRESENTATIVE	NAME: <b>MICHAEL KELLY</b>
	PHONE: <b>(980)253-1187</b>		PHONE: <b>(914)632-6036</b>
	EMAIL: <b>holdfast364@gmail.com</b>		EMAIL: <b>kellymlk136@gmail.com</b>
MANAGER	NAME: <b>gmail.com</b>	LANDLORD	NAME: <b>MUSIGNY LLC</b>
	PHONE:		PHONE: <b>(212) 754-1212</b>
	EMAIL:		EMAIL:
APPLICATION TYPE <input checked="" type="checkbox"/> <b>Liquor License</b> <input type="checkbox"/> <b>Unenclosed Sidewalk Cafe</b>			
<input type="radio"/> <b>New</b>	Has applicant owned or managed a similar business?		<input type="checkbox"/> YES <input type="checkbox"/> NO
	What is/was the name and address of establishment?		<b>CHANGE IN HOURS OF OPERATION</b>
	What were the dates applicant was involved with this former premise?		
<input type="radio"/> <b>Corp</b> <b>Change/Class Change/Removal</b>	What is the license # and expiration date?		
	Is applicant making any alterations or operational changes?		<input type="checkbox"/> YES <input type="checkbox"/> NO
	<i>If alterations or operational changes are being made, please describe/list all changes.</i>		
<input type="radio"/> <b>Alteration</b>	What is the current license # and expiration date?		
	<i>Please list/describe the nature of all the changes and attach the plans:</i>		
<b>METHOD OF OPERATION</b>			
TYPE OF ALCOHOL	<input checked="" type="checkbox"/> <b>Liquor/Wine/Beer &amp; Cider</b> <input type="checkbox"/> <b>Beer &amp; Cider</b> <input type="checkbox"/> <b>Wine/Beer &amp; Cider</b>		
ESTABLISHMENT TYPE	<input checked="" type="checkbox"/> <b>Restaurant</b> <input type="checkbox"/> <b>Cabaret</b> <input type="checkbox"/> <b>Night Club</b> <input type="checkbox"/> <b>Hotel</b> <input type="checkbox"/> <b>Bar/Tavern</b> <input type="checkbox"/> <b>Catering Establishment</b> <input type="checkbox"/> <b>Adult Entertainment</b> <input type="checkbox"/> <b>Wine Bar</b> <input type="checkbox"/> <b>Dance Club</b> <input type="checkbox"/> <b>Sports Bar</b> <input type="checkbox"/> <b>Club (Fraternal Organization - Members Only)</b>		
Has applicant/owner filed with the SLA? If yes, when? If no, when do you plan to file?		<input checked="" type="radio"/> <b>YES</b>	<input type="radio"/> <b>NO</b>
Is the 500 Foot Rule applicable? If yes, please attach a diagram of the On-Premise liquor license establishments within a 500 ft. radius of your establishment and the Public Interest Statement.		<input type="radio"/> <b>YES</b>	<input checked="" type="radio"/> <b>NO</b>
Is the 200 Foot Rule applicable? If yes, please attach a diagram of the schools and houses of worship that trigger the rule.		<input type="radio"/> <b>YES</b>	<input checked="" type="radio"/> <b>NO</b>
Has applicant/owner(s) read MCB4 Policy Regarding Concentration and Location of Alcoholic-Serving Establishments?		<input checked="" type="radio"/> <b>YES</b>	<input type="radio"/> <b>NO</b>

**OPERATIONAL DETAILS (\*Closing time will be when establishment is vacated of all patrons)**

HOURS* <i>(Indoor Only)</i>		MONDAY	TUESDAY	WEDNESDAY	THURSDAY	FRIDAY	SATURDAY	SUNDAY
	Operation	11 AM 4 AM	11 AM 4 AM	11 AM 4 AM	11 AM 4 AM	11 AM 4 AM	10 AM 4 AM	10 AM 4 AM
	Kitchen	11 AM 3 AM	11 AM 3 AM	11 AM 3 AM	11 AM 3 AM	11 AM 3 AM	10 AM 3 AM	10 AM 3 AM
	Music	11 AM 4 AM	11 AM 4 AM	11 AM 4 AM	11 AM 4 AM	11 AM 4 AM	10 AM 4 AM	10 AM 4 AM
If you plan to have music, what type(s)? (Circle all that apply)		BACKGROUND		LIVE MUSIC	DJ	JUKE BOX	KARAOKE	

**OCCUPANCY**

	Capacity (Certificate of Occupancy)	Maximum # of Persons You Anticipate Occupying Premises (Including Employees)	Number of Tables	Number of Seats	Number of Service Only Bars	Number of Stand-Up Bars	Number of Seats at Stand-Up Bar
INSIDE	45	45	9	30	0	1	15
OUTSIDE <i>(Other than sidewalk café)</i>	n/a						
SIDEWALK CAFE	n/a						

How many floors are there? What is the capacity for each floor? 1 - 45

How frequently will the owner(s) be at the establishment? all hours

Will there be dancing?	YES	<input checked="" type="radio"/> NO
Will applicant have bottle or table service for beverage alcohol?	YES	<input checked="" type="radio"/> NO
Will you be hosting private, promotional or corporate events?	<input checked="" type="radio"/> YES	NO
Will outside promoters be used on a regular basis? If yes please describe.	YES	<input checked="" type="radio"/> NO
Will you have a security plan? If, yes please attach.	YES	<input checked="" type="radio"/> NO
Will security plan be implemented?	YES	<input checked="" type="radio"/> NO
Will State certified security personnel be used?	YES	<input checked="" type="radio"/> NO
Will New York Nightlife Association and NYPD Best Practices be followed?	YES	<input checked="" type="radio"/> NO
Will applicant be using delivery bicycles? If yes, how many?	YES	<input checked="" type="radio"/> NO
Will delivery bicycles be clearly marked with the name of the restaurant and will staff wear attire clearly noting name as described by NYC Law?	YES	NO <span style="float: right;">n/a</span>
Where will delivery bicycles be stored during the day when not in use?	n/a.	

**LOCATION & ZONING**

Is this a Special District? If yes, is it Clinton, West Chelsea or Hudson Yards?	<input checked="" type="radio"/> YES	<input type="radio"/> NO	Clinton
Does the building have a Certificate of Occupancy ("C of O") or a letter of no objection?	<input checked="" type="radio"/> YES	<input type="radio"/> NO	
Is a Public Assembly permit required?	<input type="radio"/> YES	<input checked="" type="radio"/> NO	
Are your plans filed with DOB?	<input type="radio"/> YES	<input checked="" type="radio"/> NO	

**Community Notification/Relations**

<b>NOTIFICATION:</b> List all block associations; tenant associations, co-op boards or condo boards of residential buildings; and community groups that applicant has notified regarding its application. For each please list both the organization and individual you contacted	# 1	see attached list
	# 2	
	# 3	
	# 4	
	# 5	
Please provide dates when applicant met with the groups listed above.		
Who was your contact person at each group you met with?		
When did applicant post the notice that was provided?		
Where did applicant post the notice that was provided?		
Will applicant provide owner cell phone number to neighbors and respond to complaints that arise? Please provide number in space provided.	<input checked="" type="radio"/> YES	<input type="radio"/> NO
Will applicant inform the Community Board office of its job openings and/or provide a hyperlink to applicants jobs webpage?	<input checked="" type="radio"/> YES	<input type="radio"/> NO

First name	Last name	ORGANIZATION	E-MAIL
Kathleen	Treat	HKNA (incl. Dog Run)	kathleentreat123@gmail.com
Frank	Sirock	West 36th Street	mcgee79@aol.com
Joe	Restuccia	CHDC (incl. Bob's & bird parks)	
Brian	Kehoe	500-506 West 42nd Street T.A.	
Eduardo	Zeiger	West 43rd Street (b. 9th/10th)	eduardozeiger@compuserve.com
Douglas	Leland	Manhattan Plaza T.A. (400 W. 43rd St.)	mpta@mptenants.com
Linda	Ashley	West 44 Street Better Block Association	ashleyvl@aol.com
Renee & Gordon	Stanley	West 44th Street (b. 9th/10th)	twocatsid@worldnet.att.net
Rudy	Papiri	West 44th Street (b. 9th/10th)	Rudi Papiri@timemagazine.com
Tim	Tanner	West 45th Street BA	tangotanner@gmail.com
Chana	Widawski	West 45th Street (b. 9th/12th)	chanawid@gmail.com
Allison	Tupper	West 46th Street (8th Ave to 12th Ave)	Allison Tupper@verizon.net
Steve	Fanto	West 46 Street Block Association (8th Ave to 12th Ave)	stephenfanto@gmail.com
Phil	Kassen	West 47th/48th Streets	
Eike	Fears	West 47th/48th Streets	aefearshk@earthlink.net
Larry	Roberts	West 47th/48th Streets	larrymichaelroberts@gmail.com
Jim	Bogues	West 47th/48th Streets	jamesbogues@gmail.com
Chuck	Vassallo	West 47th/48th Streets	chasmv@hotmail.com
Stefan	Riedl	West 47th/48th Streets	chluderermyc@yahoo.com
Nancy	Roylance	West 47th/48th Streets	nancyroylance@ymail.com
Karen	Nightengale	Flats Tenants Association	
Maria	Guzman	Harborview Terrace T.A. (525 W. 55th St.)	mariaqvns@aol.com
Frank	Baker	400 West 56th Street	
Ellen	Celnik	The Aurora	ecelnik@actorsfund.org
Richard	Pimentel	The Aurora	rpimentel@commonground.org
Derrick	Sage	The Aurora	dsage@commonground.org
Bill	Sirezempek	The Camelot	
Marjorie	Kagen	The Colonnade	buzany@rcn.com
Nancy	Kyriacou	Oasis Gardens I 10th Ave., b. 51/52	nkyriacou@yahoo.com
Gary	Dipasquale	Oasis Gardens II 52nd St/10th Ave.	gdclay@att.net
J.D.	Noland	Midtown North Pct. Council	jeandaniel@aol.com
John	Muud	Midtown North/South Pct. Council	john.muud@usa.net
William	Otterson	Midtown North/South Pct. Council	bill@midtownsouthcc.org
Carl	Carmen	Midtown North/South Pct. Council	
Sarah	Desmond	Housing Conservation Coordinators [10th Ave., b. 52/53]	sdesmond@hcc-nyc.org
Paul	Loeb	300 W 55th St	ploeb315@aol.com
Christine	Gorman	West 55th Street Association	west55ba@gmail.com
Steve	Belida	50/51 St Street Block Association	hk5051@gmail.com
Jeff	Robins	50/51 St Street Block Association	hk5051@gmail.com
Raul	Larios	Hudson Hotel Residents	rlarios@hotmail.com
Amanda	Cernitz	Westmore 333 W 57	acernitz@gmail.com
Anita	McDonagh	Parc Vendome 340 W 57th Street	awm3333@me.com
Jesse	Bondy	Colonnade 347 W 57th Street	jessbondy@aol.com

**Manhattan Community Board No. 4  
Clinton Block Association**

## BUILDING DESIGN

State the name and type of business previously located in the space.			
Has a liquor-licensed establishment previously occupied this space at any time? If yes, please provide the name of the business.	<input checked="" type="radio"/> YES	<input type="radio"/> NO	The applicant has been open + operating since 9/27/2017
Do you plan any changes to the existing façade? If yes, please describe.	<input type="radio"/> YES	<input checked="" type="radio"/> NO	
Has the applicant/owner(s) read MCB 4 ADA Guidelines Memo?	<input checked="" type="radio"/> YES	<input type="radio"/> NO	
Is the entrance ADA Compliant?	<input checked="" type="radio"/> YES	<input type="radio"/> NO	
Do you plan any changes to the existing façade? If yes, please describe.	<input type="radio"/> YES	<input checked="" type="radio"/> NO	
Will applicant have a vestibule within the establishment?	<input type="radio"/> YES	<input checked="" type="radio"/> NO	
Will applicant use a storm enclosure?	<input type="radio"/> YES	<input checked="" type="radio"/> NO	
Will applicant agree not to place any items or obstructions on the sidewalk, for example, sandwich boards, sidewalk signs, freestanding menus and plants, as per the law?	<input checked="" type="radio"/> YES	<input type="radio"/> NO	
Will applicant comply with the NYC noise code?	<input checked="" type="radio"/> YES	<input type="radio"/> NO	
Will the establishment have any of the following: (circle all that apply)	<input type="radio"/> FRENCH DOORS	<input type="radio"/> GARAGE DOORS	<input type="radio"/> WINDOWS THAT CAN BE OPENED
Will applicant close all windows, French doors, garage doors when any music or amplified sound (including televisions) is played inside the establishment?	<input checked="" type="radio"/> YES	<input type="radio"/> NO	
Will applicant close all windows, French doors, garage doors by 11 PM Friday and Saturday and 10 PM on all other days even if no music or amplified sound is played inside the establishment?	<input checked="" type="radio"/> YES	<input type="radio"/> NO	
Has applicant obtained an acoustical report from a certified sound engineer to assess potential noise disturbance to the neighboring residents and buildings?	<input type="radio"/> YES	<input checked="" type="radio"/> NO	
Will applicant follow the recommendations of a certified sound engineer to mitigate potential noise disturbance to the neighboring residents and buildings, including placing speakers on the floor of the establishment?	<input checked="" type="radio"/> YES	<input type="radio"/> NO	
Will the kitchen exhaust system extend to the roof?	<input checked="" type="radio"/> YES	<input type="radio"/> NO	
Will the establishment have an illuminated sign?	<input type="radio"/> YES	<input checked="" type="radio"/> NO	
Will the establishment have a canopy extending over the sidewalk?	<input checked="" type="radio"/> YES	<input type="radio"/> NO	Existing
Where will the air conditioner be located? What type is it?	on roof existing		
When was the air conditioner installed?			

n/a

**OUTDOOR ITEMS - OTHER THEN SIDEWALK CAFÉ**

Has the applicant/owner(s) read MCB 4 Rear Yard Rooftop Policy?	<input checked="" type="radio"/> YES	<input type="radio"/> NO	
Will applicant use any outdoor spaces: rooftop, rear yard, patio, porch, balcony, pavilion, tents, deck or gazebo? If yes, which one(s)?	<input type="radio"/> YES	<input checked="" type="radio"/> NO	
Are the floorplans for the outdoor space(s) included?	<input type="radio"/> YES	<input type="radio"/> NO	N/A
Will applicant close and vacate the outdoor space(s) by 11PM on Friday & Saturday and 10 PM on all other days?	<input type="radio"/> YES	<input type="radio"/> NO	N/A
Will the service and consumption of alcohol in any outdoor space only be via seated food service?	<input type="radio"/> YES	<input type="radio"/> NO	N/A
Will applicant not allow standing space for patrons to drink or smoke in any outdoor space(s)?	<input type="radio"/> YES	<input type="radio"/> NO	N/A
Will there be no amplified music, as per the law?	<input type="radio"/> YES	<input type="radio"/> NO	N/A
If amplified sound is played inside the establishment, will windows and doors be closed?	<input type="radio"/> YES	<input type="radio"/> NO	N/A
Will applicant agree to post signs outside asking customers to respect the neighbors'?	<input type="radio"/> YES	<input type="radio"/> NO	N/A
Will applicant agree to train staff to encourage a peaceful environment?	<input type="radio"/> YES	<input type="radio"/> NO	N/A
Will applicant provide effective sound control (landscaping enclosure, soundproofing tenants apartments)	<input type="radio"/> YES	<input type="radio"/> NO	N/A
Will there be a lighting plan that allows safe usage of the outdoor space without disrupting neighbors?	<input type="radio"/> YES	<input type="radio"/> NO	N/A

## OUTDOOR ITEMS – SIDEWALK CAFÉ

Has the applicant/owner(s) read MCB4 Sidewalk Café Policy?	<input checked="" type="radio"/> YES	<input type="radio"/> NO	
Will applicant be applying for a sidewalk café now or in the future?	<input type="radio"/> YES	<input checked="" type="radio"/> NO	
Is applicant in this application seeking to include a sidewalk café in its liquor license?	<input type="radio"/> YES	<input type="radio"/> NO	N/A
If yes, has applicant submitted an application and plans to NYC Dept. of Consumer Affairs? Please attach application and plans.	<input type="radio"/> YES	<input type="radio"/> NO	N/A
Will applicant close and vacate the sidewalk café by 11 PM on Friday & Saturday and 10 PM on all other days?	<input type="radio"/> YES	<input type="radio"/> NO	N/A
Will applicant be serving alcohol in the sidewalk café? If so, will you have waiter service?	<input type="radio"/> YES	<input type="radio"/> NO	N/A
Will the café have a 3 ft. wide serving aisle running the entire length of the sidewalk café?	<input type="radio"/> YES	<input type="radio"/> NO	N/A
Will applicant mark the perimeter of the café on the sidewalk?	<input type="radio"/> YES	<input type="radio"/> NO	N/A
Will the service and consumption of alcohol in the sidewalk café only be via seated food service?	<input type="radio"/> YES	<input type="radio"/> NO	N/A
Will the sidewalk café not provide standing space for drinking or smoking?	<input type="radio"/> YES	<input type="radio"/> NO	N/A
Will applicant use any portable natural gas heaters? If so, do you have the requisite approvals from DOB & the Fire Department?	<input type="radio"/> YES	<input type="radio"/> NO	N/A
Will applicant have a lighting plan that will allow safe usage of the outdoor space without disrupting neighbors?	<input type="radio"/> YES	<input type="radio"/> NO	N/A
Will all furniture, plants and barricades be stored inside between the evening closing hours and the morning opening hours?	<input type="radio"/> YES	<input type="radio"/> NO	N/A
Will all furniture be stored inside between December 21 <sup>st</sup> and March 21 <sup>st</sup> , and any other day when it rains or snows?	<input type="radio"/> YES	<input type="radio"/> NO	N/A
Will applicant use umbrellas?	<input type="radio"/> YES	<input type="radio"/> NO	N/A
If construction or construction protection has reduced the sidewalk width, will applicant always maintain an 8 foot clear path of sidewalk between the perimeter of the café and the closes obstruction including construction barricades?	<input type="radio"/> YES	<input type="radio"/> NO	N/A

**ADDITIONAL STIPULATIONS: (Office Use Only)**



***To the extent any additional stipulation on pages 7 and 8 of this application conflicts with any response on pages 1 – 6 of this application, the stipulations on pages 7 and 8 control.***



**ADDITIONAL STIPULATIONS: (Office Use Only), *Continued***

***To the extent any additional stipulation on pages 7 and 8 of this application conflicts with any response on pages 1 – 6 of this application, the stipulations on pages 7 and 8 control.***

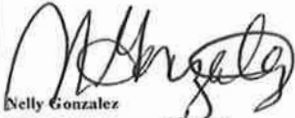
<p>Manhattan Community Board 4 (MCB4) recommends:          (MCB4's recommendation is based on a vote taken at its          November 6, 2019 full board meeting, with <u>37</u> members voting in favor          of the recommendation, <u>0</u> members opposed, <u>0</u> members          abstaining and <u>0</u> present but not eligible)</p>	<p><input checked="" type="radio"/> Denial unless all stipulations agreed to by applicant/owner are part of the method of          operation</p> <p><input type="radio"/> Denial    <input type="radio"/> Approval</p>
--	--

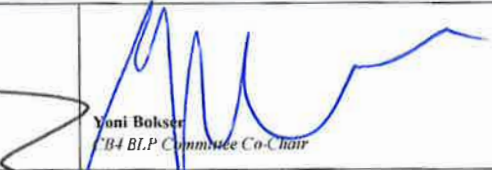
<b>CB4 REPRESENTATIVES</b>		
 Nelly Gonzalez CB4 Assistant District Manager	 Frank Holozubiec CB4 BLP Committee Co-Chair	 Yoni Bokser CB4 BLP Committee Co-Chair

**APPLICANT AGREEMENT WITH THE COMMUNITY**

Applicant agrees to these stipulations as the basis for the community support of this application and acknowledges that all of these stipulations are essential prerequisites to the MCB4 recommendation regarding this application. Applicant agrees to have these stipulations incorporated in the method of operation of its liquor license. The stipulations in this application constitute the entire agreement between MCB4 and applicant and may only be altered in writing signed by MCB4 and applicant. These stipulations supersede any oral statements or representations in connection with this application.

<p>SIGN HERE →</p>	<p>SHANE HATHAWAY          PRINT NAME OF APPLICANT</p>	 SIGNATURE OF APPLICANT	<p>10/17/19          DATE</p>
--------------------	--	--	-----------------------------------

## JOIN OUR TABLE

### Hold Fast Wings \$11

Dry Rub, Hold Fast White Sauce,  
Cilantro, Carrots (GF)

### Fried Burrata \$10

House Marinara, Grilled Ciabatta,  
Arugula Salad

### Deviled Eggs \$9 (GF)

\*Add Bacon \$2     Add Tobiko \$2

### Sesame Ahi Tuna \$14

Fried Wontons, Wasabi Cream,  
Bell Peppers, Cilantro,  
Soy sauce

### Steak on Toast \$15

Grilled Baguette, Chimichurri,  
Baby Arugula, Pickled Red Onion

### Bone Marrow \$18

Soft Scrambled Egg, Soy Glaze,  
Tobiko, Grilled Ciabatta

\*American Born Bourbon

Bone Luge Shot \$6

### Carnitas Fries \$16

Slow Cooked Pork, Crinkle Cut Fries,  
Cheddar, Sour Cream, Avocado Puree,  
Pico De Gallo, Cilantro (GF)

### Cheese Board \$18

Chefs Selection of Cheeses,  
Grilled Ciabatta, Assorted  
Accompaniments

### Butcher's Board \$18

Chefs Selection of Cured Meats,  
Grilled Ciabatta, Assorted  
Accompaniments

### Meat and Cheese Board \$30

A Combination of the Cheese and  
Butcher's Boards.

## JOIN OUR TABLE

### Hold Fast Tacos

Served On Corn Tortillas  
(2/Order)

#### Veggie \$8

Sauteed Onion & Pepper,  
Arugula Mix, Avocado  
Puree, Pico de Gallo,  
Cilantro (V)

#### Pork \$9

Slow Cooked Pork,  
Cabbage, Pineapple  
Salsa, Cilantro,  
Salsa Roja

#### Tuna \$10

Seared Tuna, Arugula  
Mix, Soy Glaze, Fried  
Wonton, Wasabi Cream,  
Cilantro

#### Steak \$11

Filet Tips, Salsa  
Roja, Cabbage,  
Pico De Gallo,  
Cilantro

\*Add Avocado Puree (V) \$2

### Wings and Waffles \$16

House Made Waffles, Dry Rubbed  
Wings, Bourbon Pecans, Maple  
Syrup

\*Add Bacon \$2

### Classic Burger \$14

Bibb Lettuce, Tomato, Crinkle  
Cut Fries, House Made Sweet  
Pickle

\*Add Cheddar \$2 / Gruyere \$3

Add Bacon \$2

### Kale & Quinoa Salad \$12

Kale, Baby Arugula, Radicchio,  
Carrots, Pumpkin Seeds, Goat  
Cheese, Strawberries, Lemon-  
Thyme Vinaigrette (GF)

\*Add Tuna \$5 / Steak \$6

### Beer for the Kitchen \$1

Enjoy the food? Show 'em some  
love!

Consuming raw or undercooked meats, poultry,  
seafood, shellfish or eggs may increase your risk  
of foodborne illness

Consuming raw or undercooked meats, poultry,  
seafood, shellfish or eggs may increase your risk of  
foodborne illness

ON-PREMISES LIQUOR LICENSE  
SERIAL #: 1302077  
COUNTY: NEW YORK

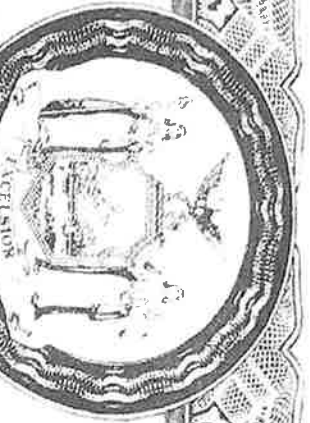

EFFECTIVE DATE: 09/21/2017  
EXPIRATION DATE: 8/31/2019  
CERTIFICATE #: 862450

# NEW YORK STATE LIQUOR AUTHORITY

THE LICENSE DESIGNATED BELOW IS HEREBY GRANTED PERMISSION, UNDER THE ALCOHOLIC BEVERAGE CONTROL LAW TO TRAFFIC IN ALCOHOLIC BEVERAGE PURSUANT TO THE TYPE OF LICENSE INDICATED IN THE UPPER LEFT HAND CORNER OF THIS CERTIFICATE AND ACCORDING TO THE STATUTES AND REGULATIONS PERTAINING THERETO.

THIS LICENSE SHALL NOT BE TRANSFERABLE TO ANY OTHER PERSON OR TO ANY OTHER PREMISES OR TO ANY OTHER PART OF THE BUILDING CONTAINING SUCH LICENSED PREMISES. IT SHALL NOT BE DEEMED A PROPERTY OR VESTED RIGHT AND MAY BE REVOKED AT ANY TIME PURSUANT TO LAW.

METHOD OF OPERATION  
RESTAURANT SERVING LIQUOR, WINE, BEER AND CIDER  
CB4 Stips: Mon - Fr from 11am to 2am and Sat - Sun 10am to 2am  
Recorded Music Permitted and No Dancing

JOIN US HK LLC  
HOLD FAST  
364 W 46TH ST  
NEW YORK NY 10036

FILING FEE \$200.00  
LICENSE FEE \$4,352.00

*Vincent G. Bradley*  
Vincent G. Bradley  
Chairman

BEFORE COMMENCING OR DOING ANY BUSINESS FOR THE TIME FOR WHICH THIS LICENSE HAS BEEN ISSUED, THE SAID LICENSE SHALL BE ENCLOSED IN A SUITABLE WOOD OR METAL FRAME, HAVING A CLEAR GLASS SPACE AND A SUBSTANTIAL WOOD OR METAL BACK SO THAT THE WHOLE OF SAID LICENSE MAY BE SEEN THEREIN, AND SHALL BE POSTED UP AND AT ALL TIMES DISPLAYED IN A CONSPICUOUS PLACE IN THE ROOM WHERE SUCH BUSINESS IS CARRIED ON, SO THAT ALL PERSONS VISITING SUCH PLACE MAY READILY SEE THE SAME.

Certificate No. B0862450

SIA FORM 189-033 (10/09)

FOLD AND TEAR HERE

FOLD AND TEAR HERE

THE CITY OF NEW YORK

# DEPARTMENT OF BUILDINGS CERTIFICATE OF OCCUPANCY

BOROUGH **MANHATTAN**

DATE: **JUN 24 1981** NO. **81172**

ZONING DISTRICT **Cl-5 in 2-6**

This certificate supersedes C.O. No.

THIS CERTIFIES that the ~~same~~ altered ~~structure~~ building premises located at

**364 West 46 Street**

(Sp. Clinton Dr.)

Block **1036** Lot **99**

CONFORMS SUBSTANTIALLY TO THE APPROVED PLANS AND SPECIFICATIONS AND TO THE REQUIREMENTS OF ALL APPLICABLE LAWS, RULES AND REGULATIONS FOR THE USES AND OCCUPANCIES SPECIFIED HEREIN

PERMISSIBLE USE AND OCCUPANCY

Floor	Area	Use	Occupancy	Remarks	
Cellar	0.0			boiler rm, storage, toilets	
base	75	45		6	Restaurant, kitchen, Eating & Drinking Esthl.
1st	40		1 2 2	One (1) Cl. A Apt.	
2nd	40		1 2 2	One (1) Cl. A Apt.	
3rd	40		1 2 2	One (1) Cl. A Apt.	
<b>TOTAL</b>		Restaurant, Eating & Drinking Establishment and Three (3) Class "A" Apartments Class "A" Multiple Dwelling Heretofore - Converted Old - Code This Certificate is predicated upon the final report of inspection dated May 29, 1981			

OPEN SPACE USES

SPECIAL PARKING SPACES, LOADING BERTHS, OTHER USES (NONE)

NO CHANGES OF USE OR OCCUPANCY SHALL BE MADE UNLESS A NEW AMENDED CERTIFICATE OF OCCUPANCY IS OBTAINED

THIS CERTIFICATE OF OCCUPANCY IS ISSUED SUBJECT TO THE CITY'S GENERAL CONDITIONS AND SPECIFICATIONS NOTED ON THE REVERSE SIDE.

*Serge Chakona*  
BOROUGH SUPERINTENDENT

*Simon Fradette*  
COMMISSIONER

ORIGINAL    OFFICE COPY DEPARTMENT OF BUILDINGS    COPY

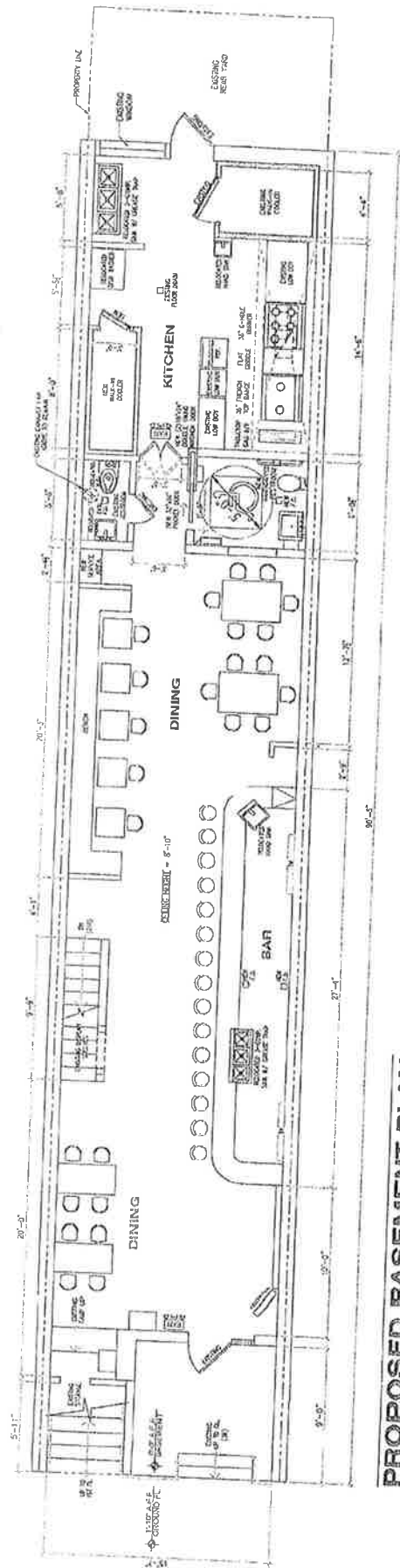

**PROPOSED BASEMENT PLAN**  
 RESTAURANT AREA

SCALE: 1/4" = 1'-0"