



# RIU PLAZA NEW YORK TIMES SQUARE

**741 EIGHTH AVENUE OWNERS LLC**  
305 WEST 46<sup>TH</sup> STREET  
NEW YORK, NEW YORK 10036

Alteration Application  
Manhattan Community Board No. 4  
Business Licenses and Permits Committee  
July 10, 2018

## Community Board Application

1. Layout
2. Menus
3. Photographs
4. Certificate of Occupancy
5. Posted Notice

**BERNSTEIN REDO, P.C.**

1177 Avenue of the Americas, 5<sup>th</sup> floor  
New York, NY 10036  
Tel. 212.651.3100

[martha@brpclaw.com](mailto:martha@brpclaw.com) | [www.brpclaw.com](http://www.brpclaw.com)

# Manhattan Community Board 4

(All Fields Must Be Completed)

## Liquor License/Sidewalk Cafe Stipulations Application

CORPORATION NAME 741 Eighth Avenue Owners, LLC		DOING BUSINESS AS (DBA) RIU Plaza New York Times Square Hotel	
STREET ADDRESS 305 West 46th Street		CROSS STREETS corner of 8th Avenue and 46th St.	ZIP CODE 10036
OWNER <i>(Attach a list of all the people that will be associated/listed with the license)</i>	NAME: Carmen Riu Guell Luis Riu Guell	ATTORNEY/ REPRESENTATIVE	NAME: Bernstein Redo, P.C.
	PHONE: 212-421-8100		PHONE: 212-651-3100
	EMAIL: Wrobel@wmlawny.com		EMAIL: martha@brpclaw.com ben@brpclaw.com
MANAGER	NAME: Katharina Romy Doehler	LANDLORD	NAME: N/A - licensee is the fee owner of a portion of the property and an affiliate entity owns the remaining portion, which the licensee occupies under a lease
	PHONE: 646-864-1100		PHONE: 212-241-8199
	EMAIL: hotel.plazanewyorktimesquare@riu.com		EMAIL: Wrobel@wmlawny.com
APPLICATION TYPE <input checked="" type="checkbox"/> Liquor License <input type="checkbox"/> Unenclosed Sidewalk Cafe			
<input type="radio"/> New	Has applicant owned or managed a similar business?		YES NO
	What is/was the name and address of establishment?		
	What were the dates applicant was involved with this former premise?		
<input type="radio"/> Corp Change/Class Change/Removal	What is the license # and expiration date?		
	Is applicant making any alterations or operational changes?		YES NO
	If alterations or operational changes are being made, please describe/list all changes.		
<input checked="" type="radio"/> Alteration	What is the current license # and expiration date?		#1289098 and 1289099 EXP 2/29/2020
	Please list/describe the nature of all the changes and attach the plans: Incorporating into the hotel licensed premises certain outside space on 46th St. (within the hotel property) with maximum 18 tables and 36 seats		
METHOD OF OPERATION			
TYPE OF ALCOHOL	<input checked="" type="radio"/> Liquor/Wine/Beer & Cider <input type="radio"/> Beer & Cider <input type="radio"/> Wine/Beer & Cider		
ESTABLISHMENT TYPE	<input checked="" type="radio"/> Restaurant <input type="radio"/> Cabaret <input type="radio"/> Night Club <input checked="" type="radio"/> Hotel <input type="radio"/> Bar/Tavern <input type="radio"/> Catering Establishment <input type="radio"/> Adult Entertainment <input type="radio"/> Wine Bar <input type="radio"/> Dance Club <input type="radio"/> Sports Bar <input type="radio"/> Club (Fraternal Organization - Members Only)		
Has applicant/owner filed with the SLA? If yes, when? If no, when do you plan to file?	YES	<input checked="" type="radio"/> NO	On or after July 9, 2018
Is the 500 Foot Rule applicable? If yes, please attach a diagram of the On-Premise liquor license establishments within a 500 ft. radius of your establishment and the Public Interest Statement.	YES	<input checked="" type="radio"/> NO	n/a - application is for an alteration
Is the 200 Foot Rule applicable? If yes, please attach a diagram of the schools and houses of worship that trigger the rule.	YES	<input checked="" type="radio"/> NO	n/a - application is for an alteration
Has applicant/owner(s) read MCB4 Policy Regarding Concentration and Location of Alcoholic-Serving Establishments?	<input checked="" type="radio"/> YES	<input type="radio"/> NO	

**OPERATIONAL DETAILS** (\*Closing time will be when establishment is vacated of all patrons)

		MONDAY	TUESDAY	WEDNESDAY	THURSDAY	FRIDAY	SATURDAY	SUNDAY
<b>HOURS*</b> <i>(Indoor Only)</i>	<b>Operation</b>	7am-4am	7am-4am	7am-4am	7am-4am	7am-4am	7am-4am	7am-4am
	<b>Kitchen</b>	7am-4am	7am-4am	7am-4am	7am-4am	7am-4am	7am-4am	7am-4am
	<b>Music</b>	7am-4am	7am-4am	7am-4am	7am-4am	7am-4am	7am-4am	7am-4am
If you plan to have music, what type(s)? (Circle all that apply)		<input checked="" type="checkbox"/> <b>BACKGROUND</b>		<input checked="" type="checkbox"/> <b>LIVE MUSIC</b>		<input checked="" type="checkbox"/> <b>DJ</b>		<input type="checkbox"/> <b>JUKE BOX</b>

\*Live music and/or DJ is for private events only

<b>OCCUPANCY</b>								
	Capacity (Certificate of Occupancy)	Maximum # of Persons You Anticipate Occupying Premises (Including Employees)	Number of Tables	Number of Seats	Number of Service Only Bars	Number of Stand-Up Bars	Number of Seats at Stand-Up Bar	
<b>INSIDE</b>	Hotel: 1650 Rest/Bar: 679	Rest/Bar: 459	187	396 plus 43 lobby seats	0	2	11	
<b>OUTSIDE</b> <i>(Other than sidewalk café)</i>	Back yard: 85 47th Street: 36	60 36	12 plus 4 low tables	52 36	N/A	N/A	N/A	
<b>SIDEWALK CAFÉ</b>	N/A	N/A	N/A	N/A				

How many floors are there? What is the capacity for each floor?	28 floors plus cellar	
How frequently will the owner(s) be at the establishment?	Owners 1/year; manager daily	
Will there be dancing?	<input type="checkbox"/> YES	<input checked="" type="checkbox"/> NO
Will applicant have bottle or table service for beverage alcohol?	<input checked="" type="checkbox"/> YES	<input type="checkbox"/> NO
Will you be hosting private, promotional or corporate events?	<input checked="" type="checkbox"/> YES	<input type="checkbox"/> NO
Will outside promoters be used on a regular basis? If yes please describe.	<input type="checkbox"/> YES	<input checked="" type="checkbox"/> NO
Will you have a security plan? If, yes please attach.	<input checked="" type="checkbox"/> YES	<input type="checkbox"/> NO
Will security plan be implemented?	<input checked="" type="checkbox"/> YES	<input type="checkbox"/> NO
Will State certified security personnel be used?	<input checked="" type="checkbox"/> YES	<input type="checkbox"/> NO
Will New York Nightlife Association and NYPD Best Practices be followed?	<input checked="" type="checkbox"/> YES	<input type="checkbox"/> NO
Will applicant be using delivery bicycles? If yes, how many?	<input type="checkbox"/> YES	<input checked="" type="checkbox"/> NO
Will delivery bicycles be clearly marked with the name of the restaurant and will staff wear attire clearly noting name as described by NYC Law?	<input type="checkbox"/> YES	<input checked="" type="checkbox"/> NO
Where will delivery bicycles be stored during the day when not in use?	n/a	

LOCATION & ZONING			
Is this a Special District? If yes, is it Clinton, West Chelsea or Hudson Yards?	<input checked="" type="radio"/> YES	NO	Clinton
Does the building have a Certificate of Occupancy ("C of O") or a letter of no objection?	<input checked="" type="radio"/> YES	NO	
Is a Public Assembly permit required?	<input checked="" type="radio"/> YES	NO	
Are your plans filed with DOB?	<input checked="" type="radio"/> YES	NO	

Community Notification/Relations			
<b>NOTIFICATION:</b> List all block associations; tenant associations, co-op boards or condo boards of residential buildings; and community groups that applicant has notified regarding its application. For each please list both the organization and individual you contacted	# 1	See list attached	
	# 2		
	# 3		
	# 4		
	# 5		
Please provide dates when applicant met with the groups listed above.	Email sent to all 6/29/2018		
Who was your contact person at each group you met with?	Contacts as per CB4 list		
When did applicant post the notice that was provided?	6/26/2018		
Where did applicant post the notice that was provided?	On doors on 46th Street side of property		
Will applicant provide owner cell phone number to neighbors and respond to complaints that arise? Please provide number in space provided.	<input checked="" type="radio"/> YES	NO	305-310-5103
Will applicant inform the Community Board office of its job openings and/or provide a hyperlink to applicants jobs webpage?	<input checked="" type="radio"/> YES	NO	

<b>BUILDING DESIGN</b>			
State the name and type of business previously located in the space.	Hotel with restaurant - no change, application is for an alteration		
Has a liquor-licensed establishment previously occupied this space at any time? If yes, please provide the name of the business.	<input checked="" type="radio"/> YES	<input type="radio"/> NO	Applicant is current licensee - RIU Plaza New York Times Square Hotel
Do you plan any changes to the existing façade? If yes, please describe.	YES	<input checked="" type="radio"/> NO	
Will applicant have a vestibule within the establishment?	<input checked="" type="radio"/> YES	<input type="radio"/> NO	In The Theatre Buffet restaurant space on 8th Avenue
Will applicant use a storm enclosure?	YES	<input checked="" type="radio"/> NO	
Will applicant not place any items or obstructions on the sidewalk, for example, sandwich boards, sidewalk signs, freestanding menus and plants, as per the law?	YES	<input checked="" type="radio"/> NO	46th Street sidewalk area is within property line
Will applicant comply with the NYC noise code?	<input checked="" type="radio"/> YES	<input type="radio"/> NO	
Will the establishment have any of the following: (circle all that apply)	<b>FRENCH DOORS</b>	<b>GARAGE DOORS</b>	<b>WINDOWS THAT CAN BE OPENED</b>
Will applicant close all windows, French doors, garage doors when any music or amplified sound (including televisions) is played inside the establishment?	YES	<input type="radio"/> NO	n/a
Will applicant close all windows, French doors, garage doors by 11 PM Friday and Saturday and 10 PM on all other days even if no music or amplified sound is played inside the establishment?	YES	<input type="radio"/> NO	n/a
Has applicant obtained an acoustical report from a certified sound engineer to assess potential noise disturbance to the neighboring residents and buildings?	YES	<input checked="" type="radio"/> NO	Application is for an alteration to an existing licensed premises
Will applicant follow the recommendations of a certified sound engineer to mitigate potential noise disturbance to the neighboring residents and buildings, including placing speakers on the floor of the establishment?	YES	<input type="radio"/> NO	n/a - is an existing premises
Will the kitchen exhaust system extend to the roof?	YES	<input type="radio"/> NO	n/a - is an existing premises
Will the establishment have an illuminated sign?	<input checked="" type="radio"/> YES	<input type="radio"/> NO	
Will the establishment have a canopy extending over the sidewalk?	<input checked="" type="radio"/> YES	<input type="radio"/> NO	
Where will the air conditioner be located? What type is it?	n/a - is an existing premises		
When was the air conditioner installed?	2016		

OUTDOOR ITEMS - OTHER THEN SIDEWALK CAFÉ			
Has the applicant/owner(s) read MCB 4 Rear Yard Rooftop Policy?	<input checked="" type="radio"/> YES	<input type="radio"/> NO	
Will applicant use any outdoor spaces: rooftop, rear yard, patio, porch, balcony, pavilion, tents, deck or gazebo? If yes, which one(s)?	<input checked="" type="radio"/> YES	<input type="radio"/> NO	rear yard
Are the floorplans for the outdoor space(s) included?	<input type="radio"/> YES	<input checked="" type="radio"/> NO	n/a - was previously provided
Will applicant close and vacate the outdoor space(s) by 11PM on Friday & Saturday and 10 PM on all other days?	<input checked="" type="radio"/> YES	<input type="radio"/> NO	
Will the service and consumption of alcohol in any outdoor space only be via seated food service?	<input checked="" type="radio"/> YES	<input type="radio"/> NO	
Will applicant not allow standing space for patrons to drink or smoke in any outdoor space(s)?	<input checked="" type="radio"/> YES	<input type="radio"/> NO	
Will there be no amplified music, as per the law?	<input checked="" type="radio"/> YES	<input type="radio"/> NO	
If amplified sound is played inside the establishment, will windows and doors be closed?	<input checked="" type="radio"/> YES	<input type="radio"/> NO	Doors to the rear outdoor space are not propped open and are closed except when used for entering and exiting
Will applicant agree to post signs outside asking customers to respect the neighbors'?	<input checked="" type="radio"/> YES	<input type="radio"/> NO	
Will applicant agree to train staff to encourage a peaceful environment?	<input checked="" type="radio"/> YES	<input type="radio"/> NO	
Will applicant provide effective sound control (landscaping enclosure, soundproofing tenants apartments)	<input checked="" type="radio"/> YES	<input type="radio"/> NO	
Will there be a lighting plan that allows safe usage of the outdoor space without disrupting neighbors?	<input checked="" type="radio"/> YES	<input type="radio"/> NO	No outdoor light projects upward

**OUTDOOR ITEMS – SIDEWALK CAFÉ** \*\*Sidewalk space on 46th Street is within property line

Has the applicant/owner(s) read MCB4 Sidewalk Café Policy?	<input checked="" type="radio"/> YES	<input type="radio"/> NO	
Will applicant be applying for a sidewalk café now or in the future?	<input type="radio"/> YES	<input checked="" type="radio"/> NO	46th Street sidewalk space is within the property line of the hotel - sidewalk café permit is not required
Is applicant in this application seeking to include a sidewalk café in its liquor license?	<input type="radio"/> YES	<input checked="" type="radio"/> NO	*Sidewalk space, but it is within property line
If yes, has applicant submitted an application and plans to NYC Dept. of Consumer Affairs? Please attach application and plans.	<input type="radio"/> YES	<input type="radio"/> NO	n/a
Will applicant close and vacate the sidewalk café by 11 PM on Friday & Saturday and 10 PM on all other days?	<input type="radio"/> YES	<input checked="" type="radio"/> NO	
Will applicant be serving alcohol in the sidewalk café? If so, will you have waiter service?	<input checked="" type="radio"/> YES	<input type="radio"/> NO	
Will the café have a 3 ft. wide serving aisle running the entire length of the sidewalk café?	<input type="radio"/> YES	<input type="radio"/> NO	n/a
Will applicant mark the perimeter of the café on the sidewalk?	<input checked="" type="radio"/> YES	<input type="radio"/> NO	Intend to have stanchions or other barriers within property line to segregate the space
Will the service and consumption of alcohol in the sidewalk café only be via seated food service?	<input checked="" type="radio"/> YES	<input type="radio"/> NO	
Will the sidewalk café not provide standing space for drinking or smoking?	<input checked="" type="radio"/> YES	<input type="radio"/> NO	
Will applicant use any portable natural gas heaters? If so, do you have the requisite approvals from DOB & the Fire Department?	<input type="radio"/> YES	<input checked="" type="radio"/> NO	
Will applicant have a lighting plan that will allow safe usage of the outdoor space without disrupting neighbors?	<input checked="" type="radio"/> YES	<input type="radio"/> NO	
Will all furniture, plants and barricades be stored inside between the evening closing hours and the morning opening hours?	<input checked="" type="radio"/> YES	<input type="radio"/> NO	
Will all furniture be stored inside between December 21 <sup>st</sup> and March 21 <sup>st</sup> , and any other day when it rains or snows?	<input checked="" type="radio"/> YES	<input type="radio"/> NO	*will not be removed on days when it rains
Will applicant use umbrellas?	<input type="radio"/> YES	<input checked="" type="radio"/> NO	
If construction or construction protection has reduced the sidewalk width, will applicant always maintain an 8 foot clear path of sidewalk between the perimeter of the café and the closes obstruction including construction barricades?	<input type="radio"/> YES	<input type="radio"/> NO	n/a

**ADDITIONAL STIPULATIONS: (Office Use Only)**

- Outdoor tables & chairs on West 46th Street will be closed and vacated of patrons no later than 10 p.m. Sunday - Thursday, 11 p.m. Friday & Saturday
- There will be no outdoor speakers on West 46th Street or 8th Avenue
- All prior stipulations dated 1/20/17 and 8/11/15 remain in effect

***To the extent any additional stipulation on pages 7 and 8 of this application conflicts with any response on pages 1 – 6 of this application, the stipulations on pages 7 and 8 control.***



***To the extent any additional stipulation on pages 7 and 8 of this application conflicts with any response on pages 1 – 6 of this application, the stipulations on pages 7 and 8 control.***

Manhattan Community Board 4 (MCB4) recommends:  
 (MCB4's recommendation is based on a vote taken at its  
7/25/18 full board meeting, with 28 members voting in favor  
 of the recommendation, 1 members opposed, 0 members  
 abstaining and 0 present but not eligible)

Denial unless all stipulations agreed to by applicant/owner are part of the method of operation

Denial  Approval

**CB4 REPRESENTATIVES**

  
 Nelly Gonzalez  
 CB4 Assistant District Manager

  
 Frank Holozubiec  
 CB4 BLP Committee Co-Chair

  
 Yoni Bokser  
 CB4 BLP Committee Co-Chair

**APPLICANT AGREEMENT WITH THE COMMUNITY**

Applicant agrees to these stipulations as the basis for the community support of this application and acknowledges that all of these stipulations are essential prerequisites to the MCB4 recommendation regarding this application. Applicant agrees to have these stipulations incorporated in the method of operation of its liquor license. The stipulations in this application constitute the entire agreement between MCB4 and applicant and may only be altered in writing signed by MCB4 and applicant. These stipulations supersede any oral statements or representations in connection with this application.

<p><b>SIGN HERE</b> →</p>	<p>Martha M. Redo          (Attorney)          PRINT NAME OF APPLICANT</p>	<p>          SIGNATURE OF APPLICANT</p>	<p>2/29/18          DATE</p>
---------------------------	--	---	----------------------------------

  
 Katharina Doehler  
 General Manager  
 2/10/18

Rider to Community Board Questionnaire – Block Associations Notified

Hudson Yards Hell's Kitchen Alliance  
Bob Benfatto at [rjbenfatto@hyhkalliance.org](mailto:rjbenfatto@hyhkalliance.org)  
Patty Gouros at [pgouris@hyhkalliance.org](mailto:pgouris@hyhkalliance.org)

HKNA  
Kathleen Treat at [kathleentreat123@gmail.com](mailto:kathleentreat123@gmail.com)

West 36<sup>th</sup> Street  
Frank Strock at [mcgee79@aol.com](mailto:mcgee79@aol.com)

Checkpeds  
Christine Berthet at [cberthet@me.com](mailto:cberthet@me.com)

CHDC  
Joe Restuccia at [info@clintonhousing.org](mailto:info@clintonhousing.org); [jrestuccia2@clintonhousing.org](mailto:jrestuccia2@clintonhousing.org)  
Ryan Marcano at [rmarcano@clintonhousing.org](mailto:rmarcano@clintonhousing.org)

West 43<sup>rd</sup> Street  
Eduardo Zeiger at [eduardozeiger@compuserve.com](mailto:eduardozeiger@compuserve.com)

Manhattan Plaza T.A.  
Douglas Leland at [mpta@mptenants.com](mailto:mpta@mptenants.com)

West 44 Street Better Block Association  
Linda Ashley at [ashleyll@aol.com](mailto:ashleyll@aol.com)

West 44<sup>th</sup> Street  
Renee & Gordon Stanley at [twocatsltd@worldnet.att.net](mailto:twocatsltd@worldnet.att.net)  
Rudy Papiri at [Rudi\\_Papiri@timemagazine.com](mailto:Rudi_Papiri@timemagazine.com)

West 45<sup>th</sup> Street BA  
Tim Tanner at [tangotanner@gmail.com](mailto:tangotanner@gmail.com)  
David C. Stuart at [west45ba@gmail.com](mailto:west45ba@gmail.com)

West 45<sup>th</sup> Street  
Chana Widawski at [chanawid@gmail.com](mailto:chanawid@gmail.com)

West 46<sup>th</sup> Street Block Association  
Allison Tupper at [AllisonTupper@verizon.net](mailto:AllisonTupper@verizon.net)  
Steve Fanto at [stephenfanto@gmail.com](mailto:stephenfanto@gmail.com)

West 47<sup>th</sup>/48<sup>th</sup> Streets  
Elke Fears at [aefearshk@earthlink.net](mailto:aefearshk@earthlink.net)  
Larry Roberts at [larrymichaelroberts@gmail.com](mailto:larrymichaelroberts@gmail.com)  
Jim Bagues at [jamesbagues@gmail.com](mailto:jamesbagues@gmail.com)  
Chuck Vassallo at [chasmv@hotmail.com](mailto:chasmv@hotmail.com)  
Stefan Riedl at [chluderernyc@yahoo.com](mailto:chluderernyc@yahoo.com) (email undeliverable)

Nancy Roylance at [nancyroylance@ymail.com](mailto:nancyroylance@ymail.com)

Harborview Terrace T.A.  
Maria Guzman at [mariagnys@aol.com](mailto:mariagnys@aol.com)

The Aurora  
Ellen Celnik at [ecelnik@actorsfund.org](mailto:ecelnik@actorsfund.org)  
Richard Pimentel at [rpimentel@commonground.org](mailto:rpimentel@commonground.org)  
Derrick Sage at [dsage@commonground.org](mailto:dsage@commonground.org)

The Colonade  
Marjorie Kagen at [buzany@rcn.com](mailto:buzany@rcn.com) (email undeliverable)

Oasis Gardens  
Nancy Kyriacou at [nkyriacou@yahoo.com](mailto:nkyriacou@yahoo.com)  
Gary Dipasquale at [gdclay@att.net](mailto:gdclay@att.net)

Midtown North Pct. Council  
J.D. Noland at [jeandaniel@aol.com](mailto:jeandaniel@aol.com)

Midtown North/South Pct. Council  
John Mudd at [john.mudd@usa.net](mailto:john.mudd@usa.net) (email response that location is near their borders)  
William Otterson at [bill@midtownsouthcc.org](mailto:bill@midtownsouthcc.org)

Housing Conservation Coordinators (212-541-5996)  
[info@hcc-ny.org](mailto:info@hcc-ny.org) (email undeliverable)

300 West 55<sup>th</sup> St  
Paul Loeb at [ploeb315@aol.com](mailto:ploeb315@aol.com)

West 55<sup>th</sup> Block Association  
Christine Gorman at [west55ba@gmail.com](mailto:west55ba@gmail.com)

50/51<sup>st</sup> Street Block Association  
Steve Belida and Jeff Robins at [hk5051@gmail.com](mailto:hk5051@gmail.com)

Hudson Hotel Residents  
Raul Larios at [rrlarios@hotmail.com](mailto:rrlarios@hotmail.com)

Westmore 333 W 57  
Amanda Cernitz at [acernitz@gmail.com](mailto:acernitz@gmail.com)

Parc Vendome 333 W 57  
Anita McDonagh at [awm3333@me.com](mailto:awm3333@me.com)

Colonnade 347 W 57<sup>th</sup> Street  
Jesse Bondy at [jessbondy@aol.com](mailto:jessbondy@aol.com)

500-506 West 42<sup>nd</sup> Street T.A. (Brian Kehoe) – no contact information provided  
Flats Tenants Association (Karen Nightengale) – no contact information provided



**RIU PLAZA NEW YORK**  
 NEW YORK, NEW YORK 10028

**RIU HOTELS & RESORTS**  
 300 AVENUE OF THE AMERICAS  
 NEW YORK, NY 10013  
 P: 212 852 4400

**DEVELOPER SERVICES**  
**TREBACH HOLDINGS, LLC**  
 100 WEST 47TH STREET  
 NEW YORK, NY 10019  
 P: 212 852 4400

**ARCHITECT**  
**BERG & FLYNN ARCHITECTURE PC**  
 100 WEST 47TH STREET, 10F  
 NEW YORK, NY 10019  
 P: 212 852 4400

**STRUCTURAL ENGINEERS**  
**DESMOND CONSULTING ENGINEERS**  
 18 WEST 47TH ST.  
 NEW YORK, NY 10019  
 P: 212 852 4400

**MECHANICAL ENGINEERS**  
**TWIG CONSULTING ENGINEERS, PC**  
 100 WEST 47TH STREET, 10F  
 NEW YORK, NY 10019  
 P: 212 852 4400

**ELEVATION CONSULTANTS**  
**VDA (VAN DELSEN & ASSOCIATES)**  
 100 WEST 47TH STREET, 10F  
 NEW YORK, NY 10019  
 P: 212 852 4400

**MECHANICAL CONTRACTORS**  
**OLSON MURRAY STEINER LLP**  
 100 WEST 47TH STREET, 10F  
 NEW YORK, NY 10019  
 P: 212 852 4400

**ACoustIC CONSULTANTS**  
**ACoustIC CONSULTANTS**  
 100 WEST 47TH STREET, 10F  
 NEW YORK, NY 10019  
 P: 212 852 4400

**ACCESSIBILITY SERVICES**  
**UNITED SPINAL ASSOCIATION**  
 200 WEST 47TH STREET, 10F  
 NEW YORK, NY 10019  
 P: 212 852 4400

**PERMITS FOR CONSTRUCTION**  
 PERMIT NO.

**ADDENDUM 1**  
 07/16/13

**ADDENDUM 2**  
 08/05/13

**ADDENDUM 3**  
 08/05/13

**ADDENDUM 4**  
 08/05/13

**ADDENDUM 5**  
 08/05/13

**ADDENDUM 6**  
 08/05/13

**ADDENDUM 7**  
 08/05/13

**ADDENDUM 8**  
 08/05/13

**ADDENDUM 9**  
 08/05/13

**ADDENDUM 10**  
 08/05/13

**ADDENDUM 11**  
 08/05/13

**ADDENDUM 12**  
 08/05/13

**ADDENDUM 13**  
 08/05/13

**ADDENDUM 14**  
 08/05/13

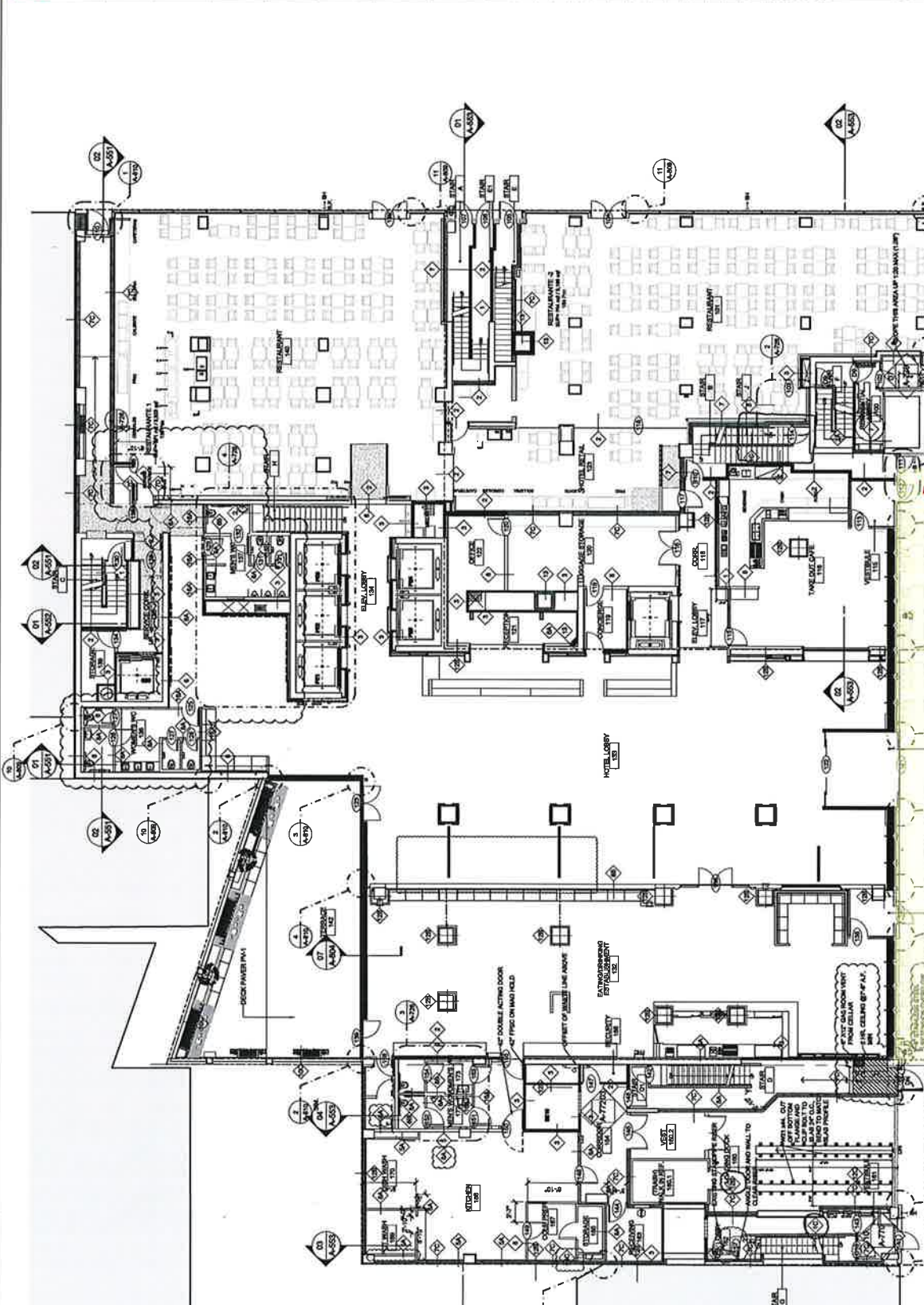

18 tables/36 seats to be included in licensed premises

**GROUND FLOOR PLAN**

DRAWING NO. **A-101.00**

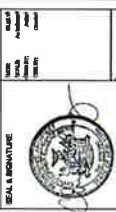

DATE	08/05/13
BY	BERG & FLYNN ARCHITECTURE PC
CHECKED BY	BERG & FLYNN ARCHITECTURE PC
SCALE	AS SHOWN



# TAPAS AT FASHION BAR

CHOOSE AND SHARE

**Deli meats platter, French baguette  
extra virgin olive oil 13.90**

*Tabla de embutidos ibericos, pan baguette  
aceite de oliva virgen extra 13.90*

--

**Cheese and deli meats platter , French baguette  
extra virgin olive oil 16.90**

*Tabla de embutidos ibericos con quesos, pan baguette  
aceite de oliva virgen extra 16.90*

--

**Spanish Omelette & French baguette 11.90**

*Tortilla Española con su pan baguette 11.90*

--

**Spicy Meatballs 11.90**

*Albondigas picantes 11.90*

--

**Chef's Sliders with French fries 11.90**

*Mini hamburguesas con patatas fritas 11.90*

--

**Garlic Shrimp 11.90**

*Gambas al ajillo 11.90*

--

**Tex-Mex Nachos 11.90**

--

**Beef empanadas, chipotle sauce 11.90**

*Empanadas de res, salsa de chipotle 11.90*

--

**The Croquettes served, alioli and tomato sauce 11.90**

**(your choice of serrano ham or chicken)**

*Las croquetas, salsa de alioli y tomate 11.90*

*( Su eleccion de jamon serrano o pollo )*

--

**Chicken Wings**

**buffalo and blue cheese sauce 11.90**

*Alitas de pollo*

*salsa "buffalo" y salsa de queso azul 11.90*

*Tax and service not included*

*"Consuming raw or undercooked meats  
poultry, seafood, shellfish, or eggs may increase  
your risk of foodborne illness"*





## COLD DISHES

MONDAY	Tuesday	Wednesday	Thursday	Friday	Saturday	Sunday
<p>CRUDITÉS</p> <p>Lettuce Mix of lettuce Sliced tomatoes Grated carrot Sliced cucumber Onion in julienne strips Corn grain Endives Watercress Cooked chickpeas</p> <p>SMALL SIDES</p> <p>Fried bread croutons Ham in cubes Cheese in cubes with oil Chopped boiled egg Butter Lemon slices</p> <p>COLD SAUCE</p> <p>Vinaigrette sauce Yogurt with herbs Caesar dressing Ketchup-Moutard-Mayonnaise Oil and vinegar</p> <p>SALADS</p> <p>Mediterranean with rice-tuna-roasted vegetables Cherry tomatoes with mozzarella and pesto</p> <p>2 miniaturas diarias COLD DISHES</p>	<p>CRUDITÉS</p> <p>Lettuce Mix of lettuce Sliced tomatoes Seasoned carrots Sliced cucumber Onion in julienne strips Palmitos Endives Watercress Radishes</p> <p>SMALL SIDES</p> <p>Fried bread croutons Ham in cubes Cheese in cubes with oil Chopped boiled egg Butter Lemon slices</p> <p>COLD SAUCE</p> <p>Vinaigrette sauce Yogurt with herbs Caesar dressing Ketchup-Moutard-Mayonnaise Oil and vinegar</p> <p>SALADS</p> <p>Cucumber, tomato, feta cheese, olives Caesar Salad with con grilled chicken</p> <p>2 miniaturas diarias COLD DISHES</p>	<p>CRUDITÉS</p> <p>Lettuce Mix of lettuce Sliced tomatoes Grated carrot Sliced cucumber Onion in julienne strips Corn grain Endives Watercress Cooked chickpeas</p> <p>SMALL SIDES</p> <p>Fried bread croutons Chicken breast in cubes Cheese in cubes with oil Chopped boiled egg Butter Lemon slices</p> <p>COLD SAUCE</p> <p>Vinaigrette sauce Yogurt with herbs Caesar dressing Ketchup-Moutard-Mayonnaise Oil and vinegar</p> <p>SALADS</p> <p>Italian with pasta and turkey German salad</p> <p>2 miniaturas diarias COLD DISHES</p>	<p>CRUDITÉS</p> <p>Lettuce Mix of lettuce Sliced tomatoes Seasoned carrots Sliced cucumber Onion in julienne strips Palmitos Endives Watercress Radishes</p> <p>SMALL SIDES</p> <p>Fried bread croutons Ham in cubes Cheese in cubes with oil Chopped boiled egg Butter Lemon slices</p> <p>COLD SAUCE</p> <p>Vinaigrette sauce Yogurt with herbs Caesar dressing Ketchup-Moutard-Mayonnaise Oil and vinegar</p> <p>SALADS</p> <p>Russian salad with tuna Waldorf salad</p> <p>2 miniaturas diarias COLD DISHES</p>	<p>CRUDITÉS</p> <p>Lettuce Mix of lettuce Sliced tomatoes Grated carrot Sliced cucumber Onion in julienne strips Palmitos Endives Watercress Cooked chickpeas</p> <p>SMALL SIDES</p> <p>Fried bread croutons Chicken breast in cubes Cheese in cubes with oil Chopped boiled egg Butter Lemon slices</p> <p>COLD SAUCE</p> <p>Vinaigrette sauce Yogurt with herbs Caesar dressing Ketchup-Moutard-Mayonnaise Oil and vinegar</p> <p>SALADS</p> <p>Turkey salad with avocado Coleslaw</p> <p>2 miniaturas diarias COLD DISHES</p>	<p>CRUDITÉS</p> <p>Lettuce Mix of lettuce Sliced tomatoes Seasoned carrots Sliced cucumber Onion in julienne strips Palmitos Endives Watercress Radishes</p> <p>SMALL SIDES</p> <p>Fried bread croutons Ham in cubes Cheese in cubes with oil Chopped boiled egg Butter Lemon slices</p> <p>COLD SAUCE</p> <p>Vinaigrette sauce Yogurt with herbs Caesar dressing Ketchup-Moutard-Mayonnaise Oil and vinegar</p> <p>SALADS</p> <p>Cobb Salad Beef salad Thai style</p> <p>2 miniaturas diarias COLD DISHES</p>	<p>CRUDITÉS</p> <p>Lettuce Mix of lettuce Sliced tomatoes Grated carrot Sliced cucumber Onion in julienne strips Corn grain Endives Watercress Cooked chickpeas</p> <p>SMALL SIDES</p> <p>Fried bread croutons Chicken breast in cubes Cheese in cubes with oil Chopped boiled egg Butter Lemon slices</p> <p>COLD SAUCE</p> <p>Vinaigrette sauce Yogurt with herbs Caesar dressing Ketchup-Moutard-Mayonnaise Oil and vinegar</p> <p>SALADS</p> <p>Pasta salad with prosciutto Spinach salad with guacamole and mango</p> <p>2 miniaturas diarias COLD DISHES</p>
<p>CRUDITÉS</p> <p>Lettuce Mix of lettuce Sliced tomatoes Grated carrot Sliced cucumber Onion in julienne strips Corn grain Endives Watercress Cooked chickpeas</p> <p>SMALL SIDES</p> <p>Fried bread croutons Ham in cubes Cheese in cubes with oil Chopped boiled egg Butter Lemon slices</p> <p>COLD SAUCE</p> <p>Vinaigrette sauce Yogurt with herbs Caesar dressing Ketchup-Moutard-Mayonnaise Oil and vinegar</p> <p>SALADS</p> <p>Hearts of Palm Stuffed eggs with blue cheese Mussels with vinaigrette</p>	<p>CRUDITÉS</p> <p>Lettuce Mix of lettuce Sliced tomatoes Seasoned carrots Sliced cucumber Onion in julienne strips Palmitos Endives Watercress Radishes</p> <p>SMALL SIDES</p> <p>Fried bread croutons Ham in cubes Cheese in cubes with oil Chopped boiled egg Butter Lemon slices</p> <p>COLD SAUCE</p> <p>Vinaigrette sauce Yogurt with herbs Caesar dressing Ketchup-Moutard-Mayonnaise Oil and vinegar</p> <p>SALADS</p> <p>Rosolbeef with gooseberry sauce Grilled green asparagus Marinated Salmon</p>	<p>CRUDITÉS</p> <p>Lettuce Mix of lettuce Sliced tomatoes Grated carrot Sliced cucumber Onion in julienne strips Palmitos Endives Watercress Radishes</p> <p>SMALL SIDES</p> <p>Fried bread croutons Ham in cubes Cheese in cubes with oil Chopped boiled egg Butter Lemon slices</p> <p>COLD SAUCE</p> <p>Vinaigrette sauce Yogurt with herbs Caesar dressing Ketchup-Moutard-Mayonnaise Oil and vinegar</p> <p>SALADS</p> <p>Somked Turkey Breast Hummus with pita bread Mussels with vinaigrette</p>	<p>CRUDITÉS</p> <p>Lettuce Mix of lettuce Sliced tomatoes Seasoned carrots Sliced cucumber Onion in julienne strips Palmitos Endives Watercress Radishes</p> <p>SMALL SIDES</p> <p>Fried bread croutons Ham in cubes Cheese in cubes with oil Chopped boiled egg Butter Lemon slices</p> <p>COLD SAUCE</p> <p>Vinaigrette sauce Yogurt with herbs Caesar dressing Ketchup-Moutard-Mayonnaise Oil and vinegar</p> <p>SALADS</p> <p>Escabeche Chicken breast Stuffed eggs with tuna Octopus salpicón</p>	<p>CRUDITÉS</p> <p>Lettuce Mix of lettuce Sliced tomatoes Grated carrot Sliced cucumber Onion in julienne strips Palmitos Endives Watercress Cooked chickpeas</p> <p>SMALL SIDES</p> <p>Fried bread croutons Chicken breast in cubes Cheese in cubes with oil Chopped boiled egg Butter Lemon slices</p> <p>COLD SAUCE</p> <p>Vinaigrette sauce Yogurt with herbs Caesar dressing Ketchup-Moutard-Mayonnaise Oil and vinegar</p> <p>SALADS</p> <p>2 miniaturas diarias COLD DISHES</p>	<p>CRUDITÉS</p> <p>Lettuce Mix of lettuce Sliced tomatoes Seasoned carrots Sliced cucumber Onion in julienne strips Palmitos Endives Watercress Radishes</p> <p>SMALL SIDES</p> <p>Fried bread croutons Ham in cubes Cheese in cubes with oil Chopped boiled egg Butter Lemon slices</p> <p>COLD SAUCE</p> <p>Vinaigrette sauce Yogurt with herbs Caesar dressing Ketchup-Moutard-Mayonnaise Oil and vinegar</p> <p>SALADS</p> <p>Tuna tataki Salmon cake Ham with cheese and herbs roll</p>	<p>CRUDITÉS</p> <p>Lettuce Mix of lettuce Sliced tomatoes Grated carrot Sliced cucumber Onion in julienne strips Corn grain Endives Watercress Cooked chickpeas</p> <p>SMALL SIDES</p> <p>Fried bread croutons Chicken breast in cubes Cheese in cubes with oil Chopped boiled egg Butter Lemon slices</p> <p>COLD SAUCE</p> <p>Vinaigrette sauce Yogurt with herbs Caesar dressing Ketchup-Moutard-Mayonnaise Oil and vinegar</p> <p>SALADS</p> <p>2 miniaturas diarias COLD DISHES</p>

## DINER



## HOT DISHES

rec.	de 1/2 GIN	MONDAY	Tuesday	Wednesday	Thursday	Friday	Saturday	Sunday
		PASTA	PASTA	PASTA	PASTA	PASTA	PASTA	PASTA
1		SPAGHETTI BOLOGNESE	SPAGHETTI BOLOGNESE	SPAGHETTI BOLOGNESE	SPAGHETTI BOLOGNESE	SPAGHETTI BOLOGNESE	SPAGHETTI BOLOGNESE	SPAGHETTI BOLOGNESE
2		PENNE ARRABIATTA	FETUCCINI ALFREDO	GNOCCHI ALLA PUTANESCA	CREAM TORTELLINI	PENNE AL PESTO WITH ARUGULA AND PARMESANO CHEESE	GNOCCHI WITH PRANNS AND SPARAGUS	PAPARDELLE WITH BEEFS, TOMATOES AND SPINACH
		MEAT	MEAT	MEAT	MEAT	MEAT	MEAT	MEAT
3		CAJUN CHICKEN BREAST	THAI RED CURRY CHICKEN	CHICKEN BREAST IN BREADCRUMBS	BUFFALO CHICKEN WINGS	CHEESE BURGER	CHICKEN AL MARGALA	VEAL GOULASH
4		HOME STYLE MEATBALLS	CORDON BLEU	CHEESE BURGER	CHICKEN AND BEEF FAJITAS	SALTIMBOCCA NAPOLITANA	HOME STYLE MEATBALLS	SWEET AND SOUR PORK
		TRINICHE	CARVE	CARVE	CARVE	CARVE	CARVE	CARVE
		PORK RIB	RIB EYE	BAKED FISH	GRILLED ROASTED PORK	BAKED CHICKEN	BAKED FISH	ROASTED ROSEMARY CHICKEN
		FISH	FISH	FISH	FISH	FISH	FISH	FISH
5		GRILLED MAHI MAHI	TILAPIA BREADED FILLET	TUNA LOIN WITH TOMATO	FRIED COD FISH & CHIPS STYLE	MELNIER FISH FILLET	GRILLED RED SNAPPER	FISH BREADED FILLET
		SIDES	SIDES	SIDES	SIDES	SIDES	SIDES	SIDES
6 y 7		MORO RICE AND BEANS	PILAF RICE	YELLOW RICE WITH VEGETABLES	YAKIMESHI FRIED RICE	SAUTEED RICE WITH NUTS	PILAF RICE	YELLOW RICE WITH VEGETABLES
8		STEAMED BROCCOLI	SAUTEED GREEN BEANS	SAUTEED MIXED VEGETABLES	CARROTS WITH BUTTER	GREEN BEANS SAUTEED WITH ONION	GREEN PEAS FRENCH STYLE	FRIED YUCA
9 y 10		MASHED CAMOTE	SAUTEED CHERRY TOMATO WITH BASIL	MASHED POTATO	MASHED PUMPKIN	SWEET POTATO FRIES	GRATINATED MASH POTATO	MASHED PUMPKIN
11		BAKED POTATO	POTATO A LA INGLESA	SAUTEED POTATOES WITH PARSLEY	PANADERA POTATOES	SAUTEED TOMATOES WITH OREGANO	SAUTEED POTATOES WITH PARSLEY	PANADERA POTATOES
12		SAUTEED ONION & MUSHROOMS	ONION RINGS	ARGENTINIAN EMPANADAS	CHICKEN CROQUETTES	SPRING ROLLS WITH SWEET AND SOUR SAUCE	STUFFED JALAPEÑOS	JAM CROQUETTES
		VEGETARIAN	VEGETARIAN	VEGETARIAN	VEGETARIAN	VEGETARIAN	VEGETARIAN	VEGETARIAN
13		VEGETARIAN LASAGNA	WHITE BEANS	STEWED CHICKPEAS	GRATIN ZUCCHINI WITH TOMATO SAUCE	SPINACH AND RICOTTA CANNELLONI	STEWED LENTILS	FRJOLLES
14		FRIED PLANTAIN	SAUTEED ONION & MUSHROOMS & SPINACH	GRILLED ZUCCHINI	GRILLED ASPARAGUS	TOMATES GRILL	PEPPERS TRIO	GRILLED ZUCCHINI
		SOUP	SOUP	SOUP	SOUP	SOUP	SOUP	SOUP
		SANCOCHO DOMINICAN	MINISTRONE	TORTILLA SOUP	POTATO AND LEEK CREAMY SOUP	BEEF SOUP	CHICKEN SOUP WITH VEGETABLES	VEGETABLE SOUP

<b><u>COLD CUTS</u></b>
COOKED HAM
TURKEY BREAST
AMERICAN CHEES
<b><u>PASTRIES</u></b>
CROISSANT
VARIED DANISH
<b><u>BREAD</u></b>
SLICED BREAD
SLICED INTEGRAL BREAD
<b><u>COMPLEMENTS</u></b>
BUTTER (PORTIONS)
MARGARINE (PORTIONS)
FOUR TYPES INDIVIDUAL NORMAL
HONEY
<b><u>NATURAL SLICED FRUIT</u></b>
FRUIT SALAD
<b><u>COFFEE &amp; TEA</u></b>
COFFEE, MILK, TEA, CHOCOLATE,
<b><u>JUICE</u></b>
TWO TYPES

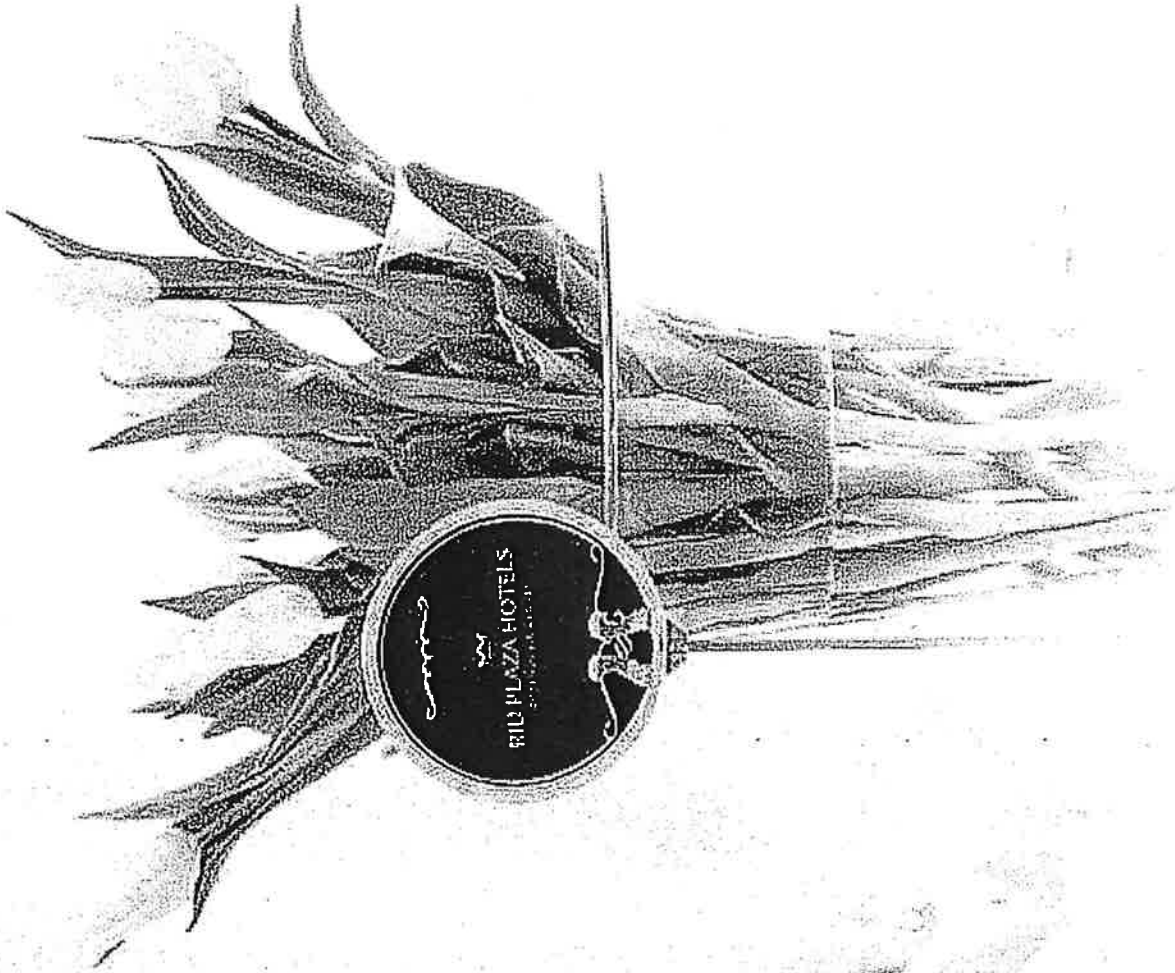

  
HOTEL RIU PLAZA  
NEW YORK TIMES SQUARE  
RIU Hotels & Resorts

# MENUS FOR CORPORATE EVENTS 2016

# BREAKFASTS

## CONTINENTAL BREAKFAST \$ 24.00

Orange and apple juice  
 Seasonal fruit salad  
 Yogurt  
 Selection of pastries  
 Butter and homemade jams  
 Selection of teas, coffee, and milk

## COLD BREAKFAST EXTRAS

Chocolate Cookies \$ 3.00  
 Donuts \$ 3.00  
 Selection of organic yogurts \$ 3.00  
 Cold cuts and cheese board \$ 7.00  
 New York Bagels with cream cheese \$ 3.00  
 New York bagels with cream cheese and smoked salmon \$ 7.00

Minimum 15 people  
 If less than 15 people, a flat rate of \$150 will be charged  
 Price per person for 1 hour. Additional hour, \$5/person

Prices per person

A 9% tax and 21% gratuity will be added to the check.

## HOT BREAKFAST EXTRAS

Scrambled or fried eggs \$ 5.00  
 Crispy bacon \$ 5.00  
 Pork sausage \$ 5.00

(All served with sautéed potatoes with scallions)

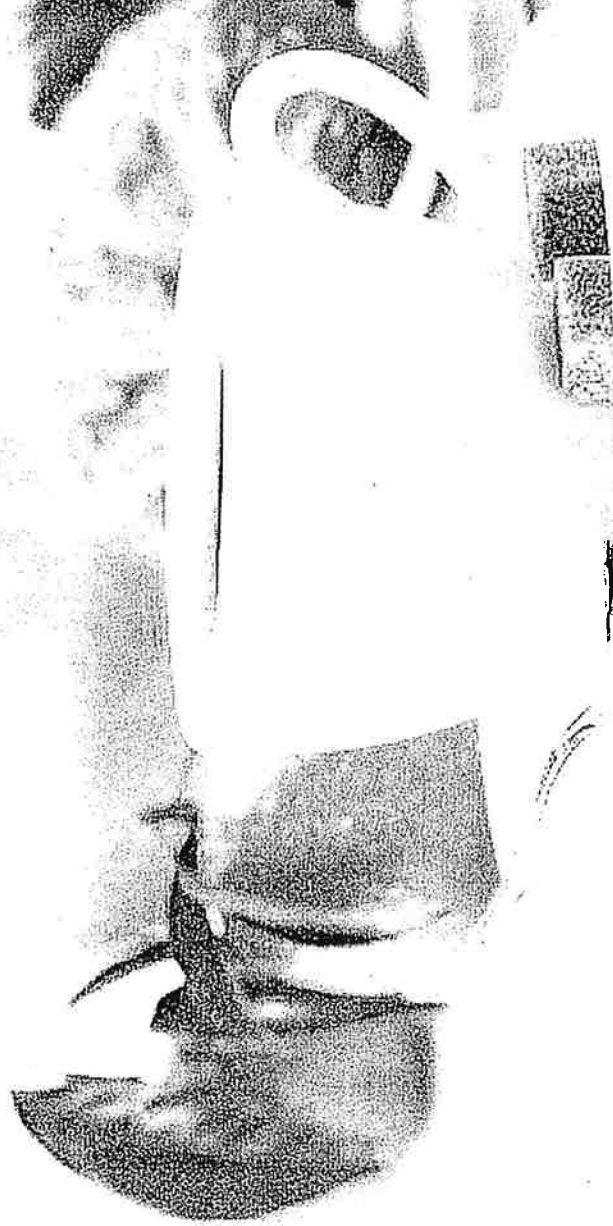
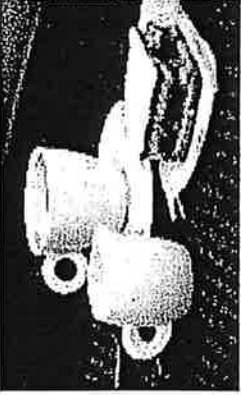

HOTEL RIU PLAZA  
 NEW YORK TIMES SQUARE  
 RIU Hotels & Resorts



# COFFEE BREAK

## COFFEE BREAK 1 \$ 18

Selection of teas, coffee, and milk  
Soft drinks and mineral water  
Orange juice  
Selection of pastries

## COFFEE BREAK 2 \$ 23

Selection of teas, coffee, and milk  
Soft drinks and mineral water  
Orange and apple juice  
Variety of mini sandwiches

## COFFEE BREAK AVAILABLE AT ALL TIMES INSIDE THE LOUNGE

### HALF DAY (4 HOURS), PER PERSON

Selection of teas, coffee, and milk \$ 14.00  
Fountain with water, juices, and soft drinks \$ 14.00

Minimum 15 people  
If less than 15 people, a flat rate of \$150 will be charged  
Price per person for 1 hour. Additional hour, \$5/person

A 9% tax and 21% gratuity will be added to the check.

## SNACKS FOR COFFEE BREAKS

Cereal bars	\$ 3.00
Organic yogurt with red berries	\$ 3.00
Blueberry muffins	\$ 3.00
Potato chips	\$ 4.00
Selection of dried fruits	\$ 5.00
Cinnamon raisin Danish	\$ 3.00
Donuts	\$ 3.00
Chocolate bars	\$ 3.00
Brownies	\$ 4.00
Carrot cake	\$ 4.00
Cheesecake	\$ 4.00
Variety of mini sandwiches (Ham, cheese, smoked salmon, tuna)	\$ 4.00

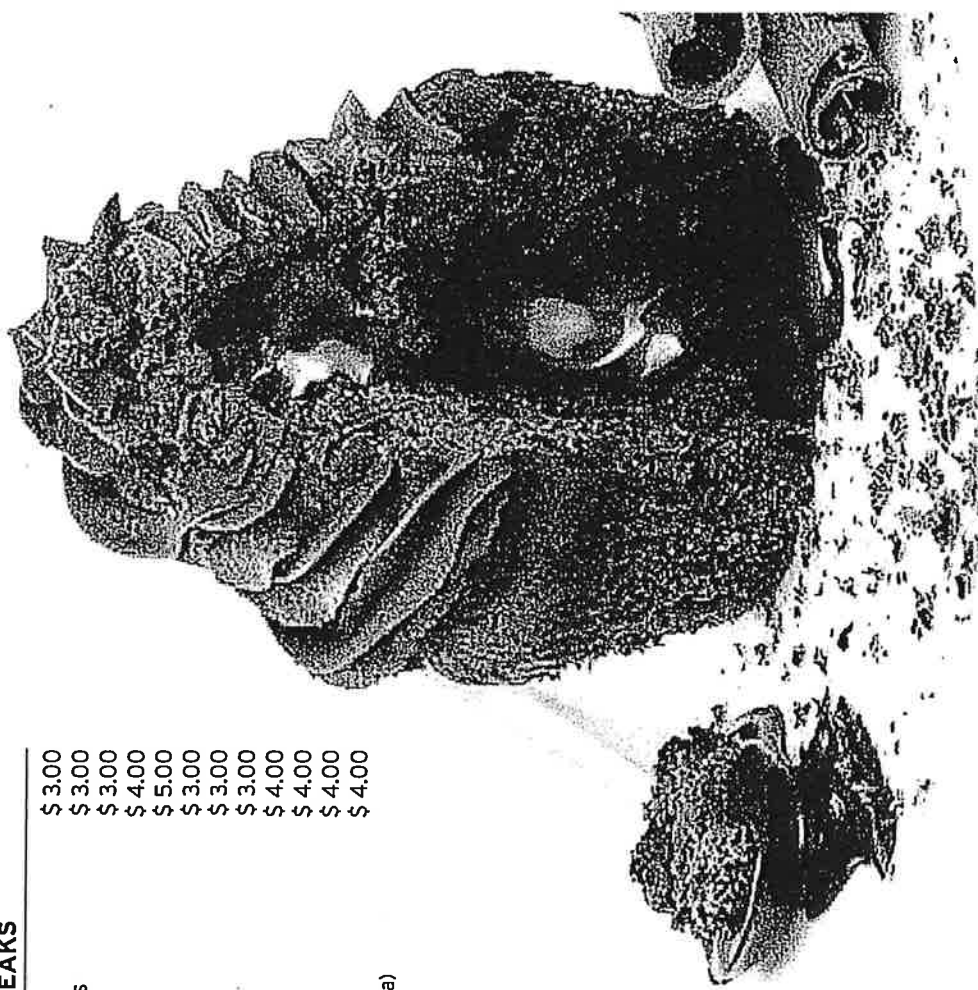

HOTEL RIU PLAZA  
NEW YORK TIMES SQUARE  
RIU Hotels & Resorts





# LUNCH MENU

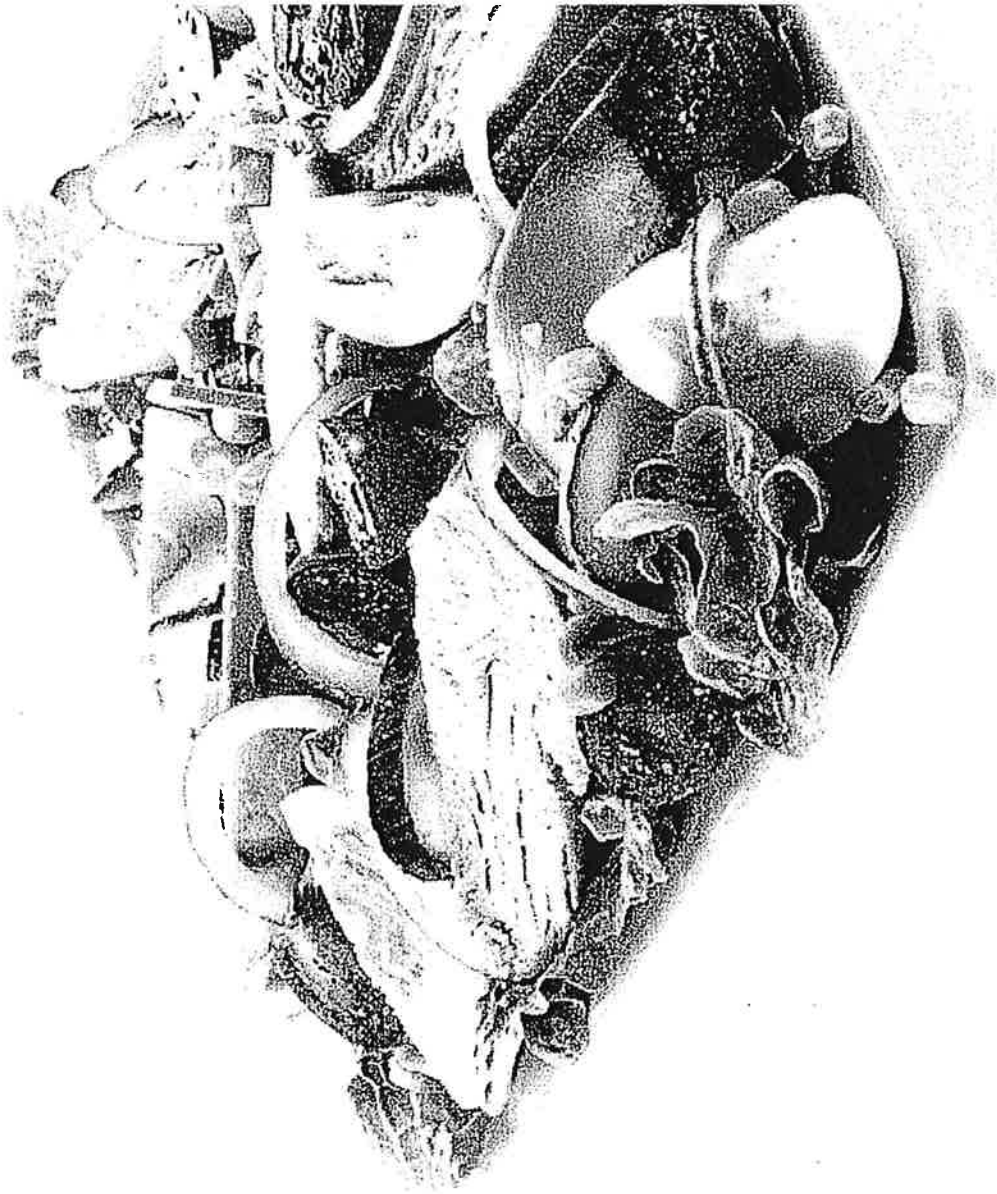

LUNCH MENU	PVP
Club sandwich Fruit salad	\$ 15,00
Soup of the day Hamburger 8 oz Chocolate cake	\$ 27,00
Caesar salad with chicken Lasagne bolognese Cheesecake	\$ 31,00
Caprese Salad Roasted chicken Brownie	\$ 33,00
Pasta salad Salmon supreme Fruit of the season	\$ 36,00

Prices per person

A 9% tax and 21% gratuity will be added to the check.



HOTEL RIU PLAZA  
NEW YORK TIMES SQUARE  
RIU Hotels & Resorts

# RECEPTION MENU

<b>HORS D'OEUVRES</b>	<b>PVP</b>
Assorted cold cuts (sausage, chicken, etc)	\$ 9.00
Assorted cheeses	\$ 12.00
Chicken nuggets	\$ 12.00

## **COCKTAIL** \$ 35.00

- Mango and strawberry tropical shooters
- Smoked salmon tapas ('montadito')
- Shrimp skewers with champagne sauce
- Chicken satay
- Serrano ham rolls
- Small beef fillets with blue-cheese sauce
- Spanish tortilla
- Assorted mini desserts

Prices per person

A 9% tax and 21% gratuity will be added to the check.



**HOTEL RIU PLAZA**  
**NEW YORK TIMES SQUARE**  
 RIU Hotels & Resorts



# DRINKS & OPEN BAR

SOFT DRINKS (Prices per unit)	P.V.P.
Sodas 10oz (coke, sprite, ginger ale, etc)	\$ 2.50
Perrier 16.90oz	\$ 7.00
S.Pellegrino 16oz	\$ 7.00
Saratoga water 28oz	\$ 12.00
Voss water 27.05oz	\$ 15.00
Voss Sparkling water 27.05oz	\$ 15.00
Natural juices 8oz	\$ 5.00

## OPEN BAR 1

**Beer:**  
Budweiser, Goose Island IPA, Shock Top

**Wine:**  
Woodbridge by Robert Mondavi - Chardonnay  
Woodbridge by Robert Mondavi - Cabernet Sauvignon

**Still and sparkling water and assorted soft drinks and juices**

## PRICES OPEN BAR 1

1 hour	\$ 28.00
2 hours	\$ 40.00
3 hours	\$ 52.00
Additional hour	\$ 13.00

Bartender Fee • \$ 275.00 each • Prices per person

A 9% tax and 21% gratuity will be added to the check.

## OPEN BAR 2

**Martini**  
Bacardi light rum  
Smirnoff vodka  
Gordon's gin  
Jose Cuervo Gold tequila  
Johnnie Walker Red Whisky

**Beer:**  
Budweiser, Goose Island IPA, Shock Top

**Wine:**  
Woodbridge by Robert Mondavi - Chardonnay  
Woodbridge by Robert Mondavi - Cabernet Sauvignon  
Freixenet Blanc de Blancs - Cava (sparkling wine)

**Still and sparkling water and assorted soft drinks and juices**

## PRICES OPEN BAR 2

1 hour	\$ 32.00
2 hours	\$ 44.00
3 hours	\$ 56.00
Additional hour	\$ 13.00

## OPEN BAR 3

**Martini**  
Bacardi light rum  
Bacardi 8 years rum  
Absolut vodka  
Smirnoff vodka  
Gordon's gin  
Tanqueray gin  
Herradura Blanco Tequila  
Jose Cuervo Gold Tequila  
Johnnie Walker Red Whisky  
Chivas 12 years

**Beer:**  
Budweiser, Goose Island IPA, Shock Top

**Wine:**  
Woodbridge by Robert Mondavi - Chardonnay  
Woodbridge by Robert Mondavi - Cabernet Sauvignon  
Freixenet Cordon Negro - Cava (sparkling wine)

**Still and sparkling water and assorted soft drinks and juices**

## PRICES OPEN BAR 3

1 hour	\$ 36.00
2 hours	\$ 48.00
3 hours	\$ 60.00
Additional hour	\$ 15.00



HOTEL RIU PLAZA  
NEW YORK TIMES SQUARE  
RIU Hotels & Resorts

# FASHION BAR RESTAURANT

World Soccer Cup  
SPECIAL OFFER  
To celebrate the  
2014 FIFA World Cup  
Champion Brazil  
• Beer - 14.95

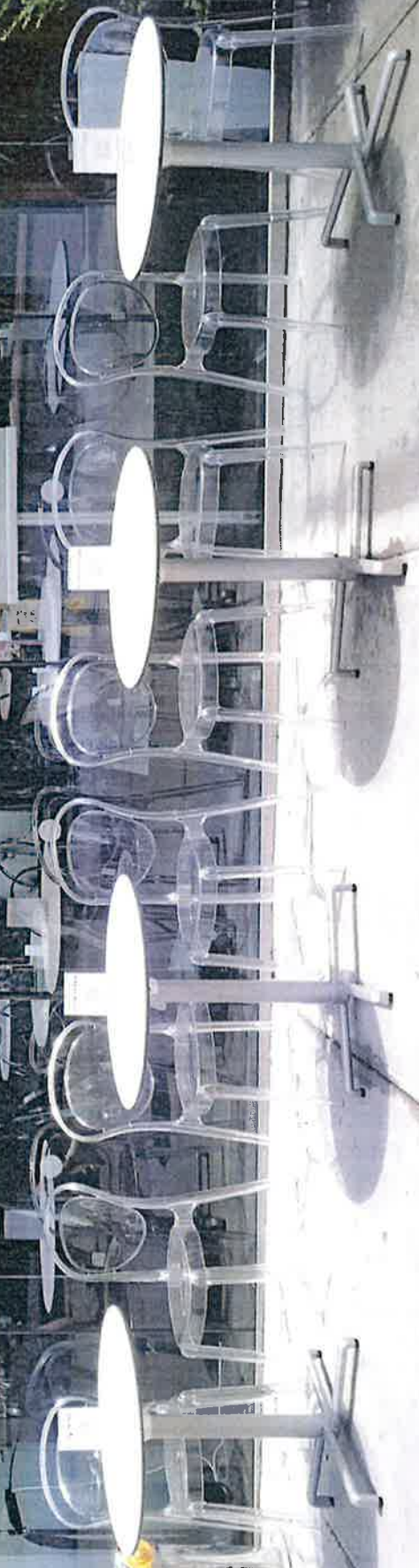



# FASHION BAR RESTAURANT

World's Largest Cup  
SPECIAL OFFER  
14.95

CAUTION  
WET FLOOR

CAUTION  
WET FLOOR





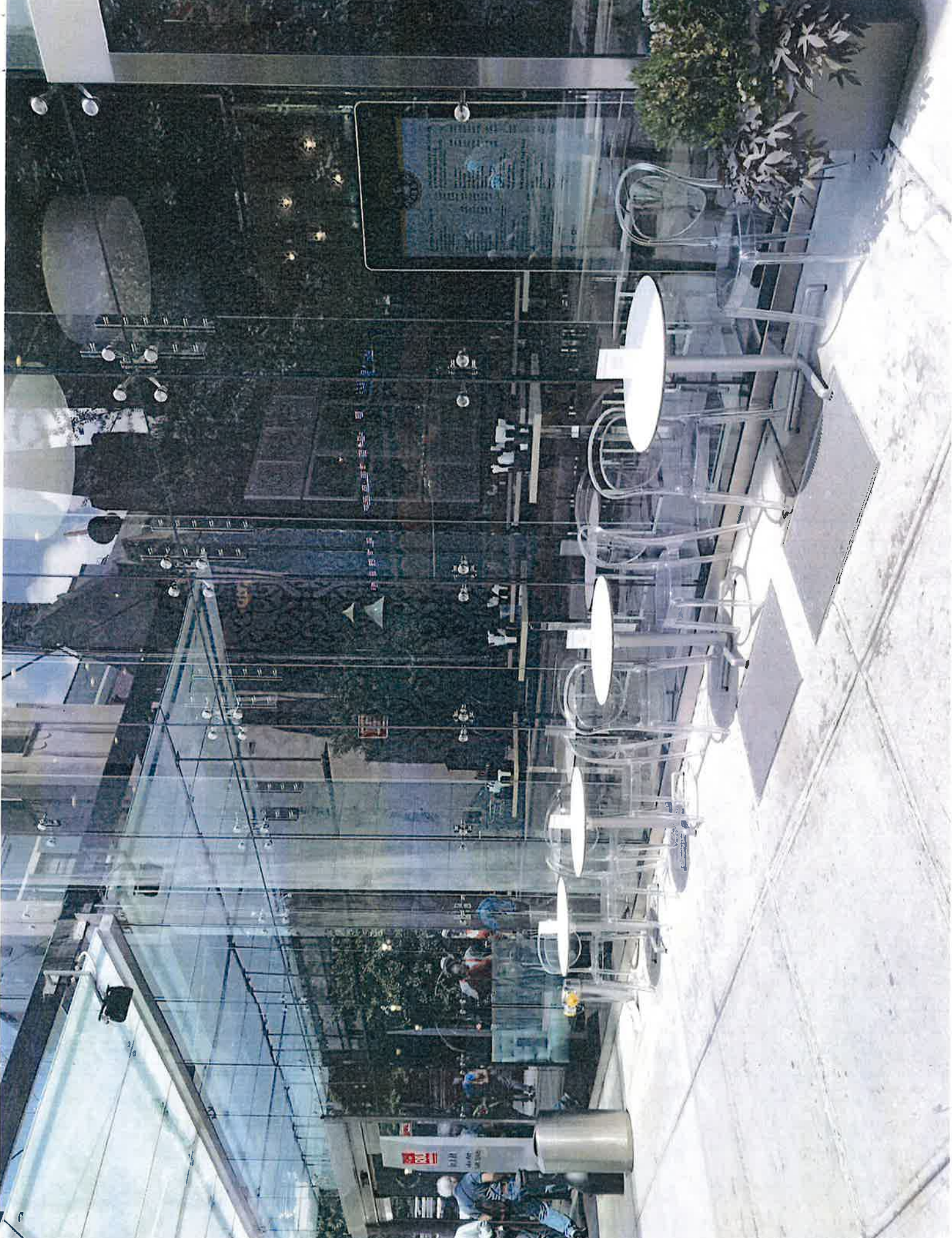



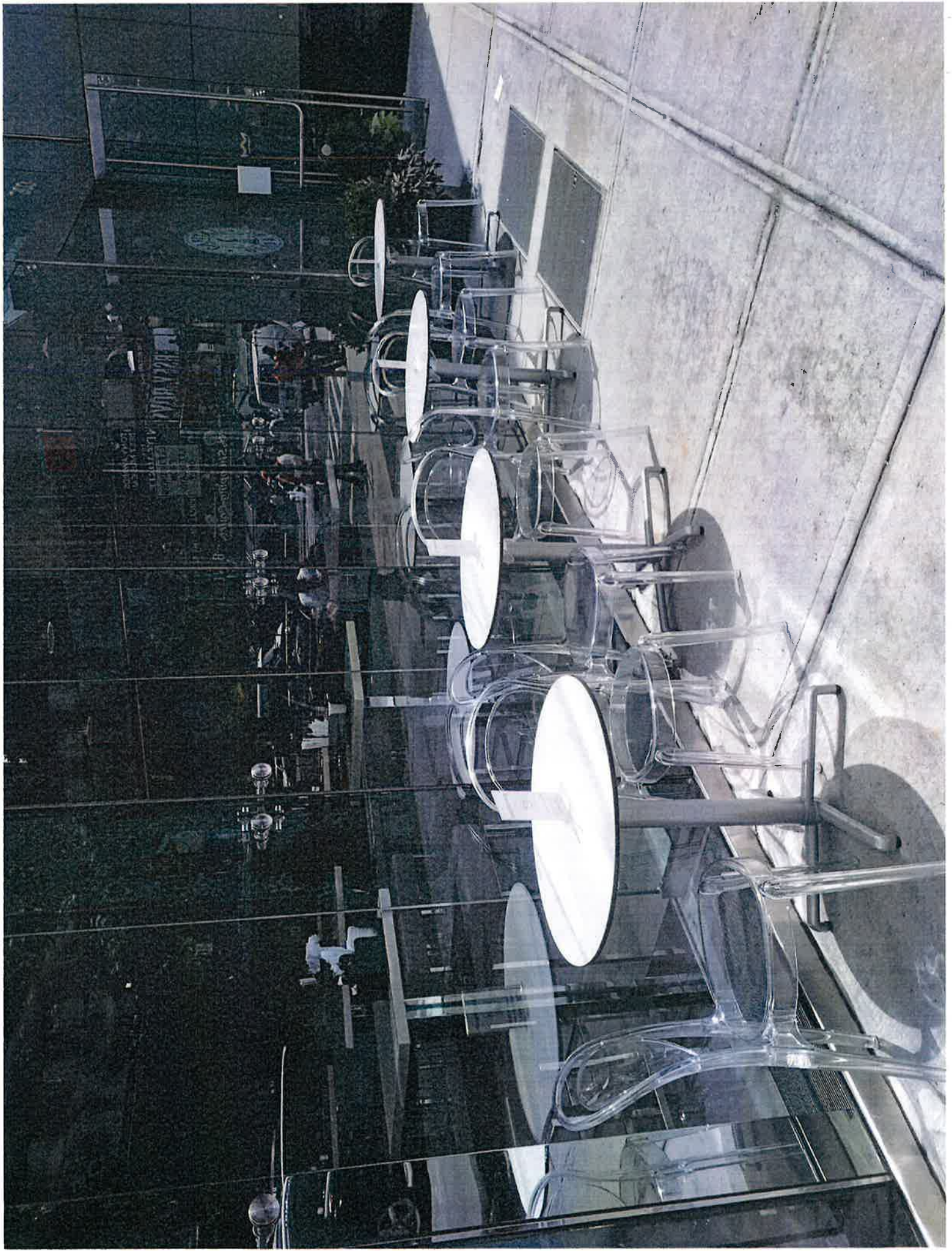

*Certificate of Occupancy*

**CO Number: 110095753T012**

This certifies that the premises described herein conforms substantially to the approved plans and specifications and to the requirements of all applicable laws, rules and regulations for the uses and occupancies specified. No change of use or occupancy shall be made unless a new Certificate of Occupancy is issued. *This document or a copy shall be available for inspection at the building at all reasonable times.*

<b>A. Borough:</b> Manhattan <b>Address:</b> 303 WEST 46 STREET <b>Building Identification Number (BIN):</b> 1089716	<b>Block Number:</b> 01037	<b>Certificate Type:</b> Temporary
	<b>Lot Number(s):</b> 29	<b>Effective Date:</b> 07/09/2018
		<b>Expiration Date:</b> 10/07/2018
	<b>Building Type:</b> New	

*For zoning lot metes & bounds, please see BISWeb.*

<b>B. Construction classification:</b>	1-C	(1968 Code)
<b>Building Occupancy Group classification:</b>	J-1	(1968 Code)
<b>Multiple Dwelling Law Classification:</b>	HAEB	
<b>No. of stories:</b> 29	<b>Height in feet:</b> 324	<b>No. of dwelling units:</b> 150

**C. Fire Protection Equipment:**  
None associated with this filing.

**D. Type and number of open spaces:**  
None associated with this filing.

**E. This Certificate is issued with the following legal limitations:**  
None

**Outstanding requirements for obtaining Final Certificate of Occupancy:**  
There are 12 outstanding requirements. Please refer to BISWeb for further detail.

**Borough Comments:** None



Borough Commissioner



Commissioner



# Certificate of Occupancy

CO Number: 110095753T012

## Permissible Use and Occupancy

All Building Code occupancy group designations are 1968 designations, except RES, COM, or PUB which are 1938 Building Code occupancy group designations.

Floor From To	Maximum persons permitted	Live load lbs per sq. ft.	Building Code occupancy group	Dwelling or Rooming Units	Zoning use group	Description of use
CEL	120	100	C J-1 B-2		5, 6	MECH & HOTEL ACCESSORY USES
MZ3		100	J-1		5	MECHANICAL ROOM. OPEN TO BELOW
001	100	100	C J-1		5, 6	LOBBY, TAKE OUT CAFE AND VESTIBULE, RESTAURANT SEATING AND SERVING AREA (NO COOKING), OUTDOOR SEATING
002	158	100	J-1		5	MECHANICAL FLOOR, OPEN TO BELOW
003		100	J-1		5	MECHANICAL FLOOR
004		100	J-1	1	5	ONE HOTEL SUITE, MECHANICAL ROOM (TENANT 5TH FLOOR)
005		100		2	5	TWO HOTEL SUITES/MECHANICAL ROOM (TENANT 6TH FLOOR)
006		100	J-1	2	5	TWO HOTEL SUITES/MECHANICAL ROOM (TENANT 7TH FLOOR)
007		100	J-1	7	5	SEVEN HOTEL ROOMS (TENANT 8TH FLOOR)
008		100	J-1	7	5	SEVEN HOTEL ROOMS (TENANT 9TH FLOOR)
009		100	J-1	7	5	SEVEN HOTEL ROOMS (TENANT 10TH FLOOR)
010		100	J-1	7	5	SEVEN HOTEL ROOMS (TENANT 11TH FLOOR)
011		100	J-1	7	5	SEVEN HOTEL ROOMS (TENANT 12TH FLOOR)



Borough Commissioner



Commissioner

DOCUMENT CONTINUES ON NEXT PAGE

# Certificate of Occupancy

CO Number: 110095753T012

## Permissible Use and Occupancy

All Building Code occupancy group designations are 1968 designations, except RES, COM, or PUB which are 1938 Building Code occupancy group designations.

Floor From To	Maximum persons permitted	Live load lbs per sq. ft.	Building Code occupancy group	Dwelling or Rooming Units	Zoning use group	Description of use
012		100	J-1	7	5	SEVEN HOTEL ROOMS (TENANT 14TH FLOOR)
013		100	J-1	7	5	SEVEN HOTEL ROOMS (TENANT 15TH FLOOR)
014		100	J-1	7	5	SEVEN HOTEL ROOMS (TENANT 16TH FLOOR)
015		100	J-1	7	5	SEVEN HOTEL ROOMS (TENANT 17TH FLOOR)
016		100	J-1	7	5	SEVEN HOTEL ROOMS (TENANT 18TH FLOOR)
017		100	J-1	7	5	SEVEN HOTEL ROOMS (TENANT 19TH FLOOR)
018		100	J-1	7	5	SEVEN HOTEL ROOMS (TENANT 20TH FLOOR)
019		100	J-1	7	5	SEVEN HOTEL ROOMS (TENANT 21TH FLOOR)
020		100	J-1	7	5	SEVEN HOTEL ROOMS (TENANT 22ND FLOOR)
021		100	J-1	7	5	SEVEN HOTEL ROOMS (TENANT 23RD FLOOR)
022		100	J-1	7	5	SEVEN HOTEL ROOMS (TENANT 24TH FLOOR)
023		100	J-1	7	5	SEVEN HOTEL ROOMS (TENANT 25TH FLOOR)
024		100	J-1	4	5	FOUR HOTEL ROOMS (TENANT 26TH FLOOR)

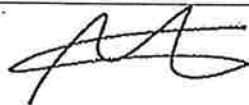

Borough Commissioner



Commissioner

DOCUMENT CONTINUES ON NEXT PAGE



*Certificate of Occupancy*

CO Number: 110095753T012

**Permissible Use and Occupancy**

All Building Code occupancy group designations are 1968 designations, except RES, COM, or PUB which are 1938 Building Code occupancy group designations.

Floor From To	Maximum persons permitted	Live load lbs per sq. ft.	Building Code occupancy group	Dwelling or Rooming Units	Zoning use group	Description of use
025		100	J-1	4	5	FOUR HOTEL ROOMS (TENANT 27TH FLOOR)
026		100	J-1	4	5	THREE HOTEL ROOMS, 1 HOTEL SUITE (TENANT 28TH FLOOR)
027		100	J-1	7	5	SEVEN HOTEL ROOMS (TENANT 29TH FLOOR)
028		100	J-1	7	5	SEVEN HOTEL ROOMS (TENANT 30TH FLOOR)
029		100	J-1		5	MECHANICAL ROOM (TENANT 31ST FLOOR)
END OF SECTION						



Borough Commissioner



Commissioner

END OF DOCUMENT

110095753/012 7/9/2018 1:51:13 PM





# Certificate of Occupancy

**CO Number: 110162724T013**

This certifies that the premises described herein conforms substantially to the approved plans and specifications and to the requirements of all applicable laws, rules and regulations for the uses and occupancies specified. No change of use or occupancy shall be made unless a new Certificate of Occupancy is issued. *This document or a copy shall be available for inspection at the building at all reasonable times.*

<b>A.</b>	<b>Borough:</b> Manhattan	<b>Block Number:</b> 01037	<b>Certificate Type:</b> Temporary
	<b>Address:</b> 305 WEST 46 STREET	<b>Lot Number(s):</b> 34	<b>Effective Date:</b> 06/06/2018
	<b>Building Identification Number (BIN):</b> 1089717		<b>Expiration Date:</b> 09/04/2018
		<b>Building Type:</b> New	
<i>For zoning lot metes &amp; bounds, please see BISWeb.</i>			
<b>B.</b>	<b>Construction classification:</b> 1-C	(1968 Code)	
	<b>Building Occupancy Group classification:</b> J-1	(1968 Code)	
	<b>Multiple Dwelling Law Classification:</b> HAEA		
	<b>No. of stories:</b> 27	<b>Height in feet:</b> 294	<b>No. of dwelling units:</b> 497
<b>C.</b>	<b>Fire Protection Equipment:</b> Standpipe system, Fire alarm system, Sprinkler system, Fire Suppression system		
<b>D.</b>	<b>Type and number of open spaces:</b> Parking spaces (50), Parking (15942 square feet), Loading berths (1), Loading berths (396 square feet)		
<b>E.</b>	<b>This Certificate is issued with the following legal limitations:</b> None		
<b>Outstanding requirements for obtaining Final Certificate of Occupancy:</b>			
There are 20 outstanding requirements. Please refer to BISWeb for further detail.			
<b>Borough Comments:</b> None			



Borough Commissioner



Commissioner

*Certificate of Occupancy*

CO Number: 110162724T013

Permissible Use and Occupancy						
All Building Code occupancy group designations are 1968 designations, except RES, COM, or PUB which are 1938 Building Code occupancy group designations.						
Floor From To	Maximum persons permitted	Live load lbs per sq. ft.	Building Code occupancy group	Dwelling or Rooming Units	Zoning use group	Description of use
CEL	188				5	STORAGE, LOCKER ROOMS, CONFERENCE ROOMS, OFFICES, ACCESSORY KITCHEN TO EATING & DRINKING ESTABLISHMENT ON THE 1ST FLOOR.
MZ1					5	MECHANICAL ROOMS
001	1		B-2		5	STORAGE
001	781					LOBBY ACCESSORY TO THE HOTEL, EATING & DRINKING ESTABLISHMENT, OUTDOOR SEATING (8) SEATS
002			J-1	20	5	TWENTY HOTEL ROOMS (TENANT 3RD FLOOR)
003			J-1	21	5	TWENTY HOTEL ROOMS (TENANT 4TH FLOOR)
004			J-1	20	5	TWENTY HOTEL ROOMS (TENANT 5TH FLOOR)
005			J-1	20	5	TWENTY HOTEL ROOMS (TENANT 6TH FLOOR)
006			J-1	20	5	TWENTY HOTEL ROOMS (TENANT 7TH FLOOR)
007			J-1	20	5	TWENTY HOTEL ROOMS (TENANT 8TH FLOOR)
008			J-1	20	5	TWENTY HOTEL ROOMS (TENANT 9TH FLOOR)
009			J-1	20	5	TWENTY HOTEL ROOMS (TENANT 10TH FLOOR)

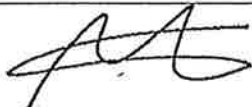

Borough Commissioner



Commissioner

*Certificate of Occupancy*

CO Number: 110162724T013

Permissible Use and Occupancy						
All Building Code occupancy group designations are 1968 designations, except RES, COM, or PUB which are 1938 Building Code occupancy group designations.						
Floor From To	Maximum persons permitted	Live load lbs per sq. ft.	Building Code occupancy group	Dwelling or Rooming Units	Zoning use group	Description of use
010			J-1	20	5	TWENTY HOTEL ROOMS (TENANT 11TH FLOOR)
011			J-1	20	5	TWENTY HOTEL ROOMS (TENANT 12TH FLOOR)
012			J-1	20	5	TWENTY HOTEL ROOMS (TENANT 14TH FLOOR)
013			J-1	20	5	TWENTY HOTEL ROOMS (TENANT 15TH FLOOR)
014			J-1	20	5	TWENTY HOTEL ROOM (TENANT 16TH FLOOR)
015			J-1	20	5	TWENTY HOTEL ROOMS (TENANT 17TH FLOOR)
016			J-1	20	5	TWENTY HOTEL ROOMS (TENANT 18TH FLOOR)
017			J-1	20	5	TWENTY HOTEL ROOMS (TENANT 19TH FLOOR)
018			J-1	20	5	TWENTY HOTEL ROOMS (TENANT 20TH FLOOR)
019			J-1	20	5	TWENTY HOTEL ROOMS (TENANT 21ST FLOOR)
020			J-1	20	5	TWENTY HOTEL ROOMS (TENANT 22ND FLOOR)
021			J-1	20	5	TWENTY HOTEL ROOMS (TENANT 23RD FLOOR)
022			J-1	20	5	TWENTY HOTEL ROOMS (TENANT 24TH FLOOR)

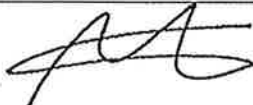

Borough Commissioner



Commissioner

*Certificate of Occupancy*

CO Number: 110162724T013

Permissible Use and Occupancy						
All Building Code occupancy group designations are 1968 designations, except RES, COM, or PUB which are 1938 Building Code occupancy group designations.						
Floor From To	Maximum persons permitted	Live load lbs per sq. ft.	Building Code occupancy group	Dwelling or Rooming Units	Zoning use group	Description of use
023			J-1	20	5	TWENTY HOTEL ROOMS (TENANT 25TH FLOOR)
024			J-1	18	5	EIGHTEEN HOTEL ROOMS, EXECUTIVE LOUNGE (TENANT 26TH FLOOR)
025			J-1	20	5	TWENTY HOTEL ROOMS (TENANT 27TH FLOOR)
026			J-1	19	5	NINETEEN HOTEL ROOMS (TENANT 28TH FLOOR)
027					5	MECHANICAL (TENANT 29TH FLOOR)
RO F					5	BULKHEAD
NOTE: THESE PREMISES 741 8TH AVE., 763 8TH AVE. AND 303 W. 46TH ST., CONSISTING OF TAX LOTS 33, 34 AND 28 HAVE BEEN DECLARED AS ONE ZONING LOT AS PER SECTION 12-10 OF THE ZONING RESOLUTION AND HAVE BEEN RECORDED AT THE OFFICE OF THE CITY REGISTER UNDER CRFN NUMBER						
END OF SECTION						



Borough Commissioner



Commissioner

END OF DOCUMENT

110162724/013 6/6/2018 11:33:45 AM



CITY OF NEW YORK

MANHATTAN COMMUNITY BOARD No. 4

330 West 42<sup>nd</sup> Street, 26<sup>th</sup> floor New York, NY 10036  
tel: 212-736-4536 fax: 212-947-9512  
www.nyc.gov/mcb4

BURT LAZARIN  
Chair

JESSE BODINE  
District Manager

## PUBLIC NOTICE

Business Licenses and Permits Committee  
will discuss an application submitted by

# Riu Plaza New York Time Square Hotel 305 W 46<sup>th</sup> Street a/k/a 741 8th Avenue

An alteration application to include the addition of 18 tables and 36 seats outside of the W 46<sup>th</sup> Street side of the hotel. The tables and seats are on the sidewalk but are within the property line

<b>DATE:</b>	Tuesday, July 10, 2018
<b>TIME:</b>	6:30 PM
<b>PLACE:</b>	Geffner House 351 W 42 <sup>nd</sup> Street

We invite you to attend this meeting and give your comments on this application.  
Alternately, you may mail, fax or email us at the address listed above.  
For more information, please call 212-736-4536.

*Posted according to the Administrative Code of the City of New York section 10-119.  
Please do not remove until after July 10, 2018.*





305

EXIT

NOTICE  
PLEASE DO NOT  
BLOCK THE  
EXIT

AUTOMATIC DOOR AUTOMATIC DOOR STAND CLEAR





# FASHION BAR & RESTAURANT



Pull  
Tirar

OPENING TIME  
BREAKFAST  
7:00 am - 11:00 am  
BAR & RESTAURANT  
12:00 Noon - 12:00 Midnight

  
OFFICE OF THE COMPTROLLER OF THE CITY OF NEW YORK  
OFFICE OF THE CHIEF OF BUREAU OF FINANCIAL SERVICES  
PUBLIC NOTICE

Business Licenses and Permits Commission  
with offices in separate buildings by  
**Riu Plaza New York  
Time Square Hotel  
305 W 46<sup>th</sup> Street  
a/k/a 741 8th Avenue**

The enclosed application is hereby the subject of a  
public notice to all persons of the City of New York  
and County of New York. The Office will receive the  
application for the license or permit on the date  
indicated below.

DATE	PLACE
7/15/2011	305 W 46 <sup>th</sup> Street
7/15/2011	305 W 46 <sup>th</sup> Street
7/15/2011	305 W 46 <sup>th</sup> Street

For more information, please contact the Office of the  
Comptroller of the City of New York, Office of the  
Chief of Bureau of Financial Services, at (212) 312-2200.  
www.comptroller.nyc.gov





Pull  
Tirar



Wi-Fi

OPENING TIME  
7:00 am - 9:00 Pm



PUBLIC NOTICE  
Ray Plaza New York  
Times Square Hotel  
305 W. 40<sup>th</sup> Street  
New York, NY 10018





# Google Maps 311 West 46th St



Image capture: Nov 2017 © 2018 Google

New York

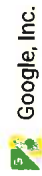

Google, Inc.

Street View - Nov 2017

Puerto Ric





# Google Maps 311 West 46th St



Image capture: Nov 2017 © 2018 Google

New York



Google, Inc.

Street View - Nov 2017



**FW: Business License and Permits Committee Meeting Tue.  
7/10/18 - Autoforwarded**

Jesse Bodine

**Sent:** Tuesday, July 10, 2018 2:40 PM

**To:** Gonzalez, Nelly (CB)

**Cc:** Holozubiec, Frank [fholozubiec@kirkland.com]; Yoni Bokser (yonibokser@gmail.com)

FYI

Jesse Bodine

District Manager

Manhattan Community Board 4

330 West 42 Street, 26th Floor

New York, New York 10036

Phone: 212-736-4536, Ext 27

Fax: 212-947-9512

[jbodine@cb.nyc.gov](mailto:jbodine@cb.nyc.gov)

---

**From:** Ute Schmid Keyes [utekeyes@gmail.com]

**Sent:** Tuesday, July 10, 2018 1:34 PM

**To:** Jesse Bodine

**Subject:** Re: Business License and Permits Committee Meeting Tue. 7/10/18 - Autoforwarded

Hello Community Board 4,

My fellow neighbors and I are against the alteration to *incorporating into the hotel licensed premises certain outside space on W 46<sup>th</sup> Street (within the property line) with max 18 tables and 36 seats* **305 W 46<sup>th</sup> Street (8/9)– Riu Plaza New York Time Square** *(incorporating into the hotel licensed premises certain outside space on W 46<sup>th</sup> Street (within the property line) with max 18 tables and 36 seats)*

The quality of life on 46th Street (Restaurant Row) has been deteriorating constantly since the Riu Plaza Hotel started their construction project. With the opening of the hotel the residents and business owners have experienced multiple problems stemming from running this hotel. Adding now IN ADDITION outdoor seating is adding to a whole catalog of problems.

I can not attend to this meeting in person but want this email to be taken into consideration when casting a vote. Or better yet, postpone the vote for the next meeting so that we residents can attend the meeting to discuss our concerns properly.

Thank you for your kind consideration.

Best ~Ute

Ute Schmid Keyes - 646-479-1484

On Fri, Jul 6, 2018 at 4:03 PM, Manhattan Community Board 4 <[Manhattan Community Board 4@mail.vresp.com](mailto:Manhattan_Community_Board_4@mail.vresp.com)> wrote:

\*\*\*

[Click to view this email in a browser](#)

**Business License and Permit  
Committee  
meeting will be  
Tuesday, July 10, 2018**

---

**NEW LOCATION:**

**Geffner House  
351 W 42nd Street  
6:30 PM**

# Agenda

## **I. NEW WINE BEER & CIDER APPLICATIONS:**

1. **528 9<sup>th</sup> Avenue (39/40) – 528 Corp. d/b/a Unidentified Flying Chicken** Hours of Operation: 11 a.m. – 11 p.m. seven days a week; Capacity: 74; Tables: 16; Seats: 31; Service Bar Only: 0, Stand-Up Bars: 0.

2. **369 W 34<sup>th</sup> Street (8/9) – BMT Food INC.**

Hours of Operation: 11 a.m. – 11 p.m. seven days a week; Capacity: 70; Tables: 10; Seats: 20; Service Bar Only: 0, Stand-Up Bars: 0.

## **II. ALTERATION APPLICATIONS:**

3. **305 W 46<sup>th</sup> Street (8/9)– Riu Plaza New York Time Square** (*incorporating into the hotel licensed premises certain outside space on W 46<sup>th</sup> Street (within the property line) with max 18 tables and 36 seats*)

Hours of Operation: 7 a.m. – 4 a.m. seven days a week; Hotel Capacity: 1650; Restaurant/Bar: 679; Tables: 187; Seats: 396 plus 43 lobby seats; Service Bar Only: 0, Stand-Up Bars: 2 with 11 seats; Backyard: Capacity: 60; tables 12 plus 4 low tables, seats: 52; W 47<sup>th</sup> Street: Capacity: 36, tables: 18; Seats: 36.

## **III. NEW ON-PREMISE LIQUOR LICENSE APPLICATIONS:**

4. **72 7<sup>th</sup> Avenue (14/15) – District 727 Inc. d/b/a District Local**

Hours of Operation: 11:30 a.m. – 2 a.m. Monday & Tuesday, 11:30 a.m. – 2

a.m. Wednesday – Saturday, 11:30 a.m. – 12 a.m. Sunday; Capacity: 75;  
Tables: 16; Seats: 53; Service Bar Only: 0, Stand-Up Bars: 1 with 16 seats.

5. **261 W 21<sup>st</sup> Street (7/8) – Bar 21 Ltd. d/b/a Bar 21**

Hours of Operation: 11 a.m. – 4 a.m. Monday – Saturday; 12 p.m. – 4 a.m.  
Sunday; Capacity: 75-100 (CofO tbd); Tables: TBD 11; Seats: 46; Service Bar  
Only: 0, Stand-Up Bars: 1 with 9-11 seats.

6. **436 W 15<sup>th</sup> Street (9/10) – PGH LLC**

Hours of Operation: 11 a.m. – 4 a.m. seven days a week; Capacity: 350;  
Tables: 54; Seats: 188; Service Bar Only: 0, Stand-Up Bars: 2 with 16 seats;  
Outside: 21 tables, 86 seats.

7. **355 W 16<sup>th</sup> Street (8/9) – Philippe by Philippe Chow**

Hours of Operation: ? – 4 a.m. seven days a week; Capacity: 176; Tables: 50;  
Seats: 150; Service Bar Only: 0, Stand-Up Bars: 1 with 20 seats.

8. **809 9<sup>th</sup> Avenue (53/54) – Westville HK LLC d/b/a Westville  
HK**

Hours of Operation: 10a.m. – 12 a.m. seven days a week; Capacity: 71;  
Tables: 27; Seats: 54; Service Bar Only: 0, Stand-Up Bars: 1 with 8 seats.

9. **635 W 42<sup>nd</sup> Street (11/12) – Canvas Events LLC d/b/a CNVS**

Hours of Operation: varies weekly; Capacity: 460; Tables: 40; Seats: 400;  
Service Bar Only: 2, Stand-Up Bars: 4 with 0 seats.

**The stipulation packet can be found by  
clicking [here](#)**

The next Business License & Permits Committee meeting is  
August 21, 2018  
Location: Fountain House  
[425 W 47th Street](#)

*Check us out on social media!*

Facebook: [Manhattan Community Board 4](#)

Twitter: [@manhattanboard4](#)

---

If you no longer wish to receive these emails, please reply to this message with "Unsubscribe" in the subject line or simply click on the following link: [Unsubscribe](#)

**[Click here to forward this email to a friend](#)**

Manhattan CB4  
330 West 42nd St  
26th Floor  
New York, New York 10036  
US

[Read](#) the VerticalResponse marketing policy.





PROPERTY LINE

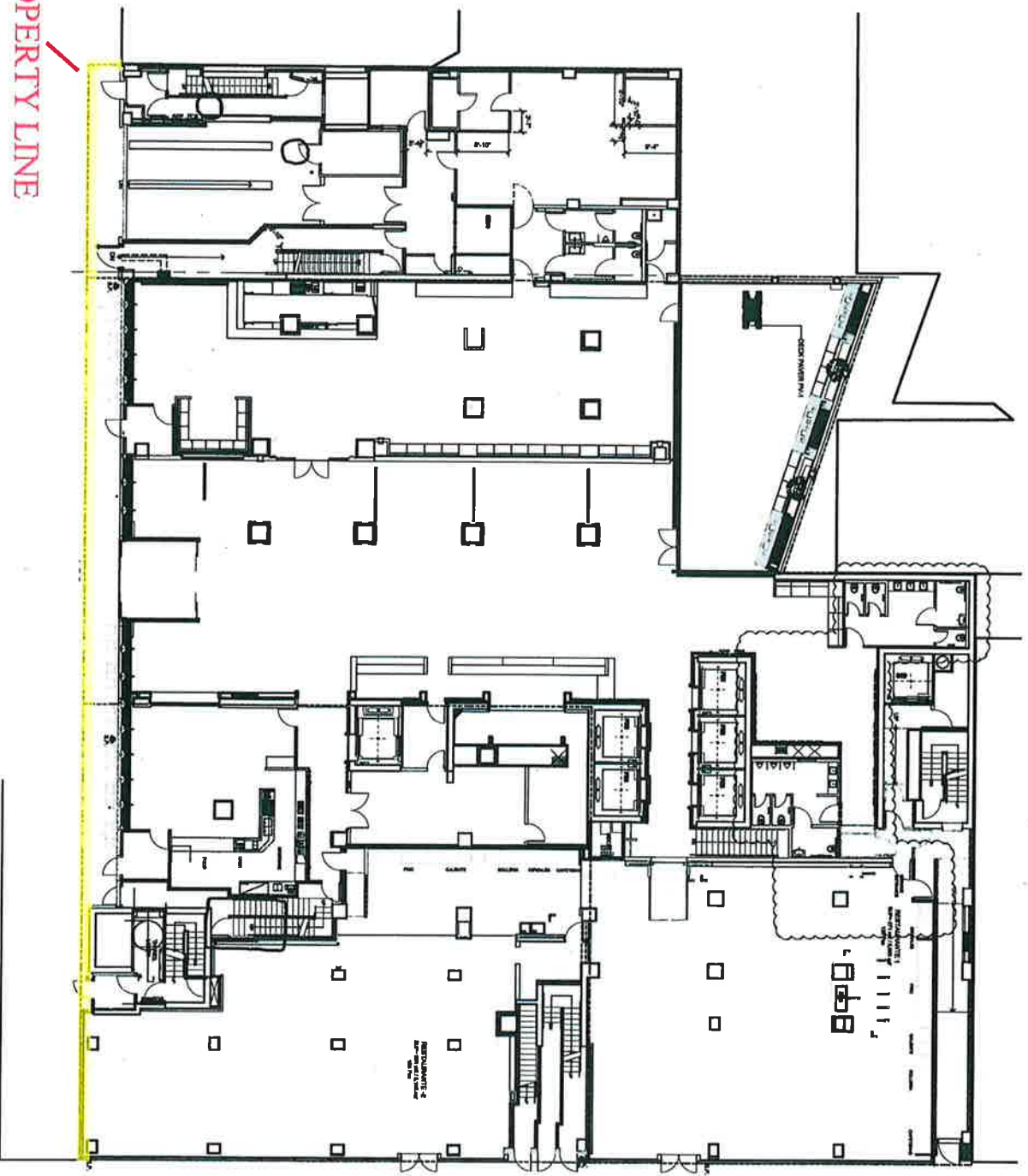

**RHU** RIU PLAZA NEW YORK  
NEW YORK, NEW YORK 10036

RIU HOTEL & RESORTS  
NEW YORK OFFICE  
100 NASSAU ST  
NEW YORK, NY 10038

THOMASCHI HOLDINGS, LLC  
110 WEST ST  
NEW YORK, NY 10038

ARCHITECT  
BENTZ + BIVINI ARCHITECTURE PC  
250 WEST 30TH ST  
NEW YORK, NY 10001

STRUCTURAL ENGINEERING  
POWELL CONSULTING ENGINEERS  
80 WEST 4TH ST  
NEW YORK, NY 10011

Mechanical Engineering  
PETER D'AMICO ENGINEERS, PC  
100 WEST 23RD ST  
NEW YORK, NY 10011

Electrical Engineering  
VVA (VVA DESIGN & ASSOCIATES)  
VVA (VVA DESIGN & ASSOCIATES)  
100 WEST 23RD ST  
NEW YORK, NY 10011

Interior Design  
ELI SAUNDERS INTERIORS  
200 WEST 11TH ST  
NEW YORK, NY 10011

Acoustic Consulting  
ROBERT A. HANSEN ASSOCIATES, INC.  
100 WEST 23RD ST  
NEW YORK, NY 10011

Accessibility Services  
UNITED SIGNAL ASSOCIATION  
100 WEST 23RD ST  
NEW YORK, NY 10011

Construction  
BENTZ + BIVINI ARCHITECTURE PC  
250 WEST 30TH ST  
NEW YORK, NY 10001

Construction  
BENTZ + BIVINI ARCHITECTURE PC  
250 WEST 30TH ST  
NEW YORK, NY 10001

Construction  
BENTZ + BIVINI ARCHITECTURE PC  
250 WEST 30TH ST  
NEW YORK, NY 10001

Construction  
BENTZ + BIVINI ARCHITECTURE PC  
250 WEST 30TH ST  
NEW YORK, NY 10001

Construction  
BENTZ + BIVINI ARCHITECTURE PC  
250 WEST 30TH ST  
NEW YORK, NY 10001

Construction  
BENTZ + BIVINI ARCHITECTURE PC  
250 WEST 30TH ST  
NEW YORK, NY 10001

Construction  
BENTZ + BIVINI ARCHITECTURE PC  
250 WEST 30TH ST  
NEW YORK, NY 10001



DATE: 12/10/10  
SCALE: AS SHOWN  
DRAWN: [Name]  
CHECKED: [Name]

PROJECT TITLE  
GROUND FLOOR  
PLAN

PROJECT NO.  
A-101.00

NO.	REVISION	DATE
01	ISSUED FOR CONSTRUCTION	12/10/10
02	ADDITIONAL REVISIONS	12/10/10
03	ADDITIONAL REVISIONS	12/10/10
04	ADDITIONAL REVISIONS	12/10/10
05	ADDITIONAL REVISIONS	12/10/10
06	ADDITIONAL REVISIONS	12/10/10
07	ADDITIONAL REVISIONS	12/10/10
08	ADDITIONAL REVISIONS	12/10/10
09	ADDITIONAL REVISIONS	12/10/10
10	ADDITIONAL REVISIONS	12/10/10
11	ADDITIONAL REVISIONS	12/10/10
12	ADDITIONAL REVISIONS	12/10/10
13	ADDITIONAL REVISIONS	12/10/10
14	ADDITIONAL REVISIONS	12/10/10
15	ADDITIONAL REVISIONS	12/10/10
16	ADDITIONAL REVISIONS	12/10/10
17	ADDITIONAL REVISIONS	12/10/10
18	ADDITIONAL REVISIONS	12/10/10
19	ADDITIONAL REVISIONS	12/10/10
20	ADDITIONAL REVISIONS	12/10/10
21	ADDITIONAL REVISIONS	12/10/10
22	ADDITIONAL REVISIONS	12/10/10
23	ADDITIONAL REVISIONS	12/10/10
24	ADDITIONAL REVISIONS	12/10/10
25	ADDITIONAL REVISIONS	12/10/10
26	ADDITIONAL REVISIONS	12/10/10
27	ADDITIONAL REVISIONS	12/10/10
28	ADDITIONAL REVISIONS	12/10/10
29	ADDITIONAL REVISIONS	12/10/10
30	ADDITIONAL REVISIONS	12/10/10



## NOTICE TO RESIDENTS

741 Eighth Avenue Owners LLC d/b/a RIU Hotel Plaza New York Times Square is scheduled to appear before Community Board No. 4 in connection with its Hotel Liquor License alteration application.

The Community Board meeting is scheduled for Tuesday July 10, 2018 @ 6:30 PM at the Geffner House, 351 West 42<sup>nd</sup> Street.

The alteration application with the NYS Liquor Authority is to incorporate into the Hotel Liquor License the outside seating area on the 46<sup>th</sup> Street side of the hotel.

The outside space to be added into the licensed premises will have a maximum of 18 tables and 36 seats. While the space is on the sidewalk, it is within the hotel property line and, therefore, a sidewalk café permit is not required.

The hours of operation to be requested for this outside space will be 7AM – Midnight daily.

Please contact this office if you have any questions or would like additional information.

Tel: 212-651-3100

[martha@brpclaw.com](mailto:martha@brpclaw.com)

[ben@brpclaw.com](mailto:ben@brpclaw.com)



LIST WHERE "NOTICE TO RESIDENTS" LEFT

302 West 46<sup>th</sup> Street  
304 West 46<sup>th</sup> Street  
313 West 46<sup>th</sup> Street  
315 West 46<sup>th</sup> Street  
317 West 46<sup>th</sup> Street  
319 West 46<sup>th</sup> Street (upstairs)  
319 West 46<sup>th</sup> Street (downstairs)  
321 West 46<sup>th</sup> Street  
323 West 46<sup>th</sup> Street  
325 West 46<sup>th</sup> Street  
330 West 46<sup>th</sup> Street  
341 West 46<sup>th</sup> Street  
343 West 46<sup>th</sup> Street  
344 West 46<sup>th</sup> Street  
345 West 46<sup>th</sup> Street  
347 West 46<sup>th</sup> Street  
351 West 46<sup>th</sup> Street  
352 West 46<sup>th</sup> Street  
355 West 46<sup>th</sup> Street  
357 West 46<sup>th</sup> Street  
358 West 46<sup>th</sup> Street  
359 West 46<sup>th</sup> Street  
361 West 46<sup>th</sup> Street  
362 West 46<sup>th</sup> Street  
363 West 46<sup>th</sup> Street  
364 West 46<sup>th</sup> Street  
365 West 46<sup>th</sup> Street  
368 West 46<sup>th</sup> Street  
369 West 46<sup>th</sup> Street  
370 West 46<sup>th</sup> Street  
372 West 46<sup>th</sup> Street  
374 West 46<sup>th</sup> Street  
375 West 46<sup>th</sup> Street

Additional notices hand-delivered:

347 West 46<sup>th</sup> Street – Andrew  
317 West 46<sup>th</sup> Street – Owens  
372 West 46<sup>th</sup> Street – Reynolds said speak to landlord  
316 West 46<sup>th</sup> Street, Apt 1 – Jackson, not interested  
360 West 46<sup>th</sup> Street – Lamb, does not mind  
247 West 46<sup>th</sup> Street (Platinum) – left a few with doorman to post on bulletin board  
301 West 46<sup>th</sup> Street – hand delivered to building





302 West 46th Street



304 West 46th Street







313 West 46th Street



315 West 46th Street





317 West 46th Street



319 West 46th Street - Downstairs







319 West 46th Street - Upstairs



321 West 46th Street







343 West 46th Street



344 West 46th Street







345 West 46th Street



347 West 46th Street







351 West 46th Street



352 West 46th Street







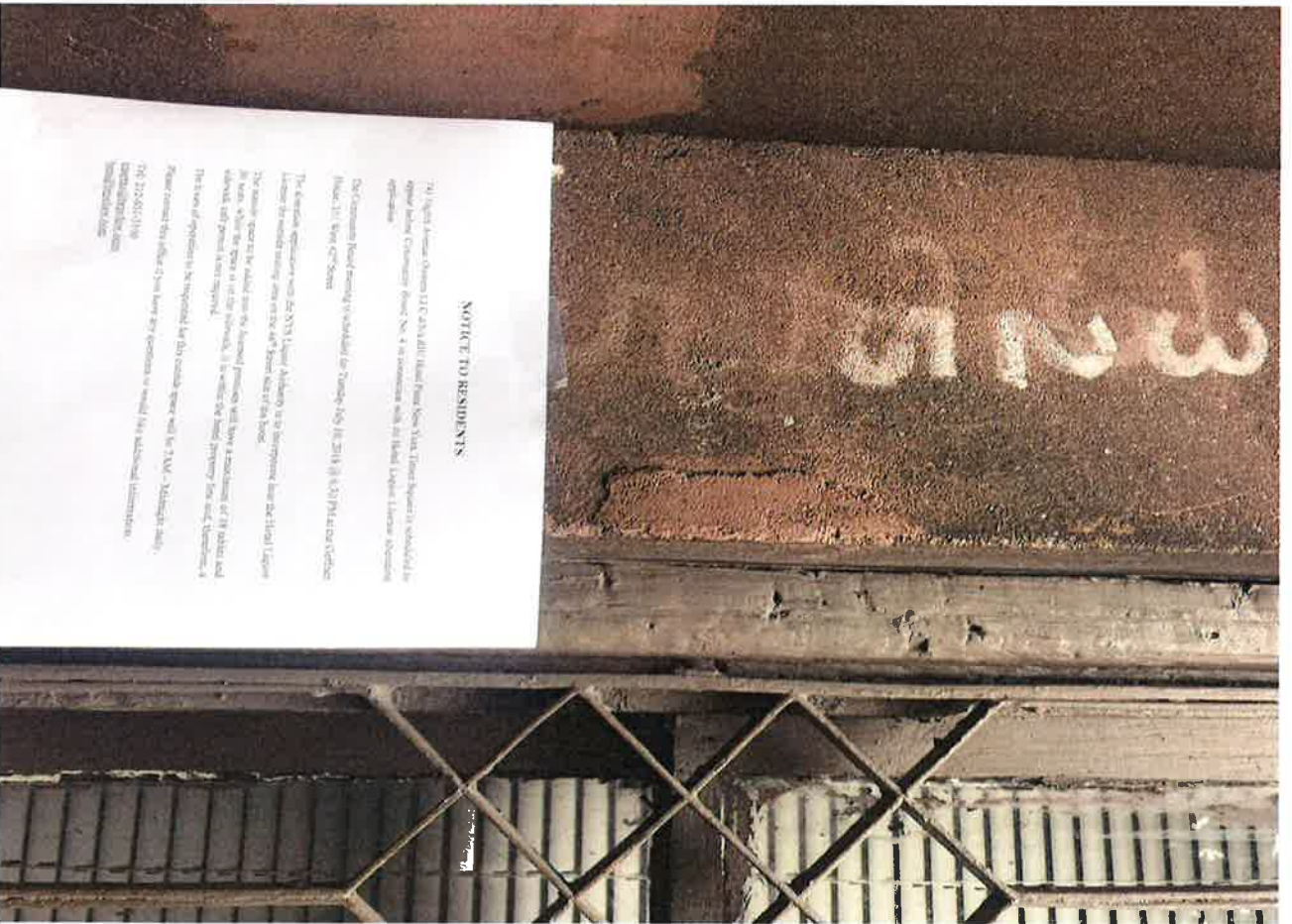





330 West 46th Street



341 West 46th Street







355 West 46th Street



357 West 46th Street

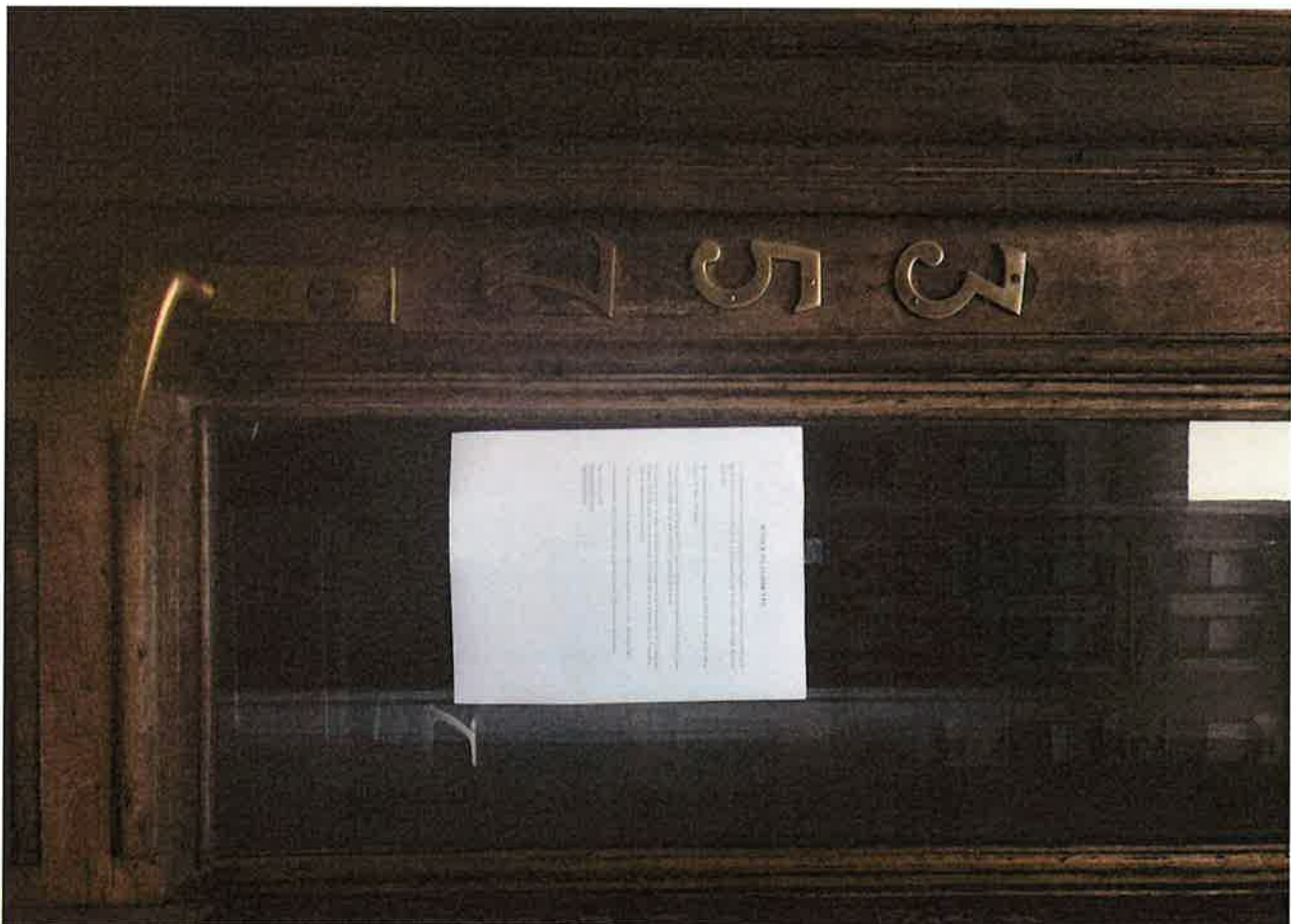





358 West 46th Street



359 West 46th Street







361 West 46th Street



362 West 46th Street







363 West 46th Street



364 West 46th Street







365 West 46th Street



368 West 46th Street







369 West 46th Street

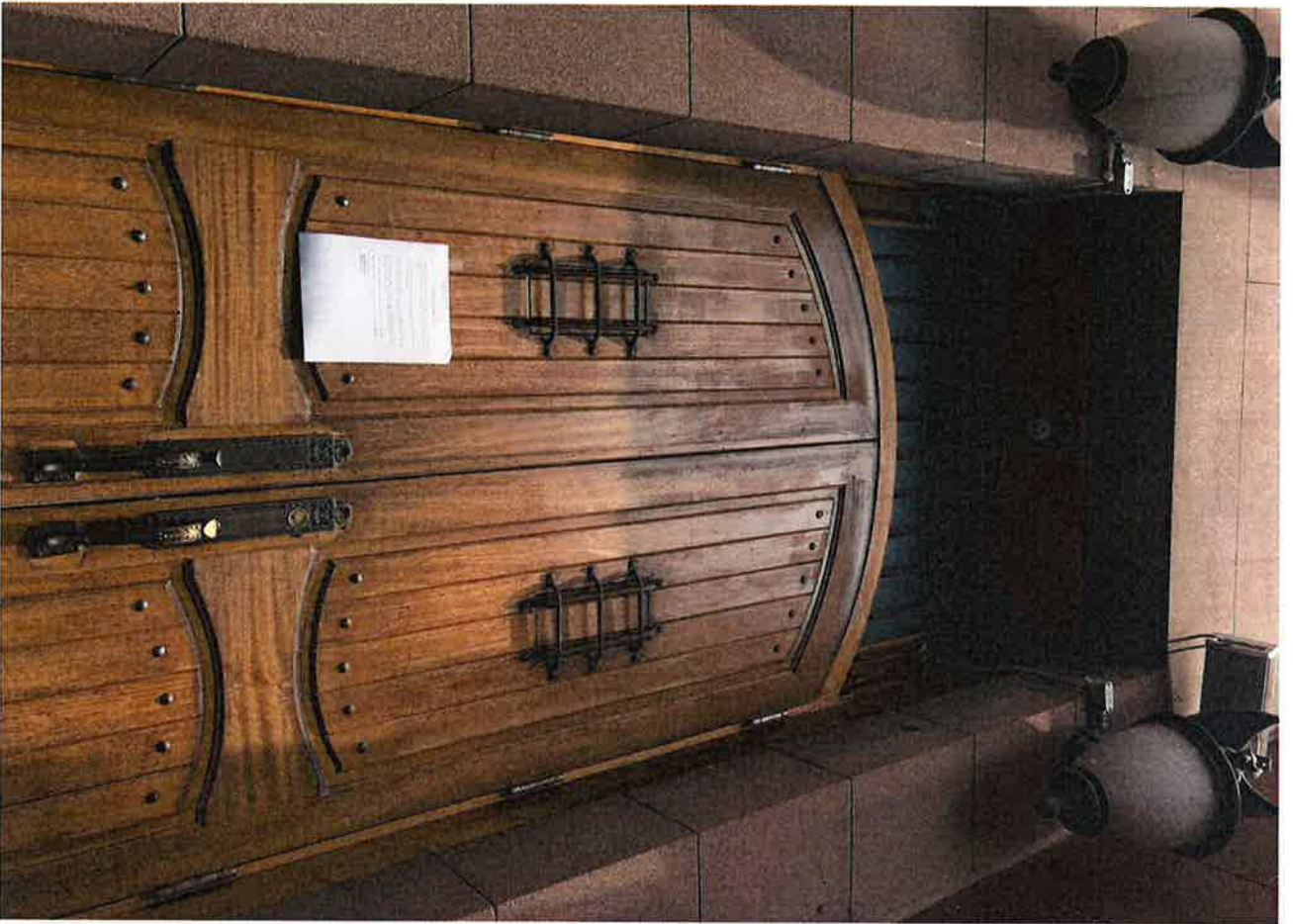

370 West 46th Street







372 West 46th Street

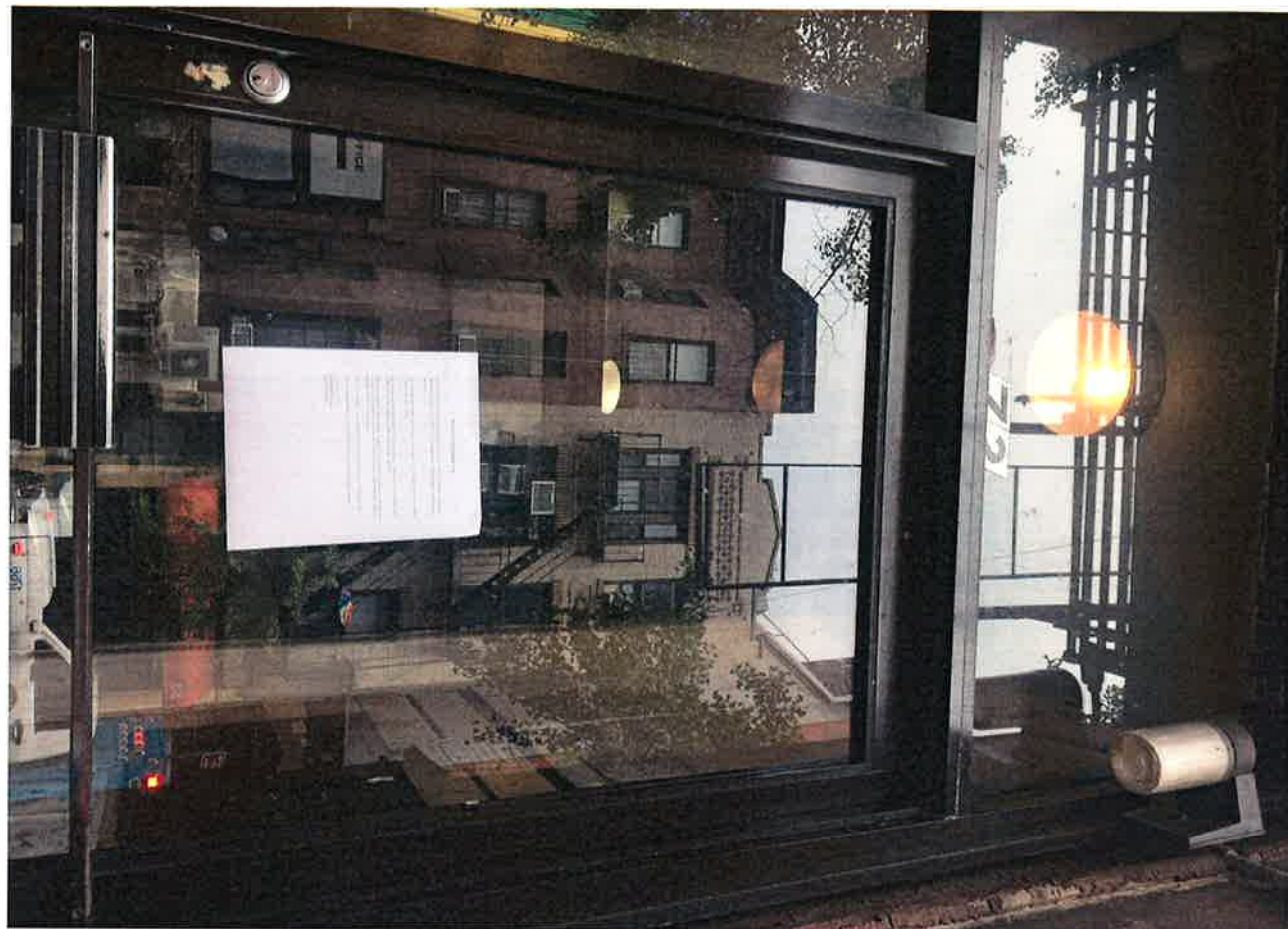

374 West 46th Street







375 West 46th Street











**BERNSTEIN REDO, P.C.**  
-ATTORNEYS AT LAW-

1177 AVENUE OF THE AMERICAS, 5<sup>TH</sup> FL  
NEW YORK, NEW YORK 10036  
TEL (212) 651-3100

DONALD M. BERNSTEIN  
MARTHA M. REDO

BENJAMIN SAVITSKY

June 8, 2018

**VIA FEDERAL EXPRESS  
WITH TRACKING NUMBER**

Community Board #4  
330 West 42<sup>nd</sup> Street, Suite 2618  
New York, NY 10036

Attn: Nelly Gonzalez, Assistant District Manager

Re: 741 Eighth Avenue Owners, LLC  
d/b/a Riu Plaza New York Times Square Hotel  
305 West 46<sup>th</sup> Street a/k/a 741 Eighth Avenue  
New York, NY 10036

Dear Nelly:

We represent the reference hotel licensee which will be filing an Application for Permission to Make Alteration with the New York State Liquor Authority.

The alterations will include the addition of 18 tables and 36 seats outside on the 46<sup>th</sup> Street side of the hotel. The tables and seats are on the sidewalk but are within the property line and, therefore, a sidewalk café permit is not required.

In connection therewith, enclosed please find the statutory 30-Day notice form, together with a copy of the proposed layout.

Thank you.

Very truly yours,



Jules Vigh  
Paralegal

Enclosures

RECEIVED JUN 11 REC'D





OFFICE USE ONLY		
<input type="radio"/> Original	<input type="radio"/> Amended	Date _____

## Standardized NOTICE FORM for Providing 30-Day Advance Notice to a Local Municipality or Community Board

1. Date Notice was Sent:       1a. Delivered by:

2. Select the type of Application that will be filed with the Authority for an On-Premises Alcoholic Beverage License:
- New Application    Renewal    Alteration    Corporate Change    Removal    Class Change    Method of Operation Change

For **New** applicants, answer each question below using all information known to date  
 For **Renewal** applicants, answer all questions  
 For **Alteration** applicants, attach a complete written description and diagrams depicting the proposed alteration(s)  
 For **Corporate Change** applicants, attach a list of the current and proposed corporate principals  
 For **Removal** applicants, attach a statement of your current and proposed addresses with the reason(s) for the relocation  
 For **Class Change** applicants, attach a statement detailing your current license type and your proposed license type  
 For **Method of Operation Change** applicants, although not required, if you choose to submit, attach an explanation detailing those changes

**This 30-Day Advance Notice is Being Provided to the Clerk of the Following Local Municipality or Community Board:**

3. Name of Municipality or Community Board:

**Applicant/Licensee Information:**

4. Licensee Serial Number (if applicable):       Expiration Date (if applicable):

5. Applicant or Licensee Name:

6. Trade Name (if any):

7. Street Address of Establishment:

8. City, Town or Village:  , NY      Zip Code:

9. Business Telephone Number of Applicant/Licensee:

10. Business E-mail of Applicant/Licensee:

11. Type(s) of alcohol sold or to be sold:       Beer & Cider    Wine, Beer & Cider    Liquor, Wine, Beer & Cider

12. Extent of Food Service:

Full food menu; full kitchen run by a chef or cook    Menu meets legal minimum food availability requirements; food prep area at minimum

13. Type of Establishment:

14. Method of Operation: (check all that apply)

Seasonal Establishment    Juke Box    Disc Jockey<sup>\*\*</sup>    Recorded Music    Karaoke

Live Music<sup>\*\*</sup> (give details i.e., rock bands, acoustic, jazz, etc.):

Patron Dancing    Employee Dancing    Exotic Dancing    Topless Entertainment

Video/Arcade Games    Third Party Promoters    Security Personnel

Other (specify):

**\*\*Live music and DJ for private events only**

15. Licensed Outdoor Area: (check all that apply)

None    Patio or Deck    Rooftop    Garden/Grounds    Freestanding Covered Structure

Sidewalk Cafe    Other (specify):





OFFICE USE ONLY		
<input type="radio"/> Original	<input type="radio"/> Amended	Date _____

16. List the floor(s) of the building that the establishment is located on:
17. List the room number(s) the establishment is located in within the building, if appropriate:
18. Is the premises located within 500 feet of three or more on-premises liquor establishments?  Yes  No
19. Will the license holder or a manager be physically present within the establishment during all hours of operation?  Yes  No
20. If this is a transfer application (an existing licensed business is being purchased) provide the name and serial number of the licensee:  
 Name  Serial Number
21. Does the applicant or licensee own the building in which the establishment is located?  Yes (if YES, SKIP 23-26)  No

**Owner of the Building in Which the Licensed Establishment is Located**

22. Building Owner's Full Name:
23. Building Owner's Street Address:
24. City, Town or Village:  State:  Zip Code:
25. Business Telephone Number of Building Owner:

**Representative or Attorney Representing the Applicant in Connection with the Application for a License to Traffic in Alcohol at the Establishment Identified in this Notice**

26. Representative/Attorney's Full Name:
27. Representative/Attorney's Street Address:
28. City, Town or Village:  State:  Zip Code:
29. Business Telephone Number of Representative/Attorney:
30. Business E-mail Address of Representative/Attorney:

I am the applicant or licensee holder or a principal of the legal entity that holds or is applying for the license. Representations in this form are in conformity with representations made in submitted documents relied upon by the Authority when granting the license. I understand that representations made in this form will also be relied upon, and that false representations may result in disapproval of the application or revocation of the license.

By my signature, I affirm - under **Penalty of Perjury** - that the representations made in this form are true.

31. Printed Principal Name:  Title:

Principal Signature: 



**RIU**  
**RIU PLAZA NEW YORK**  
 NEW YORK, NEW YORK 10028

RIU HOTEL & RESORTS  
 350 AVENUE OF THE AMERICAS  
 NEW YORK, NY 10013  
 T: 212 512 1700  
 F: 212 512 1640

DEVELOPER SERVICES  
 RIU DEVELOPMENT SERVICES, LLC  
 171 MADISON AVE., SUITE 2001  
 NEW YORK, NY 10017  
 T: 212 512 1700  
 F: 212 512 1700

ARCHITECT  
 BERG + FLYNN ARCHITECTURE PC  
 100 WEST 47TH STREET, 14TH FLOOR  
 NEW YORK, NY 10036  
 INFO@BERGFYNN.COM

STRUCTURAL ENGINEERS  
 DESIMONE CONSULTING ENGINEERS  
 145 WEST 47TH STREET, 14TH FLOOR  
 NEW YORK, NY 10036  
 T: 212 512 2211  
 F: 212 512 2211

Mechanical ENGINEERS  
 TMO CONSULTING ENGINEERS, PC  
 7 PENN PLAZA, SUITE 1102  
 NEW YORK, NY 10019  
 T: 212 512 7100  
 F: 212 512 7881

ELEVATION CONSULTANTS  
 TADAM CONSULTANTS (S ASSOCIATES)  
 7 PENN PLAZA, SUITE 1102  
 NEW YORK, NY 10019  
 T: 212 512 7100  
 F: 212 512 7881

BUILDING ENVELOPE CONSULTANTS  
 GILMANCARRAY STERNKELLIP  
 100 WEST 47TH STREET, 14TH FLOOR  
 NEW YORK, NY 10036  
 T: 212 512 4700  
 F: 212 512 4700

ACCOUNTING CONSULTANTS  
 ROBERT A. HANSEN ASSOCIATES, INC.  
 68 WEST 47TH STREET, 14TH FLOOR  
 NEW YORK, NY 10036  
 T: 212 512 7878  
 F: 212 512 7877

LIQUOR LICENSE CONSULTANTS  
 UNITED SPINA ASSOCIATION  
 700 WEST 47TH STREET, 14TH FLOOR  
 NEW YORK, NY 10019  
 T: 718 333 4702

NO.	REVISION/DESCRIPTION	DATE
01	ISSUED FOR CONSTRUCTION	08.27.15
02	ADDENDUM 1	07.16.15
03	ADDENDUM 2	07.16.15
04	ADDENDUM 3	07.16.15
05	ADDENDUM 4	07.16.15
06	ADDENDUM 5	07.16.15
07	ADDENDUM 6	07.16.15
08	ADDENDUM 7	07.16.15
09	ADDENDUM 8	07.16.15
10	ADDENDUM 9	07.16.15
11	ADDENDUM 10	07.16.15
12	ADDENDUM 11	07.16.15
13	ADDENDUM 12	07.16.15
14	ADDENDUM 13	07.16.15
15	ADDENDUM 14	07.16.15
16	ADDENDUM 15	07.16.15
17	ADDENDUM 16	07.16.15
18	ADDENDUM 17	07.16.15
19	ADDENDUM 18	07.16.15
20	ADDENDUM 19	07.16.15
21	ADDENDUM 20	07.16.15

DRAWING TITLE  
**GROUND FLOOR PLAN**

DRAWING NO.  
**A-101.00**

DATE  
 08/27/15

SCALE  
 AS SHOWN

REVISIONS  
 NO. DESCRIPTION DATE

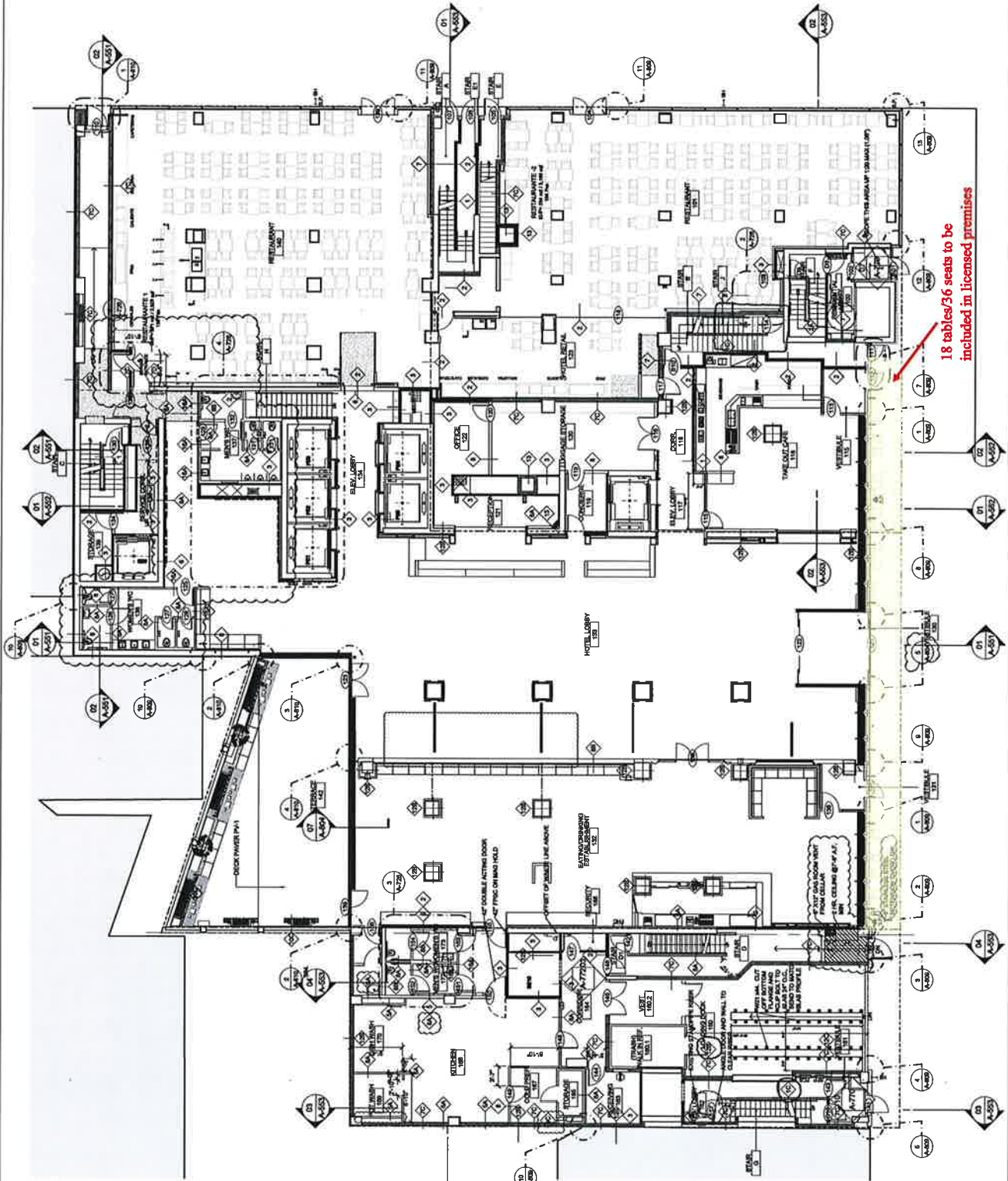

18 tables/36 seats to be included in licensed premises



