

COMMUNITY BOARD 2 APPLICATION FOR A STATE LIQUOR AUTHORITY LICENSE

FOR EXISTING LICENSEES -
ALTERATION TO ADD CONTIGUOUS OR NONCONTIGUOUS MUNICIPAL PUBLIC SPACE

Form to be Completed and Returned with 30-Day Notice

Name/email of Principal/Contact: Rosanna Russo [REDACTED]
Name/email of Representative: Michael Kelly KELLYMLK136@gmail.com
Applicant/Premises Name: Lunella Ristorante INC
DBA Name: Lunella
Address of Premises (include zip code): 173 Mulberry St NYC NY 10013
Cross Streets of Premises: Broome + Grand Streets
License ID #: 0340-23-128489

On Premise Liquor Restaurant Wine Tavern Wine Other _____

Sidewalk Café will have no more than (If premises is located on a corner please indicate for both streets):

_____ tables and _____ seats on _____ Street

_____ tables and _____ seats on _____ Street

Will applicant agree to close sidewalk café area by 10 PM every night? Yes No

Will open sidewalk café area at _____

Roadbed / Open Streets will have no more than (If premises is located on a corner please indicate for both streets):

6 tables and 12 seats on Mulberry St Street

_____ tables and _____ seats on _____ Street

Is roadbed in a floating parking lane separated from the curb by a bike path? Yes No

Does DOT Dining Out NYC application include an FDNY waiver? Yes No

Will applicant agree to close roadbed seating by 10 PM every night? Yes No

Will open roadbed seating area at 11am

For all Applicants:

Will agree there will be no host stands, bus or service stations on the sidewalk or in the roadbed? Yes No

Will agree there will be no exterior music, speakers or TVs? Yes No

Will agree that all patrons in any sidewalk café or roadbed will be seated? Yes No

SECTION 1: Site Plan

- This Site Plan Form is required to be uploaded in the "Roadway Site Plan" field of your online application.
- Refer to the [Roadway MFD](#) page in the Dining Out NYC website for more information about the application process.

Identify Permitted Parking Location:

- Identify the Parking Sign in front of or around the area where your roadway setup would be located.
- Roadway cafes can only be placed in:
 - Parking spaces, which include metered and non-metered spaces, commercial parking, alternate side parking, angled parking, and seasonally restricted parking.
 - Loading areas, including loading only, truck loading, hot el loading, and no parking zones.
 - Floating Parking Lane - a parking lane that is separated from the curb by a protected bicycle lane that is adjacent to the curb.

- P1 - Parking Space
- P2 - Loading Area
- P3 - Floating Parking Lane

Use the space below to draw or upload your Site Plan representing your cafe perimeter, furniture, and clearances.

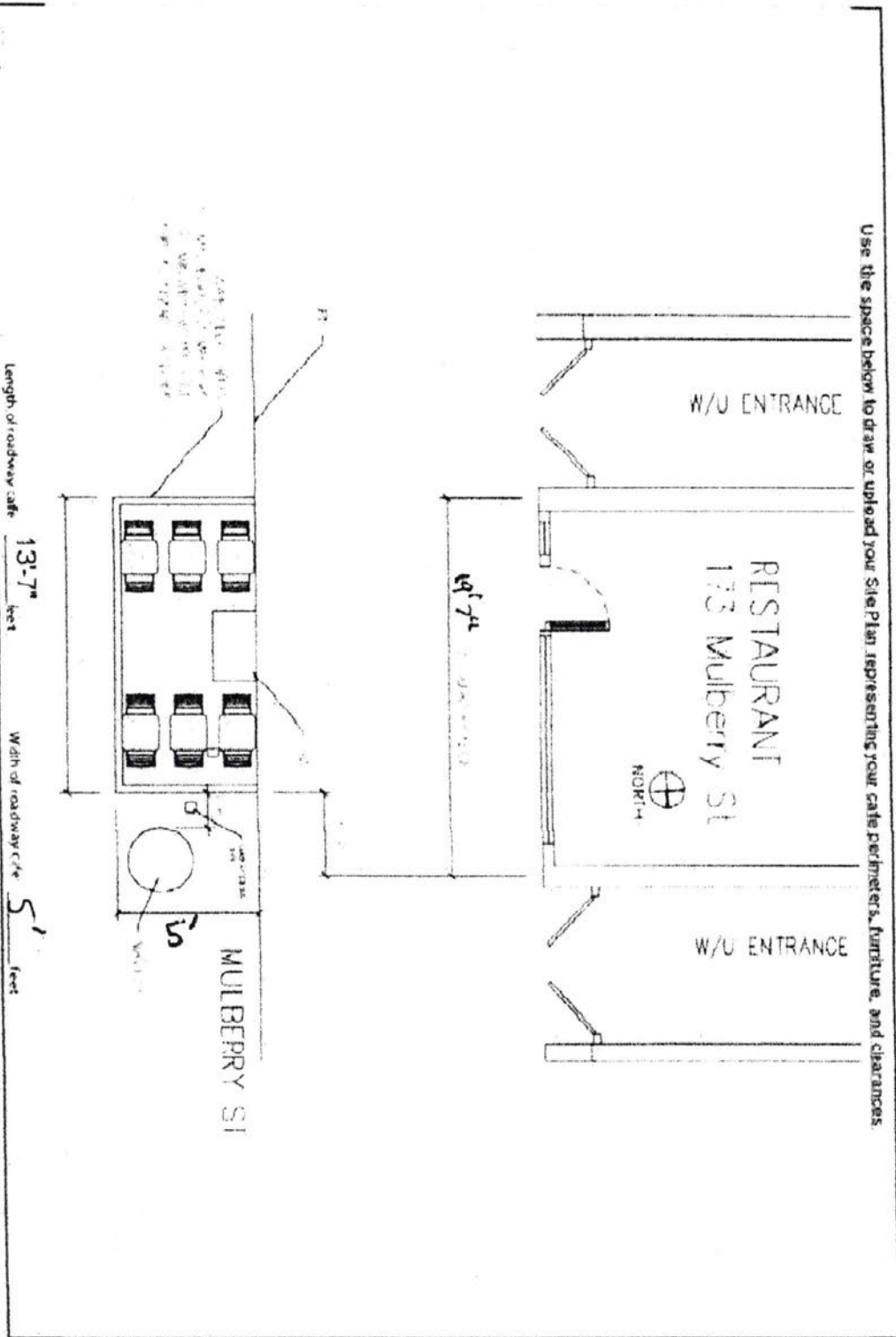

Roadway Cafe Site Plan Form

Applicant Name: LUNELLA RESTAURANCE INC
 Restaurant Name: LUNELLA
 FSEP Number: 40812973

Drawing Requirements

- Food service establishment frontage shown as:**
 - Line representing the establishment's space facing the sidewalk.
 - Length
 - Label
- Street names:**
 - Labels on each street
- Sidewalk shown as:**
 - Line representing street curb
- Roadway shown as:**
 - Width of curbside lane
- Cafe perimeter shown as:**
 - Lines indicating perimeter
 - Length and width
- Set-up furniture (tables, chairs, etc.) shown as:**
 - Lines or symbols at approximate location within setup
- Elements (in Section 2 of this form) within 15 feet of cafe perimeter, shown as:**
 - Lines or symbols
 - Distance from cafe perimeter
 - Labels
- Utility coverings (water/gas valves, and pull boxes) shown as:**
 - Symbols representing the location within the setup
- North arrow

SECTION 2: Required Clearances

- Please provide distances from the following objects.
- Only provide a distance if the listed object is within 15 feet of your proposed setup.
- Refer to the Setup Guide in the Dining Out NYC website for more information regarding clearances.

Elements with minimum 15 feet clearance from roadway cafe:

R01: Subway Sign: Open End _____ feet R03: Fire Hydrant _____ feet

Elements with minimum 10 feet clearance from roadway cafe:

R01: Subway Elevator Entrance _____ feet R05: MTA Curb Cut _____ feet
 R04: FDNY Curb Cut _____ feet

Elements with minimum 5 feet clearance from roadway cafe:

R06: Curb Cut _____ feet R11: CanBike Bike Share Station _____ feet
 R01: Emergency Exit Hatch _____ feet R12: Sign: Central _____ feet
 R08: Subway Sign: Closed End _____ feet R13: Microbiodiversity Station _____ feet
 R09: Subway Elevator: Non-Entry _____ feet R14: Damage Infrastructure _____ feet
 R10: Bus Stop Pole _____ feet
 Non-Approaching Side _____ feet

Elements with minimum 3 feet clearance from roadway cafe:

R15: Elevated Train Infrastructure _____ feet R16: Transformer: Vault _____ feet

Elements with minimum 1 foot and 6 inches clearance from roadway cafe:

R17: Vent Infrastructure _____ feet R18: Manholes _____ feet **18 inches**

Elements with minimum 6 inches clearance from roadway cafe:

R19: Thermoplastic Marking _____ feet

Roadway safe distance from crosswalks:

R20: Adjacent to non-approaching side of crosswalk _____ feet
 min. 8 foot distance

R21: Adjacent to approaching (stopping side of crosswalk min. 20 foot distance) _____ feet

R22: No crosswalk present (minimum 20 feet from curb line of intersecting street) _____ feet

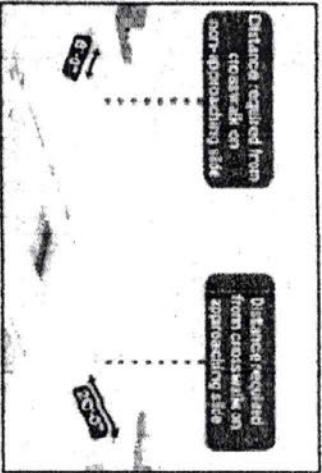

Check this box if none of the objects listed above are within 15 feet of the proposed setup.

SECTION 3: Material Requirements

- Please indicate which of the following materials will be part of your roadway cafe by checking the box next to the category. If applicable, please confirm the materials comply with the Dining Out NYC requirements. Refer to the Setup Guide in the Dining Out NYC website for more information regarding materials.

Materials Checklist:

Required

Barriers (All of the following must be met)

- Maintained on all sides of the cafe except the side fronting the ground floor restaurant.
- Not permanently affixed to the roadway.
- 34-42 in. depth (including planing), and at least 4 inches in width.
- Barriers are interconnected with each other.
- Any cladding over the barriers is securely fastened or affixed.
- Minimum 4 inches wide reflective strip on each barrier on the outward facing side.
- Weighted with a minimum of 150 pounds per linear foot of barrier length.

Optional: Only check the material categories you intend to use in your roadway cafe

Eloping (If using, all of the following must be met)

- Durable, lightweight, easily removable, mold-resistant, elevated from the ground level to allow for drainage, and removable to allow for cleaning.
- Flush with the curb line (except if located on a slope, be flush to the greatest extent feasible) and compliant with applicable accessibility requirements.
- Maintains a 6-inch covered channel between curb and base of flooring to allow for drainage.

Furnishings (If using, all of the following must be met)

- Lightweight and easily movable.
- Vertical Screens (If using, all of the following must be met)
 - Located between the barrier and the cafe above the cafe base or floor.
 - Located on the roadway-facing side, does not extend beyond the perimeter of the roadway cafe, and is not affixed to the outward facing side of barriers.
 - Easily removable, comprised of non-spark, fire-grade, and non-flammable materials.
 - If within 50 feet of any regulator or warning sign, does not exceed 46 inches in height.

Overhead Covers/ Umbrellas (If using, all of the following must be met)

- Minimum of 7 feet and maximum of 10 feet from the base or floor of the roadway cafe.
- Has a weighted base and any support structure are not affixed to the outward facing side of barriers, are of sufficient size and strength, made of durable materials, and free of defects.
- Easily removable, comprised of fire-grade and non-flammable materials.
- If within 50 feet of any regulator or warning sign, does not exceed 46 inches in height.

Lighting and Electrical Connections (If using, all of the following must be met)

- Any lighting is outdoor rated, properly secured, and lightweight.
- At least 14 feet above sidewalk, and 18 feet above roadway.
- Not attached to any (if property, including street trees).
- Electrical work complies with the applicable requirements set forth in NYC rules and the New York City Electrical Code. Please note that this may require additional permits from DOB or ESNR, and/or approval from the Landmarks Preservation Commission (LPC) as applicable.

Lunella

