

Vibrant NYC LLC
Radiant Café
172 Waverly Place
New York, New York 10014
Application for a Tavern Wine License

Manhattan Community Board 2
3 Washington Square Village
New York, NY 10012
April 2025 SLA Licensing Committee Meeting

CB2 Questionnaire

- Floor Plan
- Menu
- Photographs
- Certificate of Occupancy
- Proximity Report and Google Maps
- Lease
- SLA Application
- Outreach and Support Letters

BERNSTEIN REDO & SAVITSKY, P.C.
1177 Avenue of the Americas, 5th floor
New York, NY 10036
Tel. 212.651.3100
www.brpclaw.com

Meeting Date: 4/ /2025

APPLICANT INFORMATION:

Name of applicant(s):

Vibrant NYC LLC

Trade name (DBA):

Radiant Cafe

Premises address:

172 Waverly Place, New York, New York 10014

Cross Streets and other addresses used for building/premise:

West 10th Street & Christopher

CONTACT INFORMATION:

Principal(s) Name(s):

Stefan Tomic

Office or Home Address:

[REDACTED]

City, State, Zip: **New York, New York 10014**

Telephone #:

[REDACTED]

email :

[REDACTED]

Landlord Name / Contact:

Citi-Urban Manager

Landlord's Telephone and Fax:

[REDACTED]

NAMES OF ALL PRINCIPAL(s):

Stefan Tomic

NAMES / LOCATIONS OF PAST / CURRENT LICENSES HELD

Briefly describe the proposed operation (i.e. "We are a family restaurant that will focus on..."):

We are a welcoming neighborhood cafe that serves as a vibrant social space where customers can gather, relax and connect. Our focus is on providing high-quality coffee, pastries, and light bites, complemented by a curated selection of beer and wine, that is going to enhance the experience. The atmosphere is warm, inviting and aesthetically lively, making it a peaceful escape for our community.

WHAT TYPE(S) OF LICENSE(S) ARE YOU APPLYING FOR (MARK ALL THAT APPLY):

a new liquor license (Restaurant Tavern / On premise liquor Other)

an UPGRADE of an existing Liquor License

an ALTERATION of an existing Liquor License

a TRANSFER of an existing Liquor License

a HOTEL Liquor License

a DCA CABARET License

a CATERING / CABARET Liquor License

a BEER and WINE License

a RENEWAL of an existing Liquor License

an OFF-PREMISE License (retail)

OTHER : _____

If upgrade, alteration, or transfer, please describe specific nature of changes:

(Please include physical or operational changes including hours, services, occupancy, ownership, etc.)

n/a

If this is for a new application, please list previous use of location for the last 5 years:

Vibrant Coffee opening in June 2024. It was previously a nail salon.

Is any license under the ABC Law currently active at this location? yes no

If yes, what is the name of current / previous licensee, license # and expiration date: _____

Have any other licenses under the ABC Law been in effect in the last 10 years at this location?

yes no

If yes, please list DBA names and dates of operation:

PREMISES:

By what right does the applicant have possession of the premises?

Own Lease Sub-lease Binding Contract to acquire real property other: _____

Type of Building: Residential Commercial Mixed (Res/Com) Other: _____

Number of floor: 5 Year Built : 1868

Describe neighboring buildings:
Mixed Use, Residential

Zoning Designation: R6

Zoning Overlay or Special Designation (applicable) _____

Block and Lot Number: 610 / 27

Does the premise occupy more than one building, zoning lot, tax lot or more than one floor? yes no

Is the premise located in a historic district? yes no

(if yes, have all exterior changes or changes governed by the Landmarks Preservation Commission (LPC) been approved by the LPC? yes no, please explain : n/a

Will any outside area or sidewalk café be used for the sale or consumption of alcoholic beverages? (including sidewalk, roof and yard space) no yes : explain _____

What is the proposed Occupancy? 10

Does the premise currently have a valid Certificate of Occupancy (C of O) and all appropriate permits?
 no yes

If yes, what is the maximum occupancy for the premises? 10

If yes, what is the use group for the premises? _____

If yes, is proposed occupancy permitted? yes no, explain : _____

If your occupancy is 75 or greater, do you plan to apply for Public Assembly permit? yes no

Do you plan to file for changes to the Certificate of Occupancy? yes no
(if yes, please provide copy of application to the NYC DOB)

Will the façade or signage be changed from what currently exist at the premise? no yes

(if yes, please describe: Updated window logo

INTERIOR OF PREMISES:

What is the total licensed square footage of the premises? 435 SF

If more than one floor, please specify square footage by floors: n/a

If there is a sidewalk café, rear yard, rooftop, or outside space, what is the square footage of the area?

If more than one floor, what is the access between floors? n/a

How many entrances are there? 1 How many exits? 1 How many bathrooms? 1

Is there access to other parts of the building? no ___ yes, explain: _____

OVERALL SEATING INFORMATION:

Total number of tables? 8 Total table seats? 18

Total number of bars? 1 Total bar seats? 0

Total number of "other" seats? _____ please explain : _____

Total OVERALL number of seats in Premises : 18

BARs:

How many *stand-up bars / bar seats are being applied for on the premises? Bars 1 Seats 0

How many service bars are being applied for on the premises? 0

Any food counters? no ___ yes, describe : _____

For Alterations and Upgrades:

Please describe all current and existing bars / bar seats and specific changes: _____

n/a

* A stand-up bar is any bar or counter (whether seating or not) over which a member of the public can order, pay for and receive food and alcoholic beverages.

PROPOSED METHOD OF OPERATION:

What type of establishment will this be? (check all that apply)

___ Bar ___ Bar & Food ___ Restaurant ___ Club/ Cabaret ___ Hotel Other: Cafe

What are the Hours of Operation?

Sunday: Monday: Tuesday: Wednesday: Thursday: Friday: Saturday:
8am to 10pm 7am to 10pm 7am to 10pm 7am to 10pm 7am to 10pm 7am to 11pm 8am to 11pm

Will the business employ a manager? ___ no yes, name / experience if known: Stefan Tomic

Will there be security personnel? no ___ yes(if yes, what nights and how many?) _____

Do you have or plan to install French doors, accordion doors or windows that open? no ___ yes

If yes, please describe : _____

Will you have TV's ? no ___ yes (how many?) _____

Type of MUSIC / ENTERTAINMENT: ___ Live Music ___ Live DJ ___ Juke Box Ipod / CDs ___ none

Expected Volume level: Background (quiet) ___ Entertainment level ___ Amplified Music
(check all that apply)

Do you have or plan to install soundproofing? no ___ yes

IF YES, will you be using a professional sound engineer? _____

Please describe your sound system and sound proofing: Four Sonos One SL Speakers

Will you be permitting: ___ promoted events ___ scheduled performances ___ outside promoters

___ any events at which a cover fee is charged? private parties

Do you have plans to manage or address vehicular traffic and crowd control on the sidewalk caused by your establishment? no ___ yes (if yes, please attach plans)

Will you be utilizing ___ ropes ___ movable barriers ___ other outside equipment (describe) _____

Are your premises within 200 feet of any school, church or place of worship? no ___ yes

If there is a school, church or place of worship within 200 feet of your premises or on the same block, please submit a block plot diagram or area map showing its' location in proximity to your applicant premises (no larger than 8 ½ " x 11").

Indicate the distance in feet from the proposed premise:

Name of School / Church: _____

Address: _____ Distance: _____

Name of School / Church: _____

Address: _____ Distance: _____

Name of School / Church: _____

Address: _____ Distance: _____

Please provide contact information for Residents / Community Board and confirm that if complaints are made you will address it immediately.

Contact Person: **Stefan Tomic** Phone: _____

Address: _____

Email : _____

Application submitted on
behalf of the applicant by:

Stefan Tomic

Signature

Print or Type Name **Stefan Tomic**

Title **Member**

Thank you for your cooperation. Please return this questionnaire along with the other required documents as soon as you can. This will expedite your application and avoid any unnecessary delays. Use additional pages if necessary.



Community Board 2,
Manhattan SLA Licensing Committee
Donna Raftery, Co-Chair
Robert Ely, Co-Chair

**8 tables, 18 seats
1 stand-up bar**

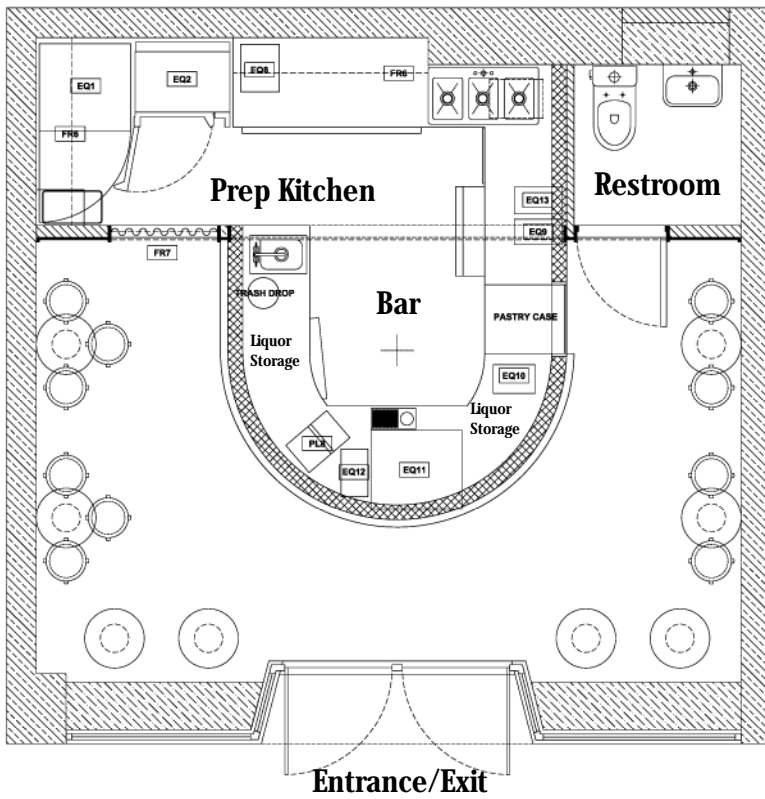

Food menu:

Stake tartar
Tuna tartar
Ceviche
Beet salad
Charcuterie board
Marinated olives
Focaccia, tomatoes, evoo, balsamic toast

Beer:

Lager
Pale Ale
Ale
Pilsner
Brown ale

Drink menu

Wine:

Sauvignon Blanc
Riesling
Pinot Grigio
Chardonnay

Cabernet Sauvignon
Pinot noir
Merlot
Malbec

Rose

Sparkling wine









c



