

Jeanine Kiely, Chair
Susan Kent, First Vice Chair
Valerie De La Rosa, Second Vice Chair
Mark Diller, District Manager



Antony Wong, Treasurer
Amy Brenna, Secretary
Ritu Chattree, Assistant Secretary

Community Board No. 2, Manhattan

3 Washington Square Village
NEW YORK, NY 10012-1899

www.cb2manhattan.org

P: 212-979-2272 F: 212-254-5102 E: info@cb2manhattan .org

Greenwich Village ♦ Little Italy ♦ SoHo ♦ NoHo ♦ Hudson Square ♦ Chinatown ♦ Gansevoort Market

COMMUNITY BOARD 2 APPLICATION FOR A STATE LIQUOR AUTHORITY LICENSE ADDENDUM FOR OUTDOOR SEATING

For a Liquor License Application that includes any outdoor areas, please complete the following:

- Submit a diagram of outdoor seating indicating length and width of area(s) and location of all tables and chairs. Include all obstructions (trees, fire hydrants, proximity to bus stops, bike racks, signs, etc.).
- Submit photos of the premises where the sidewalk café and/or roadbed will be located. Required photos show one frontal, one left and one right side view of proposed sidewalk café and/or roadbed.
 - Photos must show complete sidewalk and/or roadway area where sidewalk café and/or roadbed will be including views to curb and neighboring properties.
 - For rear yard, show photos of yard and surrounding area, including upper view of adjacent buildings.

Name of Applicant: 26 BOND STREET RETAIL LLC

Address of Premises: 26 BOND STREET, NY, NY 10012

Sidewalk café will have no more than (If premises is located on a corner please indicate for both streets):

N/A tables and _____ seats on _____ Street

N/A tables and _____ seats on _____ Street

Hours of sidewalk café: N/A to _____.

Describe any obstructions (trees, fire hydrant, proximity to bus stop, etc): _____

N/A

NYC DOT Open Street Program - Bond Street

Roadbed will have no more than (If premises is located on a corner please indicate for both streets):

7 tables and 18 seats on BOND Street

N/A tables and _____ seats on _____ Street

Hours of roadbed: 4:30pm to 11pm . Mon-Fri | 10am to 11pm Sat-Sun

Describe any obstructions (trees, fire hydrant, proximity to bus stop, etc): 1 treebed on

sidewalk

N/A Rear yard / Rooftop (circle) will have no more than _____ tables and _____ seats

Hours of rear yard / rooftop: _____ to _____.

Does seating extend beyond the business frontage? No ___ Yes

Will outdoor dining structures on the sidewalk be enclosed on three (3) or more sides? N/A No ___ Yes

Will outdoor dining structures on the roadbed be enclosed on three (3) or more sides? No ___ Yes

Is there any outdoor music, speakers or TVs? No ___ Yes, please describe: _____

Will heating elements be used? No ___ Yes, please describe: _____

unenclosed
movable
barriers

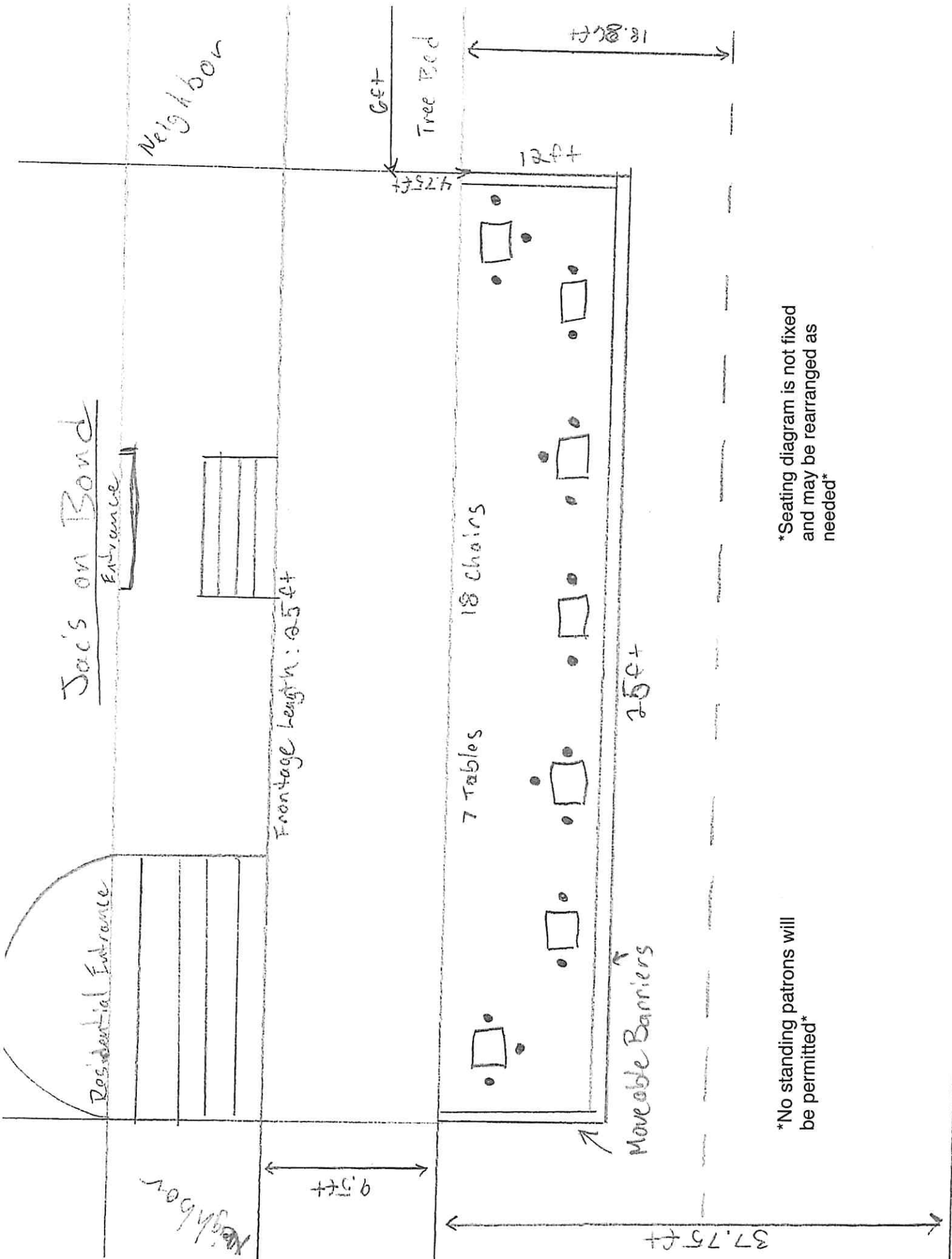

Seating diagram is not fixed and may be rearranged as needed

No standing patrons will be permitted

