



The Church of St. Anthony of Padua

155 Sullivan Street, New
York, NY 10012

**Presentation to Landmarks
Preservation Commission**

2024-05-16



Rimkus is a worldwide provider of engineering and technical consulting to corporations, insurance companies, law firms, and government agencies. Rimkus experts specialize in forensic consulting, dispute resolution and construction management services, solutions for the built environment, and human factors support for the consumer, industrial, and healthcare industries. For almost 40 years, the company's professional engineers, architects, scientists, and technical specialists have been recognized for their commitment to service excellence by local, and international business communities. Rimkus operates more than 110 offices worldwide.

The Church of St. Anthony of Padua – 155 Sullivan Street



North Facade

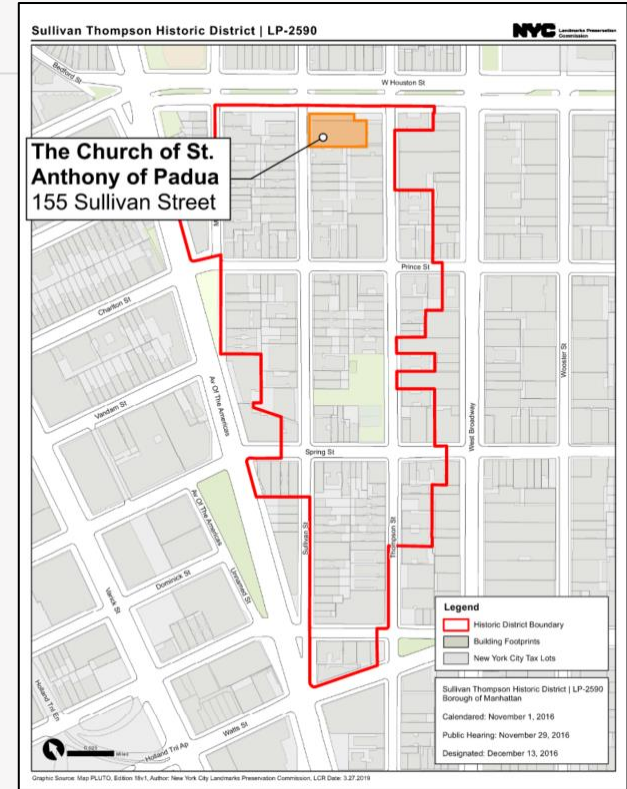

Sullivan Thompson Historic District

Proposed Courtyard

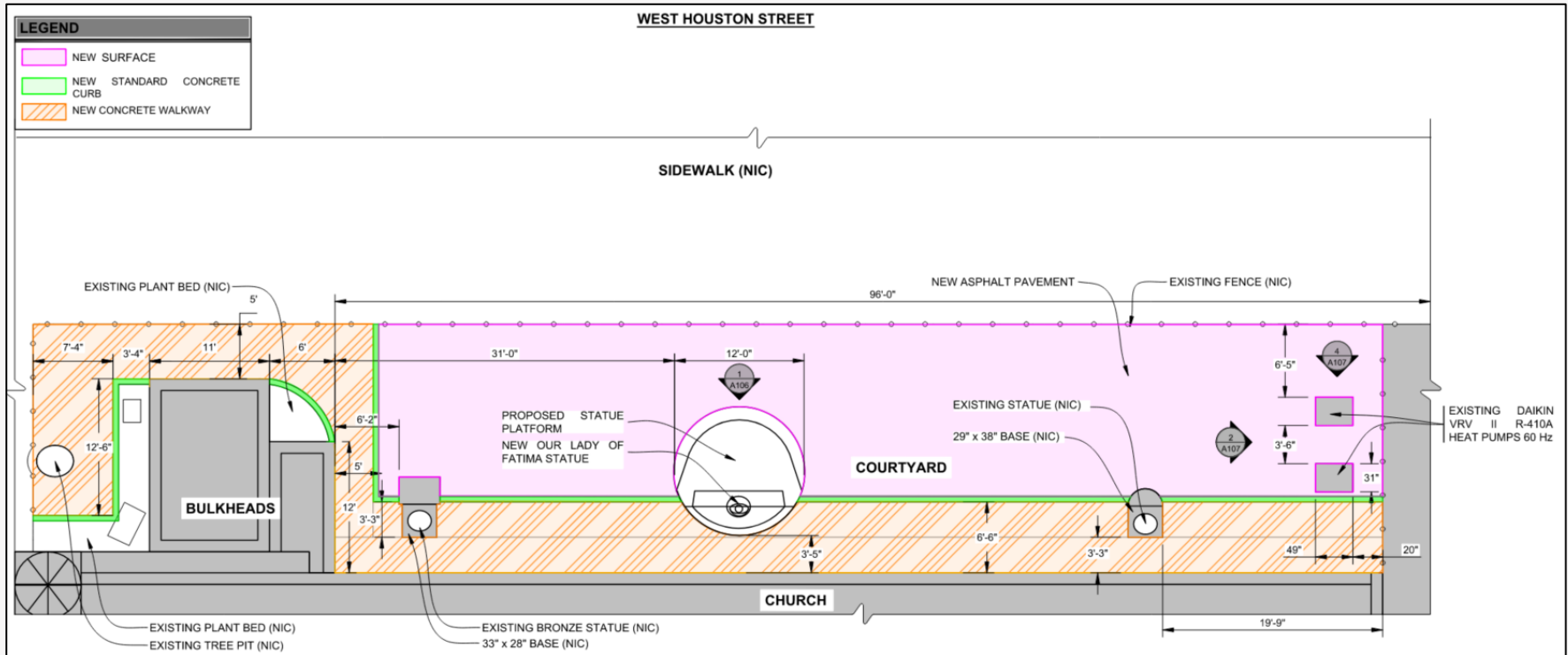

- New, Relocated Statue Base
- New Courtyard Paving and Curbs
- Legalize Existing HVAC Units
- Planter Installation around Existing HVAC Units
- New Sign Installation at Bulkhead

Proposed Courtyard



Sample Paving Pattern



Natural Stone Pavers

New Paving of either Cast Stone or Natural Stone Pavers

Sidewalk Replacement/New Curb

- Replace existing sidewalk and all curbs in kind
- Provide adequate drainage
- Make ADA Code Compliant
- Provide Safe and Smooth Walking Surface
- Potentially installed integrated lighting for statues

Existing Courtyard

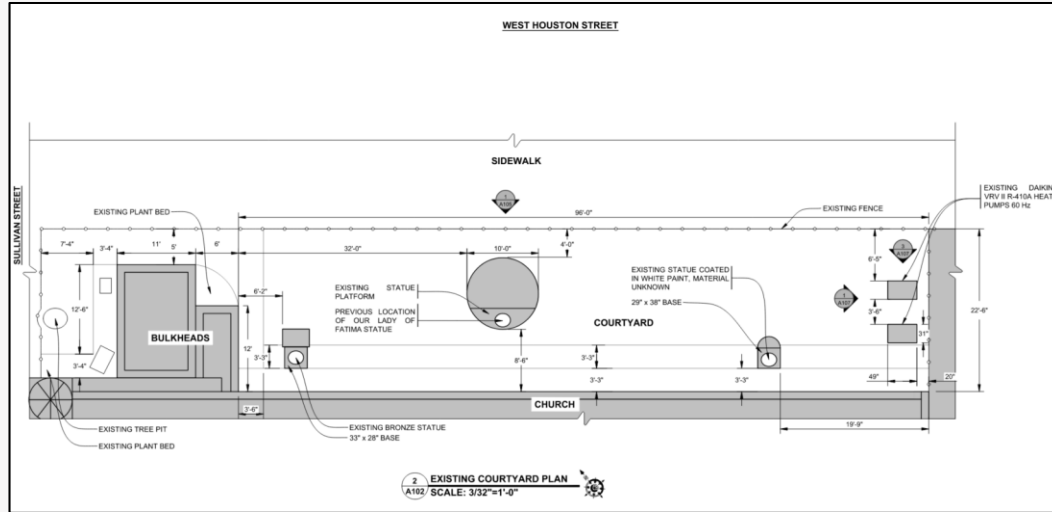

- Existing courtyard – asphalt
- Asphalt to help with pest control
- Asphalt damaged – water pooling
- Potential Tripping hazard
- Existing Courtyard is Unattractive



Existing Statue Vandalized



Existing Statue Vandalized

- Old statue of Our Lady of Fatima Vandalized
- Given desk-level approval to replace statue
- Want to change base as also damaged



Existing Statue Vandalized



Existing Statue Vandalized

Proposed Statue Base



Existing Statue Base Veneer



Traditional Display of Lady of Fatima with Grotto

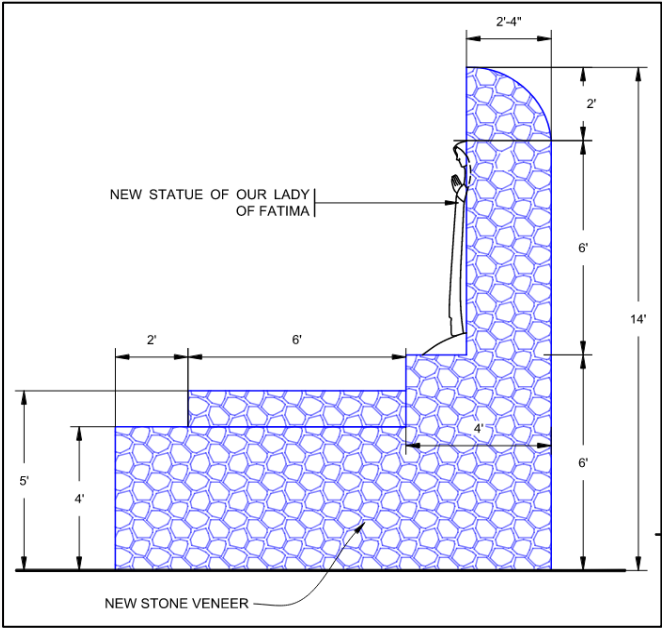
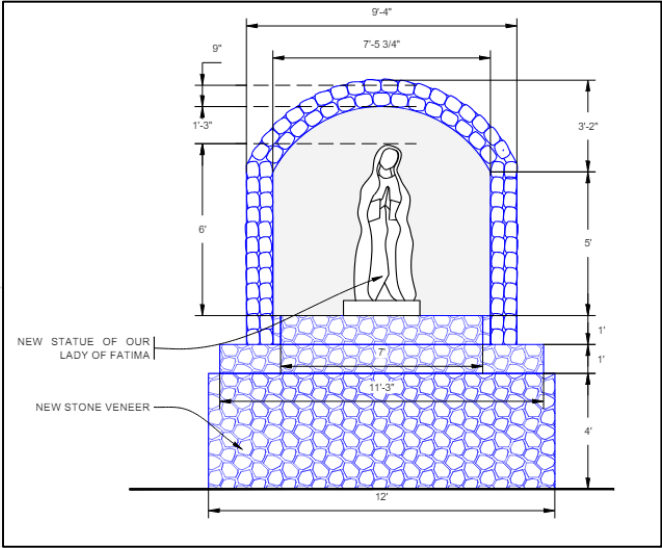

Historic Sign

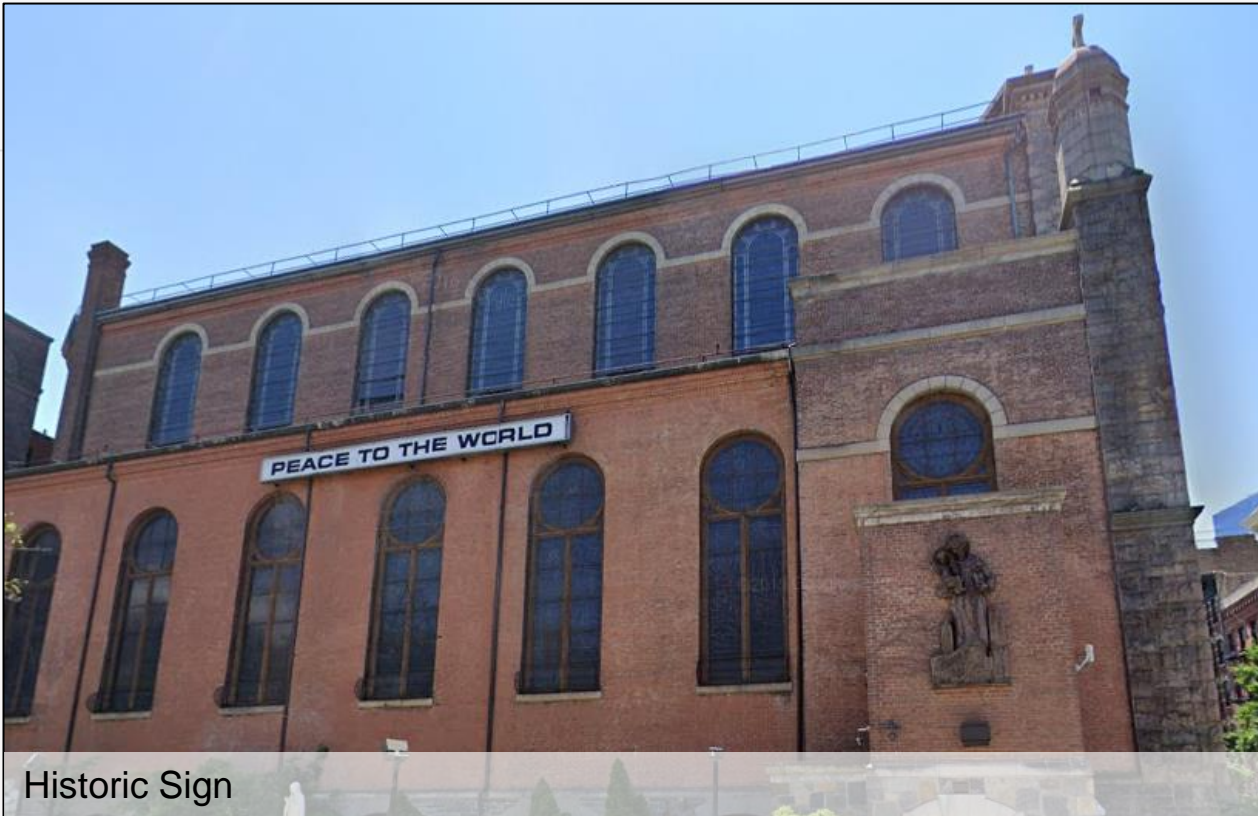

- Removed 2021
- Existing Church cannot be easily identified by a passerby

New Sign

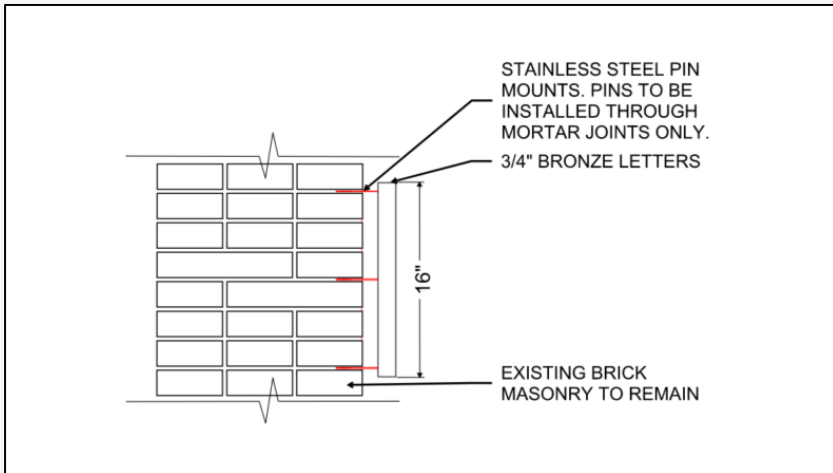
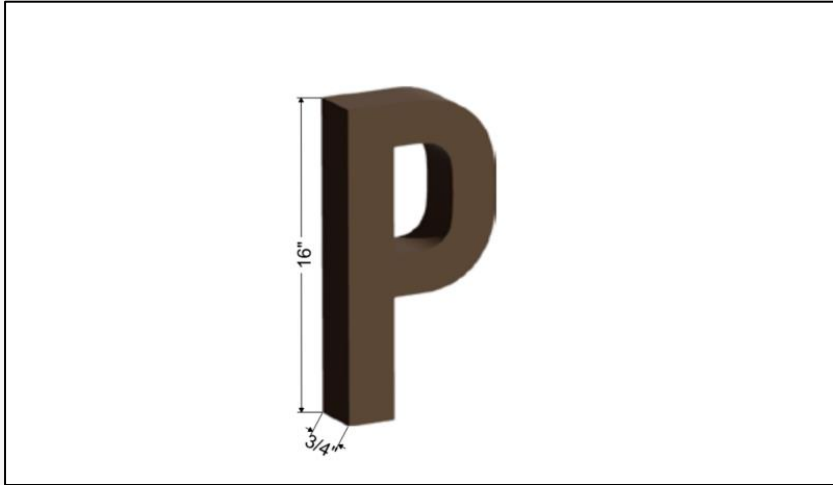

- Remove existing lighting and provide new lighting

HVAC Unit Legalization



- HVAC units previously installed without LPC approval
- Attempting to obtain LPC permit for legalization of Units.
- Can install some planters around units – precedent

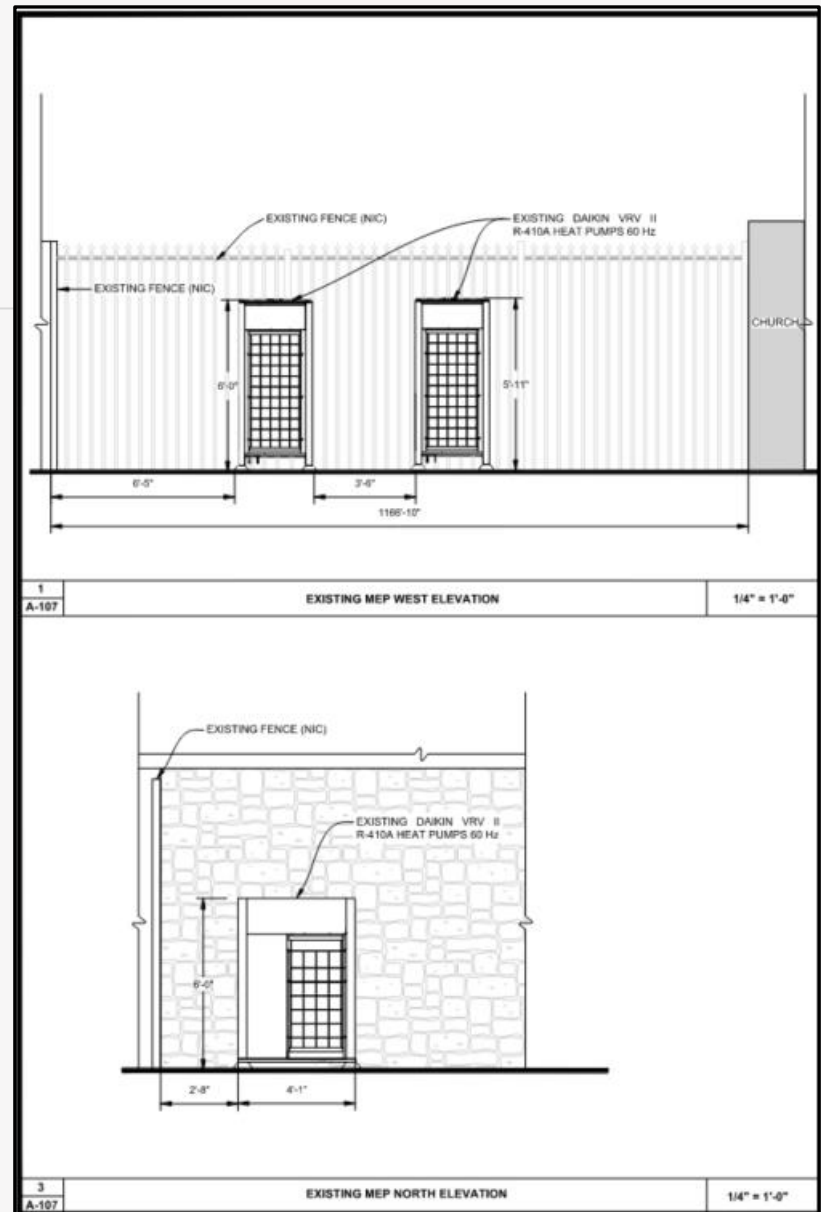

Planter Installation around HVAC Units

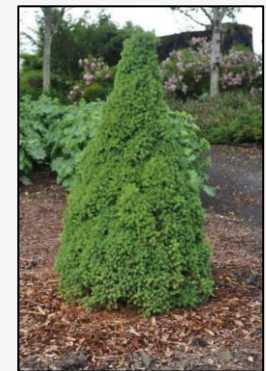
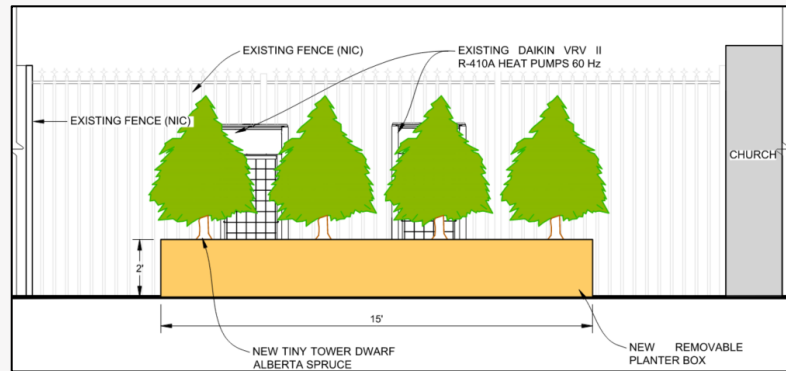
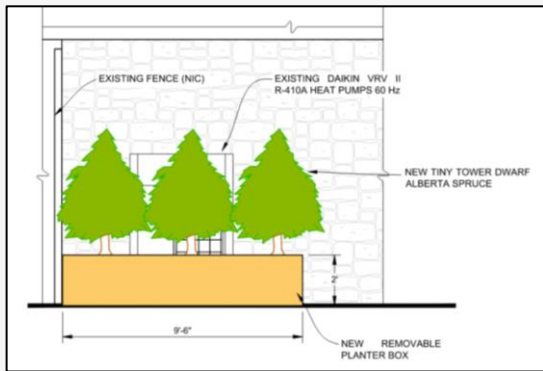
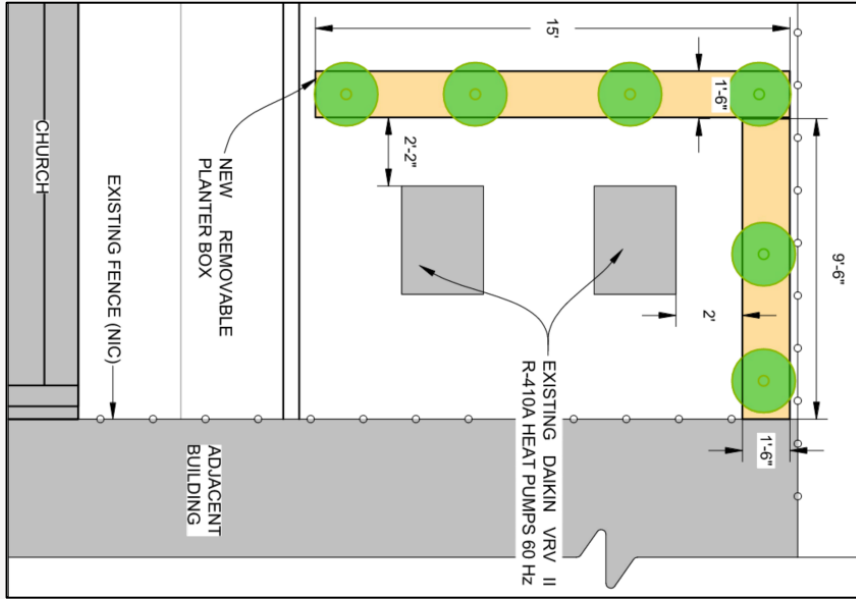



QUESTIONS?

