

Meeting Date: March 2024

APPLICANT INFORMATION:

Name of applicant(s): Great Jones Distillers, LLC

Trade name (DBA): Great Jones Distilling Co.

Premises address: 686 Broadway, New York, NY 10012

Cross Streets and other addresses used for building/premise:
East 4th Street and Great Jones Street

CONTACT INFORMATION:

Principal(s) Name(s): [REDACTED]

Office or Home Address: [REDACTED]

City, State, Zip: [REDACTED]

Telephone #: [REDACTED] email : [REDACTED]

Landlord Name / Contact:
686 Broadway Realty, LLC: [REDACTED] 01 [REDACTED]

Landlord's Telephone and Fax: [REDACTED]

NAMES OF ALL PRINCIPAL(s):	NAMES / LOCATIONS OF PAST / CURRENT LICENSES HELD
<u>Luis Fernando Felix Fernandez, Pres. & CEO</u>	<u>Great Jones Distillers, LLC, 686 Broadway, NY, NY 10012</u>
<u>Dean Mades, Secretary</u>	<u>& Black Dirt Distilling Company, LLC, 385 Glenwood Rd, Pine Island, NY</u>
<u>Proximo Spirits, Inc., Sole Member</u>	<u></u>

Briefly describe the proposed operation (i.e. "We are a family restaurant that will focus on..."):
We are a craft distillery, restaurant and bar with a small retail shop, first established in August 2020, which promotes
and features NYS craft made liquor and related agricultural products. While our retail shop will continue to sell exclusively
NYS-labeled products, we intend to complement our on-premise food and beverage offering with a full beverage menu
that includes non-NYS labeled products as well.

WHAT TYPE(S) OF LICENSE(S) ARE YOU APPLYING FOR (MARK ALL THAT APPLY):

a new liquor license (Restaurant Tavern / On premise liquor Other)

an UPGRADE of an existing Liquor License

an ALTERATION of an existing Liquor License

a TRANSFER of an existing Liquor License

a HOTEL Liquor License

a DCA CABARET License

a CATERING / CABARET Liquor License

a BEER and WINE License

a RENEWAL of an existing Liquor License

an OFF-PREMISE License (retail)

OTHER : _____

If upgrade, alteration, or transfer, please describe specific nature of changes:

(Please include physical or operational changes including hours, services, occupancy, ownership, etc.)

N/A

If this is for a new application, please list previous use of location for the last 5 years:

Applicant has been operating as a licensed craft distillery with restaurant and small retail shop since 2020.

Is any license under the ABC Law currently active at this location? yes no

If yes, what is the name of current / previous licensee, license # and expiration date: _____

Great Jones Distillers, LLC; Combined Manufacturer SN 1304035; Exp. 5/31/2025.

Have any other licenses under the ABC Law been in effect in the last 10 years at this location?

yes no

If yes, please list DBA names and dates of operation:

N/A

PREMISES:

By what right does the applicant have possession of the premises?

Own Lease Sub-lease Binding Contract to acquire real property other: _____

Type of Building: Residential Commercial Mixed (Res/Com) Other: _____

Number of floor: 5 Year Built : 1951

Describe neighboring buildings:

_____ Residential and Mixed Use _____

Zoning Designation: M1-5B

Zoning Overlay or Special Designation (applicable) Special Mixed Use District

Block and Lot Number: 531 / 3

Does the premise occupy more than one building, zoning lot, tax lot or more than one floor? yes no

Is the premise located in a historic district? yes no

(if yes, have all exterior changes or changes governed by the Landmarks Preservation Commission (LPC) been approved by the LPC? yes no, please explain : Approval pending

Will any outside area or sidewalk café be used for the sale or consumption of alcoholic beverages? (including sidewalk, roof and yard space) no yes : explain _____

What is the proposed Occupancy? 288 (restaurant/bar areas only)

Does the premise currently have a valid Certificate of Occupancy (C of O) and all appropriate permits?

no yes

If yes, what is the maximum occupancy for the premises? 538 (entire building)

If yes, what is the use group for the premises? 6

If yes, is proposed occupancy permitted? yes no, explain : _____

If your occupancy is 75 or greater, do you plan to apply for Public Assembly permit? yes no

Do you plan to file for changes to the Certificate of Occupancy? yes no
(if yes, please provide copy of application to the NYC DOB)

Will the façade or signage be changed from what currently exist at the premise? no yes

(if yes, please describe: _____

INTERIOR OF PREMISES:

What is the total licensed square footage of the premises? 3,977 sq. ft.

Basement	648	Second Floor	665
First Floor	1,775	Third Floor	889

If more than one floor, please specify square footage by floors: Basement 648 Second Floor 665
First Floor 1,775 Third Floor 889

If there is a sidewalk café, rear yard, rooftop, or outside space, what is the square footage of the area?

N/A

If more than one floor, what is the access between floors? Stairs and elevators (accessible per ADA)

How many entrances are there? 2 How many exits? 4 How many bathrooms? 14

Is there access to other parts of the building? no X yes, explain: Tours into distillery bonded area from lobby.

OVERALL SEATING INFORMATION:*

Total number of tables? 38 Total table seats? 128

*Please see attached chart for breakdown by floor.

Total number of bars? 3 Total bar seats? 25

Total number of "other" seats? N/A please explain : _____

Total OVERALL number of seats in Premises : 165

BARS:

How many *stand-up bars / bar seats are being applied for on the premises? Bars 3 Seats 25

How many service bars are being applied for on the premises? 1

Any food counters? X no yes, describe : _____

For Alterations and Upgrades:

Please describe all current and existing bars / bar seats and specific changes: N/A

* A stand-up bar is any bar or counter (whether seating or not) over which a member of the public can order, pay for and receive food and alcoholic beverages.

PROPOSED METHOD OF OPERATION:

What type of establishment will this be? (check all that apply)

Bar X Bar & Food X Restaurant Club/ Cabaret Hotel Other: _____

What are the Hours of Operation?

Sunday: Monday: Tuesday: Wednesday: Thursday: Friday: Saturday:

11 am to 2 am 11 am to 2 am 11 am to 2 am 11 am to 2 am 11 am to 2 am 11 am to 2 am 11 am to 2 am

Will the business employ a manager? no yes, name / experience if known : _____

Will there be security personnel? no yes (if yes, what nights and how many?) _____

Appropriate security personnel will be hired for private and special events as needed.

Do you have or plan to install French doors, accordion doors or windows that open? no yes

If yes, please describe : Operable windows on the 2nd floor and 3rd floor levels.

Will you have TV's ? no yes (how many?) _____

Type of MUSIC / ENTERTAINMENT: Live Music Live DJ Juke Box Ipod / CDs none

Expected Volume level: Background (quiet) Entertainment level Amplified Music
(check all that apply)

*Applies to private or special events only.

Do you have or plan to install soundproofing? no yes

IF YES, will you be using a professional sound engineer? Yes

Please describe your sound system and sound proofing: _____

For the sound system, home grade speakers are laid into the ceilings (typically 4 per floor, except first floor has 12). Music is only ambient and volume does not surpass city code limits. There are "limiters" on the speakers to ensure this, and the type of speaker itself does not allow for powerful sound.

Electronic music system provides music playlist. There is soundproofing on either side of the building. In particular, special soundproofing material was embedded in the walls as part of the renovation to absorb vibrations, which is best practice and goes beyond city ordinance requirements.

Will you be permitting: promoted events scheduled performances outside promoters

any events at which a cover fee is charged? private parties

Do you have plans to manage or address vehicular traffic and crowd control on the sidewalk caused by your establishment? no yes (if yes, please attach plans)

*2017 traffic report concluded that there would be no adverse impact on roadway or sidewalk usage. Traffic report available upon request.

Will you be utilizing ropes movable barriers other outside equipment (describe) _____

None of the above.

Are your premises within 200 feet of any school, church or place of worship? no yes

If there is a school, church or place of worship within 200 feet of your premises or on the same block, please submit a block plot diagram or area map showing its' location in proximity to your applicant premises (no larger than 8 ½ " x 11").

Indicate the distance in feet from the proposed premise:

Name of School / Church: N/A

Address: _____ Distance: _____

Name of School / Church: _____

Address: _____ Distance: _____

Name of School / Church: _____

Address: _____ Distance: _____

Please provide contact information for Residents / Community Board and confirm that if complaints are made you will address it immediately.

Contact Person: Andrew Albigese Phone: [REDACTED]

Address: 686 Broadway, New York, NY 10012

Email: [REDACTED]

Application submitted on behalf of the applicant by:

Signature

Print or Type Name Dean Mades

Title Secretary

Thank you for your cooperation. Please return this questionnaire along with the other required documents as soon as you can. This will expedite your application and avoid any unnecessary delays. Use additional pages if necessary.





Community Board 2,
Manhattan SLA Licensing Committee
Donna Raftery, Co-Chair
Robert Ely, Co-Chair

Great Jones Distillers, LLC d/b/a Great Jones Distilling Co.
 Application for On-Premises Liquor License (Manufacturer's)
 686 Broadway, New York, NY 10012
 Diagrams of the Premises

FIRST FLOOR

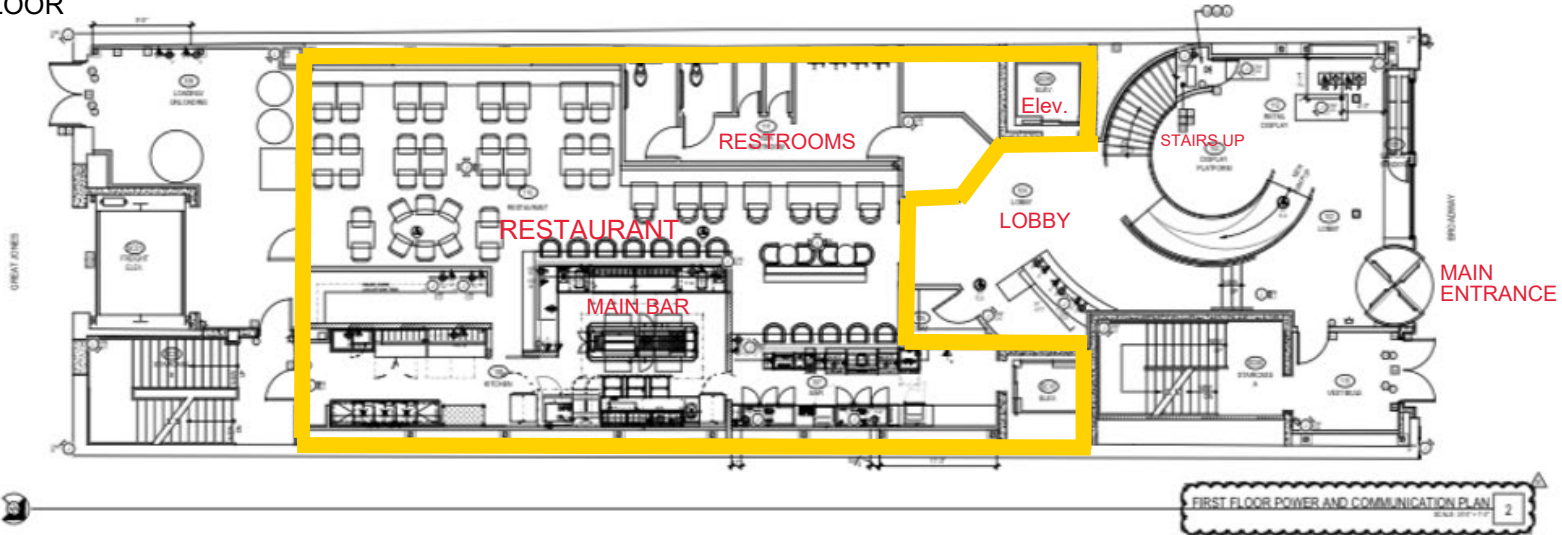

CELLAR

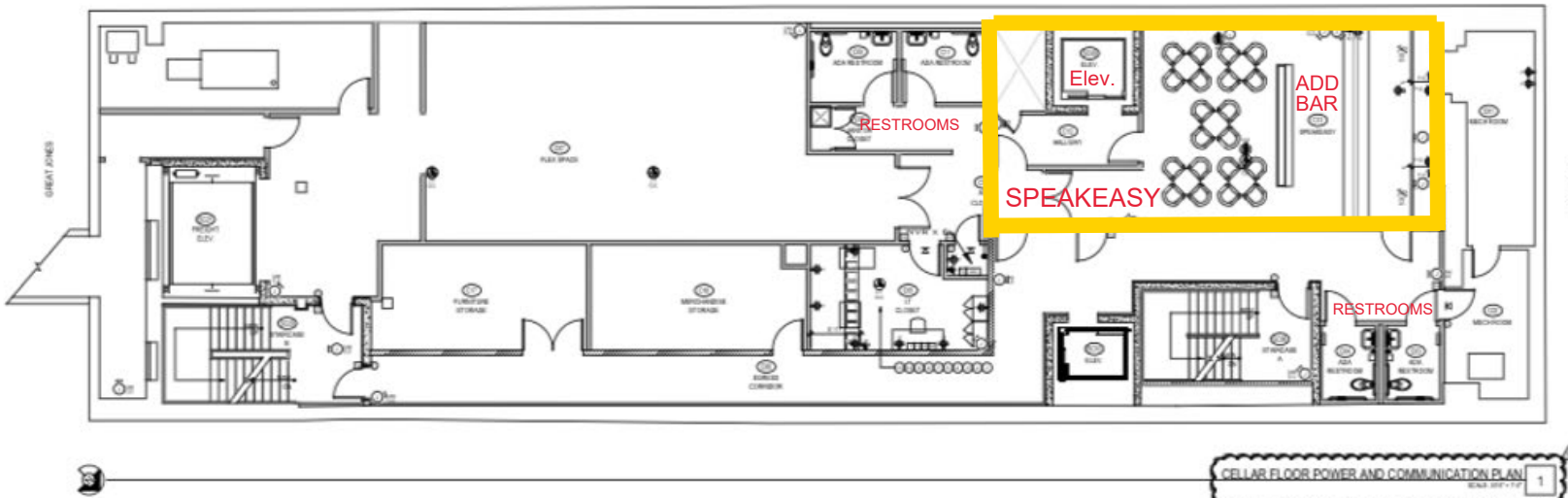

Evolve
Architecture & Design

ert design group

532 BROADHOLLOW ROAD,
SUITE 139
MELVILLE, NY 11747

PROJECT NO.	18043
DATE	01/05/18
DESIGNER	JC
CHECKER	TB/JC
DATE	31 OF 185

CONSULTANTS:
 SOLID ENGINEERING
 SOLID ENGINEERING SERVICES PC
 DATE: 01/05/18
 PROJECT: 18043
 DESIGNER: JC
 CHECKER: TB/JC
 DATE: 31 OF 185

IN CONSIDERATION OF RECORDS CHANGES FROM SOLID ARCHITECTURE & DESIGN AND SOLID DESIGN GROUP AS AN ELECTRONIC FILE THE INFORMATION TO THE FOLLOWING IS PRINTED BY LAW TO VALID WAREHOUSE AND NEARBY WAREHOUSE ARCHITECTURE & DESIGN AND SOLID DESIGN GROUP FROM ALL CLEAR, UNLIMITED, LOANS, SHARING AND COPY, INCLUDING, BUT NOT LIMITED TO, ATTORNEY'S FEE ARISING OUT OF OR IN ANY MANNER CONNECTED WITH THE USE OF THIS INFORMATION OR REPRODUCTION OF THE INFORMATION BY SOLID ARCHITECTURE & DESIGN AND SOLID DESIGN GROUP UNDER THIS AGREEMENT.

THE GREAT JONES DISTILLERY
 686 BROADWAY
 NEW YORK, NY 10012

ALL DESIGN, DEVELOPMENT AND PLANS CREATED OR REPRESENTED BY THE DESIGNER AND THE PROPERTY OF THE DESIGNER ARE HEREBY GRANTED FOR USE IN THE SPECIFIC PROJECT. USE OF THESE DRAWINGS FOR OTHER PROJECTS OR REVISIONS OF PLANS MAY BE SUBJECT TO CHARGES TO THE PROJECTOR OR REVISIONS OF PLANS MAY BE SUBJECT TO CHARGES TO THE PROJECTOR. THE FULL AND COMPLETE PERMISSION OF THE DESIGNER IS REQUIRED FOR ANY REVISIONS OF PLANS OR CHANGES TO THE PROJECT.

PROJECT BY:
 GREAT JONES DISTILLING CO
 686 BROADWAY
 NEW YORK, NY 10012

SHEET TITLE:
 CELLAR & FIRST FLOOR
 POWER AND
 COMMUNICATION PLAN

SHEET NO.
 A-314.00

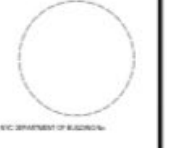

Great Jones Distillers, LLC d/b/a Great Jones Distilling Co.
 Application for On-Premises Liquor License (Manufacturer's)
 686 Broadway, New York, NY 10012
 Diagrams of the Premises

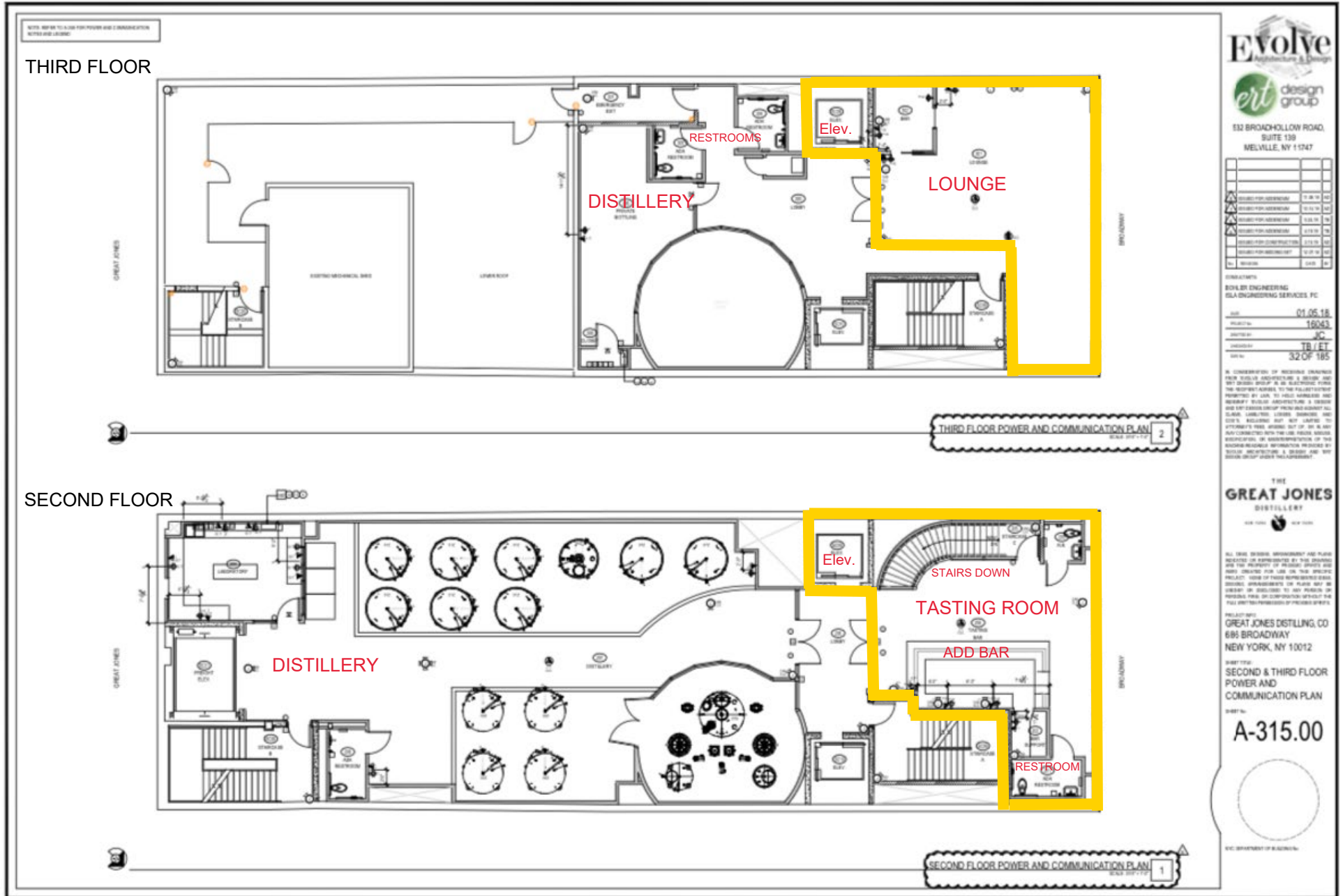

Evolve
 Architecture & Design

ert design group

532 BROADHOLLOW ROAD,
 SUITE 130
 MELVILLE, NY 11747

NO.	DESCRIPTION	DATE
1	ISSUED FOR PERMITTING	01.05.18
2	ISSUED FOR PERMITTING	01.05.18
3	ISSUED FOR PERMITTING	01.05.18
4	ISSUED FOR PERMITTING	01.05.18
5	ISSUED FOR PERMITTING	01.05.18
6	ISSUED FOR PERMITTING	01.05.18
7	ISSUED FOR PERMITTING	01.05.18
8	ISSUED FOR PERMITTING	01.05.18
9	ISSUED FOR PERMITTING	01.05.18
10	ISSUED FOR PERMITTING	01.05.18

EVOLVED BY:
 EVOLVE ENGINEERING
 ELECTRICAL ENGINEERING SERVICES, P.C.
 DATE: 01.05.18
 PROJECT: 16043
 DRAWN BY: JC
 CHECKED BY: TB/ET
 SHEET NO: 32 OF 185

IN CONSIDERATION OF RECEIVING COMPENSATION FROM EVOLVE ARCHITECTURE & DESIGN AND ERT DESIGN GROUP AS AN ELECTRICIAN FROM THE PROJECT ABOVE, TO THE FULLEST EXTENT PERMITTED BY LAW, TO HOLD, HOLDERS AND RECEIVERS, EVOLVE ARCHITECTURE & DESIGN AND ERT DESIGN GROUP HEREBY WAIVES ALL CLAIMS, DAMAGES, LOSSES, REPAIRS AND COSTS INCLUDING REASONABLE ATTORNEY'S FEES, ARISING OUT OF OR IN ANY WAY CONNECTED WITH THE USE, REUSE, REPRODUCTION, OR MISREPRODUCTION OF THE ARCHITECTURAL INFORMATION PROVIDED BY EVOLVE ARCHITECTURE & DESIGN AND ERT DESIGN GROUP UNDER THIS AGREEMENT.

THE GREAT JONES DISTILLERY
 NEW YORK, NY

ALL DATE DESIGN, REVISIONS AND PLANS SELECTED OR REPRESENTED BY THIS DRAWING ARE THE PROPERTY OF EVOLVE ENGINEERING AND ERT DESIGN GROUP. ANY REUSE OR REPRODUCTION OF THIS DRAWING WITHOUT THE WRITTEN PERMISSION OF EVOLVE ENGINEERING AND ERT DESIGN GROUP IS STRICTLY PROHIBITED.

PROJECT NO:
 GREAT JONES DISTILLING, CO
 686 BROADWAY
 NEW YORK, NY 10012

SHEET TITLE:
 SECOND & THIRD FLOOR
 POWER AND
 COMMUNICATION PLAN

SHEET NO:
A-315.00

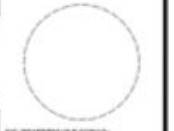

ELECTRIC ENGINEERING

Great Jones Distillers, LLC d/b/a Great Jones Distilling Co.
Application for On-Premises Liquor License (Manufacturer's)
686 Broadway, New York, NY 10012
Diagrams of the Premises

SUBCELLAR

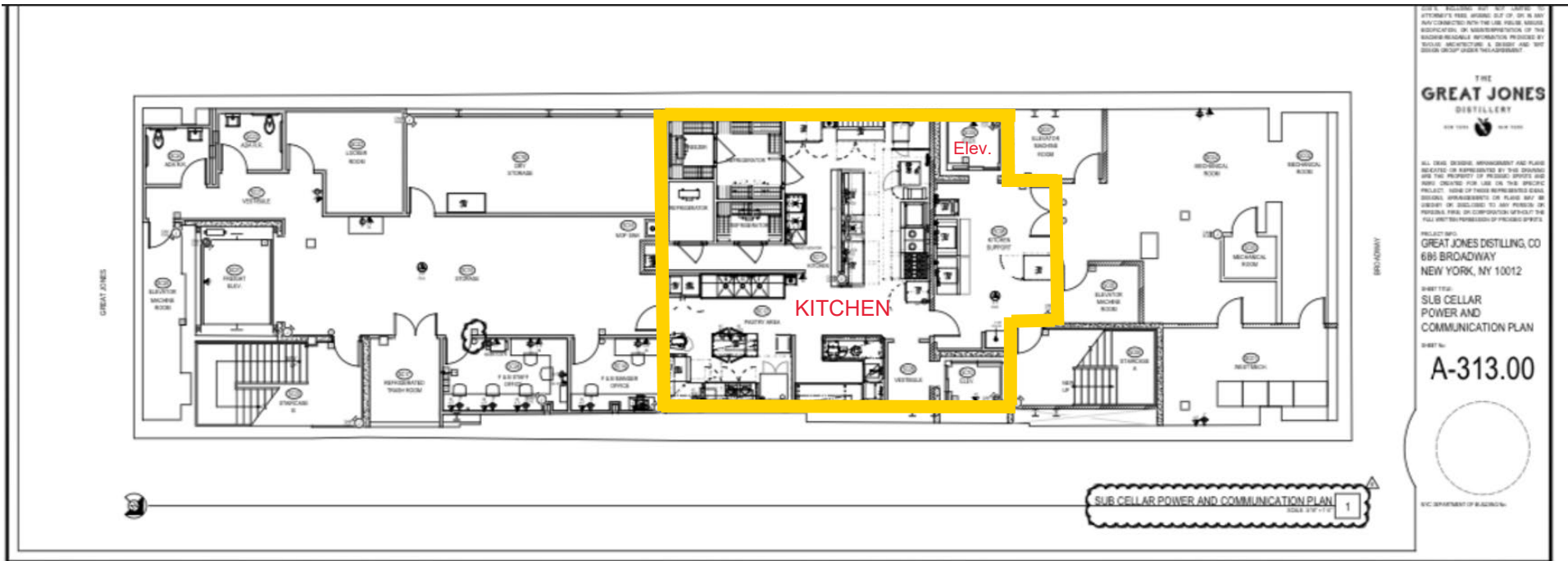



Menu

BITES

HOUSE MADE MILK BREAD • Honey Butter • \$14

HOUSE MADE PICKLES • Red Onions • \$8

EAST COAST OYSTERS • Blue Point Oysters, Radish Mignonette • \$26 / \$52

CRUDO • Yellowfin Tuna, Piquillo Pepper, Capers Vinaigrette • \$16

SALMON RILLETTE • Atlantic Salmon, Toasted Anadama • \$16

CROQUETTES • Confit Duck, Calabrian Chile Aioli • \$18

BARREL SMOKED RIBS • Berkshire Pork, Spiced Bourbon Glaze • \$32 / \$49

SMALL

LOCAL BURRATA • Jersey Girl Burrata, Charred Tomato, Pesto, Arugula (VG) • \$24

CHOPPED SALAD • Little Gem, Radicchio, Buttermilk Dressing • \$18

BEET SALAD • Roasted Beets, Blue Cheese, Avocado (GF) • \$21

ROASTED PRAWNS • Confit Garlic - Ancho Chili Butter • \$25

SHORT RIB • Red Wine Braised Short Ribs, Root Vegetables, Natural Jus • \$26

PASTA • Truffle Glazed Tagliatelle (V) • \$25/\$29

LARGE

BURGER • Red Wine Braised Onions, Applewood Smoked Bacon, Cheddar Cheese, House Pickle • \$31

Add Blue Cheese \$3

SALMON • Faroe Island Salmon, Cucumber, Lemon, Tomato, Olive • \$34

BRANZINO • Haricots Verts, Lemon Brown Butter (GF) • \$34

CHICKEN • Soy Roasted Green Circle, Roasted Brussels Sprouts (GF) • \$36

DUCK • Long Island Duck Breast, Roasted Broccolini, Confit Croquette • \$43

LAMB • Braised Lamb Shank, French Bean Cassoulet (GF) • \$44

STEAK • Hanger Steak, Wild Mushrooms, Cipollini Onions (GF) • \$43

BOLOGNESE • Seasonal Mushrooms, Tomato, Basil, Gnocchette (VVG) • \$24

SIDES

POTATO PATE • Brown Butter, Grana Padano, Truffle Aioli (VG) • \$15

BRUSSELS SPROUTS • Pickled Red Onions, Parmesan Cheese (GF) • \$15

SPINACH AND ARTICHOKE • Toasted Anadama • \$22

Thoroughly cooking foods of animal origin, including but not limited to beef, eggs, fish, lamb, milk, poultry, or seafood reduces the risk of foodborne illness. Young children, the elderly and individuals with certain health conditions may be at a higher risk if these foods are consumed raw or undercooked.