

Meeting Date: _____

APPLICANT INFORMATION:

Name of applicant(s):

Talum LLC

Trade name (DBA):

Kanpai

Premises address:

183 Grand Street, New York, NY 10013

Cross Streets and other addresses used for building/premise:

Mulberry and Baxter

CONTACT INFORMATION:

Principal(s) Name(s):

Scott Edington

Office or Home Address: _____

City, State, Zip: _____

Telephone #: _____

email : _____

Landlord Name / Contact:

Jared Minc

Landlord's Telephone and Fax: _____

NAMES OF ALL PRINCIPAL(s):

NAMES / LOCATIONS OF PAST / CURRENT LICENSES HELD

Scott Edington

n/a

Jonathan Ross

n/a

Faris Ghareeb

n/a

Briefly describe the proposed operation (i.e. "We are a family restaurant that will focus on..."):

High end sushi restaurant with mainly seating at the sushi bar.

WHAT TYPE(S) OF LICENSE(S) ARE YOU APPLYING FOR (MARK ALL THAT APPLY):

a new liquor license (Restaurant Tavern / On premise liquor Other)

an UPGRADE of an existing Liquor License

an ALTERATION of an existing Liquor License

a TRANSFER of an existing Liquor License

a HOTEL Liquor License

a DCA CABARET License

a CATERING / CABARET Liquor License

a BEER and WINE License

a RENEWAL of an existing Liquor License

an OFF-PREMISE License (retail)

OTHER : _____

If upgrade, alteration, or transfer, please describe specific nature of changes:

(Please include physical or operational changes including hours, services, occupancy, ownership, etc.)

If this is for a new application, please list previous use of location for the last 5 years:

Retail Store

Is any license under the ABC Law currently active at this location? yes no

If yes, what is the name of current / previous licensee, license # and expiration date: _____

Have any other licenses under the ABC Law been in effect in the last 10 years at this location?

yes no

If yes, please list DBA names and dates of operation:

PREMISES:

By what right does the applicant have possession of the premises?

Own Lease Sub-lease Binding Contract to acquire real property other: _____

Type of Building: Residential Commercial Mixed (Res/Com) Other: _____

Number of floor: 3 plus basement Year Built : 1971

Describe neighboring buildings:

Mixed buildings with businesses on ground floor and residential units upstairs

Zoning Designation: Mixed

Zoning Overlay or Special Designation (applicable) _____

Block and Lot Number: 236 / 17

Does the premise occupy more than one building, zoning lot, tax lot or more than one floor? yes no

Is the premise located in a historic district? yes no

(if yes, have all exterior changes or changes governed by the Landmarks Preservation Commission (LPC) been approved by the LPC? yes no, please explain : _____

Will any outside area or sidewalk café be used for the sale or consumption of alcoholic beverages? (including sidewalk, roof and yard space) no yes : explain Sidewalk cafe with 8 seats and backyard patio with 16 seats

What is the proposed Occupancy? _____

Does the premise currently have a valid Certificate of Occupancy (C of O) and all appropriate permits?

no yes

If yes, what is the maximum occupancy for the premises? 75

If yes, what is the use group for the premises? 6

If yes, is proposed occupancy permitted? yes no, explain : _____

If your occupancy is 75 or greater, do you plan to apply for Public Assembly permit? yes no

Do you plan to file for changes to the Certificate of Occupancy? yes no
(if yes, please provide copy of application to the NYC DOB)

Will the façade or signage be changed from what currently exist at the premise? no yes

(if yes, please describe: _____

INTERIOR OF PREMISES:

What is the total licensed square footage of the premises? Approximately 2,000 Square Feet

If more than one floor, please specify square footage by floors: 1st Floor - 1,600 Square Feet
Basement 400 Square feet

If there is a sidewalk café, rear yard, rooftop, or outside space, what is the square footage of the area?

If more than one floor, what is the access between floors? Stairs

How many entrances are there? 1 How many exits? 2 How many bathrooms? 1

Is there access to other parts of the building? no yes, explain: _____

OVERALL SEATING INFORMATION:

Total number of tables? 3 Total table seats? 12

Total number of bars? 1 Total bar seats? 30

Total number of "other" seats? 24 please explain: Outdoor seating

Total OVERALL number of seats in Premises: 66

BARs:

How many *stand-up bars / bar seats are being applied for on the premises? Bars 1 Seats 30

How many service bars are being applied for on the premises? 0

Any food counters? no yes, describe: The bar will serve as a sushi bar

For Alterations and Upgrades:

Please describe all current and existing bars / bar seats and specific changes: _____

* A stand-up bar is any bar or counter (whether seating or not) over which a member of the public can order, pay for and receive food and alcoholic beverages.

PROPOSED METHOD OF OPERATION:

What type of establishment will this be? (check all that apply)

Bar Bar & Food Restaurant Club/ Cabaret Hotel Other: _____

What are the Hours of Operation?

Sunday: Monday: Tuesday: Wednesday: Thursday: Friday: Saturday:
10a to 2am 10a to 2am 10a to 2am 10a to 2am 10a to 2am 10a to 2am 10a to 2am

Will the business employ a manager? no yes, name / experience if known : n/a

Will there be security personnel? no yes(if yes, what nights and how many?) _____

Do you have or plan to install French doors, accordion doors or windows that open? no yes

If yes, please describe : _____

Will you have TV's ? no yes (how many?) _____

Type of MUSIC / ENTERTAINMENT: Live Music Live DJ Juke Box Ipod / CDs none

Expected Volume level: Background (quiet) Entertainment level Amplified Music
(check all that apply)

Do you have or plan to install soundproofing? no yes

IF YES, will you be using a professional sound engineer? _____

Please describe your sound system and sound proofing: _____

Will you be permitting: promoted events scheduled performances outside promoters

any events at which a cover fee is charged? private parties

Do you have plans to manage or address vehicular traffic and crowd control on the sidewalk caused by your establishment? no yes (if yes, please attach plans)

Will you be utilizing ropes movable barriers other outside equipment (describe) _____

Are your premises within 200 feet of any school, church or place of worship? no yes

If there is a school, church or place of worship within 200 feet of your premises or on the same block, please submit a block plot diagram or area map showing its' location in proximity to your applicant premises (no larger than 8 ½ " x 11").

Indicate the distance in feet from the proposed premise:

Name of School / Church: _____

Address: _____ Distance: _____

Name of School / Church: _____

Address: _____ Distance: _____

Name of School / Church: _____

Address: _____ Distance: _____

Please provide contact information for Residents / Community Board and confirm that if complaints are made you will address it immediately.

Contact Person: Scott Edington Phone: _____

Address: _____

Email : _____

Application submitted on
behalf of the applicant by:

ID jU9ptjAKj9taRryXVg28zNfm

Signature

Print or Type Name Kenneth E. Belkin, Esq.

Title Attorney

Thank you for your cooperation. Please return this questionnaire along with the other required documents as soon as you can. This will expedite your application and avoid any unnecessary delays. Use additional pages if necessary.





Community Board 2,
Manhattan SLA Licensing Committee
Donna Raftery, Co-Chair
Robert Ely, Co-Chair

Jeanine Kiely, *Chair*
Susan Kent, *First Vice Chair*
Valerie De La Rosa, *Second Vice Chair*
Mark Diller, *District Manager*



Antony Wong, *Treasurer*
Amy Brenna, *Secretary*
Ritu Chattree, *Assistant Secretary*

Community Board No. 2, Manhattan

3 Washington Square Village
NEW YORK, NY 10012-1899
www.cb2manhattan.org

P: 212-979-2272 F: 212-254-5102 E: info@cb2manhattan.org

Greenwich Village ♦ Little Italy ♦ SoHo ♦ NoHo ♦ Hudson Square ♦ Chinatown ♦ Gansevoort Market

COMMUNITY BOARD 2 APPLICATION FOR A STATE LIQUOR AUTHORITY LICENSE ADDENDUM FOR OUTDOOR SEATING

For a Liquor License Application that includes any outdoor areas, please complete the following:

- Submit a diagram of outdoor seating indicating length and width of area(s) and location of all tables and chairs. Include all obstructions (trees, fire hydrants, proximity to bus stops, bike racks, signs, etc.).
- Submit photos of the premises where the sidewalk café and/or roadbed will be located. Required photos show one frontal, one left and one right side view of proposed sidewalk café and/or roadbed.
 - Photos must show complete sidewalk and/or roadway area where sidewalk café and/or roadbed will be including views to curb and neighboring properties.
 - For rear yard, show photos of yard and surrounding area, including upper view of adjacent buildings.

Name of Applicant: Talum LLC

Address of Premises: 183 Grand Street, New York, NY 10013

Sidewalk café will have no more than *(If premises is located on a corner please indicate for both streets):*

4 tables and 8 seats on Grand Street

 tables and seats on Street

Hours of sidewalk café: 10a to 12a .

Describe any obstructions (trees, fire hydrant, proximity to bus stop, etc):

Roadbed will have no more than *(If premises is located on a corner please indicate for both streets):*

 tables and seats on Street

 tables and seats on Street

Hours of roadbed: to .

Describe any obstructions (trees, fire hydrant, proximity to bus stop, etc):

Rear yard / Rooftop (circle) will have no more than 4 tables and 16 seats

Hours of rear yard / rooftop: 10a to 12a .

Does seating extend beyond the business frontage? No Yes

Will outdoor dining structures **on the sidewalk** be enclosed on three (3) or more sides? No X Yes

Will outdoor dining structures **on the roadbed** be enclosed on three (3) or more sides? No Yes

Is there any outdoor music, speakers or TVs? XNo Yes, please describe:

Will heating elements be used? No X Yes, please describe: Two Heat Lamps if any

First Floor Interior Diagram

Talum LLC
183 Grand Street
New York, NY 10013

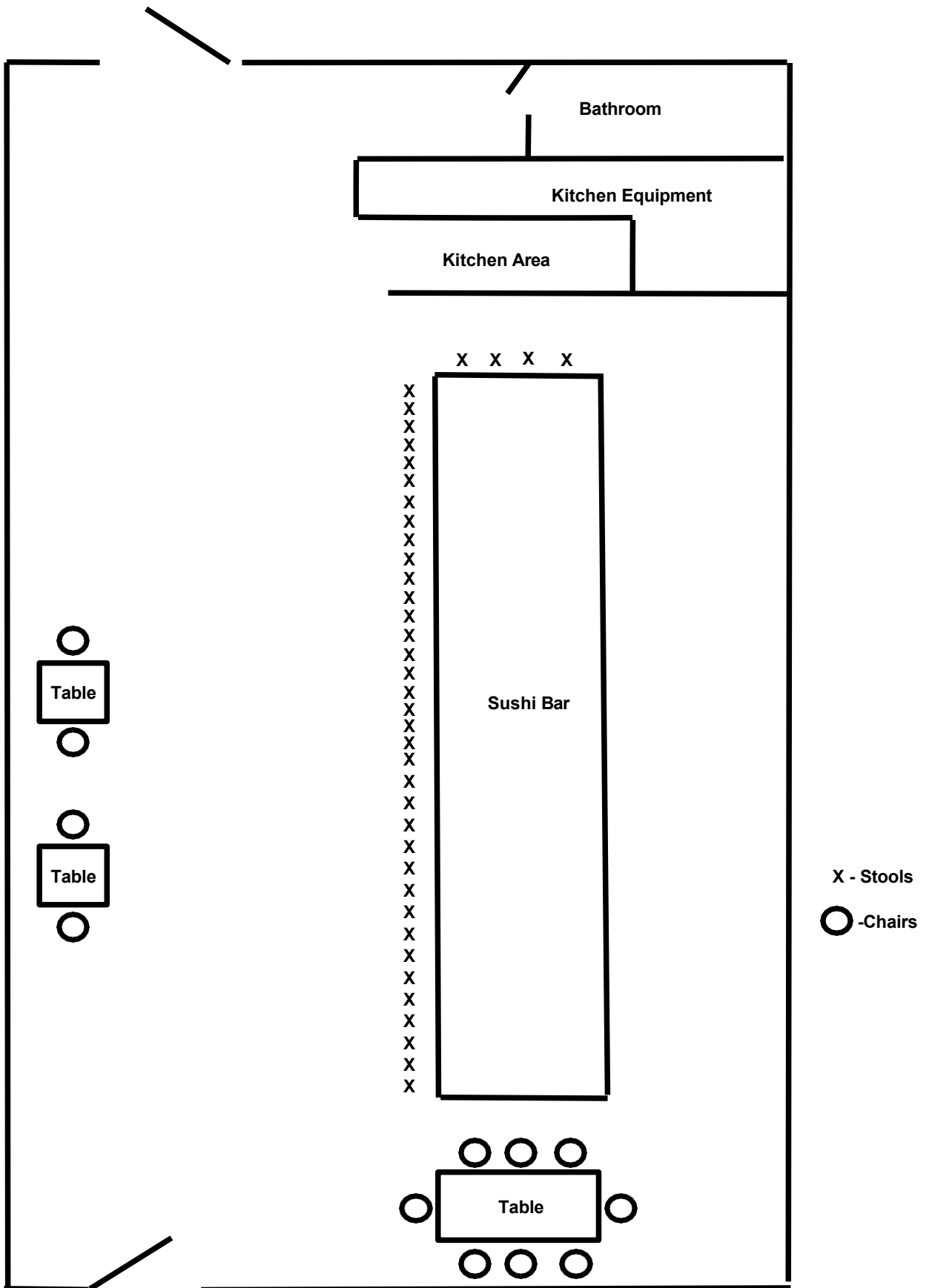

Front Exterior Diagram

183 Grand Street
New York, NY 10013

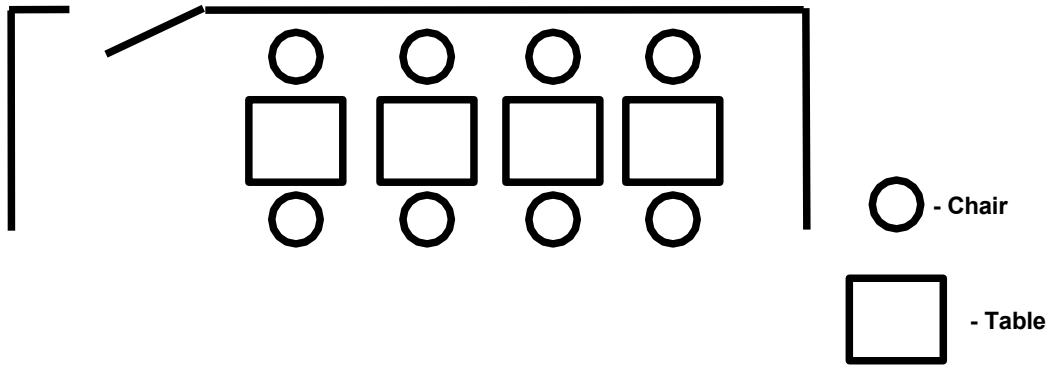

Rear Exterior Diagram

183 Grand Street
New York, NY 10013

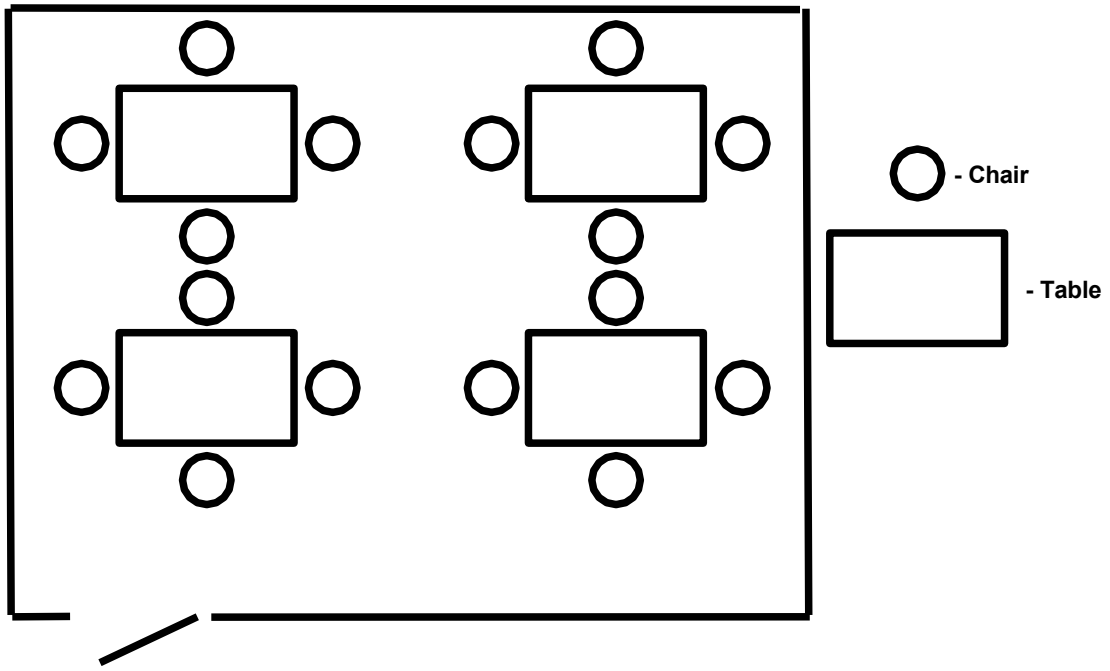

TALUM MENU

MAKI

- Spicy Tuna Roll - \$15
- California Roll - \$13
- American Roll - \$17
- Italian Roll - \$17
- China Roll - \$17
- Salmon Avocado Roll - \$15
- Nolita Roll - \$17

SASHIMI - \$3 / ea

- Yellow Tail
- Fluke - Hirame
- Sake Salmon
- Ahi Tuna

STARTERS

- Wasabi Crispy Rice - \$8
- Miso Soup - \$6
- Edamame - \$5
- Seaweed Salad - \$5
- Hot & Sour Soup - \$6

RAMEN NOODLES - \$12