

Sedona Club Inc

Sedona Club Inc / 39 Clarkson Street, 6th Floor and Roof
New York, New York 10014

Questionnaire for a Private Members Club Liquor License Application

1. Diagrams
2. Photographs
3. Menus
4. Acoustic Survey
5. Area Survey with List of Measurements

BERNSTEIN REDO & SAVITSKY PC
1177 Avenue of the Americas, 5th floor
New York, NY 10036
Tel. 212.651.3100
www.brpclaw.com

Meeting Date: August 2023

APPLICANT INFORMATION:

Name of applicant(s): Sedona Club Inc

Trade name (DBA): To be determined

Premises address: 39 Clarkson Street, 6th Floor and Rooftop

Cross Streets and other addresses used for building/premise:
Hudson and Greenwich Streets

CONTACT INFORMATION:

Principal(s) Name(s): Parker Lieberman as the ABC Officer

Office or Home Address: 39 Clarkson Street

City, State, Zip: New York, New York 10014

Telephone #: [REDACTED] email : [REDACTED]

Landlord Name / Contact: Vanquish Properties LLC c/o Kalyanta LLC

Landlord's Telephone and Fax: [REDACTED]

NAMES OF ALL PRINCIPAL(s):	NAMES / LOCATIONS OF PAST / CURRENT LICENSES HELD
<u>Parker Lieberman</u>	<u>N/A</u>
_____	_____
_____	_____

Briefly describe the proposed operation (i.e. "We are a family restaurant that will focus on..."):

Sedona Club Inc will be a private members club on the 6th floor and rooftop at 39 Clarkson Street. The new establishment plans to blend in with the exquisite character of the South Village neighborhood and is looking forward to welcoming residents as members. The 6th floor will feature an Omakase restaurant with a lounge area. The adjacent rooftop will be covered with a connecting exterior rooftop. The menus are classic Japanese Omakase and Southeast Asian interpreted with a global approach. The result is a unique dining experience, ranging from regularly rotating specials to house favorites such as salmon tacos and miso Chilean sea bass. A full sushi bar is also included together with bespoke custom cocktails. Renowned international chef Olivier Limousin will be presiding over the menus.

WHAT TYPE(S) OF LICENSE(S) ARE YOU APPLYING FOR (MARK ALL THAT APPLY):

- a new liquor license (Restaurant Tavern / On premise liquor Other) **Private members club**
- an UPGRADE of an existing Liquor License
- an ALTERATION of an existing Liquor License
- a TRANSFER of an existing Liquor License
- a HOTEL Liquor License
- a DCA CABARET License
- a CATERING / CABARET Liquor License
- a BEER and WINE License
- a RENEWAL of an existing Liquor License
- an OFF-PREMISE License (retail)
- OTHER : _____

If upgrade, alteration, or transfer, please describe specific nature of changes:
(Please include physical or operational changes including hours, services, occupancy, ownership, etc.)

N/A: The building was the home of Koppers Chocolate Factory that occupied the space since 1937 and closed in 2015.

If this is for a new application, please list previous use of location for the last 5 years:

Vacant

Is any license under the ABC Law currently active at this location? yes no

If yes, what is the name of current / previous licensee, license # and expiration date: _____

N/A

Have any other licenses under the ABC Law been in effect in the last 10 years at this location?
 yes no

If yes, please list DBA names and dates of operation:

N/A

PREMISES:

By what right does the applicant have possession of the premises?

Own Lease Sub-lease Binding Contract to acquire real property other: _____

Type of Building: Residential Commercial Mixed (Res/Com) Other: _____

Number of floor: 6 plus cellar Year Built : Estimated 1920

Describe neighboring buildings:
Mixed: commercial and residential

Zoning Designation: M1-5

Zoning Overlay or Special Designation (applicable) N/A

Block and Lot Number: 601 / 72

Does the premise occupy more than one building, zoning lot, tax lot or more than one floor? yes no

Is the premise located in a historic district? yes no

(if yes, have all exterior changes or changes governed by the Landmarks Preservation Commission (LPC) been approved by the LPC? yes no, please explain : N/A

Will any outside area or sidewalk café be used for the sale or consumption of alcoholic beverages? (including sidewalk, roof and yard space) no yes : explain Covered rooftop with adjacent exterior rooftop.

What is the proposed Occupancy? 150 for the 6th floor and 65 for the rooftop

Does the premise currently have a valid Certificate of Occupancy (C of O) and all appropriate permits?

no* yes ***Applicant will apply for a Temporary Certificate of Occupancy and all appropriate permits.**

If yes, what is the maximum occupancy for the premises? 215

If yes, what is the use group for the premises? Applicant will apply for a Temporary Certificate of Occupancy showing Use Group 6.

If yes, is proposed occupancy permitted? yes no, explain : _____

The occupancy will be permitted once the Temporary Certificate of Occupancy issues.

If your occupancy is 75 or greater, do you plan to apply for Public Assembly permit? yes no

Do you plan to file for changes to the Certificate of Occupancy? yes no
(if yes, please provide copy of application to the NYC DOB)

Will the façade or signage be changed from what currently exist at the premise? no yes

(if yes, please describe: New signage

INTERIOR OF PREMISES:

What is the total licensed square footage of the premises? 6,343 square feet

If more than one floor, please specify square footage by floors: 3,494 square feet for the 6th floor, 1,966 for the covered rooftop; and, 883 for the exterior rooftop.

If there is a sidewalk café, rear yard, rooftop, or outside space, what is the square footage of the area?

1,966 for the covered rooftop; and, 883 for the exterior rooftop for a total of 2,849 square feet.

If more than one floor, what is the access between floors? Stairs and elevator

How many entrances are there? 4 How many exits? 4 How many bathrooms ? 4

Is there access to other parts of the building? ___ no X yes, explain: _____

Elevators and staircases to floors below the 6th floor. *6th floor tables 31 and seats 74 with 4 bar stools which includes the Omakase food counter and the lounge space. Rooftop tables 23 and seats 60.

OVERALL SEATING INFORMATION:

Total number of tables? 59* Total table seats? 134*

Total number of bars? 1 Total bar seats? 4

Total number of "other" seats? None please explain : _____

Total OVERALL number of seats in Premises : 138*

BARS:

How many *stand-up bars / bar seats are being applied for on the premises? Bars 1 Seats 4

How many service bars are being applied for on the premises? One 15'-6" service bar located on the covered rooftop

Any food counters? ___ no X yes, describe : 6th floor 28' Omakase food counter with 12 seats

For Alterations and Upgrades:

Please describe all current and existing bars / bar seats and specific changes: N/A

* A stand-up bar is any bar or counter (whether seating or not) over which a member of the public can order, pay for and receive food and alcoholic beverages.

PROPOSED METHOD OF OPERATION:

What type of establishment will this be? (check all that apply)

___ Bar ___ Bar & Food ___ Restaurant ___ Club/ Cabaret ___ Hotel X Other: Private members club

What are the Hours of Operation? **See enclosed chart**

Sunday: _____ Monday: _____ Tuesday: _____ Wednesday: _____ Thursday: _____ Friday: _____ Saturday: _____
_____ to _____ _____ to _____ _____ to _____ _____ to _____ _____ to _____ _____ to _____

Will the business employ a manager? ___ no yes, name / experience if known : Ian Medwin
See enclosed resume

Will there be security personnel? no ___ yes(if yes, what nights and how many?) _____
Do you have or plan to install French doors, accordion doors or windows that open? no ___ yes

If yes, please describe : N/A

Will you have TV's ? no ___ yes (how many?) _____

Type of MUSIC / ENTERTAINMENT: ___ Live Music ___ Live DJ ___ Juke Box Ipod / CDs ___ none

Expected Volume level: Background (quiet) ___ Entertainment level ___ Amplified Music
(check all that apply)

Do you have or plan to install soundproofing? ___ no yes

IF YES, will you be using a professional sound engineer? **Yes, see enclosed acoustical survey**

Please describe your sound system and sound proofing:

See enclosed acoustical survey

Will you be permitting: ___ promoted events ___ scheduled performances ___ outside promoters **N/A**

___ any events at which a cover fee is charged? private parties

Do you have plans to manage or address vehicular traffic and crowd control on the sidewalk caused by your establishment? ___ no yes (if yes, please attach plans) **We will encourage reservations to limit the number of guests arriving and will accommodate members who walk-in without reservations.**

Will you be utilizing ___ ropes ___ movable barriers ___ other outside equipment (describe) _____

The team / staff will be trained to make sure there are no lines outside.

Are your premises within 200 feet of any school, church or place of worship? no ___ yes

If there is a school, church or place of worship within 200 feet of your premises or on the same block, please submit a block plot diagram or area map showing its' location in proximity to your applicant premises (no larger than 8 ½ " x 11").

Indicate the distance in feet from the proposed premise:

Name of School / Church: _____

Address: _____ Distance: _____

Name of School / Church: _____

Address: _____ Distance: _____

Name of School / Church: _____

Address: _____ Distance: _____

Please provide contact information for Residents / Community Board and confirm that if complaints are made you will address it immediately.

Contact Person: _____ Phone: _____

Address: _____

Email : _____

Application submitted on
behalf of the applicant by:

Donald M. Bernstein

Signature

Print or Type Name **Donald M. Bernstein**

Title **Counsel for applicant**

Thank you for your cooperation. Please return this questionnaire along with the other required documents as soon as you can. This will expedite your application and avoid any unnecessary delays. Use additional pages if necessary.



Community Board 2,
Manhattan SLA Licensing Committee
Donna Raftery, Co-Chair
Robert Ely, Co-Chair

Sedona Club Inc / 39 Clarkson Street, 6th Floor and Rooftop
New York, New York 10014

Proposed Hours of Operation

The proposed hours of operation for the 6th floor are:

- 1130am to 2:00am Monday to Saturday
- 11am to 4pm Sunday

The proposed hours of operation for the interior rooftop are:

- 9am to 10pm Monday to Saturday
- 9am to 4pm Sunday

The proposed hours of operation for the exterior rooftop are:

- 9am to 9pm Monday to Saturday
- 9am to 4pm Sunday

Sedona Club Inc

Diagrams

Ground floor diagram showing elevators to 6th floor and Roof. See red circle below.

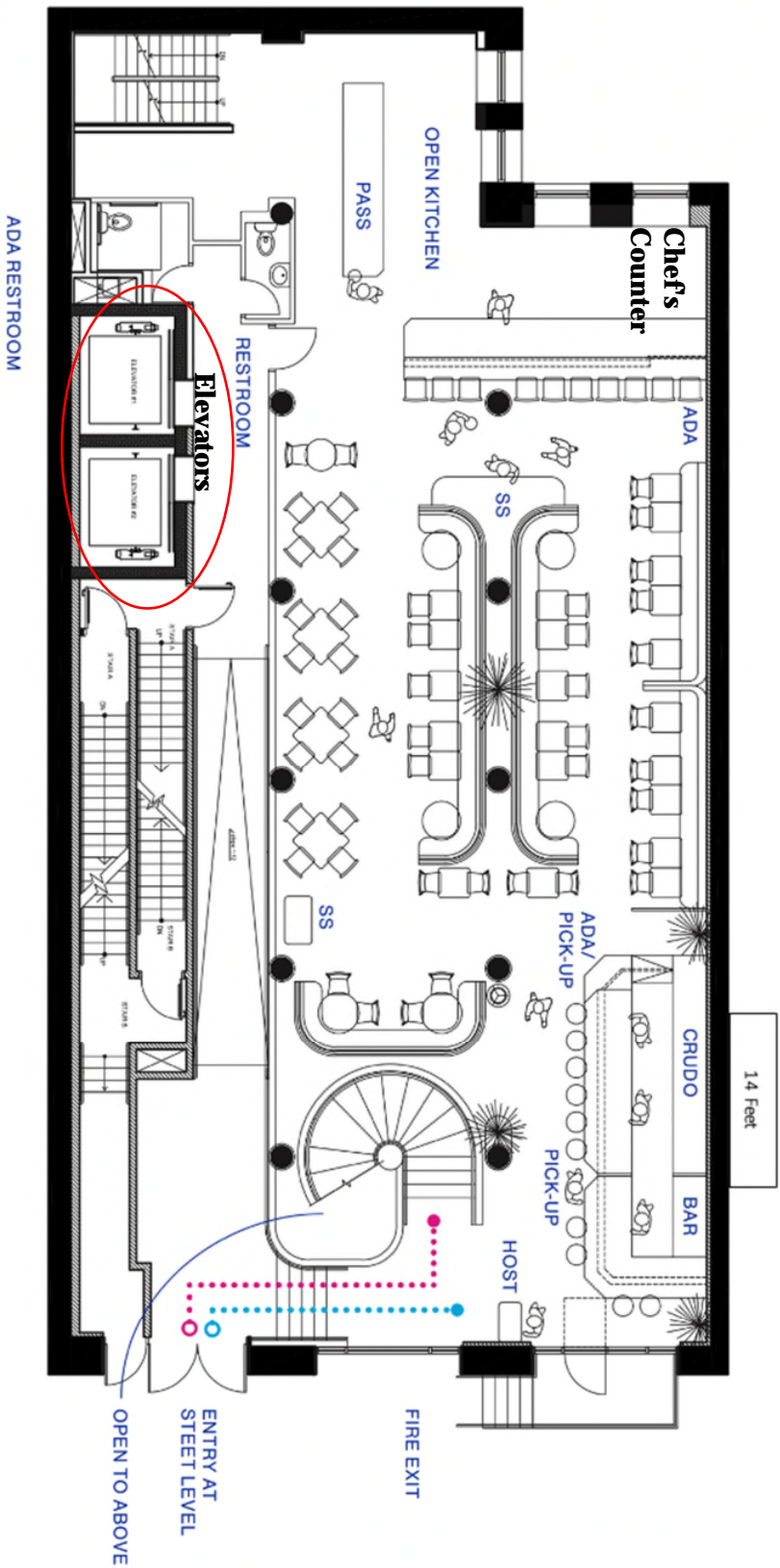

Sedona Club Inc / 39 Clarkson Street, 6th Floor and Roof/ New York, NY 10014

6th floor Omakase tables 5 and 24 seats which include the Omakase food counter
Lounge tables 26 and 50 seats with one customer bar with 4 bar stools / Total tables 31 and seats 78
Square footage is 3,494 and Occupancy is 150

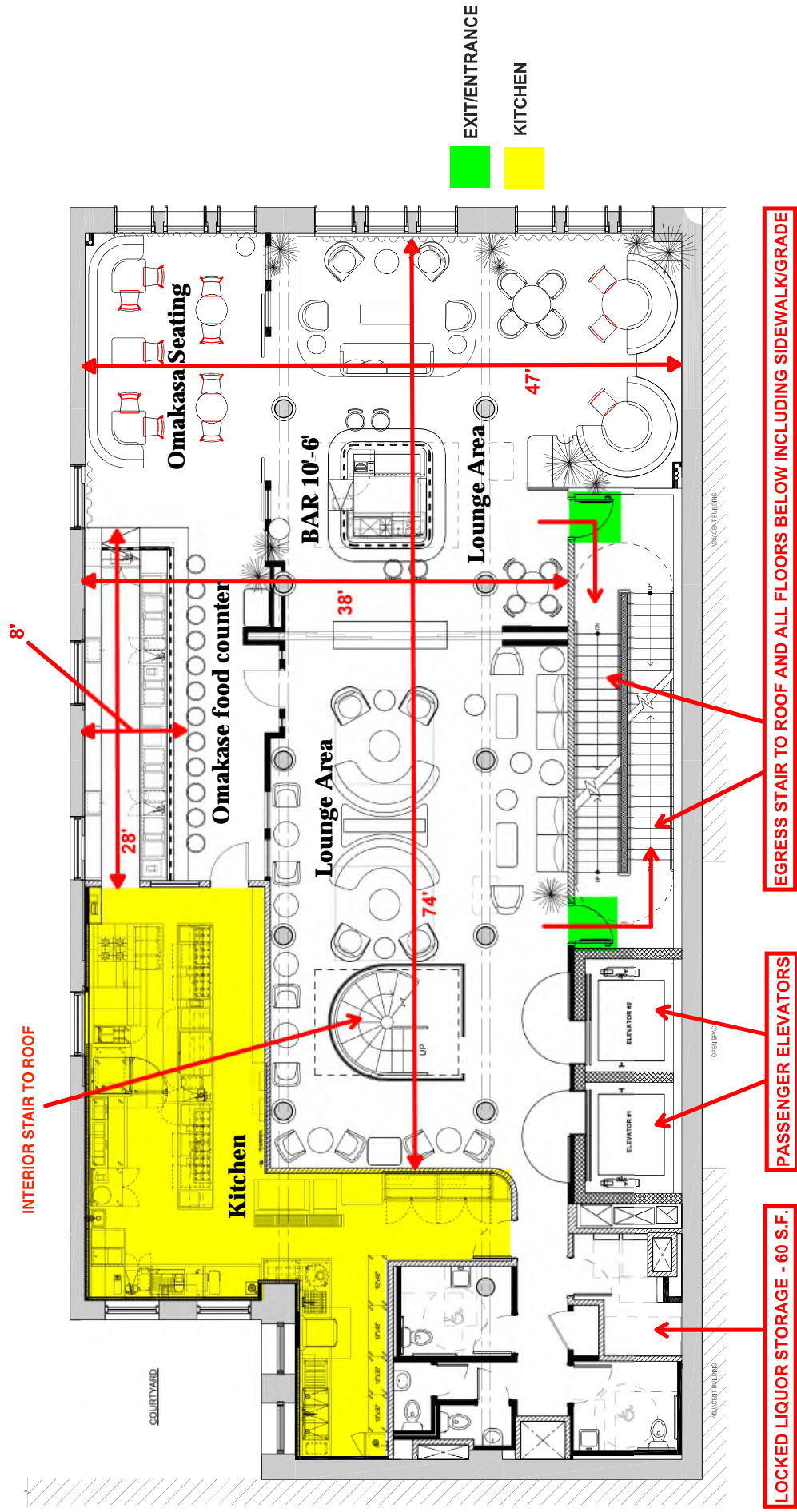

Sedona Club Inc / 39 Clarkson Street, 6th Floor and Roof/ New York, NY 10014

Roof interior tables 14 and seats 32 outlined in pink

Roof exterior tables 9 and seats 28 outlined in blue / Total tables 23 and seats 60

**Square footage for the interior is 1,966 and square footage for the exterior is 883. Total square footage is 2,849 and occupancy is 65.
The roof is contained by walls**

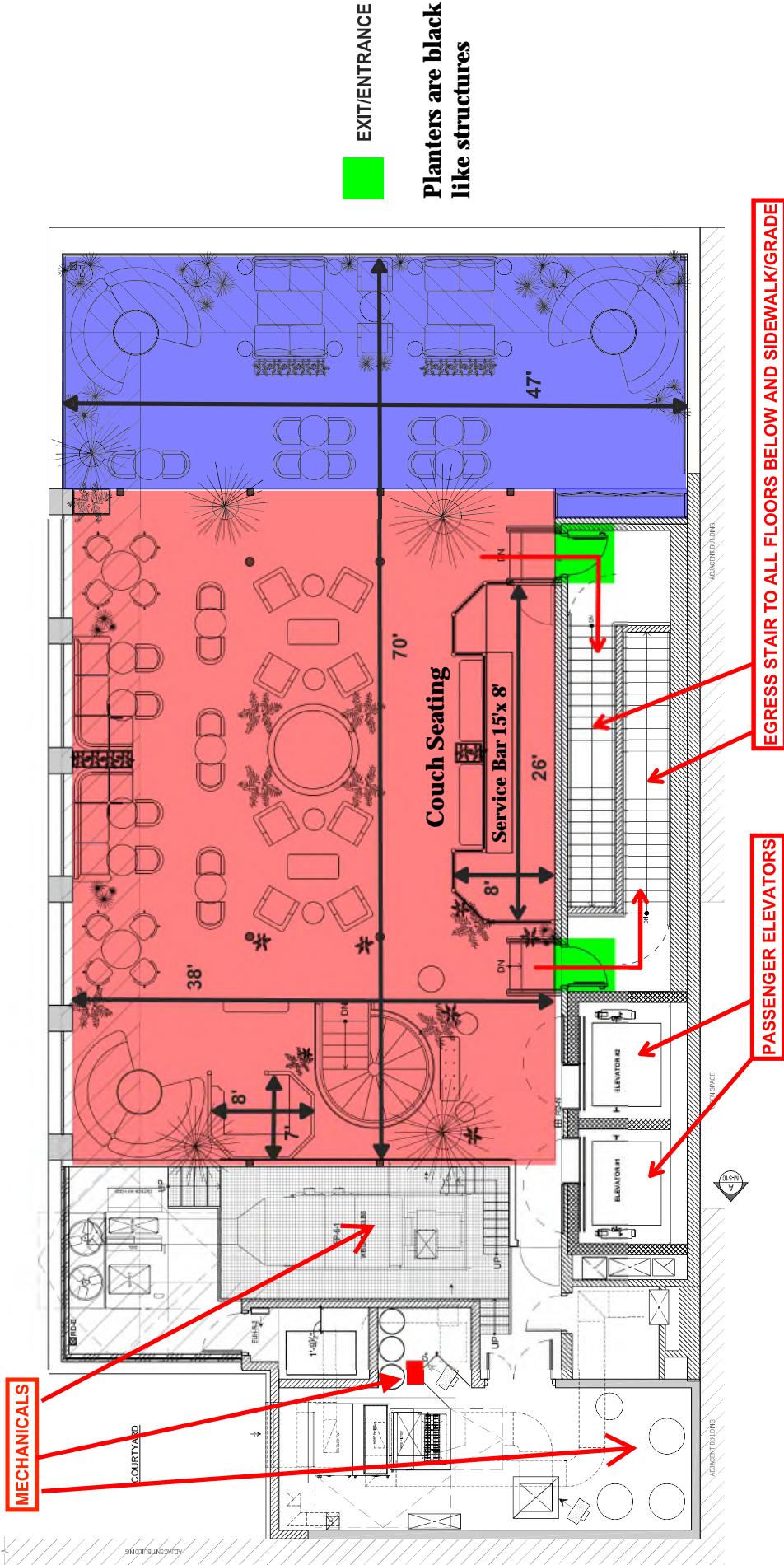

Sedona Club Inc

Photographs

Sedona Club Inc
39 Clarkson Street, 6th Floor and Rooftop
New York, New York 10014



6th floor elevators



Sedona Club Inc
39 Clarkson Street, 6th Floor and Rooftop
New York, New York 10014



Roof elevators

Sedona Club Inc
39 Clarkson Street, 6th Floor and Rooftop
New York, New York 10014



Partial residential building / Leroy Street



The Printing House Residential Building

On 421 Hudson Street

Sedona Club Inc
39 Clarkson Street, 6th Floor and Rooftop
New York, New York 10014



Residential Building / Leroy Street



The Printing House Residential

Sedona Club Inc
39 Clarkson Street, 6th Floor and Rooftop
New York, New York 10014



Commercial Building

Sedona Club Inc

Menus

R

ROOF TOP LUNCH MENU

To Share	Salads	Entrées	Sides
Chips & Caviar	Caesar (Add Chicken, Shrimp).	Grilled Daily Fish.	Pommes Purée
French Onion Dip	Parmesan, Herb Crouton	Lemon, Herbs, Chilies	Truffle Fries
CRUDITE	Asian Chicken.	Artic Char	Roasted Carrots
Whipped Feta With Herbs/Lemon	Napa Cabbage, Mesclun, Peanut, Sesame Mustard Vinaigrette	Ginger, Lime, Cherry Tomato	Spinach
	Grilled Avocado	Steak Frites	Mushrooms
Starters	Watercress, Pickled Onion, Watermelon, Ponzu Vinaigrette	NY Strip, Herb Butter	
Snapper Ceviche Crispy Plantain	Vegetable Salad	Ollie Burger	
HAMACHI SASHIMI* Yuzu Kosho, Cucumber, Fresno Chili	Radish, Hearts Of Palm, Green Beans	Pommes Frites, Caramelized Onion, Ollie Sauce	
TUNA TARTARE* Avocado, Cucumber, Soy, Chili, Chia Seed Crackers		The Club Roasted Chicken ,Cheddar, Lettuce, Tomato, Onion, Secret Sauce, Fries	
Beef Tartar (Starter/Entrée). Filet Mignon, Fresno Chili, Caper		Spaghettini Garlic, Olive Oil, Basil, Tomatoes	
Gazpacho / Bisque / Minestrone.		Grilled Zucchini Sauteed Vegetables, Basil Pesto, Herbs	

MENU

OMAKASE MENU LUNCH

BASE
5 piece

Edamame

Shiitake Mushroom Salad
yuzu, cucumber and
seaweed

Tuna Sashimi
ponzu and chives

Albacore Sushi
ponzu and chives, 1-pc

Salmon Sushi
toasted sesame, 1-pc

Shrimp Sushi toasted
sesame, 1-pc

Toro Hand Roll

LEVEL 1
9 piece

Edamame

Tuna Sashimi
ponzu and chives

Albacore Sushi
ponzu and chives, 2-pc

Salmon Sushi
toasted sesame, 2-pc

Toro Hand Roll

Japanese Yellowtail* Sushi
lemon, 1-pc

Sea Bass Sushi
yuzu ponzu, 1-pc

Blue & Dungeness Crab Hand Roll

LEVEL 2
12 piece

Edamame

Tuna Sashimi
ponzu and chives

Albacore Sushi
ponzu and chives, 1-pc

Salmon Sushi
toasted sesame, 2-pc

Toro Hand Roll

Japanese Yellowtail Sushi
lemon, 2-pc

Chutoro Sushi
2-pc

Sea Bass Sushi
yuzu ponzu, 1-pc

New Zealand Sea Bream Sushi
citrus salt, 1-pc

Blue & Dungeness Crab Hand Roll

LEVEL 3 VEGETARIAN
7 piece

Shiitake Mushroom Salad
yuzu, cucumber and seaweed

Cauliflower Puree
torched satsuma mandarin
and togarashi

Carrot Nigiri
koji-cured and smoked, topped with
white kelp

Spaghetti Squash Nigiri
fried onions

Zuke Daikon Nigiri
Fried shallots, Smoked Eggplant Nigiri

Truffle Avocado Oshizushi
pressed and layered

Smoked Pineapple Nigiri

MENU OMAKASE MENU DINNER

LEVEL 1 9 piece

Edamame

Shiitake Mushroom Salad, yuzu, cucumber and seaweed

Tuna Sashimi – ponzu and chives

Albacore Sushi – ponzu and chives, 1-pc

Salmon Sushi – toasted sesame, 1-pc

New Zealand Sea Bream* Sushi – citrus salt, 1-pc

Toro Hand Roll

Japanese Yellowtail* Sushi – lemon, 1-pc

Bluefin Otoro Sushi, 1-pc

Sea Bass Sushi – yuzu ponzu, 1-pc

Blue & Dungeness Crab Hand Roll

Fruit

LEVEL 2 13 piece

Edamame

Tuna Sashimi – ponzu and chives

Albacore Sushi – ponzu and chives, 1-pc

Live Diver Scallop

Uni handroll (caviar)

Salmon Sushi – toasted sesame, 1-pc

New Zealand Sea Bream* Sushi – citrus salt, 1-pc

Cho Toro sushi 1pc

Toro Hand Roll

Japanese Yellowtail* Sushi – lemon, 1-pc

Bluefin O'toro Sushi, 1-pc

Sea Bass Sushi – yuzu ponzu, 1-pc

Blue & Dungeness Crab Hand Roll

Wagyu Nigiri A-5 – seared then sauced

Fruit

LEVEL 3 VEGETARIAN 12 piece

Shiitake Mushroom Salad served sunomono style, with yuzu

Cauliflower Puree with torched satsuma mandarin

Pressed King Oyster Mushroom Nigiri Tomato Nigiri with kombu

Spaghetti Squash Nigiri topped with fried onions

Zuke Daikon Nigiri with fried shallots

Smoked Eggplant Nigiri

Watermelon Tartare Nigiri

Cucumber Gunkan pressed and marinated cucumber

Truffle Avocado Oshizushi pressed and layered

Oyster Mushroom Handroll sautéed in yuzu

Melon & Cashew Ricotta cold melon with whipped cashew ricotta and nori

MENU

DINNER MENU 6TH FLOOR LOUNGE AND ROOFTOP

SNACK

CRISPY SPINACH
togarashi

SWEET POTATO FRIES
wasabi butter, black truffle

Honey Butter Chips
Whipped honey butter

Crispy pork Skin
Chimichurri Dipping sauce

GRILLED SHISHITO PEPPERS
Kabayaki, citrus ponzu, furikake

SMALL PLATES

Lobster Dynamite
Scallion

Little Shrimp
Cornflake, Curry Leaf, Sweet Chili

Heart Of Palm
Avocado, Passion Fruit, Kabayaki

Duck Lettuce Wraps
Pickled Vegetables, Hoisin, Peanut

Spicy Corn Ribs
Cotija, Togarashi Aioli

Shiso Leaf Tempura
Black Garlic, Chili Aioli

Brioche
Caviar, Uni, Abalone

MAKI

SEARED A5 MIYAZAKI*
tempura zucchini, shishito, avocado, crispy
onion,
truffle ponzu

TUNA & TORO*
bluefin tuna, avocado, spicy mayo, yellowfin
tuna tataki

SPICY YELLOWTAIL*
jalapeño, wasabi aioli

HAPPY ROLL*
tempura enoki, shimeji, shiitake, truffle aioli

DRAGON
tempura shrimp, snow crab, avocado, mango,
eel sauce

NIGIRI | SASHIMI

O-TORO*
fatty tuna

AKAMI*
bluefin tuna

MAGURO*
yellowfin tuna

SAKE*
king salmon

SAKE ABURI*
king salmon belly

CHU-TORO
medium fatty tuna

HAMACHI*
Yellowtail

KANPACHI*
Amberjack

KANI*
king crab

IKURA*
marinated salmon roe

UNI*
sea urchin | Santa Barbara | Japan

O-TORO SPECIAL*
uni, shiso

Vegetable roll
Avocado, cucumber, celery, carrot

YAKITORI

SCALLOP TOBAN YAKI
red miso, shiitake, Bok choy

SOY SAKE SALMON
Bok choy, sesame, lemon

VEGETABLE TEMPURA
mushroom soy dashi, chive, black truffle

GARLIC KING CRAB
XO, scallion

MISO SWORDFISH
cashew, mango,

WAGYU SKIRT STEAK
3 oz, soy, garlic, sesame, crispy onion

PARK AND RIDE CHICKEN
Chili, peanut sauce

GRILLED VEGETABLE
shiitake, Bok choy, lotus root, Sichuan
peppercorn, cashew

BABY SQUID
Olive oil, Herbs

DESSERT MENU

6TH FLOOR AND ROOFTOP

Les Desserts

La Gauffre Crispy Waffles, Praline	15
LE CARAMEL Chocolate Tart, Salted Caramel, Macadamia	16
LA PÊCHE Peach Salad, Vervains, Strawberry Sirop 1	18
LE SOUFFLE FOR TWO Valrhona Dark Chocolate / Grand Mariner, Strawberry Coulis	30
LA POMME Green Apple Tarte, Caramel, Vanilla Ice Cream	16
LES GLACES ET SORBETS Vanilla, Dark Chocolate, Pistachio, Raspberry, Mango, Pomelo	14

Coffee & Espresso
Café American
Espresso
Cappuccino
Café Au Lait
Iced Tea
Iced Coffee
Hot Chocolate
Citron Presse
Hot Tea

Sedona Club Inc

Acoustic Survey

ACOUSTILOG[®]

INC.

19 Mercer Street, NY, NY 10013 (212) 925-1365 Fax: (212) 966-4216 www.acoustilog.com

February 9, 2023

Mr. Parker Lieberman
Amber Hospitality
135 West 50th Street, Suite 200
New York, NY 10020

Re: Rooftop Noise, 39 Clarkson Street, New York, NY 10014

Dear Mr. Lieberman,

I have studied the noise issues at the above premises. I am providing recommendations to prevent noise disturbances to the neighbors from music and voices at the new space.

SUMMARY

You are opening a 7th floor rooftop terrace with 75 person maximum occupancy. Background music will not be used.

The design of the rooftop enclosure and the level of ambient noise in the area will keep sound levels within Noise Code limits for voices. Recommendations are provided in this report.

DBA VS OCTAVE BAND SOUND LEVELS

One way that sound levels were measured is with the A-weighting decibel scale. This "dBA" scale is the most common type of sound measurement, which represents an overall measurement of all frequencies, but with a strong tendency to ignore the low-frequency "bass" sounds. It is thus appropriate for evaluating voice noise. Measuring the dBA levels requires only a simple sound level meter. The dBA level is shown on the right side of the graphs.

Octave-band sound level readings were also taken, which are measured in decibels, or db. Frequencies above 250 Hertz comprise the middle and high frequencies. These sounds require a complex spectrum analyzer to measure them. The loudest sounds produced by voices are in the middle frequencies, and are usually adequately measured using dBA readings. The middle frequencies are shown in the middle of the frequency graph.

THE NOISE CODE - UNREASONABLE NOISE

§24-203 General definitions. When used in the New York city noise control code the following terms shall have the following meanings:

(62) Unreasonable noise means any excessive or unusually loud sound that disturbs the peace, comfort or repose of a reasonable person of normal sensitivities, injures or endangers the health or safety of a reasonable person of normal sensitivities or which causes injury to plant or animal life, or damage to property or business.

§24-218 General prohibitions.

(a) No person shall make, continue or cause or permit to be made or continued any unreasonable noise.

(a-1) No person shall make, continue or cause to permit or be made or continued any unreasonable noise:

(1) for any commercial purpose or during the course of conducting any commercial activity; or

(2) through the use of a device, other than a device used within the interior living space of an individual residential unit, installed within or upon a multiple dwelling or a building used in part or in whole for non-residential purposes.

(b) Unreasonable noise shall include but shall not be limited to sound, attributable to any device, that exceeds the following prohibited noise levels:

(1) Sound, other than impulsive sound, attributable to the source, measured at a level of 7 dB(A) or more above the ambient sound level at or after 10:00 p.m. and before 7:00 a.m., as measured at any point within a receiving property or as measured at a distance of 15 feet or more from the source on a public right-of-way.

(2) Sound, other than impulsive sound, attributable to the source, measured at a level of 10 dB(A) or more above the ambient sound level at or after 7:00 a.m. and before 10:00 p.m., as measured at any point within a receiving property or as measured at a distance of 15 feet or more from the source on a public right-of-way.

(3) Impulsive sound, attributable to the source, measured at a level of 15 dB(A) or more above the ambient sound level, as measured at any point within a receiving property or as measured at a distance of 15 feet or more from the source on a public right-of-way. Impulsive sound levels shall be measured in the A-weighting network with the sound level meter set to fast response. The ambient sound level shall be taken in the A-weighting network with the sound level meter set to slow response.

(c) Notwithstanding the provisions of subdivision b of this section, where a particular sound source or device is subject to decibel level limits and requirements specifically prescribed for such source or device elsewhere in this code, the decibel level limits set forth in this section shall not apply to such sound source or device.

(d) The decibel level limits set forth in this section shall not apply to sound attributable to construction devices and activities.

The voices of customers in the restaurant are considered "other than impulsive sound" – see Paragraphs (1) and (2) above. These voice sounds are loudest in the midrange frequencies and thus, as explained above, are properly described using dBA readings.

Note that Section §24-218 prohibits "unreasonable noise", not all noise. Section §24-218 (b) applies to devices, not to people, but is used in this report as a reasonable guideline.

MAP

The nearest / most-affected residential locations are shown in the Google Maps photo below.

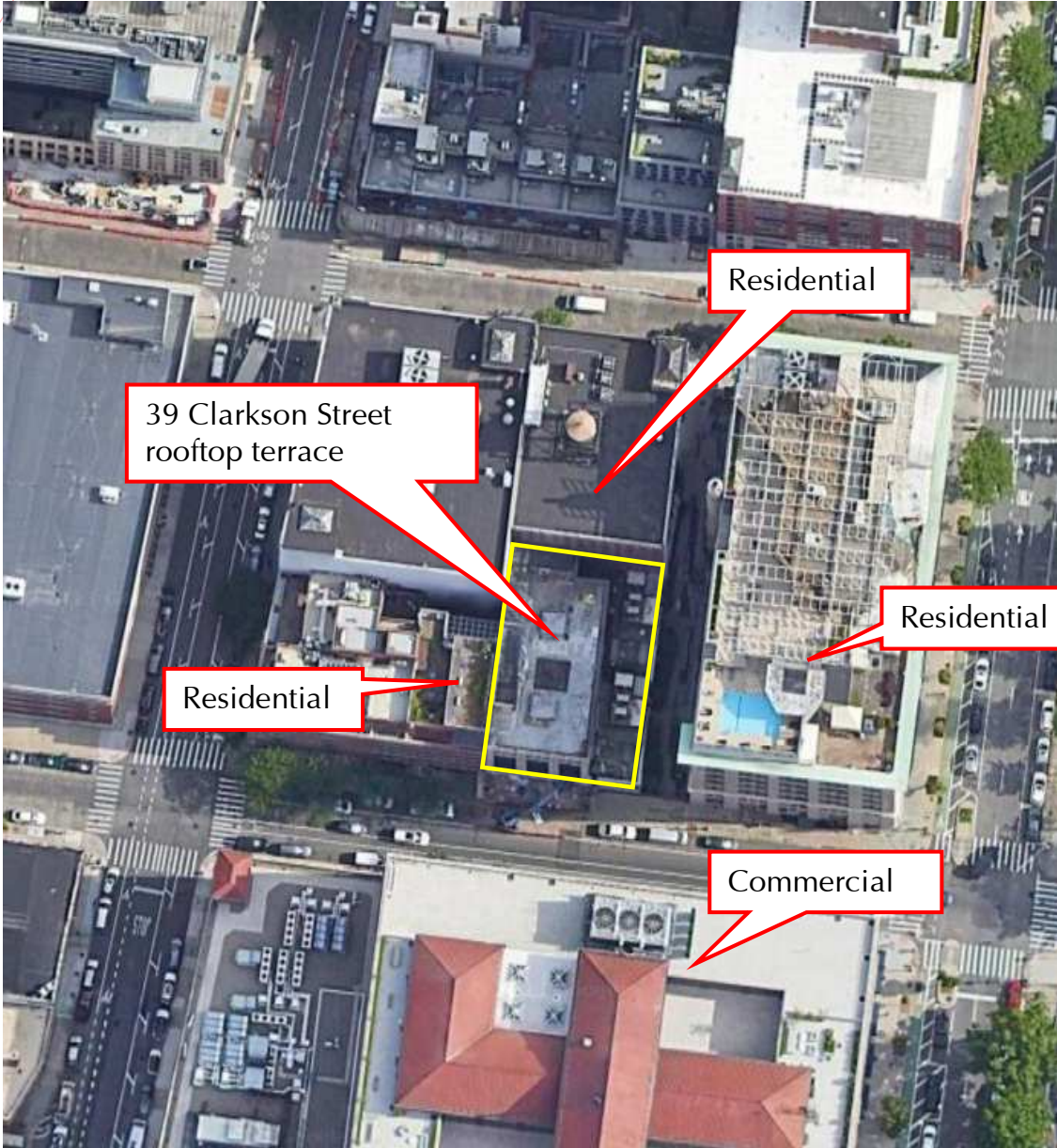

ANALYSIS - ROOFTOP TERRACE

I conducted sound tests on the rooftop late on a Monday night. This was a worst-case (quietest) late-night reading. These measurements allowed determination of the proper sound recommendations for the outdoor space.

See the chart below of the moment-by-moment rooftop sound levels. The lowest levels are between midnight and 3:00 AM.

The outdoor ambient sound level was a minimum of 59 decibels at 125 Hertz and 55 dBA. Measured 3 feet inside an open window in the area, the ambient sound level would be approximately 44 decibels at 125 Hertz and 44 dBA.

Note that the area is noisy due to the nearby traffic, including trucks and motorcycles, but I used the minimum level of the readings for the analysis.

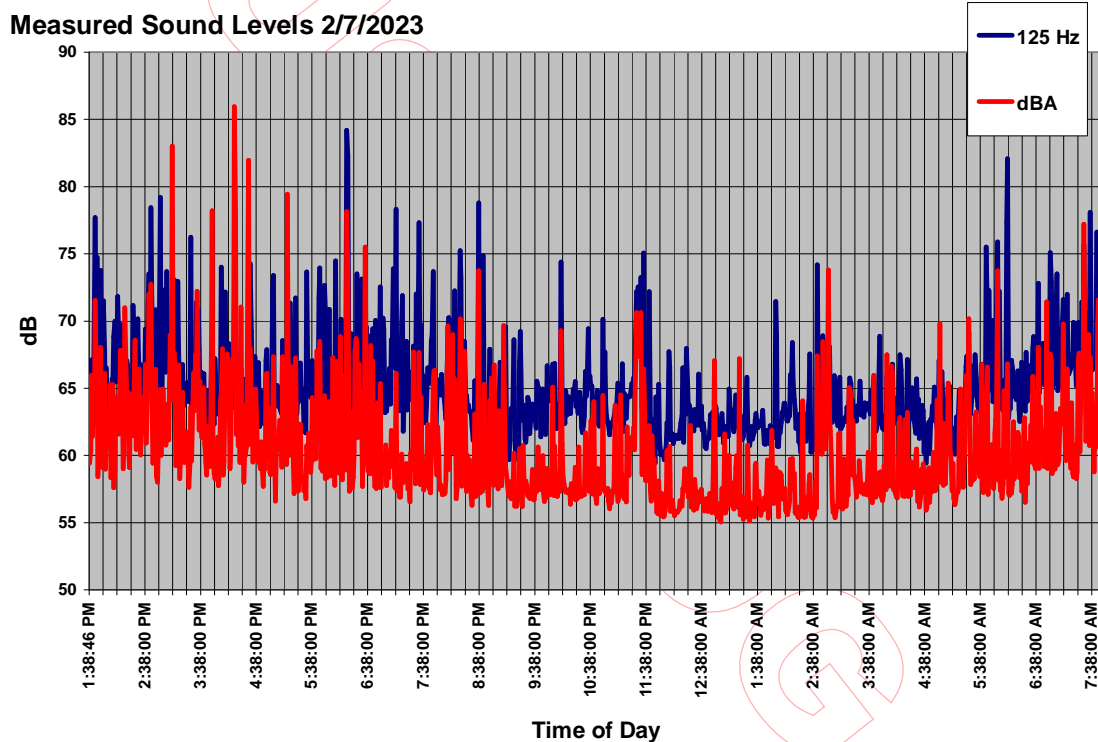

The nearest residential buildings have windows facing the terrace.

I have analyzed the acoustical performance of the acoustical blankets covering the opening in the glass rooftop enclosure, and this has been conservatively accounted for in this report.

The enclosure and the barrier blankets on the east side both provide attenuation. The enclosure will have a solid wall on the west side.

Sound is also attenuated by travel distance and is partially masked by traffic noise in the neighborhood. Sound is further reduced by passing through an open window.

Ambient noise was factored in, using the minimum levels recorded at night to be conservative. The voice noise level was analyzed by calculating the noise from people and deducting the predicted sound attenuation.

Any residual sound from voices would be only 27 dBA in the nearest, most affected apartment. This is well under the 44 dBA indoor ambient level and virtually inaudible.

In order to be Code-compliant, the voice sound must not exceed the ambient by 7 or 10 decibels (night/day). Since the sound will not exceed the level of ambient noise, it will meet Code requirements.

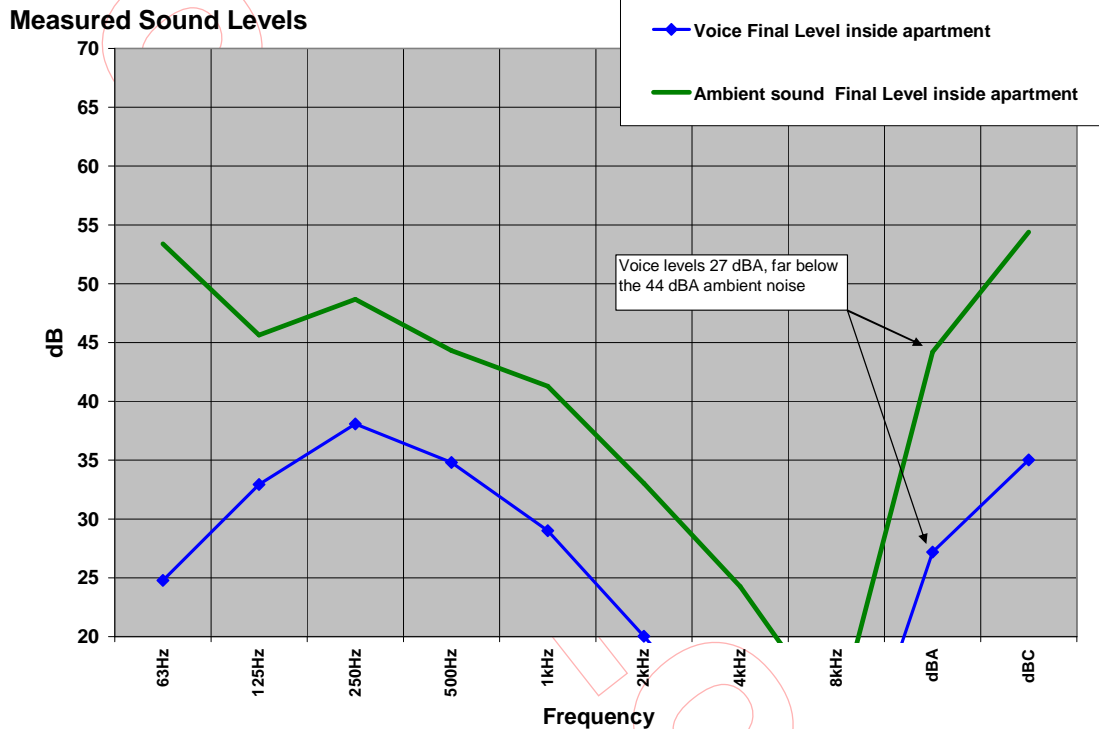

RECOMMENDATIONS

GLASS ENCLOSURE

1. The enclosure roof should use either insulated glass with a total thickness of at least 5/8" or solid or laminated glass with a thickness of at least 1/4".

VERTICAL BARRIER BLANKETS

2. To reduce voice sounds traveling through the archway openings, install a system of Mass Loaded Vinyl (MLV) blankets. The openings to be covered are on the east side of the rooftop venue. They should extend throughout each opening, and extend below the height of the parapet walls.
 - a. The MLV will have a surface density of one pound per square foot.

- b. The vinyl should be the reinforced type since it is being used outdoors.
- c. Each blanket must overlap the next by at least 2" when in place.
- d. Small gaps are allowable if the gaps add up to less than 1% of the total area.
- e. The vinyl is available from Acoustical Surfaces Inc. Ask for Tyler at 800 448 0737. tyler@stopnoise.com

SOUND ABSORPTION

- 3. Inside the rooftop enclosure, install sound-absorbing panels on the walls where practical, to prevent reverberant sound build-up. This will benefit your customers by providing a less-echoey environment and will also reduce sound traveling towards the neighbors.
 - a. One suitable choice is the 1" thick Sound Silencer panel from Acoustical Surfaces. Data attached.
 - b. These can be hidden behind a trellis or plantings but must not be blocked with any solid material such as wood or closed fencing.
 - c. You could install these on the non-open areas such as the north and west walls.
 - d. The panels should also be installed on the east parapet wall facing the MLV.

If I can be of further assistance, please call.

It is strongly recommended that all complicated construction projects get regular inspection visits at critical times, to make sure the system performs properly. This is an optional service which I can provide. All Acoustilog, Inc.-designed information supplied is for the original client and may not be copied in any way for different projects by any architect, consultant, engineer or other party. Copyright Acoustilog, Inc. © 2023. All rights reserved. No reproduction of any type permitted without written permission of Acoustilog, Inc.

Yours Truly,

Alan Fierstein



President

acoustilog1@verizon.net

*All readings re: .0002 microbar and to Code.
Readings taken with Bruel & Kjaer
2250/2260/2270 Analyzer, Bruel & Kjaer 4134,
4135, 4145, 4155, 4165, 4189 or 4190
Microphone, Acoustilog 232A Reverberation
Timer. Calibrated to Bruel & Kjaer 4220 Sound
Source or Quest CA-15.*



There are residential buildings surrounding the rooftop. The area is noisy due to the adjacent traffic, including trucks and motorcycles.

39 Clarkson Street rooftop terrace – View looking north.

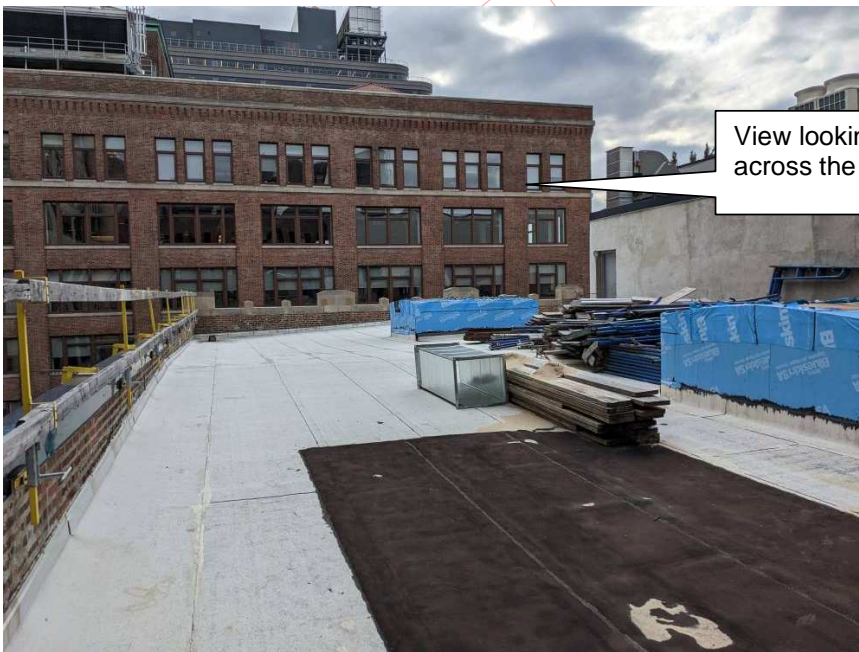

View looking south. The building across the street is commercial.



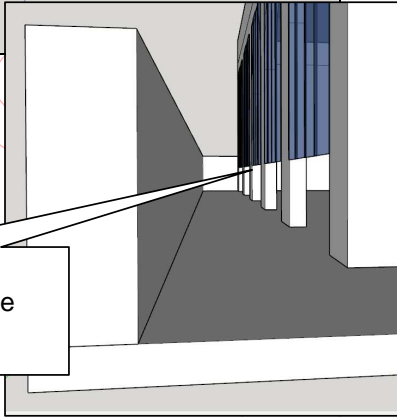



ACOUSTICAL SURFACES, Inc.

Your One-Stop Resource for Soundproofing and Noise Control Solutions

- Applications
- What's Your Problem?
- Acoustics 101
- Soundproofing Tips
- Literature
- Photos
- News
- Who We Are
- Financing
- Contact Us
- Links
- Site Map
- Blog
- Home

Noise Control Help Line
1-800-854-2948
M-F 7am-6pm (Central time)
BEST PRICE GUARANTEE

- ECHO ELIMINATOR™
- SOUND SILENCER™
- dBA Panels
- DESIGNER ACOUSTICAL CURTAINS
- DECORATIVE FABRIC WRAPPED PANELS
- SOUND ABSORBING FOAM
- HANGING ACOUSTICAL BAFFLES
- SONEX™ FOAM PRODUCTS
- ACOUSTIC QUILTED CURTAIN
- NOISE BARRIER-NOISE BLOCKERS
- FLOORING UNDERLAYS
- SEALANTS - ADHESIVES - GREEN GLUE
- ACOUSTICAL CEILING TILES
- SOFTWALL - WALLMATE
- VIBRATION MOUNTS - HANGERS & PADS
- HVAC PRODUCTS / SILENCERS
- WALL INSULATION
- SOUND LEVEL METERS - HEADPHONES
- SOUND TESTING & ACOUSTICAL ANALYSIS SERVICES
- ADJUSTABLE DOOR SEALS
- SCHOOL NOISE MANAGEMENT
- ACOUSTIC WINDOWS - INSERTS
- ACOUSTIC / SOUNDPROOF DOORS
- ACOUSTIC ENCLOSURES
- RSIC SOUND ISOLATION CLIPS
- ACOUSTI-BOARD
- OUTDOOR BARRIER WALL™ SYSTEM
- ONE STEP DECORATIVE WALL SYSTEM
- ACOUSTIMETAL™ PERFORATED METAL PANELS
- SOUNDSCREEN™ WHITE NOISE MACHINE
- ACOUSTI-GASKET™ TAPE
- T-MOLD SYSTEM™
- ACOUSTICAL FABRIC SELECTION
- ADJUSTABLE CUTTERS - SPRINKLER CUTTER
- BUY NOW PAY LATER

[STATEMENT OF WARRANTY](#)



NOISE S.T.O.P.™ Vinyl BARRIER

Mass Loaded Vinyl Noise Barrier

- Reduces Sound Transmission
- Contains Noise
- Improves Communications
- Improves Health & Safety

When noise and sound transmission needs to be effectively controlled, Mass Loaded Vinyl Noise Barrier is the solution to build noise barriers and soundproof walls.

MATERIAL: Mass Loaded Vinyl Barrier

PATTERN: Smooth Finish

FEATURES: High density limp material to reduce noise transmission.

APPLICATIONS: Reduced noise transmission through ceilings, walls, floors, machinery enclosures, duct-work. Apply over suspended ceilings on studs or joists.

THICKNESS: 1/16" - 1/2lb./sq.ft. 1/8" - 1lb./sq.ft. 1/4" - 2lb./sq.ft.

SIZES: 54" Wide x 20', 30', 60' Rolls - 2'x2', 2'x4' Sheets, Die Cutting Available

COLOR: Black, Grey (Reinforced), Tan and Clear (Transparent or Translucent)

FLAMMABILITY: UL 94VO

INSTALLATION: Material can be nailed, screwed, stapled or can be reinforced and grommetted and hung like a curtain.

Product Tests & Information:

- [Acoustical Tests](#)
- [MSDS](#)
- [Flammability](#)



Safe & Secure - Instock - Ready to ship

1 lb 54" x 20 (black) Rolls Only

Barriers	Noise Transmission Loss (dB) Per Octave Band (HZ)						STC
	125	250	500	1000	2000	4000	
2 lb. PSF	16	22	26	32	35	40	31
1.25 lb. PSF	14	18	24	27	33	38	28
1 lb. PSF	13	17	22	26	32	37	27
1/2 lb. PSF	8	13	17	22	27	31	20



Live chat by AliveChat



Specifications subject to change with out notice.

© 2010 Acoustical Surfaces, Inc., All rights reserved.

ACOUSTICAL DATA

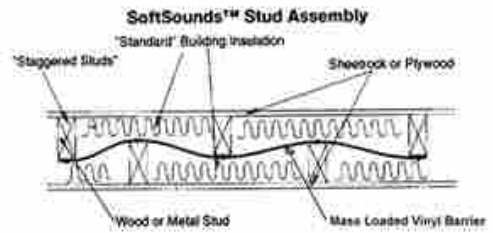
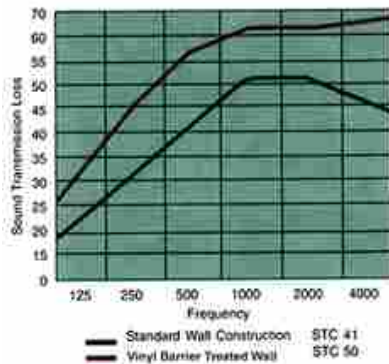

ASI Pro Audio's Suggested Retrofit Wall Construction System

- Fill area between studs with SoftSounds™ insulation, 3" or 5"
- Glue 1.25 lb. sq. ft. barrier to back of drywall
- Install drywall
- Use A.S.I. Acoustic Sealant on gaps in drywall.

Part #	Description
SSB-1918	SoftSounds™ Insulation
STDP	24 Oz. Sealant
1.25B-20R	Super Sound Barrier
RBC	RBC Clips

Wall System Estimated STC 49

*NOTE: use of RBC-1 clips and hat channel would increase STC to 52

ASI Pro Audio's Suggested New Wall Construction System

- Fill area between studs with SoftSounds™ insulation, 3" or 5"
- Stud insulators on studs 12" to 16" on center
- Glue 1.25 lb. sq. ft. barrier to back of drywall
- 2nd layer of drywall (if possible)
- Use A.S.I. Acoustic Sealant on gaps in drywall.

Part #	Description
SSB-1918	SoftSounds™ Insulation
SI	Stud Insulators
RBC	RBC Clips
STDP	24 Oz. Sealant
1.25B-20R	Super Sound Barrier

Wall System Estimated STC 57

*NOTE: use of RBC-1 clips and hat channel would increase STC to 62

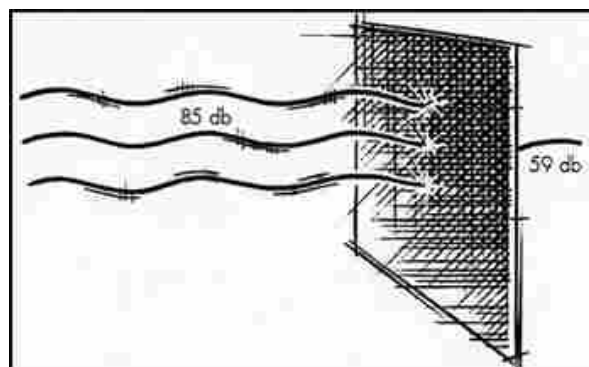

Click PDF icon to download printer friendly file format of product specs.

Click to receive a free copy of Adobe Acrobat Reader.

- Soundproofing Products • Sonex Ceiling & Wall Panels • Sound Control Curtains • Equipment Enclosures • Acoustical Baffles & Banners • Solid Wood & Veneer Acoustical Ceiling & Wall Systems • Professional Audio Acoustics • Vibration & Damping Control Fire Retardant Acoustics • Hearing

Speaker Selector with Volume Controls for Six Pairs of Speakers

SSVC-6



DESCRIPTION

FEATURES

SPECS

RESOURCES

WARRANTY

Niles Audio SSVC-6 | FG01044 Features at a Glance

- Power handling: 100 watts per channel RMS; 200 watts peak
- Selectable impedance magnification for 1, 2, 3/4, 5/6 pairs of speakers
- Individual room on/off selector switches
- 12-step controls; 54dB maximum attenuation
- Separate left and right ground paths for compatibility with all amplifiers
- Removable screwless connectors accommodate up to 12-gauge wire
- Rugged all metal chassis construction
- Non skid feet won't scratch furniture and ensure unit stability during operation
- 72 adhesive-backed room identification labels



PROFESSIONAL
by HARMAN

- [HOME](#)
- [PRODUCTS](#)
- [SUPPORT](#)
- [DOWNLOADS](#)
- [COMPANY](#)
- [NEWS](#)
- [STORE](#)
- [SEARCH](#)
- [SITEMAP](#)

Installed Sound

8100 Series : AE : AE Compact : AW & AWG All Weather : CBT Series : Commercial Series Speakers : Control 1 Pro : Control 200 : Control 2P : Control 300 : Control 40 : Control 5 : Control 60 Series : Control Contractor : Control Contractor 50 Series Sub/Sat : Control CRV : Custom Shop : CWT Series : Marquis Dance Club : PD5000 Series : PD700 : VERTEC : VLA : VP : VRX

Control 25

**Compact Indoor
Outdoor Background
Foreground Loudspeaker**



- [Brochure](#)
- [Spec Sheet](#)
- [Owner's Manual](#)

The Control 25 is perhaps the most versatile of JBL Professional's Control Contractor Series indoor/outdoor loudspeakers.

Features :

- ▶ Components: 5.25 in Polypropylene coated woofer, .75 in Titanium coated horn loaded tweeter.
- ▶ Built-in InvisiBall® mounting hardware*.
- ▶ Weather resistant enclosure and transducers.
- ▶ Readily paintable.
- ▶ 90° x 90° high frequency horn.
- ▶ Overload Protection Circuitry.
- ▶ Sensitivity: 88 dB SPL, 1W, 1m
- ▶ *Patents pending worldwide

Specifications :

- Frequency Range :** 80 Hz to 16 kHz (-10 dB)
- Power Capacity :** 150 W Continuous Program Power
75 W Continuous Pink Noise
- Sensitivity :** 88 dB SPL, 1 W, 1m
- Directivity Factor (Q) :** 5.3 dB
- Directivity Index (DI) :** 7.2 dB
- Nominal Impedance :** 8 ohms
- Crossover Frequency :** 3.0kHz
- Frequency LF Driver :** 135mm (5.25 in) Polypropylene cone w/ WeatherEdge
- HF Driver :** 19mm (.75 in) Titanium coated polycarbonate
- Enclosure Material :** HIPS (High Impact Polystyrene)
- Overload Protection :** Full-Range power limiting to protect network and transducers
- Terminations :** Spring terminals, accepts banana plug
- Environmental :** Conforms to Mil Spec 810 for humidity, salt spray, temperature & UV. IEC 529 IP-X4 splashproof rating
- Dimensions (H x W x D) :** 236 x 188 x 149 mm (9.3 x 7.4 x 5.8 in)
- Net Weight (ea) :** 2.3 kg (5 lb)
- Shipping Weight (ea) :** 5 kg (11 lb)
- Included Accessories :** InvisiBall Assembly
- Optional Accessories :** MTC-25V: For vertical columnar orientation of up to 3 loudspeakers extension of the woofer surround that MTC-25/25H: For horizontal spacing of two speakers. Three brackets array up to six loudspeakers in a 360° array. MTC-28/25CM: Ceiling-mount adapter. MTC-25SSG: Stainless Steel Grille for harsh environments. Available in silver, black (-BK) or white (-WH) MTC-25WMO: WeatherMax™ Stainless Steel Grille protects against driving precipitation. Available in black or white (-WH) MTC-PC2: Input panel cover protects input terminals in outdoor environments.



Contact | Careers | Privacy Policy | Site Map
© 2013 JBL Incorporated, 8500 Balboa Blvd, Northridge, CA 91329 USA. All Rights Reserved.

PHONE, MIXER
OR OTHER
SOUND SOURCE

EQUALIZER

LIMITER
(STEREO)

AMPLIFIERS/AMPLIFIED
SPEAKERS
Volume controls on
maximum.

NOTE - LIMITER AND EQUALIZER
FUNCTIONS CAN BE COMBINED IN
ONE PROCESSOR

NOT TO SCALE. All Acoustilog,
Inc.-designed information supplied
is for the original client and may
not be copied in any way for
different projects by any architect,
consultant, engineer or other party.
Copyright Acoustilog, Inc. © 2022.
All rights reserved. No reproduction
of any type permitted without
written permission of Acoustilog,
Inc.



Larger Images

ALL YOU NEED TO GET THE MOST FROM YOUR PA. NOW WITH COMPLETE CONTROL FROM YOUR MOBILE DEVICE.

The DriveRack® PA2 provides all the processing you need between your mixer and amplifiers to optimize and protect your loudspeakers. With the latest advancements in dbx's proprietary AutoEQ™ and AFS™ algorithms, a new input delay module for delaying the FOH system to the backline, Ethernet control via an Android®, iOS®, Mac®, or Windows® device, and updated Wizards, the DriveRack PA2 continues the DriveRack legacy of great-sounding, powerful, and affordable loudspeaker management processors, for a whole new generation.



control app for all 4 major OSes

AUTOEQ™

New, improved AutoEQ algorithm ensures an extremely accurate, fast, and non-intrusive automatic EQ experience.

With the RTA Mic "listening" to your room, the new, updated DriveRack PA2 AutoEQ algorithm sets speaker levels and room EQ automatically in a matter of seconds. This means room adjustments can now be made very quickly, without subjecting the audience to annoying, lengthy broadcasts of pink noise.

ENHANCED AFS™ FEEDBACK ELIMINATION

Enhanced AFS™ algorithm for faster, more precise feedback elimination, without adversely affecting your system's tone.

Nothing turns audiences away like annoying and potentially painful audio feedback. Fortunately, dbx engineers have revisited their already-stellar Advanced Feedback Suppression algorithm and made it work even better. The DriveRack PA2 listens for and anticipates feedback and adjusts speaker output automatically before it even has a chance, while never altering your sound.

UPDATED WIZARD SETUP FUNCTIONS

Updated Wizards make initial set up easy, while ensuring speaker tunings and other settings are up-to-date.

Wizard functions on the DriveRack PA2 guide you through easy, step-by-step processes to help you get the most from your loudspeaker system. Helps you easily configure level balancing, AutoEQ, Advanced Feedback Suppression, and provides access to built-in and constantly updating speaker tunings from most major speaker manufacturers.

AVAILABLE INPUT PROCESSING

- > dbx Compression
- > AFS™ (Advanced Feedback Suppression)
- > Graphic EQ
- > 8-Band Parametric EQ (adjusted when using the AutoEQ)
- > Subharmonic Synthesis

AVAILABLE OUTPUT PROCESSING

- > Crossover (supports full range, 2-way, and 3-way systems)
- > 8-Band Parametric EQs (used for speaker tunings)
- > dbx Limiting
- > Driver Alignment Delays

DriveRack PA2

Complete Loudspeaker Management System

MSRP ~~\$624.94~~
\$399.95
 SAVE \$224.99!

Buy It Now

OVERVIEW

- VIDEOS
- FEATURES
- MANUALS/DOCUMENTATION
- DOWNLOADS
- SPECIFICATIONS
- NEWS
- SUPPORT/FAQS

f Like 555 t Tweet

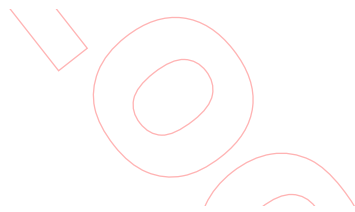

Features

- > All New Setup Wizard
- > Streamlined AutoEQ™
- > All New AFS™ (Advanced Feedback Suppression)
- > Mobile Control (Android®, iOS®, Mac®, Windows®)
- > dbx Compression
- > Graphic EQ
- > 8-Band Parametric EQ (adjusted when using the AutoEQ) Input
- > Subharmonic Synthesis
- > Crossover (supports full range, 2-way, and 3-way systems)
- > 8-Band Parametric EQs (used for speaker tunings) Output
- > dbx Limiting
- > Driver Alignment Delays



The screenshot shows the RadioShack website interface. At the top, there's a navigation bar with the RadioShack logo, customer service contact info, store location, language options, and account/shopping cart links. Below this is a search bar and category tabs for 'CELL PHONES & ACCESSORIES', 'ELECTRONICS & ACCESSORIES', 'HOBBY & DO-IT-YOURSELF', 'BATTERIES & POWER', and 'SHOP ALL PRODUCTS'. A promotional banner for 'R CASH' offers a \$10 reward on a \$30 spend. The main product section features a 'Digital Sound Level Meter' with a price of \$49.99, a 4-star rating from 6 reviews, and an 'ADD TO CART' button. Shipping benefits include free shipping and free ship-to-store. A 'FIND IT NEARBY' button and social media sharing options are also visible.

Product Summary

Fine-tune your audio.

Fine-tune your PA or stereo systems audio response to match the acoustic environment with this Digital Sound Level Meter. It comes with a carrying case for travel and features an easy-to-read display.

- Carrying case protects the meter when traveling
- Easy-to-read display, sound range 30-130db, digit LCD display
- You can fine-tune your PA or stereo systems audio response to match the acoustic environment

Pricing and availability: Please note that all prices are subject to change without prior notice. Prices advertised on this site are for online orders only. Prices on some items may differ from those advertised in RadioShack stores. All merchandise may not be available at all stores, and all stores may not participate in all sales promotions. We recommend you contact the store to confirm product availability and price.

Shipping

Usually ships in 1 - 2 business days

In store: [Check availability](#)

By phone: 1-800-843-7422

Manufacturer Warranty

- Parts: 12 month
- Labor: 12 month



ACOUSTICAL SURFACES, Inc.

Your One-Stop Resource for Soundproofing and Noise Control Solutions

- [Applications](#)
- [What's Your Problem?](#)
- [Acoustics 101](#)
- [Soundproofing Tips](#)
- [Literature](#)
- [Photos](#)
- [News](#)
- [Who We Are](#)
- [Financing](#)
- [Contact Us](#)
- [Links](#)
- [Site Map](#)
- [Blog](#)
- [Home](#)

Noise Control Help Line
1-800-854-2948
M-F 7am-6pm (Central time)
BEST PRICE GUARANTEE

- ECHO ELIMINATOR™
- SOUND SILENCER™
- dBA Panels
- DECORATIVE FABRIC WRAPPED PANELS
- SOUND ABSORBING FOAM
- HANGING ACOUSTICAL BAFFLES
- SONEX™ FOAM PRODUCTS
- ACOUSTIC QUILTED CURTAIN
- NOISE BARRIER-NOISE BLOCKERS
- FLOORING UNDERLAYS
- SEALANTS - ADHESIVES - GREEN GLUE
- ACOUSTICAL CEILING TILES
- SOFTWALL - WALLMATE
- VIBRATION MOUNTS - HANGERS & PADS
- HVAC PRODUCTS / SILENCERS
- WALL INSULATION
- SOUND LEVEL METER - HEADPHONES
- SOUND TESTING & ACOUSTICAL ANALYSIS SERVICES
- ADJUSTABLE DOOR SEALS
- SCHOOL NOISE MANAGEMENT
- KIKBRIK - DRUM DAMPER
- ACOUSTIC WINDOWS - INSERTS
- ACOUSTIC DOORS
- ACOUSTIC ENCLOSURES
- RSIC SOUND ISOLATION CLIPS
- OUTDOOR BARRIER WALL™ SYSTEM
- ACOUSTI-BOARD™
- ONE STEP DECORATIVE WALL SYSTEM
- ACOUSTIMETAL™ PERFORATED METAL PANELS
- SOUNDSCREEN™ WHITE NOISE MACHINE
- T-MOLD SYSTEM™
- ACOUSTICAL FABRIC SELECTION
- ADJUSTABLE CUTTERS - SPRINKLER CUTTER
- BUY NOW PAY LATER

All of the information on our site is available for download within the product pages.

Specifications subject to change with out notice.

© 2007 Acoustical Surfaces, Inc., All rights reserved.

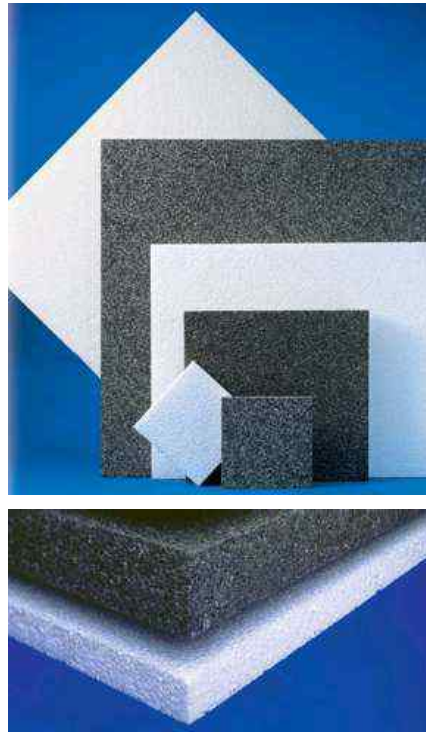

SOUND SILENCER™

Porous Expanded Polypropylene (P.E.P.P.) Acoustical Wall and Ceiling Tile Panels

- Class A Fire Retardant
- No Fiberglass-Non-Fibrous
- Moisture Resistant Indoor
- Non-fibrous
- Impact Resistant
- Water resistant
- Non-abrasive surface
- Indoor/Outdoor
- Both STC and NRC ratings
- Tackable surface
- Bacteria and fungi resistant
- Lightweight
- Superior Soundproofing Qualities

Click on image for larger view



Charcoal - Actual Size

White - Actual Size

click on  icon to download product Spec sheet.



Product testing and information			
 Testimonials	 Acoustical Test	 MSDS	 Flammability
 Installation	 Product Photo's	 Misc. Data	

MATERIAL: Semi Rigid Porous Expanded Polypropylene Acoustical Bead Foam (P.E.P.P.).

PATTERN: Non Abrasive, Slightly Textured, Porous

FEATURES: Lightweight, Impact Resistant, Moisture, Bacteria & Fungi Resistant, Tackable Surface

APPLICATIONS: Gymnasiums, Auditoriums, Classrooms, Swimming Pools, Ice Arenas, Clean Rooms, Food Processing Plants, Food Prep Areas, Cafeterias & Restaurants, Manufacturing Plants, Car Washes, Rooftop and Machine Enclosures, Gun Ranges, Dog Kennels, Locker Rooms.

THICKNESS: 1" & 2"

SIZES: Nominal 2' x 2', 2' x 4'; Custom Sizes Available

COLORS: White, Charcoal

FLAMMABILITY: ASTM E84, Class A. 1": Flame Spread: 3, Smoke Developed: 84. 2": Flame Spread: 5, Smoke Developed: 113

INSTALLATION: ASI S.T.O.P. Noise Acoustical Adhesive, Mechanical Fasteners

***Note to all installers**

Sound Silencer™ PEPP is a thermal molded product and although tough to see one side of the panel will have injection and mold release marks these are circular marks that range in size and indent depth. These marks denote the back side of the panel so panels should be installed with these marks facing the wall or ceiling for best possible aesthetical outcome.

Sound Silencer™ - Sound Absorption / Noise Reduction							
Mount	125Hz	250Hz	500Hz	1KHz	2KHz	4KHz	NRC
1" Wall Amtg	0.05	0.06	0.21	0.80	0.65	0.75	0.45
1" Wall w/ 3/4" Airspace	0.06	0.13	0.51	0.79	0.62	0.79	0.50
1" Wall w/ 1" B.A.C.	0.11	0.58	1.07	0.71	0.74	0.72	0.80
2" Wall Amtg	0.07	0.21	0.81	0.85	0.93	0.88	0.70
2" Wall w/ 3/4" Airspace	0.10	0.29	0.99	0.74	0.90	0.93	0.75
2" Wall w/ 1" B.A.P.	0.17	0.81	0.97	0.85	0.89	0.92	0.90
1" Ceiling E400	0.46	0.59	0.42	0.49	0.76	0.86	0.55
2" Ceiling E400	0.51	0.52	0.52	0.77	0.89	0.98	0.70
1" Wall C423 12" spacing	0.04	0.07	0.20	0.83	0.81	1.00	0.50
2" Wall C423 12" spacing	0.09	0.21	0.82	1.11	1.11	1.12	0.80

Sound Silencer™ - Sound Transmission Loss (STC)							
	125Hz	250Hz	500Hz	1KHz	2.5KHz	5KHz	STC
1"	6	5	7	8	10	15	9
2"	9	8	10	10	17	22	13
1" - w/5/8" Gypsum both sides	27	27	29	31	32	45	32

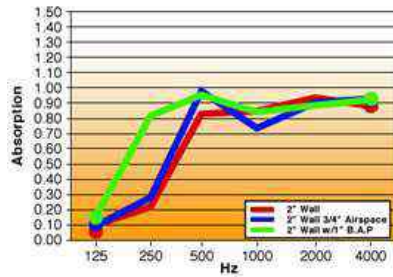
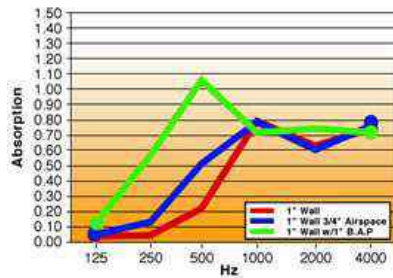

Click PDF icon to download printer friendly file format of product specs.

[ASTM C423 – Sound Absorption 8 Panels – 1" PEPP Arranged in 2 x 4 Fashion with 12" spacing between all panels](#)

[ASTM C423 – Sound Absorption 8 Panels – 2" PEPP Arranged in 2 x 4 Fashion with 12" spacing between all panels](#)



Click to receive a free copy of Adobe Acrobat Reader.

- Soundproofing Products • Sonex™ Ceiling & Wall Panels • Sound Control Curtains • Equipment Enclosures • Acoustical Baffles & Banners • Solid Wood & Veneer Acoustical Ceiling & Wall Systems • Professional Audio Acoustics • Vibration & Damping Control Fire Retardant Acoustics • Hearing Protection • Moisture & Impact Resistant Products • Floor Impact Noise Reduction • Sound Absorbers • Noise Barriers • Fabric Wrapped Wall Panels • Acoustical Foam (Egg Crate) Acoustical Sealants & Adhesives • Outdoor Noise Control • Assistive Listening Devices • OSHA, FDA, ADA Compliance • On-Site Acoustical Analysis • Acoustical Design & Consulting • Large Inventory • Fast Shipment • No Project too Large or Small • Major Credit Cards Accepted

Sedona Club Inc

Area Survey with List of Measurements

AREA SURVEY
39 Clarkson Street
New York, NY
May 29, 2023

NOT TO SCALE

GARAGE
DOOR

RESIDENTIAL

GARAGE
DOOR

RESIDENTIAL

COMMERCIAL
SPACE

OFF.
BUILD.
ENT.

EN JAPANESE
BRASSERIE

OUT OF
RANGE

- LEROY ST. -

SHIPPING
STORE

FITNESS
CENTER

COMMERCIAL
SPACE

FITNESS
CENTER

RESIDENTIAL

- HUDSON ST. -

ATHLETIC
FIELD

RAYMOND
PAGAN
FIELD

COMMERCIAL
SPACE

ALLEYWAY

DENTAL
OFFICE

GALLERY

APPLICANT

RESIDENTIAL

- CLARKSON ST. -

GARAGE

BAKERY/
COFFEE

NYC

CARPENTERS

OFFICE
BUILDING

EMPTY

LOT

(CONST.)

COMMERCIAL
BUILDING
(UPS)

TRAINING
CENTER

- W. HOUSTON ST. -

COMMERCIAL
BUILDING
(UPS)

GARAGE

OFF. BUID.
ENTRANCE

VACANT

VACANT

JUICE
STORE

OFFICE
BUID. ENT.

DEPARTMENT
OF
STATE

Landess-Simon, Inc.

Legal & Commercial Photography

45 Lawlins Park

Wyckoff, NJ 07481

Phone: (201) 848-5652

E-mail: landess@att.net

landessphotographers.com

RE: 39 CLARKSON STREET (375' RADIUS)

1. EN Japanese Brasserie - 435 Hudson Street - 476'

CHURCHES & SCHOOLS

There are no churches and schools within 500' of the applicant.

ATHLETIC
FIELD

EMPTY
LOT

- HUDSON ST. -

RESIDENTIAL

BAKERY/
COFFEE

RESIDENTIAL

APPLICANT

NYC

GALLERY

CARPENTERS

RESIDENTIAL

TRAINING
CENTER

- CLARKSON ST. -

- GREENWICH ST. -

LOADING DOCKS

GARAGE

BLOCK PLOT
39 CLARKSON STREET
NEW YORK, N.Y.
MAY 29, 2023
NOT TO SCALE

Landess-Simon, Inc.

Legal & Commercial Photography

45 Lawlins Park
Wyckoff, NJ 07481
Phone: (201) 848-5652
E-mail: landess@att.net
landessphotographers.com

Greenwich Street

Entrance

64'

Elevator
1st Floor

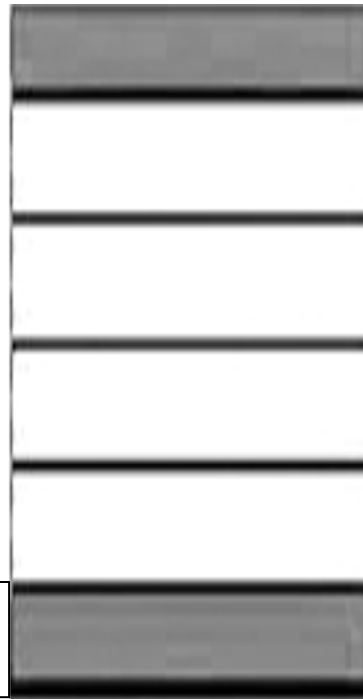

Elevator
6th Floor

APPLICANT

61'

Total Interior Measurement = 125'

INTERIOR MEASUREMENT
39 Clarkson Street
New York, NY
May 29, 2023

NOT TO SCALE

Clarkson Street

Hudson Street