

APPLICANT INFORMATION:

Name of applicant(s): Amis 79 LLC

Trade name (DBA): TBD

Premises address: 79 MacDougal Street, New York, NY 10012

Cross Streets and other addresses used for building/premise:
West Houston and Bleecker Streets

CONTACT INFORMATION:

Principal(s) Name(s): Jeongeun Park

Office or Home Address: [Redacted]

City, State, Zip: New York, NY

Telephone #: [Redacted] email: [Redacted]

Landlord Name / Contact: MacDougal & Sixth Realty LLC

Landlord's Telephone and Fax: [Redacted]

NAMES OF ALL PRINCIPAL(s): NAMES / LOCATIONS OF PAST / CURRENT LICENSES HELD

Jeongeun Park

Briefly describe the proposed operation (i.e. "We are a family restaurant that will focus on..."):

A French-inspired fine dining restaurant

WHAT TYPE(S) OF LICENSE(S) ARE YOU APPLYING FOR (MARK ALL THAT APPLY):

- a new liquor license (Restaurant Tavern / On premise liquor Other)
- an UPGRADE of an existing Liquor License
- an ALTERATION of an existing Liquor License
- a TRANSFER of an existing Liquor License
- a HOTEL Liquor License
- a DCA CABARET License
- a CATERING / CABARET Liquor License
- a BEER and WINE License
- a RENEWAL of an existing Liquor License
- an OFF-PREMISE License (retail)
- OTHER : _____

If upgrade, alteration, or transfer, please describe specific nature of changes:
(Please include physical or operational changes including hours, services, occupancy, ownership, etc.)

N/A

If this is for a new application, please list previous use of location for the last 5 years:

Restaurant

Is any license under the ABC Law currently active at this location? yes no

If yes, what is the name of current / previous licensee, license # and expiration date: _____

N/A

Have any other licenses under the ABC Law been in effect in the last 10 years at this location?

yes no

If yes, please list DBA names and dates of operation:

DLA Restaurants LLC,

PREMISES:

By what right does the applicant have possession of the premises?

Own Lease Sub-lease Binding Contract to acquire real property other: _____

Type of Building: Residential Commercial Mixed (Res/Com) Other: _____

Number of floor: 7 Year Built : 1910

Describe neighboring buildings: Mixed: Residential/Commercial

Zoning Designation: R7-2

Zoning Overlay or Special Designation (applicable) N/A

Block and Lot Number: 526 / 28

Does the premise occupy more than one building, zoning lot, tax lot or more than one floor? yes no

Is the premise located in a historic district? yes no

(if yes, have all exterior changes or changes governed by the Landmarks Preservation Commission (LPC) been approved by the LPC? yes no, please explain : _____

Will any outside area or sidewalk café be used for the sale or consumption of alcoholic beverages? (including sidewalk, roof and yard space) no yes : explain roadbed seating

What is the proposed Occupancy? 78

Does the premise currently have a valid Certificate of Occupancy (C of O) and all appropriate permits?

no yes

If yes, what is the maximum occupancy for the premises? 78

If yes, what is the use group for the premises? 6

If yes, is proposed occupancy permitted? yes no, explain : _____

If your occupancy is 75 or greater, do you plan to apply for Public Assembly permit? yes no

Do you plan to file for changes to the Certificate of Occupancy? yes no
(if yes, please provide copy of application to the NYC DOB)

Will the façade or signage be changed from what currently exist at the premise? no yes

(if yes, please describe: _____

INTERIOR OF PREMISES:

What is the total licensed square footage of the premises? 2,400 sq ft

If more than one floor, please specify square footage by floors: GF: 1,400 sq ft and Basement: 1,000 sq ft

If there is a sidewalk café, rear yard, rooftop, or outside space, what is the square footage of the area?

TBD

If more than one floor, what is the access between floors? Stairs

How many entrances are there? 1 How many exits? 1 How many bathrooms? 2

Is there access to other parts of the building? no yes, explain: _____

OVERALL SEATING INFORMATION:

Total number of tables? 18 Total table seats? 54

Total number of bars? 2 Total bar seats? 10

Total number of "other" seats? 20 please explain: roadbed seating

Total OVERALL number of seats in Premises: 84 (64 inside and 20 outside)

BARS:

How many *stand-up bars / bar seats are being applied for on the premises? Bars 1 Seats 10

How many service bars are being applied for on the premises? 1

Any food counters? no yes, describe: _____

For Alterations and Upgrades:

Please describe all current and existing bars / bar seats and specific changes: _____

N/A

* A stand-up bar is any bar or counter (whether seating or not) over which a member of the public can order, pay for and receive food and alcoholic beverages.

PROPOSED METHOD OF OPERATION:

What type of establishment will this be? (check all that apply)

Bar Bar & Food Restaurant Club/ Cabaret Hotel Other: _____

What are the Hours of Operation?

Sunday: Monday: Tuesday: Wednesday: Thursday: Friday: Saturday:
12pm to 12am 5pm to 12am 5pm to 12am 5pm to 12am 5pm to 12am 5pm to 12am 12pm to 12am

Will the business employ a manager? no yes, name / experience if known : _____

Will there be security personnel? no yes(if yes, what nights and how many?) _____

Do you have or plan to install French doors, accordion doors or windows that open? no yes

If yes, please describe : _____

Will you have TV's ? no yes (how many?) _____

Type of MUSIC / ENTERTAINMENT: Live Music Live DJ Juke Box Ipod / CDs none

Expected Volume level: Background (quiet) Entertainment level Amplified Music
(check all that apply) ***twice a year (Acoustic and Jazz)**

Do you have or plan to install soundproofing? no yes

IF YES, will you be using a professional sound engineer? Yes

Please describe your sound system and sound proofing: _____

Soundboard in walls and ceilings

Will you be permitting: No promoted events No scheduled performances No outside promoters

No any events at which a cover fee is charged? Yes private parties

Do you have plans to manage or address vehicular traffic and crowd control on the sidewalk caused by your establishment? no yes (if yes, please attach plans)

Will you be utilizing No ropes No movable barriers No other outside equipment (describe) No

Are your premises within 200 feet of any school, church or place of worship? no yes

If there is a school, church or place of worship within 200 feet of your premises or on the same block, please submit a block plot diagram or area map showing its' location in proximity to your applicant premises (no larger than 8 1/2 " x 11").

Indicate the distance in feet from the proposed premise:

Name of School / Church: _____

Address: _____ Distance: _____

Name of School / Church: _____

Address: _____ Distance: _____

Name of School / Church: _____

Address: _____ Distance: _____

Please provide contact information for Residents / Community Board and confirm that if complaints are made you will address it immediately.

Contact Person: _____ Phone: _____

Address: _____

Email : _____

Application submitted on
behalf of the applicant by:

Signature

Print or Type Name JEONGEUN PARK

Title OWNER

Thank you for your cooperation. Please return this questionnaire along with the other required documents as soon as you can. This will expedite your application and avoid any unnecessary delays. Use additional pages if necessary.



Community Board 2, Manhattan
SLA Licensing Committee
Carter Booth, Co-Chair
Robert Ely, Co-Chair

Jeanine Kiely, Chair
Susan Kent, First Vice Chair
Valerie De La Rosa, Second Vice Chair
Bob Gormley, District Manager



Antony Wong, Treasurer
Eugene Yoo, Secretary
Ritu Chatterjee, Assistant Secretary

Community Board No. 2, Manhattan

3 Washington Square Village
NEW YORK, NY 10012-1899

www.cb2manhattan.org

P: 212-979-2272 F: 212-254-5102 E: info@cb2manhattan .org

Greenwich Village ♦ Little Italy ♦ SoHo ♦ NoHo ♦ Hudson Square ♦ Chinatown ♦ Gansevoort Market

COMMUNITY BOARD 2 APPLICATION FOR A STATE LIQUOR AUTHORITY LICENSE ADDENDUM FOR OUTDOOR SEATING

For a Liquor License Application that includes any outdoor areas, please complete the following:

- Submit a diagram of outdoor seating indicating length and width of area(s) and location of all tables and chairs. Include all obstructions (trees, fire hydrants, proximity to bus stops, bike racks, signs, etc.).
- Submit photos of the premises where the sidewalk café and/or roadbed will be located. Required photos show one frontal, one left and one right side view of proposed sidewalk café and/or roadbed.
 - Photos must show complete sidewalk and/or roadway area where sidewalk café and/or roadbed will be including views to curb and neighboring properties.
 - If seating is in a rear yard show photos of yard and surrounding area, including upper view of adjacent buildings.

Sidewalk café will have no more than *(If premises is located on a corner please indicate for both streets):*

_____ tables and _____ seats on _____ Street

_____ tables and _____ seats on _____ Street

Hours of sidewalk café: _____ to _____ .

Describe any obstructions (trees, fire hydrant, proximity to bus stop, etc): _____

Roadbed will have no more than *(If premises is located on a corner please indicate for both streets):*

_____ 5 _____ tables and _____ 20 _____ seats on _____ MacDougal _____ Street

_____ 0 _____ tables and _____ 0 _____ seats on _____ n/a _____ Street

Hours of roadbed: _____ n/a _____ to _____ n/a _____ .

Describe any obstructions (trees, fire hydrant, proximity to bus stop, etc): _____ n/a _____

Rear yard will have no more than _____ 0 _____ tables and _____ 0 _____ seats

Hours of rear yard: _____ n/a _____ to _____ n/a _____ .

Does seating extend beyond the business frontage? No Yes

Will outdoor dining structures **on the sidewalk** be enclosed on three (3) or more sides? No Yes

Will outdoor dining structures **on the roadbed** be enclosed on three (3) or more sides? No Yes

Is there any outdoor music, speakers or TVs? No Yes, please describe: _____

Will heating elements be used? No Yes, please describe: _____



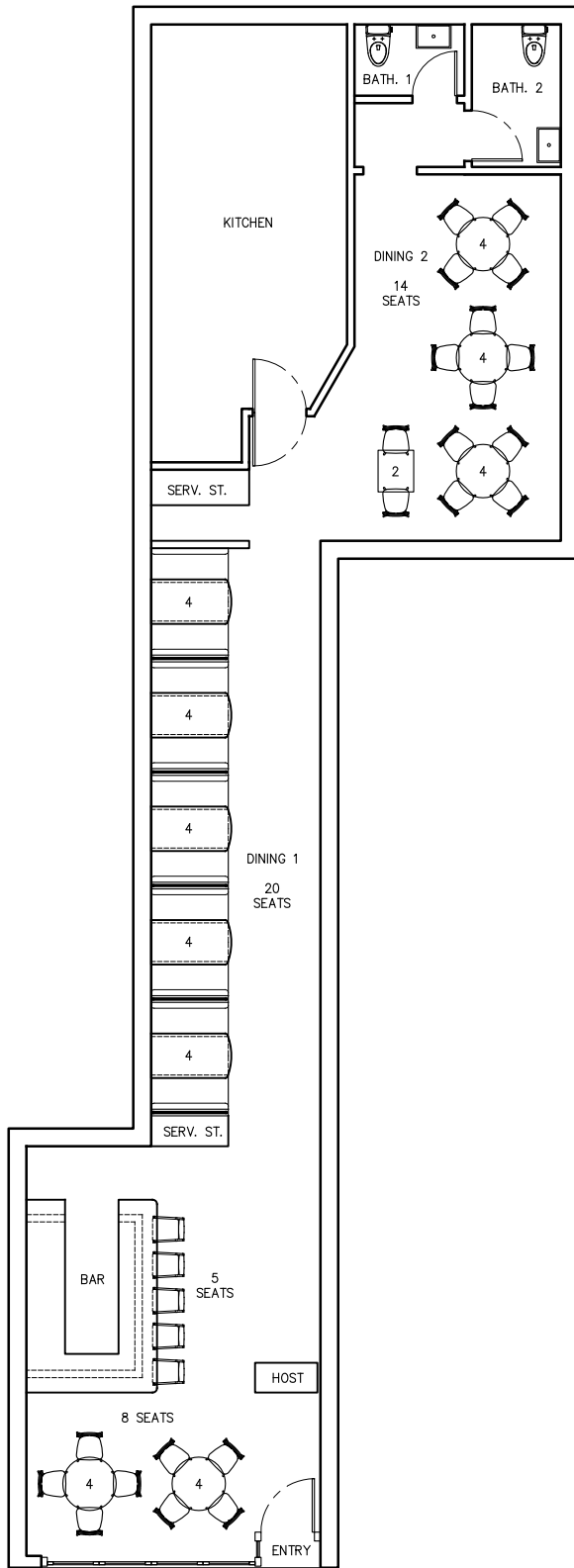

Roadbed Seating



A La carte

- Sourdough \$9
- Potato pancake \$18
- Oyster \$25
- Seafoods platter \$43
- King crab salad \$28
- Leeks vinaigrette \$22

Prix-fixe menu \$75

Spinach Tartlet, Sardine, Chestnut

Beef tartare

Squash with Potato, Sea urchin

Semi dried beet with Apple

Branzino with fish broth and mala oil

Chrysanthemum ice cream with Rice donuts

Desserts

- Panna cotta with vinegar and honey 15
- Chocolate cake with whipped cream 17
- Strawberry sorbet with balsamic 13