

Meeting Date: \_\_\_\_\_

## APPLICANT INFORMATION:

Name of applicant(s):

**Christopher Street Events LLC**

Trade name (DBA):

**L'Artusi Supper Club**

Premises address:

**105 Christopher Street**

Cross Streets and other addresses used for building/premise:

**Christopher between Bleeker and Hudson**

## CONTACT INFORMATION:

Principal(s) Name(s):

**Kevin Garry**

Office or Home Address:

**205 Hudson Street 7th Floor**

City, State, Zip:

**NY, NY 10013**

Telephone #:

**917-502-4239**

email :

**kevin@epicurean.info**

Landlord Name / Contact:

**Robert Susser**

Landlord's Telephone and Fax:

**646-345-7877**

**NAMES OF ALL PRINCIPAL(s):**

**Kevin Garry**

**August Cardona**

**NAMES / LOCATIONS OF PAST / CURRENT LICENSES HELD**

**L'Artusi, b'artusi, Anfora**

Briefly describe the proposed operation (i.e. "We are a family restaurant that will focus on..."):

**We have more demand that we can fulfill at L'Artusi and would like to create "L'Artusi Supper Club" that allows for the L'Artusi experience**

**in a more intimate, communal, family style setting. Our intention is to offer both classic and new L'Artusi dishes created by our long time**

**chef, Joe Vigorito. We also plan to host winemaker dinners, guest chef dinners and also private events from time to time.**

**WHAT TYPE(S) OF LICENSE(S) ARE YOU APPLYING FOR ( MARK ALL THAT APPLY):**

☒ a new liquor license ( ☒ Restaurant ☐ Tavern / On premise liquor ☐ Other )

☐ an UPGRADE of an existing Liquor License

☐ an ALTERATION of an existing Liquor License

☐ a TRANSFER of an existing Liquor License

☐ a HOTEL Liquor License

☐ a DCA CABARET License

☐ a CATERING / CABARET Liquor License

☐ a BEER and WINE License

☐ a RENEWAL of an existing Liquor License

☐ an OFF-PREMISE License (retail)

☐ OTHER : \_\_\_\_\_

If upgrade, alteration, or transfer, please describe specific nature of changes:

(Please include physical or operational changes including hours, services, occupancy, ownership, etc.)

---

---

---

If this is for a new application, please list previous use of location for the last 5 years:

**I sodi restaurant has been in the space since 2008. They are moving to a bigger location.**

---

---

Is any license under the ABC Law currently active at this location? ☒ yes ☐ no

If yes, what is the name of current / previous licensee, license # and expiration date: \_\_\_\_\_

I Sodi LLC - 1200148 - expires 1/31/24 - issued in 2008

---

Have any other licenses under the ABC Law been in effect in the last 10 years at this location?

☒ yes ☐ no

If yes, please list DBA names and dates of operation:

Just I Sodi , since 2008

---

---

## PREMISES:

By what right does the applicant have possession of the premises?

☐ Own ☒ Lease ☐ Sub-lease ☐ Binding Contract to acquire real property ☐ other: \_\_\_\_\_

Type of Building: ☐ Residential ☐ Commercial ☒ Mixed (Res/Com) ☐ Other: \_\_\_\_\_

Number of floor: 4 Year Built : 1900

Describe neighboring buildings:

**A mix of retail and residential**

Zoning Designation: R6

Zoning Overlay or Special Designation (applicable) \_\_\_\_\_

Block and Lot Number: 619 / 38

Does the premise occupy more than one building, zoning lot, tax lot or more than one floor? ☐ yes ☒ no

Is the premise located in a historic district? ☒ yes ☐ no

(if yes, have all exterior changes or changes governed by the Landmarks Preservation Commission (LPC) been approved by the LPC? ☐ yes ☒ no, please explain : **No plans to change exterior**

Will any outside area or sidewalk café be used for the sale or consumption of alcoholic beverages? (including sidewalk, roof and yard space) ☒ no ☐ yes : explain \_\_\_\_\_

What is the proposed Occupancy? 48

Does the premise currently have a valid Certificate of Occupancy (C of O) and all appropriate permits?

☐ no ☒ yes

If yes, what is the maximum occupancy for the premises? 48

If yes, what is the use group for the premises? UG6

If yes, is proposed occupancy permitted? ☒ yes ☐ no, explain : \_\_\_\_\_

If your occupancy is 75 or greater, do you plan to apply for Public Assembly permit? ☐ yes ☐ no **N/A**

Do you plan to file for changes to the Certificate of Occupancy? ☐ yes ☒ no  
(if yes, please provide copy of application to the NYC DOB)

Will the façade or signage be changed from what currently exist at the premise? ☐ no ☒ yes

(if yes, please describe: **A very minimal window decal and basic small awning**

## INTERIOR OF PREMISES:

What is the total licensed square footage of the premises? 1863 sq ft

If more than one floor, please specify square footage by floors: 960 sq ft on ground floor; 863 in basement

If there is a sidewalk café, rear yard, rooftop, or outside space, what is the square footage of the area?

\_\_\_\_\_

If more than one floor, what is the access between floors? Interior Staircase

How many entrances are there? 1 How many exits? 1 How many bathrooms ? 1

Is there access to other parts of the building? X no    yes, explain:   

## OVERALL SEATING INFORMATION:

Total number of tables? 3 Total table seats? 36

Total number of bars? 0 Total bar seats? 0

Total number of "other" seats?    please explain :   

Total OVERALL number of seats in Premises : 36

## BARs:

How many \*stand-up bars / bar seats are being applied for on the premises? Bars 0 Seats 0

How many service bars are being applied for on the premises? 1

Any food counters? x no    yes, describe :   

### *For Alterations and Upgrades:*

Please describe all current and existing bars / bar seats and specific changes:   

Current tenant, i sodi, has one main stand up bar that we intend to remove and have a very small service bar in the back

\* A stand-up bar is any bar or counter (whether seating or not) over which a member of the public can order, pay for and receive food and alcoholic beverages.

## PROPOSED METHOD OF OPERATION:

What type of establishment will this be? (check all that apply)

   Bar    Bar & Food x Restaurant    Club/ Cabaret    Hotel    Other:

What are the Hours of Operation?

Sunday: Monday: Tuesday: Wednesday: Thursday: Friday: Saturday:

12PM to 12AM 12PM to 12AM 12PM to 12AM 12PM to 12AM 12PM to 12AM 12PM to 12AM 12PM to 12AM

Will the business employ a manager? ☐ no ☒ yes, name / experience if known : TBD

Will there be security personnel? ☒ no ☐ yes( if yes, what nights and how many?) \_\_\_\_\_

Do you have or plan to install French doors, accordion doors or windows that open? ☒ no ☐ yes

If yes, please describe : \_\_\_\_\_

Will you have TV's ? ☒ no ☐ yes ( how many? ) \_\_\_\_\_

**Type of MUSIC / ENTERTAINMENT:** ☐ Live Music ☐ Live DJ ☐ Juke Box ☒ Ipod / CDs ☐ none

Expected Volume level: ☒ Background (quiet) ☐ Entertainment level ☐ Amplified Music  
(check all that apply)

Do you have or plan to install soundproofing? ☒ no ☐ yes

IF YES, will you be using a professional sound engineer? \_\_\_\_\_

Please describe your sound system and sound proofing: \_\_\_\_\_

Will you be permitting: ☐ promoted events ☐ scheduled performances ☐ outside promoters

☐ any events at which a cover fee is charged? ☒ private parties

Do you have plans to manage or address vehicular traffic and crowd control on the sidewalk caused by your establishment? ☒ no ☐ yes ( if yes, please attach plans)

Will you be utilizing ☐ ropes ☐ movable barriers ☐ other outside equipment (describe) \_\_\_\_\_

Are your premises within 200 feet of any school, church or place of worship? ☒ no ☐ yes

***If there is a school, church or place of worship within 200 feet of your premises or on the same block, please submit a block plot diagram or area map showing its' location in proximity to your applicant premises ( no larger than 8 ½ " x 11").***

Indicate the distance in feet from the proposed premise:

Name of School / Church: \_\_\_\_\_

Address: \_\_\_\_\_ Distance: \_\_\_\_\_

Name of School / Church: \_\_\_\_\_

Address: \_\_\_\_\_ Distance: \_\_\_\_\_

Name of School / Church: \_\_\_\_\_

Address: \_\_\_\_\_ Distance: \_\_\_\_\_

Please provide contact information for Residents / Community Board and confirm that if complaints are made you will address it immediately.

Contact Person: Max Bookman, Esq. Phone: 212-513-1988

Address: Pesetsky & Bookman, 325 Broadway, Suite 501, New York NY 10007

Email : max@pb.law

Application submitted on  
behalf of the applicant by:



\_\_\_\_\_  
Signature

Print or Type Name Kevin Garry

Title Managing Partner

Thank you for your cooperation. Please return this questionnaire along with the other required documents as soon as you can. This will expedite your application and avoid any unnecessary delays. Use additional pages if necessary.



Community Board 2, Manhattan  
SLA Licensing Committee  
Carter Booth, Co-Chair  
Robert Ely, Co-Chair

OFFICE USE ONLY	
<input type="radio"/> Original	<input type="radio"/> Amended Date _____

## ESTABLISHMENT QUESTIONNAIRE

In this section you must describe the premises to be licensed. Answer ALL questions completely. Please do not answer "see attached" to any question. Any incomplete answer may delay or prevent the processing of the application.

**Helpful Hint: Drawing your diagram and reviewing your photographs may assist you in completing this section.**  
**See sample diagrams at the end of this application.**

### 1. Zoning

1a. State what the area is zoned for:  
 (e.g., Residential, Business, Mixed etc.)

Mixed

1b. Does the premises have a **VALID CERTIFICATE OF OCCUPANCY**  
 and **ALL** appropriate permits?

☒ Yes

☐ No

☐ Pending

### 2. Premises

2a. Describe the type of building in which the premises  
 will be located.

Typical NYC walk up apartment building (4 floors) with ground  
 floor commercial and basement

2b. Is or has the building/proposed premises been known by any other address?

☐ Yes

☒ No

If YES, please specify:

*If the address was changed due to a 911 update or other government action, please include  
 documentation for the change.*

2c. Is there currently an active license or has there ever been a license to traffic  
 in alcoholic beverages at this location?

☒ Currently Licensed

☐ Previously Licensed

☐ Never Licensed

☐ Do Not Know

Name of Licensee:

sodi

License Serial Number:

1200148

2d. Are there any disciplinary actions pending against the applicant, current licensee or prior licensee?

☐ Yes

☐ No

☒ Do Not Know

**Any pending disciplinary action may delay a determination on this application or result in the disapproval.**

2e. If the proposed premises has never been licensed, what was the prior use?

2f. Is any other floor or area of the building currently licensed?

☐ Yes

☒ No

Name of Licensee:

License Serial Number:

OFFICE USE ONLY		
<input type="radio"/> Original	<input type="radio"/> Amended	Date _____

### 3. Premises (interior):

3a. List the total number of floors of the business establishment to be licensed, including the basement:

3b. List the floor(s) where the proposed premises will be located:  
(e.g., basement, ground floor, 2nd & 3rd floor, etc.)

3c. Where is the alcohol stored?

3d. Is there interior access to any other floor(s) or area(s) that will not be part of the premises to be licensed?  
If yes, show the means of access on the interior diagram(s).

☐ Yes ☒ No

3e. Are the premises to be licensed divided in any way, by a public or private passageway, over which the applicant does not have exclusive possession and control?  
(e.g., hallway, stairwells, common areas, etc.)

☐ Yes ☒ No

If YES, describe:

3f. How many public restrooms? If less than two (2) public restrooms, you must request a waiver of the two (2) restroom rule in writing. Please show restrooms on diagram.

3g. List the maximum occupancy of the premises:  3h. Number of tables?

3i. Number of seats at tables?  3j. Number of seats at bar or counter?



### 4. Bars:

4a. How many customer bars are located on the premises?  
(a customer bar is where patrons may order, purchase or receive alcoholic beverages)

4b. How many service bars? (a service bar is for wait staff use exclusively)

4c. Describe each bar in the fields below:

#### Bar 1

Bar Type:    
 Length:   
 Shape:    
 Location:  

#### Bar 2

Bar Type:   
 Length:   
 Shape:   
 Location:

#### Bar 3

Bar Type:   
 Length:   
 Shape:   
 Location:

**Attach additional sheets if there are more than 3 bars.**

OFFICE USE ONLY	
<input type="radio"/> Original	<input type="radio"/> Amended
Date	_____

**5. Kitchen:**

5a. Does the premises have a full kitchen? ☒ Yes ☐ No

If NO, does the premises have a food preparation area? ☐ Yes ☐ No

**Show Kitchen or Food Prep Area on the Interior Diagram**

**NOTE: FOOD MUST BE AVAILABLE FOR SALE DURING ALL HOURS OF OPERATION; SUBMIT A MENU**

5b. Is a chef/cook employed at the premises? ☒ Yes ☐ No

If YES, please list hours of day chef/cook will devote to the premises:

All hours of operation

**6. Hotel or Bed & Breakfast:**

6a. How many floors?

6b. How many guest rooms?

6c. For Hotels Only: Is there a public restaurant on the hotel premises? ☐ Yes ☐ No

**7. Outdoor Areas:**

7a. Are there any outside areas used for the sale or consumption of alcohol? ☐ Yes ☒ No

7b. If YES, what is the outside occupancy?

7c. Check all types that apply:  
(there must be direct access from the interior of the premises to any outdoor area(s) that you wish to license. Show access on diagram)

- |   |                               |                                  |                                   |                                 |
|---|-------------------------------|----------------------------------|-----------------------------------|---------------------------------|
| <input type="checkbox"/> Sidewalk Cafe                          | <input type="checkbox"/> Deck | <input type="checkbox"/> Patio   | <input type="checkbox"/> Porch    | <input type="checkbox"/> Gazebo |
| <input type="checkbox"/> Rooftop                                | <input type="checkbox"/> Yard | <input type="checkbox"/> Balcony | <input type="checkbox"/> Pavilion | <input type="checkbox"/> Tent   |
| <input type="checkbox"/> Other (describe): <input type="text"/> |                               |                                  |                                   |                                 |

7d. Is the outdoor area(s) divided by any public or private passageway or area that the applicant does not have exclusive control? ☐ Yes ☐ No

If YES, how is it divided?

7e. How is the outdoor area(s) contained? Check all that apply and show enclosure on diagram.

- |   |                               |                                    |                                 |                                     |
|---|-------------------------------|------------------------------------|---------------------------------|-------------------------------------|
| <input type="checkbox"/> Fencing                                | <input type="checkbox"/> Wall | <input type="checkbox"/> Shrubbery | <input type="checkbox"/> Roping | <input type="checkbox"/> Stanchions |
| <input type="checkbox"/> Other (describe): <input type="text"/> |                               |                                    |                                 |                                     |

7f. Is a permit required by the locality for outside area(s)? ☐ Yes ☐ No

If yes, submit a copy of the permit.

☐ Original☐ Amended

OFFICE USE ONLY

Date

## PROPOSED METHOD OF OPERATION

*This form satisfies Section 110 of the ABC Law requiring that a statement be submitted indicating the type of establishment operated at the premises.*

The information in this section will be the method of operation you are approved for and will be binding. Should you wish to deviate from this method of operation in any way, you must first apply for and receive permission from the Authority.

1. Will any other business of any kind be conducted in said premises? ☐ Yes ☒ No  
(If YES, please provide details on a separate sheet)

- 1a. If the premises *is not* a catering establishment, will the premises periodically close to host private events? ☒ Yes ☐ No

If YES, how frequently?

2. Will the premises have music? ☒ Yes ☐ No

2a. If YES, check all that apply: ☒ Recorded ☐ DJ ☐ Juke Box ☐ Karaoke

☐ Live Music (give details: e.g., rock bands, acoustic, jazz, etc.):

- 2b. Will the premises use the services of an Event Promoter? ☐ Yes ☐ No

3. Will the premises permit dancing? ☐ Yes ☒ No

3a. If dancing is permitted, who will be permitted to dance? ☐ Patrons ☐ Employees for Entertainment ☐ Both

3b. If dancing is permitted, will there be exotic dancing including, but not limited to, topless entertainment, pole dancing and/or lap dancing? ☐ Yes ☐ No

4. Will there be topless entertainment? ☐ Yes ☒ No

5. Will the business employ a manager? ☒ Yes ☐ No

5a. If NO, will principal(s) manage? ☐ Yes ☐ No

6. How many employees? (excluding principals and security personnel)

6a. If answer is "0" please provide an explanation:

OFFICE USE ONLY		
<input type="radio"/> Original	<input type="radio"/> Amended	Date

7. NYS Law requires businesses to carry workers' compensation and disability insurance (see instructions).  
If applied for and pending, please indicate.

Workers' Compensation Carrier Name and Policy Number:

Disability Insurance Carrier Name and Policy Number:

**If you are exempt from Workers' Compensation and/or Disability Benefits Insurance coverage, submit an approved Certificate of Attestation of Exemption from NYS Workers' Compensation and/or Disability Benefits Insurance Coverage from the NYS Workers' Compensation Board. The application is available on their website: <http://www.wcb.ny.gov> or you may contact them by phone at: (877) 632-4996**

8. Will security personnel be used at the premises? ☐ Yes ☒ No

9a. If YES, how many?

- 9b. If YES, provide your **Proprietary Security Guard Employer Unique Identification Number** assigned to the business by the NYS Department of State Division of Licensing Services or the name of the security company through which the security personnel will be hired:

***The Licensee is responsible for assuring that hired security personnel are registered in accordance with NYS Security Guard Registration Guidelines. Please contact the NYS Department of State to obtain information.***

9. Provide a detailed plan of supervision for the premises to be licensed. Clearly describe how you will maintain control and order over the licensed premises. How will you monitor alcohol sales and prevent sales to minors and sales to intoxicated persons? How will you handle unruly patrons, altercations, etc., to prevent the premises from becoming disorderly? Include additional sheets if necessary.

Similar to our other establishments, we staff an onsite manager that is responsible for ensuring that guests consume alcohol safely and not to excess. We reserve the right not to serve if we feel that a guest is past the point of intoxication. Any patron that appears to be under the age of 30 will be carded. We are well versed in serving alcohol responsibly and will continue to do so.

10. Are all responses provided in this application consistent with the information provided to the municipality or Community Board within the Standardized Notice Form for Providing 30-Day Advance Notice?

☒ Yes ☐ No

10a. If NO, please explain:

**ALCOHOLIC BEVERAGES MAY ONLY BE CONSUMED, SOLD OR GIVEN AWAY DURING THE HOURS APPROVED BY THE COUNTY WHERE THE PREMISES IS LOCATED UNLESS FURTHER RESTRICTED BY THE AUTHORITY**

A list of county closing hours is available at the following link:  
<http://sla.ny.gov/provisions-for-county-closing-hours>

Grand  
Floor

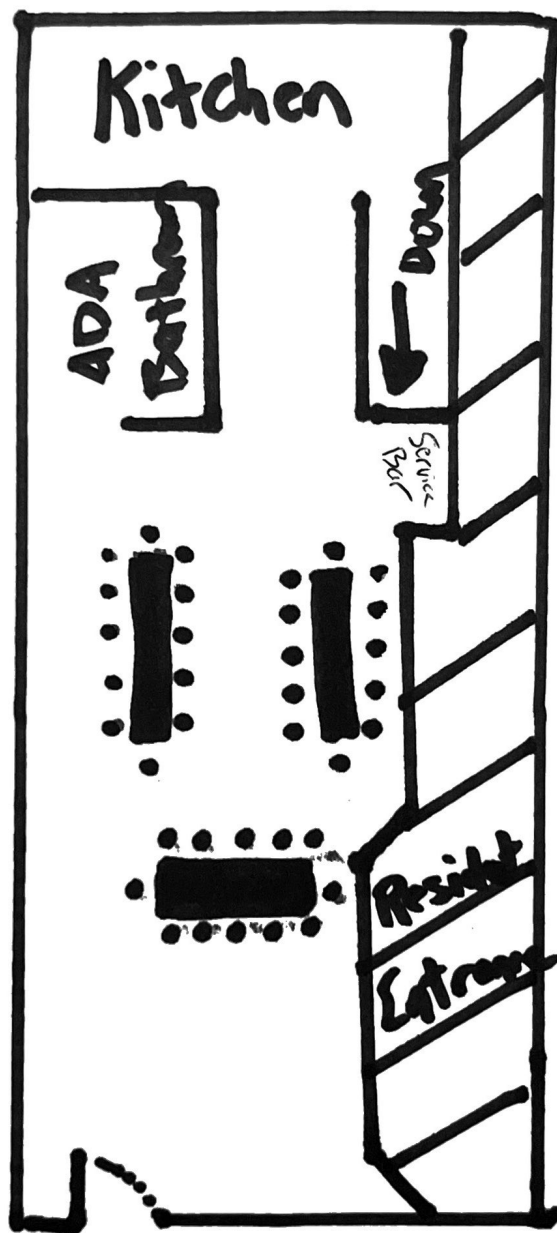

Christopher  
Street

Basement

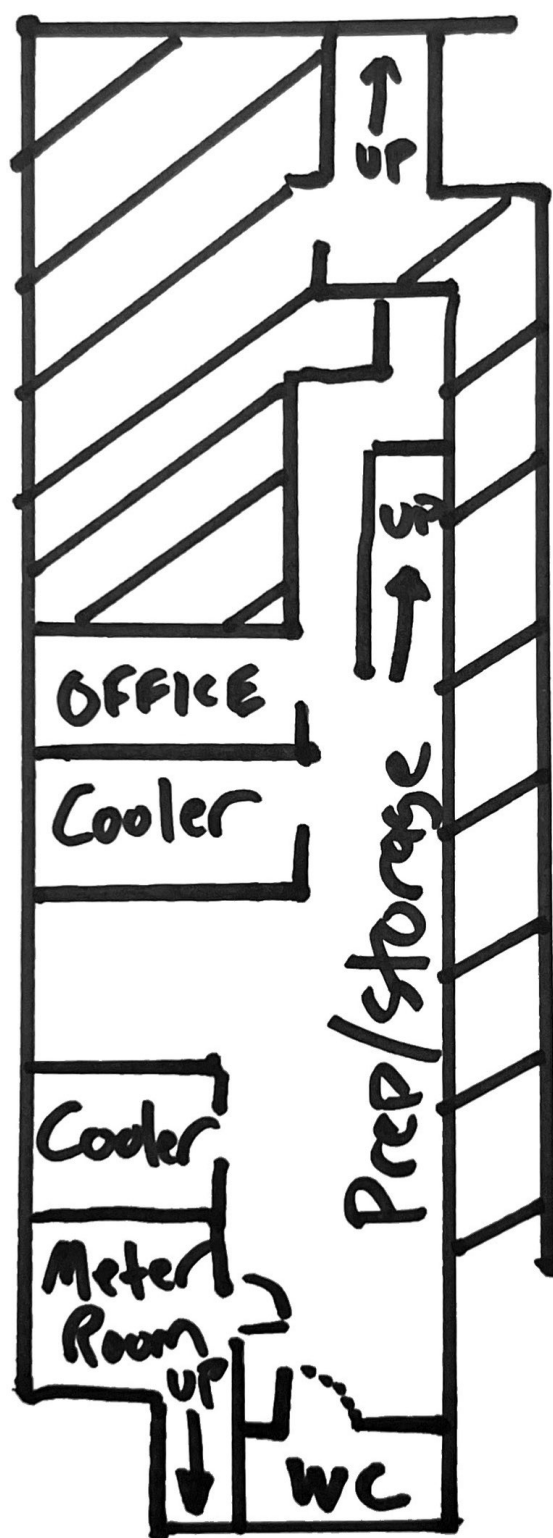

Christopher Street



# L'ARTUSI

## CRUDO

<b>FLUKE*</b> APPLE, CELERY, HORSERADISH	24
<b>WAGYU CARPACCIO*</b> SHALLOT, RYE CRISPS, HORSERADISH CREMA	24
<b>TUNA*</b> OLIVES, SUNDRIED TOMATOES, BASIL AIOLI	25

## VERDURA

<b>ROASTED BEETS</b> MINT YOGURT, WATERCRESS, HAZELNUT	19
<b>FIG &amp; PEAR BURRATA CROSTONE</b> SOURDOUGH, PINE NUT, MINT, BASIL	25
<b>TUSCAN KALE</b> APPLE, CHERRIES, PECAN, PIAVE VECCHIO	19
<b>ROASTED MUSHROOMS*</b> PANCETTA, FRIED EGG, CHILIES, RICOTTA SALATA	20

## PESCE

<b>SCALLOPS</b> CAULIFLOWER PUREE, SWISS CHARD, CAULIFLOWER ESCABECHE, URFA BIBER	34
<b>BRANZINO FILET</b> ROASTED LEMON, OLIVES, HONEY	28

## CARNE

<b>ROASTED CHICKEN</b> HEN OF THE WOODS, SCALLION	34
<b>HANGER STEAK</b> CRISPY POTATOES, SALSA BIANCA	34
<b>L'BURGER*</b> TALEGGIO, CHILI AIOLI, TOMATO, ARUGULA, CRISPY POTATOES	27

## PASTA

<b>TAGLIATELLE</b> BOLOGNESE BIANCO, PARMIGIANO	25	<b>SPAGHETTI</b> GARLIC, CHILIES, PARMIGIANO	25
<b>BUCATINI</b> PANCETTA, TOMATO, CHILIES, PECORINO	23	<b>GARGANELLI</b> MUSHROOM RAGU, RICOTTA SALATA	23
<b>BUCATINI NERO</b> CRAB, CALABRIAN CHILI, TOMATO, NORI BREADCRUMBS	35	<b>PICI "CACIO E PEPE"</b> BLACK PEPPER, PECORINO, PARMIGIANO	22
<b>RIGATONI</b> RABBIT SAUSAGE, SOFRITO, MUSTARD GREENS, PARMIGIANO	26	<b>BUCKWHEAT TORTELLIINI</b> BUTTERNUT SQUASH, WALNUTS, SAGE	23

## CONTORNI

<b>CRISPY POTATOES</b> SALSA BIANCA	12	<b>DELICATA SQUASH</b> PEPITAS, SAGE, MAPLE	12
<b>BRUSSELS SPROUTS</b> LEMON, PECORINO	12	<b>HOUSE-MADE FOCACCIA</b> NONA ROSE'S PEPPERS	8

<b>VEAL CHOP MARSALA</b> PORCINI, PANCETTA, CIPOLLINI	75
--	----

\* CONSUMING RAW OR UNDERCOOKED MEAT, POULTRY, SHELLFISH, OR EGGS MAY INCREASE YOUR RISK OF FOODBORNE ILLNESS

This report is for informational purposes only in aid of identifying establishments potentially subject to 500 and 200 foot rules. Distances are approximated using industry standard GIS techniques and do not reflect actual distances between points of entry. The NYS Liquor Authority makes no representation as to the accuracy of the information and disclaims any liability for errors.

**Proximity Report For:**

Location	<b>105 Christopher St, New York, New York, 10014</b>
Geocode	<b>Latitude: 40.73337 longitude: -74.00498</b>
Report Generated On	<b>2/24/2023</b>

**8 Closest Liquor Stores**

Name	Address	Distance
PRIDE WINE & SPIRITS INC Ser #: 1300163	98 CHRISTOPHER ST NEW YORK, NY 10014	90 ft
SEA GRAPE INC Ser #: 1023604	512 HUDSON STREET NEW YORK, NY 10014	354 ft
PORTUGUESE WINE HOUSE INC, THE Ser #: 1105353	98 7TH AVE SOUTH NEW YORK, NY 10014	507 ft
KRATZ WINES LLC Ser #: 1328267	23 JONES ST STORE EAST NEW YORK, NY 10014	793 ft
CHRISTOPHER STREET WINE & LIQUOR CORP Ser #: 1342884	45 CHRISTOPHER ST NEW YORK, NY 10014	896 ft
GOLDEN RULE WINE & LIQUOR STORE INC Ser #: 1023599	457 HUDSON STREET NEW YORK, NY 10014	905 ft
J V WINES INC Ser #: 1273476	145 7TH AVE S NEW YORK, NY 10014	996 ft
KOVY WINE & SPIRITS CORP Ser #: 1023602	579 HUDSON STREET NEW YORK, NY 10014	1,113 ft

**Schools within 500 feet**

Name	Address	Distance
PS 3 CHARRETTE SCHOOL	490 HUDSON ST NEW YORK, NY 10014	463 ft

**Churches within 500 feet**

Name	Distance
Christian City Church	171 ft
Saint James	296 ft
Finnish Lutheran Church	387 ft
St John's Lutheran Church	387 ft

### Pending On Premises Liquor Licenses within 750 feet

Name	Address	Distance
ANGELS SHARE NYC INC Ser #: 1351240	45 GROVE ST NEW YORK, NY 10014	246 ft
SUSHI ON WEST 10TH STREET LLC Ser #: 1338902	210 W 10TH ST UNIT 2 NEW YORK, NY 10014	301 ft
I SODI LLC Ser #: 1357401	314 BLEECKER ST NEW YORK, NY 10014	336 ft
518 HUDSON STREET LLC Ser #: 1338435	518 HUDSON ST NEW YORK, NY 10014	337 ft
PEN AND FROG SOCIAL CLUB LLC Ser #: 1351825	86 BEDFORD ST NEW YORK, NY 10014	478 ft
RUBY'S WEST VILLAGE LLC Ser #: 1345228	225 W 4TH ST NEW YORK, NY 10014	650 ft
239 WEST 4TH STREET RESTAURANT LLC Ser #: 1351177	239 W 4TH ST NEW YORK, NY 10014	704 ft
BISTROTIER LLC Ser #: 1341710	684 GREENWICH ST NEW YORK, NY 10014	748 ft

### Active On Premises Liquor Licenses within 750 feet

Name	Address	Distance
VILLAGE ACADEMY BAR INC,THE Ser #: 1025682	115 CHRISTOPHER STREET NEW YORK, NY 10014	63 ft
I SODI LLC Ser #: 1200148	105 CHRISTOPHER ST BLEECKER & HUDSON STREETS NEW YORK, NY 10014	118 ft
VICSAM REST INC Ser #: 1034184	114 116 CHRISTOPHER ST NEW YORK, NY 10014	144 ft
228 WEST 10TH STREET LLC Ser #: 1217898	228 W 10TH ST BLEECKER & HUDSON NEW YORK, NY 10014	185 ft
RPC RESTAURANT CORP Ser #: 1316389	120 CHRISTOPHER ST NEW YORK, NY 10014	196 ft
LUCILLE LORTEL THEATRE FOUNDATION INC Ser #: 1343302	121 CHRISTOPHER ST NEW YORK, NY 10014	207 ft
RISHANK LLC Ser #: 1313809	122 CHRISTOPHER ST NEW YORK, NY 10014	224 ft
ORANGE GROVE VENTURES LLC Ser #: 1324665	39 GROVE ST NEW YORK, NY 10014	228 ft
RED GRASS LLC Ser #: 1339441	337 BLEECKER ST NEW YORK, NY 10014	229 ft
JMWILLIAMS LLC Ser #: 1244633	42 44 GROVE STREET NEW YORK, NY 10014	294 ft
FIFTYONE MERCHANTS LLC Ser #: 1275555	49 GROVE ST STORE 1 2 3 NEW YORK, NY 10014	330 ft
EMPLOYEES ONLY LLC & AMERICAN BART INST OF NY INC Ser #: 1157172	510 HUDSON ST CHRISTOPHER W 10TH NEW YORK, NY 10014	356 ft
HUDSON CORNER LLC Ser #: 1334758	520 522 HUDSON ST NEW YORK, NY 10014	360 ft
4T USA INC Ser #: 1341872	310 BLEECKER ST NEW YORK, NY 10014	371 ft

Active On Premises Liquor Licenses within 750 feet		
Name	Address	Distance
CAMPANAROCATERING LLC Ser #: 1300508	55 GROVE ST NEW YORK, NY 10014	413 ft
COWGIRL INC Ser #: 1025508	519 521 HUDSON STREET NEW YORK, NY 10014	416 ft
GRANGIO RESTAURANT CORPORATION Ser #: 1034180	59 GROVE STREET NEW YORK, NY 10014	426 ft
GROVE STREET HOSPITALITY LLC Ser #: 1338454	57 GROVE ST NEW YORK, NY 10014	431 ft
L'ACCOLADE LLC Ser #: 1316638	300 302 BLEECKER ST NEW YORK, NY 10014	432 ft
305 BLEECKER FOOD MARKET LLC Ser #: 1289037	305 BLEECKER ST NEW YORK, NY 10014	440 ft
FIFTYTWO MERCHANTS LLC Ser #: 1304160	52 GROVE ST NEW YORK, NY 10014	442 ft
RF HUDSON (DE) LLC Ser #: 1268205	529 HUDSON ST BASEMENT NEW YORK, NY 10014	461 ft
NINANO INC Ser #: 1335713	61 GROVE ST STORE WEST NEW YORK, NY 10014	474 ft
RF HUDSON (DE) LLC Ser #: 1251196	529 HUDSON ST NEW YORK, NY 10014	477 ft
HUDSON GASTROPUB LLC Ser #: 1296877	131 CHRISTOPHER ST NEW YORK, NY 10014	486 ft
PANZI ENTERPRISES LLC Ser #: 1183943	92 7TH AVE SOUTH GROVE & BARROW ST NEW YORK, NY 10014	497 ft
ALFRED B HOSPITALITY LLC Ser #: 1305298	531 HUDSON ST NEW YORK, NY 10014	505 ft
RAINBOW STARSHIP LLC Ser #: 1311555	100A 7TH AVE S NEW YORK, NY 10014	525 ft
BACBARS GROUP LLC Ser #: 1183524	116 CHARLES ST AKA 533 HUDSON HUDSON & CHARLES STREETS NEW YORK, NY 10014	528 ft
DEACON BRODY MANAGEMENT INC Ser #: 1167601	91 7TH AVE S NEW YORK, NY 10014	539 ft
296 SANDWICH LLC Ser #: 1200891	296 BLEECKER ST BARROW & GROVE STREETS NEW YORK, NY 10014	539 ft
AMBER 135 I INC Ser #: 1321890	135 CHRISTOPHER ST NEW YORK, NY 10014	562 ft
BOUCHERIE LLC Ser #: 1297112	97 99 7TH AVE S NEW YORK, NY 10014	595 ft
WILFIE & NELL LLC Ser #: 1207765	228 W 4TH STREET 7TH AVE & W 10TH NEW YORK, NY 10014	608 ft
SADA ONE LLC Ser #: 1251709	230 W 4TH STREET NEW YORK, NY 10014	615 ft
ARS NOVA THEATER I INC Ser #: 1319611	27 BARROW ST NEW YORK, NY 10014	617 ft
L PLUS L PRODUCTIONS LLC Ser #: 1234388	113 7TH AVENUE S CHRISTOPHER & WEST STREETS NEW YORK, NY 10014	629 ft
GEORGE MARCEL LLC Ser #: 1291243	234 W 4TH ST NEW YORK, NY 10014	630 ft

Active On Premises Liquor Licenses within 750 feet		
Name	Address	Distance
DEVEILED FOODS LLC & SAJ HOSPITALITY LLC Ser #: 1166320	189 W 10TH ST NEW YORK, NY 10014	632 ft
NOORTWYCK LLC, THE Ser #: 1343229	289 BLEECKER ST NEW YORK, NY 10014	646 ft
UPRIGHT HOLDINGS 547 LLC Ser #: 1313660	547 HUDSON ST NEW YORK, NY 10014	681 ft
MANHATTAN MONSTER INC Ser #: 1025603	80 GROVE STREET NEW YORK, NY 10014	688 ft
CREATIVE EDGE PARTIES CATERERS INC Ser #: 1022662	666 GREENWICH ST NEW YORK, NY 10014	700 ft
CALIENTE CAB REST CO INC Ser #: 1025490	61 7TH AVENUE SOUTH NEW YORK, NY 10014	706 ft
183 RIO RESTAURANT, INC Ser #: 1153221	183 W 10TH ST AKA 233 W 4TH ST NEW YORK, NY 10014	709 ft
ZMZ BARROW TAVERN LLC Ser #: 1301387	15 BARROW ST NEW YORK, NY 10014	724 ft
WHILE WE WERE YOUNG LLC Ser #: 1290230	183 W 10TH ST SPACE #2 NEW YORK, NY 10014	725 ft
STJARDIM LLC Ser #: 1334701	183 W 10TH ST STORE #1 / AKA 233 W 4TH ST NEW YORK, NY 10014	725 ft
PETNO RESTAURANT INC Ser #: 1143575	143 CHRISTOPHER ST CHRISTOPHER & GREENWICH NEW YORK, NY 10014	730 ft
15 ACRES INC Ser #: 1025204	57 59 CHRISTOPHER ST NEW YORK, NY 10014	734 ft
ONE IF BY LAND RESTAURANT LLC Ser #: 1283957	17 BARROW ST NEW YORK, NY 10014	740 ft
BOBO RESTAURANT LLC Ser #: 1187186	181 W 10TH STREET WEST 4TH ST & 7TH AVENUE NEW YORK, NY 10014	744 ft
SEVILLE RESTAURANT & BAR INC Ser #: 1028424	62 CHARLES STREET AKA 249 WEST 4TH STREET NEW YORK, NY 10014	750 ft

20

DEPARTMENT OF BUILDINGS

BOROUGH OF MANHATTAN, THE CITY OF NEW YORK

Date

February 23, 1971

No. 70148

CERTIFICATE OF OCCUPANCY

NO CHANGES OF USE OR OCCUPANCY NOT CONSISTENT WITH THIS CERTIFICATE SHALL BE MADE UNLESS FIRST APPROVED BY THE BOROUGH SUPERINTENDENT

This certificate supersedes C. O. No. 69696 Temp.

THIS CERTIFIES that the ~~new~~ altered ~~existing~~ building—premises located at

105 Christopher Street (front Building) Block 619 Lot 38

That the zoning lot and premises above referred to are situated, bounded and described as follows:

BEGINNING at a point on the north south side of Christopher Street distant 125 feet west from the corner formed by the intersection of

Bleecker Street and Christopher Street

running thence north 93' 6" feet; thence west 25 feet;

thence south 93' 6" feet; thence east 25 feet;

running thence feet; thence feet;

to the point or place of beginning, conforms substantially to the approved plans and specifications, and to the requirements of the Building Code, the Zoning Resolution and all other laws and ordinances, and of the rules of the Board of Standards and Appeals, applicable to a building of its class and kind at the time the permit was issued; and

CERTIFIES FURTHER that, any provisions of Section 646F of the New York Charter have been complied with as certified by a report of the Fire Commissioner to the Borough Superintendent.

~~NEW~~ or Alt. No.— 1444-1969

Construction classification—

Class 3 Nonfireproof feet.

Occupancy classification— Old Law Tenement

Height 4

stories, 45

Date of completion— February 23, 1971

Located in

R 6

Zoning District.

at time of issuance of permit. 163-1969; 3552-1970

This certificate is issued subject to the limitations hereinafter specified and to the following resolutions of the Board of Standards and Appeals:

and The City Planning Commission:

(Calendar numbers to be inserted here)

PERMISSIBLE USE AND OCCUPANCY

Off-Street Parking Spaces

Off-Street Loading Berths

STORY	LIVE LOADS Lbs. per Sq. Ft.	PERSONS ACCOMMODATED	USE
Clr. On Ground			Boiler room and tenants' storage.
1st	75	48	Eating and drinking establishment, Use Group 6.
2nd 3rd & 4th	40 each		Three (3) apartments on each story.

THIS CERTIFICATE SHALL ALSO BE CONSIDERED A CERTIFICATE OF COMPLIANCE OR OCCUPANCY UNDER SECTION 301 OF THE MULTIPLE DWELLING LAW.

OFFICE COPY—DEPARTMENT OF BUILDINGS

THIS CERTIFICATE OF OCCUPANCY MUST BE POSTED WITHIN THE BUILDING IN ACCORDANCE WITH THE RULES OF THE DEPARTMENT PROMULGATED MARCH 31ST, 1967.

*Samuel F. Dennis*  
Borough Superintendent

# DEPARTMENT OF BUILDINGS

THE CITY OF NEW YORK

BOROUGH OF

## PERMISSIBLE USE AND OCCUPANCY (continued)

100

STORY	LIVE LOADS Lbs. per Sq. Ft.	PERSONS ACCOMMODATED	USE
NO CHANGES OF USE OR OCCUPANCY NOT COME BE MADE UNLESS FIRST APPROVED BY THE BOROUGH SUPERINTENDENT			
This certificate is valid for the use and occupancy of the building as shown on the drawings and specifications filed with this certificate. It is subject to the provisions of the Building Code of the City of New York, and to the rules and regulations of the Department of Buildings. It is also subject to the provisions of the Fire Code of the City of New York, and to the rules and regulations of the Department of Fire.			
This certificate is issued subject to the limitations hereinafter specified and to the following restrictions:			
1. The building shall be used for the purpose specified in the certificate.			
2. The building shall be used for the purpose specified in the certificate.			
3. The building shall be used for the purpose specified in the certificate.			
4. The building shall be used for the purpose specified in the certificate.			
5. The building shall be used for the purpose specified in the certificate.			
6. The building shall be used for the purpose specified in the certificate.			
7. The building shall be used for the purpose specified in the certificate.			
8. The building shall be used for the purpose specified in the certificate.			
9. The building shall be used for the purpose specified in the certificate.			
10. The building shall be used for the purpose specified in the certificate.			
11. The building shall be used for the purpose specified in the certificate.			
12. The building shall be used for the purpose specified in the certificate.			
13. The building shall be used for the purpose specified in the certificate.			
14. The building shall be used for the purpose specified in the certificate.			
15. The building shall be used for the purpose specified in the certificate.			
16. The building shall be used for the purpose specified in the certificate.			

Borough Superintendent

OFFICE COPY--DEPARTMENT OF BUILDINGS