

Meeting Date: \_\_\_\_\_

**APPLICANT INFORMATION:**

Name of applicant(s): DOUBLE J OPERATIONS, LLC

Trade name (DBA): KUNG FU RASTA

Premises address: 406 BROOME STREET; NEW YORK, NY 10013

Cross Streets and other addresses used for building/premise: AKA 199 LAFAYETTE ST. BETWEEN CLEVELAND PL AND LAFAYETTE ST.

**CONTACT INFORMATION:**

Principal(s) Name(s): JAIME MULHOLLAND

Office or Home Address: \_\_\_\_\_

City, State, Zip: \_\_\_\_\_

Telephone #: \_\_\_\_\_ email: \_\_\_\_\_

Landlord Name / Contact: LAFAYETTE 199, LLC (EDMOND LI)

Landlord's Telephone and Fax: \_\_\_\_\_

**NAMES OF ALL PRINCIPAL(S): NAMES / LOCATIONS OF PAST / CURRENT LICENSES HELD**

JAMIE MULHOLLAND Blue Mosquito LLC 389 Broome St

Briefly describe the proposed operation (i.e. "We are a family restaurant that will focus on..."):

THE PROPOSED PREMISES WILL BE AN ELEGANT RESTAURANT WITH AN EXQUISITE MENU AT AFFORDABLE PRICES. WE WILL CATER TO A MATURE CROWD MOSTLY IN THEIR 40S AND 50S. THIS WILL BE A FOOD-CENTERED ESTABLISHMENT.

**WHAT TYPE(S) OF LICENSE(S) ARE YOU APPLYING FOR ( MARK ALL THAT APPLY):**

- a new liquor license (  Restaurant  Tavern / On premise liquor  Other )
- an UPGRADE of an existing Liquor License
- an ALTERATION of an existing Liquor License
- a TRANSFER of an existing Liquor License
- a HOTEL Liquor License
- a DCA CABARET License
- a CATERING / CABARET Liquor License
- a BEER and WINE License
- a RENEWAL of an existing Liquor License
- an OFF-PREMISE License (retail)
- OTHER : \_\_\_\_\_

If upgrade, alteration, or transfer, please describe specific nature of changes:  
(Please include physical or operational changes including hours, services, occupancy, ownership, etc.)

If this is for a new application, please list previous use of location for the last 5 years:

GRAN TIVOLI ITALIAN RESTAURANT

Is any license under the ABC Law currently active at this location?  yes  no

If yes, what is the name of current / previous licensee, license # and expiration date: \_\_\_\_\_

Have any other licenses under the ABC Law been in effect in the last 10 years at this location?  
 yes  no

If yes, please list DBA names and dates of operation:

GRAN TIVOLI (SERIAL # 1311379) Feb. 12, 2019 - Oct. 31, 2020

**PREMISES:**

By what right does the applicant have possession of the premises?

Own  Lease  Sub-lease  Binding Contract to acquire real property  other: \_\_\_\_\_

Type of Building:  Residential  Commercial  Mixed (Res/Com)  Other: \_\_\_\_\_

Number of floor: 7 Year Built: 1900

Describe neighboring buildings: mixed use

Zoning Designation: C 6-2

Zoning Overlay or Special Designation (applicable) \_\_\_\_\_

Block and Lot Number: 482, 7501

Does the premise occupy more than one building, zoning lot, tax lot or more than one floor?  yes  no

Is the premise located in a historic district?  yes  no

(if yes, have all exterior changes or changes governed by the Landmarks Preservation Commission (LPC) been approved by the LPC?  yes  no, please explain: no changes

Will any outside area or sidewalk café be used for the sale or consumption of alcoholic beverages? (including sidewalk, roof and yard space)  no  yes : explain \_\_\_\_\_

What is the proposed Occupancy? 271

Does the premise currently have a valid Certificate of Occupancy (C of O) and all appropriate permits?  no  yes

If yes, what is the maximum occupancy for the premises? 278

If yes, what is the use group for the premises? 6 see attached Cofo being renewed

If yes, is proposed occupancy permitted?  yes  no, explain: \_\_\_\_\_

If your occupancy is 75 or greater, do you plan to apply for Public Assembly permit?  yes  no

Do you plan to file for changes to the Certificate of Occupancy?  yes  no (if yes, please provide copy of application to the NYC DOB)

Will the façade or signage be changed from what currently exist at the premise?  no  yes

(if yes, please describe: \_\_\_\_\_

**INTERIOR OF PREMISES:**

What is the total licensed square footage of the premises? 7,500 sq. ft.

If more than one floor, please specify square footage by floors: 3,500 (1st. floor) + 4,000 (CELLAR)

If there is a sidewalk café, rear yard, rooftop, or outside space, what is the square footage of the area?  
No

If more than one floor, what is the access between floors? yes staircase

How many entrances are there? 2 How many exits? 3 How many bathrooms? 3

Is there access to other parts of the building?  no \_\_\_ yes, explain: \_\_\_\_\_

**OVERALL SEATING INFORMATION:**

Total number of tables? 36 Total table seats? 156

Total number of bars? 2 Total bar seats? 26 = 13 (1st. floor bar) + 13 (CELLAR bar)

Total number of "other" seats? 0 please explain: \_\_\_\_\_

Total OVERALL number of seats in Premises : 182

**BARS:**

How many \*stand-up bars / bar seats are being applied for on the premises? Bars 2 Seats 27

How many service bars are being applied for on the premises? 0

Any food counters?  no \_\_\_ yes, describe : \_\_\_\_\_

**For Alterations and Upgrades:**

Please describe all current and existing bars / bar seats and specific changes: \_\_\_\_\_  
\_\_\_\_\_

\* A stand-up bar is any bar or counter (whether seating or not) over which a member of the public can order, pay for and receive food and alcoholic beverages.

**PROPOSED METHOD OF OPERATION:**

What type of establishment will this be? (check all that apply)

\_\_\_ Bar \_\_\_ Bar & Food  Restaurant \_\_\_ Club/ Cabaret \_\_\_ Hotel \_\_\_ Other: \_\_\_\_\_

What are the Hours of Operation?

Sunday: 10AM to 2AM Monday: 10AM to 2AM Tuesday: 10AM to 2AM Wednesday: 10AM to 2AM Thursday: 10AM to 2AM Friday: 10AM to 2AM Saturday: 10AM to 2AM

Will the business employ a manager?  no  yes, name / experience if known : \_\_\_\_\_

Will there be security personnel?  no  yes (if yes, what rights and how many?) SUN/MON/TUE/WED - 1 GUARD TH/FR/SAT - 4 GUARDS

Do you have or plan to install French doors, accordion doors or windows that open?  no  yes

If yes, please describe : \_\_\_\_\_

Will you have TV's ?  no  yes ( how many? ) \_\_\_\_\_

Type of MUSIC / ENTERTAINMENT:  Live Music  Live DJ  Juke Box  Ipod / CDs  none

Expected Volume level:  Background (quiet)  Entertainment level  Amplified Music  
(check all that apply)

Do you have or plan to install soundproofing?  no  yes

IF YES, will you be using a professional sound engineer? \_\_\_\_\_

Please describe your sound system and sound proofing: AMBIENT MUSIC LEVELS AT ALL TIMES

Will you be permitting:  promoted events  scheduled performances  outside promoters

any events at which a cover fee is charged?  private parties (ONCE A MONTH ON AVERAGE)

Do you have plans to manage or address vehicular traffic and crowd control on the sidewalk caused by your establishment?  no  yes ( if yes, please attach plans)

Will you be utilizing  ropes  movable barriers  other outside equipment (describe) \_\_\_\_\_

Are your premises within 200 feet of any school, church or place of worship?  no  yes

**If there is a school, church or place of worship within 200 feet of your premises or on the same block, please submit a block plot diagram or area map showing its' location in proximity to your applicant premises ( no larger than 8 1/2 " x 11").**

Indicate the distance in feet from the proposed premise:

Name of School / Church: \_\_\_\_\_

Address: \_\_\_\_\_ Distance: \_\_\_\_\_

Name of School / Church: \_\_\_\_\_

Address: \_\_\_\_\_ Distance: \_\_\_\_\_

Name of School / Church: \_\_\_\_\_

Address: \_\_\_\_\_ Distance: \_\_\_\_\_

Please provide contact information for Residents / Community Board and confirm that if complaints are made you will address it immediately.

Contact Person: JAMIE Mulholland Phone: [REDACTED]

Address: \_\_\_\_\_

Email : [REDACTED]

Application submitted on behalf of the applicant by:

Adam C. Powell

Signature

Print or Type Name ADAM CLAYTON POWELL

Title REPRESENTATIVE

Thank you for your cooperation. Please return this questionnaire along with the other required documents as soon as you can. This will expedite your application and avoid any unnecessary delays. Use additional pages if necessary.

[Signature]

[Signature]

Community Board 2,  
Manhattan SLA Licensing Committee  
Donna Raftery, Co-Chair  
Robert Ely, Co-Chair







# STREET LEVEL / RESTAURANT

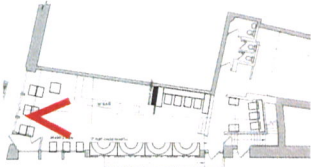

# STREET LEVEL / RESTAURANT

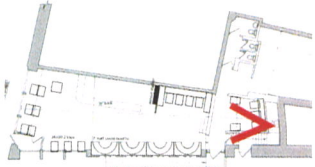

# STREET LEVEL / RESTAURANT

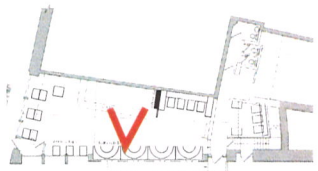

## **Rastafari**

### **Plates**

Medjool Date and Celery Salad

roasted walnuts, micro lettuces, jerez vinegar, extra virgin olive oil

Organic Baby Lettuces

daikon, jicama, pea tendrils, sunflower seeds, ginger honey vinaigrette

Assorted Seaweed

wakame, hijiki, nori, arame, oginori, mozuku, sweet miso vinaigrette

Aleva Dairy Burrata

lampascioni onions, sunchokes, piquillo peppers

Roasted Baby Beets and Goat Cheese Cream

flageolet beans, pinenut breadcrumbs, pickled onion, aged balsamic

Warm Mushroom Salad

beechnut, king oyster, french horn, calabaza, hazelnuts, watermelon radish, goat's milk tomatillo cheese

Pulpo a la Plancha

seared spanish octopus, acerola cherry, peppers, hearts of palm, cerignola olive, citrus

Head-on Maine Shrimp

romanesco cauliflower, baby heirloom tomatoes, red chili, lemon, mint

Crispy Dorade

fennel, orange and basil salad, orange mint vinaigrette, smoked paprika oil

Dayboat Chatham Cod

braised escarole, curry, coconut milk, cashews, kaffir lime, dende oil

Herdendale Farms Flat Iron Steak

duck fat roasted fingerling potato & cipollini hash, jerusalem artichoke, green olive chimichurri

Meadow Run Farms Coriander Loin of Lamb

calabaza puree, apricot, almond, raisin, mint

### **Ceviche Bar**

Big Eye Tuna Belly, Blood Orange Juice, Mango, Coconut Milk, Ginger, Thai Chilies

Fluke, Pink Peppercorns, Pickled Icicle Radish, Smoked Sea Salt

Yellowtail Kampachi, Watermelon, Chayote, Yuzu

Laughing Bird Shrimp, Passion Fruit, Cucumber, Perilla

Widow's Hole Oyster, Green Apple, Jalapeno, Lemongrass

Conch, Pineapple, Hearts of Palm, Aji Amarillo, Cilantro

Our Fish and Seafood will be Supplied from Sustainable and Pole-and-Line Caught Sources. We Work with Basis NYS Farm to Chef Program and When Possible, Ingredients are Natural and Organic and Supplied by the Local NY State Farms Listed Below, Based on Seasonality:

**Dairy**

Four Brothers Dairy Goat Farm  
Battenkill Valley Creamery  
Meadow Creek Farm  
Evans Farmhouse Creamery

**Fruits and Vegetables**

Glebocki Farms  
Satur Farms  
Blue Moon Acres  
Norwich Meadows  
Little Cypress Organics  
Blooming Hill Farm

**Grain**

Timeless Organics

**Meat and Poultry**

Bobo Poultry  
Padgett Farm  
Meadow Run Farm  
Herondale Farm

