

Museum of Women

DOUP Partners LLC dba Museum of Women
480 Broadway / New York, New York 10014

Questionnaire for a Summer Seasonal Beer and Wine License Application

1. Diagrams
2. Photograph of Exterior
3. Menu
4. SLA Proximity Report for Reference
5. Temporary Certificate of Occupancy together with Department of Buildings Property Profile Page

BERNSTEIN REDO & SAVITSKY PC

1177 Avenue of the Americas, 5th floor

New York, NY 10036

Tel. 212.651.3100

www.brpclaw.com

WHAT TYPE(S) OF LICENSE(S) ARE YOU APPLYING FOR (MARK ALL THAT APPLY):

a new liquor license (Restaurant Tavern / On premise liquor Other)

an UPGRADE of an existing Liquor License

an ALTERATION of an existing Liquor License

a TRANSFER of an existing Liquor License

a HOTEL Liquor License

a DCA CABARET License

a CATERING / CABARET Liquor License

a BEER and WINE License

a RENEWAL of an existing Liquor License

an OFF-PREMISE License (retail)

OTHER : Summer seasonal beer and wine license

If upgrade, alteration, or transfer, please describe specific nature of changes:

(Please include physical or operational changes including hours, services, occupancy, ownership, etc.)

N/A

If this is for a new application, please list previous use of location for the last 5 years:

Clothing Store

Is any license under the ABC Law currently active at this location? yes no

If yes, what is the name of current / previous licensee, license # and expiration date: N/A

Have any other licenses under the ABC Law been in effect in the last 10 years at this location?

yes no

If yes, please list DBA names and dates of operation:

N/A

PREMISES:

By what right does the applicant have possession of the premises?

Own Lease Sub-lease Binding Contract to acquire real property other: License Agreement

Type of Building: Residential Commercial Mixed (Res/Com) Other: _____

Number of floor: 8 Year Built : Around 1900

Describe neighboring buildings:
Mixed

Zoning Designation: M1-5B

Zoning Overlay or Special Designation (applicable) N/A

Block and Lot Number: 473 / 10

Does the premise occupy more than one building, zoning lot, tax lot or more than one floor? yes no

Is the premise located in a historic district? yes no

(if yes, have all exterior changes or changes governed by the Landmarks Preservation Commission (LPC) been approved by the LPC? yes no, please explain : Application to be filed

Will any outside area or sidewalk café be used for the sale or consumption of alcoholic beverages? (including sidewalk, roof and yard space) no yes : explain _____

What is the proposed Occupancy? 168= cellar / 30= sub-cellar / 266= ground floor / 113= second floor. Total= 577

Does the premise currently have a valid Certificate of Occupancy (C of O) and all appropriate permits?

no yes The TCO will be amended and renewed and the applicant will apply for all appropriate permits.

If yes, what is the maximum occupancy for the premises? 577

If yes, what is the use group for the premises? Use Group 6

If yes, is proposed occupancy permitted? yes no, explain : _____

If your occupancy is 75 or greater, do you plan to apply for Public Assembly permit? yes no

Do you plan to file for changes to the Certificate of Occupancy? yes no
(if yes, please provide copy of application to the NYC DOB) TCO to be amended to add additional restrooms

Will the façade or signage be changed from what currently exist at the premise? no yes

(if yes, please describe: Signage to read "Museum of Women"

INTERIOR OF PREMISES:

What is the total licensed square footage of the premises? 30,911 square feet

If more than one floor, please specify square footage by floors: Ground floor= 7,509 sq ft; Second floor= 7,509 sq ft; Cellar= 10,103 sq ft and Sub-cellar= 5,790 sq ft

If there is a sidewalk café, rear yard, rooftop, or outside space, what is the square footage of the area?

No

If more than one floor, what is the access between floors? Interior staircases, elevators and escalators

How many entrances are there? 1 How many exits? 1 How many bathrooms? 5

Is there access to other parts of the building? X no ___ yes, explain: _____

OVERALL SEATING INFORMATION: Additional seating numbers to be provided

Total number of tables? 8 Total table seats? 80 - includes a maximum of 50 seats for a 2nd floor event

Total number of bars? 2 Total bar seats? 8

Total number of "other" seats? 6 please explain : Couch seating

Total OVERALL number of seats in Premises : 94

BARS:

How many *stand-up bars / bar seats are being applied for on the premises? Bars 2 Seats 8

How many service bars are being applied for on the premises? None

Any food counters? X no ___ yes, describe : _____

For Alterations and Upgrades:

Please describe all current and existing bars / bar seats and specific changes: N/A

* A stand-up bar is any bar or counter (whether seating or not) over which a member of the public can order, pay for and receive food and alcoholic beverages.

PROPOSED METHOD OF OPERATION:

What type of establishment will this be? (check all that apply)

___ Bar X Bar & Food ___ Restaurant ___ Club/ Cabaret ___ Hotel X Other: Museum

What are the Hours of Operation? **Since the last ticket sale is 9:00PM we do not anticipate guests staying later than 10:30PM. The 12:00AM closing hour is for special events.**

Sunday: Monday: Tuesday: Wednesday: Thursday: Friday: Saturday:

9AM to 12AM 9AM to 12AM 9AM to 12AM 9AM to 12AM 9AM to 12AM 9AM to 12AM 9AM to 12AM

Will the business employ a manager? ___ no X yes, name / experience if known : TDB

One - 4PM to 12AM

Will there be security personnel? ___ no X yes(if yes, what nights and how many?) Friday and Saturday

Do you have or plan to install French doors, accordion doors or windows that open? X no ___ yes

If yes, please describe : N/A

Will you have TV's ? X no ___ yes (how many?) _____

Type of MUSIC / ENTERTAINMENT: X Live Music* ___ Live DJ ___ Juke Box ___ Ipod / CDs ___ none

Expected Volume level: X Background (quiet) X Entertainment level ___ Amplified Music
(check all that apply) *Live music only for a special event. Not all special events will have live music.

Do you have or plan to install soundproofing? ___ no X yes

IF YES, will you be using a professional sound engineer? X

Please describe your sound system and sound proofing: **There will be 4 speakers in the bar and then about 20 smaller ones scattered through the space playing sound effects for the rooms with a 90 DB level. Concrete walls covered by plaster and carpeting and concrete in the ceilings. Further- there are no tenants on the 3rd and 4th floor.**

Will you be permitting: ___ promoted events ___ scheduled performances ___ outside promoters

___ any events at which a cover fee is charged? X private parties

Do you have plans to manage or address vehicular traffic and crowd control on the sidewalk caused by your establishment? X no ___ yes (if yes, please attach plans) **We have ticketed sales to avoid crowds.**

Will you be utilizing ___ ropes ___ movable barriers ___ other outside equipment (describe) _____

N/A

Are your premises within 200 feet of any school, church or place of worship? X no ___ yes

If there is a school, church or place of worship within 200 feet of your premises or on the same block, please submit a block plot diagram or area map showing its' location in proximity to your applicant premises (no larger than 8 ½ " x 11").

Indicate the distance in feet from the proposed premise:

Name of School / Church: _____

Address: _____ Distance: _____

Name of School / Church: _____

Address: _____ Distance: _____

Name of School / Church: _____

Address: _____ Distance: _____

Please provide contact information for Residents / Community Board and confirm that if complaints are made you will address it immediately.

Contact Person: Morgan First Phone: [REDACTED]

Address: [REDACTED]

Email : [REDACTED]

Application submitted on
behalf of the applicant by:

Donald M. Bernstein

Signature

Print or Type Name Donald M. Bernstein

Title Counsel for applicant

Thank you for your cooperation. Please return this questionnaire along with the other required documents as soon as you can. This will expedite your application and avoid any unnecessary delays. Use additional pages if necessary.



Community Board 2, Manhattan
SLA Licensing Committee
Carter Booth, Co-Chair
Robert Ely, Co-Chair

Museum of Women

Diagrams

Ground Floor

7,509 SF

DOUP Partners LLC
dba Museum of Women
480 Broadway
New York, New York 10013

8 tables with 30 seats and 8 bar stools
plus 6 couch seats for a total of 44 seats

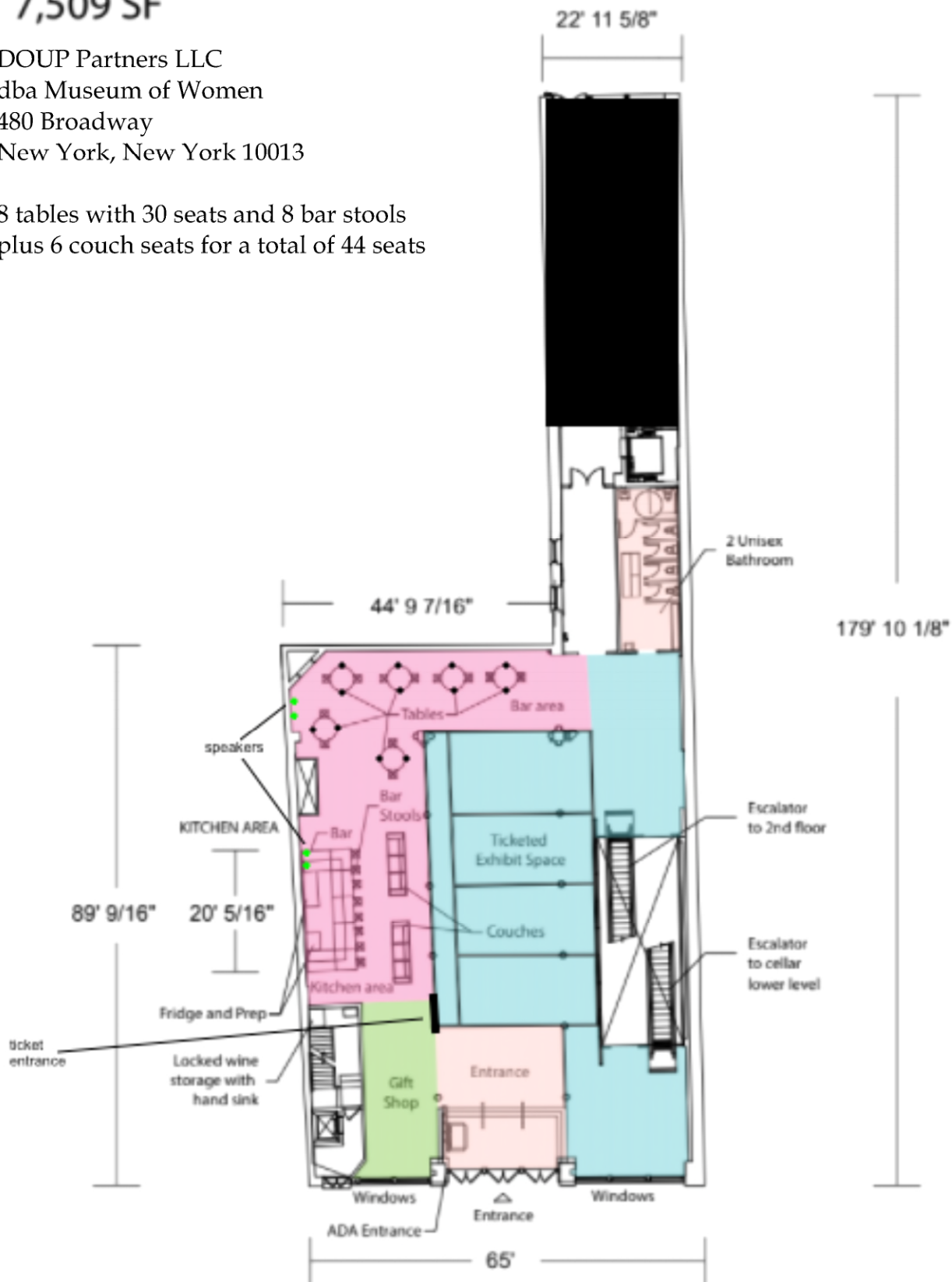

Second Floor

7,509 SF

DOUP Partners LLC
dba Museum of Women
480 Broadway
New York, New York 10013

Maximum 50 seats for an event

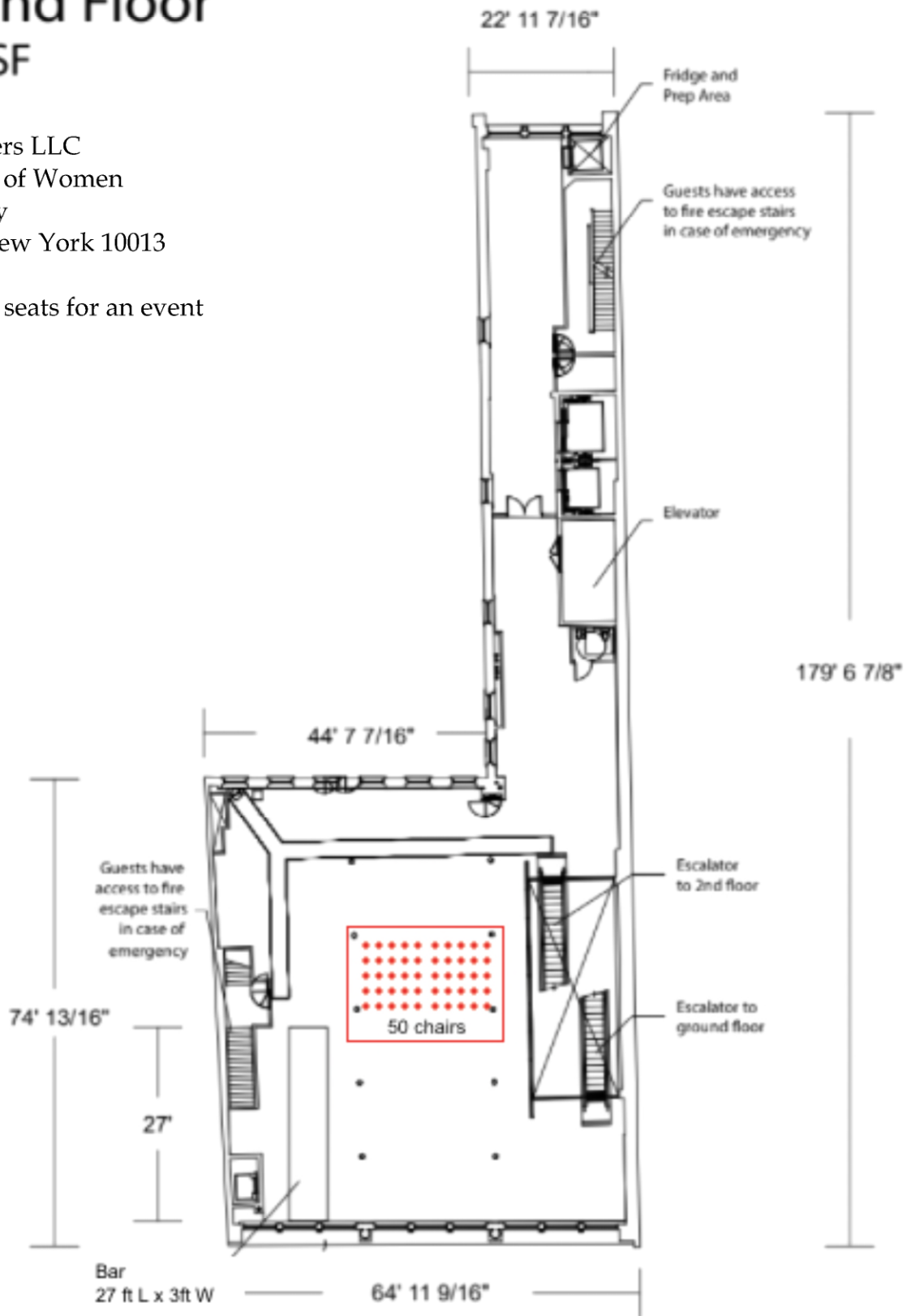

Cellar Floor

Lower Level

10,103 SF

DOUP Partners LLC
dba Museum of Women
480 Broadway
New York, New York 10013

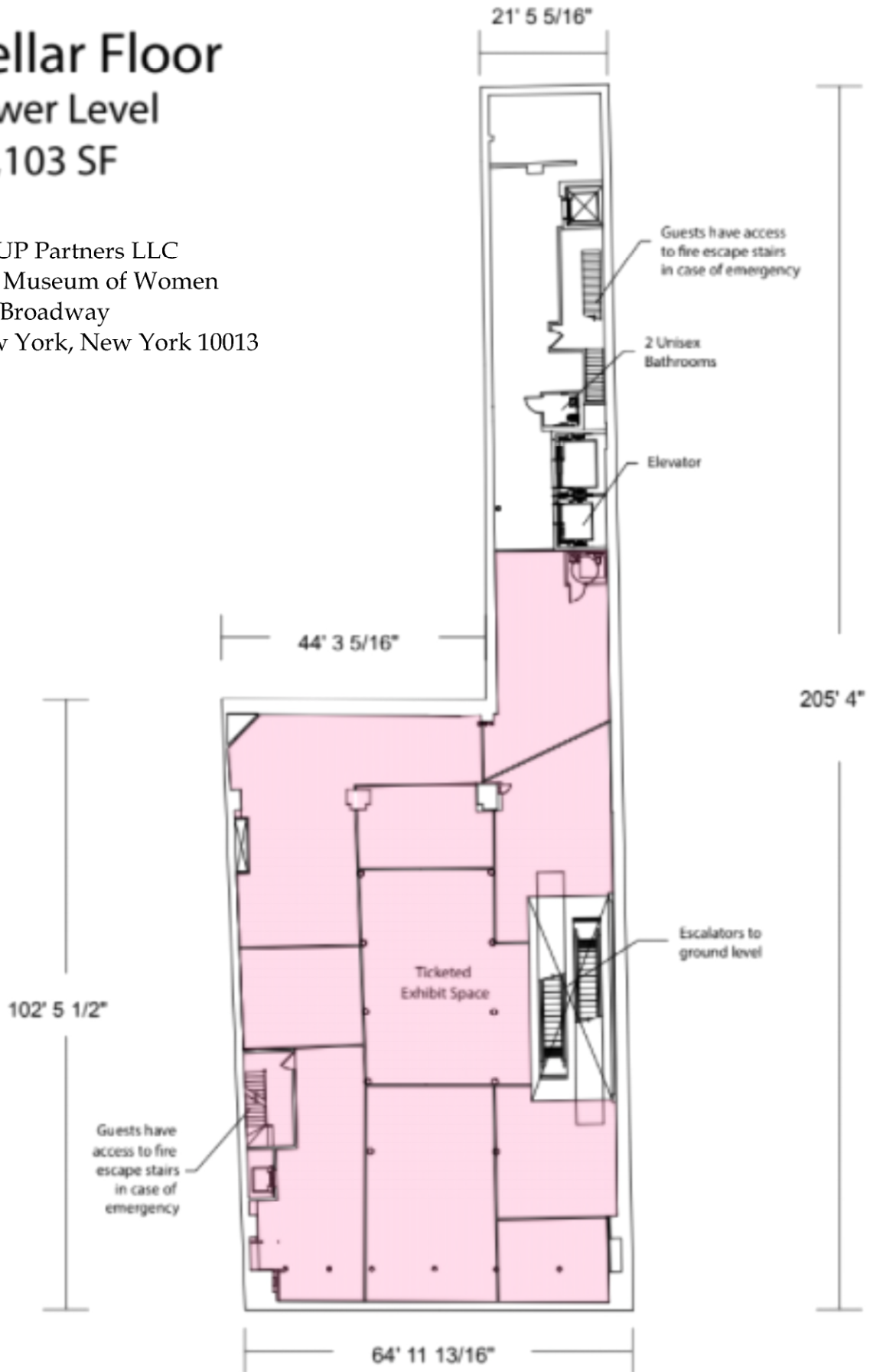

Sub cellar Floor

Basement

5,790 SF

Staff only floor

DOUP Partners LLC
dba Museum of Women
480 Broadway
New York, New York 10013

