

Jeannine Kiely, *Chair*
Susan Kent, *First Vice Chair*
Valerie De La Rosa, *Second Vice Chair*
Bob Gormley, *District Manager*



Antony Wong, *Treasurer*
Eugene Yoo, *Secretary*
Ritu Chattree, *Assistant Secretary*

COMMUNITY BOARD NO. 2, MANHATTAN

3 WASHINGTON SQUARE VILLAGE

NEW YORK, NY 10012-1899

www.cb2manhattan.org

P: 212-979-2272 F: 212-254-5102 E: info@cb2manhattan.org

Greenwich Village ♦ Little Italy ♦ SoHo ♦ NoHo ♦ Hudson Square ♦ Chinatown ♦ Gansevoort Market

COMMUNITY BOARD 2 APPLICATION FOR A LIQUOR LICENSE

Please fill out this questionnaire and return to the Community Board 2 office by fax or mail to arrive at least **5 business days** before the Committee meeting. In addition, bring **10 copies** plus supporting material requested to the SLA committee meeting.

Failure to complete and return the questionnaire and supporting materials on time will result in your item being removed from the agenda.

Failure to provide a completed questionnaire or failure to present before CB2 will result in notifying the State Liquor Authority (SLA) of your noncompliance with the community review process.

If you need to reschedule, please notify the Community Board 2 office no later than the Friday prior to the following months meeting. Speak to Florence Arenas at the Board Office. **A maximum of 1 layover request** will be granted per application. **Failure to reappear without notification will result in a recommendation to deny this application.**

The following supporting materials are **required** for this application:

1. A list of all other licensed premises within 500 ft. of this location including Beer and Wine.
2. Floor plans of the premise, including all tables and chairs and kitchen lay out to be licensed. Please also include any schematics for sidewalk café, backyard garden space and/or rooftop areas if applicable.
3. Provide any plans filed or to be filed with the Buildings Department.
4. Proposed menu, if applicable.
5. Certificate of Occupancy or Letter of No Objection for the premises.
6. Letter of Understanding or Letter of Intent from the Landlord.
7. Provide proof of community outreach with signatures or letters from Residential Tenants at location and from surrounding buildings. (i.e. a letter from the neighborhood block association or petition in support.)
8. A copy of your NYS Liquor Authority application as it will be submitted to the SLA. (excluding financial information)

Meeting Date: _____

APPLICANT INFORMATION:

Name of applicant(s): **67G, LLC**

Trade name (DBA): **Krewe**

Premises address: **67 Gansevoort Street, New York, NY 10014**

Cross Streets and other addresses used for building/premise:
9th Avenue, Washington Street

CONTACT INFORMATION:

Principal(s) Name(s): **Cathy Quain**

Office or Home Address: [REDACTED]

City, State, Zip: [REDACTED]

Telephone #: [REDACTED] email : [REDACTED]

Landlord Name / Contact: [REDACTED]

Landlord's Telephone and Fax: [REDACTED]

NAMES OF ALL PRINCIPAL(s): NAMES / LOCATIONS OF PAST / CURRENT LICENSES HELD

67G, LLC is owend by Krewe du Optic, LLC the owners of which are:

- 1. John Stirling Barrett
- 2. John Stirling Barrett II
- 3. Christopher Brancato

There are no past or current licenses to report.

Briefly describe the proposed operation (i.e. "We are a family restaurant that will focus on..."):

Krewe is a national eyewear retailer seeking a beer and wine license for the flagship store that will open this year.

WHAT TYPE(S) OF LICENSE(S) ARE YOU APPLYING FOR (MARK ALL THAT APPLY):

- a new liquor license (Restaurant Tavern / On premise liquor Other)
- an UPGRADE of an existing Liquor License
- an ALTERATION of an existing Liquor License
- a TRANSFER of an existing Liquor License
- a HOTEL Liquor License
- a DCA CABARET License
- a CATERING / CABARET Liquor License
- a BEER and WINE License
- a RENEWAL of an existing Liquor License
- an OFF-PREMISE License (retail)
- OTHER : _____

If upgrade, alteration, or transfer, please describe specific nature of changes:
(Please include physical or operational changes including hours, services, occupancy, ownership, etc.)

N/A

If this is for a new application, please list previous use of location for the last 5 years:

Fashion Retailer

Is any license under the ABC Law currently active at this location? yes no

If yes, what is the name of current / previous licensee, license # and expiration date: N/A

Have any other licenses under the ABC Law been in effect in the last 10 years at this location?
 yes no

If yes, please list DBA names and dates of operation:

N/A

PREMISES:

By what right does the applicant have possession of the premises?

Own Lease Sub-lease Binding Contract to acquire real property other: _____

Type of Building: Residential Commercial Mixed (Res/Com) Other: _____

Number of floor: 3 Year Built : 1887

Describe neighboring buildings: Commercial & Office Buildings

Zoning Designation: M1-5

Zoning Overlay or Special Designation (applicable) n/a

Block and Lot Number: 644 / 63

Does the premise occupy more than one building, zoning lot, tax lot or more than one floor? yes no

Is the premise located in a historic district? yes no

(if yes, have all exterior changes or changes governed by the Landmarks Preservation Commission (LPC) been approved by the LPC? yes no, please explain : Pending approval

Will any outside area or sidewalk café be used for the sale or consumption of alcoholic beverages? (including sidewalk, roof and yard space) no yes : explain Open Restaurants

What is the proposed Occupancy? 74

Does the premise currently have a valid Certificate of Occupancy (C of O) and all appropriate permits?

no yes (LNO)

If yes, what is the maximum occupancy for the premises? 74

If yes, what is the use group for the premises? 6

If yes, is proposed occupancy permitted? yes no, explain : _____

If your occupancy is 75 or greater, do you plan to apply for Public Assembly permit? yes no N/A

Do you plan to file for changes to the Certificate of Occupancy? yes no
(if yes, please provide copy of application to the NYC DOB)

Will the façade or signage be changed from what currently exist at the premise? no yes

(if yes, please describe: The existing blade signage in the will be replaced with one that says KREWE

INTERIOR OF PREMISES:

What is the total licensed square footage of the premises? 3500 Sq Ft

If more than one floor, please specify square footage by floors: Basement: 2000 Sq Ft , Main Floor: 1500 Sq Ft

If there is a sidewalk café, rear yard, rooftop, or outside space, what is the square footage of the area?

If more than one floor, what is the access between floors? Stairs

How many entrances are there? 1 How many exits? 1 How many bathrooms ? 1

Is there access to other parts of the building? no _____ yes, explain: _____

OVERALL SEATING INFORMATION:

Total number of tables? 8 Total table seats? 8 Indoors 16 Outdoors

Total number of bars? 1 Total bar seats? 2

Total number of "other" seats? N/A please explain : _____

Total OVERALL number of seats in Premises : 24

BARS:

How many *stand-up bars / bar seats are being applied for on the premises? Bars 1 Seats 2

How many service bars are being applied for on the premises? 0

Any food counters? no _____ yes, describe : _____

For Alterations and Upgrades:

Please describe all current and existing bars / bar seats and specific changes: N/A

* A stand-up bar is any bar or counter (whether seating or not) over which a member of the public can order, pay for and receive food and alcoholic beverages.

PROPOSED METHOD OF OPERATION:

What type of establishment will this be? (check all that apply)

Bar Bar & Food Restaurant Club/ Cabaret Hotel Other: Retail Eyewear Store

What are the Hours of Operation?

Sunday: Monday: Tuesday: Wednesday: Thursday: Friday: Saturday:

10am to 8pm 10am to 8pm 10am to 8pm 10am to 8pm 10am to 8pm 10am to 8pm 10am to 8pm

Will the business employ a manager? ___ no yes, name / experience if known : Pending

Will there be security personnel? no ___ yes(if yes, what nights and how many?) N/A

Do you have or plan to install French doors, accordion doors or windows that open? no ___ yes

If yes, please describe : _____

Will you have TV's ? no ___ yes (how many?) _____

Type of MUSIC / ENTERTAINMENT: ___ Live Music ___ Live DJ ___ Juke Box Ipod / CDs ___ none

Expected Volume level: Background (quiet) ___ Entertainment level ___ Amplified Music
(check all that apply)

Do you have or plan to install soundproofing? no ___ yes

IF YES, will you be using a professional sound engineer? N/A

Please describe your sound system and sound proofing: N/A

Will you be permitting: ___ promoted events ___ scheduled performances ___ outside promoters

___ any events at which a cover fee is charged? ___ private parties N/A

Do you have plans to manage or address vehicular traffic and crowd control on the sidewalk caused by your establishment? no ___ yes (if yes, please attach plans)

Will you be utilizing ___ ropes ___ movable barriers ___ other outside equipment (describe) _____

N/A - Will have outside planters.

Are your premises within 200 feet of any school, church or place of worship? no ___ yes

If there is a school, church or place of worship within 200 feet of your premises or on the same block, please submit a block plot diagram or area map showing its' location in proximity to your applicant premises (no larger than 8 ½ " x 11").

Indicate the distance in feet from the proposed premise:

Name of School / Church: _____

Address: _____ Distance: _____

Name of School / Church: _____

Address: _____ Distance: _____

Name of School / Church: _____

Address: _____ Distance: _____

Please provide contact information for Residents / Community Board and confirm that if complaints are made you will address it immediately.

Contact Person: **Michael J Paleudis, Esq.** Phone: _____

Address: _____

Email : **mjp@kplawyers.com**

Application submitted on
behalf of the applicant by:



Signature

Print or Type Name **Chris Brancato**

Title **Principal**

Thank you for your cooperation. Please return this questionnaire along with the other required documents as soon as you can. This will expedite your application and avoid any unnecessary delays. Use additional pages if necessary.



Community Board 2, Manhattan
SLA Licensing Committee
Donna Raftery, Co-Chair
Robert Ely, Co-Chair

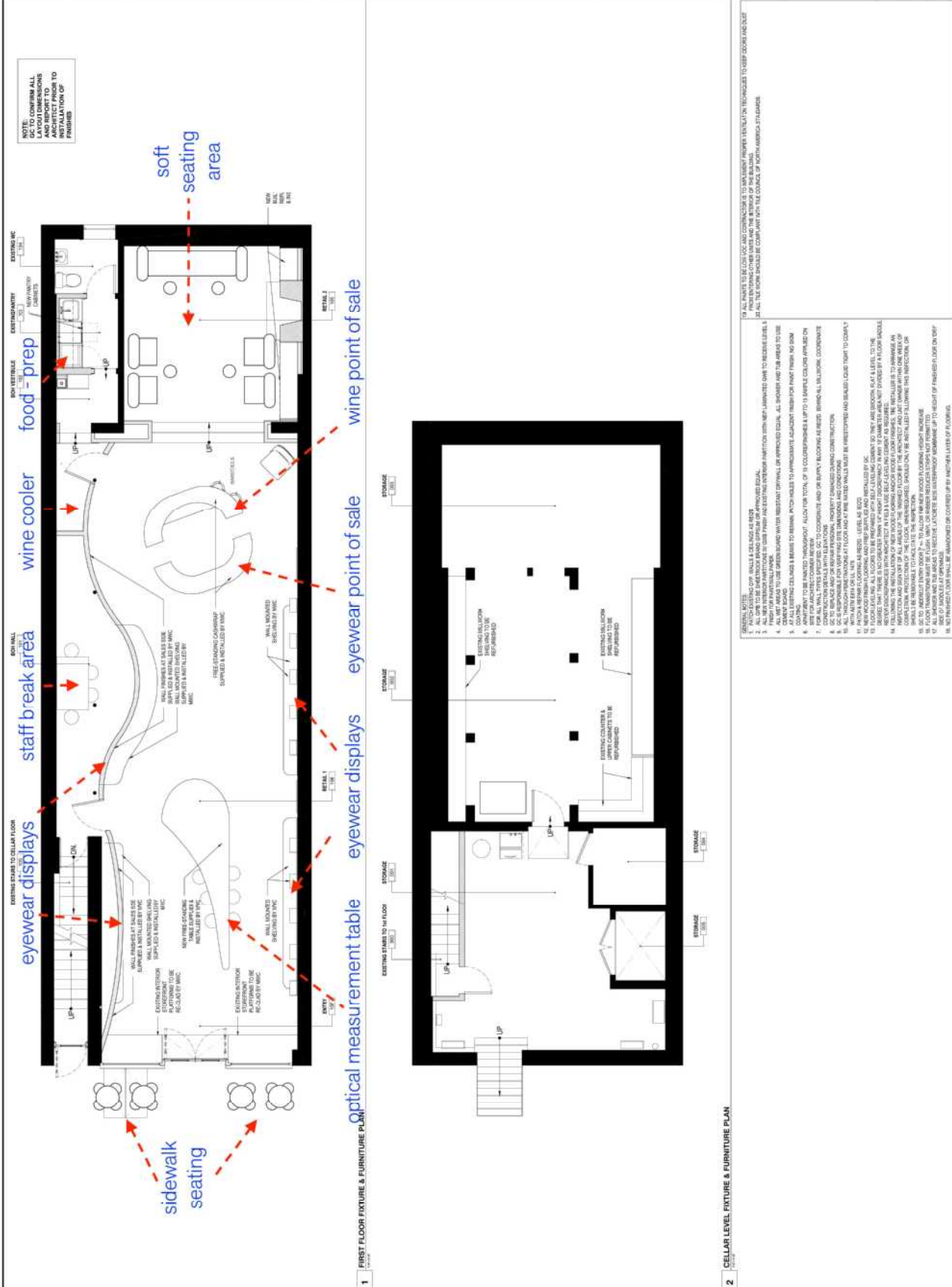

NOTE: VERIFY ALL DIMENSIONS AND CONFIRM ALL LAYOUT DIMENSIONS WITH THE ARCHITECT PRIOR TO INSTALLATION OF FIXTURES.

1 FIRST FLOOR FIXTURE & FURNITURE PLAN

2 CELLAR LEVEL FIXTURE & FURNITURE PLAN

3 FIXTURE & FURNITURE LEGEND

- GENERAL NOTES:**
1. WALL FINISHES AT BASE LINE SUPPLIED & INSTALLED BY MFC.
 2. ALL NEW ELECTRICAL WORK SHALL BE INSTALLED IN ACCORDANCE WITH THE NATIONAL ELECTRICAL CODE (NEC) AND ALL APPLICABLE LOCAL CODES.
 3. ALL NEW ELECTRICAL WORK SHALL BE INSTALLED IN ACCORDANCE WITH THE NATIONAL ELECTRICAL CODE (NEC) AND ALL APPLICABLE LOCAL CODES.
 4. ALL NEW ELECTRICAL WORK SHALL BE INSTALLED IN ACCORDANCE WITH THE NATIONAL ELECTRICAL CODE (NEC) AND ALL APPLICABLE LOCAL CODES.
 5. ALL NEW ELECTRICAL WORK SHALL BE INSTALLED IN ACCORDANCE WITH THE NATIONAL ELECTRICAL CODE (NEC) AND ALL APPLICABLE LOCAL CODES.
 6. ALL NEW ELECTRICAL WORK SHALL BE INSTALLED IN ACCORDANCE WITH THE NATIONAL ELECTRICAL CODE (NEC) AND ALL APPLICABLE LOCAL CODES.
 7. ALL NEW ELECTRICAL WORK SHALL BE INSTALLED IN ACCORDANCE WITH THE NATIONAL ELECTRICAL CODE (NEC) AND ALL APPLICABLE LOCAL CODES.
 8. ALL NEW ELECTRICAL WORK SHALL BE INSTALLED IN ACCORDANCE WITH THE NATIONAL ELECTRICAL CODE (NEC) AND ALL APPLICABLE LOCAL CODES.
 9. ALL NEW ELECTRICAL WORK SHALL BE INSTALLED IN ACCORDANCE WITH THE NATIONAL ELECTRICAL CODE (NEC) AND ALL APPLICABLE LOCAL CODES.
 10. ALL NEW ELECTRICAL WORK SHALL BE INSTALLED IN ACCORDANCE WITH THE NATIONAL ELECTRICAL CODE (NEC) AND ALL APPLICABLE LOCAL CODES.
 11. ALL NEW ELECTRICAL WORK SHALL BE INSTALLED IN ACCORDANCE WITH THE NATIONAL ELECTRICAL CODE (NEC) AND ALL APPLICABLE LOCAL CODES.
 12. ALL NEW ELECTRICAL WORK SHALL BE INSTALLED IN ACCORDANCE WITH THE NATIONAL ELECTRICAL CODE (NEC) AND ALL APPLICABLE LOCAL CODES.
 13. ALL NEW ELECTRICAL WORK SHALL BE INSTALLED IN ACCORDANCE WITH THE NATIONAL ELECTRICAL CODE (NEC) AND ALL APPLICABLE LOCAL CODES.
 14. ALL NEW ELECTRICAL WORK SHALL BE INSTALLED IN ACCORDANCE WITH THE NATIONAL ELECTRICAL CODE (NEC) AND ALL APPLICABLE LOCAL CODES.
 15. ALL NEW ELECTRICAL WORK SHALL BE INSTALLED IN ACCORDANCE WITH THE NATIONAL ELECTRICAL CODE (NEC) AND ALL APPLICABLE LOCAL CODES.
 16. ALL NEW ELECTRICAL WORK SHALL BE INSTALLED IN ACCORDANCE WITH THE NATIONAL ELECTRICAL CODE (NEC) AND ALL APPLICABLE LOCAL CODES.
 17. ALL NEW ELECTRICAL WORK SHALL BE INSTALLED IN ACCORDANCE WITH THE NATIONAL ELECTRICAL CODE (NEC) AND ALL APPLICABLE LOCAL CODES.
 18. ALL NEW ELECTRICAL WORK SHALL BE INSTALLED IN ACCORDANCE WITH THE NATIONAL ELECTRICAL CODE (NEC) AND ALL APPLICABLE LOCAL CODES.
 19. ALL NEW ELECTRICAL WORK SHALL BE INSTALLED IN ACCORDANCE WITH THE NATIONAL ELECTRICAL CODE (NEC) AND ALL APPLICABLE LOCAL CODES.
 20. ALL NEW ELECTRICAL WORK SHALL BE INSTALLED IN ACCORDANCE WITH THE NATIONAL ELECTRICAL CODE (NEC) AND ALL APPLICABLE LOCAL CODES.

4 FIXTURE & FURNITURE NOTES