

Jeanine Kiely, Chair  
Susan Kent, First Vice Chair  
Valerie De La Rosa, Second Vice Chair  
Bob Gormley, District Manager



Antony Wong, Treasurer  
Eugene Yoo, Secretary  
Ritu Chatterjee, Assistant Secretary

## Community Board No. 2, Manhattan

3 Washington Square Village  
NEW YORK, NY 10012-1899

www.cb2manhattan.org

P: 212-979-2272 F: 212-254-5102 E: info@cb2manhattan .org

Greenwich Village ♦ Little Italy ♦ SoHo ♦ NoHo ♦ Hudson Square ♦ Chinatown ♦ Gansevoort Market

### COMMUNITY BOARD 2 APPLICATION FOR A STATE LIQUOR AUTHORITY LICENSE ADDENDUM FOR OUTDOOR SEATING

For a Liquor License Application that includes any outdoor areas, please complete the following:

- Submit a diagram of outdoor seating indicating length and width of area(s) and location of all tables and chairs. Include all obstructions (trees, fire hydrants, proximity to bus stops, bike racks, signs, etc.).
- Submit photos of the premises where the sidewalk café and/or roadbed will be located. Required photos show one frontal, one left and one right side view of proposed sidewalk café and/or roadbed.
  - Photos must show complete sidewalk and/or roadway area where sidewalk café and/or roadbed will be including views to curb and neighboring properties.
  - If seating is in a rear yard show photos of yard and surrounding area, including upper view of adjacent buildings.

#### RH NY Guesthouse F&B LLC

**Sidewalk café** will have no more than (If premises is located on a corner please indicate for both streets):

14 tables and 40 seats on Gansevoort Street  
           tables and            seats on            Street

Hours of sidewalk café: 8am to 10pm .

Describe any obstructions (trees, fire hydrant, proximity to bus stop, etc): N/A

**Roadbed** will have no more than (If premises is located on a corner please indicate for both streets):

           tables and            seats on            Street  
           tables and            seats on            Street

Hours of roadbed:            to            .

Describe any obstructions (trees, fire hydrant, proximity to bus stop, etc):           

**Rear yard** will have no more than            tables and            seats

Hours of rear yard:            to            .

Does seating extend beyond the business frontage?  No  Yes

Will outdoor dining structures **on the sidewalk** be enclosed on three (3) or more sides?  No  Yes

Will outdoor dining structures **on the roadbed** be enclosed on three (3) or more sides?  No  Yes

Is there any outdoor music, speakers or TVs?  No  Yes, please describe:           

Will heating elements be used?  No  Yes, please describe: Electric heating units hung from canopy above

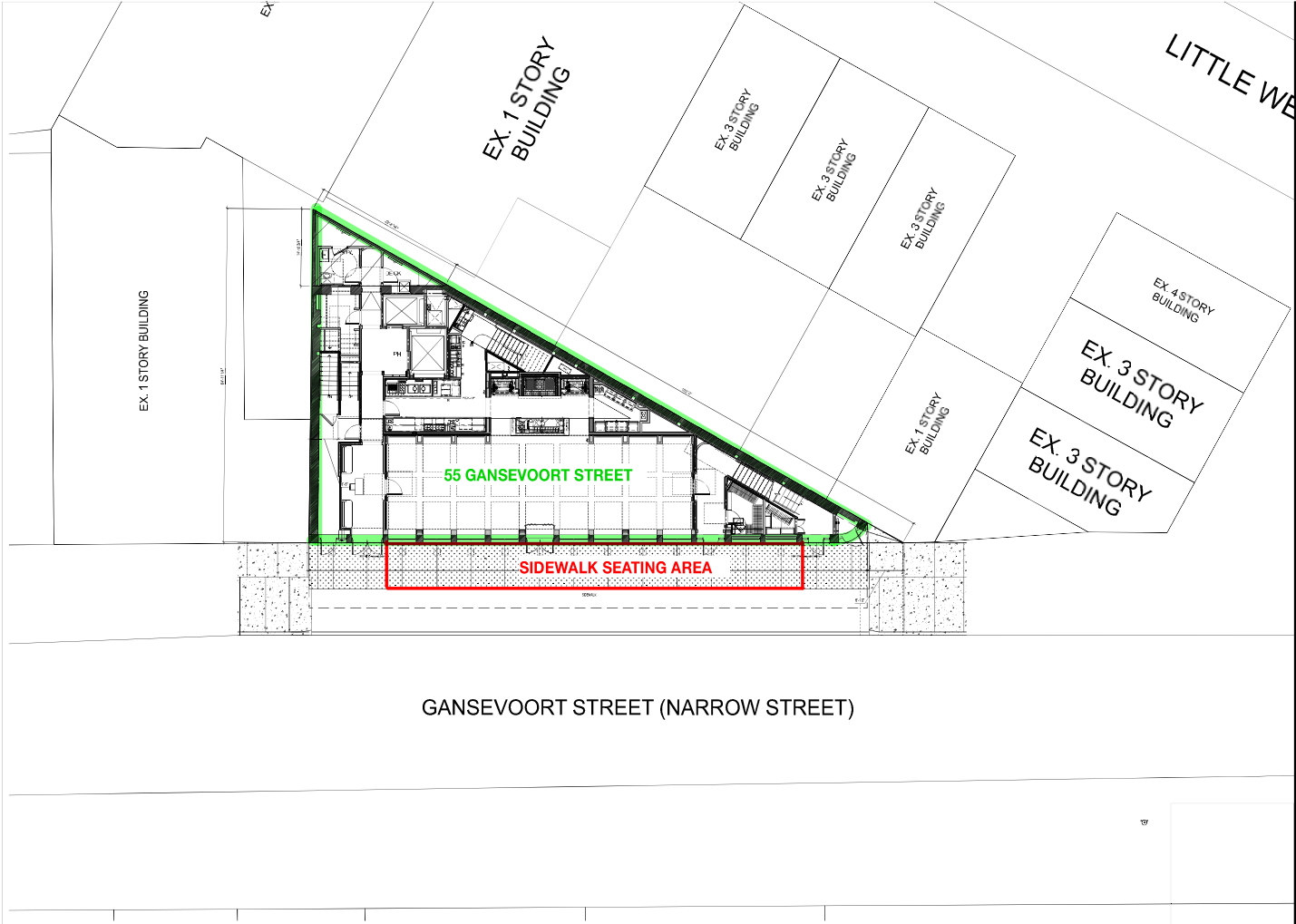

**M**  
**GVS**

Architect of Record:  
 45 Square Feet Architects PLLC  
 100 West 17th Street  
 New York, NY 10011  
 Tel: 212-463-1100  
 Fax: 212-463-1101  
 www.45squarefeet.com

Principal Architect:  
 45 Square Feet Architects PLLC  
 100 West 17th Street  
 New York, NY 10011  
 Tel: 212-463-1100  
 Fax: 212-463-1101  
 www.45squarefeet.com

Architect:  
 45 Square Feet Architects PLLC  
 100 West 17th Street  
 New York, NY 10011  
 Tel: 212-463-1100  
 Fax: 212-463-1101  
 www.45squarefeet.com

Engineer:  
 45 Square Feet Architects PLLC  
 100 West 17th Street  
 New York, NY 10011  
 Tel: 212-463-1100  
 Fax: 212-463-1101  
 www.45squarefeet.com

Interior Designer:  
 45 Square Feet Architects PLLC  
 100 West 17th Street  
 New York, NY 10011  
 Tel: 212-463-1100  
 Fax: 212-463-1101  
 www.45squarefeet.com

Site Plan:  
 45 Square Feet Architects PLLC  
 100 West 17th Street  
 New York, NY 10011  
 Tel: 212-463-1100  
 Fax: 212-463-1101  
 www.45squarefeet.com

Date	Task
10/10/2017	Site Plan
11/09/2017	FAA-01
12/15/2017	FAA-02
03/05/2018	FAA-Planmatic
04/05/2018	FAA-Mechanical
10/05/2018	FAA-Structural
10/15/2018	FAA-03
01/30/2019	Submittal 01/16

Project Name:  
 RH GuestHouse  
 Project Address:  
 55 Gansevoort St.  
 New York, NY 10014

Drawing Title:  
 site plan

Project Number:  
 SP-001

Project File:  
 MP Project.F. 012019

RH NY Guesthouse F&B LLC

