

**450 WEST BROADWAY LLC  
450 WEST BROADWAY  
NEW YORK, NEW YORK 10012**

---

MANHATTAN COMMUNITY BOARD 2  
FEBRUARY 2022  
SLA LICENSING COMMITTEE

**Questionnaire**

1. Proposed Floor Plans
2. Proposed Menu
3. Exterior Photograph
4. SLA Proximity Report, OASIS and Google Maps
5. NYC Department of Buildings Property Profile Page and Current Certificate of Occupancy
6. Outreach

**BERNSTEIN REDO, & SAVITSKY P.C.**  
1177 AVENUE OF THE AMERICAS, 5<sup>TH</sup> FLOOR  
NEW YORK, NY 10031  
212-651-3100

Terri Cude, *Chair*  
Daniel Miller, *First Vice Chair*  
Susan Kent, *Second Vice Chair*  
Bob Gormley, *District Manager*



Antony Wong, *Treasurer*  
Keen Berger, *Secretary*  
Erik Coler, *Assistant Secretary*

## COMMUNITY BOARD No. 2, MANHATTAN

3 WASHINGTON SQUARE VILLAGE

NEW YORK, NY 10012-1899

[www.cb2manhattan.org](http://www.cb2manhattan.org)

P: 212-979-2272 F: 212-254-5102 E: [info@cb2manhattan.org](mailto:info@cb2manhattan.org)

Greenwich Village ✦ Little Italy ✦ SoHo ✦ NoHo ✦ Hudson Square ✦ Chinatown ✦ Gansevoort Market

### **COMMUNITY BOARD 2 APPLICATION FOR A LIQUOR LICENSE**

Please fill out this questionnaire and return to the Community Board 2 office by fax or mail to arrive at least **5 business days** before the Committee meeting. In addition, bring **10 copies** plus supporting material requested to the SLA committee meeting.

**Failure to complete and return the questionnaire and supporting materials on time will result in your item being removed from the agenda.**

**Failure to provide a completed questionnaire or failure to present before CB2 will result in notifying the State Liquor Authority (SLA) of your noncompliance with the community review process.**

If you need to reschedule, please notify the Community Board 2 office no later than the Friday prior to the following month's meeting. Speak to Florence Arenas at the Board Office. **A maximum of 1 layover request** will be granted per application. **Failure to reappear without notification will result in a recommendation to deny this application.**

The following supporting materials are **required** for this application:

1. A list of all other licensed premises within 500 ft. of this location including Beer and Wine.
2. Floor plans of the premise, including all tables and chairs and kitchen lay out to be licensed. Please also include any schematics for sidewalk café, backyard garden space and/or rooftop areas if applicable.
3. Provide any plans filed or to be filed with the Buildings Department.
4. Proposed menu, if applicable.
5. Certificate of Occupancy or Letter of No Objection for the premises.
6. Letter of Understanding or Letter of Intent from the Landlord.
7. Provide proof of community outreach with signatures or letters from Residential Tenants at location and from surrounding buildings. (i.e. a letter from the neighborhood block association or petition in support.)
8. A copy of your NYS Liquor Authority application as it will be submitted to the SLA. (excluding financial information)



**WHAT TYPE(S) OF LICENSE(S) ARE YOU APPLYING FOR ( MARK ALL THAT APPLY):**

a new liquor license (  Restaurant  Tavern / On premise liquor  Other )

an UPGRADE of an existing Liquor License

an ALTERATION of an existing Liquor License

a TRANSFER of an existing Liquor License

a HOTEL Liquor License

a DCA CABARET License

a CATERING / CABARET Liquor License

a BEER and WINE License

a RENEWAL of an existing Liquor License

an OFF-PREMISE License (retail)

OTHER : \_\_\_\_\_

If upgrade, alteration, or transfer, please describe specific nature of changes:  
(Please include physical or operational changes including hours, services, occupancy, ownership, etc.)

n/a  
\_\_\_\_\_  
\_\_\_\_\_  
\_\_\_\_\_

If this is for a new application, please list previous use of location for the last 5 years:

The premises has been vacant for some time but was most recently an art gallery.  
\_\_\_\_\_  
\_\_\_\_\_

Is any license under the ABC Law currently active at this location?  yes  no

If yes, what is the name of current / previous licensee, license # and expiration date: \_\_\_\_\_

n/a  
\_\_\_\_\_

Have any other licenses under the ABC Law been in effect in the last 10 years at this location?

yes  no

If yes, please list DBA names and dates of operation:

n/a  
\_\_\_\_\_  
\_\_\_\_\_

## PREMISES:

By what right does the applicant have possession of the premises?

Own  Lease  Sub-lease  Binding Contract to acquire real property  other: \_\_\_\_\_

Type of Building:  Residential  Commercial  Mixed (Res/Com)  Other: \_\_\_\_\_

Number of floor: 1st and cellar Year Built : 2000

Describe neighboring buildings:

Mixed

Zoning Designation: M1-5A

Zoning Overlay or Special Designation (applicable) \_\_\_\_\_

Block and Lot Number: 516 / 37

Does the premise occupy more than one building, zoning lot, tax lot or more than one floor?  yes  no

Is the premise located in a historic district?  yes  no

(if yes, have all exterior changes or changes governed by the Landmarks Preservation Commission (LPC) been approved by the LPC?  yes  no, please explain : no changes to be made

Will any outside area or sidewalk café be used for the sale or consumption of alcoholic beverages? (including sidewalk, roof and yard space)  no  yes : explain NYC Open Restaurants Sidewalk/Roadway

What is the proposed Occupancy? 170

Does the premise currently have a valid Certificate of Occupancy (C of O) and all appropriate permits?

no  yes

If yes, what is the maximum occupancy for the premises? 170 \*\* to be updated re occupancy

If yes, what is the use group for the premises? 6

If yes, is proposed occupancy permitted?  yes  no, explain : \_\_\_\_\_

If your occupancy is 75 or greater, do you plan to apply for Public Assembly permit?  yes  no

Do you plan to file for changes to the Certificate of Occupancy?  yes\*  no  
(if yes, please provide copy of application to the NYC DOB) \*to increase occupancy

Will the façade or signage be changed from what currently exist at the premise?  no  yes

(if yes, please describe: New signage only

## INTERIOR OF PREMISES:

What is the total licensed square footage of the premises? 5,620

If more than one floor, please specify square footage by floors: 1st: 2,750; cellar: 2,860

If there is a sidewalk café, rear yard, rooftop, or outside space, what is the square footage of the area?

TBD - will be as per DOT Open Restaurants Program

If more than one floor, what is the access between floors? stairs, elevator

How many entrances are there? 2 How many exits? 2 How many bathrooms? 3

Is there access to other parts of the building?  no  yes, explain: \_\_\_\_\_

## OVERALL SEATING INFORMATION:

Total number of tables? 35 Total table seats? 127

Total number of bars? 1 Total bar seats? 13

Total number of "other" seats? n/a please explain : \_\_\_\_\_

Total OVERALL number of seats in Premises : 140

## BARS:

How many \*stand-up bars / bar seats are being applied for on the premises? Bars 1 Seats 13

How many service bars are being applied for on the premises? 0

Any food counters?  no  yes, describe : Raw bar display/pick-up counter

### ***For Alterations and Upgrades:***

Please describe all current and existing bars / bar seats and specific changes: \_\_\_\_\_

n/a

\* A stand-up bar is any bar or counter (whether seating or not) over which a member of the public can order, pay for and receive food and alcoholic beverages.

## PROPOSED METHOD OF OPERATION:

What type of establishment will this be? (check all that apply)

Bar  Bar & Food  Restaurant  Club/ Cabaret  Hotel  Other: \_\_\_\_\_

What are the Hours of Operation?\*

\*Alcohol service begins no earlier than 10AM on Sunday and 8AM Monday - Saturday

Sunday:      Monday:      Tuesday:      Wednesday:      Thursday:      Friday:      Saturday:  
7AMto2AM   7AMto2AM   7AMto2AM   7AMto2AM   7AMto2AM   7AMto2AM   7AMto2AM

Will the business employ a manager? \_\_\_ no X yes, name / experience if known : TBD

Will there be security personnel? X no \_\_\_ yes( if yes, what nights and how many?) \_\_\_\_\_

Do you have or plan to install French doors, accordion doors or windows that open? X no \_\_\_ yes

If yes, please describe : \_\_\_\_\_

Will you have TV's ? X no \_\_\_ yes ( how many? ) \_\_\_\_\_

**Type of MUSIC / ENTERTAINMENT:** X Live Music\* \_\_\_ Live DJ \_\_\_ Juke Box X Ipod / CDs \_\_\_ none  
\*for special events

Expected Volume level: X Background (quiet) \_\_\_ Entertainment level \_\_\_ Amplified Music  
(check all that apply)

Do you have or plan to install soundproofing? \_\_\_ no X yes

IF YES, will you be using a professional sound engineer? Yes

Please describe your sound system and sound proofing: First class sound attenuating material

Will you be permitting: \_\_\_ promoted events \_\_\_ scheduled performances \_\_\_ outside promoters

\_\_\_ any events at which a cover fee is charged? X private parties

Do you have plans to manage or address vehicular traffic and crowd control on the sidewalk caused by your establishment? X no \_\_\_ yes ( if yes, please attach plans)

Will you be utilizing \_\_\_ ropes \_\_\_ movable barriers \_\_\_ other outside equipment (describe) \_\_\_\_\_

Are your premises within 200 feet of any school, church or place of worship? X no \_\_\_ yes

***If there is a school, church or place of worship within 200 feet of your premises or on the same block, please submit a block plot diagram or area map showing its' location in proximity to your applicant premises ( no larger than 8 ½ " x 11").***

Indicate the distance in feet from the proposed premise:

Name of School / Church: \_\_\_\_\_

Address: \_\_\_\_\_ Distance: \_\_\_\_\_

Name of School / Church: \_\_\_\_\_

Address: \_\_\_\_\_ Distance: \_\_\_\_\_

Name of School / Church: \_\_\_\_\_

Address: \_\_\_\_\_ Distance: \_\_\_\_\_

Please provide contact information for Residents / Community Board and confirm that if complaints are made you will address it immediately.

Contact Person: Robert Goldman Phone: ██████████

Address: ████████████████████

Email : ████████████████████

Application submitted on behalf of the applicant by:

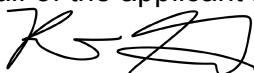

\_\_\_\_\_  
Signature

Print or Type Name Robert Goldman

Title Member

Thank you for your cooperation. Please return this questionnaire along with the other required documents as soon as you can. This will expedite your application and avoid any unnecessary delays. Use additional pages if necessary.



Community Board 2, Manhattan  
SLA Licensing Committee  
Carter Booth, Co-Chair  
Robert Ely, Co-Chair

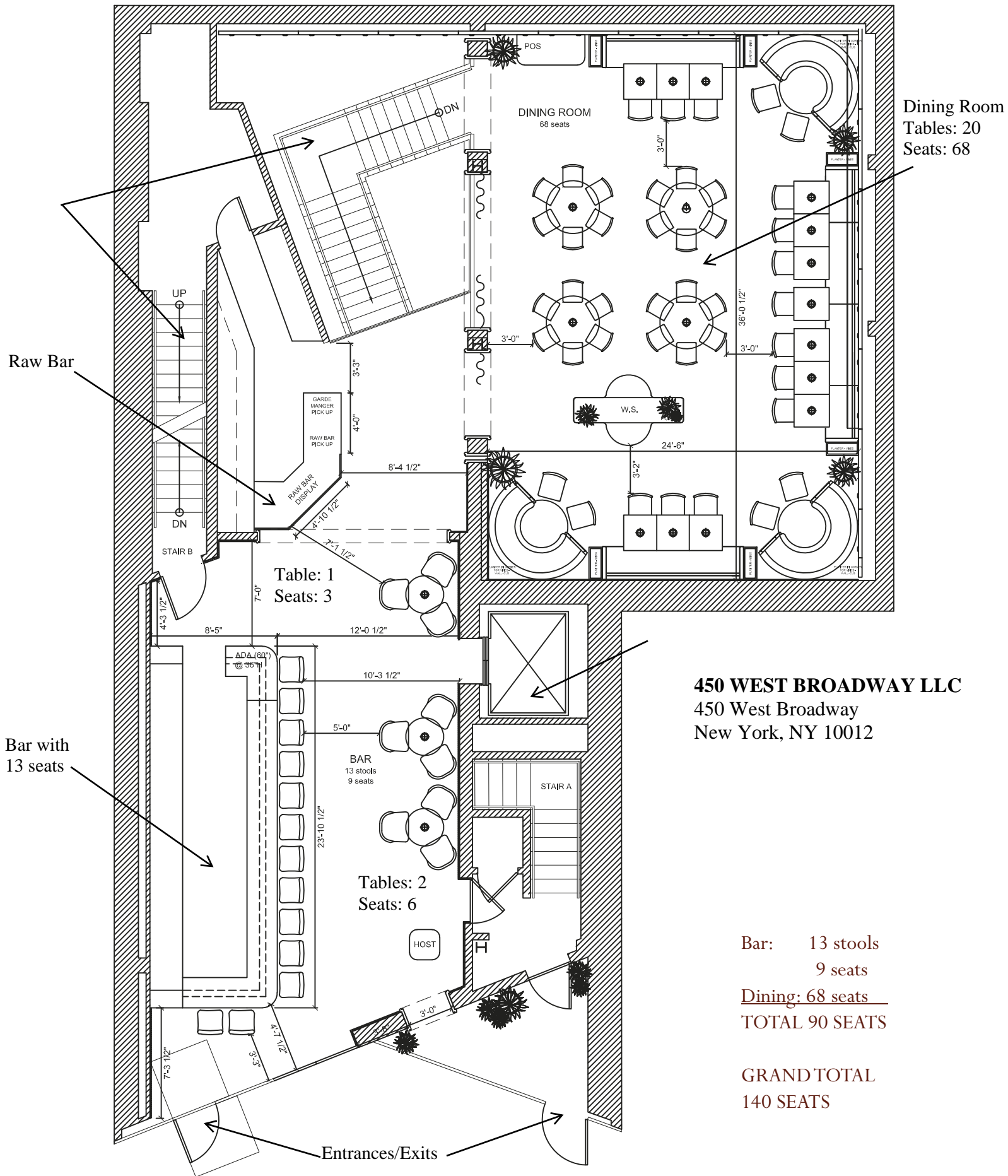

Dining Room  
Tables: 20  
Seats: 68

Raw Bar

Bar with 13 seats

**450 WEST BROADWAY LLC**  
450 West Broadway  
New York, NY 10012

Bar: 13 stools  
9 seats  
Dining: 68 seats  
**TOTAL 90 SEATS**

**GRAND TOTAL**  
**140 SEATS**

Entrances/Exits

