

Meeting Date: 08-10-21

APPLICANT INFORMATION:

Name of applicant(s): 240 West 14th St Corp.

Trade name (DBA): FBD

Premises address: 240 West 14th Street NYC

Cross Streets and other addresses used for building/premise:
B/n 7th & 8th Avenues

CONTACT INFORMATION:

Principal(s) Name(s): Andrew Nelson

Office or Home Address: 240 W. 14th Street

City, State, Zip: New York

Telephone # [REDACTED] email: [REDACTED]

Landlord Name / Contact: [REDACTED]

Landlord's Telephone and Fax: [REDACTED]

NAMES OF ALL PRINCIPAL(s): NAMES / LOCATIONS OF PAST / CURRENT LICENSES HELD

<u>Andrew Nelson</u>	
_____	_____
_____	_____
_____	_____

Briefly describe the proposed operation (i.e. "We are a family restaurant that will focus on..."):

Full service Italian restaurant featuring regional specialties, handmade personal pizzas, steaks and chops catering to the local community, featuring take out and delivery during all hours of operation

WHAT TYPE(S) OF LICENSE(S) ARE YOU APPLYING FOR (MARK ALL THAT APPLY):

- a new liquor license (Restaurant Tavern / On premise liquor Other)
- an UPGRADE of an existing Liquor License
- an ALTERATION of an existing Liquor License
- a TRANSFER of an existing Liquor License
- a HOTEL Liquor License
- a DCA CABARET License
- a CATERING / CABARET Liquor License
- a BEER and WINE License
- a RENEWAL of an existing Liquor License
- an OFF-PREMISE License (retail)
- OTHER : _____

If upgrade, alteration, or transfer, please describe specific nature of changes:
(Please include physical or operational changes including hours, services, occupancy, ownership, etc.)

If this is for a new application, please list previous use of location for the last 5 years:

Crispo's Italian Restaurant

Is any license under the ABC Law currently active at this location? yes no (inactive, unexpired)

If yes, what is the name of current / previous licensee, license # and expiration date: _____
Faylor Corp 1024882

Have any other licenses under the ABC Law been in effect in the last 10 years at this location?
 yes no

If yes, please list DBA names and dates of operation:

PREMISES:

By what right does the applicant have possession of the premises?

Own Lease Sub-lease Binding Contract to acquire real property other: _____

Type of Building: Residential Commercial Mixed (Res/Com) Other: _____

Number of floor: 5 Year Built : _____

Describe neighboring buildings: mixed use

Zoning Designation: C6-2A

Zoning Overlay or Special Designation (applicable) _____

Block and Lot Number: 618 / 13

Does the premise occupy more than one building, zoning lot, tax lot or more than one floor? yes no

Is the premise located in a historic district? yes no

(if yes, have all exterior changes or changes governed by the Landmarks Preservation Commission (LPC) been approved by the LPC? yes no, please explain : _____

Will any outside area or sidewalk café be used for the sale or consumption of alcoholic beverages? (including sidewalk, roof and yard space) no yes : explain seating within building line

What is the proposed Occupancy? 8 (building line) backyard seating
40 Backyard

Does the premise currently have a valid Certificate of Occupancy (C of O) and all appropriate permits?

no yes

If yes, what is the maximum occupancy for the premises? 135

If yes, what is the use group for the premises? 6

If yes, is proposed occupancy permitted? yes no, explain : _____

If your occupancy is 75 or greater, do you plan to apply for Public Assembly permit? yes no

Do you plan to file for changes to the Certificate of Occupancy? yes no
(if yes, please provide copy of application to the NYC DOB)

Will the façade or signage be changed from what currently exist at the premise? no yes

(if yes, please describe: new signage

INTERIOR OF PREMISES:

What is the total licensed square footage of the premises? Approx 2300 sf

If more than one floor, please specify square footage by floors: 1500 square feet 1st fl
800 square feet Basement

If there is a sidewalk café, rear yard, rooftop, or outside space, what is the square footage of the area?
Backyard 800 sf

If more than one floor, what is the access between floors? interior stairs

How many entrances are there? 1 How many exits? 1 How many bathrooms? 4

Is there access to other parts of the building? no yes, explain: _____

OVERALL SEATING INFORMATION:

Total number of tables? 21 Total table seats? 62

Total number of bars? 1 Total bar seats? 4

Total number of "other" seats? _____ please explain: _____

Total OVERALL number of seats in Premises: 66

BARS:

How many *stand-up bars / bar seats are being applied for on the premises? Bars 1 Seats 4

How many service bars are being applied for on the premises? 0

Any food counters? no yes, describe: _____

For Alterations and Upgrades:

Please describe all current and existing bars / bar seats and specific changes: _____

* A stand-up bar is any bar or counter (whether seating or not) over which a member of the public can order, pay for and receive food and alcoholic beverages.

PROPOSED METHOD OF OPERATION:

What type of establishment will this be? (check all that apply)

Bar Bar & Food Restaurant Club/ Cabaret Hotel Other: _____

What are the Hours of Operation?

Sunday: 10am to 12am Monday: 11am to 12am Tuesday: 11am to 12am Wednesday: 11^{am} to 12^{am} Thursday: 11^{am} to 2am Friday: 11^{am} to 2am Saturday: 10am to 2am

Will the business employ a manager? no yes, name / experience if known: TBD

Will there be security personnel? no yes (if yes, what nights and how many?) _____

Do you have or plan to install French doors, accordion doors or windows that open? no yes

If yes, please describe: _____

Will you have TV's? no yes (how many?) _____

Type of MUSIC / ENTERTAINMENT: Live Music Live DJ Juke Box Ipod / CDs none

Expected Volume level: Background (quiet) Entertainment level Amplified Music
(check all that apply)

Do you have or plan to install soundproofing? no yes

IF YES, will you be using a professional sound engineer? yes

Please describe your sound system and sound proofing: Specify or other internet source

Will you be permitting: promoted events scheduled performances outside promoters

any events at which a cover fee is charged? private parties

Do you have plans to manage or address vehicular traffic and crowd control on the sidewalk caused by your establishment? no yes (if yes, please attach plans) One employee will be designated to

insure that vehicles and pedestrians are not ennuisance to the neighbors
Will you be utilizing ropes movable barriers other outside equipment (describe) _____

Are your premises within 200 feet of any school, church or place of worship? no yes

If there is a school, church or place of worship within 200 feet of your premises or on the same block, please submit a block plot diagram or area map showing its' location in proximity to your applicant premises (no larger than 8 1/2 " x 11").

Indicate the distance in feet from the proposed premise:

Name of School / Church: _____

Address: _____ Distance: _____

Name of School / Church: _____

Address: _____ Distance: _____

Name of School / Church: _____

Address: _____ Distance: _____

Please provide contact information for Residents / Community Board and confirm that if complaints are made you will address it immediately.

Contact Person: Andrew Nelson Phone: 

Address: 240 W. 14th Street NYC NY

Email: 

Application submitted on
behalf of the applicant by:

Signature

Print or Type Name Andrew Nelson

Title Managing Member

Thank you for your cooperation. Please return this questionnaire along with the other required documents as soon as you can. This will expedite your application and avoid any unnecessary delays. Use additional pages if necessary.

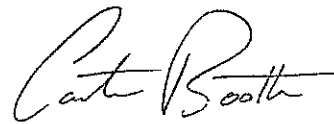



Community Board 2, Manhattan
SLA Licensing Committee
Carter Booth, Co-Chair
Robert Ely, Co-Chair

90 Tables
40 seats
EXISTING OUTDOOR PATIO

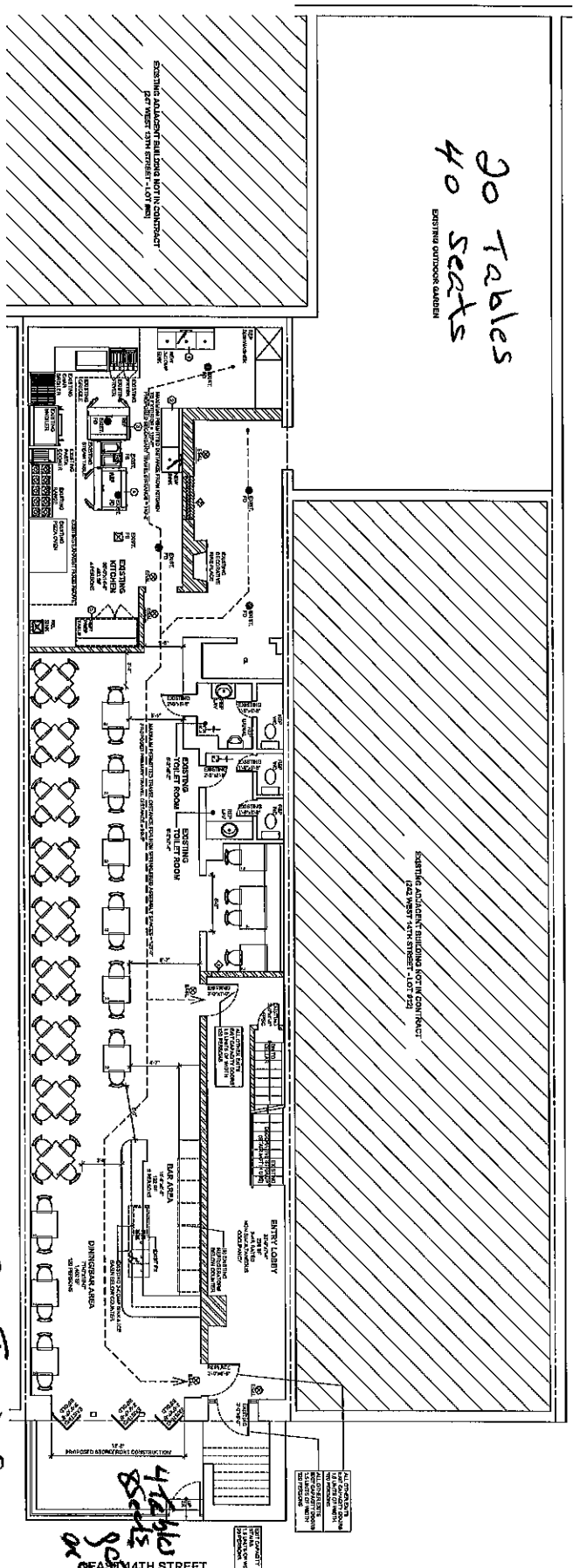

BASEMENT FLOOR CONSTRUCTION PLAN

CONSTRUCTION PLAN LEGEND

- EXISTING CONSTRUCTION TO REMAIN UNDISTURBED
- EXISTING 2 IN RATED CONSTRUCTION TO REMAIN UNDISTURBED
- PROPOSED 2 IN RATED INTERIOR PARTITION (SEE DETAIL ON G-001)
- PROPOSED 2 IN RATED METAL (SEE DETAIL ON G-001)
- WALL TRIMMED DETAILS ON G-001
- EQUIPMENT TAG - SEE SCHEDULE ON THIS SHEET
- EXISTING ILLUMINATED EXIT SIGN & LIGHT
- EXISTING DIRECTIONAL ILLUMINATED EXIT SIGN & LIGHT

- BASEMENT FLOOR CONSTRUCTION NOTES**
- ALL CONSTRUCTION ARE TO REMAIN UNDISTURBED UNLESS OTHERWISE NOTED.
 - ALL EXISTING PARTITIONS TO BE REMOVED TO EXPOSE THE CONCRETE SLAB ON G-001.
 - ALL EXISTING PARTITIONS TO BE REMOVED TO EXPOSE THE CONCRETE SLAB ON G-001.
 - ALL EXISTING PARTITIONS TO BE REMOVED TO EXPOSE THE CONCRETE SLAB ON G-001.
 - ALL EXISTING PARTITIONS TO BE REMOVED TO EXPOSE THE CONCRETE SLAB ON G-001.
 - ALL EXISTING PARTITIONS TO BE REMOVED TO EXPOSE THE CONCRETE SLAB ON G-001.
 - ALL EXISTING PARTITIONS TO BE REMOVED TO EXPOSE THE CONCRETE SLAB ON G-001.
 - ALL EXISTING PARTITIONS TO BE REMOVED TO EXPOSE THE CONCRETE SLAB ON G-001.
 - ALL EXISTING PARTITIONS TO BE REMOVED TO EXPOSE THE CONCRETE SLAB ON G-001.
 - ALL EXISTING PARTITIONS TO BE REMOVED TO EXPOSE THE CONCRETE SLAB ON G-001.
 - ALL EXISTING PARTITIONS TO BE REMOVED TO EXPOSE THE CONCRETE SLAB ON G-001.
 - ALL EXISTING PARTITIONS TO BE REMOVED TO EXPOSE THE CONCRETE SLAB ON G-001.
 - ALL EXISTING PARTITIONS TO BE REMOVED TO EXPOSE THE CONCRETE SLAB ON G-001.
 - ALL EXISTING PARTITIONS TO BE REMOVED TO EXPOSE THE CONCRETE SLAB ON G-001.
 - ALL EXISTING PARTITIONS TO BE REMOVED TO EXPOSE THE CONCRETE SLAB ON G-001.

EXISTING EATING & DRINKING ESTABLISHMENT

ALL EXISTING EATING AND DRINKING ESTABLISHMENTS SHALL BE IN ACCORDANCE WITH THE ALCOHOLIC BEVERAGE CONTROL LAW AND REGULATIONS. ALL EXISTING EATING AND DRINKING ESTABLISHMENTS SHALL BE IN ACCORDANCE WITH THE ALCOHOLIC BEVERAGE CONTROL LAW AND REGULATIONS. ALL EXISTING EATING AND DRINKING ESTABLISHMENTS SHALL BE IN ACCORDANCE WITH THE ALCOHOLIC BEVERAGE CONTROL LAW AND REGULATIONS.

ITEM #	ITEM	QUANTITY	MANUFACTURER	MODEL NO.	SIZE	VOLTS/AMPS	CAPACITY
1	2000WATT	1	GENCO	2000WATT	2000WATT	2000WATT	2000WATT
2	1000WATT	1	GENCO	1000WATT	1000WATT	1000WATT	1000WATT
3	500WATT	1	GENCO	500WATT	500WATT	500WATT	500WATT
4	250WATT	1	GENCO	250WATT	250WATT	250WATT	250WATT
5	125WATT	1	GENCO	125WATT	125WATT	125WATT	125WATT
6	62.5WATT	1	GENCO	62.5WATT	62.5WATT	62.5WATT	62.5WATT

