

David Gruber, Chair
Bo Riccobono, First Vice Chair
Jo Hamilton, Second Vice Chair
Bob Gormley, District Manager



Antony Wong, Treasurer
Susan Kent, Secretary
Keen Berger, Assistant Secretary

COMMUNITY BOARD NO. 2, MANHATTAN

3 WASHINGTON SQUARE VILLAGE
NEW YORK, NY 10012-1899

www.cb2manhattan.org

P: 212-979-2272 F: 212-254-5102 E: info@cb2manhattan.org

Greenwich Village ♦ Little Italy ♦ SoHo ♦ NoHo ♦ Hudson Square ♦ Chinatown ♦ Gansevoort Market

COMMUNITY BOARD 2 APPLICATION FOR A LIQUOR LICENSE

Thursday, May 15, 2014, at 6:30 p.m., at St. Anthony of Padua, 151-155 Sullivan St., Lower Hall

Please fill out this questionnaire and return to the Community Board 2 office by fax or mail to arrive at least **5 business days** before the Committee meeting. In addition, bring **10 copies plus supporting material requested** to the SLA committee meeting.

Failure to complete and return the questionnaire and supporting materials on time will result in your item being removed from the agenda.

Failure to provide a completed questionnaire or failure to present before CB2 will result in notifying the State Liquor Authority (SLA) of your noncompliance with the community review process.

If you need to reschedule, please notify the Community Board 2 office no later than the Friday prior to the following months meeting. **Speak to Florence Arenas at the Board Office. A maximum of 1 layover request will be granted per application. Failure to reappear without notification will result in a recommendation to deny this application.**

The following supporting materials are **required** for this application:

- ✓ 1. A list of all other licensed premises within 500 ft. of this location including Beer and Wine.
- ✓ 2. Floor plans of the premise, including all tables and chairs and kitchen lay out to be licensed. Please also include any schematics for sidewalk café, backyard garden space and/or rooftop areas if applicable.
3. Provide any plans filed or to be filed with the Buildings Department.
- ✓ 4. Proposed menu, if applicable.
- ✓ ~~5.~~ Certificate of Occupancy or Letter of No Objection for the premises.
6. Letter of Understanding or Letter of Intent from the Landlord.
7. Provide proof of community outreach with signatures or letters from Residential Tenants at location and from surrounding buildings. (i.e. a letter from the neighborhood block association or petition in support.)
- ~~8.~~ A copy of your NYS Liquor Authority application as it will be submitted to the SLA. (excluding financial information)

DATE: _____

APPLICANT INFORMATION:

Name of applicant(s): Saito LLC

Trade name (DBA): Saito

Premises address: 70 Kenmare St.

Cross Streets and other addresses used for building/premise:
Mulberry St. — Mott St.

CONTACT INFORMATION:

Principal(s) Name(s): Hitoshi Fujita

Office or Home Address: _____

City, State, Zip: _____

Telephone #: _____ email : _____

Landlord Name / Contact: Park Lane Management Corp.

Landlord's Telephone and Fax: _____

NAMES OF ALL PRINCIPAL(s):

Hitoshi Fujita

MAKOTO HATANAKA

DAISUKE NAKAZAWA

NAMES / LOCATIONS OF PAST / CURRENT LICENSES HELD

NONE

NONE

BARROW WEST VILLAGE LLC (FRATELLI'S) 13 BARROW ST.
APPLICATION WAS WITHDRAWN

Briefly describe the proposed operation (i.e. "We are a family restaurant that will focus on..."):

Full service Japanese Restaurant

WHAT TYPE(S) OF LICENSE(S) ARE YOU APPLYING FOR (MARK ALL THAT APPLY):

- a new liquor license (Restaurant Tavern / On premise liquor Other)
- an UPGRADE of an existing Liquor License
- an ALTERATION of an existing Liquor License
- a TRANSFER of an existing Liquor License
- a HOTEL Liquor License
- a DCA CABARET License
- a CATERING / CABARET Liquor License
- a BEER and WINE License
- a RENEWAL of an existing Liquor License
- an OFF-PREMISE License (retail)
- OTHER : _____

If upgrade, alteration, or transfer, please describe specific nature of changes:
(Please include physical or operational changes including hours, services, occupancy, ownership, etc.)

N/A

If this is for a new application, please list previous use of location for the last 5 years:

RESTAURANT since 2013

Is any license under the ABC Law currently active at this location? yes no

If yes, what is the name of current / previous licensee, license # and expiration date: _____

SOH PEACE INC (TORA) RW # 1273826 EXP. 8/31/20

Have any other licenses under the ABC Law been in effect in the last 10 years at this location?
 yes no

If yes, please list DBA names and dates of operation:

PREMISES:

By what right does the applicant have possession of the premises?

Own Lease Sub-lease Binding Contract to acquire real property other: _____

Type of Building: Residential Commercial Mixed (Res/Com) Other: _____

Number of floor: 6 Year Built: 1900

Describe neighboring buildings: Mixed Residential + Commercial

Zoning Designation: C6-1

Zoning Overlay or Special Designation (applicable) Special Little Italy District

Block and Lot Number: 480 1 4

Does the premise occupy more than one building, zoning lot, tax lot or more than one floor? yes no

Is the premise located in a historic district? yes no

(if yes, have all exterior changes or changes governed by the Landmarks Preservation Commission (LPC) been approved by the LPC? yes no, please explain: N/A

Will any outside area or sidewalk café be used for the sale or consumption of alcoholic beverages? (including sidewalk, roof and yard space) no yes: explain _____

What is the proposed Occupancy? 74

Does the premise currently have a valid Certificate of Occupancy (C of O) and all appropriate permits?
 no yes CNO

If yes, what is the maximum occupancy for the premises? 74

If yes, what is the use group for the premises? 6

If yes, is proposed occupancy permitted? yes no, explain: CNO LESS THAN 75 PERSONS

If your occupancy is 75 or greater, do you plan to apply for Public Assembly permit? yes no N/A

Do you plan to file for changes to the Certificate of Occupancy? yes no
(if yes, please provide copy of application to the NYC DOB)

Will the façade or signage be changed from what currently exist at the premise? no yes

(if yes, please describe: WE WILL PUT UP OUR OWN SIGN

INTERIOR OF PREMISES:

What is the total licensed square footage of the premises? 870

If more than one floor, please specify square footage by floors: BSMT - 400 1st flr - 470

If there is a sidewalk café, rear yard, rooftop, or outside space, what is the square footage of the area?
no

If more than one floor, what is the access between floors? inside stairwell

How many entrances are there? 1 How many exits? 1 How many bathrooms? 1

Is there access to other parts of the building? no yes, explain: _____

OVERALL SEATING INFORMATION:

Total number of tables? 3 Total table seats? 8

Total number of bars? 1 Total bar seats? 10

Total number of "other" seats? 0 please explain: _____

Total OVERALL number of seats in Premises : 18

BARS:

How many *stand-up bars / bar seats are being applied for on the premises? Bars 1 Seats _____

How many service bars are being applied for on the premises? 0

Any food counters? no yes, describe: _____

For Alterations and Upgrades:

Please describe all current and existing bars / bar seats and specific changes: _____

* A stand-up bar is any bar or counter (whether seating or not) over which a member of the public can order, pay for and receive food and alcoholic beverages.

PROPOSED METHOD OF OPERATION:

What type of establishment will this be? (check all that apply)

Bar Bar & Food Restaurant Club/ Cabaret Hotel Other: _____

What are the Hours of Operation?

Sunday: 5P to 12A Monday: 5P to 12A Tuesday: 5P to 12A Wednesday: 5P to 12A Thursday: 5P to 12A Friday: 5P to 12A Saturday: 5P to 12A

Will the business employ a manager? no yes, name / experience if known: _____

Will there be security personnel? no yes (if yes, what nights and how many?) _____

Do you have or plan to install French doors, accordion doors or windows that open? no yes

If yes, please describe: _____

Will you have TV's? no yes (how many?) _____

Type of MUSIC / ENTERTAINMENT: Live Music Live DJ Juke Box Ipod / CDs none

Expected Volume level: Background (quiet) Entertainment level Amplified Music
(check all that apply)

Do you have or plan to install soundproofing? no yes

IF YES, will you be using a professional sound engineer? _____

Please describe your sound system and sound proofing: FLAD w 2 small speakers

Will you be permitting: promoted events scheduled performances outside promoters

any events at which a cover fee is charged? private parties

Do you have plans to manage or address vehicular traffic and crowd control on the sidewalk caused by your establishment? no yes (if yes, please attach plans)

Will you be utilizing ropes movable barriers other outside equipment (describe) _____

Are your premises within 200 feet of any school, church or place of worship? no yes

If there is a school, church or place of worship within 200 feet of your premises or on the same block, please submit a block plot diagram or area map showing its' location in proximity to your applicant premises (no larger than 8 1/2 " x 11").

Indicate the distance in feet from the proposed premise:

Name of School / Church: _____

Address: _____ Distance: _____

Name of School / Church: _____

Address: _____ Distance: _____

Name of School / Church: _____

Address: _____ Distance: _____

Please provide contact information for Residents / Community Board and confirm that if complaints are made you will address it immediately.

Contact Person: HITOSHI FUJITA Phone: 

Address: 

Email: 

Application submitted on behalf of the applicant by:

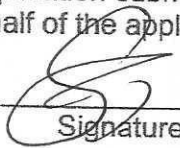
Signature

Print or Type Name Michael Kelly

Title Representative

Thank you for your cooperation. Please return this questionnaire along with the other required documents as soon as you can. This will expedite your application and avoid any unnecessary delays. Use additional pages if necessary.





Community Board 2, Manhattan
SLA Licensing Committee
Carter Booth, Co-Chair
Robert Ely, Co-Chair

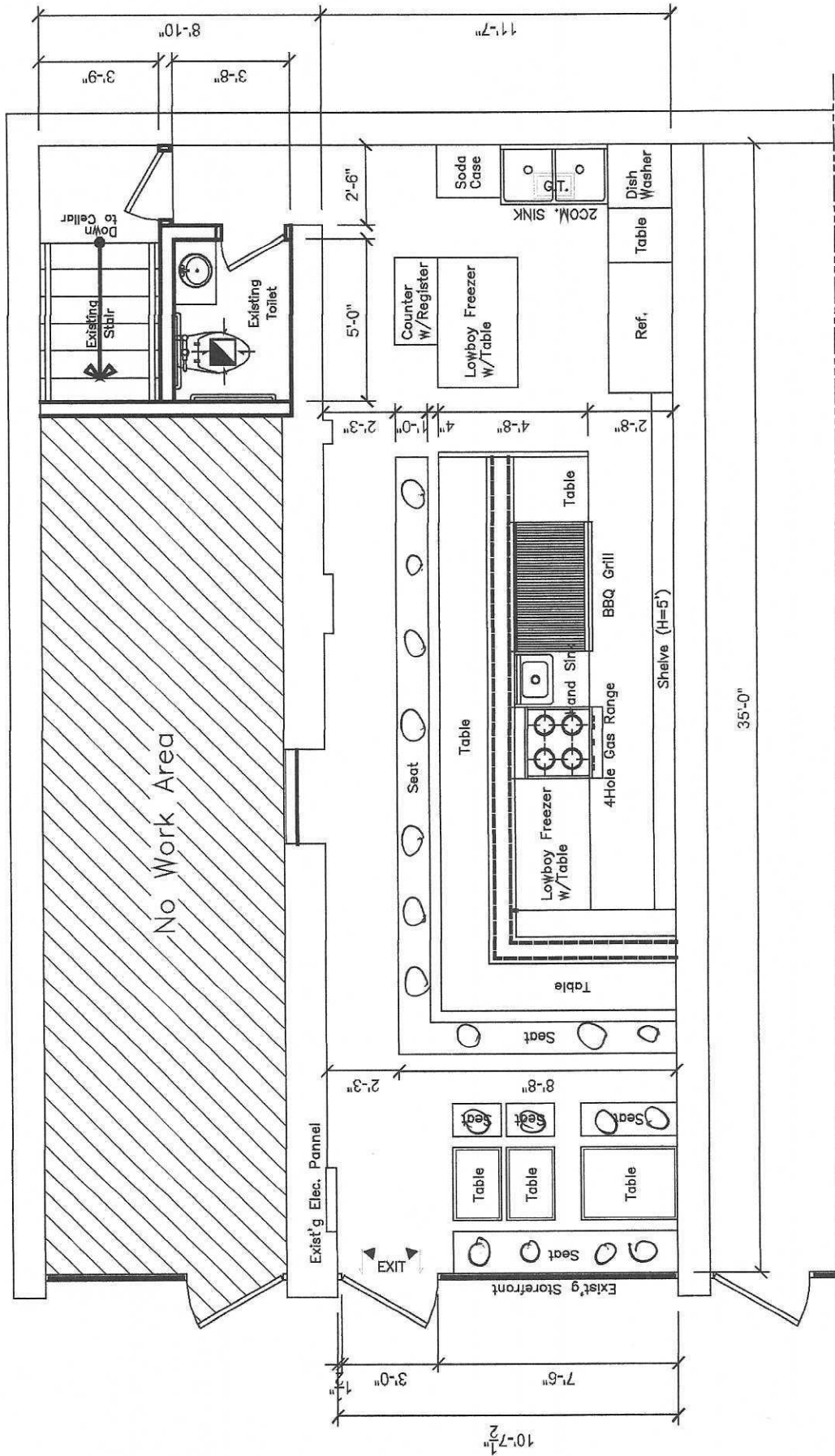

← KENMARE ST →

FIRST FLOOR PLAN

SCALE 1/4" = 1'-0"

1
A-200

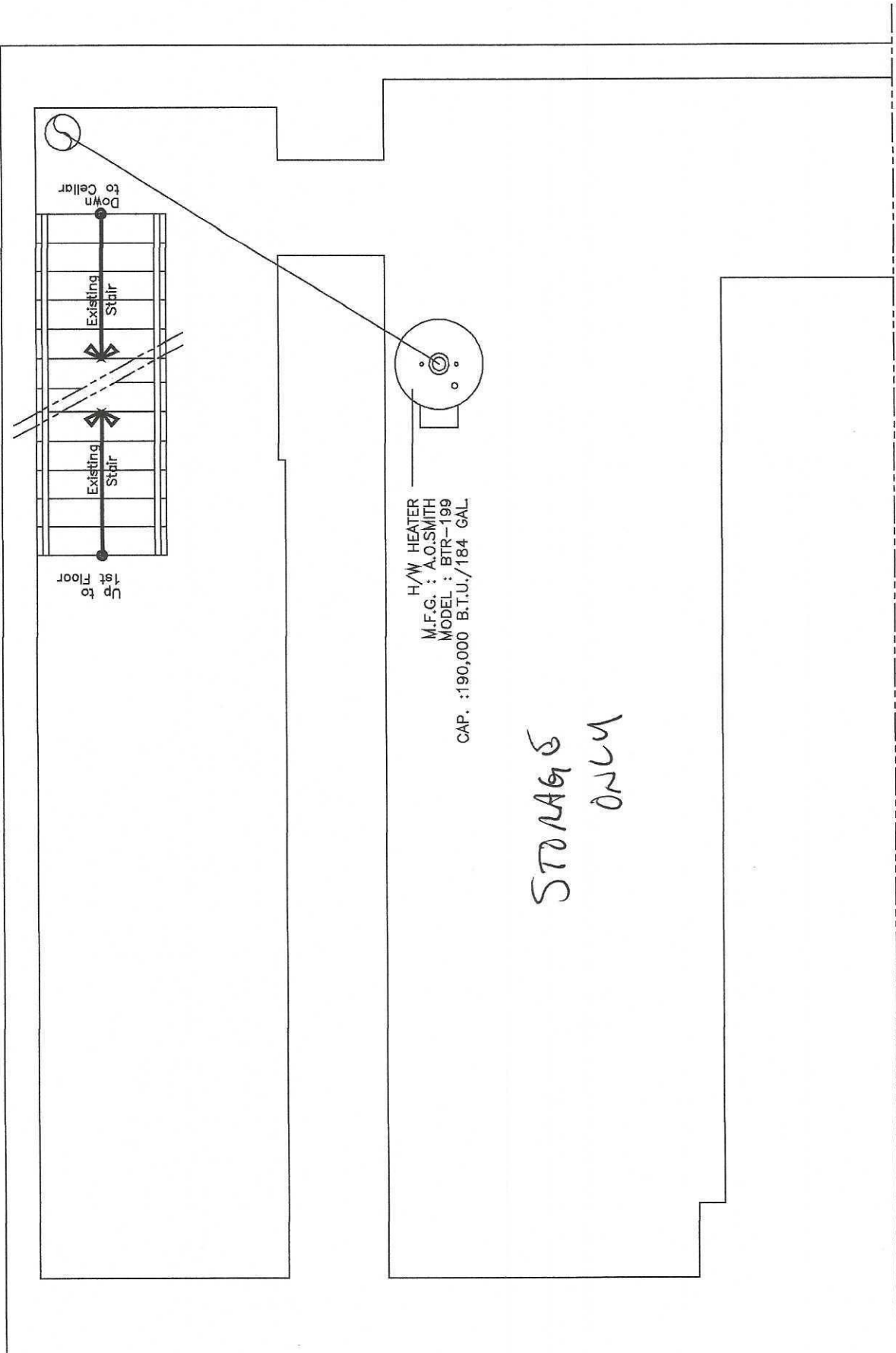

CELLAR FLOOR PLAN