

Terri Cude, Chair  
Daniel Miller, First Vice Chair  
Susan Kent, Second Vice Chair  
Bob Gormley, District Manager



Antony Wong, Treasurer  
Keen Berger, Secretary  
Erik Coler, Assistant Secretary

## COMMUNITY BOARD No. 2, MANHATTAN

3 WASHINGTON SQUARE VILLAGE  
NEW YORK, NY 10012-1899

www.cb2manhattan.org

P: 212-979-2272 F: 212-254-5102 E: info@cb2manhattan.org

Greenwich Village ♦ Little Italy ♦ SoHo ♦ NoHo ♦ Hudson Square ♦ Chinatown ♦ Gansevoort Market

### **COMMUNITY BOARD 2 APPLICATION FOR A LIQUOR LICENSE**

Please fill out this questionnaire and return to the Community Board 2 office by fax or mail to arrive at least **5 business days** before the Committee meeting. In addition, bring **10 copies plus supporting material requested** to the SLA committee meeting.

**Failure to complete and return the questionnaire and supporting materials on time will result in your item being removed from the agenda.**

**Failure to provide a completed questionnaire or failure to present before CB2 will result in notifying the State Liquor Authority (SLA) of your noncompliance with the community review process.**

If you need to reschedule, please notify the Community Board 2 office no later than the Friday prior to the following months meeting. Speak to Florence Arenas at the Board Office. **A maximum of 1 layover request will be granted per application. Failure to reappear without notification will result in a recommendation to deny this application.**

The following supporting materials are **required** for this application:

1. A list of all other licensed premises within 500 ft. of this location including Beer and Wine. *ATTACHED*
2. Floor plans of the premise, including all tables and chairs and kitchen lay out to be licensed. Please also include any schematics for sidewalk café, backyard garden space and/or rooftop areas if applicable. *ATTACHED*
3. Provide any plans filed or to be filed with the Buildings Department. *Cosmetic Changes. NO DOB*
4. Proposed menu, if applicable. *ATTACHED*
5. Certificate of Occupancy or Letter of No Objection for the premises. *ATTACHED*
6. Letter of Understanding or Letter of Intent from the Landlord. *ATTACHED*
7. Provide proof of community outreach with signatures or letters from Residential Tenants at location and from surrounding buildings. (i.e. a letter from the neighborhood block association or petition in support.) *Could NOT ATTAIN DUE TO COVID*
8. A copy of your NYS Liquor Authority application as it will be submitted to the SLA. (excluding financial information)

Meeting Date: \_\_\_\_\_

**APPLICANT INFORMATION:**

Name of applicant(s): DAVID JAMES & REHAN ALAM (CORP TO BE FORMED)

Trade name (DBA): SALOON SINGER

Premises address: 169 BLEECKER STREET, NEW YORK, NY 10012

Cross Streets and other addresses used for building/premise:  
SULLIVAN STREET & TITMOPSON STREET

**CONTACT INFORMATION:**

Principal(s) Name(s): REHAN ALAM, DAVID JAMES, MOHAMMED ALAM

Office or Home Address: \_\_\_\_\_

City, State, Zip: \_\_\_\_\_

Telephone #: \_\_\_\_\_ email: \_\_\_\_\_

Landlord Name / Contact: \_\_\_\_\_

Landlord's Telephone and Fax: \_\_\_\_\_

NAMES OF ALL PRINCIPAL(S):	NAMES / LOCATIONS OF PAST / CURRENT LICENSES HELD
<u>REHAN ALAM</u>	<u>Kips Bay Hospitality LLC, DBA TARA ROSE 384 3RD Ave NEW YORK 10016</u>
<u>MOHAMMED ALAM</u>	<u>106 AMSTERDAM PAST COOP, d/BA ELLINGTON IN THE PARK W 105th &amp; HUDSON NY 10025</u>
<u>MOHAMMED ALAM</u>	<u>151 BLEECKER LLC, d/BA, RED LION 151 BLEECKER STREET NEW YORK, 10012</u>

Briefly describe the proposed operation (i.e. "We are a family restaurant that will focus on..."):  
- RESTAURANT & BAR serving new American Tapas & Cocktails, and Wine  
THE CONCEPT IS ABOUT COMMUNITY, ARTISTRY, FAMILY, FRIENDS, & FUN.

**WHAT TYPE(S) OF LICENSE(S) ARE YOU APPLYING FOR ( MARK ALL THAT APPLY):**

- a new liquor license (  Restaurant  Tavern / On premise liquor  Other )
- an UPGRADE of an existing Liquor License
- an ALTERATION of an existing Liquor License
- a TRANSFER of an existing Liquor License
- a HOTEL Liquor License
- a DCA CABARET License
- a CATERING / CABARET Liquor License
- a BEER and WINE License
- a RENEWAL of an existing Liquor License
- an OFF-PREMISE License (retail)
- OTHER : \_\_\_\_\_

If upgrade, alteration, or transfer, please describe specific nature of changes:  
(Please include physical or operational changes including hours, services, occupancy, ownership, etc.)

---

---

---

If this is for a new application, please list previous use of location for the last 5 years:

Jo Jo Philosophy → RESTAURANT & BAR. (Live Music) (Sports)  
THUNDER JACKSON → RESTAURANT & BAR (Live Music)

Is any license under the ABC Law currently active at this location?  yes  no

If yes, what is the name of current / previous licensee, license # and expiration date: \_\_\_\_\_

TJW Family Foods LLC dba Jo Jo's Philosophy # 1298997 04/30/2021

Have any other licenses under the ABC Law been in effect in the last 10 years at this location?  
 yes  no

If yes, please list DBA names and dates of operation:

---

---

**PREMISES:**

By what right does the applicant have possession of the premises?

Own  Lease  Sub-lease  Binding Contract to acquire real property  other: \_\_\_\_\_

Type of Building:  Residential  Commercial  Mixed (Res/Com)  Other: \_\_\_\_\_

Number of floor: 5 Year Built : 1910

Describe neighboring buildings: All mixed on Bleeker, Residential on Sullivan

Zoning Designation: R7-2, C1-5

Zoning Overlay or Special Designation (applicable) \_\_\_\_\_

Block and Lot Number: 539 / 42

Does the premise occupy more than one building, zoning lot, tax lot or more than one floor?  yes  no

Is the premise located in a historic district?  yes  no

(if yes, have all exterior changes or changes governed by the Landmarks Preservation Commission (LPC) been approved by the LPC?  yes  no, please explain : Will be applied post CB. ONLY Awning Change

Will any outside area or sidewalk café be used for the sale or consumption of alcoholic beverages? (including sidewalk, roof and yard space)  no  yes : explain SWC license + Roadway

What is the proposed Occupancy? 65 persons. Below 74

Does the premise currently have a valid Certificate of Occupancy (C of O) and all appropriate permits?

no  yes

If yes, what is the maximum occupancy for the premises? ~~74~~ 75

If yes, what is the use group for the premises? All

If yes, is proposed occupancy permitted?  yes  no, explain : \_\_\_\_\_

If your occupancy is 75 or greater, do you plan to apply for Public Assembly permit?  yes  no

Do you plan to file for changes to the Certificate of Occupancy?  yes  no  
(if yes, please provide copy of application to the NYC DOB)

Will the façade or signage be changed from what currently exist at the premise?  no  yes

(if yes, please describe: Awning and paint. Signage will be same dimension, just NAME Change.

## INTERIOR OF PREMISES:

What is the total licensed square footage of the premises? 1600

If more than one floor, please specify square footage by floors: \_\_\_\_\_

If there is a sidewalk café, rear yard, rooftop, or outside space, what is the square footage of the area?

No SWC yet. Will seek permit. 180 sqft. space. Single line SEATS.

If more than one floor, what is the access between floors? \_\_\_\_\_

How many entrances are there? 2 How many exits? 2 How many bathrooms? 3

Is there access to other parts of the building? no  yes, explain: cellar.

## OVERALL SEATING INFORMATION:

Total number of tables? 13 Total table seats? 52

Total number of bars? 1 Total bar seats? 12

Total number of "other" seats? 2 please explain: Piano SEATS

Total OVERALL number of seats in Premises: 66 seats

change

## BARS:

How many \* stand-up bars / bar seats are being applied for on the premises? Bars 1 Seats 12

How many service bars are being applied for on the premises? 0

Any food counters? no  yes, describe: Order food at Bar.

### **For Alterations and Upgrades:**

Please describe all current and existing bars / bar seats and specific changes: \_\_\_\_\_

\* A stand-up bar is any bar or counter (whether seating or not) over which a member of the public can order, pay for and receive food and alcoholic beverages.

## PROPOSED METHOD OF OPERATION:

What type of establishment will this be? (check all that apply)

Bar  Bar & Food  Restaurant  Club/ Cabaret  Hotel  Other: \_\_\_\_\_

What are the Hours of Operation?

Sunday: 10am to 4am Monday: 11am to 4am Tuesday: 11am to 4am Wednesday: 11am to 4am Thursday: 11am to 4am Friday: 11am to 4am Saturday: 10am to 4am

Will the business employ a manager?  no  yes, name / experience if known : DAVID JAMES

Will there be security personnel?  no  yes (if yes, what nights and how many?) \_\_\_\_\_

Do you have or plan to install French doors, accordion doors or windows that open?  no  yes

If yes, please describe : Blecker Side has windows that open.

Will you have TV's ?  no  yes ( how many? ) 2

Type of MUSIC / ENTERTAINMENT:  Live Music  Live DJ  Juke Box  Ipod / CDs  none

Expected Volume level:  Background (quiet)  Entertainment level  Amplified Music  
(check all that apply)

Do you have or plan to install soundproofing?  no  yes

IF YES, will you be using a professional sound engineer? YES

Please describe your sound system and sound proofing: Acoustical Ceiling Panels.

2 or 3 10inch Speakers. Softer genre of music. Piano & Violin.

Will you be permitting:  promoted events  scheduled performances  outside promoters

N/A any events at which a cover fee is charged?  private parties

Do you have plans to manage or address vehicular traffic and crowd control on the sidewalk caused by your establishment?  no  yes ( if yes, please attach plans)

Will you be utilizing  ropes  movable barriers  other outside equipment (describe) \_\_\_\_\_

Barriers for SWC seating, ROADWAY SEATING Set-Up

Are your premises within 200 feet of any school, church or place of worship?  no  yes

**If there is a school, church or place of worship within 200 feet of your premises or on the same block, please submit a block plot diagram or area map showing its' location in proximity to your applicant premises ( no larger than 8 1/2 " x 11").**

Indicate the distance in feet from the proposed premise:

Name of School / Church: \_\_\_\_\_

Address: \_\_\_\_\_ Distance: \_\_\_\_\_

Name of School / Church: \_\_\_\_\_

Address: \_\_\_\_\_ Distance: \_\_\_\_\_

Name of School / Church: \_\_\_\_\_

Address: \_\_\_\_\_ Distance: \_\_\_\_\_

Please provide contact information for Residents / Community Board and confirm that if complaints are made you will address it immediately.

Contact Person: REHAN ALAM Phone: [REDACTED]

Address: [REDACTED]

Email: [REDACTED]

Application submitted on behalf of the applicant by:

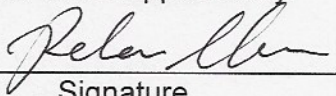
  
Signature

Print or Type Name REHAN ALAM

Title OWNER, LLC MEMBER

Thank you for your cooperation. Please return this questionnaire along with the other required documents as soon as you can. This will expedite your application and avoid any unnecessary delays. Use additional pages if necessary.





Community Board 2, Manhattan  
SLA Licensing Committee  
Carter Booth, Co-Chair  
Robert Ely, Co-Chair

1600 Sq. Ft.

Saloon Singer - 169 Bleeker St.

Bleeker  
← (21 ft. 3 in) →

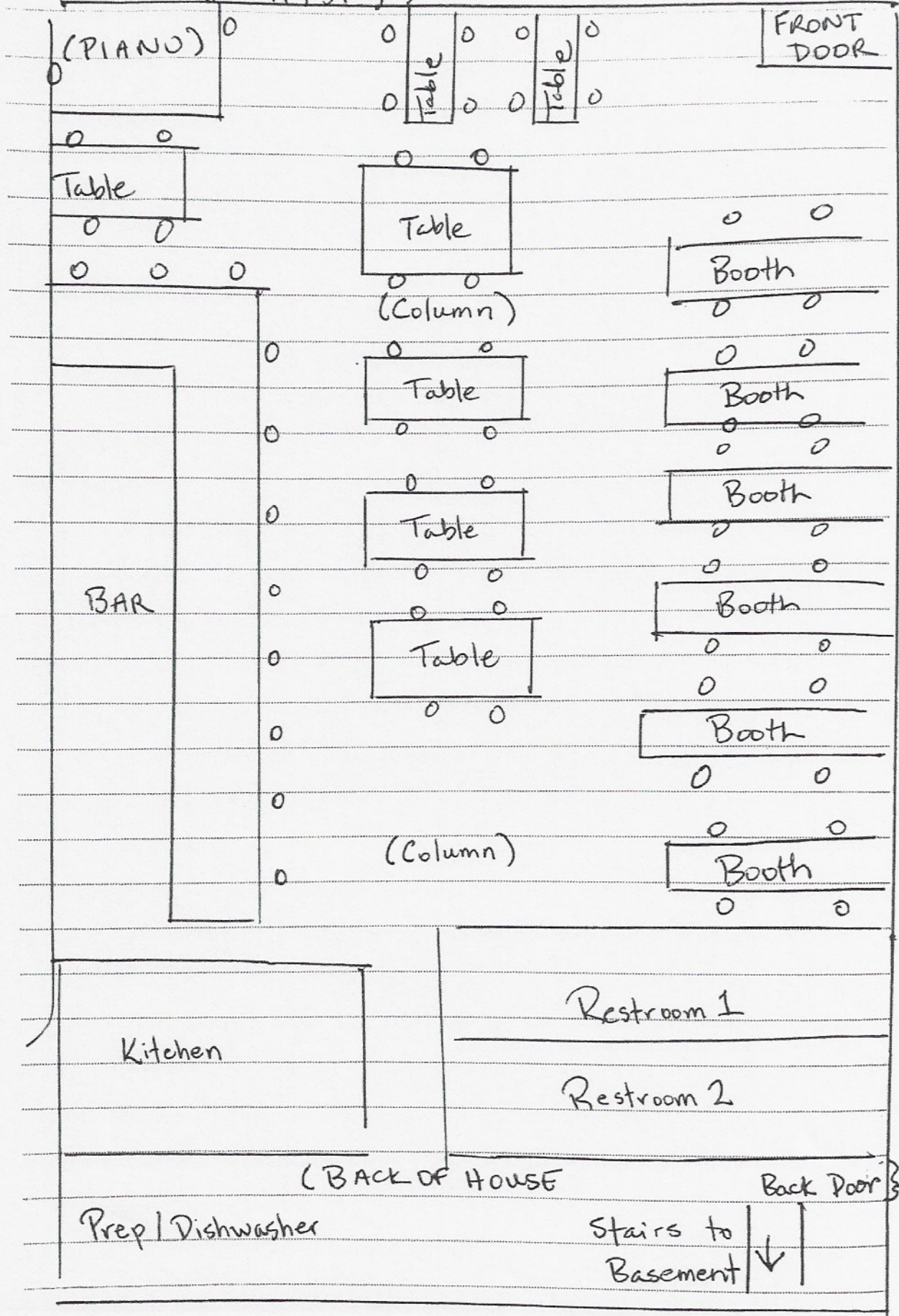

FRONT DOOR

(PIANO)

Table

Table

Table

Table

(Column)

Table

Table

Table

(Column)

Booth

Booth

Booth

Booth

Booth

Booth

BAR

Kitchen

Restroom 1

Restroom 2

(BACK OF HOUSE

Back Door

Prep / Dishwasher

Stairs to  
Basement ↓

Sullivan ← (45 ft. 10 in.) →