

Terri Cude, *Chair*
Daniel Miller, *First Vice Chair*
Susan Kent, *Second Vice Chair*
Bob Gormley, *District Manager*

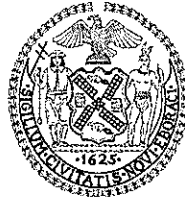

Antony Wong, *Treasurer*
Keen Berger, *Secretary*
Erik Coler, *Assistant Secretary*

COMMUNITY BOARD NO. 2, MANHATTAN

3 WASHINGTON SQUARE VILLAGE

NEW YORK, NY 10012-1899

www.cb2manhattan.org

P: 212-979-2272 | F: 212-254-5102 | E: info@cb2manhattan.org

Greenwich Village ✦ Little Italy ✦ SoHo ✦ NoHo ✦ Hudson Square ✦ Chinatown ✦ Gansevoort Market

COMMUNITY BOARD 2 APPLICATION FOR A LIQUOR LICENSE

Please fill out this questionnaire and return to the Community Board 2 office by fax or mail to arrive at least 5 business days before the Committee meeting. In addition, bring 10 copies plus supporting material requested to the SLA committee meeting.

Failure to complete and return the questionnaire and supporting materials on time will result in your item being removed from the agenda.

Failure to provide a completed questionnaire or failure to present before CB2 will result in notifying the State Liquor Authority (SLA) of your noncompliance with the community review process.

If you need to reschedule, please notify the Community Board 2 office no later than the Friday prior to the following months meeting. Speak to Florence Arenas at the Board Office. A maximum of 1 layover request will be granted per application. **Failure to reappear without notification will result in a recommendation to deny this application.**

The following supporting materials are required for this application:

- ✓ 1. A list of all other licensed premises within 500 ft. of this location including Beer and Wine.
- ✓ 2. Floor plans of the premise, including all tables and chairs and kitchen lay out to be licensed. Please also include any schematics for sidewalk café, backyard garden space and/or rooftop areas if applicable.
- ✓ 3. Provide any plans filed or to be filed with the Buildings Department.
- ✓ 4. Proposed menu, if applicable.
- ✓ 5. Certificate of Occupancy or Letter of No Objection for the premises.
- ✓ 6. Letter of Understanding or Letter of Intent from the Landlord.
7. Provide proof of community outreach with signatures or letters from Residential Tenants at location and from surrounding buildings. (i.e. a letter from the neighborhood block association or petition in support.)
8. A copy of your NYS Liquor Authority application as it will be submitted to the SLA. (excluding financial information)

Meeting Date: _____

APPLICANT INFORMATION:

Name of applicant(s):

178 Bleecker Cafe LLC

Trade name (DBA):

To be Determined

Premises address:

178 Bleecker St #1st Floor, New York, NY 10012

Cross Streets and other addresses used for building/premise:

MacDougal St & Sullivan St

CONTACT INFORMATION:

Principal(s) Name(s):

Kuoliang Wei , and Athena Hom

Office or Home Address: _____

City, State, Zip: _____

Telephone #: _____

email : _____

Landlord Name / Contact: _____

Landlord's Telephone and Fax: _____

NAMES OF ALL PRINCIPAL(s):

Kuoliang Wei

Athena Hom

NAMES / LOCATIONS OF PAST / CURRENT LICENSES HELD

N/A

Rumpus Room located at 249 Eldridge St, New York, NY 10002

Briefly describe the proposed operation (i.e. "We are a family restaurant that will focus on..."):

Upscale Restaurant and Bar focus on quality "Fresh" food created by our talented chef, with items such as

beef tartare appetizer to a poached salmon with potato croquette

Full bar with chef driven craft cocktails and Esoteric Wines everages. Decor will be classic high end decor

comfortable banquettes, beautiful ambience.

WHAT TYPE(S) OF LICENSE(S) ARE YOU APPLYING FOR (MARK ALL THAT APPLY):

a new liquor license (Restaurant Tavern / On premise liquor Other)

an UPGRADE of an existing Liquor License

an ALTERATION of an existing Liquor License

a TRANSFER of an existing Liquor License

a HOTEL Liquor License

a DCA CABARET License

a CATERING / CABARET Liquor License

a BEER and WINE License

a RENEWAL of an existing Liquor License

an OFF-PREMISE License (retail)

OTHER : _____

If upgrade, alteration, or transfer, please describe specific nature of changes:

(Please include physical or operational changes including hours, services, occupancy, ownership, etc.)

If this is for a new application, please list previous use of location for the last 5 years:

This is newer construction, building was completed in 2017

Is any license under the ABC Law currently active at this location? yes no

If yes, what is the name of current / previous licensee, license # and expiration date: _____

Have any other licenses under the ABC Law been in effect in the last 10 years at this location?

yes no

If yes, please list DBA names and dates of operation:

PREMISES:

By what right does the applicant have possession of the premises?

Own Lease Sub-lease Binding Contract to acquire real property other: _____

Type of Building: Residential Commercial Mixed (Res/Com) Other: _____

Number of floor: 6 Year Built : 2017

Describe neighboring buildings: Mixed use lots of retail

Zoning Designation: R7-2

Zoning Overlay or Special Designation (applicable) C1-5

Block and Lot Number: 526 / 7502

Does the premise occupy more than one building, zoning lot, tax lot or more than one floor? yes no

Is the premise located in a historic district? yes no

(if yes, have all exterior changes or changes governed by the Landmarks Preservation Commission (LPC) been approved by the LPC? yes no, please explain : _____

Will any outside area or sidewalk café be used for the sale or consumption of alcoholic beverages? (including sidewalk, roof and yard space) no yes explain 3-2 Person tables in front

What is the proposed Occupancy? 74

Does the premise currently have a valid Certificate of Occupancy (C of O) and all appropriate permits? no yes

If yes, what is the maximum occupancy for the premises? 200 or lower

If yes, what is the use group for the premises? Eating & Drinking with Entertainment

If yes, is proposed occupancy permitted? yes no, explain : _____

If your occupancy is 75 or greater, do you plan to apply for Public Assembly permit? yes no

Do you plan to file for changes to the Certificate of Occupancy? yes no (if yes, please provide copy of application to the NYC DOB)

Will the façade or signage be changed from what currently exist at the premise? no yes

(if yes, please describe: Add a sign above the door with restaurants name and awning that retracts

INTERIOR OF PREMISES:

What is the total licensed square footage of the premises? 1324 - Ground FL, 101 SF garden = 1,425 sf

If more than one floor, please specify square footage by floors: only 1st floor

If there is a sidewalk café, rear yard, rooftop, or outside space, what is the square footage of the area?

101 SF outdoor back garden, sidewalk cafe (applying for approx 100 sf 15' x 6')

If more than one floor, what is the access between floors? _____

How many entrances are there? 1 How many exits? 2 How many bathrooms ? 2

Is there access to other parts of the building? ___ no yes, explain: Common Hallway

OVERALL SEATING INFORMATION:

Total number of tables? 9 Total table seats? 36 / *backyard 1 table. 8 seats*

Total number of bars? 1 Total bar seats? 16

Total number of "other" seats? 8 please explain : Hightop Counter opposite of bar

Total OVERALL number of seats in Premises : 60

BARS:

How many *stand-up bars / bar seats are being applied for on the premises? Bars 1 Seats 16

How many service bars are being applied for on the premises? 0

Any food counters? ___ no yes, describe : the kitchen is behind the bar. 6' of the bar if for food

For Alterations and Upgrades:

Please describe all current and existing bars / bar seats and specific changes: _____

* A stand-up bar is any bar or counter (whether seating or not) over which a member of the public can order, pay for and receive food and alcoholic beverages.

PROPOSED METHOD OF OPERATION:

What type of establishment will this be? (check all that apply)

Bar ___ Bar & Food Restaurant ___ Club/ Cabaret ___ Hotel ___ Other: _____

What are the Hours of Operation?

Sunday: Monday: Tuesday: Wednesday: Thursday: Friday: Saturday:

10am to 12am 10am to 2am 10am to 2am 10am to 2am 10am to 2am 10am to 2am 10am to 2am

Will the business employ a manager? ___ no yes, name / experience if known : 25 year Restaurant Exp

Will there be security personnel? no ___ yes(if yes, what nights and how many?)

Do you have or plan to install French doors, accordion doors or windows that open? no ___ yes

If yes, please describe : _____

Will you have TV's ? ___ no yes (how many?) 4

Type of MUSIC / ENTERTAINMENT: ___ Live Music ___ Live DJ ~~___ Juke Box~~ Ipod / CDs ___ none

Expected Volume level: Background (quiet) ___ Entertainment level ___ Amplified Music
(check all that apply)

Do you have or plan to install soundproofing? ___ no yes

IF YES, will you be using a professional sound engineer?

Please describe your sound system and sound proofing: surround sound used for background music , self amplified speakers, use sonos to program music, install sound proof in ceiling

Will you be permitting: ___ promoted events ___ scheduled performances ___ outside promoters

___ any events at which a cover fee is charged? private parties

Do you have plans to manage or address vehicular traffic and crowd control on the sidewalk caused by your establishment? no ___ yes (if yes, please attach plans)

Will you be utilizing ropes movable barriers ___ other outside equipment (describe) ___
Ropes or such, for outdoor seating

Are your premises within 200 feet of any school, church or place of worship? no ___ yes

If there is a school, church or place of worship within 200 feet of your premises or on the same block, please submit a block plot diagram or area map showing its' location in proximity to your applicant premises (no larger than 8 1/2 " x 11").

Indicate the distance in feet from the proposed premise:

Name of School / Church: _____

Address: _____ Distance: _____

Name of School / Church: _____

Address: _____ Distance: _____

Name of School / Church: _____

Address: _____ Distance: _____

Please provide contact information for Residents / Community Board and confirm that if complaints are made you will address it immediately.

Contact Person: Athena Hom Phone: [REDACTED]

Address: 178 Bleecker St, New York, NY 10012

Email: [REDACTED]

Application submitted on
behalf of the applicant by:

[Signature]
Signature

Print or Type Name Hong Chen

Title attorney for applicant

Thank you for your cooperation. Please return this questionnaire along with the other required documents as soon as you can. This will expedite your application and avoid any unnecessary delays. Use additional pages if necessary.

[Signature: Carter Booth]

[Signature: Robert Ely]

Community Board 2, Manhattan
SLA Licensing Committee
Carter Booth, Co-Chair
Robert Ely, Co-Chair

178 Bleeker Cafe Ltd

178 Bleeker St 1st Floor,

New York, NY, 10012

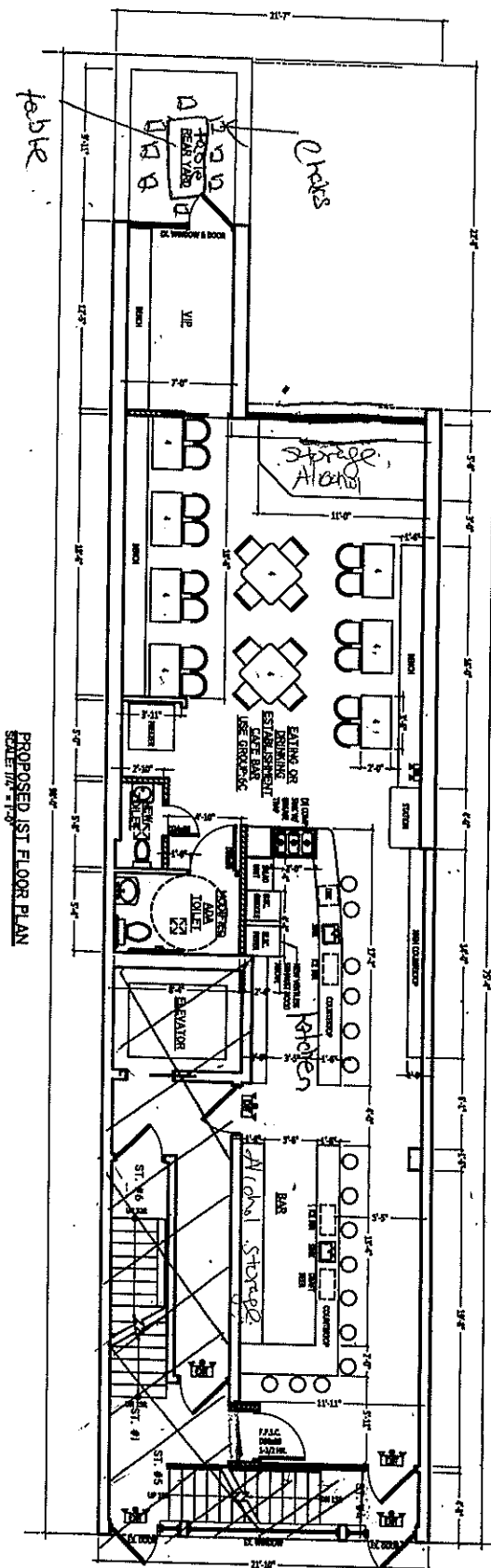

BLEECKER ST