

DATE: _____

APPLICANT INFORMATION:

Name of applicant(s): ELI LILLA INC.

Trade name (DBA): CAFFE ROMA

Premises address: 383-385 BROOME ST.

Cross Streets and other addresses used for building/premise:
MULBERRY ST + MOTT ST.

CONTACT INFORMATION:

Principal(s) Name(s): VINCENT ZECCARDI

Office or Home Address: 383-385 BROOME ST.

City, State, Zip: NY NY 10013

Telephone #: [REDACTED] email: [REDACTED]

Landlord Name / Contact: [REDACTED]

Landlord's Telephone and Fax: [REDACTED]

| NAMES OF ALL PRINCIPAL(s): | NAMES / LOCATIONS OF PAST / CURRENT LICENSES HELD |
|----------------------------|---|
| <u>VINCENT ZECCARDI</u> | <u>CAFFE ROMA 518 WASHINGTON ST HOBOKEN, NJ</u> |
| <u>VINCENT ZECCARDI</u> | _____ |
| _____ | _____ |

Briefly describe the proposed operation (i.e. "We are a family restaurant that will focus on..."):
WE ARE A FAMILY BAKERY IN EXISTANCE FOR OVER 125
YEARS. WE SPECIALIZE IN AFTER DINNER DESSERTS AND
PASTRIES. WE HAVE NUMEROUS REQUESTS FOR AFTER DINNER COCKTAILS
AND SAMBUCA OR ANISETTO WITH COFFEES.

Hunting for the Very Best

a food writer's journey

TAG ARCHIVES: CAFFE ROMA

Little Italy Isn't Dead: Caffe Roma

Posted on [March 8, 2018](#) | [Leave a comment](#)

Periodically, there's an article about how Little Italy is dead or dying. Yes, it's more of a tourist destination and less of a neighborhood where Italian people live. There are still some Italians there, and there are Italian-American-owned businesses there. A recent article in the *New York Times* made me want to write a series on Little Italy Isn't Dead and feature some of the businesses there.

Caffe Roma

Caffe Roma was formerly Caffe Ronca, opened by Italian immigrant Pasquale Ronca in 1891 and run with his brother Giovanni who came to NYC a year later. It was a hangout for NYC's literati—writers, artists, musicians, actors. Pasquale would go on to be impresario for Italian songs for the Brooklyn Academy of Music. In 1952, Vincenzo Zeccardi, an immigrant and former church ceiling painter, bought it, and it is still in his family today.

WHAT TYPE(S) OF LICENSE(S) ARE YOU APPLYING FOR (MARK ALL THAT APPLY):

- a new liquor license (Restaurant Tavern / On premise liquor Other)
- an UPGRADE of an existing Liquor License
- an ALTERATION of an existing Liquor License
- a TRANSFER of an existing Liquor License
- a HOTEL Liquor License
- a DCA CABARET License
- a CATERING / CABARET Liquor License
- a BEER and WINE License
- a RENEWAL of an existing Liquor License
- an OFF-PREMISE License (retail)
- OTHER : _____

If upgrade, alteration, or transfer, please describe specific nature of changes:
(Please include physical or operational changes including hours, services, occupancy, ownership, etc.)

N/A

If this is for a new application, please list previous use of location for the last 5 years:

BAKERY (open since 1891)

Is any license under the ABC Law currently active at this location? yes no

If yes, what is the name of current / previous licensee, license # and expiration date: _____

Have any other licenses under the ABC Law been in effect in the last 10 years at this location?

yes no

We are researching the past history for a past liquor license at this location

If yes, please list DBA names and dates of operation:

PREMISES:

By what right does the applicant have possession of the premises?

Own Lease Sub-lease Binding Contract to acquire real property other: _____

Type of Building: Residential Commercial Mixed (Res/Com) Other: _____
Both

Number of floor: ³⁸³ 4 ³⁸⁵ 5 Year Built: ³⁸³ 1900 ³⁸⁵ 1900

Describe neighboring buildings: Mixed Use

Zoning Designation: C6-2G L1

Zoning Overlay or Special Designation (applicable) _____

Block and Lot Number: 471 ³⁸³ 1 ³⁸⁵ 37 & 36

Does the premise occupy more than one building, zoning lot, tax lot or more than one floor? yes no

Is the premise located in a historic district? yes no

(if yes, have all exterior changes or changes governed by the Landmarks Preservation Commission (LPC) been approved by the LPC? yes no, please explain : _____

Will any outside area or sidewalk café be used for the sale or consumption of alcoholic beverages? (including sidewalk, roof and yard space) no yes : explain SIDEWALK CAFE

What is the proposed Occupancy? 74

Does the premise currently have a valid Certificate of Occupancy (C of O) and all appropriate permits? no yes APPLYING FOR LNO

If yes, what is the maximum occupancy for the premises? 74

If yes, what is the use group for the premises? 6

If yes, is proposed occupancy permitted? yes no, explain : _____

If your occupancy is 75 or greater, do you plan to apply for Public Assembly permit? yes no N/A

Do you plan to file for changes to the Certificate of Occupancy? yes no
(if yes, please provide copy of application to the NYC DOB)

Will the façade or signage be changed from what currently exist at the premise? no yes

(if yes, please describe: _____

INTERIOR OF PREMISES:

1100 in Seating area
1100 in Bakery area
550 in Basement Storage area

What is the total licensed square footage of the premises? 2750

If more than one floor, please specify square footage by floors: _____

If there is a sidewalk café, rear yard, rooftop, or outside space, what is the square footage of the area?

SIDEWALK CAFE 175 SQ FT.

If more than one floor, what is the access between floors? STAIRCASE

How many entrances are there? 2 How many exits? 7 How many bathrooms? 2

Is there access to other parts of the building? no yes, explain: _____

OVERALL SEATING INFORMATION:

Total number of tables? 14 Total table seats? 58

Total number of bars? 1 Total bar seats? 7

Total number of "other" seats? 22 please explain: sidewalk cafe seating

Total OVERALL number of seats in Premises: 65

BARS:

How many *stand-up bars / bar seats are being applied for on the premises? Bars 1 Seats 7

How many service bars are being applied for on the premises? 0

Any food counters? no yes, describe: _____

For Alterations and Upgrades:

Please describe all current and existing bars / bar seats and specific changes: _____

* A stand-up bar is any bar or counter (whether seating or not) over which a member of the public can order, pay for and receive food and alcoholic beverages.

PROPOSED METHOD OF OPERATION:

What type of establishment will this be? (check all that apply)

Bar Bar & Food Restaurant Club/ Cabaret Hotel Other: _____

Bakery / Cafe

What are the Hours of Operation?

Sunday: 8^A to 11^P Monday: 8^A to 11^P Tuesday: 8^A to 11^P Wednesday: 8^A to 11^P Thursday: 8^A to 11^P Friday: 8^A to 12^A Saturday: 8^A to 12^A

Will the business employ a manager? no ___ yes, name / experience if known : owner will manage

Will there be security personnel? no ___ yes(if yes, what nights and how many?)

Do you have or plan to install French doors, accordion doors or windows that open? no ___ yes

If yes, please describe : _____

Will you have TV's ? no ___ yes (how many?) _____

Type of MUSIC / ENTERTAINMENT: ___ Live Music ___ Live DJ ___ Juke Box Ipod / CDs ___ none

Expected Volume level: Background (quiet) ___ Entertainment level ___ Amplified Music (check all that apply)

Do you have or plan to install soundproofing? no ___ yes EXISTING

IF YES, will you be using a professional sound engineer? _____

Please describe your sound system and sound proofing: IPOD w/ 2 small speakers

Will you be permitting: no promoted events no scheduled performances no outside promoters

no any events at which a cover fee is charged? no private parties

Do you have plans to manage or address vehicular traffic and crowd control on the sidewalk caused by your establishment? no ___ yes (if yes, please attach plans)

Will you be utilizing no ropes no movable barriers no other outside equipment (describe) no

Are your premises within 200 feet of any school, church or place of worship? no ___ yes
CHURCH LISTED ON SLA WEBSITE HAS BEEN CLOSED.

If there is a school, church or place of worship within 200 feet of your premises or on the same block, please submit a block plot diagram or area map showing its' location in proximity to your applicant premises (no larger than 8 1/2 " x 11").

Indicate the distance in feet from the proposed premise:

Name of School / Church: _____

Address: _____ Distance: _____

Name of School / Church: _____

#5

Address: _____ Distance: _____

Name of School / Church: _____

Address: _____ Distance: _____

Please provide contact information for Residents / Community Board and confirm that if complaints are made you will address it immediately.

Contact Person: _____ Phone: _____

Address: _____

Email : _____

Application submitted on behalf of the applicant by:



Signature

Print or Type Name Michael Kelly

Title AUTHORIZED REPRESENTATIVE

Thank you for your cooperation. Please return this questionnaire along with the other required documents as soon as you can. This will expedite your application and avoid any unnecessary delays. Use additional pages if necessary.



Community Board 2, Manhattan
SLA Licensing Committee
Carter Booth, Co-Chair
Robert Ely, Co-Chair

Proximity Report for Location:

July 15, 2020

383 Broome St, New York, NY, 10013

* This report is for informational purposes only in aid of identifying establishments potentially subject to 500 and 200 foot rules. Distances are approximated using industry standard GIS techniques and do not reflect actual distances between points of entry. The NYS Liquor Authority makes no representation as to the accuracy of the information and disclaims any liability for errors.

Closest Liquor Stores

| Name | Address | Approx. Distance |
|-------------------------------|--------------------------------|------------------|
| GROTTA AZZURRA IMPORTS INC | 177 MULBERRY ST STORE 1A | 95 ft |
| SA VINO ITALIANO INC. | 200 GRAND ST | 370 ft |
| EL CORRAL SOHO INC | 406 BROOME ST, STORE H AKA 199 | 410 ft |
| WINE O INC | 171 ELIZABETH ST | 560 ft |
| YOUNG NAM KANG | 52 SPRING STREET | 605 ft |
| R & S 49 LIQUOR CORP | 92 ELIZABETH ST | 740 ft |
| GRANYETTE WINES & SPIRITS INC | 137 GRAND ST | 835 ft |

Churches within 500 Feet

| Name | Approx. Distance |
|---------------------------|------------------|
| Most Holy Crucifix Church | 20 ft |

Schools within 500 Feet

| Name | Address | Approx. Distance |
|------|---------|------------------|
|------|---------|------------------|

On-Premise Licenses within 750 Feet

| Name | Address | Approx. Distance |
|---------------------------------|---------------------|------------------|
| MULBERRY STREET BAR LLC | 176 1/2 MULBERRY ST | 45 ft |
| GROTTA AZZURRA INN INC | 177 MULBERRY STREET | 95 ft |
| SUD 123 INCORPORATED | 178 MULBERRY ST | 100 ft |
| 389 BROOME LLC | 389 BROOME ST | 130 ft |
| LUNELLA RISTORANTE INC | 173 MULBERRY STREET | 150 ft |
| LA MELA RISTORANTE ITALIANO INC | 171 MULBERRY STREET | 170 ft |
| LETS EAT CANTINA INC | 173 MOTT ST | 170 ft |
| 390 BROOME RESTAURANT LLC | 390 BROOME ST | 175 ft |
| 164 MULBERRY STREET CORP | 164 MULBERRY STREET | 220 ft |
| CEKAJ CORP | 165 MULBERRY ST | 240 ft |
| SPRING SOHO INC | 98 KENMARE ST | 315 ft |
| 161 MULBERRY RESTAURANT LLC | 161 MULBERRY ST | 330 ft |
| SANUK LLC | 52 KENMARE ST | 330 ft |
| TOMINO LLC | 192 GRAND ST | 370 ft |
| LASSO NYC INC | 192 MOTT ST | 375 ft |
| EMMANUEL NY CORP | 194 GRAND ST | 375 ft |

| Name | Address | Approx. Distance |
|--|--------------------------------|------------------|
| 153 ELIZABETH HOTEL LLC AND BLUE BELL RESTAURANT L | 153 ELIZABETH ST AKA 40 KENMAR | 385 ft |
| SUPERNATURAL WINE INC & SUPERNATURAL WINES NY LLC | 247 249 CENTRE ST | 405 ft |
| EGG SHOP LES LLC, THE | 151 ELIZABETH ST | 420 ft |
| GENUINE GRAND ST NYC LLC | 191 GRAND ST | 435 ft |
| FERRARA FOODS & CONFECTION INC | 195 GRAND STREET | 445 ft |
| 174 GRAND STREET CORP | 174 GRAND STREET | 450 ft |
| 114 KENMARE ASSOCIATES LLC | 106 KENMARE AKA 199 LAFAYETTE | 475 ft |
| SUGAR BEETS INC | 239 CENTRE ST | 480 ft |
| GRAN TIVOLI LLC | 199 LAFAYETTE ST | 490 ft |
| CAFFE VETRO INC | 200 MOTT ST | 490 ft |
| TOKANA CAFE BAR RESTORANT INC | 163 ELIZABETH ST | 490 ft |
| MARGHERITA CORPORATION | 197 GRAND ST | 490 ft |
| JO RACH INC | 148 MULBERRY STREET | 500 ft |
| SOHO HUMMUS LLC | 19 CLEVELAND PL | 500 ft |
| TAVA CAFE LLC | 202 MOTT ST | 520 ft |
| 343 BROOME STREET RESTAURANT INC | 343 BROOME ST | 525 ft |
| CHERRY LANE INC | 349 BROOME ST | 530 ft |
| BLACK ROCK KITCHEN INC | 171 GRAND ST | 540 ft |
| LITTLE ITALY SPEAK EASY INC. | 149 MULBERRY STREET | 540 ft |
| PIZZA OF 32 SPRING STREET INC | 32 SPRING STREET | 545 ft |
| SPRING LOUNGE LLC | 209 MULBERRY ST | 565 ft |
| NEW RESTART INC | 145 147 MULBERRY STREET | 565 ft |
| BL 98 KENMARE NY LLC | 19 KENMARE ST | 565 ft |
| MARI MAKAN LLC | 20 SPRING ST | 585 ft |
| IRIDIUM RESTAURANT CORP | 20 SPRING STREET | 595 ft |
| PSSP NY INC | 143 MULBERRY STREET | 595 ft |
| AGOODLOOK LLC | 174 ELIZABETH ST | 600 ft |
| 18 FRONT INC | 18 SPRING STREET | 605 ft |
| 14 SPRING STREET CAFE LLC | 14 SPRING STREET | 620 ft |
| BUFFANNA INC | 141 MULBERRY STREET | 625 ft |
| 212 LAFAYETTE ASSOCIATES LLC | 212 LAFAYETTE STREET | 630 ft |
| OMAKASA 56 SPRING LLC | 56 SPRING ST | 635 ft |
| TWELVE SPRING ST REST CORP | 12 SPRING ST AKA176ELIZABETHST | 645 ft |
| 218 LLC | 218 LAFAYETTE STREET | 645 ft |
| SPRING REST GROUP LLC | 53 SPRING ST | 655 ft |
| BOWERY RESTAURANT GROUP LLC | 146 BOWERY | 655 ft |
| ZIA MARIA LITTLE ITALY INC | 138 MULBERRY ST | 670 ft |
| CORIANDER FACTORY INC | 222 LAFAYETTE ST | 675 ft |
| ED'S LOBSTER BAR LLC | 222 LAFAYETTE STREET | 685 ft |
| 133 MULBERRY OPERATING CORP | 133 MULBERRY ST | 700 ft |
| ACT VENTURES LLC | 161 LAFAYETTE ST | 700 ft |
| SWEET 101 LLC | 161 LAFAYETTE STREET AKA 155 G | 700 ft |
| MOLLY PICON LLC | 224 LAFAYETTE ST | 705 ft |
| MIKA FOOD LLC | 214 MULBERRY ST | 720 ft |
| PAESANO REST CORP | 136 MULBERRY ST | 725 ft |
| MM 130 BOWERY REST. CORP. | 130 BOWERY | 730 ft |

| Name | Address | Approx. Distance |
|----------------------|---------------------------|------------------|
| UNCLE BOON'S LLC | 7 SPRING ST | 735 ft |
| 5 SPRING STREET CORP | 5 SPRING STREET GROUND FL | 745 ft |
| ASC INC | 134 MULBERRY ST | 745 ft |

Pending Licenses within 750 Feet

| Name | Address | Approx. Distance |
|-------------------------------|---------------------|------------------|
| ROOT NOLITA LLC | 371 BROOME ST | 140 ft |
| EASY VICTOR LLC | 98 KENMARE ST | 325 ft |
| BONDI-75 KENMARE STREET LLC | 75 KENMARE ST | 340 ft |
| MAVERICK KWUN MING WONG | 186 GRAND ST | 370 ft |
| HSP PARTNERS LLC | 25 CLEVELAND PL | 465 ft |
| 128 BILLIARD INC | 128 ELIZABETH ST | 475 ft |
| ANGELO OF MULBERRY STREET INC | 146 MULBERRY STREET | 540 ft |
| GREEN GARDEN VILLAGE INC | 214-216 GRAND ST | 565 ft |

Unmapped licenses within zipcode of report location

| Name | Address |
|------|---------|
|------|---------|

Caffe Roma

Main Menu

INSALATE E ANTIPASTI

Insalata Del Giorno

daily salad

Piccola. \$5.25

Grande. \$8.25

Insalata Di Tonno

tuna salad

Piccola. \$5.25

Grande. \$8.25

Insalata Cinese

Piccola. \$5.25

Grande. \$7.95

Insalata Di Spinaci

Piccola. \$5.75

Grande. \$8.25

Chicken Chipotle

Piccola. \$5.75

Grande. \$8.25

PANINI SANDWICHES - HOT

All Panini Served With Chips

Rustica

\$7.50

grilled chicken, gruyere,
caramelized onions & pesto
mayonnaise served on a rustic roll

Lucchese

\$7.50

turkey, provolone, fresh avocado,
sun-dried tomatoes, fresh basil &
kalamata spread served on filone

Italiana

\$7.50

grilled chicken, mayonnaise, fresh
roma tomatoes, fresh basil, red
onion & mixed greens served on
filone

Vento

\$7.50

tuna, mayonnaise, lettuce, tomato,
pesto & swiss cheese served on a
rustic roll

Torina

\$7.50

tuna, swiss cheese, roasted bell
pepper mayonnaise & fresh baby
spinach served on focaccia

PANINI SANDWICHES - COLD**Americana****\$7.50**

black forest ham, apple chutney,
caramelized onions, brie & spinach
served on a rustic roll

Milanese**\$7.50**

wine-cured salami, balsamic
vinegar, gruyere & organic greens
served on a rustic roll

Siciliano**\$7.50**

breaded eggplant, roasted
peppers, provolone, grilled
zucchini & balsamic vinegar
served on filone.

Parma**\$7.95**

imported prosciutto, fresh
mozzarella, roma tomatoes, mixed
greens, fresh basil, olio d' oliva &
balsamic vinegar served on a
country italian roll

Caprese**\$7.25**

fresh mozzarella, roma tomatoes,
basil, red onions, balsamic
dressing & organic greens served
on a country italian roll.

DESSERT

Gelato

.....\$2.25

.....\$4.50

Biscotti

.....\$1.25

.....\$1.50

Tiramisu

\$4.25

Cannoli

.....\$3.95

.....\$4.25

Assorted Cookies

.....\$1.25

.....\$1.75

disclaimer: *pricing and availability subject to change.*

Terms of Service | Privacy Policy

ADDITIONS

| | | | |
|-------------------------|---------------|--------------|---------------|
| Baguette, Butter | \$1.85 | Toast | \$1.75 |
|-------------------------|---------------|--------------|---------------|

| | | | |
|----------------|---------------|--------------|---------------|
| Sausage | \$2.25 | Bacon | \$2.25 |
|----------------|---------------|--------------|---------------|

| | | | |
|------------|---------------|--|--|
| Ham | \$2.00 | | |
|------------|---------------|--|--|

CAFFE ROMA

383-385 Broome Street
New York, N.Y. 10013

— BROOME STREET —

— MULBERRY STREET —

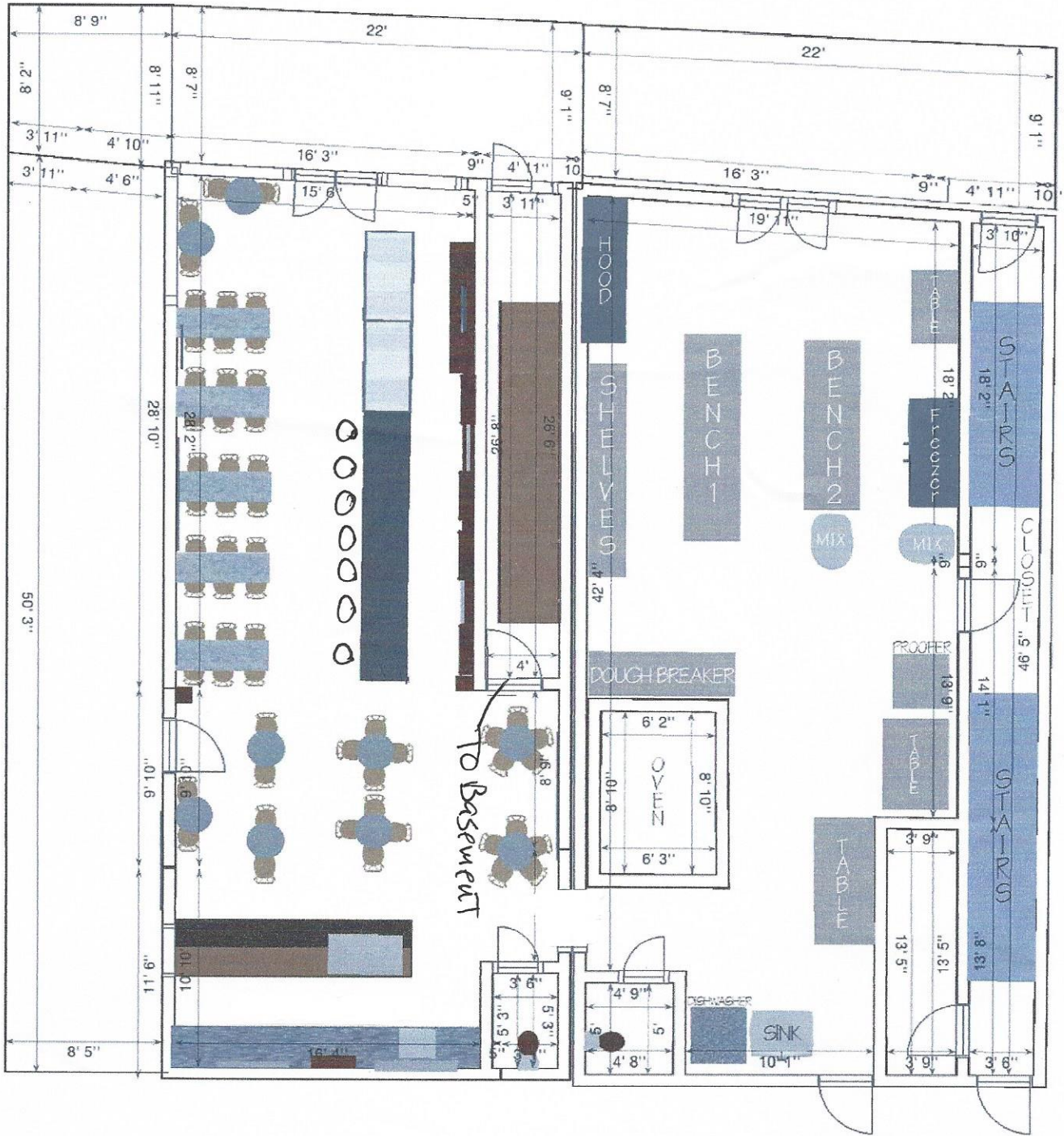

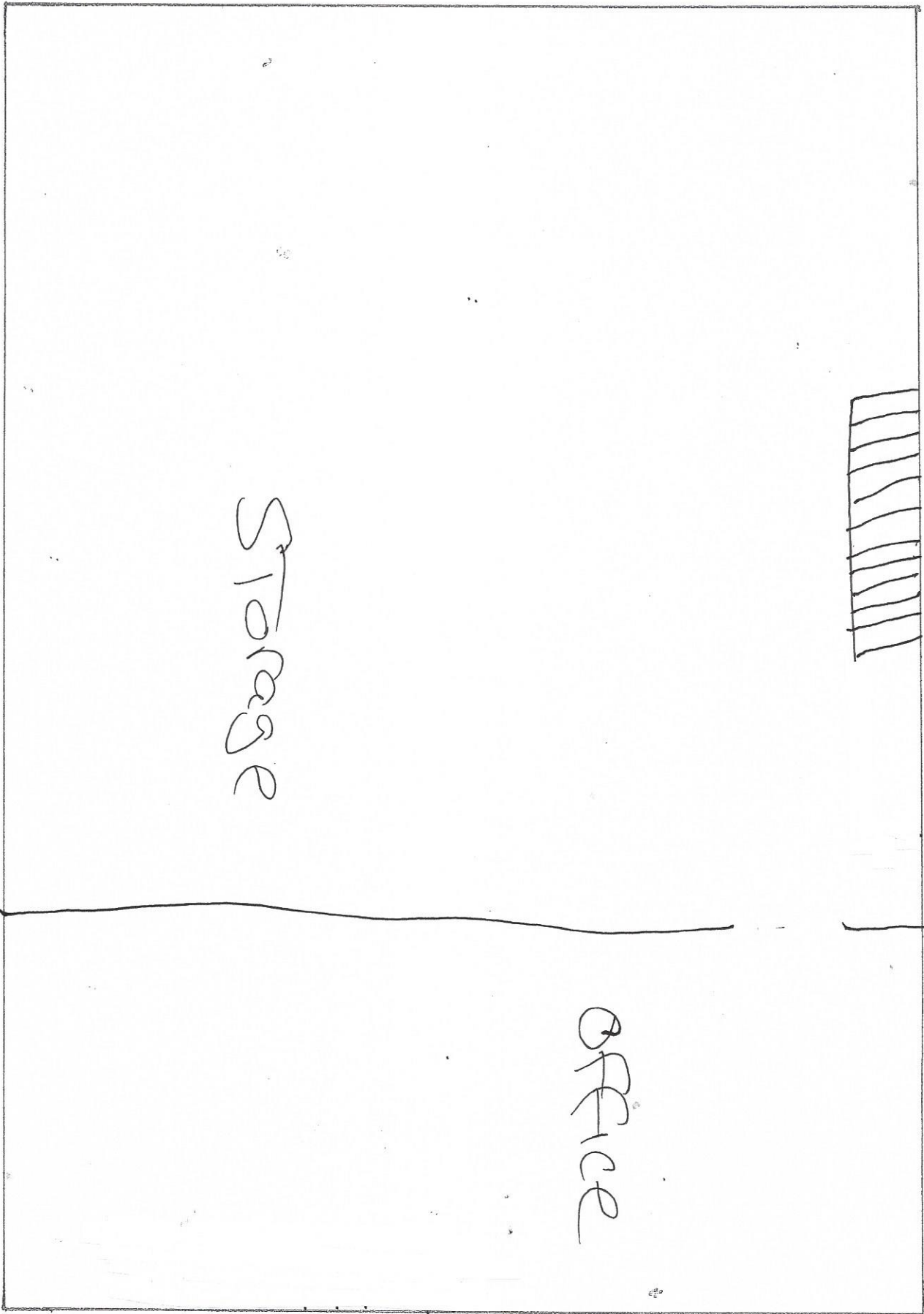

Storage

Office

Basement